

MANHOLE STAKE-OUT TABLE

MH NO	EACROSS DD STA	OFFSET
100A	4+00.00	42.8' LEFT
100	4+45.00	0' LEFT
101	3+55.00	57' LEFT
102	3+97	5.5' LEFT

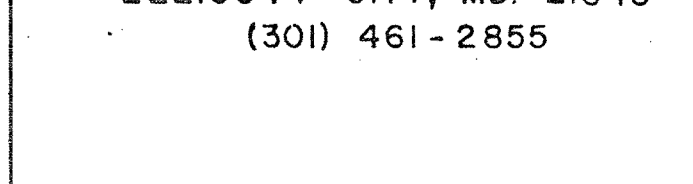
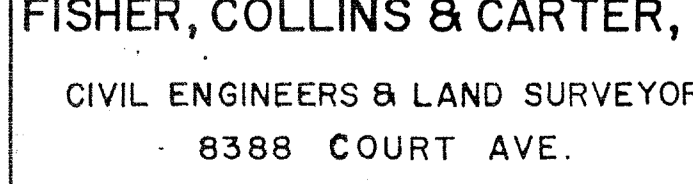
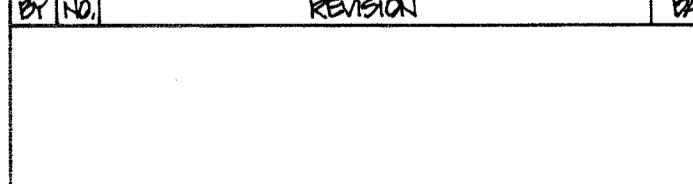
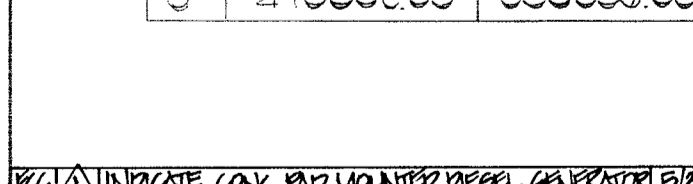
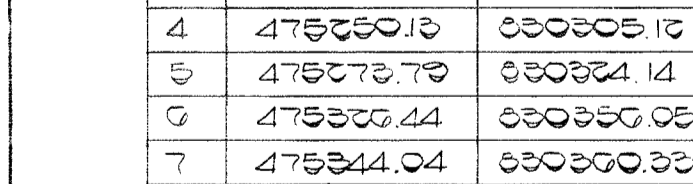
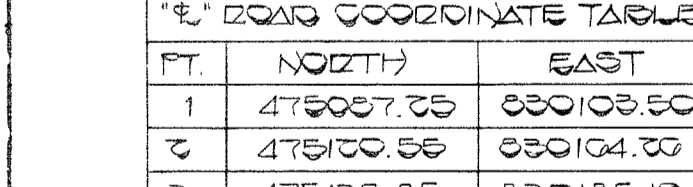
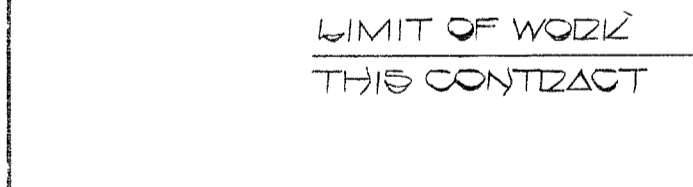
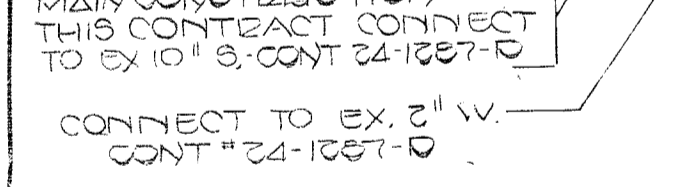
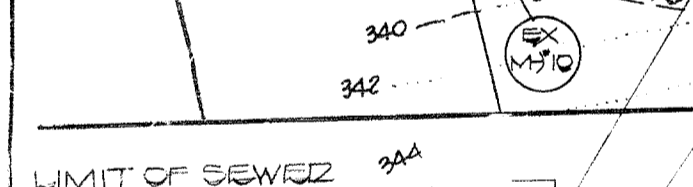
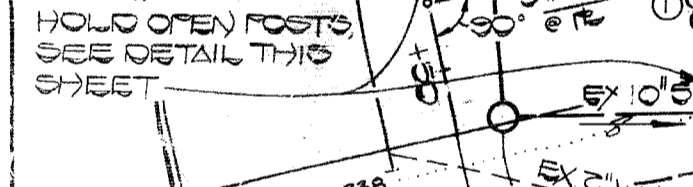
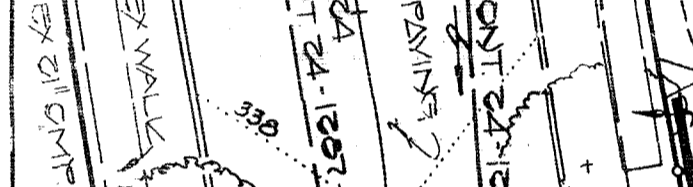
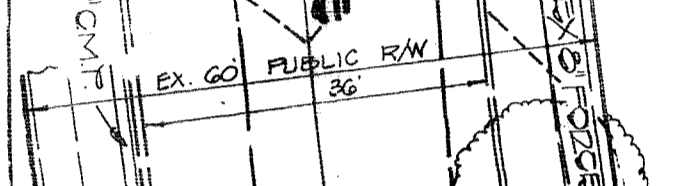
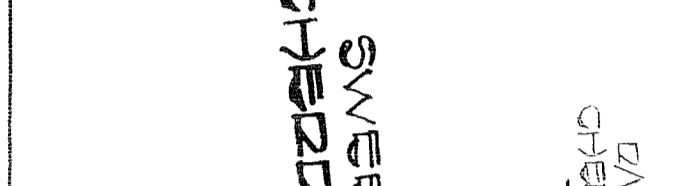
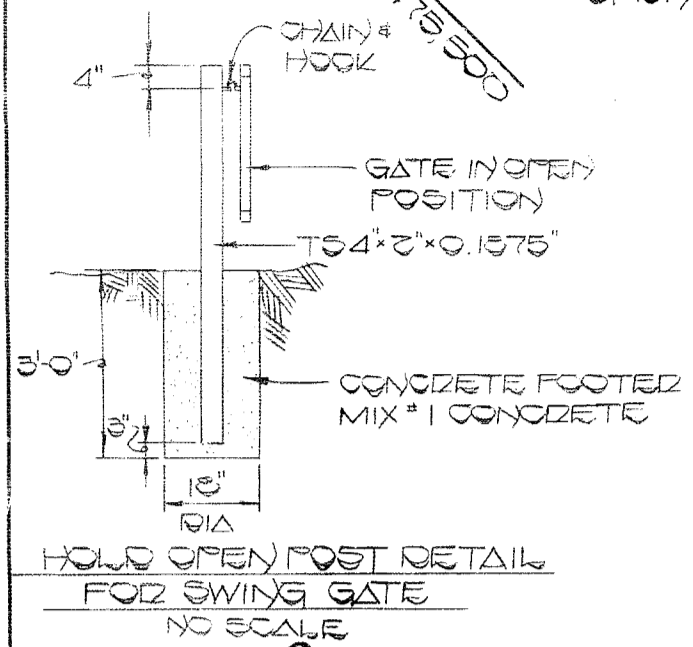
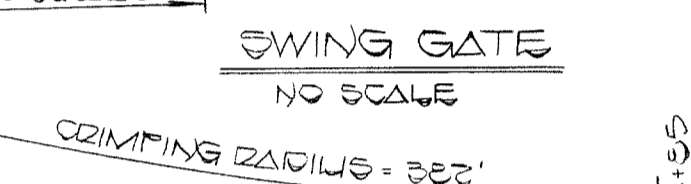
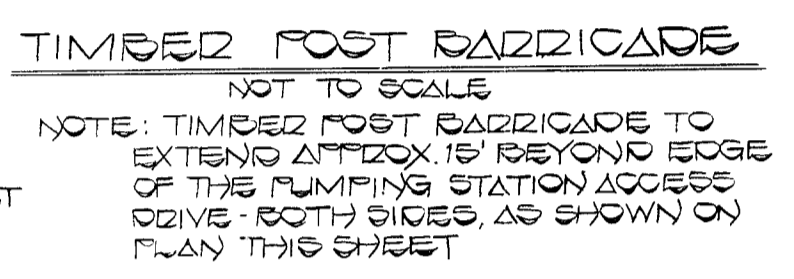

- GENERAL NOTES:**
- TOTAL AREA OF PROPERTY: 31,400 SQ. FT.
 - PRESENT ZONING: R-20 (RESIDENTIAL-SINGLE).
 - PROPERTY REFERENCE: PLAT NO. 6928
 - PROPERTY IS SHOWN ON TAX MAP 46 - PARCELS 190 AND 255.
 - PARKING DATA:
 - INTENDED USE OF STRUCTURE: WASTEWATER PUMPING STATION.
 - NUMBER SPACES REQUIRED: 2
 - NUMBER SPACES PROVIDED: 2 REGULAR SPACES (9'x18').
 - CONTRACTOR SHALL NOTIFY THE HOWARD COUNTY CONSTRUCTION INSPECTION/SURVEY DIVISION 24 HOURS PRIOR TO COMMENCEMENT OF WORK AT 792-7272.
 - ALL PAVING AND STORM DRAIN CONSTRUCTION SHALL BE IN ACCORDANCE WITH THE HOWARD COUNTY ROAD CONSTRUCTION CODE AND STANDARD SPECIFICATIONS.
 - EXISTING UTILITIES SHOWN HEREON HAVE BEEN LOCATED FROM FIELD AND OFFICE INFORMATION. THE CONTRACTOR SHALL DETERMINE THE EXACT LOCATION OF EXISTING UTILITIES TO HIS OWN SATISFACTION BEFORE MAKING ANY CONNECTION THERETO OR EXCAVATING IN THE AREA THEREOF.
 - THE CONTRACTOR SHALL NOTIFY MISS UTILITY 1-800-257-7777 A MINIMUM OF THREE DAYS PRIOR TO BEGINNING ANY CONSTRUCTION THEREON.
 - SEE ARCHITECTURAL DRAWINGS FOR BUILDING DIMENSIONS.
 - PHOTOGRAMMETRIC SURVEY PROVIDED BY PHOTO SCIENCE INC. - AIRPARK ROAD, GAITHERSBURG, MARYLAND 20760 - DATED: 2/9/81.
 - ALL EXTERIOR LIGHTING OF BUILDING WILL BE DIRECTED DOWNWARD.
 - NO PARKING WILL BE PERMITTED ALONG THE ACCESS ROAD.
 - STORMWATER MANAGEMENT FOR THIS PROJECT WAS PROVIDED UNDER F04-120

FORCE MAIN STAKE-OUT TABLE

ITEM	FORCE MAIN STA.	EACROSS DD STA.	OFFSET
EMERGE MH	0+10	4+25.00	0' RIGHT
0 1/2 H.E.	0+07	4+00.00	0' RIGHT
BEGIN CRIMP	1+44.00	2+00.70	0' LEFT
END CRIMP	1+75.00	2+03.01	7' LEFT
BEGIN CRIMP	2+05	1+55.14	7' LEFT
END CRIMP	2+75	0+03.00	57' LEFT

PLAN
SCALE: 1" = 20'

LANDSCAPE LEGEND

WHITE PINE - PINUS STROBUS
5 TO 6' HEIGHT PLANT @ 10' O/C

SPECIAL STABILIZATION NOTE

FOR SLOPES STEEPER THAN 3:1 USE SEEDING MIXTURE OF:
1. COWAN VETCH, INOCULATED 15 LBS./ACRE
2. CENTUKIA 21 TALL FESCUE 40 LBS./ACRE
PREPARE SITE IN ACCORDANCE WITH SEDIMENT CONTROL NOTES.

STREET TREES - 2 1/2" CAL. (MIN) MAPLES PLANTED @ 40' O/C. SEE F-84-120.

ELECTRICAL CONDUIT ENGAGEMENT RETAIL
NO SCALE

OWNER AND DEVELOPER:
WINCHESTER HOMES INC.
13321 NEW HAMPSHIRE AVENUE
SILVER SPRING, MARYLAND 20906
TELEPHONE: (301) 622-4300

LOT NO.	ADDRESS
45	6315 SWEET CHERRY LANE
	ADDRESS CHART

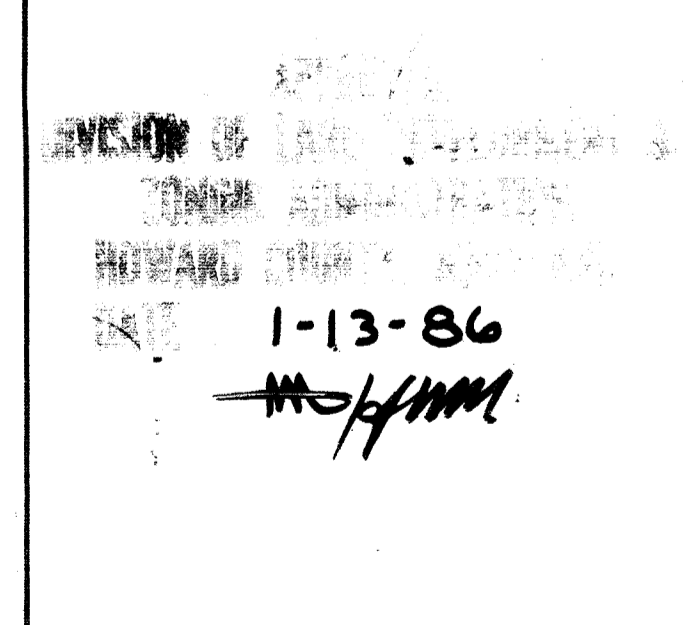

FISHER, COLLINS & CARTER, INC.
CIVIL ENGINEERS & LAND SURVEYORS
8388 COURT AVE.
ELLCOTT CITY, MD. 21043
(301) 461-2855

ENGINEER'S CERTIFICATE
I HEREBY CERTIFY THAT THIS PLAN FOR EROSION AND SEDIMENT CONTROL REPRESENTS A PRACTICAL AND WORKABLE PLAN BASED ON MY PERSONAL KNOWLEDGE OF THE SITE CONDITIONS AND THAT IT WAS PREPARED IN ACCORDANCE WITH THE REQUIREMENTS OF THE HOWARD SOIL CONSERVATION DISTRICT.

Signature: *Charles J. Carter*
DATE: 10/15/86

DEVELOPER'S CERTIFICATE
"I/WE CERTIFY THAT ALL DEVELOPMENT AND CONSTRUCTION WILL BE DONE ACCORDING TO THIS PLAN OF DEVELOPMENT AND PLAN FOR EROSION AND SEDIMENT CONTROL AND THAT ALL RESPONSIBLE PERSONNEL INVOLVED IN THE CONSTRUCTION PROJECT WILL HAVE A CERTIFICATE OF ATTENDANCE AT A DEPARTMENT OF NATURAL RESOURCES APPROVED TRAINING PROGRAM FOR THE CONTROL OF SEDIMENT AND EROSION BEFORE BEGINNING THE PROJECT. I ALSO AUTHORIZE PERIODIC ON-SITE INSPECTION BY THE HOWARD SOIL CONSERVATION DISTRICT OR THEIR AUTHORIZED AGENTS, AS ARE DEEMED NECESSARY."

Signature: *Richard S. Tempa*
DATE: 10/21/86

REVIEWED FOR HOWARD COUNTY SOIL CONSERVATION DISTRICT AND MEETS TECHNICAL REQUIREMENTS.

U.S. SOIL CONSERVATION SERVICE
DATE: 11/18/86

THIS DEVELOPMENT IS APPROVED FOR EROSION AND SEDIMENT CONTROL BY THE HOWARD SOIL CONSERVATION DISTRICT.
APPROVED: *James E. ...*
DATE: 11/17/86

APPROVED: OFFICE OF PLANNING AND ZONING

PLANNING DIRECTOR: *John W. ...* DATE: 11-18-86
DATE: 11-18-86

APPROVED: HOWARD COUNTY HEALTH DEPARTMENT FOR PUBLIC WATER AND SEWERAGE SYSTEMS.
HEALTH OFFICER: *James ...* DATE: 11-17-86

APPROVED: DEPARTMENT OF PUBLIC WORKS FOR PUBLIC WATER AND SEWER AND STORM DRAINAGE SYSTEMS AND ROADS.

DIRECTOR, PUBLIC WORKS: *...* DATE: 11-18-86

CHIEF, BUREAU OF ENGINEERING: *...* DATE: 11-18-86

SUBDIVISION NAME: CHERRYTREE FARM
SECTION/AREA / LOT: 1 / 1 / 45
PLAT NO.: 6928
BLOCK NO.: 10
ZONE: R-20
TAX / ZONE MAP: 46
ELEC. DIST.: 6TH
CENSUS TR.: 6062
WATER CODE: 6-10
SEWER CODE: 700000

SITE DEVELOPMENT PLAN
CHERRYTREE FARM
SECTION 1 AREA 1
LOT 45
WASTEWATER PUMPING STATION
TAX MAP 46 PARCELS 190 & 255
6TH. ELECTION DISTRICT
HOWARD COUNTY MARYLAND
REVISION DECEMBER 2, 1985
SCALE: 1" = 20'
JANUARY 8, 1985
SHEET 2 OF 15
SITE PLAN SHEET 1 OF 2

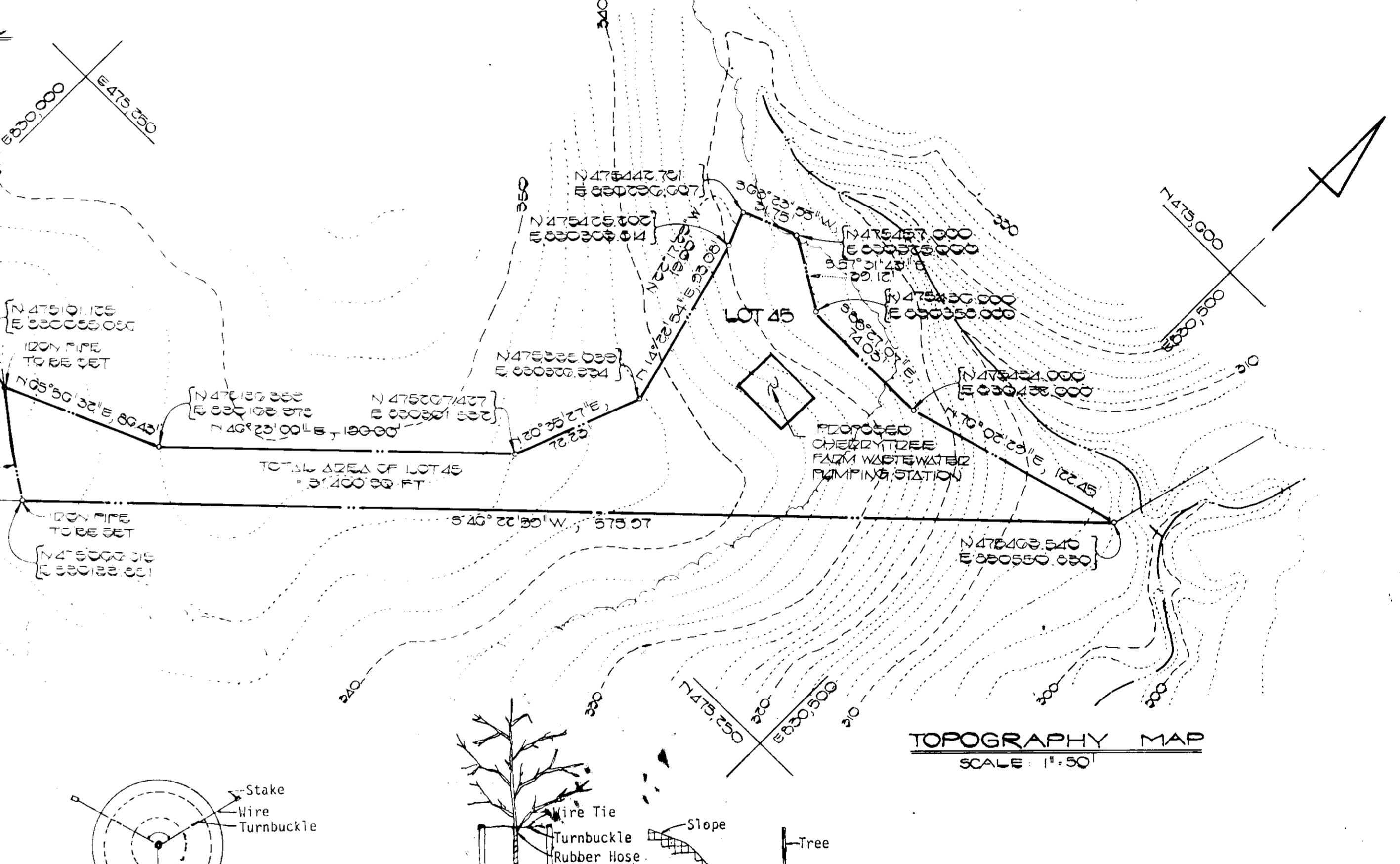
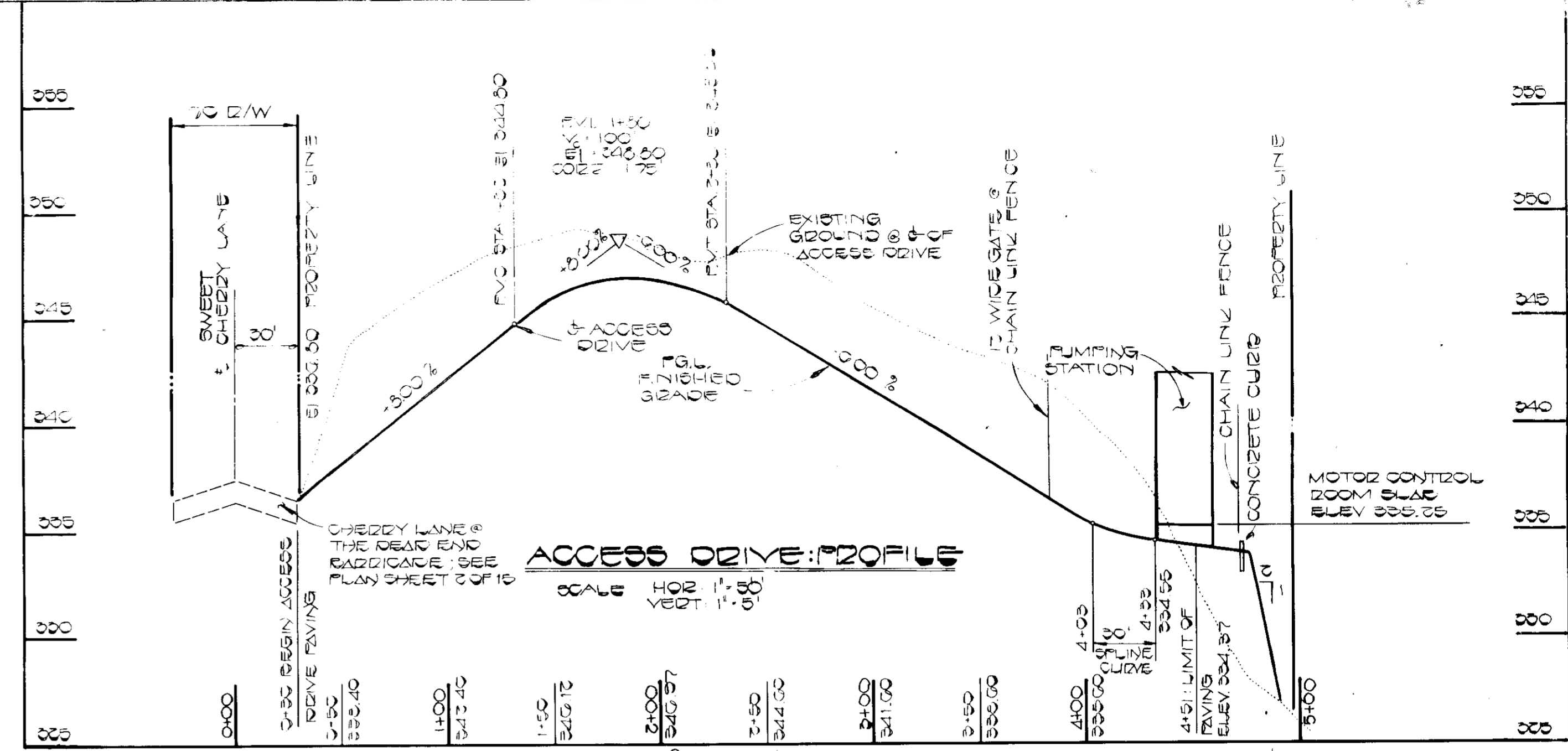
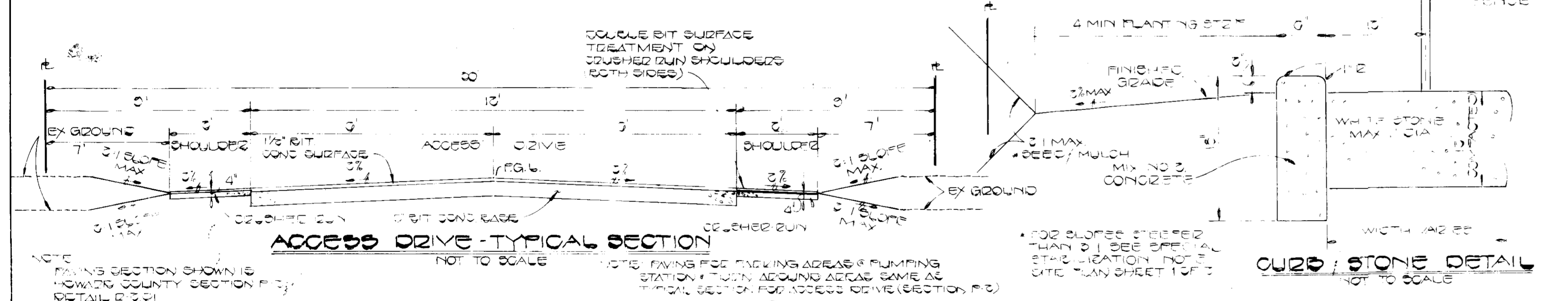
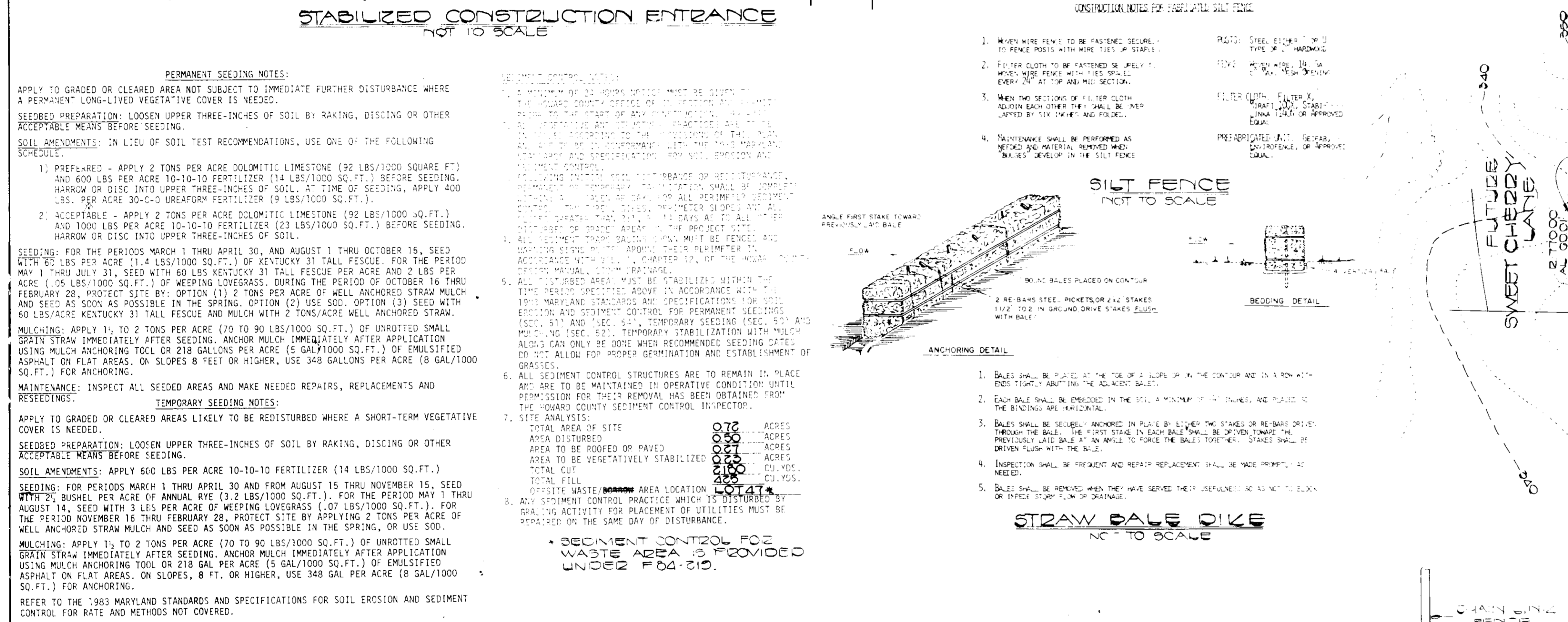
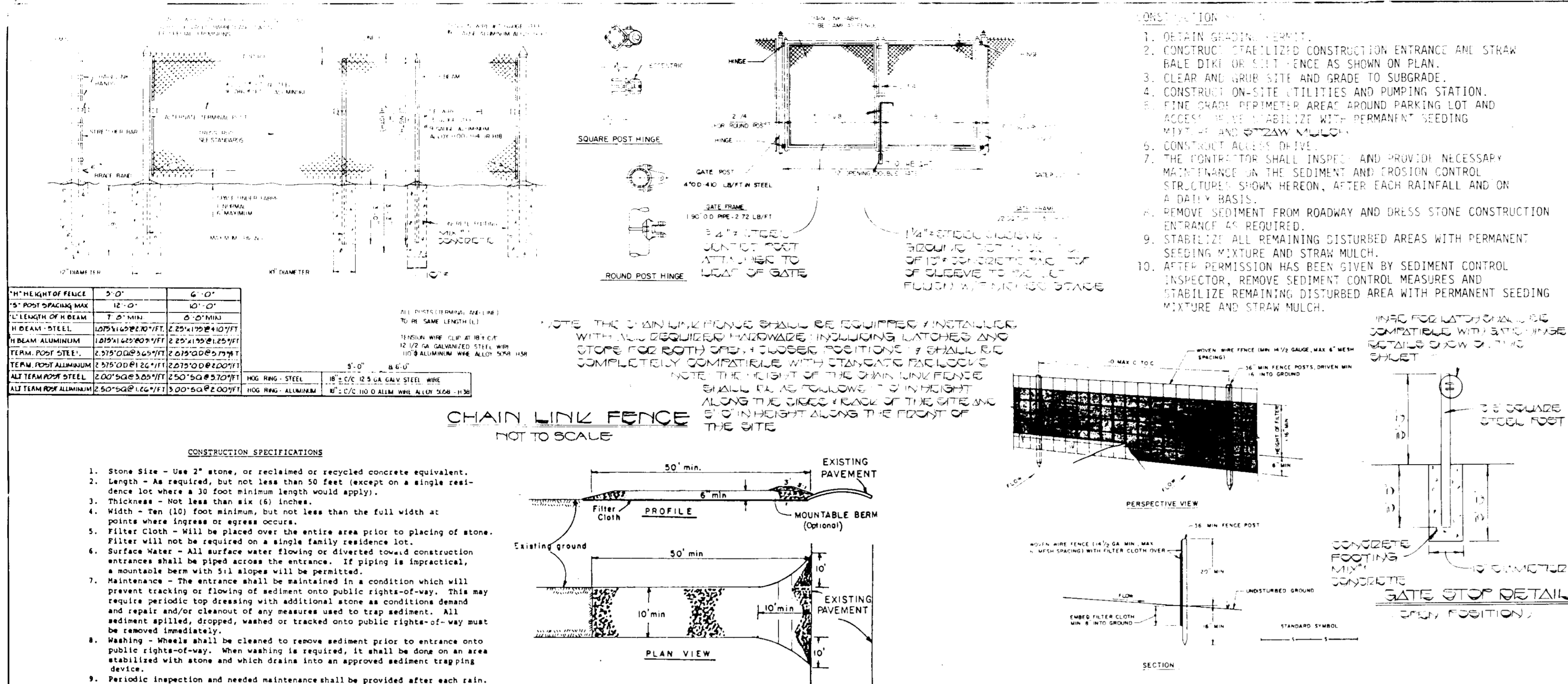

FISHER, COLLINS & CARTER, INC.
CIVIL ENGINEERS & LAND SURVEYORS
8388 COURT AVE.
ELLICOTT CITY, MD. 21043
(301) 461-2855

ENGINEER'S CERTIFICATE
I HEREBY CERTIFY THAT THIS PLAN FOR EROSION AND SEDIMENT CONTROL REPRESENTS A PRACTICAL AND WORKABLE PLAN BASED ON MY PERSONAL KNOWLEDGE OF THE SITE CONDITIONS AND THAT IT WAS PREPARED IN ACCORDANCE WITH THE REQUIREMENTS OF THE HOWARD SOIL CONSERVATION DISTRICT.

Signature: *Charles J. Carter*
DATE: 10/15/86

DEVELOPER'S CERTIFICATE
I/WE CERTIFY THAT ALL DEVELOPMENT AND CONSTRUCTION WILL BE DONE ACCORDING TO THIS PLAN OF DEVELOPMENT AND PLAN FOR EROSION AND SEDIMENT CONTROL AND THAT ALL RESPONSIBLE PERSONNEL INVOLVED IN THE CONSTRUCTION PROJECT WILL HAVE A CERTIFICATE OF ATTENDANCE AT A DEPARTMENT OF NATURAL RESOURCES APPROVED TRAINING PROGRAM FOR THE CONTROL OF SEDIMENT AND EROSION BEFORE BEGINNING THE PROJECT. I ALSO AUTHORIZE PERIODIC ON-SITE INSPECTION BY THE HOWARD SOIL CONSERVATION DISTRICT OR THEIR AUTHORIZED AGENTS, AS ARE DEEMED NECESSARY.

Signature: *Richard S. Kemp*
DATE: 10/11/86

REVIEWED FOR HOWARD COUNTY SOIL CONSERVATION DISTRICT AND MEETS TECHNICAL REQUIREMENTS.

U.S. SOIL CONSERVATION SERVICE DATE: _____

APPROVED: _____ DATE: 11-17-84

APPROVED: OFFICE OF PLANNING AND ZONING
PLANNING DIRECTOR DATE: 11-18-86

CHIEF, DIVISION OF LAND DEVELOPMENT AND ZONING ADMINISTRATION DATE: 11-18-86

APPROVED: HOWARD COUNTY HEALTH DEPARTMENT FOR PUBLIC WATER AND SEWERAGE SYSTEMS. DATE: 11-17-84

APPROVED: DEPARTMENT OF PUBLIC WORKS FOR PUBLIC WATER AND SEWER AND STORM DRAINAGE SYSTEMS AND ROADS. DATE: _____

DIRECTOR, PUBLIC WORKS DATE: _____

CHIEF, BUREAU OF ENGINEERING DATE: _____

SUBDIVISION NAME: CHERRYTREE FARM SECTION AREA 1 LOT 45
FLAT No: 10 BLOCK No: 10 ZONE: R 20 TAX / ZONE MAP: 46 ELEC. DIST: 6 TH CENSUS TR: 6062
WATER CODE: E 10 SEWER CODE: 7000000

NOTES AND DETAIL SHEET
CHERRYTREE FARM
SECTION 1 AREA 1
LOT 45
WASTEWATER PUMPING STATION
TAX MAP 46 PARCELS 190 & 255
6TH. ELECTION DISTRICT
HOWARD COUNTY, MARYLAND
REVISED DECEMBER 2, 1985
SCALE: AS SHOWN JANUARY 8, 1985
SHEET 3 OF 15
SITE PLAN SHEET 2 OF 2

APPROVED
DIVISION OF LAND DEVELOPMENT & ZONING ADMINISTRATION
HOWARD COUNTY, MARYLAND
DATE: 1-13-86

OWNER AND DEVELOPER:
WINCHESTER HOMES INC.
13321 NEW HAMPSHIRE AVENUE
SILVER SPRING, MARYLAND 20906
TELEPHONE: (301) 622-4300