

TYPICAL HOUSES
No Scale

GENERAL NOTES:

1. The land included in this plan is zoned R5A.
2. All coordinates shown hereon are based on the Maryland State Grid System.
3. The area covered is located on Tax Map #42, Parc. 76.
4. The total area of this plan is 4.416 Acres.
5. All roadways are existing.
6. Any damage to county owned rights-of-way shall be corrected at the developer's expense.
7. Number of Units shown: 107.
8. Number of Parking Spaces Required: 214, Provided: 214.
9. Maximum Building Coverage: 40%.
 - A. 210 : 542.7' x 135.4' Min. Lot Size 40
 - B. 220 : 533.2' x 133.2' Min. Lot Size 40
 - C. 250 : 626.7' x 156.4' Min. Lot Size 40

LEGEND

1. Contour Interval 2 Ft.
2. Existing Contour 250
3. Proposed Contour 220
4. Spot Elevation +20.4
5. Direction of Drainage
6. Existing Trees to be Saved
7. Walk Out Basement

NOTE: Approved Road Construction Plans shall be used for installation of Public Utilities.

Public Water & Sewer shown for reference only. See Water & Sewer Plans Contract No. 24-1271-D & F-85-12.

NOTE: Sediment & Erosion Control for Previously Approved Road Construction Plans F-85-12 to be utilized.



Regraded Comm. Open Space Lot 110 1/13/83 & Moved units on lots 89-95

APPROVED: FOR PUBLIC WATER AND PUBLIC SEWERAGE SYSTEMS, HOWARD COUNTY HEALTH DEPARTMENT
 COUNTY HEALTH OFFICER: *[Signature]* DATE: 1-26-85

APPROVED: HOWARD COUNTY OFFICE OF PLANNING & ZONING
 PLANNING DIRECTOR: *[Signature]* DATE: 1-23-85

APPROVED: FOR PUBLIC WATER AND PUBLIC SEWERAGE, STORM DRAINAGE SYSTEMS AND PUBLIC ROADS, HOWARD COUNTY DEPARTMENT OF PUBLIC WORKS
 DIRECTOR: *[Signature]* DATE: 1-24-85

CHIEF BUREAU OF ENGINEERING: *[Signature]* DATE: 1-18-85

APPROVED: *[Signature]* DATE: 12-14-84

NOTE: The Contractor or Developer shall contact the Construction Inspection Survey Division 24 hours in advance of commencement of work at 792-7272.

SUBDIVISION NAME	SECT./AREA	LOT/PARCEL
GLENSHIRE TOWNE	1	Lots 1-107
PLAT # OR L.P.	BLOCK #	ZONED
6068-8070	17	R5A
TAX ZONE MAP	ELEC. DIST.	CENSUS YR.
6TH	6TH	2005-02
WATER CODE	SEWER CODE	
E-14	4420-900	

CLARK · FINEFROCK & SACKETT
 ENGINEERS · PLANNERS · SURVEYORS
 11115 LOCKWOOD DRIVE · SILVER SPRING, MARYLAND 20904 · (301) 593-3400

DESIGNED: R.G.B. SCALE: 1" = 30'

DRAWN: V.H.L. DRAWING: 1 of 5

CHECKED: R.G.B. JOB NO.: 81-060

DATE: 12-19-84 FOR: PULTE HOME CORP. FILE NO.: 81-060-X

1120 New Hampshire Ave. Silver Spring, Md. 20904

SDP - 85-93



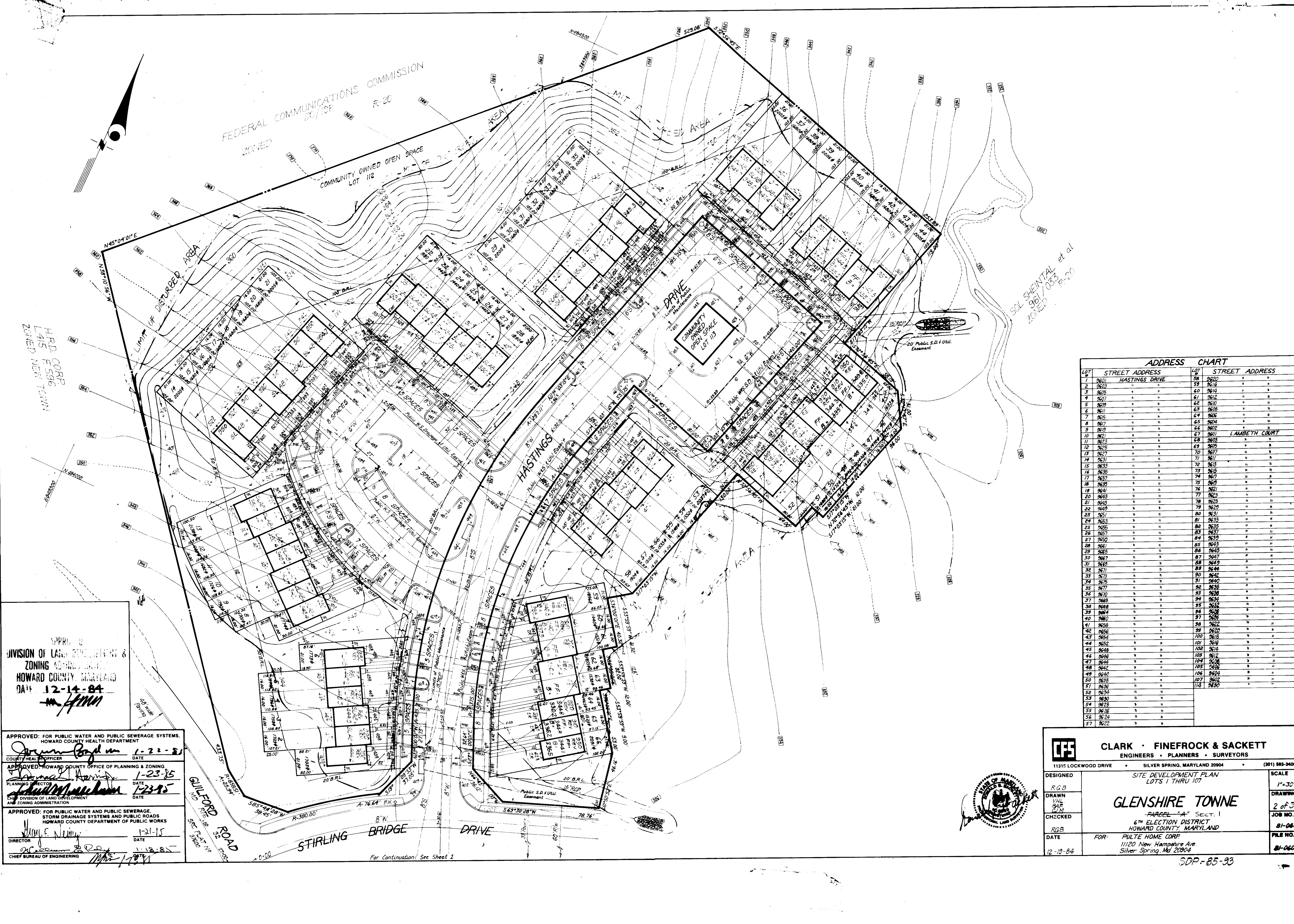

ADDRESS CHART

LOT	STREET ADDRESS	LOT	STREET ADDRESS
1	9601 HASTINGS DRIVE	38	9620
2	9603	39	9618
3	9605	40	9616
4	9607	41	9614
5	9609	42	9612
6	9611	43	9610
7	9613	44	9608
8	9615	45	9606
9	9617	46	9604
10	9619	47	9602
11	9621	48	9600
12	9623	49	9598
13	9625	50	9596
14	9627	51	9594
15	9629	52	9592
16	9631	53	9590
17	9633	54	9588
18	9635	55	9586
19	9637	56	9584
20	9639	57	9582
21	9641	58	9580
22	9643	59	9578
23	9645	60	9576
24	9647	61	9574
25	9649	62	9572
26	9651	63	9570
27	9653	64	9568
28	9655	65	9566
29	9657	66	9564
30	9659	67	9562
31	9661	68	9560
32	9663	69	9558
33	9665	70	9556
34	9667	71	9554
35	9669	72	9552
36	9671	73	9550
37	9673	74	9548
38	9675	75	9546
39	9677	76	9544
40	9679	77	9542
41	9681	78	9540
42	9683	79	9538
43	9685	80	9536
44	9687	81	9534
45	9689	82	9532
46	9691	83	9530
47	9693	84	9528
48	9695	85	9526
49	9697	86	9524
50	9699	87	9522
51	9701	88	9520
52	9703	89	9518
53	9705	90	9516
54	9707	91	9514
55	9709	92	9512
56	9711	93	9510
57	9713	94	9508

APPROVED FOR PUBLIC WATER AND PUBLIC SEWERAGE SYSTEMS, HOWARD COUNTY HEALTH DEPARTMENT
 COUNTY HEALTH OFFICER: *[Signature]* DATE: 1-22-85

APPROVED HOWARD COUNTY OFFICE OF PLANNING & ZONING
 PLANNING DIRECTOR: *[Signature]* DATE: 1-23-85

APPROVED FOR PUBLIC WATER AND PUBLIC SEWERAGE, STORM DRAINAGE SYSTEMS AND PUBLIC ROADS, HOWARD COUNTY DEPARTMENT OF PUBLIC WORKS
 DIRECTOR: *[Signature]* DATE: 1-21-85

CHIEF BUREAU OF ENGINEERING: *[Signature]* DATE: 1-19-85

CLARK · FINEFROCK & SACKETT
 ENGINEERS · PLANNERS · SURVEYORS

11315 LOCKWOOD DRIVE • SILVER SPRING, MARYLAND 20904 • (301) 583-3400

DESIGNED: RGB
 DRAWN: VHL
 CHECKED: RGB

DATE: 12-19-84

SITE DEVELOPMENT PLAN
 LOTS 1 THRU 107

GLENSHIRE TONNE
 PARCEL "A" SECT. 1
 6TH ELECTION DISTRICT
 HOWARD COUNTY, MARYLAND

FOR: PULTE HOME CORP
 11120 New Hampshire Ave.
 Silver Spring, Md 20904

SCALE: 1"=30'
 DRAWING: 2 of 3
 JOB NO.: 81-060
 FILE NO.: 81-060-X

GENERAL NOTES

- Grading Permits shall be obtained prior to installation of sediment control.
- All Sediment Control Measures will be installed and stabilized according to this plan prior to any other grading, clearing or disturbance of existing surface of site.
- Notify the Bureau of Inspections and Permits at least 24 hours before starting any work.
- All Sediment Control Practices to conform to the Standards and Specs. for Soil Erosion and Sediment Control in Developing Areas, and shall be adjusted to meet actual field conditions.
- All structural Sediment Control Measures are to remain in place until permission for their removal has been obtained from the Bureau of Inspections and Permits.
- On Site Inspection and maintenance of all sediment control measures including clean-out of Sediment Traps and Dikes, and proper establishment of all planted vegetative measures will be the responsibility of the developer or his representative on the site on a continuing day to day basis.
- If will be the developer's responsibility to provide additional Sediment & Erosion Control Devices to protect stabilized areas during construction.
- The contractor shall keep all public roads free of sediment deposits left from traffic leaving construction site.
- Approval of this plan is conditional upon the approval of Sediment Control Plan for the off-site waste or borrow area prior to the import of any borrow or export of waste to or from this site.
- See Pages 51.01 - 51.08 of the Maryland State & Specs. for Soil Erosion and Sediment Control for Permanent Seeding and Pages 50.01 - 50.05 for Temporary Seeding.
- As per C.O.M.A.R. 08.05.01.06 -- "Following initial soil disturbance or redistribution, permanent or temporary stabilization shall be completed within: (a) seven calendar days as to the surface of all perimeter controls, dikes, swales, ditches, perimeter slopes, and all slopes greater than 3 horizontal to one vertical (3:1) and (b) fourteen days as to all other disturbed or graded areas on the project site."
- All Pipes to be blocked at the end of each day (See detail below).
- The total amount of Straw Bale Dikes/Silt Fence shown = 0 L.F.
- SITE ANALYSIS:**
 - A Total Area: 11723 Acres
 - B Area to be Reroofed: 1190 Acres
 - C Area to be Paved: 0263 Acres
 - D Area to be Seeded: 4673 Acres
 - E Area Undisturbed: 5527 Acres

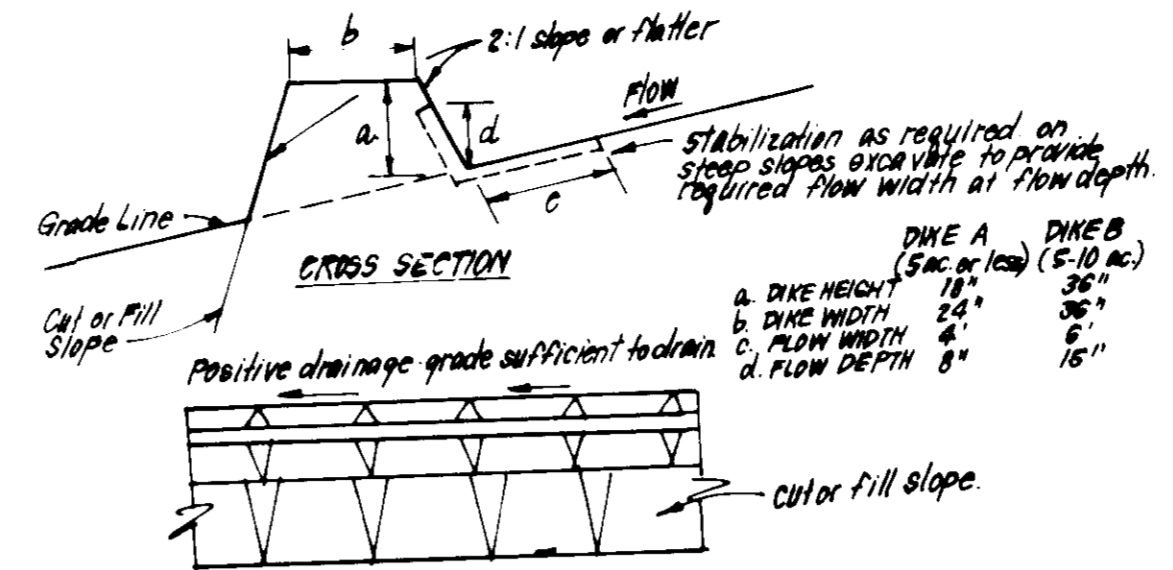

- CONSTRUCTION SPECIFICATIONS:**
- All dikes shall be compacted by earth moving equipment.
 - All dikes shall have positive drainage to an outlet.
 - Top width may be wider and dike slopes may be flatter if desired to facilitate crossing by construction traffic.
 - Field location should be adjusted as needed to utilize a stabilized safe outlet.
 - Earth dikes shall have an outlet that functions with a min. of erosion runoff.
 - Earth dikes shall have a sediment trapping device such as a sediment trap or sediment silt basin where either the dike or the drainage area above the dike are not adequately stabilized.
 - Stabilization shall be: (A) in accordance with the State & Specs. for Seed and Straw Mulch if not in seeding season (B) flow channel as per Std Detail ED-1, pg. 10.03 of the State & Specs.

- CONSTRUCTION SEQUENCE:**
- Obtain Grading Permit.
 - Sediment Basin is to be Functioning before grading is to be started.
 - Install Sediment & Erosion Control Measures.
 - Clear and Rough Grade Site.
 - Construct Buildings, sidewalks, curb & gutter and sidewalks.
 - Upon approval of Sediment & Erosion Control Inspector, remove Sediment & Erosion Control measures and stabilize area.

NOTE:
Ex. Sediment Basin is to be in place and functioning before grading is to be started. See F-85-12 for Sediment Basin detail and additional Sediment & Erosion Control.

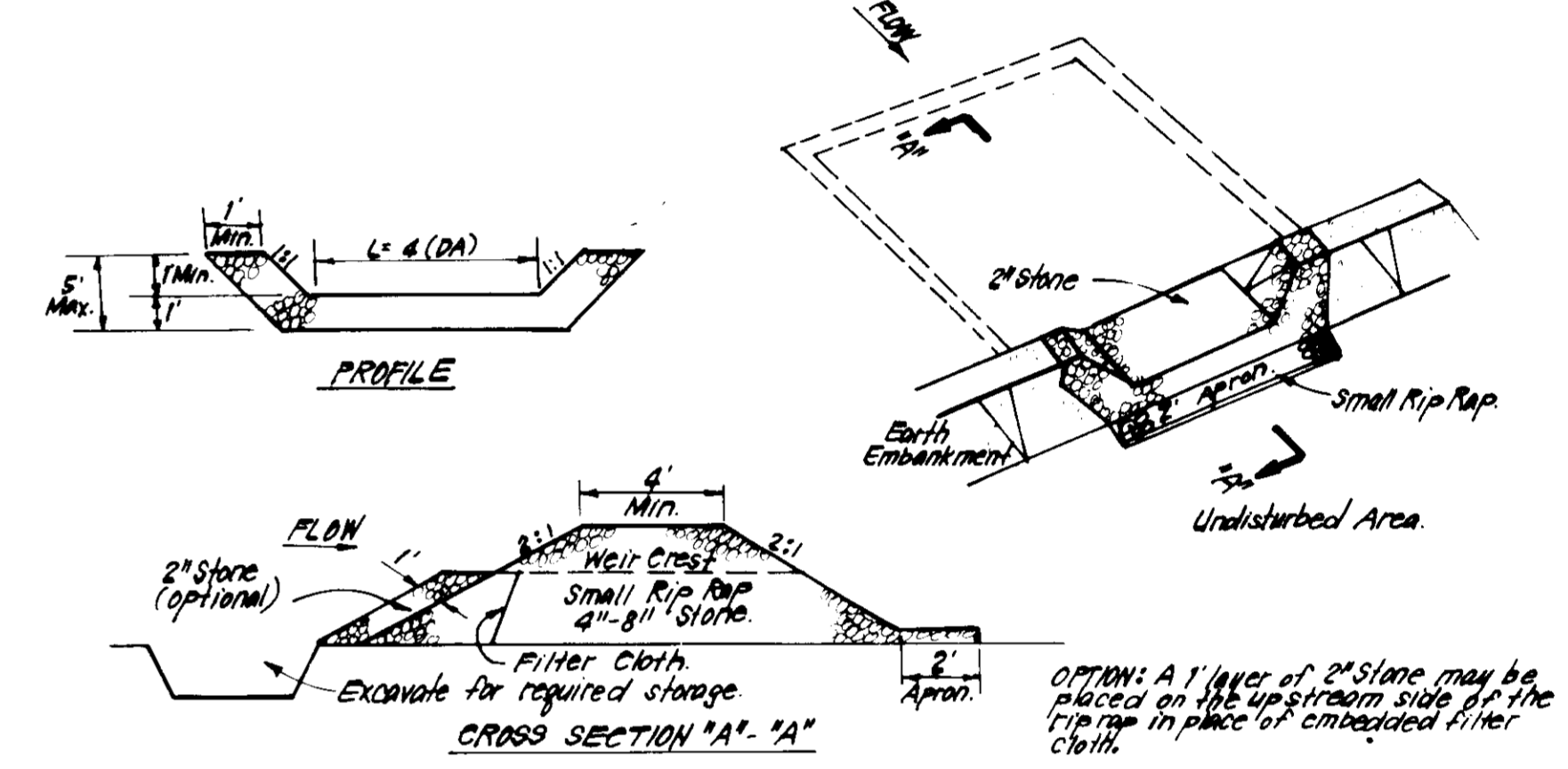

- CONSTRUCTION SPECIFICATIONS:**
- Area under embankment shall be cleared, grubbed and stripped of any vegetation and root mat. The top area shall be cleared.
 - The fill material for the embankment shall be free of roots and other woody vegetation as well as oversized stones, rocks, organic material or other objectionable material. The embankment shall be compacted by traversing with equipment while it is being constructed.
 - All cut and fill slopes shall be 2:1 or flatter.
 - The stone used in the outlet shall be small rip rap 4" - 8" along with 1" thickness of 2" aggregate placed on the up-grade side on the small rip rap or embedded filter cloth in the rip rap.
 - Sediment shall be removed and trap restored to its original dimensions when the sediment has accumulated to 1/2 the design depth of the trap.
 - The structure shall be inspected after each rain and repairs made as needed.
 - Construction operations shall be carried out in such a manner that erosion and water pollution is minimized.
 - The structure shall be removed and the area stabilized when the drainage area has been properly stabilized.

STONE OUTLET SEDIMENT TRAP (S.O.ST.) ST.V.
NO SCALE

SOST TRAP #1
DA = 0.65 Acres
Storage Required = 0.65 (1800) = 1170 c.f.
Storage Provided = 1170 of
Depth = 3ft
Top Stone Crest = 344.0
Bottom Elevation = 340.0
Cleanout Elevation = 341.5
Bottom Dimensions = 7x24'

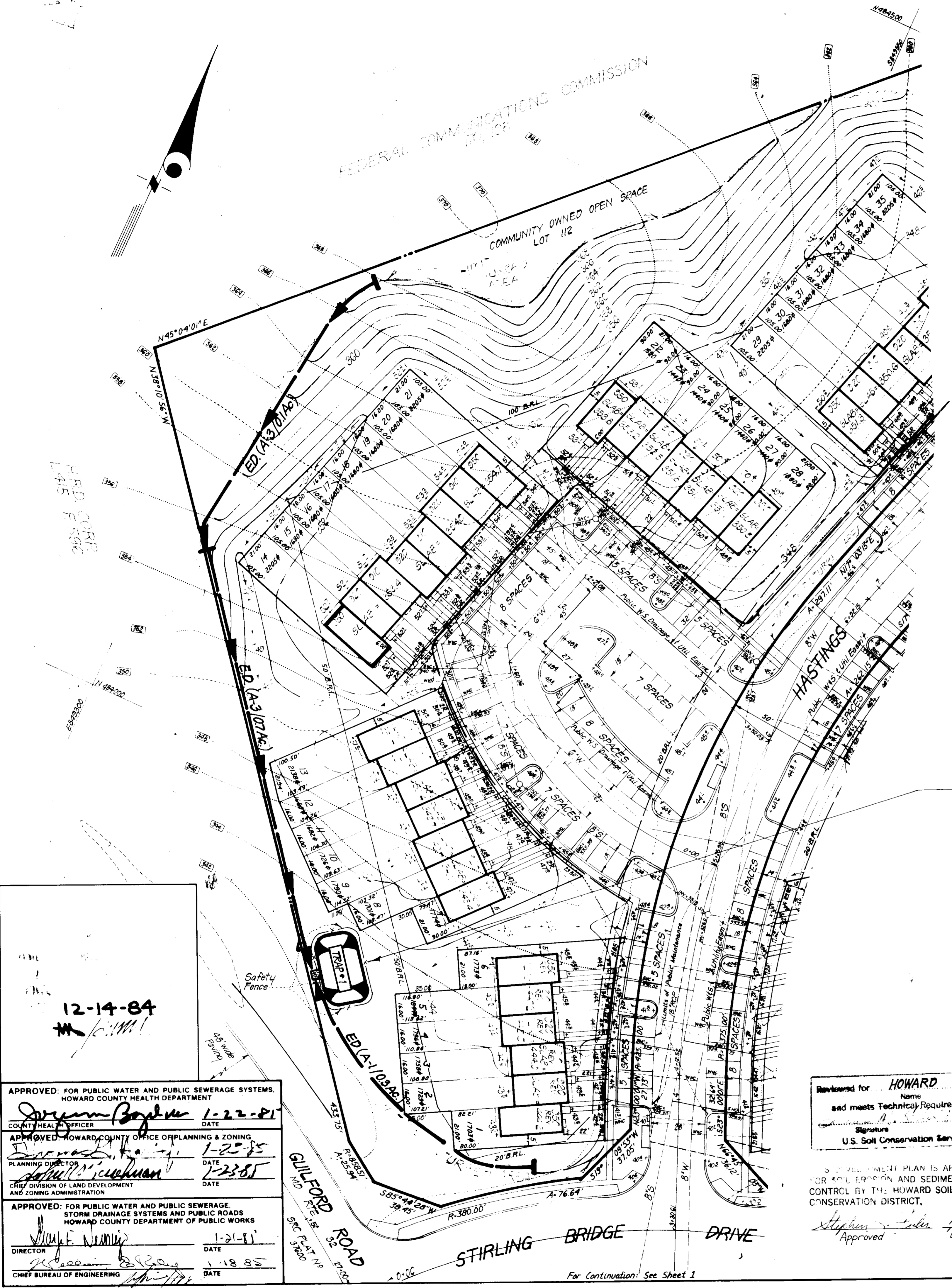

12-14-84
#10111

APPROVED: FOR PUBLIC WATER AND PUBLIC SEWERAGE SYSTEMS, HOWARD COUNTY HEALTH DEPARTMENT
 COUNTY HEALTH OFFICER: *J. J. ...* DATE: 1-22-85

APPROVED: HOWARD COUNTY OFFICE OF PLANNING & ZONING
 PLANNING DIRECTOR: *...* DATE: 1-23-85

APPROVED: FOR PUBLIC WATER AND PUBLIC SEWERAGE, STORM DRAINAGE SYSTEMS AND PUBLIC ROADS, HOWARD COUNTY DEPARTMENT OF PUBLIC WORKS
 DIRECTOR: *...* DATE: 1-21-85

CHIEF BUREAU OF ENGINEERING: *...* DATE: 1-18-85

Reviewed for: **HOWARD S.C.D.**
 Name: *Howard S.C.D.*
 and meets Technical Requirements
 Signature: *...* Date: *...*
 U.S. Soil Conservation Service

DEVELOPER'S/BUILDER'S CERTIFICATE
 "I/We certify that all development and construction will be done according to this plan of development and plan for erosion and sediment control and that all responsible personnel involved in the construction project will have a Certificate of Attendance at a Dept. of Natural Resources Approved Training Program for the Control of Sediment and Erosion before beginning the project. I also authorize periodic on-site inspection by the Howard Soil Conservation District or their authorized agents, as are deemed necessary."
 Signature of Developer/Builder: *Thomas Laurence* Date: 11-19-84
 Signature: *Stephen ...* Date: 1/19/85

ENGINEER'S CERTIFICATE
 I hereby certify that this plan for Erosion and Sediment Control represents a practical and workable plan based on my personal knowledge of the site conditions and that it was prepared in accordance with the requirements of the Howard Soil Conservation District.
 Signature: *G. Nelson Clark* Date: 11-17-84

		CLARK · FINEFROCK & SACKETT ENGINEERS · PLANNERS · SURVEYORS 11315 LOCKWOOD DRIVE · SILVER SPRING, MARYLAND 20904 · (301) 593-3400	
		DESIGNED AND EROSION CONTROL PLAN LOTS 1 THRU 107 GLENSHIRE TOWNE PARCEL "A" SECT. 1 6TH ELECTION DISTRICT HOWARD COUNTY, MARYLAND	SCALE: As Shown DRAWING: 3 of 5 CHECKED: BAF JOB NO.: 81-060 J.P.A. FILE NO.: 81-060 SE
DATE: 12-19-84	FOR: PULTE HOME CORP 11120 New Hampshire Ave. Silver Spring, Maryland 20904	SDP-85-93	

For Continuation: See Sheet 1

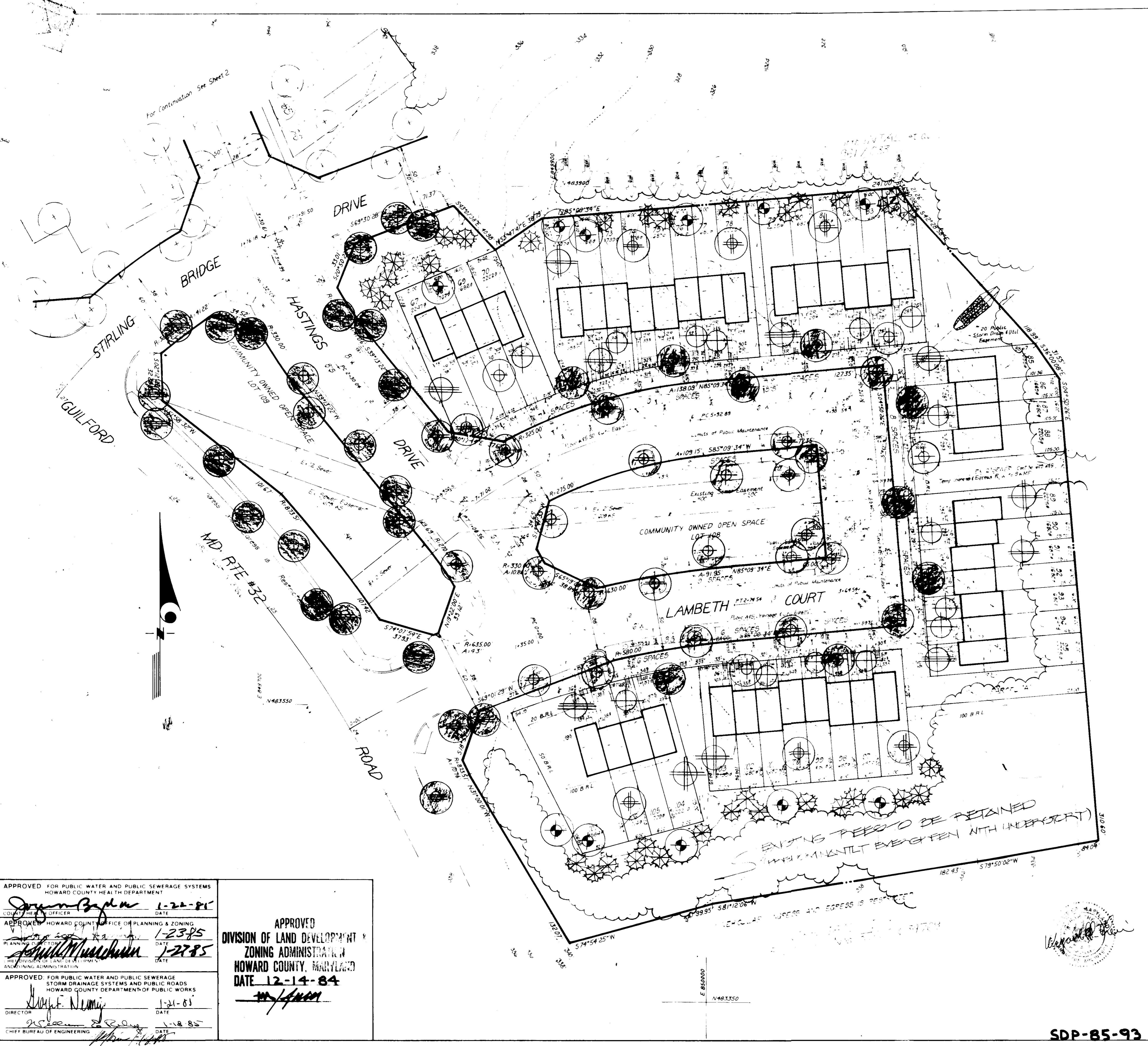

PLANT SCHEDULE

KEY	PLANT NAME	SIZE	QUANT	REMARKS
* PER COUNTY APPROVED STREET TREE SPECIFICATIONS				
⊕	ACER PLURIMUM OCT GLORY	2 1/2" CAL	41	D&D HEAVY - EAST
⊕	COCCOON GLORY MAPLE	2 1/4" HT	24	
⊕	ZELKOVA S. VILLAGE GREEN		24	
⊕	VILLAGE GREEN ZELKOVA		29	
⊕	QUEPOLD PURPA		7	↓
⊕	NORTHERN RED OAK			
⊕	QUEPOLD ZALUSTIUS			
⊕	PIN OAK			
⊕	ACER PLURIMUM OCT GLORY	2 1/2" CAL	5	D&D HEAVY - EAST
⊕	COCCOON GLORY MAPLE	2 1/4" HT	7	
⊕	ZELKOVA S. VILLAGE GREEN		7	
⊕	VILLAGE GREEN ZELKOVA		5	
⊕	QUEPOLD PURPA		15	
⊕	NORTHERN RED OAK		16	
⊕	QUEPOLD ZALUSTIUS			
⊕	PIN OAK			
⊕	FRAXINUS P. LONGEOLATA			
⊕	MORCHILLIS GREEN OAK			
⊕	PLATANUS AERIFOLIA		21	↓
⊕	LONDON PLANE TREE			
⊕	PLUNUS SERA. 'SWEETEN'	2 1/2" CAL	15	
⊕	SWEETEN CHESTNUT	2 1/4" HT	9	
⊕	PLUNUS C. THUNDERBOLT		22	
⊕	PURPLE LEAF FL. PLUM		10	
⊕	AMELANCHIER CANADENSIS		7	↓
⊕	SERVICE BERRY			
⊕	CORNUS FLORIDA			
⊕	FLOWERING DOGWOOD			
⊕	MALUS SNOWDRIFT			
⊕	SNOWDRIFT CRABAPPLE			
⊕	TRINUS STROBUS	8" HT	75	D&D - EAST
⊕	EASTERN WHITE PINE			

NOTES:
 * THIS PLAN SUPERCEDES PREVIOUSLY APPROVED ROAD CONSTRUCTION PLANS #81-000D, DATED 9-7-84, FOR STREET TREE PLANTING ONLY.
 * CONTRACTOR SHALL VERIFY LOCATION OF ALL UNDERGROUND UTILITIES PRIOR TO BEGINNING.
 * ALL PLANTING SHALL BE DONE IN ACCORDANCE WITH ATTACHED SPECIFICATIONS.

DATE: 12-30-84
 PREPARED BY: PERIOD SO PER COUNTY COMMENTS

CLARK • FINEBROCK & SACKETT
 ENGINEERS • PLANNERS • SURVEYORS
 11315 LOCKWOOD DRIVE • SILVER SPRING, MARYLAND 20904 (301) 583-3400

DESIGNED: JBC	LANDSCAPE PLANTING PLAN LOT 100 THRU 107 Sect. 1 GLENCHOVE TOWNE (PARCEL A) 6TH ELECTION DISTRICT HOWARD COUNTY, MARYLAND FOR 8 PULTE HOME CORP. 11600 NEW HAMPDEN DRIVE SILVER SPRING, MD 20904	SCALE: 1" = 20'
DRAWN: JBC		DRAWING NO: 4055
CHECKED: NLT		JOB NO: 21-010
DATE: 11-84		FILE NO: 2-200

APPROVED FOR PUBLIC WATER AND PUBLIC SEWERAGE SYSTEMS
 HOWARD COUNTY HEALTH DEPARTMENT
 DATE: 1-22-85

APPROVED HOWARD COUNTY OFFICE OF PLANNING & ZONING
 DATE: 1-23-85

APPROVED FOR PUBLIC WATER AND PUBLIC SEWERAGE
 STORM DRAINAGE SYSTEMS AND PUBLIC ROADS
 HOWARD COUNTY DEPARTMENT OF PUBLIC WORKS
 DATE: 1-21-85

APPROVED
 DIVISION OF LAND DEVELOPMENT & ZONING ADMINISTRATION
 HOWARD COUNTY, MARYLAND
 DATE: 12-14-84

SDP-85-93

APPROVED
 DIVISION OF LAND DEVELOPMENT &
 ZONING ADMINISTRATION
 HOWARD COUNTY, MARYLAND
 DATE 12-14-84
[Signature]

APPROVED FOR PUBLIC WATER AND PUBLIC SEWERAGE SYSTEMS
 HOWARD COUNTY HEALTH DEPARTMENT
[Signature] 1-22-85
 COUNTY HEALTH OFFICER DATE
 APPROVED HOWARD COUNTY OFFICE OF PLANNING & ZONING
[Signature] 1-23-85
 PLANNING OFFICER DATE
 APPROVED FOR PUBLIC WATER AND PUBLIC SEWERAGE
 STORM DRAINAGE SYSTEMS AND PUBLIC ROADS
 HOWARD COUNTY DEPARTMENT OF PUBLIC WORKS
[Signature] 1-21-85
 DIRECTOR DATE
 CHIEF BUREAU OF ENGINEERING
[Signature] 1-18-85
 DATE

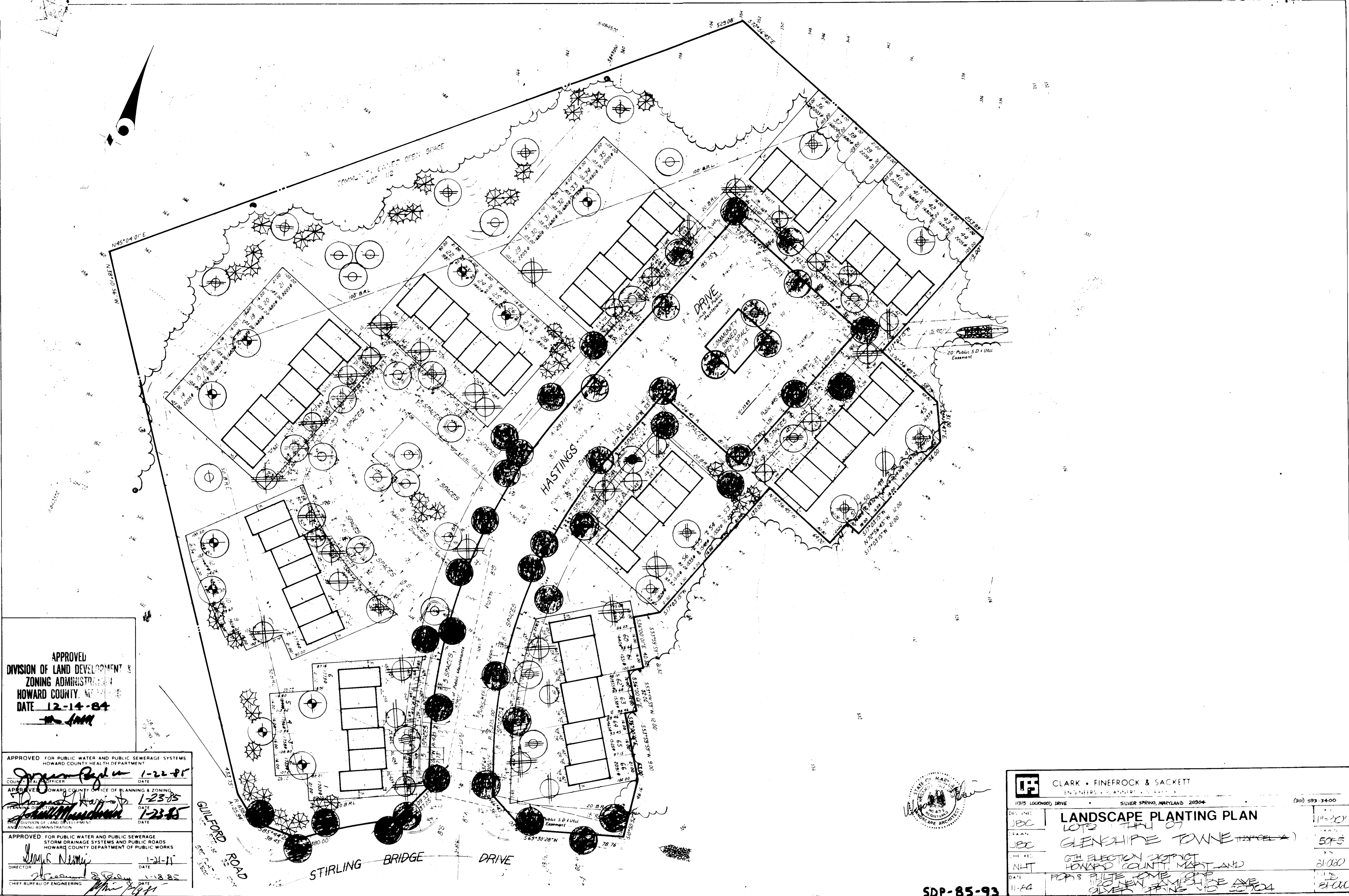

CLARK • FINEROCK & SACKETT ENGINEERS • PLANNERS • ARCHITECTS 11315 LOCKWOOD DRIVE SILVER SPRING, MARYLAND 20904 (301) 593-3400		
DATE: JBC DRAWN: JBC CHECKED: NHT DATE: 11-84	LANDSCAPE PLANTING PLAN LOTS 1 THRU 07 GLENSHIRE TOWNE (PARTIAL) 6TH ELECTION DISTRICT HOWARD COUNTY, MARYLAND POP'S PLATE HOME SHOP 1120 NEW GLENVIEW AVE SILVER SPRING MD 20904	11-2001 50' x 5' 81,000 81,000

SDP-85-93