

GENERAL NOTES

- Grading Permits shall be obtained prior to installation of Sediment Control & Grading
- All Sediment and Erosion Control Measures will be installed and stabilized according to this plan prior to any other grading, clearing or disturbance of the existing surface of the site. See note #6 for stabilization except that the seed mixture will be annual ryegrass applied at a rate of 1.4 lbs/1000 sf
- Notify the Bureau of Inspections and Permits at least 24 hours before starting any work
- All Sediment Control Practices to conform to the "Standards and Specifications for Soil Erosion and Sediment Control in Developing Areas" and shall be adjusted to meet actual field conditions
- Stabilization of Disturbed ground to be done as soon after construction as possible
- All disturbed areas to be stabilized in accordance with the following Specifications:
 - A Seed - certified 85% germination applied at the rate of 3 lbs/1000 sf Mixture - 40% Kentucky Blue, 20% chewing Fescue, 20% Kentucky 31 and 20% annual ryegrass
 - B Fertilizer - 10-10-10 applied at a rate of 23 lbs/1000 sf Ground Agricultural Lime or Dolomitic Lime applied at a rate of 30 lbs/1000 sf
 - C Mulch - Weed free grain straw applied at a rate of 70-90 lbs/1000 sf Mulch shall be secured to the ground by any approved method i.e.; asphalt tacks, chemical binder etc
 - D All Sod used shall be Maryland State Certified
- All Structural Sediment Control Measures are to remain in place until permission for their removal has been obtained from the Bureau of Inspections and Permits
- On Site Inspection and Maintenance of all Sediment Control Measures including clean out of Sediment Traps and Dikes, and proper establishment of all planned vegetative measures will be the responsibility of the developer or his representative on the site, on a continuing day to day basis
- It will be the developer's responsibility to provide additional Sediment & Erosion Control Devices to protect stabilized areas during construction
- The Contractor shall keep all public roads free of sediment deposits left from traffic leaving construction site
- Approval of this plan is conditional upon the approval of Sediment Control Plan for the off-site waste or borrow area prior to the import of any borrow or export of waste to or from this site
- All pipes to be blocked at the end of each day. See detail this sheet NA
- Total Amount of Straw Bales or Silt Fence shown: 365 LF
- SITE ANALYSIS:
 - A Total Area: 0.961 Acres
 - B Area to be Roofed: 0.166 Acres
 - C Area to be Paved: 0.120 Acres
 - D Area to be Seeded: 0.525 Acres
 - E Area Undisturbed: 0.150 Acres
- CONSTRUCTION SEQUENCE:
 - A Install Sediment & Erosion Control Devices and Stabilize Diversion Dike
 - B Excavate for Foundations and Rough Grade
 - C Construct Structures, Driveways and Sidewalks
 - D Final Grade and Stabilize in accordance with note #6
- If houses are to be constructed on an "As-Sold" basis at random, Single Lot Sediment Control, as shown on this sheet, shall be implemented

4 bales shall be tied with non-weathering materials, i.e. wire, nylon

Two rebar or wooden stakes driven through each hole 1/2" - 2" into ground. Rebars to be spaced 5'-5.7' with top of bales

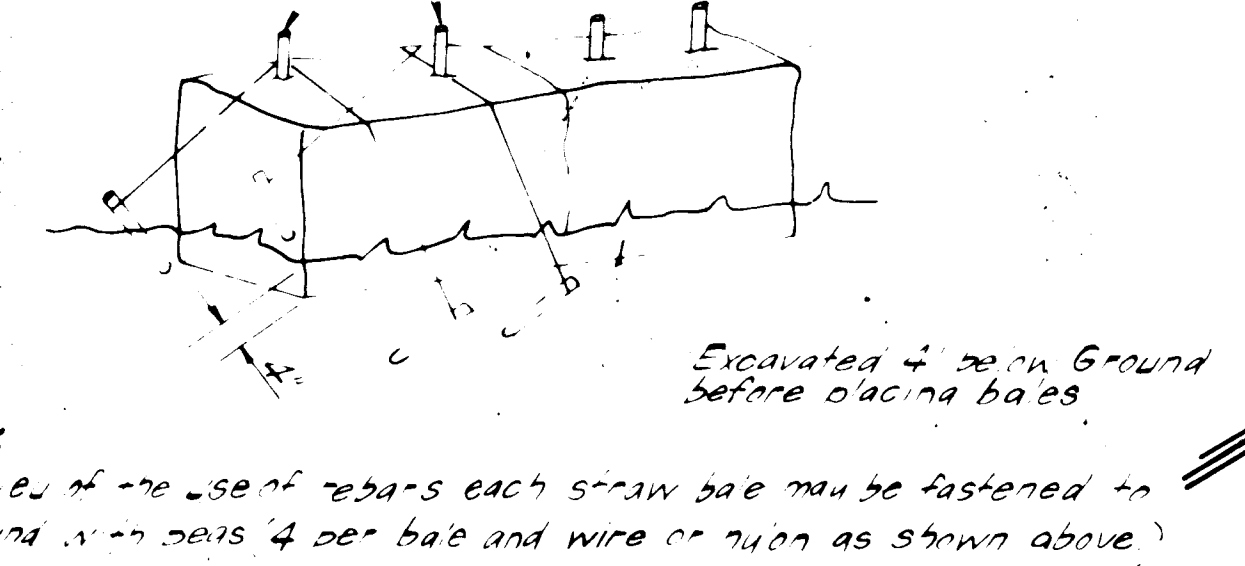

STRAW BALE DIKE DETAIL (S.B.D.)
NO SCALE

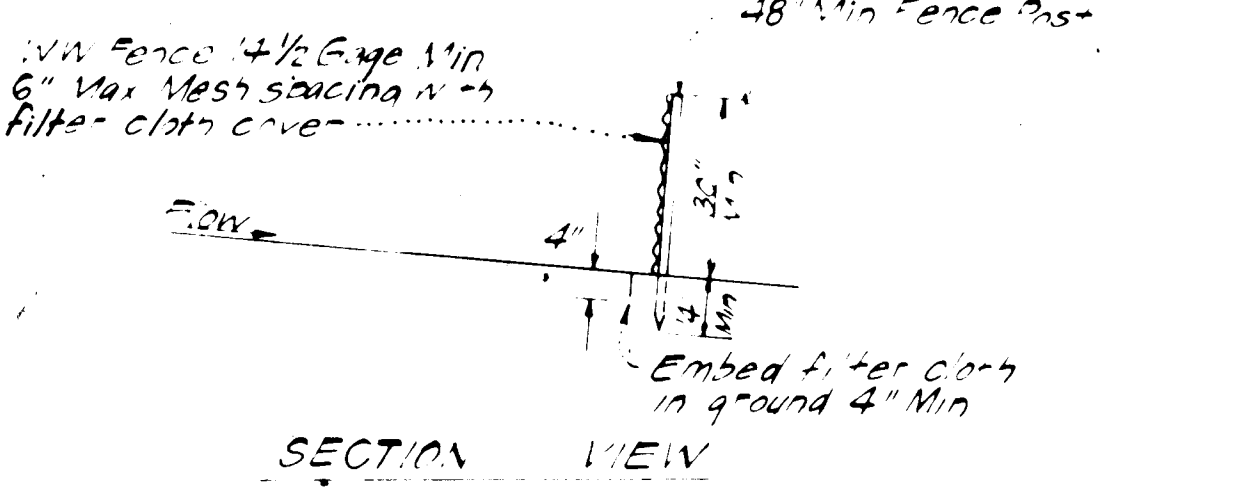
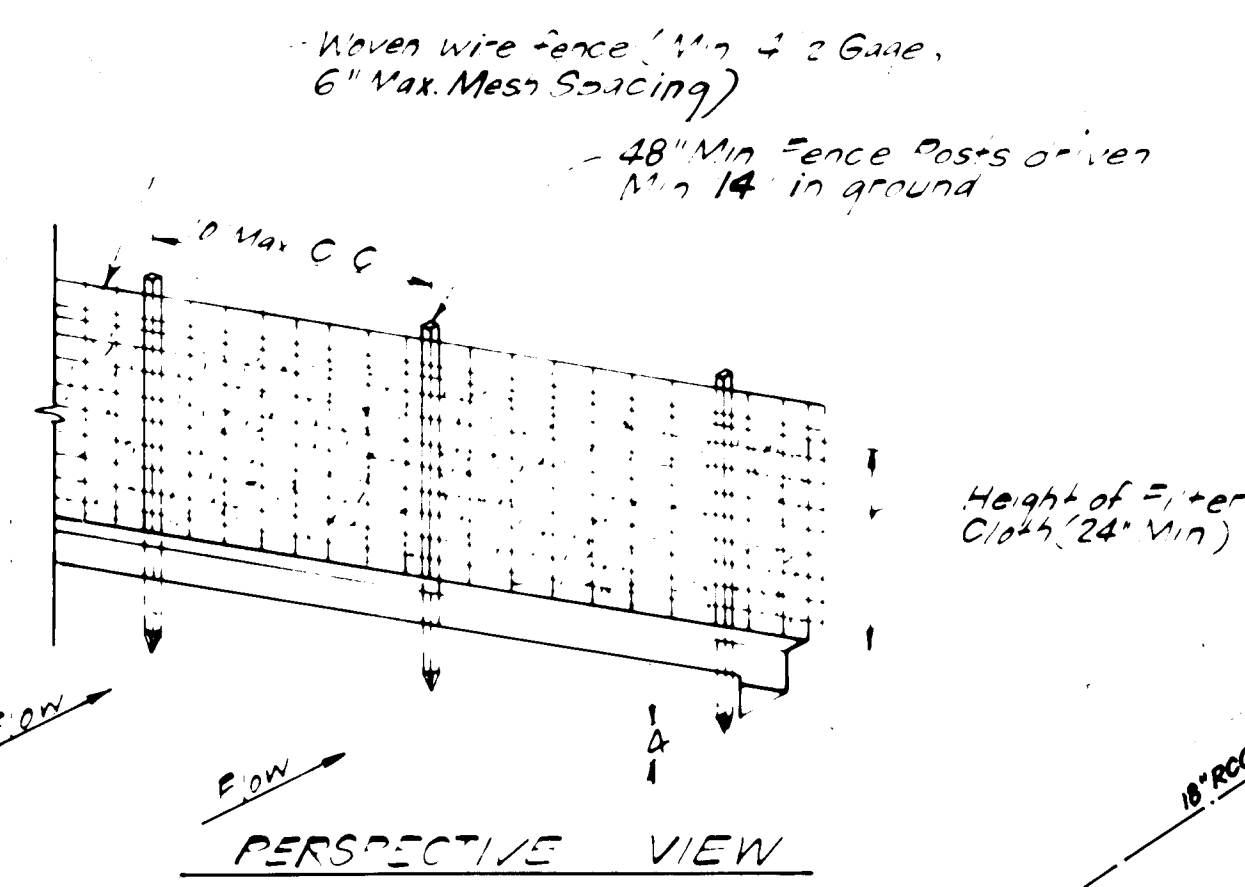

CONSTRUCTION NOTES:

- Woven wire fence to be fastened to fence posts with wire ties spaced every 24\"/>
- Filter cloth to be fastened securely with woven wire fence with wire ties spaced every 24\"/>

NOTES: Steel either 1/2\"/>

FENCE: Woven wire, 4 1/2 Ga, Max 6\"/>

FILTER CLOTH: Filter X, Mirafi 100X, Laurel Erosion Control Cloth, Bidim, Polyfilter X or equal

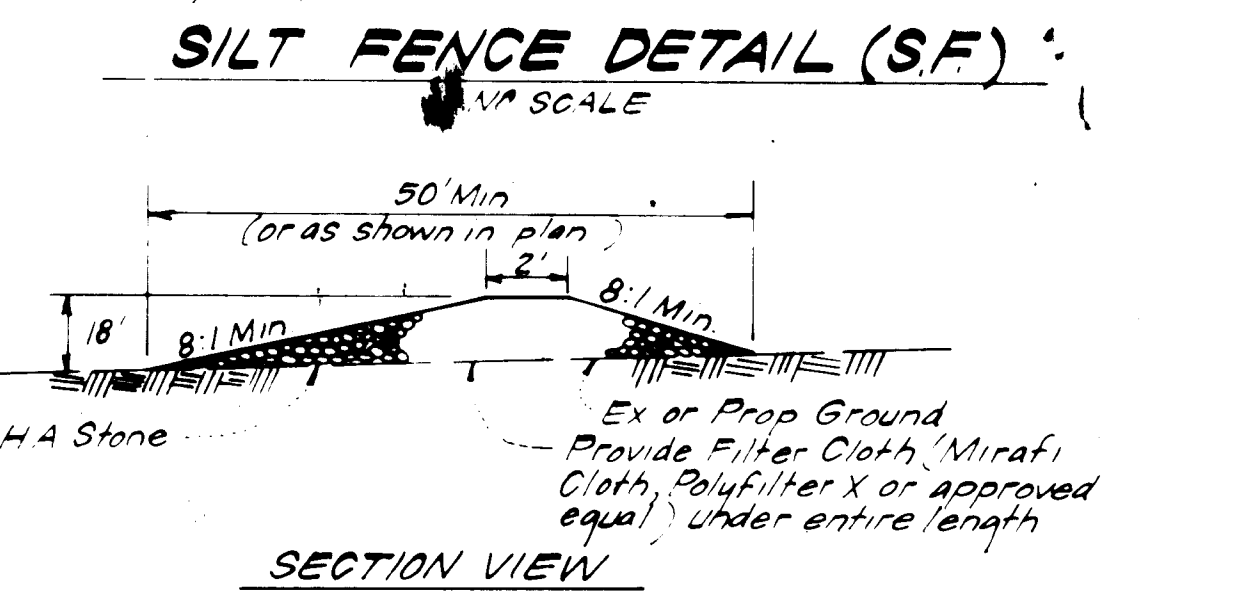

SILT FENCE DETAIL (S.F.)
NO SCALE

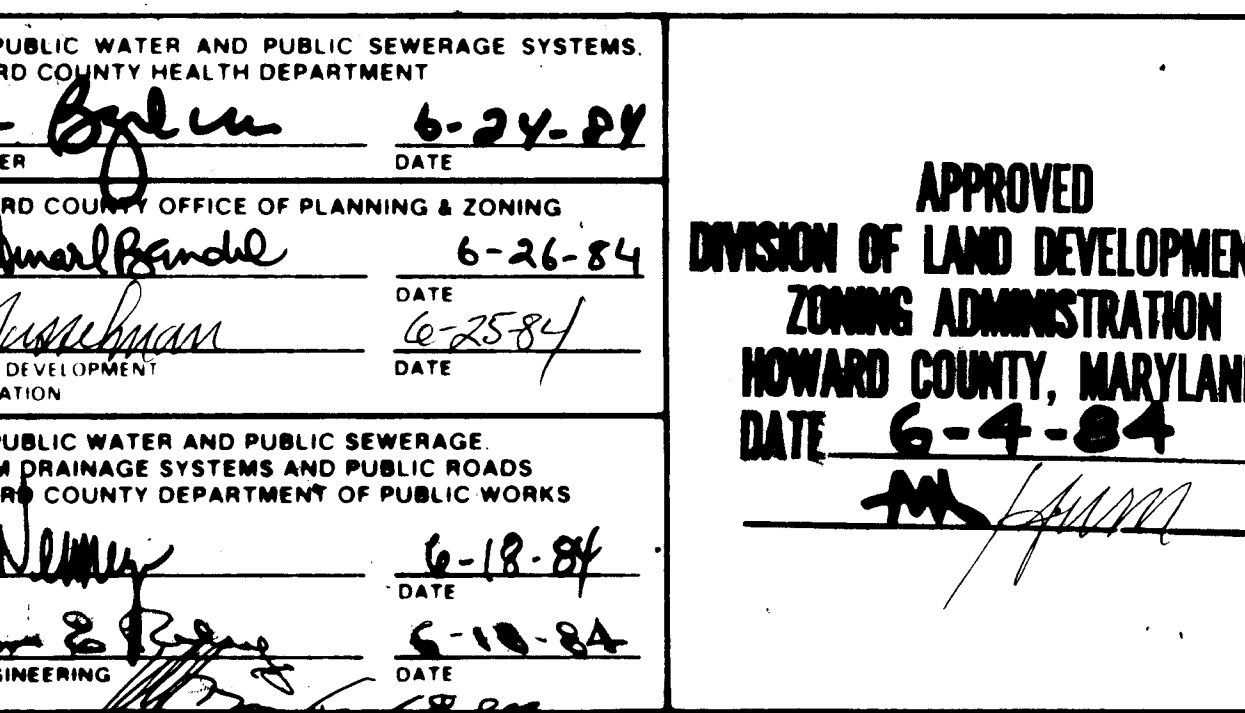

STONE CONSTRUCTION ENTRANCE (S.C.E.)
NO SCALE



NOTES:

- The land contained in this plan is zoned New Town (B.F.M.D.)
- The lots shown on this plan are covered by Final Development Plan Phase 178; A, III, Part II.
- All coordinates shown herein are based on Howard County Geodetic Control Traverse which is based upon the Maryland State Plane Coordinate System.
- The total area included in this plan is 0.961 Acres.
- All roadways are public and existing.
- Any damage to County Owned Rights-of-Way or Paving shall be corrected at the owners expense.
- Total number of lots: 4.

LEGEND:

- Contour Interval
- Existing Contour
- Proposed Contour
- Spot Elevation
- Direction of Drainage
- Walk-Out Basement
- Trees to be Retained
- Straw Bale Dike / Silt Fence
- Diversion Dike
- Stone Construction Entrance

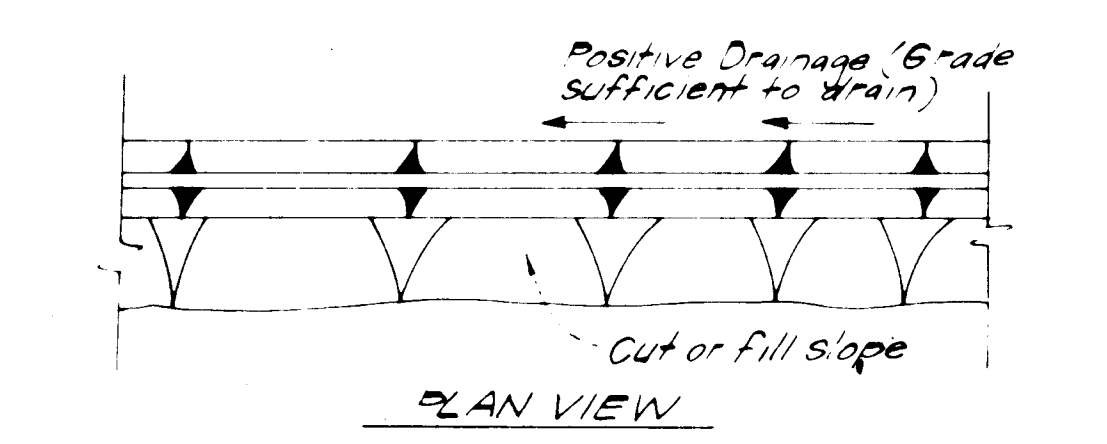
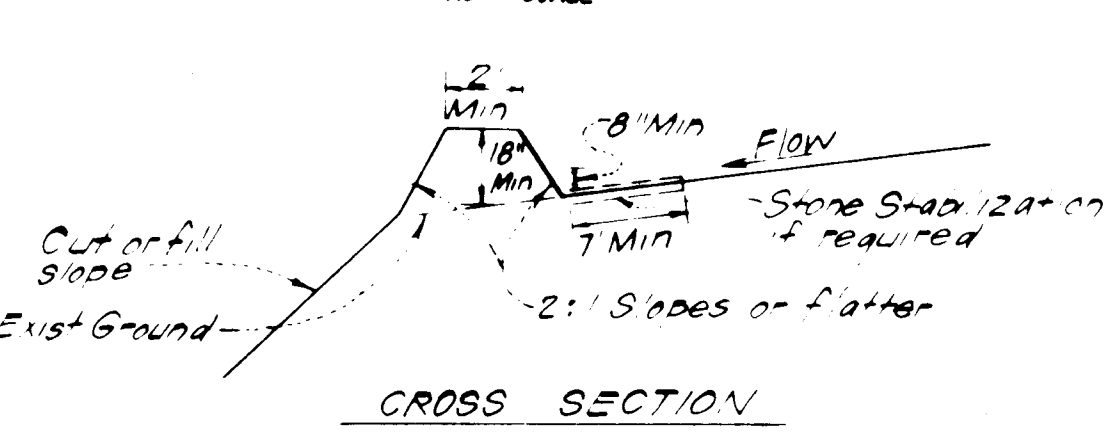
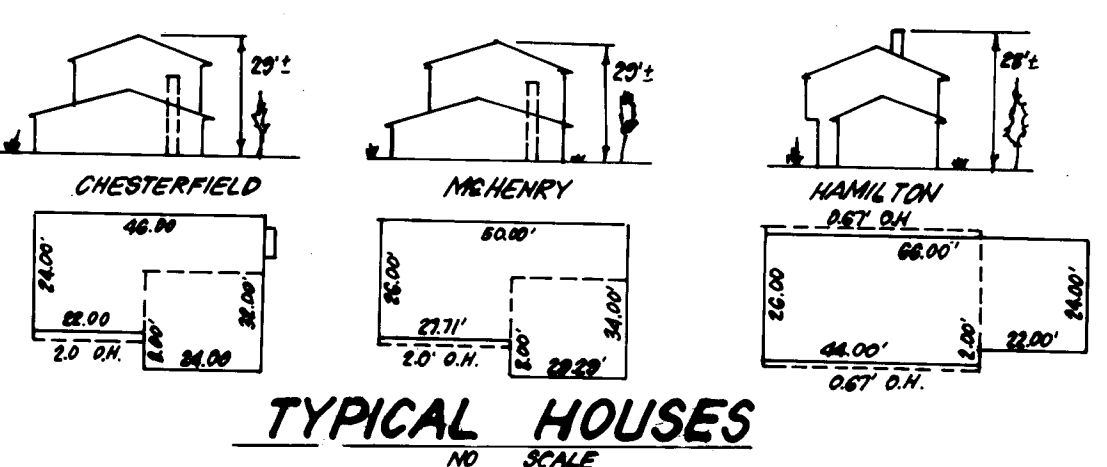

DIVERSION DIKE (D.D.)
NO SCALE

Reviewed for HOWARD COUNTY, B.C.D. Name: Stephen A. Clark, Signature: Stephen A. Clark, Date: 6-14-84, U.S. Soil Conservation Service

THIS DEVELOPMENT PLAN IS APPROVED FOR SOIL EROSION AND SEDIMENT CONTROL BY THE HOWARD SOIL CONSERVATION DISTRICT.

Signature: Stephen A. Clark, Date: 6-14-84, APPROVED

ENGINEER'S CERTIFICATE
I hereby certify that this plan for Erosion and Sediment Control represents a practical and workable plan based on my personal knowledge of the site conditions and that it was prepared in accordance with the requirements of the Howard Soil Conservation District.

Signature: G. Nelson Clark, Date: 5-1-84



Signature: G. Nelson Clark, Date: 4-25-84

DEVELOPER'S/BUILDER'S CERTIFICATE

"I/We certify that all development and construction will be done according to this plan of development and plan for erosion and sediment control and that all responsible personnel involved in the construction project will have a Certificate of Attendance at a Dept. of Natural Resources Approved Training Program for the Control of Sediment and Erosion before beginning the project. I also authorize periodic on-site inspection by the Howard Soil Conservation District or their authorized agents, as are deemed necessary."

Signature: Thomas J. Sackett, Date: 4-25-84

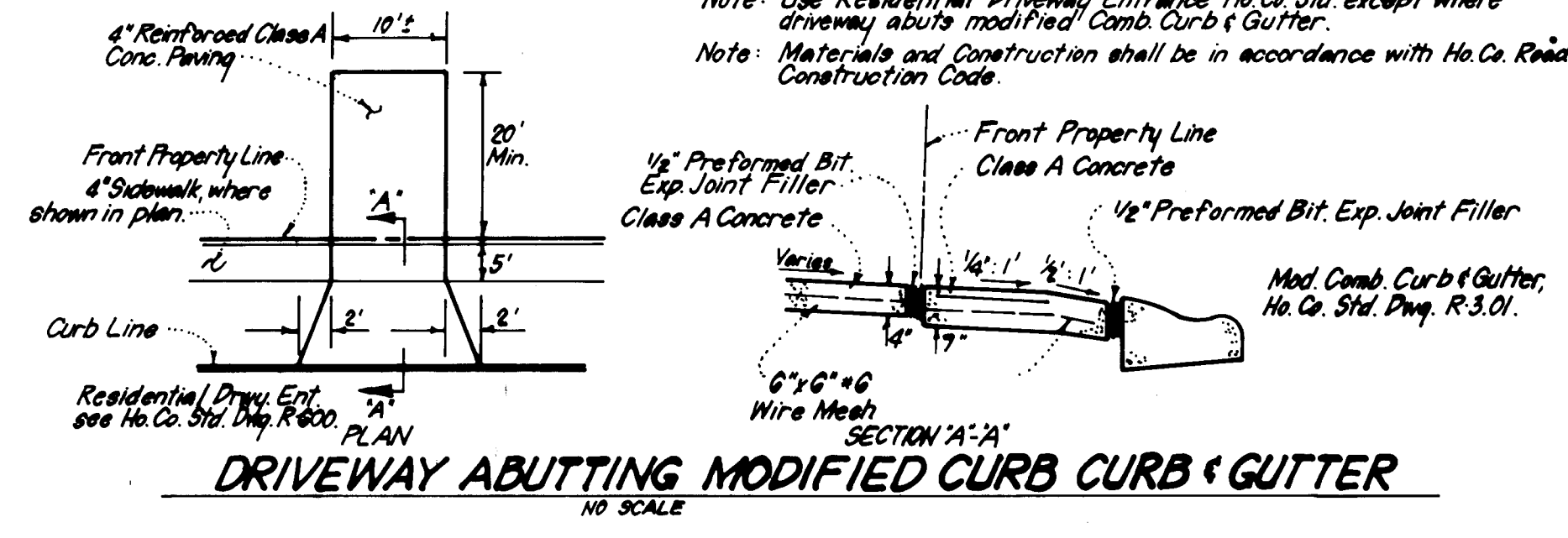

DRIVEWAY ABUTTING MODIFIED CURB CURB & GUTTER
NO SCALE

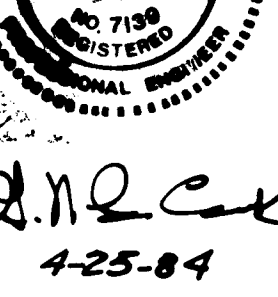

Signature: Thomas J. Sackett, Date: 4-25-84

ADDRESS CHART			
LOT NO	STREET ADDRESS		
175	7432	SANDALFOOT WAY	
176	7428	"	
177	7424	"	
178	7420	"	

SUBDIVISION NAME: COLUMBIA	V.O.K.C. 2/3	LOT / PARCEL: Lots 175-178
PLAT # or L.P.F. 5222	BLOCK # 18	ZONE R-3
TAX / ZONE MAP REF. #41	6TH	6002
WATER CODE E-16	SEWER CODE 6440000	

S.O.S.T. *			
Lot Size	1/4 Ac	1/2 Ac	1 Ac
L	2'	3'	6'
Depth	2'	3'	2'
Bot Length **	1'	26'	26'
Bot Widths **	1'	11'	26'
Bot Area	12 1/2	296 1/2	676 1/2

* See S&P ST. 3, pg 20-07 for detail not shown
** Can be adjusted in field but bottom area must be as given or greater

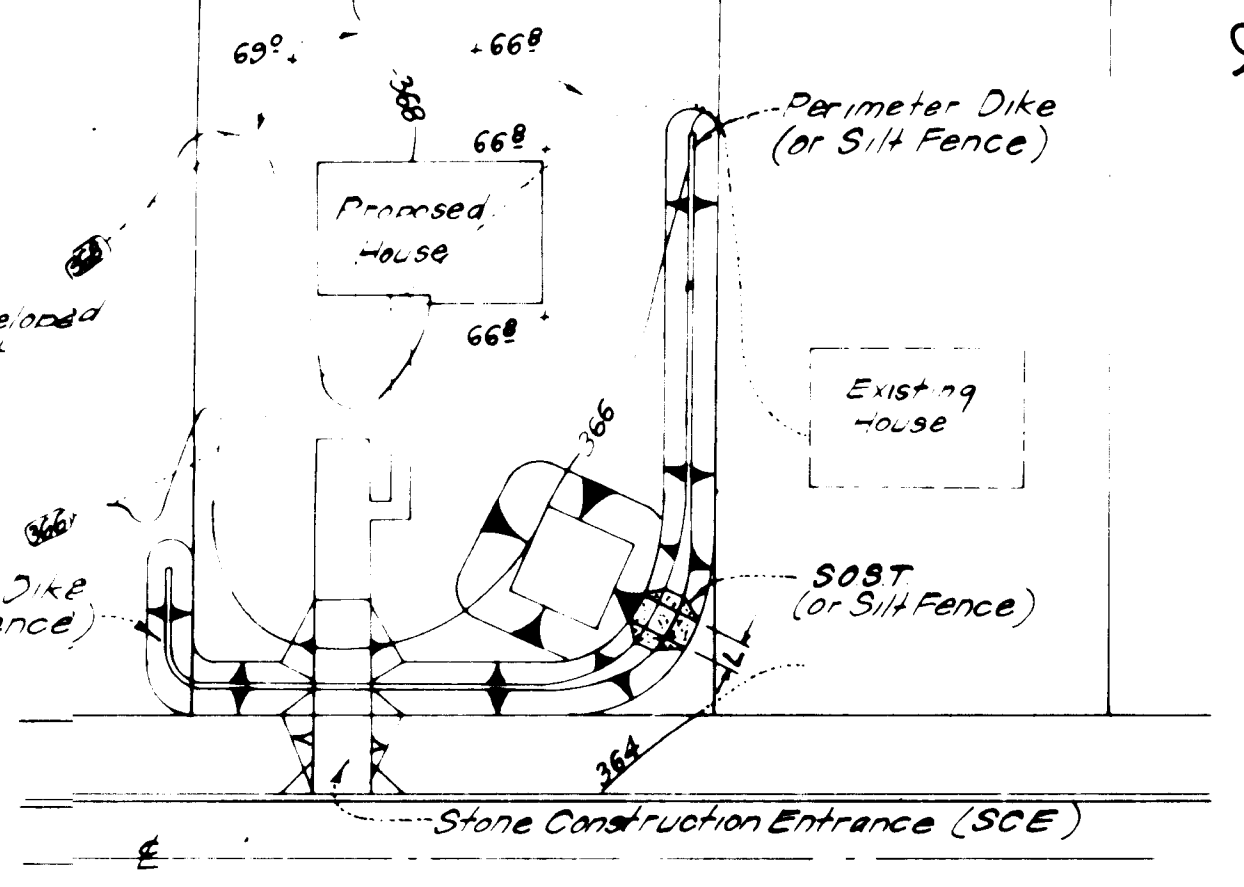

SINGLE LOT SEDIMENT CONTROL PLAN
NO SCALE

APPROVED FOR PUBLIC WATER AND PUBLIC SEWERAGE SYSTEMS, HOWARD COUNTY HEALTH DEPARTMENT
Signature: John E. Gyles, Date: 6-24-84
APPROVED HOWARD COUNTY OFFICE OF PLANNING & ZONING
Signature: Arthur Small, Date: 6-26-84
APPROVED FOR PUBLIC WATER AND PUBLIC SEWERAGE, STORM DRAINAGE SYSTEMS AND PUBLIC ROADS, HOWARD COUNTY DEPARTMENT OF PUBLIC WORKS
Signature: [Signature], Date: 6-18-84
Signature: [Signature], Date: 6-18-84

APPROVED DIVISION OF LAND DEVELOPMENT & ZONING ADMINISTRATION, HOWARD COUNTY, MARYLAND, DATE: 6-4-84

CLARK · FINEPROCK & SACKETT
ENGINEERS · PLANNERS · SURVEYORS
11315 LOCKWOOD DRIVE · SILVER SPRING, MARYLAND 20904 · (301) 583-3400
DESIGNED: J.M.E., J.L.S.
DRAWN: B.A.F.
CHECKED: J.M.E., J.L.S.
DATE: April 1984
SCALE: 1" = 30'
JOB NO.: 83-055
FILE NO.: 83-055-X
FOR: THE RYLAND GROUP (COLUMBIA DIV.)
503 One Knoll North Drive
Columbia, Maryland 21044