

- GENERAL NOTES:**
1. The Land included in this plan is zoned: R-12.
  2. The coordinates shown hereon are based on the Maryland State Grid System.
  3. Total area of lots: 2.163 Acres
  4. All roadways are public and existing.
  5. Any damage to county owned rights-of-way shall be corrected at the owners expense.
  7. Total number of lots: 4

- LEGEND:**
1. Contour Interval 2 Ft
  2. Existing Contour (dashed line)
  3. Proposed Contour (solid line)
  4. Spot Elevation (+ 80's)
  5. Direction of Drainage (arrow)
  6. Existing Trees to be Retained (circle with cross)
  - 7.

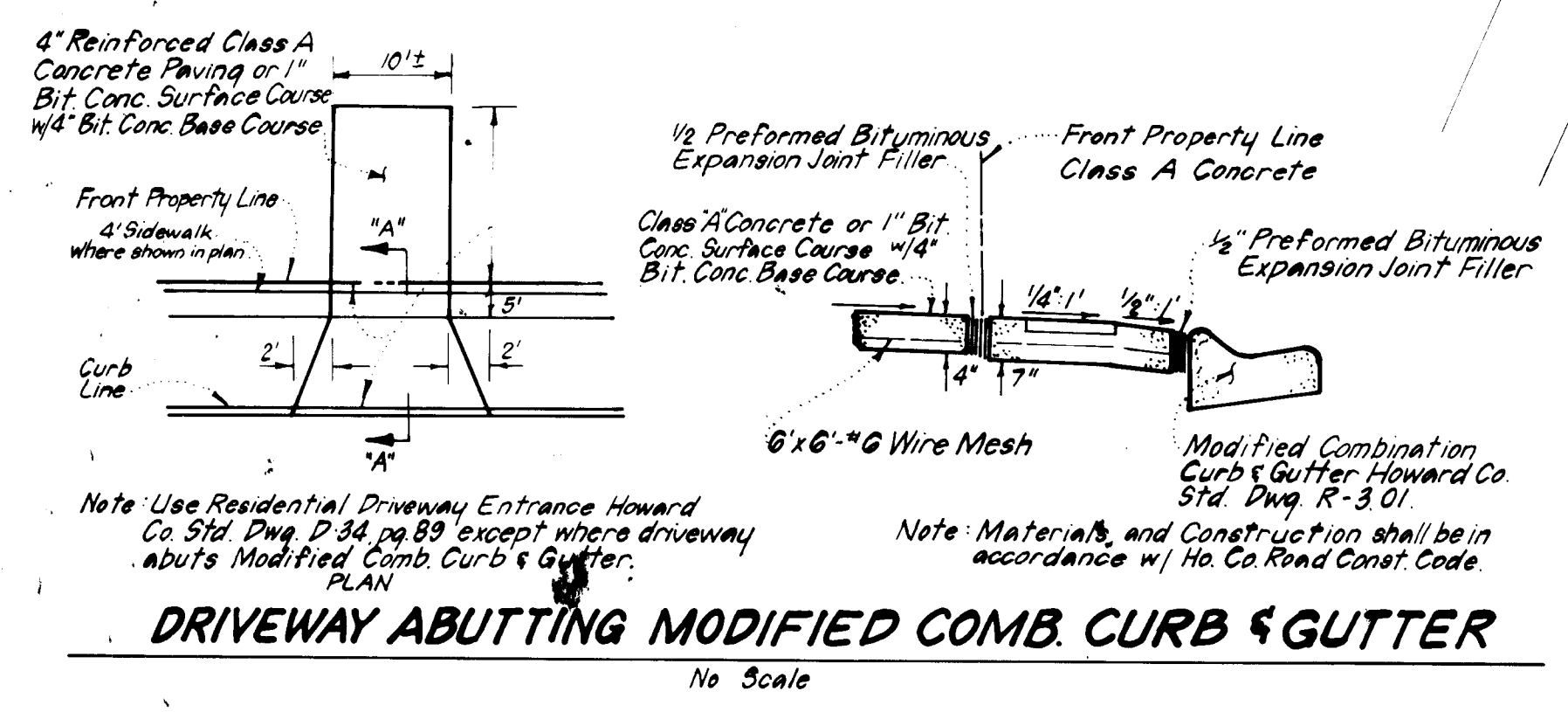
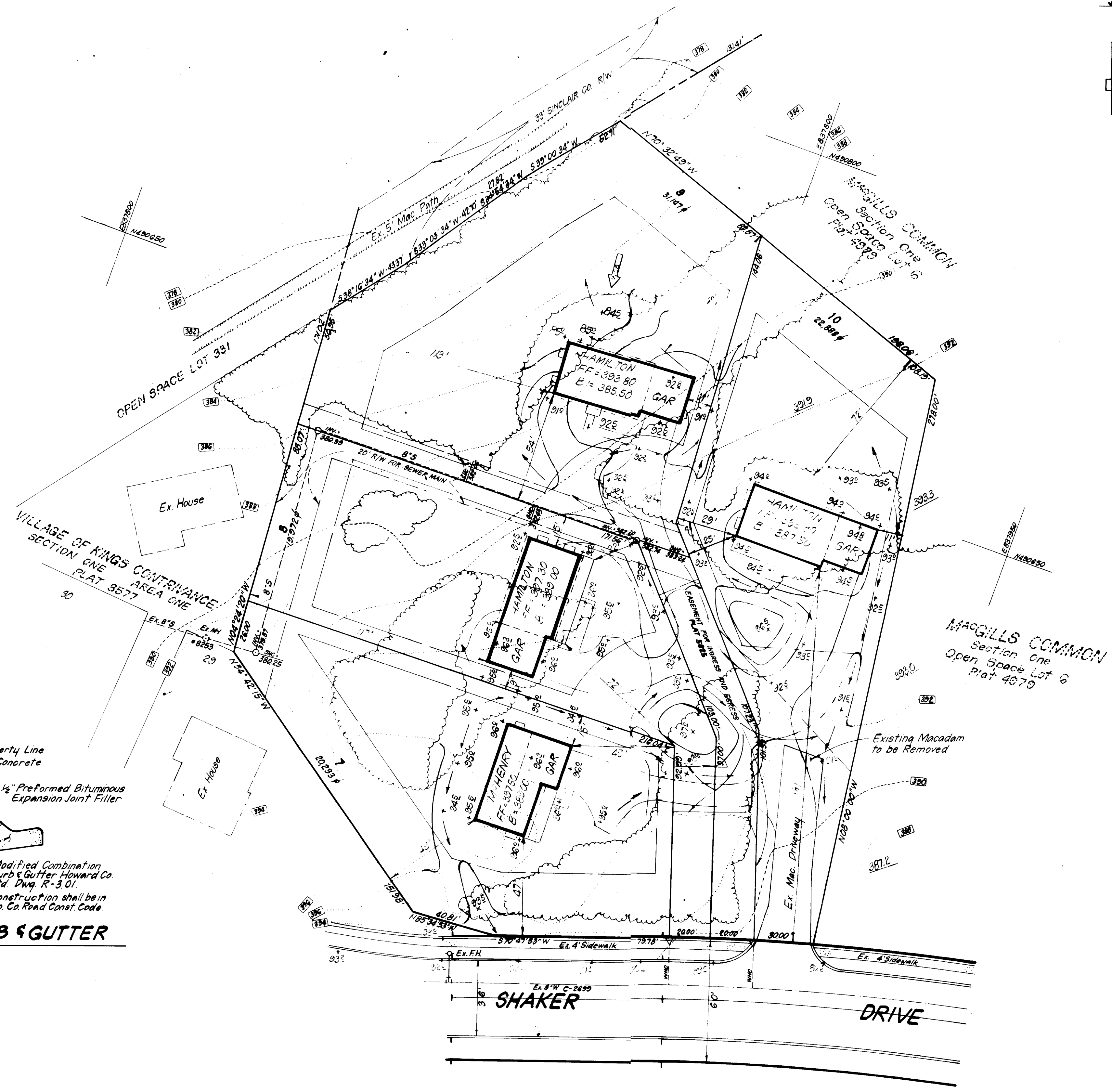

ADDRESS CHART	
LOT No.	STREET ADDRESS
7	10196 SHAKER DRIVE
8	10192 " "
9	10186 " "
10	10180 " "

SUBDIVISION NAME MACGILL'S COMMON	SECT./AREA Sect One	LOT/PARCEL LOTS 1 THRU 10
PLAT #/LIT 5825	BLK # / ZONE 1 R-12	TAX / ZONE MAP/ELECT. DIST. / CENSUS TR. TAX MAP #42 G <sup>TH</sup> 6061.02
WATER CODE E-13	SEWER CODE 5321.300	

APPROVED: FOR PUBLIC WATER AND PUBLIC SEWERAGE SYSTEMS,  
HOWARD COUNTY HEALTH DEPARTMENT

*John Green* 6-24-84  
COUNTY HEALTH OFFICER DATE

APPROVED: HOWARD COUNTY OFFICE OF PLANNING & ZONING

*Amal Powell* 6-26-84  
PLANNING DIRECTOR DATE

APPROVED: FOR PUBLIC WATER AND PUBLIC SEWERAGE,  
STORM DRAINAGE SYSTEMS AND PUBLIC ROADS  
HOWARD COUNTY DEPARTMENT OF PUBLIC WORKS

*W. F. Nalley* 6-18-84  
DIRECTOR DATE

*W. F. Nalley* 6-28-84  
CHIEF BUREAU OF ENGINEERING DATE

APPROVED  
DIVISION OF LAND DEVELOPMENT  
ZONING ADMINISTRATION  
HOWARD COUNTY, MARYLAND  
DATE 5-11-84



**CLARK · FINEFROCK & SACKETT**  
ENGINEERS · PLANNERS · SURVEYORS  
11315 LOCKWOOD DRIVE · SILVER SPRING, MARYLAND 20904 · (301) 593-3400

DESIGNED J.M.E.	<b>SITE DEVELOPMENT PLAN</b> <b>LOTS 7 THRU 10</b> <b>MACGILL'S COMMON</b> SECTION ONE 6 <sup>TH</sup> ELECTION DISTRICT HOWARD COUNTY, MARYLAND	SCALE 1" = 30'
DRAWN BAF		DRAWING 1 of 2
CHECKED J.M.E.		JOB NO. 84-016
DATE April, 1984		FILE NO. 84-016 X
FOR: THE RYLAND GROUP (COL. DIV.) One Knoll North Drive Suite 503 Columbia, Maryland 21045		

SDP-84-130

Excavate 4' deep ground before pouring concrete  
 1. Contour interval 2 Ft  
 2. Existing Contour  
 3. Proposed Contour  
 4. Spot Elevation  
 5. Direction of Drainage  
 6. Existing Trees to be Retained  
 7. Straw Bale Dike/Silt Fence  
 8. Stone Construction Entrance

**STRAW BALE DIKE DETAIL (S.B.D.)**  
 NO SCALE

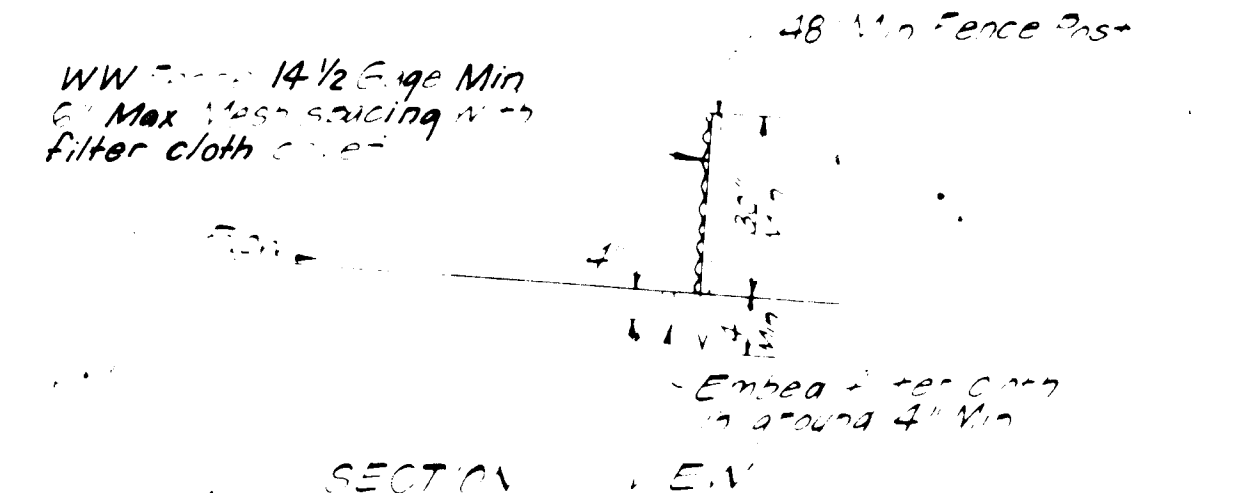
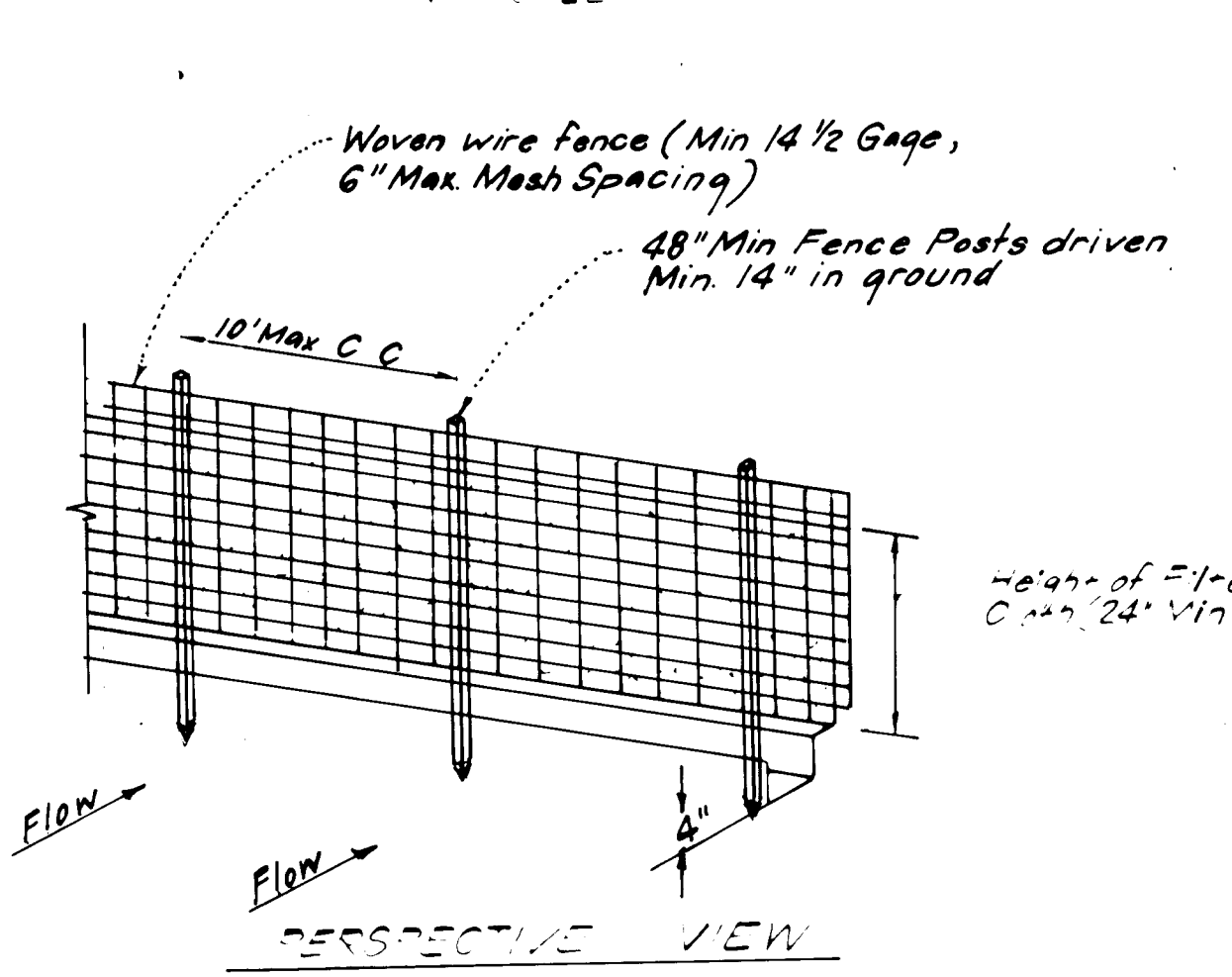

**SILT FENCE DETAIL (S.F.)**  
 NO SCALE

CONSTRUCTION NOTES:  
 1. Woven wire fence to be fastened securely to fence posts with 16 gauge wire or staples.  
 2. Filter cloth to be secured to fence with 16 gauge wire or staples every 4' at top and mid section.  
 3. Posts to be 48\"/>

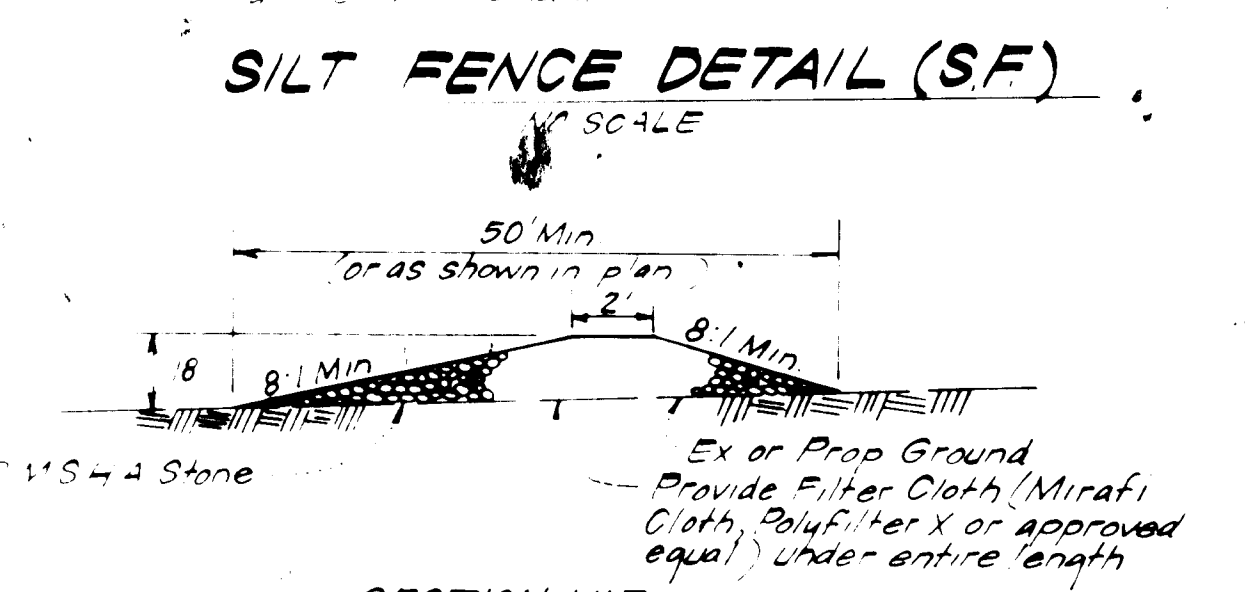

**SINGLE LOT SEDIMENT CONTROL PLAN**  
 NO SCALE

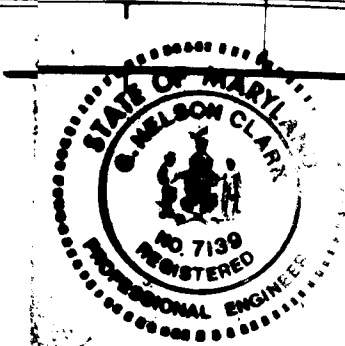
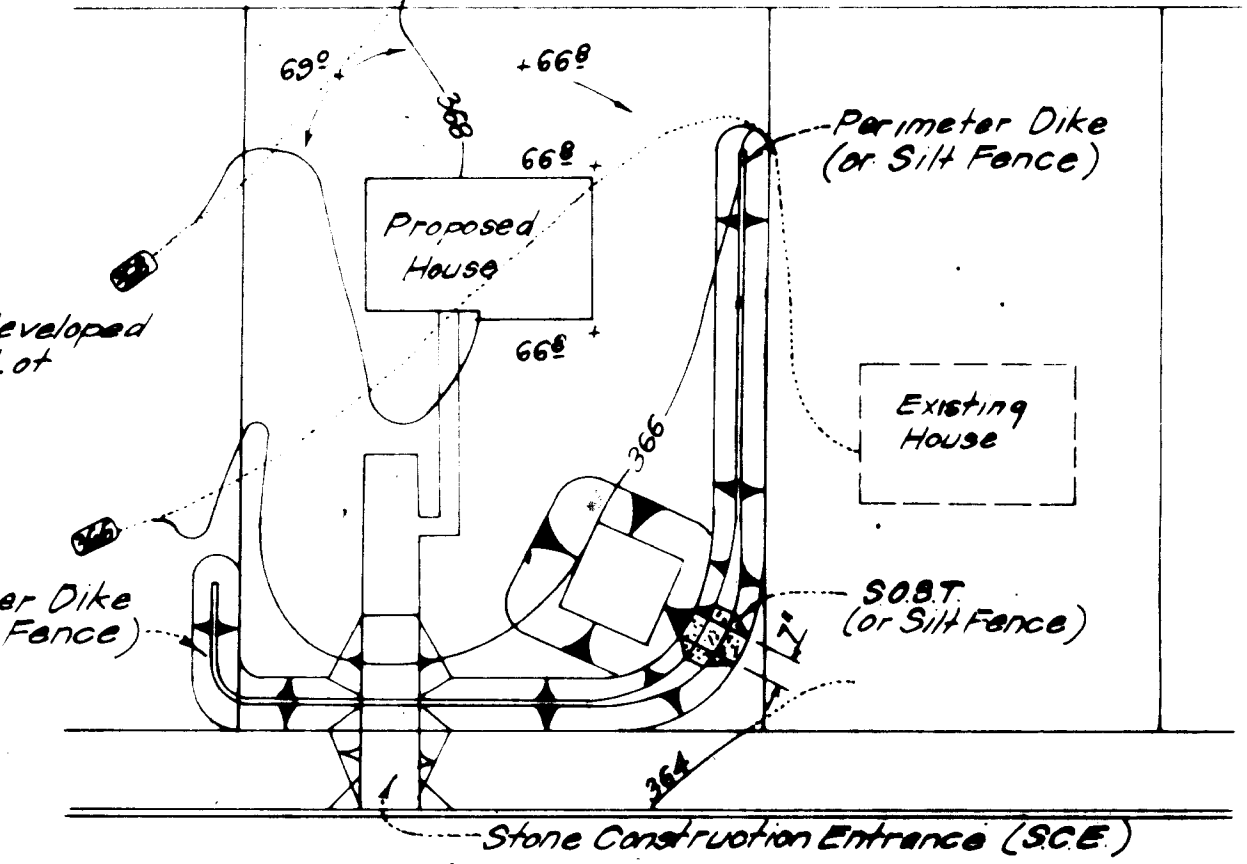

**ENGINEER'S CERTIFICATE**  
 I hereby certify that this plan for Erosion and Sediment Control represents a practical and workable plan based on my personal knowledge of this site conditions and that it was prepared in accordance with the requirements of the Howard Soil Conservation District.  
 G. Nelson Clark 4-12-84 Date  
 G. Nelson Clark

**DEVELOPER'S/BUILDER'S CERTIFICATE**  
 "I/we certify that all development and construction will be done according to this plan of development and plan for erosion and sediment control and that all responsible personnel involved in the construction of this project will have a Certificate of Attendance at a Dept. of Natural Resources Approved Training Program for the Control of Sediment and Erosion before beginning the project. I also authorize periodic on-site inspection by the Howard Soil Conservation District or their authorized agents, as may be deemed necessary."  
 Maurice M. Simpkins 4-12-84 Date  
 MAURICE M. SIMPKINS

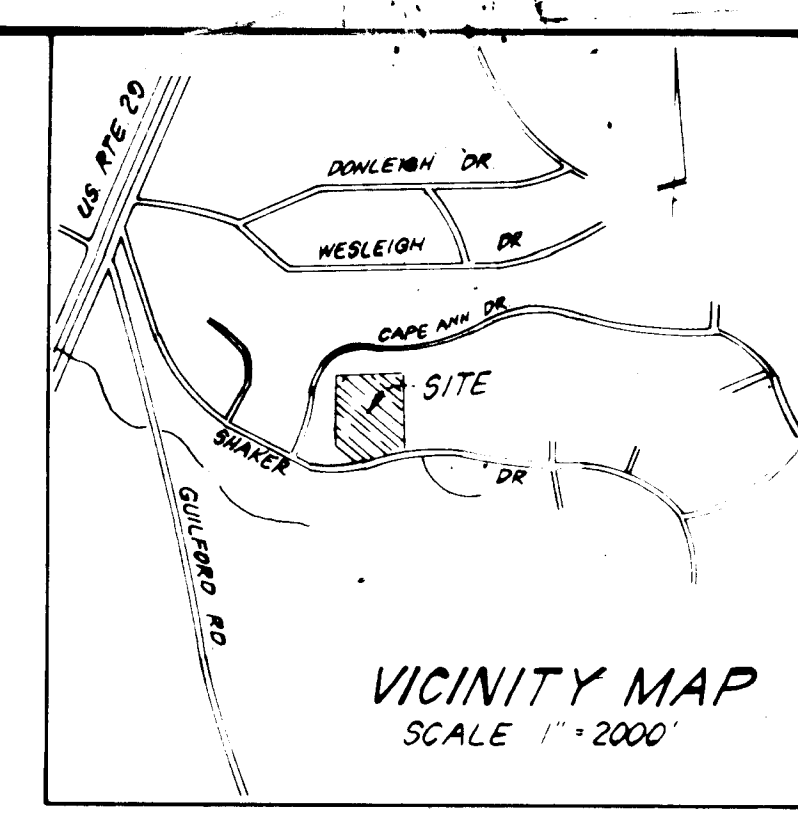
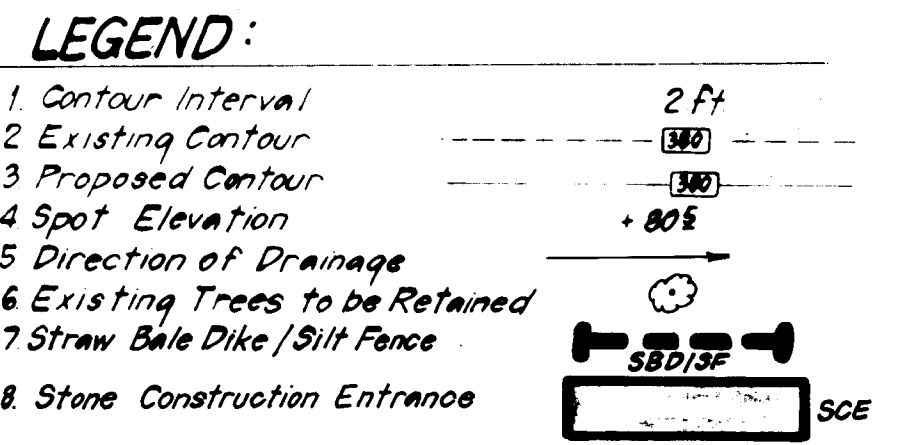

**GENERAL NOTES**

- Grading Permits shall be obtained prior to installation of Sediment Control & Grading.
- All Sediment and Erosion Control Measures will be installed and stabilized according to this plan prior to any other grading, clearing or disturbance of the existing surface of the site. See note #6 for stabilization except that the seed mixture will be annual rye applied at a rate of 1.4 lbs./1000 sf.
- Notify the Bureau of Inspections and Permits at least 24 hours before starting any work.
- All Sediment Control Practices to conform to the "Standards and Specifications for Soil Erosion and Sediment Control in Developing Areas" and shall be adjusted to meet actual field conditions.
- Stabilization of Disturbed ground to be done as soon after construction as possible.
- All disturbed areas to be stabilized in accordance with the following Specifications:  
 A. Seed - certified 85% germination applied at the rate of 3 lbs./1000 sf. Mixture - 40% Kentucky Blue, 20% chewing Fescue, 20% Kentucky 31 and 20% annual rye.  
 B. Fertilizer - 10-10-10 applied at a rate of 23 lbs./1000 sf. Ground Agricultural Lime or Dolomitic Lime applied at a rate of 90 lbs./1000 sf.  
 C. Mulch - Weed free grain straw applied at a rate of 70-90 lbs./1000 sf. Mulch shall be secured to the ground by any approved method i.e. asphalt tacks, chemical binder etc.  
 D. All Soil used shall be Maryland State Certified.
- All structural Sediment Control Measures are to remain in place until permission for their removal has been obtained from the Bureau of Inspections and Permits.
- On Site Inspection and Maintenance of all Sediment Control Measures including clean out of Sediment Traps and Dikes, and proper establishment of all planned vegetative measures will be the responsibility of the developer or his representative on the site, on a continuing day to day basis.
- It will be the developer's responsibility to provide additional Sediment & Erosion Control Devices to protect stabilized areas during construction.
- The Contractor shall keep all public roads free of sediment deposits left from traffic leaving construction site.
- Approval of this plan is conditional upon the approval of Sediment Control Plan for the off-site waste or borrow area prior to the import of any borrow or export of waste on or from this site.
- All pipes to be blocked at the end of each day. See detail this sheet N/A.
- Total Amount of Straw Bales or Silt Fence shown: 350 LF.
- SITE ANALYSIS:**  
 A. Total Area: 2.163 Acres  
 B. Area to be Roofed: 0.178 Acres  
 C. Area to be Paved: 0.173 Acres  
 D. Area to be Seeded: 0.653 Acres  
 E. Area Undisturbed: 1.159 Acres
- CONSTRUCTION SEQUENCE:**  
 A. Install Sediment & Erosion Control Devices and Stabilize Diversion Dike  
 B. Excavate for Foundations and Rough Grade  
 C. Construct Structures, Driveways and Sidewalks  
 D. Final Grade and Stabilize in accordance with note #6
- If houses are to be constructed on an "As-Sold" basis at random, Single Lot Sediment Control, as shown on this sheet, shall be implemented.

Reviewed for Howard S.C.D. Name and meets Technical Requirements  
 Signature: G. Nelson Clark Date: 6-11-84  
 U.S. Soil Conservation Service

THIS DEVELOPMENT PLAN IS APPROVED FOR SOIL EROSION AND SEDIMENT CONTROL BY THE HOWARD SOIL CONSERVATION DISTRICT.

SUBDIVISION NAME	MACGILLS COMMON	SECT AREA	LOT/PARCEL
PLAT #	5025	BLK #	1
ZONE	R-12	TAX MAP #	442
DATE	6-11-84	SEWER	5821300

APPROVED FOR PUBLIC WATER AND PUBLIC SEWERAGE SYSTEMS  
 HOWARD COUNTY HEALTH DEPARTMENT  
 COUNTY HEALTH OFFICER: [Signature] DATE: 6-24-84

APPROVED HOWARD COUNTY OFFICE OF PLANNING & ZONING  
 PLANNING DIRECTOR: [Signature] DATE: 6-26-84  
 CHIEF DIVISION OF LAND DEVELOPMENT & ZONING ADM.: [Signature] DATE: 6-28-84

APPROVED FOR PUBLIC WATER AND PUBLIC SEWERAGE STORM DRAINAGE SYSTEMS AND PUBLIC ROADS  
 HOWARD COUNTY DEPARTMENT OF PUBLIC WORKS  
 DIRECTOR: [Signature] DATE: 6-18-84  
 CHIEF BUREAU OF ENGINEERING: [Signature] DATE: 6-18-84

APPROVED  
 DIVISION OF LAND DEVELOPMENT & ZONING ADMINISTRATION  
 HOWARD COUNTY, MARYLAND  
 DATE: 5-11-84

<b>CLARK · FINEFROCK &amp; SACKETT</b> ENGINEERS · PLANNERS · SURVEYORS		11315 LOCKWOOD DRIVE · SILVER SPRING, MARYLAND 20904 · (301) 593-3400
DESIGNED	J.L.S.	SCALE 1" = 30'
DRAWN	BAF	DRAWING 84-01G
CHECKED	J.L.S.	JOB NO. 84-01G
DATE	FOR: APR 12, 1984	FILE NO. 84-01G-02
THE RYLAND GROUP (COL. DR.) One Knoll North Drive Suite 503 Columbia, Maryland 21045 <b>SDP-84-250</b>		