

1	6000
2	6000
3	6000
4	6000
5	6000
6	6000
7	6000
8	6000
9	6000
10	6000
11	6000
12	6000
13	6000
14	6000
15	6000
16	6000
17	6000
18	6000
19	6000
20	6000
21	6000
22	6000
23	6000
24	6000
25	6000
26	6000
27	6000
28	6000
29	6000
30	6000
31	6000
32	6000
33	6000
34	6000
35	6000
36	6000
37	6000
38	6000
39	6000
40	6000
41	6000
42	6000
43	6000
44	6000
45	6000
46	6000
47	6000
48	6000
49	6000
50	6000
51	6000
52	6000
53	6000
54	6000
55	6000
56	6000
57	6000
58	6000
59	6000
60	6000
61	6000
62	6000
63	6000
64	6000

Ex Trap #3
 D.A. = 2.3 Acres
 Storage Required - 1440 CF
 Storage Provided - 1440 CF
 Top of Stone Crest - 409.0
 Bottom Elev. - 405.0
 Bottom Dimensions - 22.0 x 22.0
 SEE PLAN FOR DETAILS

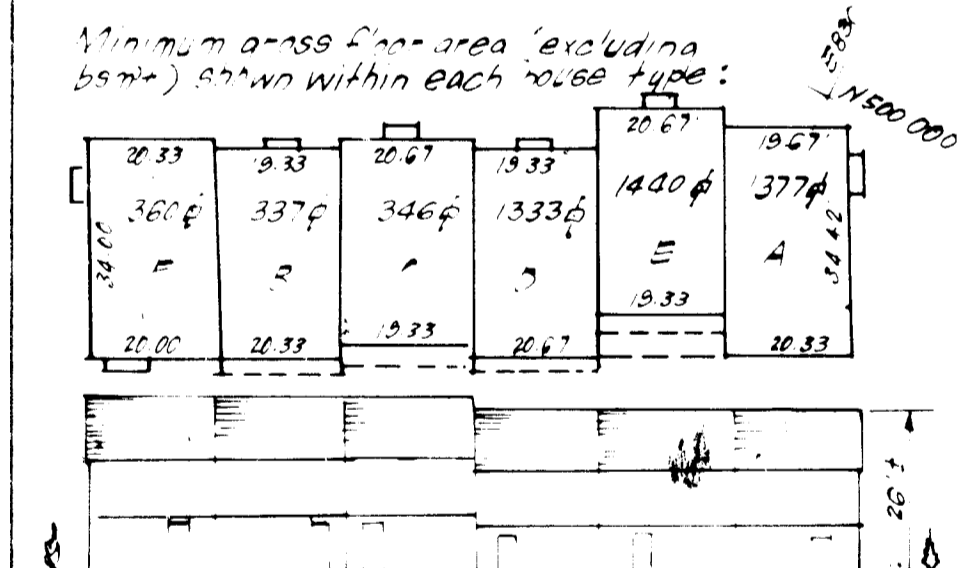
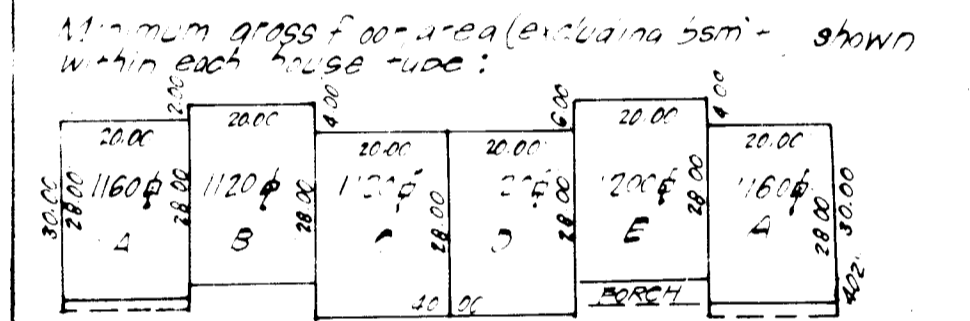

TYPICAL HOUSES
 NO SCALE

Ex Trap #2
 D.A. = 2.3 Acres
 Storage Required - 4140 CF
 Storage Provided - 4140 CF
 Depth - 4'
 Top of Stone Crest - 409.0
 Bottom Elev. - 405.0
 Bottom Dimensions - See Plan

APPROVED FOR PUBLIC WATER AND PUBLIC SEWERAGE SYSTEMS
 HOWARD COUNTY HEALTH DEPARTMENT
 DATE 4-17-84

APPROVED HOWARD COUNTY OFFICE OF PLANNING AND ZONING
 DIVISION OF LAND DEVELOPMENT & ZONING ADMIN. DATE 4-18-84

APPROVED FOR PUBLIC WATER AND PUBLIC SEWERAGE
 STORM DRAINAGE SYSTEMS AND PUBLIC ROADS
 HOWARD COUNTY DEPARTMENT OF PUBLIC WORKS
 DATE 4-16-84

APPROVED
 DIVISION OF LAND DEVELOPMENT &
 ZONING ADMINISTRATION
 HOWARD COUNTY, MARYLAND
 DATE 2-8-84

THE HOWARD RESEARCH AND
 DEVELOPMENT CORPORATION
 L 483
 F 196
 ZONED NEW TOWN

ZONED NEW TOWN
 PARCEL C-3
 VILLAGE OF HICKORY RIDGE
 SECTION 3 AREA 2
 PLAT 5618

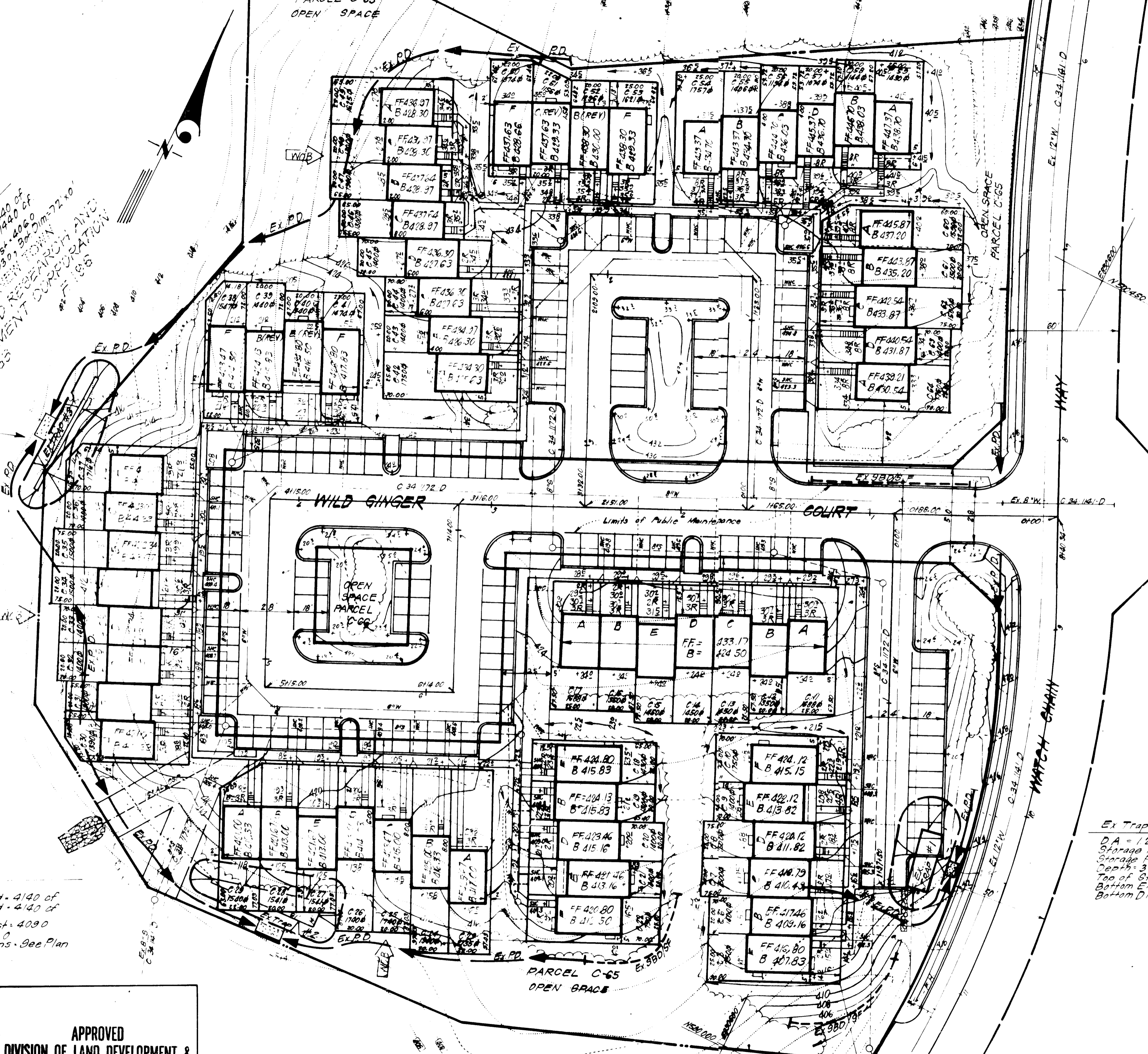

THE HOWARD RESEARCH AND
 DEVELOPMENT CORPORATION
 L 483
 F 196
 ZONED NEW TOWN

- GENERAL NOTES:**
- The Land included in this plan is zoned: New Town 35A-100
 - All coordinates shown hereon are based on the Maryland State Grid System.
 - The area covered is located on Tax Map # 35.
 - The total area of this plan is 2.051 Acres.
 - All roadways are public & existing.
 - Any damage to County owned rights of way shall be corrected at the developer's expense.
 - Number of Units shown: 80
 - Number of Parking Spaces Provided: 123, Required: 120
 - Building Coverage: $\frac{37421.62 \text{ (Area of Units)}}{200376.0 \text{ (Area of Lots \& Open Space)}} = 18.7\%$
 - The lots shown are covered by Final Development Plan # 184 Part 1

- LEGEND:**
- Contour Interval 2 FT
 - Existing Contour - - - - -
 - Proposed Contour - - - - -
 - Spot Elevation 105
 - Direction of Drainage
 - Existing Trees to be retained
 - Perimeter Dike Existing
 - Grass Base Dike with Fence Existing
- NOTE: Approved Road Construction Plans shall be used for installation of Public Utilities
 Public Water & Sewer shown for reference only. See Water & Sewer Plans Contract No. 6-34-1172-D

Ex Trap #1
 D.A. = 1.2 Acres
 Storage Required - 2160 CF
 Storage Provided - 2160 CF
 Depth - 3'
 Top of Stone Crest - 414.0
 Bottom Elev. - 411.0
 Bottom Dimensions - 34' x 12'

SEDIMENT & EROSION CONTROL FOR THIS SITE IS PROVIDED FOR BY PREVIOUSLY APPROVED ROAD CONSTRUCTION PLAN DWG No. F84 80.

SUBDIVISION NAME	VILLAGE OF HICKORY RIDGE	SECT AREA	3 1/2	LOT PARCEL	# 5 A 64
PLAT OR L.P. BLOCK	5780	TOWNE	35	TAX ZONE	MA 100
WATER CODE	E27	SEWER CODE	653.000		

DESIGNED	JME	SCALE	1"=30'
DRAWN	JME	DRAWING	106 C
CHECKED	JME	JOB NO	85 113
DATE	1-11-84	FILE NO	83 113 X

CLARK · FINEFROCK & SACKETT
 ENGINEERS · PLANNERS · SURVEYORS
 11315 LOCKWOOD DRIVE · SILVER SPRING, MARYLAND 20904

SITE DEVELOPMENT PLAN
 LOTS C-5 THRU C-64
COLUMBIA
 VILLAGE OF HICKORY RIDGE
 SECTION 3 AREA 2
 6TH ELECTION DISTRICT
 HOWARD COUNTY, MARYLAND
 FOR: The Ryland Group, Inc.
 One Knoll North #503
 Columbia, Maryland 21045

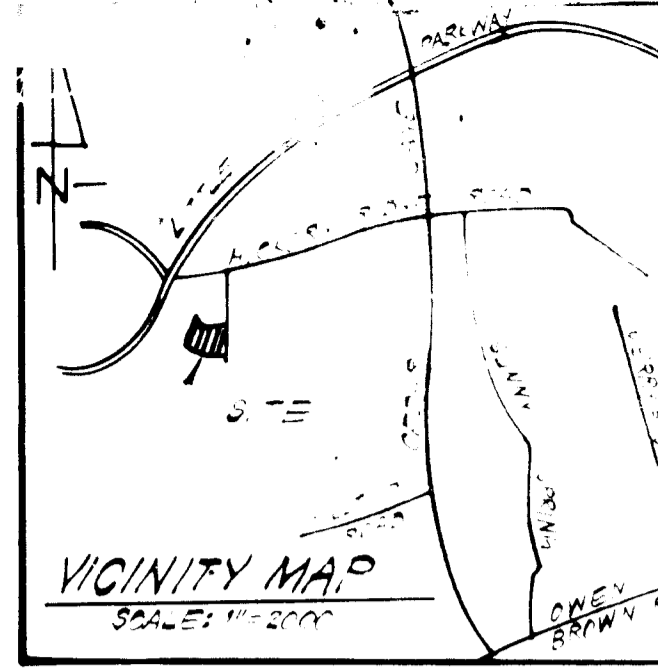

ZONED: NEW TOWN
 THE HOWARD RESEARCH AND
 DEVELOPMENT CORPORATION
 L 463 F.196

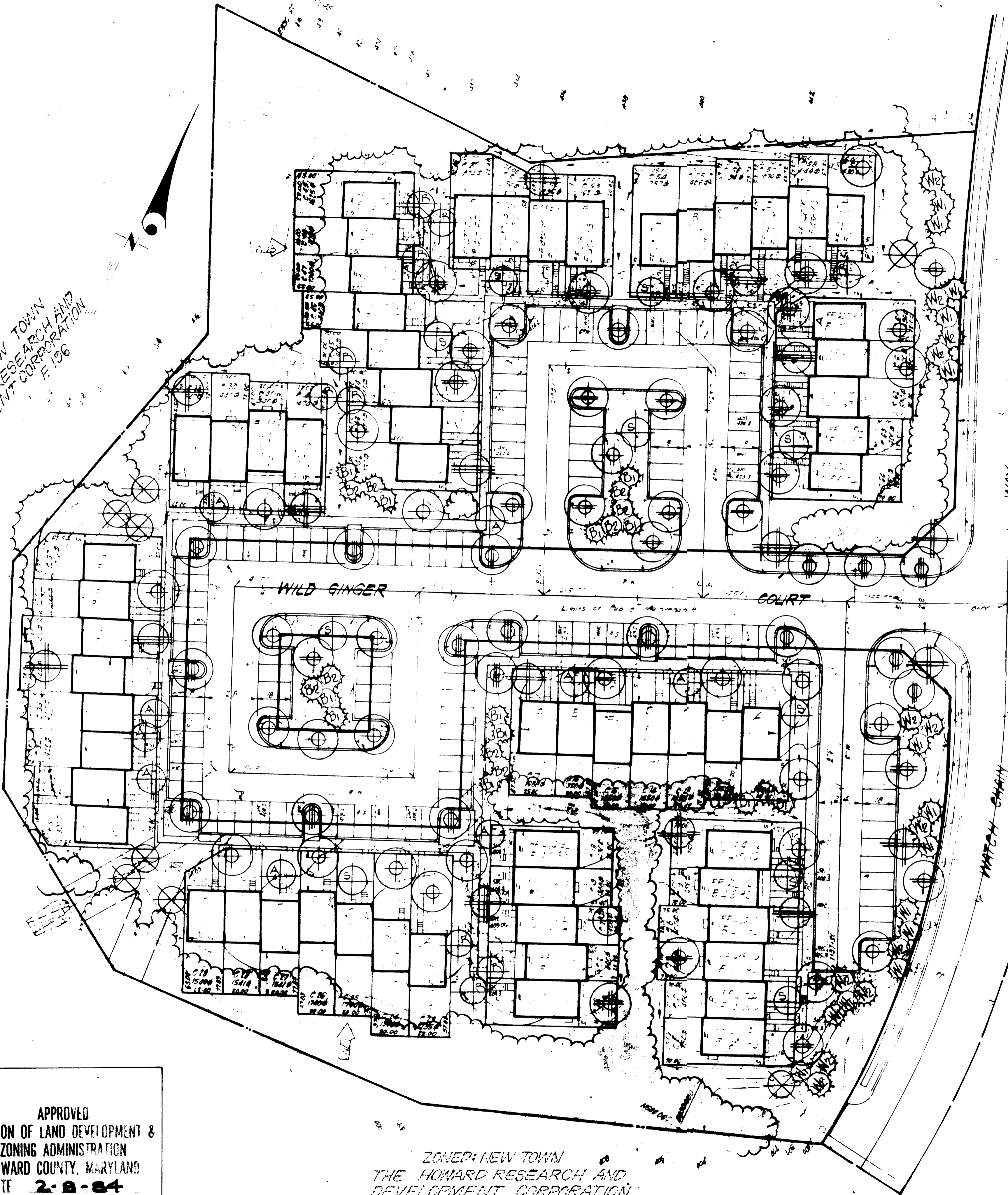

PLANT SCHEDULE

KEY	PLANT NAME	SIZE	QUANT	REMARKS
⊕	ZELCOYA SERENA V. GREEN	2 1/2 FT	7	
⊕	VILLAGE GREEN ZELCOYA			
⊕	ACER PLURIMUM QT. FLOP		12	
⊕	COOPER GLOOM YAMPE			
⊕	QUERCUS PUBERA		2	
⊕	NORTHERN RED OAK			
⊕	FRAXINUS P. LANCEOLATA		11	
⊕	GREEN ASH			
⊕	FRAXINUS P. KANEAN	2 1/2 FT	11	
⊕	KANEAN CHEST	2 1/2 FT		
⊕	FRAXINUS C. THUNDERBOLT		5	
⊕	PURPLELEAF PLUM			
⊕	MALVUS SNOGLOID		1	
⊕	SNOGLOID CRABAPPLE			
⊕	MALVUS AMERICAN BEAUTY		3	
⊕	AMER. BEAUTY CRABAPPLE			
⊕	MALVUS PAVANT		10	
⊕	PAVANT CRABAPPLE			
⊗	ACER CINNABLA		8	
⊗	AMUR MAPLE			
W1	PINUS STROBUS	6-7 FT	4	
W1	EASTERN WHITE PINE			
W2	PINUS STROBUS	7-8 FT	2	
W2	EASTERN WHITE PINE			
B1	PINUS THUNDERBOLT	6-7 FT	2	
B1	JAPANESE BLACK PINE			
B2	PINUS THUNDERBOLT	7-8 FT	10	
B2	JAPANESE BLACK PINE			

NOTES

- CONTRACTOR SHALL VERIFY EXISTENCE OF UNDERGROUND UTILITIES PRIOR TO DIGGING
- ALL PLANTING SHALL BE IN COMPLIANCE WITH STANDARD HARD PLANTING OPERATIONS
- SUBSTITUTIONS MAY BE PERMITTED WITH THE APPROVAL OF THE LANDSCAPE ARCH (393-2400)

APPROVED FOR PUBLIC WATER AND PUBLIC SEWERAGE SYSTEMS
 HOWARD COUNTY HEALTH DEPARTMENT
 COUNTY HEALTH OFFICER: [Signature] DATE: 4-17-84

APPROVED HOWARD COUNTY OFFICE OF PLANNING & ZONING
 PLANNING DIRECTOR: [Signature] DATE: 4-18-84

APPROVED FOR PUBLIC WATER AND PUBLIC SEWERAGE, STORM DRAINAGE SYSTEMS AND PUBLIC ROADS
 HOWARD COUNTY DEPARTMENT OF PUBLIC WORKS
 DIRECTOR: [Signature] DATE: 4-16-84

CHIEF BUREAU OF ENGINEERING: [Signature] DATE: 4-13-84

APPROVED
 DIVISION OF LAND DEVELOPMENT &
 ZONING ADMINISTRATION
 HOWARD COUNTY, MARYLAND
 DATE: 2-8-84
 [Signature]

ZONED: NEW TOWN
 THE HOWARD RESEARCH AND
 DEVELOPMENT CORPORATION
 L 463 F.196

Wayard L. Thier
 4/5/84

CLARK • FINEROCK & SACKETT
 ENGINEERS, ARCHITECTS, PLANNERS
 11315 LOCKWOOD DRIVE SILVER SPRING, MARYLAND 20904

LANDSCAPE PLANTING PLAN

DESIGNED BY: JBC
 DRAWN BY: JBC
 CHECKED BY: W.H.T.
 DATE: 2-5-84

LOT 5 C-3 TRAIL C-24
 COLUMBIA
 V.O.H.P., 3/2
 6TH ELECTION DISTRICT
 HOWARD COUNTY, MARYLAND

THE POTLAND GROUP
 ONE WOLF NORTH
 COLUMBIA, MD 21045