

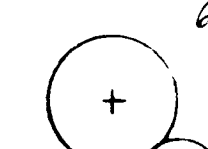

- LEGEND:**
- 1. Contour Interval 2 FT
 - 2. Existing Contour 300
 - 3. Proposed Contour 300
 - 4. Spot Elevation -028
 - 5. Direction of Drainage
 - 6. Existing Trees to be retained
-  Major Deciduous Tree (oak, maples) 24"-3" Cal. 12'-14" ht.
 Intermediate Flowering Tree 2-2 1/2" Cal. 6-10' ht.
 Evergreen Trees (pines, spruce) 2 1/2" Cal. 6-8' ht.



- GENERAL NOTES:**
1. The Land included in this plan is zoned: R60
 2. The Lots shown on this plan are subject to Final Development Plan Phase #74
 3. All coordinates are based on traverse controls for Columbia established by Maps, Inc. in 1966 by Pyrdum Jesonke in 1968, which controls were tied to Maryland Bureau of Control Survey monuments and to U.S. Coast & Geodetic Survey monuments in the Columbia area.
 4. The area covered in this submission is located on Tax Map # 42
 5. The total area included on this plan is 0.1447 Acres
 6. All roadways are public & existing.
 7. Any damage to county owned rights of way shall be corrected at the developer's expense.
 8. Total number of Lots: 1.

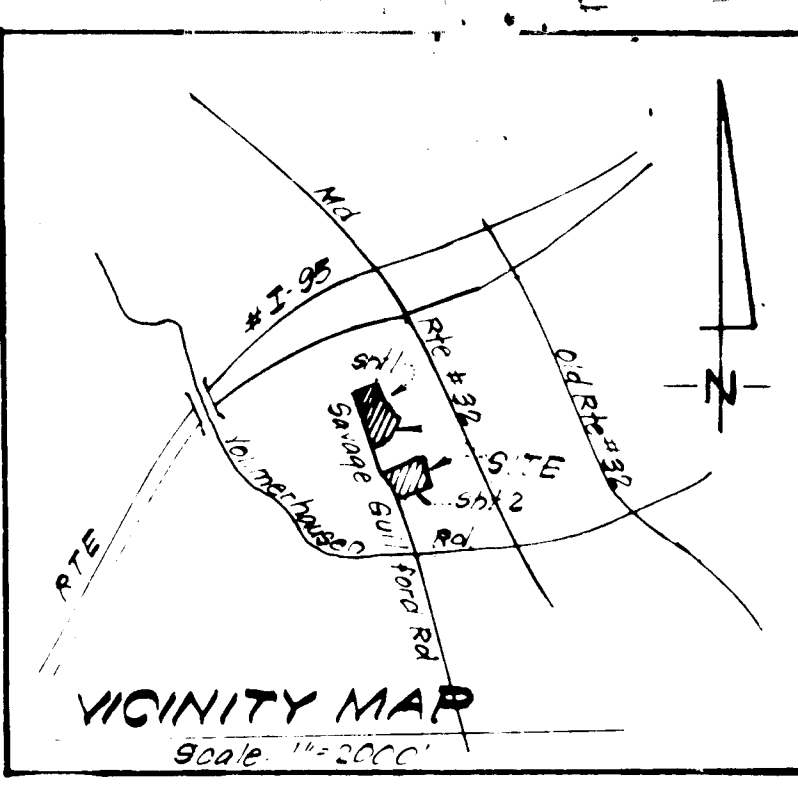
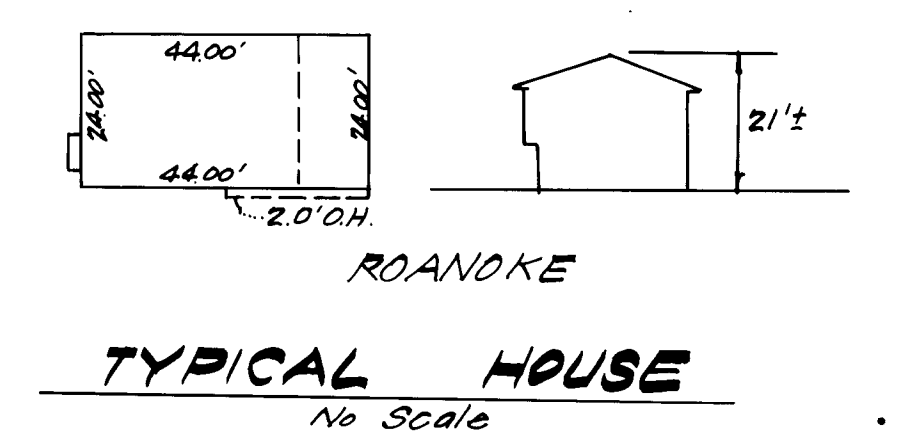

ADDRESS CHART	
LOT NO.	STREET ADDRESS
160	8038 Andiron Lane

SUBDIVISION NAME	SECT./AREA	LOT/PARCEL#
Greenbriar Woods-V.K.C.	5/1	160
PLAT# OR L.P.L.#	ZONE	PARCEL# MAP FILED DIST. CONSID. TR.
4349	22 R.S.C.	42 6TH 6064
WATER CODE	SEWER CODE	
E-14	5291500	

CLARK • FINEFROCK & SACKETT
ENGINEERS • PLANNERS • SURVEYORS
11315 LOCKWOOD DRIVE SILVER SPRING, MARYLAND 20904 (301) 593-1411

DESIGNED	REVISED SITE DEVELOPMENT PLAN	SCALE
DATE	LOT 160	1"=30'
DRAWN	GREENBRIAR WOODS	DRAWING
CHECKED	V.L.B.	1 of 1
DATE	SECTION 5 AREA 1	JOB NO.
	6TH ELECTION DISTRICT	79-093
	HOWARD COUNTY, MARYLAND	FILE NO.
	FOR THE RYLAND GROUPING (GOL) DIVISION	79-093-X
	One Knoll North Dr., Suite 503	
	Columbia, Md. 21045	

SURVEYOR'S CERTIFICATION

I hereby certify that the information contained hereon is the same as shown on previously approved SDP 80-74 C with the following exceptions:

1. House Type and Grading has been revised on Lot 160.

I further certify that the Sediment & Erosion control measures, as previously approved, will not be affected, the grading is substantially the same as originally approved, the building setbacks comply with Howard County Zoning and Subdivision Regulations, and the lot has the same geometric configuration as shown on the respective recorded subdivision Plat.

Oct. 27, 1983
Date

Donald B. Sackett
DONALD B. SACKETT
Registered Land Surveyor
Md. No. 6059

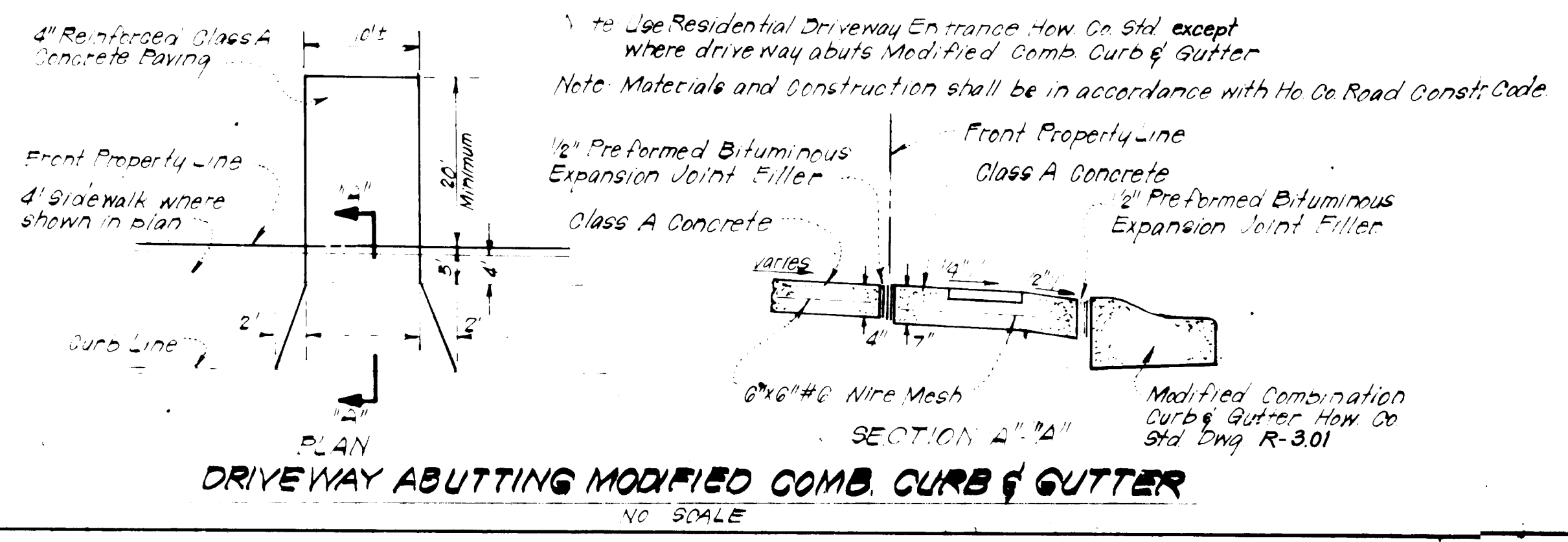

APPROVED
DIVISION OF LAND DEVELOPMENT & ZONING ADMINISTRATION
HOWARD COUNTY, MARYLAND
DATE 11-17-83

[Signature]

APPROVED FOR PUBLIC WATER AND PUBLIC SEWERAGE SYSTEMS, HOWARD COUNTY HEALTH DEPARTMENT
DATE 12-6-83

APPROVED HOWARD COUNTY OFFICE OF PLANNING & ZONING
DATE 12-8-83

APPROVED FOR PUBLIC WATER AND PUBLIC SEWERAGE, STORM DRAINAGE SYSTEMS AND PUBLIC ROADS, HOWARD COUNTY DEPARTMENT OF PUBLIC WORKS
DATE 12-7-83

APPROVED FOR PUBLIC WATER AND PUBLIC SEWERAGE, STORM DRAINAGE SYSTEMS AND PUBLIC ROADS, HOWARD COUNTY DEPARTMENT OF PUBLIC WORKS
DATE 11-5-83

