

TYPICAL HOUSES
No Scale

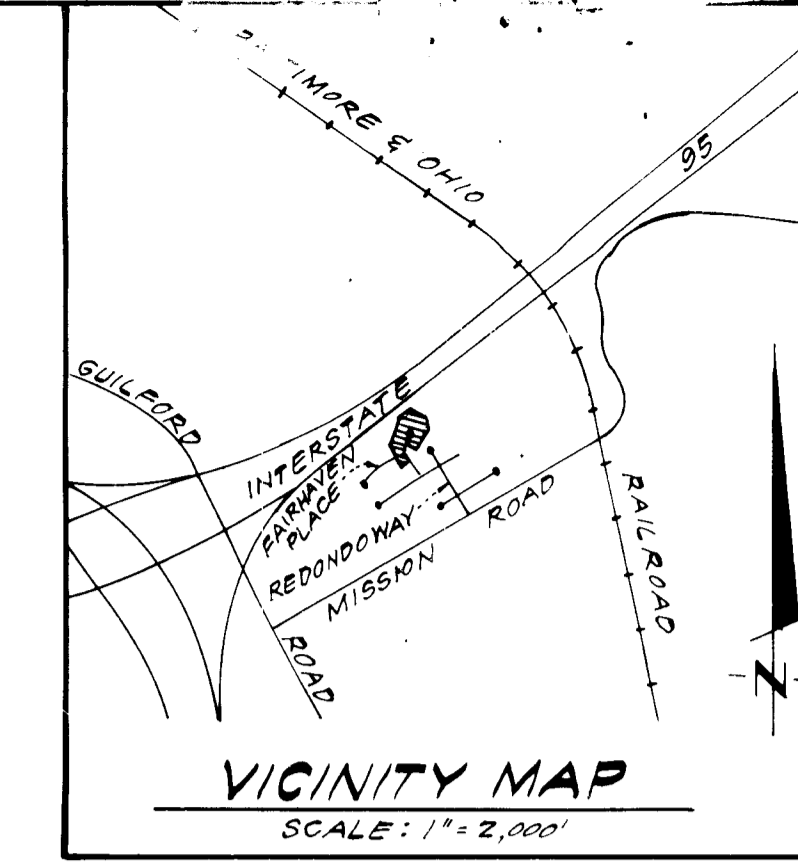

- GENERAL NOTES:**
- All coordinates are based on Howard County Control Station Control Point Nos. 2243001R and 2142003R.
 - Total Number of Lots: 12
 - The total area included in this plan is 1.897 Acres.
 - All roadways are public and existing.
 - Any damage to county owned rights of way shall be corrected at the developer's expense.
 - The contractor or developer shall contact the construction inspection/survey division, 24 hours in advance of commencement of work at 892-2417 or 892-2418.

- SPECIAL NOTES:**
- Approved Road Construction Plans shall be used for All Public Utilities.
- Public Water and Sewer shown for Reference only. For more detailed information - see water and sewer plans Contract No. 24-1076 D.
- The Water & Sewer House Connections not included in a "Developer's Agreement" shall conform to the Howard Co Plumbing Code. The on-site WHC shall be 1" copper and the SHC shall be 4" iron.

- LEGEND:**
- Contour Interval 2 FT.
 - Existing Contour - - - - -
 - Proposed Contour - - - - -
 - Spot Elevation + 295
 - Direction of Drainage →
 - Existing Trees to be Retained

ADDRESS CHART	
LOT NUMBER	STREET ADDRESS
26	8701 FAIRHAVEN PLACE
51	8702 FAIRHAVEN PLACE
52	8721 SMITHFIELD PLACE
53	8725 " "
54	8729 " "
55	8733 " "
56	8737 " "
57	8738 " "
58	8734 " "
59	8730 " "
60	8726 " "
61	8722 SMITHFIELD PLACE

STREET TREES
Street trees shall be planted by the developer, Security Development, at a rate of at least one tree per 40' of lot frontage, and in accordance with Section 16.131 of the Subdivision and Land Development Regulations of Howard County.

SUBDIVISION NAME	HERITAGE WOODS	SECT./AREA	1/1	LOT/PARCELS	Lots 1 thru 75
PLAT/REF. LIT.	5314	ZONE	R.S.C.	PERMITS/ELECT.	42
WATER CODE	E14	SEWER CODE	400.900	CENSUS	6064

APPROVED FOR PUBLIC WATER AND PUBLIC SEWERAGE SYSTEMS,
HOWARD COUNTY HEALTH DEPARTMENT

COUNTY HEALTH OFFICER: *[Signature]* DATE: 9-24-83

APPROVED, HOWARD COUNTY OFFICE OF PLANNING & ZONING

PLANNING DIRECTOR: *[Signature]* DATE: 7-30-83

CHIEF DIVISION OF LAND DEVELOP. & ZONING ADMIN: *[Signature]* DATE: 9-20-83

APPROVED FOR PUBLIC WATER AND PUBLIC SEWERAGE,
STORM DRAINAGE SYSTEMS AND PUBLIC ROADS
HOWARD COUNTY DEPARTMENT OF PUBLIC WORKS

DIRECTOR: *[Signature]* DATE: 9-23-83

CHIEF BUREAU OF ENGINEERING: *[Signature]* DATE: 9-23-83

APPROVED
DIVISION OF LAND DEVELOPMENT &
ZONING ADMINISTRATION
HOWARD COUNTY
DATE: 9-7-83
[Signature]

CLARK · FINEFROCK & SACKETT
ENGINEERS · PLANNERS · SURVEYORS

11315 LOCKWOOD DRIVE • SILVER SPRING, MARYLAND 20904 • (301) 593-3400

DESIGNED: JME SITE DEVELOPMENT PLAN LOTS 26 & 51 thru 61 SCALE: 1" = 30'

DRAWN: VLB HERITAGE WOODS DRAWING: 1 of 3

CHECKED: JME SECTION 1 AREA 1 JOB NO: 82-070

DATE: AUG., 1983 FOR: Diversified Housing Corp. Suite 211 American City Bldg. Columbia, Maryland 21044 FILE NO: 82-070-

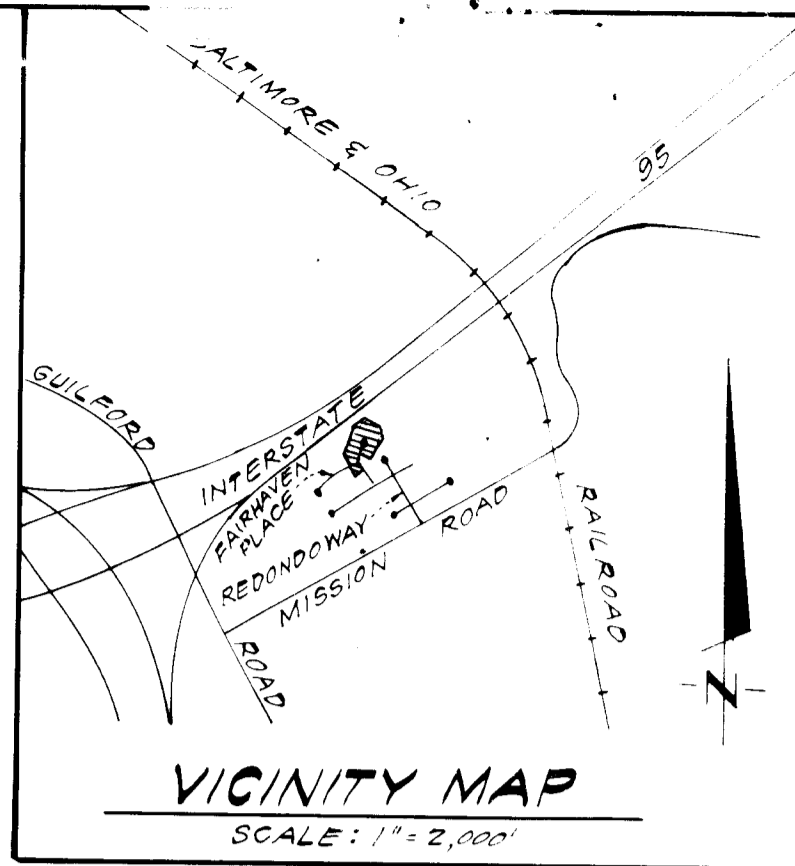

TRAP #1 S.O.S.T. (ST-3)
 D.A. = 0.6 Acres
 Storage Required = 0.6 (1800) = 1080 cf.
 Storage Provided = 1080 cf.
 Depth = 3'
 Top of Stone Crest = 325.0
 Bottom Elevation = 322.0
 Bottom Dimensions = 30' x 4'

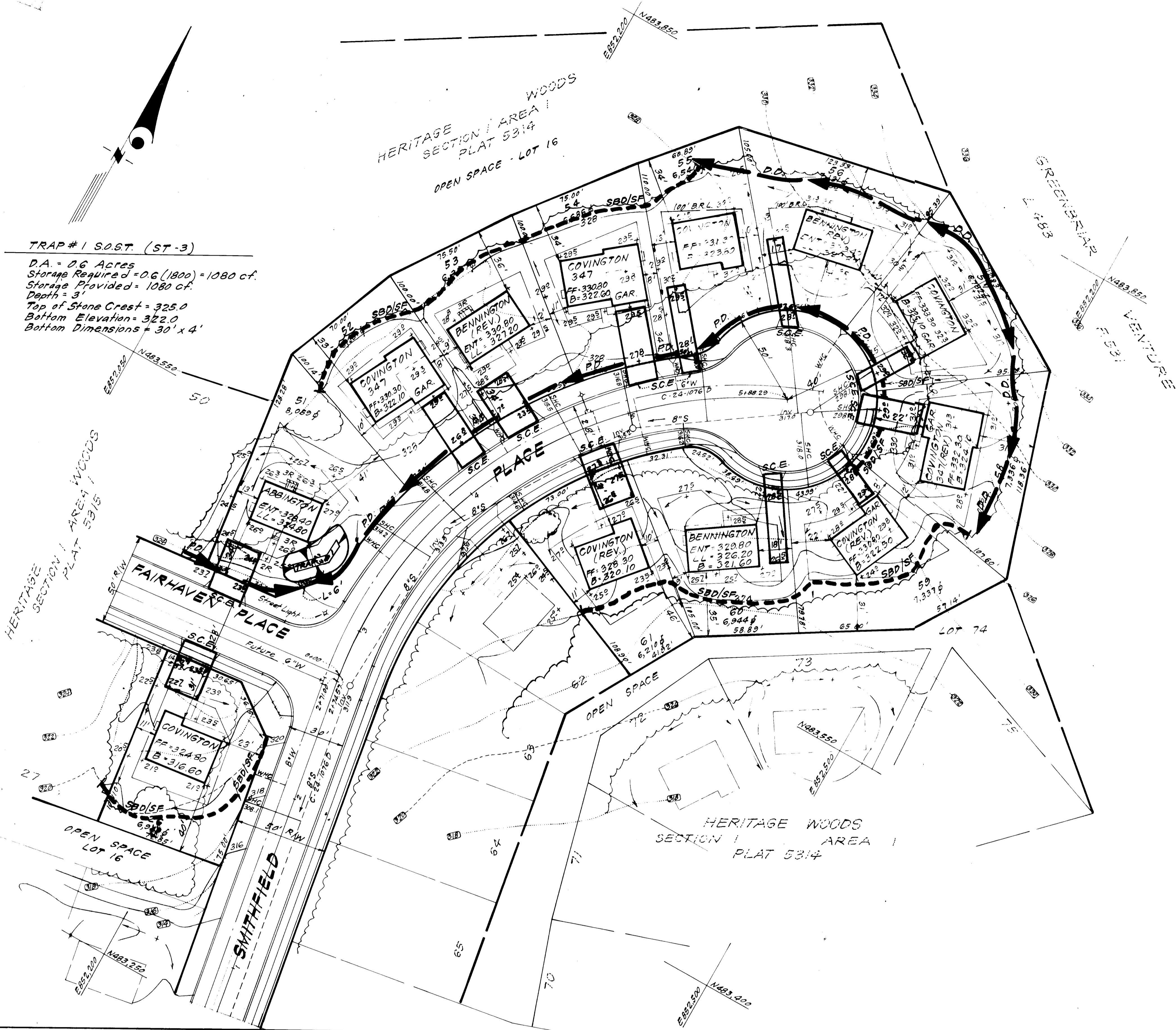

- LEGEND:**
- Contour Interval 2 F.T.
 - Existing Contour - - - - -
 - Proposed Contour - - - - -
 - Spot Elevation + 295
 - Direction of Drainage →
 - Existing Trees to be Retained (tree symbol)
 - Straw Bale Dike/Silt Fence SBD/SF
 - Perimeter Dike P.D.
 - Diversion Dike D.D.
 - Sediment Trap (trapezoid symbol)
 - Stone Construction Entrance S.C.E.

APPROVED FOR PUBLIC WATER AND PUBLIC SEWERAGE SYSTEMS.
 HOWARD COUNTY HEALTH DEPARTMENT
 COUNTY HEALTH OFFICER *John Boyer* 9-29-83
 APPROVED HOWARD COUNTY OFFICE OF PLANNING & ZONING
 PLANNING DIRECTOR *James M. Mays* 9-30-83
 CHIEF DIVISION OF LAND DEVELOPMENT & ZONING ADMIN. DATE 9-30-83

APPROVED
 DIVISION OF LAND DEVELOPMENT & ZONING ADMINISTRATION
 HOWARD COUNTY MARYLAND
 DATE 9-7-83
M. J. J.

APPROVED FOR HOWARD
 James M. Mays 9-19-83
 U.S. Soil Conservation Service
 THIS DEVELOPMENT PLAN IS APPROVED FOR SOIL EROSION AND SEDIMENT CONTROL BY THE HOWARD SOIL CONSERVATION DISTRICT
W. T. Rowe 9-14-83
 Approved Date

DEVELOPER'S/BUILDER'S CERTIFICATE
 I/We certify that all development and construction will be done according to the plan of development and plan for erosion and sediment control and that all necessary precautions involved in the construction project will be observed. I/We will have a Certificate of Attendance at a Dept. of Natural Resources approved training program for the Control of Sediment and Erosion before beginning the project. I/We also agree to cooperate in the inspection by the Howard Soil Conservation District.
Paul Montgomery 8/10/83
 Paul Montgomery

ENGINEER'S CERTIFICATE
 I hereby certify that this plan for Erosion and Sediment Control represents a practical and workable plan based on my personal knowledge of the site conditions and that it was prepared in accordance with the requirements of the Howard Soil Conservation District.
G. Nelson Clark 8-8-83
 G. Nelson Clark Date

CLARK · FINEFROCK & SACKETT ENGINEERS · PLANNERS · SURVEYORS 11315 LOCKWOOD DRIVE · SILVER SPRING, MARYLAND 20904 · (301) 593-3400		
DESIGNED B.P.	SEDIMENT & EROSION CONTROL PLAN LOTS 26 & 51 thru 61	SCALE 1" = 30'
DRAWN V.L.B.	HERITAGE WOODS SECTION 1, AREA 1 6TH ELECTION DISTRICT HOWARD COUNTY, MARYLAND	DRAWING 2 of 3
CHECKED B.P.		JOB NO. 82-070
DATE Aug, 1983	FOR: Diversified Housing Corp. Suite 211 American City Bldg. Columbia, Maryland 21044	FILE NO. 82-070SE

SDP-84-32

GENERAL NOTES

- Grading Permits shall be obtained prior to installation of Sediment Control & Grading.
- All Sediment and Erosion Control Measures will be installed and stabilized in accordance with this plan prior to any other grading, clearing or disturbance of the existing surface of the site. See note #6 for stabilization except that the seed mixture will be applied at a rate of 14 lbs/1000 sq ft.
- Notify the Bureau of Inspections and Permits at least 24 hrs before starting any work.
- All Sediment Control Practices to conform to the "Standards and Specifications for Erosion and Sediment Control in Developing Areas" and shall be adjusted to meet actual field conditions.
- Stabilization of Disturbed ground to be done as soon after construction as possible.
- All disturbed area to be stabilized in accordance with the following Seed/Planting:
 - A. Seed - certified 85% germination applied at the rate of 3.58/1000 sq ft. Mixture of Kentucky Blue, 20% Chenina Fescue, 20% Kentucky 31 and 20% annual Ryegrass.
 - B. Fertilizer - 10-10-10 applied at a rate of 23 lbs/1000 sq ft. Ground Agricultural Lime or Dolomitic Lime applied at a rate of 30 lbs/1000 sq ft.
 - C. Mulch - Weeds free grain straw applied at a rate of 70-90 bs/1000 sq ft. Mulch shall be secured to the ground by any approved method or as a result of aeration factors. Mulch shall be secured to the ground by any approved method or as a result of aeration factors.
 - D. All Seed Use shall be Maryland State Certified.
- All structural Sediment Control Measures are to remain in place until permission for their removal has been obtained from the Bureau of Inspections and Permits.
- On-Site Inspection and Maintenance of all Sediment Control Measures including clean out of Sediment Traps and Dikes, and proper establishment of all planned vegetative measures will be the responsibility of the developer or his representative on a continuing day to day basis.
- It will be the developer's responsibility to provide additional Sediment & Erosion Control Devices to protect stabilized areas during construction.
- The Contractor shall keep all public roads free of sediment deposits and traffic leaving construction site.
- Approval of this plan is conditional upon the approval of Sediment Control Plan by the off-site waste or borrow area prior to the import of any borrow or export of waste from this site.
- All pipes to be blocked at the end of each day. See detail this sheet.
- Total Amount of Straw Bales or Silt Fence shown = 660 =
- SITE ANALYSIS:**
 - A. Total Area: 1.897 Acres
 - B. Area to be Roofed: .284 Acres
 - C. Area to be Paved: .157 Acres
 - D. Area to be Seeded: 1.118 Acres
 - E. Area Undisturbed: .338 Acres
- CONSTRUCTION SEQUENCE:**
 - A. Install Sediment & Erosion Control Devices and Stabilize Diversion Dike
 - B. Excavate for Foundations and Rowan Grade
 - C. Erect Structures, Driveways and Sidewalks
 - D. Final Grade and Stabilize in accordance with note #6
- If houses are to be constructed on an "As-Bid" basis at random, Stone Construction Control as shown on this sheet, shall be implemented.

Two repairs of wooden stakes driven through each bale 1/2" into ground. Repairs to be driven flush with top of bales.

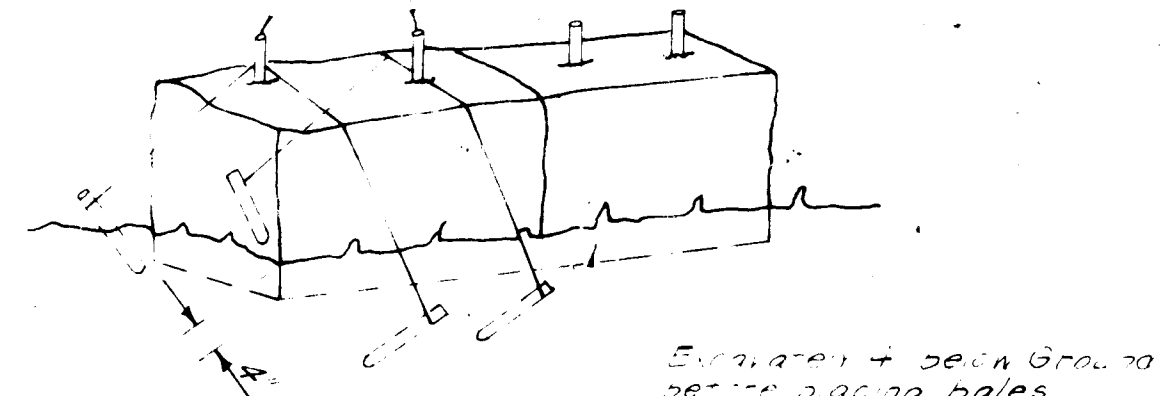

STRAW BALE DIKE DETAIL (S.B.D.)
No SCALE

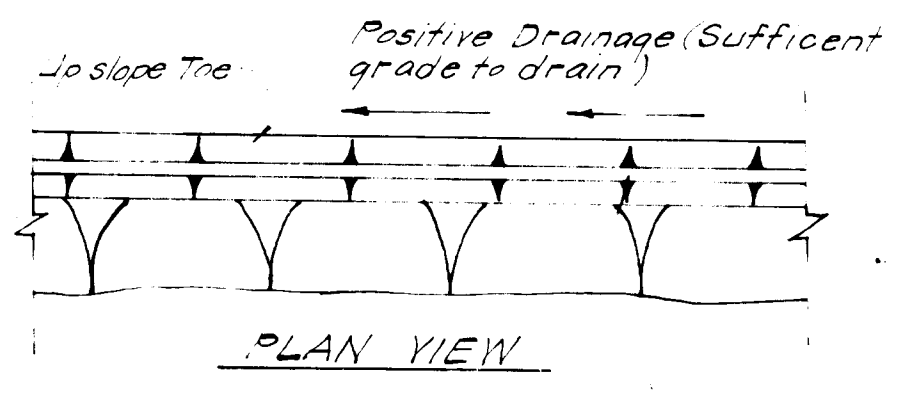
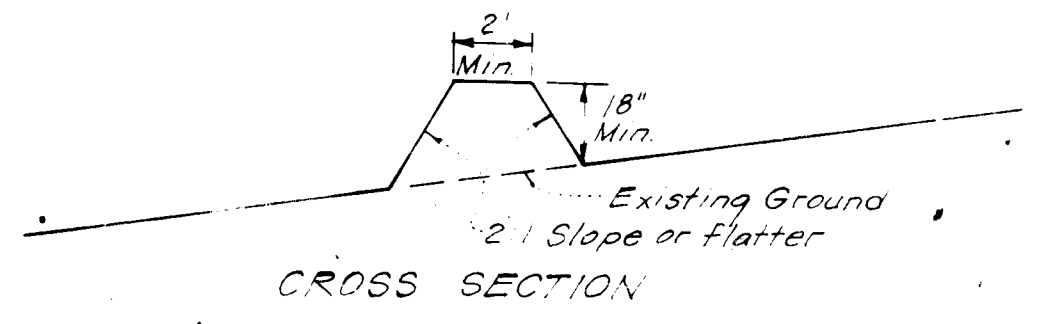

PERIMETER DIKE (P.D.)
No SCALE

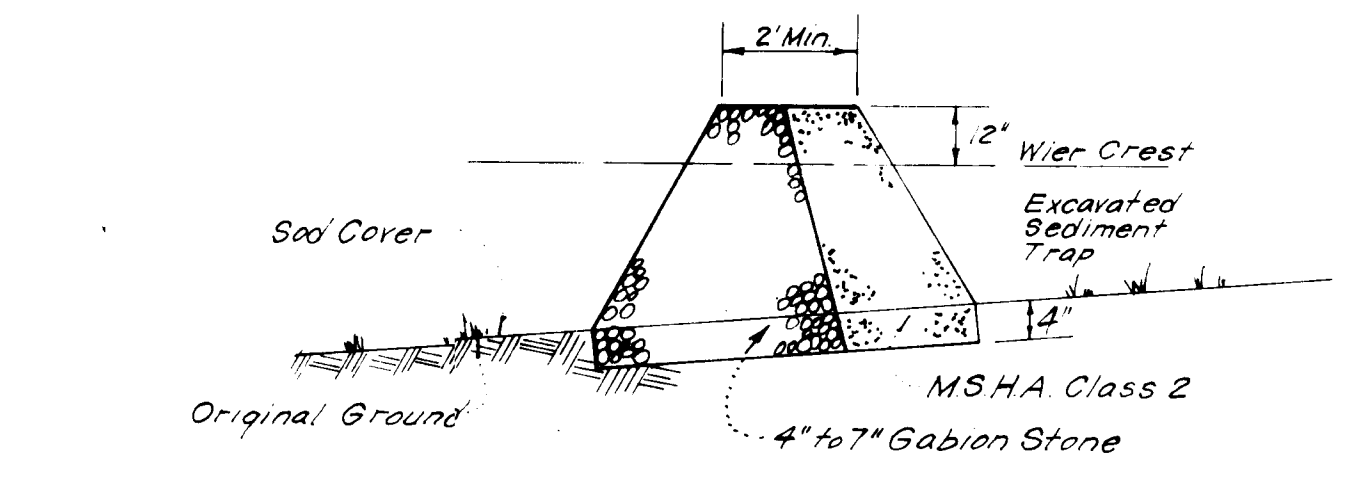

DETAILS OF STONE FILTER OUTLET FOR STONE OUTLET SEDIMENT TRAP
No SCALE

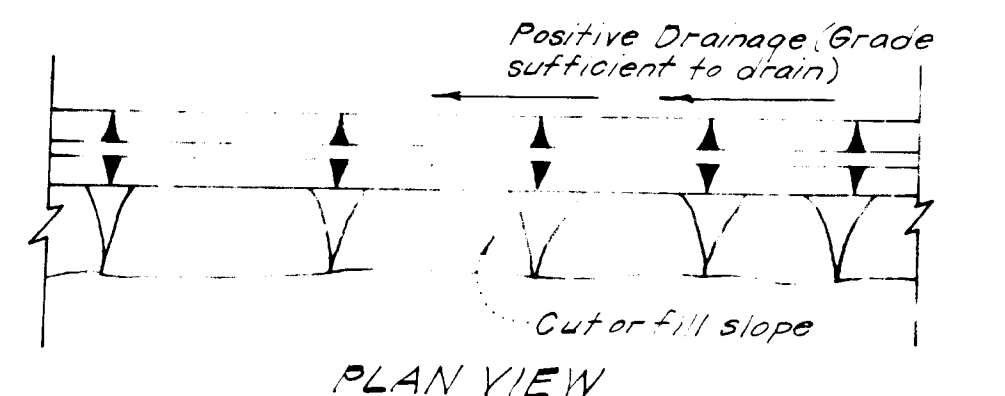
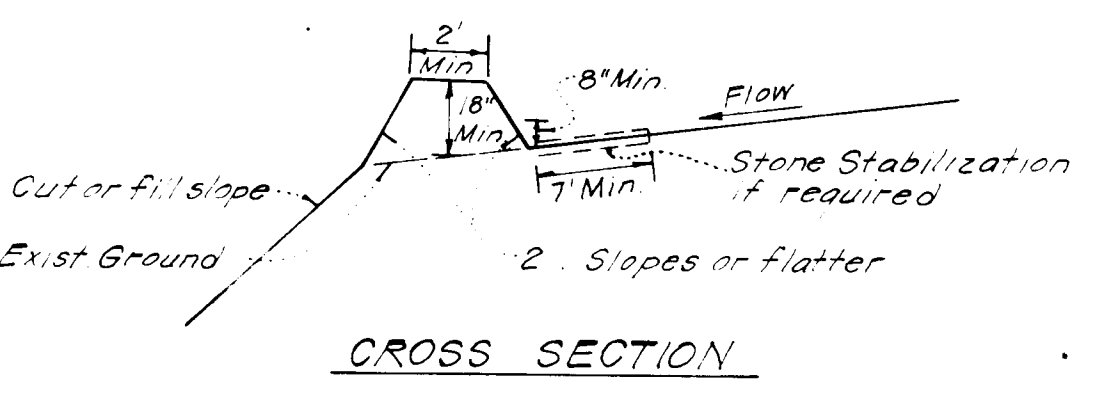
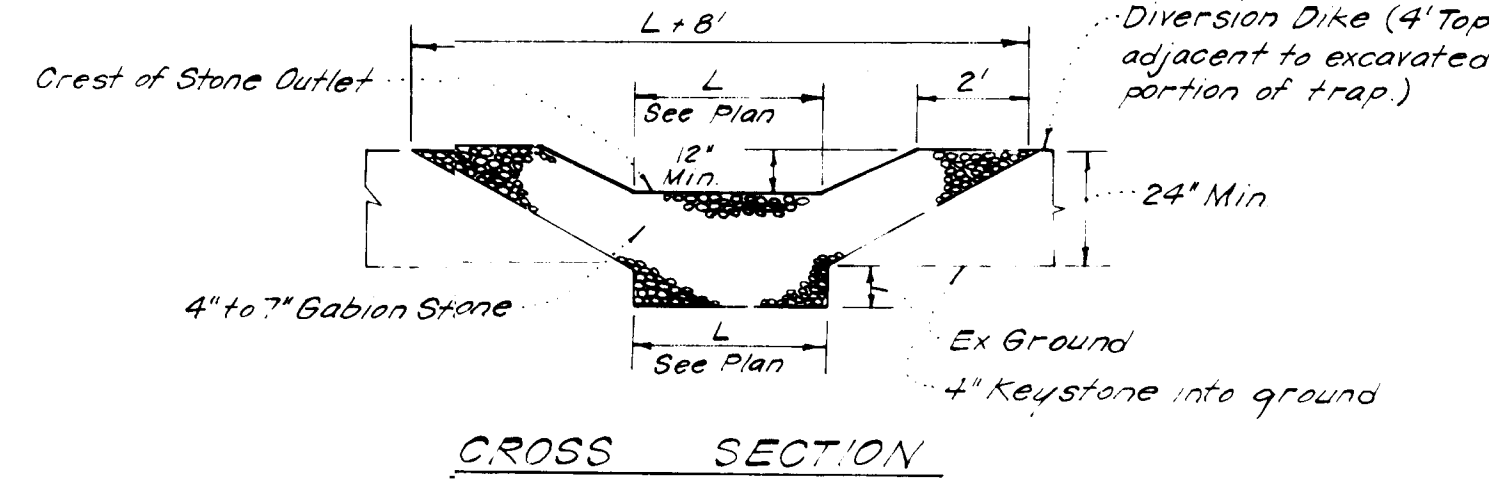

DIVERSION DIKE (D.D.)
No SCALE

- Notes:**
- Sediment Trap to be cleaned out when sediment reaches a level of 1ft below crest of stone outlet.
 - Bottom of Sediment Trap to be level and constructed to the dimensions shown on plan.
 - Stone Outlet to be constructed through diversion dike adjacent to excavated area.

DETAILS OF STONE FILTER OUTLET FOR STONE OUTLET SEDIMENT TRAP
No SCALE

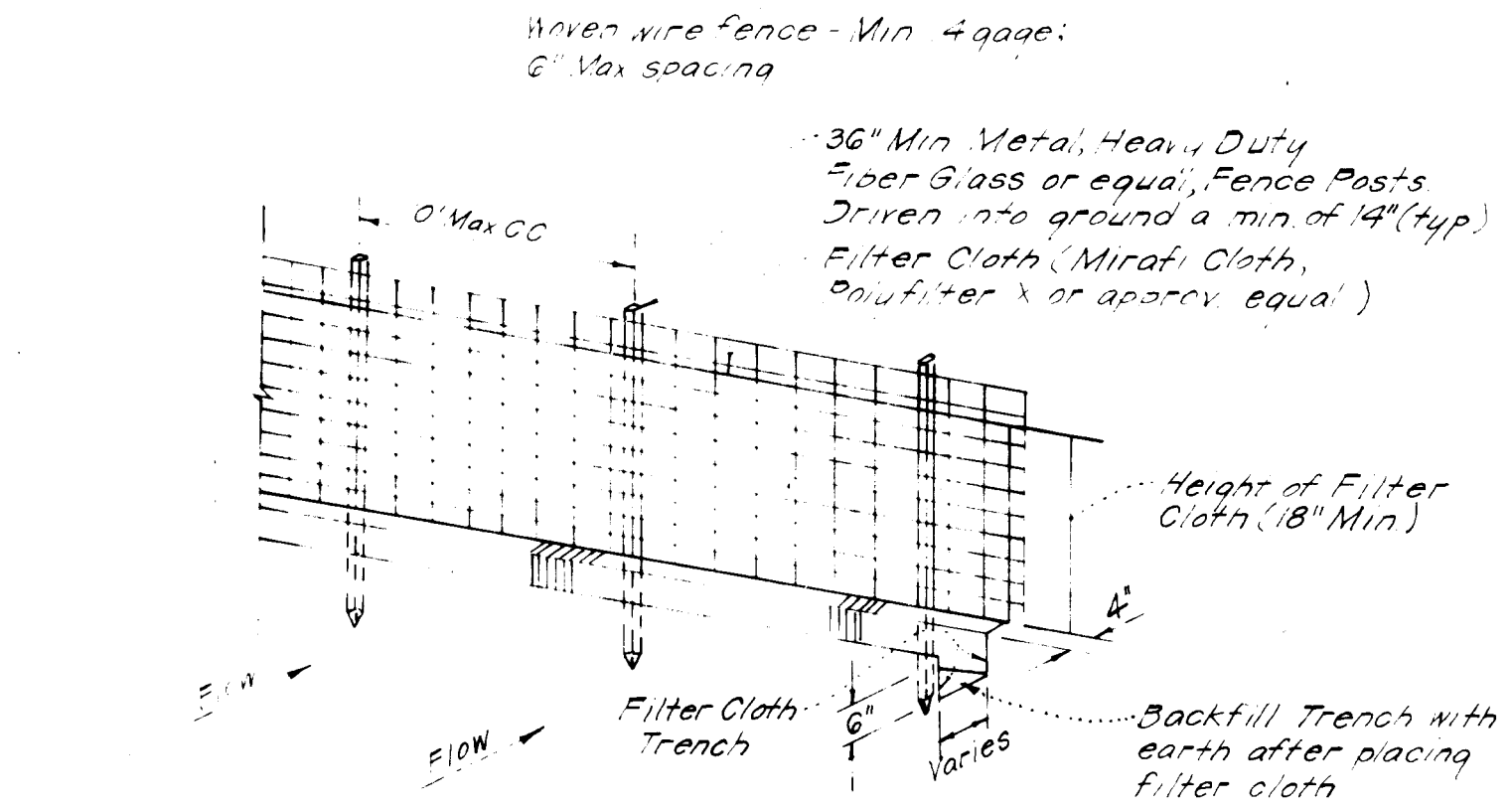

SILT FENCE DETAIL (S.F.)
No SCALE

- Notes:**
- Woven Wire Fence to be fastened securely to fence posts by use of wire ties.
 - Filter Cloth to be fastened securely to Woven Wire, by use of wire ties spaced every 24" x 24".

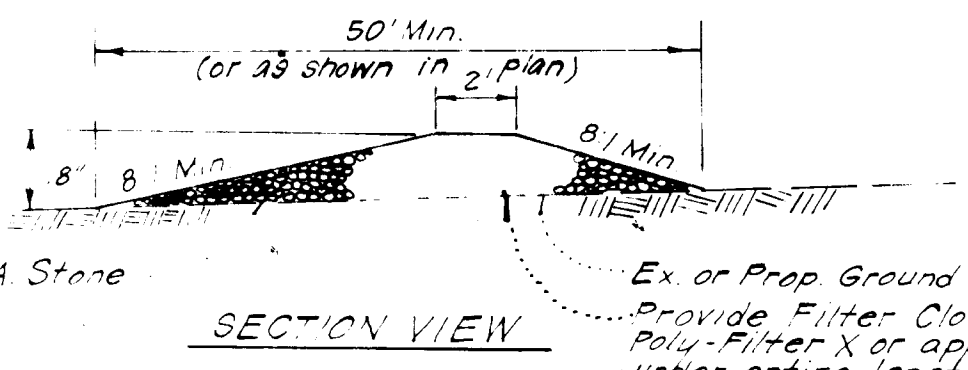

STONE CONSTRUCTION ENTRANCE (S.C.E.)
No SCALE

Use 2 MSHA Stone. Ex or Prop Ground. Provide Filter Cloth (Miraf Cloth, Poly Filter X or approved equal) under entire length.

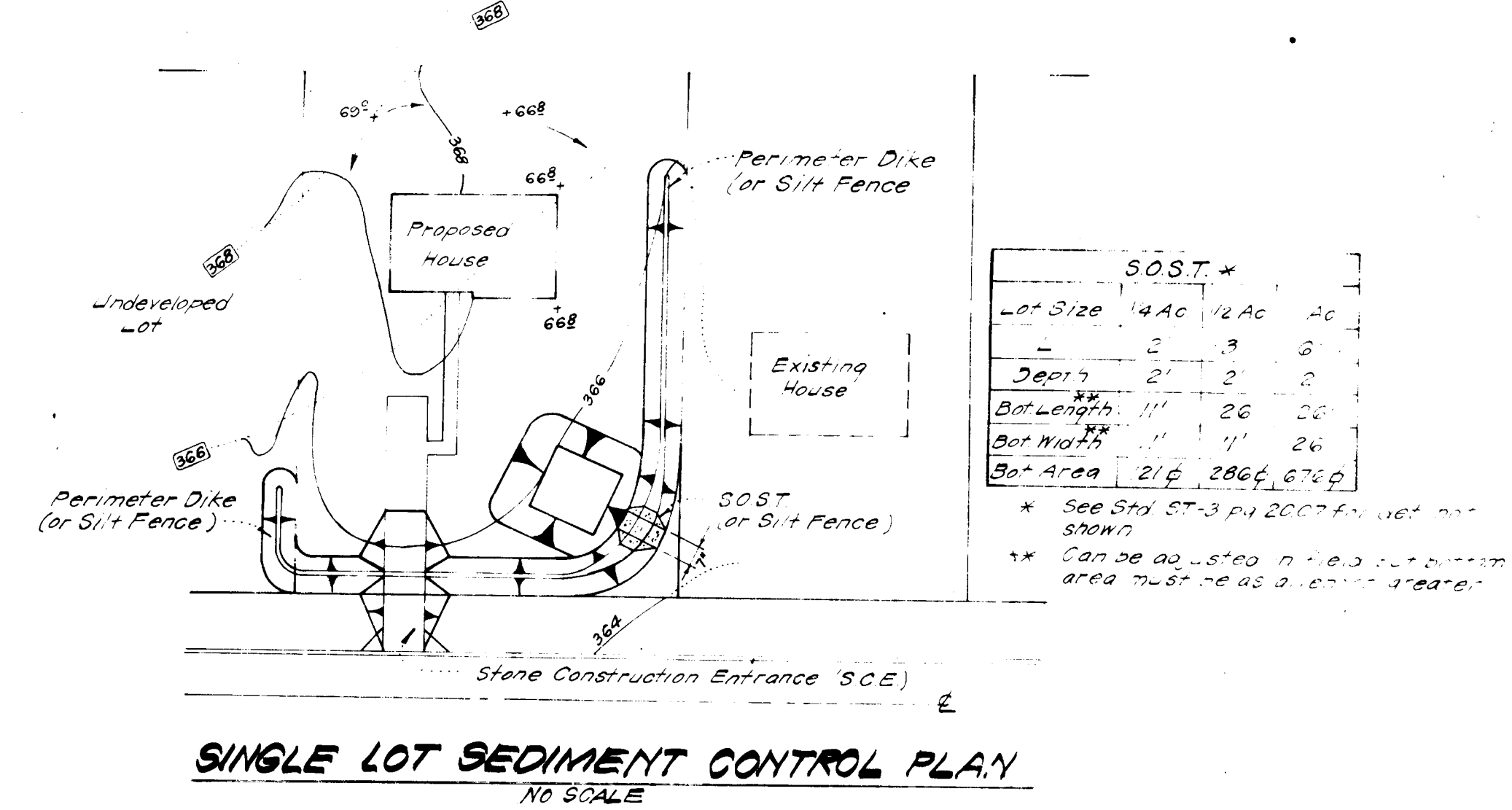

SINGLE LOT SEDIMENT CONTROL PLAN
No SCALE

APPROVED FOR PUBLIC WATER AND PUBLIC SEWERAGE SYSTEMS, HOWARD COUNTY HEALTH DEPARTMENT
 COUNTY HEALTH OFFICER: Joseph P. Jones 9-29-83
 APPROVED HOWARD COUNTY OFFICE OF PLANNING & ZONING
 PLANNING DIRECTOR: Robert M. Murchison 9-30-83
 ACTING CHIEF DIVISION OF LAND DEVELOPMENT & ZONING ADMIN: Joseph P. Jones 9-30-83
 APPROVED FOR PUBLIC WATER AND PUBLIC SEWERAGE, STORM DRAINAGE SYSTEMS AND PUBLIC ROADS, HOWARD COUNTY DEPARTMENT OF PUBLIC WORKS
 DIRECTOR: Robert M. Murchison 9-23-83
 CHIEF BUREAU OF ENGINEERING: Robert M. Murchison 9-23-83

APPROVED
DIVISION OF LAND DEVELOPMENT & ZONING ADMINISTRATION
HOWARD COUNTY, MARYLAND
 DATE 9-7-83
M. J. F.

Reviewed for: Howard S.C.D. Name
 and meets Technical Requirements
 Signature: Paul Montgomery Date: 8/19/83
 U.S. Soil Conservation Service

THIS DEVELOPMENT PLAN IS APPROVED FOR SOIL EROSION AND SEDIMENT CONTROL BY THE HOWARD COUNTY CONSERVATION DISTRICT
 Approved: Paul Montgomery 9/19/83 Date

DEVELOPER'S/BUILDER'S CERTIFICATE
 "I/We certify that all development and construction will be done according to this plan of development and plan for erosion and sediment control and that all responsible personnel involved in the construction project will have a Certificate of Attendance at a Dept. of Natural Resources Approved Training Program for the Control of Sediment and Erosion before beginning the project. I also authorize periodic on-site inspection by the Howard Soil Conservation District or their authorized agents, as are deemed necessary."
 Signature of Developer/Builder: Paul Montgomery Date: 8/19/83

ENGINEER'S CERTIFICATE
 I hereby certify that this plan for Erosion and Sediment Control represents a practical and workable plan based on my personal knowledge of the site conditions and that it was prepared in accordance with the requirements of the Howard Soil Conservation District.
 Signature: G. Nelson Clark Date: 8-23-83

CLARK • FINEFROCK & SACKETT
 ENGINEERS • PLANNERS • SURVEYORS
 11515 LOCKHART DR. VE... MARYLAND 21044

DESIGNED	<u>B.P.</u>	SCALE	<u>As Shown</u>
DRAWN	<u>V.L.B.</u>	DR. W. N.	
CHECKED	<u>B.P.</u>		<u>3 OF 3</u>
DATE	<u>Aug, 1983</u>		<u>82-070</u>

SEDIMENT & EROSION CONTROL PLAN
LOTS 26 & 51 thru 61
HERITAGE WOODS
 SECTION 1 AREA 1
 6TH ELECTION DISTRICT
 HOWARD COUNTY, MARYLAND
 FOR: Diversified Housing Corp.
 Suite 211, American City Bldg
 Columbia, Maryland 21044
 82-070SE