

**SEDIMENT CONTROL NOTES**

1. GRADING PERMITS SHALL BE OBTAINED PRIOR TO INSTALLATION OF SEDIMENT CONTROL MEASURES.
2. ALL SEDIMENT & EROSION CONTROL MEASURES WILL BE INSTALLED & STABILIZED ACCORDING TO THIS PLAN PRIOR TO ANY OTHER DISTURBANCE OF THE EXISTING SURFACE OF THE LOTS INCLUDING FERTILIZER & LIME ACCORDING TO NOTE #C SEED WITH ANNUAL RYE 1.5 LBS/1000 SQ. FT.
3. NOTIFY BUREAU OF INSPECTION & PERMITS AT LEAST 24 HOURS BEFORE STARTING WORK.
4. ALL SEDIMENT CONTROL PRACTICES TO CONFORM TO THE STANDARDS & SPEC. FOR SOIL EROSION & SEDIMENT CONTROL IN DEVELOPING AREAS AND SHALL BE ADJUSTED TO MEET ACTUAL FIELD CONDITIONS.
5. STABILIZATION OF DISTURBED GROUND TO BE DONE AS SOON AFTER CONSTRUCTION AS POSSIBLE.
6. PERMANENT STABILIZATION:
 

KENTUCKY BLUE GRASS	40%	CERTIFIED 85%
CHEWINGS FESCUE	30%	CERTIFICATION
RED FESCUE	20%	APPLIED AT
ANNUAL RYE	10%	5 LBS/1000 SQ. FT.

APPLY DOLOMITIC LIME AT 30 LBS/1000 SQ. FT. AND FERTILIZER 10-10-10 AT 25 LBS/1000 SQ. FT. (OR AS INDICATED BY SOIL TEST) BEFORE SEEDING. MULCH WITH WOOD PRES. CHIPPINGS STRAIN AT 70-90 LBS/100 SQ. FT. & SECURE TO GROUND BY APPROVED METHOD.

7. SEDIMENT CONTROL MEASURES TO REMAIN IN PLACE UNTIL PERMISSION FOR REMOVAL HAS BEEN OBTAINED FROM BUREAU OF INSPECTION & PERMITS.
8. ON SITE INSPECTION & MAINTENANCE OF SEDIMENT CONTROL MEASURES INCLUDING CLEAN OUT OF SEDIMENT TRAPS & DYES & PROPER ESTABLISHMENT OF ALL VEGETATIVE MEASURES WILL BE THE RESPONSIBILITY OF THE DEVELOPER ON A CONTINUING DAY TO DAY BASIS.

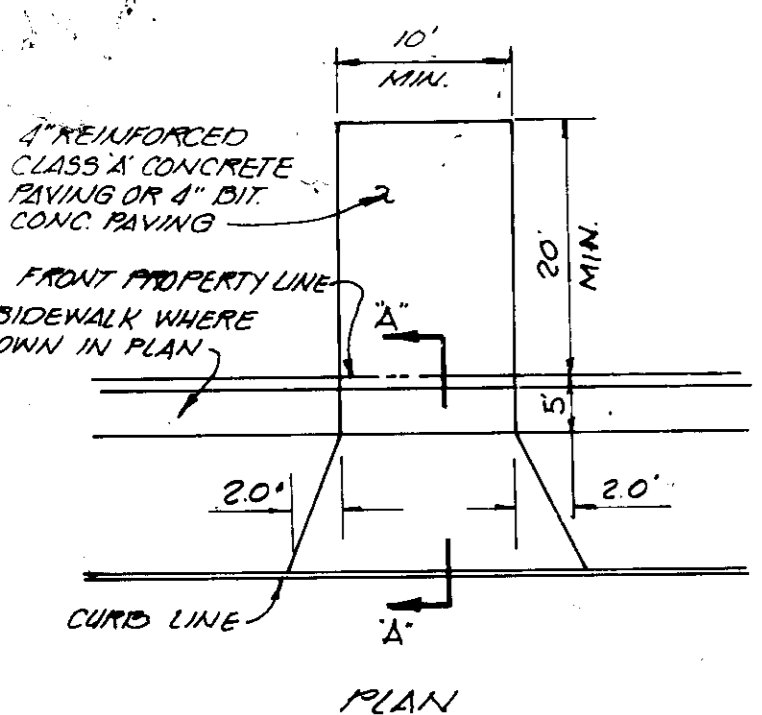

**TYPICAL PERIMETER DIKE DETAIL (PD)**

NOTE: MATERIALS AND CONSTRUCTION SHALL BE IN ACCORDANCE WITH MD CO. CONSTRUCTION CODE.

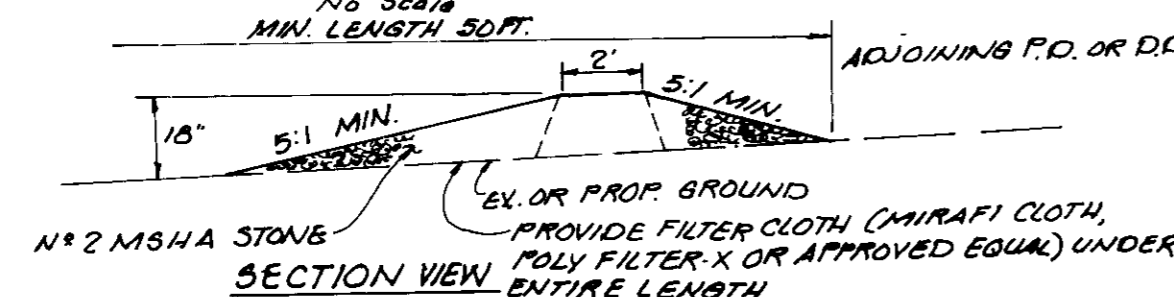

**STONE CONSTRUCTION ENTRANCE DETAIL (S.C.E.)**

TRAP #7 5.0ST. ST-3  
 DA: 0.3 AC  
 STORAGE REQUIRED: 0.6\*1800=1080 FT.<sup>3</sup>  
 STORAGE PROVIDED: 1080 FT.<sup>3</sup>  
 DEPTH: 2'  
 TOP OF STONE CREST: 411.0  
 BOTTOM ELEV.: 409.0  
 BOTTOM DIMENSIONS: 23'x16'  
 L: 2'

**DRIVEWAY ABUTTING STD. 7\"/>**

TRAP #8 5.0ST. ST-3  
 DA: 0.4 AC  
 STORAGE REQUIRED: 0.4\*1800=720 FT.<sup>3</sup>  
 STORAGE PROVIDED: 720 FT.<sup>3</sup>  
 DEPTH: 2'  
 TOP OF STONE CREST: 405.0  
 BOTTOM ELEV.: 403.0  
 BOTTOM DIMENSIONS: 16'x14'  
 L: 3'

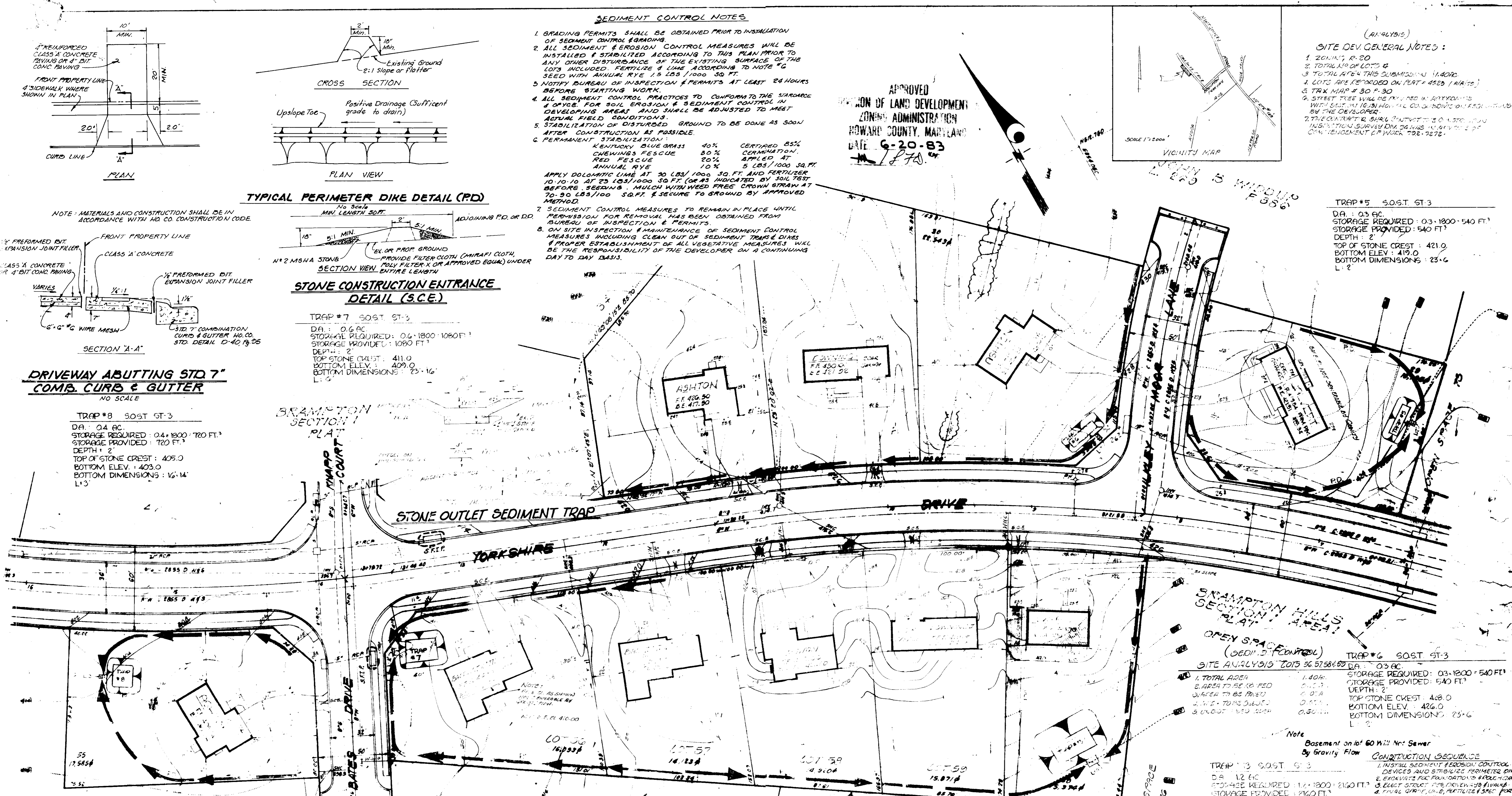

REVIEWED FOR HOWARD S.C.D. THIS DEVELOPMENT PLAN IS APPROVED FOR SOIL EROSION AND SEDIMENT CONTROL BY THE MD MEETS TECHNICAL REQUIREMENTS. HOWARD SOIL CONSERVATION DISTRICT.  
 SIGNATURE: [Signature] DATE: 7-8-83 APPROVED: [Signature] DATE: 7-8-83  
 U.S. SOIL CONSERVATION SERVICE

APPROVED FOR PUBLIC WATER AND PUBLIC SEWERAGE SYSTEMS, HOWARD COUNTY HEALTH DEPARTMENT  
 SIGNATURE: [Signature] DATE: 7-14-83  
 HEALTH OFFICER  
 APPROVED FOR HOWARD COUNTY OFFICE OF PLANNING & ZONING  
 SIGNATURE: [Signature] DATE: 7-15-83  
 PLANNING DIRECTOR  
 APPROVED FOR PUBLIC WATER AND PUBLIC SEWERAGE, STORM DRAINAGE SYSTEMS AND PUBLIC ROADS, HOWARD COUNTY DEPARTMENT OF PUBLIC WORKS  
 SIGNATURE: [Signature] DATE: 7-12-83  
 CHIEF BUREAU OF ENGINEERING

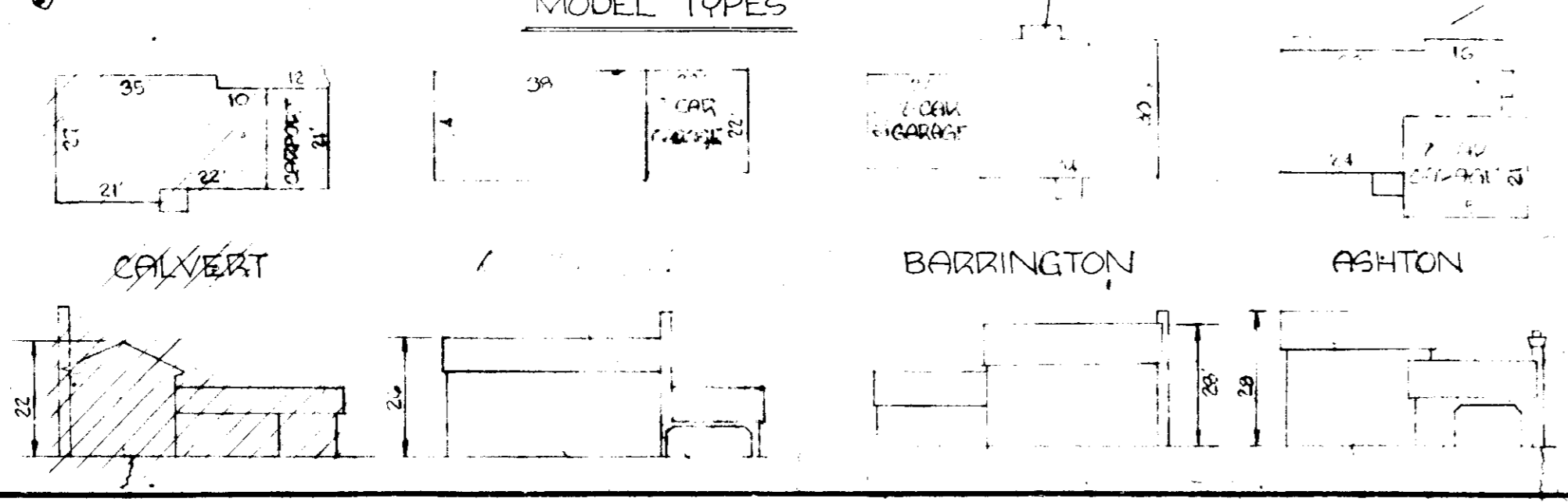

**DEVELOPER'S CERTIFICATE**

I certify that all development and construction will be done in accordance with this plan of development and plan for erosion and sediment control, and that all responsible personnel involved in the construction project will have a certificate of attendance at a Dept. of Natural Resources approved training program for the control of sediment and erosion before beginning the project. I also authorize periodic on-site inspection by the Howard Soil Conservation District, or their authorized agents, as are deemed necessary.

Signature of Developer/Builder: [Signature] DATE: 7/2/83

**ENGINEER'S CERTIFICATE**

I hereby certify that this plan for erosion and sediment control represents a practical and workable plan based on my personal knowledge of the site, and that it was prepared in accordance with the requirements of the Howard Soil Conservation District.

Signature of Engineer: [Signature] DATE: 7/1/83



LAND DESIGN ASSOCIATES  
 416 EAST WYOMING ROAD, TOWSON, MD 21284  
 TELEPHONE (410) 281-0176

REVISION TO SITE DEVELOPMENT PLAN 81-45  
 SITE DEVELOPMENT & SEDIMENT CONTROL  
**BRAMPTON HILLS**  
 SECTION 1 - AREA 1 - LOTS 56, 58 & 59  
 HOWARD COUNTY, MARYLAND  
 2ND ELECTION DISTRICT

FOR: GRAYSON HOMES, INC.  
 6212 JOHNNYCAKE RD. REISTERSTOWN, MD 21707

SCALE: 1"=40'  
 DATE: 7/1/83

(ANALYSIS)  
**SITE DEV. GENERAL NOTES:**  
 1. ZONING: R-20  
 2. TOTAL NO. OF LOTS: 4  
 3. TOTAL AREA THIS SUBMISSION: 11.40 AC.  
 4. LOTS ARE REFERRED ON PLAT # 4528 (PARTIAL)  
 5. TRAX MAP # 30 P-30  
 6. STREET TREE WILL BE PROVIDED IN APPROXIMATE WIDTH DIST. BY 16.5' HORIZONTAL CURV. BOUND. ON EROSION CONTROL BY THE DEVELOPER.  
 7. THE CONTRACTOR SHALL CONTACT THE HOWARD SOIL CONSERVATION DISTRICT FOR PERMITS AND INSPECTIONS. SEE HOWARD SOIL CONSERVATION DISTRICT, 282-2822.

TRAP #5 5.0ST. ST-3  
 DA: 0.3 AC  
 STORAGE REQUIRED: 0.3\*1800=540 FT.<sup>3</sup>  
 STORAGE PROVIDED: 540 FT.<sup>3</sup>  
 DEPTH: 2'  
 TOP OF STONE CREST: 421.0  
 BOTTOM ELEV.: 419.0  
 BOTTOM DIMENSIONS: 23'x6'  
 L: 2'

TRAP #6 5.0ST. ST-3  
 DA: 0.3 AC  
 STORAGE REQUIRED: 0.3\*1800=540 FT.<sup>3</sup>  
 STORAGE PROVIDED: 540 FT.<sup>3</sup>  
 DEPTH: 2'  
 TOP OF STONE CREST: 426.0  
 BOTTOM ELEV.: 424.0  
 BOTTOM DIMENSIONS: 23'x6'  
 L: 2'

TRAP #3 5.0ST. ST-3  
 DA: 12.6 AC  
 STORAGE REQUIRED: 12.6\*1800=22680 FT.<sup>3</sup>  
 STORAGE PROVIDED: 22680 FT.<sup>3</sup>  
 DEPTH: 2'  
 TOP OF STONE CREST: 411.0  
 BOTTOM ELEV.: 409.0  
 BOTTOM DIMENSIONS: 30'x14'  
 L: 3'