

GENERAL NOTES

1. AREA OF PARCEL - 5.26 ACRES+
2. PRESENT ZONING - M-2 (MANUFACTURING-HEAVY)
3. PROPERTY IS RECORDED IN PLAT BOOK 29, FOLIO 35
4. PARKING DATA
 - a. USE - WAREHOUSE AND ADMINISTRATIVE OFFICES
 - b. TOTAL NUMBER OF EMPLOYEES - 96 MAX.
 1. WAREHOUSE - 72 MAX.
 2. OFFICES - 24 MAX.
 - c. TOTAL AREA OF BUILDING - 76,000 S.F. BUILDING COVERAGE 34%
 1. WAREHOUSE - 72,000 S.F.
 2. OFFICES - 4,000 S.F.
 - d. TOTAL NUMBER OF PARKING SPACES REQUIRED - 48 (1 SPACE/2 EMP.)
 1. REGULAR SPACES (9'x18') = 46
 2. HANDICAP SPACES (12'x18') = 2
 - e. TOTAL NUMBER OF PARKING SPACES PROVIDED - 48
 1. REGULAR SPACES (9'x18') = 47
 2. HANDICAP SPACES (12'x18') = 1
5. OPEN SPACE DATA
 - a. OPEN SPACE REQUIRED (20%) = 1.053 ACRES+
 - b. OPEN SPACE PROVIDED - 1.9 ACRES+ (36%)
6. THE PROPERTY IS LOCATED ON TAX MAP 43, P/O PARCEL 636
7. THE CONTRACTOR SHALL NOTIFY THE HOWARD COUNTY CONSTRUCTION INSPECTION/SURVEY DIVISION 24 HOURS PRIOR TO COMMENCEMENT OF WORK AT 992-2418.
8. HANDICAPPED FACILITIES TO BE CONSTRUCTED IN ACCORDANCE WITH THE "DESIGN OF BARRIER FREE FACILITIES" AND THE "MARYLAND BUILDING CODE FOR THE HANDICAPPED AND AGED".
9. ALL PAVING AND STORM DRAIN CONSTRUCTION SHALL BE IN ACCORDANCE WITH THE HOWARD COUNTY ROAD CONSTRUCTION CODE AND STANDARD SPECIFICATIONS.
10. EXISTING UTILITIES SHOWN HEREON HAVE BEEN LOCATED FROM FIELD AND OFFICE INFORMATION. THE CONTRACTOR SHALL DETERMINE THE EXACT LOCATION OF EXISTING UTILITIES TO HIS OWN SATISFACTION BEFORE MAKING ANY CONNECTION THERETO OR EXCAVATING IN THE AREA THEREOF.
11. THE CONTRACTOR SHALL NOTIFY MISS UTILITY AT 559-0100 A MINIMUM OF THREE DAYS PRIOR TO BEGINNING ANY CONSTRUCTION SHOWN HEREON.
12. LIGHTING - NO PARKING LOT LIGHTING PROPOSED. SECURITY LIGHTING ATTACHED TO BUILDING, DIRECTION AND SHIELDING SHOWN THUS. ALL EXTERIOR LIGHTING SHALL BE DIRECTED/REFLECTED AWAY FROM ADJACENT RESIDENTIALLY ZONED PROPERTIES AND PUBLIC RIGHT-OF-WAYS.
13. NO CARS, TRUCKS OR SERVICE VEHICLES OWNED BY THE MARYLAND FRESH TOMATO COMPANY WILL BE STORED ON-SITE.
14. ANY CHANGES IN USE AND/OR INCREASED NUMBER OF EMPLOYEES ONSITE WILL REQUIRE APPROVAL BY THE OFFICE OF PLANNING AND ZONING.

LEGEND

- EXISTING CONTOUR (2' INTERVAL)
- PROPOSED CONTOUR (2' INTERVAL)
- SPOT ELEVATION
- DRAINAGE FLOW
- RETAINING WALL
- EX. WOODS TO BE SAVED
- STRAM BALE DIKE (S.B.D.)
- SILT FENCE (S.F.)
- STABILIZED CONSTRUCTION ENTRANCE (S.C.E.)
- PERIMETER DIKE (P.D.)

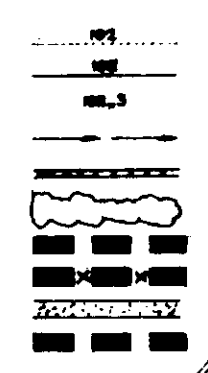

BUILDING PROFILE
NOT TO SCALE

5-3-83
LAWM

PLANT LIST				
NO.	NAME (SPECIES)	HEIGHT	CALIPER	COND.
44	SUGAR MAPLE (ACER SACCHARUM)	10'-12'	2 1/2"	B&B

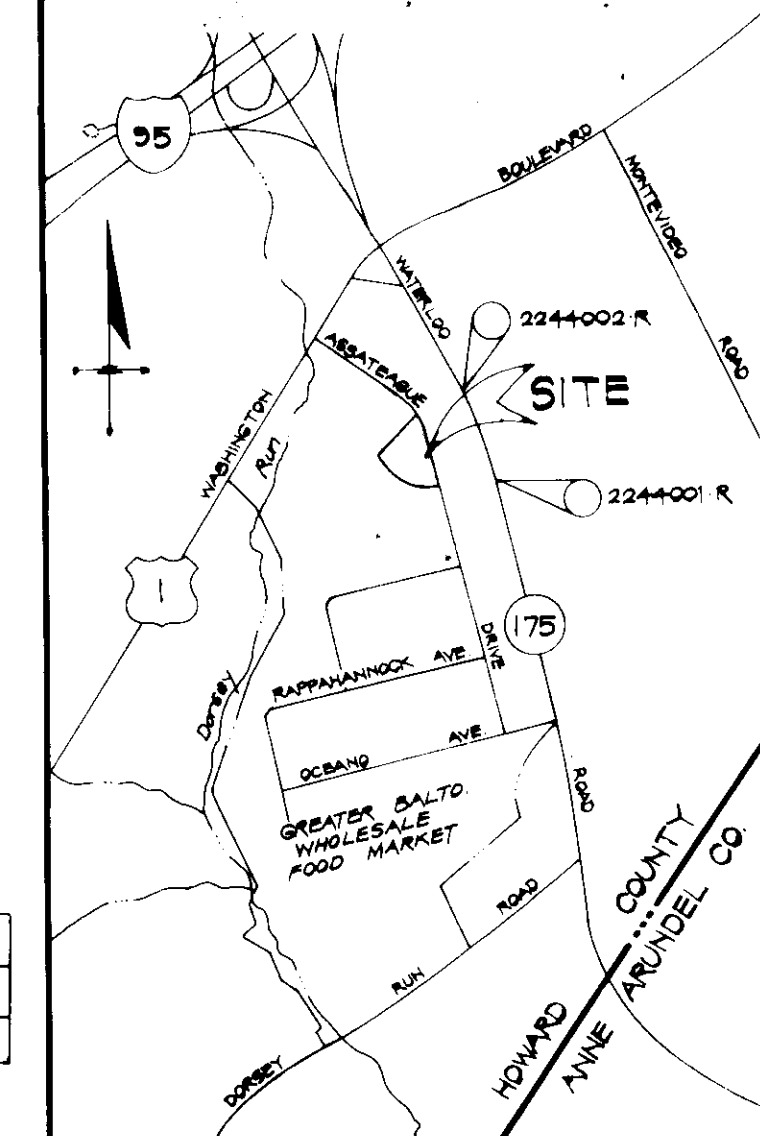

VICINITY MAP
SCALE: 1" = 2000'

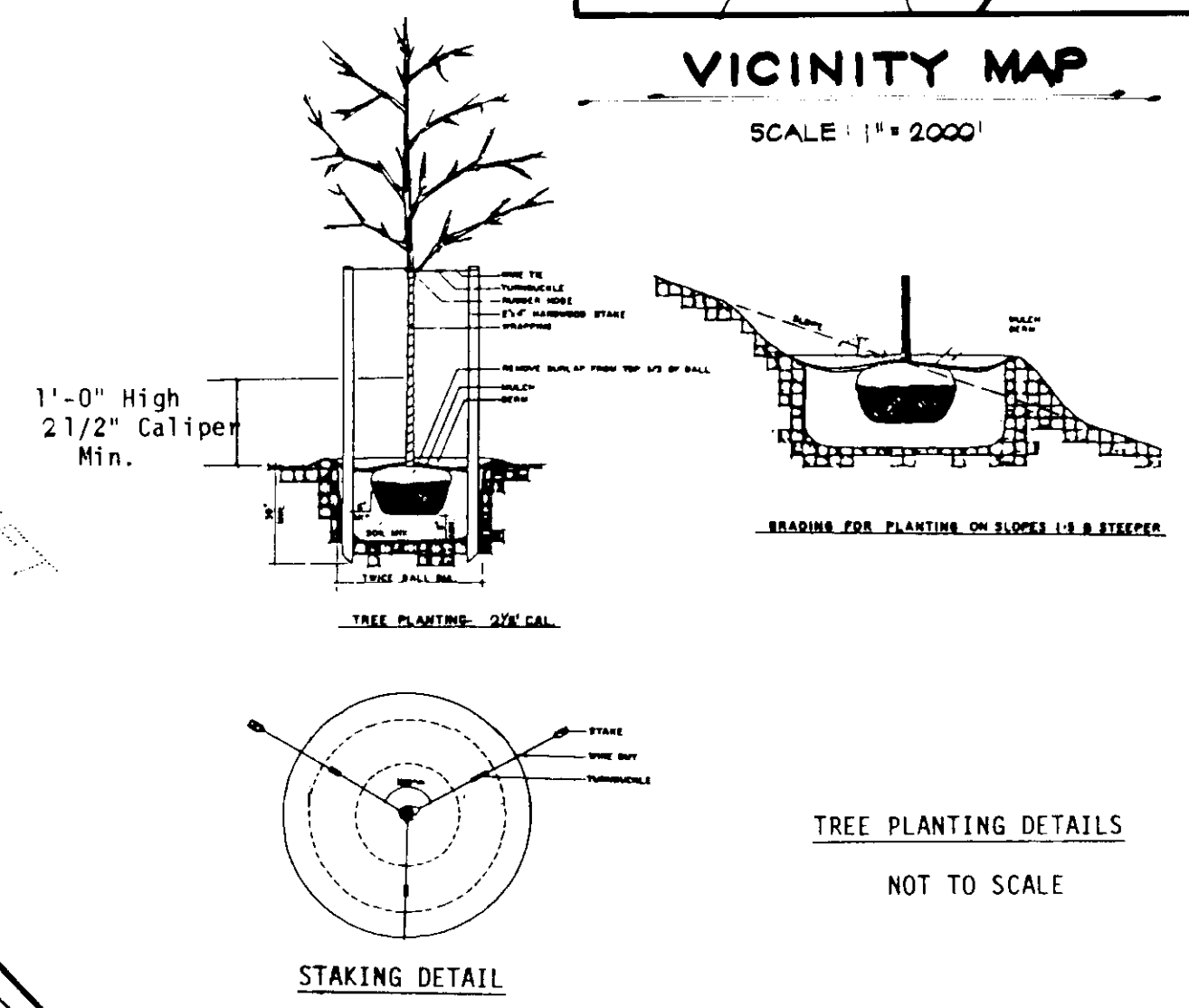

TREE PLANTING DETAILS
NOT TO SCALE

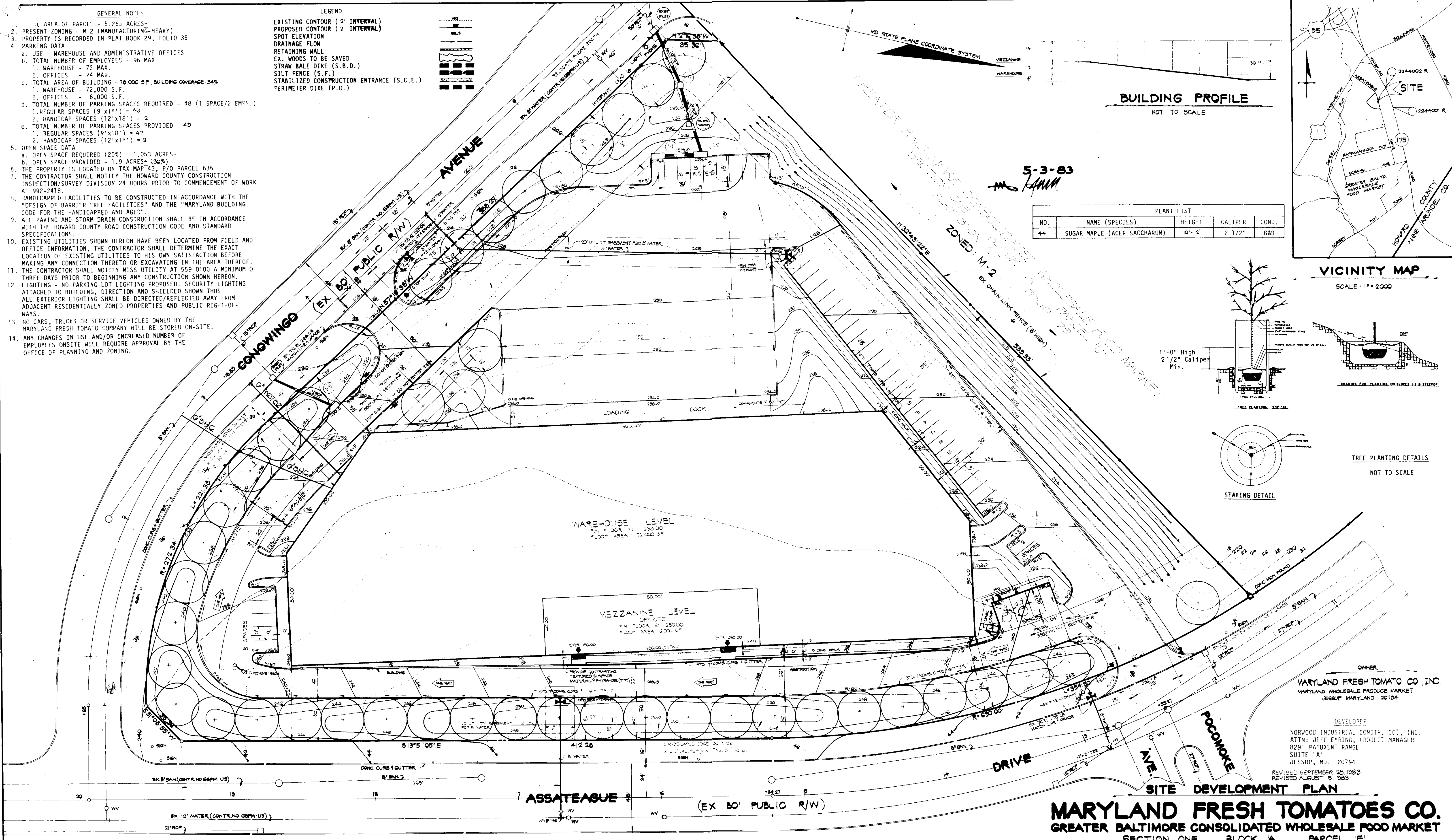

SITE PLAN
SCALE: 1" = 30'

MARYLAND FRESH TOMATOES CO.
GREATER BALTIMORE CONSOLIDATED WHOLESALE FOOD MARKET
 SECTION ONE BLOCK 'A' PARCEL 'E'
 6th ELECTION DISTRICT TAX MAP 43 P/O PARCEL 636 HOWARD COUNTY, MARYLAND
 SCALE: AS SHOWN SHEET 1 OF 3 MAY 10, 1983

OWNER
MARYLAND FRESH TOMATO CO., INC.
 MARYLAND WHOLESALE PRODUCE MARKET
 JESSUP, MARYLAND 20724

DEVELOPER
 NORWOOD INDUSTRIAL CONST. CO., INC.
 ATTN: JEFF EYRING, PROJECT MANAGER
 8291 PATUXENT RANGE
 SUITE 'A'
 JESSUP, MD. 20794
 REVISED SEPTEMBER 28, 1983
 REVISED AUGUST 15, 1983

PREPARED BY:
FISHER, COLLINS AND CARTER, INC.
 CIVIL ENGINEERS AND LAND SURVEYORS
 SUITE 203 - 8386 COURT AVENUE
 ELLICOTT CITY, MARYLAND 21043
 (301) 461 2855

ENGINEER'S CERTIFICATE
 I HEREBY CERTIFY THAT THIS PLAN FOR EROSION AND SEDIMENT CONTROL REPRESENTS A PRACTICAL AND WORKABLE PLAN BASED ON MY PERSONAL KNOWLEDGE OF THE SITE CONDITIONS AND THAT IT WAS PREPARED IN ACCORDANCE WITH THE REQUIREMENTS OF THE HOWARD SOIL CONSERVATION DISTRICT.

 SIGNATURE OF ENGINEER

 DATE

DEVELOPER'S CERTIFICATE
 "I/WE CERTIFY THAT ALL DEVELOPMENT AND CONSTRUCTION WILL BE DONE ACCORDING TO THIS PLAN OF DEVELOPMENT AND PLAN FOR EROSION AND SEDIMENT CONTROL AND THAT ALL RESPONSIBLE PERSONNEL INVOLVED IN THE CONSTRUCTION PROJECT WILL HAVE A CERTIFICATE OF ATTENDANCE AT A DEPARTMENT OF NATURAL RESOURCES APPROVED TRAINING PROGRAM FOR THE CONTROL OF SEDIMENT AND EROSION BEFORE BEGINNING THE PROJECT. I ALSO AUTHORIZE PERIODIC ON-SITE INSPECTION BY THE HOWARD SOIL CONSERVATION DISTRICT OR THEIR AUTHORIZED AGENTS, AS ARE DEEMED NECESSARY."

 SIGNATURE OF DEVELOPER

 DATE

REVIEWED FOR HOWARD COUNTY SOIL CONSERVATION DISTRICT AND MEETS TECHNICAL REQUIREMENTS.

 U.S. SOIL CONSERVATION SERVICE DATE

THIS DEVELOPMENT IS APPROVED FOR EROSION AND SEDIMENT CONTROL BY THE HOWARD SOIL CONSERVATION DISTRICT.

APPROVED:

 DISTRICT COORDINATOR DATE

APPROVED: DEPARTMENT OF PUBLIC WORKS, FOR PUBLIC WATER AND SEWER AND STORM DRAINAGE SYSTEMS AND ROADS.

 DIRECTOR, PUBLIC WORKS DATE

 CHIEF, BUREAU OF ENGINEERING DATE

APPROVED: OFFICE OF PLANNING AND ZONING

 PLANNING DIRECTOR DATE

 CHIEF, DIVISION OF LAND DEVELOPMENT AND ZONING ADMINISTRATION DATE

APPROVED: HOWARD COUNTY HEALTH DEPARTMENT, FOR PUBLIC WATER AND SEWERAGE SYSTEMS.

 HEALTH OFFICER DATE

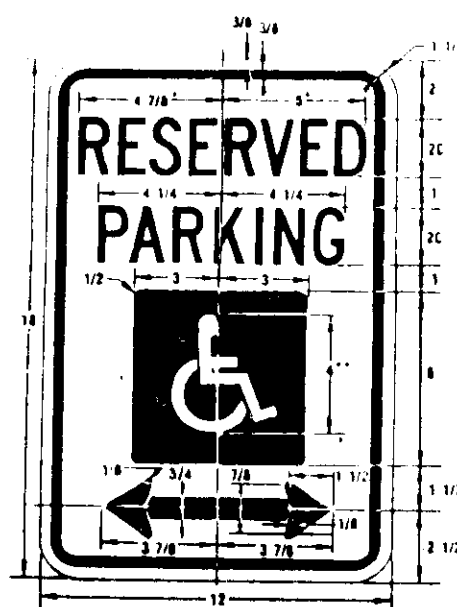
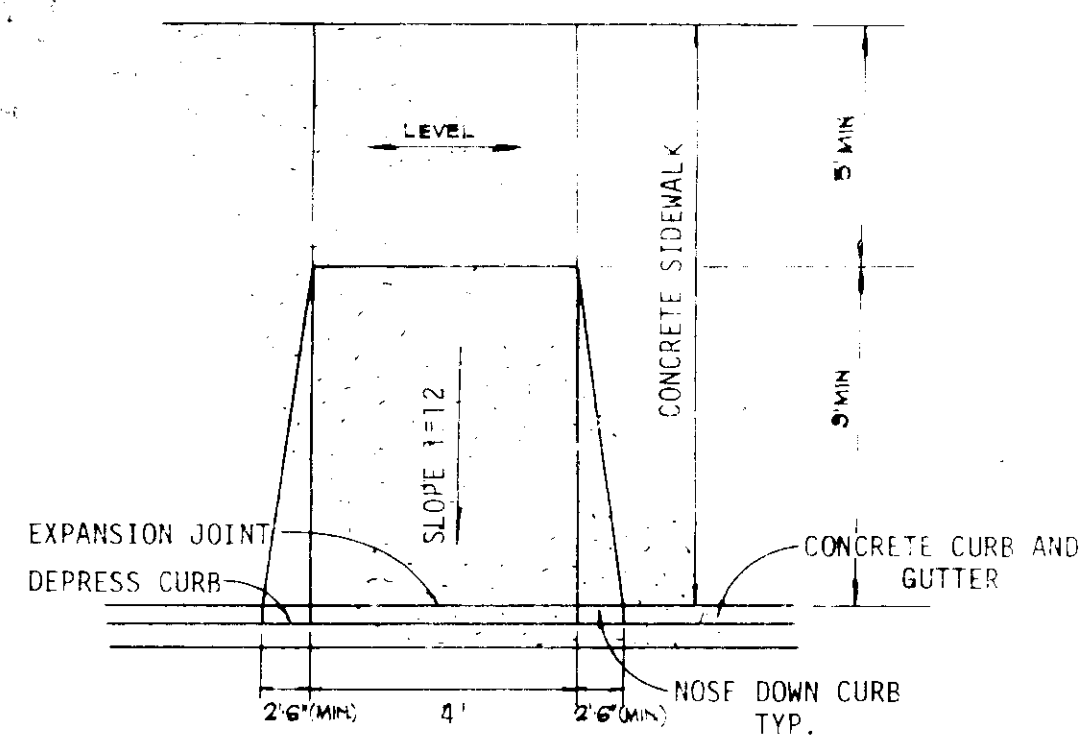

REDUCE SPACING WITH SEE PAGE 10 FOR SYMBOL DESIGN

CURB LIGHT AND BORDER-LINES WHITE SYMBOL OR BLUE BACKGROUND BACKGROUND - WHITE

HANDICAPPED SIGN DETAIL NOT TO SCALE

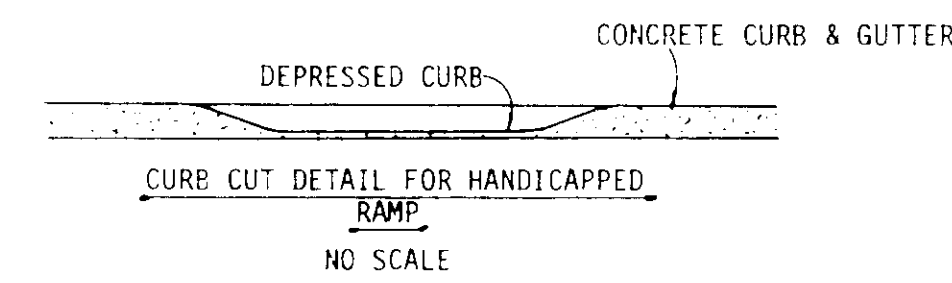

NOTE: EXPANSION JOINT TO BE PROVIDED WHEREVER SIDEWALKS ABUTS CURB

NOTE: SCORE @ 5' INTERVALS

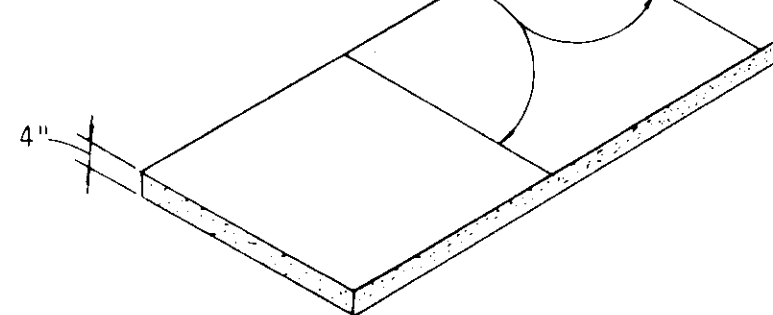

TYPICAL SIDEWALK DETAIL NO SCALE

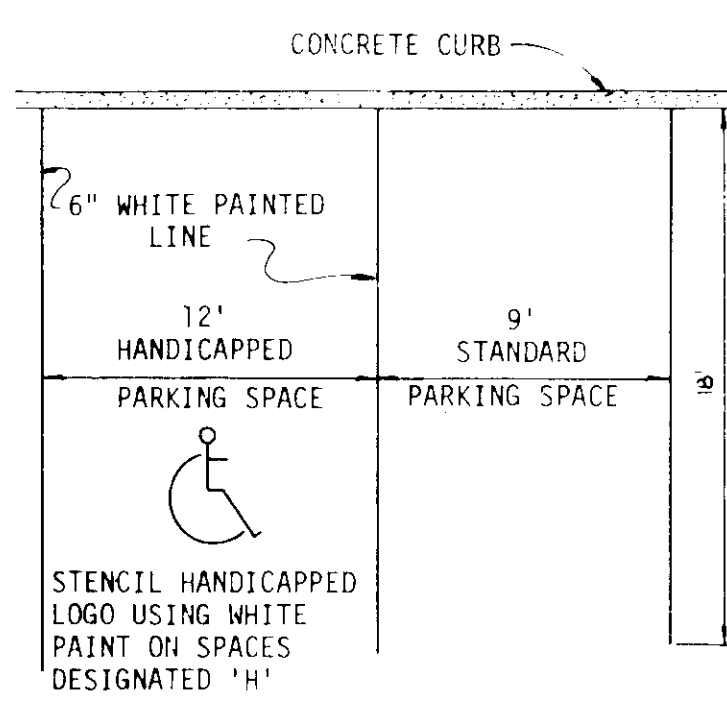

TYPICAL PARKING DETAIL NO SCALE

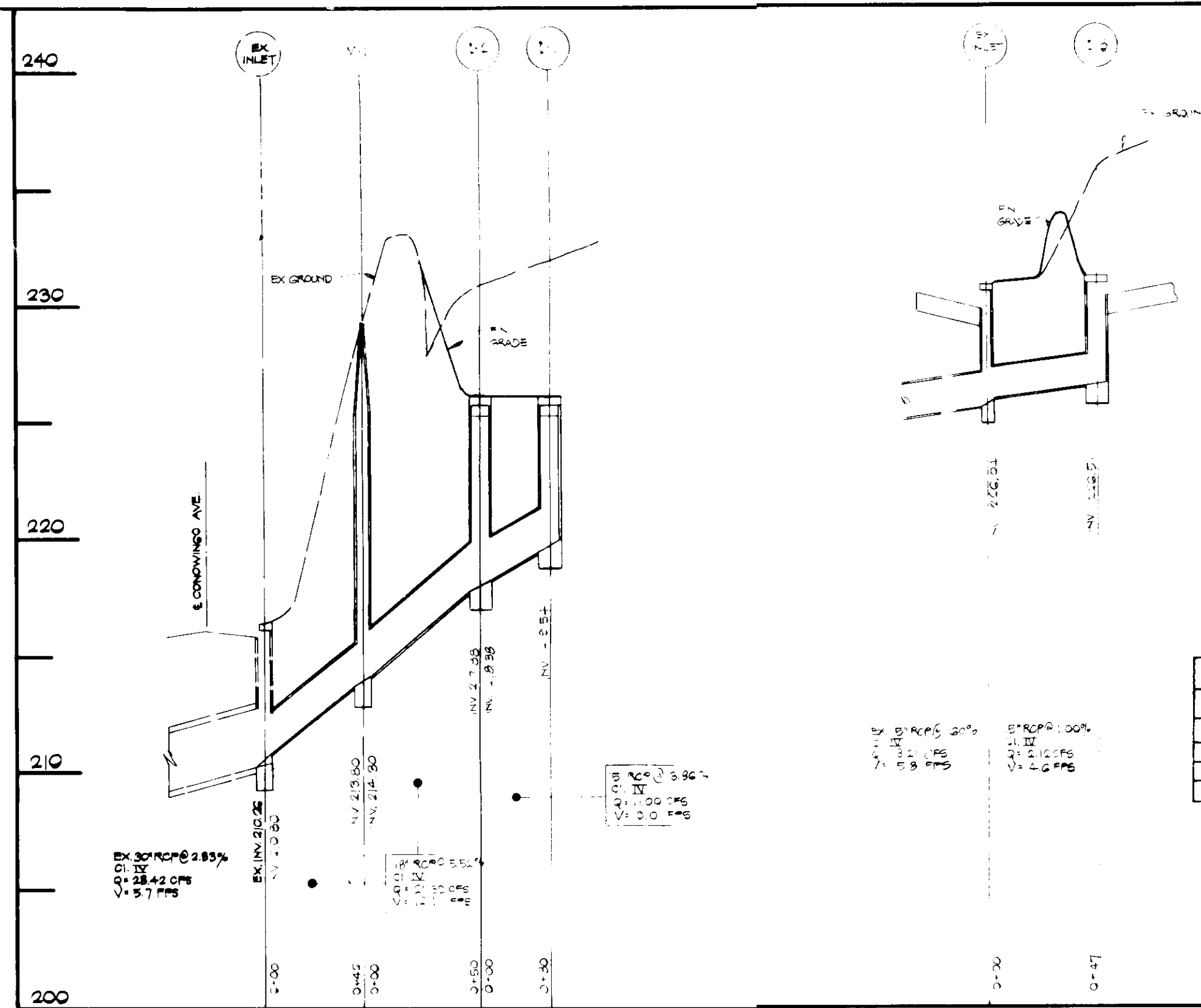

STRUCTURE SCHEDULE					
NO.	TYPE	INV. IN	INV. OUT	TOP ELEV.	REMARKS
I-1	A-10	--	219.54	226.23	SD-4.02*
I-2	A-10	218.38	217.88	226.23	SD-4.02*
I-3	A-10	--	226.51	231.39	SD-4.02*
M-1	PRECAST	214.30	213.80	229.50	G-5.12-STANDARD

*SEE INLET DEPRESSION DETAIL SHEET 2 OF 3

5-3-83

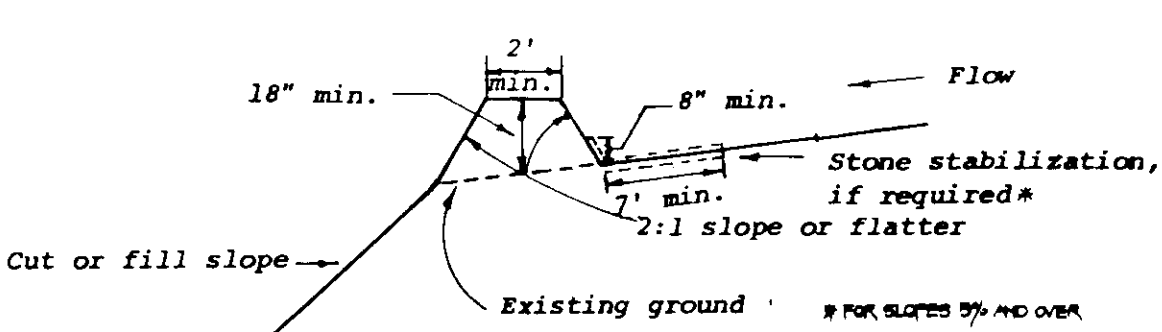

PERIMETER DIKE NOT TO SCALE



STRAW BALE DIKE NOT TO SCALE

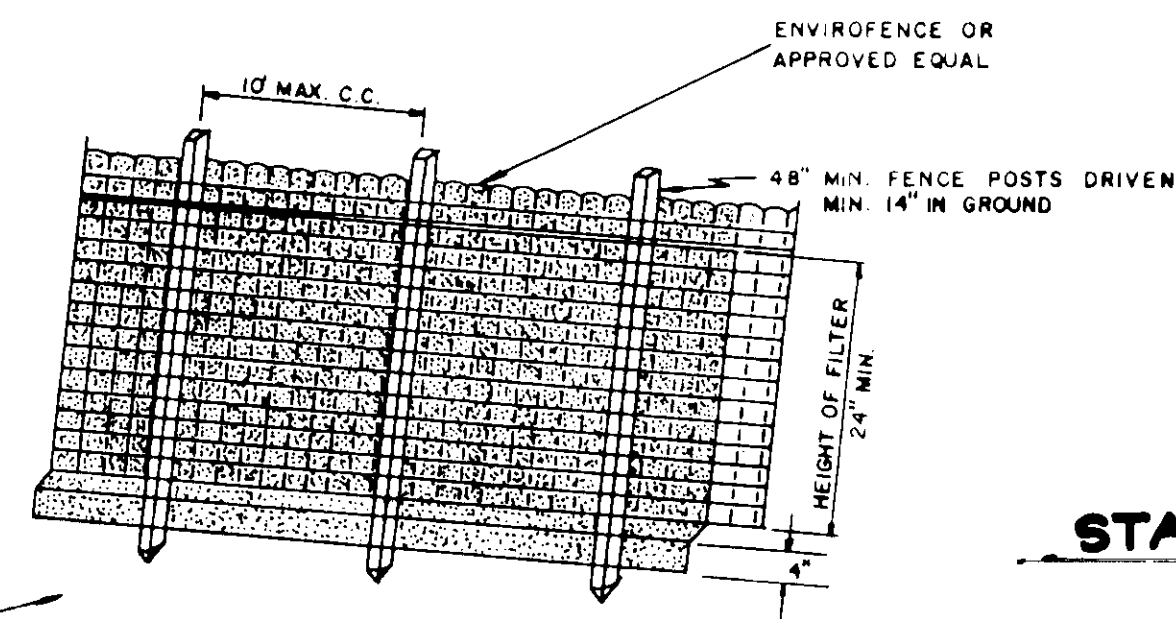

STABILIZED CONSTRUCTION ENTRANCE NOT TO SCALE

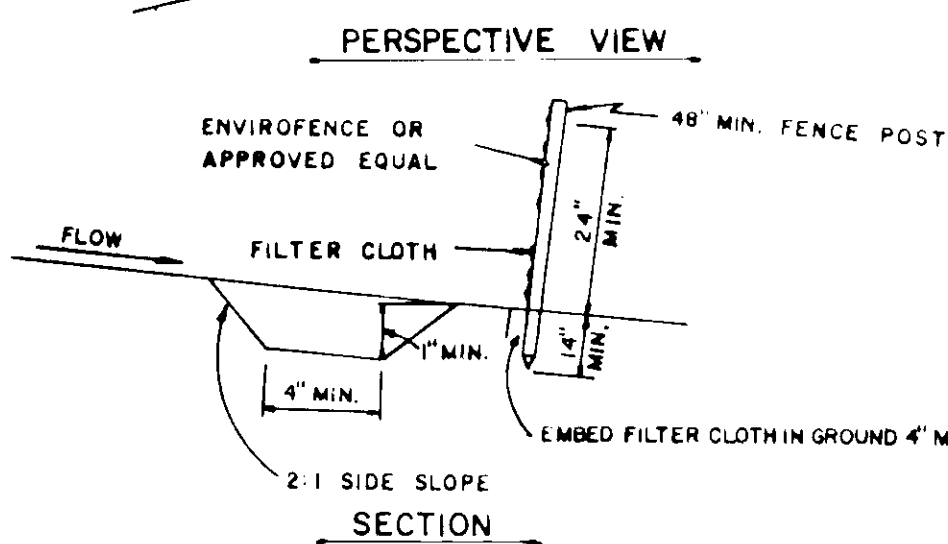

SILT FENCE DETAIL NOT TO SCALE

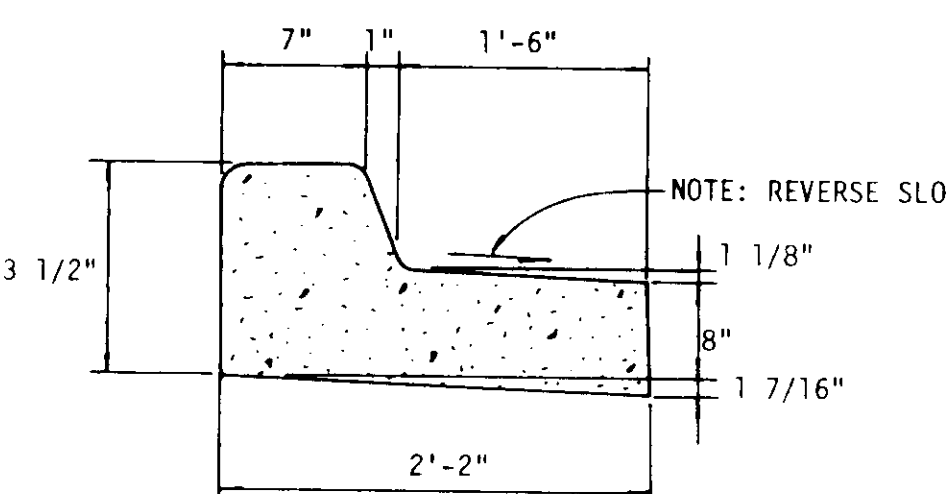

STANDARD 7" COMBINATION CURB & GUTTER NO SCALE

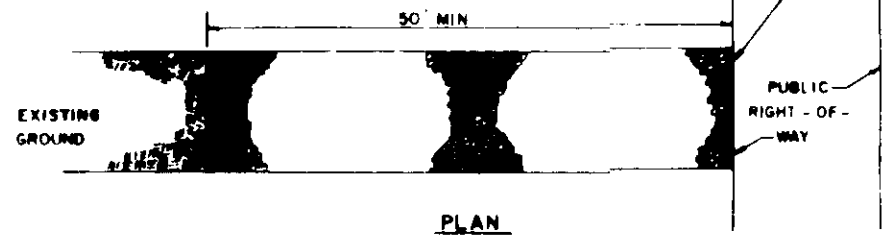
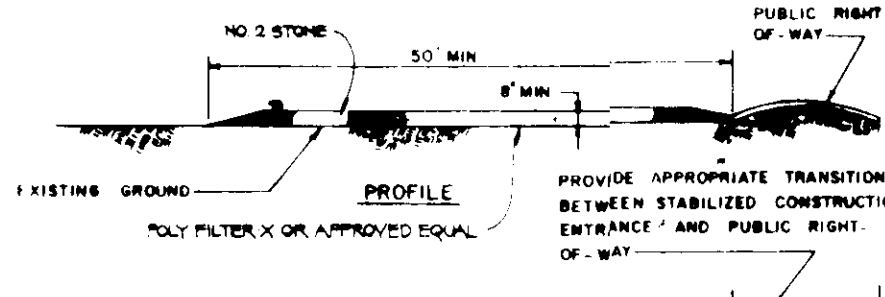

INLET PROTECTION DETAIL NOT TO SCALE

STORM DRAIN PROFILES

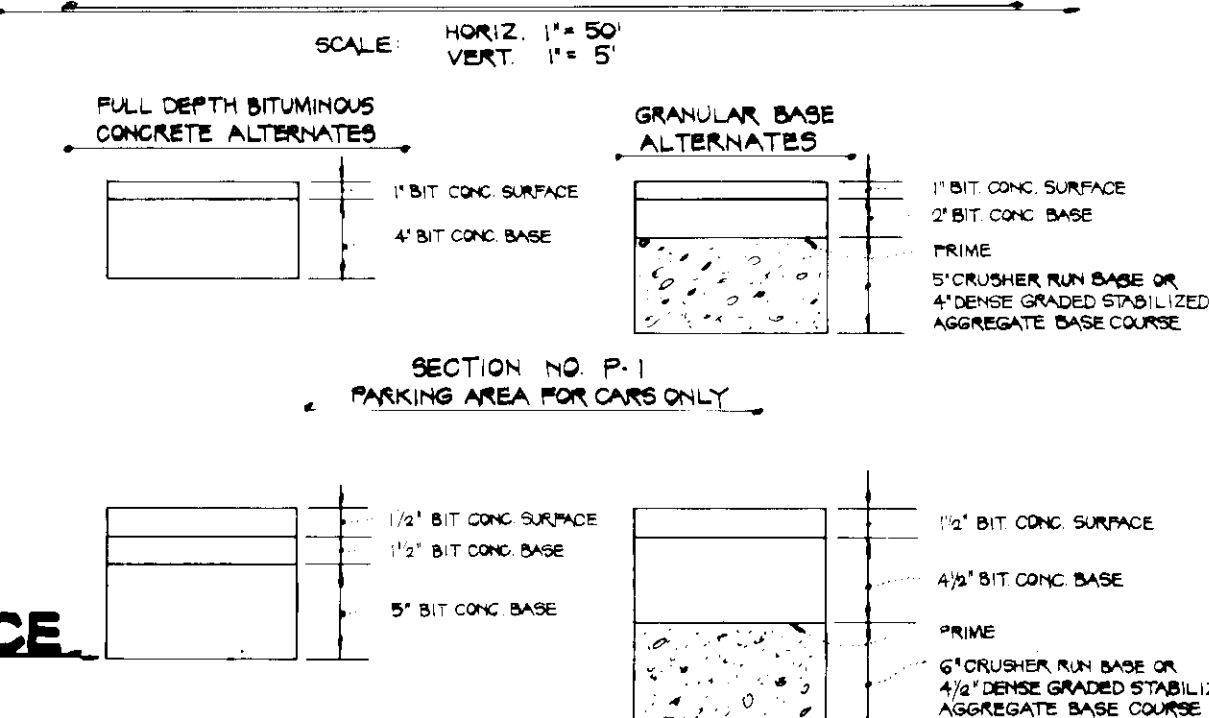

PAVING SECTION ALTERNATES

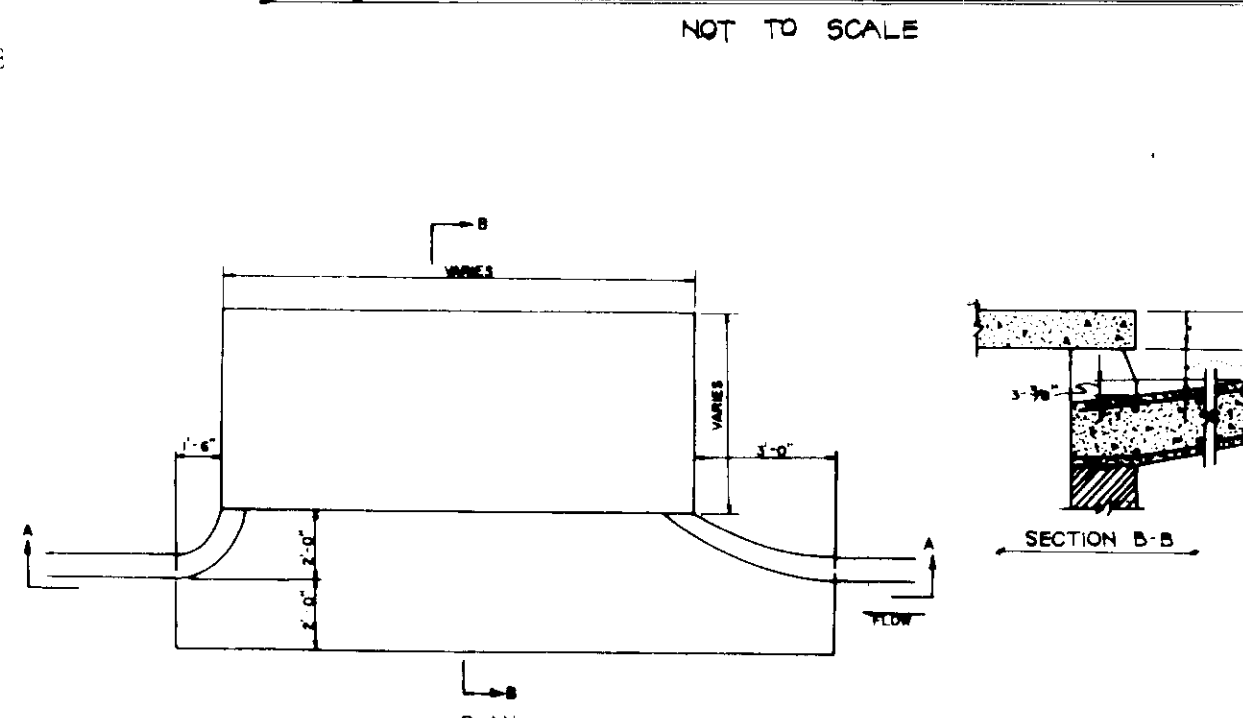

INLET DEPRESSION @ I-1 AND I-2 NOT TO SCALE

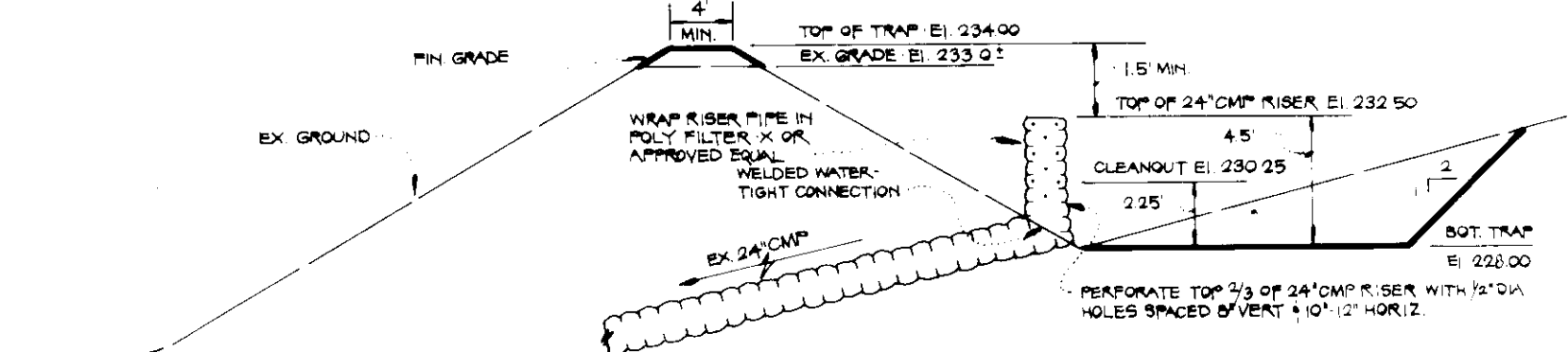

SEDIMENT TRAP NO. 1 NOT TO SCALE

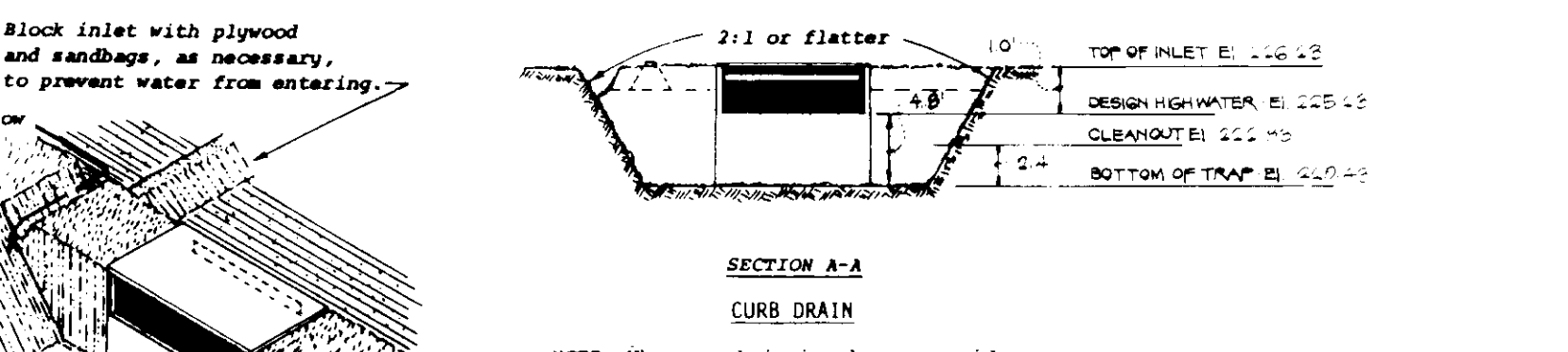

SEDIMENT TRAP NO. 2 @ I-1 NOT TO SCALE

STORM DRAIN PROFILES AND DETAILS

MARYLAND FRESH TOMATOES CO.
 GREATER BALTIMORE CONSOLIDATED WHOLESALE FOOD MARKET

SECTION ONE BLOCK 'A' PARCEL 'E'
 6th ELECTION DISTRICT TAX MAP 43 NO PARCEL 636 HOWARD COUNTY, MARYLAND
 SCALE: AS SHOWN SHEET 2 OF 3 MAY 19 1983

PREPARED BY
FISHER, COLLINS AND CARTER, INC.
 CIVIL ENGINEERS AND LAND SURVEYORS
 SUITE 203 - 8388 COURT AVENUE
 ELLICOTT CITY, MARYLAND 21043
 (301) 461-2855

ENGINEER'S CERTIFICATE
 I HEREBY CERTIFY THAT THIS PLAN FOR EROSION AND SEDIMENT CONTROL REPRESENTS A PRACTICAL AND WORKABLE PLAN BASED ON MY PERSONAL KNOWLEDGE OF THE SITE CONDITIONS AND THAT IT WAS PREPARED IN ACCORDANCE WITH THE REQUIREMENTS OF THE HOWARD SOIL CONSERVATION DISTRICT.
 SIGNATURE OF ENGINEER: [Signature] DATE: 11/12

DEVELOPER'S CERTIFICATE
 "I/WE CERTIFY THAT ALL DEVELOPMENT AND CONSTRUCTION WILL BE DONE ACCORDING TO THIS PLAN OF DEVELOPMENT AND PLAN FOR EROSION AND SEDIMENT CONTROL AND THAT ALL RESPONSIBLE PERSONNEL INVOLVED IN THE CONSTRUCTION PROJECT WILL HAVE A CERTIFICATE OF ATTENDANCE AT A DEPARTMENT OF NATURAL RESOURCES APPROVED TRAINING PROGRAM FOR THE CONTROL OF SEDIMENT AND EROSION BEFORE BEGINNING THE PROJECT. I ALSO AUTHORIZE PERIODIC ON-SITE INSPECTION BY THE HOWARD SOIL CONSERVATION DISTRICT OR THEIR AUTHORIZED AGENTS, AS ARE DEEMED NECESSARY."
 SIGNATURE OF DEVELOPER: [Signature] DATE: 11/12

REVIEWED FOR HOWARD COUNTY SOIL CONSERVATION DISTRICT AND MEETS TECHNICAL REQUIREMENTS.
 U.S. SOIL CONSERVATION SERVICE DATE: 11-20-83
 THIS DEVELOPMENT IS APPROVED FOR EROSION AND SEDIMENT CONTROL BY THE HOWARD SOIL CONSERVATION DISTRICT.
 APPROVED: [Signature] DATE: 11-20-83
 DISTRICT COORDINATOR HOWARD SOIL CONSERVATION DISTRICT

APPROVED: DEPARTMENT OF PUBLIC WORKS, FOR PUBLIC WATER AND SEWER AND STORM DRAINAGE SYSTEMS AND ROADS.
 DIRECTOR, PUBLIC WORKS DATE: 10-24-83
 CHIEF, BUREAU OF ENGINEERING

APPROVED: OFFICE OF PLANNING AND ZONING
 PLANNING DIRECTOR DATE: 10-24-83
 CHIEF, DIVISION OF LAND DEVELOPMENT AND ZONING ADMINISTRATION
 APPROVED: HOWARD COUNTY HEALTH DEPARTMENT, FOR PUBLIC WATER AND SEWERAGE SYSTEMS.
 HEALTH OFFICER DATE: 10-24-83

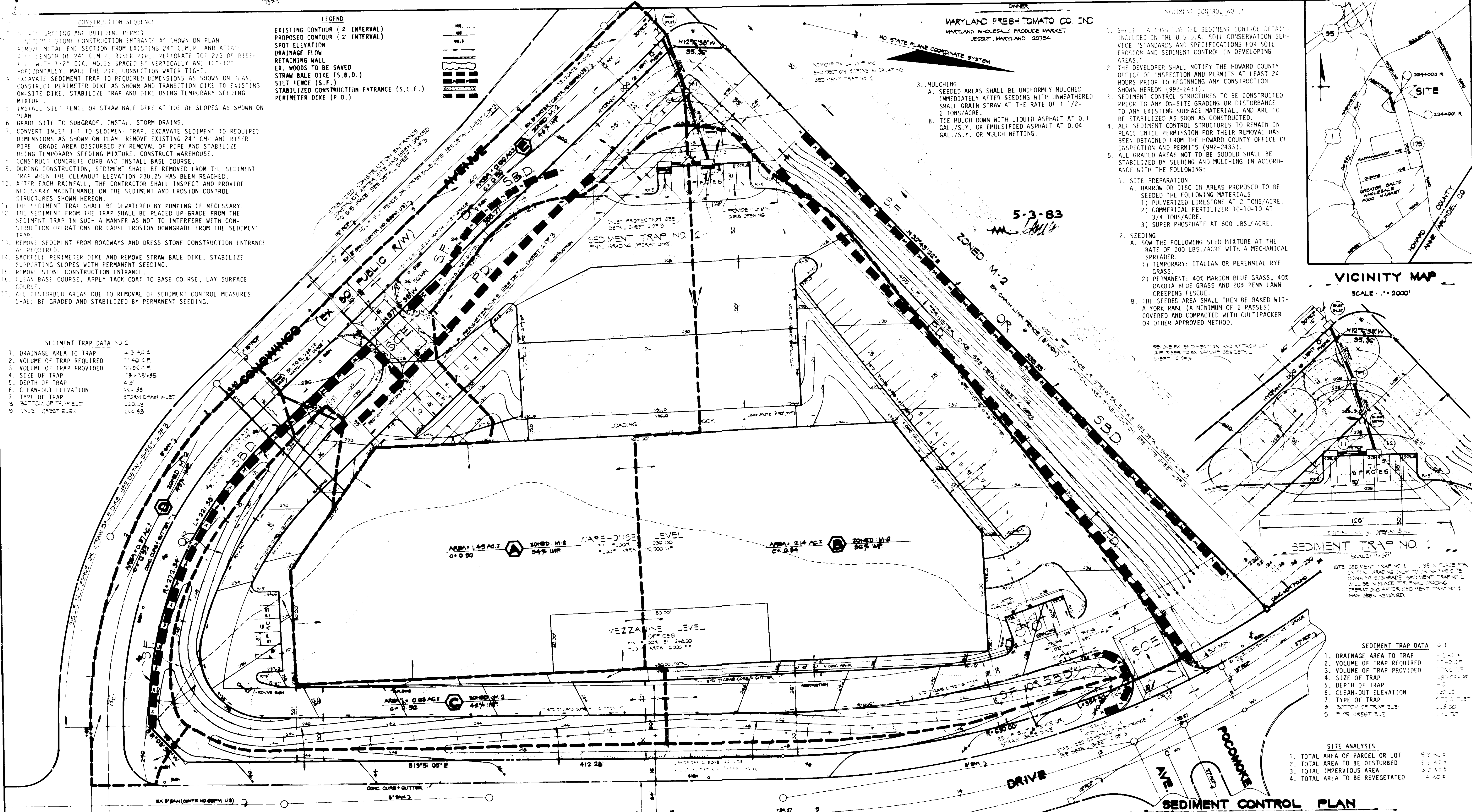

- CONSTRUCTION SEQUENCE**
1. EXISTING STONE CONSTRUCTION ENTRANCE AS SHOWN ON PLAN.
 2. REMOVE METAL END SECTION FROM EXISTING 24" C.M.P. AND ATTACH WITH LENGTH OF 24" C.M.P. RISER PIPE. PERFORATE TOP 2/3 OF RISER PIPE WITH 1/2" DIA. HOLES SPACED 8" VERTICALLY AND 12"-12" HORIZONTALLY. MAKE THE PIPE CONNECTION WATER TIGHT.
 3. EXCAVATE SEDIMENT TRAP TO REQUIRED DIMENSIONS AS SHOWN ON PLAN.
 4. CONSTRUCT PERIMETER DIKE AS SHOWN AND TRANSITION DIKE TO EXISTING ON-SITE DIKE. STABILIZE TRAP AND DIKE USING TEMPORARY SEEDING MIXTURE.
 5. INSTALL SILT FENCE OR STRAW BALE DIKE AT TOE OF SLOPES AS SHOWN ON PLAN.
 6. GRADE SITE TO SUBGRADE. INSTALL STORM DRAINS.
 7. CONVERT INLET 1-1 TO SEDIMENT TRAP. EXCAVATE SEDIMENT TO REQUIRED DIMENSIONS AS SHOWN ON PLAN. REMOVE EXISTING 24" C.M.P. AND RISER PIPE. GRADE AREA DISTURBED BY REMOVAL OF PIPE AND STABILIZE USING TEMPORARY SEEDING MIXTURE. CONSTRUCT WAREHOUSE.
 8. CONSTRUCT CONCRETE CURB AND INSTALL BASE COURSE.
 9. DURING CONSTRUCTION, SEDIMENT SHALL BE REMOVED FROM THE SEDIMENT TRAP WHEN THE CLEANOUT ELEVATION 230.25 HAS BEEN REACHED.
 10. AFTER EACH RAINFALL, THE CONTRACTOR SHALL INSPECT AND PROVIDE NECESSARY MAINTENANCE ON THE SEDIMENT AND EROSION CONTROL STRUCTURES SHOWN HEREON.
 11. THE SEDIMENT TRAP SHALL BE DEWATERED BY PUMPING IF NECESSARY.
 12. THE SEDIMENT FROM THE TRAP SHALL BE PLACED UP-GRADE FROM THE SEDIMENT TRAP IN SUCH A MANNER AS NOT TO INTERFERE WITH CONSTRUCTION OPERATIONS OR CAUSE EROSION DOWNGRADE FROM THE SEDIMENT TRAP.
 13. REMOVE SEDIMENT FROM ROADWAYS AND DRESS STONE CONSTRUCTION ENTRANCE AS REQUIRED.
 14. BACKFILL PERIMETER DIKE AND REMOVE STRAW BALE DIKE. STABILIZE SUPPORTING SLOPES WITH PERMANENT SEEDING.
 15. REMOVE STONE CONSTRUCTION ENTRANCE.
 16. CLEAN BASE COURSE, APPLY TACK COAT TO BASE COURSE, LAY SURFACE COURSE.
 17. ALL DISTURBED AREAS DUE TO REMOVAL OF SEDIMENT CONTROL MEASURES SHALL BE GRADED AND STABILIZED BY PERMANENT SEEDING.

- LEGEND**
- EXISTING CONTOUR (2 INTERVAL)
 - PROPOSED CONTOUR (2 INTERVAL)
 - SPOT ELEVATION
 - DRAINAGE FLOW
 - RETAINING WALL
 - EX. WOODS TO BE SAVED
 - STRAW BALE DIKE (S.B.D.)
 - SILT FENCE (S.F.)
 - STABILIZED CONSTRUCTION ENTRANCE (S.C.E.)
 - PERIMETER DIKE (P.D.)

- SEDIMENT TRAP DATA**
1. DRAINAGE AREA TO TRAP
 2. VOLUME OF TRAP REQUIRED
 3. VOLUME OF TRAP PROVIDED
 4. SIZE OF TRAP
 5. DEPTH OF TRAP
 6. CLEAN-OUT ELEVATION
 7. TYPE OF TRAP
 8. BOTTOM OF TRAP ELEV.
 9. PIPE CREST ELEV.

MARYLAND FRESH TOMATO CO., INC.
 MARYLAND WHOLESALE PRODUCE MARKET
 JESSUP, MARYLAND 20734

- SEDIMENT CONTROL NOTES**
1. SPECIFIC ATTENTION FOR THE SEDIMENT CONTROL DETAILS INCLUDED IN THE U.S.D.A. SOIL CONSERVATION SERVICE STANDARDS AND SPECIFICATIONS FOR SOIL EROSION AND SEDIMENT CONTROL IN DEVELOPING AREAS.
 2. THE DEVELOPER SHALL NOTIFY THE HOWARD COUNTY OFFICE OF INSPECTION AND PERMITS AT LEAST 24 HOURS PRIOR TO BEGINNING ANY CONSTRUCTION SHOWN HEREON (992-2433).
 3. SEDIMENT CONTROL STRUCTURES TO BE CONSTRUCTED PRIOR TO ANY ON-SITE GRADING OR DISTURBANCE TO ANY EXISTING SURFACE MATERIAL, AND ARE TO BE STABILIZED AS SOON AS CONSTRUCTED.
 4. ALL SEDIMENT CONTROL STRUCTURES TO REMAIN IN PLACE UNTIL PERMITS FOR THEIR REMOVAL HAS BEEN OBTAINED FROM THE HOWARD COUNTY OFFICE OF INSPECTION AND PERMITS (992-2433).
 5. ALL GRADED AREAS NOT TO BE SODDED SHALL BE STABILIZED BY SEEDING AND MULCHING IN ACCORDANCE WITH THE FOLLOWING:
 1. SITE PREPARATION
 - A. HARROW OR DISC IN AREAS PROPOSED TO BE SEEDING THE FOLLOWING MATERIALS:
 - 1) PULVERIZED LIMESTONE AT 2 TONS/ACRE.
 - 2) COMMERCIAL FERTILIZER 10-10-10 AT 3/4 TONS/ACRE.
 - 3) SUPER PHOSPHATE AT 600 LBS./ACRE.
 2. SEEDING
 - A. SOW THE FOLLOWING SEED MIXTURE AT THE RATE OF 200 LBS./ACRE WITH A MECHANICAL SPREADER:
 - 1) TEMPORARY: ITALIAN OR PERENNIAL RYE GRASS.
 - 2) PERMANENT: 40% MARION BLUE GRASS, 40% DAKOTA BLUE GRASS AND 20% PENN LAWN CREEPING FESCUE.
 - B. THE SEEDING AREA SHALL THEN BE RAKED WITH A YORK RAKE (A MINIMUM OF 2 PASSES) COVERED AND COMPACTED WITH CULTIPACKER OR OTHER APPROVED METHOD.

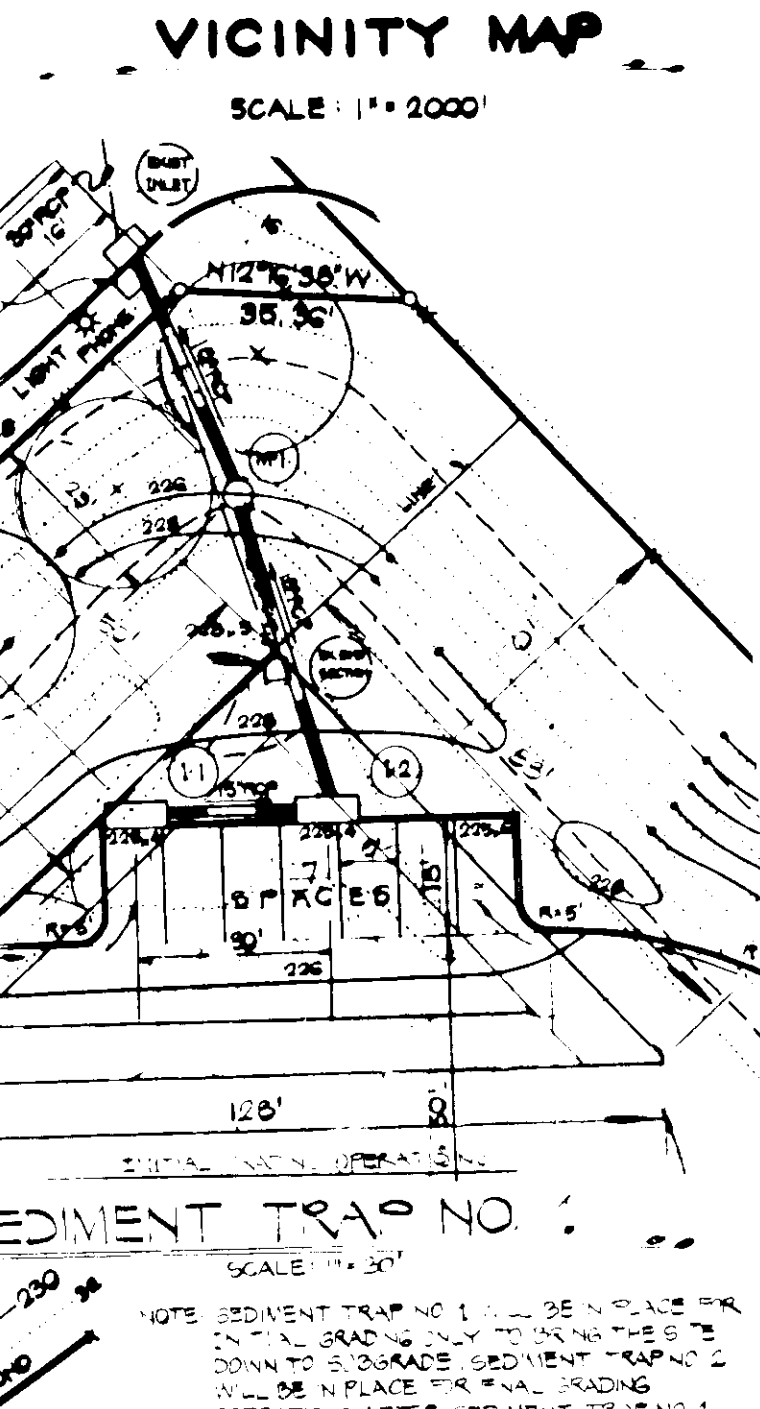
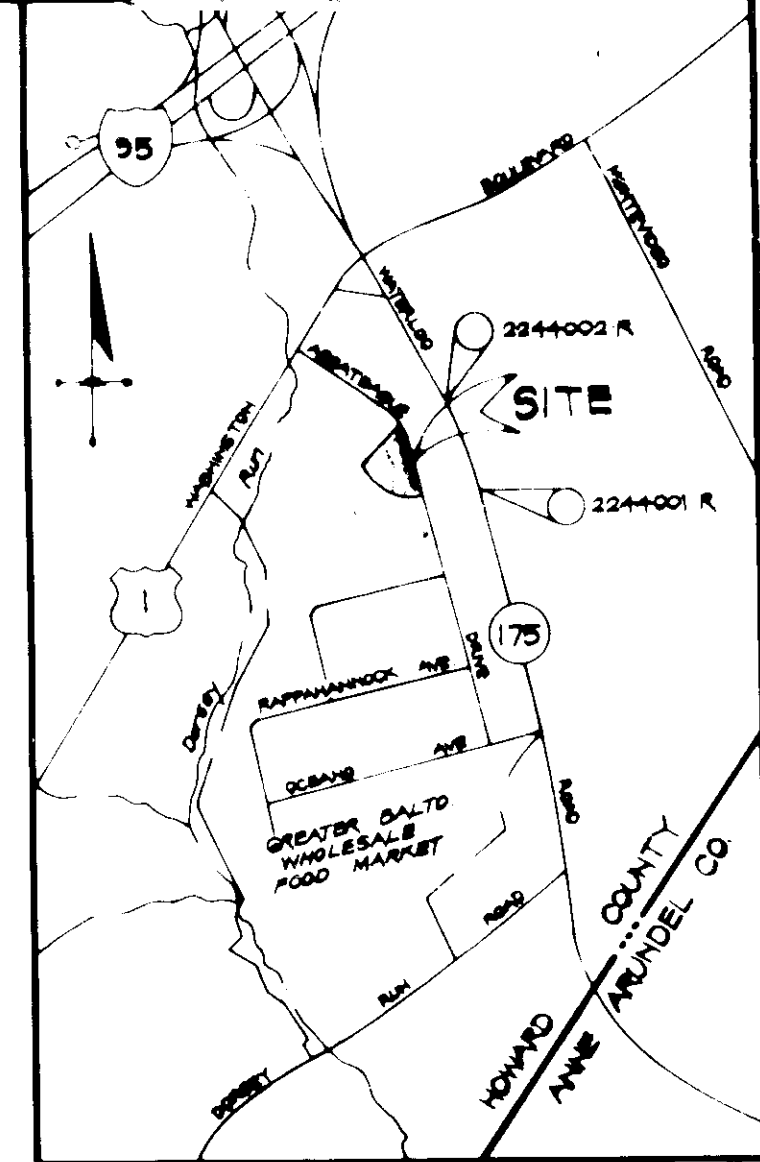

- SEDIMENT TRAP DATA**
1. DRAINAGE AREA TO TRAP
 2. VOLUME OF TRAP REQUIRED
 3. VOLUME OF TRAP PROVIDED
 4. SIZE OF TRAP
 5. DEPTH OF TRAP
 6. CLEAN-OUT ELEVATION
 7. TYPE OF TRAP
 8. BOTTOM OF TRAP ELEV.
 9. PIPE CREST ELEV.
- SITE ANALYSIS**
1. TOTAL AREA OF PARCEL OR LOT
 2. TOTAL AREA TO BE DISTURBED
 3. TOTAL IMPERVIOUS AREA
 4. TOTAL AREA TO BE REVEGETATED

SEDIMENT CONTROL PLAN
MARYLAND FRESH TOMATOES CO.
GREATER BALTIMORE CONSOLIDATED WHOLESALE FOOD MARKET
 SECTION ONE BLOCK 'A' PARCEL 'E'
 6TH ELECTION DISTRICT TAX MAP 43 70 PARCEL 636 HOWARD COUNTY, MARYLAND
 SCALE: AS SHOWN SHEET 3 OF 3 MAY 15, 1983

PREPARED BY
FISHER, COLLINS AND CARTER, INC.
 CIVIL ENGINEERS AND LAND SURVEYORS
 SUITE 203 - 8388 COURT AVENUE
 ELLICOTT CITY, MARYLAND 21043
 (301) 461-2855

ENGINEER'S CERTIFICATE
 I HEREBY CERTIFY THAT THIS PLAN FOR EROSION AND SEDIMENT CONTROL REPRESENTS A PRACTICAL AND WORKABLE PLAN BASED ON MY PERSONAL KNOWLEDGE OF THE SITE CONDITIONS AND THAT IT WAS PREPARED IN ACCORDANCE WITH THE REQUIREMENTS OF THE HOWARD SOIL CONSERVATION DISTRICT.

DATE: 1/18/83

DEVELOPER'S CERTIFICATE
 "I/WE CERTIFY THAT ALL DEVELOPMENT AND CONSTRUCTION WILL BE DONE ACCORDING TO THIS PLAN OF DEVELOPMENT AND PLAN FOR EROSION AND SEDIMENT CONTROL AND THAT ALL RESPONSIBLE PERSONNEL INVOLVED IN THE CONSTRUCTION PROJECT WILL HAVE A CERTIFICATE OF ATTENDANCE AT A DEPARTMENT OF NATURAL RESOURCES APPROVED TRAINING PROGRAM FOR THE CONTROL OF SEDIMENT AND EROSION BEFORE BEGINNING THE PROJECT. I ALSO AUTHORIZE PERIODIC ON-SITE INSPECTION BY THE HOWARD SOIL CONSERVATION DISTRICT OR THEIR AUTHORIZED AGENTS, AS ARE DEEMED NECESSARY."

DATE: 1/18/83

REVIEWED FOR HOWARD COUNTY SOIL CONSERVATION DISTRICT AND MEETS TECHNICAL REQUIREMENTS.

U.S. SOIL CONSERVATION SERVICE DATE: 1-18-83

THIS DEVELOPMENT IS APPROVED FOR EROSION AND SEDIMENT CONTROL BY THE HOWARD SOIL CONSERVATION DISTRICT.

DISTRICT COORDINATOR DATE: 1-18-83

APPROVED: DEPARTMENT OF PUBLIC WORKS, FOR PUBLIC WATER AND SEWER AND STORM DRAINAGE SYSTEMS AND ROADS.

DIRECTOR, PUBLIC WORKS DATE: 1-18-83

CHIEF, BUREAU OF ENGINEERING DATE: 1-18-83

APPROVED: OFFICE OF PLANNING AND ZONING

PLANNING DIRECTOR DATE: 1-18-83

CHIEF, DIVISION OF LAND DEVELOPMENT AND ZONING ADMINISTRATION DATE: 1-18-83

APPROVED: HOWARD COUNTY HEALTH DEPARTMENT, FOR PUBLIC WATER AND SEWERAGE SYSTEMS.

HEALTH OFFICER DATE: 1-18-83