

DRIVEWAY ENTRANCE ABUTTING MODIFIED COMB. C.+G.
NO SCALE

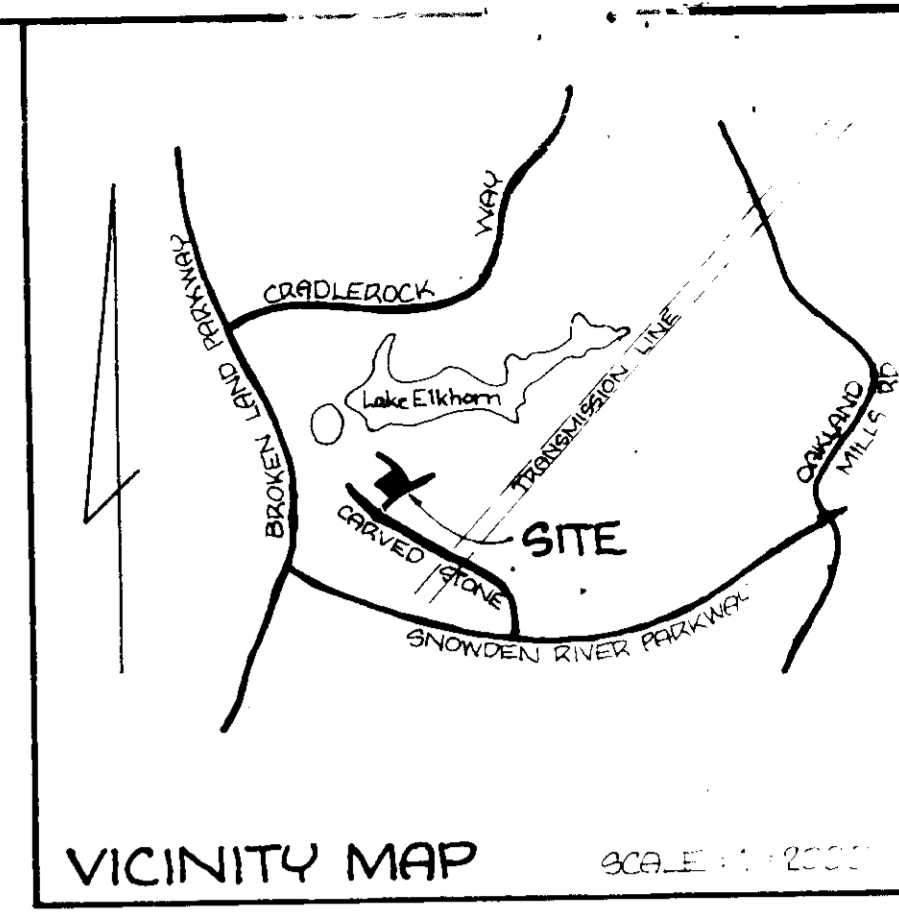

- NOTES:**
1. ZONING: N.T. AREA: 1.46 AC. ATTACHED LAND USE, FDP-116, PART I & II.
 2. ALL ROADWAYS EXISTING & PUBLIC.
 3. ANY DAMAGE TO COUNTY-OWNED RIGHTS-OF-WAY TO BE CORRECTED AT DEVELOPER'S EXPENSE.
 4. TOTAL NO. OF LOTS & UNITS: 16
 5. LEGEND:
 - 392 EXISTING CONTOURS
 - 392 PROPOSED CONTOURS
 - 392+1 SPOT ELEVATIONS
 - DIRECTION OF DRAINAGE
 - EXISTING UTILITY EASEMENTS
 6. DEVELOPER TO CONSTRUCT WALKWAY FROM SIDEWALK AROUND LIFEQUEST LANE CURVE-992 TO RAW LINE ADJOINING COMMUNITY-OWNED LOT A-221.
 7. PARKING SPACES REQUIRED: 32
PARKING SPACES PROVIDED: 32

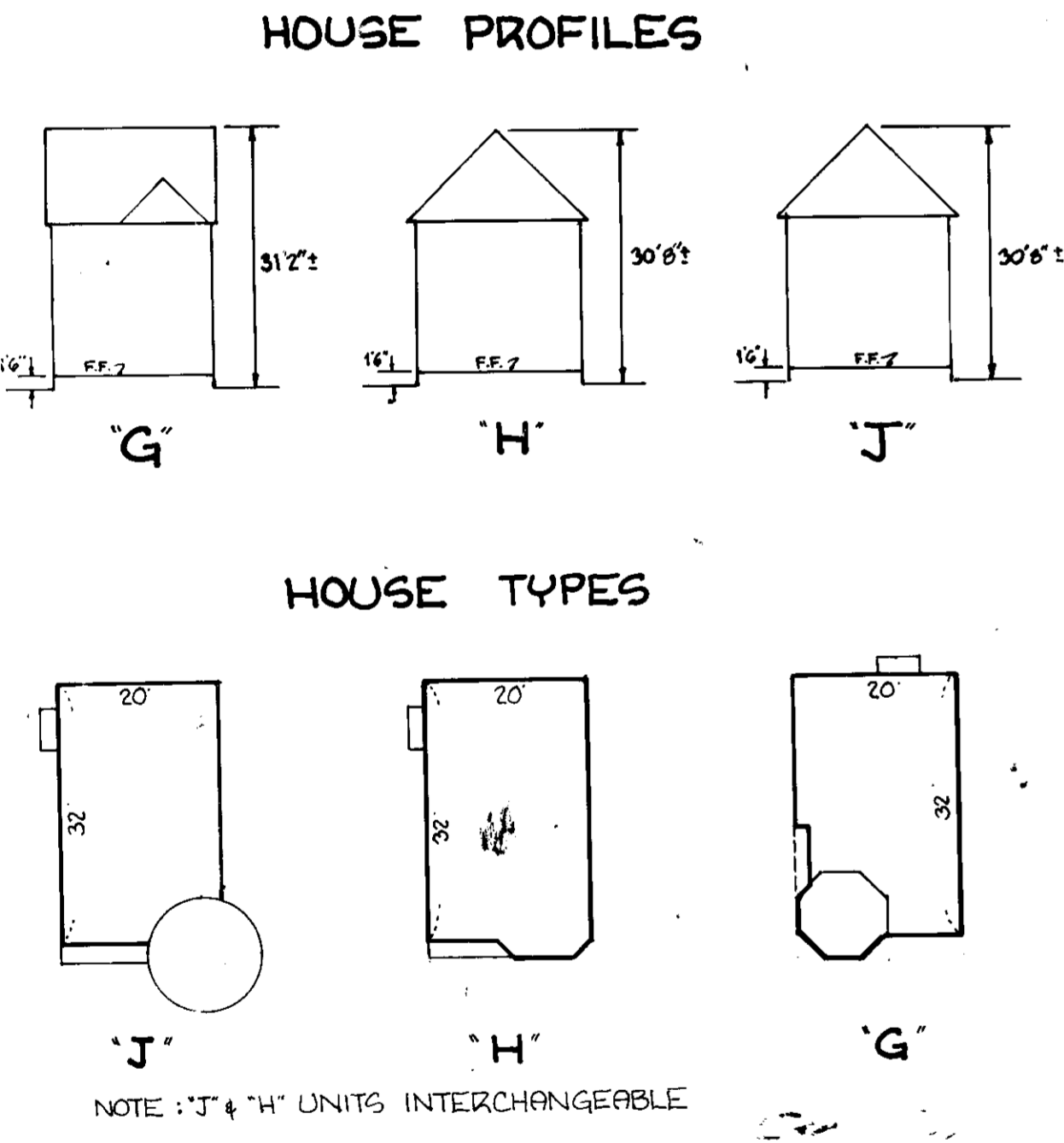
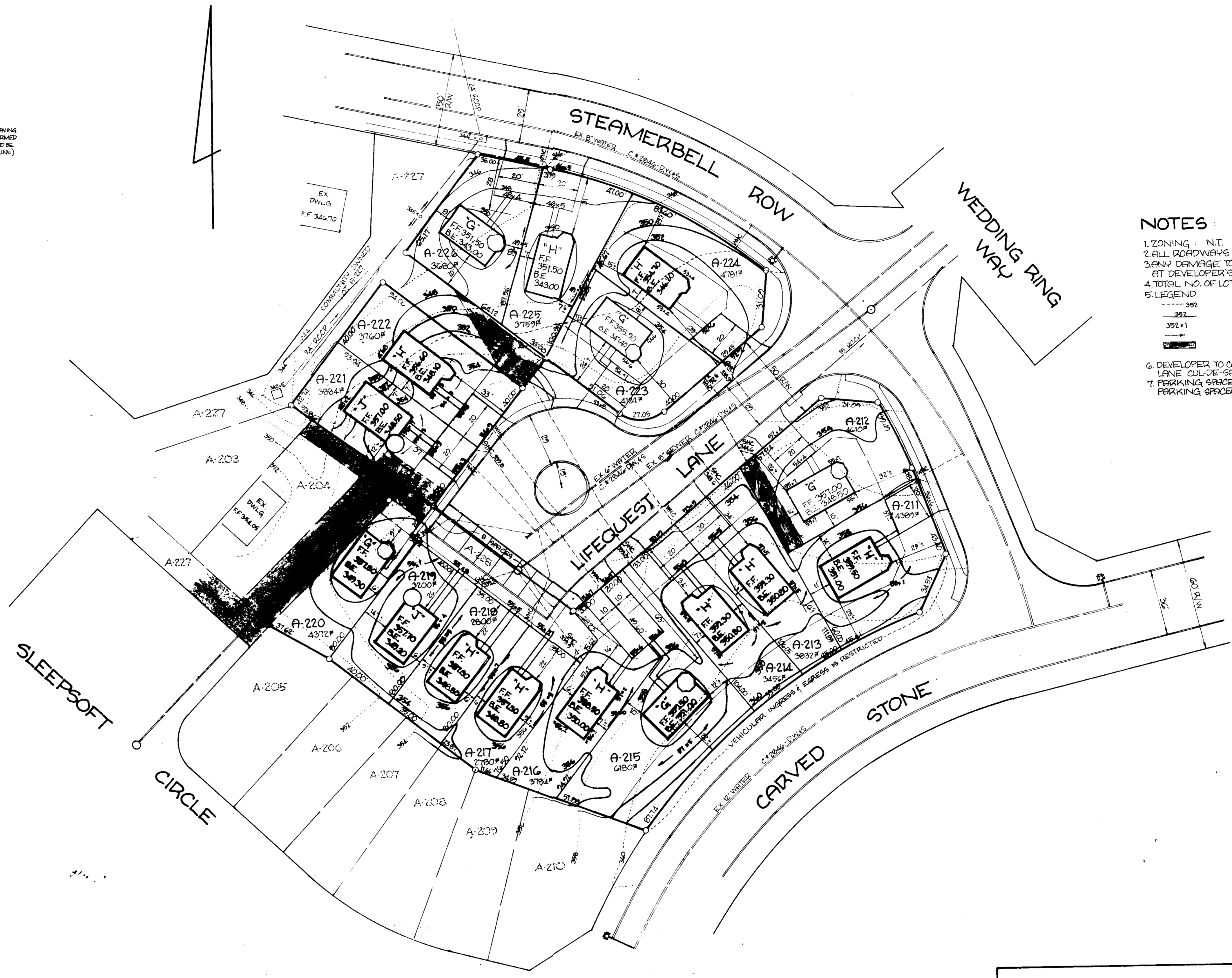

APPROVED: FOR PUBLIC WATER & PUBLIC SEWERAGE SYSTEMS.
HOWARD COUNTY HEALTH DEPARTMENT
[Signature] 6-9-83
COUNTY HEALTH OFFICER DATE

APPROVED: HOWARD COUNTY OFFICE OF PLANNING & ZONING.
[Signature] 6-13-83
PLANNING DIRECTOR DATE
[Signature] 6-13-83
CHIEF, DIVISION OF LAND DEVELOPMENT & ZONING ADMINISTRATION DATE

APPROVED: FOR PUBLIC WATER, PUBLIC SEWERAGE, STORM DRAINAGE SYSTEMS, & PUBLIC ROADS. HOWARD COUNTY DEPARTMENT OF PUBLIC WORKS.
[Signature] 6-6-83
DIRECTOR DATE
CHIEF, BUREAU OF ENGINEERING DATE

DEVELOPER'S CERTIFICATE
I CERTIFY THAT ALL DEVELOPMENT AND CONSTRUCTION WILL BE DONE ACCORDING TO THIS PLAN OF DEVELOPMENT AND PLAN FOR EROSION & SEDIMENT CONTROL, & THAT ALL RESPONSIBLE PERSONNEL INVOLVED IN THE CONSTRUCTION PROJECT WILL HAVE A CERTIFICATE OF ATTENDANCE AT A DEPT. OF NATURAL RESOURCES APPROVED TRAINING PROGRAM FOR THE CONTROL OF SEDIMENT & EROSION BEFORE BEGINNING THE PROJECT. I ALSO AUTHORIZE PERIODIC ON-SITE INSPECTION BY THE HOWARD SOIL CONSERVATION DISTRICT, OR THEIR AUTHORIZED AGENTS, AS ARE DEEMED NECESSARY.
[Signature] 3/16/83
DEVELOPER DATE

ENGINEER'S CERTIFICATE
I CERTIFY THAT THIS PLAN FOR EROSION & SEDIMENT CONTROL REPRESENTS A PRACTICAL & MODIFIABLE PLAN BASED ON MY PERSONAL KNOWLEDGE OF THE SITE CONDITIONS, & THAT IT WAS PREPARED IN ACCORDANCE WITH THE REQUIREMENTS OF THE HOWARD SOIL CONSERVATION DISTRICT.
[Signature] 5-16-1983
ENGINEER DATE

SITE DEVELOPMENT PLAN
COLUMBIA VILLAGE OF OWEN BROWN
SECTION 2 AREA 1 LOTS A-211 A-226 SHEET 1 OF 3
6TH ELECTION DISTRICT HOWARD COUNTY, MARYLAND PLAT # 43902
SCALE: 1" = 30' MARCH 3, 1983 A REVISION OF S.D.P. 80-371c

ENGINEER & SURVEYOR
HUDKINS ASSOCIATES, INC.
291 JOSEPH SQUARE
COLUMBIA, MD. 21044
730-9060

OWNER & DEVELOPER
ETHAN GROSSMAN
10750 HICKORY RIDGE RD. SUITE 107
COLUMBIA, MD. 21044
730-2494

5-18-83
[Signature]

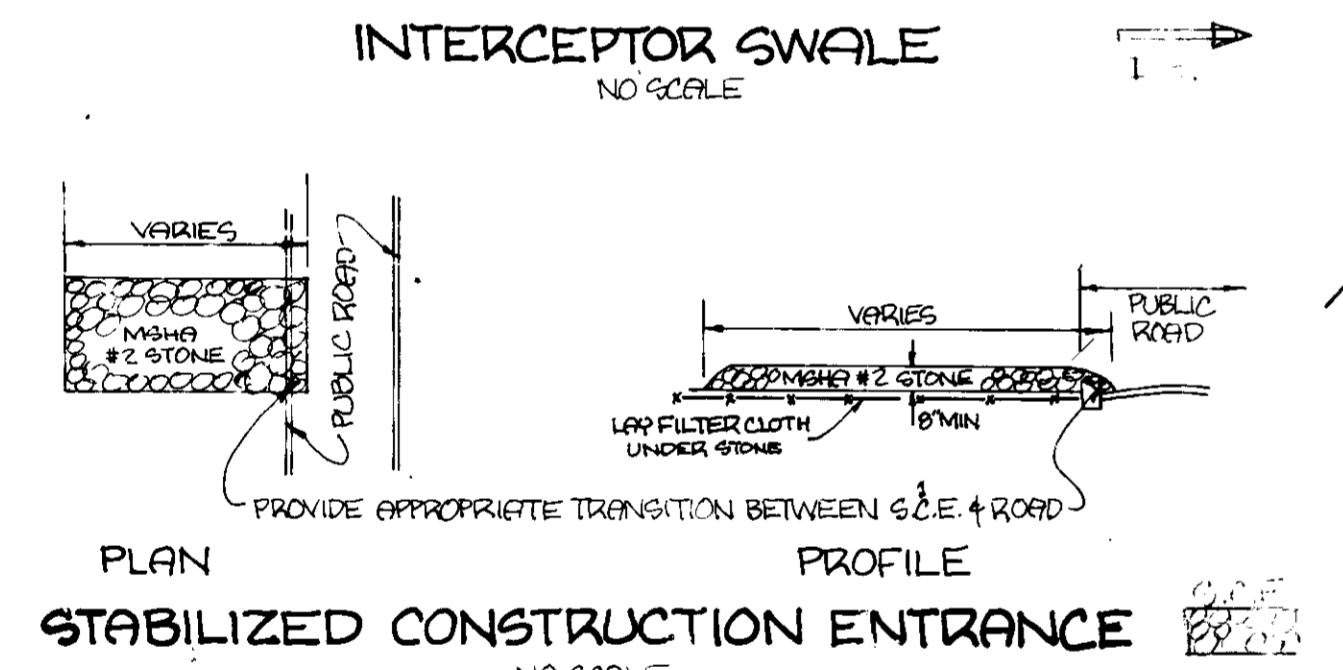
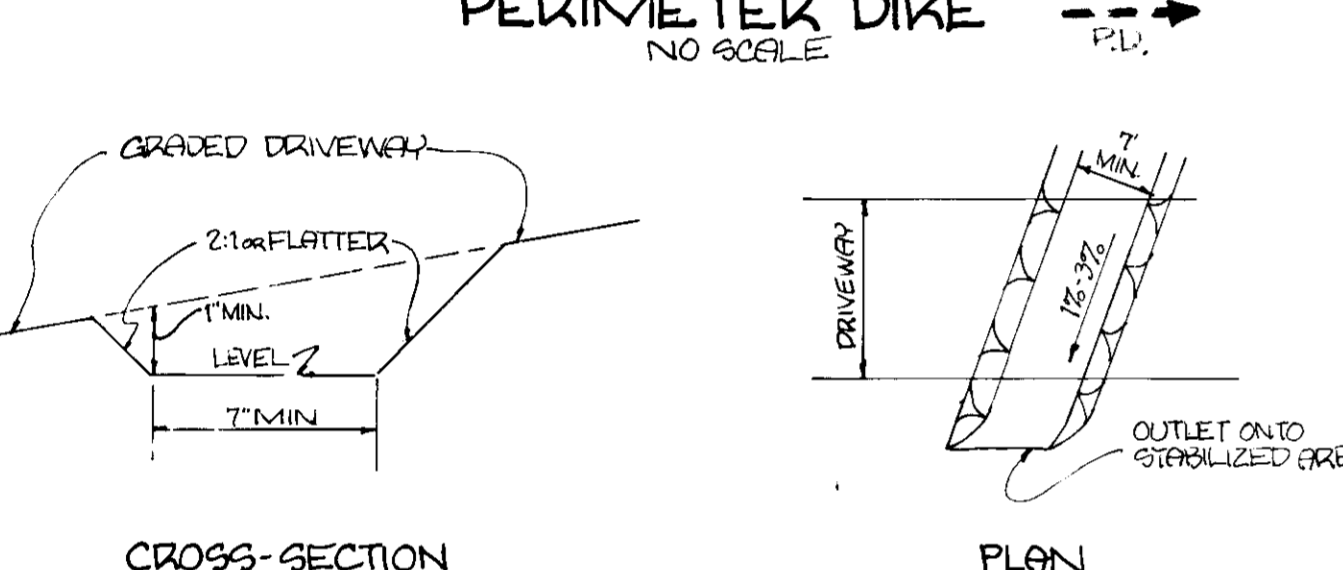
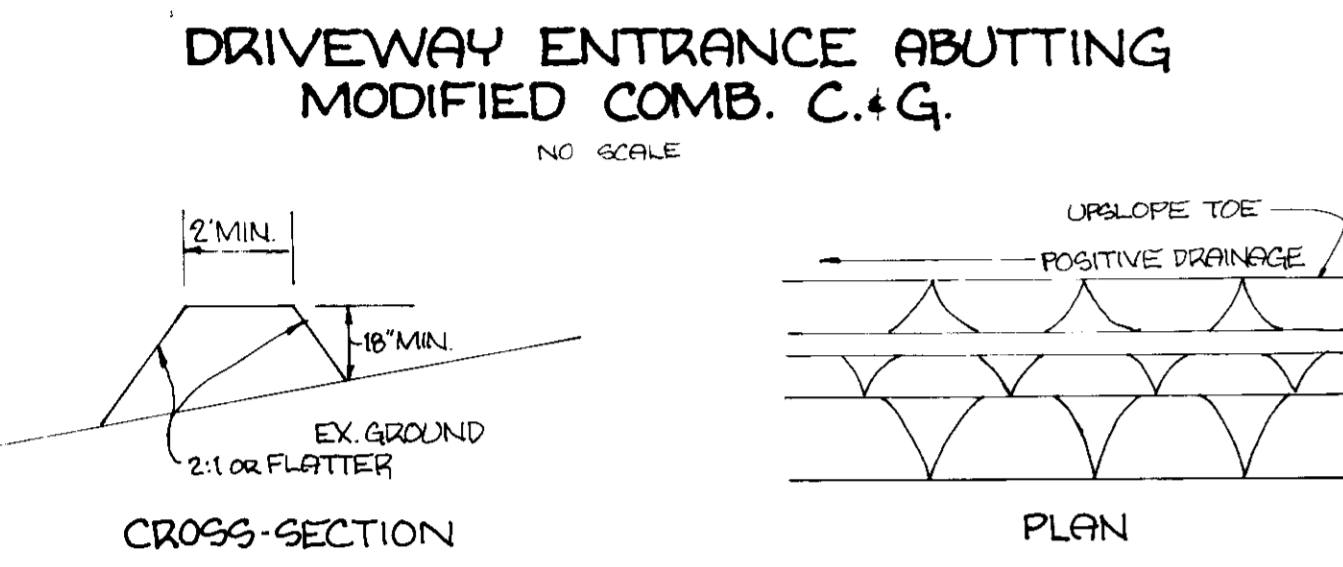
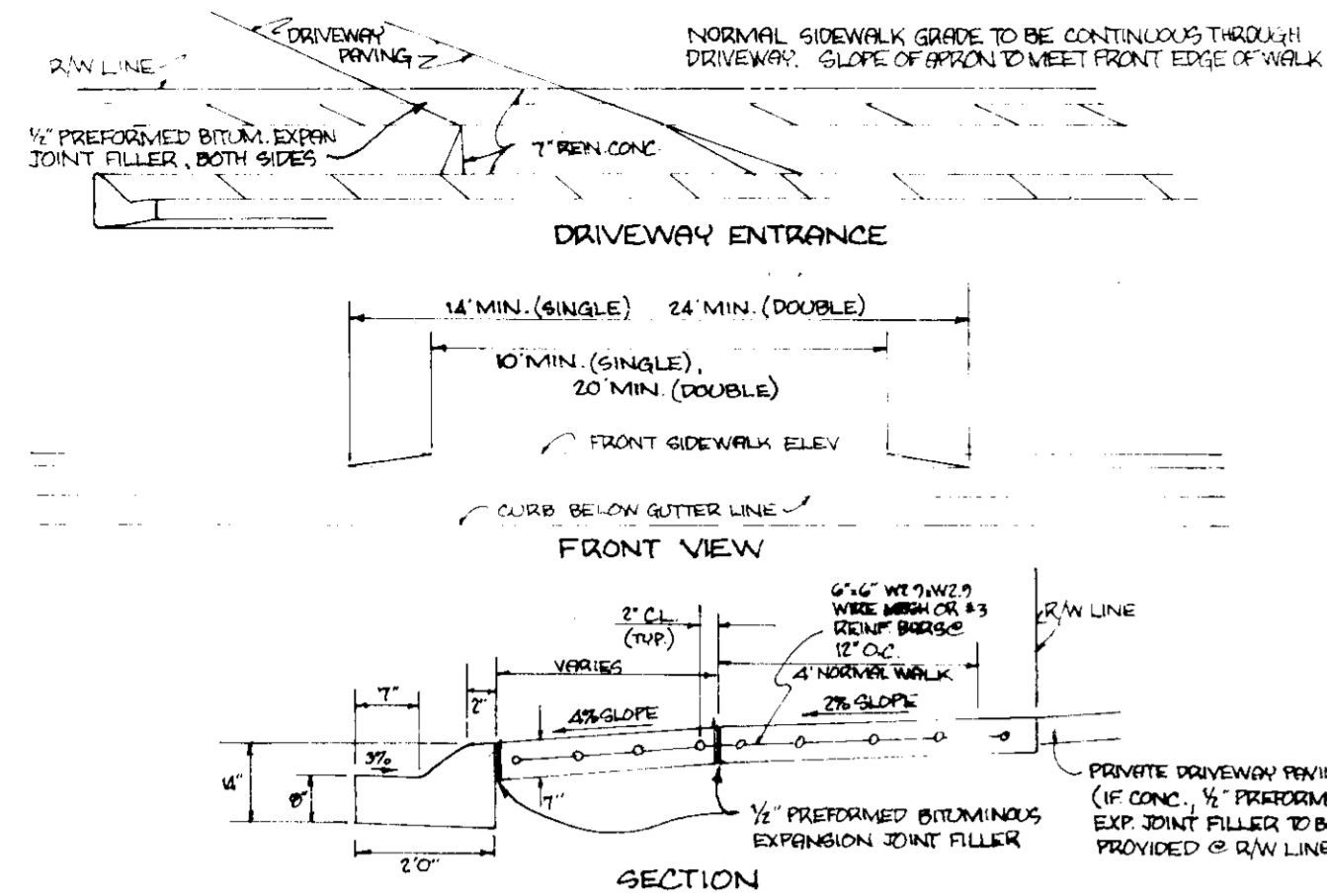

REVIEWED: FOR HOWARD COUNTY CONSERVATION DISTRICT & MEETS TECHNICAL REQUIREMENTS.
 T. Kagan 6/18/83
 U.S. SOIL CONSERVATION SERVICE DATE

APPROVED: FOR SOIL EROSION & SEDIMENT CONTROL HOWARD COUNTY CONSERVATION DISTRICT
 6/18/83
 HOWARD C.C.D. DATE

APPROVED: FOR PUBLIC WATER & PUBLIC SEWERAGE SYSTEMS, HOWARD COUNTY HEALTH DEPARTMENT.
 6/19/83
 COUNTY HEALTH OFFICER per S.B. DATE

APPROVED: HOWARD COUNTY OFFICE OF PLANNING & ZONING.
 6-13-83
 PLANNING DIRECTOR DATE

APPROVED: FOR PUBLIC WATER, PUBLIC SEWERAGE, STORM DRAINAGE SYSTEMS & PUBLIC ROADS, HOWARD COUNTY DEPARTMENT OF PUBLIC WORKS.
 6-13-83
 DIRECTOR DATE

DEVELOPER'S CERTIFICATE
 I CERTIFY THAT ALL DEVELOPMENT AND CONSTRUCTION WILL BE DONE ACCORDING TO THIS PLAN OF DEVELOPMENT AND PLAN FOR EROSION & SEDIMENT CONTROL, & THAT ALL RESPONSIBLE PERSONNEL INVOLVED IN THE CONSTRUCTION PROJECT WILL HAVE A CERTIFICATE OF ATTENDANCE AT A DEPT. OF NATURAL RESOURCES APPROVED TRAINING PROGRAM FOR THE CONTROL OF SEDIMENT & EROSION BEFORE BEGINNING THE PROJECT. I ALSO AUTHORIZE PERIODIC ON-SITE INSPECTION BY THE HOWARD SOIL CONSERVATION DISTRICT, OR THEIR AUTHORIZED AGENTS, AS ARE DETERMINED NECESSARY.
 DATE: 3/16/83
 DEVELOPER

ENGINEER'S CERTIFICATE
 I CERTIFY THAT THIS PLAN FOR EROSION & SEDIMENT CONTROL REPRESENTS A PRACTICAL & WORKABLE PLAN BASED ON MY PERSONAL KNOWLEDGE OF THE SITE CONDITIONS, & THAT IT WAS PREPARED IN ACCORDANCE WITH THE REQUIREMENTS OF THE HOWARD SOIL CONSERVATION DISTRICT.
 DATE: 3-16-1973
 SIGNATURE: Walter Park

SITE ANALYSIS:
 1. ZONING: N.T. 2. NO. OF LOTS: 16
 3. AREA TO BE PAVED: 0.17 AC. 4. AREA TO BE ROOFED: 0.25 AC.
 5. AREA TO BE GRADED: 1.04 AC. 6. AREA TO BE UNDISTURBED: 0 AC.
 7. TOTAL AREA: 1.46 AC.

CONSTRUCTION SEQUENCE:
 1. OBTAIN GRADING PERMIT.
 2. INSTALL SEDIMENT CONTROL MEASURES.
 3. EXCAVATE FOR FOUNDATIONS & ROUGH GRADE.
 4. CONSTRUCT BUILDINGS.
 5. FINE GRADE & STABILIZE.
 6. OBTAIN PERMISSION FOR REMOVAL OF SEDIMENT CONTROL MEASURES.

SEDIMENT CONTROL PLAN
 COLUMBIA VILLAGE OF OWEN BROWN
 SECTION 2 AREA 1 LOTS A-211 A-226 SHEET 2 OF 3
 6TH ELECTION DISTRICT HOWARD COUNTY, MARYLAND PLAT #4303
 SCALE: 1" = 30' MARCH 3, 1983 A REVISION OF S.D.P. 80-37c

ENGINEER & SURVEYOR
 HUDKINS ASSOCIATES, INC.
 231 JOSEPH SQUARE
 COLUMBIA, MD. 21044
 730-9060

OWNER & DEVELOPER
 ETHAN GROSSMAN
 10750 HICKORY RIDGE RD. SUITE 109
 COLUMBIA, MD. 21044
 730-2494

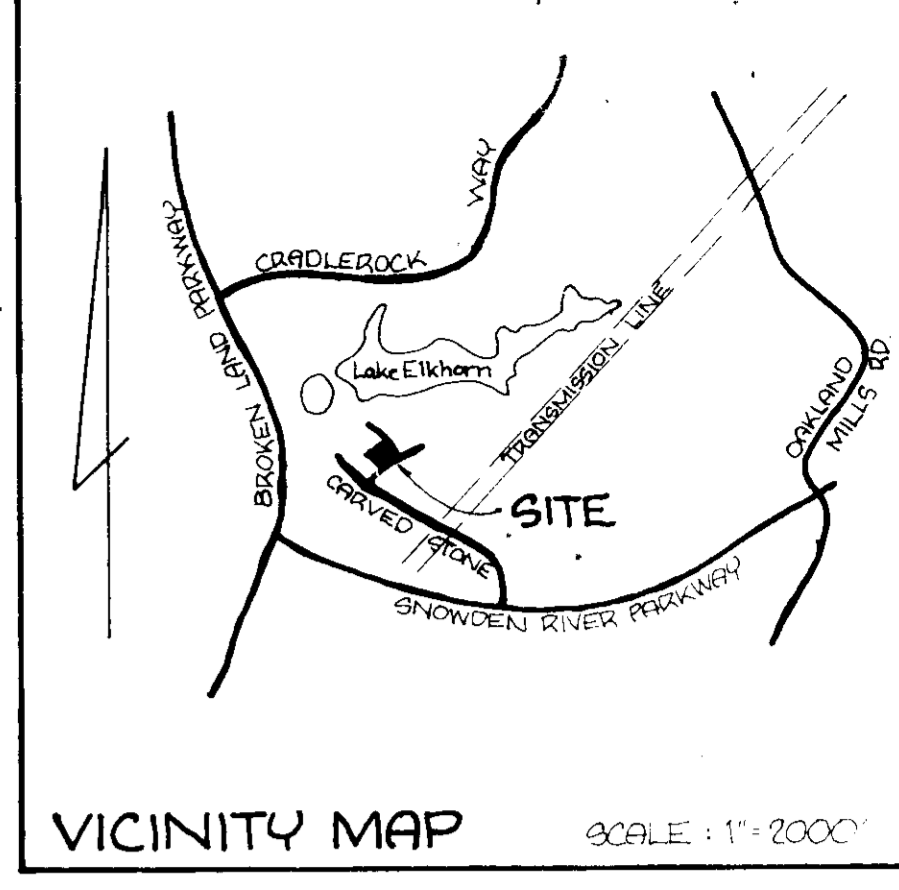
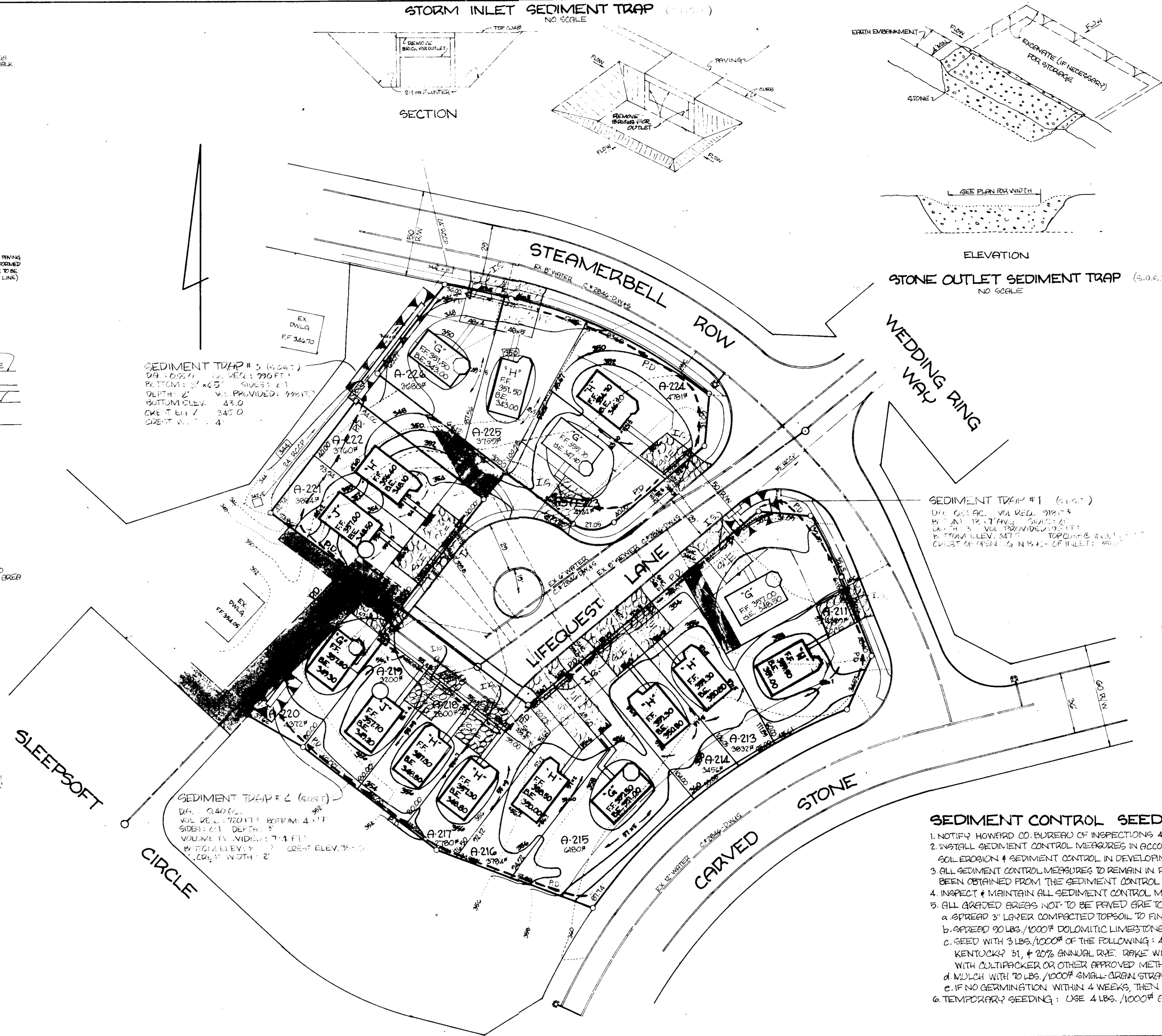

5-18-83

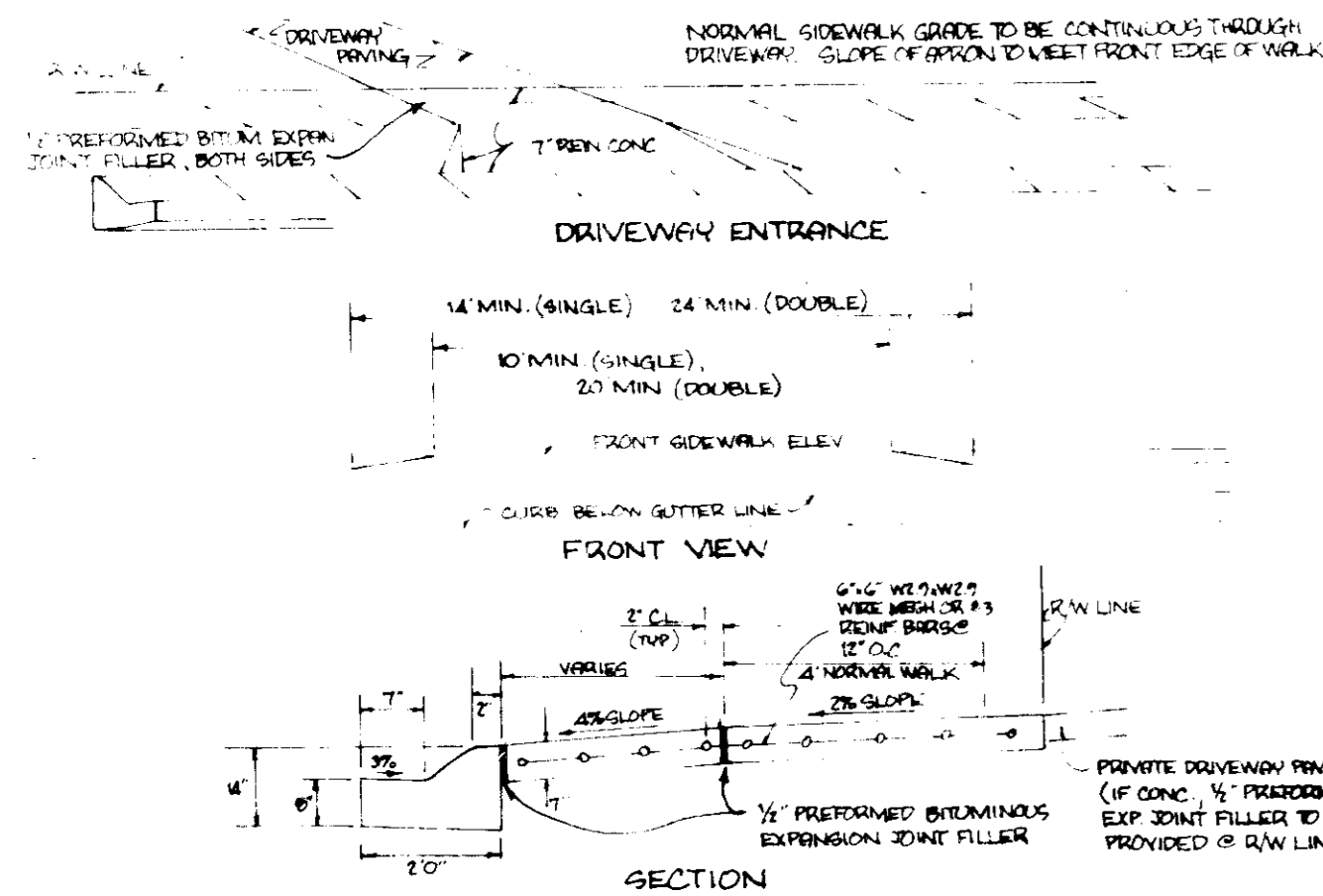

DRIVEWAY ENTRANCE ABUTTING
 MODIFIED COMB. C.+G.
 NO SCALE

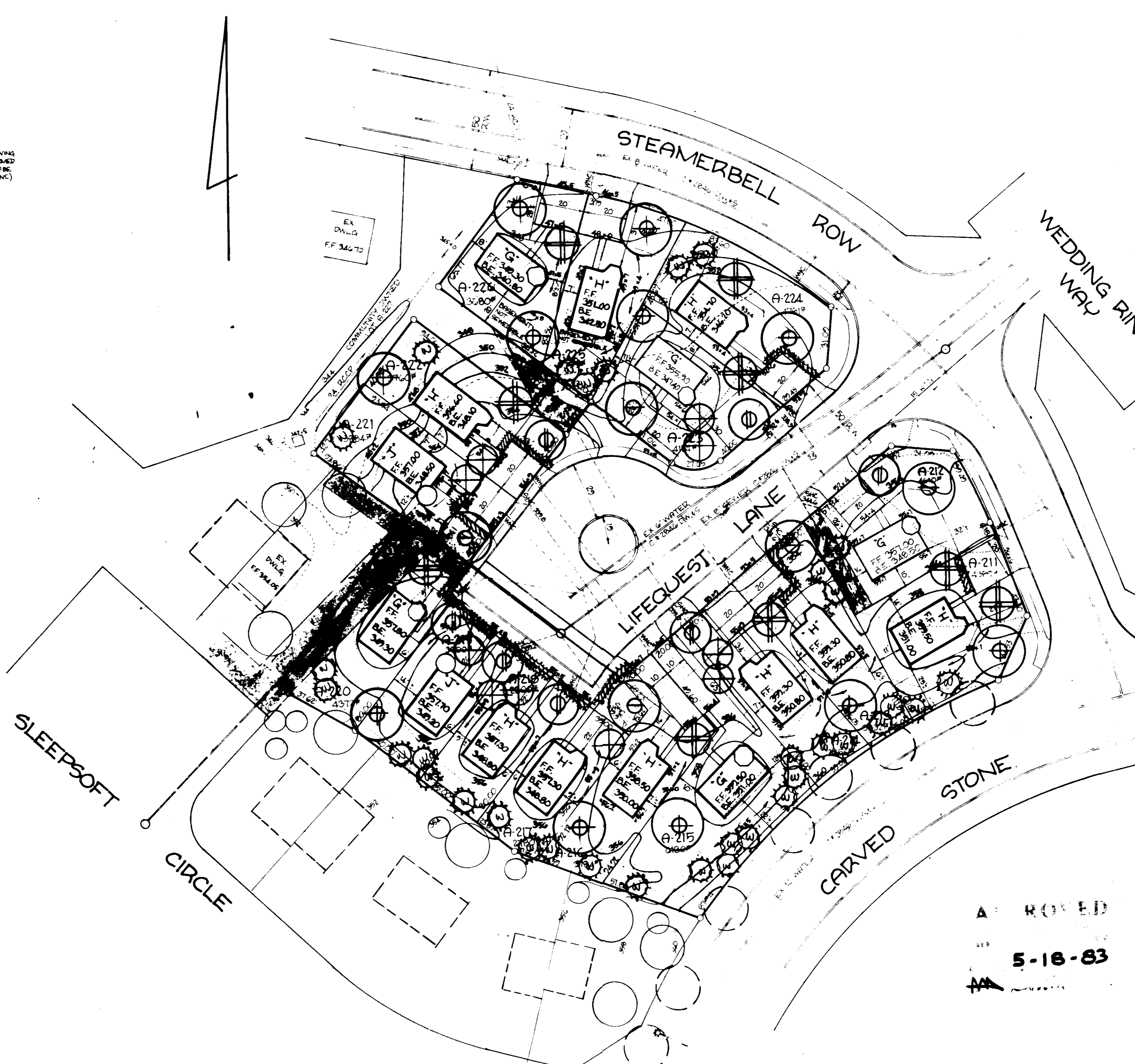
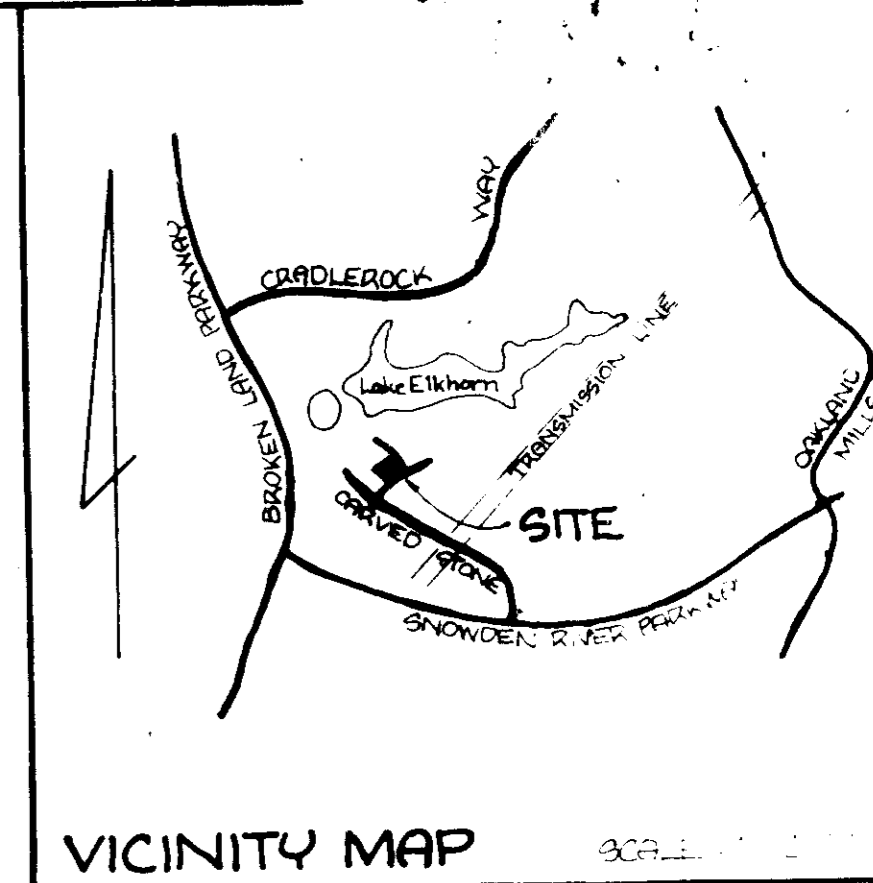

- NOTES:**
1. ZONING - NT. AREA: 1.46 AC.
 2. ALL DRIVEWAYS EXISTING & PUBLIC
 3. ANY DAMAGE TO COUNTY-OWNED RIGHTS-OF-WAY TO BE CORRECTED AT DEVELOPER'S EXPENSE.
 4. TOTAL NO. OF LOTS & UNITS: 16.
 5. LEGEND:
 - 392 EXISTING CONTOURS
 - - - 392 PROPOSED CONTOURS
 - 392+1 SPOT ELEVATIONS
 - DIRECTION OF DRAINAGE
 - EXISTING UTILITY EMBELEMMENTS
 6. DEVELOPER TO CONSTRUCT WALKWAY FROM SIDEWALK AROUND LIFEQUEST LANE CUL-DE-SAC TO R/W LINE JOINING COMMUNITY-OWNED LOT A-221.

PLANT SCHEDULE

KEY	PLANT NAME	SIZE	QUANT	REMARKS
⊕	ACER RUBRUM OCTOPER GLORY OCTOPER GLORY MAPLE	2 1/2'-3' CAL 12-14' HT.	10	#4 B HEAVY HEAPS
⊖	QUERCUS PALUSTRIS PIN OAK	2 1/2'-3' CAL 12-14' HT.	6	
⊙	PYRUS CALLERIANA 'BRADFORD' BRADFORD PEAR	2 1/2'-3' CAL 10-12' HT.	7	
⊕	PRUNUS GERRULATA KWANZAN KWANZAN CHERRY	8-10' HT.	9	
⊕	MALUS RADIANT RADIANT CRABAPPLE	8-10' HT.	10	
⊙	PINUS STROBUS EASTERN WHITE PINE	6-8' HT.	36	
⊕	LIGUSTRUM OVALIFOLIUM CALIFORNIA PRIVET	2'-3' BR CUT BACK TO 18" HT	PLANT 12' OC 250 L.F.	PROVIDED AT BUILDER'S OPTION

NOTE: ALL PLANTING TO BE IN COMPLIANCE WITH STANDARD HRD-COLUMBIA PLANTING SPECIFICATIONS
 CONTRACTOR TO VERIFY LOCATION OF UNDERGROUND UTILITIES BEFORE DIGGING.

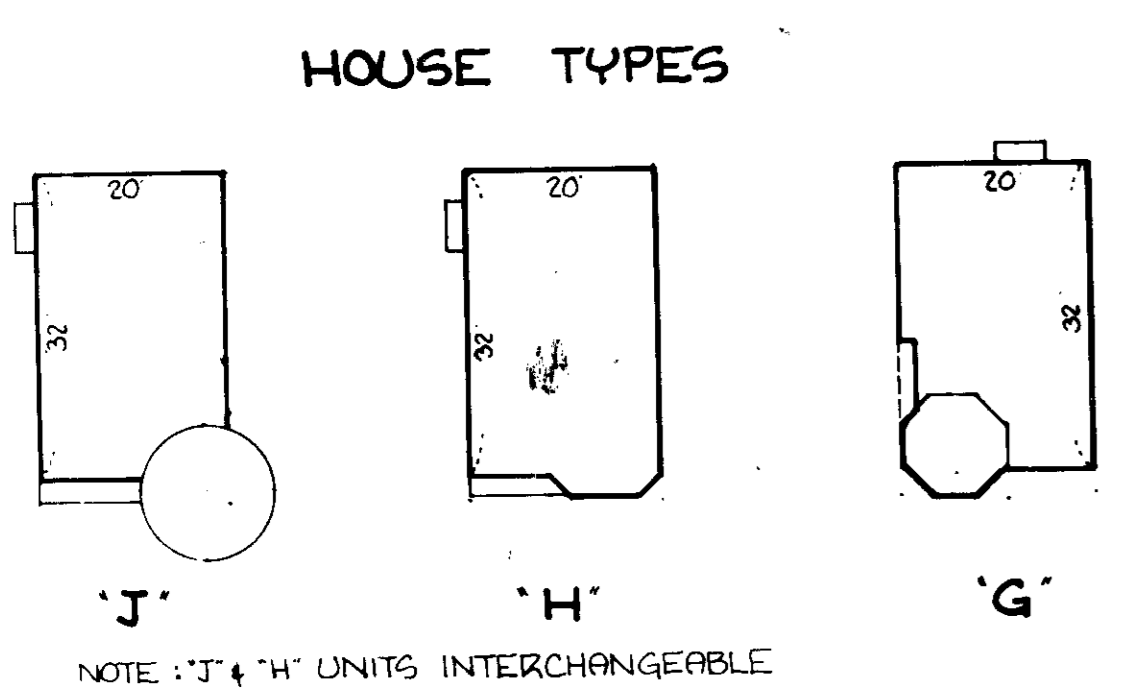

APPROVED: FOR PUBLIC WATER & PUBLIC SEWERAGE SYSTEMS.
 HOWARD COUNTY HEALTH DEPARTMENT
 COUNTY HEALTH OFFICER: *[Signature]* DATE: 6-9-83

APPROVED: HOWARD COUNTY OFFICE OF PLANNING & ZONING.
 PLANNING DIRECTOR: *[Signature]* DATE: _____

APPROVED: FOR PUBLIC WATER, PUBLIC SEWERAGE, STORM DRAINAGE SYSTEMS & PUBLIC ROADS. HOWARD COUNTY DEPARTMENT OF PUBLIC WORKS.
 DIRECTOR: *[Signature]* DATE: 6-10-83

DEVELOPER'S CERTIFICATE

I CERTIFY THAT ALL DEVELOPMENT AND CONSTRUCTION WILL BE DONE ACCORDING TO THIS PLAN OF DEVELOPMENT AND PLAN FOR EROSION & SEDIMENT CONTROL, & THAT ALL RESPONSIBLE PERSONNEL INVOLVED IN THE CONSTRUCTION PROJECT WILL HAVE A CERTIFICATE OF ATTENDANCE AT A DEPT. OF NATURAL RESOURCES APPROVED TRAINING PROGRAM FOR THE CONTROL OF SEDIMENT & EROSION BEFORE BEGINNING THE PROJECT. I ALSO AUTHORIZE PERIODIC ON-SITE INSPECTION BY THE HOWARD COUNTY CONSERVATION DISTRICT, OR THEIR AUTHORIZED AGENTS, AS ARE DEEMED NECESSARY.

[Signature] DATE: 3/6/83

ENGINEER'S CERTIFICATE

I CERTIFY THAT THIS PLAN OF DEVELOPMENT AND CONSTRUCTION IS IN ACCORDANCE WITH ALL APPLICABLE FEDERAL, STATE, AND LOCAL REGULATIONS AND ORDINANCES, AND THAT I AM A LICENSED PROFESSIONAL ENGINEER AND SURVEYOR IN THE STATE OF MARYLAND.

[Signature] DATE: 5-16-83

REVISED
 5-18-83

NEU VALLEY NURSERY
 ELK RIDGE, MD 21227 796-4195

LANDSCAPE PLANTING PLAN
 COLUMBIA VILLAGE OF OWEN BROWN
 SECTION 2 AREA 1 LOTS A-211 A-226 SHEET 3 OF 3
 6TH ELECTION DISTRICT HOWARD COUNTY, MARYLAND PLAT #4303
 SCALE: 1" = 30' MARCH 29, 1983 A REVISION OF S.D.P. 80-37c

ENGINEER & SURVEYOR: HILDING ASSOCIATES, INC. 231 JOSEPH SQUARE COLUMBIA, MD 21044 796-3767

OWNER & DEVELOPER: ETHAN GROSSMAN 10750 HICKORY BRIDGE RD SUITE 107 COLUMBIA, MD 21044 730-2494