

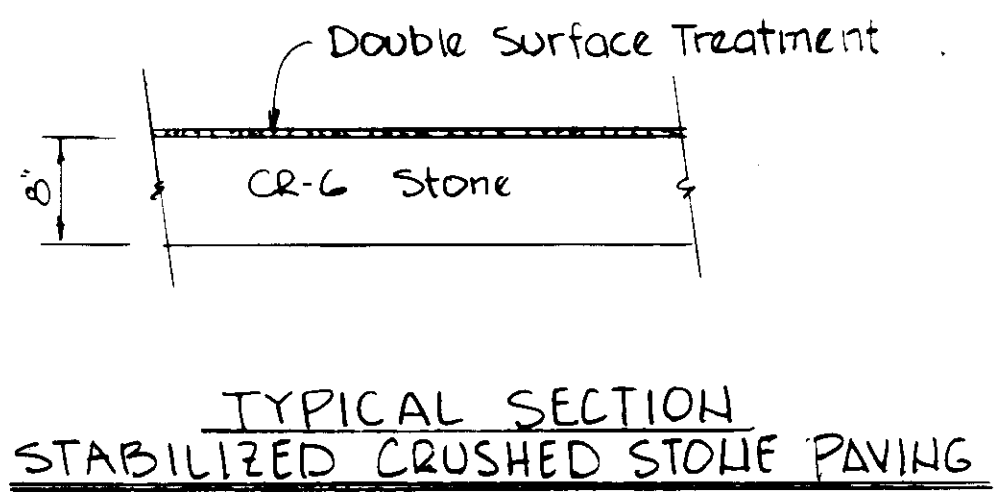

- SEDIMENT CONTROL NOTES**
- Specifications for the Sediment Control Details shown herein are included in the U.S.D.A. Soil Conservation Service "Standards and Specifications for Soil Erosion and Sediment Control in Developing Areas."
  - The Developer shall notify the Howard County Office of Inspection and Permits at least 24 hours prior to beginning any construction shown herein (992-2435 or 992-2436).
  - All sediment control structures to remain in place until permission for their removal has been obtained from the Howard County Office of Inspection and Permits (992-2435 or 992-2436).
  - All graded areas shall be established in accordance with the following requirements:
    - Site Preparation:
      - Barrow or disc the area to be seeded with the following materials at the specified rate to a depth of 3".
        - Pulverized limestone at 14 tons/acre.
        - Commercial fertilizer 10-10-10 at 3/4 tons/acre.
        - Super phosphate at 400 lbs./acre.
      - Seeding:
        - Sow the following seed mixture at the specified rate with a mechanical spreader:
          - Temporary - Italian or Perennial Ryegrass (1 lb./1000 sq.ft.)
          - Permanent - (Slopes flatter than 3:1) - Common Kentucky Bluegrass 40%, Home Bluegrass 40%, Red Fescue 20% (3 lb./1000 sq.ft.) (Slopes steeper than 3:1) - Ground cover (50 lbs./1000 sq.ft.)
        - The seed shall be covered to a depth of 1/2-inch and the area compacted with a roller or other approved method.
      - Mulching:
        - Seeded areas shall be uniformly mulched immediately after seeding with uncombed small grain straw at the rate of 14 to 2 tons/acre.
        - The mulch shall be covered with 1/2-inch of 0.1 gal./sq.y. or unmulched asphalt at 0.04 gal./sq.y.
      - Fertilizing:
        - Apply 10-10-10 fertilizer at 1000 lbs./acre. (25 lbs./1000 sq.ft.)
        - Apply ground agricultural limestone at 2000 lbs./acre. (50 lbs./1000 sq.ft.)
        - Incorporate both lime and fertilizer into soil by disking. Firm up after incorporation.
        - Lay mulch to a tight fit. Soil to insure contact with underlying soil. Water as necessary for first two weeks (in summer) to ensure establishment.
      - Ground Cover:
        - Cover seeds (unmulched) at 15 lbs./acre, and Kentucky 31 Tall Fescue (certified) at 40 lbs./acre. (2:1 minimum slope)
    - The contractor shall place plywood braced with sand bags at the inlet end of unfinished drain pipes at the end of each work day.
    - All structures shall be protected with straw bale dikes, silt fence, or other approved sediment control devices.
    - Specific control measures shown on this plan may be altered, with previous approval of the Sediment Control Inspector, in location or extent as required to fit changed conditions encountered at the site.



**CONSTRUCTION SEQUENCE**

- Obtain grading permit.
- Install stabilized construction entrance, diversion dike and silt fence as shown.
- Strip and grade site. Unsatisfactory or excess material to be stockpiled on site and protected with silt fence until stabilized or removed from site and disposed of in a spoil area with an approved erosion and sediment control plan.
- Begin construction.
- Install SWM Facility, sewer, water and electric services. Repair sediment control devices as required.
- Final grade site, prepare subgrade and pave.
- Remove sediment control devices upon approval of sediment control inspector when site is stabilized.

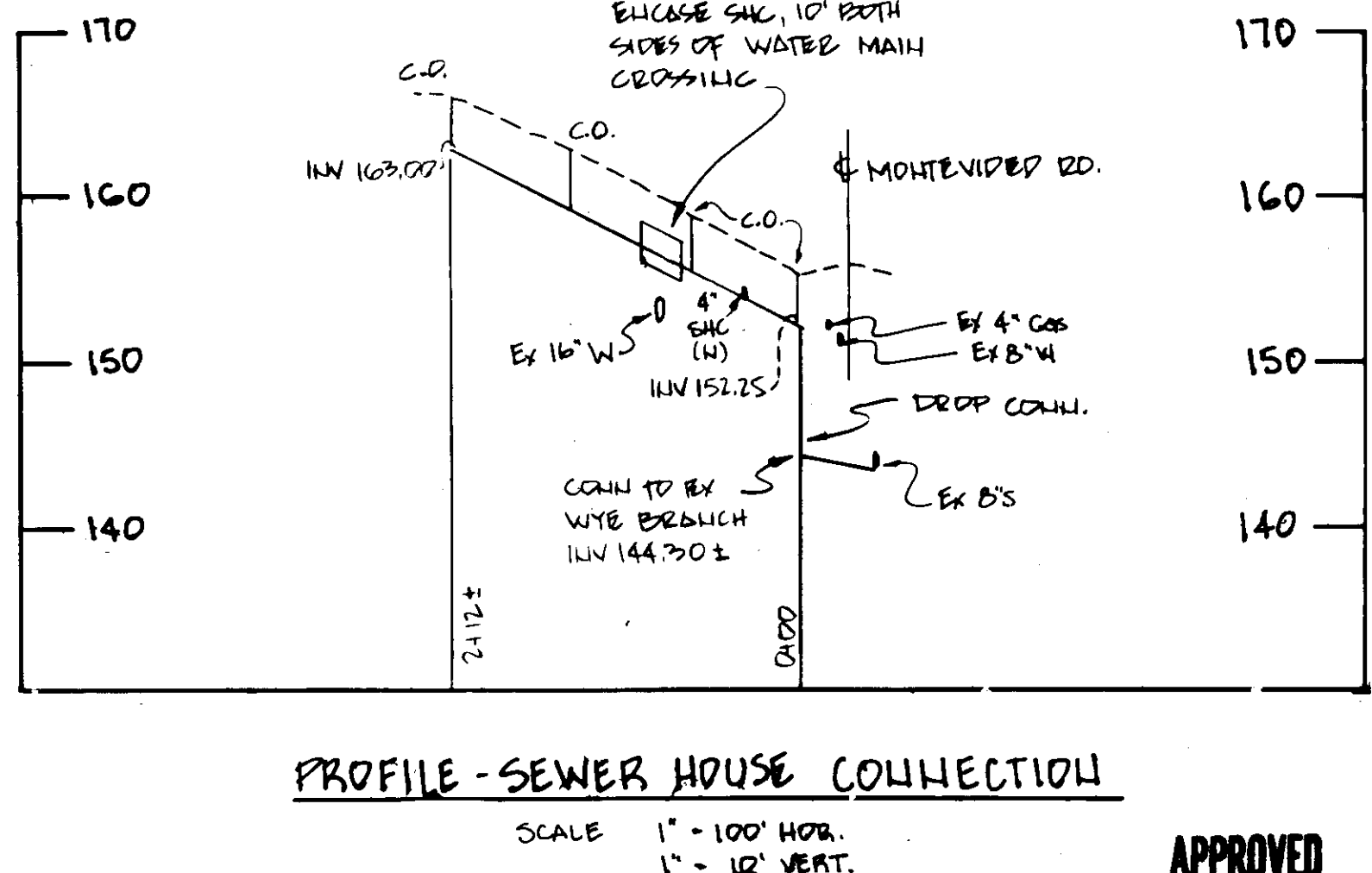
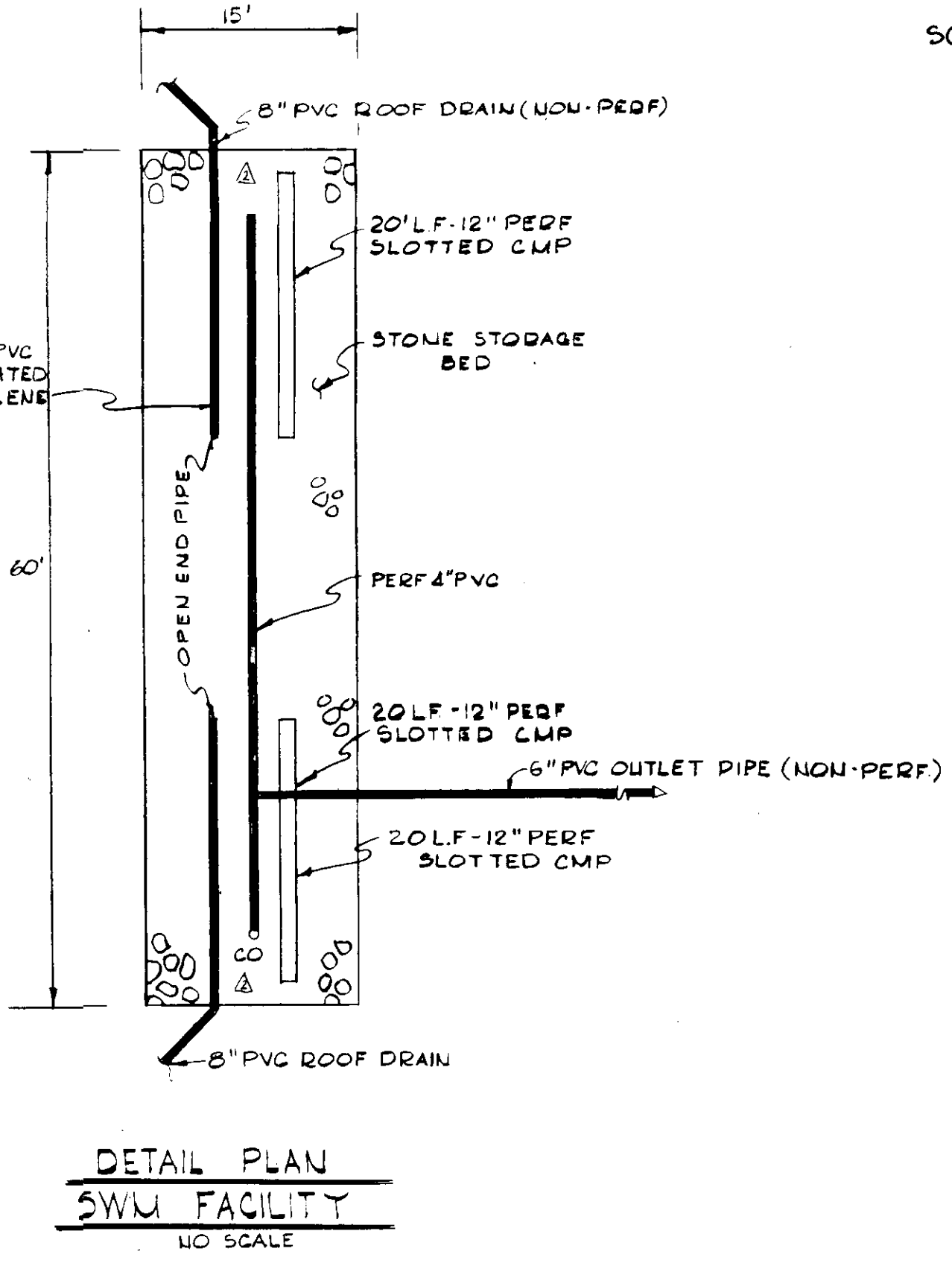
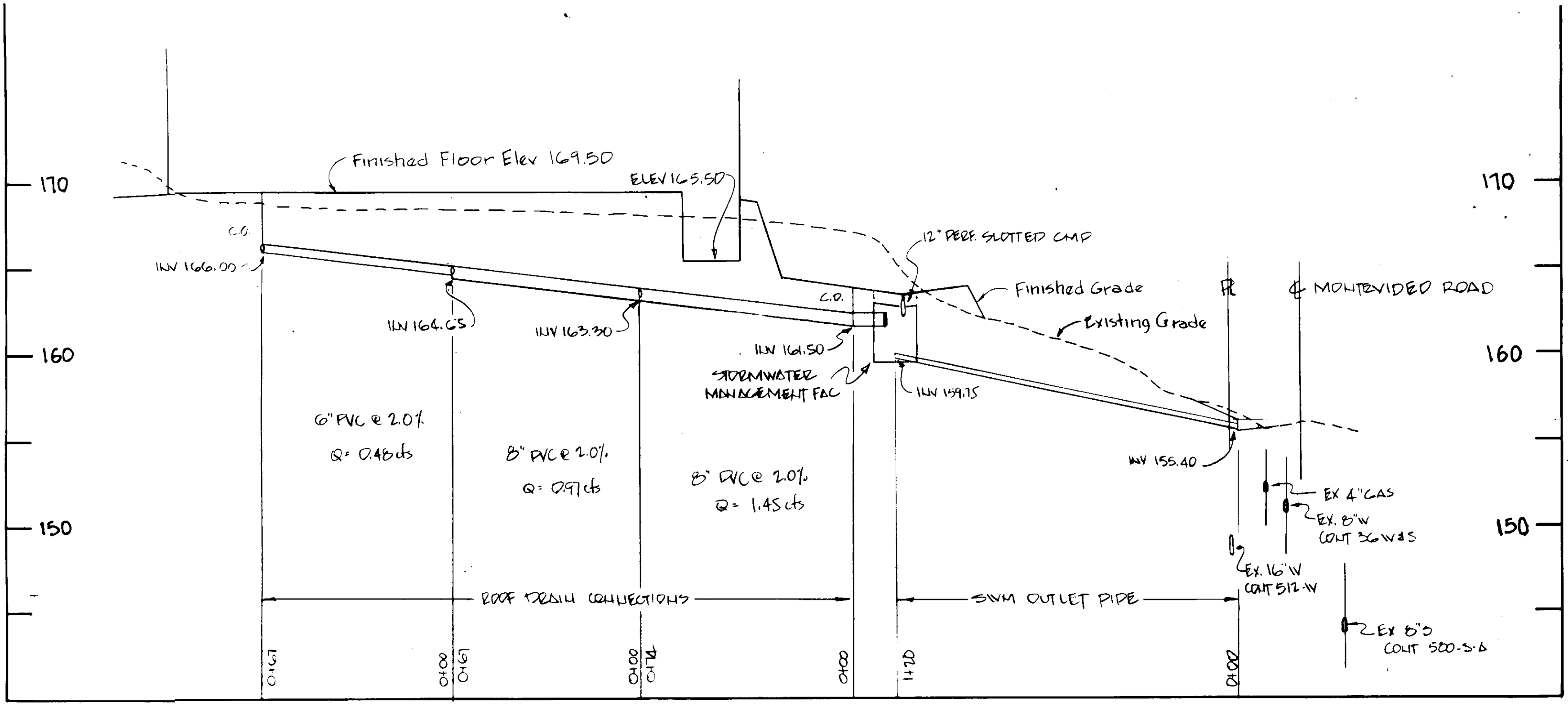
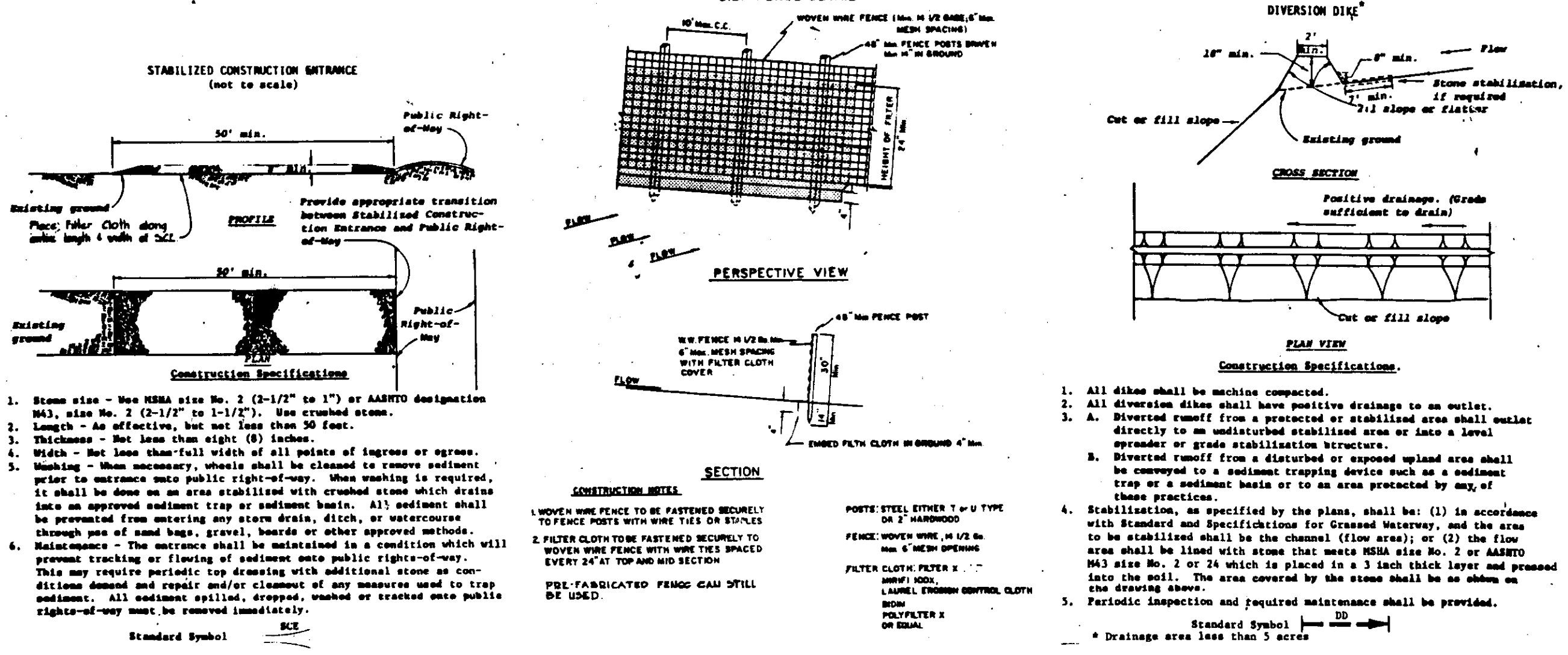

OWNER & DEVELOPER:  
BRIAN E COLLIN, ET AL  
T/A CUSTOM STEEL FABRICATORS  
7059 KIT KAT ROAD  
ELK RIDGE, MD 21227

APPROVED  
DIVISION OF LAND DEVELOPMENT &  
ZONING ADMINISTRATION  
HOWARD COUNTY, MARYLAND  
DATE 5-20-83

THIS DEVELOPMENT PLAN IS APPROVED FOR EROSION AND SEDIMENT CONTROL BY THE HOWARD SOIL CONSERVATION DISTRICT.

APPROVED: *[Signature]* 6-10-83  
HOWARD SOIL CONSERVATION DISTRICT DATE

DEVELOPED FOR HOWARD SOIL CONSERVATION DISTRICT AND MEETS TECHNICAL REQUIREMENTS

APPROVED: FOR PUBLIC WATER AND PUBLIC SEWERAGE SYSTEM HOWARD COUNTY HEALTH DEPARTMENT

SIGNATURE: *[Signature]* DATE: 6-16-83  
US SOIL CONSERVATION DIST. COUNTY HEALTH OFFICER S.S. DATE

<b>PURDUM &amp; JESCHKE</b> CONSULTING ENGINEERS LAND SURVEYORS 1023 North Calvert Street Baltimore, Maryland 21202 301/837-0194	APPROVED FOR PUBLIC WATER, PUBLIC SEWERAGE AND STORM DRAINAGE SYSTEMS AND PUBLIC ROADS - HOWARD COUNTY DEPARTMENT OF PUBLIC WORKS <i>[Signature]</i> 6-13-83 DIRECTOR DATE	APPROVED: HOWARD COUNTY OFFICE OF PLANNING AND ZONING <i>[Signature]</i> 6-17-83 DIRECTOR DATE	DEVELOPER CERTIFICATION: I CERTIFY THAT ALL DEVELOPMENT AND/OR CONSTRUCTION WILL BE DONE ACCORDING TO THIS PLAN OF DEVELOPMENT, AND PLAN OF EROSION AND SEDIMENT CONTROL, AND I ALSO AUTHORIZE PERIODIC ON-SITE INSPECTION BY THE HOWARD SOIL CONSERVATION DISTRICT OR THEIR AUTHORIZED AGENTS AS DEEMED NECESSARY. <i>[Signature]</i> 6/18/83 DATE	ENGINEER'S CERTIFICATION: I CERTIFY THAT THIS PLAN FOR EROSION AND SEDIMENT CONTROL REPRESENTS A PRACTICAL AND WORKABLE PLAN BASED ON MY PERSONAL KNOWLEDGE OF THE SITE CONDITIONS AND THAT IT WAS PREPARED IN ACCORDANCE WITH THE REQUIREMENTS OF THE HOWARD CONSERVATION DISTRICT. <i>[Signature]</i> 6/18/83 DATE	SITE DEVELOPMENT PLAN <b>CUSTOM STEEL FABRICATION</b> 7450 MONTEVIDEO ROAD HOWARD COUNTY, MARYLAND 1 <sup>ST</sup> ELECTION DISTRICT TAX MAP 43 PARCEL 88 FEBRUARY, 1983	Sheet 2 of 2 DES: BCE DRW: BCE CHK: WGR
	APPROVED FOR PUBLIC WATER, PUBLIC SEWERAGE AND STORM DRAINAGE SYSTEMS AND PUBLIC ROADS - HOWARD COUNTY DEPARTMENT OF PUBLIC WORKS <i>[Signature]</i> 6-13-83 CHIEF BUREAU OF ENGINEERING DATE	APPROVED: HOWARD COUNTY OFFICE OF PLANNING AND ZONING <i>[Signature]</i> 6-17-83 CHIEF DIVISION OF LAND DEVELOPMENT AND ZONING ADMINISTRATION DATE	APPROVED: HOWARD COUNTY OFFICE OF PLANNING AND ZONING <i>[Signature]</i> 6-17-83 DATE	APPROVED: HOWARD COUNTY OFFICE OF PLANNING AND ZONING <i>[Signature]</i> 6-17-83 DATE	APPROVED: HOWARD COUNTY OFFICE OF PLANNING AND ZONING <i>[Signature]</i> 6-17-83 DATE	ZONED M-2 LIBER 736 FOLIO 499 SCALE AS SHOWN