

NOTE: ALL CONSTRUCTION WITHIN SHA R/W SHALL BE IN ACCORDANCE WITH SHA PERMIT NO.

US ROUTE 1 (STATE ROAD)
VEHICULAR INGRESS & EGRESS IS RESTRICTED

SITE DEVELOPMENT NOTES

- PROPERTY
 - TAX MAP NO. 50 PARCEL 261
 - DEED REFERENCE: 884-029
 - RECORD PLAT: 5411
- SITE ANALYSIS
 - TOTAL AREA OF PARCEL: 2,7256 AC @ 10*
 - PRESENT ZONING: M-2
 - PROPOSED USE: RETAIL SALES & LIGHT MANUFACTURING
 - TOTAL AREA OF BUILDING: 98,600 S.F.
 - *RETAIL SALES (MAX. AREA) 4,265 S.F.
 - LIGHT MANUFACTURING 29,325 S.F.
 - PARKING SPACES REQUIRED:
 - (4,265 ÷ 200) + (29,325 ÷ 500) = 80
 - PARKING SPACES PROVIDED: 81 (Including 4 for Handicapped)
 - GREEN AREA: 24,163 S.F. (88%)
 - BUILDING AREA: 23,600 S.F. (88%)
 - PAVED AREA: 60,958 S.F. (22%)
 - TOTAL 118,726 S.F. (100%) OF PARCEL
 - * 2d) LIMITED RETAIL SALES ON THIS SITE SHALL MEET THE REQUIREMENTS OF SECTION 117.A.13 OF THE ZONING REGULATIONS.
- TOPOGRAPHY SURVEY
 - SURVEY DATE: SEPT. 1980 AND MARCH 1981
 - BENCH MARK: R/R SPIKE IN B.G.#E POLE #280643 N. SIDE OF WHISKEY BOT. RD. ELEV.: 222.28
 - COORDINATES: ASSUMED
- CONSTRUCTION
 - CALL "MISS UTILITY" 24 HOURS PRIOR TO STARTING ANY CONSTRUCTION.
 - ALL DAMAGES TO PUBLIC R/W AREA, PAVING, CURB AND GUTTER SHALL BE REPAIRED AT THE DEVELOPER'S EXPENSE.
 - ALL WORK WITHIN S.H.A. R/W SHALL BE IN ACCORDANCE WITH S.H.A. ACCESS PERMIT AND S.H.A. STANDARD DETAILS AND SPECIFICATIONS.
 - ALL WORK SHALL BE IN ACCORDANCE WITH THE LATEST HOWARD COUNTY STANDARD DETAILS AND SPECIFICATIONS.
- STORM WATER MANAGEMENT FOR PARCEL I IS PROVIDED BY POND ON PARCEL G. SEE S.W.M. PLAN EDP 82-55.
 - EXCLUDES AREA OF 0.32 ACRES ± OF DRIVEWAY & ENTRANCE CONSTRUCTION ON PARCEL H.

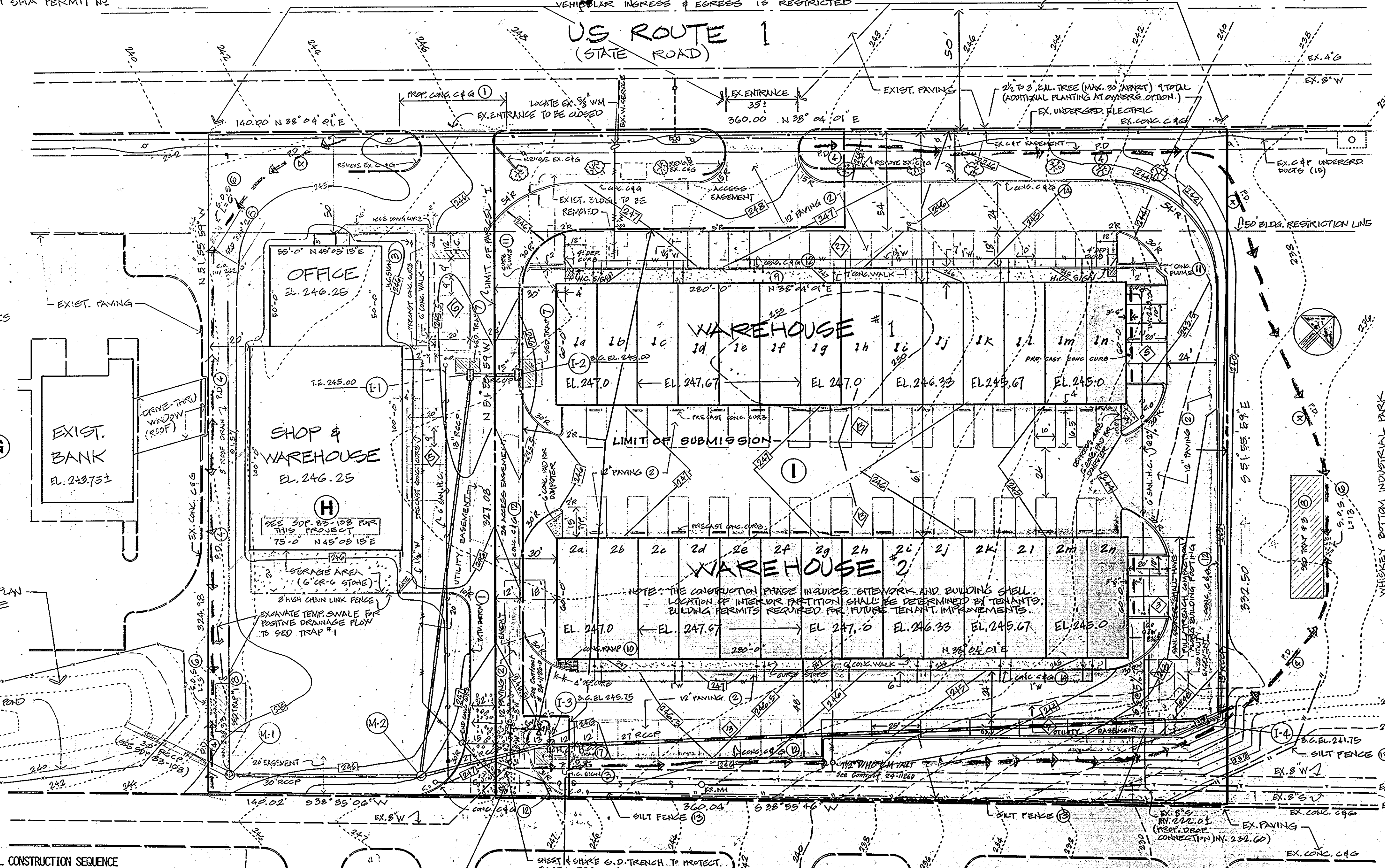
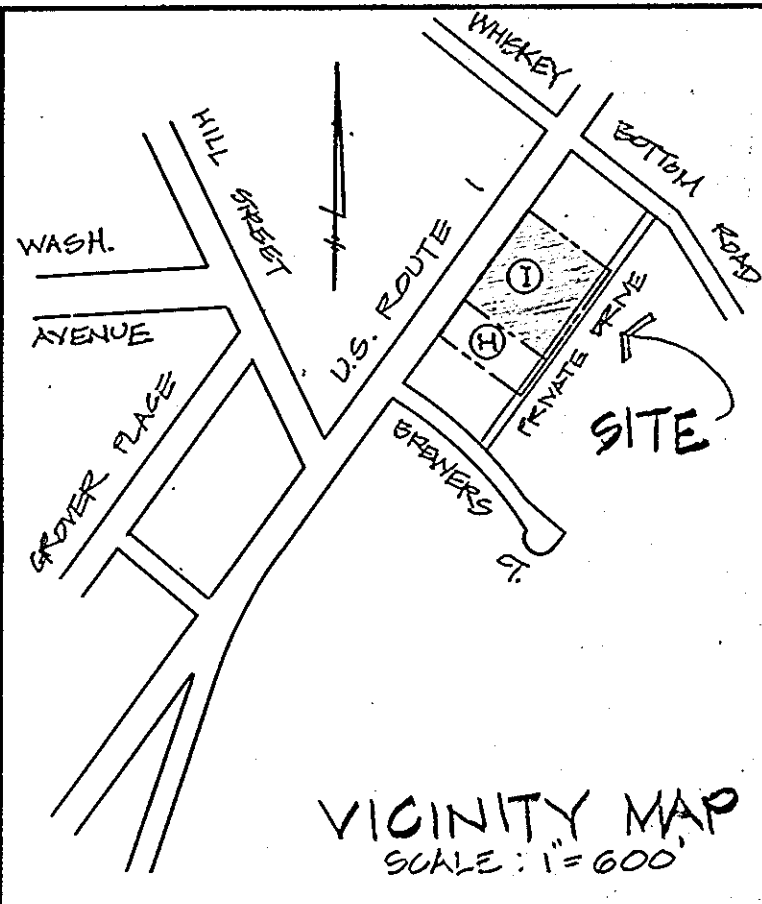

CARROLLTON ENTERPRISES PLAT NO. 5217

EXIST. BANK EL. 243.751

FOR APPROVED S.W.M. PLAN FOR ENTIRE SITE, SEE SDP-82-55

NOTE: THE CONSTRUCTION PHASE INCLUDES SITEWORK AND BUILDING SHELL. LOCATION OF INTERIOR PARTITION SHALL BE DETERMINED BY TENANTS. BUILDING PERMITS REQUIRED FOR FUTURE TENANT IMPROVEMENTS.

GENERAL NOTES (SEDIMENT CONTROL)

- OBTAIN GRADING PERMIT FROM HOWARD COUNTY.
- EROSION AND SEDIMENT CONTROL MEASURES TO BE INSTALLED AS SHOWN ON THESE DRAWINGS AND IN ACCORDANCE WITH THE "STANDARDS AND SPECIFICATIONS FOR SOIL EROSION AND SEDIMENT CONTROL IN DEVELOPING AREAS" DATED JULY, 1975.
- LOCATION OF TEMPORARY SEDIMENT CONTROL DEVICES ARE APPROXIMATE AND SHALL MEET FIELD CONDITIONS.
- ADDITIONAL SEDIMENT CONTROL MEASURES MAY BE REQUIRED BY CHANGING FIELD CONDITIONS, SUBJECT TO APPROVAL OF SEDIMENT CONTROL INSPECTOR.
- ALL FILLS SHALL BE BERMED AT TOP AFTER EACH WORKING DAY. ALL SLOPES SHALL BE LEFT ROUGH TO PREVENT UNDESIRED EROSION UNTIL READY TO STABILIZE.
- PERMANENT SLOPES SHALL NOT EXCEED 2:1 SLOPE.
- CONTRACTOR SHALL CLEAN OUT TRAPS WHEN SEDIMENT REACHES CLEANOUT ELEVATIONS SHOWN ON THESE PLANS.
- SITE ANALYSIS:
 - TOTAL AREA OF SITE: 2.7 ± ACRES
 - AREA DISTURBED: 0.7 ± ACRES
 - AREA OF BLDG. & PAVING: 2.2 ± ACRES
 - AREA STABILIZED: 0.8 ± ACRES
- TEMPORARY SEEDING - ANY DISTURBED AREA LEFT, IDLE FOR MORE THAN 30 DAYS SHALL BE STABILIZED WITH TEMPORARY SEEDING IN ACCORDANCE WITH THE FOLLOWING SPECIFICATIONS:
 - PERIODS MARCH 1 THRU APRIL 30, AND FROM AUGUST 15 THRU NOVEMBER 15, SEED WITH 2 1/2 BUSHELS PER ACRE (3.2 LBS./1,000 SQ. FT.) OF ANNUAL RYE FOR THE PERIOD MAY 1 THRU AUGUST 24, SEED WITH 3 LBS./ACRE (0.07 LBS./1,000 SQ. FT.) OF WEEPING LOVEGRASS.
- PERMANENT SEEDING:
 - SPREAD 4" OF TOPSOIL
 - APPLY 100 LBS. OF 20-10-10 FERTILIZER PER ACRE
 - SEED WITH 60 LBS./ACRE OF "KENTUCKY 31" TALL FESCUE
 - ALL SLOPES STEEPER THAN 5:1 SHALL BE STABILIZED WITH 20 LBS./ACRE OF CROWNVECH AND 40 LBS./ACRE OF "KENTUCKY 51" FESCUE
- SOD, IF USED, SHALL BE MARYLAND OR VIRGINIA STATE "CERTIFIED" OR "APPROVED" SOD

SEDIMENT CONTROL CONSTRUCTION SEQUENCE

- CONTRACTOR SHALL CONTACT HOWARD COUNTY INSPECTION (912-2417 or 792-7922) PRIOR TO STARTING CONSTRUCTION AND SOIL CONSERVATION DISTRICT (465-3180) A MINIMUM OF 48 HOURS BEFORE STARTING ANY GRADING OR CONSTRUCTION.
- INSTALL STABILIZED CONSTRUCTION ENTRANCE, PERIMETER DIKES, SEDIMENT TRAPS #1, 2 AND 3 AND STONE OUTLET STRUCTURES AS SHOWN ON THIS DRAWING.
- GRADE SITE.
- INSTALL STORM DRAIN SYSTEM AND INLET SEDIMENT TRAPS AT I-1, I-2, I-3. BLOCK TOP OF I-4 TO DIVERT SURFACE FLOW TO SEDIMENT TRAP #3 UNTIL STONE SUBBASE MATERIAL IS INSTALLED IN PAVING AREAS.
- STABILIZE WITH TEMPORARY SEEDING.
- CONSTRUCT BUILDINGS, INSTALL UTILITIES AND PAVE DRIVEWAYS AND PARKING AREA.
- REMOVE ALL SEDIMENT CONTROL DEVICES AND STABILIZE ALL GRASS AREAS WITH PERMANENT SEEDING.

STAB. STONE CONSTR. ENTR. 20' x 50'

PRIVATE DRIVE PLAN: SCALE 1"=30'

NOTE: 1) ON SITE WATER SERVICES ARE SCHEMATIC AND SHALL BE ADJUSTED DURING CONSTRUCTION TO MEET TENANT REQUIREMENTS. 2) ALL WATER HOUSE CONNECTION (SERVICE LINES) SHALL BE TYPICAL WATER PIPE. PROVIDE MIN. 3'-6" COVER.

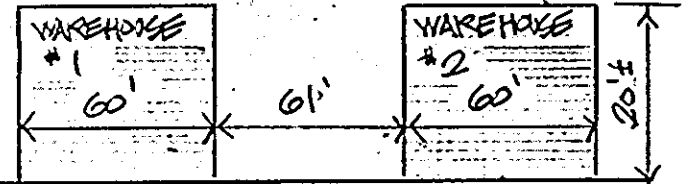

SEDIMENT TRAPS						
TRAP #	#1	#2	#3	I-1	I-2	I-3
DETAIL/SHEET	8/2	8/2	8/2	7/2	7/2	7/2
DEPTH (FT.)	3.5	3.5	3.5	3.5	3.5	2.5
LENGTH x WIDTH (FT.)	15 x 10	25 x 10	56 x 10	5 x 10	12 x 10	5 x 5
BOTTOM ELEV.	239.5	239.5	233.5	241.5	241.5	243.25
CLEAN-OUT ELEV.	242.0	242.0	236.0	243.5	243.5	244.75
DRAINAGE AREA (ACRES)	0.66	0.96	2.1	0.33	0.60	0.13
STORAGE REQ'D. (C.Y.)	44	64	140	22	30	9
STORAGE PROVIDED (C.Y.)	48	71	140	25	42	9

NOTE: I-4 Inlet shall be blocked to divert surface flow to sediment trap #3 until stone sub-base material is installed in paving area.

APPROVED FOR PUBLIC WATER & PUBLIC SEWERAGE SYSTEMS, HOWARD COUNTY HEALTH DEPARTMENT
 COUNTY HEALTH OFFICER: [Signature] DATE: 9-21-83
 APPROVED HOWARD COUNTY OFFICE OF PLANNING & ZONING
 PLANNING DIRECTOR: [Signature] DATE: 9-21-83
 CHIEF DIVISION OF LAND DEVELOPMENT AND ZONING ADMINISTRATION
 APPROVED FOR PUBLIC WATER, PUBLIC SEWERAGE AND STORM DRAINAGE SYSTEMS AND PUBLIC ROADS - HOWARD COUNTY DEP. OF PUBLIC WORKS
 DIRECTOR, DEPT. OF PUBLIC WORKS: [Signature] DATE: 9-13-83
 CHIEF, BUREAU OF ENGINEERING: [Signature] DATE: 9-13-83

These plans for [Project Name] soil erosion and sediment control meet the requirements of the Howard Soil Conservation District.
 HOWARD SOIL CONSERVATION DISTRICT: [Signature] DATE: 6-20-83

These plans have been reviewed for the Howard Soil Conservation District and meet the technical requirements for [Project Name] soil erosion and sediment control.
 U.S. SOIL CONSERVATION SERVICE: [Signature] DATE: 6-10-83

"I certify that this plan for erosion and sediment control represents a practical and workable plan based on my personal knowledge of the site conditions and that it was prepared in accordance with the requirements of the Howard Soil Conservation District."
 R. ALONZO ADDRESS: [Signature] DATE: 6/10/83

"I certify that all development and construction will be done according to this plan, and that any responsible personnel involved in the construction project will have a Certificate of Attendance at a Department of Natural Resources Approved Training Program for the Control of Sediment and Erosion for beginning the project."
 VICE PRESIDENT: [Signature] DATE: 2-8-83

OWNER:
 THE HOLLADAY CORPORATION
 1720 WISCONSIN AVE., N.W.
 WASHINGTON, D.C. 20037
 (202) 237-6470

PREPARED BY
H. MALMUD & ASSOC. INC.
 8815 MEADOW HEIGHTS RD.
 RANDALLSTOWN, MD. 21133
 TELEPHONE (301) 855-6465

DATE	NO.	REVISION	DESCRIPTION
6-27-84	1		"ESCAPE" HANDICAP RAMP REMOVED - 1' POSITIONED PARALLEL TO SIDEWALK - N.E. RAMP AT ENDS W.H.B.R.

SITE PLAN - Parcel I - 1
Whiskey bottom ind. park
 HOWARD COUNTY, MD.
 ELECTION DISTRICT NO. 6
 DATE 2/8/83 SCALE AS SHOWN SHEET 1 OF 2
 SDP-83-109

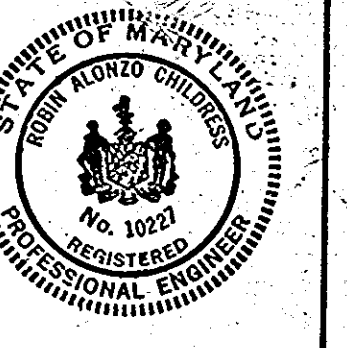

APPROVED
 DIVISION OF LAND DEVELOPMENT & ZONING ADMINISTRATION
 HOWARD COUNTY, MARYLAND
 DATE 5-27-83

a) CONC. C&G: SEE HOWARD CO. STD. DETAIL R-3.01
 NOTE - REVERSE GUTTER SLOPE AS REQUIRED FOR POSITIVE DRAINAGE (SEE CONTOURS ON SITE PLAN)
 b) WITHIN S.H.A. RW: MATCH EXISTING CONC. C&G
 c) BITU. BERM: SEE HOWARD CO. STD. DETAIL R-3.03

1 CURB DETAIL

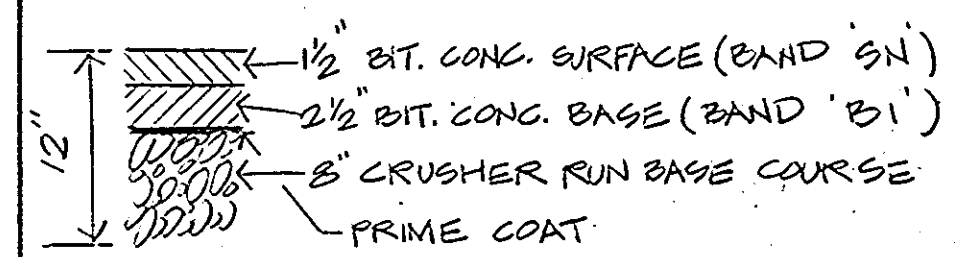

NOTE:
 1. BASE WILL BE PRIMED IN ACCORDANCE WITH SECTION C-30.3 OF HOWARD COUNTY ROAD CONSTRUCTION CODE & STD. SPECIFICATIONS.
 2. TACK COAT IS REQUIRED IN ACCORDANCE WITH SECTION C-31.4 OF HOWARD COUNTY ROAD CONSTRUCTION CODE & STD. SPECIFICATION.
 3. ALL MATERIALS & CONSTRUCTION SHALL BE IN ACCORDANCE WITH THE HOWARD COUNTY ROAD CONSTRUCTION CODE & STANDARD SPEC.

2 PAVING DETAIL

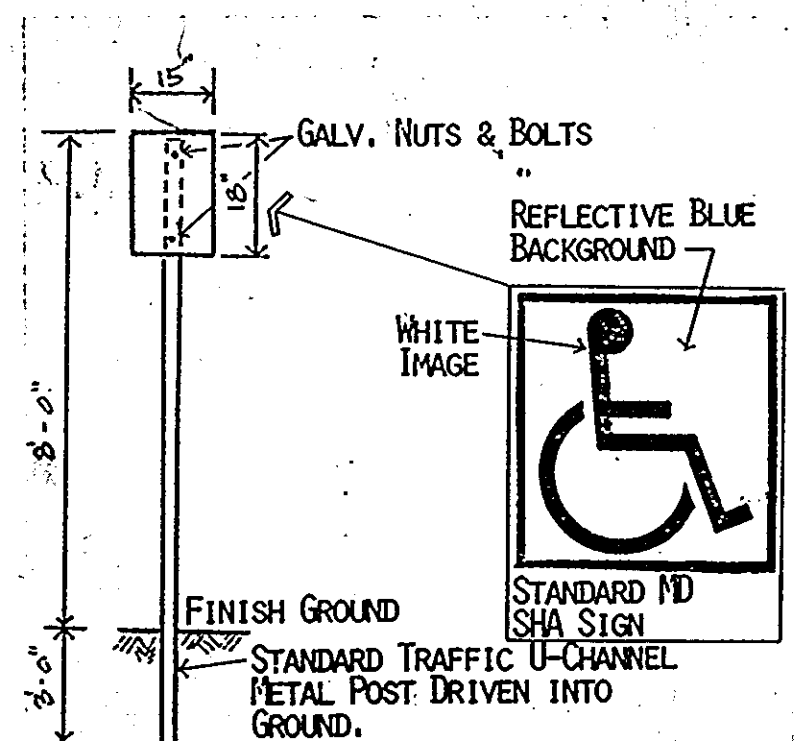

NOTE: WHEELCHAIR SYMBOL TO BE PAINTED ON PARKING SPACE PAVEMENT.

3 HANDICAP PARKING SIGN

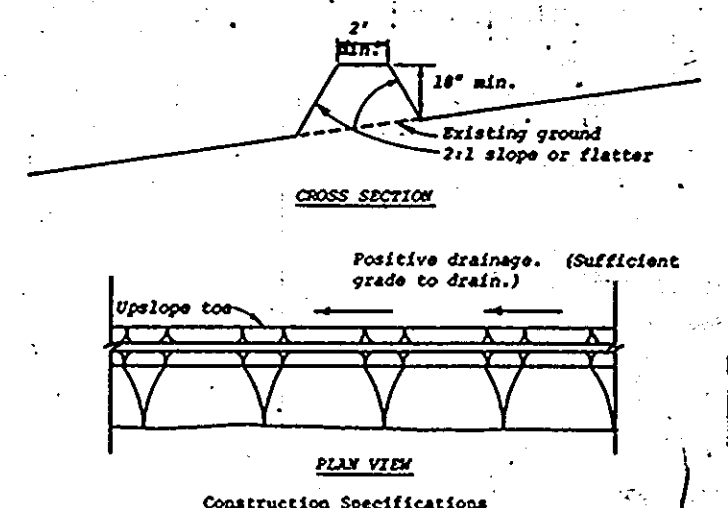

Construction Specifications
 1. All dikes shall be machine compacted.
 2. All perimeter dikes shall have positive drainage to an outlet.
 3. A. Diverted runoff from a protected or stabilized upland area shall outlet directly onto an undisturbed stabilized area or into a level spreader or grade stabilization structure.
 3. B. Diverted runoff from a disturbed or exposed upland area shall be conveyed to a sediment trapping device such as a sediment trap or a sediment basin or to an area protected by any of these structures.
 4. Stabilization, when required, shall be done in accordance with Standard and Specifications for Graded Highway. The minimum area to be stabilized shall be the channel flow area.
 5. Periodic inspection and required maintenance shall be provided.

4 PERIMETER DIKE

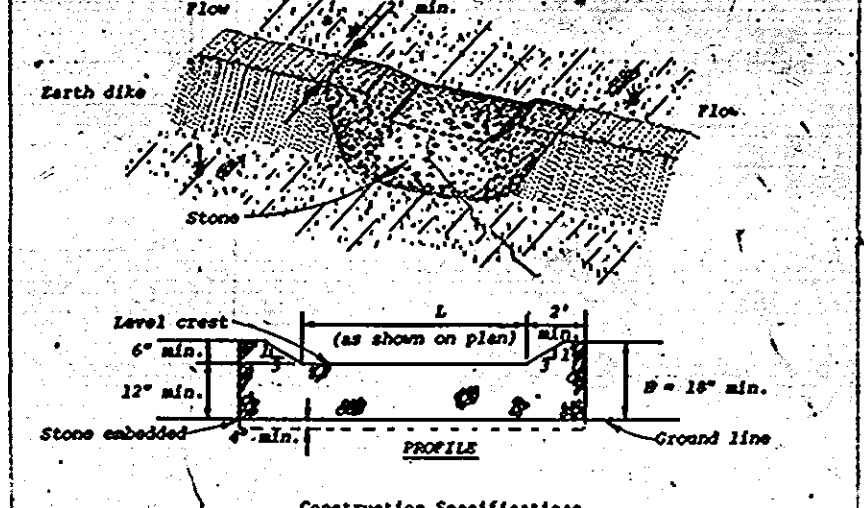

Construction Specifications
 1. The stone shall be crushed stone. Gravel may be used if crushed stone is not available. The stone shall meet MSHA Size No. 2 or ASDSTO designation M3 Size No. 2 or 24.
 2. The crest of the stone dike shall be at least six inches lower than the lowest elevation of the top of the earth dike and shall be level.
 3. The stone outlet structure shall be embedded into the soil a minimum of four inches.
 4. The minimum length, in feet, of the crest of the stone outlet structure shall be equal to six times the number of acres of contributing drainage area.
 5. The stone outlet structure shall be inspected after each rain, and the stone shall be replaced when the structure ceases to function as intended due to silt accumulation among the stones, washout, construction traffic damage, etc.

6 STONE OUTLET STRUCTURE

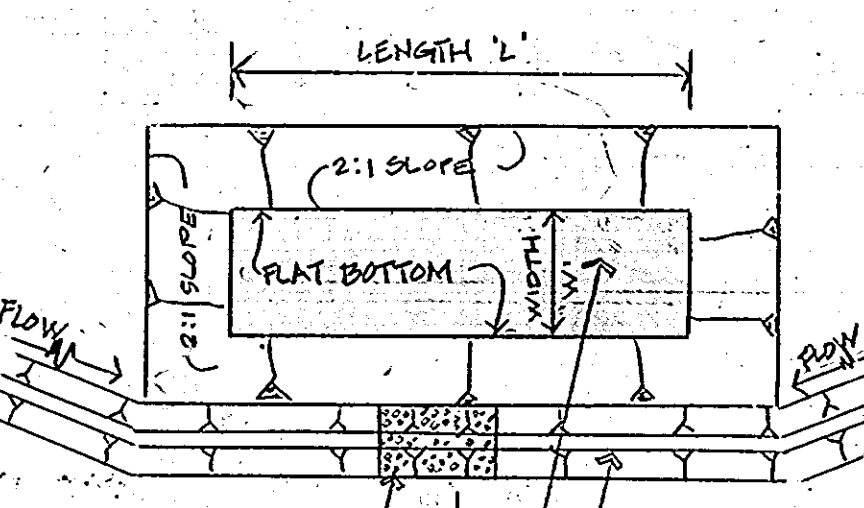

NOTE: FOR CONSTRUCTION DIMENSIONS AND VOLUME SEE SEDIMENT CONTROL DESIGN DATA CHART.

8 SEDIMENT TRAP

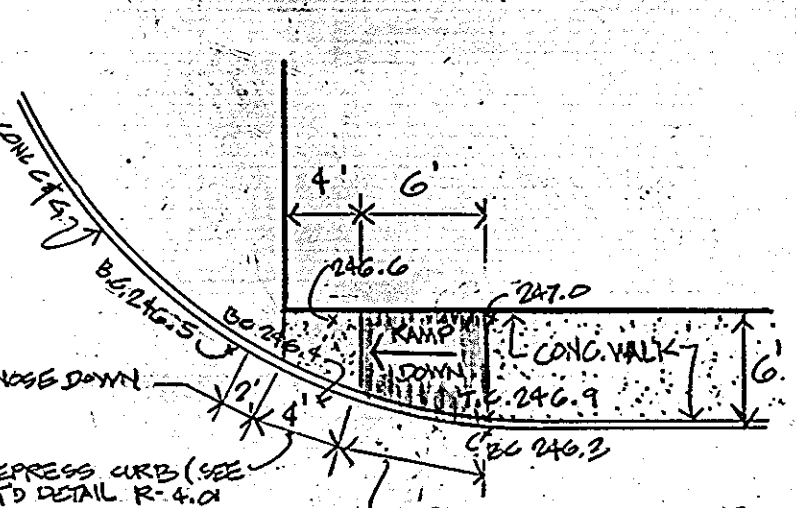

NOTE: FOR CONSTRUCTION DIMENSIONS AND VOLUME SEE SEDIMENT CONTROL DESIGN DATA CHART.

10 RAMP DETAIL (WAREHOUSE #2)

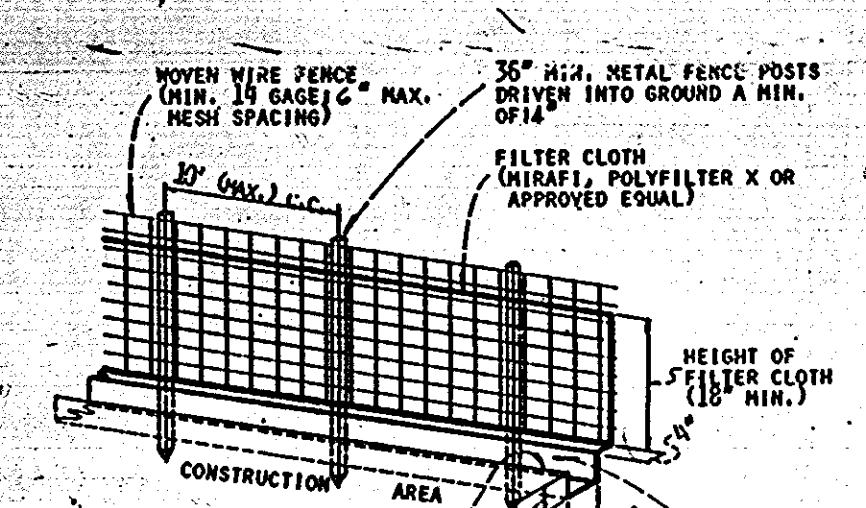

CONSTRUCTION SPECIFICATIONS
 1. WOVEN WIRE FENCE TO BE FASTENED SECURELY TO FENCE POSTS BY USE OF WIRE TIES.
 2. FILTER CLOTH TO BE FASTENED SECURELY TO WOVEN WIRE FENCE BY USE OF WIRE TIES SPACED EVERY 2 TO 3 FEET.
 3. SILT FENCE TO BE PLACED IN LIEU OF STRAW BALES AND/OR DIVERSION DIKES AT THE OPTION OF THE DEVELOPER AND/OR CONTRACTOR.

13 SILT FENCE

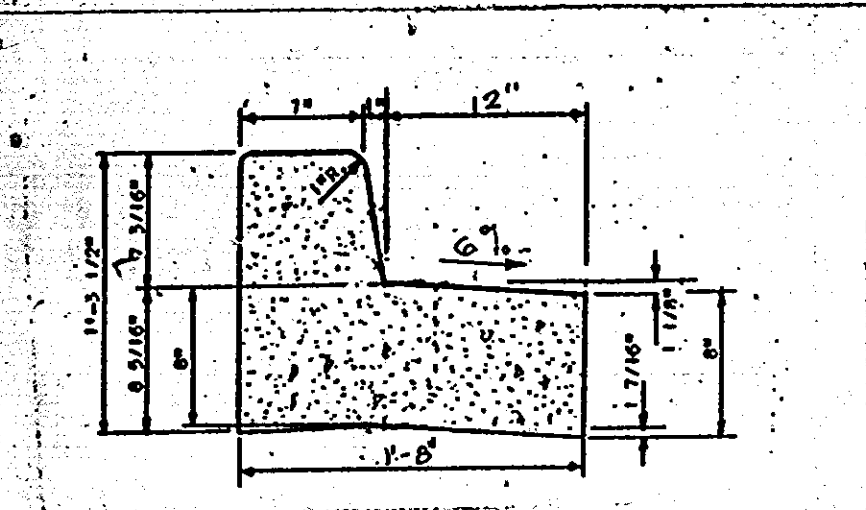

Concrete shall be M.S.H.A. Mix No. 2

14 CONCRETE CURB & GUTTER (REVERSE GUTTER SLOPE)

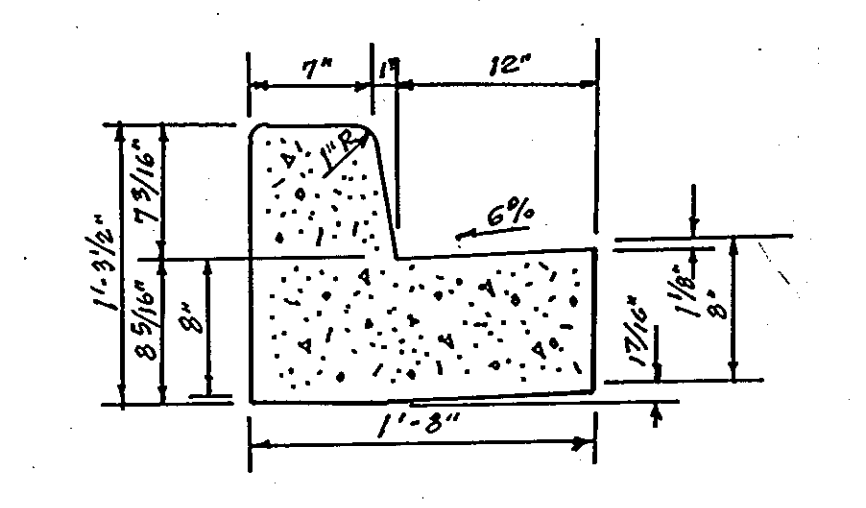

Concrete shall be M.S.H.A. Mix No. 2

CONCRETE CURB & GUTTER (STANDARD GUTTER SLOPE)

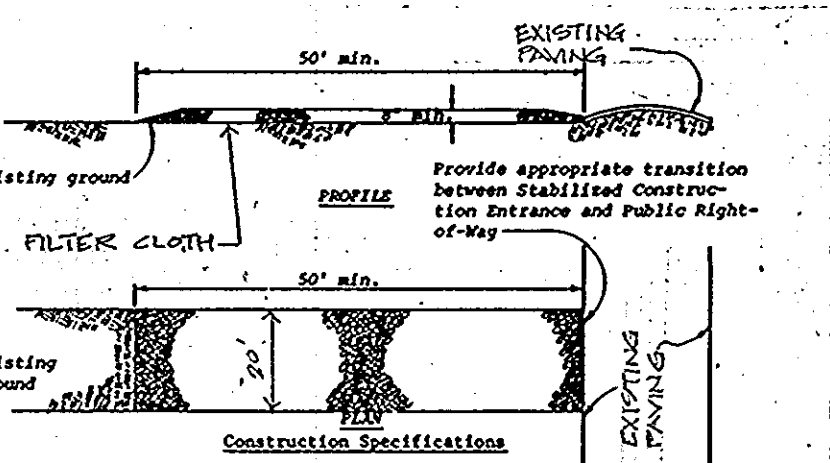

Construction Specifications
 1. Stone size - Use MSHA size No. 2 (2-1/2" to 1") or ASDSTO designation M3, size No. 2 (2-1/2" to 1-1/2"). Use crushed stone.
 2. Length - As effective, but not less than 50 feet.
 3. Thickness - Not less than eight (8) inches.
 4. Width - Not less than full width of all points of ingress or egress.
 5. Warning - When necessary, wheels shall be cleaned to remove sediment prior to entrance onto public right-of-way. When washing is required, it shall be done on an area stabilized with crushed stone which drains into an approved sediment trap or sediment basin. All sediment shall be prevented from entering any storm drain, ditch, or watercourse through use of sand bags, gravel, boards or other approved methods.
 6. Maintenance - The entrance shall be maintained to a condition which will prevent tracking or flowing of sediment onto public right-of-way. This may require periodic top dressing with additional stone as conditions demand and repair and/or cleanup of any measure used to trap sediment. All sediment applied, dropped, washed or tracked onto public right-of-way must be removed immediately.

5 STABILIZED CONSTR. ENTRA.

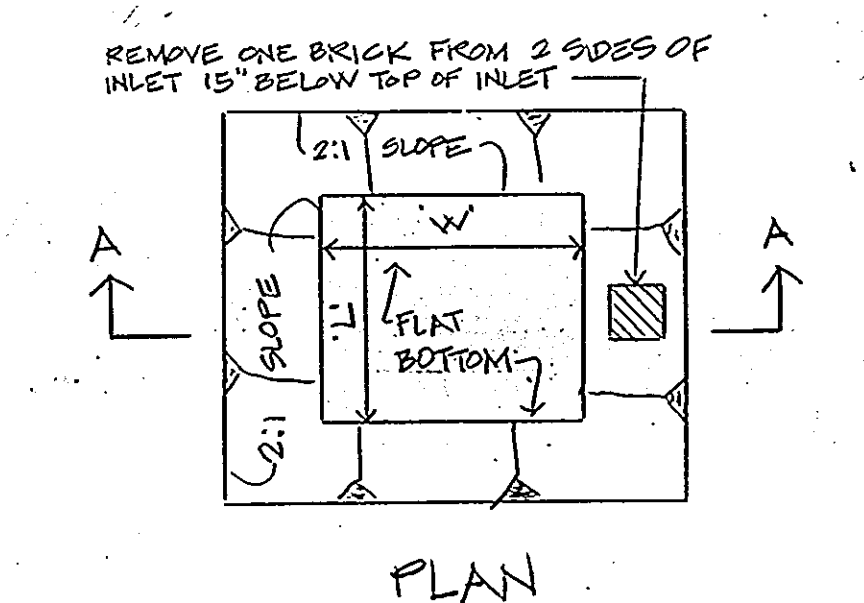

NOTE: SCHEDULING & CONSTRUCTION SEQUENCE OF STORM DRAIN SYSTEM FOR PARCELS 'H' & 'I' SHALL BE COORDINATED BY PROPERTY OWNERS.

7 INLET SEDIMENT TRAP

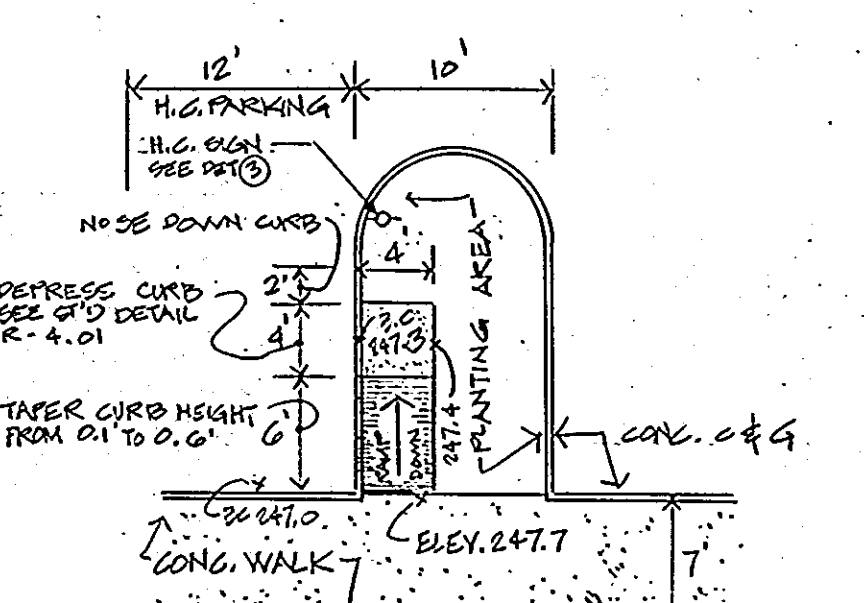

9 RAMP DETAIL (WAREHOUSE #1)

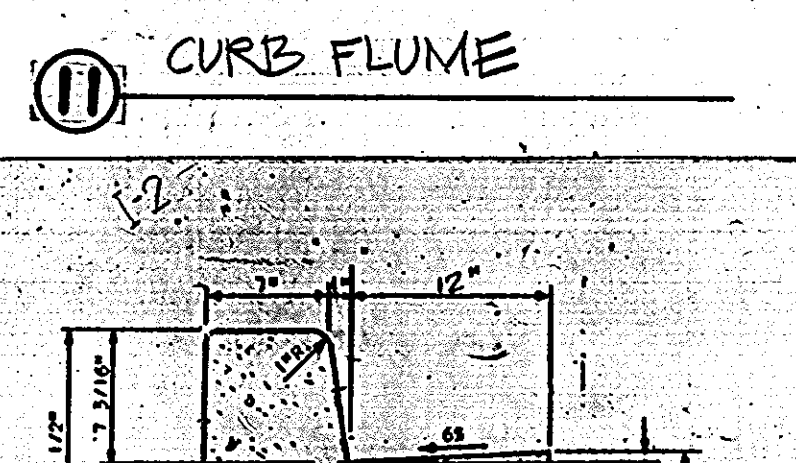

11 CURB FLUME

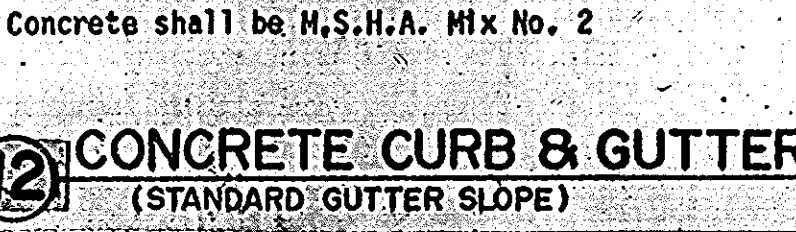

12 CONCRETE CURB & GUTTER (STANDARD GUTTER SLOPE)

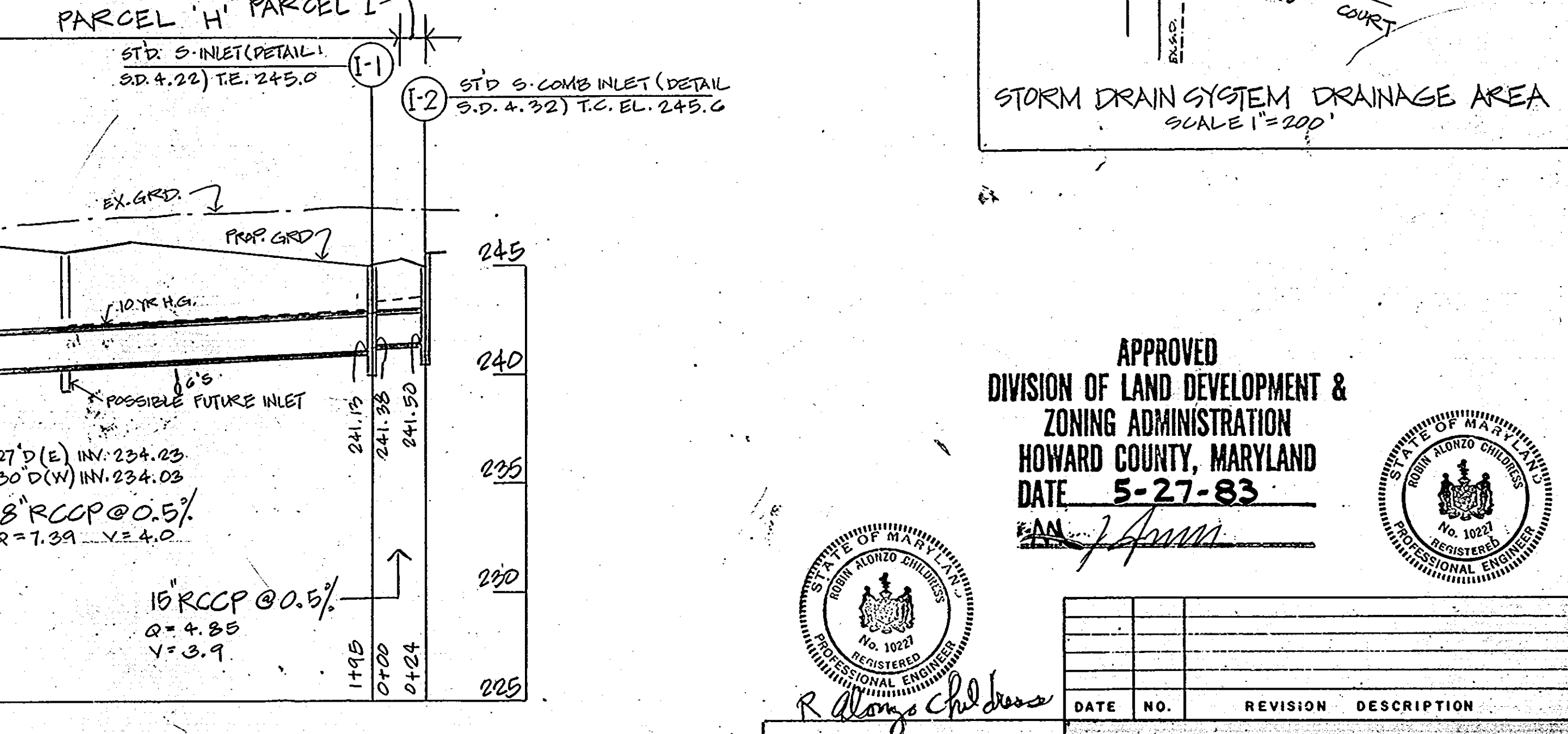
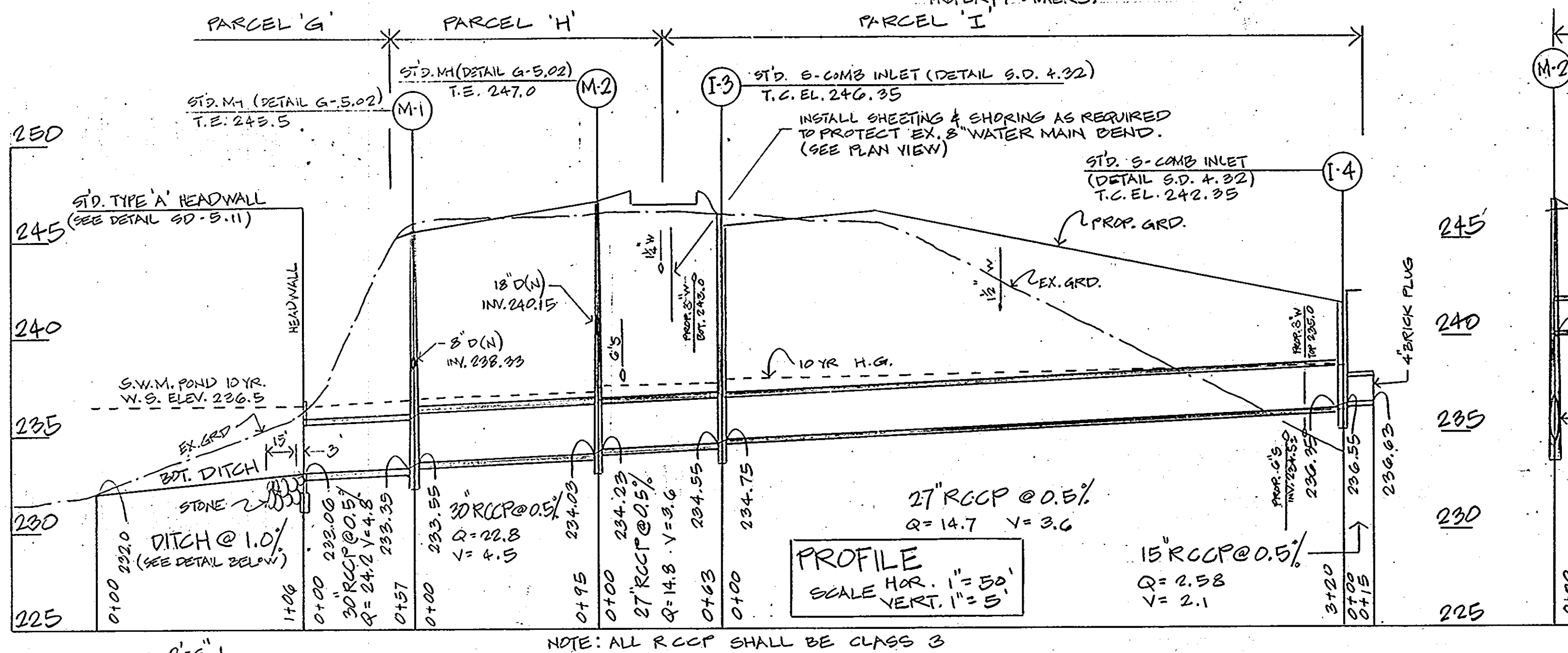

APPROVED FOR PUBLIC WATER & PUBLIC SEWERAGE SYSTEMS, HOWARD COUNTY HEALTH DEPARTMENT
 COUNTY HEALTH OFFICER 9-20-83
 APPROVED HOWARD COUNTY OFFICE OF PLANNING & ZONING 9-21-83
 PLANNING DIRECTOR
 CHIEF DIVISION OF LAND DEVELOPMENT DATE 9-21-83
 APPROVED FOR PUBLIC WATER, PUBLIC SEWERAGE AND STORM DRAINAGE SYSTEMS AND PUBLIC ROADS - HOWARD COUNTY DEPT. OF PUBLIC WORKS
 DIRECTOR, DEPT. OF PUBLIC WORKS DATE 9-13-83
 CHIEF, BUREAU OF ENGINEERING DATE 9-13-83

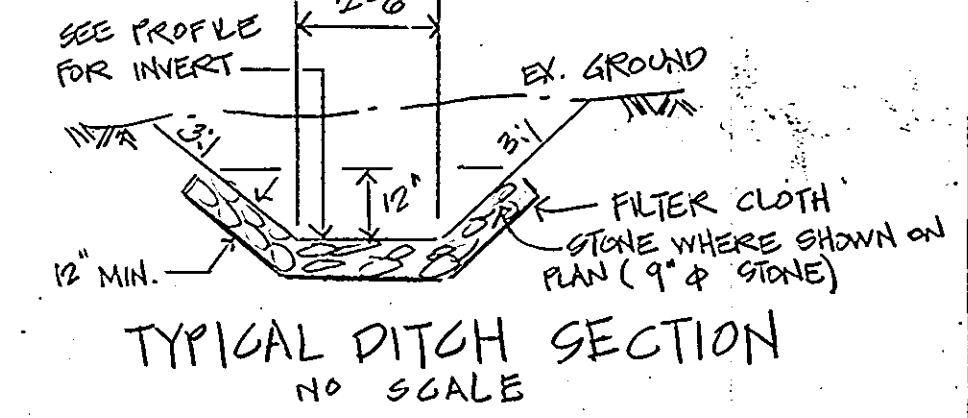

THIS DEVELOPMENT PLAN IS APPROVED FOR SOIL EROSION AND SEDIMENT CONTROL BY THE HOWARD COUNTY CONSERVATION DISTRICT.
 Reviewed for S.C.D. and meets Technical Requirements
 U.S. Soil Conservation Service

"I certify that this plan for erosion and sediment control represents a practical and workable plan based on my personal knowledge of the site conditions and that it was prepared in accordance with the requirements of the Howard Soil Conservation District."
 R. ALBERTO CHILDRRESS
 DATE 2/10/83

"I/we certify that all development and construction will be done according to this plan, and that any responsible personnel involved in the construction project will have a Certificate of Attendance at a Department of Natural Resources Approved Training Program for the Control of Sediment and Erosion before beginning this project."
 Robert H. Merrill
 VICE PRESIDENT
 DATE 2-8-83

PREPARED BY
H. MALMUD & ASSOC. INC.
 6815 MEADOW HEIGHTS RD.
 RANDALLSTOWN, MD. 21133
 TELEPHONE (301) 655-6485



APPROVED
 DIVISION OF LAND DEVELOPMENT & ZONING ADMINISTRATION
 HOWARD COUNTY, MARYLAND
 DATE 5-27-83
 R. ALBERTO CHILDRRESS

DATE	NO.	REVISION	DESCRIPTION

SITE PLAN - Parcel - 1
 Whiskey bottom ind. park
 HOWARD COUNTY, MD.
 ELECTION DISTRICT NO. 6
 DATE 2/10/83 SCALE AS SHOWN SHEET 2 OF 2
 5/1/83