

VICINITY MAP & SOILS MAP  
TAX MAP 37 PARCEL 199 DEED 094/529 SCALE 1"=200'

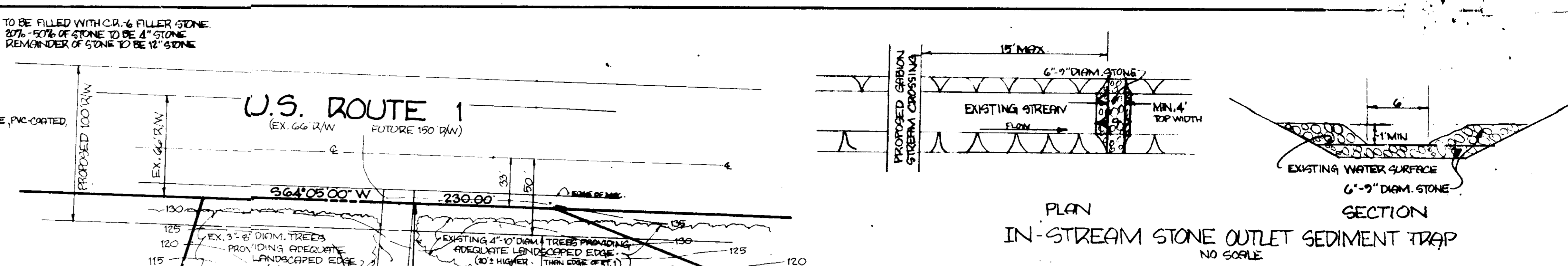

**GENERAL NOTES (CONT.)**  
 12. NO. OF EMPLOYEES REQUIRED: 0  
 13. NO. OF PARKING SPACES REQUIRED: 0  
 14. NO. OF PARKING SPACES ARE DELINEATED ON THE SITE DUE TO GRAVEL SURFACE. GENERAL PARKING AREAS AVAILABLE FOR USE ARE SHOWN ON PLAN. 272 PARKING SPACES ARE AVAILABLE. NO MORE PARKING WILL BE NEEDED FOR EXPLOSIVES STORAGE.  
 15. ALL PARTS OF GRAVEL AREA NOT USED FOR PARKING ARE USED FOR STORAGE OF CONSTRUCTION MATERIALS & EQUIPMENT.

**CONSTRUCTION SEQUENCE**  
 1. OBTAIN GRADING PERMIT.  
 2. INSTALL IN-STREAM SEDIMENT TRAP.  
 3. GRADE DRIVE, INSTALL SILT FENCE & INTERCEPTOR SWALE.  
 4. GRADE AREA AROUND MAGAZINES & INSTALL MAGAZINES.  
 5. STABILIZE GRADED AREAS. REMOVE SILT FENCE & INTERCEPTOR SWALE.  
 6. INSTALL GRAVEL & GABIONS.  
 7. OBTAIN PERMISSION FOR REMOVAL OF IN-STREAM SEDIMENT TRAP FROM SEDIMENT CONTROL INSPECTOR.

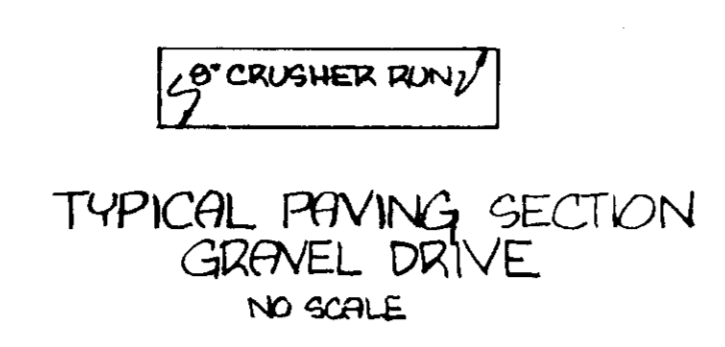
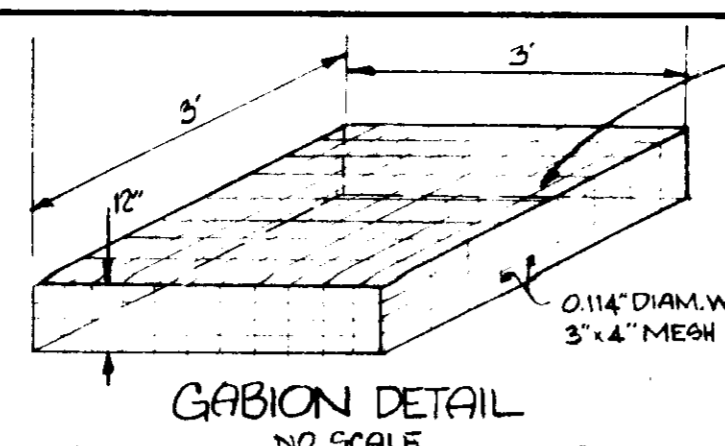
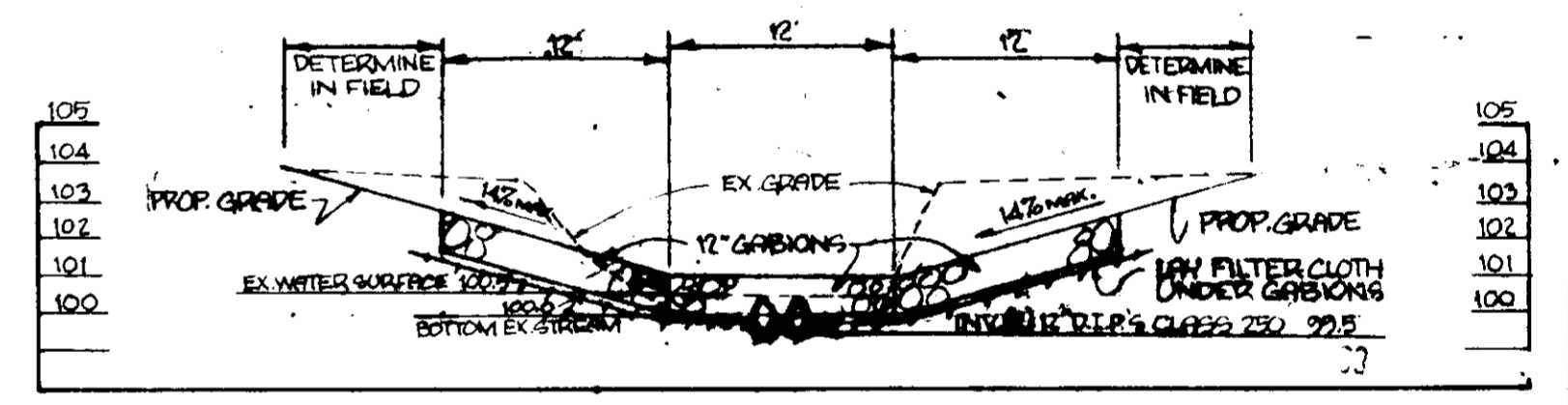
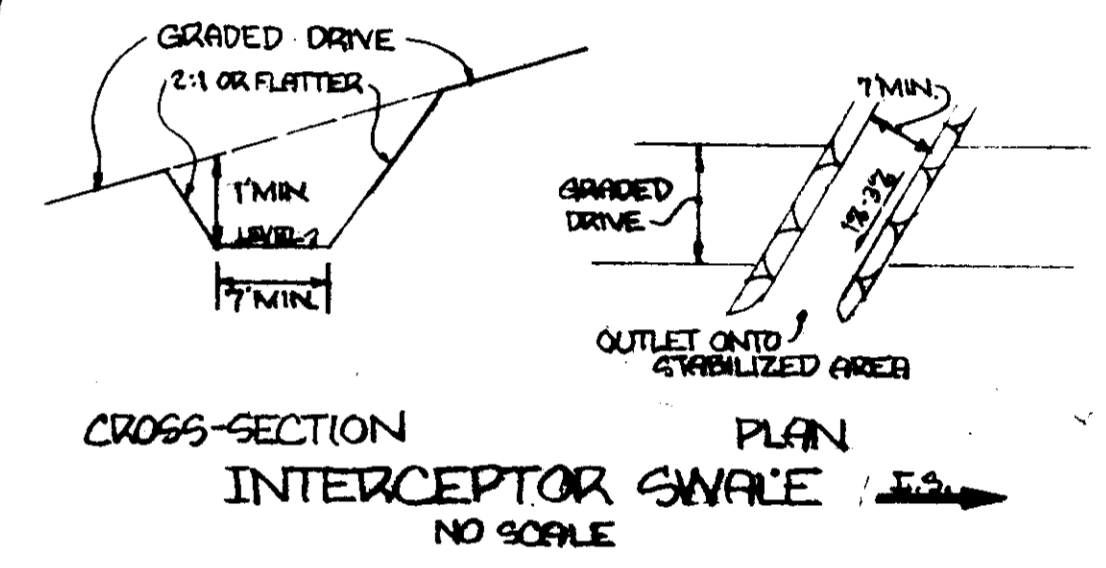

**GENERAL NOTES**  
 1. AREA: 13.64 AC. AREA THIS SUBMISSION: 0.35 AC.  
 2. ZONING: M-2  
 3. EXISTING USE: STORAGE FOR CONSTRUCTION EQUIPMENT  
 4. PROPOSED USE: SAME, PLUS STORAGE OF EXPLOSIVES.  
 5. MAGAZINES TO BE 4" ABOVE 100-YR FLOOD PLAIN ELEVATION 110.0.  
 6. SITE ANALYSIS:  
 AREA TO BE PAVED: 0  
 AREA TO BE GRAVELLED: 0.24 AC.  
 AREA TO BE GRAVEL (NEW): 0.11 AC.  
 AREA TO BE UNDERGRADED: 13.29 AC.  
 7. NO ADDITIONAL PARKING REQUIRED FOR STORAGE OF EXPLOSIVES.  
 8. SEE BOARD OF APPEALS CASE BA-02-34-E.  
 9. CONTRACTOR SHALL HAVE THE RIGHT TO ADJUST THE LOCATION OF GRAVEL ROAD & STREAM CROSSING TO AVOID LARGE TREES.  
 10. ALL CONSTRUCTION WORK ASSOCIATED WITH PROPOSED MAGAZINES SHALL BE IN ACCORDANCE WITH NATIONAL FIRE CODE PARAPHLET #4095.  
 11. MAXIMUM STORAGE: 500 LBS. OF CLASS B EXPLOSIVES.  
 \* SEE CONTINUATION OF NOTES UPPER RIGHT CORNER OF THIS SHEET \*

**SEDIMENT CONTROL & SEEDING NOTES**  
 1. SILT FENCE TO BE INSTALLED PRIOR TO ANY GRADING.  
 2. NOTIFY HOWARD COUNTY BUREAU OF INSPECTIONS & HOWARD SOIL CONSERVATION DISTRICT 48 HRS. BEFORE STARTING WORK.  
 3. ON-SITE INSPECTION & MAINTENANCE OF SILT FENCE & ESTABLISHMENT OF ALL VEGETATIVE MEASURES ARE THE RESPONSIBILITY OF THE DEVELOPER OR HIS PERSONAL REPRESENTATIVE.  
 4. PERMANENT SEEDING:  
 a. APPLY 50 LBS./1000<sup>2</sup> OF LIMESTONE  
 b. APPLY 25 LBS./1000<sup>2</sup> OF 10-10-10 FERTILIZER  
 c. HARROW OR DISC INTO SOIL TO 3" DEPTH  
 d. SEED WITH 1 LB./1000<sup>2</sup> OF KENTUCKY 31 FESCUE AND 0.5 LB./1000<sup>2</sup> OF CROWN VETCH  
 e. MULCH WITH SMALL-GRAIN STRAW @ 75 LBS./1000<sup>2</sup>  
 f. ANCHOR MULCH WITH GRAVEL ASPHALT AT 0.1 GAL./SQ. YD. (11 GAL./1000<sup>2</sup>).

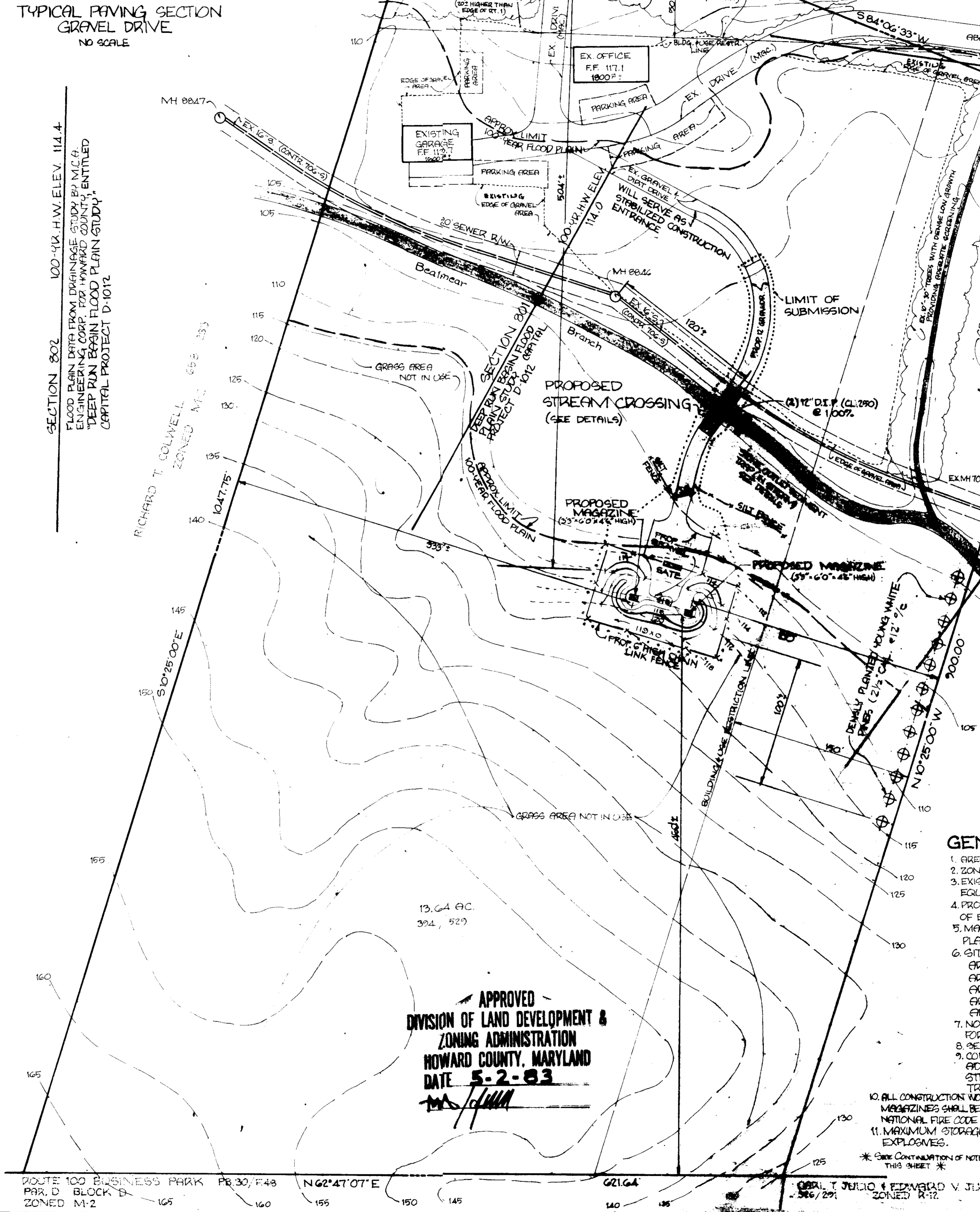

APPROVED  
 DIVISION OF LAND DEVELOPMENT & ZONING ADMINISTRATION  
 HOWARD COUNTY, MARYLAND  
 DATE 5-2-83

**DEVELOPER'S CERTIFICATE**  
 HEREBY CERTIFY THAT ALL DEVELOPMENT AND CONSTRUCTION WILL BE DONE ACCORDING TO THIS PLAN OF DEVELOPMENT AND PLAN FOR EROSION & SEDIMENT CONTROL, AND THAT ALL RESPONSIBLE PERSONNEL INVOLVED IN THE CONSTRUCTION PROJECT WILL HAVE A CERTIFICATE OF ATTENDANCE AT A DEPT. OF NATURAL RESOURCES APPROVED TRAINING PROGRAM FOR THE CONTROL OF SEDIMENT & EROSION BEFORE BEGINNING THE PROJECT. I ALSO AUTHORIZE PERIODIC ON-SITE INSPECTIONS BY THE HOWARD SOIL OR THEIR AUTHORIZED AGENTS AS ARE DEEMED NECESSARY.

DEVELOPER'S SIGNATURE: *W. Wilson* DATE: 5-2-83

APPROVED FOR SOIL EROSION & SEDIMENT CONTROL... HOWARD SOIL CONSERVATION DISTRICT. DATE: 5-24-83

REVIEWED FOR HOWARD SOIL CONSERVATION DISTRICT & MEETS TECHNICAL REQUIREMENTS. DATE: 5/24/83

APPROVED NO SEWER OR WATER PROPOSED STORAGE ONLY. DATE: 6-9-83

APPROVED HOWARD COUNTY OFFICE OF PLANNING & ZONING. DATE: 6-10-83

APPROVED FOR STORM DRAINAGE SYSTEMS & PUBLIC ROADS. DATE: 6-9-83

**ENGINEER'S CERTIFICATE**  
 I CERTIFY THAT THIS PLAN FOR EROSION & SEDIMENT CONTROL REPRESENTS A PRACTICAL & WORKABLE PLAN BASED ON MY PROFESSIONAL KNOWLEDGE OF THE SITE CONDITIONS, AND THAT IT WAS PREPARED IN ACCORDANCE WITH THE REQUIREMENTS OF THE HOWARD SOIL CONSERVATION DISTRICT.

ENGINEER'S SIGNATURE: *Malcolm Hookins* DATE: 5-2-83

DEVELOPER: W.F. WILSON & SONS, INC. 3419 PLUMTREE DRIVE ELLICOTT CITY, MD 21043

OWNER: JOHN FREEZER, JR. & REULAH M. FREEZER 6607 WASHINGTON BLVD. ELKRIIDGE, MD 21227

ENGINEER: HOOKINS ASSOCIATES, INC. 231 JOSEPH SQUARE COLUMBIA, MARYLAND 21044

**SITE DEVELOPMENT PLAN**  
 JOHN F. FREEZER, JR. PROPERTY  
 W.F. WILSON & SONS, INC. EXPLOSIVES STORAGE FACILITY  
 PARCEL 199  
 1<sup>ST</sup> ELECTION DISTRICT HOWARD COUNTY, MD.  
 SCALE: 1"=50' FEB. 8, 1983 REV. 4/7/83  
 TAX MAP 37, PARCEL 199 DEED: 394/529