

PLAN DRIVEWAY ABUTTING MODIFIED CURB & GUTTER

- ALTERNATE #1
1" Bit Conc Surface
2" Bit Conc Base
6" Gravel
- ALTERNATE #2
1" Bit Conc Surface
4" Bit Conc Base
3" Gravel
- ALTERNATE #3
1" Bit Conc Surface
3" Bit Conc Base
3" Gravel

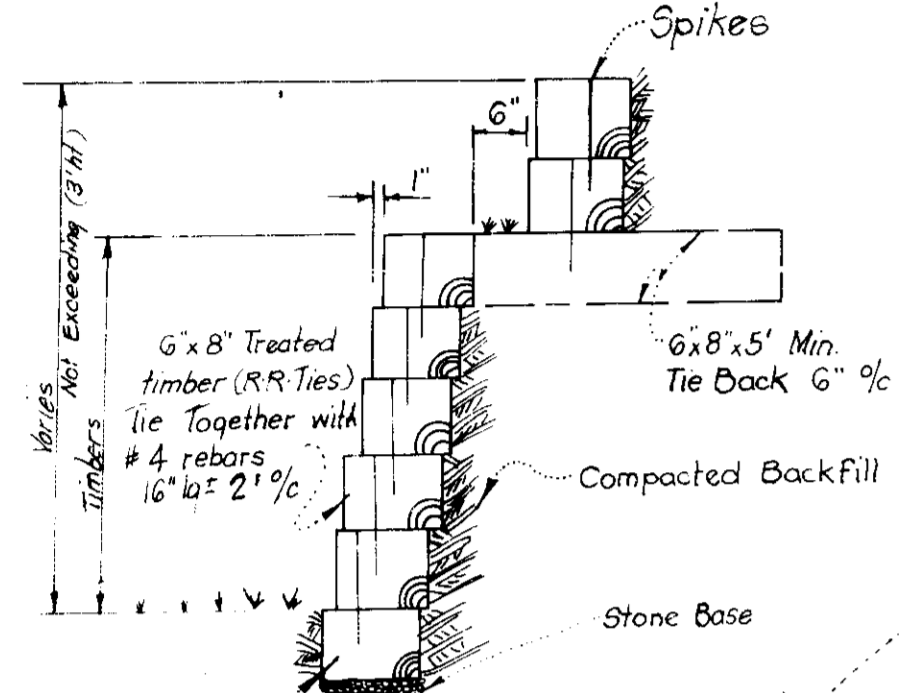

TIMBER RETAINING WALL

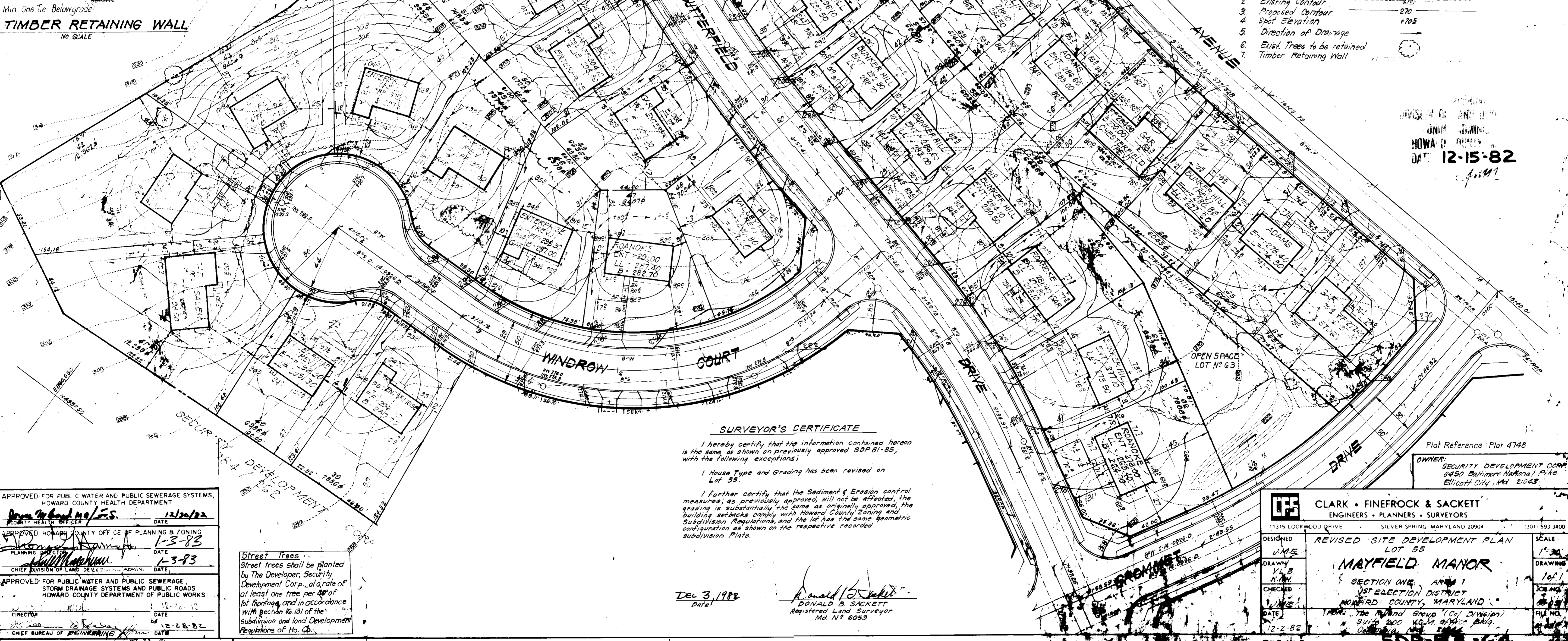

GENERAL NOTES

- The Land included in this plan is zoned: R.S.C.
- Coordinates shown are extensions made from the Maryland State Plane Coordinate System Bearings refer to true north and are based on Howard County Geodetic Survey Monument No. 244.0003.
- The area covered in this submission is located on Tax Map #37.
- The total area included on this plan is 0.138 Acres.
- All roadways are public and existing.
- Any damage to county owned rights of way shall be corrected at the developer's expense.
- Total Number of Lots: 1

LEGEND:

- Contour Interval 2 FT
- Existing Contour (dashed line)
- Proposed Contour (solid line)
- Spot Elevation (+705)
- Direction of Drainage (arrow)
- Exist. Trees to be retained (circle with cross)
- Timber Retaining Wall (rectangle with cross)

SURVEYOR'S CERTIFICATE

I hereby certify that the information contained hereon is the same as shown on previously approved SDP 81-85, with the following exceptions:

- House Type and Grading has been revised on Lot 55.

I further certify that the Sediment & Erosion control measures, as previously approved, will not be affected, the grading is substantially the same as originally approved, the building setbacks comply with Howard County Zoning and Subdivision Regulations, and the lot has the same geometric configuration as shown on the respective recorded subdivision Plats.

Dec 3, 1982
Date

Donald B. Sackett
Registered Land Surveyor
Md. No. 6059

HOWARD COUNTY ENGINEERS
DATE 12-15-82

Plot Reference: Plat 4748
OWNER: SECURITY DEVELOPMENT CORP.
6490 Baltimore National Pike
Ellicott City, Md 21043

APPROVED FOR PUBLIC WATER AND PUBLIC SEWERAGE SYSTEMS, HOWARD COUNTY HEALTH DEPARTMENT	DATE 12/20/82
APPROVED HOWARD COUNTY OFFICE OF PLANNING & ZONING	DATE 1-3-83
APPROVED FOR PUBLIC WATER AND PUBLIC SEWERAGE, STORM DRAINAGE SYSTEMS AND PUBLIC ROADS HOWARD COUNTY DEPARTMENT OF PUBLIC WORKS	DATE 12-28-82

Street Trees
Street trees shall be planted by The Developer, Security Development Corp., at a rate of at least one tree per 40' of lot frontage, and in accordance with section 16.131 of the Subdivision and Land Development Regulations of Ho. Co.

CLARK • FINEFROCK & SACKETT
ENGINEERS • PLANNERS • SURVEYORS
11315 LOCKWOOD DRIVE SILVER SPRING MARYLAND 20904 (301) 593-3400

DESIGNED: J.M.S.
DRAWN: V.L.B., M.M.M.
CHECKED: J.M.S.
DATE: 12-2-82

REVISED SITE DEVELOPMENT PLAN
LOT 55
MAYFIELD MANOR
SECTION ONE, AREA 1
1ST ELECTION DISTRICT
HOWARD COUNTY, MARYLAND
The National Group (Local Division)
Suite 200 N.W. Office Bldg.
Columbia, Md. 21046

SCALE: 1" = 20'
DRAWING NO: 08-14
JOB NO: SDP-83-64