

LISBON SCHOOL
133/189, 213/589, 227/356
ZONED 'R'

NOTE:
FOR ELEVATION DETAIL OF BUILDING
SEE SHEET 2 OF 3

NOTE 'A':
PLACE 46 L.F. OF CONCRETE
CURB, FOR DETAIL SEE
SHEET 3 OF 3. DEPRESS
CURB AT RAMP FOR DETAIL
SEE SHEET 2 OF 3.

NOTE 'B':
EXIST. PROPOSED CONCRETE SIDEWALK
FOR SIDEWALK DETAIL SEE
THIS SHEET.

NOTE 'C':
EXIST. PROPOSED (4) HANDICAPPED
PARKING SPACES PER
ARTICLE 41, SECTION 257JK OF
THE ANNOTATED CODE OF
MARYLAND. PROVIDE SIGN AT EACH SPACE.

SEPTIC SYSTEM NOTE
IN ORDER TO USE THE EFFLUENT AREA UPHILL FROM
THE PROPOSED SEPTIC SYSTEM FOR THE BUILDING,
AS SHOWN HEREON, A PUMP SHALL BE INSTALLED TO
PUMP THE SEPTIC TANK EFFLUENT TO THE
REQUIRED ELEVATION.

IT IS SUBJECT TO THE APPROVAL OF THE COUNTY
HEALTH DEPARTMENT AND ALL OTHER COUNTY
AGENCIES HAVING JURISDICTION.

NOTE 'F':
EXIST. DENOTES EXISTING EXTERIOR LIGHTING
TO BE INSTALLED UNDER THIS CONTRACT.

FUTURE DENOTES FUTURE EXTERIOR LIGHTING
FOR DETAIL SEE SHEET SD-2 OF SD-3

NOTE 'D':
SEPTIC TANK AND GREASE TRAP
SHALL BE REINFORCED PRECAST
CONCRETE WITH:
a) WALLS 4" THICK (MIN.) 6"x6"x6" W/M
b) TOP SLAB 6" THICK (MIN.) #4 BARS @
6" E.W. (4) #4 BARS @ 6" O/C
c) CONCRETE STRENGTH = 4,000 PSI (28 DAY)
d) 24" INCHES DIA. ACCESS MANHOLES
SEPTIC TANK, GREASE TRAP, AND
DISTRIBUTION BOX SHALL BE AS
MANUFACTURED BY YORK CONCRETE
SEPTIC TANKS CO. OR APPROVED
EQUVAL.

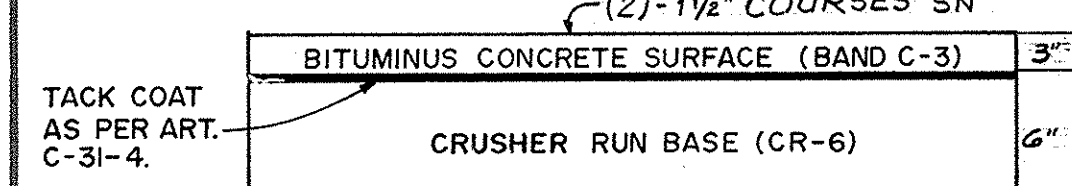

HOWARD COUNTY STANDARD (DWG. D-13 PG.68)
CLEARING & GRADING ART. C-1
SUBGRADE ART. C-2
BASE COURSE ART. C-25
SURFACE ART. C-31

9" PAVING SECTION

NO SCALE
(PRIVATE MAINTAINED AREAS ONLY)
(ALTERNATE FOR HOWARD CO. DWG. D-13, PG.68)

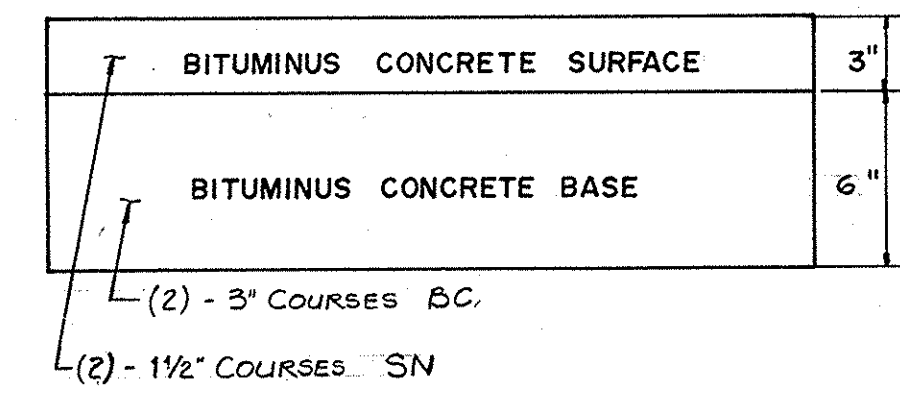

DETAIL 'A'

NO SCALE
(FOR ENTRANCE IMPROVEMENT)
PER MARYLAND S.H.A. STANDARDS

SIDEWALK DETAIL

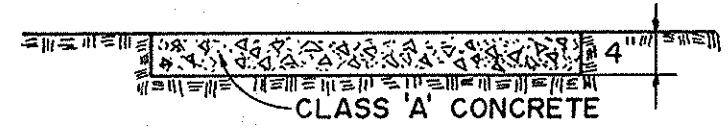

NO SCALE

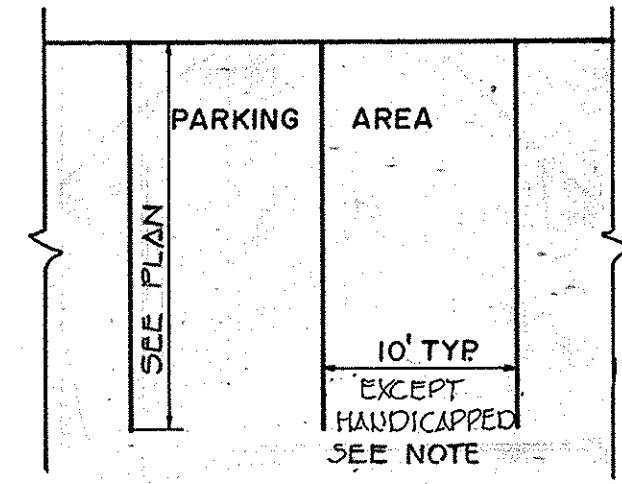

PARKING PLAN

NOTE:
PARKING SPACE WIDTH FOR
HANDICAPPED SPACES IS 12.0'

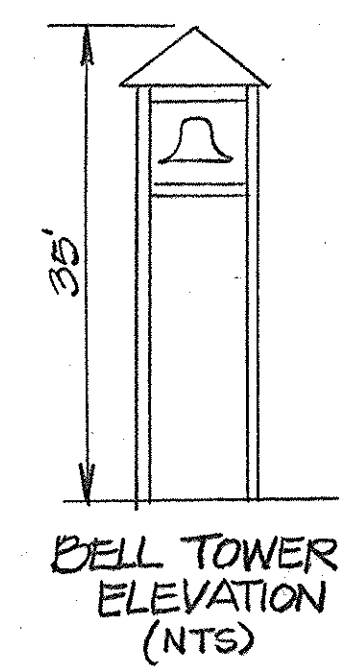

BELL TOWER
ELEVATION
(NTS)

GENERAL NOTES:

- TAX MAP 7, PARCEL 484
- DEED REFERENCE: 920/721 RECORDED PLAT 4191
- THIS AREA DESIGNATES A PRIVATE SEWAGE EASEMENT OF APPROX. 10,000 SQ. FT. AS REQUIRED BY THE MARYLAND STATE DEPT. OF HEALTH & MENTAL HYGIENE FOR INDIVIDUAL SEWAGE DISPOSAL. IMPROVEMENTS OF ANY NATURE IN THIS AREA ARE RESTRICTED UNTIL PUBLIC SEWAGE IS AVAILABLE & SERVICING THE STRUCTURES ON THIS SITE. THIS EASEMENT SHALL BECOME NULL & VOID UPON CONNECTION TO A PUBLIC SEWAGE SYSTEM. (CONT. SEE NOTE #14)
- THIS PLAT IS SUBJECT TO VP-79-22
- ALL WORK SHALL BE PERFORMED IN ACCORDANCE WITH THE HOWARD COUNTY ROAD CONSTRUCTION CODE & STANDARD SPECIFICATIONS.
- THE LOCATION OF EXISTING UTILITIES SHOWN HEREON IS NOT GUARANTEED. THE CONTRACTOR SHALL TAKE ALL NECESSARY PRECAUTIONS TO PROTECT THE EXISTING UTILITIES & MAINTAIN UNINTERRUPTED SERVICE. THE EXISTENCE OF UTILITIES OTHER THAN THOSE SHOWN HEREON IS NOT KNOWN. THE CONTRACTOR SHALL IMMEDIATELY NOTIFY THE APPROPRIATE UTILITY COMPANY IF OTHER UTILITIES ARE ENCOUNTERED. ANY DAMAGES WILL BE REPAIRED AT THE CONTRACTOR'S EXPENSE & UNDER THE DIRECTION OF THE UTILITY COMPANY.
- ALL WATER AND SEWER WORK AND MATERIALS SHALL BE IN ACCORDANCE WITH THE HOWARD COUNTY PLUMBING CODE AND HEALTH DEPARTMENT REGULATIONS.
- THE CONTRACTOR IS TO NOTIFY THE FOLLOWING UTILITIES AT LEAST 72 HOURS BEFORE STARTING WORK SHOWN ON THESE DRAWINGS.
BELL TELEPHONE SYSTEM 363-3649
LONG DISTANCE CABLE DIV. 393-3553 or 3554
BALTO. GAS & ELECT. CO. 539-8000 ext. 691
- PETITIONER SHALL COMPLY WITH ALL APPLICABLE FEDERAL, STATE, AND COUNTY LAWS AND REGULATIONS.
- TOTAL DISTURBANCE OF 1,348 SQ. FT. REQUIRES 15% AFFORESTATION = 202 SQ. FT. FOREST CONSERVATION OBLIGATIONS WITH WELL & SEPTIC WELL BE PROVIDED WITH A FEE IN LIEU PAYMENT AT \$0.95 S.F. = \$192.09

PAVILION ELEVATION (NTS)

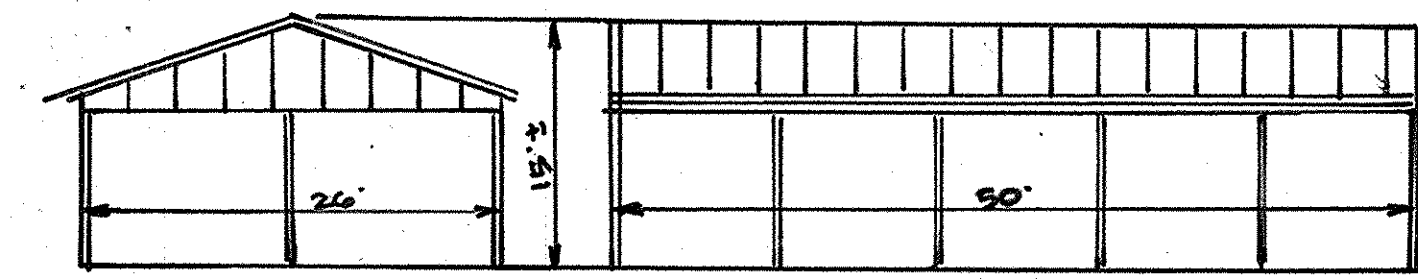

- ALL ELEVATIONS SHOWN HEREON ARE BASED ON ASSUMED DATUM.
- ALL FILL AREAS UNDER PAVEMENT SHALL BE COMPACTED TO A MIN. 95% OF OPTIMUM COMPACTION PER A.A.S.H.T.O. T-190
- ALL EXCESS EXCAVATION TO BE PLACED ON SITE. ALL DISTURBED AREAS SHALL RECEIVE 2" TOPSOIL SEED AND MULCH.
- SITE ANALYSIS:
 - a. AREA OF PARCELS 4.129 AC.
 - b. PRESENT ZONING 'R' RC-DEO
 - c. SEATING CAPACITY 282
 - d. FLOOR SPACE
FIRST FLOOR 5036 Sq. Ft.
BASEMENT 5036 Sq. Ft.
FLOOR AREA OF ASSEMBLY SPACE OPEN TO THE PUBLIC 2800' sq. ft.
 - e. NOS. PARKING SPACES REQUIRED 28 94 (15 SPACE/3 SEATS)
 - f. NOS. PARKING SPACES PROVIDED 94 96
 - g. BUILDING & PAVING COVERAGE 51087 sq. ft. or 25%

- DENOTES ORIGINAL PERC LOCATIONS PER HEALTH DEPARTMENT APPLICATION #28800.
O DENOTES NEW PERC LOCATIONS (FIELD LOCATED)
- THE COUNTY HEALTH OFFICER SHALL HAVE THE AUTHORITY TO GRANT VARIANCES FOR ENCROACHMENTS INTO THE PRIVATE SEWAGE EASEMENT. RECORDATION OF A MODIFIED SEWAGE EASEMENT SHALL NOT BE NECESSARY.
- BA CASE 13-0710 APPROVED ON JANUARY 21, 2014 TO EXPAND AN APPROVED CONDITIONAL USE BY ERECTING AN 1,800 S.F. RECTANGULAR PAVILION TO THE EAST OF THE EXISTING FACILITY PER THE FOLLOWING CONDITIONS:
 - THE CONDITIONAL USE SHALL BE CONDUCTED IN CONFORMANCE WITH AND SHALL APPLY ONLY TO THE RELIGIOUS FACILITY AND BUREAU FACILITY AS DESCRIBED IN PETITION AND DETAIL ON THE PLAN ACCEPTED BY OPE ON OCTOBER 23, 2011 AND NOT TO ANY OTHER ACTIVITIES OR STRUCTURES ON THE TRACTED ON.
 - PETITIONER SHALL COMPLY WITH ALL AGENCY COMMENTS.

APPROVED
DIVISION OF LAND DEVELOPMENT

HOWARD COUNTY, MARYLAND

DATE 10-17-80

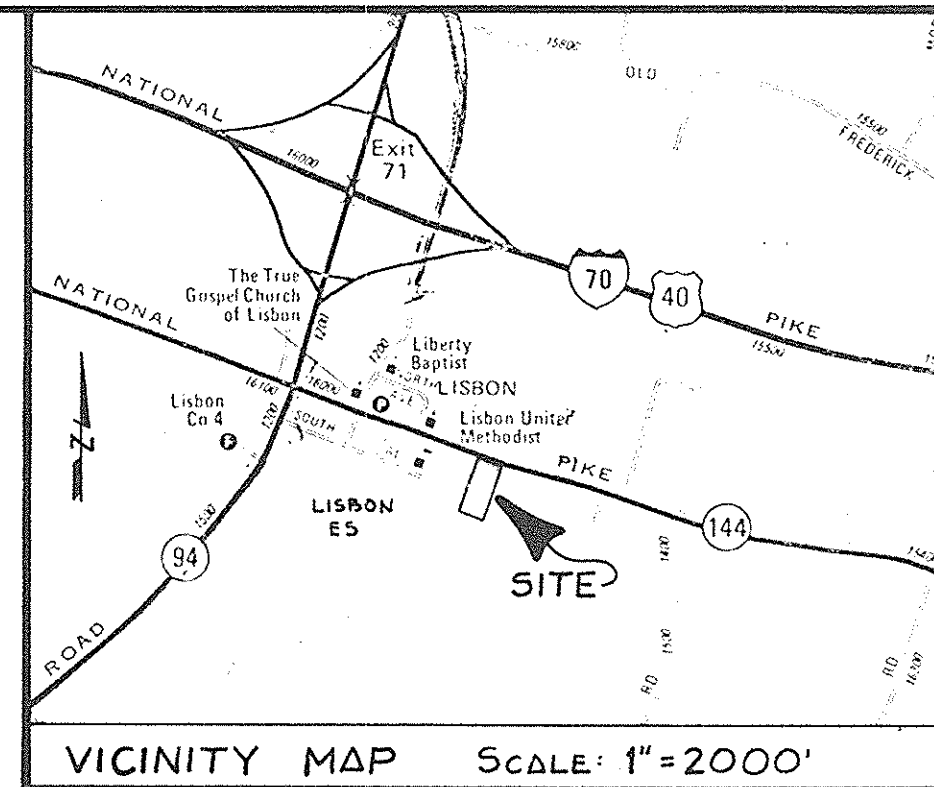

VICINITY MAP SCALE: 1"=2000'

REVISION #4
9/2/2014 ADD PROPOSED PAVILION DOCUMENT EXISTING CONDITIONS

VANMAR ASSOCIATES, INC.
ENGINEERS SURVEYORS PLANNERS
310 SOUTH MAIN STREET, MOUNT AIRY, MARYLAND, 21771
(301) 629-2890 (301) 631-5015 (410) 549-2751
© Copyright, Latest Data Shown

REV. 6/25/03 ADD BELL TOWER PER

APPROVED: FOR PRIVATE WATER AND PRIVATE SEWAGE SYSTEMS, HOWARD COUNTY HEALTH DEPARTMENT

Joseph Boyles 1-23-81
County Health Officer Date

APPROVED: HOWARD COUNTY OFFICE OF PLANNING & ZONING
Thomas St. Amie 1-29-81
Planning Director Date

John M. Mendenhall 1-28-81
Chief Division of Land Development Date

APPROVED: FOR STORM DRAINAGE SYSTEMS AND PUBLIC ROADS
HOWARD COUNTY DEPARTMENT OF PUBLIC WORKS

Henry F. Nummy 1-29-81
Director Date

William E. Rahn 1-28-81
Chief Bureau of Engineering Date

11/14/80 2 REV. PER CO. COMMENTS DATED 10/18/80

3/5/80 1 REV. PER COUNTY COMMENTS

DATE	NO.	REVISION DESCRIPTION
		OWNER LISBON UNITED METHODIST CHURCH MD. RTE. 144 LISBON, MARYLAND 21765
		DEVELOPER LISBON UNITED METHODIST CHURCH MD. RTE. 144 LISBON, MARYLAND 21765

PROJECT:
LISBON UNITED METHODIST CHURCH
FREEMAN PROPERTY, LOT 4, MD. RT. 144

AREA:
4TH ELECTION DISTRICT
HOWARD COUNTY, MARYLAND

TITLE:
SITE PLAN

TYDINGS HEIM ASSOCIATES INC.
CONSULTING ENGINEERS-LAND & CONSTRUCTION SURVEYORS
8370 COURT AVENUE, ELLICOTT CITY, MD. 21043 465-0660

1-9-81 DATE
DESIGNED BY: C.R.C.
DRAWN BY: J.P.O.
PROJECT NO: 569
DATE: MAY 13, 1980
SCALE: 1"=30'
DRAWING NO SD-1 OF SD-3

Charles R. Cocher
PROFESSIONAL ENGR. NO. 7893

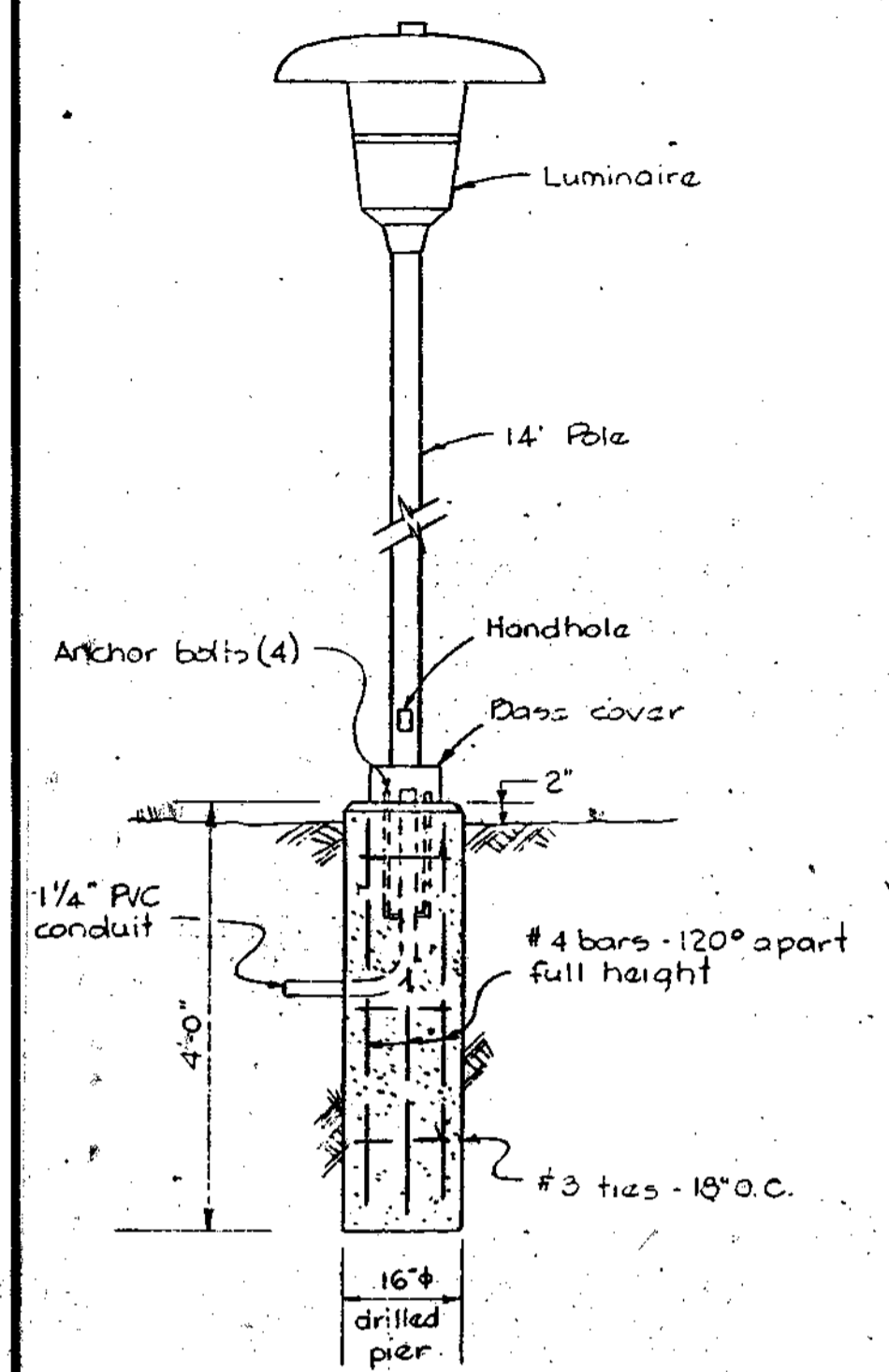

DETAIL OF TYPE "Q" FIXTURE
No Scale

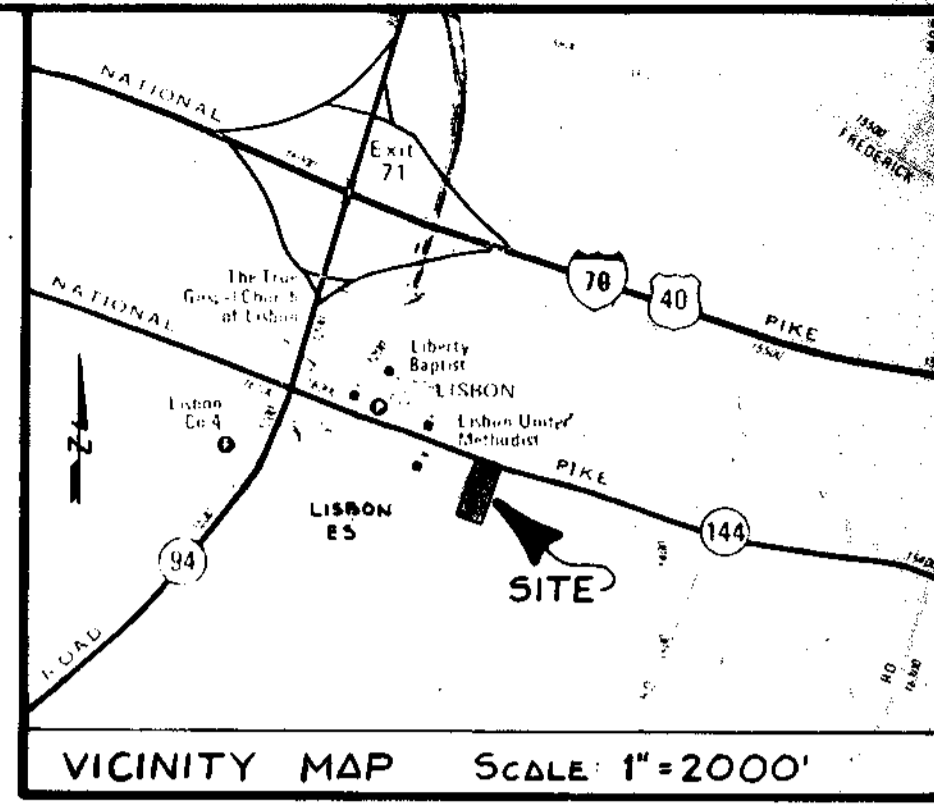
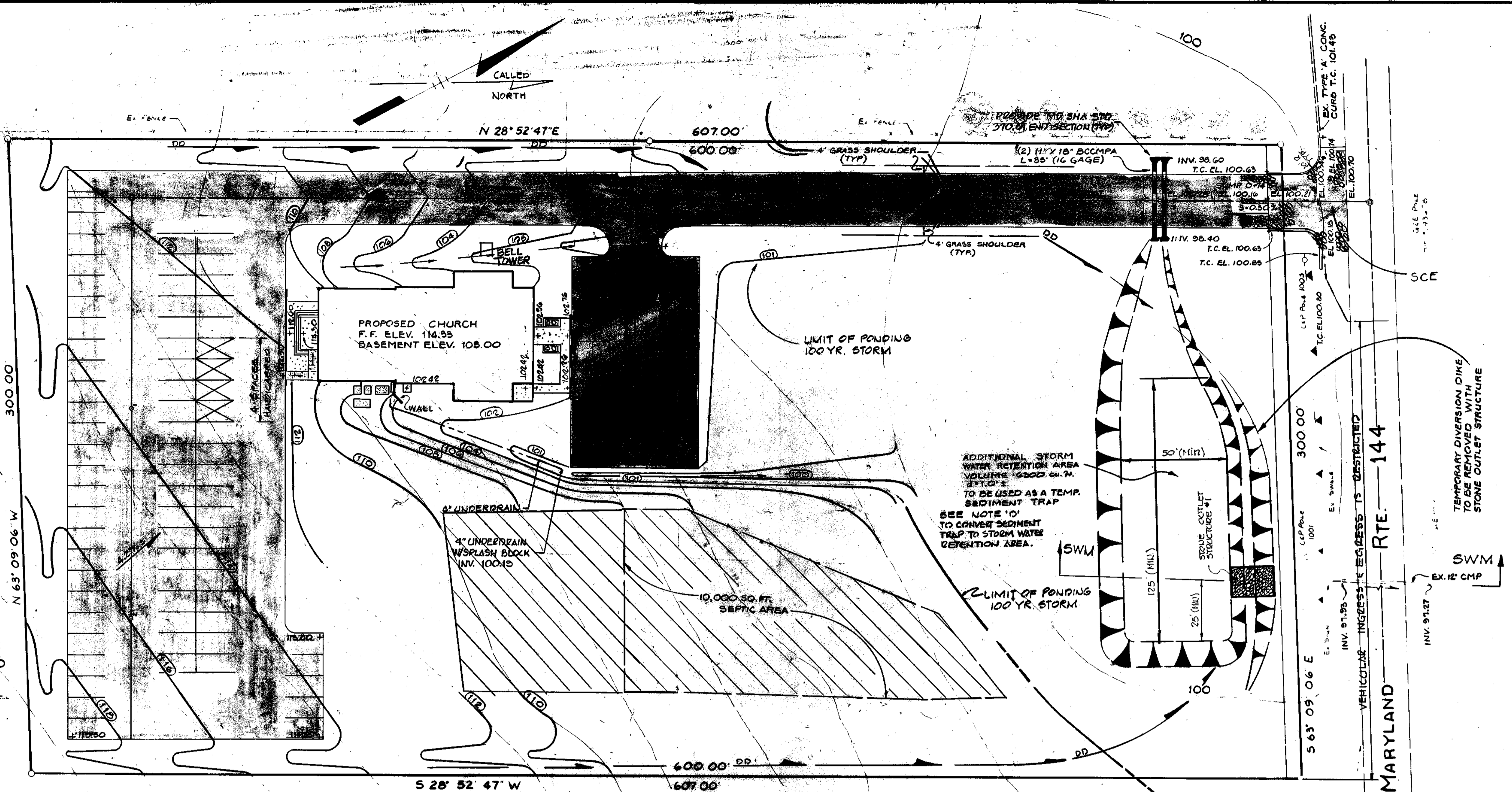

THESE PLANS HAVE BEEN REVIEWED FOR THE HOWARD SOIL CONSERVATION DISTRICT AND MEET THE TECHNICAL REQUIREMENTS FOR SOIL EROSION AND SEDIMENT CONTROL.

James M. Hahn
Signature
U.S. Soil Conservation Service
1-13-81
Date

THESE PLANS HAVE BEEN REVIEWED FOR THE HOWARD SOIL CONSERVATION DISTRICT AND MEET THE TECHNICAL REQUIREMENTS FOR SOIL EROSION AND SEDIMENT CONTROL.

William T. Rowe
Signature
Howard S.C.D.
1-13-81
Date

APPROVED: FOR PRIVATE WATER AND PRIVATE SEWERAGE SYSTEMS, HOWARD COUNTY HEALTH DEPARTMENT

Joyce Boylens
Signature
County Health Officer
1-23-81
Date

APPROVED: HOWARD COUNTY OFFICE OF PLANNING & ZONING

James L. Harris
Signature
Planning Director
1-29-81
Date

William M. ...
Signature
Chief Division of Land Development
1-28-81
Date

APPROVED: FOR STORM DRAINAGE SYSTEMS AND PUBLIC ROADS
HOWARD COUNTY DEPARTMENT OF PUBLIC WORKS

Harold F. Neumeier
Signature
Director
1-29-81
Date

William P. ...
Signature
Chief Bureau of Engineering
1-28-81
Date

11/4/80: REV. PER. CO. COMMENTS DATED 10/18/80
9/5/80: REV. PER. COUNTY COMMENTS

DATE	NO.	REVISION DESCRIPTION
		OWNER LISBON UNITED METHODIST CHURCH MD. RTE 144
		DEVELOPER LISBON UNITED METHODIST CHURCH MD. RTE 144
		PROJECT LISBON UNITED METHODIST CHURCH FREEMAN PROPERTY, LOT 4, MD. RTE 144
		AREA 4TH ELECTION DISTRICT HOWARD COUNTY, MARYLAND
		TITLE GRADING, EROSION AND SEDIMENT CONTROL PLAN

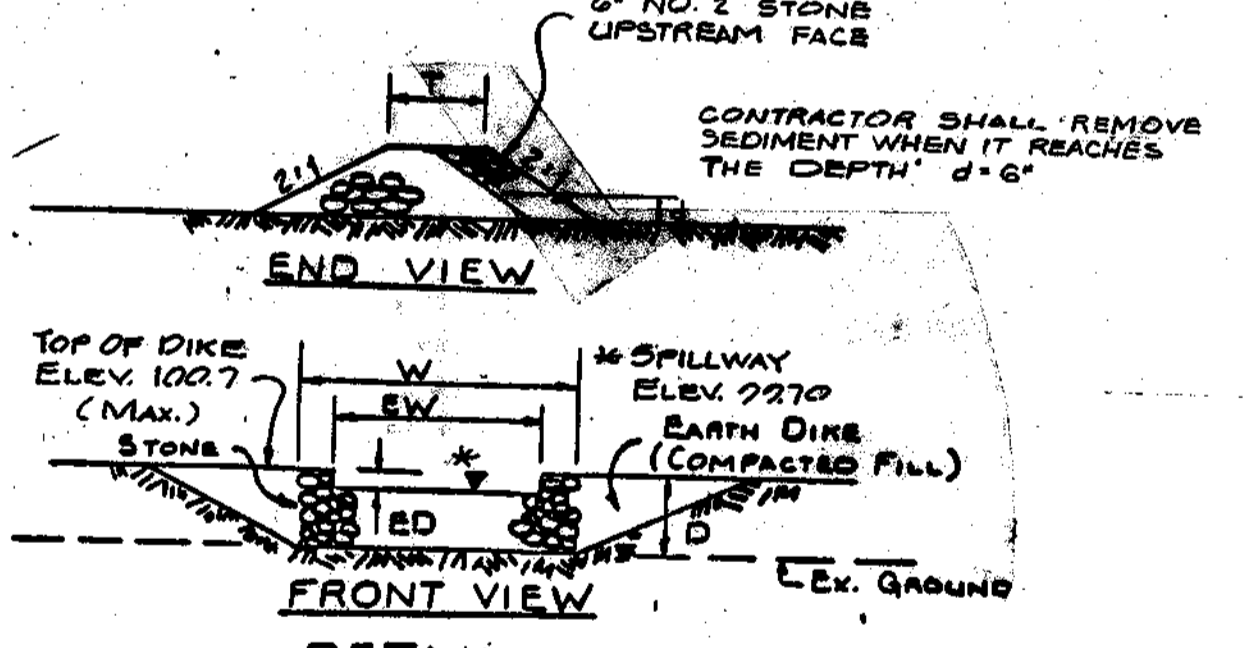
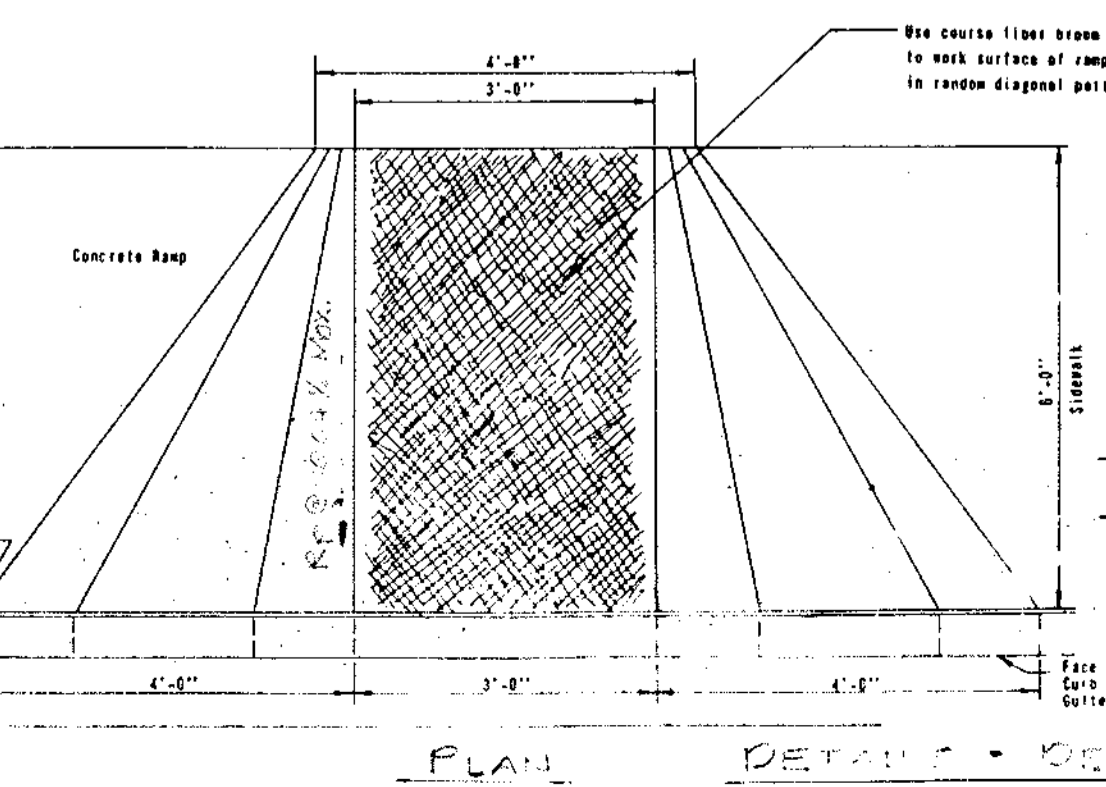
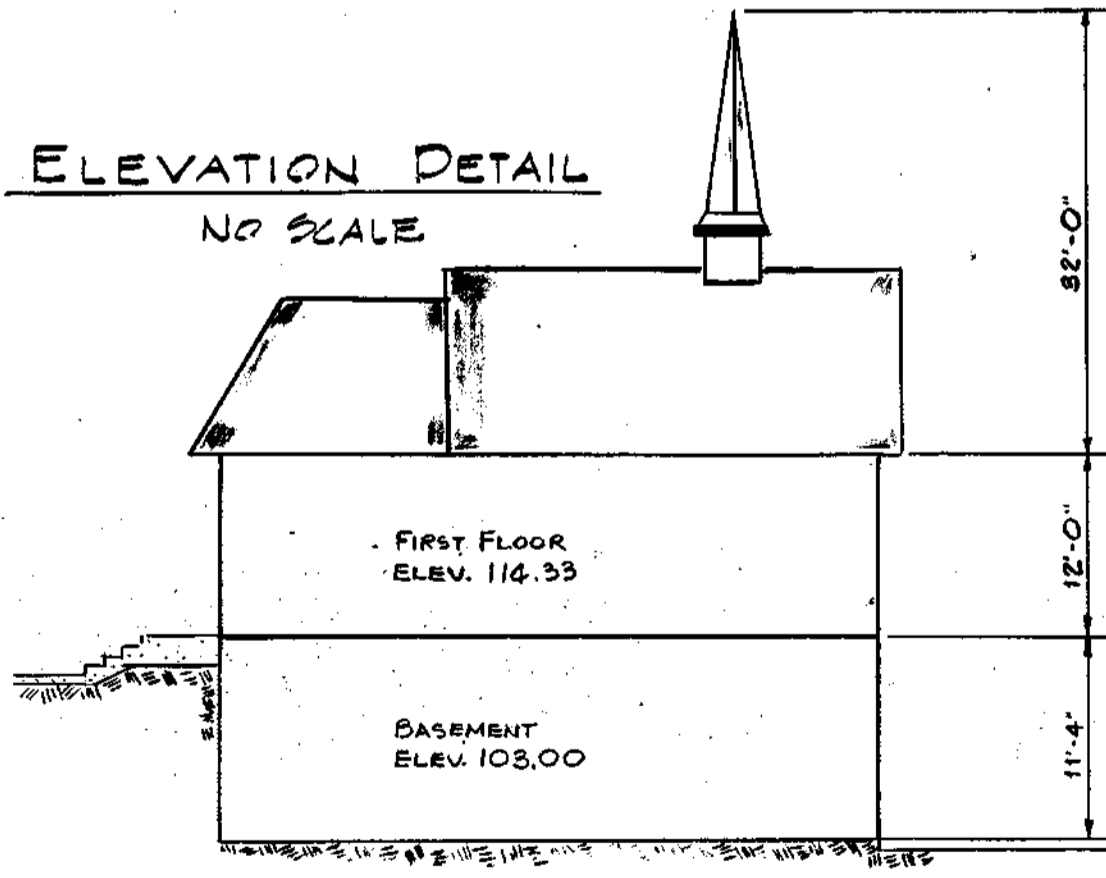

DETAIL STONE OUTLET STRUCTURE
NO SCALE

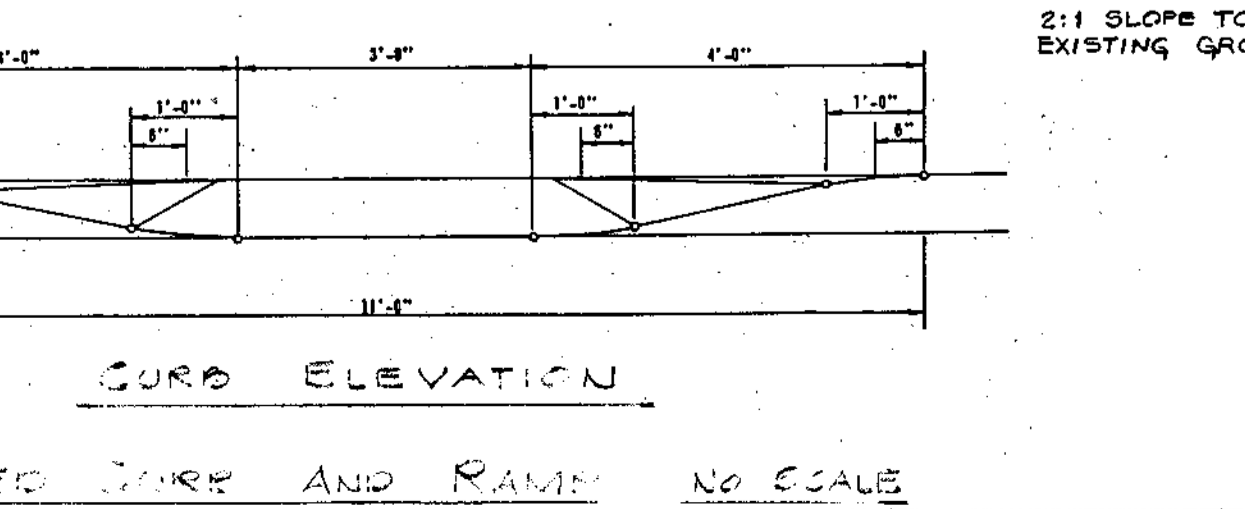
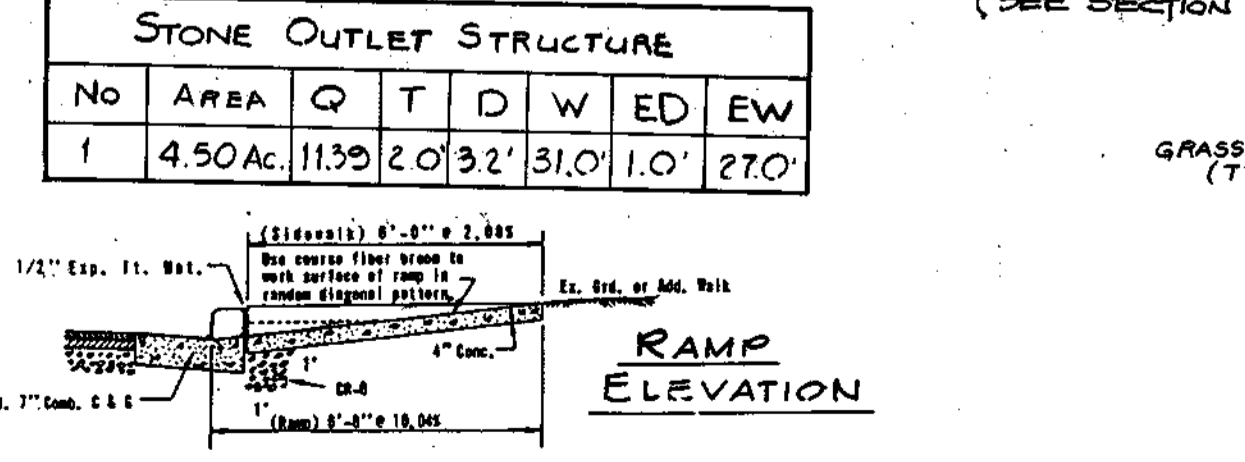

PLAN DETAIL - DECREASED CURB AND RAMP NO SCALE

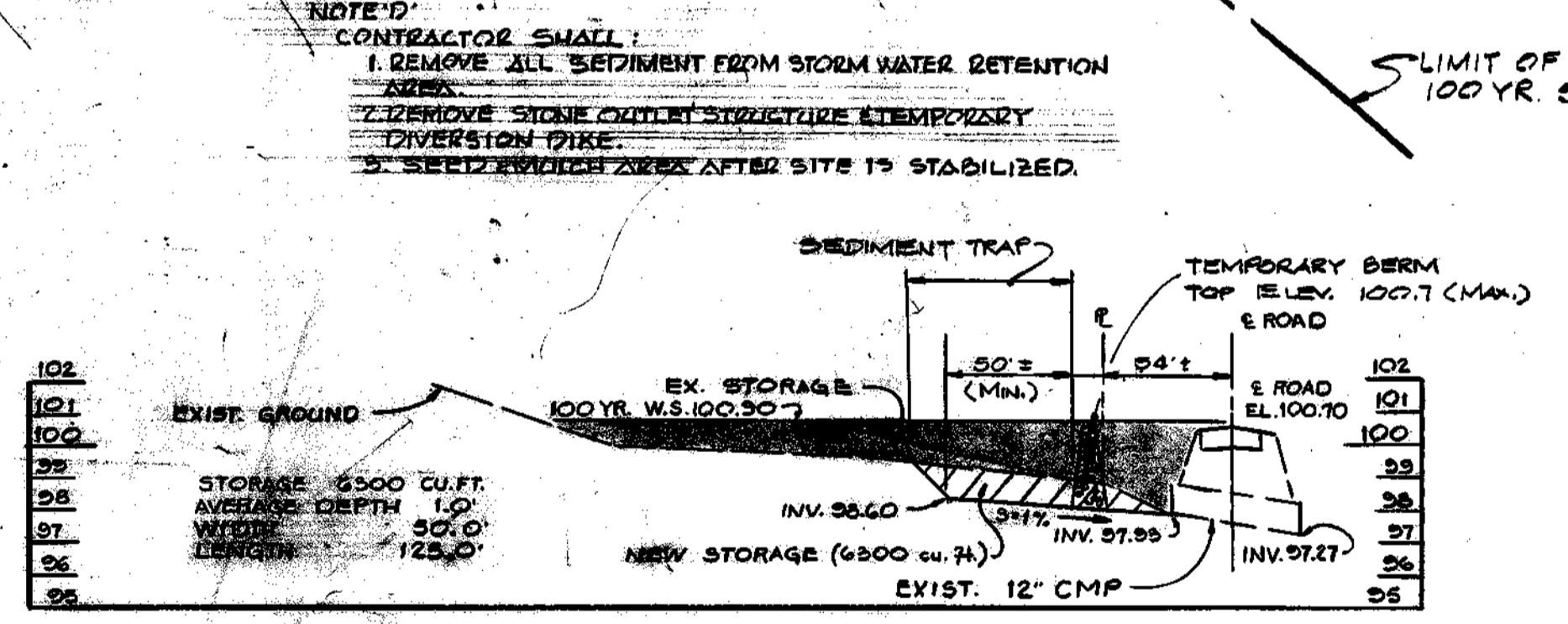

SECTION SWM FOR GRADING AT EXIST. 12" CMP
PROFILE SCALE: HORIZ. 1"=50'
VERT. 1"=5'

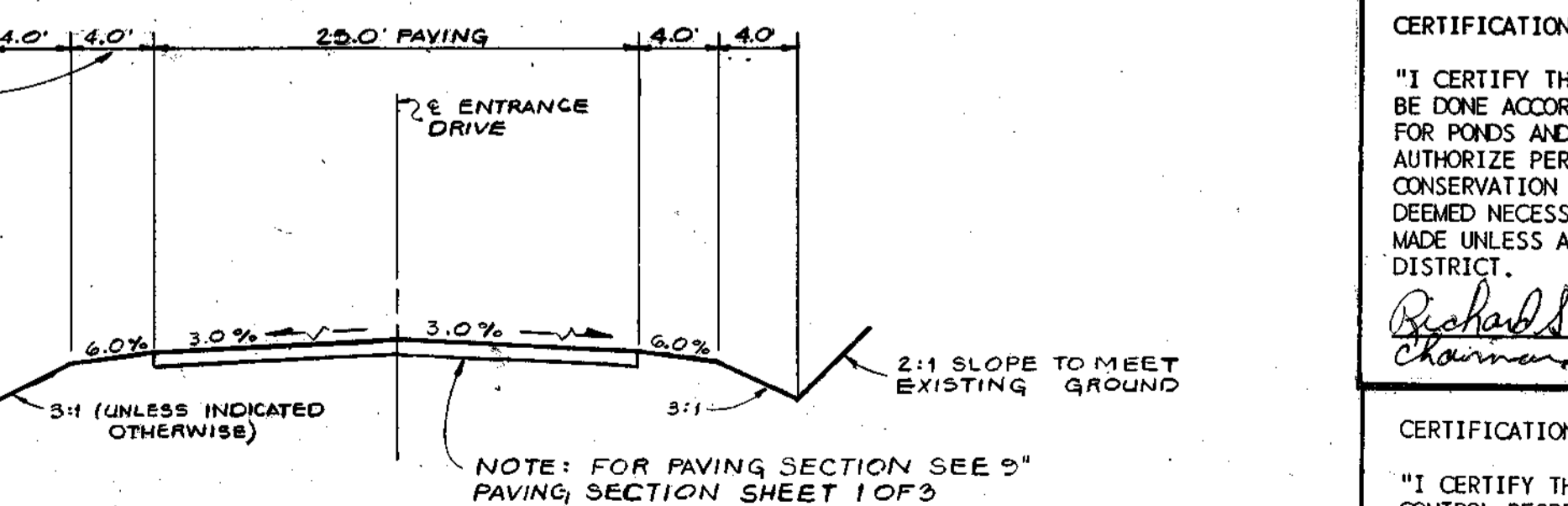

ENTRANCE DRIVE SECTION
NO SCALE

APPROVED
DIVISION OF LAND DEVELOPMENT
HOWARD COUNTY, MARYLAND
DATE 10-17-80
AWM

REV 6/25/03 ADD BELL TOWER - PCR

CERTIFICATION BY THE DEVELOPER:
"I CERTIFY THAT ALL DEVELOPMENT AND OR CONSTRUCTION WILL BE DONE ACCORDING TO THESE PLANS OF DEVELOPMENT AND PLANS FOR PONDS AND EROSION AND SEDIMENT CONTROL AND I ALSO AUTHORIZE PERIODIC ON-SITE INSPECTION BY THE HOWARD SOIL CONSERVATION DISTRICT OR THEIR AUTHORIZED AGENTS, AS ARE DEEMED NECESSARY." DEVIATION FROM THIS PLAN WILL NOT BE MADE UNLESS AUTHORIZED BY THE HOWARD SOIL CONSERVATION DISTRICT.

Richard S. Mullins
Signature
Chambers of Practice
5-13-80
Date

CERTIFICATION BY THE ENGINEER:
"I CERTIFY THAT THIS PLAN FOR EROSION AND SEDIMENT CONTROL REPRESENTS A PRACTICAL AND WORKABLE PLAN BASED ON MY PERSONAL KNOWLEDGE OF THE SITE CONDITIONS AND THAT IT WAS PREPARED IN ACCORDANCE WITH THE REQUIREMENTS OF THE HOWARD SOIL CONSERVATION DISTRICT."

Charles L. Cookson
Signature
Engineer
5-13-80
Date

TYDINGS HEIM ASSOCIATES INC.
CONSULTING ENGINEERS, PLANNERS & CONSTRUCTION SURVEYORS
8370 COURT AVENUE, ELICOTT CITY, MD. 21043 466-0660

1-9-81
DESIGNED BY: L.R.
DRAWN BY: J.P.O.
PROJECT NO: 528
DATE: MAY 13, 1980
SCALE: 1"=30'

Charles L. Cookson
Signature
PROFESSIONAL ENGINEER NO. 7803
DRAWING NO. 50-2 OF 50-3
500-80-157

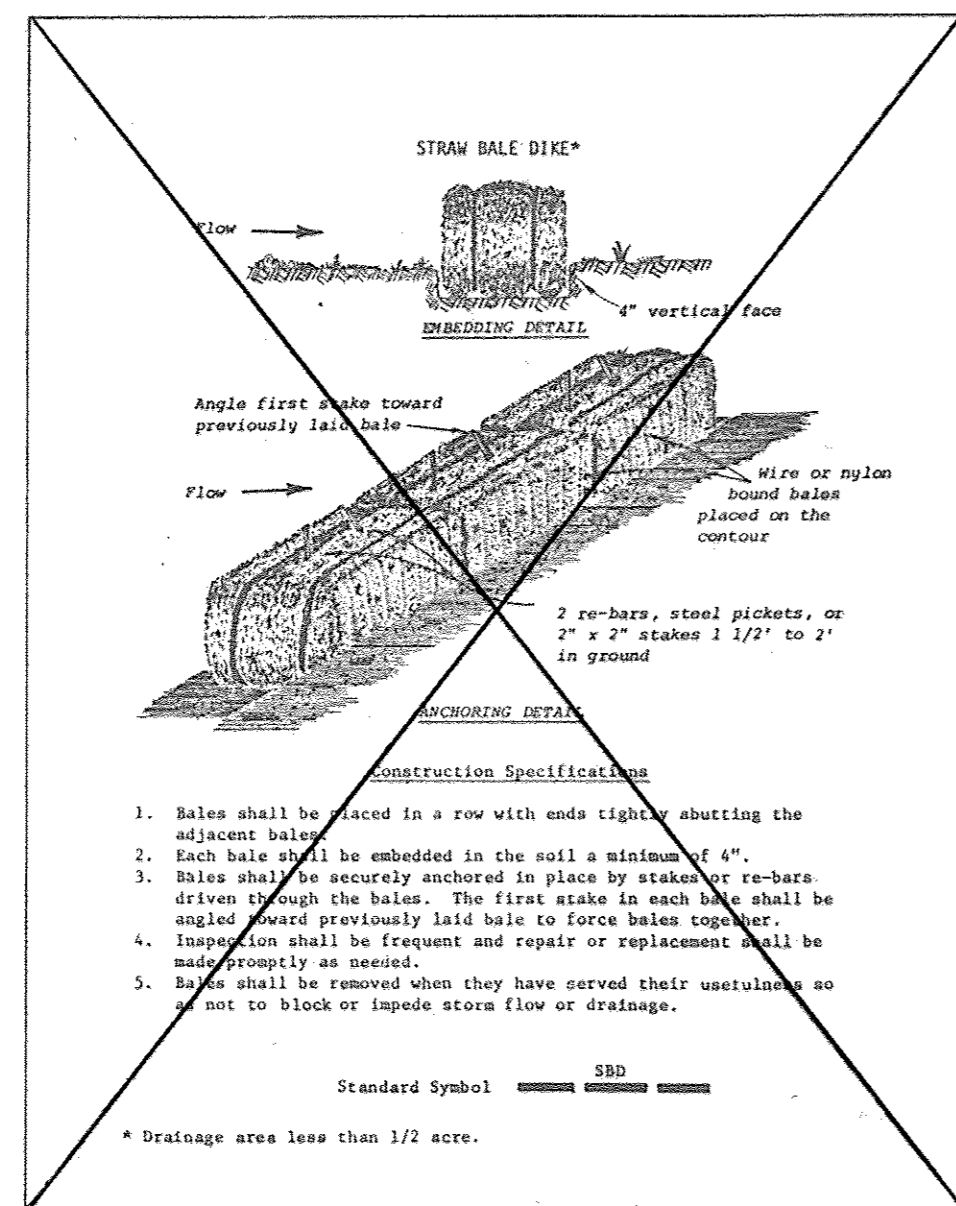
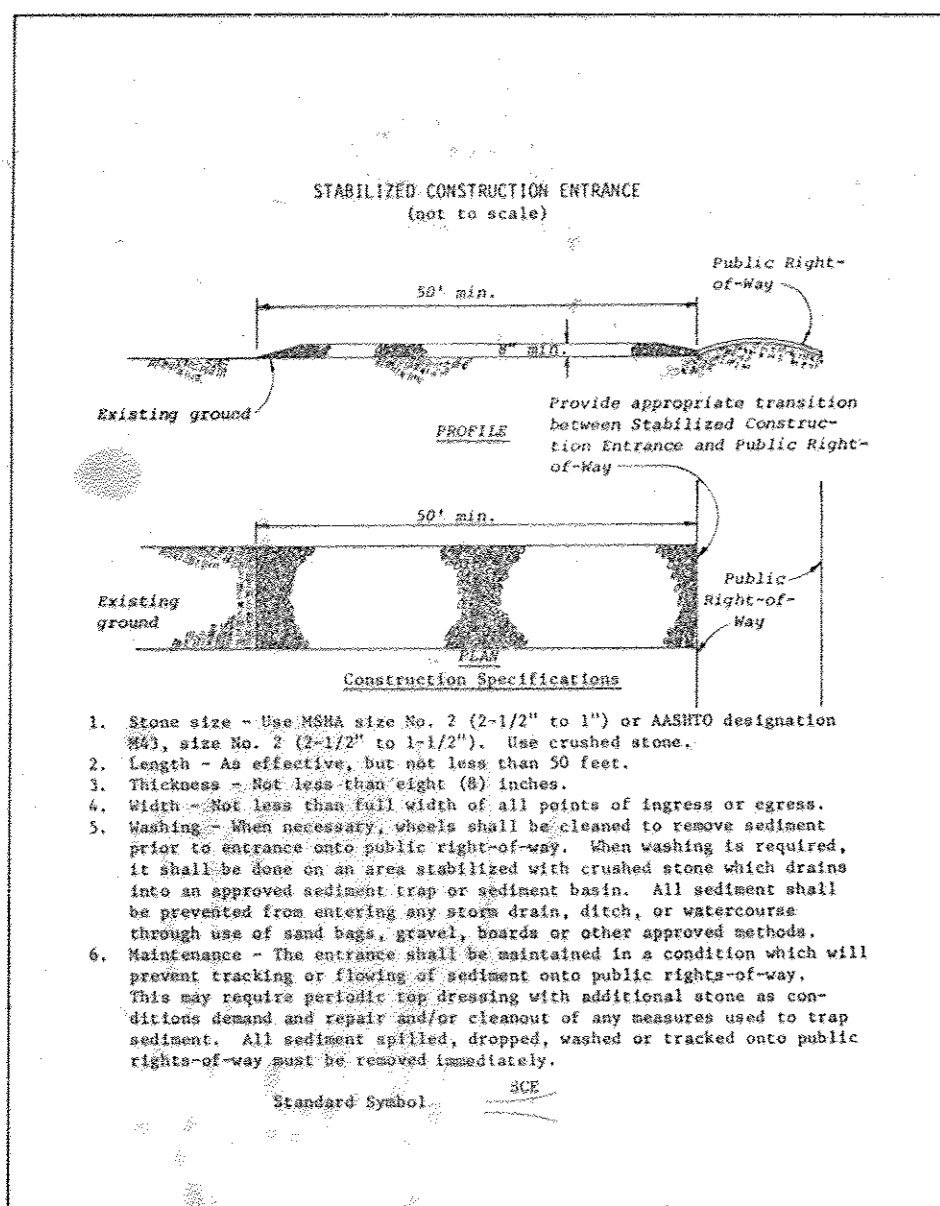

NOT THIS CONTRACT

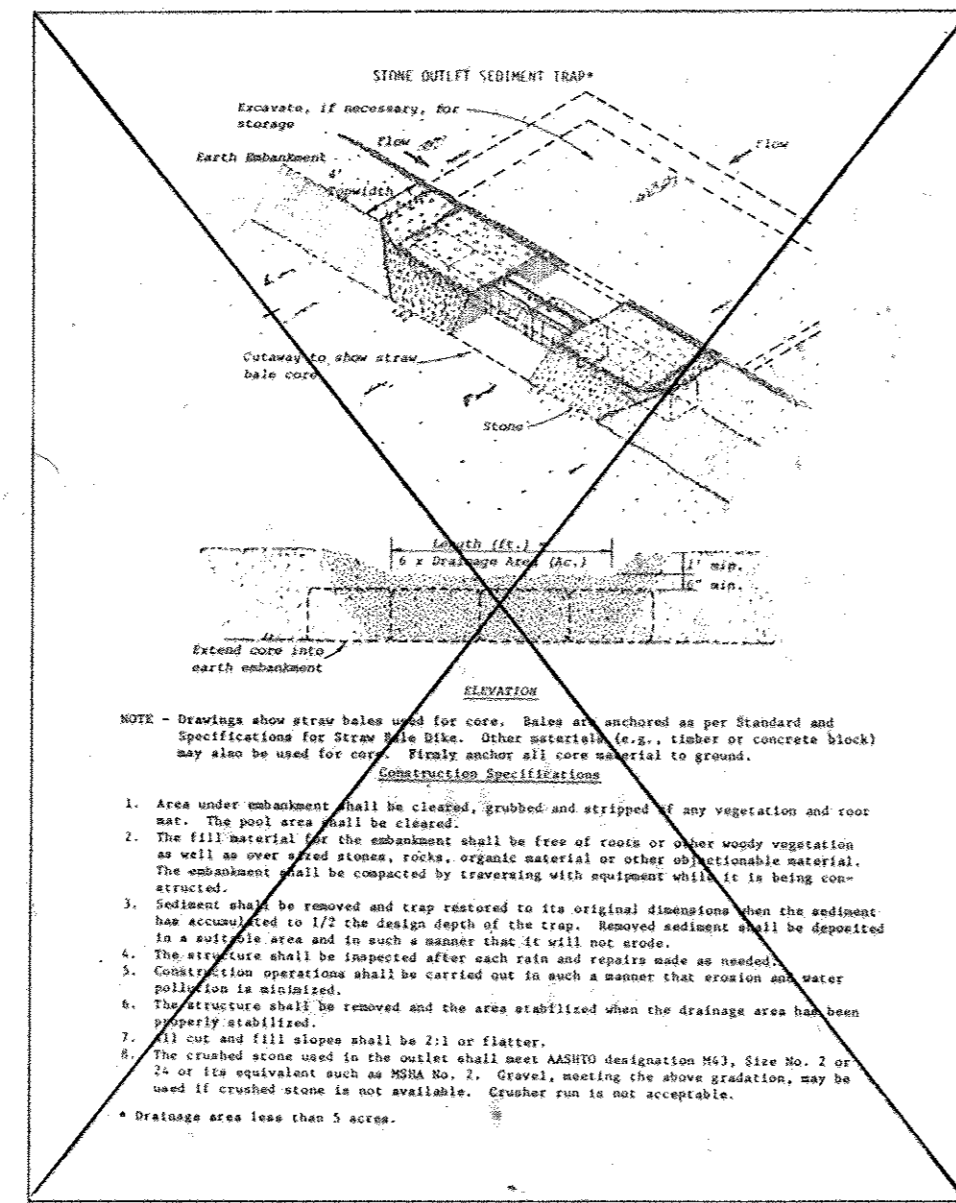
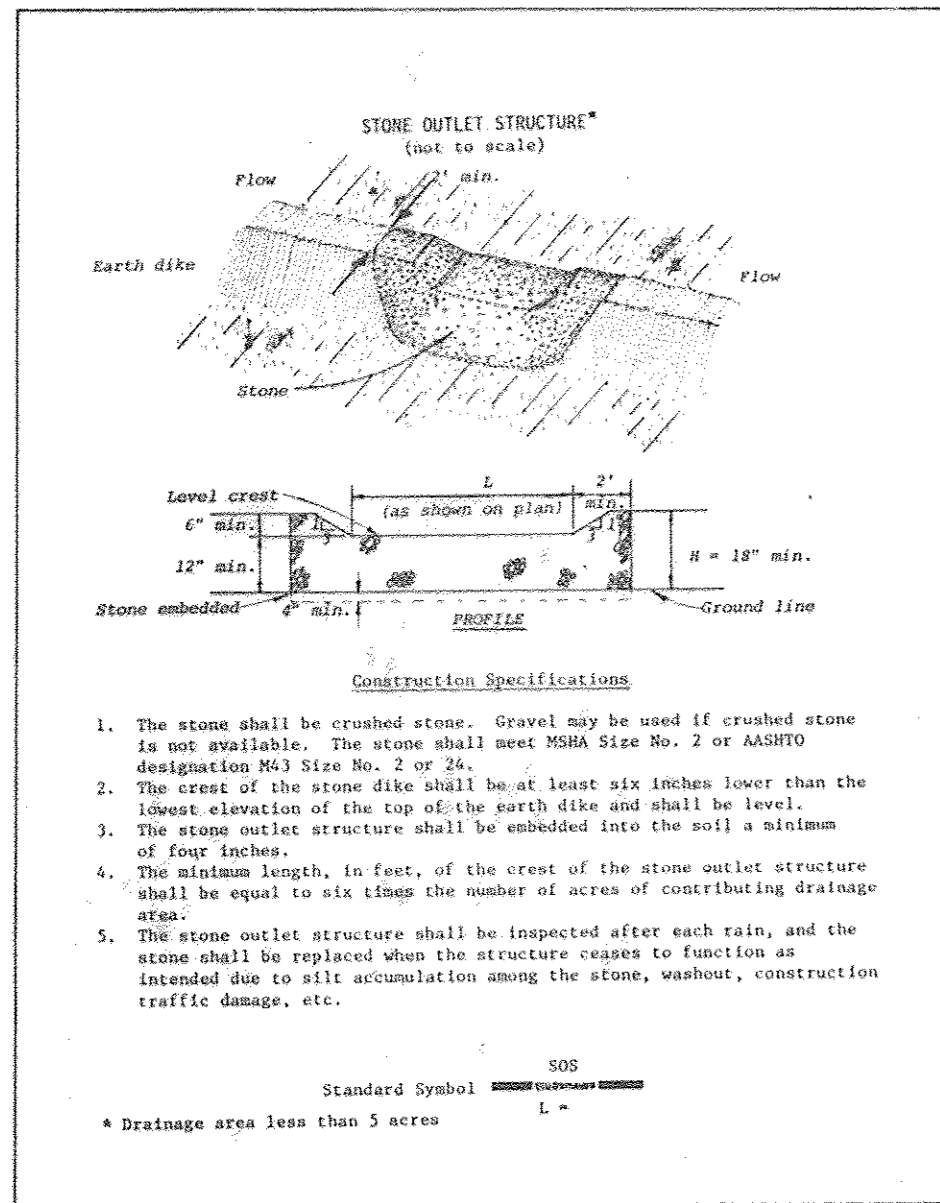

NOT THIS CONTRACT

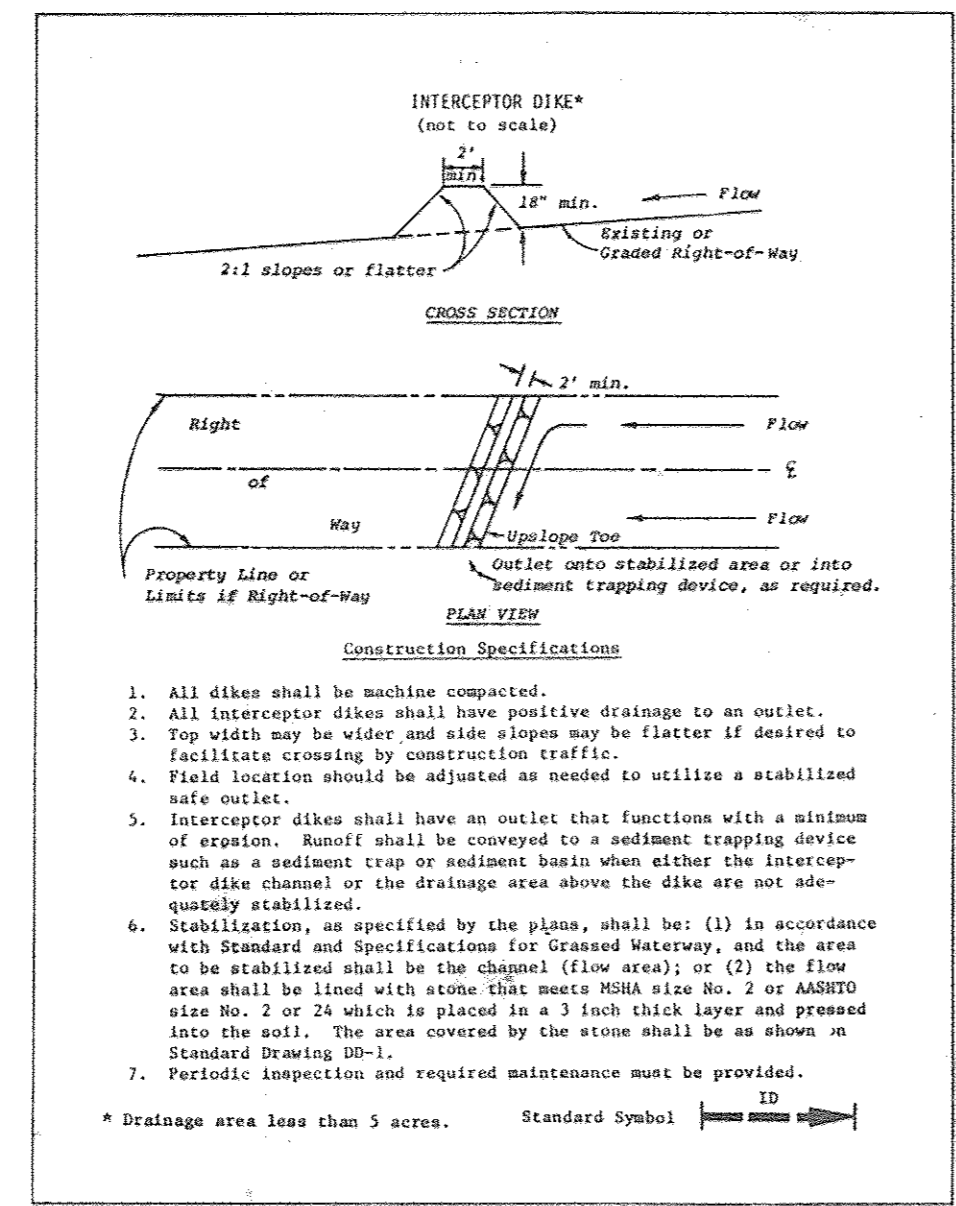
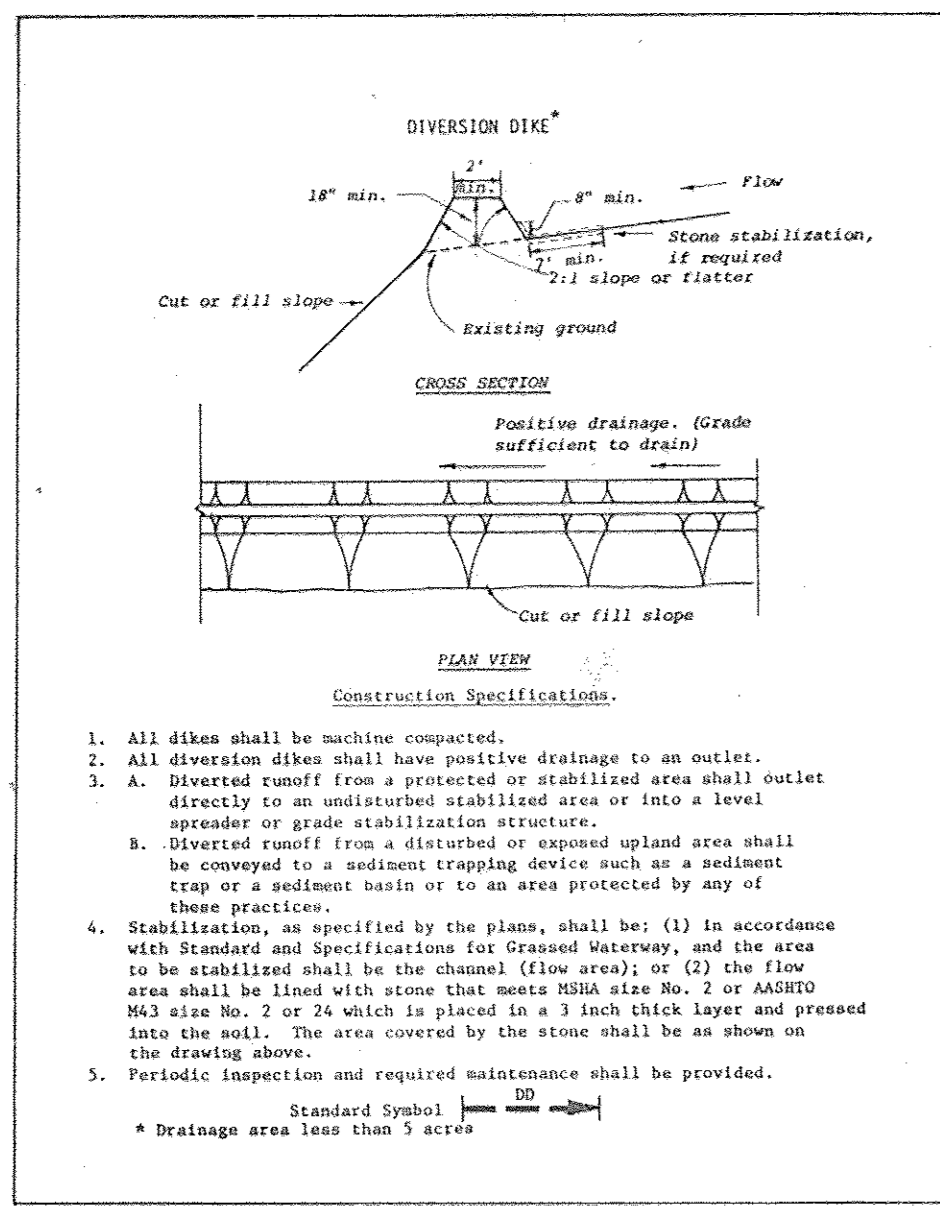

SEDIMENT CONTROL CONSTRUCTION NOTES

GENERAL NOTES

- A MINIMUM 24 HOURS NOTICE MUST BE GIVEN TO THE HOWARD COUNTY OFFICE OF INSPECTION AND PERMITS PRIOR TO THE START OF ANY CONSTRUCTION (922-2070)
- ALL SEDIMENT CONTROL STRUCTURES WILL BE INSTALLED IN ACCORDANCE WITH "THE STANDARDS AND SPECIFICATIONS FOR SOIL EROSION AND SEDIMENT CONTROL IN DEVELOPING AREAS" AS PREPARED BY THE U.S. DEPARTMENT OF AGRICULTURE SOIL CONSERVATION SERVICE.
- SITE GRADINGS WILL BEGIN ONLY AFTER ALL PERIMETER SEDIMENT CONTROL MEASURES HAVE BEEN INSTALLED AND ARE IN A FUNCTIONING CONDITION.
- ALL DISTURBED AREAS ARE TO BE DRESSED AND STABILIZED ACCORDING TO THE TEMPORARY OR PERMANENT SEEDING SCHEDULES AS SOON AS PROPER WEATHER CONDITIONS EXIST FOR THE ESTABLISHMENT OF A PERMANENT VEGETATIVE COVER.
- SEDIMENT WILL BE REMOVED FROM TRAP WHEN THE DEPTH REACHES THE CLEAN OUT ELEVATION SHOWN ON THE PLANS.
- FERTILIZER AND LIME RATES MAY BE CHANGED THROUGH AUTHORIZATION BY THE HOWARD SOIL CONSERVATION DISTRICT IF SOIL TESTS DETERMINE A REDUCTION IN THE SPECIFIED RATES IS JUSTIFIED.
- ALL SEDIMENT CONTROL STRUCTURES ARE TO REMAIN IN PLACE AND ARE TO BE MAINTAINED IN OPERATIVE CONDITION UNTIL PERMISSION FOR THEIR REMOVAL HAS BEEN OBTAINED FROM THE HOWARD COUNTY SEDIMENT CONTROL INSPECTOR.
- REFERENCES CALLED FOR ON THE SEDIMENT CONTROL CONSTRUCTION PLAN AND DETAILS ARE MADE TO "THE STANDARDS AND SPECIFICATIONS FOR SOIL EROSION AND SEDIMENT CONTROL IN DEVELOPING AREAS".

TEMPORARY SEEDING

AREA TO BE SEEDDED SHALL BE RECENTLY LOOSENEED. IF THE GROUND IS PACKED, CRUSTED OR HARD, THE TOP LAYER OF SOIL SHALL BE LOOSENEED BY DISCING, RACKING OR OTHER ACCEPTABLE MEANS.

- APPLY 10-20-10 FERTILIZER (OR EQUIVALENT) AT THE RATE OF 600 LBS. PER ACRE OR 15 LBS. PER 1000 SQ. FT.
- WHERE SOIL IS KNOWN TO BE HIGHLY ACID, APPLY DOLOMITIC LIMESTONE AT THE RATE OF 1 TON PER ACRE.
- WORK BOTH INTO SOIL AND SEED WITH CYCLONE SEEDER, DRILL, CULTIPAKER SEEDER OR HYDROSEEDER (SLURRY WILL INCLUDE SEED AND FERTILIZER) AT THE RATE OF 40 LBS. PER ACRE OF ITALIAN OR PERENNIAL RYEGRASS.
- MULCH WITH UNWEATHERED SMALL GRAIN STRAW AT THE RATE OF 1 1/2 TO 2 TONS. PER ACRE AND ANCHOR WITH A CUTBACK ASPHALT OR EMULSIFIED ASPHALT AT THE RATE OF 5 GAL. PER 1000 SQ. FT.

PERMANENT SEEDING

FINAL STABILIZATION WILL TAKE PLACE AS SOON AS POSSIBLE AS WEATHER CONDITIONS PERMIT, AS FOLLOWS:

- APPLY DOLOMITIC LIMESTONE AT THE RATE OF 2 TONS. PER ACRE (ONE TON. PER ACRE IF APPLICATION OF TON. PER ACRE WAS MADE FOR TEMPORARY SEEDING).
- APPLY 0-20-20 FERTILIZER AT THE RATE OF 600 LBS. PER ACRE. HARROW OR DISC LIME AND 0-20-20 FERTILIZER INTO THE SOIL TO A MINIMUM DEPTH OF 3 LAWNS OR HIGH MAINTENANCE AREAS WILL BE DRAGGED AND LEVELED WITH A YORK RAKE. AT THE TIME OF SEEDING APPLY 400 POUNDS OF 38-0-0 UREAFORM FERTILIZER AND 500 LBS. OF 10-20-20 OR EQUIVALENT FERTILIZER PER ACRE.
- SEED WITH A MIXTURE OF CERTIFIED "MERION" KENTUCKY BLUEGRASS @ 40 LBS. PER ACRE; COMMON KENTUCKY BLUEGRASS @ 40 LBS. PER ACRE; RED FESCUE, PENNLAWN OR JAMESTOWN @ 20 LBS. PER ACRE.
- MULCH WITH UNWEATHERED SMALL GRAIN STRAW AT THE RATE OF 1 1/2 TO 2 TONS. PER ACRE AND ANCHOR WITH A CUTBACK ASPHALT OR EMULSIFIED ASPHALT AT THE RATE OF 5 GAL. PER 1000 SQ. FT.
- SEED ALL SLOPES WITH A MIXTURE OF CERTIFIED KENTUCKY 31 TALL FESCUE @ 50 LBS. PER ACRE AND INOCULATED KOREAN LESPEDEZA @ 15 LBS. PER ACRE.

SEQUENCE OF CONSTRUCTION

- OBTAIN A GRADING PERMIT.
 - INSTALL STABILIZED CONSTRUCTION ENTRANCE.
 - INSTALL SEDIMENT TRAP WITH STONE OUTLET STRUCTURE AND SEED PER TEMPORARY SEEDING NOTES.
 - INSTALL PERIMETER DIKES AND SEED PER TEMPORARY SEEDING NOTES.
 - PERFORM ROUGH GRADING OPERATION AND SEED PER TEMPORARY SEEDING NOTES.
- NOTE: NO STORM DRAINS SHALL BE INSTALLED UNDER THIS PERMIT. ALL SEDIMENT CONTROL DEVICES SHALL REMAIN IN PLACE AND BE MAINTAINED UNTIL SUCH TIME AS ALL ROADWAY AND STORM DRAIN CONSTRUCTION HAS BEEN COMPLETED.

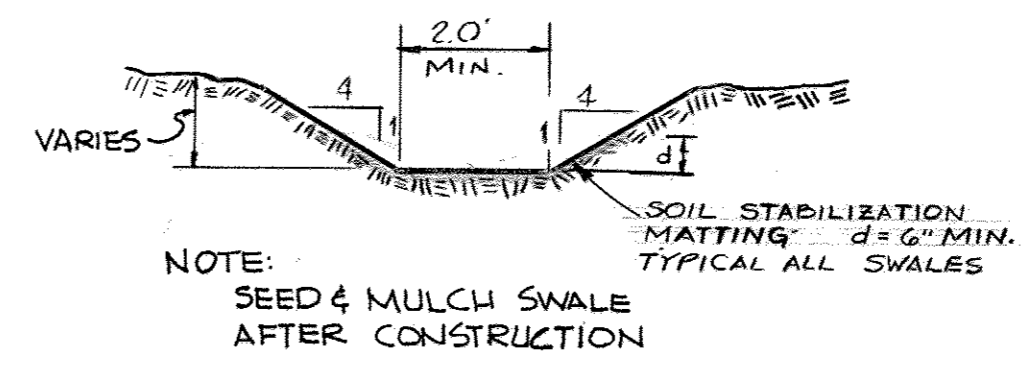
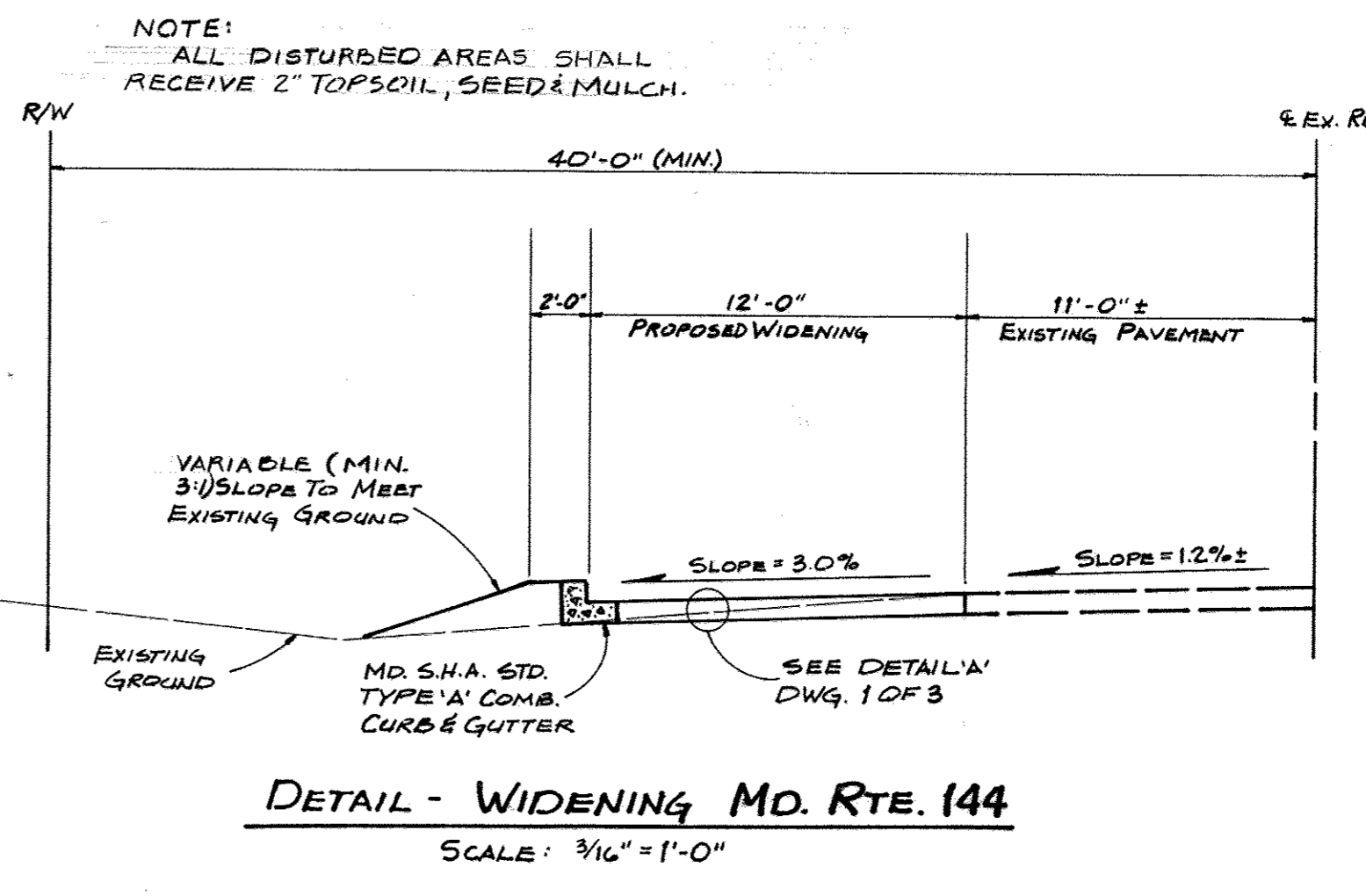

CLASS "A" CONCRETE CURB AND GUTTER

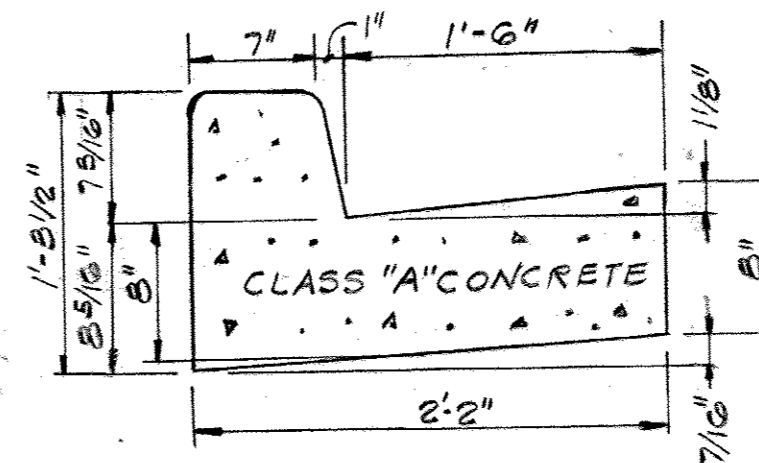

STANDARD 7" COMB. CURB AND GUTTER

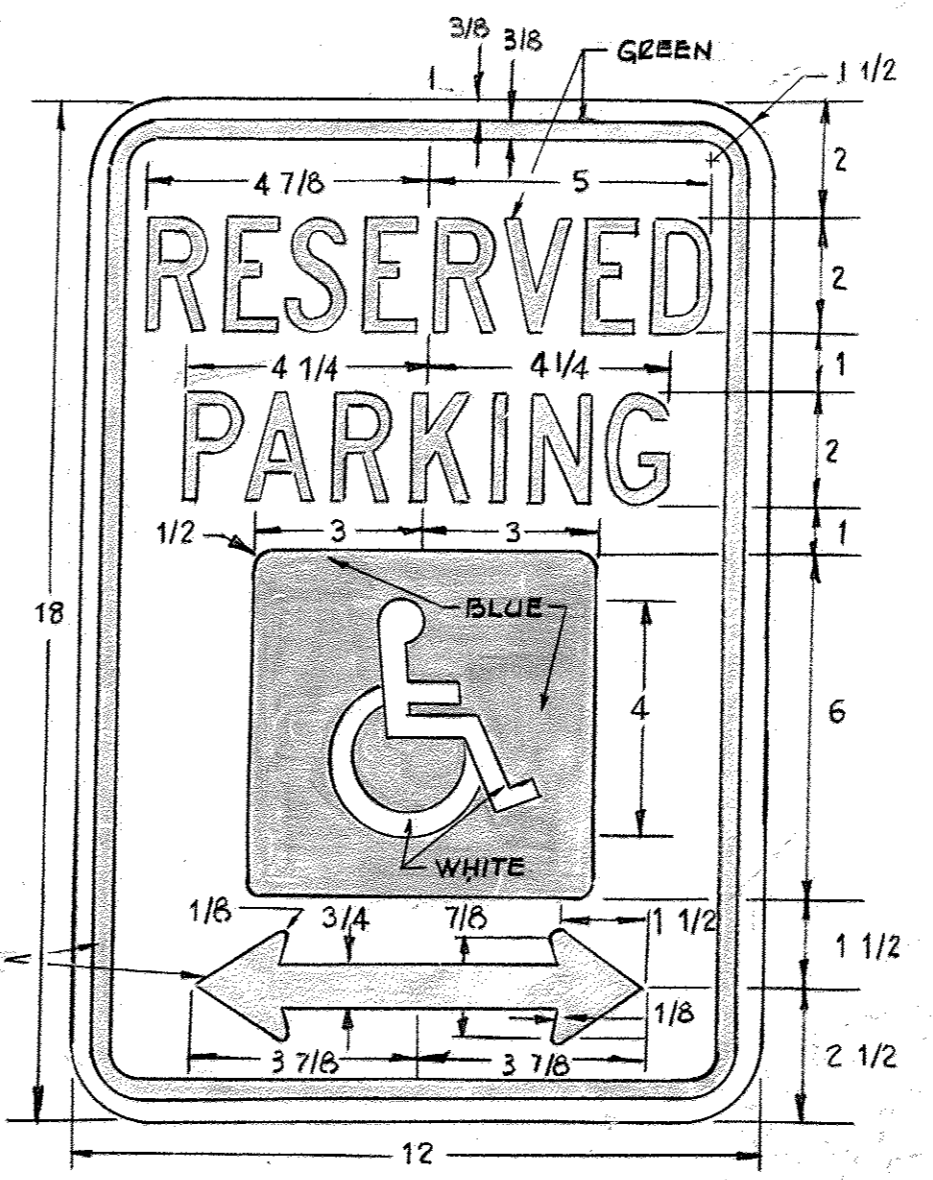

DETAIL HANDICAPPED PARKING SIGN NO SCALE

APPROVED
DIVISION OF LAND DEVELOPMENT
HOWARD COUNTY, MARYLAND
DATE 10-17-80
AMM

CERTIFICATION BY THE DEVELOPER:
"I CERTIFY THAT ALL DEVELOPMENT AND OR CONSTRUCTION WILL BE DONE ACCORDING TO THESE PLANS OF DEVELOPMENT AND PLAN FOR PONDS AND EROSION AND SEDIMENT CONTROL AND I ALSO AUTHORIZE PERIODIC ON-SITE INSPECTION BY THE HOWARD SOIL CONSERVATION DISTRICT OR THEIR AUTHORIZED AGENTS, AS ARE DEEMED NECESSARY." DEVIATION FROM THIS PLAN WILL NOT BE MADE UNLESS AUTHORIZED BY THE HOWARD SOIL CONSERVATION DISTRICT.
Richard S. Muller
Chairman of Trustees
5-13-80
Date

CERTIFICATION BY THE ENGINEER:
"I CERTIFY THAT THIS PLAN FOR EROSION AND SEDIMENT CONTROL REPRESENTS A PRACTICAL AND WORKABLE PLAN BASED ON MY PERSONAL KNOWLEDGE OF THE SITE CONDITIONS AND THAT IT WAS PREPARED IN ACCORDANCE WITH THE REQUIREMENTS OF THE HOWARD SOIL CONSERVATION DISTRICT."
Charles R. Cochran
Engineer
5-13-80
Date

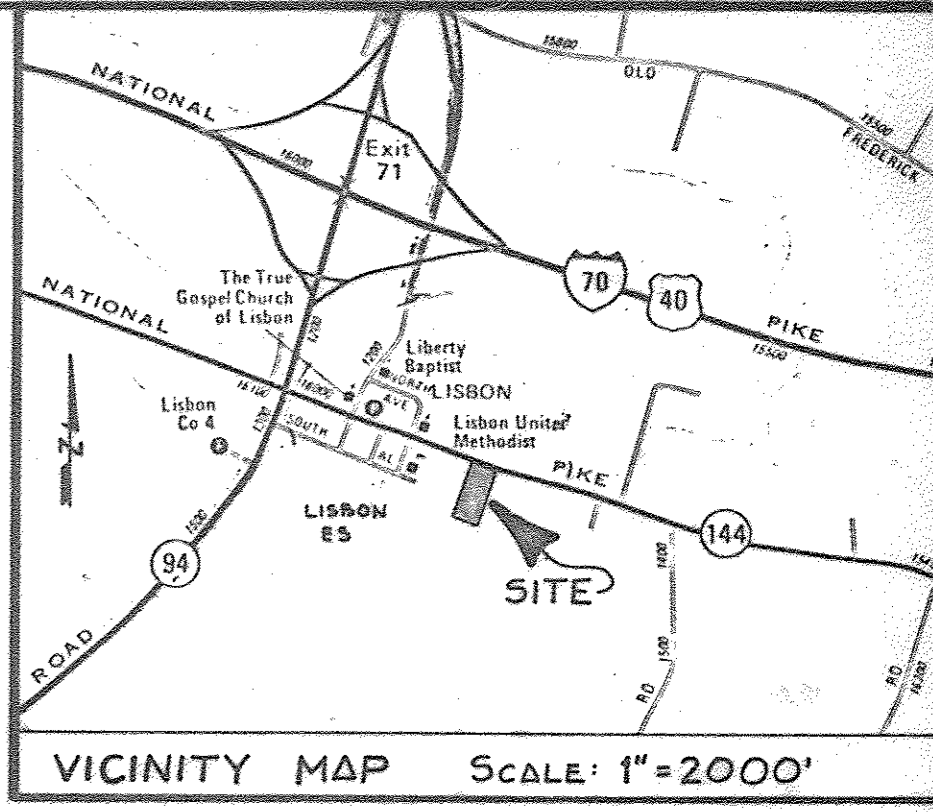

THESE PLANS HAVE BEEN REVIEWED FOR THE HOWARD SOIL CONSERVATION DISTRICT AND MEET THE TECHNICAL REQUIREMENTS FOR SOIL EROSION AND SEDIMENT CONTROL.

Signature: *John M. Vele*
U.S. Soil Conservation Service
Date: 1-13-81

THESE PLANS HAVE BEEN REVIEWED FOR THE HOWARD SOIL CONSERVATION DISTRICT AND MEET THE TECHNICAL REQUIREMENTS FOR SOIL EROSION AND SEDIMENT CONTROL.

Signature: *William Thorne*
Howard S.C.D.
Date: 1-13-81

APPROVED: FOR PRIVATE WATER AND PRIVATE SEWERAGE SYSTEMS, HOWARD COUNTY HEALTH DEPARTMENT

Signature: *Joyce Boydles*
County Health Officer
Date: 1-23-81

APPROVED: HOWARD COUNTY OFFICE OF PLANNING & ZONING

Signature: *Thomas J. Harris*
Planning Director
Date: 1-29-81

Signature: *John M. Muehlen*
Chief, Division of Land Development
Date: 1-28-81

APPROVED: FOR STORM DRAINAGE SYSTEMS AND PUBLIC ROADS HOWARD COUNTY DEPARTMENT OF PUBLIC WORKS

Signature: *Kenneth F. Nemeyer*
Director
Date: 1-29-81

Signature: *William E. Reay*
Chief Bureau of Engineering
Date: 1-28-81

11/18/80 2 REV. PER CO. COMMENTS DATED 10/6/80

3/9/80 1 REV. PER COUNTY COMMENTS

DATE	NO.	REVISION DESCRIPTION
		OWNER: LISBON UNITED METHODIST CHURCH MD RTE. 144 LISBON, MARYLAND 21765
		DEVELOPER: LISBON UNITED METHODIST CHURCH MD RTE. 144 LISBON, MARYLAND 21765
		PROJECT: LISBON UNITED METHODIST CHURCH FREEMAN PROPERTY, LOT #4, MD. RTE. #144
		AREA: 4TH ELECTION DISTRICT HOWARD COUNTY, MARYLAND
		TITLE: DETAIL SHEET

TYDINGS HEIM ASSOCIATES INC.
CONSULTING ENGINEERS, LAND & CONSTRUCTION SURVEYORS
8370 COURT AVENUE, ELLICOTT CITY, MD. 21043 465-0660

1-9-81
DATE

DESIGNED BY: C.R.C.
DRAWN BY: J.P.O.
PROJECT NO: 569

DATE: MAY 13, 1980
SCALE: AS SHOWN

PROFESSIONAL ENGR. NO. 7893
DRAWING NO 523 OF 523
SDP-80-157