

VICINITY MAP  
SCALE 1" = 2000'

**SITE ANALYSIS**

TOTAL AREA OF PROPERTY: 63.68 AC.  
TOTAL DISTURBED AREA: 24,100 SQ. FT.  
TOTAL BUILDING COVERAGE: 4205 SQ. FT.  
TOTAL CONCESSION AREA: 268 SQ. FT.  
DEED REFERENCE: LIBER 501 FOLIO 704  
ZONING: R-20

**BENCHMARK SCHEDULE**

BM 1 P.R. SPIKE IN BASE OF POLE G & E #189307 AT  
INT. OF FAIR ST. AND BALTIMORE ST. ELEV: 242.272

**PARKING SCHEDULE**

TOTAL PARKING REQUIRED - SEE SECTION 123, B, 26(C)5 OF THE 1977 ZONING REGULATIONS  
TOTAL PARKING PROVIDED - 178 SPACES (SEE SDP-79-10)  
HANDICAPPED PARKING SPACES (12'x20') - 4 SPACES  
TYPICAL PARKING SPACES (10'x20') - 174 SPACES

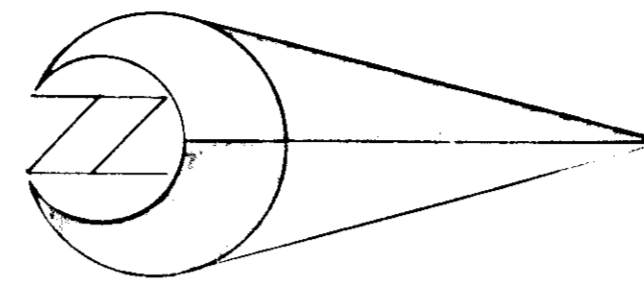

ALL EXTERIOR LIGHTING, SHOWN THIS WAY, SHALL BE DIRECTED DOWNWARD.

PARCEL 397  
LIBER 551 FOLIO 4

**LEGEND**

- EXISTING CONTOUR ——— 258
- PROPOSED CONTOUR ——— 258
- EXISTING CONCRETE CURB & GUTTER
- EXISTING CONCRETE CURB & GUTTER TO BE REMOVED
- PROPOSED CONCRETE CURB & GUTTER
- H. CO. ST'D DWG. D-40 PAGE 95 SEE SHEET 5
- PROPOSED BITUMINOUS PAVING H. CO. ST'D DWG. D-13 PAGE 6 B
- PROPOSED CONCRETE PAVER SEE DETAIL SHT 4
- PROPOSED CONCRETE PAD SEE DETAIL SHEET 4
- PROPOSED BUILDING

REVISIONS  
1. Additional grading - Add Sheet 2

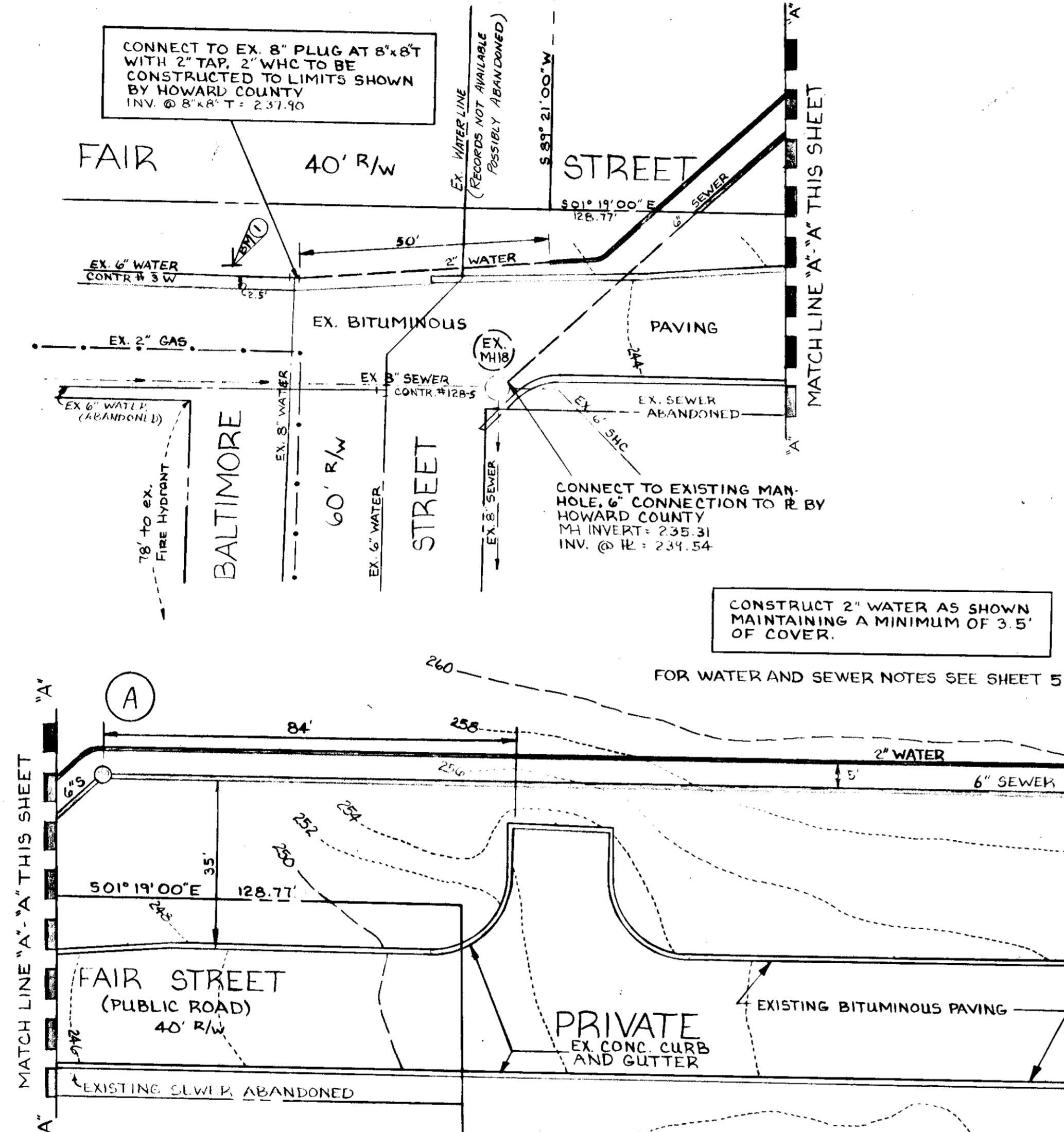

REMOVE EXISTING BITUMINOUS PAVING AND CONCRETE CURB AND GUTTER AS NECESSARY TO CONSTRUCT NEW CONCRETE CURB AND GUTTER AND HANDICAPPED RAMP. MAXIMUM RAMP SLOPE = 12:1 (8.3%)

NOSE DOWN CURB TO PROVIDE FOR HANDICAPPED RAMP SEE DETAIL SHEET 5

CONSTRUCT 2" WATER AS SHOWN MAINTAINING A MINIMUM OF 3' 5" OF COVER.

FOR WATER AND SEWER NOTES SEE SHEET 5

EXISTING BITUMINOUS PAVING

LOCATION OF FUTURE TOT LOT (N.I.C.)

2 HANDICAPPED SPACES - EACH SPACE SHALL BE MARKED WITH A SIGN IN ACCORDANCE WITH THE MARYLAND STATE BUILDING CODE FOR THE HANDICAPPED AND THE AGED.

NOSE DOWN CURB TO PROVIDE HANDICAPPED RAMP. RAMP WIDTH SHALL BE 6'-0"

REMOVE EXISTING BITUMINOUS PAVING AND CONCRETE CURB & GUTTER TO CONSTRUCT NEW CONCRETE CURB & GUTTER.

APPROVED  
DIVISION OF LAND DEVELOPMENT

HOWARD COUNTY, MARYLAND  
DATE 6-7-79

**PLAN**

SCALE: 1" = 20'

**BUILDING PROFILE**

SCALE: 1" = 20'

**OWNER/DEVELOPER**

HOWARD COUNTY DEPT. OF RECREATION & PARKS  
3430 COURT HOUSE DRIVE  
ELLCOTT CITY, MARYLAND 21043  
301-992-2480

APPROVED FOR PUBLIC WATER AND PUBLIC SEWERAGE SYSTEMS HOWARD COUNTY HEALTH DEPARTMENT  
*Maria Spang* 7-20-79 DATE  
COUNTY HEALTH OFFICER

APPROVED HOWARD COUNTY OFFICE OF PLANNING AND ZONING  
*Thomas A. Davis* 7-23-79 DATE  
PLANNING DIRECTOR

APPROVED FOR PUBLIC WATER AND PUBLIC SEWERAGE STORM DRAINAGE SYSTEMS AND PUBLIC ROADS HOWARD COUNTY DEPARTMENT OF PUBLIC WORKS  
*Frank F. Neuman* 7-19-79 DATE  
DIRECTOR

*W.C. Alford* 7-18-79 DATE  
CHIEF BUREAU OF ENGINEERING



NO.	DATE	REVISION
1	9-26-75	ADDITION TO BUILDING

**BENNETT-JOLSON & ASSOCIATES AIA ARCHITECTS**  
COLUMBIA, MARYLAND TEL. 301-730-1766

**MACRIS, HENDRICKS AND WITMER P.A.**  
ENGINEERS, SURVEYORS, PLANNERS  
15209 FREDERICK ROAD ROCKVILLE, MD. 20850 TEL (301)-340-8705

**DEPARTMENT OF RECREATION & PARKS**  
HOWARD COUNTY, MD.  
5-2-79 DATE  
*Walter J. ...* DIRECTOR

**CAPITAL PROJECT N-4-3008**

**SITE DEVELOPMENT PLAN**

**CONCESSION BUILDING FOR SAVAGE PARK**  
TAX MAP 47 LIBER 501 FOLIO 704 PAR. 92  
ELECTION DISTRICT NO. 6 HOWARD COUNTY, MD.

DRAWING NO.	SCALE	DATE
1 OF 5	AS SHOWN	3-8-79

SDP-79-138

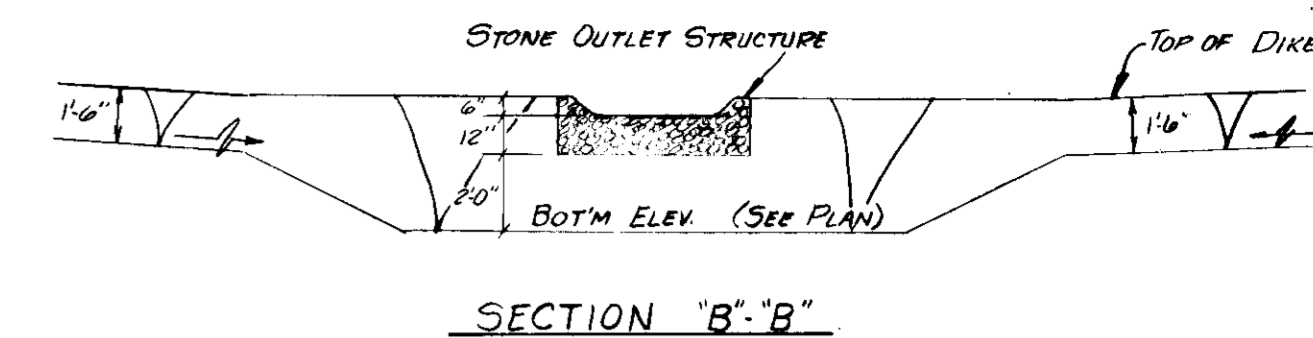
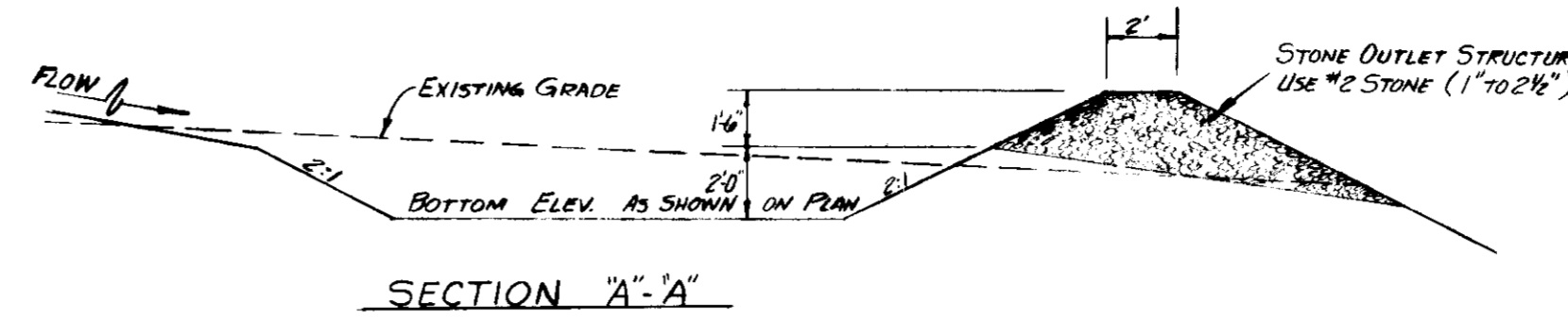
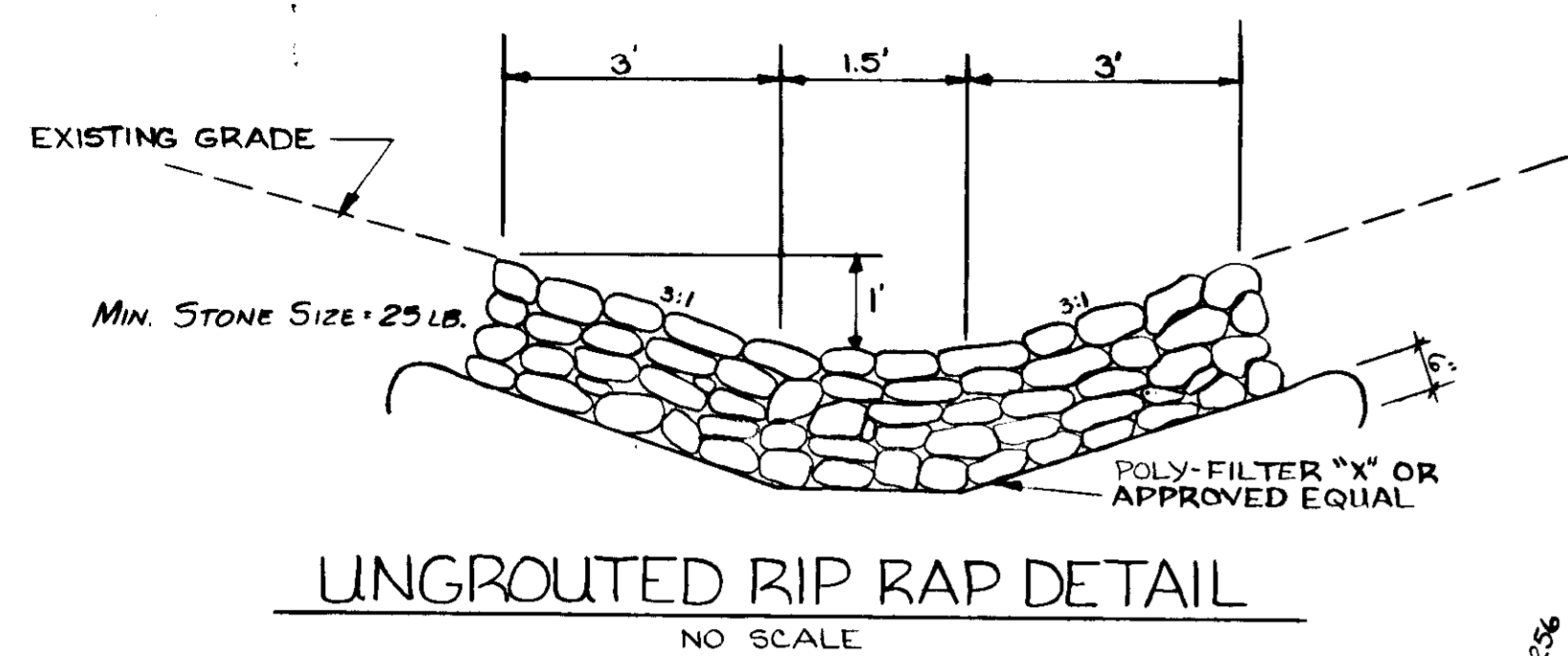

STONE OUTLET SEDIMENT TRAP  
NO SCALE

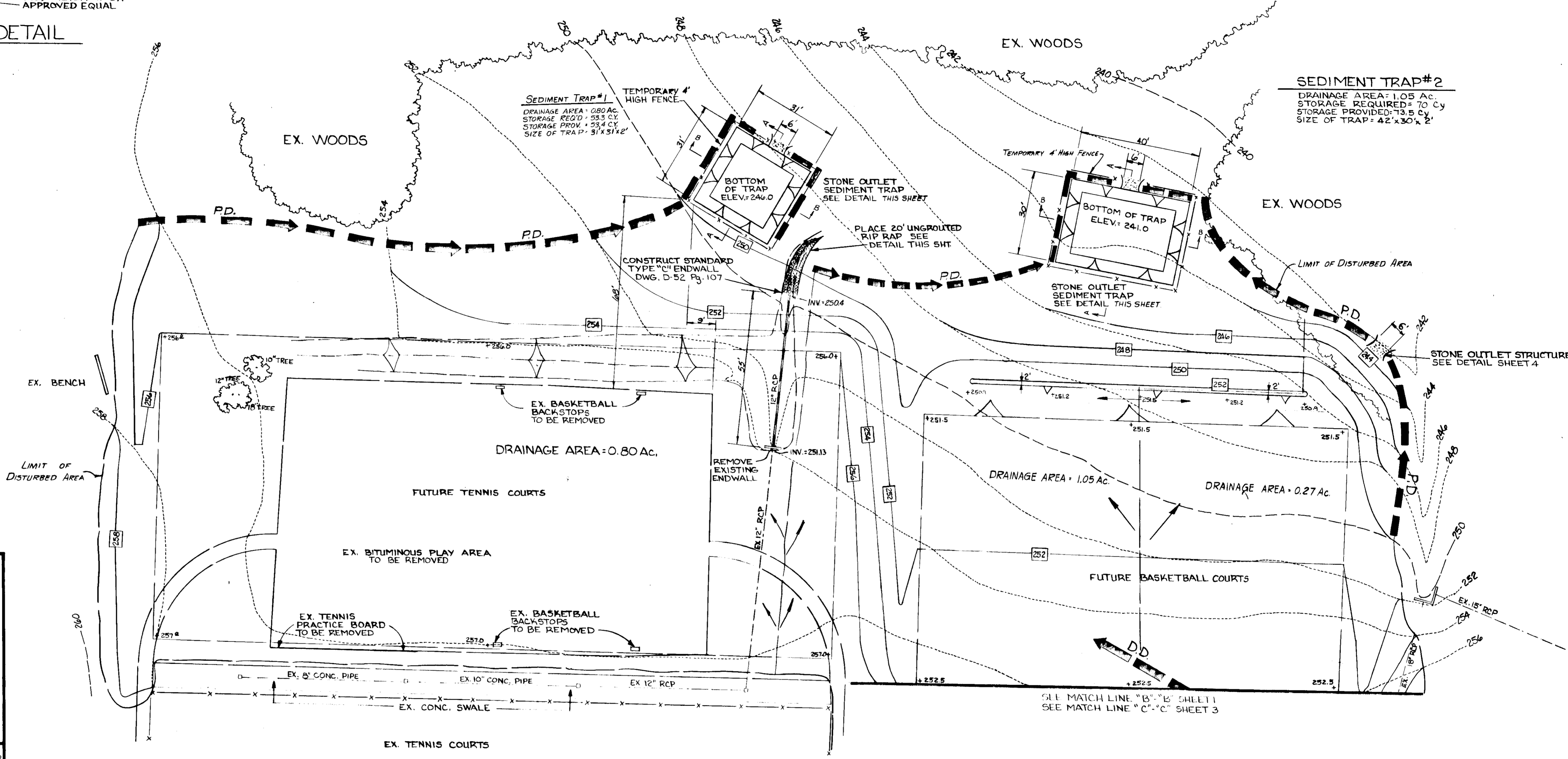

PLAN  
SCALE: 1"=20'

REVISIONS  
1. Additional grading. See this sheet

THIS PLAN HAS BEEN REVIEWED FOR THE HOWARD SOIL CONSERVATION DISTRICT AND MEETS THE TECHNICAL REQUIREMENTS.

*Wanda Bunkle*  
SIGNATURE  
U.S. SOIL CONSERVATION SERVICE  
7-17-79  
DATE

THIS DEVELOPMENT PLAN IS APPROVED FOR SOIL EROSION AND SEDIMENT CONTROL BY THE HOWARD SOIL CONSERVATION DISTRICT.

APPROVED *Wanda J. Rowe*  
SIGNATURE  
HOWARD S.C.D.  
7-17-79  
DATE

APPROVED FOR PUBLIC WATER AND PUBLIC SEWAGE SYSTEMS HOWARD COUNTY HEALTH DEPARTMENT.

*Joyce Bryan*  
COUNTY HEALTH OFFICER  
7-20-79  
DATE

APPROVED HOWARD COUNTY OFFICE OF PLANNING AND ZONING

*Donald A. Smith*  
PLANNING DIRECTOR  
7-23-79  
DATE  
*Charles McArthur*  
CHIEF DIVISION OF LAND DEVELOPMENT  
7-23-79  
DATE

APPROVED FOR PUBLIC WATER AND PUBLIC SEWAGE STORM DRAINAGE SYSTEMS AND PUBLIC ROADS HOWARD COUNTY DEPARTMENT OF PUBLIC WORKS.

*Steve F. Newman*  
DIRECTOR  
7-19-79  
DATE  
*W.O. F. Ford*  
CHIEF BUREAU OF ENGINEERING  
7-18-79  
DATE



APPROVED  
DIVISION OF LAND DEVELOPMENT  
HOWARD COUNTY, MARYLAND  
DATE 6-7-79  
*ACM*

**BENNETT-JOLSON & ASSOCIATES AIA ARCHITECTS**  
COLUMBIA, MARYLAND TEL. 301-730-1766

**MACRIS, HENDRICKS AND WITMER P.A.**  
ENGINEERS, SURVEYORS, PLANNERS  
15209 FREDERICK ROAD ROCKVILLE, MD. 20850 TEL (301)-340-8705

**DEPARTMENT OF RECREATION & PARKS**  
HOWARD COUNTY, MARYLAND  
5-7-79  
DATE  
*Director*  
DIRECTOR

**CAPITAL PROJECT N-4-3008**

**SITE DEVELOPMENT PLAN**

CONCESSION BUILDING FOR SAVAGE PARK  
TAX MAP 47 LIBER 501 FOLIO 704 PAR. 92 ELECTION DISTRICT NO. 6 HOWARD COUNTY, MD.

DRAWING NO. 2 OF 5	SCALE AS SHOWN	DATE 3-8-79
		JOB NO. 78-134

SDP-79-138

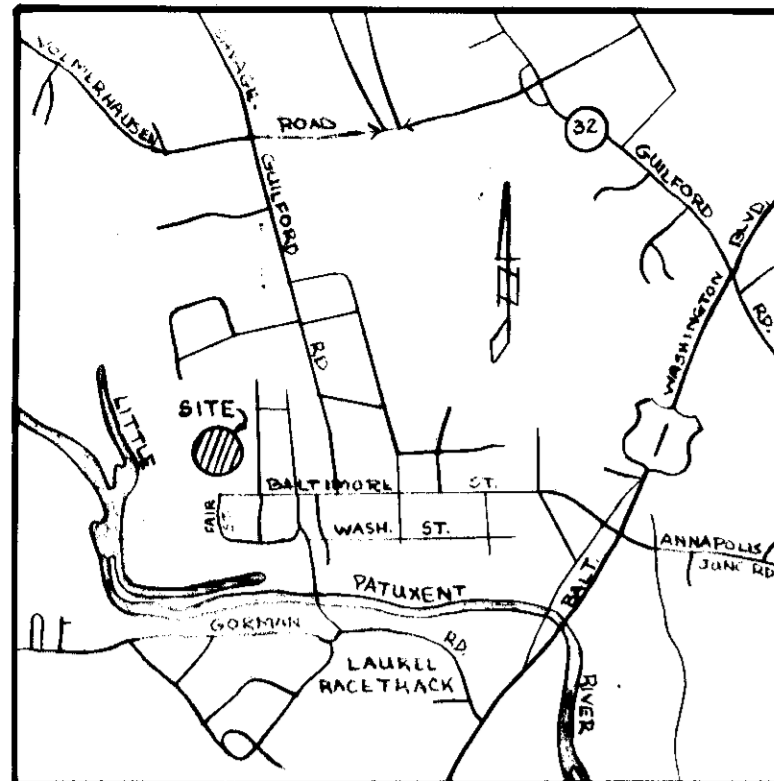

VICINITY MAP  
SCALE 1" = 2000'

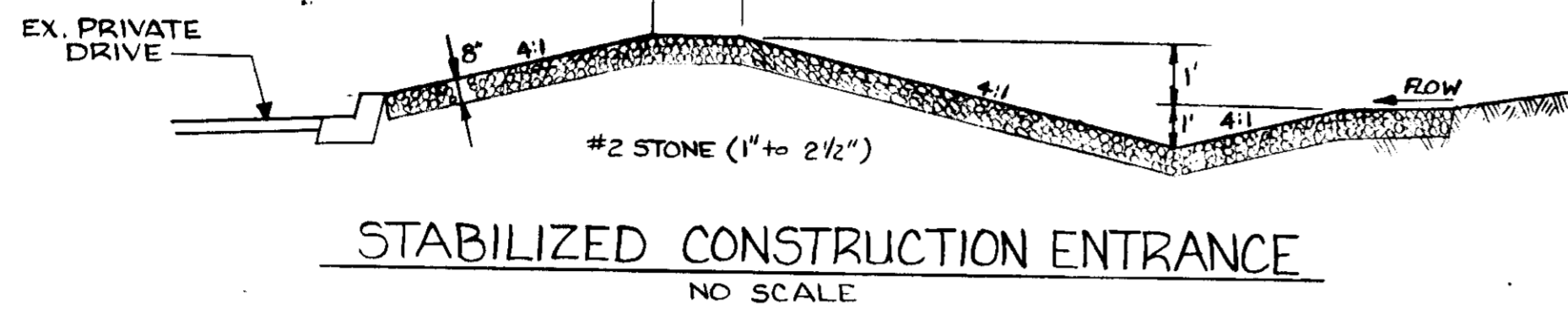

LEGEND

- EXISTING CONTOUR  258
- PROPOSED CONTOUR  258
- PERIMETER DIKE
- STONE OUTLET STRUCTURE

SITE ANALYSIS

TOTAL AREA OF PROPERTY: 63.68 AC.  
TOTAL DISTURBED AREA: 109,300 SQ. FT.  
TOTAL REVEGETATED AREA: 99,000 SQ. FT.  
TOTAL PAVING REMOVED: 8600 SQ. FT.

REVISIONS

1. Additional grading - Add Sheet 2
2. Addition to building - A 9-26-95

THESE PLANS HAS BEEN REVIEWED FOR THE HOWARD SOIL CONSERVATION DISTRICT AND MEET THE TECHNICAL REQUIREMENTS

*William B. Bennett* 7-17-79  
SIGNATURE DATE  
U.S. SOIL CONSERVATION SERVICE

THIS DEVELOPMENT PLAN IS APPROVED FOR SOIL EROSION AND SEDIMENT CONTROL BY THE HOWARD SOIL CONSERVATION DISTRICT.

APPROVED *Wm. T. Rowe* 7-17-79  
SIGNATURE DATE  
HOWARD S.C.D.

APPROVED FOR PUBLIC WATER AND PUBLIC SEWERAGE SYSTEMS HOWARD COUNTY HEALTH DEPARTMENT.  
*Joyce B. Baker* 7-21-79  
COUNTY HEALTH OFFICER DATE

APPROVED HOWARD COUNTY OFFICE OF PLANNING AND ZONING.  
*Thomas J. Harris* 7-23-79  
PLANNING DIRECTOR DATE  
*John J. Starnes* 7-28-79  
CHIEF OFFICER OF LAND DEVELOPMENT DATE

APPROVED FOR PUBLIC WATER AND PUBLIC SEWERAGE STORM DRAINAGE SYSTEMS AND PUBLIC ROADS HOWARD COUNTY DEPARTMENT OF PUBLIC WORKS.  
*John F. Newman* 7-19-79  
DIRECTOR DATE  
*W.O. Colbert* 7-18-79  
CHIEF BUREAU OF ENGINEERING DATE

DEVELOPER'S CERTIFICATION

"I CERTIFY THAT ALL DEVELOPMENT AND/OR CONSTRUCTION WILL BE DONE IN ACCORDANCE WITH THIS PLAN OF DEVELOPMENT AND PLAN FOR EROSION AND SEDIMENT CONTROL, AND I ALSO AUTHORIZE PERIODIC ON-SITE INSPECTION BY HOWARD SOIL CONSERVATION DISTRICT OR THEIR AUTHORIZED AGENTS, AS ARE DEEMED NECESSARY." DEVIATION FROM THIS PLAN WILL NOT BE MADE UNLESS AUTHORIZED BY THE HOWARD SOIL CONSERVATION DISTRICT.

*Wm. B. Bennett* 5-7-79  
SIGNATURE OF DEVELOPER DATE

ENGINEER'S CERTIFICATION

"I CERTIFY THAT THIS PLAN FOR EROSION AND SEDIMENT CONTROL REPRESENTS A PRACTICAL AND WORKABLE PLAN BASED ON MY PERSONAL KNOWLEDGE OF THE SITE CONDITIONS AND THAT IT WAS PREPARED IN ACCORDANCE WITH THE REQUIREMENTS OF THE HOWARD SOIL CONSERVATION DISTRICT."

*Wm. B. Bennett* 4-22-79  
SIGNATURE OF ENGINEER DATE

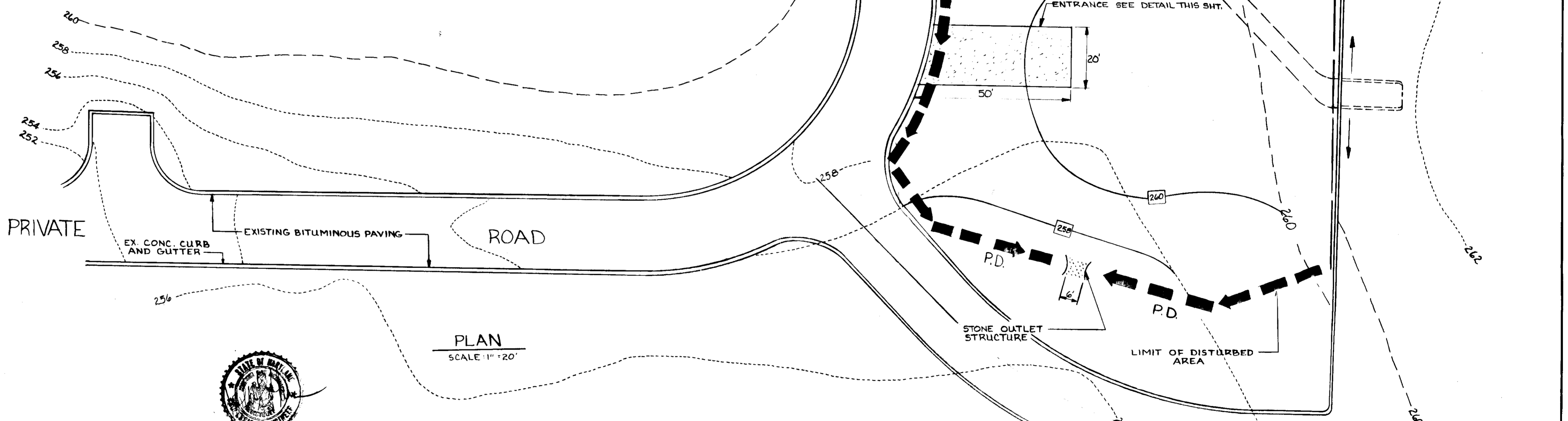

**MACRIS, HENDRICKS AND WITMER P.A.**  
ENGINEERS, SURVEYORS, PLANNERS  
15209 FREDERICK ROAD ROCKVILLE, MD. 20850 TEL. (301)-340-8705

**DEPARTMENT OF RECREATION & PARKS**  
HOWARD COUNTY, MD.  
5-7-79 DATE  
*Wm. B. Bennett* DIRECTOR

**CAPITAL PROJECT N-4-3008**  
SITE DEVELOPMENT  
PLAN

**OWNER / DEVELOPER**  
HOWARD COUNTY DEPT. OF RECREATION AND PARKS  
3430 COURT HOUSE DRIVE  
ELLIOTT CITY, MD. 21043  
TEL. 912-2400

**CONCESSION BUILDING FOR SAVAGE PARK**  
TAX MAP 47 LIBER 501 FOLIO 704 PAR 92  
ELECTION DISTRICT NO. 6 HOWARD COUNTY, MD.

APPROVED DIVISION OF LAND DEVELOPMENT  
HOWARD COUNTY, MARYLAND  
DATE 6-7-79  
*Wm. B. Bennett*

DRAWING NO.	SCALE	DATE
3	AS SHOWN	3-8-79
OF 5		JOB NO. 78-134

# SOIL EROSION AND SEDIMENT CONTROL NOTES

1. ALL SOIL EROSION AND SEDIMENT CONTROL MEASURES SHALL BE CONSTRUCTED PRIOR ANY OTHER SITE DISTURBANCE.
2. ALL SEDIMENT CONTROL MEASURES SHALL REMAIN IN PLACE UNTIL PERMISSION FOR THEIR REMOVAL HAS BEEN OBTAINED FROM THE BUREAU OF INSPECTIONS AND PERMITS, PHONE 992-2435.
3. NOTIFY THE BUREAU OF INSPECTIONS AND PERMITS AT LEAST 24 HOURS BEFORE THE START OF ANY WORK, PHONE 992-2435.
4. CONTINUED INSPECTION AND MAINTENANCE SHALL BE THE RESPONSIBILITY OF THE DEVELOPER.
5. ALL SEDIMENT CONTROL MEASURES SHALL COMFORM TO "THE STANDARDS AND SPECIFICATIONS FOR SOIL EROSION AND SEDIMENT CONTROL IN DEVELOPING AREAS" AND AS SHOWN AND DETAILED ON THESE PLANS.
6. SEED OR SOD ALL EXPOSED SOIL IN GRASSED AREAS WITHIN 72 HOURS OF GRADING TO FINISHED GRADE IN ACCORDANCE WITH HOWARD SOIL CONSERVATION DISTRICT STANDARDS AND SPECIFICATIONS AND THESE NOTES.
7. TEMPORARY SEEDING:
  - GROUND LIMESTONE - 3500 LBS/Ac. WORKED INTO TOP 3" OF SOIL
  - FERTILIZER - 1300 LBS/Ac. 10-10-10
  - MULCH - 3000 LBS/Ac. STRAW (WHEAT PREFERRED)
  - SEED - 40 LBS/Ac. RYE GRASS
  - BINDER - ASPHALT SPRAY @ RATE OF 1 GAL./1000 SQ. FT.
  - ALTERNATE - HYDRO SEED FERTILIZER, SEED AND MULCH USING "TURFIBER" OR APPROVED EQUAL.
8. PERMANENT SEEDING:
  - GROUND LIMESTONE - 2000 LBS/Ac. WORKED INTO TOP 3" OF SOIL
  - FERTILIZER - 1300 LBS/Ac. 10-10-10
  - SEED - 90% KENTUCKY 31 TALL FESCUE  
8% RYE GRASS  
2% MERION BLUEGRASS
  - SEEDING RATE - 150 LBS/Ac.
  - BINDER - ASPHALT SPRAY OF MULCH @ RATE OF 1 GAL./1000 SQ. FT.
  - ALTERNATE - HYDRO SEED FERTILIZER, SEED, AND BINDER USING "TURFIBER" OR APPROVED EQUAL.
9. NO SLOPES SHALL BE STEEPER THAN 3:1.

## SODDING NOTES

1. APPLY 10-10-10 FERTILIZER @ 1000 LBS/Ac. (25 LBS/100 SQ. FT.)
2. APPLY GROUND AGRICULTURAL LIMESTONE @ 2000 LBS/Ac. (50 LBS/1000 SQ. FT.)
3. INCORPORATE BOTH LIME AND FERTILIZER INTO SOIL BY DISCING, FIRM UP AFTER INCORPORATION.
4. LAY SOD TO A TIGHT FIT, ROLL TO ENSURE CONTACT WITH UNDERLYING SOIL.
5. WATER AS NECESSARY FOR FIRST TWO WEEKS TO ENSURE ESTABLISHMENTS.

## SEQUENCE OF CONSTRUCTION

1. OBTAIN BUILDING PERMIT.
2. CONSTRUCT AND MAINTAIN ALL SOIL EROSION AND SEDIMENT CONTROL STRUCTURES PRIOR TO ANY OTHER SITE DISTURBANCE. PLACE SAND BAGS TO PROTECT INLET OPENING AT THIS TIME.
3. PROCEED WITH PAVEMENT REMOVAL, SITE GRADING, AND BUILDING CONSTRUCTION.
4. AS VARIOUS AREAS ARE BROUGHT TO FINAL GRADE, PLACE TOPSOIL, SOD/SEED GRASSED AREAS AND STABILIZE OTHER AREAS IN CONFORMANCE WITH THESE PLANS AND "SOIL EROSION AND SEDIMENT CONTROL NOTES".
5. UPON COMPLETION OF FINE GRADING AND STABILIZATION OF SITE, ALL SEDIMENT CONTROL STRUCTURES SHALL BE REMOVED.

### REVISIONS

1. Additional grading - Add Sheet 2

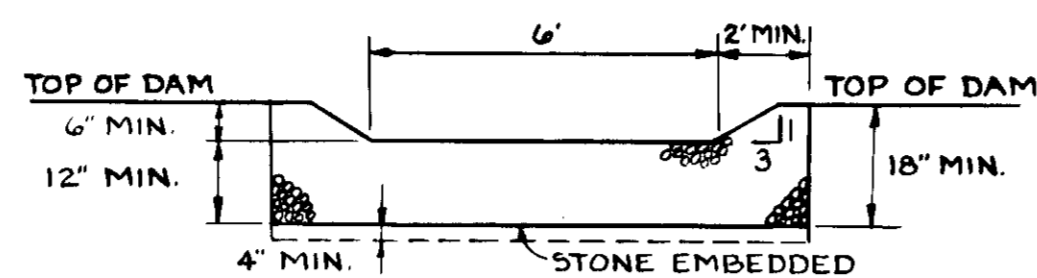

STONE OUTLET STRUCTURE

NO SCALE

STONE SHALL BE CRUSHED STONE OR MEET M.S.H.A. SIZE #2 OR A.A.S.H.T.O. DESIGNATION M43 SIZE #2 OR 24

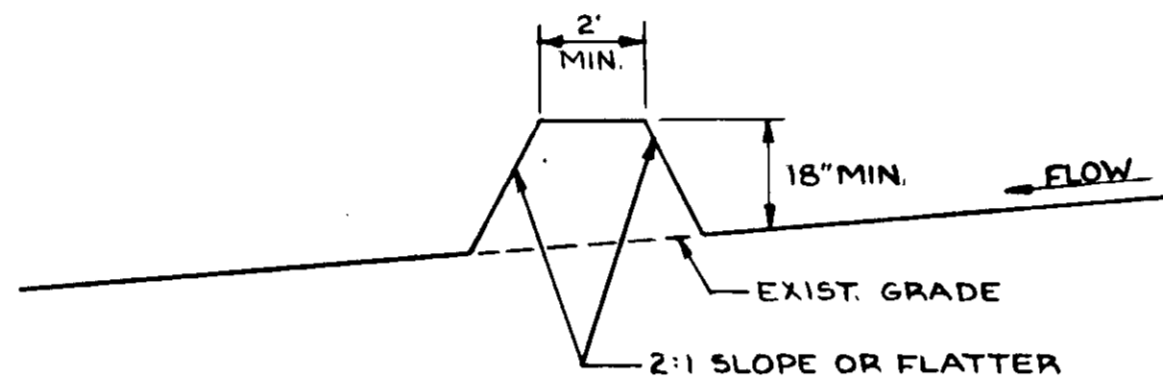

PERIMETER DIKE

NO SCALE

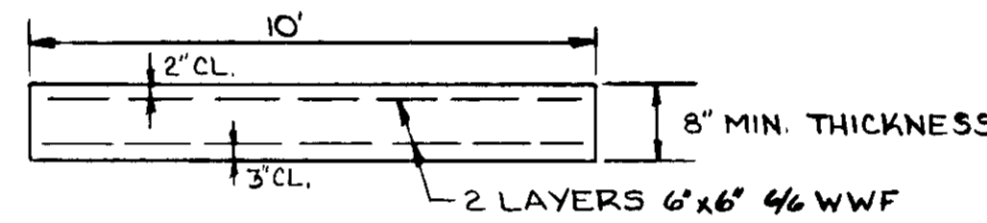

CONCRETE TRASH PAD

NO SCALE

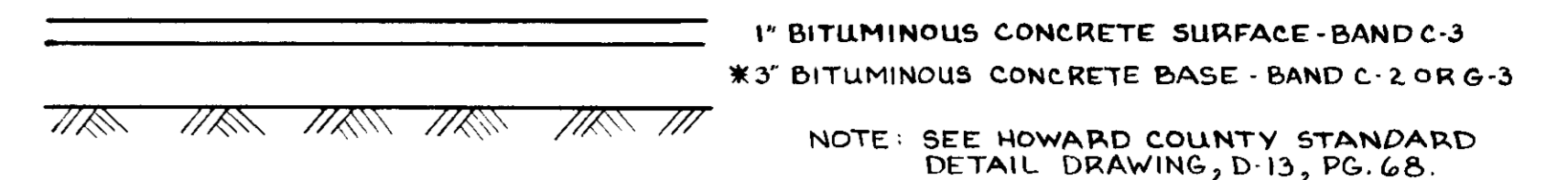

1. THE BASE WILL BE PRIMED IN ACCORDANCE WITH SECTION C-30-3 AS PROVIDED IN THE HOWARD COUNTY ROAD CONSTRUCTION CODE & STANDARD SPECIFICATIONS.
2. TACK COAT IS REQUIRED IN ACCORDANCE WITH SECTION C-31-4 OF THE HOWARD COUNTY ROAD CONSTRUCTION CODE & STANDARD SPECIFICATIONS.
3. ALL CONSTRUCTION AND MATERIALS SHALL BE IN ACCORDANCE WITH THE REQUIREMENTS OF THE HOWARD COUNTY ROAD CONSTRUCTION CODE & STANDARD SPECIFICATIONS.
- \* 4. BASE COURSE SHALL BE 4' IN AREA OF 10' WIDE VEHICULAR DRIVE.

BITUMINOUS PAVING DETAIL

NO SCALE

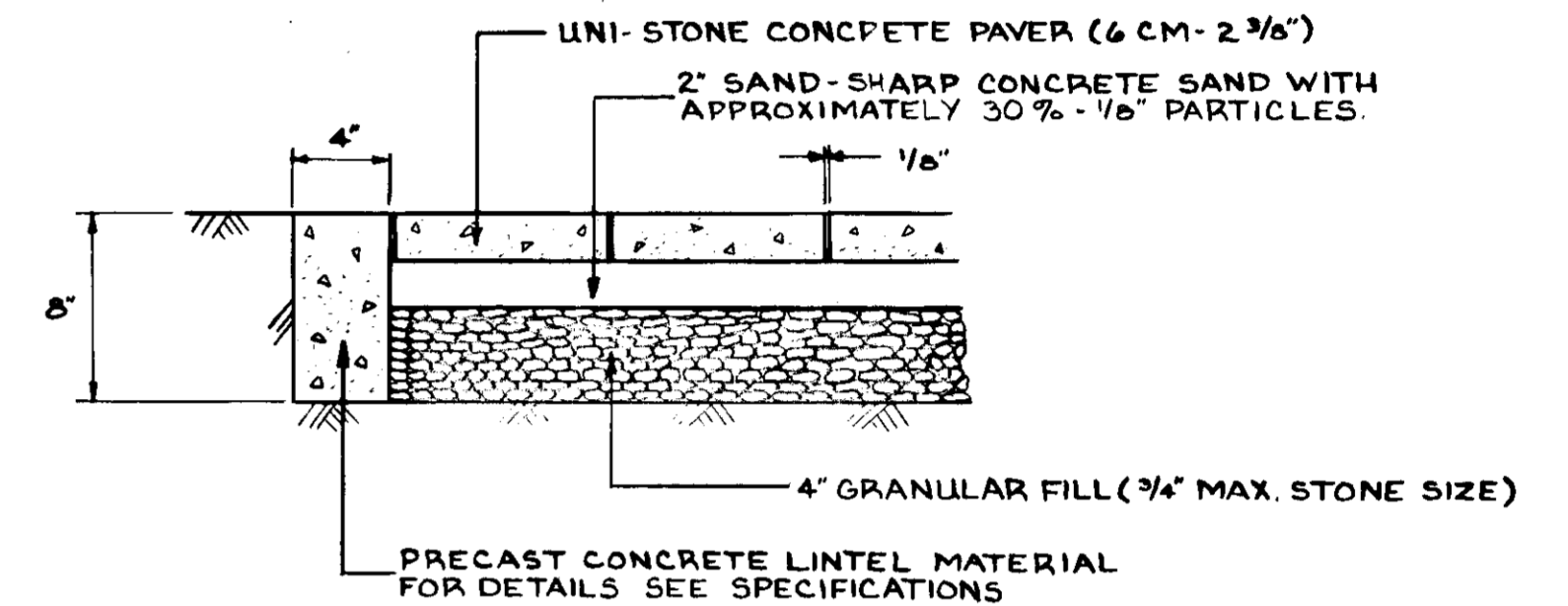

1. TAMP DOWN AND LEVEL THE PAVERS WITH MECHANICAL VIBRATORS UNTIL PAVERS ARE UNIFORMLY LEVEL, TRUE TO GRADE AND FREE OF ANY MOVEMENT.
2. FILL ALL VOIDS IN THE PAVER JOINTS BY SWEEPING IN DRY, SHARP SAND.

CONCRETE PAVER DETAIL

NO SCALE

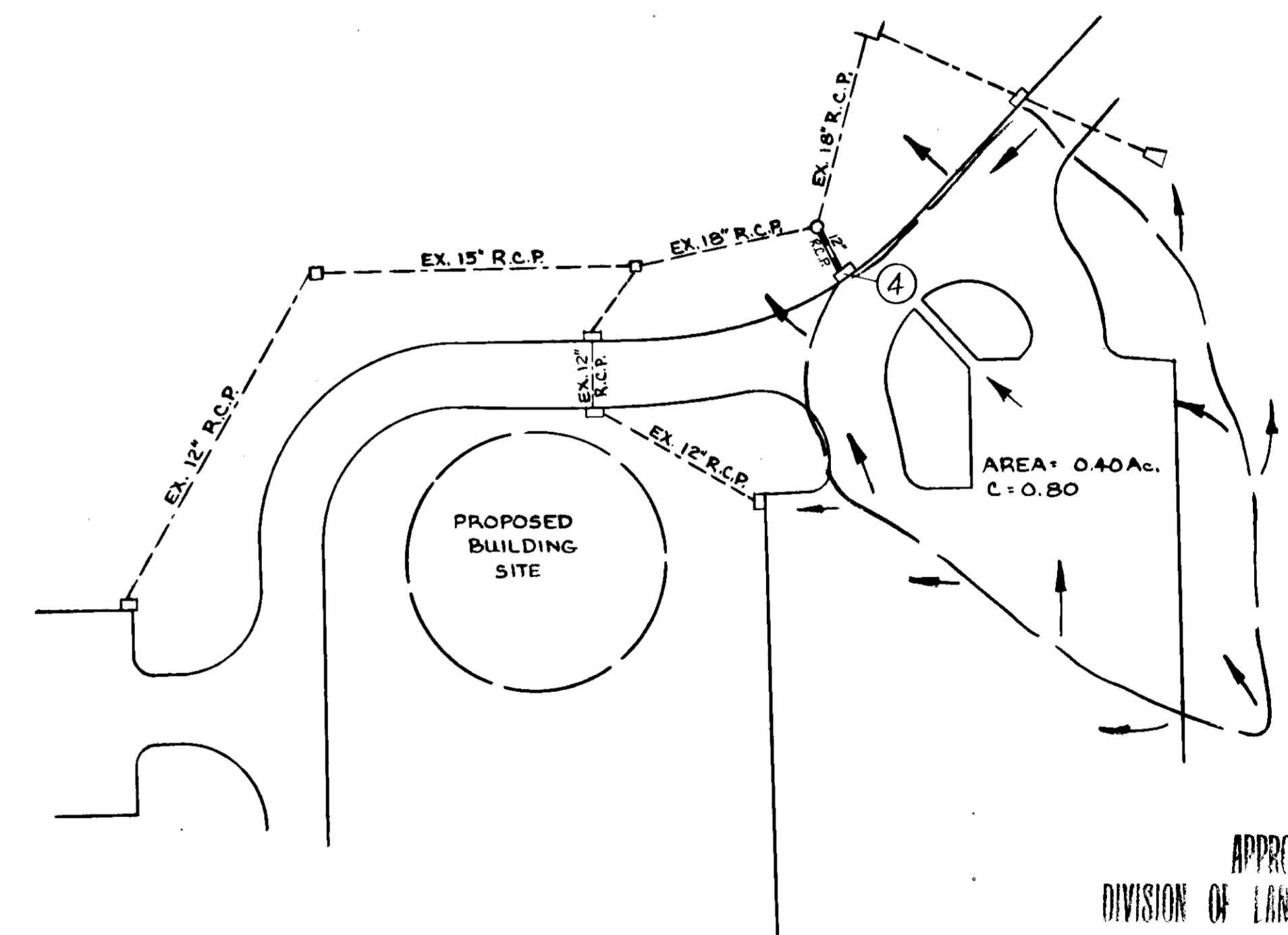

DRAINAGE AREA MAP

SCALE: 1" = 40'

APPROVED  
DIVISION OF LAND DEVELOPMENT

HOWARD COUNTY, MARYLAND

DATE 6-7-79

APPROVED FOR PUBLIC WATER AND PUBLIC SEWERAGE SYSTEMS HOWARD COUNTY HEALTH DEPARTMENT.

*Joseph P. Ryan*  
COUNTY HEALTH OFFICER  
DATE 7-20-79

THESE PLANS HAS BEEN REVIEWED FOR THE HOWARD SOIL CONSERVATION DISTRICT AND MEET THE TECHNICAL REQUIREMENTS.

*William J. Rowe*  
SIGNATURE  
U.S. SOIL CONSERVATION SERVICE  
DATE 7-17-79

APPROVED HOWARD COUNTY OFFICE OF PLANNING AND ZONING.

*Donald J. Harris*  
PLANNING DIRECTOR  
DATE 7-23-79

*John C. H. H. H.*  
CHIEF DIVISION OF LAND DEVELOPMENT  
DATE 7-2-79

APPROVED FOR PUBLIC WATER AND PUBLIC SEWERAGE STORM DRAINAGE SYSTEMS AND PUBLIC ROADS HOWARD COUNTY DEPARTMENT OF PUBLIC WORKS.

*John F. Nunn*  
DIRECTOR  
DATE 7-19-79

THIS DEVELOPMENT PLAN IS APPROVED FOR SOIL EROSION AND SEDIMENT CONTROL BY THE HOWARD SOIL CONSERVATION DISTRICT.

APPROVED *William J. Rowe*  
SIGNATURE  
HOWARD S.C.D.  
DATE 7-17-79

**BENNETT-JOLSON & ASSOCIATES** ARCHITECTS  
COLUMBIA, MARYLAND TEL. 301-730-1766

**MACRIS, HENDRICKS AND WITMER P.A.** ENGINEERS, SURVEYORS, PLANNERS  
15209 FREDERICK ROAD ROCKVILLE, MD 20850 TEL. (301)-340-8705

DEPARTMENT OF RECREATION & PARKS  
HOWARD COUNTY, MD  
DATE 5-7-79  
*W. J. Rowe*  
DIRECTOR

CAPITAL PROJECT N-4-3008

SITE DEVELOPMENT  
PLAN

CONCESSION BUILDING FOR SAVAGE PARK  
TAX MAP 47 LIBER 501 FOLIO 704 PAR 92 ELECTION DISTRICT NO. 6 HOWARD COUNTY, MD.

DRAWING SCALE AS SHOWN DATE 3-8-79 JOB NO. 78-134

SDP-79-138

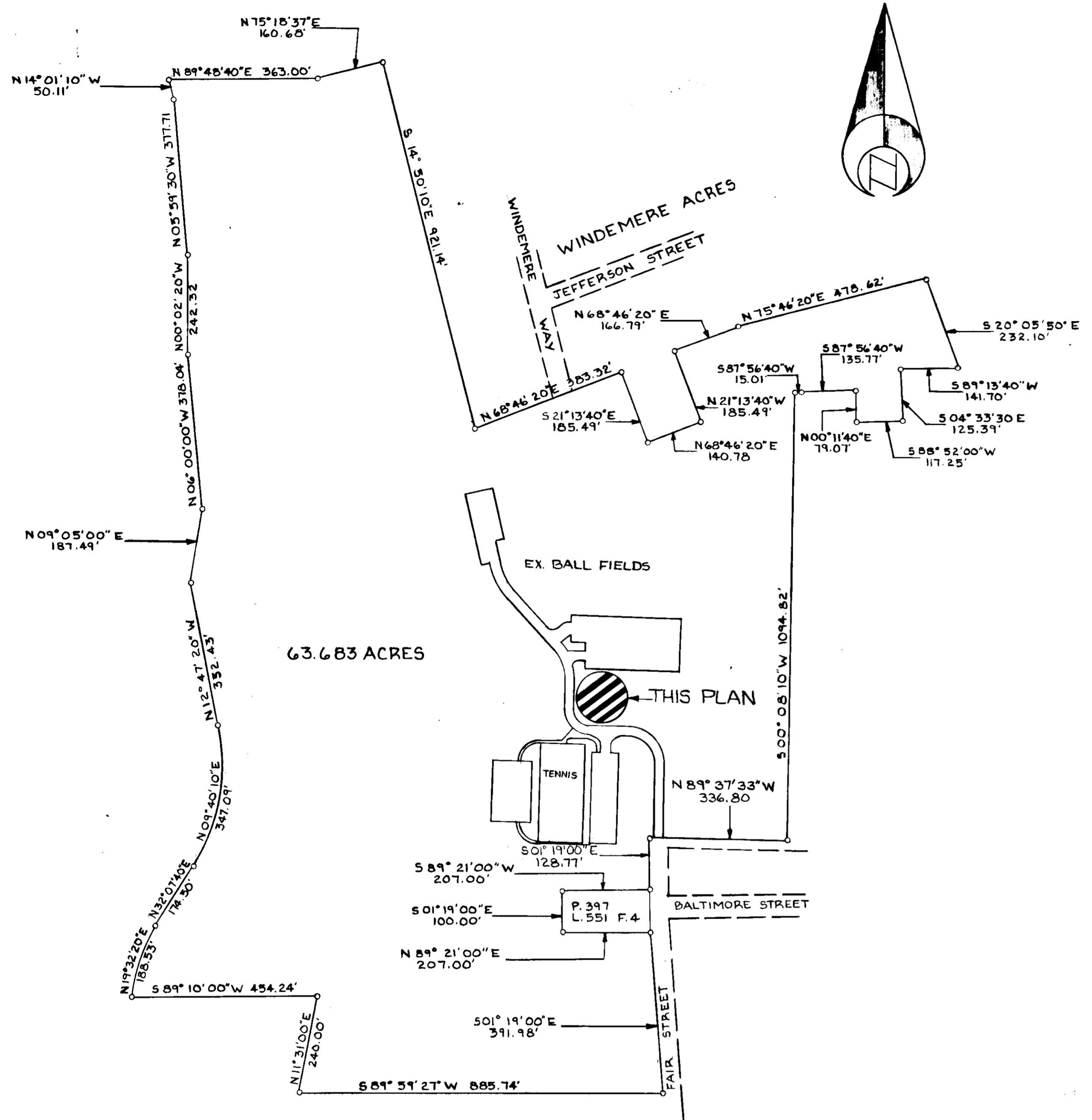

PROPERTY BOUNDARY OUTLINE  
SCALE: 1" = 200'

REVISIONS  
1. Additional grading - Add Sheet 2

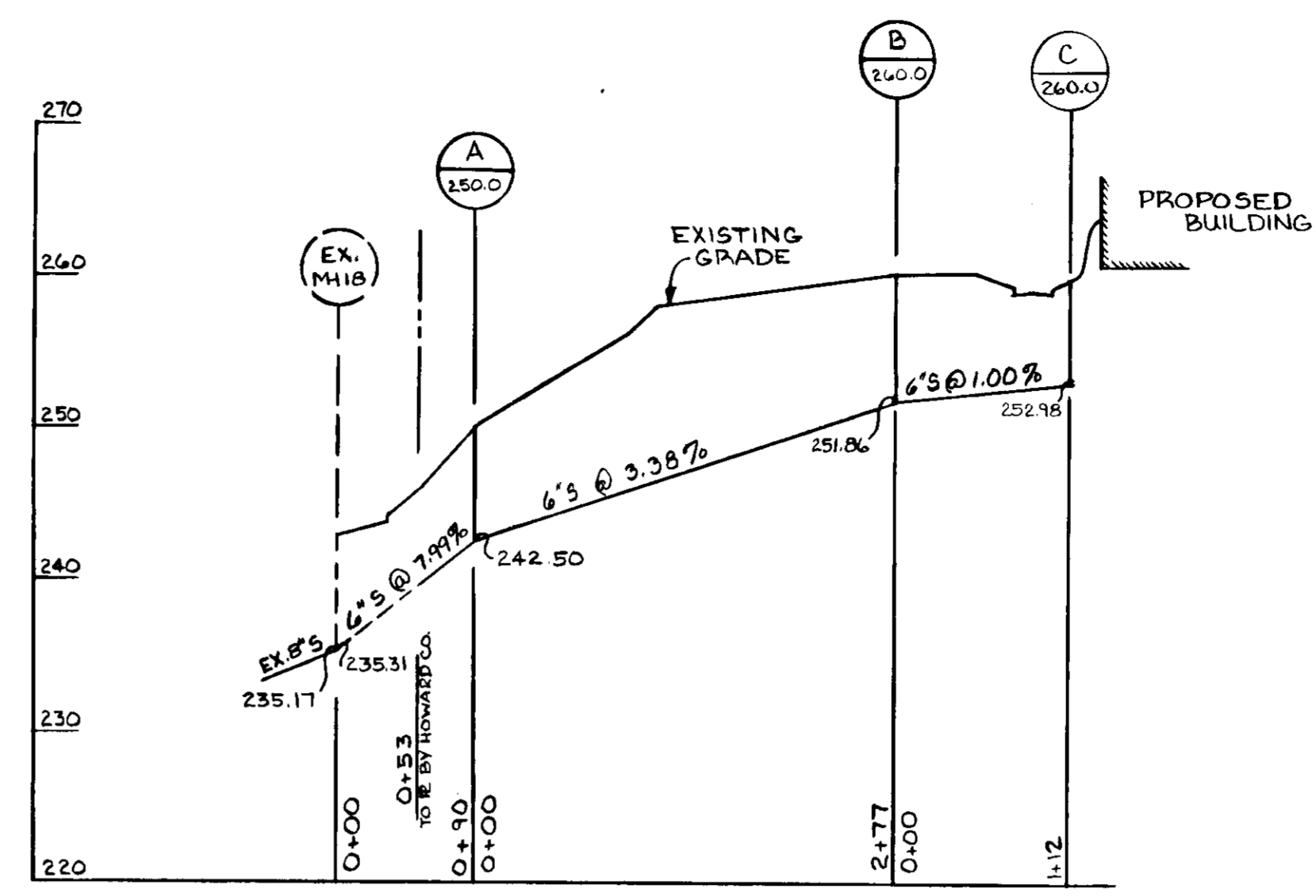

SEWER PROFILE  
SCALE: VERT. 1" = 10'  
HORIZ. 1" = 100'

STRUCTURE SCHEDULE				
NO.	TYPE	TOP ELEV.	INVERT	REMARKS
1	10" x 10" SQ.	260.00	258.0	JOSAM #5066
2	10" x 10" SQ.	260.00	258.0	JOSAM #5066
3	10" x 10" SQ.	260.08	258.0	JOSAM #5066
4	A-5	258.70	254.20	HOWARD CO. DWG. 64-A-10, 11, 12

PIPE SCHEDULE		
SIZE	TYPE	LENGTH
6"	PVC	113'
12"	RCP CL III	67'

- WATER AND SEWER NOTES**
- All manholes shall be precast concrete.
  - All 6" sewer shall be V.C.P.X., C.S.P.X., or A.C.P. class 2400.
  - All 2" water shall be as noted in Construction Specifications.

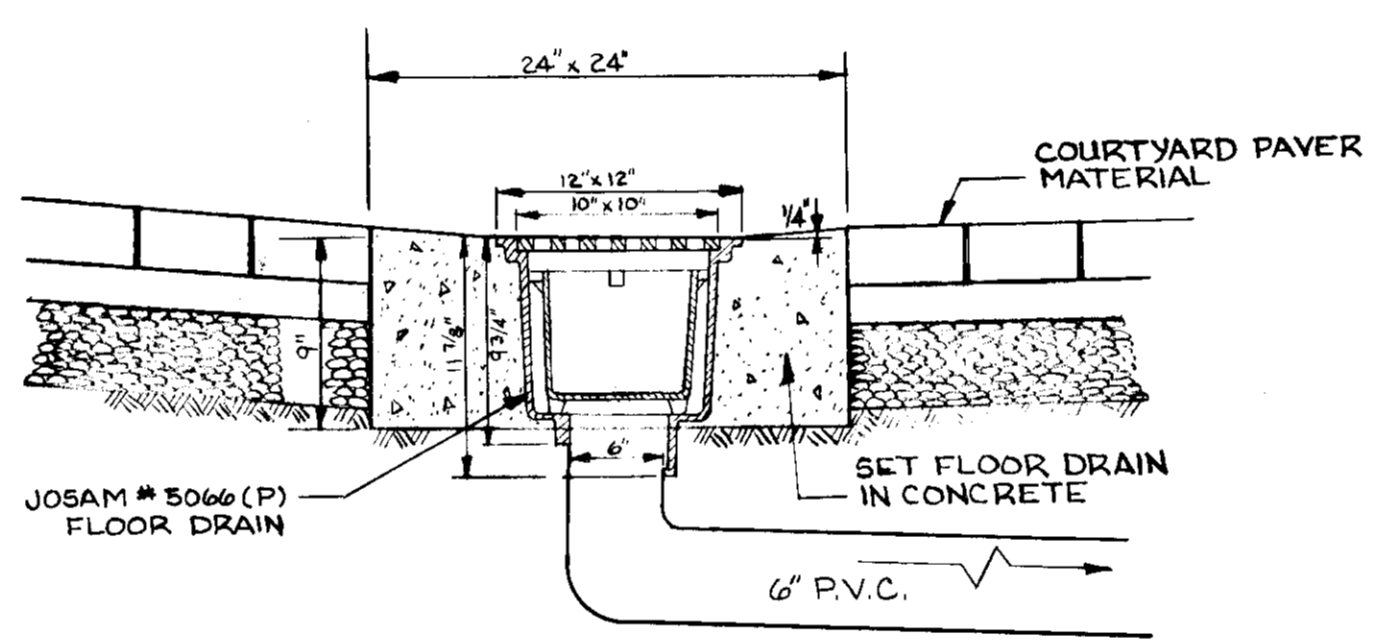

COURTYARD DRAIN DETAIL  
NO SCALE

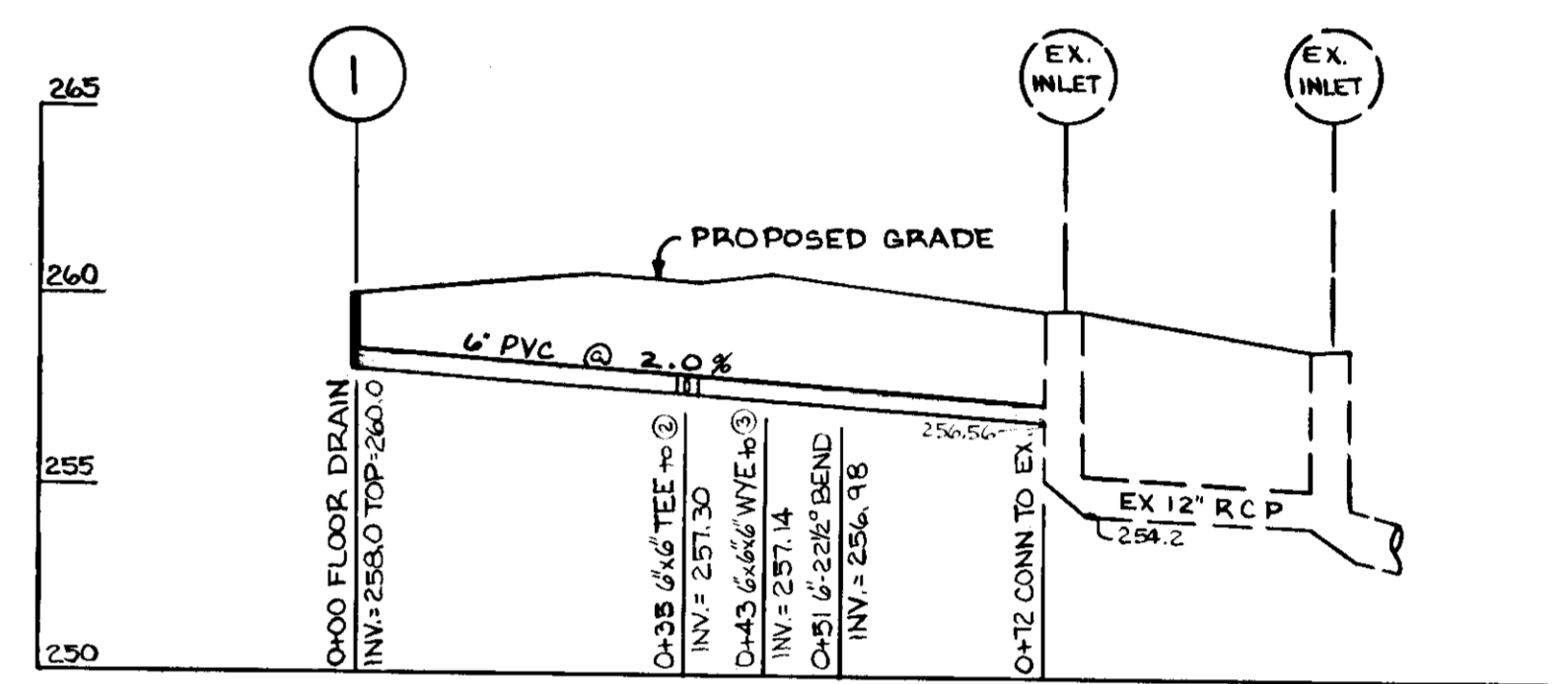

COURTYARD DRAIN PROFILE  
SCALE: VERT. 1" = 3'  
HORIZ. 1" = 20'

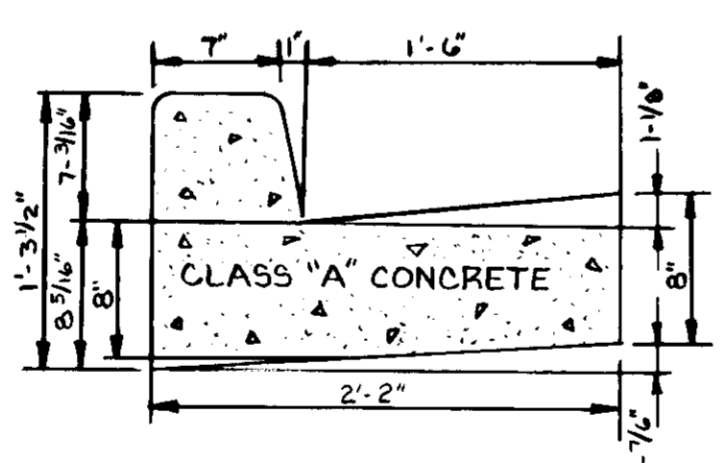

HOWARD COUNTY STD. DETAIL  
DRAWING D-40, PAGE 95  
CURB & GUTTER DETAIL  
NO SCALE

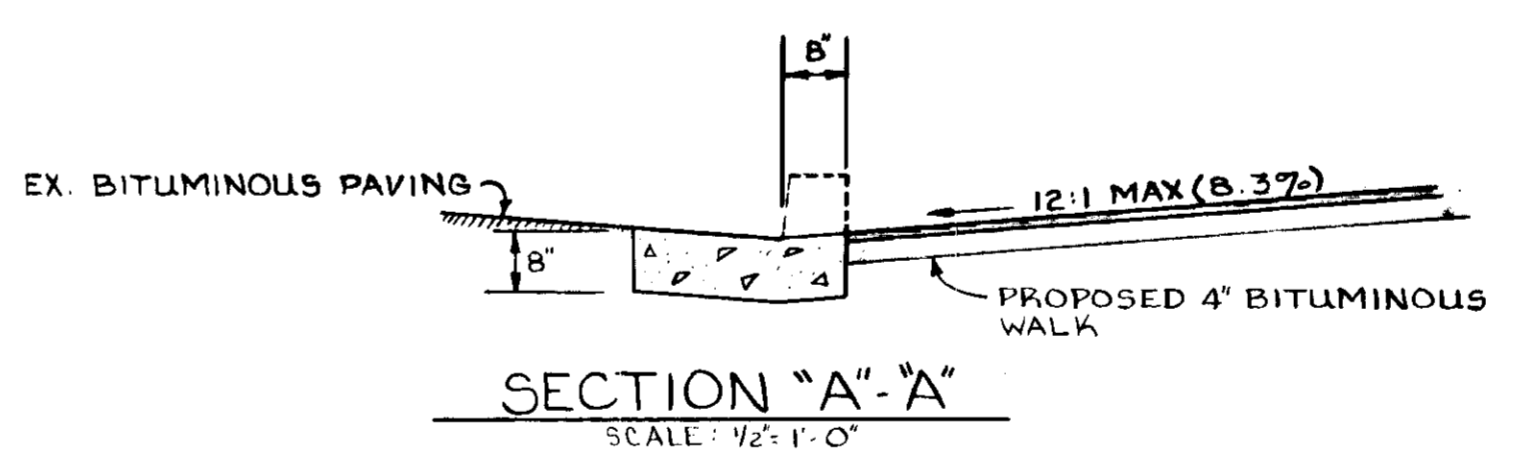

SECTION "A-A"  
SCALE: 1/2" = 1'-0"

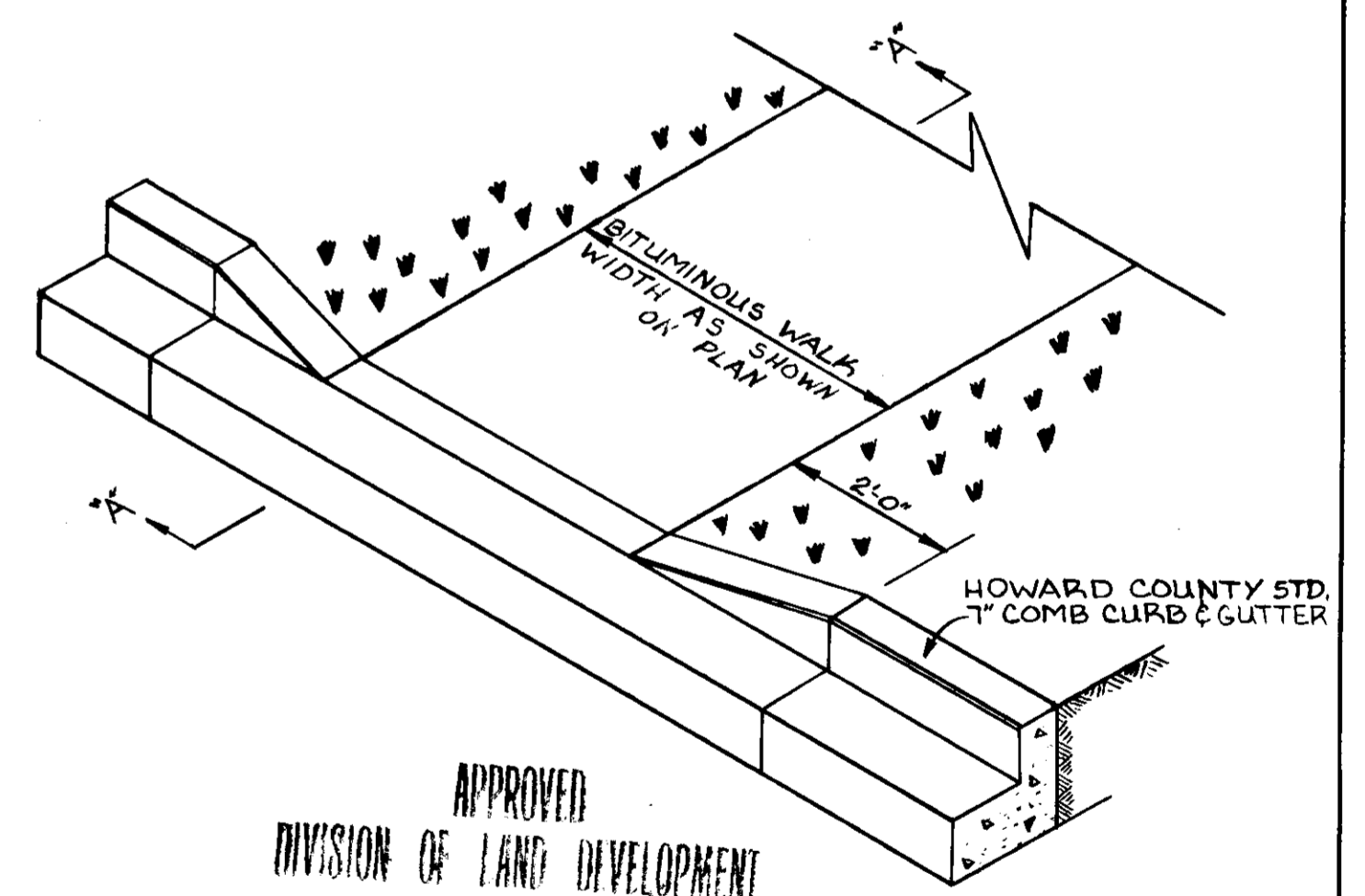

HANDICAPPED RAMP DETAIL  
SCALE: 1/2" = 1'-0"

APPROVED FOR PUBLIC WATER AND PUBLIC SEWERAGE SYSTEMS HOWARD COUNTY HEALTH DEPARTMENT.  
*John Bohm* 7-20-79  
COUNTY HEALTH OFFICER DATE

APPROVED HOWARD COUNTY OFFICE OF PLANNING AND ZONING.  
*Thomas J. Jamieson* 7-23-79  
PLANNING DIRECTOR DATE

APPROVED FOR PUBLIC WATER AND PUBLIC SEWERAGE STORM DRAINAGE SYSTEMS AND PUBLIC ROADS HOWARD COUNTY DEPARTMENT OF PUBLIC WORKS.  
*George F. Neumann* 7-19-79  
DIRECTOR DATE

*W.O. Pickett* 7-18-79  
CHIEF BUREAU OF ENGINEERING DATE



<b>BENNETT-JOLSON &amp; ASSOCIATES AIA ARCHITECTS</b> COLUMBIA, MARYLAND TEL. 301-730-1766	<b>MACRIS, HENDRICKS AND WITMER P.A.</b> ENGINEERS, SURVEYORS, PLANNERS 15209 FREDERICK ROAD ROCKVILLE, MD. 20850 TEL. (301)-340-8705	DEPARTMENT OF RECREATION & PARKS HOWARD COUNTY, MD. 5-7-79 DATE <i>W. L. Wilson</i> DIRECTOR	CAPITAL PROJECT N-4-3008 SITE DEVELOPMENT PLAN	CONCESSION BUILDING FOR SAVAGE PARK TAX MAP 47 LIBER 501 FOLIO 704 PAR 92 ELECTION DISTRICT NO. 6 HOWARD COUNTY, MD.	DRAWING NO. 5 OF 5	SCALE AS SHOWN	DATE 3-8-79 JOB NO. 78-134
					SDP-79-138		