

TYPICAL HOUSE TYPES AND ELEVATIONS
No Scale

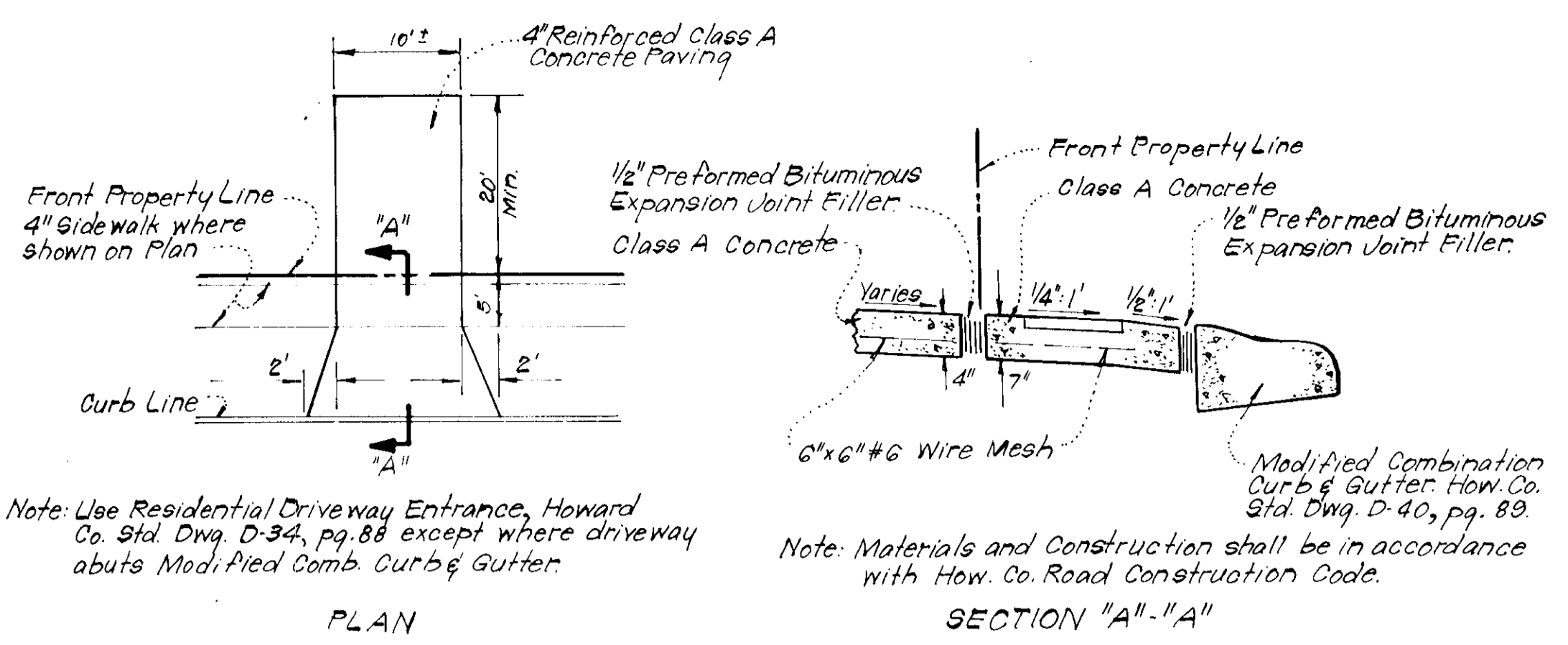

Note: Use Residential Driveway Entrance, Howard Co. Std. Dwg. D-34, pg. 88 except where driveway abuts Modified Comb. Curb & Gutter.

Note: Materials and Construction shall be in accordance with How. Co. Road Construction Code.

DRIVEWAY ABUTTING MODIFIED COMB. CURB & GUTTER
No Scale

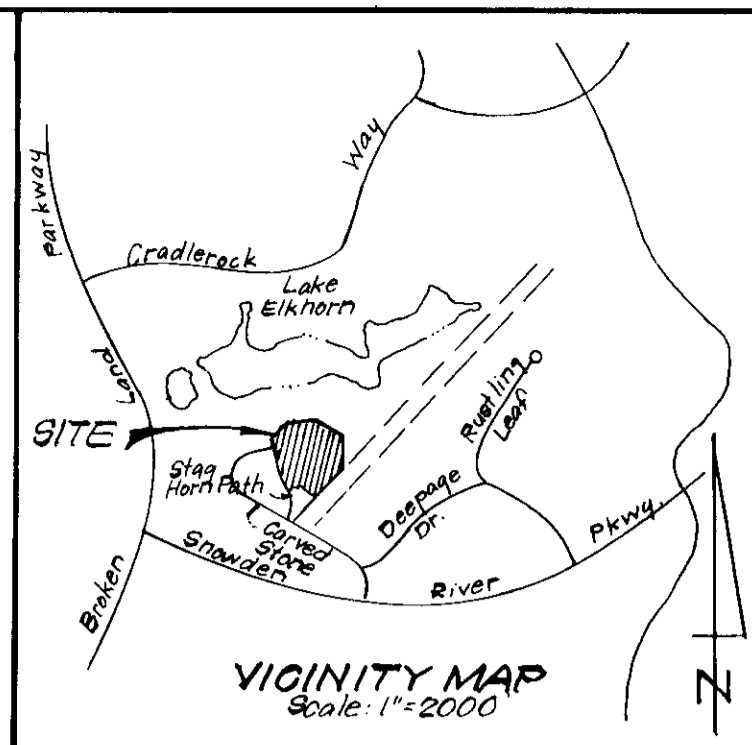

VICINITY MAP
Scale 1"=2000'

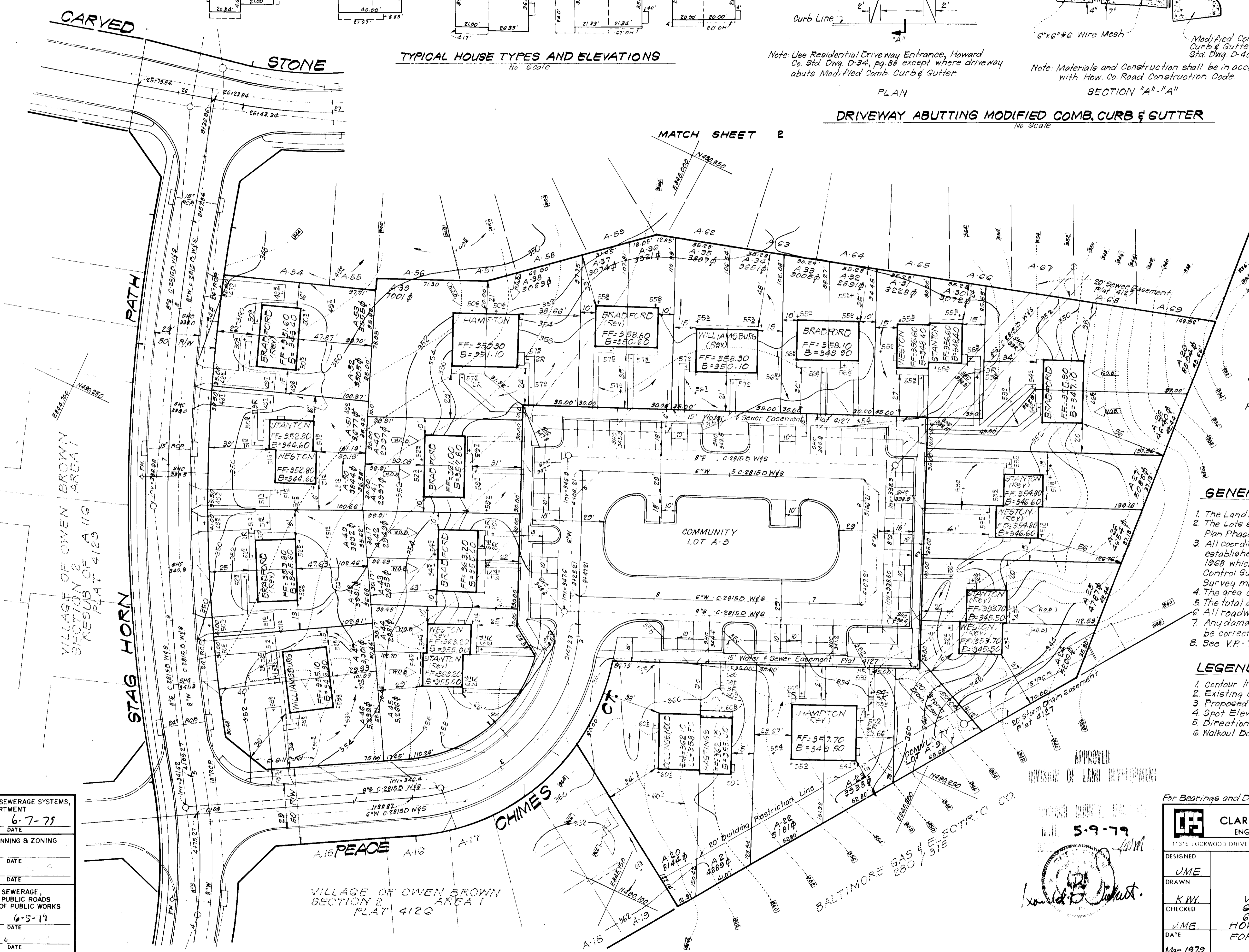

SITE ANALYSIS

LOTS:	
Residential Lots	36
Community Owned Lots	9
Parking	
Spaces Required	192
Spaces Provided	195

GENERAL NOTES:

- The Land included in this plan is zoned New Town (SFA)
- The Lots shown on this plan are covered by Final Development Plan Phase 118 Part 1-A
- All coordinates are based on traverse controls for Columbia established by Maps, Inc., in 1965 by Purdum & Jeschke in 1968 which controls were tied to Maryland Bureau of Control Survey monuments and to U.S. Coast and Geodetic Survey monuments in the Columbia area.
- The area covered in this submission is located on Tax Map No. 42.
- The total area included in this plan is 2.574 Acres
- All roadways are public & existing.
- Any damage to county owned rights of way or paving shall be corrected at developer's expense.
- See V.P. 78-72C

LEGEND:

1. Contour Interval	2 FT.
2. Existing Contours	360'
3. Proposed Contours	340'
4. Spot Elevation	+40'
5. Direction of Drainage	→
6. Walkout Basements	⬇

APPROVED FOR PUBLIC WATER AND PUBLIC SEWERAGE SYSTEMS,
HOWARD COUNTY HEALTH DEPARTMENT
DATE 6-7-78
COUNTY HEALTH OFFICER

APPROVED HOWARD COUNTY OFFICE OF PLANNING & ZONING
PLANNING DIRECTOR DATE
CHIEF DIVISION OF LAND DEVELOPMENT DATE

APPROVED FOR PUBLIC WATER AND PUBLIC SEWERAGE,
STORM DRAINAGE SYSTEMS AND PUBLIC ROADS
HOWARD COUNTY DEPARTMENT OF PUBLIC WORKS
DATE 6-5-79
DIRECTOR

CHIEF BUREAU OF ENGINEERING DATE

For Bearings and Distances of Individual Lots See Plats 4126, 27 & 28.

CLARK • FINEFROCK & SACKETT
ENGINEERS • PLANNERS • SURVEYORS
11315 LICKWOOD DRIVE SILVER SPRING, MARYLAND 20904 (301) 593 3400

DESIGNED: J.M.E. SCALE: 1"=30'
DRAWN: K.W.V. DRAWING: 1025
CHECKED: J.M.E. JOB NO.:
DATE: Mar, 1979 FILE NO.: 78-1177X

SITE DEVELOPMENT PLAN
LOTS A-20 THRU A-115
COLUMBIA
VILLAGE OF OWEN BROWN
SECTION 2 AREA
6th ELECTION DISTRICT
HOWARD COUNTY, MARYLAND
FOR: The Ryland Group Inc. (Col. Div.)
Suite 200 V.O.M. Office Bldg.
Columbia, Maryland 21043

5-9-79
K. Sackett

SDP-79-121c

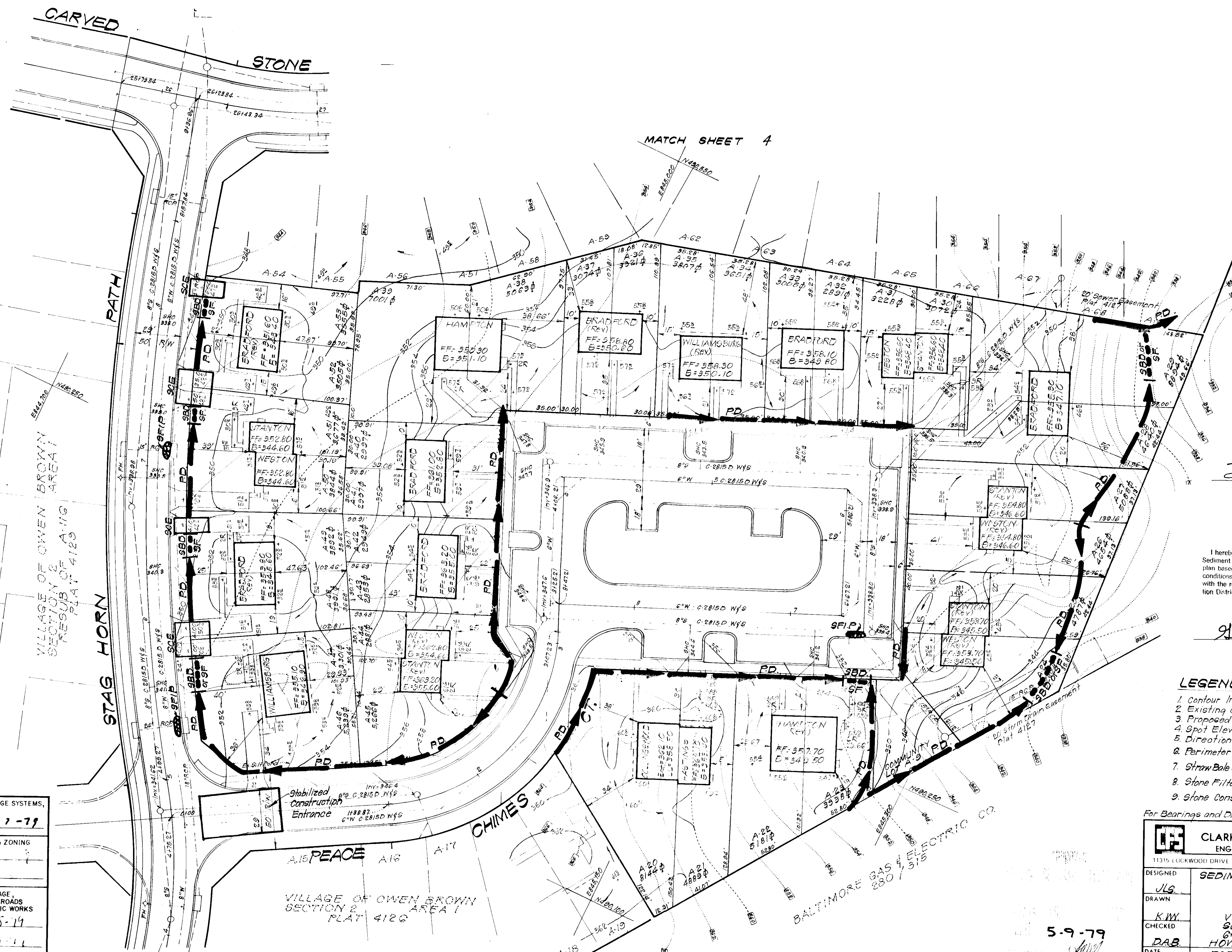
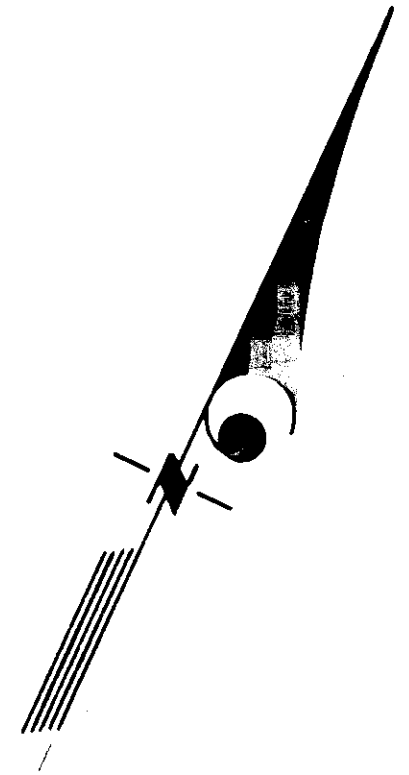
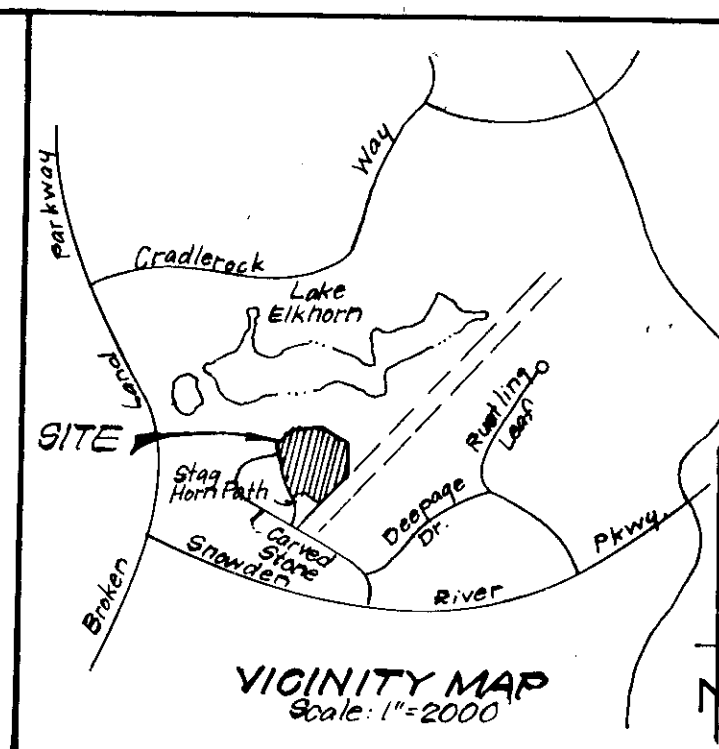

MATCH SHEET 4

Reviewed for... Howard... S.C.D.
 Name
 and meets Technical Requirements
 C. Wayne Ray 5/23/79
 Signature Date
 U.S. Soil Conservation Service

THIS DEVELOPMENT PLAN IS APPROVED FOR SOIL EROSION AND SEDIMENT CONTROL BY THE HOWARD SOIL CONSERVATION DISTRICT.

W. J. [Signature] Approved 5-23-79 Date

DEVELOPER'S CERTIFICATE

I certify that all development and/or construction will be done according to this plan of development and plan for Erosion and Sediment Control, and I authorize periodic on-site inspection by the Howard Soil Conservation District or their authorized agents as are deemed necessary. Deviation from this plan will not be made unless authorized by the Howard Soil Conservation District.

J. S. [Signature] 4-4-79 Date
 Signature Date

ENGINEER'S CERTIFICATE

I hereby certify that this plan for Erosion and Sediment Control represents a practical and workable plan based on my personal knowledge of the site conditions and that it was prepared in accordance with the requirements of the Howard Soil Conservation District.

G. Nelson Clark 4-4-79 Date
 Signature Date

LEGEND:

- 1. Contour Interval 2 Ft.
- 2. Existing Contours - - - - -
- 3. Proposed Contours - - - - -
- 4. Spot Elevation +40.8
- 5. Direction of Drainage →
- 6. Perimeter Dike [Symbol]
- 7. Straw Bale Dike or Silt Fence [Symbol]
- 8. Stone Filter Inlet Protection [Symbol]
- 9. Stone Construction Entrance [Symbol]

For Bearings and Distances of Individual Lots See Plats 4126, 27 & 28.

APPROVED FOR PUBLIC WATER AND PUBLIC SEWERAGE SYSTEMS,
 HOWARD COUNTY HEALTH DEPARTMENT
 [Signature] 6-7-79 DATE
 COUNTY HEALTH OFFICER
 APPROVED HOWARD COUNTY OFFICE OF PLANNING & ZONING
 PLANNING DIRECTOR DATE
 CHIEF DIVISION OF LAND DEVELOPMENT DATE
 APPROVED FOR PUBLIC WATER AND PUBLIC SEWERAGE,
 STORM DRAINAGE SYSTEMS AND PUBLIC ROADS
 HOWARD COUNTY DEPARTMENT OF PUBLIC WORKS
 [Signature] 6-5-79 DATE
 DIRECTOR
 CHIEF BUREAU OF ENGINEERING DATE

CLARK • FINEPROCK & SACKETT ENGINEERS • PLANNERS • SURVEYORS 11315 LOCKWOOD DRIVE SILVER SPRING, MARYLAND 20904 (301) 593-3400			
DESIGNED	SEDIMENT & EROSION CONTROL PLAN LOTS A-20 THRU A-115	SCALE	1"=30'
DRAWN		DRAWING	3045
CHECKED		JOB NO.	
DATE	COLUMBIA VILLAGE OF OWEN BROWN SECTION 2, AREA 1 6TH ELECTION DISTRICT HOWARD COUNTY, MARYLAND FOR: The Ryland Group Inc. (Cal. Div.) Suite 200 V.O.M. Office Bldg. Columbia, Maryland 21043	FILE NO.	78-1175E
APR 1979			

Reviewed for Howard S.C.D.
 Name
 and meets Technical Requirements
C. Wayne Day 5/23/79
 Signature Date
 U.S. Soil Conservation Service

THIS DEVELOPMENT PLAN IS APPROVED FOR SOIL EROSION AND SEDIMENT CONTROL BY THE HOWARD SOIL CONSERVATION DISTRICT.

Mrs. F. E. Hill 5-23-79
 Approved Date

DEVELOPER'S CERTIFICATE

I certify that all development and/or construction will be done according to this plan of development and plan for Erosion and Sediment Control, and I also authorize periodic on-site inspection by the Howard Soil Conservation District or their authorized agents as are deemed necessary. Deviation from this plan will not be made unless authorized by the Howard Soil Conservation District.

D. B. Sargent 4-27-79
 Signature Date

ENGINEER'S CERTIFICATE

I hereby certify that this plan for Erosion and Sediment Control represents a practical and workable plan based on my personal knowledge of the site conditions and that it was prepared in accordance with the requirements of the Howard Soil Conservation District.

G. Nelson Clark 4-27-79
 Signature Date

5-9-79

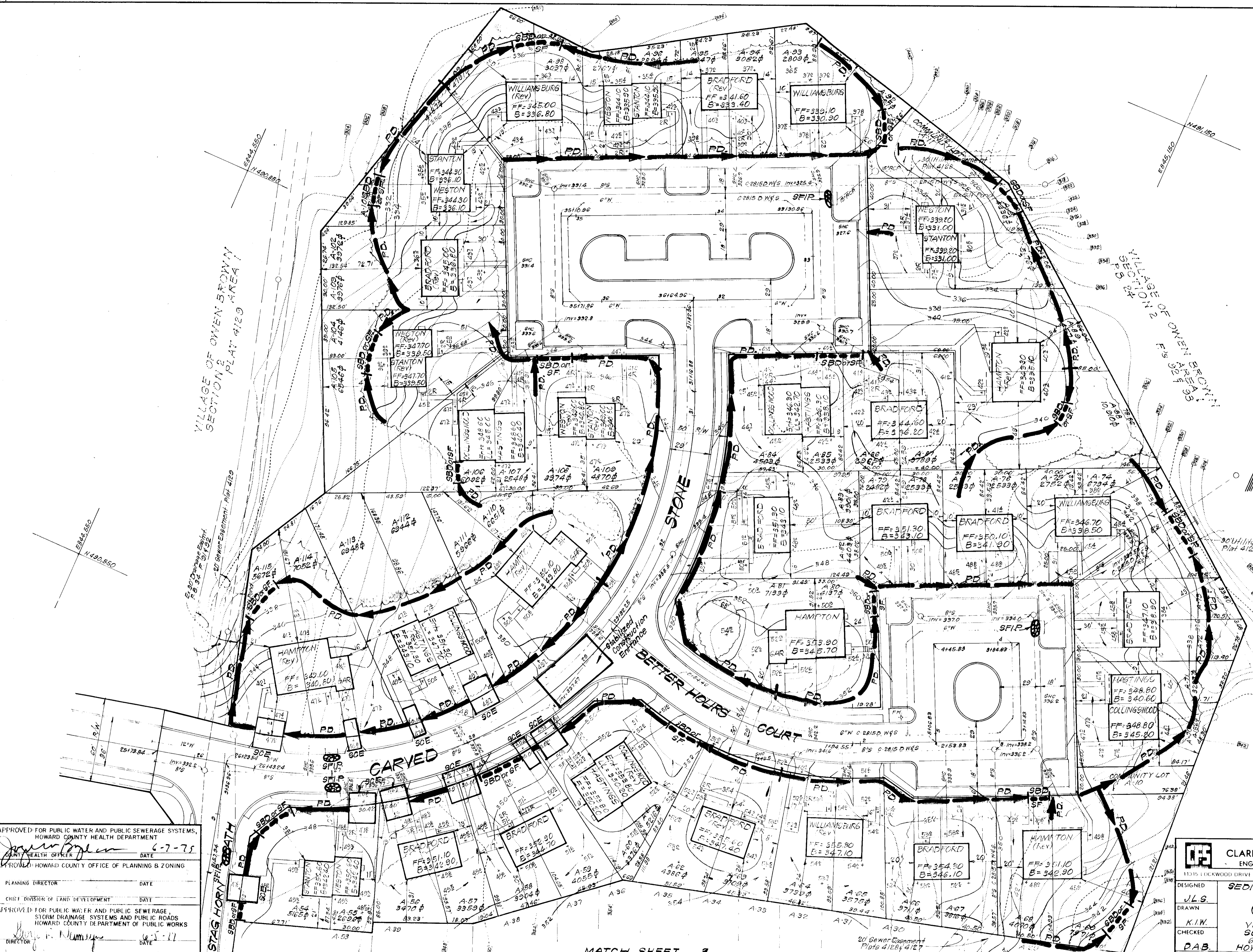

APPROVED FOR PUBLIC WATER AND PUBLIC SEWERAGE SYSTEMS,
 HOWARD COUNTY HEALTH DEPARTMENT
[Signature] 6-7-79
 HEALTH OFFICER DATE

APPROVED HOWARD COUNTY OFFICE OF PLANNING & ZONING
 PLANNING DIRECTOR DATE

CHIEF DIVISION OF LAND DEVELOPMENT DATE

APPROVED FOR PUBLIC WATER AND PUBLIC SEWERAGE,
 STORM DRAINAGE SYSTEMS AND PUBLIC ROADS
 HOWARD COUNTY DEPARTMENT OF PUBLIC WORKS
[Signature] 6-5-79
 DIRECTOR DATE

CHIEF BUREAU OF ENGINEERING DATE

CLARK • FINEROCK & SACKETT ENGINEERS • PLANNERS • SURVEYORS 11315 LOCKWOOD DRIVE SILVER SPRING, MARYLAND 20904 (301) 593-3400		DESIGNED	SEDIMENT & EROSION CONTROL PLAN LOTS A-20 THRU A-115 COLUMBIA VILLAGE OF OWEN BROWN SECTION 2 AREA 1 6th ELECTION DISTRICT HOWARD COUNTY, MARYLAND FOR: The Ryland Group Inc. (Col. Div.) Suite 200 V.O.M. Office Bldg. Columbia, Maryland 21043	SCALE
		DRAWN		1"=30'
CHECKED		DRAWING	4 of 5	
DATE		JOB NO.		
APR 1979		FILE NO.	78-1179E	
			SDP-79-121c	

GENERAL NOTES

- Grading Permits shall be obtained prior to installation of Sediment Control & Grading.
- All Sediment and Erosion Control Measures will be installed and stabilized according to this plan prior to any other grading, clearing or disturbance of the existing surface of the site. See note #6 for stabilization except that the seed mixture will be annual ryegrass applied at a rate of 1.4 lbs/1000 sq ft.
- Notify the Bureau of Inspections and Permits at least 24 hrs before starting any work.
- All Sediment Control Practices to conform to the "Standards and Specifications for Soil Erosion and Sediment Control in Developing Areas" and shall be adjusted to meet actual field conditions.
- Stabilization of Disturbed ground to be done as soon after construction as possible.
- All grading shall be treated in accordance with the following Specifications:
 - A. Seed - certified 85% germination applied at the rate of 9 lbs/1000 sq ft. Mixture - 40% Kentucky Blue, 20% Chewing Fescue, 20% Kentucky 31 and 20% annual ryegrass.
 - B. Fertilizer - 10-10-10 applied at a rate of 23 lbs/1000 sq ft. Ground Agricultural Lime or Dolomitic Lime applied at a rate of 46 lbs/1000 sq ft.
 - C. Mulch - Weed free grain straw applied at a rate of 46 lbs/1000 sq ft. Mulch shall be secured to the ground by any approved method i.e.; asphalt tacks, chemical binder, etc.
 - D. All Seed used shall be Maryland State Certified.
- All Structural Sediment Control Measures are to remain in place until permission for their removal has been obtained from the Bureau of Inspections and Permits.
- On-Site Inspection and Maintenance of all Sediment Control Measures including clean out of Sediment Traps and dikes, and proper establishment of all planned vegetative measures will be the responsibility of the developer or his representative on the site, on a continuing day to day basis.
- It will be the developer's responsibility to provide additional Sediment & Erosion Control Devices to protect stabilized areas during construction.
- The Contractor shall keep all public roads free of sediment deposits left from traffic leaving construction site.
- Stabilized Construction Entrances shall be placed at all construction entrances.
- If houses are to be constructed on an "As-Sold" basis at random, Single Lot Sediment Control, as shown on this sheet, shall be implemented.
- Total Amount of Straw Bales or Silt Fence shown = 615 LF
- SITE ANALYSIS:
 - A. Total Area: 9.574 Acres
 - B. Area to be Roofed: 1.212 Acres
 - C. Area to be Paved: 0.570 Acres
 - D. Area to be Seeded: 6.683 Acres
 - E. Area Undisturbed: 1.100 Acres
- CONSTRUCTION SEQUENCE:
 - A. Install Sediment & Erosion Control Devices and Stabilize Diversion Dikes.
 - B. Excavate for Foundations and Rough Grade.
 - C. Erect Structures, Driveways and Sidewalks.
 - D. Final Grade and Stabilize in accordance with note #6.

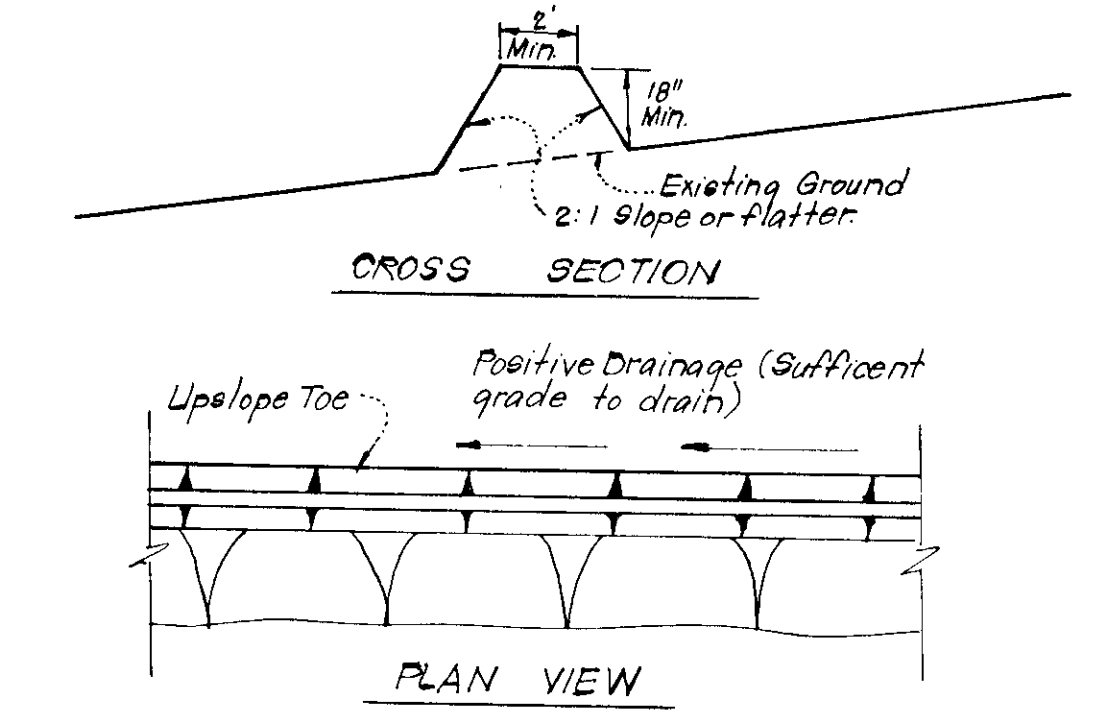
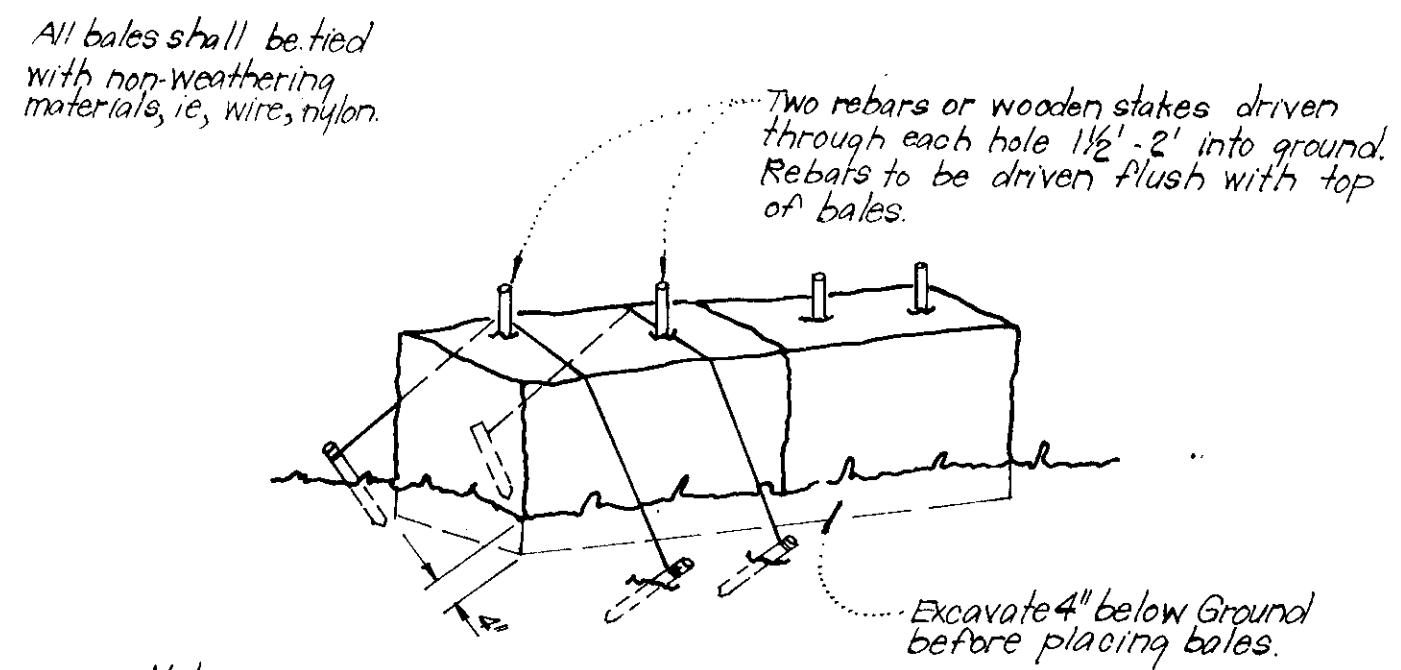

TYPICAL PERIMETER DIKE DETAIL (P.D.)
No Scale

TYPICAL STRAW BALE DIKE DETAIL (S.B.D.)
No Scale

Note:
1. In lieu of the use of rebar each straw bale may be fastened to ground with pegs (4 per bale and wire or nylon as shown above.)

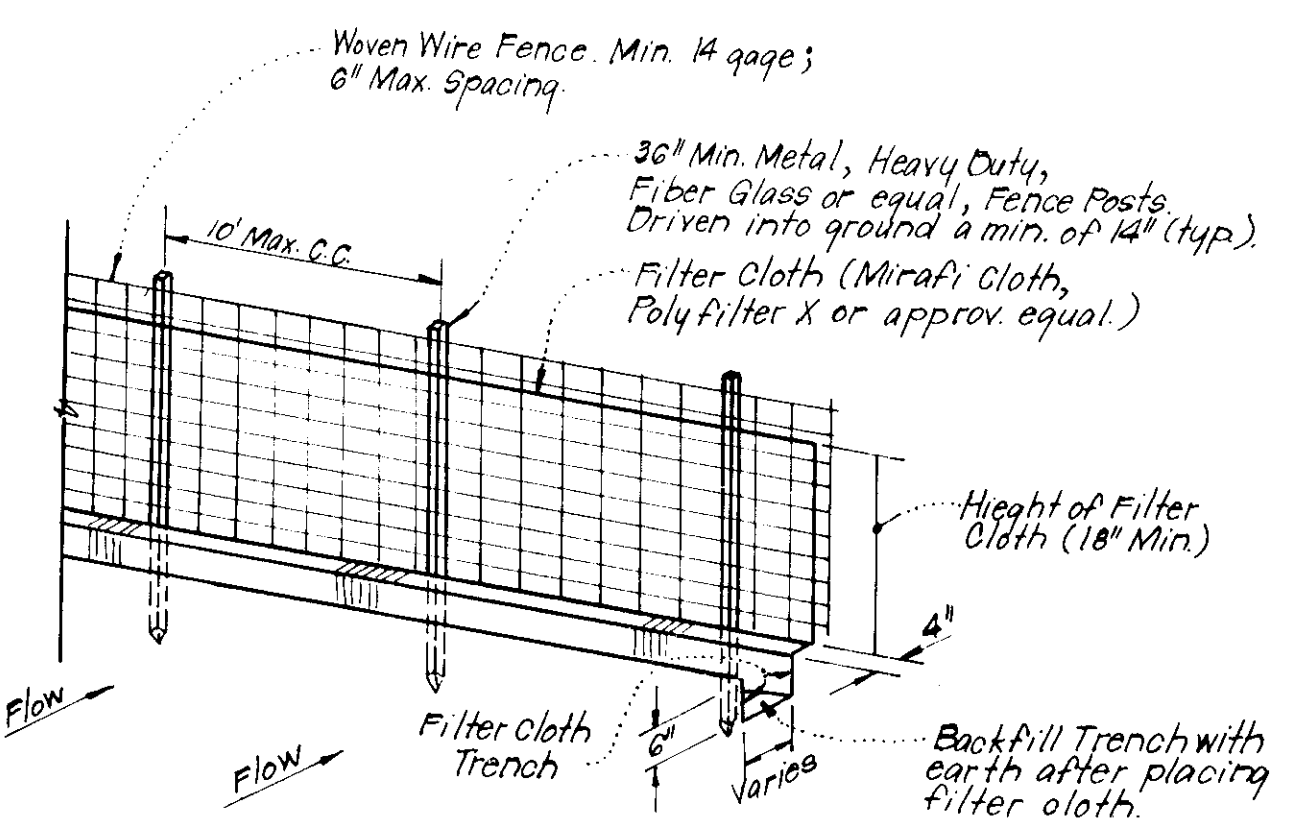

Notes:
1. Woven Wire Fence to be fastened securely to fence posts by use of wire ties.
2. Filter Cloth to be fastened securely to Woven Wire, by use of wire ties spaced every 24\"/>

TYPICAL SILT FENCE DETAIL (S.F.)
No Scale

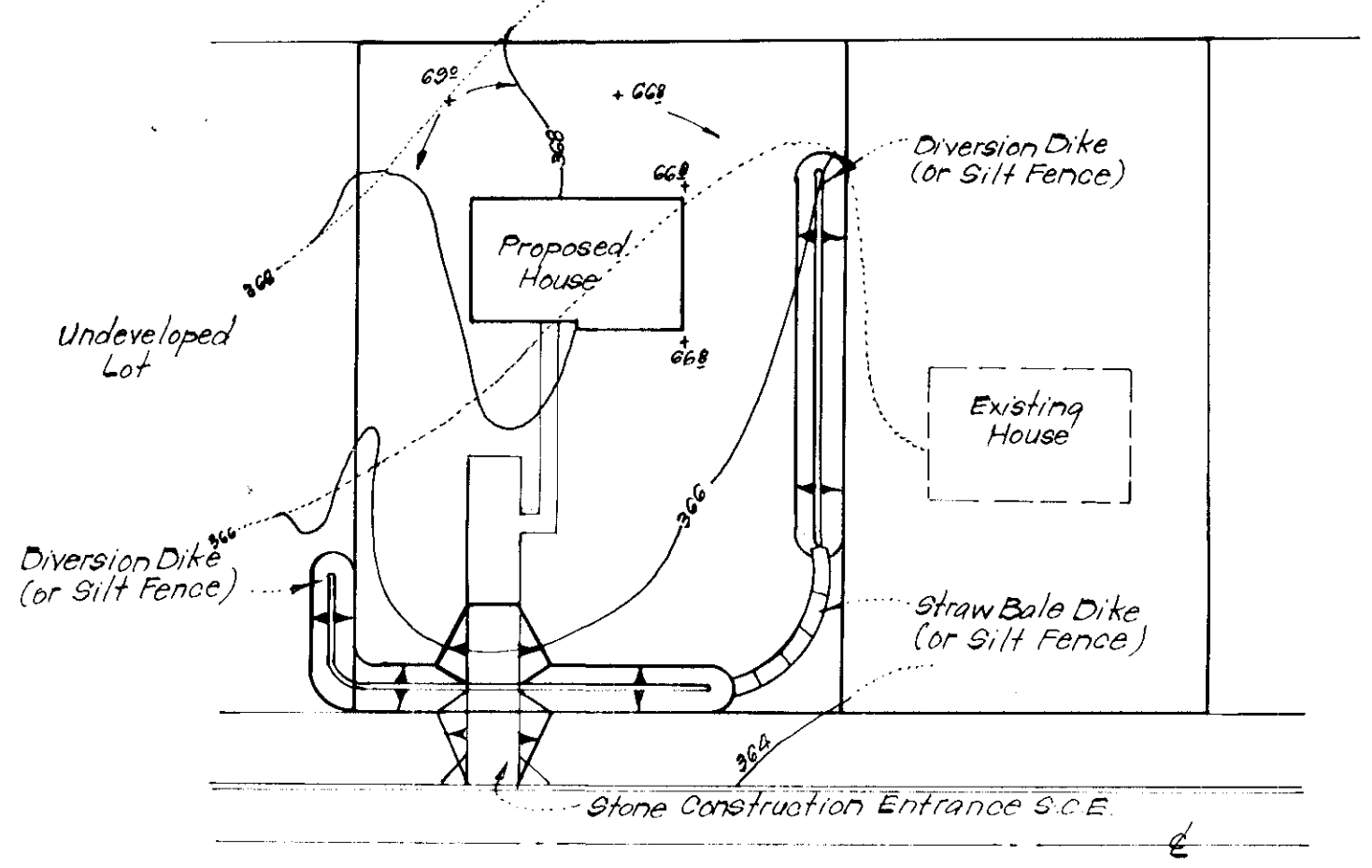

TYPICAL SINGLE LOT SEDIMENT CONTROL PLAN
No Scale

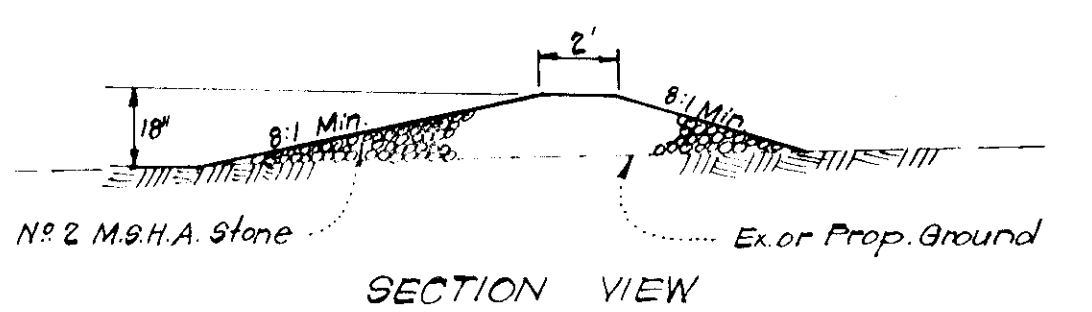

STONE CONSTRUCTION ENTRANCE DETAIL (S.C.E.)
No Scale

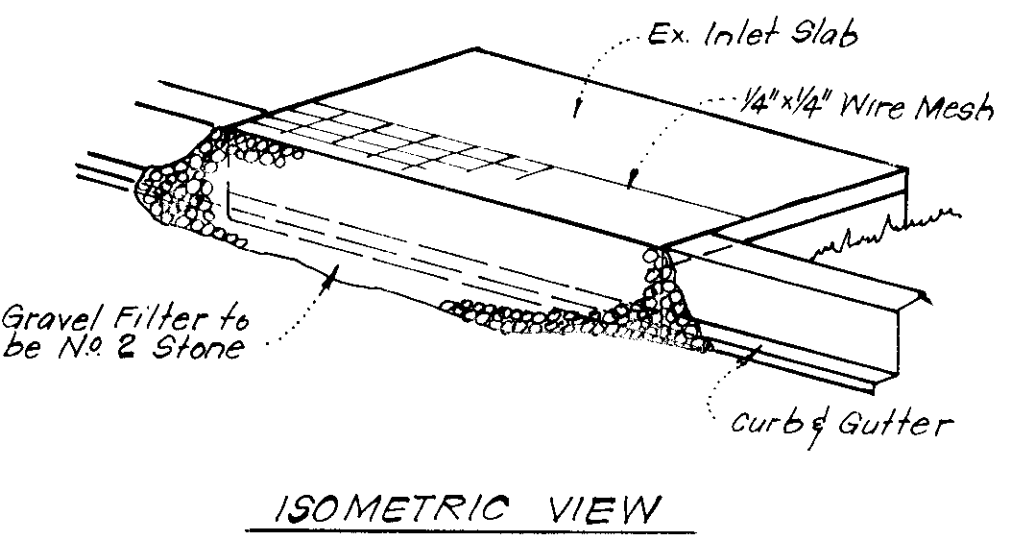

ISOMETRIC VIEW

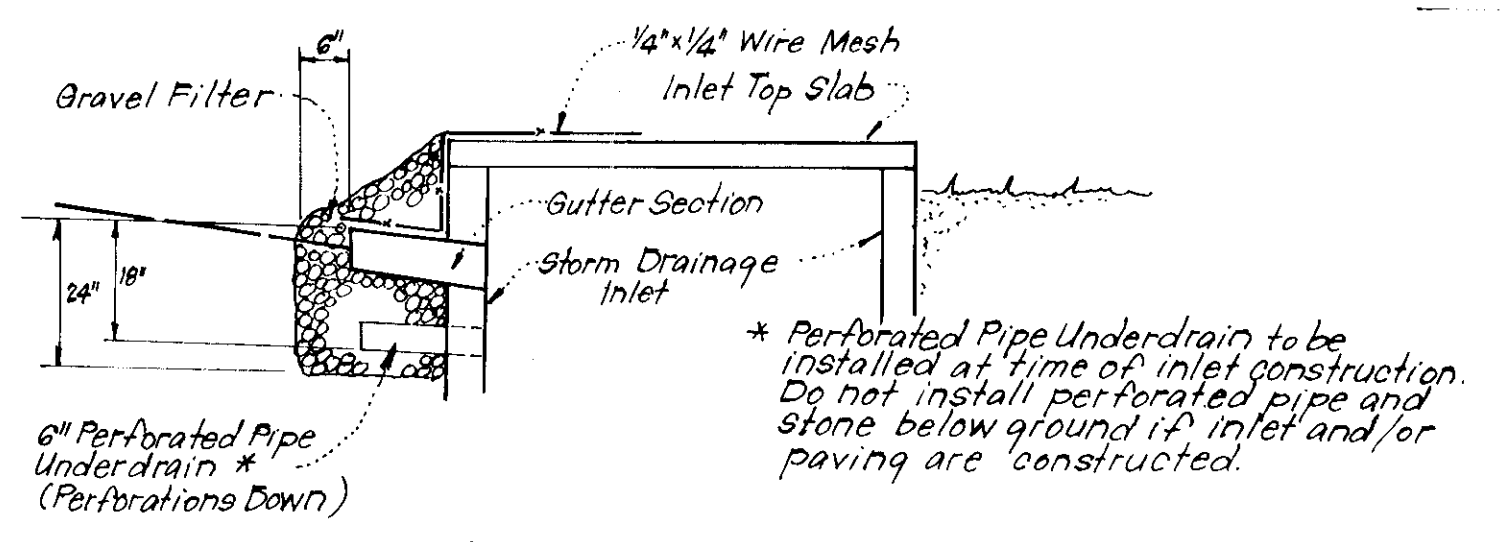

STONE FILTER INLET PROTECTION (S.F.I.P.)
No Scale

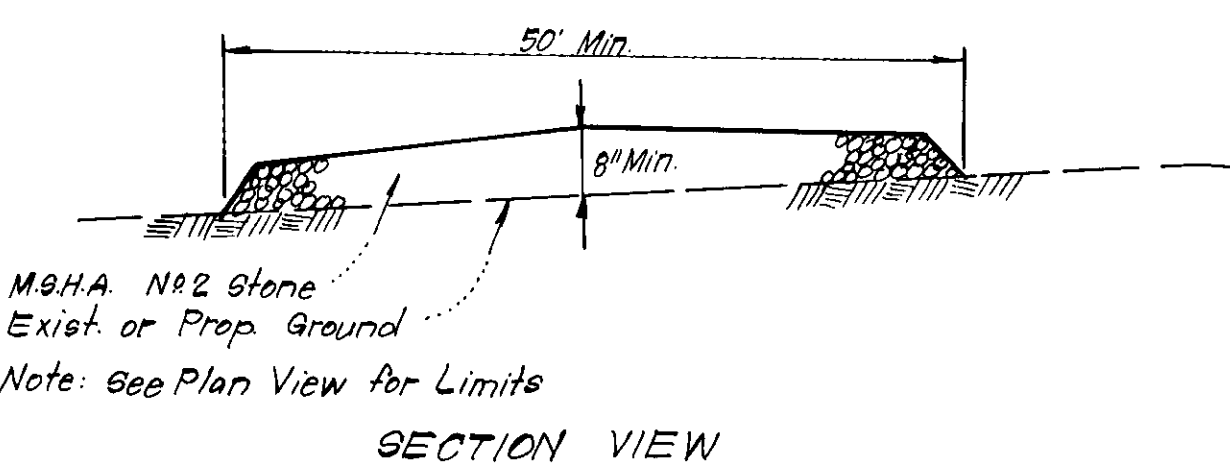

STABILIZED CONSTRUCTION ENTRANCE
No Scale

APPROVED
DIVISION OF LAND DEVELOPMENT
HOWARD COUNTY, MARYLAND
DATE 5-9-79
JWH

APPROVED FOR PUBLIC WATER AND PUBLIC SEWERAGE SYSTEMS,
HOWARD COUNTY HEALTH DEPARTMENT
DATE 6-7-79
APPROVED FOR HOWARD COUNTY OFFICE OF PLANNING & ZONING
PLANNING DIRECTOR DATE
CHIEF, DIVISION OF LAND DEVELOPMENT DATE
APPROVED FOR PUBLIC WATER AND PUBLIC SEWERAGE,
STORM DRAINAGE SYSTEMS AND PUBLIC ROADS
HOWARD COUNTY DEPARTMENT OF PUBLIC WORKS
DATE 6-5-79
CHIEF, BUREAU OF ENGINEERING DATE

Reviewed for H.C.D. S.C.D.
Name
and meets Technical Requirements
Signature 5/23/79 Date
U.S. Soil Conservation Service

THIS DEVELOPMENT PLAN IS APPROVED
FOR SOIL EROSION AND SEDIMENT CONTROL BY THE HOWARD SOIL
CONSERVATION DISTRICT.

DEVELOPER'S CERTIFICATE
I certify that all development and/or construction
will be done according to this plan of development
and plan for Erosion and Sediment Control, and I also
authorize periodic on-site inspection by the Howard
Soil Conservation District or their authorized agents
as are deemed necessary. Deviation from this plan
will not be made unless authorized by the Howard
Soil Conservation District.

ENGINEER'S CERTIFICATE
I hereby certify that this plan for Erosion and
Sediment Control represents a practical and workable
plan based on my personal knowledge of the site
conditions and that it was prepared in accordance
with the requirements of the Howard Soil Conserva-
tion District.

WES FARR Approved 5-23-79 Date

239 arg Date 4-4-79
Signature Date

W. Nelson Clark 4-4-79 Date

CLARK • FINEFROCK & SACKETT
ENGINEERS • PLANNERS • SURVEYORS
15315 LUKWOOD DRIVE SILVER SPRING, MARYLAND 20904 (301) 583-3400

DESIGNED VLS	SEDIMENT & EROSION CONTROL PLAN LOTS A-20 THRU A-115 COLUMBIA VILLAGE OF OWEN BROWN SECTION 2 AREA 1 6th ELECTION DISTRICT HOWARD COUNTY, MARYLAND FOR: The Ryland Group Inc. (Col. Div.) Suite 200 Y.O.M. OFFICE Bldg. Columbia, Maryland 21043	SCALE As Shown
DRAWN K.L.W.		DRAWING 50 of 5
CHECKED D.A.B.		JOB NO.
DATE APR, 1979		FILE NO. 78-1177-SE
		SDP-79-121c