

Developer
 I certify that this Plan of **Soil Conservation** will be implemented in the **soil conservation**, and all structures will be installed to the design and specifications as spelled out in this plan. I also authorize periodic on-site evaluation by the **Howard Soil Conservation District** personnel and cooperating agencies.
William W. Pindell & Elizabeth T. H.W. March 6, 1979
 Owner/Developer Date

Surveyor
 I certify that this Plan of **Soil Conservation** is designed with my personal knowledge of the site conditions and has been designed to the Standards and Specifications adopted by the **Howard Soil Conservation District**.
Robert T. Flehbaugh March 6, 1979
 Surveyor Date

N/F
 Elliot Baldwin
 221 - 418



Sign to be placed per Site Plan and in accordance with article 516.4 of Barrier Free Facilities Booklet.

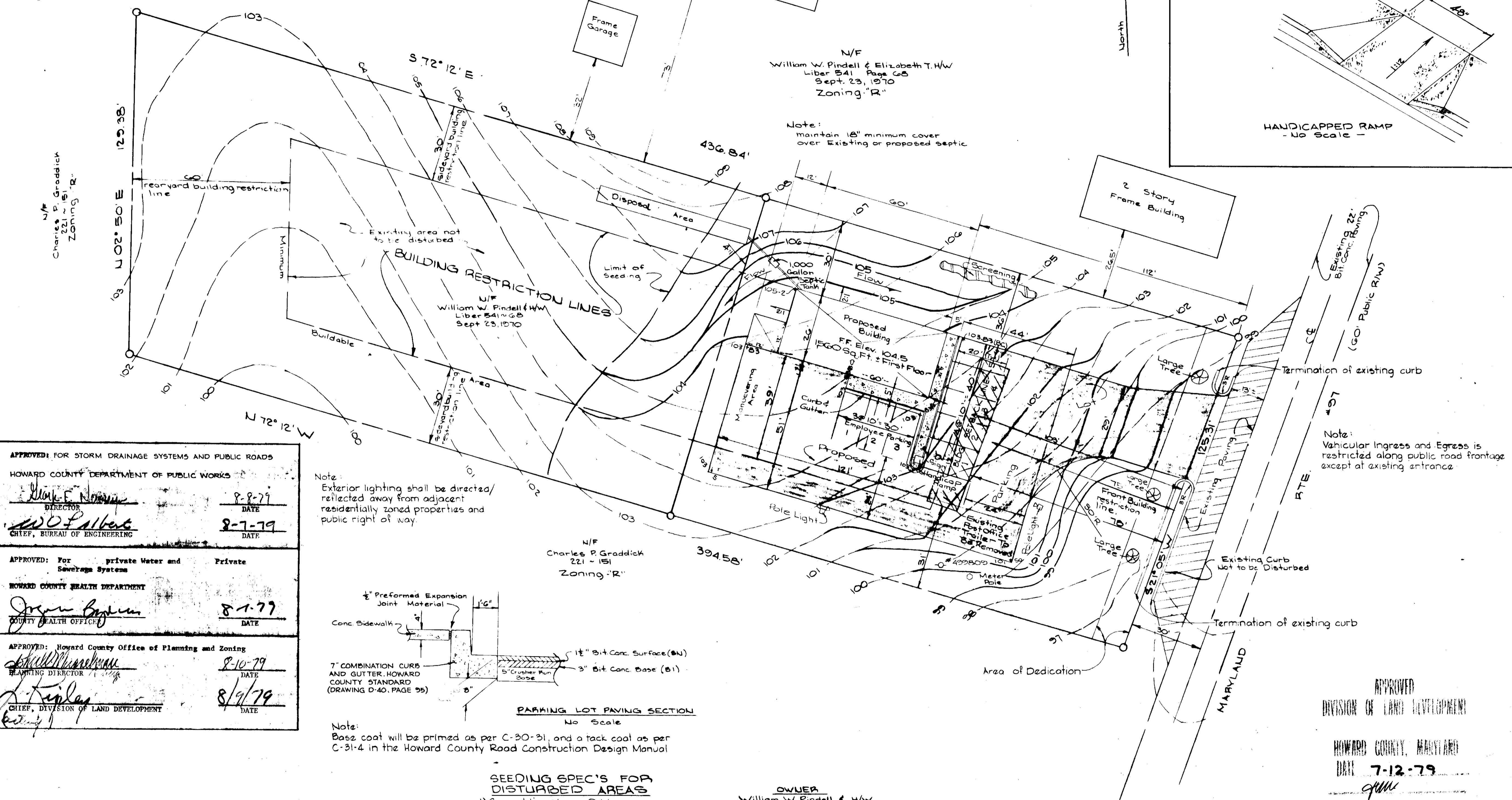
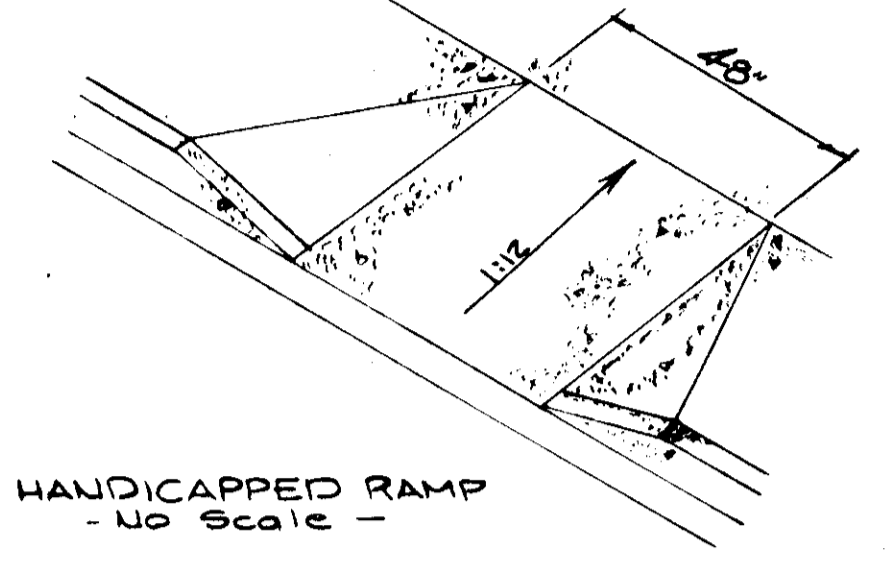

APPROVED FOR STORM DRAINAGE SYSTEMS AND PUBLIC ROADS
 HOWARD COUNTY DEPARTMENT OF PUBLIC WORKS
Wayne F. Norman 8-8-79
 DIRECTOR DATE
W. F. Albani 8-7-79
 CHIEF, BUREAU OF ENGINEERING DATE

APPROVED FOR private Water and Sewerage Systems
 HOWARD COUNTY HEALTH DEPARTMENT
Joyce E. Spitzer 8-1-79
 COUNTY HEALTH OFFICER DATE

APPROVED: Howard County Office of Planning and Zoning
Shirley M. Johnson 8-10-79
 PLANNING DIRECTOR DATE
R. K. Ripley 8/9/79
 CHIEF, DIVISION OF LAND DEVELOPMENT DATE

Note:
 Exterior lighting shall be directed/reflected away from adjacent residentially zoned properties and public right of way.

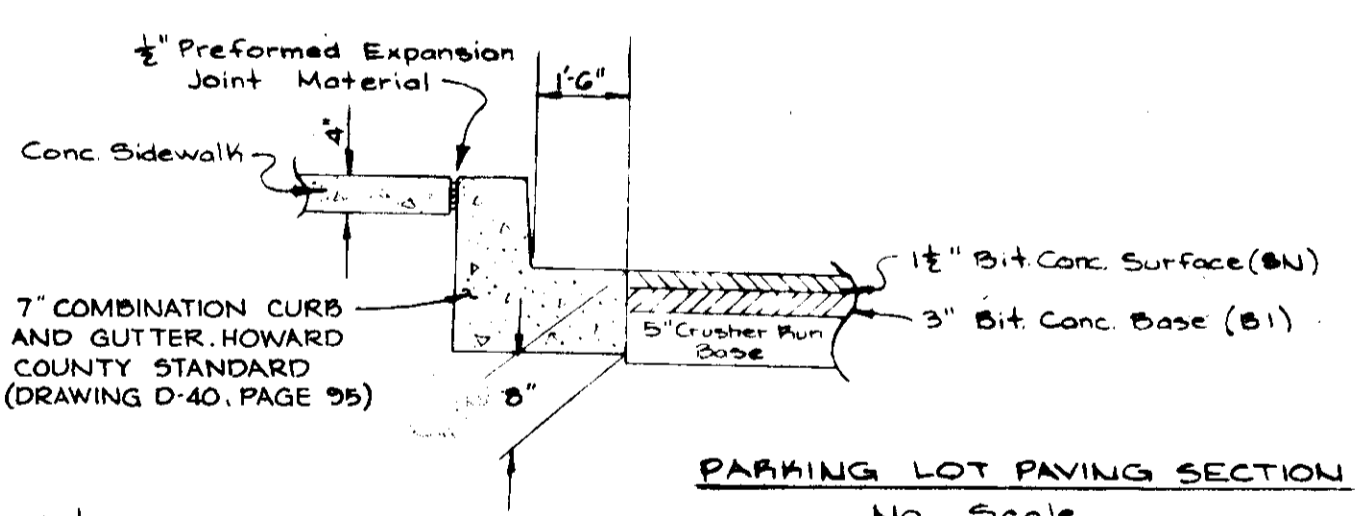

Note:
 Base coat will be primed as per C-30-31, and a tack coat as per C-31-4 in the Howard County Road Construction Design Manual

SEEDING SPEC'S FOR DISTURBED AREAS
 1) Ground limestone @ 1 ton per acre
 2) Seed: (a) Kentucky Tall Fescue (KY 31) @ 50 lbs. per acre, and (b) White Clover @ 2 lbs. per acre or Korean Lespedeza @ 8 lbs. per acre
 3) Fertilizer 10-10-10 @ 1000 lbs. per acre.

SITE ANALYSIS:
 Area - 1.152 AC or 51,924 sq ft
 Zoning - "R"
 1st Floor Area - 3,500 sq ft
 Parking Spaces Required - 7.8
 Parking Spaces Provided - 8
 Employees - 1

LEGEND:
 1) Existing Contour
 2) Proposed Contour
 3) Proposed Spot Elev.
 4) Proposed Parking lot Paving
 5) Existing Entrance Paving
 6) Proposed Conc. Sidewalk

R.T.F. INC.
 LAND SURVEYORS
 142 EAST MAIN STREET
 WESTMINSTER, MD. 21157
 878-1222 848-2040

Robert T. Flehbaugh
 Robert T. Flehbaugh
 Reg. Land Surveyor No. 6034

APPROVED
 DIVISION OF LAND DEVELOPMENT
 HOWARD COUNTY, MARYLAND
 DATE 7-12-79
 gmm

SITE DEVELOPMENT PLAN
 GLENWOOD POST OFFICE
 NEW POST OFFICE BUILDING
 OWNER'S NAME: WILLIAM W. PINDELL
 DEED RECORDING REFERENCE: 541 ~ 68
 ELECTION DISTRICT NUMBER: 4
 HOWARD COUNTY, MARYLAND
 TAX MAP: 14 PARCEL: 132
 SCALE: 1"=20'
 DATE: 2-26-79
 REVISED: 3-2-79
 REVISED: 6-14-79
 REVISED: 7-17-79



STABILIZED CONSTRUCTION ENTRANCE
NO SCALE

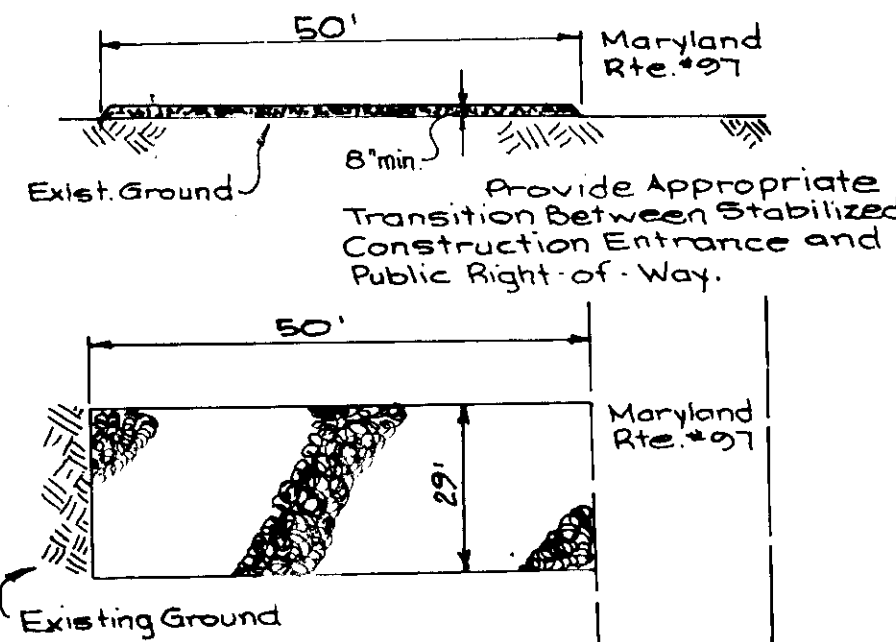

I certify that this plan of Sediment Control will be implemented to the fullest extent, and all structures will be installed to the design and specifications as specified in this plan. I also authorize periodic on-site evaluation by the Howard Soil Conservation District personnel and cooperating agencies.

Jamie M. Fay P.E. March 6, 1979
Professional Engineer
Professional No. 10034

I certify that this plan of Sediment Control is drafted with my personal knowledge of the site conditions and has been designed to the Standards and Specifications adopted by the Howard Soil Conservation District.

Robert T. Fishbaugh P.E. March 6, 1979
Professional Engineer
Professional No. 6034

The Development Plan is Approved For Soil Erosion and Sediment Control by the Howard Soil Conservation District.

Approved: *Robert Zielke* 7/27/79
Professional Engineer
Professional No. 8871

REVIEWED FOR HOWARD COUNTY S.C.D.
NAME: *Howard*
AND MEETS TECHNICAL REQUIREMENTS. *C.W. Buntz* 7/30/79
U.S. SOIL CONSERVATION SERVICE
SEDIMENT CONTROL NOTES

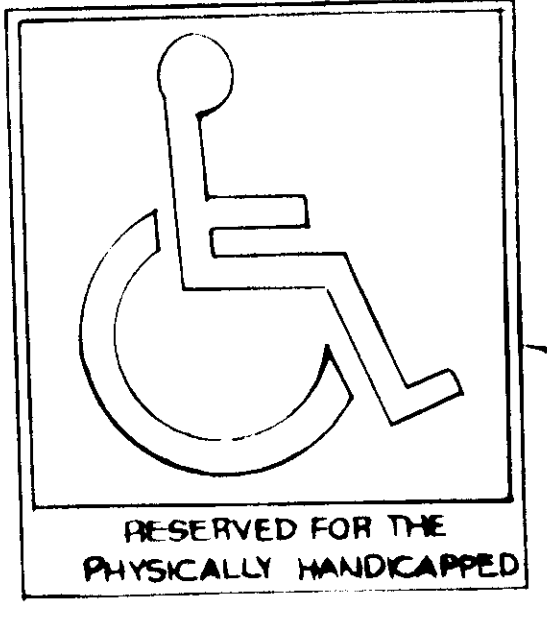

Sign to be placed per Site Plans in accordance with Article 516.4 of Barrier-Free Facilities Booklet.

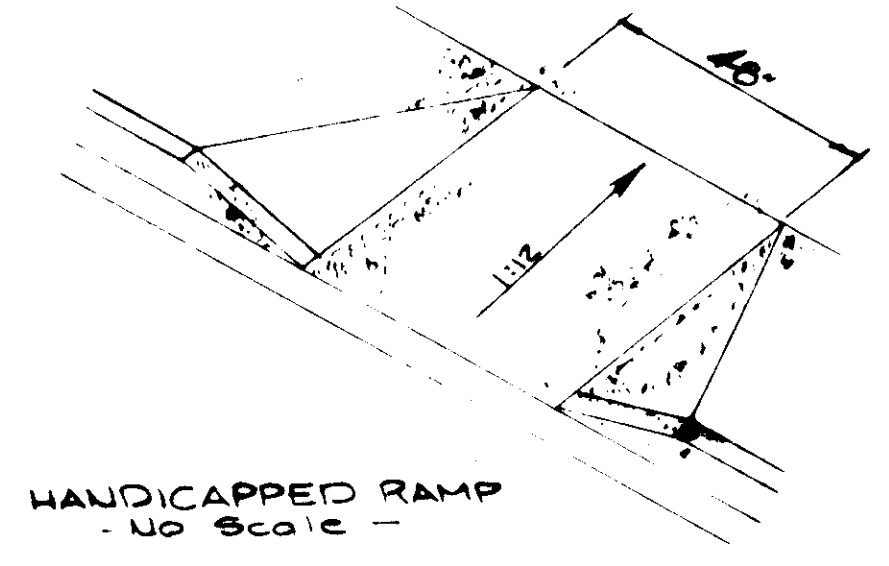
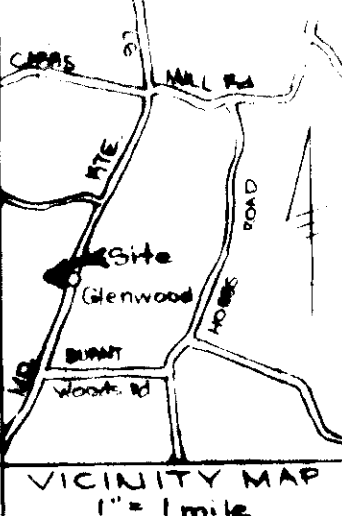

Construction Specifications

- Stone Size: Use MSHA size no 2 (2 1/2" to 1") or AASHTO designation M43, size no 2 (2 1/2" to 1") use crushed stone.
- Washing: When necessary, wheels shall be cleaned to remove sediment prior to entrance onto public right-of-way. When washing is required it shall be done on an area stabilized with crushed stone which drains into an approved sediment trap or sediment basin. All sediment shall be prevented from entering any storm drain, ditch or watercourse through use of sandbags, gravel, boards, or other approved methods.
- Maintenance: The entrance shall be maintained in a condition which will prevent tracking or flowing of sediment onto public right-of-ways. This may require periodic top dressing with additional stone as conditions demand, and repair and/or cleanout of any measures used to trap sediment. All sediment spilled, dropped, washed or tracked onto public right-of-ways must be removed immediately.

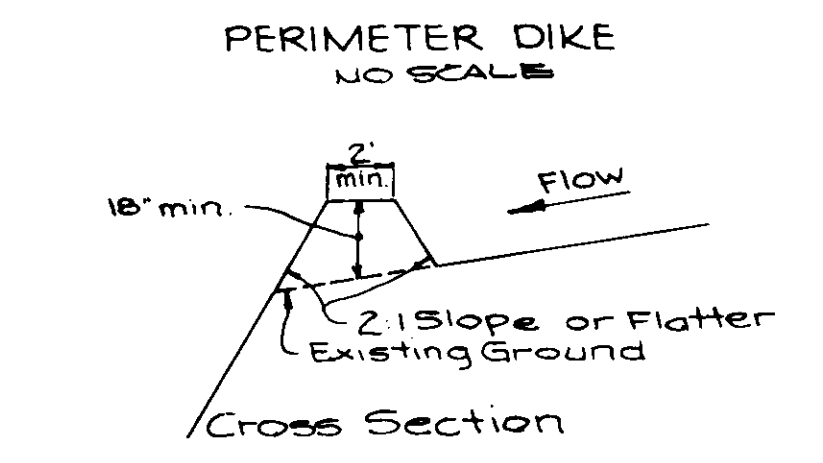

PERIMETER DIKE
NO SCALE

18" min. 2:1 Slope or Flatter Existing Ground

Cross Section

Upslope toe Positive Drainage (Grade sufficient to drain.)

Plan View

Construction Specifications

- All dikes shall be machine compacted.
- All dikes shall have positive drainage to an outlet.
- Over-topped runoff from a disturbed or exposed upland area shall be conveyed to a sediment trap or stone outlet structure.
- Periodic inspection and required maintenance shall be provided.

STRAW BALE DIKE

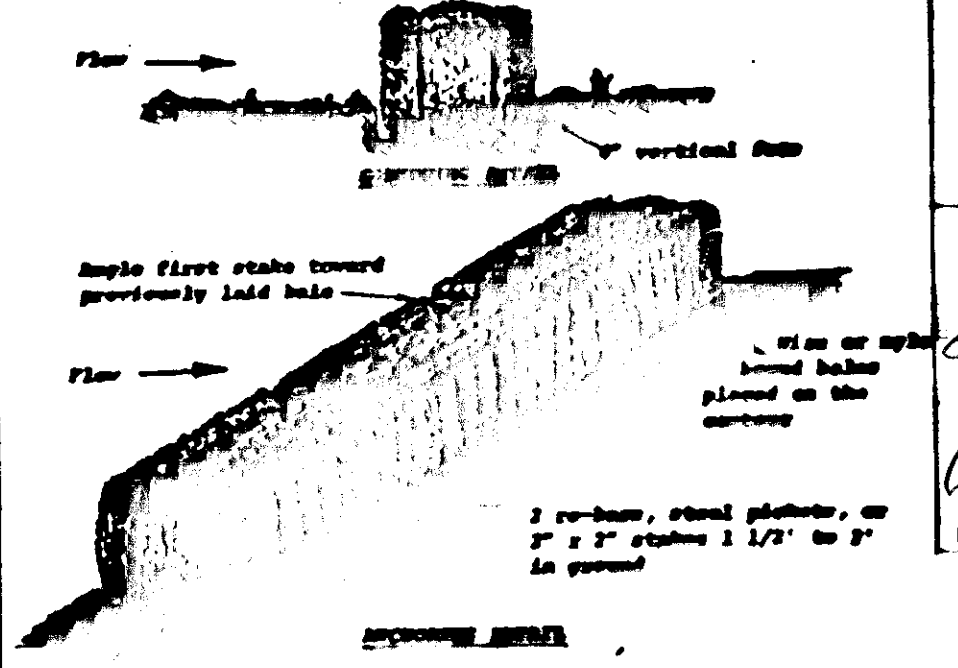

Construction Specifications

- Bales shall be placed in a row with ends tightly abutting the adjacent bales.
- Each bale shall be embedded in the soil a minimum of 4".
- Bales shall be firmly anchored in place by stakes or rebar driven through the bales. The first stake in each bale shall be angled toward previously laid bales to force bales together.
- Interstices shall be filled with straw and replacement shall be made promptly as needed.
- Bales shall be removed when they have served their usefulness or as set by block or impact across flow of drainage.

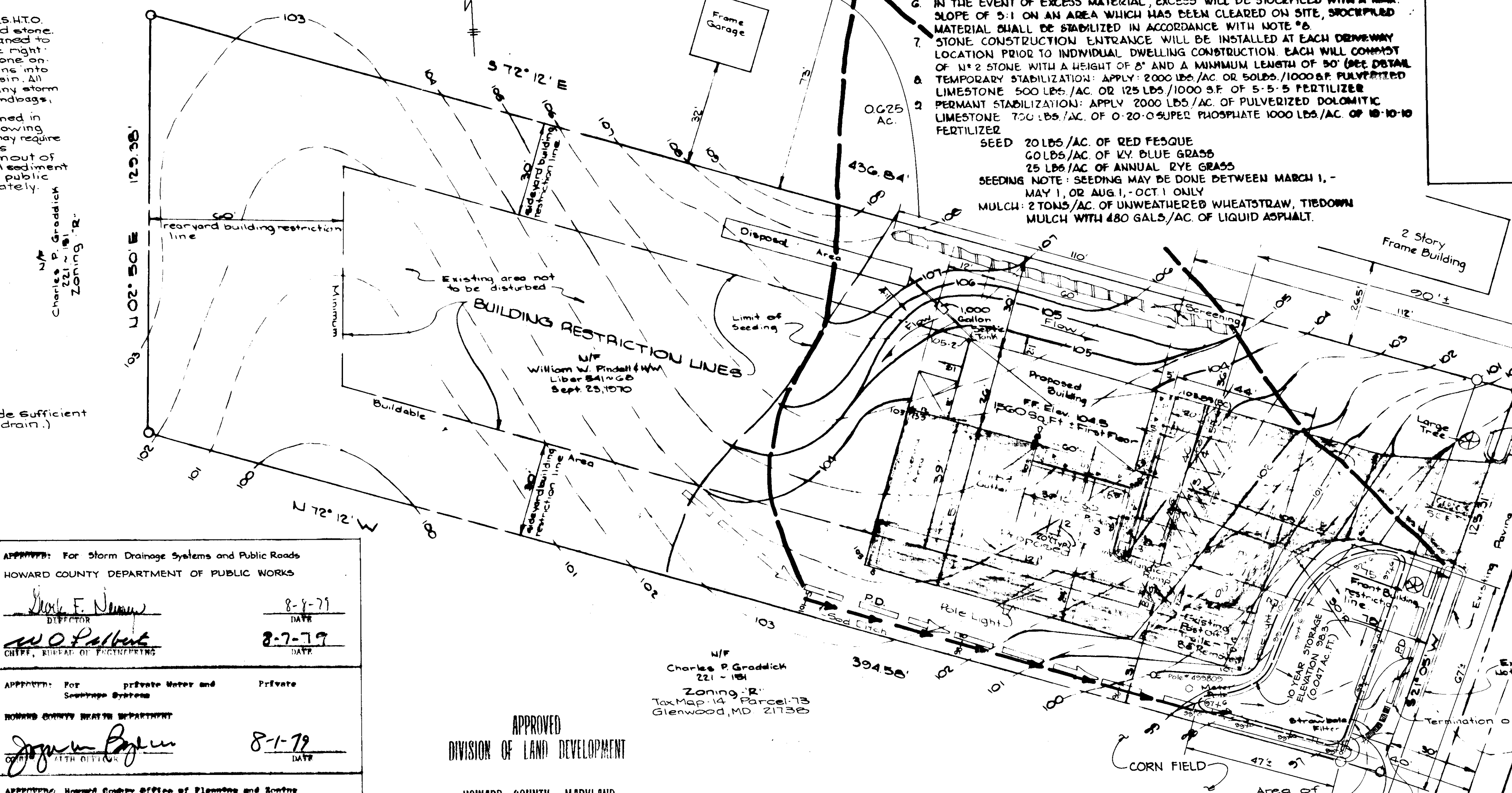

APPROVED: For Storm Drainage Systems and Public Roads
HOWARD COUNTY DEPARTMENT OF PUBLIC WORKS

John F. Neman 8-4-79
DIRECTOR DATE

W.O. Peltier 8-7-79
CHIEF, BUREAU OF ENGINEERING DATE

APPROVED: For private Water and Sewerage Systems
HOWARD COUNTY WATER DEPARTMENT

James Payne 8-1-79
CHIEF, WITH OFFICE DATE

APPROVED: Howard County Office of Planning and Zoning
William W. Pindell 8-10-79
PLANNING AND ZONING DATE

D. Taylor 8/9/79
CHIEF, DIVISION OF LAND DEVELOPMENT DATE

APPROVED
DIVISION OF LAND DEVELOPMENT
HOWARD COUNTY, MARYLAND
DATE 7-12-79

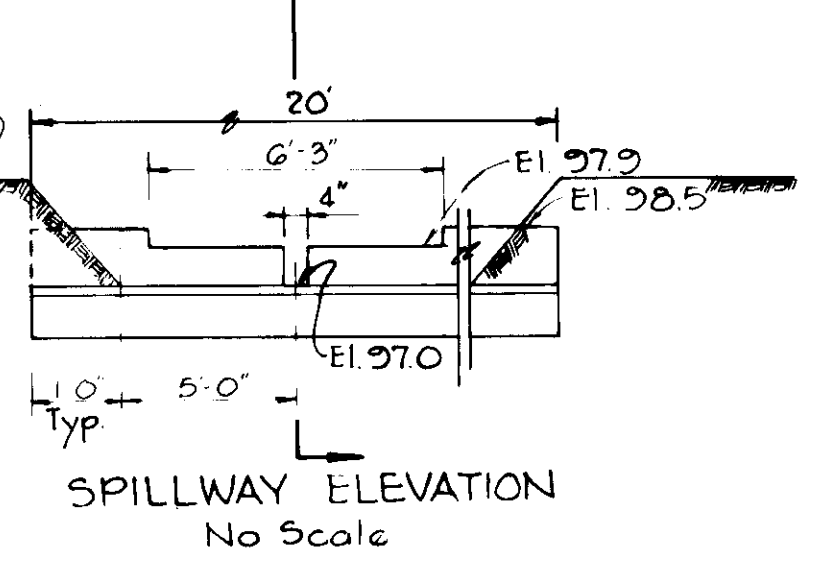

SPILLWAY ELEVATION
No Scale

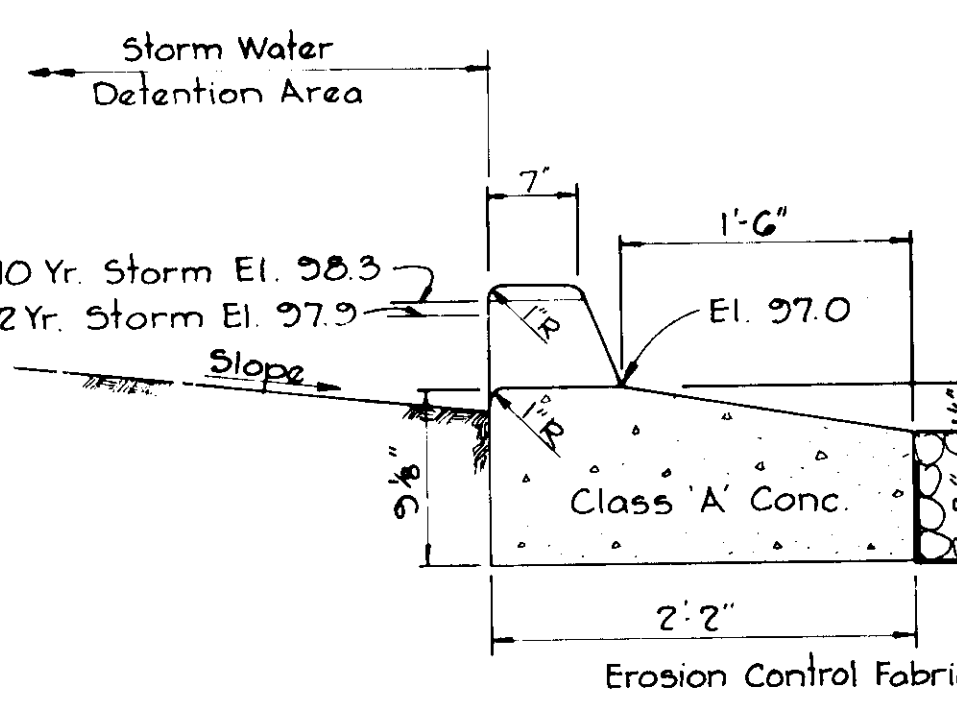

SPILLWAY SECTION
No Scale

SEDIMENT CONTROL DETAILS

R.T.F. INC.
LAND SURVEYORS
142 EAST MAIN STREET
WESTMINSTER, MD. 21157
878-1222 848-8040

LEGEND:

- Existing Contour
- Proposed Contour
- Proposed Spot Elev. 105+05
- Proposed Parking lot Paving
- Existing Entrance Paving
- Proposed Conc Sidewalk
- Proposed Sod ditch Elev.

STORM WATER MANAGEMENT DETAILS

Robert Fishbaugh
Professional Engineer
Professional No. 6034

SITE DEVELOPMENT PLAN
GLENWOOD POST OFFICE
NEW POST OFFICE BUILDING
OWNER'S NAME: WILLIAM W. PINDELL
DEED RECORDING REFERENCE: 541 ~ 68
ELECTION DISTRICT NUMBER: 4th
HOWARD COUNTY, MARYLAND
TAX MAP 14, LOT 2 3/4 PARCEL - 171
SCALE: 1"=20'
DATE: 2-26-79
REVISED: 3-2-79
REVISED: 4-16-79
REVISED: 5-2-79
REVISED: 6-14-79
REVISED 7-17-79 SHEET 2 OF 3
SDP-79-114