

SHEET 1 OF 2
SECTION 1, AREA 2
GLENMONT
PLAT # 3972

SHEET 1 OF 2
SECTION 1, AREA 2
GLENMONT
PLAT # 3972

GENERAL NOTES

1. Tax Map No. 30
2. Total area, 10.4 acres
3. Public Water and Sewer to be installed
4. All driveways to be built to Maryland Code, § 21-103
5. Elevation is based on the 1985 datum of the Howard County Survey of 1982
6. All driveways to be built to Howard Co. Road Construction Code, § 21-103
7. ANY DAMAGE TO EXISTING PAVING AND RIGHT-OF-WAY OF FIVE FINGERS ROAD SHALL BE CORRECTED AT THE DEVELOPER'S EXPENSE.
8. ALL DRIVEWAYS ARE PRIVATE.

SITE ANALYSIS

1. Zoning R-12
2. Number of lots shown: 5
3. Area included: 1.15 acres
4. Submittal date: 1/23/79

<i>Joyce M. Boyer</i>	2-1-79
<i>Thomas A. Harris</i>	2-6-79
<i>John W. Muesel</i>	2-6-79
<i>Ray F. Nunn</i>	1-30-79
<i>W. O. Libat</i>	1-29-79

PROFILES



CHOPTANK



NANTICOKE (FORMERLY) QUEENSTOWNE

FLOOR PLANS

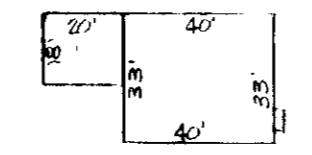

CHOPTANK

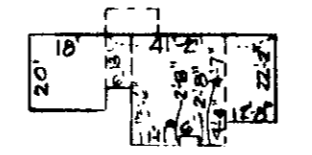

NANTICOKE (FORMERLY) QUEENSTOWNE

TYPICAL HOUSES

NO SCALE

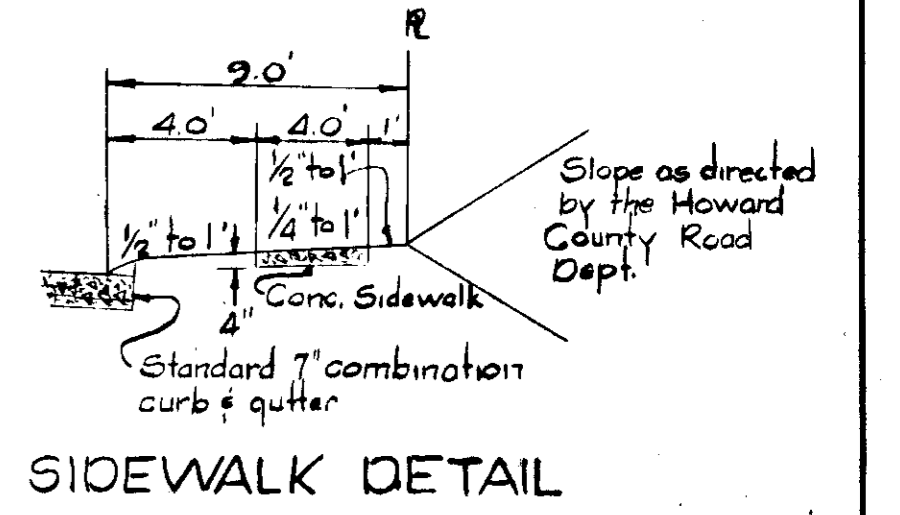
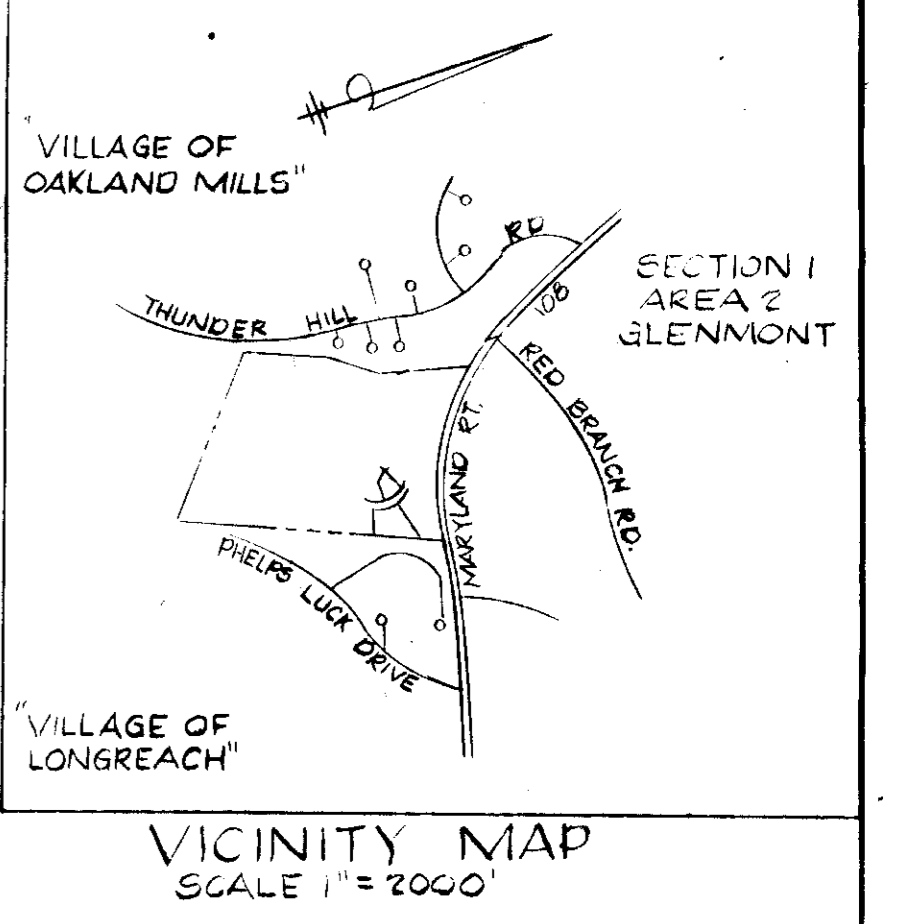
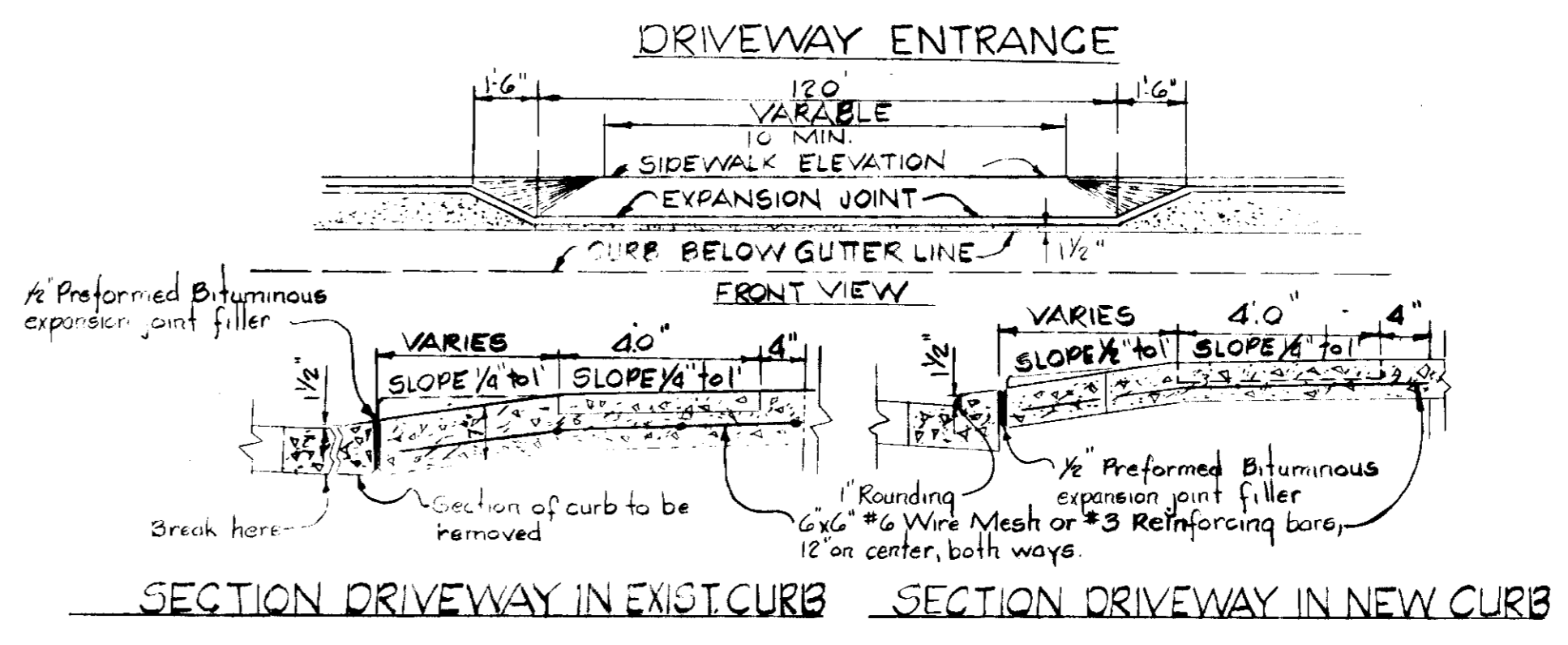

TYPICAL SUGGESTED PLANTING SCHEDULE

- S-1 PYRACANTHA MONROVIA 3'-4" 1
- MONROVIA FIREHORN
- S-2 ILEX CORNUTA ROTUNDA 15'-18" 14
- DWARF CHINESE HOLLY
- S-3 JUNIPERUS SCOPULORUM 4'-5" 1
- "BLUE HAVEN"
- BLUE HAVEN JUNIPER
- T-1 MALUS ZUMI CALOCARDA 1
- ZUMI CRAB

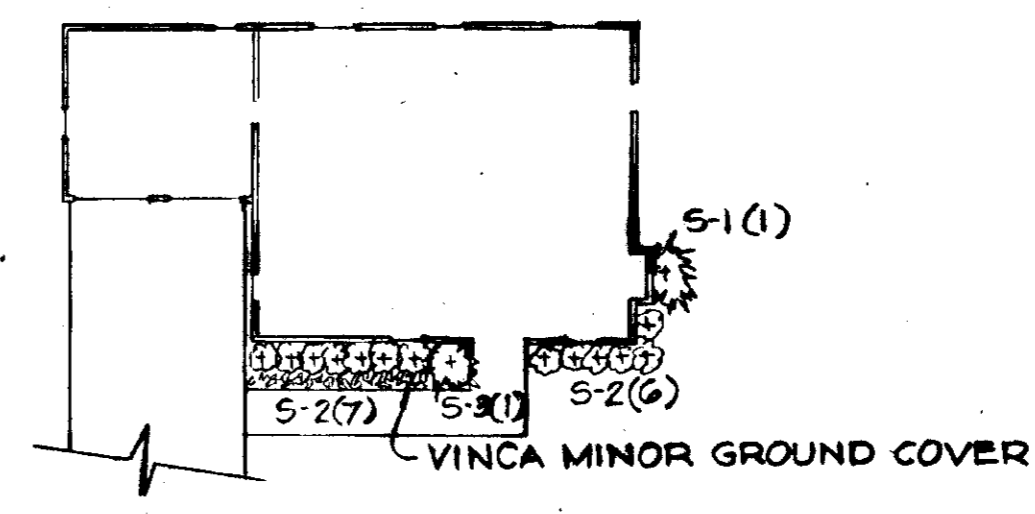

TYPICAL SUGGESTED PLANTING PLAN

UNDER THE SUPERVISION OF ARTHUR E. MUEGE, P.E. NO. 8707 THE RIEMER GROUP, INC. HAS MADE THE FOLLOWING REVISIONS TO THIS PLAN		
REVISION NO.	DESCRIPTION	DATE
1	REVISED LOT 97 ONLY	12-20-83

SITE DEVELOPMENT PLAN GLENMONT

Section 1 Area 2
Lots 95, 96, 97, 112, 113 Block E

ELECTION DISTRICT GUILFORD NO. 6 HOWARD CO. MD.
SCALE 1" = 50'

SHEET 1 OF 2 SECTION 1 AREA 2
Recorded as Plat # 3972 on March 22, 1978 among the land records of Howard County, Maryland

APPROVED
DIVISION OF LAND DEVELOPMENT

HOWARD COUNTY, MARYLAND
DATE 12-4-78

OWNER & DEVELOPER
Walter Stefanowicz
10854 York Road
Cockeysville Md. 21143

KIDDE
KIDDE CONSULTANTS, INC.
1020 CROMWELL BRIDGE ROAD
BALTIMORE, MARYLAND 21204

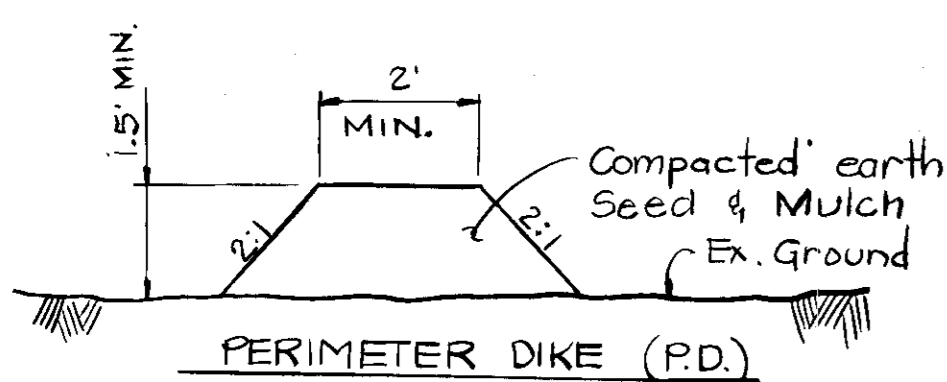
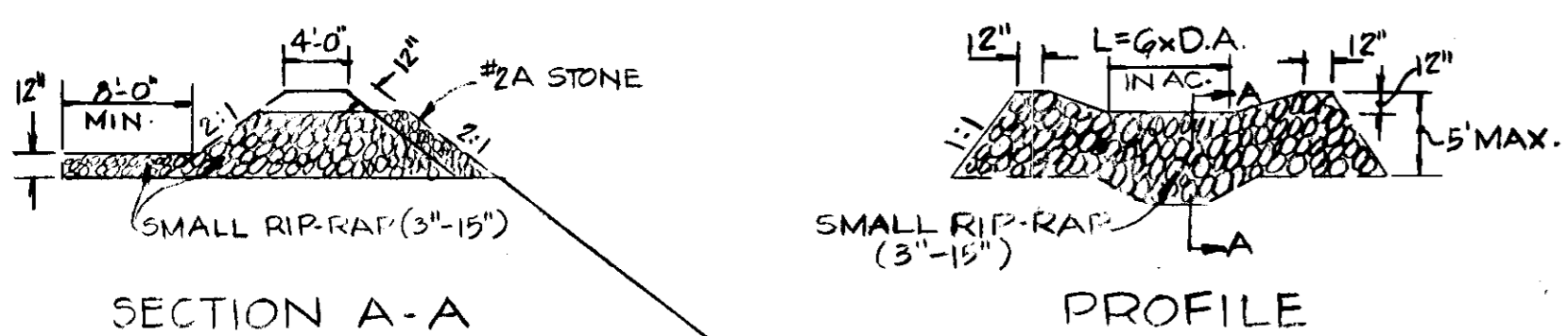
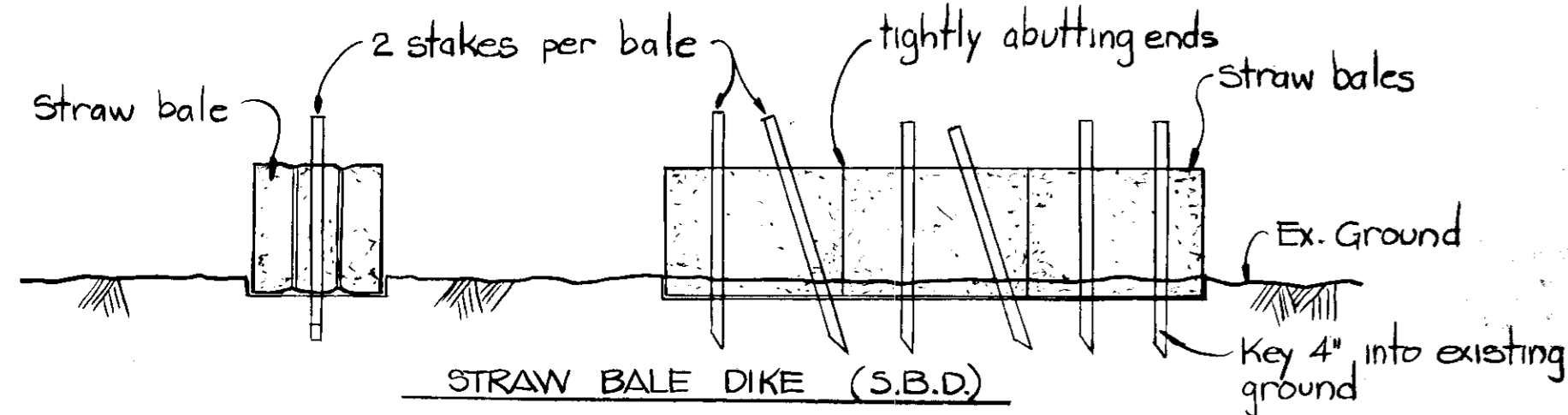
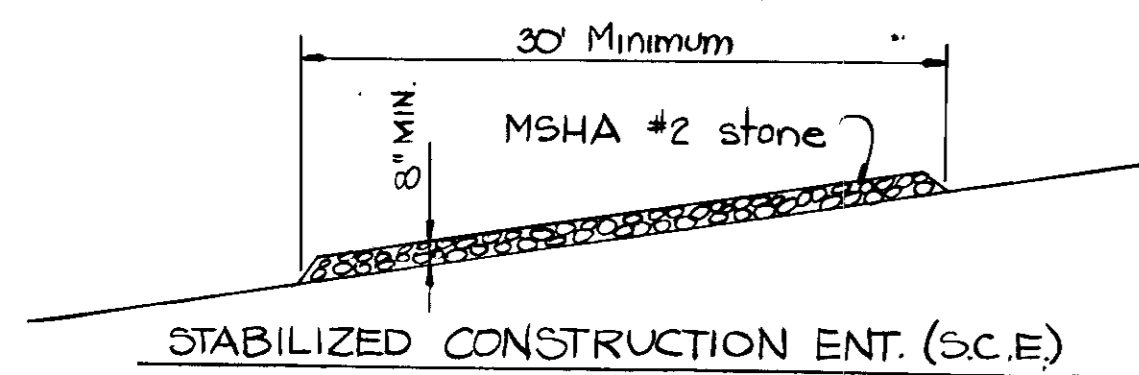

DETAILS
NO SCALE

GENERAL NOTES

1. Tax Map No. 30
2. Total area: 3 acres
3. Public Water and Sewer to be Utilized
4. All coordinates are based on Maryland State Grid system
5. All elevations are based on the U.S. Coast and Geodetic Survey datum of 1929
6. All driveways to be built as per Howard Co. Road Construction Code, Chapter 34 Rip-Rap
7. For bearings and distances of boundaries see Record & Return Book # 3972
8. ANY DAMAGE TO EXISTING PAVING AND RIGHT-OF-WAY OF FIVE FINGERS ROAD SHALL BE CORRECTED AT THE DEVELOPER'S EXPENSE.
9. ALL DRIVEWAYS ARE PRIVATE.
10. A GRADING PERMIT WILL BE OBTAINED PRIOR TO ANY EARTH MOVING WORK.

SITE ANALYSIS

1. Zoning R-12
2. Number of lots shown: 5
3. Area included in this Submittal: 1.63 Acres (undisturbed area: 17567⁺)
4. Disturbed area: 53200⁺
5. Impervious area: 14115⁺
6. Vegetatively stabilized: 39085⁺

APPROVED: For Public Water & Sewerage Systems, Howard County Health Dept.	<i>John F. Nemy</i> 2-1-79
APPROVED: Howard County Officers of Planning & Zoning	<i>Thomas A. Hanning</i> 2-6-79
APPROVED: Howard County Department of Public Works	<i>John W. Mueselman</i> 2-6-79
APPROVED: Howard County Department of Public Works	<i>Walter F. Nemy</i> 1-30-79
APPROVED: Howard County Department of Public Works	<i>W. O. Lambert</i> 1-29-79

DEVELOPER'S CERTIFICATION

I certify that all development and/or construction will be done according to this plan of development and plan of erosion and sediment control and I also authorize periodic onsite inspection by the Howard County Soil Conservation District or their authorized agents as are deemed necessary deviation from this plan only if authorized by the Howard County Soil Conservation District.

Walter Stefanowicz Date: 11/1/70
Walter Stefanowicz
10854 York Road
Cockeysville Md. 21143

SILT TRAP DATA

TRAP NUMBER	DRAINAGE AREA	STORAGE AREA	STORAGE SHOWN	DEPTH	BOTTOM ELEVATION	CLEAN OUT ELEVATION
#1	0.0 Ac.	40 cy.	59 cy.	2.0'	419.0	420.0
#2	0.0 Ac.	61 cy.	62 cy.	2.0'	417.0	418.0

Reviewed for Howard County S.C.S. and meets technical Requirements.

C. Wayne Ray Date: 1/9/79
U.S. Soil Conservation Service

This development plan is approved for soil erosion and Sediment Control by the Howard County soil conservation district.

Approved *Wes Egan* Date: 1-9-79
Howard County S.C.D.

ENGINEER'S CERTIFICATION

I certify that this plan for erosion and sediment control represents a practical and workable plan based on my personal knowledge of the site conditions and that it was prepared in accordance with the requirements of the Howard County Soil Conservation District.

Wes Egan Date: 1/11/78
KIDDE CONSULTANTS INC.
1020 CROMWELL BRIDGE ROAD
TOWSON MARYLAND, 21204

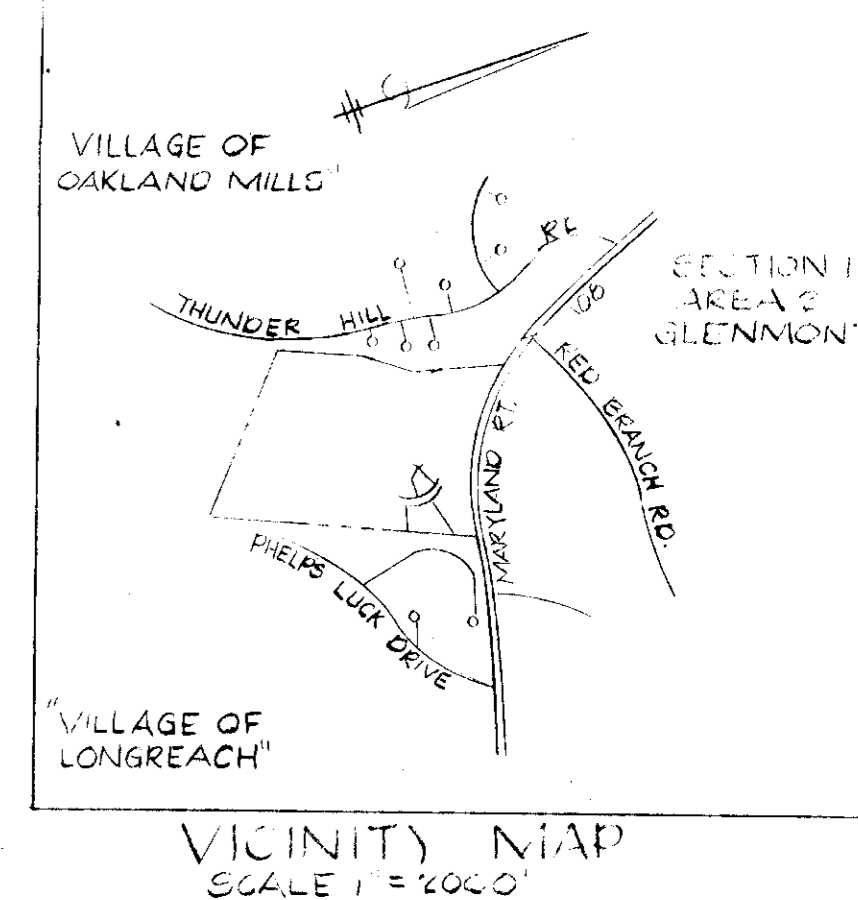
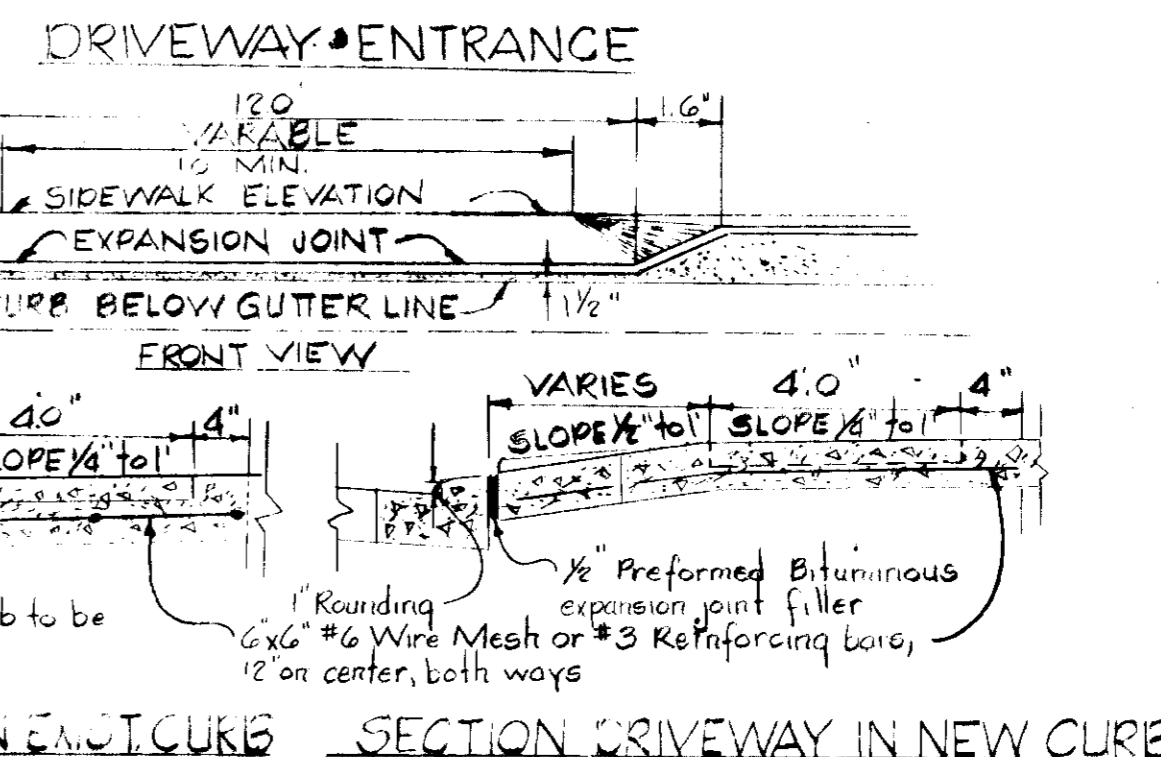

LEGEND

- Silt trap
- Existing Ground Elevation
- Proposed grade
- Perimeter Dike (P.D.)
- Stone outlet Structure (S.O.S.)
- Straw bale dike (S.B.D.)
- stabilized construction entrance (S.C.E.)

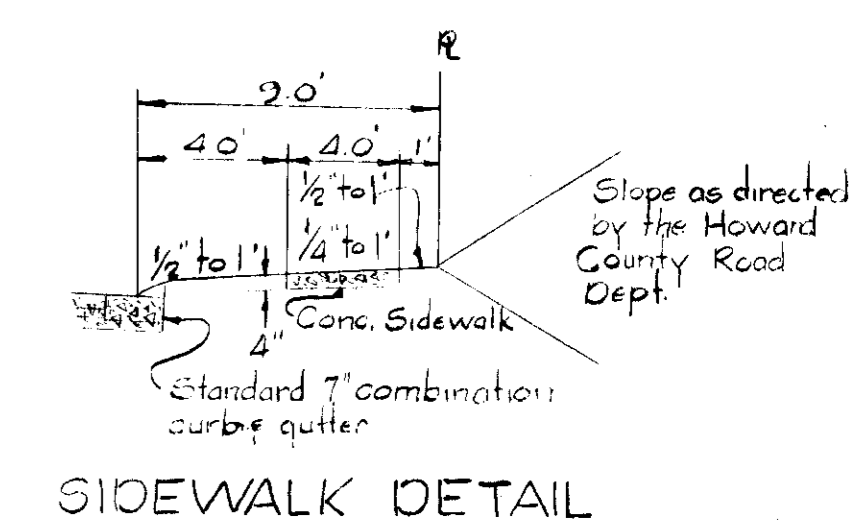

SEQUENCE OF OPERATION

1. Howard County Bureau of Licenses, Inspection & Permits to be notified 24 hrs. in advance of any construction start.
2. Construct & stabilize all sediment control measures.
3. Clearing & rough grade site.
4. Construction of houses & utilities.
5. Final grading & stabilization of disturbed areas.
6. Maintenance immediately upon completion.
7. Remove temporary sediment control measures after obtaining proper approval & stabilize these disturbed areas.

SEDIMENT CONTROL NOTE

1. All sediment control measures to be constructed according to the Standards & Specifications for Soil Erosion & Sediment Control in Developing Areas.
2. Follow sequence of operations above
3. Contractor to direct all surface run-off to P.D., S.C.E., S.B.D. & silt traps. No silt to be allowed to enter street R/W or off site.
4. Contractor to inspect all sediment control measures at least weekly & after each rain & make any necessary repairs and or replacements as required.
5. Contributing area to each stabilized construction entrance or straw bale dike is less than 0.4 Acres ±
6. All disturbed areas to be seeded as following
Ferm. seed
Creeping Red Fescue (50%) & certified Kentucky Blue Grass (50%) @ 130#/Acre. Mulching with wheat straw & asphalt tie down
prepare surface with ground limestone @ 2 tons per acre, commercial fertilizer 10-10-10 @ 0.75 tons per acre, Superphosphate @ 600# per acre, Mulch 1.5 tons per acre.
7. Removal of any sediment control measures only within approval from Howard County Inspector & only after site stabilized according to note #6 above.

SEDIMENT CONTROL PLAN
GLENMONT

Section 1 Area 2
Lots 95, 96, 97, 112, 113 Block E
ELECTION DISTRICT GUILFORD NC6 HOWARD CO. MD.
SCALE 1" = 50'
SHEET 1 OF 2
Recorded in Plat # 3972 on M. & D. 22, 1978 among the land records of Howard County, Maryland

OWNER & DEVELOPER
Walter Stefanowicz
10854 York Road
Cockeysville Md. 21143

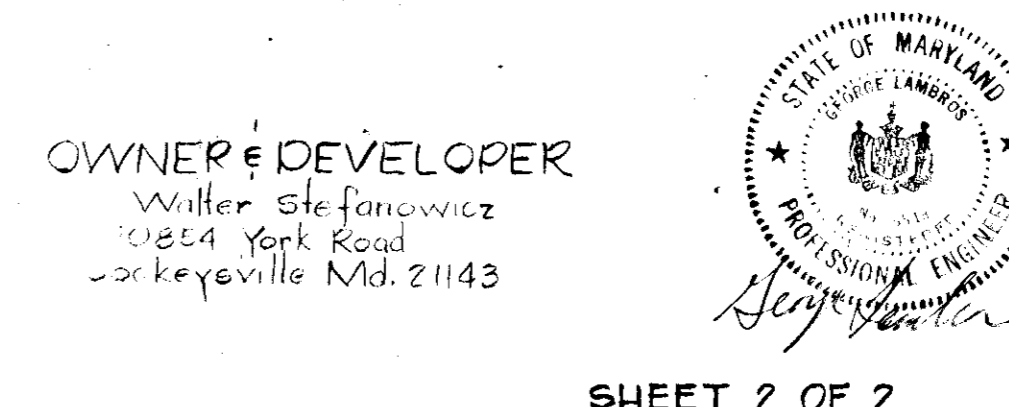

KIDDE
KIDDE CONSULTANTS, INC.
1020 CROMWELL BRIDGE ROAD
BALTIMORE, MARYLAND 21204