

Note: Use Residential Driveway Entrance, Howard Co. Std. Dwg. D-34, pg. 83 except where driveway abuts Modified Comb. Curb & Gutter.

Note: Materials and Construction shall be in accordance with Howard Co. Road Construction Code.

PLAN
DRIVEWAY ABUTTING MODIFIED COMB. CURB & GUTTER
No Scale

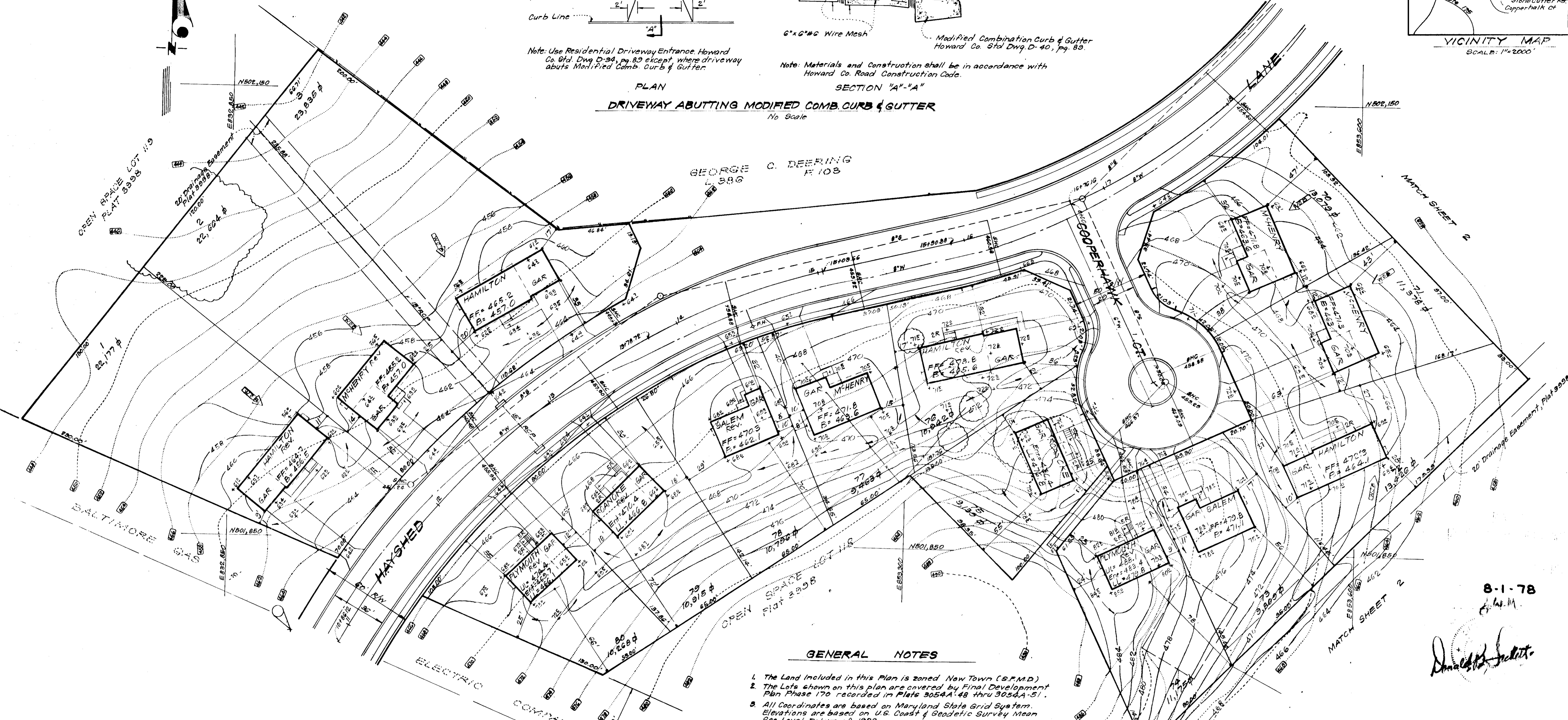

GENERAL NOTES

1. The Land included in this Plan is zoned New Town (S.F.M.D.)
2. The Lots shown on this plan are covered by Final Development Plan Phase 170 recorded in Plates 3054A, 48 thru 3054A, 51.
3. All Coordinates are based on Maryland State Grid System. Elevations are based on U.S. Coast & Geodetic Survey Mean Sea Level Datum of 1929.
4. The Area covered in this submission is located on Tax Map #36 §37.
5. The total Area included in this plan is 9.520 Acres.
6. All Roadways are public and existing.
7. Any damage to county owned rights of way or paving shall be corrected at the developer's expense.
8. Total No. of Lots included in this submission = 31.

LEGEND

1. Contour Interval 2 FT.
2. Existing Contour
3. Proposed Contour
4. Spot Elevation
5. Direction of Drainage
6. Exist. Trees to be retained
7. Retaining Wall

APPROVED FOR PUBLIC WATER AND PUBLIC SEWERAGE SYSTEMS, HOWARD COUNTY HEALTH DEPARTMENT

Joyce M. Boylen 8-21-78
PLANNING DIRECTOR

APPROVED FOR PUBLIC WATER AND PUBLIC SEWERAGE, STORM DRAINAGE SYSTEMS AND PUBLIC ROADS, HOWARD COUNTY DEPARTMENT OF PUBLIC WORKS

Richard E. Breidenberger 8/28/78
DIRECTOR

Note: For Bearings and Distances of Individual Lot Line See record plat recorded as 3058 §3039

CLARK • FINEFROCK & SACKETT
ENGINEERS • PLANNERS • SURVEYORS

11315 LOCKWOOD DRIVE SILVER SPRING, MARYLAND 20904 (301) 593-4100

DESIGNED DBS	SITE DEVELOPMENT PLAN LOTS 1 THRU 3 & LOTS 53 THRU 80	SCALE 1"=30'
DRAWN		DRAWING 1047-B
K.I.W.	VILLAGE OF LONGREACH SECTION 1, AREA 10, PART A 6th ELECTION DISTRICT HOWARD COUNTY, MARYLAND	JOB NO.
CHECKED DBS		FILE NO. 1047-X
DATE June, 1978	FOR: THE RYLAND GROUP (Columbia, MD) Suite 200 V.O.M. OFFICE BUILDING Columbia, Maryland 21045	

SDP-79-01-C

8-1-78

David H. Sackett

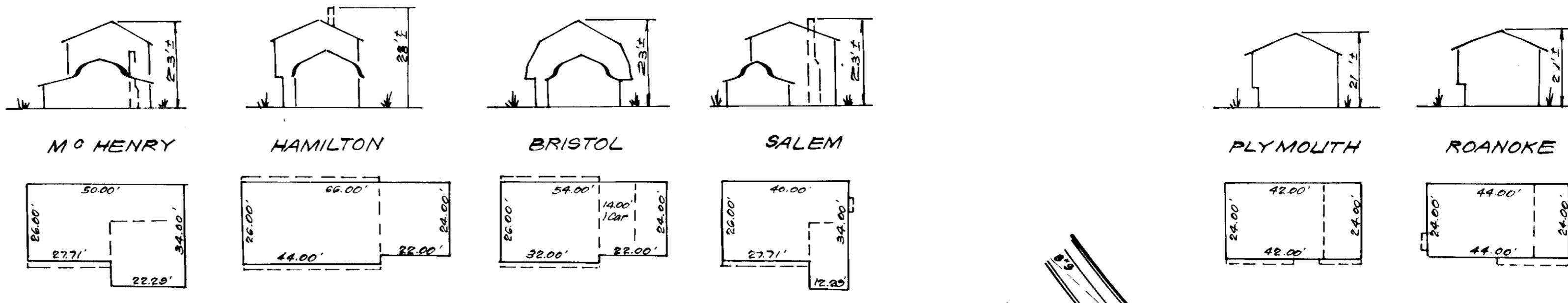

TYPICAL HOUSES
No Scale

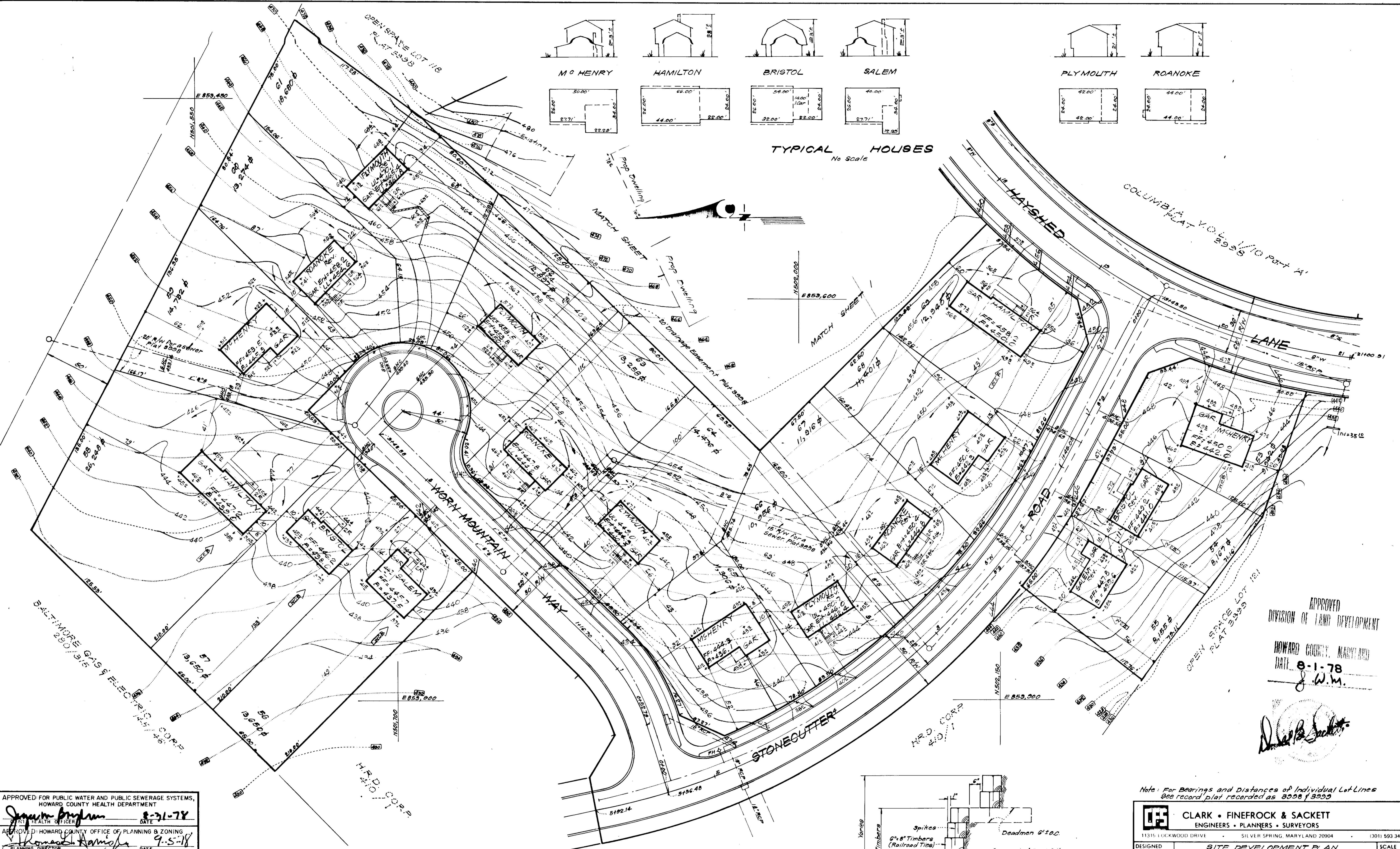

APPROVED
DIVISION OF LAND DEVELOPMENT
HOWARD COUNTY, MARYLAND
DATE: 8-1-78
J.W.M.

John W. M...

APPROVED FOR PUBLIC WATER AND PUBLIC SEWERAGE SYSTEMS,
HOWARD COUNTY HEALTH DEPARTMENT
James E. Ingram 8-21-78
HEALTH OFFICER DATE

APPROVED HOWARD COUNTY OFFICE OF PLANNING & ZONING
Thomas Ramona 9-5-78
PLANNING DIRECTOR DATE

APPROVED FOR PUBLIC WATER AND PUBLIC SEWERAGE,
STORM DRAINAGE SYSTEMS AND PUBLIC ROADS
HOWARD COUNTY DEPARTMENT OF PUBLIC WORKS
Richard E. Freudenberger 8/28/78
DIRECTOR DATE

W.O. L... 8-28-78
CHIEF BUREAU OF ENGINEERING DATE

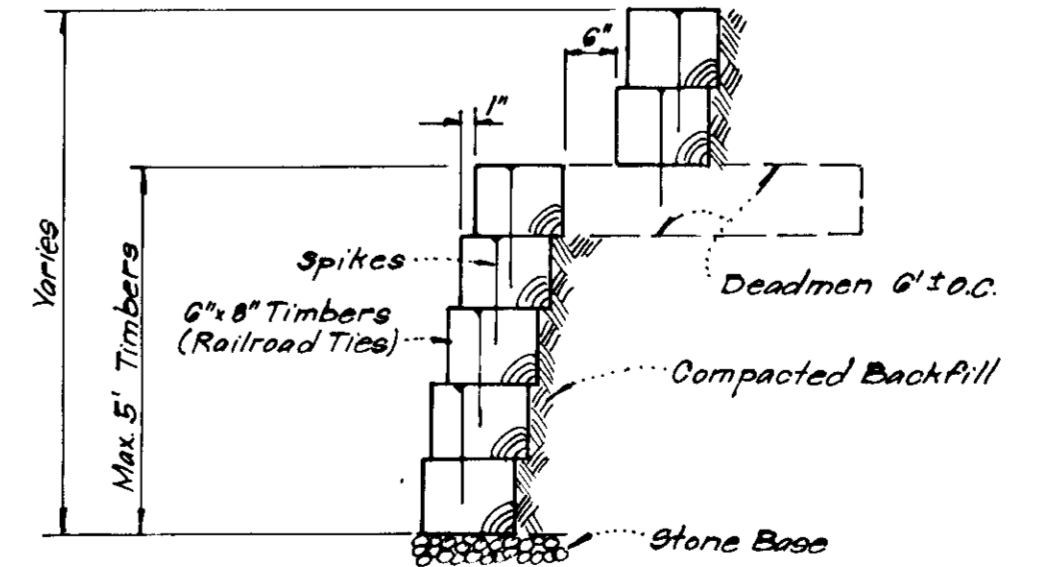

TIMBER RETAINING WALL
No Scale

Note: For Bearings and Distances of Individual Lot Lines
See record plat recorded as 8098 f3999

CLARK • FINEFROCK & SACKETT ENGINEERS • PLANNERS • SURVEYORS 11115 LOCKWOOD DRIVE SILVER SPRING, MARYLAND 20904 (301) 593 3400		
DESIGNED DBS	SITE DEVELOPMENT PLAN LOTS 53 THRU 80 & COLUMBIA VILLAGE OF LONGREACH SECTION 1 AREA 10 PART A 6th ELECTION DISTRICT HOWARD COUNTY, MARYLAND FOR: THE RYLAND GROUP, INC. Suite 200 Y.O.M. Office Building Columbia, Maryland 21045	SCALE 1"=30'
DRAWN K.L.W.		DRAWING 2 of 5
CHECKED DBS		JOB NO.
DATE June 1978		FILE NO. 1347-X
		SD.P-79-01C

See Also: 1302-SF

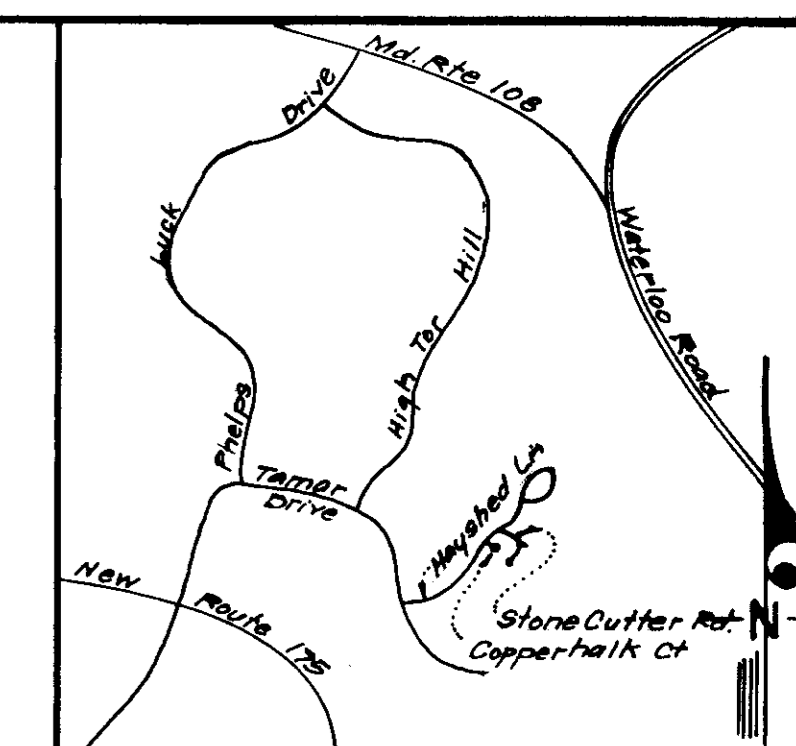

Note: Existing Sediment Trap as shown on Road Construction Plans, for Village of Longreach Sect. 1 Area 10, by Perdum & Jeschke, to be left in place.



Reviewed for Howard Name S.C.D.
and meets Technical Requirements
C. Wilson Date 8-21-78
Signature
U.S. Soil Conservation Service

THIS DEVELOPMENT PLAN IS APPROVED
FOR SOIL EROSION AND SEDIMENT
CONTROL BY THE HOWARD SOIL
CONSERVATION DISTRICT.

LES Egan Approved 8-21-78 Date

APPROVED
DIVISION OF LAND DEVELOPMENT
HOWARD COUNTY, MARYLAND
DATE 8-1-78
f.w.m.

APPROVED FOR PUBLIC WATER AND PUBLIC SEWERAGE SYSTEMS,
HOWARD COUNTY HEALTH DEPARTMENT
James M. Boyd Name 8-21-78 Date
HEALTH OFFICER
APPROVED HOWARD COUNTY OFFICE OF PLANNING & ZONING
Richard C. Freudenberg Name 8/28/78 Date
PLANNING DIRECTOR
CHIEF DIVISION OF LAND DEVELOPMENT
APPROVED FOR PUBLIC WATER AND PUBLIC SEWERAGE,
STORM DRAINAGE SYSTEMS AND PUBLIC ROADS
HOWARD COUNTY DEPARTMENT OF PUBLIC WORKS
Richard C. Freudenberg Name 8/28/78 Date
DIRECTOR
CHIEF BUREAU OF ENGINEERING 8-28-78 Date

- LEGEND**
- 1. Contour Interval 2 FT.
 - 2. Existing Contour 470
 - 3. Proposed Contour 470
 - 4. Spot Elevation +70#
 - 5. Direction of drainage DD
 - 6. Exist. Trees to be Retained (Symbol)
 - 7. Retaining Wall (Symbol)
 - 8. Diversion Dike DD
 - 9. Straw Bale Dike & Silt Fence SBD or SF
 - 10. Stone Filter Inlet Protection S.F.I.P.
 - 11. Stone Construction Entrance S.C.E.

DEVELOPER'S CERTIFICATE
I certify that all development and/or construction will be done according to this plan of development and plan for Erosion and Sediment Control, and I authorize periodic on-site inspection by the Howard Soil Conservation District or their authorized agents as are deemed necessary. Deviation from this plan will not be made unless authorized by the Howard Soil Conservation District.
Z.B. Soyars Signature 7-5-78 Date
L.B. Sargent

ENGINEER'S CERTIFICATE
I hereby certify that this plan for Erosion and Sediment Control represents a practical and workable plan based on my personal knowledge of the site conditions and that it was prepared in accordance with the requirements of the Howard Soil Conservation District.
G. Nelson Clark Signature 7-5-78 Date



Note: For Bearings and Distances of Individual Lot Line See record plat recorded as 3338 & 3399

CLARK • FINEFROCK & SACKETT
ENGINEERS • PLANNERS • SURVEYORS
11315 LUCKWOOD DRIVE SILVER SPRING, MARYLAND 20904 (301) 593 3400

DESIGNED J.L.S.	SEDIMENT & EROSION CONTROL PLAN LOTS 1 THRU 3 & LOTS 53 THRU 80 COLUMBIA VILLAGE OF LONGREACH SECTION 1 AREA 10 PART A 6th ELECTION DISTRICT HOWARD COUNTY, MARYLAND FOR: THE RYLAND GROUP (Columbia Div.) Suite 200 Y.O.M. Office Building Columbia, Maryland 21043	SCALE 1"=30'
DRAWN		DRAWING 3045
CHECKED K.I.W.		JOB NO.
DATE June, 1978		FILE NO. 1302SE
		See Also: 1347-X

S.D.P.-79-01C

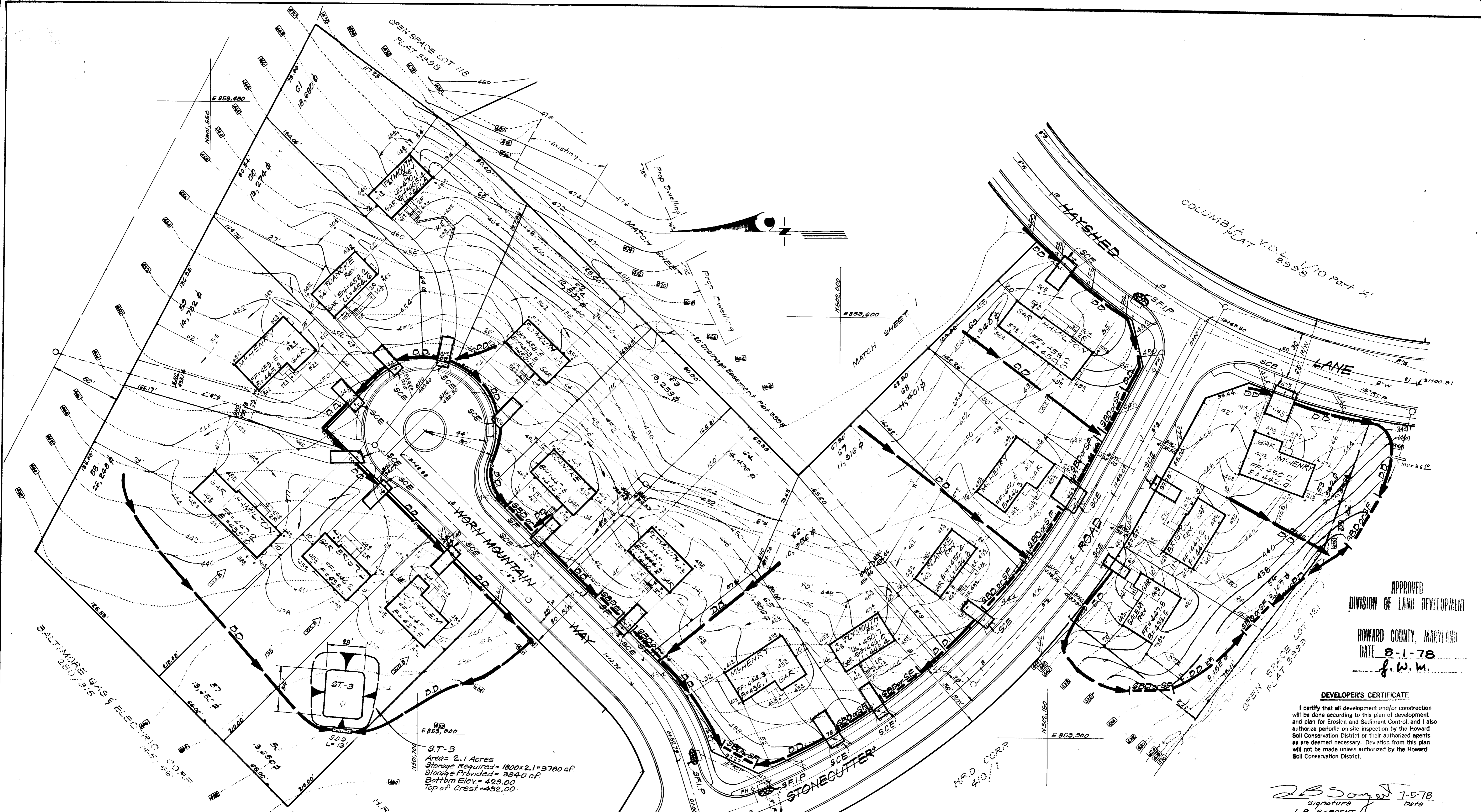

ST-3
 Area = 2.1 Acres
 Storage Required = 1800 x 2.1 = 3780 cF
 Storage Provided = 3840 cF
 Bottom Elev = 429.00
 Top of Crest = 432.00

APPROVED
 DIVISION OF LAND DEVELOPMENT
 HOWARD COUNTY, MARYLAND
 DATE 8-1-78
 f.w.m.

DEVELOPER'S CERTIFICATE
 I certify that all development and/or construction will be done according to this plan of development and plan for Erosion and Sediment Control, and I also authorize periodic on-site inspection by the Howard Soil Conservation District or their authorized agents as are deemed necessary. Deviation from this plan will not be made unless authorized by the Howard Soil Conservation District.

L.B. Sargent 7-5-78
 Signature Date
 L.B. SARGENT

Note: For Bearings and Distances of Individual Lot Lines see record plat recorded as 8998 & 8999

APPROVED FOR PUBLIC WATER AND PUBLIC SEWERAGE SYSTEMS,
 HOWARD COUNTY HEALTH DEPARTMENT
Joyce M. Brown 8-21-78
 COUNTY HEALTH OFFICER DATE
 APPROVED HOWARD COUNTY OFFICE OF PLANNING & ZONING
 PLANNING DIRECTOR DATE
 CHIEF DIVISION OF LAND DEVELOPMENT DATE
 APPROVED FOR PUBLIC WATER AND PUBLIC SEWERAGE,
 STORM DRAINAGE SYSTEMS AND PUBLIC ROADS
 HOWARD COUNTY DEPARTMENT OF PUBLIC WORKS
Richard E. Freudenberg 8/28/78
 DIRECTOR DATE
 CHIEF BUREAU OF ENGINEERING DATE

Reviewed for Howard S.C.D.
 Name
 and meets Technical Requirements
L. Wagoner 8-21-78
 Signature Date
 U.S. Soil Conservation Service
 THIS DEVELOPMENT PLAN IS APPROVED
 FOR SOIL EROSION AND SEDIMENT
 CONTROL BY THE HOWARD SOIL
 CONSERVATION DISTRICT.

WES EARP Approved 8-21-78
 Date

ENGINEER'S CERTIFICATE
 I hereby certify that this plan for Erosion and Sediment Control represents a practical and workable plan based on my personal knowledge of the site conditions and that it was prepared in accordance with the requirements of the Howard Soil Conservation District.

G. Nelson Clark 7-5-78
 Date



CLARK & FINEFROCK & SACKETT ENGINEERS • PLANNERS • SURVEYORS 11315 LOCKWOOD DRIVE SILVER SPRING, MARYLAND 20904 (301) 593-3400		
DESIGNED DBS	SEDIMENT & EROSION CONTROL PLAN LOTS 53 THRU 80 COLUMBIA VILLAGE OF LONGREACH SECTION 1, AREA 10, PART 'A' 6th ELECTION DISTRICT HOWARD COUNTY, MARYLAND FOR: THE RYLAND GROUP, INC. Suite 200 V.O.M. Office Building Columbia, Maryland 21045	SCALE 1"=30'
DRAWN K.I.W.		DRAWING 4 of 5
CHECKED DBS		JOB NO.
DATE June 1978		FILE NO. 1302-SE
SDP-79-01c		See Also: 1347-X

GENERAL NOTES

- All Sediment and Erosion Control Measures will be installed and stabilized according to this plan prior to any other grading, clearing or disturbance of the existing surface of the site. See Note #5 for stabilization except that the seed mixture will be annual rye applied at a rate of 1.4 lbs/1000 s.f. starting any work.
- Notify the Bureau of Inspections and Permits at least 24 hours before starting any work.
- All Sediment Control Practices to conform to the "Standards and Specifications for Soil Erosion and Sediment Control in Developing Areas" and shall be adjusted to meet actual field conditions.
- Stabilization of Disturbed Ground to be done as soon after construction as possible.
- All Grading shall be treated in accordance with the following Specifications:
 - Seed - certified 85% germination applied at the rate of 3 lbs/1000 s.f. mixture - 40% Kentucky Blue, 20% Chewings Fescue, 20% Kentucky 31, and 20% annual rye.
 - Fertilizer - 10-10-10 applied at the rate of 23 lbs/1000 sq. ft. Ground Agricultural Lime or Dolomitic Lime applied at the rate of 40 lbs/1000 s.f.
 - Mulch - Weed free grain straw applied at the rate of 70 lbs/1000 s.f. Mulch shall be secured to the ground by any approved method i.e. asphalt tacks, chemical binder, wood chips, etc.
- All Structural Sediment Control Measures are to remain in place until permission for their removal has been obtained from the Bureau of Inspections and Permits.
- On Site Inspection and Maintenance of all Sediment Control Measures including clean out of sediment traps and dikes, and proper establishment of all planned vegetative measures will be the responsibility of the Developer or his representative on the site, on a continuing day to day basis.
- Protection of stabilized area from sediment runoff shall be provided by the use of an approved Sediment Control Device, i.e. straw bale, diversion dike, etc.
- The Contractor shall keep all public roads free of sediment deposits left from traffic leaving construction site.
- Stabilized Construction Entrances shall be placed at all construction entrances.
- SITE ANALYSIS:**
 - Total Area = 3.52 Acres
 - Area to be Roofed = 0.93 Acres
 - Area to be Paved = 0.54 Acres
 - Area to be Seeded = 5.77 Acres
 - Area Undisturbed = 2.28 Acres
- CONSTRUCTION SEQUENCE:**
 - Install Sediment & Erosion Control Devices and stabilize Diversion Dikes.
 - Excavate for Foundations and Rough Grade.
 - Erect Structures, Drive ways and Side walks.
 - Final grade and stabilize in accordance with Note #5.
- If Houses are to be constructed on an "As Sold" basis at random, Single Lot Sediment Control, as shown on this site, shall be implemented.
- It will be the Developer's responsibility to provide additional Sediment & Erosion Control Devices to protect stabilized areas during construction.
- Total Amount of Straw Bales or Silt Fence shown = 721 L.F.

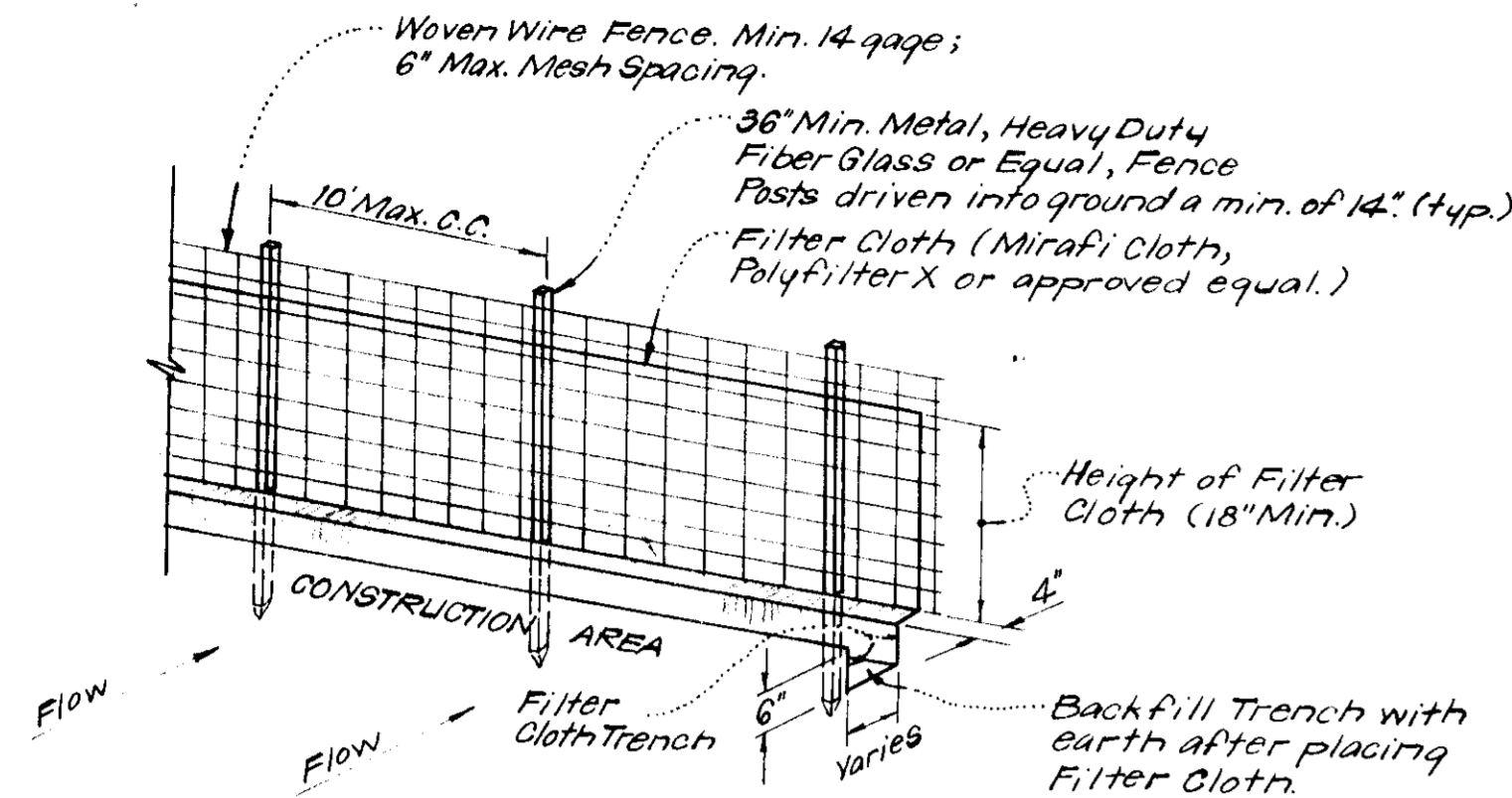

NOTES:
 1. Woven Wire Fence to be fastened securely to fence posts by use of wire ties.
 2. Filter Cloths to be fastened securely to woven wire fence by use of wire ties spaced every 24" x 24".

SILT FENCE DETAIL (S.F.)
 No Scale

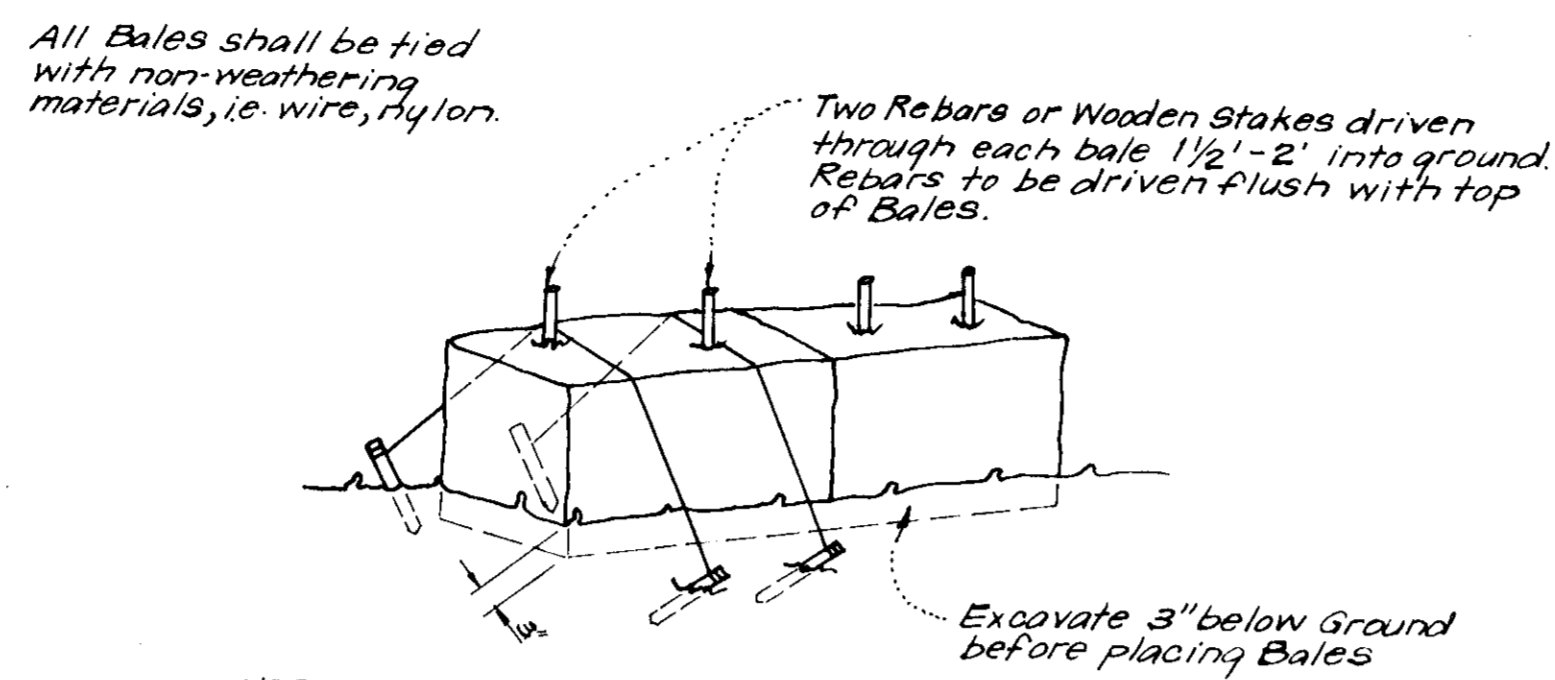

NOTE:
 1. In lieu of the use of rebar each Straw Bale may be fastened to ground with pegs (4 per bale and wire or nylon as shown above).

TYPICAL STRAW BALE DETAIL (S.B.D.)
 No Scale

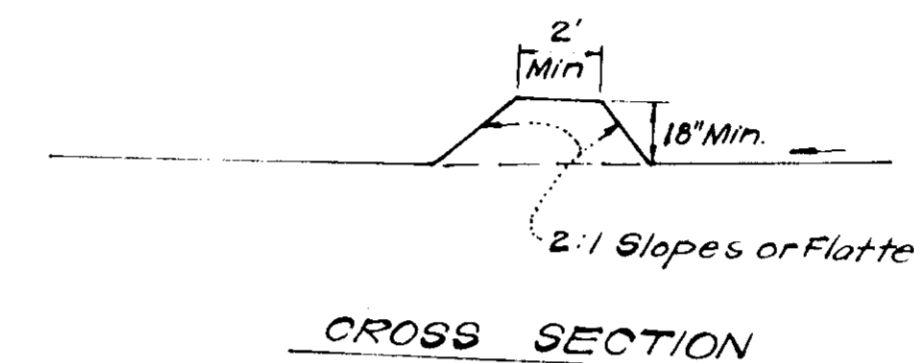

CROSS SECTION

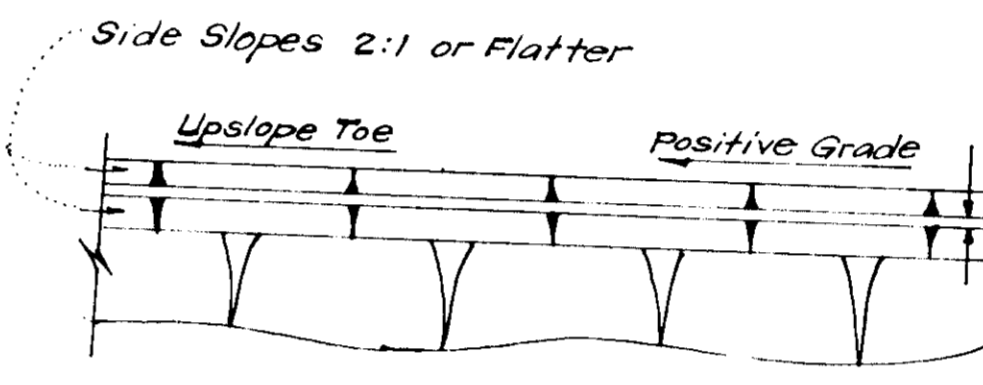

PLAN VIEW
DIVERSION DIKE (D.D.)
 No Scale

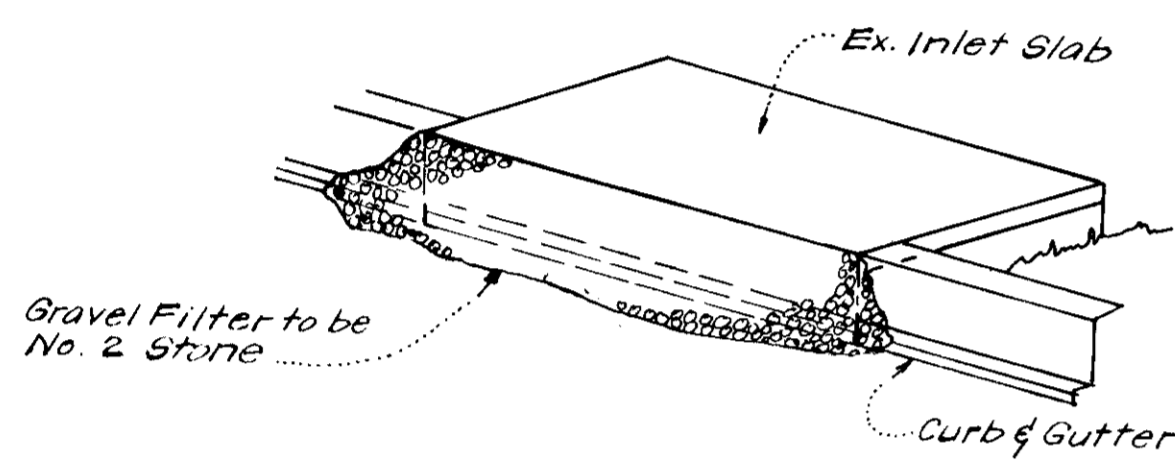

ISOMETRIC VIEW

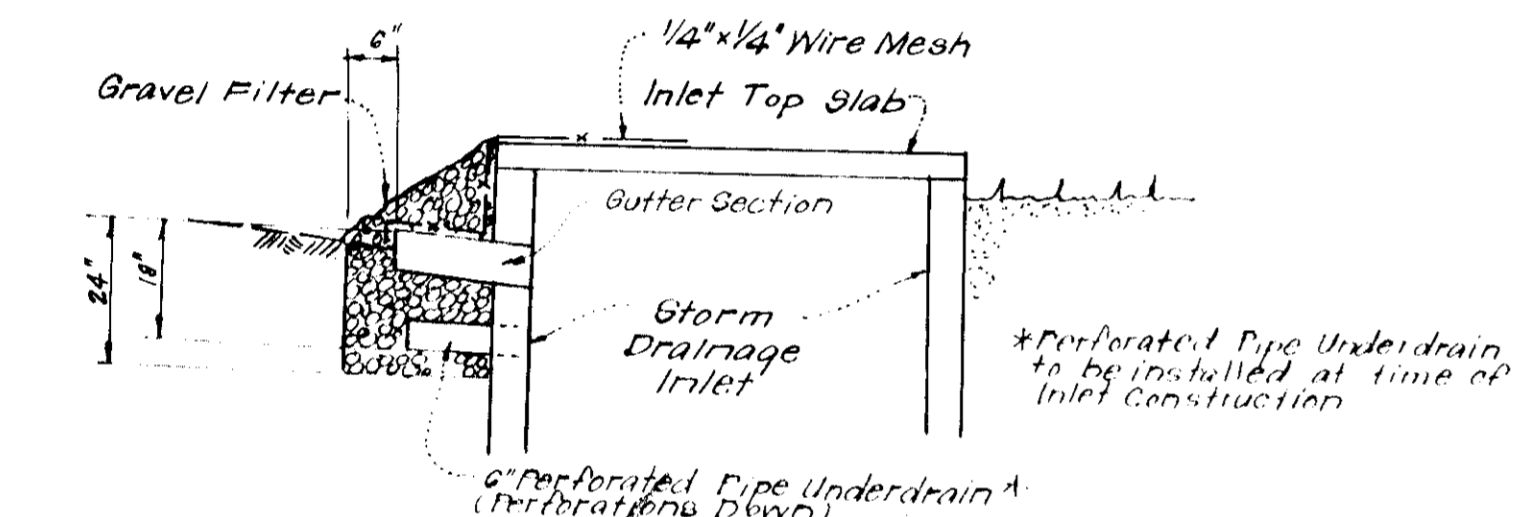

SECTION VIEW

STONE FILTER INLET PROTECTION DETAIL (S.F.I.P.)
 No Scale

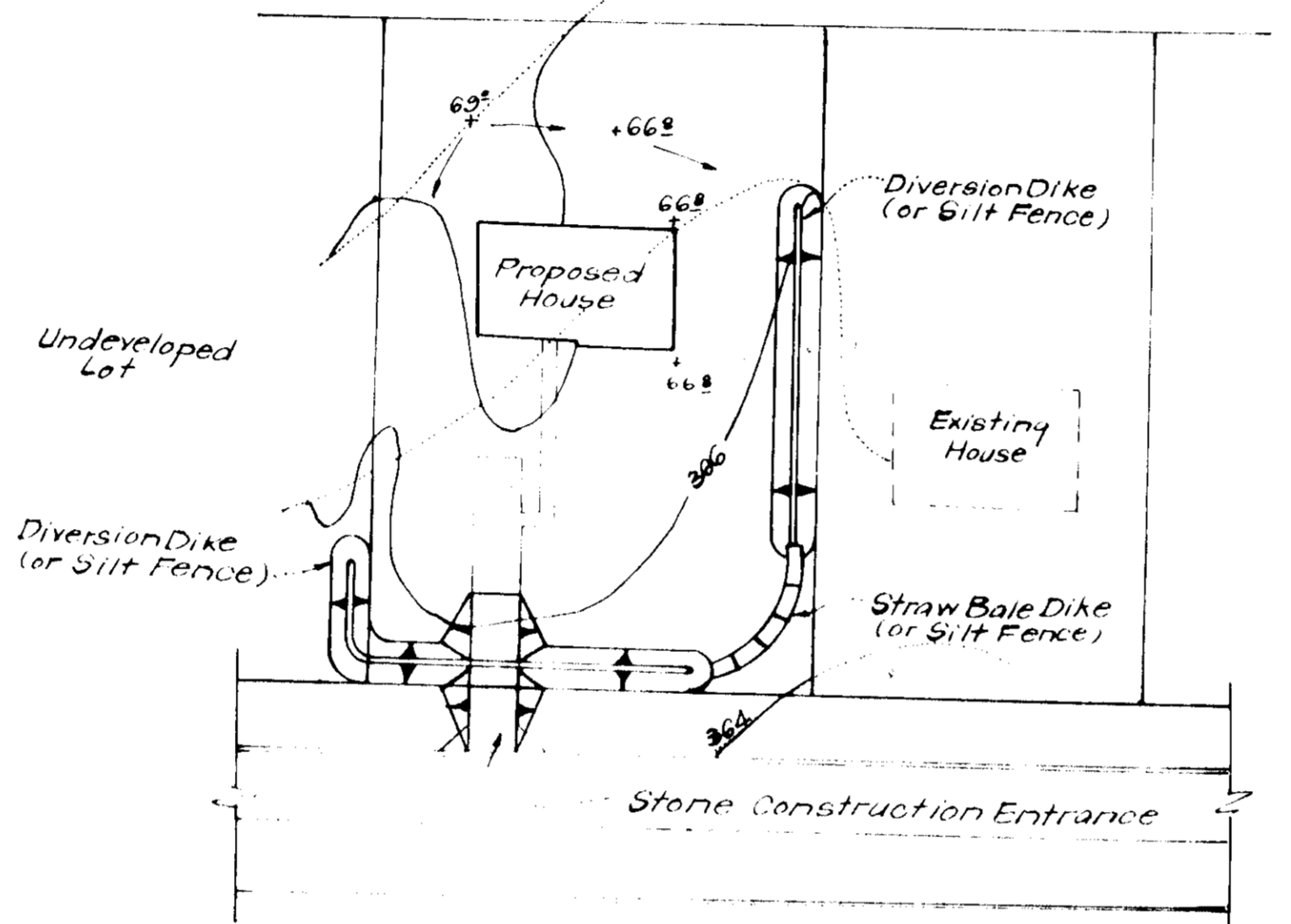

TYPICAL SINGLE LOT SEDIMENT CONTROL PLAN
 No Scale



STONE CONSTRUCTION ENTRANCE DETAIL (S.C.E.)
 No Scale

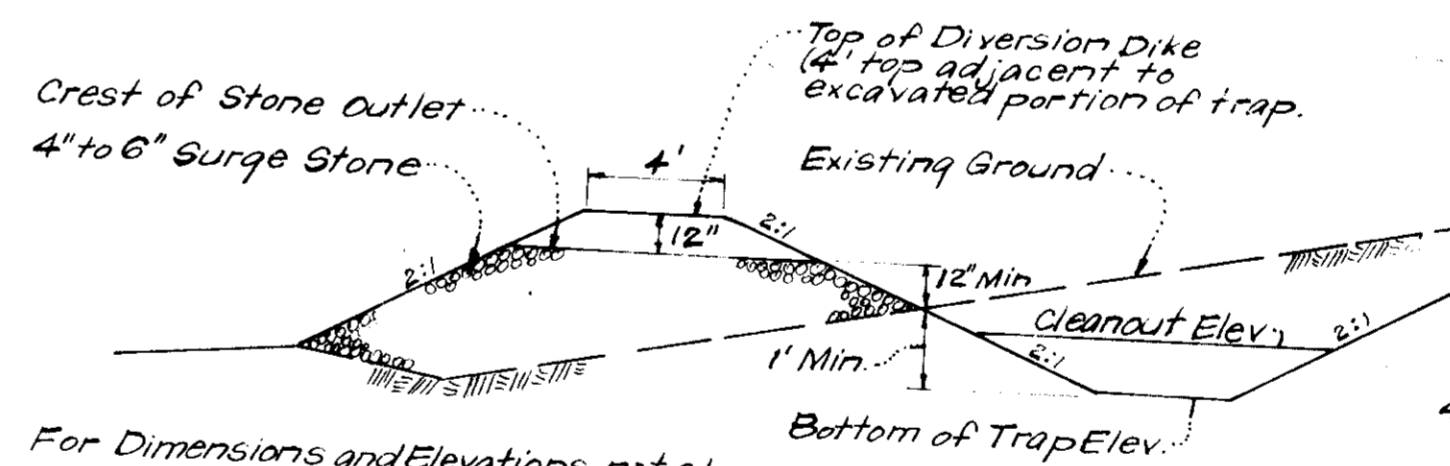

TYPICAL PROFILE

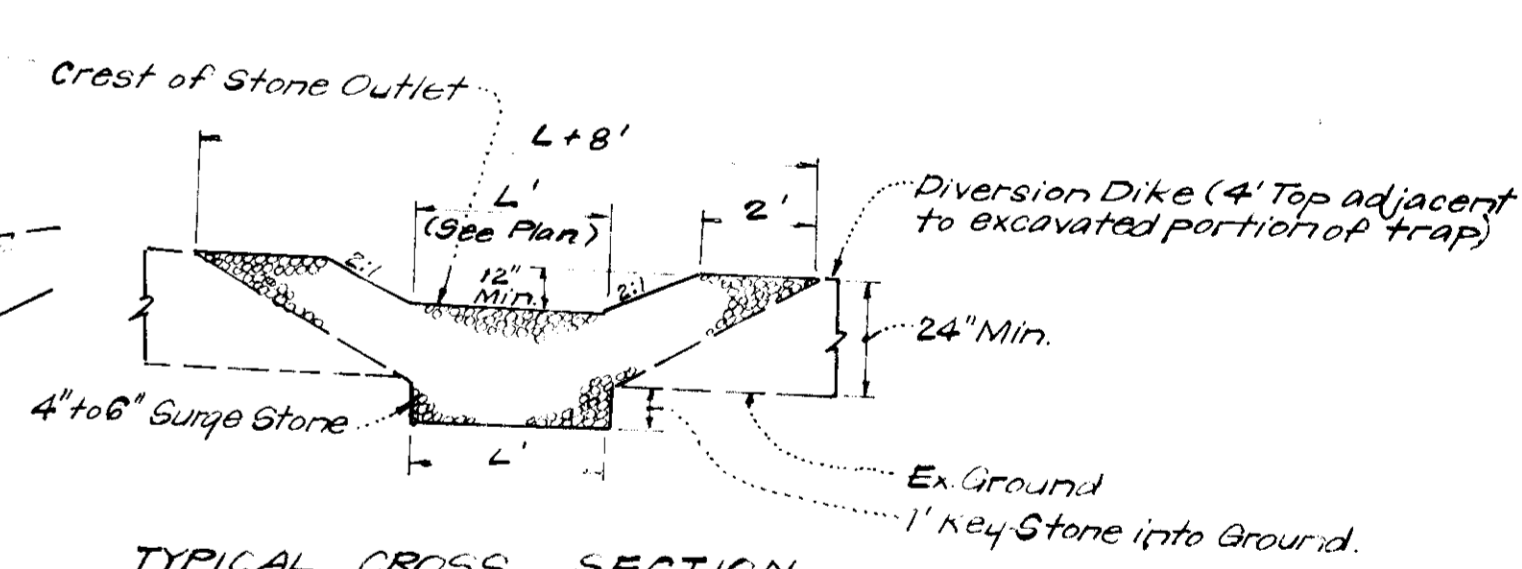

TYPICAL CROSS SECTION

DETAILS OF STONE FILTER OUTLET (FOR STONE OUTLET SEDIMENT TRAP)
 No Scale

STONE FILTER OUTLET NOTES:

- Sediment Trap to be cleaned out when sediment reaches a level of 1.5ft. below the Crest of Stone Outlet.
- Bottom of Sediment Trap to be level and constructed to the dimensions shown on plan.
- Stone Outlet to be constructed through diversion dike adjacent to excavated portion of Sediment Trap.

ENGINEER'S CERTIFICATE

I hereby certify that this plan for Erosion and Sediment Control represents a practical and workable plan based on my personal knowledge of the site conditions and that it was prepared in accordance with the requirements of the Howard Soil Conservation District.

G Nelson Clark
 G Nelson Clark
 7-5-78
 Date

DEVELOPER'S CERTIFICATE

I certify that all development and/or construction will be done according to this plan of development and plan for Erosion and Sediment Control, and I also authorize periodic on-site inspection by the Howard Soil Conservation District or their authorized agents as are deemed necessary. Deviation from this plan will not be made unless authorized by the Howard Soil Conservation District.

L B Sargent
 L B Sargent
 7-5-78
 Date

Reviewed for... HOWARD... S.C.D.
 Name
 and meets Technical Requirements
L. Rogers Ray
 Signature
 8-21-78
 Date
 U.S. Soil Conservation Service

THIS DEVELOPMENT PLAN IS APPROVED FOR SOIL EROSION AND SEDIMENT CONTROL BY THE HOWARD SOIL CONSERVATION DISTRICT.

W. S. Fazio
 Approved
 8-21-78
 Date

APPROVED
 DIVISION OF LAND DEVELOPMENT

HOWARD COUNTY, MARYLAND
 DATE 8-1-78
L.W.M.

CLARK • FINEFROCK & SACKETT ENGINEERS • PLANNERS • SURVEYORS 11115 LEE KENNEDY DRIVE SUITE 200 WILMINGTON, MARYLAND 20894 (301) 593-3400		SCALE As Shown DRAWING 5 of 5 JOB NO. FILE NO. 1302-SE
DESIGNED J.L.S. DRAWN K.I.W. CHECKED J.L.S. DATE July, 1978	SEDIMENT & EROSION CONTROL PLAN LOTS 53 THRU 80 & LOTS 1 THRU 3 COLUMBIA VILLAGE OF LONGREACH SECTION 1 AREA 10 PART 1A 6TH ELECTION DISTRICT HOWARD COUNTY, MARYLAND FOR THE RYLAND GROUP INC. Suite 200 W.O.M. OFFICE Bldg. Columbia, Maryland 21045	DATE July, 1978

APPROVED FOR PUBLIC WATER AND PUBLIC SEWERAGE SYSTEMS, HOWARD COUNTY HEALTH DEPARTMENT
James M. Brown
 COUNTY HEALTH OFFICER
 DATE 8-31-78

APPROVED, HOWARD COUNTY OFFICE OF PLANNING & ZONING
 PLANNING DIRECTOR
 DATE

CHIEF, DIVISION OF LAND DEVELOPMENT
 DATE

APPROVED FOR PUBLIC WATER AND PUBLIC SEWERAGE STORM DRAINAGE SYSTEMS AND PUBLIC ROADS HOWARD COUNTY DEPARTMENT OF PUBLIC WORKS
Richard E. Freudenberger
 DIRECTOR
 DATE 8/28/78

CHIEF, BUREAU OF ENGINEERING
 DATE