

DRIVEWAY ABUTTING MOD. COMB. CURB & GUTTER
NO SCALE

GENERAL NOTES

1. All coordinates are based on Maryland State Grid System. Elevations are based on U.S. Coast and Geodetic Survey Mean Sea Level Datum of 1929.
2. The lots shown on this plan are covered by Final Development Plan Phase 100-A recorded in Plat Book 20 Folios 149 to 157.
3. The Area covered in this submission is located on Tax Map No. 35.
4. The total area included in this plan is 0.480 Acres.
5. The land in this plan is zoned New Town. (S.F.M.D.)
6. Street & Utility Improvements of Sunny Spring are existing, and of Branch Beech are proposed.
7. Any damage to county owned Right of Ways or paving shall be corrected at the Developer's expense.

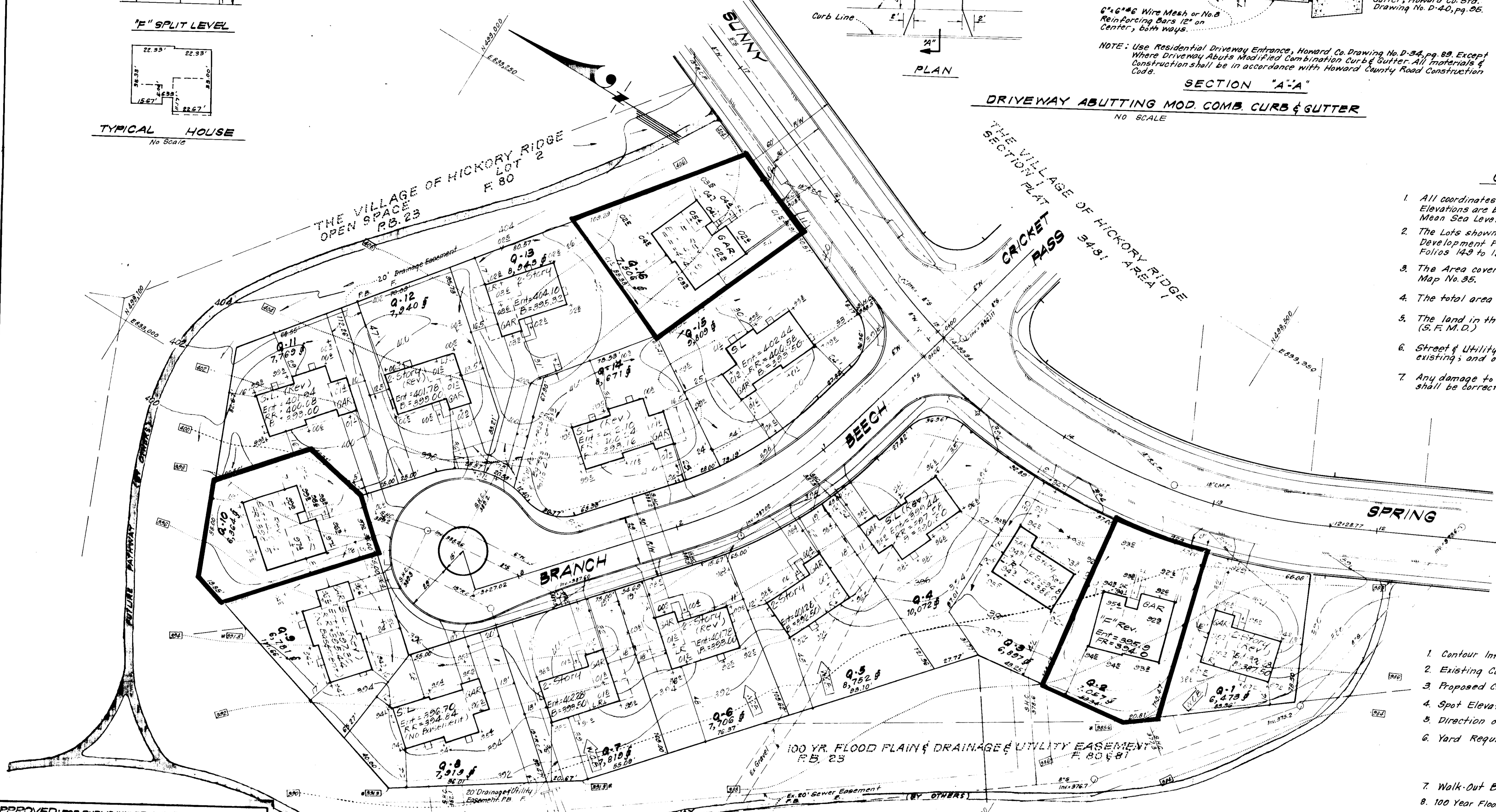

7-27-77

LEGEND

1. Contour Interval: 2 Ft.
2. Existing Contour: ---
3. Proposed Contour: - - -
4. Spot Elevation: + 005
5. Direction of Drainage: →
6. Yard Requirements: Front = 30' on 60' Wide Street, 20' on 50' Wide Street, Side = 7.5' (Min.)
7. Walk-Out Basement: W.O.B.
8. 100 Year Flood Plain Elevation: 207.1'

NOTE:
For bearings and distances of individual lot lines, see record plat recorded as Plat 3631. A resubdivision of Parcel Q.

SURVEYOR'S CERTIFICATION
I hereby certify that the information contained herein is the same as shown on previously approved SDP 77-400, with the following exceptions:
1. House Type and Grading has been revised on Lots Q-2, Q-10 & Q-16.
I further certify that the sediment & erosion control measures as previously approved, will not be affected, if the grading is substantially the same as originally approved, the building setbacks comply with E.D.P. Phase 100-A and the lot has the same geometric configuration as shown on the respective recorded subdivision plat.

Donald B. Sackett
DONALD B. SACKETT
Registered Land Surveyor
Md. No. 6059

7-8-77
Date

OWNER:
Columbia Builders, Inc.
606 American City Bldg.
Columbia, Maryland, 21044

No.	REVISIONS	DATE
1.	Changed House Type & Grading on Lots Q-2, Q-10 & Q-16	7-8-77

APPROVED FOR PUBLIC WATER AND PUBLIC SEWERAGE SYSTEMS, HOWARD COUNTY HEALTH DEPARTMENT
Joseph Borden
COUNTY HEALTH OFFICER
DATE: 8-16-77

APPROVED FOR HOWARD COUNTY OFFICE OF PLANNING & ZONING
William M. Smith
PLANNING DIRECTOR
DATE: 8-17-77

APPROVED FOR PUBLIC WATER AND PUBLIC SEWERAGE, STORM DRAINAGE SYSTEMS AND PUBLIC ROADS, HOWARD COUNTY DEPARTMENT OF PUBLIC WORKS
W.S. [Signature]
DATE: 8-12-77

APPROVED FOR HIGHWAYS
[Signature]
DATE: [Blank]

CLARK • FINEROCK & SACKETT
ENGINEERS • PLANNERS • SURVEYORS
11435 LOCKWOOD DRIVE SILVER SPRING, MARYLAND 20904 (301) 593-3400

DESIGNED W.H.T.
DRAWN K.I.W.
CHECKED W.H.T.
DATE July 1977

REVISED SITE DEVELOPMENT PLAN
LOTS Q-2, Q-10 & Q-16.
COLUMBIA
VILLAGE OF HICKORY RIDGE
SECTION 1 AREA 1
5th ELECTION DISTRICT
HOWARD COUNTY, MARYLAND
FOR: COLUMBIA BUILDERS, INC.
606 American City Building
Columbia, Maryland 21044

SCALE 1" = 30'
DRAWING 1 of 1
JOB NO. [Blank]
FILE NO. 1232-A-XI

SDP-78-08c