

STATION
 PC = 3+70.00
 PI = 4+12.00
 PT = 4+35.97

CURVE DATA
 A = 90°00'00"
 R = 42.00'
 L = 65.97'
 T = 42.00'
 Chd. = 39.40'

STATION
 PC = 6+16.48
 PI = 6+26.36
 PT = 6+36.36

CURVE DATA
 A = 28°57'17"
 R = 47.61'
 L = 10.10'
 T = 19.90'
 Chd. = 19.76'

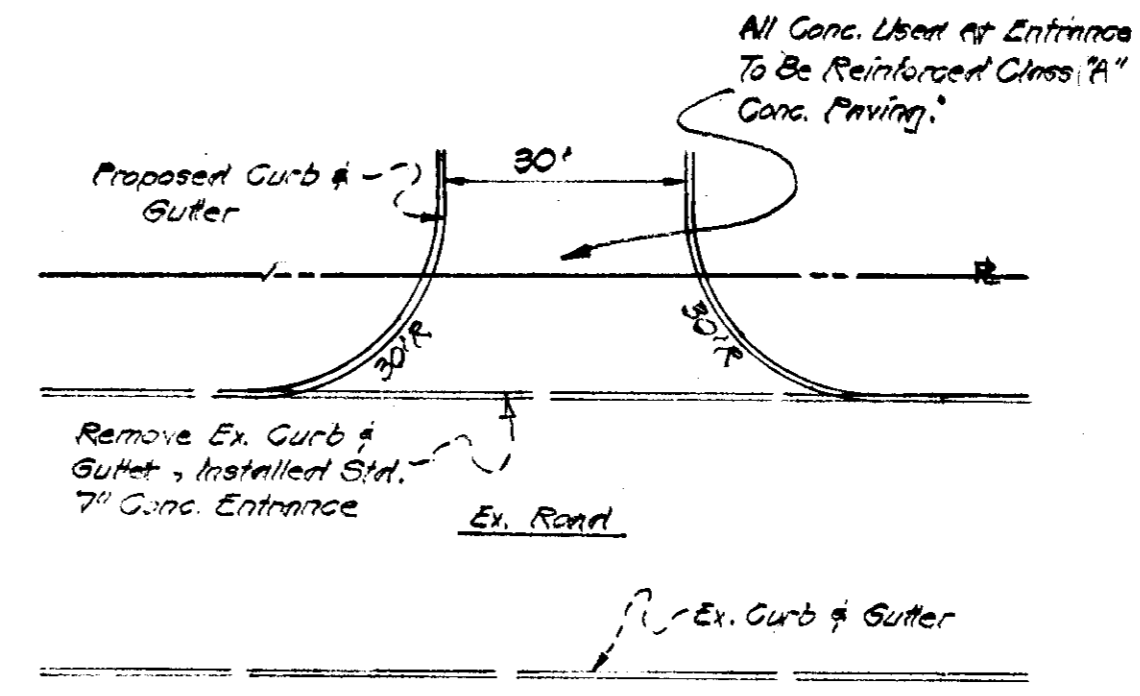

ENTRANCE DETAIL
 NO SCALE
 Entrance To Be Coordinated With Howard Co. Road Design For Commercial Driv. Entrance D-34 A, Page 84.

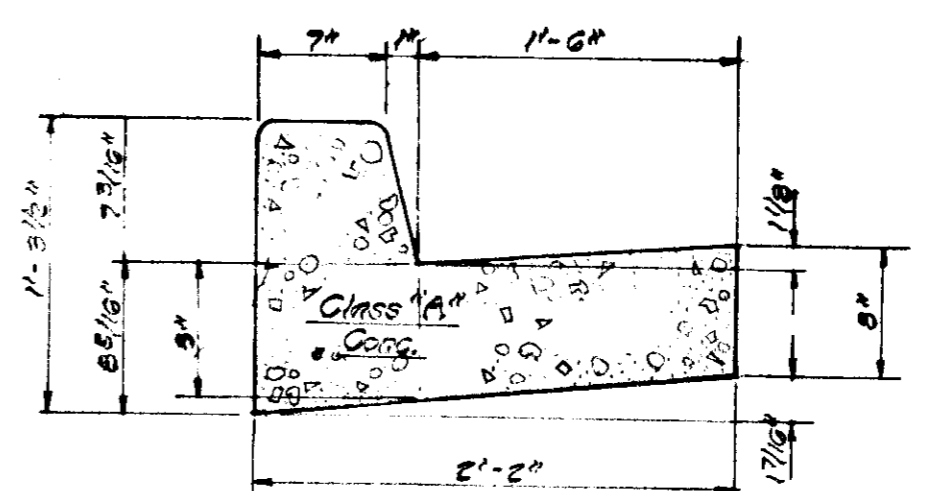

CURB DETAIL
 NO SCALE
 Standard 7' Combination Curb & Gutter
 Howard County Std. D-40, P.25.

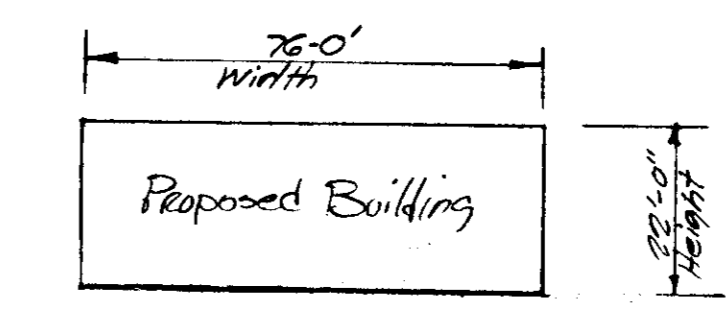

BUILDING SCHEMATIC
 NOT TO SCALE

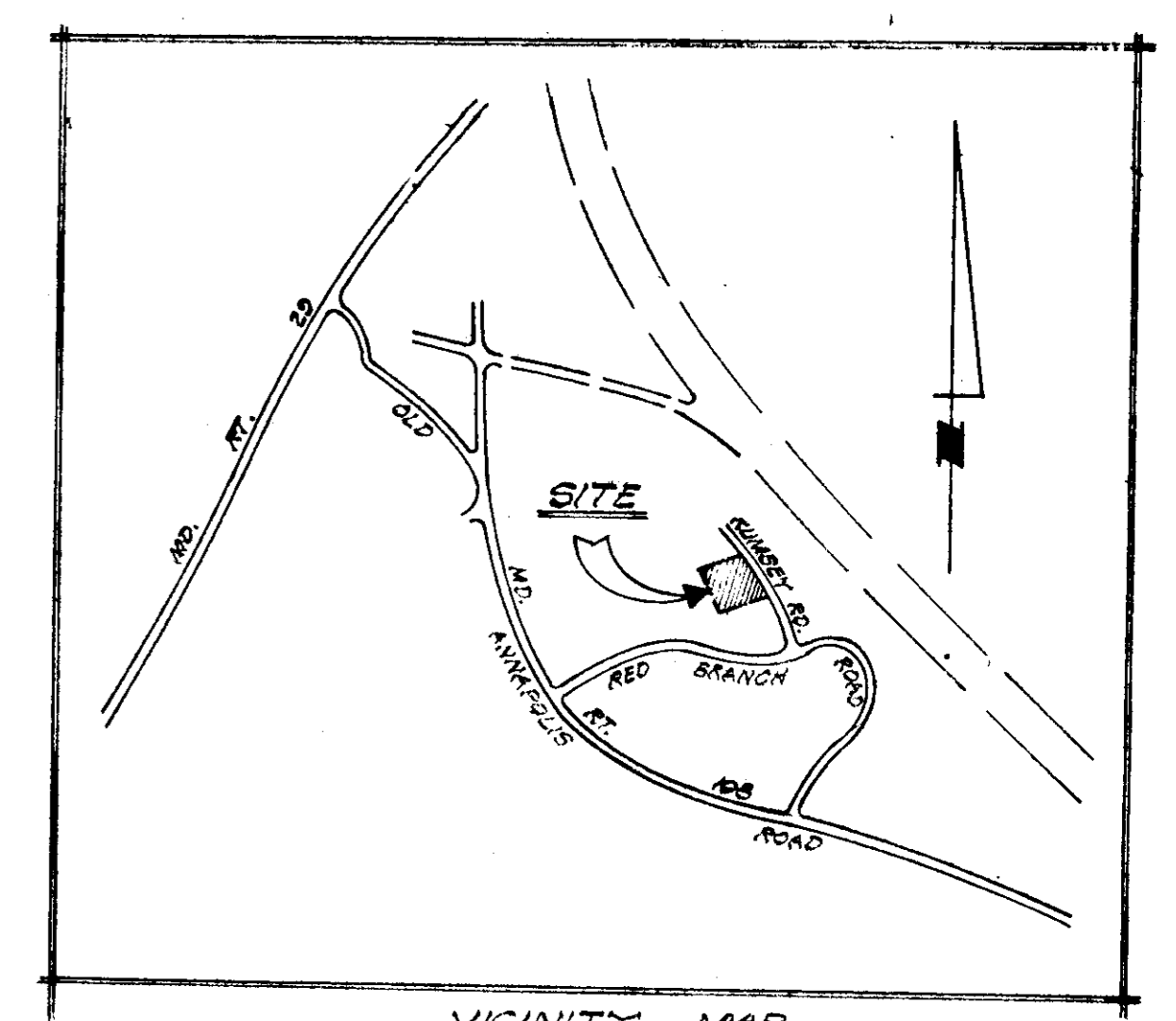

VICINITY MAP
 NO SCALE

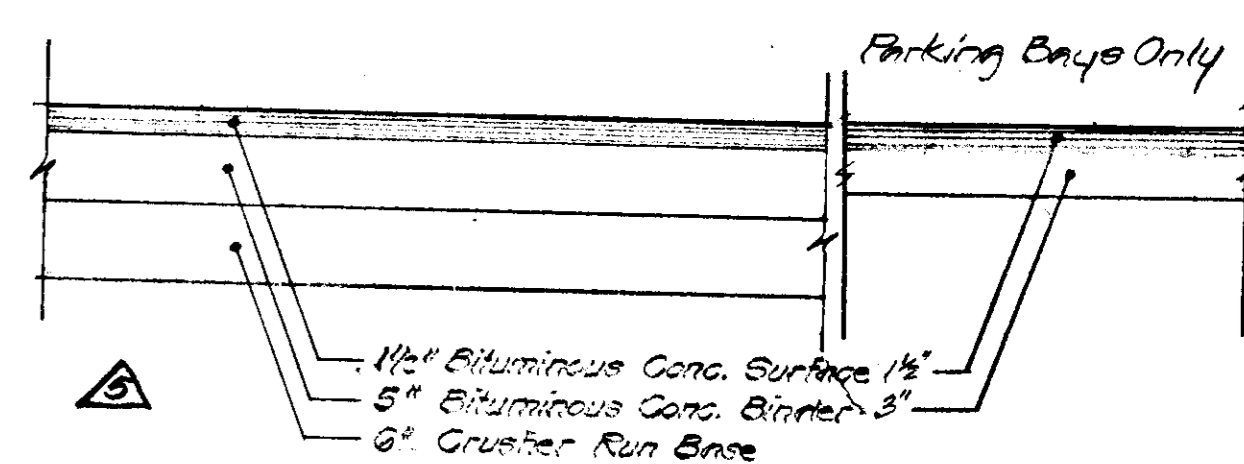

NOTE:
 1. Paving Section & Materials Used Shall Meet The Minimum Requirements Of The Howard County Road Construction Code And Standard Specifications (D-5, P.23).
 2. Base Will Be Primed Per Section G-20-3 HCRCC
 3. Thick Coat Is Required Per Section G-31-4 HCRCC

GENERAL NOTES

PLACE 2" TOPSOIL & SEED & MULCH OR SOD ALL AREAS DISTURBED BY CONSTRUCTION UNLESS OTHERWISE NOTED. SEE NOTE BELOW.

ALL SEDIMENT CONTROL PRACTICES MUST BE INSTALLED PRIOR TO BEGINNING MAJOR GRADING, CLEARING, OR CONSTRUCTION OPERATIONS.

THE CONTRACTOR SHALL MEET ALL THE REQUIREMENTS OF THE HOWARD COUNTY SOIL CONSERVATION DISTRICT AND SHALL CONFORM TO ALL SEDIMENT AND EROSION CONTROL MEASURES SET FORTH BY THE U.S. DEPARTMENT OF AGRICULTURE, SOIL CONSERVATION SERVICE.

PAVING SECTION AND MATERIAL USED SHALL MEET THE MINIMUM REQUIREMENTS OF THE HOWARD COUNTY ROAD CONSTRUCTION CODE AND STANDARD SPECIFICATIONS. (D-5, P.23)

TOPO TAKEN FROM FIELD DATA SUPPLIED BY UNI-VERSAL ENGINEERING MANAGEMENT, INC.

PUBLIC WATER AND SEWER SYSTEMS TO BE MADE AVAILABLE AND UTILIZED.

ALL BUILDING RESTRICTION LINES TO CONFORM TO THE FINAL DEVELOPMENT PLAN CRITERIA PHASE 25.

ALL TRAFFIC CONTROL DEVICES, MARKING AND SIGNALING SHALL BE INSTALLED IN ACCORDANCE WITH THE MANUAL OF UNIFORM TRAFFIC CONTROL DEVICES 1971 EDITION.

ALL EXISTING ELEVATIONS ARE BASED ON U.S.G.S. DATUM.

A BUILDING IDENTITY SIGN WILL BE ERRECTED IN ACCORDANCE WITH THE HOWARD COUNTY SIGN CODE.

THE DRAINAGE STRUCTURES, MANHOLES, CATCH BASINS, ROADS, MUST BE CONSTRUCTED IN ACCORDANCE WITH HOWARD COUNTY CONSTRUCTION CODE AND STANDARD SPECIFICATIONS.

- UTILITY NOTES:**
- All Utilities To Be Built Under Howard County Specifications Or Approved Equal And By A Qualified Utility Contractor.
 - Proposed Water Main To Have A Minimum Of 4' Cover From Finished Grade. Water Main Shall Have A Minimum Of 0.5' Clearance With All Storm Drain And 1.0' Minimum Of Clearance With All Sewers
 - Building Permits Must Be Obtained By Contractor Prior To Beginning Of Construction.
 - Water & Sewer Services To Be Installed Within 50' Of Building This Contract.
 - Contractor To Be Responsible For Protection Of Any Proposed Building, or Existing At The Time Utilities Are Installed By Sheeting & Shoring Or Other Suitable Means.
 - Contractor To Verify Location Of The Tile Drains And Condemnation Lines - If Any - And Tie Them Into Suitable Outfall.
 - Contractor To Verify The Location Of Existing Main Before Laying Any Pipe.

APPROVED HOWARD CO. OFFICE OF PLANNING & ZONING
[Signature] 1-6-78
 PLANNING DIRECTOR DATE

APPROVED FOR PUBLIC WATER, PUBLIC SEWERAGE, STORM DRAINAGE SYSTEMS AND ROADS
 HOWARD CO. DEPT. OF PUBLIC WORKS
[Signature] 1-6-78
 CHIEF DIVISION OF LAND DEVELOPMENT DATE

APPROVED FOR PUBLIC WATER AND PUBLIC SEWERAGE SYSTEM HOWARD COUNTY HEALTH DEPARTMENT
[Signature] 11-22-77
 DIRECTOR DATE

APPROVED FOR PUBLIC WATER AND PUBLIC SEWERAGE SYSTEM HOWARD COUNTY HEALTH DEPARTMENT
[Signature] 12-21-77
 CHIEF, BUREAU OF HIGHWAYS DATE

APPROVED FOR PUBLIC WATER AND PUBLIC SEWERAGE SYSTEM HOWARD COUNTY HEALTH DEPARTMENT
[Signature] 1-4-78
 COUNTY HEALTH OFFICER DATE

Reviewed for Howard S.O.D.
 Name
 And meets Technical Requirements.

[Signature] 12/13/77
 Signature Date

U.S. Soil Conservation Service

7-21-77
 [Initials] Ex. Diversion
 Dike in Plan
 [Initials] Revised Sitework
 [Initials] Revised Elevation
 Ramp
 [Initials] Revised Grading
 [Initials] Use Car Stops
 [Initials] Revised Paving Section
 [Initials] Revised 6" W. to 8" W. & 8" W. to 6" W.
 [Initials] Revised Outlets

UNIVERSAL ENGINEERING MANAGEMENT, INC.
 10 Old Post Office Road
 Silver Spring, Maryland
 Tel. 588-0611 20910

THIS DEVELOPMENT PLAN IS APPROVED FOR SOIL EROSION AND SEDIMENT CONTROL BY THE HOWARD SOIL CONSERVATION DISTRICT.
 Approved *[Signature]* Date 12-13-77
 Howard C. D.

"I CERTIFY THAT ALL DEVELOPMENT AND/OR CONSTRUCTION WILL BE DONE ACCORDING TO THIS PLAN OF DEVELOPMENT AND PLAN FOR EROSION AND SEDIMENT CONTROL. AND I ALSO AUTHORIZE PERIODIC ON-SITE INSPECTION BY THE HOWARD SOIL CONSERVATION DISTRICT OR THEIR AUTHORIZED AGENTS, AS ARE DEEMED NECESSARY." DEVIATION FROM THIS PLAN WILL NOT BE MADE UNLESS AUTHORIZED BY THE HOWARD SOIL CONSERVATION DISTRICT.

[Signature] 12-7-77
 SIGNATURE OF DEVELOPER DATE

BAKER-WENDELL INC.
 7735 OLD GEORGETOWN RD.
 BETHESDA, MARYLAND 20014
 301-652-4400

"NIRO ATOMIZER
 OAKLAND RIDGE INDUSTRIAL PARK
 Section 2, Lot 88, Bldg. Addition &
 Alterations to Approved SDP-75-78C
 Tax Map #30 2ND Election District
 Howard County, Maryland

SITE PLAN
 SCALE 1" = 30.0' DATE APRIL 1978
 BY CHECK
 1 OF 4
 10/18/77-241

INLET SCHEDULE					
NO.	TYPE	Q	IN	OUT	TO ELEV.
EX-6	S	0.13	425.00	420.50	
EX-7	S	0.67	426.04	431.20	
EX-9	A-S	2.83	428.51	431.00	
EX-10	A-S	1.33	428.05	431.00	
EX-11	Trench	0.13	430.00	434.84	
EX-5	S	1.51	428.40	431.33	

* I-B Ex. S-Grate To Be Modified To An A-5
 ** 1'-10" Trench Drain Needs Foundation ('Heavy Duty') Or Equal.

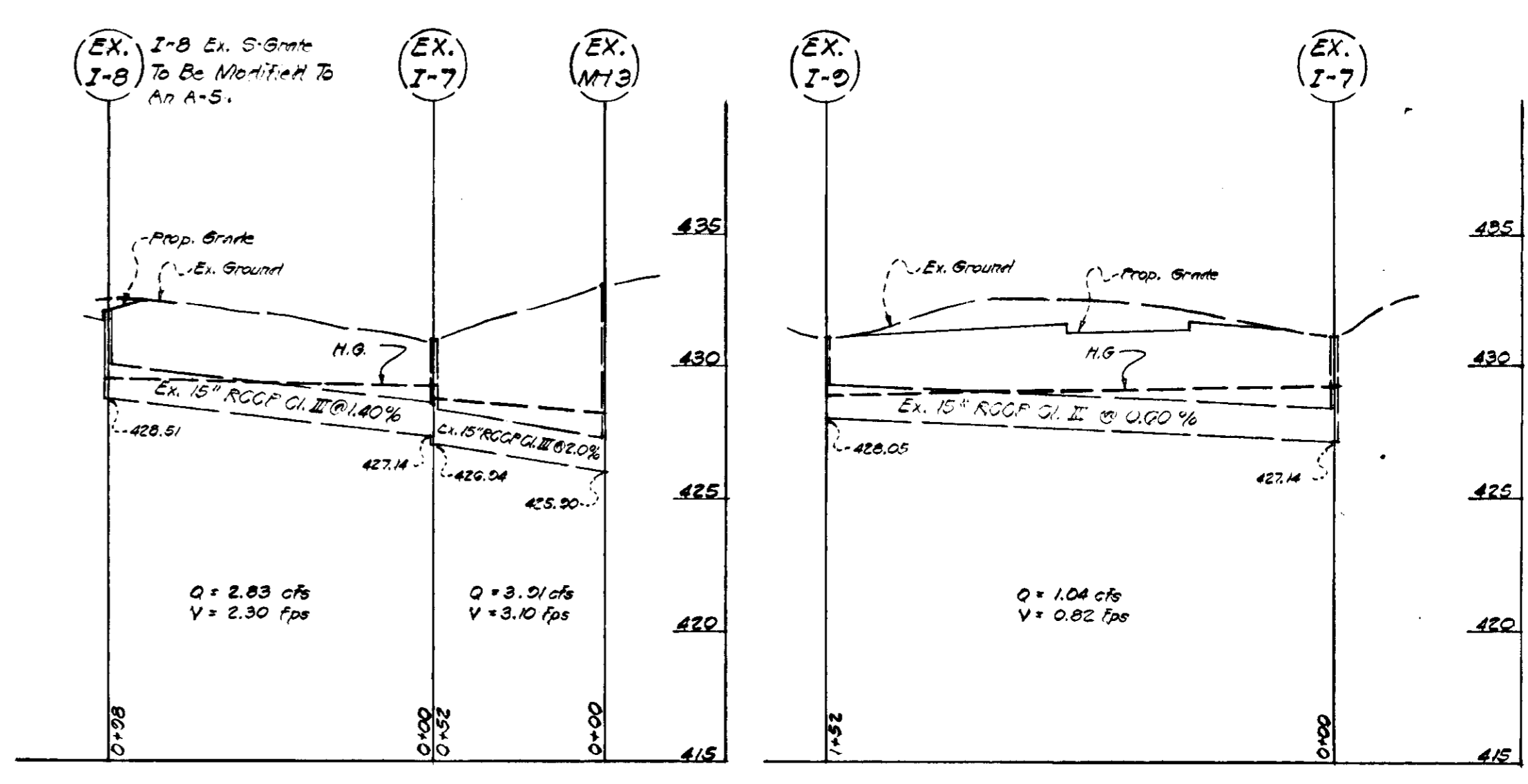

STORM DRAIN PROFILE SCALE: Hor. 1" = 40'
 Vert. 1" = 5'

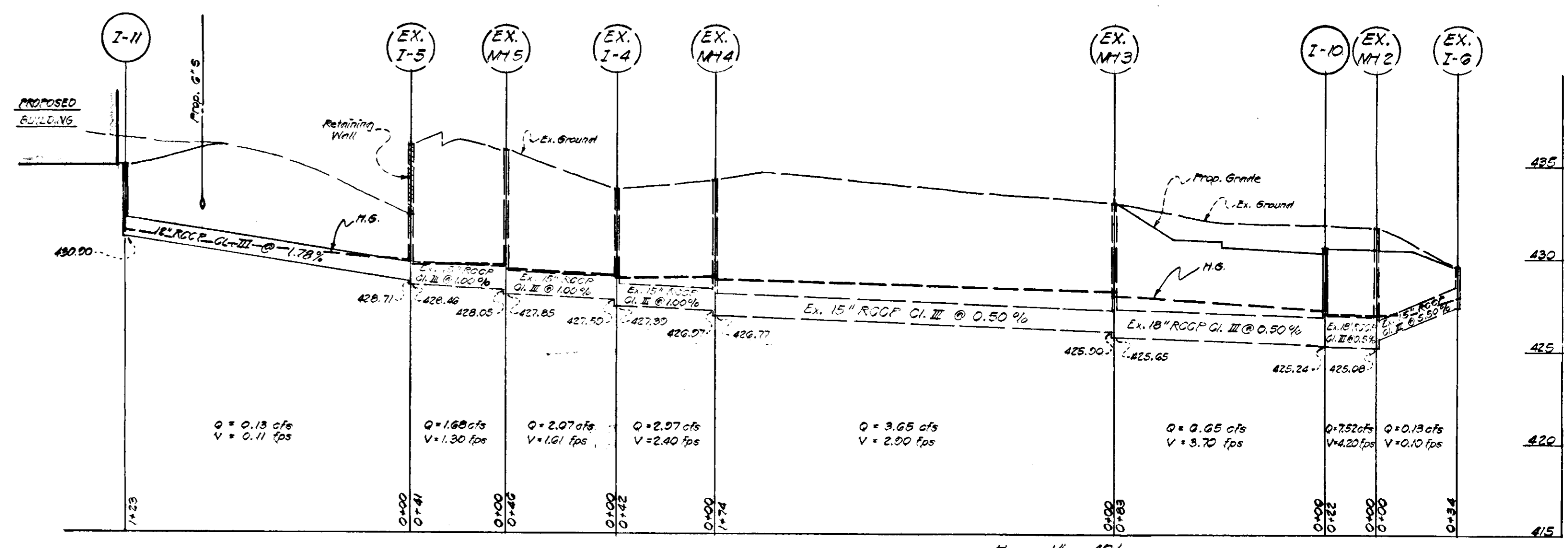

STORM DRAIN PROFILE SCALE: Hor. 1" = 40'
 Vert. 1" = 5'

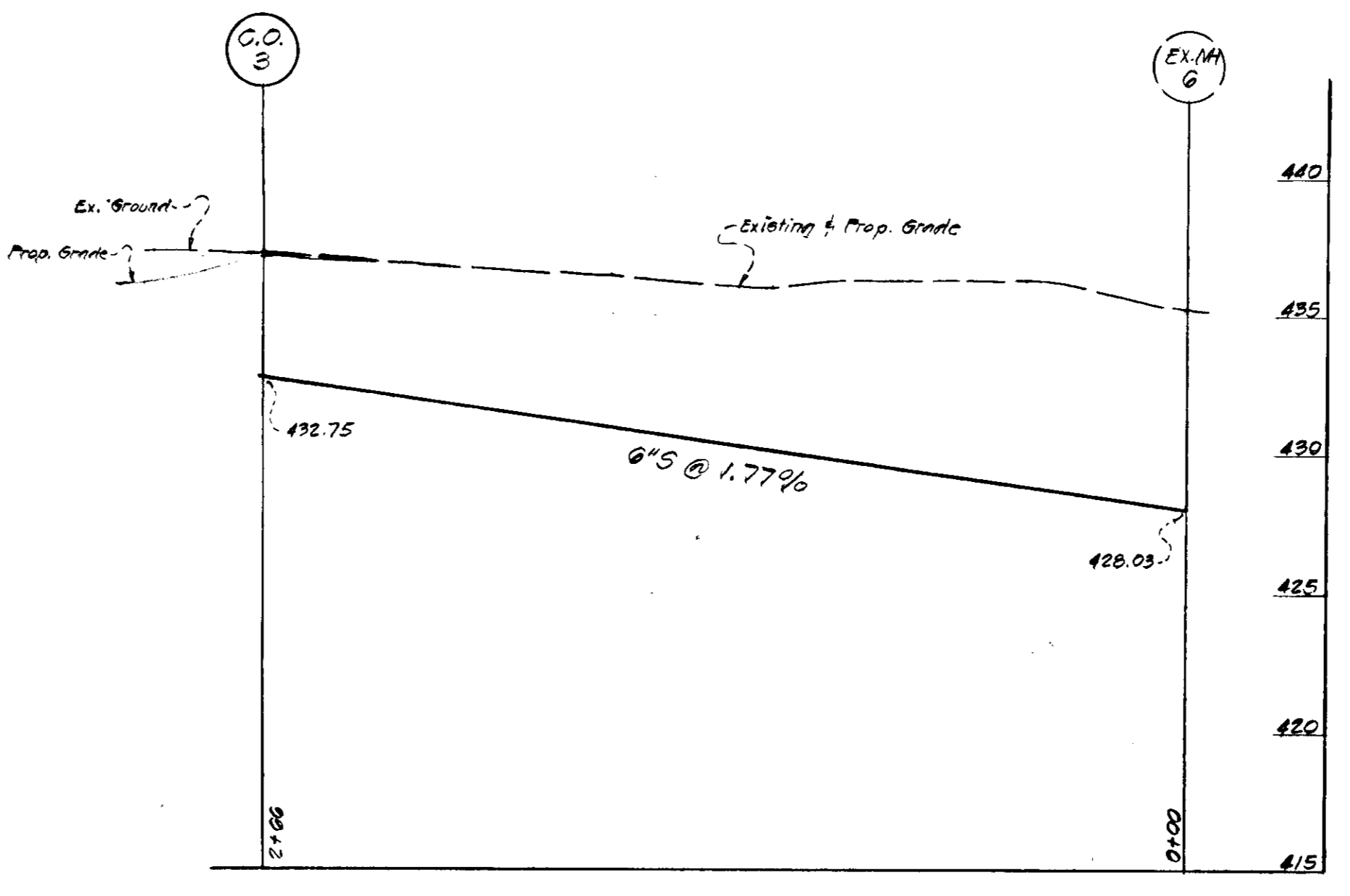

SEWER PROFILE SCALE: Hor. 1" = 40'
 Vert. 1" = 5'

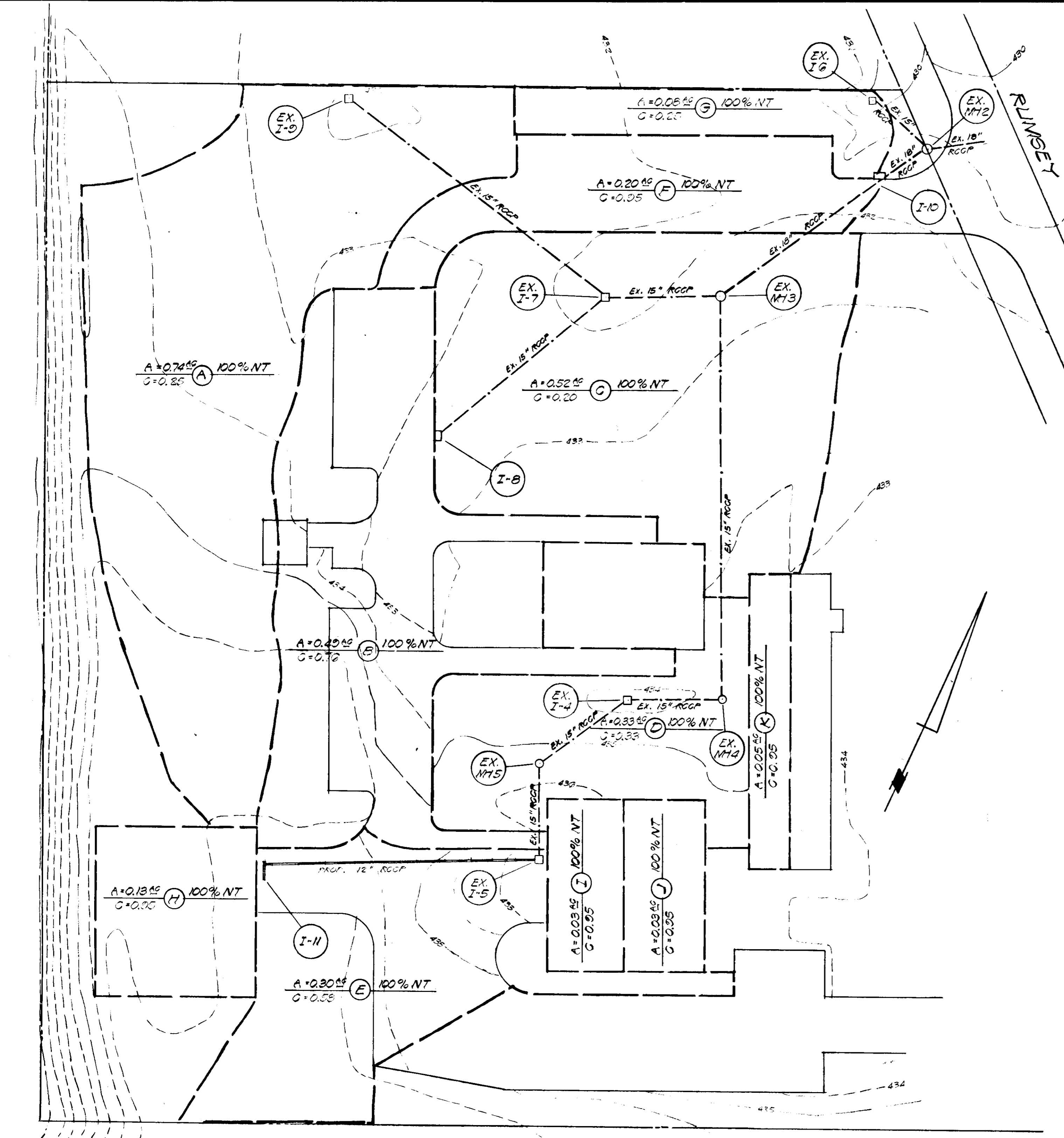

AREA MAP SCALE: 1" = 30'

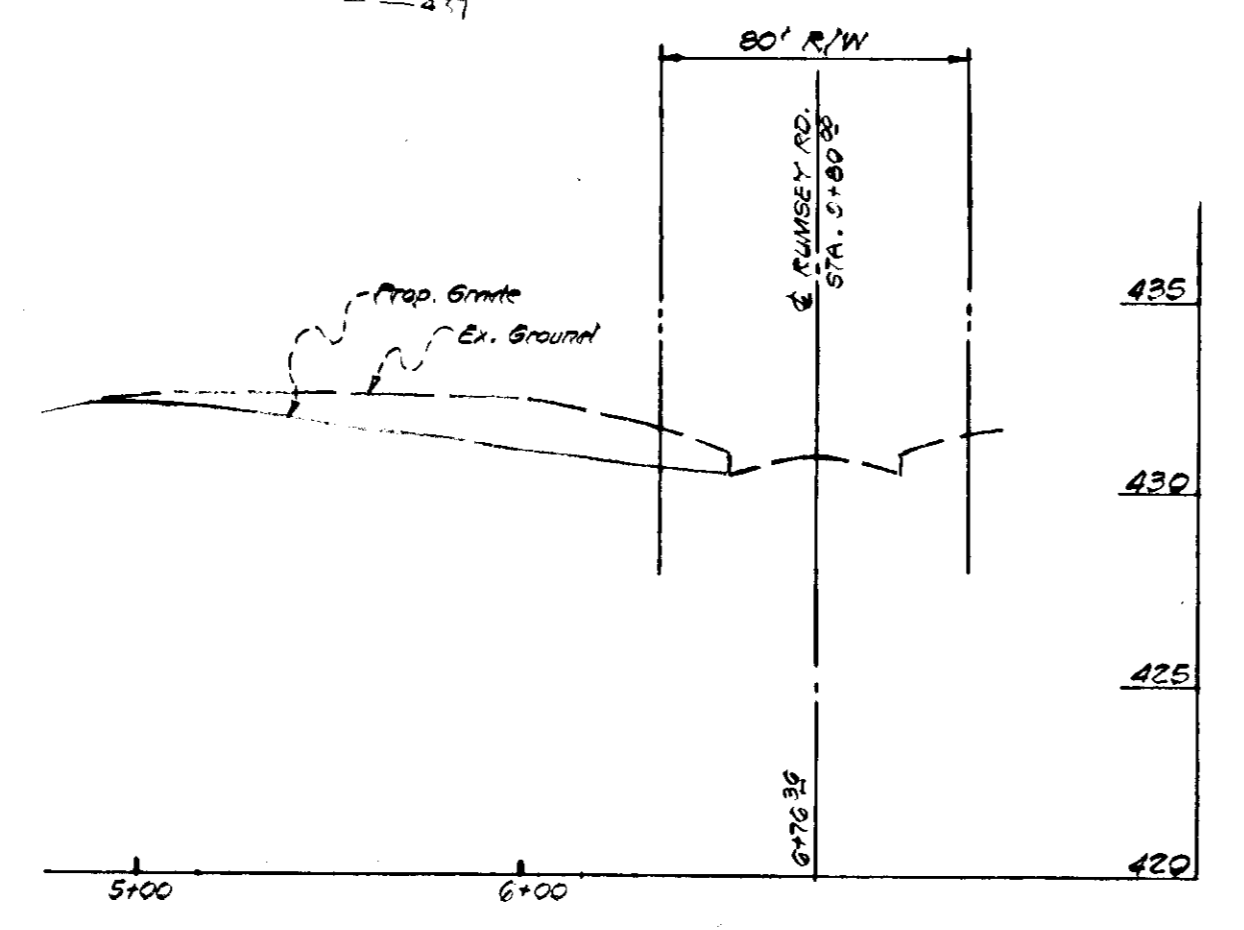

PRIVATE ROAD ENTRANCE PROFILE SCALE: Hor. 1" = 40'
 Vert. 1" = 5'

"I certify that all development and/or construction will be done according to this plan of development and plan for Erosion and Sediment Control, and I also authorize periodic onsite inspection by the Howard Soil Conservation District or their authorized agents, as are deemed necessary.
 Deviation from this plan will not be made unless authorized by the Howard Soil Conservation District.
 Signature of Developer: K.S. [Signature] Date: 12-7-77

Reviewed for HOWARD S.C.D. Name
 And meets Technical Requirements.
 Signature: C. Wayne Ray Date: 12/13/77
 U.S. Soil Conservation Service
 Approved Howard County Office of Planning and Zoning
 Signature: [Signature] Date: 1-6-78
 Planning Director
 Chief Division of Land Development
 Approved for Public Water, Public Sewerage, Storm Drainage Systems and Roads
 Howard County Department of Public Works.
 Signature: [Signature] Date: 1-11-77
 Director
 Chief, Bureau of Highway
 Approved for Public Water and Public Sewerage System
 Howard County Health Department.
 Signature: [Signature] Date: 1-4-78
 County Health Office

APPROVED
 HOWARD COUNTY
 6-8-77
 "NIRO ATOMIZER"
 OAKLAND RIDGE INDUSTRIAL PARK
 Section 2, Lot 88, Bldg. Addition &
 Alterations to Approved SDP-75-78C
 Tax Map # 30 2ND Election District
 HOWARD COUNTY, MARYLAND

Parcel 302 Tax Map 30
 UNIVERSAL ENGINEERING
 MANAGEMENT, INC.
 10 Old Post Office Road
 Silver Spring, Maryland
 Tel. 888-0811 20010

DRAINAGE AREA MAP &
 STORM DRAIN & SEWER
 PROFILES
 SCALE: 1" = 40' DATE: 12-7-77
 2 OF 4
 JOB# 77-84

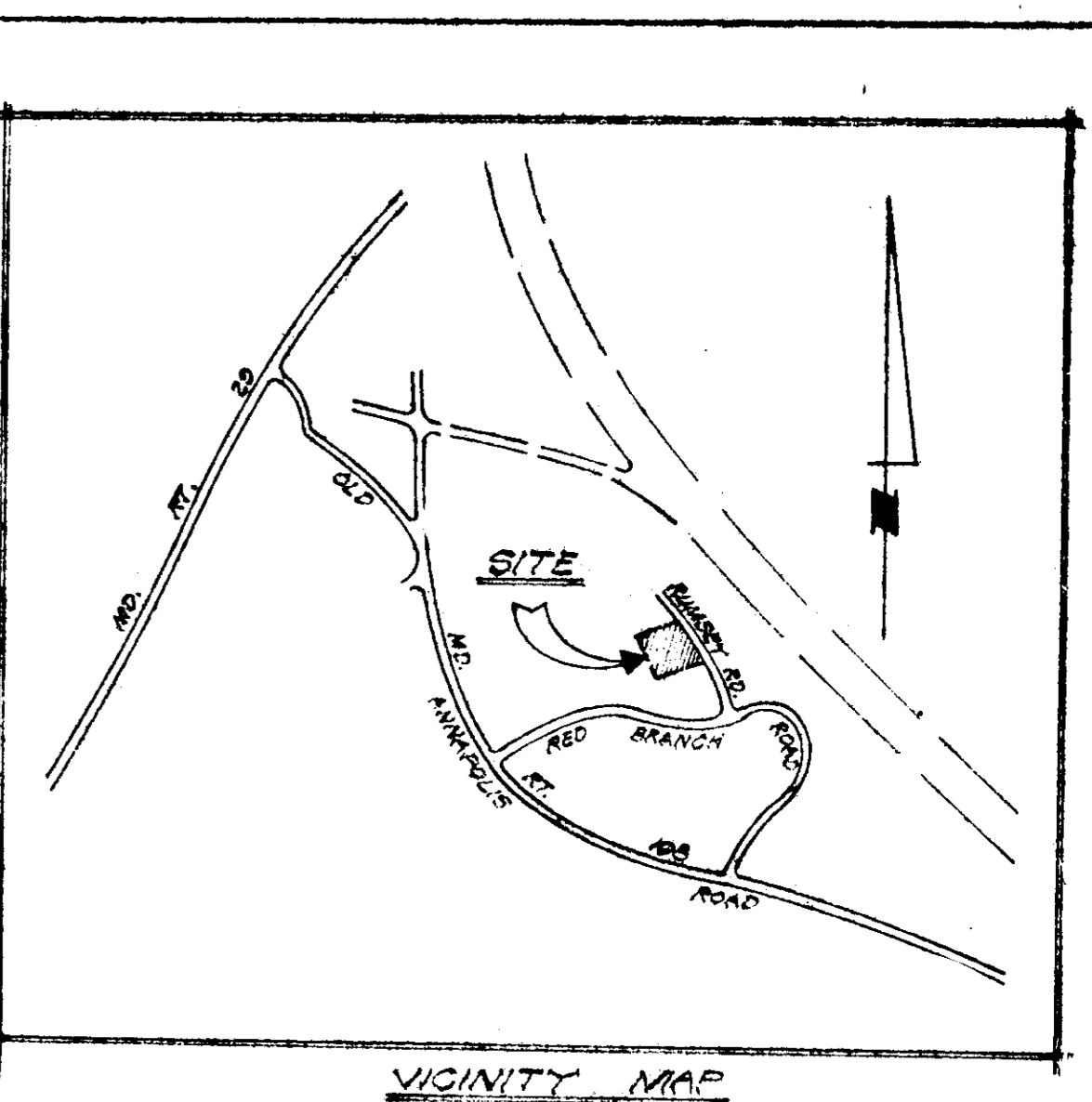
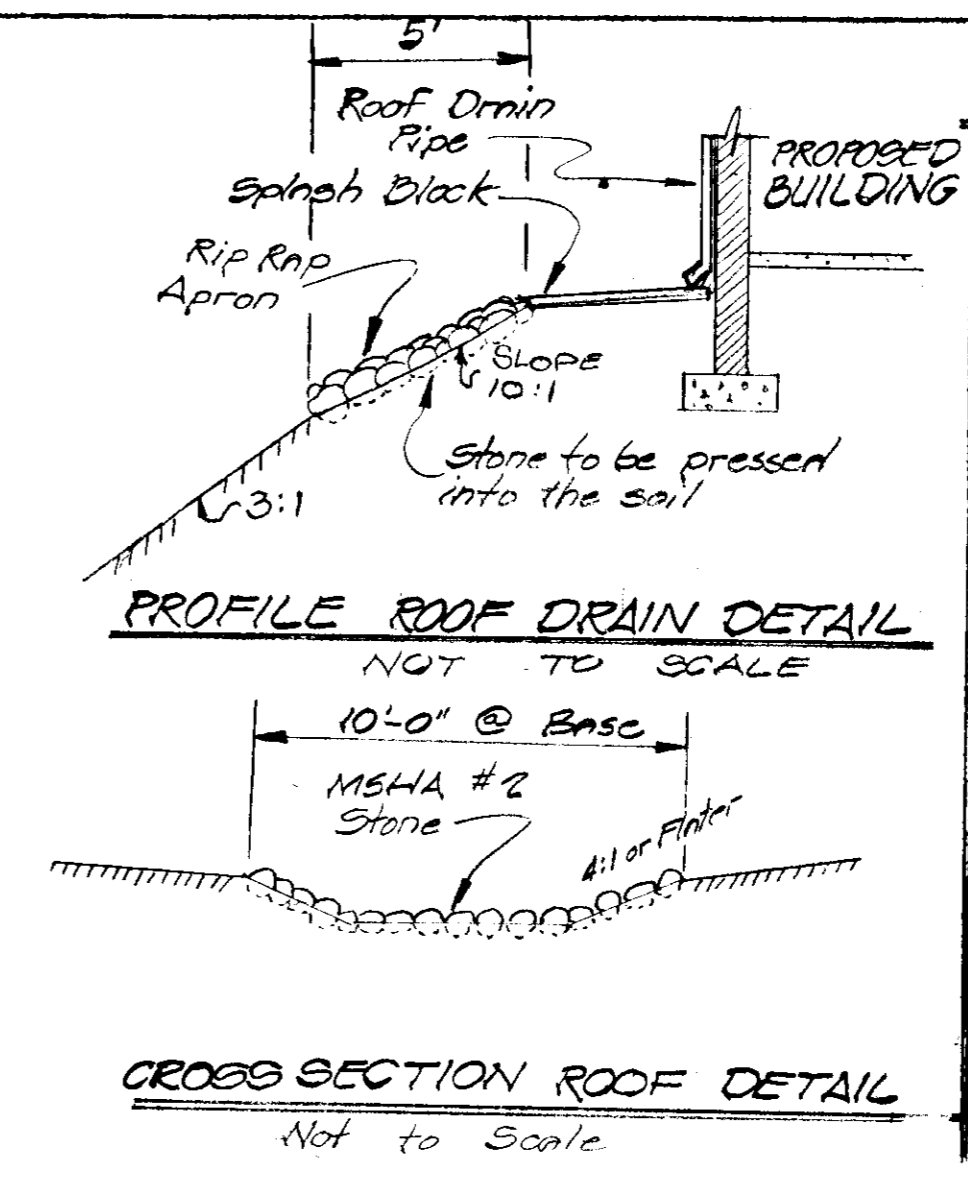
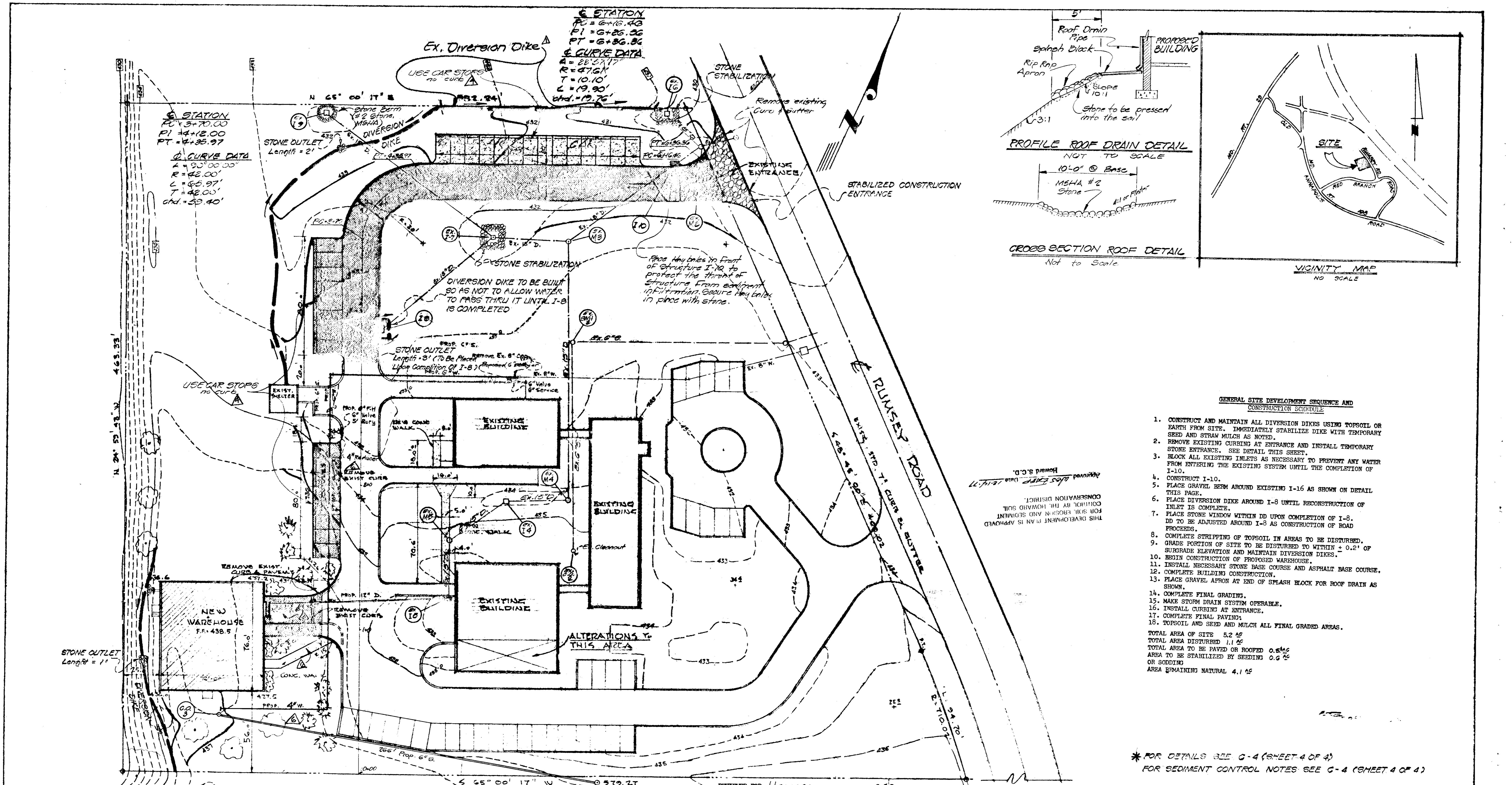

- GENERAL SITE DEVELOPMENT SEQUENCE AND CONSTRUCTION SCHEDULE**
1. CONSTRUCT AND MAINTAIN ALL DIVERSION DIKES USING TOPSOIL OR EARTH FROM SITE. IMMEDIATELY STABILIZE DIKE WITH TEMPORARY SEED AND STRAW MULCH AS NOTED.
 2. REMOVE EXISTING CURBING AT ENTRANCE AND INSTALL TEMPORARY STONE ENTRANCE. SEE DETAIL THIS SHEET.
 3. BLOCK ALL EXISTING INLETS AS NECESSARY TO PREVENT ANY WATER FROM ENTERING THE EXISTING SYSTEM UNTIL THE COMPLETION OF I-10.
 4. CONSTRUCT I-10.
 5. PLACE GRAVEL BEHM AROUND EXISTING I-16 AS SHOWN ON DETAIL THIS PAGE.
 6. PLACE DIVERSION DIKE AROUND I-8 UNTIL RECONSTRUCTION OF INLET IS COMPLETE.
 7. PLACE STONE WINDOW WITHIN DD UPON COMPLETION OF I-8. DD TO BE ADJUSTED AROUND I-8 AS CONSTRUCTION OF ROAD PROCEEDS.
 8. COMPLETE STRIPPING OF TOPSOIL IN AREAS TO BE DISTURBED.
 9. GRADE PORTION OF SITE TO BE DISTURBED TO WITHIN $\pm 0.2'$ OF SUBGRADE ELEVATION AND MAINTAIN DIVERSION DIKES.
 10. BEGIN CONSTRUCTION OF PROPOSED WAREHOUSE.
 11. INSTALL NECESSARY STONE BASE COURSE AND ASPHALT BASE COURSE.
 12. COMPLETE BUILDING CONSTRUCTION.
 13. PLACE GRAVEL APRON AT END OF SPLASH BLOCK FOR ROOF DRAIN AS SHOWN.
 14. COMPLETE FINAL GRADING.
 15. MAKE STORM DRAIN SYSTEM OPERABLE.
 16. INSTALL CURBING AT ENTRANCE.
 17. COMPLETE FINAL PAVING.
 18. TOPSOIL AND SEED AND MULCH ALL FINAL GRADED AREAS.
- TOTAL AREA OF SITE 5.2 AC
 TOTAL AREA DISTURBED 1.1 AC
 TOTAL AREA TO BE PAVED OR ROOFED 0.8 AC
 AREA TO BE STABILIZED BY SEEDING 0.6 AC
 OR SODDING
 AREA REMAINING NATURAL 4.1 AC

I hereby certify that this plan of development and the plan for control of Silt and Erosion meets the requirements, Standards and Specifications of the Soil Conservation District.

4/28/77
 Bernard J. Boveleky P.E. 38857
 SIGNATURE OF DEVELOPER DATE

12-7-77
 SIGNATURE OF DEVELOPER DATE

- UTILITY NOTES:**
1. All Utilities To Be Built Under Howard County Specifications Or Approved Equal And By A Qualified Utility Contractor.
 2. Proposed Water Main To Have A Minimum Of 4" Cover From Finished Grade. Water Main Shall Have A Minimum Of 0.5' Clearance With All Storm Drain And 10' Minimum Of Clearance With All Sewers.
 3. Building Permits Must Be Obtained By Contractor Prior To Beginning Of Construction.
 4. Water & Sewer Services To Be Installed Within 50' Of Building This Contract.
 5. Contractor To Be Responsible For Protection Of Any Proposed Building, If Existing At The Time Utilities Are Installed By Streeing & Shoring Or Other Suitable Means.
 6. Contractor To Verify Location Of The Tile Drains And Comensation Lines, If Any, And Tie Them Into Suitable Outfall.
 7. Contractor To Verify The Location Of Existing Main Before Laying Any Pipe.

REVIEWED FOR HOWARD COUNTY AND MEETS TECHNICAL REQUIREMENTS.

Approved for Public Water and Public Sewerage System Howard County Health Department.

APPROVED HOWARD COUNTY OFFICE OF PLANNING AND ZONING

APPROVED FOR PUBLIC WATER, PUBLIC SEWERAGE, STORM DRAINAGE SYSTEMS AND ROADS HOWARD COUNTY DEPARTMENT OF PUBLIC WORKS

* FOR DETAILS SEE C-4 (SHEET 4 OF 4)
 FOR SEDIMENT CONTROL NOTES SEE C-4 (SHEET 4 OF 4)

APPROVED
 HOWARD COUNTY
 DATE 6-8-77

NIRO ATOMIZER

OAKLAND RIDGE INDUSTRIAL PARK
 Section 2, Lot 88, Bldg., Addition & Alterations to Approved BDP-75-78C.
 Tax Map #30 2000 Election District
 Howard County, Maryland

BAKER-WENDELL, INC.
 7735 OLD GEORGETOWN RD.
 BETHESDA, MARYLAND 28014
 301-652-4400

UNIVERSAL ENGINEERING MANAGEMENT, INC.
 10 Old Post Office Road
 Silver Spring, Maryland
 Tel. 508-0811 20010

Parcel 302 Tax Map 30

SEDIMENT CONTROL PLAN
 SCALE 1" = 30.0' DATE 12-10-77
 BY CHECK

C-3
 3 OF 4
 HOW-77-1-CAI

SDP-77-84c

SETBACK CONTROL NOTES

- 1. ALL EROSION AND SEDIMENT CONTROL MEASURES ARE TO BE CONSTRUCTED AND MAINTAINED IN ACCORDANCE WITH APPLICABLE PUBLISHED "STANDARDS AND SPECIFICATIONS FOR SOIL EROSION AND SEDIMENT CONTROL IN DEVELOPING AREAS."

SEEDING, SODDING AND/OR MULCHING NOTES

- 1. ALL DISTURBED AREAS SHALL BE SEED, SODDED AND/OR MULCHED IN ACCORDANCE WITH "STANDARDS AND SPECIFICATIONS FOR SOIL EROSION AND SEDIMENT CONTROL IN DEVELOPING AREAS" AS DISTRIBUTED BY HOWARD COUNTY SOIL CONSERVATION DISTRICT.

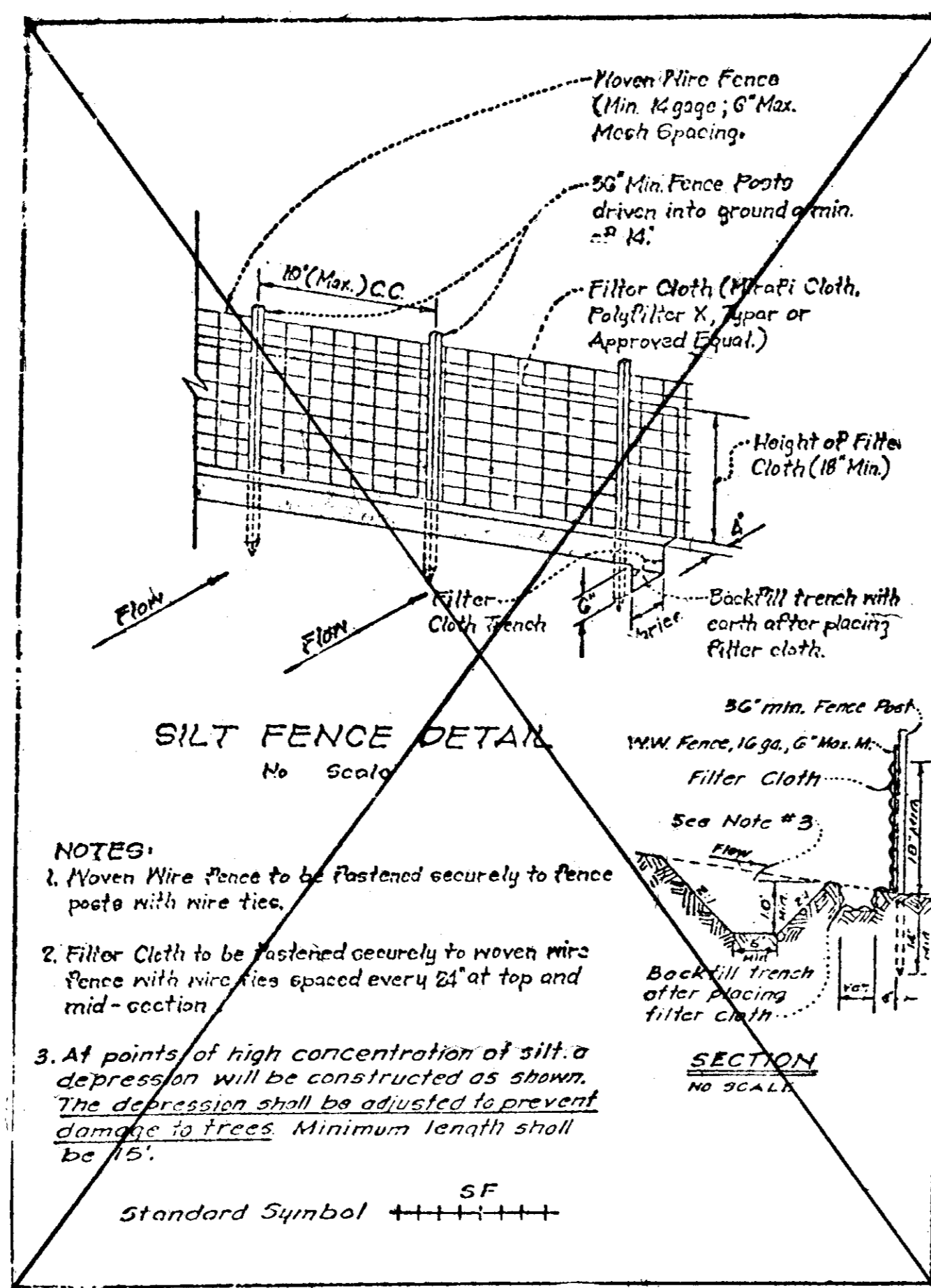

- NOTES: 1. Moven Wire Fence to be fastened securely to fence posts with wire ties. 2. Filler Cloth to be fastened securely to moven wire fence with wire ties spaced every 2' at top and mid-section. 3. At points of high concentration of silt a depression will be constructed as shown. The depression shall be adjusted to prevent damage to trees. Minimum length shall be 15'.

Standard Symbol SF

USDA-SCS-Md

July 1975

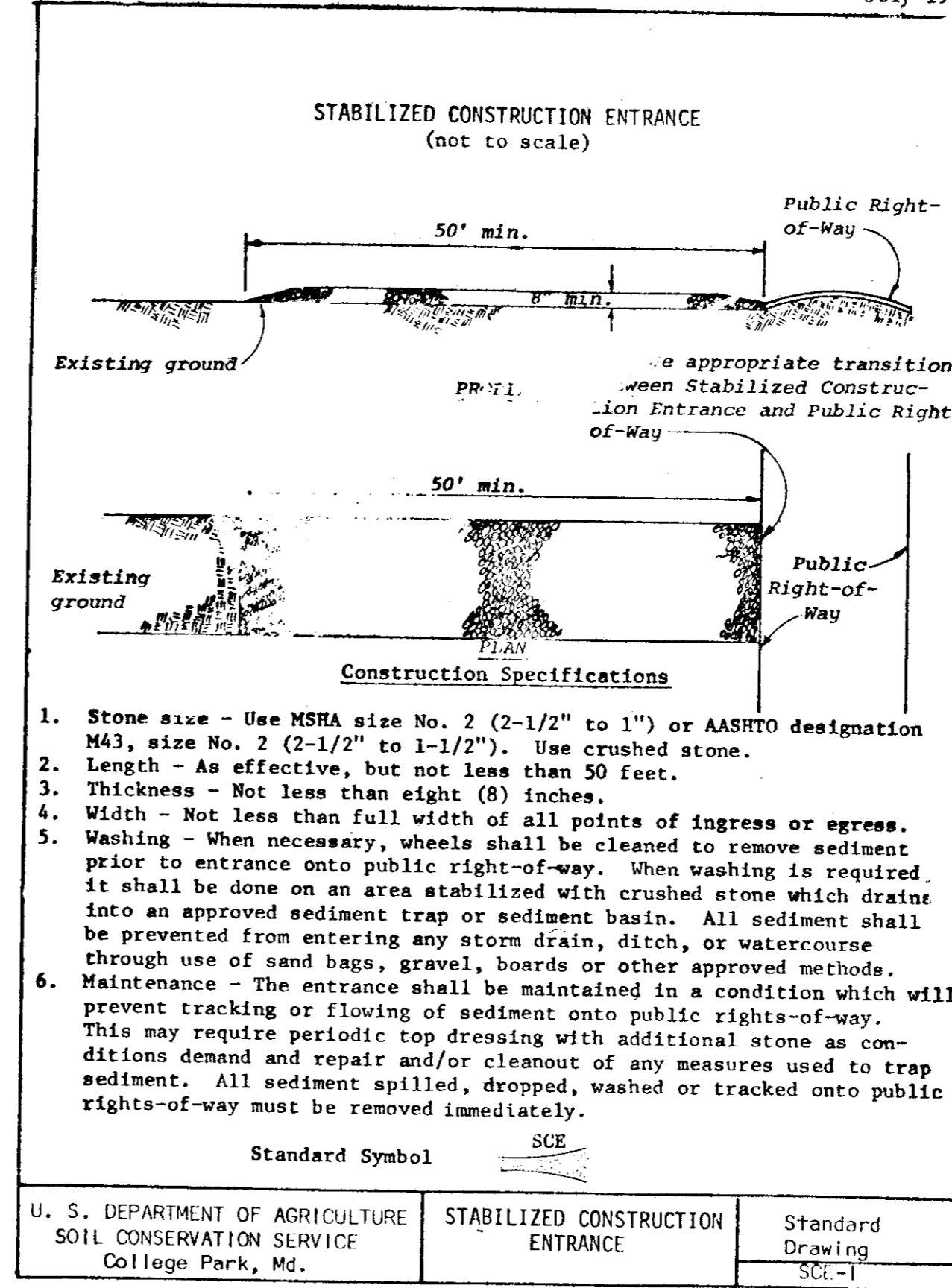

Table with 3 columns: U. S. DEPARTMENT OF AGRICULTURE SOIL CONSERVATION SERVICE, STABILIZED CONSTRUCTION ENTRANCE, Standard Drawing SCE-1

USDA-SCS-Md

July 1975

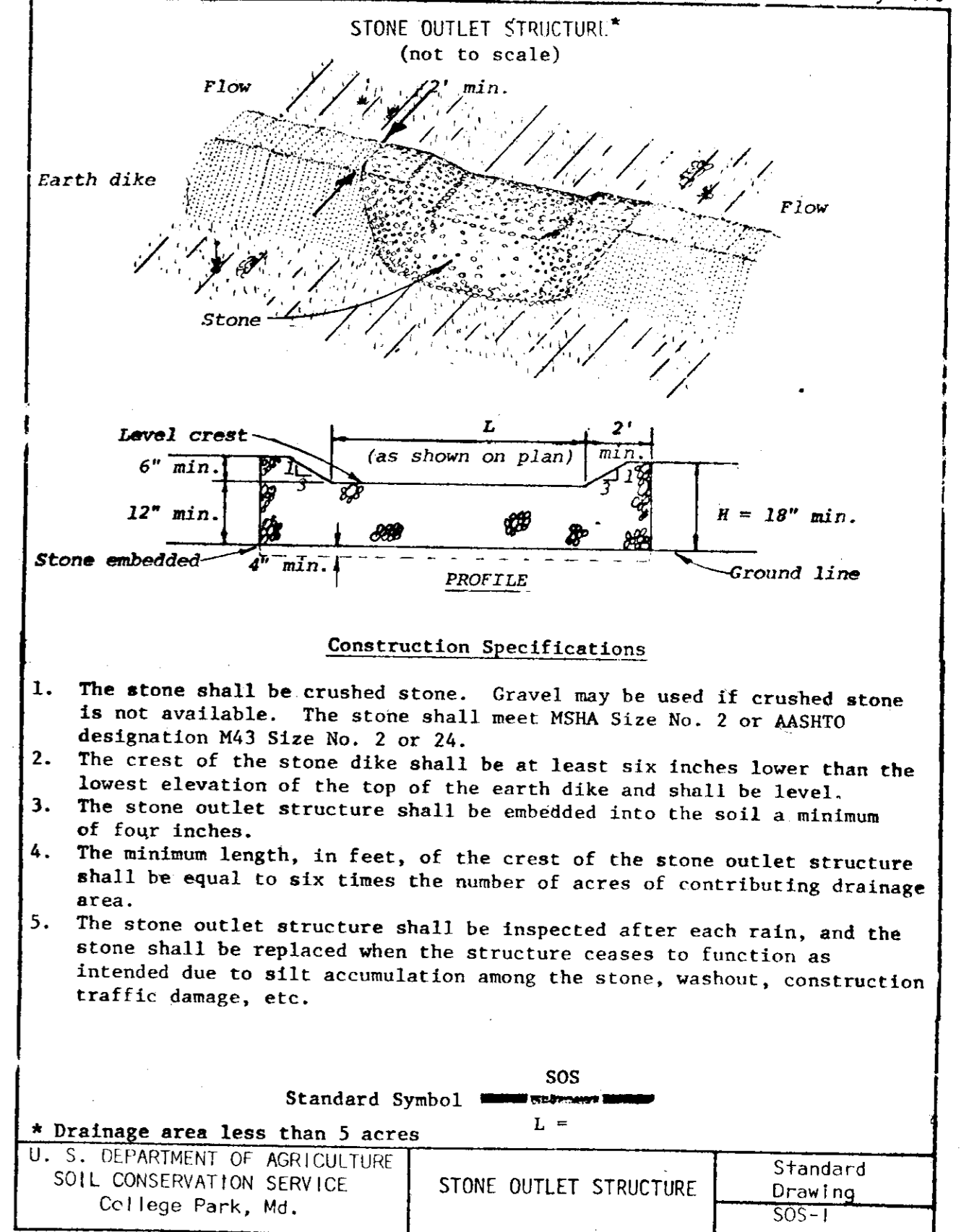

Table with 3 columns: U. S. DEPARTMENT OF AGRICULTURE SOIL CONSERVATION SERVICE, STONE OUTLET STRUCTURE, Standard Drawing SOS-1

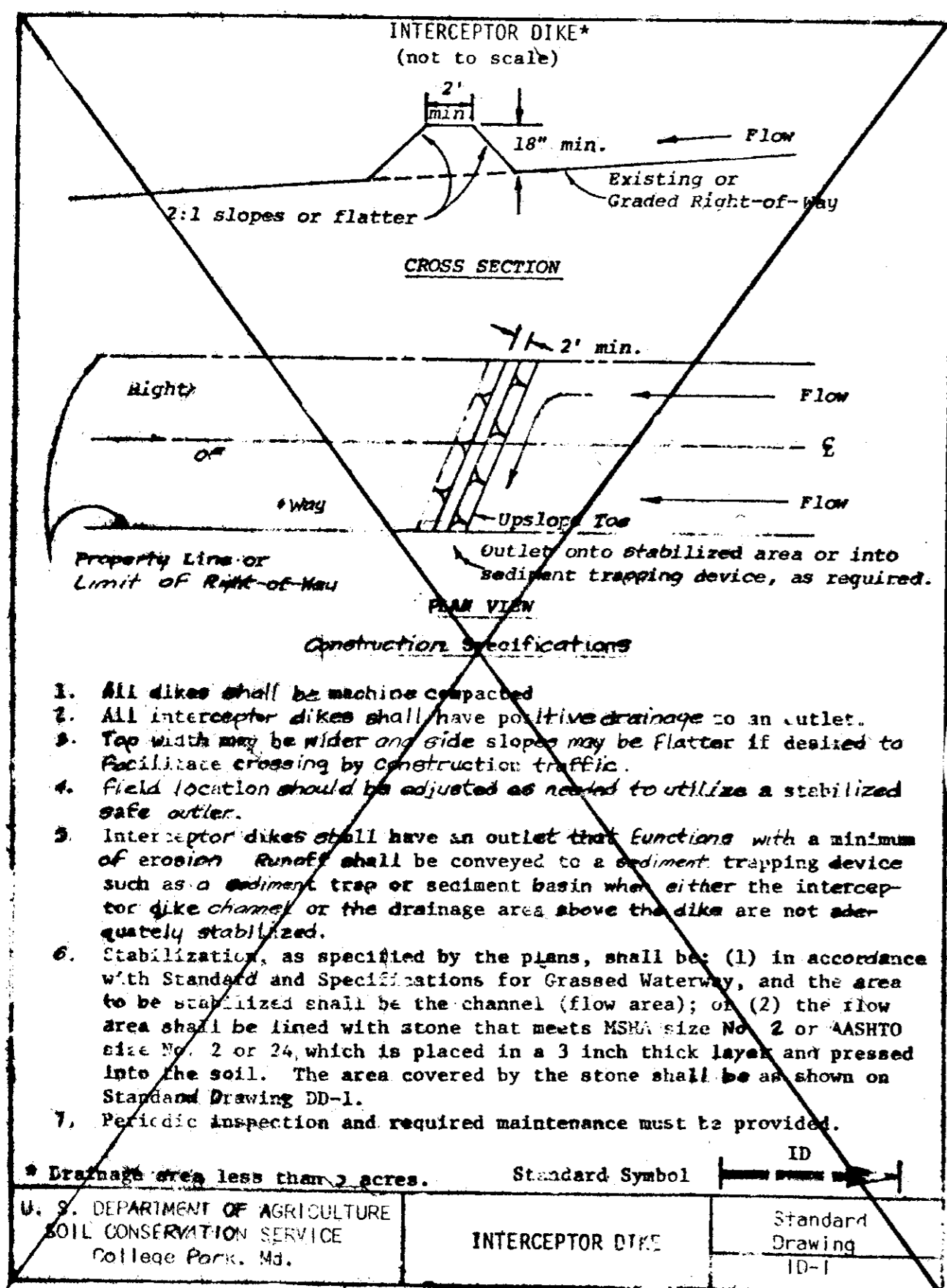

Table with 3 columns: U. S. DEPARTMENT OF AGRICULTURE SOIL CONSERVATION SERVICE, INTERCEPTOR DIKE, Standard Drawing ID-1

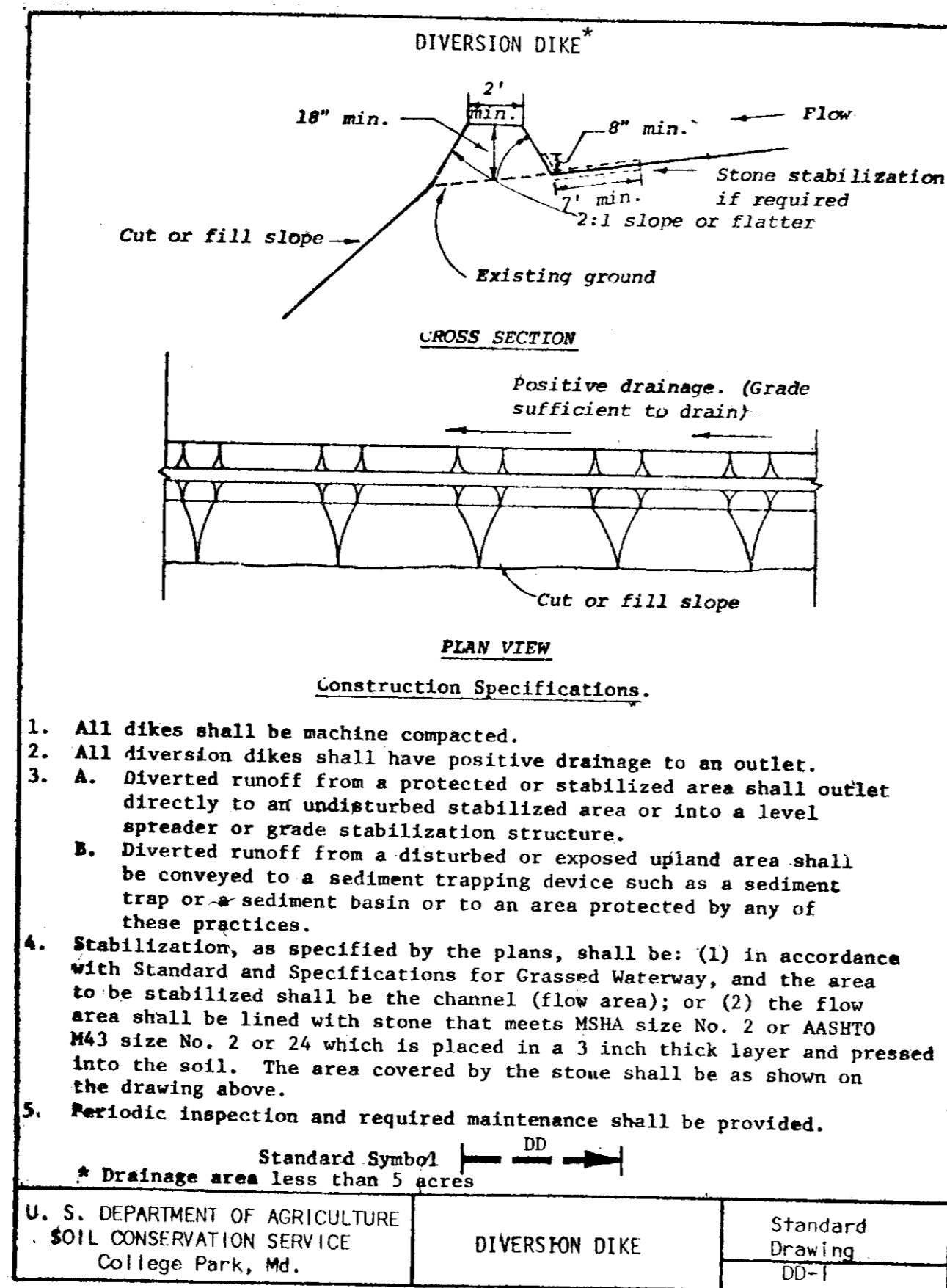

Table with 3 columns: U. S. DEPARTMENT OF AGRICULTURE SOIL CONSERVATION SERVICE, DIVERSION DIKE, Standard Drawing DD-1

SEEDING:

- 1. USE KENTUCKY 31 TALL FESCUE AT THE RATE OF 60 LBS. PER ACRE. 2. SEEDING CAN BE APPLIED FROM FEB. 2 TO APRIL 30 OR MAY 15 TO AUG. 31. 3. SEED CAN BE APPLIED BY HAND OR MECHANICALLY WITH FERTILIZER INCLUDED. 4. SOIL TO BE FIRM AND MOIST. 5. MAXIMUM SEEDING DEPTH SHALL BE 1".

MULCHING:

- 1. USE UNROTTED SMALL GRAIN STRAW. 2. APPLY AT THE RATE OF 1 1/2 TO 2 TONS PER ACRE OR 70 TO 90 POUNDS PER 1000 SQUARE FEET. 3. STRAW IS TO BE FREE OF ALL PROHIBITED NOXIOUS WEEDS. 4. SPREAD UNIFORMLY BY HAND OR MECHANICALLY.

"I CERTIFY THAT ALL DEVELOPMENT AND/OR CONSTRUCTION WILL BE DONE ACCORDING TO THIS PLAN OF DEVELOPMENT AND PLAN FOR EROSION AND SEDIMENT CONTROL, AND I ALSO AUTHORIZE PERIODIC ON-SITE INSPECTION BY THE HOWARD COUNTY SOIL CONSERVATION DISTRICT OR THEIR APPOINTED AGENTS, AS ARE DEMAND NECESSARY."

Signature: Ryan S. Chidley, 12-9-77, SIGNATURE OF DEVELOPER, DATE

I HEREBY CERTIFY THAT THIS PLAN OF DEVELOPMENT AND THE PLAN FOR CONTROL OF SILT AND EROSION MEETS THE REQUIREMENTS, STANDARDS AND SPECIFICATIONS OF THE SOIL CONSERVATION DISTRICT. Signature: Bernard J. Bovelesky, P.E. 8897, DATE: 4/28/77

THIS DEVELOPMENT PLAN IS APPROVED FOR SOIL EROSION AND SEDIMENT CONTROL BY THE HOWARD COUNTY SOIL CONSERVATION DISTRICT. Approved: [Signature], Date: 12-18-77

SODDING

- 1. CLASS OF TURFGRASS SOD SHALL BE MARYLAND OR VIRGINIA STATE CERTIFIED, OR MARYLAND OR VIRGINIA STATE APPROVED SOD. 2. SOD SHALL BE MACHINE CUT AT A UNIFORM SOIL THICKNESS OR 3/4 INCH, PLUS OR MINUS 1/8 INCH, AT THE TIME OF CUTTING. MEASUREMENT FOR THICKNESS SHALL EXCLUDE TOP GROWTH AND THATCH. 3. STANDARD SIZE SECTIONS OF SOD SHALL BE STRONG ENOUGH TO SUPPORT THEIR OWN WEIGHT AND RETAIN THEIR SIZE AND SHAPE WHEN SUSPENDED VERTICALLY FROM A FIRM GRASP ON THE UPPER 10% OF THE SECTION. 4. INDIVIDUAL PIECES OF SOD SHALL BE CUT TO THE SUPPLIER'S WIDTH AND LENGTH. MAXIMUM ALLOWABLE DEVIATION FROM STANDARD WIDTHS AND LENGTHS SHALL BE 5%. BROKEN EDGES AND TORN OR UNEVEN ENDS WILL NOT BE ACCEPTABLE.

APPROVED FOR PUBLIC WATER, PUBLIC SEWERAGE, STORM DRAINAGE SYSTEMS AND ROADS HOWARD COUNTY DEPARTMENT OF PUBLIC WORKS

Director: [Signature], Date: 12-21-77, CHIEF, BUREAU OF HIGHWAYS, Date: 12-21-77

Approved for Public Water and Public Sewerage System: Howard County Health Department. Signature: [Signature], Date: 1-4-78, County Health Office

STONE STABILIZATION NOT TO SCALE

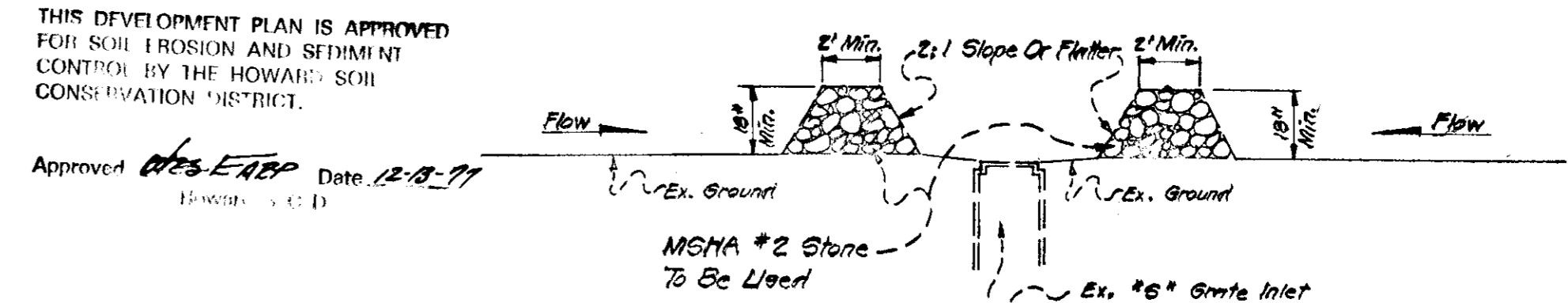

REVIEWED FOR: Howard, S.C.D. NAME, AND MEETS TECHNICAL REQUIREMENTS. Signature: [Signature], DATE: 12/13/77, U.S. SOIL CONSERVATION SERVICE

APPROVED HOWARD COUNTY OFFICE OF PLANNING AND ZONING: Signature: [Signature], DATE: 1-6-78, PLANNING DIRECTOR, Signature: [Signature], DATE: 1-16-78, CHIEF DIVISION OF LAND DEVELOPMENT

SEDIMENT CONTROL PLAN

NIRO ATOMIZER OAKLAND RIDGE INDUSTRIAL PARK Section 2, Lot 88, Etc. Alterations to Approved SDP-75-78C Tax Map #30 2nd Edition District: Howard County, Md.

UNI-VERSAL ENGINEERING MANAGEMENT, INC. 10 Old Post Office Road Silver Spring, Maryland 589-0611 OWNER: NIRO ATOMIZER, INC. 5165 Ramsey Road Columbia, Md. 21043 Tel. 301 997-8700

DESIGN BY: M.T. APPROVED BY: E.J.B. DATE: AS SHOWN APRIL 1977 DWG. BY: S.T.D. CHK. BY: [Signature] JOB NO: 77-1-241 SHEET 4 OF 4

C-4 Parcel 302 Tax Map 30

589-77-84c