

SEDIMENT CONTROL NOTES

1. THE H.S.C.D AND BUREAU OF LICENSE, INSPECTION, AND PERMITS WILL BE GIVEN 24 HOURS NOTICE PRIOR TO ANY GRADING.
2. ALL SEDIMENT CONTROL STRUCTURES SHOWN ON THIS PLAN UNLESS OTHERWISE SPECIFIED, WILL BE INSTALLED AND STABILIZED IN ACCORDANCE WITH NOTE # 8 PRIOR TO ANY OTHER GRADING OR FARTH DISTURBANCE ON THIS SITE.
3. AS SOON AS ROUGH GRADING IS COMPLETED, AREA TO BE STABILIZED WITH BASE MATERIAL.
4. ALL CUT AND FILL SLOPES WILL BE A MAXIMUM OF 3:1.
5. FOLLOWING THE STABILIZATION OF ALL AREAS, UPGRADE THE AREA OF THE SEDIMENT CONTROL. MEASURES MAY BE REMOVED AND GRADED TO THE FINAL GRADES PLANNED AND STABILIZED IMMEDIATELY.
6. ELEVATIONS MARKED WITH (X) ARE FINISHED GRADES.
7. ALL EXCESS CUT WILL BE TRUCKED TO APPROVED DISPOSAL SITE.

7. SEDIMENT CONTROL MEASURES WILL NOT BE REMOVED UNTIL APPROVAL IS OBTAINED FROM THE H.S.C.D.
8. TEMPORARY STABILIZATION:
APPLY: 2000 LBS./ACRE OR 46 LBS./SQ. FT. OF PULVERIZED DOLOMITIC LIMESTONE.
500 LBS./ACRE OR 115 LBS./1000 SQ. FT. OF 10-10-10 FERTILIZER, PLANT TO RYEGRASS @ 40 LBS./ACRE FERTILIZE WITH 10-10-10, AND MULCH WITH STRAW @ 1 1/2 TONS/ACRE.
9. PERMANENT STABILIZATION:
APPLY: 2000 LBS./ACRE OF PULVERIZED DOLOMITIC LIMESTONE
700 LBS./ACRE OF 0-20-0 SUPER PHOSPHATE,
1000 LBS./ACRE OF 10-10-10 FERTILIZER.
SEED: 85 LBS./ACRE OF KENTUCKY 31 TALL FESCUE,
40 LBS./ACRE OF KENTUCKY BLUE GRASS,
25 LBS./ACRE OF ANNUAL RYE GRASS.
NOTE: SEEDING MAY BE DONE BETWEEN MARCH 1 - MAY 1, OR AUGUST 1 - OCTOBER 1 ONLY
MULCH: 2 TONS/ACRE OF UNWEATHERED WHEATSTRAW, THE MULCH DOWN WITH 400 GAL./ACRE OF LIQUID ASPHALT.

REVIEWED FOR HOWARD SOIL CONSERVATION DISTRICT AND MEETS TECHNICAL REQUIREMENTS.

Reviewed by: C. Wayne Ray 5/5/77 DATE
US SOIL CONSERVATION SERVICE
THIS DEVELOPMENT PLAN IS APPROVED FOR SOIL EROSION AND SEDIMENT CONTROL BY THE HOWARD SOIL CONSERVATION DISTRICT

APPROVED: John A. Mullen 5-5-77 DATE
HOWARD SOIL CONSERVATION DIST.
BY THE DEVELOPER:
I CERTIFY THAT ALL DEVELOPMENT AND/OR CONSTRUCTION WILL BE ACCORDING TO THIS PLAN OF DEVELOPMENT AND PLAN FOR EROSION AND SEDIMENT CONTROL, AND I ALSO AUTHORIZE PERIODIC ON SITE INSPECTION BY THE HOWARD SOIL CONSERVATION DIST. OR THEIR AUTHORIZED AGENTS, AS ARE DEEMED NECESSARY. DEVIATION FROM THIS PLAN WILL NOT BE MADE UNLESS AUTHORIZED BY THE HOWARD SOIL CONSERVATION DISTRICT.

DEVELOPER: John L. Schmidt 7/19/76 DATE
BY THE ENGINEER:
I CERTIFY THAT THIS PLAN FOR EROSION AND SEDIMENT CONTROL REPRESENTS A PRACTICAL AND WORKABLE PLAN BASED ON MY PERSONAL KNOWLEDGE OF THE SITE CONDITIONS AND THAT IT WAS PREPARED IN ACCORDANCE WITH THE REQUIREMENTS OF THE SOIL CONSERVATION DISTRICT.

- CONSTRUCTION SEQUENCE**
1. CONSTRUCT ALL TEMPORARY SEDIMENT CONTROL DEVICES (TEMP STONE CONSTRUCTION ENTRANCE, STRAW BALE BERM, ETC.)
 2. BEGIN ROAD GRADING TO SUBGRADE AND BEGIN CURB INSTALLATION.
 3. CONSTRUCT WATER RETAINING WALL.
 4. COMPLETE ROAD GRADING AND PAVE TO FINISH GRADE.
 5. REMOVE TEMPORARY SED. CONTROL DEVICES, AND STABILIZE AREA IF DISTURBED.

APPROVED: FOR PRIVATE WATER AND PRIVATE SEWERAGE SYSTEMS
HOWARD COUNTY HEALTH DEPARTMENT
Joseph B. Adams 5/20/77 DATE
COUNTY HEALTH OFFICER
APPROVED: HOWARD COUNTY OFFICE OF PLANNING AND ZONING
James A. Harms 5-31-77 DATE
PLANNING DIRECTOR
Phillip M. Muehlen 5-27-77 DATE
CHIEF, DIV. OF LAND DEVELOPMENT
APPROVED: FOR STORM DRAINAGE SYSTEMS AND ROADS.
Ph. Treadwell 5-21-77 DATE
DIRECTOR, PUBLIC WORKS
Gravette N. McLeod 5/25/77 DATE
CHIEF, BUREAU OF HIGHWAYS

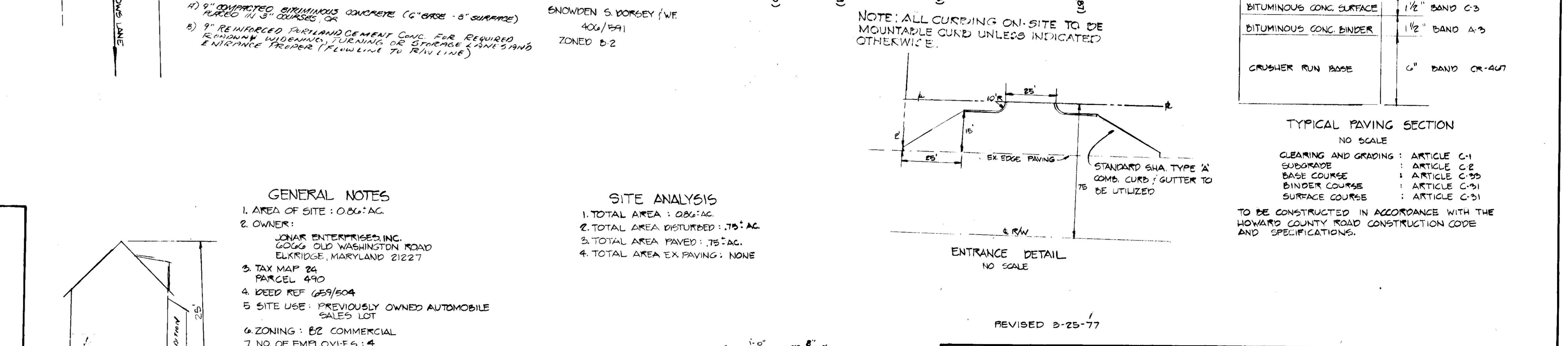
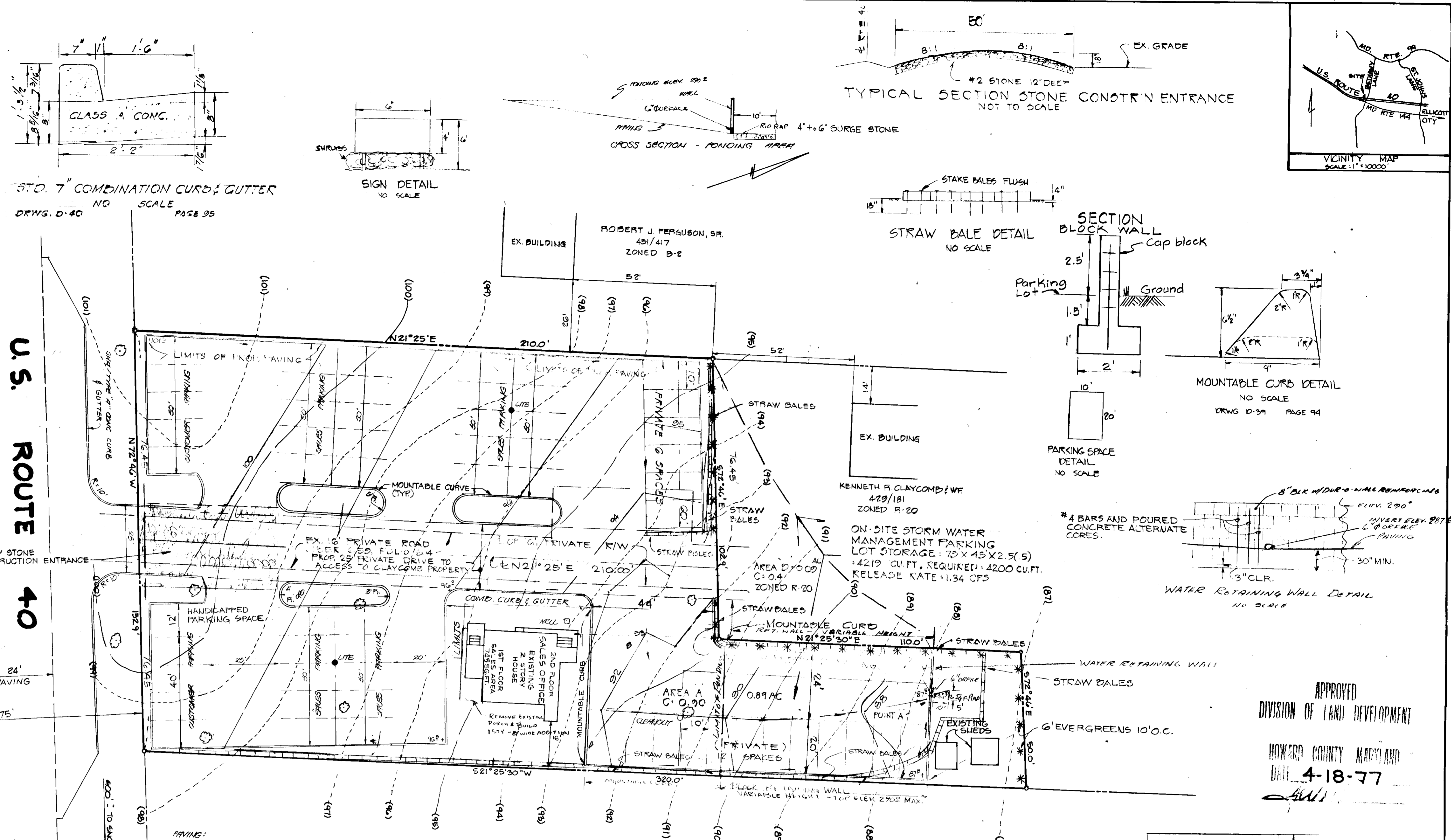

APPROVED: FOR PRIVATE WATER AND PRIVATE SEWERAGE SYSTEMS
HOWARD COUNTY HEALTH DEPARTMENT
Joseph B. Adams 5/20/77 DATE
COUNTY HEALTH OFFICER
APPROVED: HOWARD COUNTY OFFICE OF PLANNING AND ZONING
James A. Harms 5-31-77 DATE
PLANNING DIRECTOR
Phillip M. Muehlen 5-27-77 DATE
CHIEF, DIV. OF LAND DEVELOPMENT
APPROVED: FOR STORM DRAINAGE SYSTEMS AND ROADS.
Ph. Treadwell 5-21-77 DATE
DIRECTOR, PUBLIC WORKS
Gravette N. McLeod 5/25/77 DATE
CHIEF, BUREAU OF HIGHWAYS

GENERAL NOTES

1. AREA OF SITE: 0.86 AC.
2. OWNER: JONAS ENTERPRISES, INC. 6000 OLD WASHINGTON ROAD ELK RIDGE, MARYLAND 21227
3. TAX MAP 24 PARCEL 490
4. DEED REF 659/604
5. SITE USE: PREVIOUSLY OWNED AUTOMOBILE SALES LOT
6. ZONING: B2 COMMERCIAL
7. NO. OF EMPLOYEES: 14
8. PARKING SPACES REQUIRED: 12
9. PARKING SPACES SHOWN: 10
10. THE STORM WATER MANAGEMENT FACILITIES WILL BE MAINTAINED BY THE PROPERTY OWNER, ITS SUCCESSORS AND ASSIGNS.
11. NO EMPLOYEE ON 2ND FLOOR PERMANENTLY.

SITE ANALYSIS

1. TOTAL AREA: 0.86 AC.
2. TOTAL AREA DISTURBED: .75 AC.
3. TOTAL AREA PAVED: .75 AC.
4. TOTAL AREA EX PAVING: NONE

ENTRANCE DETAIL
NO SCALE

REVISOR: 3-25-77

TITLE	SITE DEVELOPMENT PLAN		
PROJECT	ENTERPRISE USED AUTO SALES		
LOCATION	2ND ELECTION DISTRICT - HOWARD COUNTY - MD		
DATE	JUNE 1976	DES BY:	TKG
		DRAWN BY:	JC
		CHKD BY:	JAB
SCALE:	1" = 20'	JOB NO.:	76106
		DRWG NO.:	1A

STATE OF MARYLAND
ENGINEERING PLANNING SURVEYING
BOENDER ASSOC. INC.
ELLCOTT CITY
485-7777

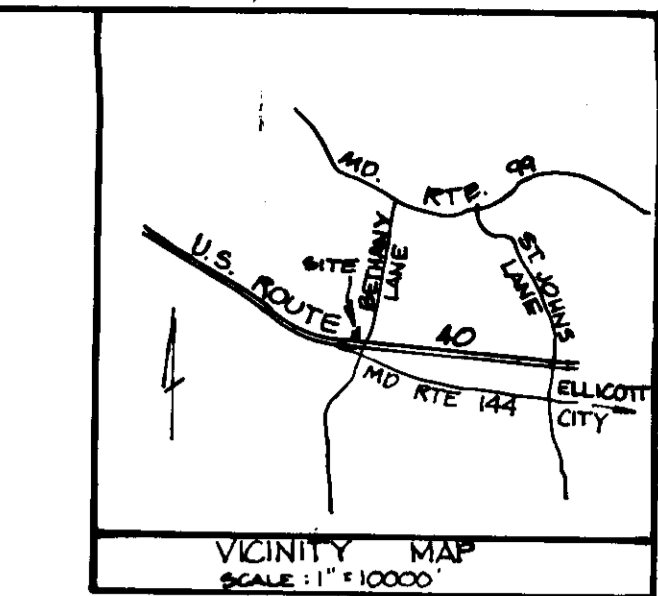

APPROVED
DIVISION OF LAND DEVELOPMENT
HOWARD COUNTY MARYLAND
DATE 4-18-77