

LEGEND

- CONTROLS
- EXISTING 305 (INTERNAL)
 - EXISTING SANITARY
 - EXISTING WATER
 - PROPOSED STORM SWAINS
 - EXISTING PAVING
 - PROPOSED SAC PAVING
 - FENCE
 - LIGHT POLES

SEWAGE CONTROL NOTES

- The developer shall notify the Howard County Soil Conservation District at least 20 hours prior to beginning any construction shown herein. (611-885-2180)
- Soil Conservation District measures must be installed prior to grading operations.
- Soil Conservation District measures shall be installed in accordance with the following:
 - Place 3" (each) compacted layer of topsoil to finished grade.
 - Spread 100-100-100 granitic limestone at the rate of 1000 lbs/acre and immediately disk into topsoil to a depth of 3 inches.
 - Hydrated lime at the rate of 15 tons/acre.
 - 3" (each) compacted layer of topsoil to finished grade.
 - Spread 100-100-100 granitic limestone at the rate of 1000 lbs/acre and immediately disk into topsoil to a depth of 3 inches.
 - Hydrated lime at the rate of 15 tons/acre.
 - 3" (each) compacted layer of topsoil to finished grade.
 - Spread 100-100-100 granitic limestone at the rate of 1000 lbs/acre and immediately disk into topsoil to a depth of 3 inches.
 - Hydrated lime at the rate of 15 tons/acre.
 - 3" (each) compacted layer of topsoil to finished grade.
 - Spread 100-100-100 granitic limestone at the rate of 1000 lbs/acre and immediately disk into topsoil to a depth of 3 inches.
 - Hydrated lime at the rate of 15 tons/acre.

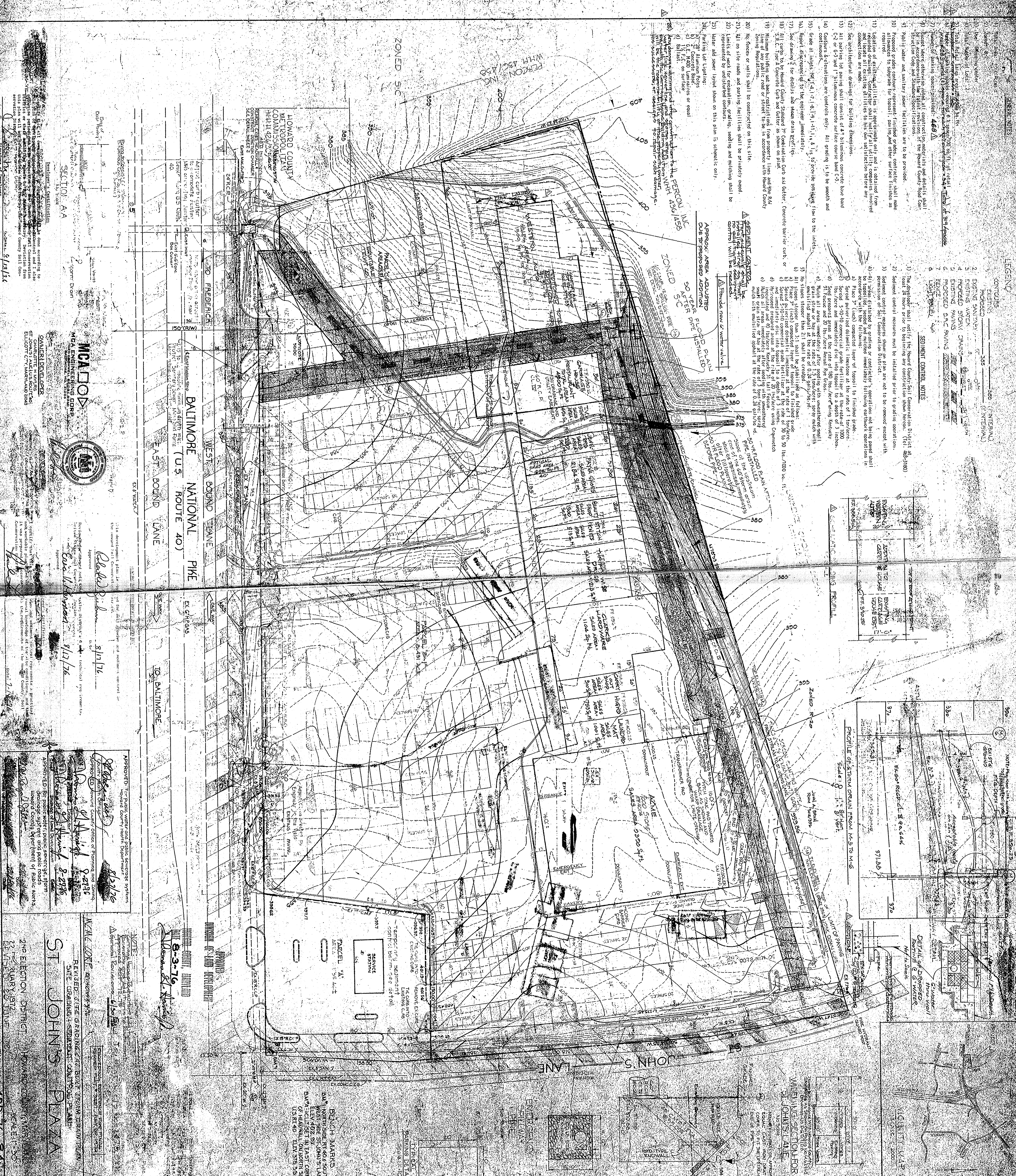
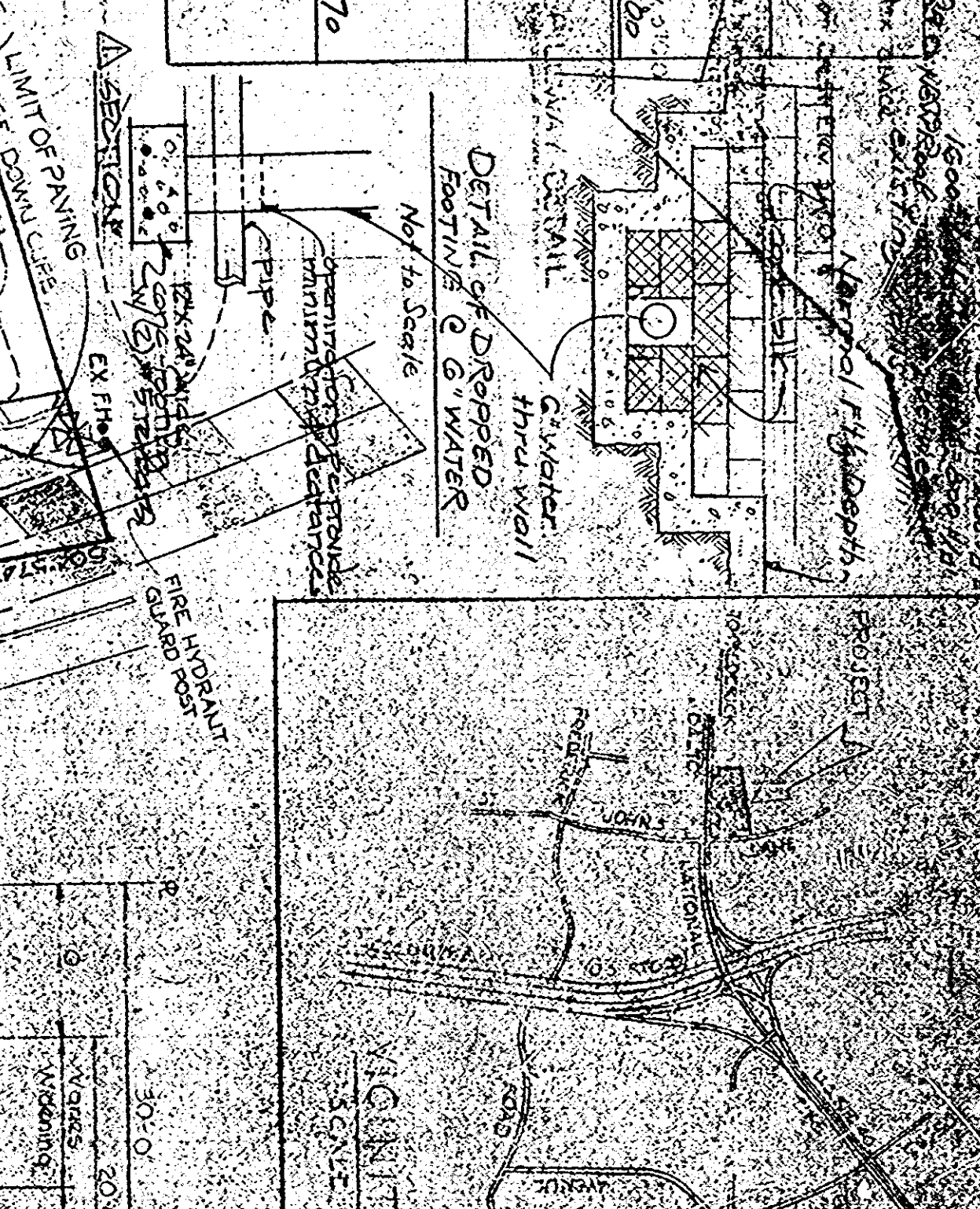
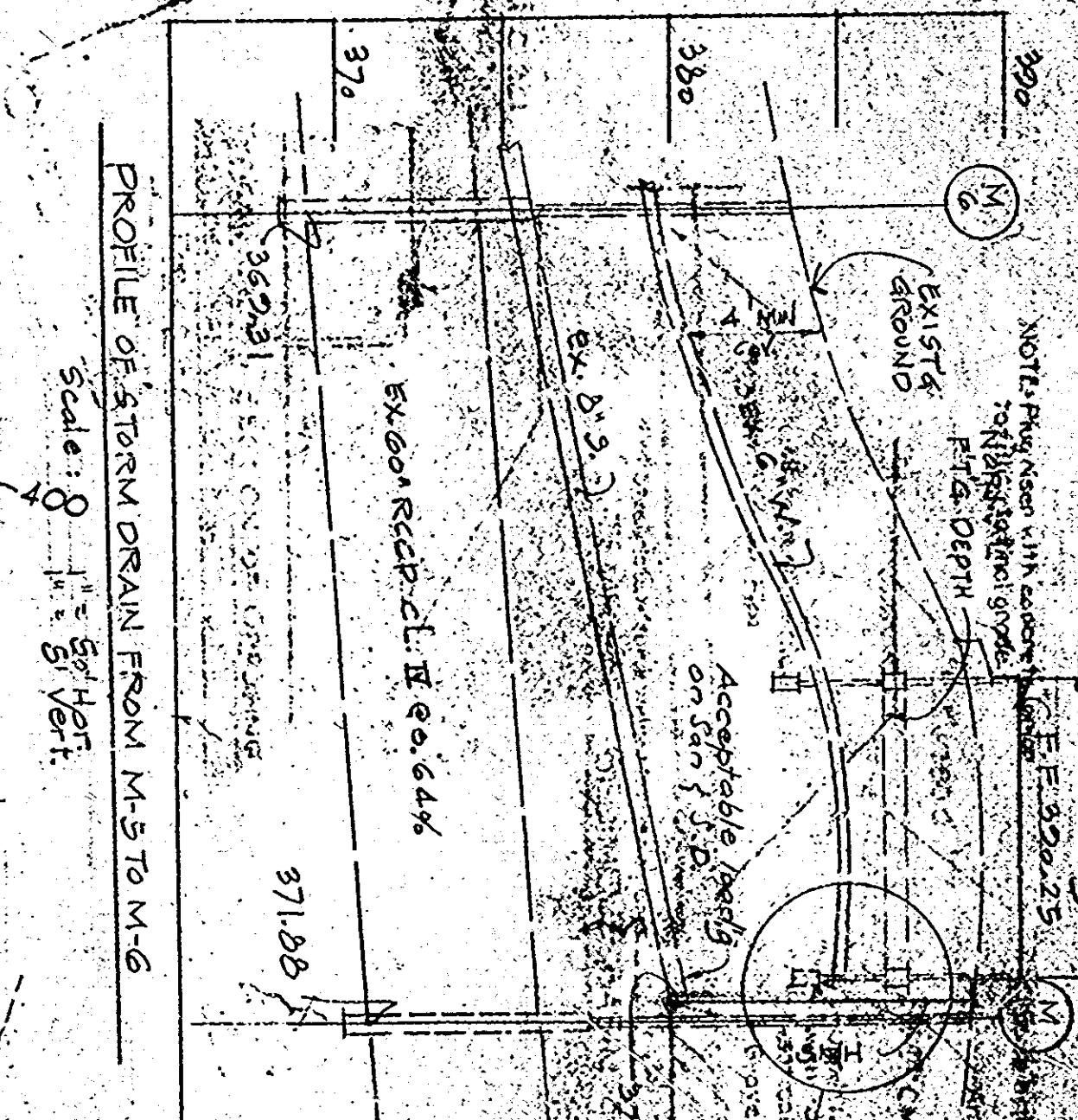
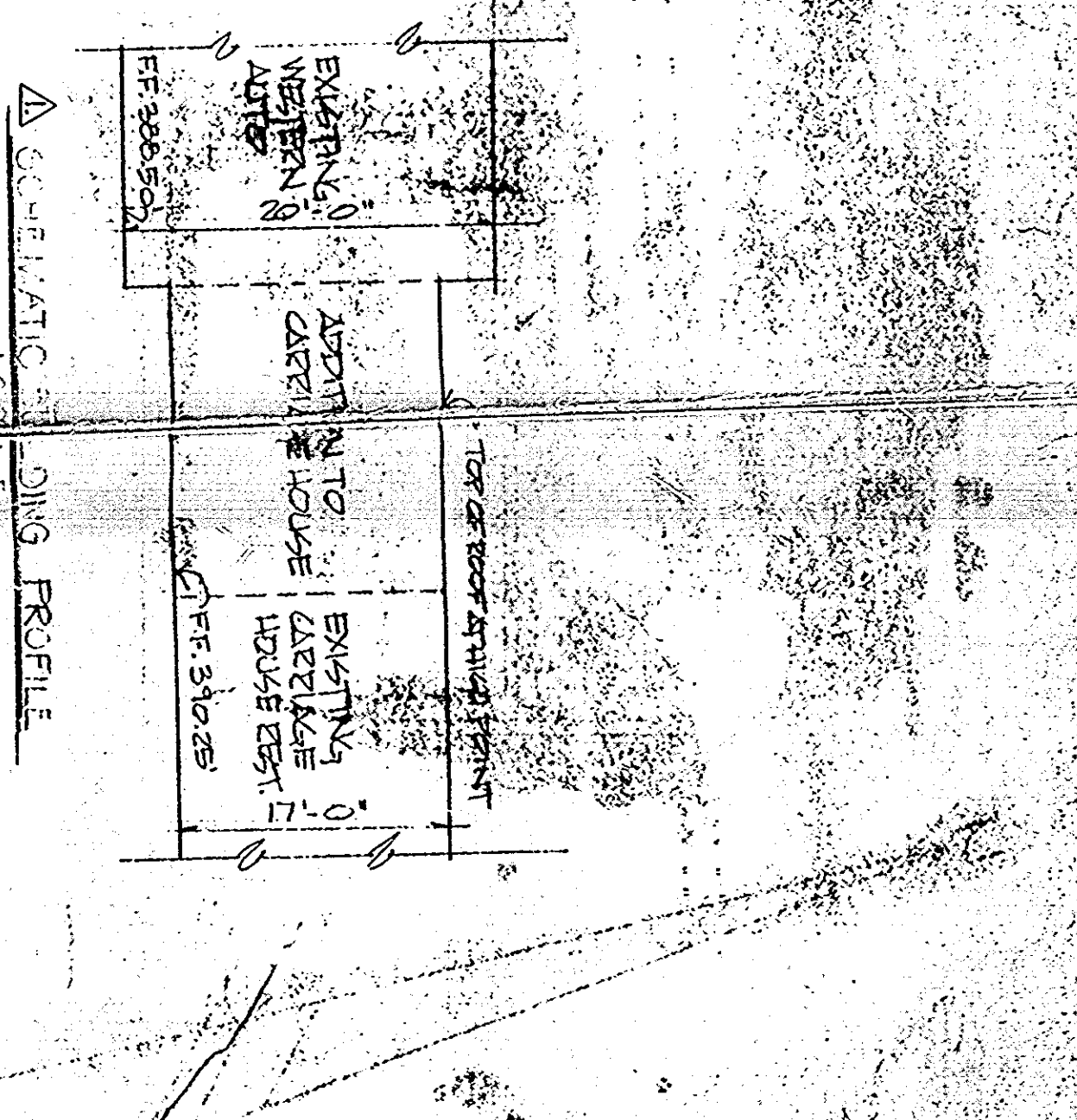

HOWARD COUNTY METROPOLITAN COMMISSION
 4620 BROADWAY
 BALTIMORE, MARYLAND 21204
 PHONE: 410-386-1400
 FAX: 410-386-1401

SECTION AA
 TO BALTIMORE
 TO WESTBOUND LANE
 TO EASTBOUND LANE
 TO JOHN'S LANE

APPROVED FOR THE PUBLIC WATER AND PUBLIC SEWERAGE SYSTEMS
 DEPARTMENT OF PUBLIC UTILITIES
 8/17/76

APPROVED FOR THE PUBLIC WATER AND PUBLIC SEWERAGE SYSTEMS
 DEPARTMENT OF PUBLIC UTILITIES
 8/21/76

ST JOHN'S PLAZA
 2ND ELECTION DISTRICT
 HOWARD COUNTY, MARYLAND
 8/21/76