

GENERAL NOTES

- ALL MATERIALS AND METHODS OF CONSTRUCTION NOT SHOWN ON THESE PLANS OR ACCOMPANYING SPECIFICATIONS SHALL CONFORM TO THE HOWARD COUNTY ROAD CONSTRUCTION CODE & STANDARD SPECIFICATIONS (REVISED AUGUST 6, 1968).
- FOR ALL DETAILS NOT SHOWN ON THESE PLANS OR ACCOMPANYING SPECIFICATIONS, SEE THE HOWARD COUNTY ROAD CONSTRUCTION CODE AND STANDARD SPECIFICATIONS (REVISED AUGUST 6, 1968).
- TREES WHICH ARE TO REMAIN ARE MARKED ON THE PLANS. PRIOR TO THE COMMENCING OF CONSTRUCTION OPERATIONS, CONTRACTOR SHALL PROTECT IN ACCORDANCE WITH SPECIFICATIONS.
- TOPOGRAPHIC DATA BASED UPON FIELD RUN SURVEY, BY PURDUM & JESCHKE, DATED DECEMBER 13, 1973.
- ALL ROADS AND DRIVES SHALL BE PRIVATELY OWNED AND MAINTAINED.
- PUBLIC WATER AND SEWERAGE SYSTEMS WILL BE USED.
- MINIMUM BUILDING SETBACK RESTRICTIONS FROM PROPERTY LINES OR R/W LINE OF ANY PUBLIC ROAD OR STREET TO BE IN ACCORDANCE WITH HOWARD COUNTY ZONING REGULATIONS.
- PRESENT ZONING - R-40.
- TOTAL AREA OF PARCEL - 119.600 ACRES ±.
- TOTAL AREA OF THIS SUBMISSION - 3.1 ACRES ±.
- TOTAL FLOOR SPACE 44,000 S.F.
 BASEMENT 6,798 S.F.
 FIRST FLOOR 23,371 S.F.
 SECOND FLOOR 11,925 S.F.
 MECHANICAL PENTHOUSE 1,906 S.F.
- PARKING REQUIREMENTS UNDER SECTION 23.01 OF THE ZONING REGULATIONS OF HOWARD COUNTY.
 REQUIRED PARKING:
 1,027 STUDENTS AT 2 SPACES
 PER 3 STUDENTS 685 SPACES
 105 EMPLOYEES AT 1 SPACE
 PER EMPLOYEE 105 SPACES
 TOTAL 790 SPACES
 PREVIOUSLY PROVIDED PARKING:
 EXISTING PARKING 495 SPACES
 UNDER CONSTRUCTION 295 SPACES
 TOTAL 790 SPACES
 REQUIRED UNDER THIS SUBMISSION 0 SPACES
 PROVIDED UNDER THIS SUBMISSION 0 SPACES
- SEE ARCHITECTURAL DRAWINGS AND SPECIFICATIONS FOR BUILDING DIMENSIONS.
- THE CONTRACTOR SHALL NOTIFY ALL NECESSARY UTILITY COMPANIES A MINIMUM OF THREE (3) DAYS BEFORE COMMENCING WORK ON THESE PLANS BY CALLING "MISS UTILITIES" - (301) 559-0100.
- THE CONTRACTOR SHALL NOTIFY THE HOWARD SOIL CONSERVATION DISTRICT (466-3180) AT LEAST 24 HOURS PRIOR TO COMMENCING WORK ON THESE PLANS.
- UNDERGROUND FACILITIES, STRUCTURES AND UTILITIES HAVE BEEN PLOTTED FROM AVAILABLE SURVEYS AND RECORDS AND THEREFORE, THEIR LOCATIONS MUST BE CONSIDERED APPROXIMATE ONLY. THE VERIFICATION OF THE LOCATION OF ALL UNDERGROUND FACILITIES, STRUCTURES AND UTILITIES EITHER SHOWN OR NOT SHOWN SHALL BE THE RESPONSIBILITY OF THE CONTRACTOR.
- ALL AREAS DISTURBED BY GRADING OR CONTRACTOR'S OPERATIONS, NOT BEING PAVED, SHALL BE TOPSOILED, SEEDED AND MULCHED OR OTHERWISE PROTECTED IN ACCORDANCE WITH THE SEDIMENT CONTROL PLAN.
- TEMPORARY COMPACTED EARTH FILLED DIVERSION DIKES ARE TO BE CONSTRUCTED AT THE TOP OF ALL CUT OR FILL SLOPES OVER FOUR (4) FEET IN HEIGHT CONCURRENTLY WITH THE INITIAL GRADING AND DIRECTED TO UNDISTURBED GROUND AT THE END OF EACH DAY.
- ALL SWALES SHALL BE SODDED AND TAMPED AND ALL SLOPES SHALL BE SEEDED OR SODDED IN ACCORDANCE WITH "STANDARDS AND SPECIFICATIONS FOR SOIL EROSION AND SEDIMENT CONTROL IN URBANIZING AREAS". (SOIL CONS. SERVICE)
- ALL INLETS AND MANHOLES TO HAVE A MINIMUM 8" CONCRETE FOOTING UNLESS DETAILED OTHERWISE.
- PROPOSED GRADES AND CONTOURS REPRESENT FINISHED GRADES, CONTRACTOR SHALL MAKE ALLOWANCES TO SUBGRADE FOR TOPSOIL, PAVING AND OTHER SURFACE FINISHES AS REQUIRED.
- CONTOURS AND ELEVATIONS ARE CONTROLS ONLY. ALL GRADING IS TO BE SMOOTH AND CONTINUOUS.
- TRENCHES CROSSING UNDER PAVING SHALL BE COMPACTED TO AT LEAST 95% OF MAXIMUM DENSITY.

INDEX OF DRAWINGS

SITE DEVELOPMENT:

SD1.00	Area of Submission
SD1.01	Dimension Control & Grading Plan
SD1.02	Sediment Control Plan
SD1.03	Area Drainage Plan
SD1.04	Site Utilities & Storm Drainage Profiles
SD1.05	Landscape Plan
SD1.06	Site Details
SD1.07	Site Details

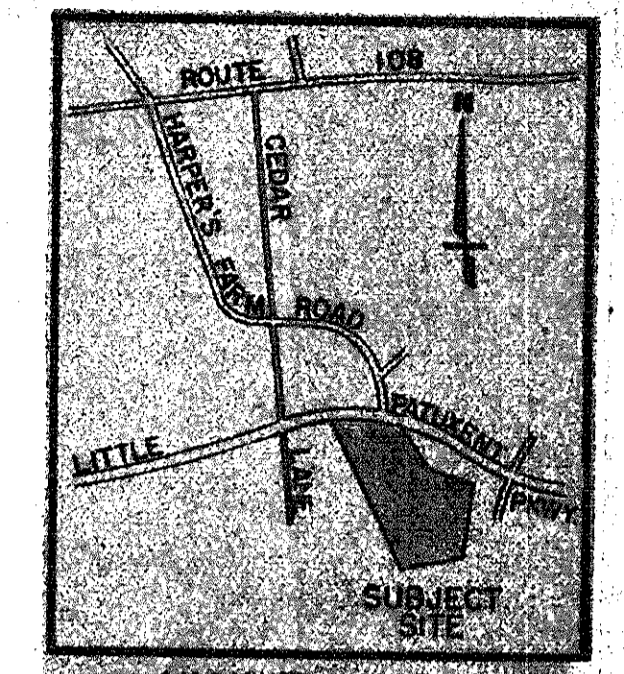

TOWN CENTER SECTION 8, AREA 3
P.B. 27, FOLIO 49

TOWN CENTER SECTION 8, AREA 1
PARCEL 1A
P.B. 16, FOLIO 114

TOWN CENTER SECTION 8, AREA 1
PARCEL 1B
P.B. 16, FOLIO 114

THE HOWARD RESEARCH AND DEVELOPMENT CORPORATION
516/752
R-40

HOWARD RESEARCH AND DEVELOPMENT CORPORATION
463/196
NEW TOWN

HOWARD COMMUNITY COLLEGE BOARD OF TRUSTEES
466/224
R-40

THE HOWARD RESEARCH AND DEVELOPMENT CORPORATION
455/219
R-40

**Howard Community College
Communication Arts / Administration Bldg.**

Architects: Cochran, Stephenson & Donkervoet, Inc. and The Oglesey Group, Inc., Oglesey, Wilky, Halford, Johnson, Inc. Baltimore, Maryland / Dallas, Texas
 Structural Engineer: Hunt & Joiner, Inc., Dallas
 Mechanical Engineer: Zumwalt & Vinther, Inc., Dallas
 General Contractor: [Blank]

Allocation: Howard County: \$ [Blank] State of Maryland: \$ [Blank]
 Total Construction Cost \$ [Blank]

Funded by: Howard County and The State of Maryland
 Board of Trustees, Howard Community College, Columbia, Md.
 Dr. John W. Gundstrom, Gloria Herrera
 Dr. Charles B. Leonard, Jr., Andrew N. Adams, Jr.
 Frederick K. Schoenbrodt, Leola M. Dorsey
 John M. Hamilton, M.D., Dr. Alfred J. Smith, Jr.

Dr. Edward L. Cochran, Co. Exec. State Board of Public Works
 Marvin Mandel, Governor
 Louis L. Goldstein, Comptroller
 William S. James, Treasurer
 MARVIN MANDEL, GOVERNOR

2x4 BRACING - TOP & BOTTOM - CONST. GRADE REDWOOD
 6x6 CONSTRUCTION HEART REDWOOD

BLACK EDGES & BACK
 BLACK BACKGROUND W/ GOLD LEGEND
 GOLD BACKGROUND W/ BLACK LEGEND
 LEGEND TO BE HELVETICA MEDIUM UPPER & LOWER CASE AS SHOWN.
 BLACK BACKGROUND W/ GOLD LEGEND
 SIGN TO BE 3/4" MEDIUM DENSITY OVERLAY EXT. PLYWOOD, PRIME PAINT, SECURE W/ 2x4 GALV. LAG SCREWS (PAINT) - TO MISS LEGEND - 3 EA. SIDE.

JOB SIGN 11' x 10'

THE HOWARD RESEARCH AND DEVELOPMENT CORPORATION
455/219
R-40

HOWARD COMMUNITY COLLEGE BOARD OF TRUSTEES
523/328
R-40

THE HOWARD RESEARCH AND DEVELOPMENT CORPORATION
463/196
NEW TOWN

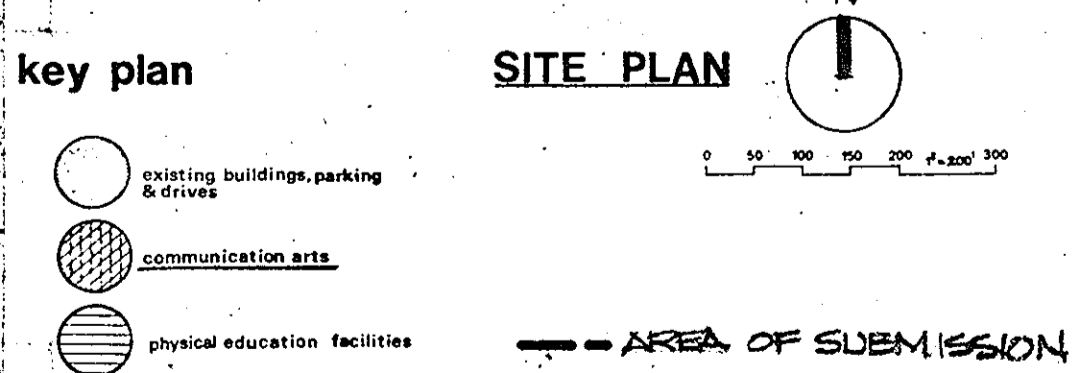
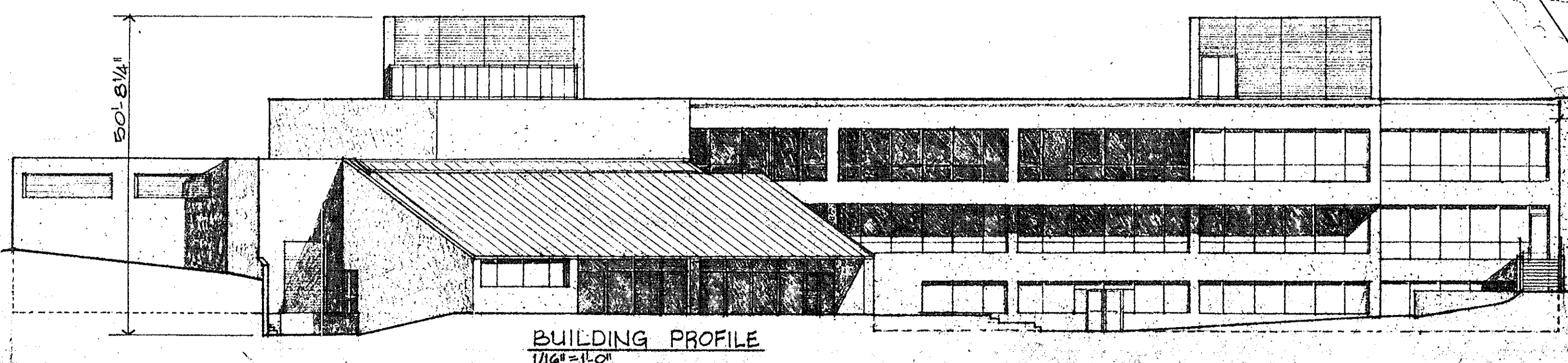

APPROVED
 DIVISION OF LAND DEVELOPMENT
 AND TRANSPORTATION PLANNING
 HOWARD COUNTY, MARYLAND
 DATE: 11-24-75

APPROVED: FOR PUBLIC WATER AND PUBLIC SEWERAGE, STORM DRAINAGE SYSTEMS & ROADS. HOWARD COUNTY DEPARTMENT OF PUBLIC WORKS. E.C. Roberts 12-8-75 DIRECTOR	APPROVED: HOWARD COUNTY OFFICE OF PLANNING AND ZONING. Thomas G. Homish 12-17-75 PLANNING DIRECTOR	APPROVED: FOR PUBLIC WATER AND PUBLIC SEWERAGE SYSTEMS. HOWARD COUNTY HEALTH DEPARTMENT. [Signature] 12/16/75 COUNTY HEALTH OFFICER
DATE: 12/8/75	DATE: 12/17/75	DATE: 12/16/75

NO.	BY	DATE	DESCRIPTION
A.C.S.	10/17/75		NOTE
A.C.S.	11/6/75		H.C. COMMENTS

RAYMOND L. GOODSON, JR., INC. CONSULTING ENGINEERS

3409 JARROVILL, DALLAS, TEXAS 75204 A TEL: 527-2230

OWNER - DEVELOPER
 HOWARD COMMUNITY COLLEGE BOARD OF TRUSTEES
 LITTLE PATUXENT PARKWAY
 COLUMBIA, MARYLAND 21044

ARCHITECTS
 THE OGLESEY GROUP, INC. OGLESEY, WILKY, HALFORD, JOHNSON
 COCHRAN, STEPHENSON & DONKERVOT, INC.
 925 NORTH CHARLES STREET
 BALTIMORE, MARYLAND 21202

HOWARD COMMUNITY COLLEGE
 COMMUNICATION ARTS / ADMINISTRATION BLDG.
 5TH ELECTION DISTRICT HOWARD CO, MARYLAND
 TAX MAP NO. 35 PARCELS A, B, C, 47 & 50
 AREA OF SUBMISSION

Cochran, Stephenson, & Donkervoet, Inc. Architects
 The Oglesey Group, Inc. Oglesey, Wilky, Halford, Johnson
 Howard Community College
 Communication Arts / Administration
 date OCT 1, 1975 job 7363
 SDP-76-30c

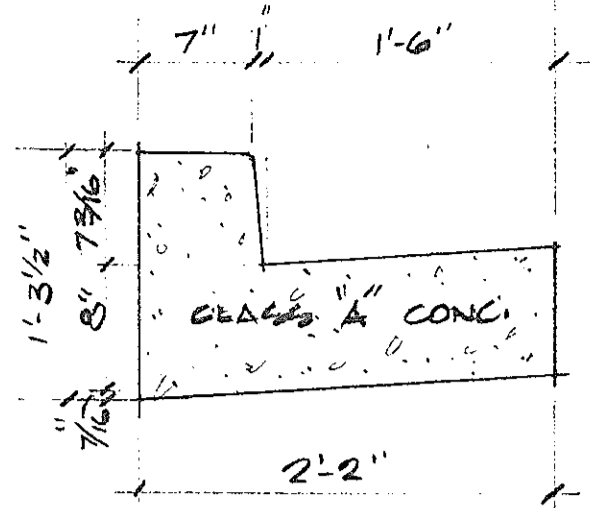

STANDARD 7" COMBINATION CURB & GUTTER SCALE 1"=10"

BIT. CONC. SURFACE BAND C-3
 BIT CONC. BASE BAND C-2 OR G-3
 TYPICAL WALKWAY PAVING SECTION NO SCALE

BITUMINOUS CONC. SURFACE BAND C-3
 BITUMINOUS CONC. BASE (GRAVEL MIX)
 TYPICAL BIT. CONC. ROADWAY PAVING SECTION NO SCALE

*BASE WILL BE PRIMED IN ACCORDANCE WITH SECTION C-30-3 OF HOWARD CO. ROAD CONSTRUCTION CODE

TACK COAT WILL BE IN ACCORDANCE WITH SECTION C-31-4 OF HOWARD CO. ROAD CONSTRUCTION CODE.

ALL MATERIALS & METHODS OF CONSTRUCTION NOT SHOWN ON THESE PLANS & ALL MATERIAL SPECIFICATIONS SHALL CONFORM TO THE HOWARD COUNTY ROAD CONSTRUCTION CODE AND STANDARD SPECIFICATIONS, (REVISED AUG. 6, 1968)

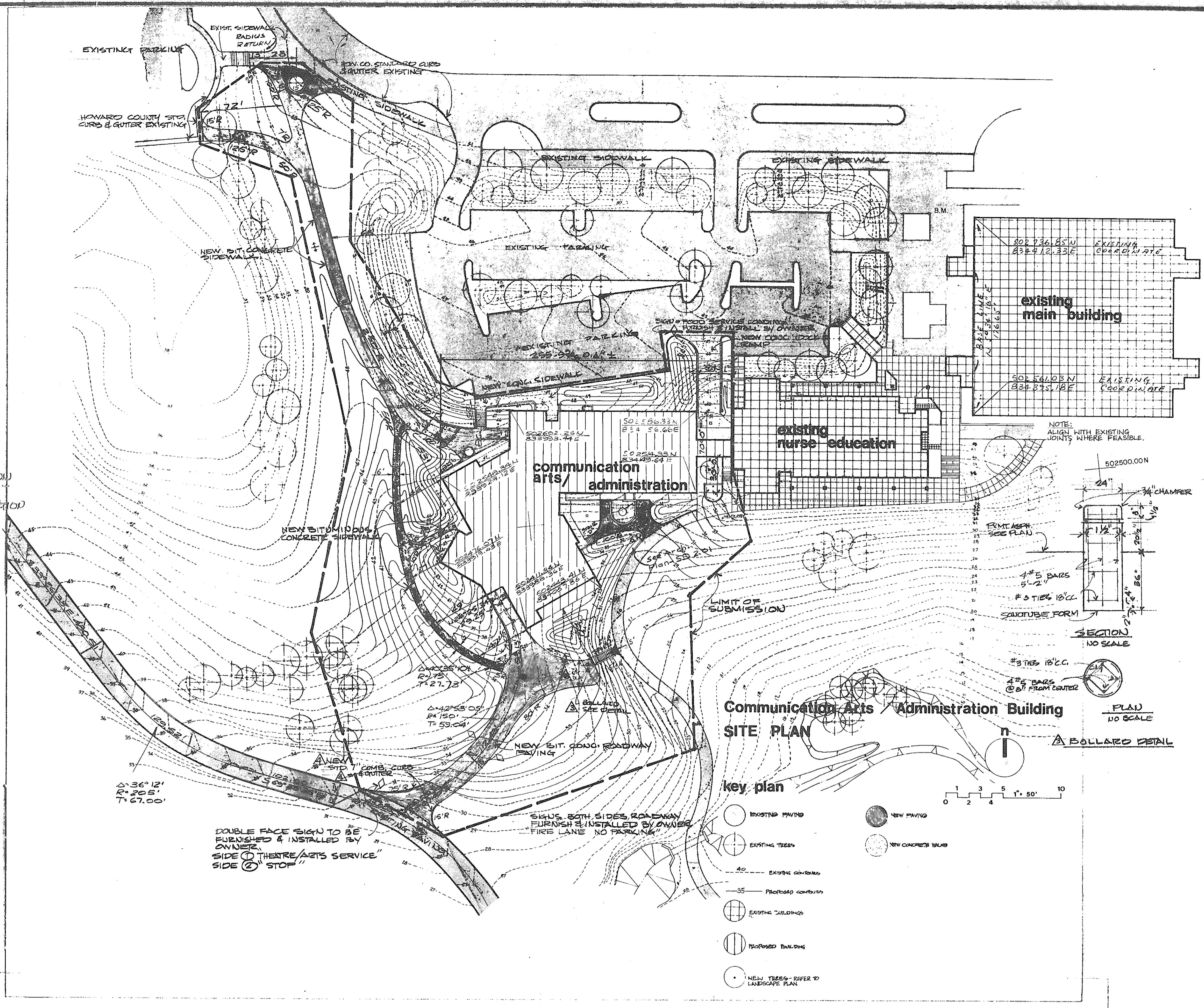

NOTES:
 1. All Coordinates Shown Are Based On Maryland State Grid System.
 2. See Architectural Plans For Detail Of Grading Near Bldg.

BENCH MARK
 N.E. Corner Of Planter At N.W. Corner Of Main Bldg.
 (Top) Elevation 443.04 (Based On U.S.C. & G.S. System).

APPROVED
 DIVISION OF LAND DEVELOPMENT
 AND TRANSPORTATION PLANNING
 HOWARD COUNTY, MARYLAND
 DATE 11-24-75
 VRC

APPROVED: FOR PUBLIC WATER AND PUBLIC SEWERAGE, STORM DRAINAGE SYSTEMS & ROADS, HOWARD COUNTY DEPARTMENT OF PUBLIC WORKS. DATE 12-8-75 DIRECTOR S. H. Messersmith	APPROVED: HOWARD COUNTY OFFICE OF PLANNING AND ZONING. DATE 12-17-75 PLANNING DIRECTOR D. J. Kinnel	APPROVED: FOR PUBLIC WATER AND PUBLIC SEWERAGE SYSTEMS, HOWARD COUNTY HEALTH DEPARTMENT. DATE 12/16/75 COUNTY HEALTH OFFICER C. W. ...
--	--	---

NO.	BY	DATE	DESCRIPTION
1	C.S.	10/15/75	NOTE
2	C.S.	11/6/75	H.A.D. COMMENTS



RG
 RAYMOND L. GOODSON & ASSOCIATES, INC.
 ARCHITECTS
 925 NORTH CHARLES STREET
 BALTIMORE, MARYLAND 21202

OWNER - DEVELOPER
 HOWARD COMMUNITY COLLEGE BOARD OF TRUSTEES
 LITTLE PATIENT PARKWAY
 COLUMBIA, MARYLAND 21044

ARCHITECTS
 THE OGLESBY GROUP, INC. OGLESBY, WILEY, HALFORD, JOHNSON
 COCHRAN STEPHENSON & DONKEROEFT, INC.
 925 NORTH CHARLES STREET
 BALTIMORE, MARYLAND 21202

HOWARD COMMUNITY COLLEGE
 COMMUNICATION ARTS / ADMINISTRATION BLDG.
 5TH ELECTION DISTRICT HOWARD CO., MARY. AND
 TAX MAP NO. 35 PARCELS A, B, C, 47 & 50
 DIMENSION CONTROL & GRADING PLAN

Howard Community College
Communication Arts / Administration
 date OCT 1, 1975 job 7363
 Cochran, Stephenson, & Donkeroeft, Inc. Architects
 The Oglesey Group, Inc. Oglesey, Wiley, Halford, Johnson

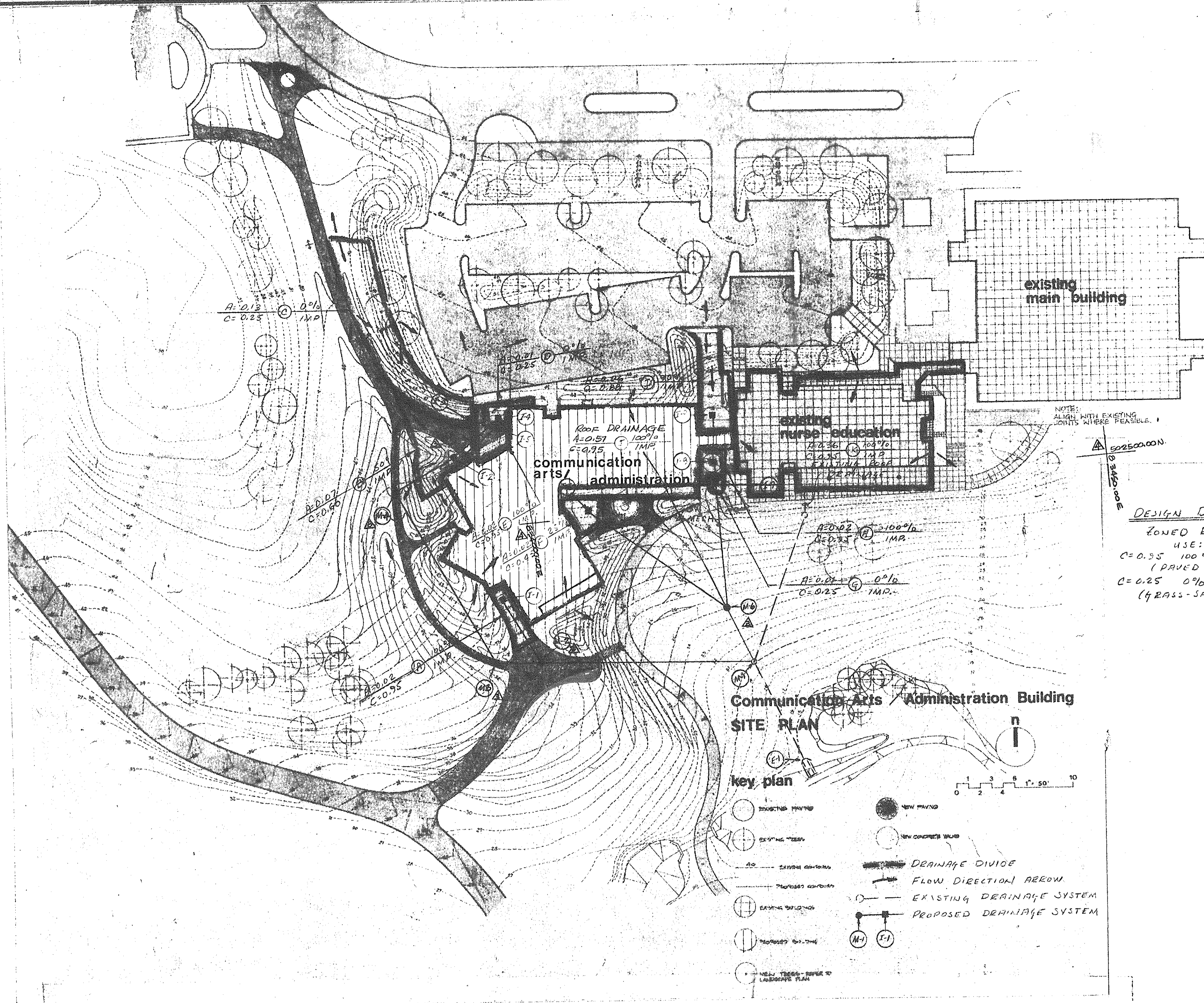

DESIGN DATA
 ZONED R-40
 USE:
 C=0.95 100% IMPERVIOUS (PAVED AREAS)
 C=0.25 0% IMPERVIOUS (GRASS-SANDY SOIL)

**Communication Arts Administration Building
 SITE PLAN**

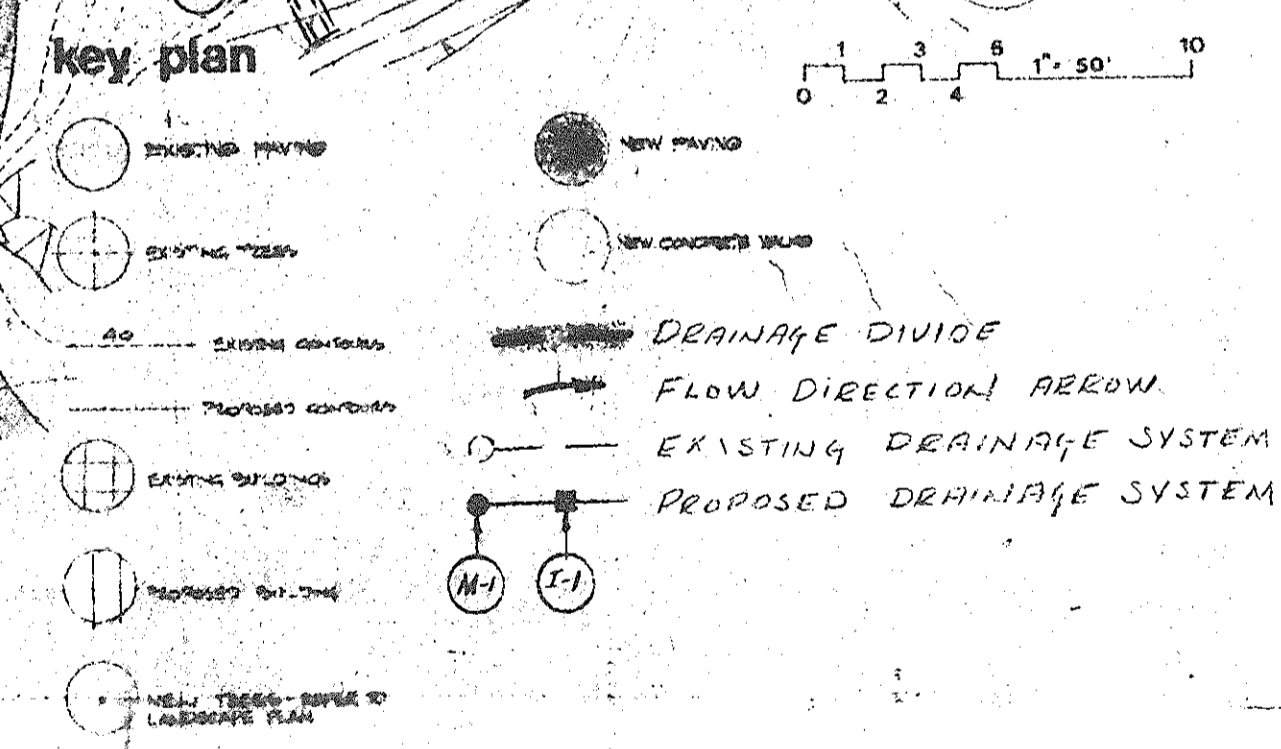

APPROVED
 DIVISION OF LAND DEVELOPMENT
 AND TRANSPORTATION PLANNING
 HOWARD COUNTY, MARYLAND
 DATE 11-24-75

APPROVED: FOR PUBLIC WATER AND PUBLIC SEWERAGE, STORM DRAINAGE SYSTEMS & ROADS, HOWARD COUNTY DEPARTMENT OF PUBLIC WORKS.
 W. O. Fairbank, 12-8-75, DIRECTOR

APPROVED: HOWARD COUNTY OFFICE OF PLANNING AND ZONING.
 Thomas L. Hamrick, 12-17-75, PLANNING DIRECTOR

APPROVED: FOR PUBLIC WATER AND PUBLIC SEWERAGE SYSTEMS, HOWARD COUNTY HEALTH DEPARTMENT.
 J. W. McLeod, 12/14/75, CHIEF, BUREAU OF HIGHWAYS

NOTED DATE DESCRIPTION
 C.S. 10/15/75 NOTE
 C.S. 11/6/75 H.C.C. COMMENTS

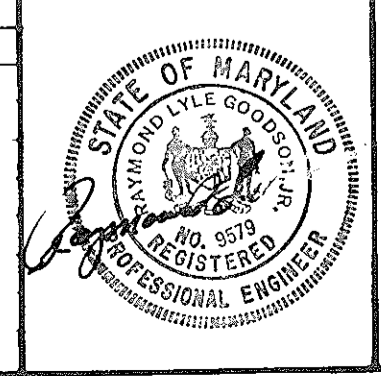

RG
 RAYMOND GOLDENSTEIN, REGISTERED PROFESSIONAL ENGINEER

OWNER - DEVELOPER
 HOWARD COMMUNITY COLLEGE BOARD OF TRUSTEES
 LITTLE PATUXENT PARKWAY
 COLUMBIA, MARYLAND 21044
 ARCHITECTS
 THE OGLESBY GROUP, INC. OGLESBY, WILEY, HALFORD, JOHNSON
 COCHRAN STEPHENSON & DONKervoet, INC.
 925 NORTH CHARLES STREET
 BALTIMORE, MARYLAND 21202

HOWARD COMMUNITY COLLEGE
 COMMUNICATION ARTS/ADMINISTRATION BLDG.
 5TH ELECTION DISTRICT, HOWARD COUNTY, MARYLAND
 TAX MAP NO. 35, PARCELS A, B, C, 47 & 50

AREA DRAINAGE MAP

Cochran, Stephenson, & Donkervoet, Inc. Architects
 The Oglesby Group, Inc. Oglesby, Wiley, Halford, Johnson
**Howard Community College
 Communication Arts / Administration**
 date OCT 1, 1975 job 7363
 SD 1.03
 SDP-76-30c

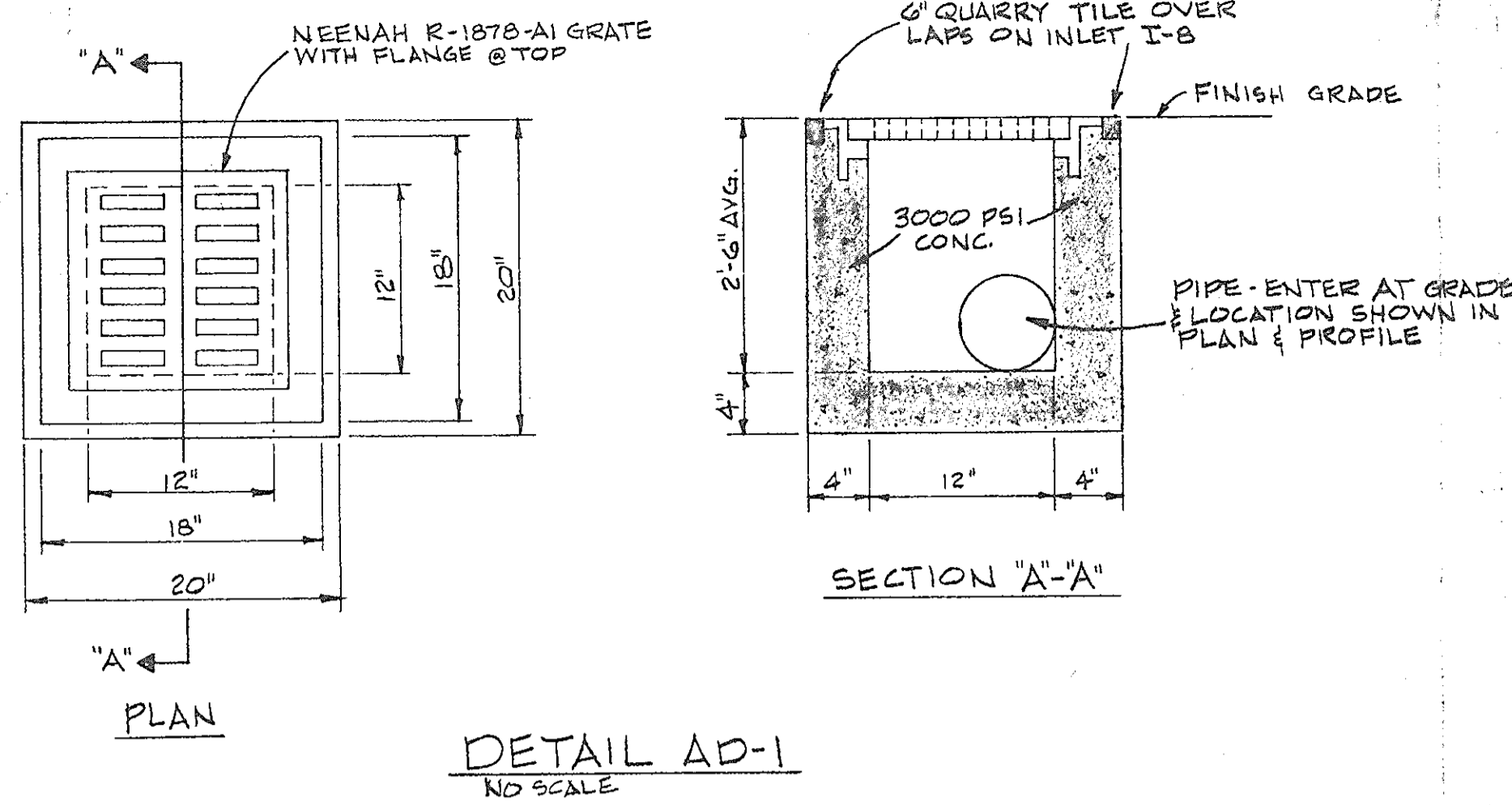

NOTES

1. ALL DRAINAGE STRUCTURES SHALL BE IN ACCORDANCE WITH THE HOWARD COUNTY ROAD CONST. CODE.
2. ALL DIMENSIONS GIVEN ARE FROM OUTSIDE WALLS OF THE PROPOSED BUILDING TO CENTER OF STRUCTURE. (SEE ARCHITECTURAL DRAWINGS FOR MORE DETAIL).
3. FIRE HYDRANT SHALL BE STRAPPED TO THE IT AND SHALL BE BURIED WITH CONCRETE IN ACCORDANCE WITH STD. DET.
4. BURY LINE ELEV. FOR F.H. TO BE AS NOTED ON PLAN.
5. F.H. LINE TO HAVE MIN. COVE 3'-5\"/>

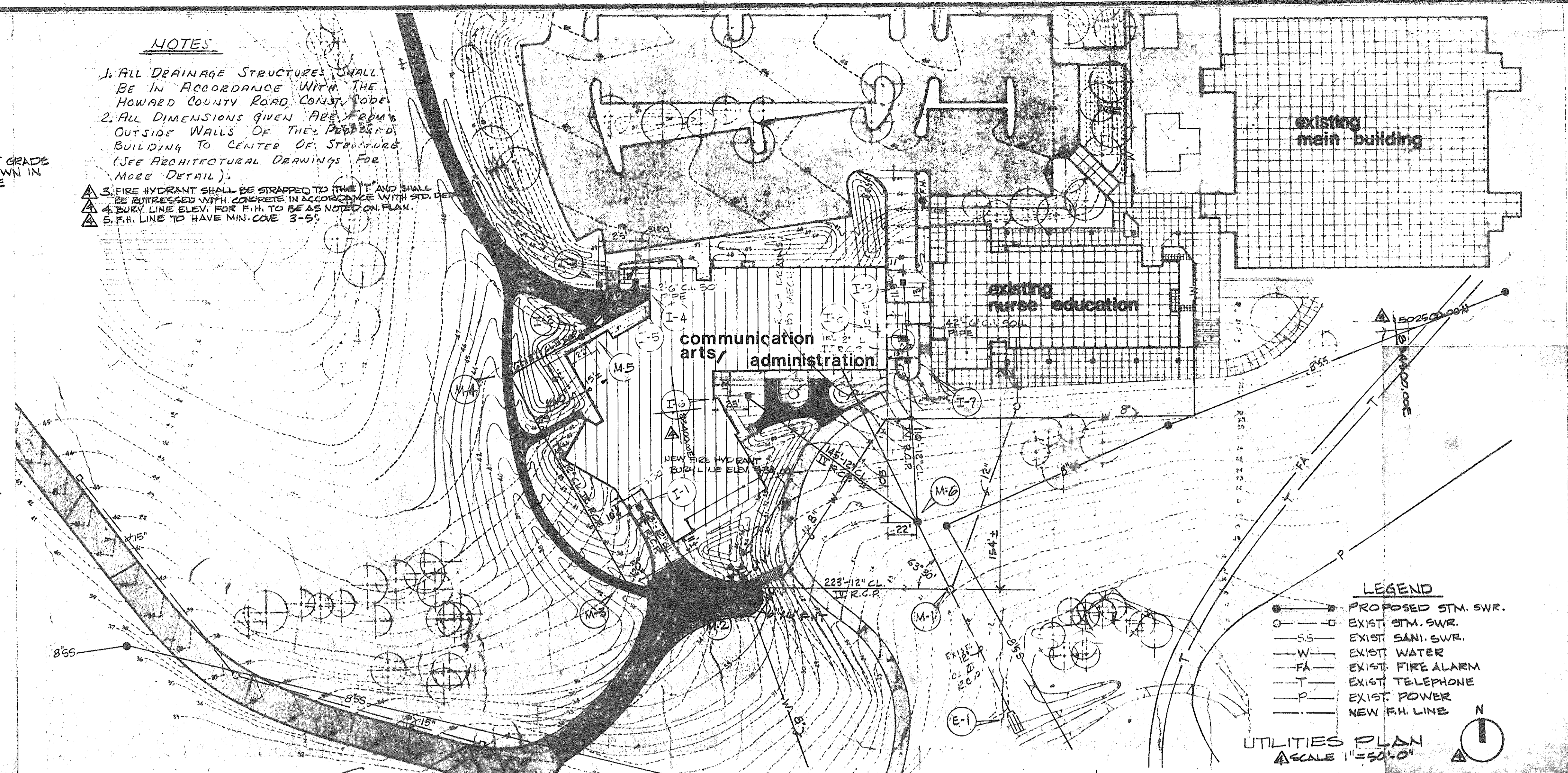

NO	TYPE	LOCATION	INVERT	INVERT	TOP ELEV	REMARKS
M-1	B-MANHOLE	Set Man. Profile	414.33	414.13	414.90	Existing M.H.
M-2	"	"	427.98	427.08	434.50	How. Co. STD. DET. SD. P. 9
M-3	"	"	429.94	429.74	435.30	"
M-4	"	"	438.89	438.89	443.10	"
E-1	B-HOWL	"	---	412.34	414.34	Existing HDWL
I-2	AD-1	"	---	428.75	431.25	See Detail Above
I-2	"	"	---	439.33	441.83	"
I-3	"	"	---	442.50	445.00	"
I-4	"	"	---	442.26	444.76	"
I-5	AD-2	"	---	442.00	442.12	See Detail Above
I-6	AD-1	"	---	431.90	434.40	See Detail Above
I-7	"	"	---	430.75	433.25	"
I-8	"	"	---	429.07	431.57	"
I-9	"	"	---	426.02	428.52	"
M-5	B-MANHOLE	"	436.15	435.95	442.10	HOW. CO. STD. DET. SD. P. 9
M-6	"	"	414.01	413.81	425.00	HOW. CO. STD. DET. SD. P. 9

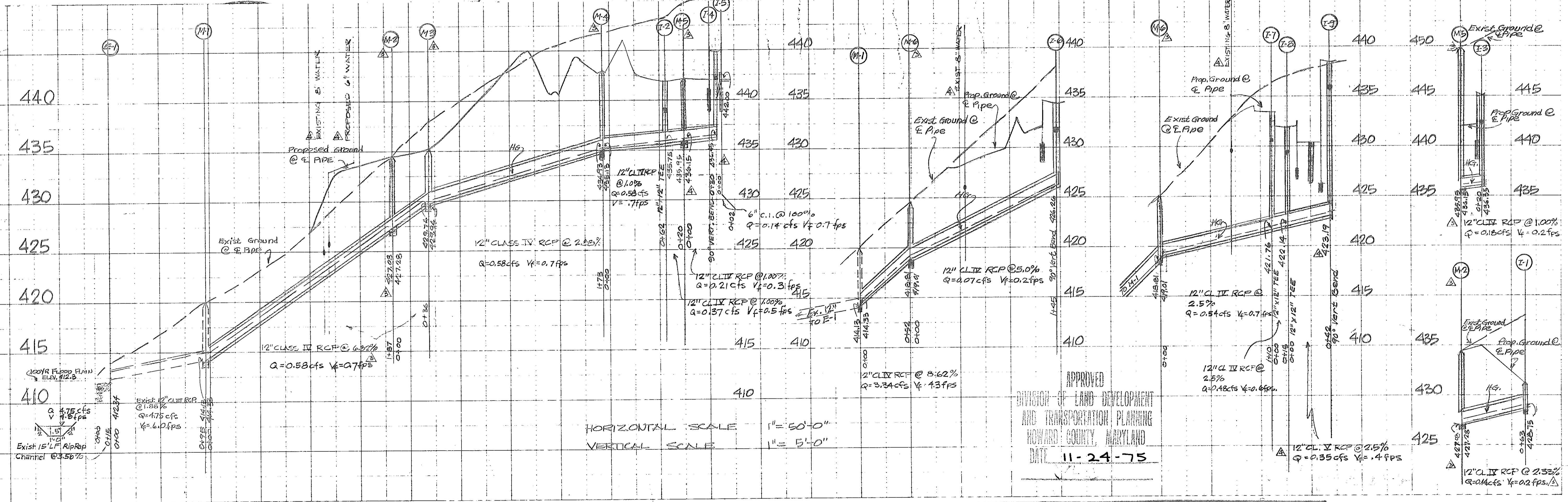
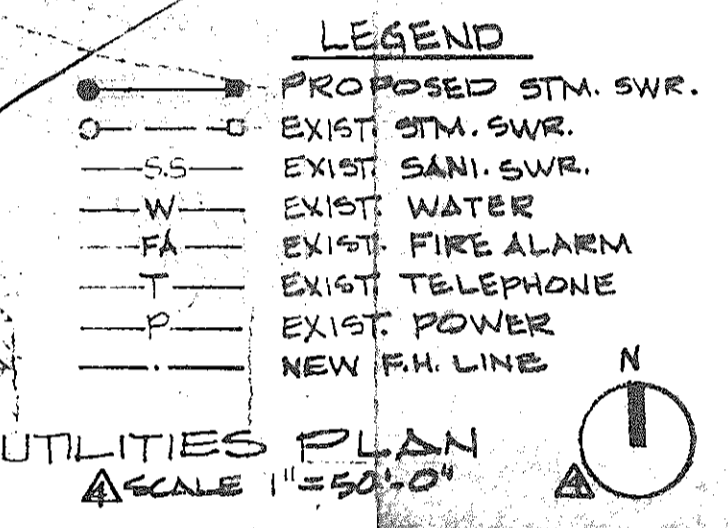

APPROVED
DIVISION OF LAND DEVELOPMENT
AND TRANSPORTATION PLANNING
HOWARD COUNTY, MARYLAND
DATE: 11-24-75

APPROVED: FOR PUBLIC WATER AND PUBLIC SEWERAGE, STORM DRAINAGE SYSTEMS & ROADS, HOWARD COUNTY DEPARTMENT OF PUBLIC WORKS
DATE: 12-8-75
DIRECTOR: D. W. McNeel

APPROVED: HOWARD COUNTY OFFICE OF PLANNING AND ZONING
DATE: 12/14/75
PLANNING DIRECTOR: J. C. Clavel

APPROVED: FOR PUBLIC WATER AND PUBLIC SEWERAGE SYSTEMS, HOWARD COUNTY HEALTH DEPARTMENT.
DATE: 12/14/75
COUNTY HEALTH OFFICER: J. C. Clavel

REV. NO. 1
DATE 12/14/75
DESCRIPTION: NOTE
C.S. 11/6/75 H.C. COMMENTS

STATE OF MARYLAND
RAYMOND E. GODSON, JR., INC.
REGISTERED PROFESSIONAL ENGINEER

OWNER - DEVELOPER
HOWARD COMMUNITY COLLEGE BOARD OF TRUSTEES
LITTLE PATIENT PARKWAY
COLUMBIA, MARYLAND 21044

ARCHITECTS
THE OGLESBY GROUP, INC. OGLESBY, WILEY, HALFORD, JOHNSON
COCHRAN STEPHENSON & DONKEROEFT, INC.
925 NORTH CHARLES STREET
BALTIMORE, MARYLAND 21202

HOWARD COMMUNITY COLLEGE
COMMUNICATION ARTS / ADMINISTRATION BLDG.
5TH ELECTION DISTRICT HOWARD CO, MARYLAND
TAX MAP NO. 35 PARCELS A, B, C, 47 & E0

SITE UTILITIES & STORM DRAINAGE PROFILES

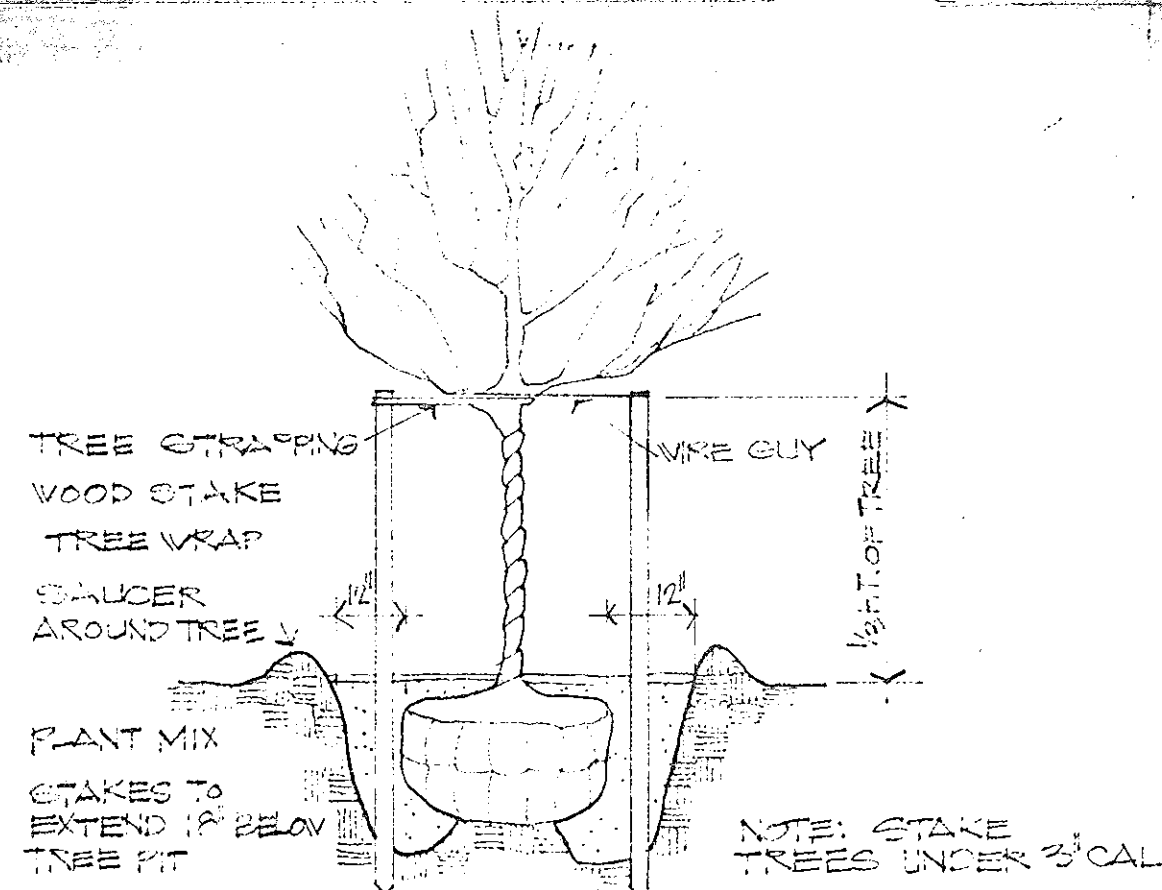

② TREE STAKING
3/8" = 1'-0"

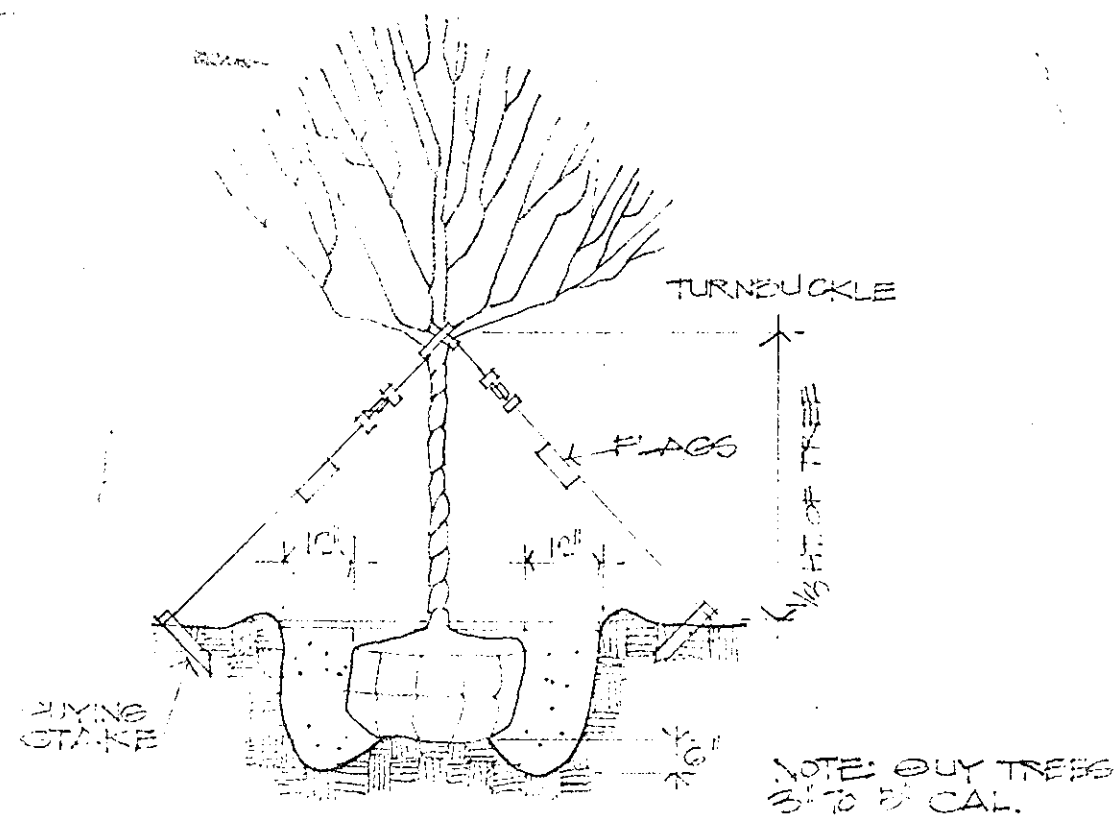

③ TREE GUYING
3/8" = 1'-0"

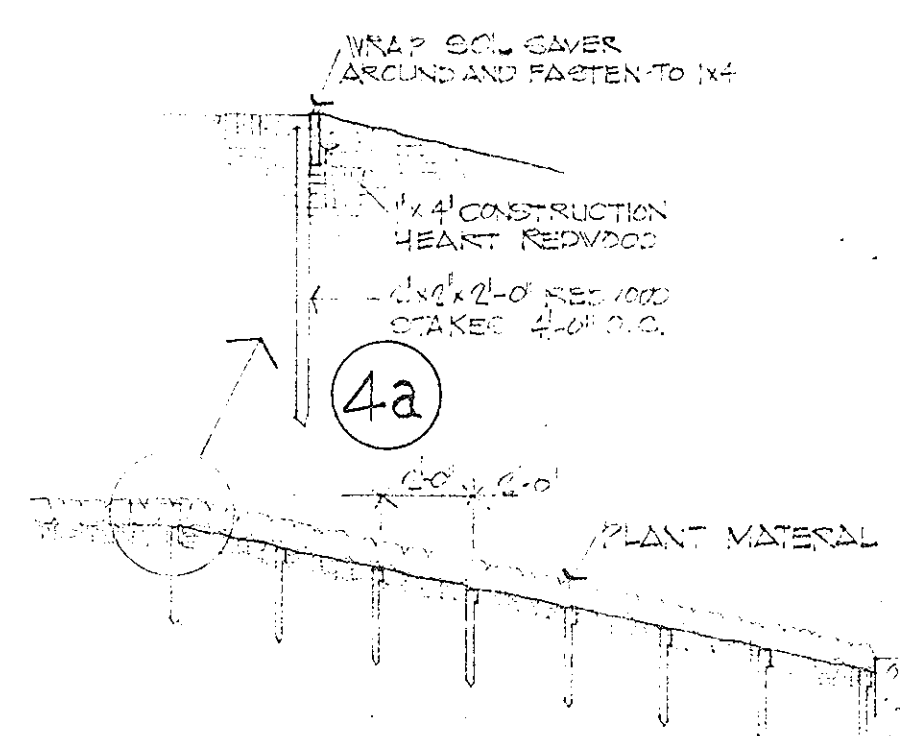

④ TRENCH SECTION THROUGH SLOPING PLANTERS
1/4" = 1'-0"

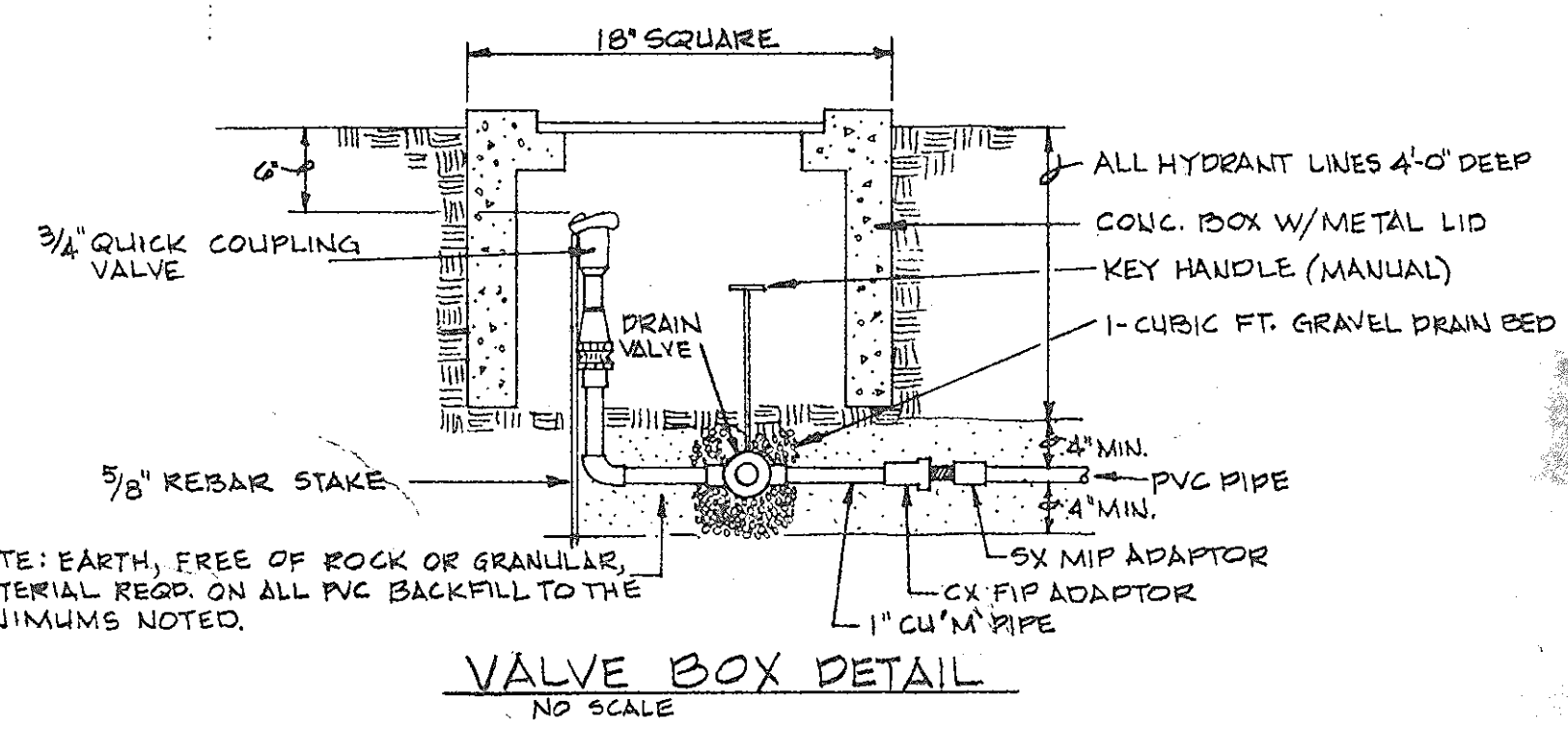

VALVE BOX DETAIL
NO SCALE

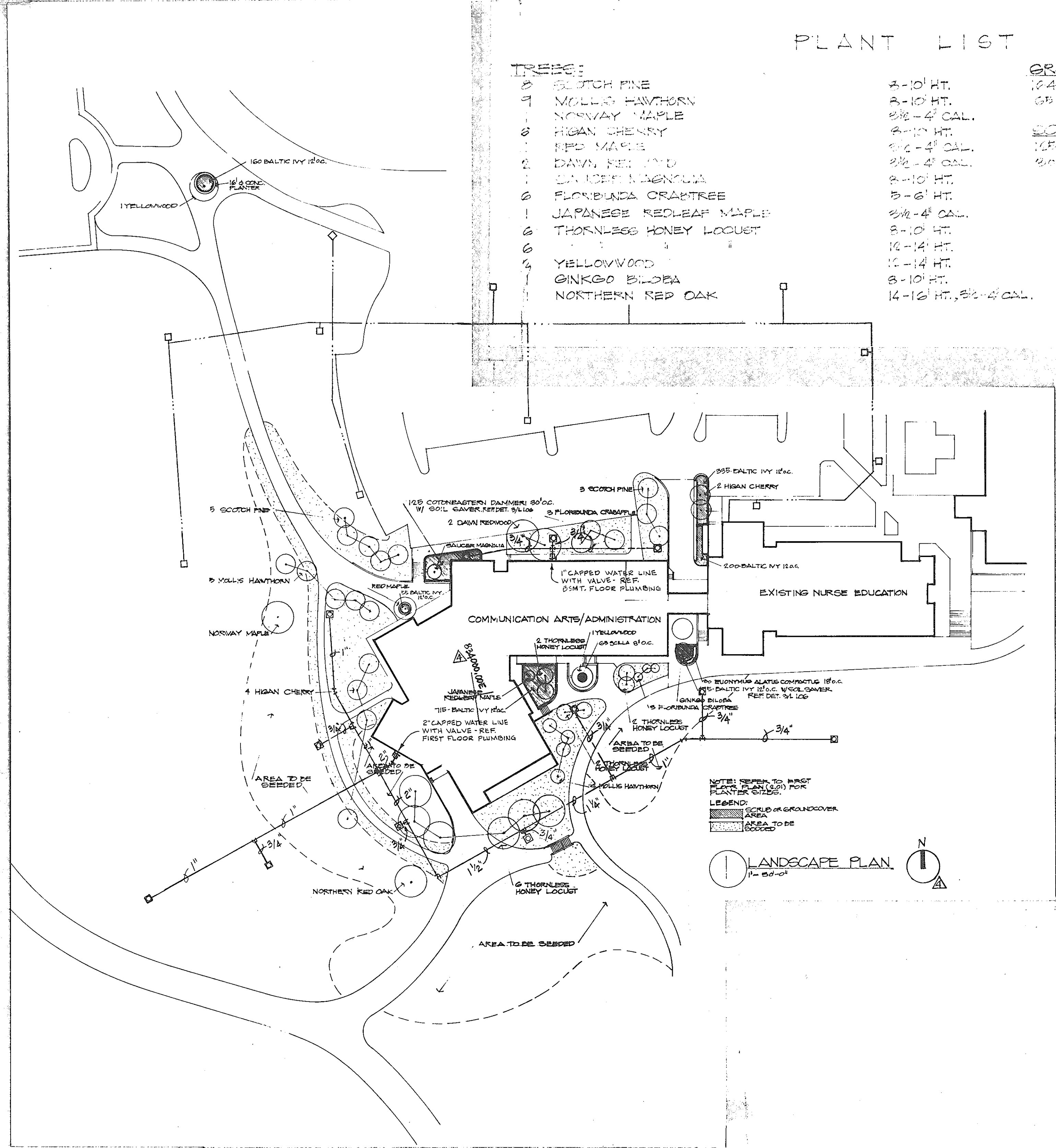

PLANT LIST

TREES:	GROUNDCOVER:
8 SCOTCH PINE	3-10 HT.
9 MOLLIS HAWTHORN	3-10 HT.
10 NORWAY MAPLE	3/8-4 CAL.
11 HIGAN CHERRY	3-10 HT.
12 RED MAPLE	3/8-4 CAL.
13 DAN REDWOOD	3/8-4 CAL.
14 JAPANESE REDLEAF MAPLE	3-10 HT.
15 THORNLESS HONEY LOCUST	3-6 HT.
16 GINKGO BILBOA	3/8-4 CAL.
17 FLORINDA CRABTREE	3-10 HT.
18 JAPANESE REDLEAF MAPLE	3-10 HT.
19 THORNLESS HONEY LOCUST	10-14 HT.
20 GINKGO BILBOA	10-14 HT.
21 NORTHERN RED OAK	8-10 HT.
	14-16 HT., 3/8-4 CAL.

SPRINKLER LEGEND

☐	QUICK COUPLER LAWN HYDRANT & DRAIN VALVE (SEE DETAIL)
⚠	DELETE NOTE
☐	EXIST. LAWN HYDRANT

APPROVED: FOR PUBLIC WATER AND PUBLIC SEWERAGE, STORM DRAINAGE SYSTEMS & ROADS. HOWARD COUNTY DEPARTMENT OF PUBLIC WORKS. <i>W. O. Talbot</i> 12-8-75 DIRECTOR	APPROVED: HOWARD COUNTY OFFICE OF PLANNING AND ZONING. <i>J. D. ...</i> 12-17-75 PLANNING DIRECTOR	APPROVED: FOR PUBLIC WATER AND PUBLIC SEWERAGE SYSTEMS. HOWARD COUNTY HEALTH DEPARTMENT. <i>M. ...</i> 12/14/75 COUNTY HEALTH OFFICER
--	--	---

REVISIONS

NO.	BY	DATE	DESCRIPTION
1	C.S.	10/30/75	NOTE
2	C.S.	11/6/75	H.CO. COMMENTS

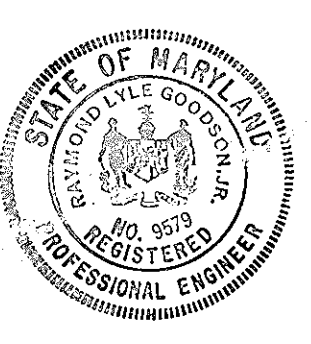

RG
RAYMOND L. GOODSON, INC.

OWNER - DEVELOPER
HOWARD COMMUNITY COLLEGE BOARD OF TRUSTEES
LITTLE PATUKENT PARKWAY
COLUMBIA MARYLAND 21044

ARCHITECTS
THE OGLESBY GROUP, INC. OGLESBY, WILEY, HALFORD, JOHNSON
COCHRAN STEPHENSON & DONKERVOET, INC.
925 NORTH CHARLES STREET
BALTIMORE MARYLAND 21202

HOWARD COMMUNITY COLLEGE
COMMUNICATION ARTS / ADMINISTRATION BLDG.
5TH ELECTION DISTRICT HOWARD CO, MARYLAND
TAX MAP NO. 35 PARCELS A, B, C, 47 & 50

LANDSCAPE PLAN

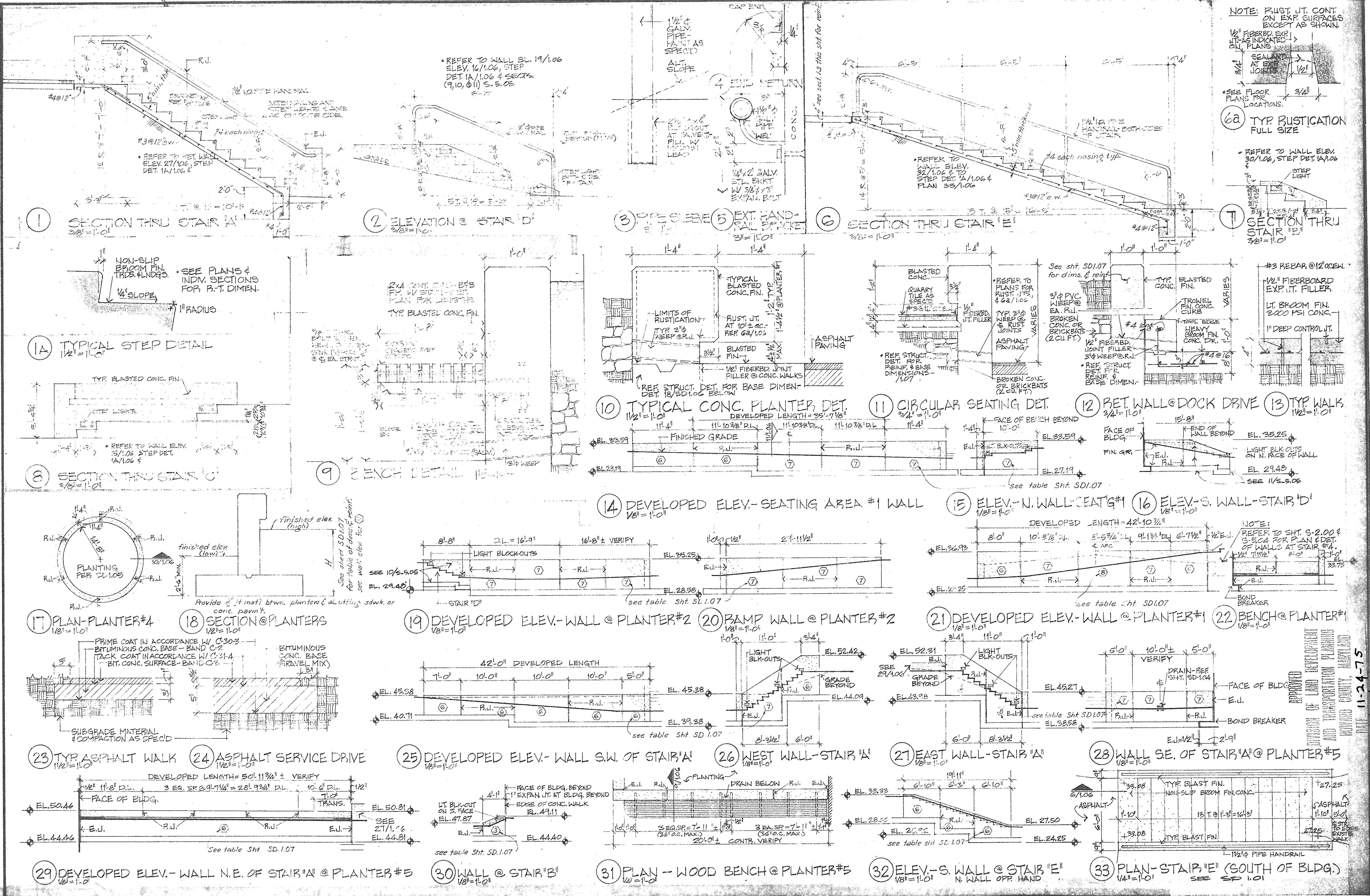

NOTE: RUST. JT. CONT. ON EXP. SURFACES EXCEPT AS SHOWN.

1/2" FIBERBOARD EXP. JT. AS INDICATED ON PLANS.

SEALANT AT E JOINT.

SEE FLOOR PLANS FOR LOCATIONS.

6a TYP RUSTICATION FULL SIZE

REFER TO WALL ELEV. 30/1.06, STEP DET. 1A/1.06

Cochran, Stephenson, & Donkervoet, Inc. Architects

The Oglesby Group, Inc. Oglesby, Wiley, Halford, Johnson

Howard Community College
Communication Arts / Administration

DATE: OCT 1, 1975
 JOB: 7363
 SCALE: AS SHOWN

APPROVED FOR PUBLIC WATER AND PUBLIC SEWERAGE, STORM DRAINAGE SYSTEMS & ROADS, HOWARD COUNTY DEPARTMENT OF PUBLIC WORKS.

12-8-75
 DATE

APPROVED HOWARD COUNTY OFFICE OF PLANNING AND ZONING.

12/17/75
 DATE

APPROVED FOR PUBLIC WATER AND PUBLIC SEWERAGE SYSTEMS, HOWARD COUNTY HEALTH DEPARTMENT.

12/16/75
 DATE

REV. NO. | DATE | DESCRIPTION

1 | 12/17/75 | NOTE

2 | 12/16/75 | H.C.C. COMMENTS

STATE OF MARYLAND
 PROFESSIONAL ENGINEER
 RAYMOND L. GOODSON, R. E.

OWNER - DEVELOPER
 HOWARD COMMUNITY COLLEGE BOARD OF TRUSTEES
 LITTLE PATENT PARKWAY
 COLUMBIA, MARYLAND 21044

ARCHITECTS
 THE OGLESBY GROUP, INC., OGLESBY, WILEY, HALFORD, JOHNSON
 COCHRAN STEPHENSON & DONKERVOET, INC.
 925 NORTH CHARLES STREET
 BALTIMORE, MARYLAND 21202

HOWARD COMMUNITY COLLEGE
 COMMUNICATION ARTS / ADMINISTRATION BLDG.

5TH ELECTION DISTRICT HOWARD CO., MARYLAND
 TAX MAP NO. 35 PARCELS A, B, C, 47 & 50

SITE DETAILS

SD
 1.06

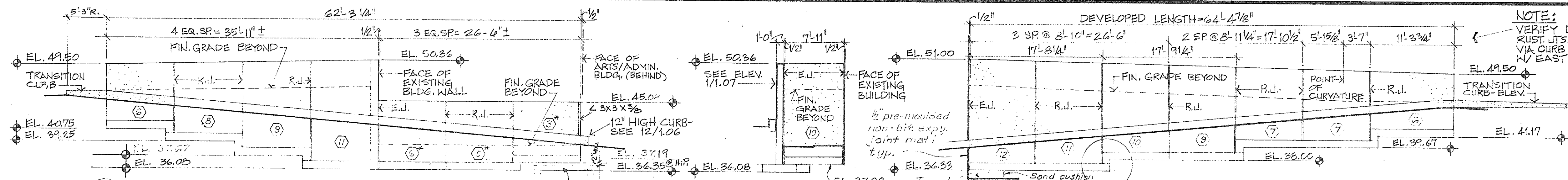

1 ELEV.-EAST RETAINING WALL @ DOCK #1 DRIVE
 2 WALL S. OF PLANTER #6
 3 DEVELOPED ELEV.-WEST RETAINING WALL @ DOCK #1 DRIVE

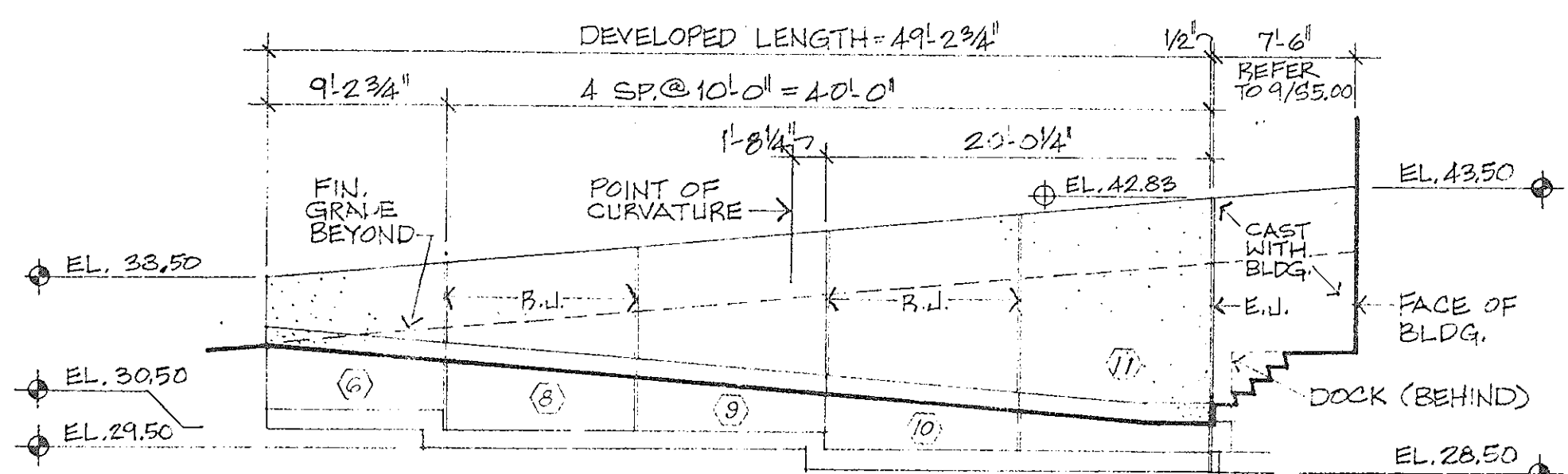

4 DEVELOPED ELEV.-RET. WALL @ DOCK DRIVE #2

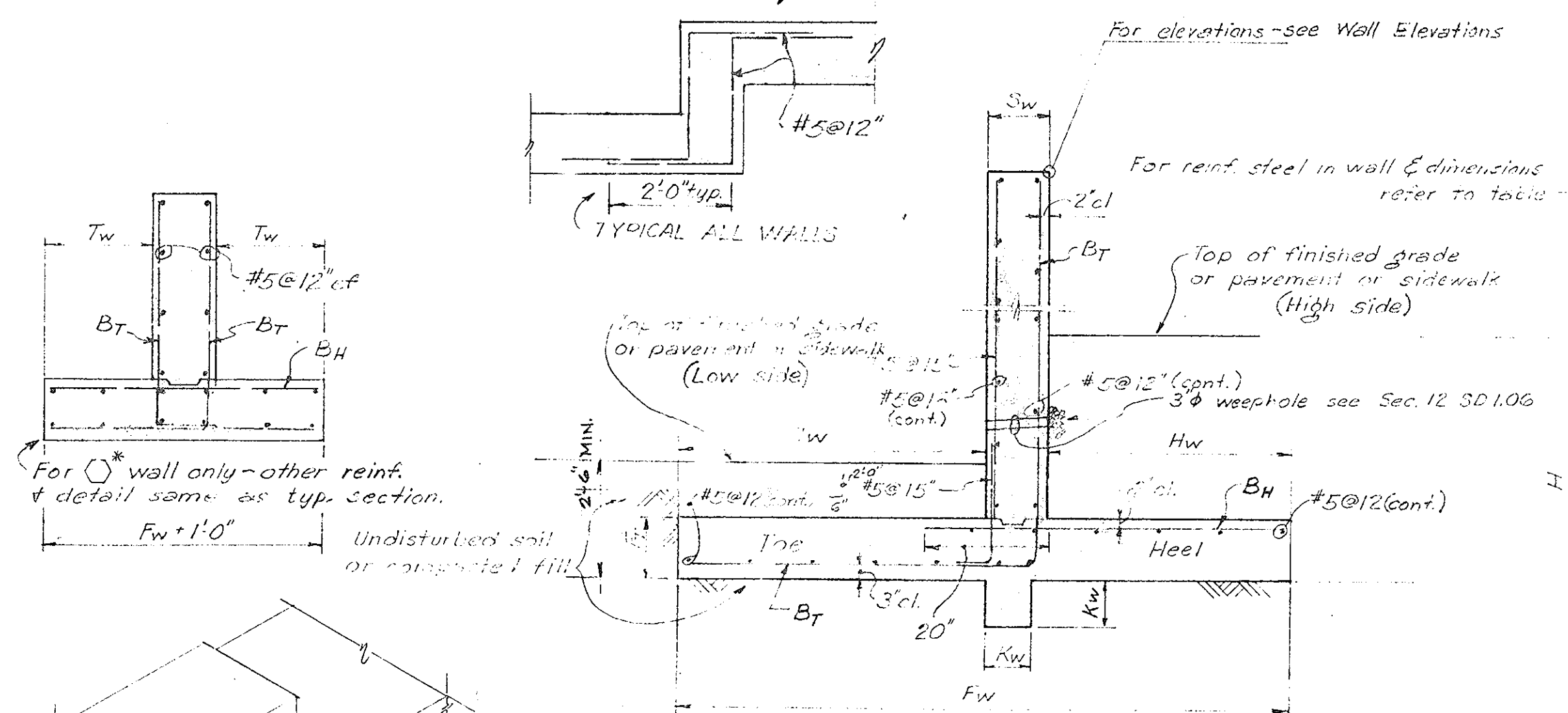

TYPICAL RETAINING WALL SECTION
 Scale 1/2" = 1'-0"

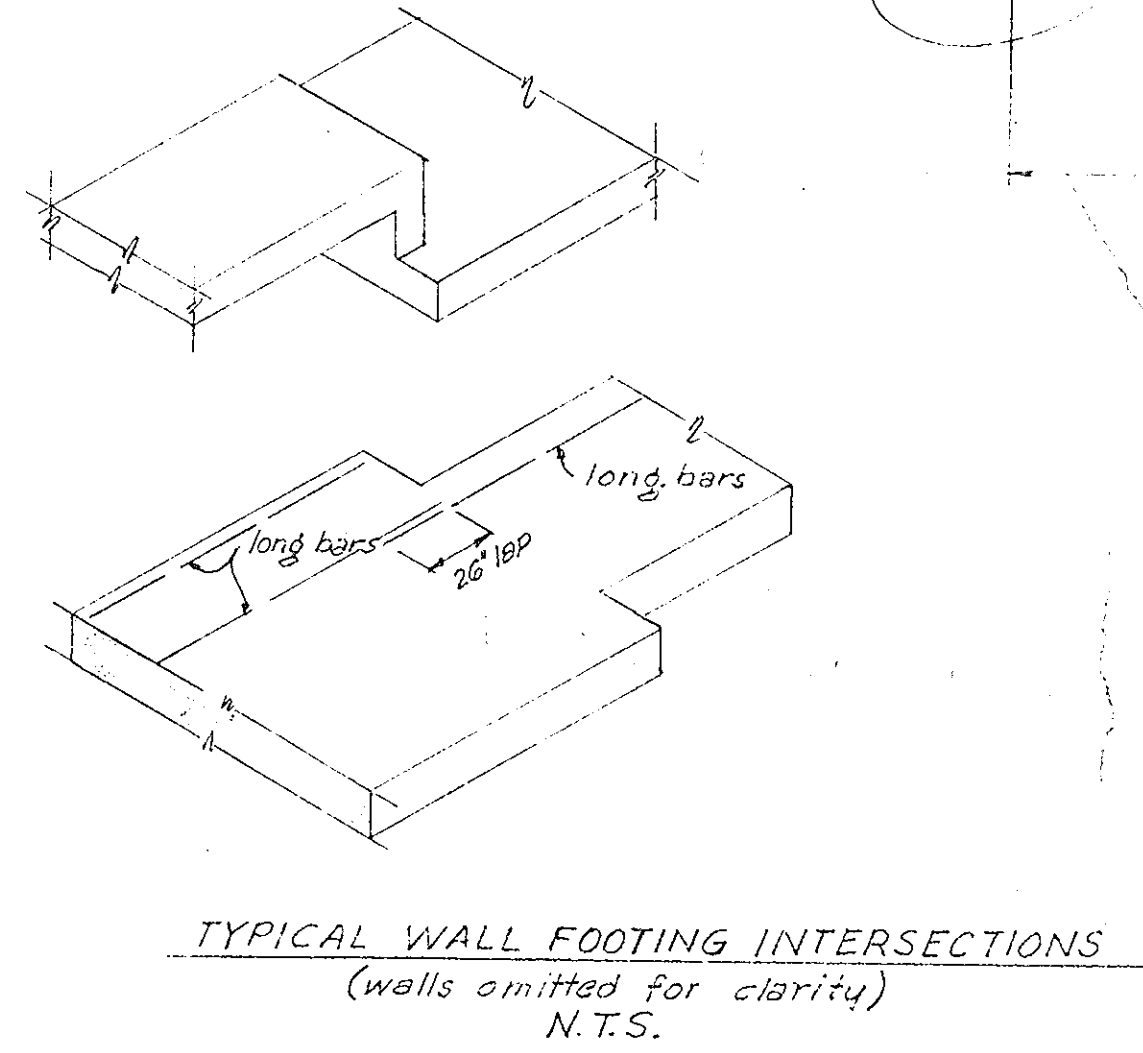

TYPICAL WALL FOOTING INTERSECTIONS
 (walls omitted for clarity)
 N.T.S.

H	F _w	T _w	S _w	H _w	F _t	K _w	B _t	B _H
3	2'-6"	1'-9"	1'-0"	5'-3"	1'-0"	9"	5'-0"	5'-10"
6	5'-8"	2'-10"	1'-0"	1'-0"	1'-0"	9"	5'-10"	5'-10"
7	6'-4"	3'-2"	1'-0"	2'-2"	1'-0"	9"	5'-10"	5'-10"
8	7'-0"	3'-6"	1'-0"	2'-6"	1'-0"	9"	5'-10"	5'-10"
9	7'-9"	3'-10"	1'-0"	2'-10"	1'-0"	9"	5'-10"	5'-10"
10	8'-6"	4'-3"	1'-0"	3'-3"	1'-0"	9"	6'-11"	6'-12"
11	9'-2"	4'-7"	1'-0"	3'-7"	1'-0"	9"	6'-8"	6'-9"
12	9'-10"	4'-11"	1'-0"	3'-11"	1'-0"	9"	6'-6"	6'-7"

Enter table with H as noted thus \bigcirc on partial elevations.

GENERAL NOTES FOR RET. WALLS
 f_c = 3000 psi
 f_y = 60,000 psi
 Wall designed for 40#_{hr} horl. pressure
 & 2' surcharge
 Max toe pressure 2000 psf.

APPROVED
 DIVISION OF LAND DEVELOPMENT
 AND TRANSPORTATION PLANNING
 HOWARD COUNTY, MARYLAND
 DATE 11-24-75

APPROVED: FOR PUBLIC WATER AND PUBLIC SEWERAGE, STORM DRAINAGE SYSTEMS & ROADS, HOWARD COUNTY DEPARTMENT OF PUBLIC WORKS. DIRECTOR: <i>W. C. Schatz</i> 12-8-75 DATE: 12/4/75 BUREAU OF HIGHWAYS	APPROVED: HOWARD COUNTY OFFICE OF PLANNING AND ZONING. PLANNING DIRECTOR: <i>William J. Haney</i> 12-17-75 DATE: 12/17/75 CHIEF, DIVISION OF LAND DEVELOPMENT & TRANSPORTATION PLANNING	APPROVED: FOR PUBLIC WATER AND PUBLIC SEWERAGE SYSTEMS, HOWARD COUNTY HEALTH DEPARTMENT. COUNTY HEALTH OFFICER: <i>Robert W. ...</i> 11/16/75 DATE: 11/16/75	REVISIONS NO. BY DATE DESCRIPTION 1 G.S. 10/1/75 NOTE 2 G.S. 11/6/75 H.G.O. COMMENTS		OWNER - DEVELOPER HOWARD COMMUNITY COLLEGE BOARD OF TRUSTEES LITTLE PATUXENT PARKWAY COLUMBIA MARYLAND 21044 ARCHITECTS THE OGLESBY GROUP - INC. OGLESBY, WILSEY, HALFORD, JOHNSON COCHRAN STEPHENSON & DONKEROEFT INC. 925 NORTH CHARLES STREET BALTIMORE MARYLAND 21202	HOWARD COMMUNITY COLLEGE COMMUNICATION ARTS / ADMINISTRATION BLDG. 5TH ELECTION DISTRICT HOWARD CO, MARYLAND TAX MAP NO. 35 PARCELS A, B, C, 47 & 50 SITE DETAILS
---	--	--	---	--	---	---