

ESTIMATED TRAFFIC DATA
 TAMAR DRIVE
 AVERAGE DAILY 6000 VEH
 PEAK HOUR (10% ADT) 600 VEH
 80 UNITS
 AVERAGE DAILY STRIPS/DU 6000 VEH
 PEAK HOUR (0.6/DU) 4800 VEH

LEGEND
 EXISTING CONTOURS ——— [410]
 FINISHED CONTOUR ——— [410]
 FIRST FLOOR ELEVATION FT 413.18
 TERRACE FLOOR ELEVATION TER FT 417.46
 SRT ELEVATION +175'
 DIRECTION OF DRAINAGE
 CONCRETE WALK
 UNDERGROUND RAIN DRAIN
 REVISIONS REQUIRED BY SH

NOTES
 (1) ALL DIMENSIONS ARE SCALED AND SUBJECT TO ADJUSTMENT ON FINAL STAKE-OUT DRAWING. THE CONTRACTOR SHALL BE RESPONSIBLE FOR THE FINAL STAKE-OUT DRAWING.
 (2) ALL DRIVEWAY AREAS TO BE SLOPED TO DRAIN TO EXISTING COLLECTION SYSTEM.
 (3) ALL DRIVEWAY AREAS TO BE PAVED WITH 4" ASPHALT.
 (4) ALL INTERLOCK STREETS TO BE PRIVATE.

TYPICAL SIDEWALK CURB & PAVING SECTION (NO SCALE)

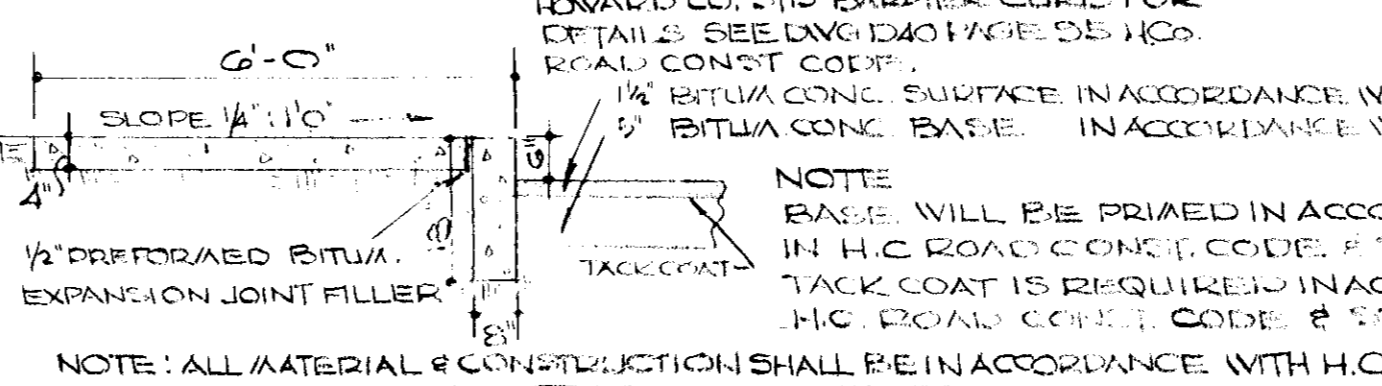

NOTE: ALL MATERIAL & CONSTRUCTION SHALL BE IN ACCORDANCE WITH H.C. ROAD CONST CODE & STANDARD SPECS.

UNIT TABULATION - (NO BASEMENTS)

UNIT NO	TYPE	NO OF GROSS AREA UNITS IN SQ FEET
1	1BR	28
2	2BR	10
3	3BR	6
4	4BR	28
5	5BR	10
TOTAL		80

SITE ANALYSIS

TOTAL AREA PARCEL 1, 2, 3 & 4	706,840 sq ft
LIMIT UNIT ALLOWABLE	243
PROVIDED PHASE I (60 UNITS)	80
TOTAL PROVIDED	243
COVERAGE ALLOWABLE (30%)	212,054 sq ft
PROVIDED (77% PHASE I, 22% PHASE II)	212,054 sq ft
PARKING - 80 DU	110,000 sq ft
REQUIRED (1/2.1 RATIO)	120
PROVIDED	121
ZONING	NEWTOWN (APTS)

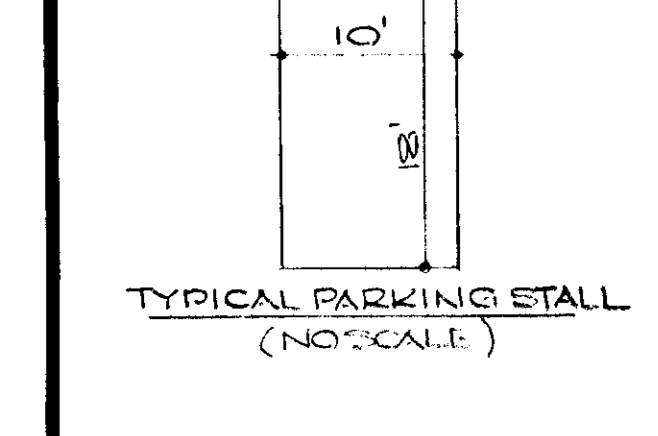
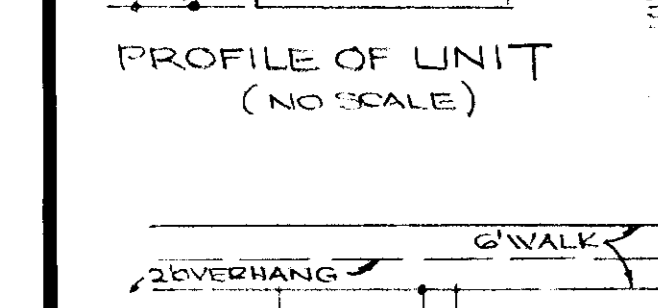
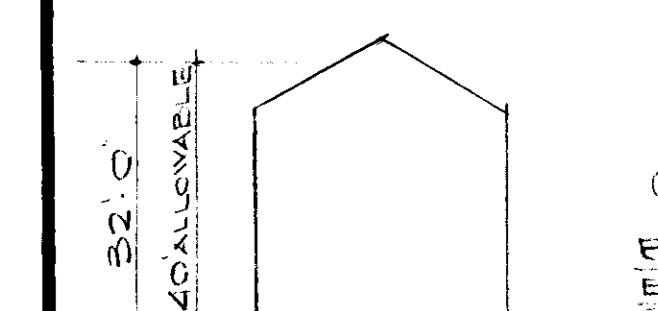
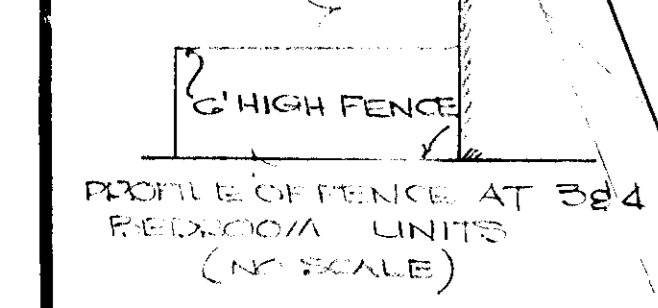

APPROVED
 DIVISION OF LAND DEVELOPMENT AND TRANSPORTATION PLANNING
 HOWARD COUNTY, MARYLAND
 APR 1 1975

Reviewed For HOWARD S.C.D. and Meets Technical Requirements.
 Eric V. Morrison
 U.S. SOIL CONSERVATION SERVICE
 This Development Plan is Approved for Soil Erosion and Sediment Control by the Howard Soil Conservation District.
 APPROVED Robert W. Zahms Date 9/15/75
 Howard S.C.D.

FILE NUMBER	PLAN IDENTIFICATION
OWNERS NAME NATIONAL CORPORATION	ADDRESS 1135 FIFTEENTH ST NW WASH DC 20005
TELEPHONE NO 202 466 8200	DATE 20075
PROGRESS DATA CHART	DATE INITIALS
DATE OF ORIGINAL SUBMISSION	
RETURNS	
REVISIONS REC'D BY HC PC	
APPROVAL OF SITE PLAN	
BUILDING PERMIT APPLICATION REC'D	
BUILDING PERMIT APPLICATION RELSD	
USE OCCUPANCY APPLICATION REC'D	
USE OCCUPANCY FIELD INSPECTION	
USE OCCUPANCY PERMIT REC'D	
APPROVED FOR PUBLIC WATER, PUBLIC SEWERAGE SYSTEMS HOWARD COUNTY HEALTH DEPARTMENT.	DATE 4/30/75
COUNTY HEALTH OFFICER	
APPROVED HOWARD COUNTY OFFICE OF PLANNING AND ZONING	DATE 5-2-75
PLANNING DIRECTOR	
CHIEF OF PLANNING AND ZONING	
APPROVED FOR PUBLIC WATER, PUBLIC SEWERAGE AND STORAGE DRAINAGE SYSTEMS, ROADS HOWARD COUNTY DEPARTMENT OF PUBLIC WORKS.	DATE 4/21/75
DIRECTOR	
CHIEF OF BUREAU OF HIGHWAYS	

GEN BOLT GORE NEWKIST PARKINER CIVIL ENGINEERS & LAND SURVEYORS 1111 BOYFANT STREET SILVER SPRING MARYLAND 583-1111

COLLINS & KRONSTADT LEAHY HOGAN COLLINS
 architects · planners · engineers
 1111 spring street · silver spring, maryland

PHASE II
 SITE PLAN AND STORAGE DRAINAGE PLAN
 VILLAGE OFFICE REACH-GRIFFITH DISTRICT
 PARCEL 1, 2 SECTION 1 AREA 1 PLAT 17 & 18 FOLIO 60
 FINAL DEVELOPMENT PLAN PHASE II 77 P. 1310 FOLIO 50:2 COLUMBIA, MD

910-1

STRUCTURE SCHEDULE				
NO	TYPE	INV IN	INV OUT	TOP
I-7	HOWARD CO STD A-D INLET-DRAIN D-LOD-A	381.5	380.5	388.0
I-8	" " " " " "	385.5	384.5	392.5
I-9	" " " " " "	-	402.5	408.2
I-10	" " " " " "	-	476.0	380.5
I-11	" " " " " "	400.0	399.4	403.5

PIPE SCHEDULE		
SIZE	TYPE	LENGTH
15"	RCP C.I. III	244'
15"	RCP C.I. III	214'

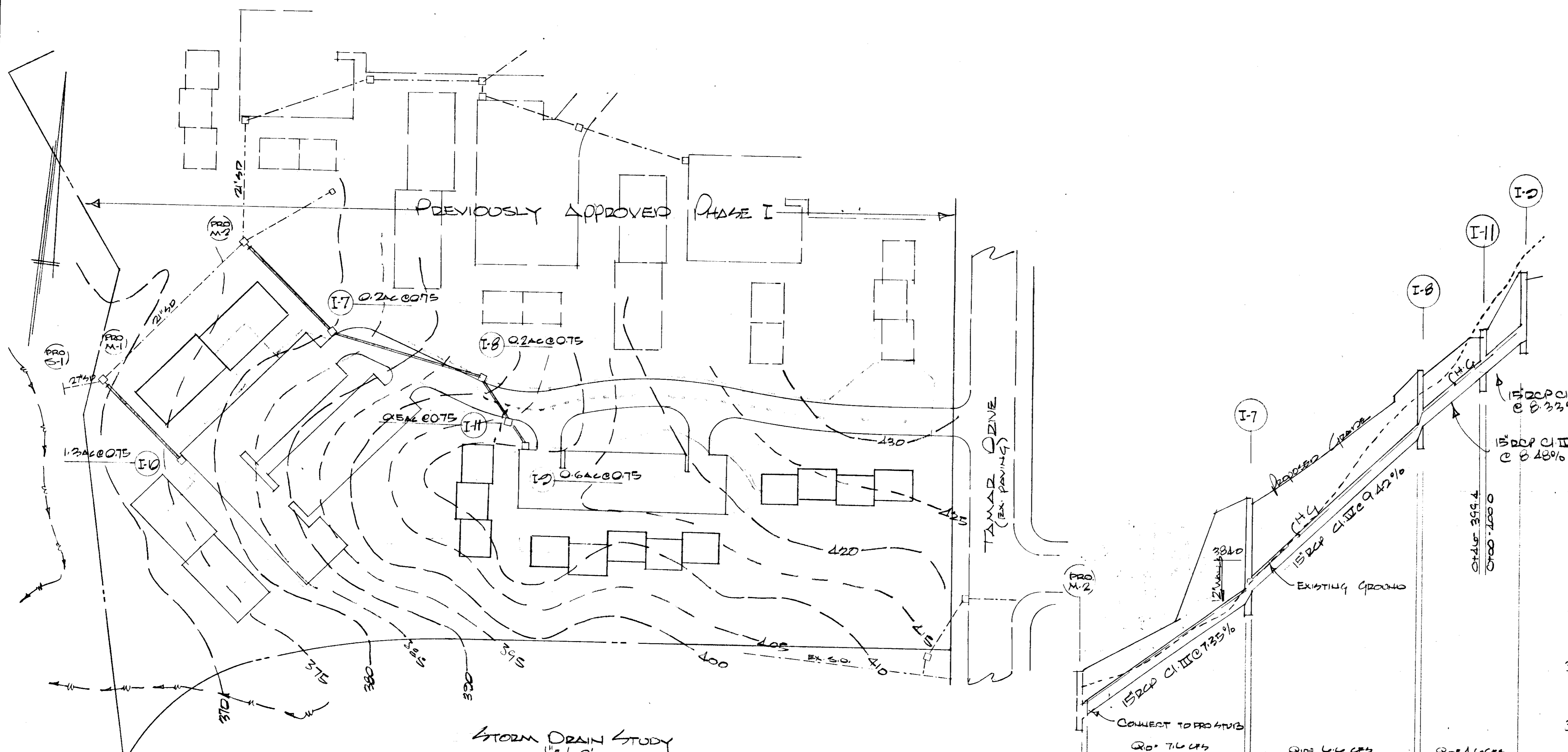
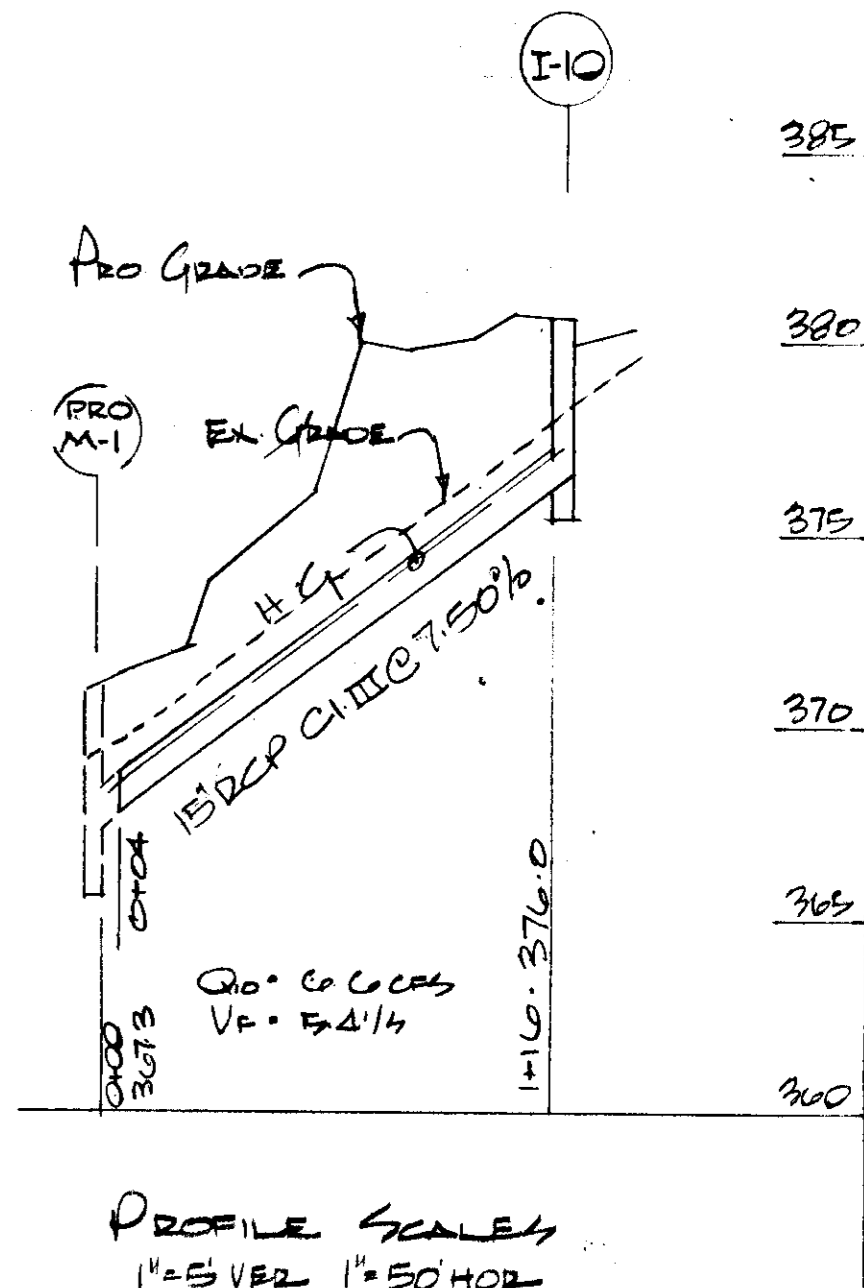

APPROVED
 DIVISION OF LAND DEVELOPMENT
 AND TRANSPORTATION PLANNING
 HOWARD COUNTY, MARYLAND
 DATE: APR 1, 1975
[Signature]

Reviewed For HOWARD NAME S.C.D. and Meets
 Technical Requirements.
 Signature: Eric V. Morgan Date: 4/15/75
 U.S. SOIL CONSERVATION SERVICE
 This Development Plan is Approved For Soil Erosion
 And Sediment Control by the Howard Soil Conservation
 District.
 Approved: Robert Ziehm Date: 4/15/75
 HOWARD S.C.D.

File Number	Plan Identification	Owner's Name	Address	Telephone No.	Progress Data Chart	Date	Initials
		NATIONAL CORPORATION for HOUSING PARTNERSH PS	123 FIFTEENTH ST. NW. WASH DC. 20005	202-466-8200			

APPROVED: For Public Water & Public Sewerage Systems
 Howards County Health Department
[Signature] DATE: 4/30/75
 COUNTY HEALTH OFFICER
 APPROVED: Howards County Office of Planning & Zoning
 PLANNING OFFICER
[Signature] DATE: 5-2-75
 APPROVED: For Public Water, Public Sewerage and Storm Drainage Systems and Roads
 Howards County Department of Public Works
[Signature] DATE: 4/18/75
 CHIEF BUREAU OF HIGHWAYS

NOTE: ALL ROOFTOP & PAVED AREAS COMPUTED AS 0.3 RUNOFF & LAWN AREAS AS 0.3 RUNOFF

STORM DRAIN STUDY
 1" = 60'



SEYBOLT GORE NEWQUIST & BERLINSKY
 CIVIL ENGINEERS & LAND SURVEYORS
 111 BONIFANT STREET
 SILVER SPRING, MARYLAND
 589-1111

REVISED TO FIELD FOR BROWNSVILLE FROM COMMITMENT JAN 1975
 PROJECTS 25
 CO-210-774
 F.H.A.
 FETS 23 1-75
 ISSUED

COLLINS & KRONSTADT code 301
LEAHY · HOGAN · COLLINS 587-8642
 architects · planners · engineers
 1111 spring street · silver spring, maryland

STORM DRAIN STUDY (PROFILES) - PHASE II
 PARCEL "D" SECTION I AREA I PLAT BOOK 1 FOLIO 60
 FINAL DEVELOPMENT PLAN PHASE II - PRELIMINARY 50-72 COL, MD

SID-2

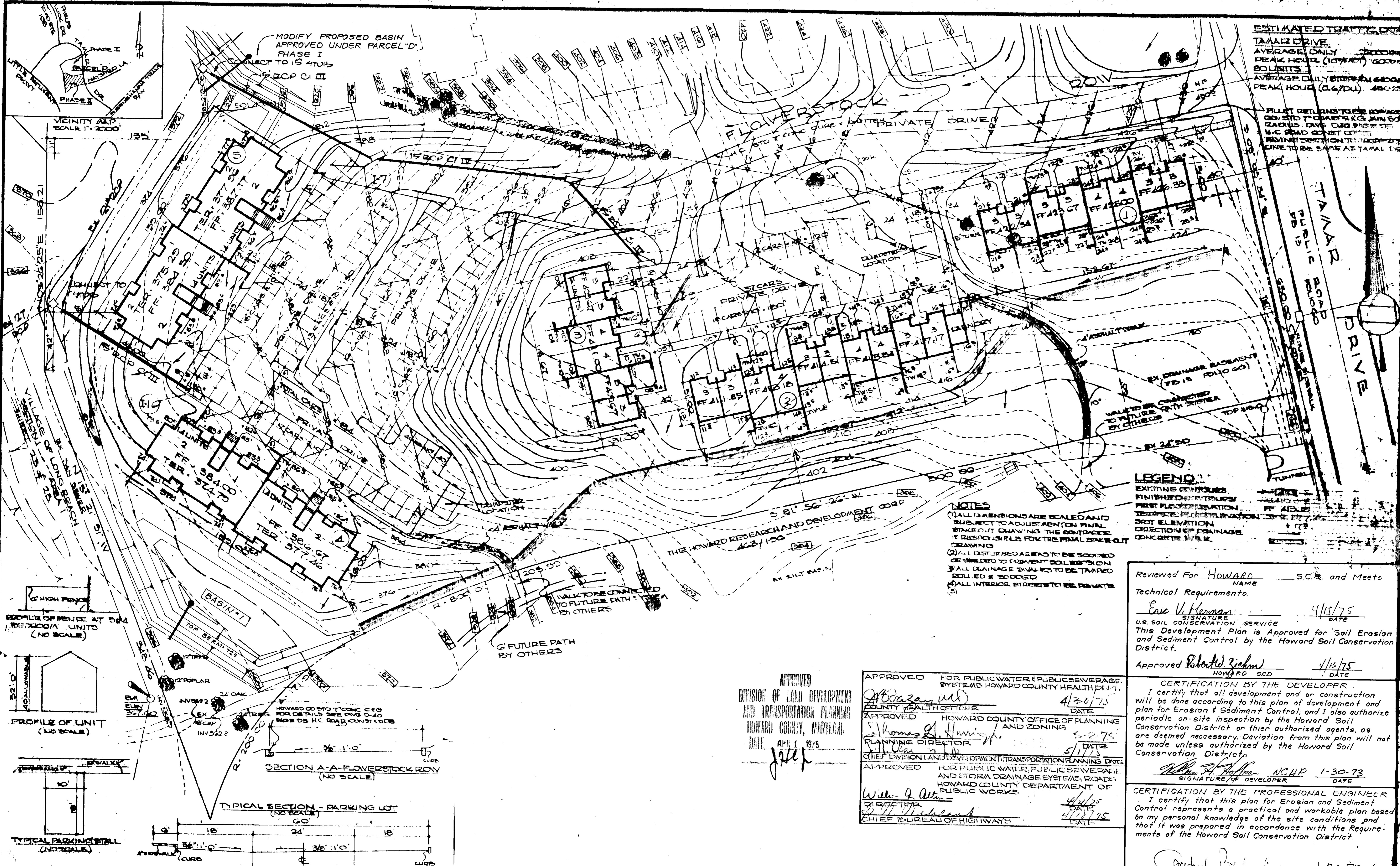

ESTIMATED TRAFFIC DATA
TANAR DRIVE
 AVERAGE DAILY TRAFFIC 12000
 PEAK HOUR (10:00 AM) 6000
 BOUNDRIES
 AVERAGE DAILY TRAFFIC 4000
 PEAK HOUR (6:00 PM) 4000

VICINITY MAP
 SCALE 1" = 2000'

NOTES
 (1) ALL DIMENSIONS ARE SCALED AND SUBJECT TO ADJUSTMENT ON FINAL STAKE OUT DRAWING THE CONTRACTOR IS RESPONSIBLE FOR THE FINAL STAKE OUT DRAWING
 (2) ALL DISTURBED AREAS TO BE SOILED OR RESEED TO SUBVENT SOIL EROSION
 (3) ALL DRAINAGE SWALES TO BE TYPED ROLLED & SOILED
 (4) ALL INTERIOR STREETS TO BE PRIVATE

LEGEND
 EXISTING CONTROLS
 FINISHED ELEVATION
 FIRST FLOOR ELEVATION
 TERRACE FLOOR ELEVATION
 SPT ELEVATION
 DIRECTION OF DRAINAGE
 CONCRETE WALK

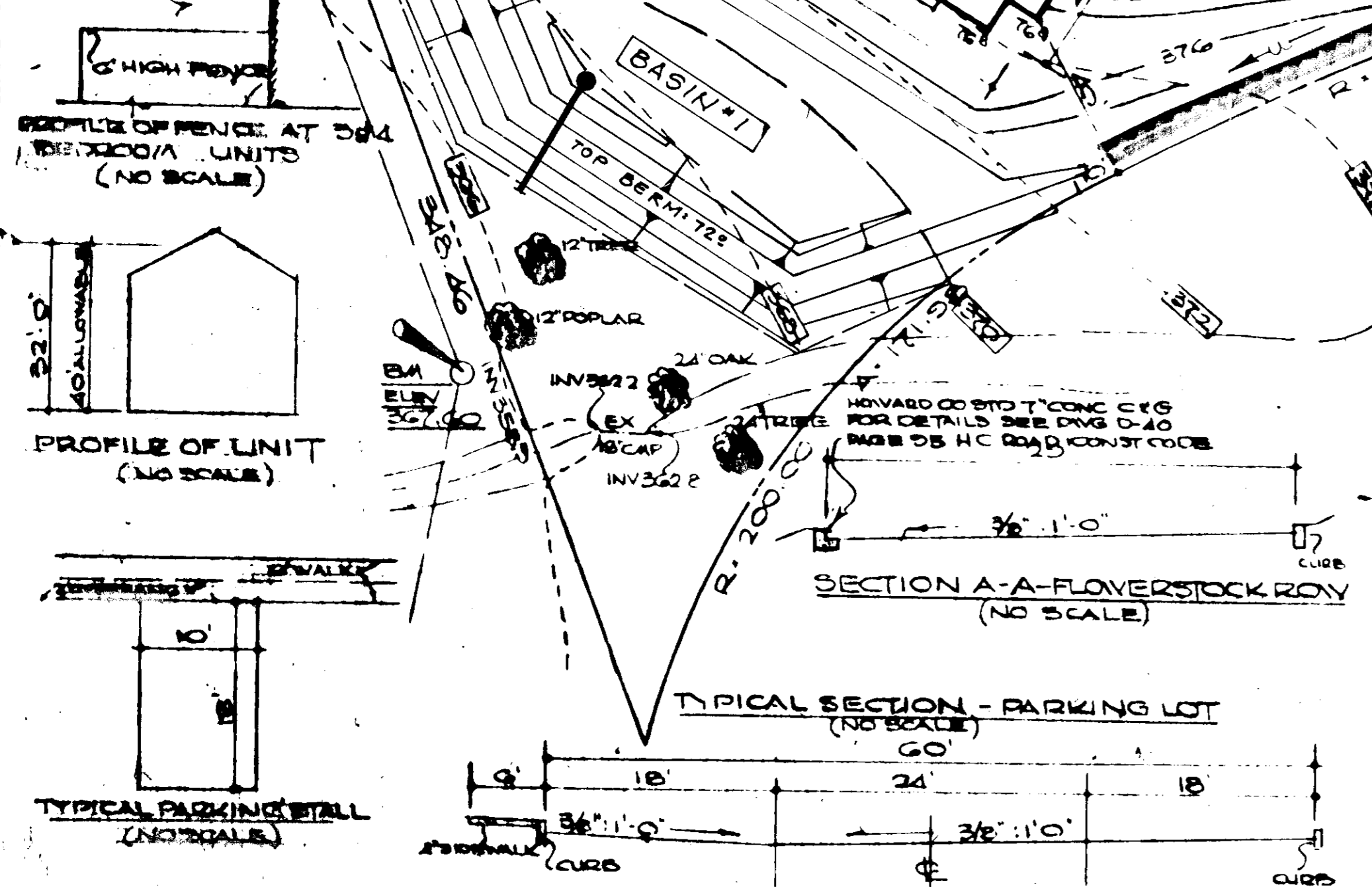

APPROVED
 DIVISION OF LAND DEVELOPMENT
 AND TRANSPORTATION PLANNING
 HOWARD COUNTY, MARYLAND
 DATE APR 1 1975
J. J. [Signature]

APPROVED FOR PUBLIC WATER & PUBLIC SEWERAGE SYSTEMS AS HOWARD COUNTY HEALTH DEPT. COUNTY HEALTH OFFICER
[Signature] 4/20/75
 DATE
 APPROVED HOWARD COUNTY OFFICE OF PLANNING AND ZONING
 PLANNING DIRECTOR
[Signature] 5/2/75
 DATE
 CHIEF DIVISION LAND DEVELOPMENT & TRANSPORTATION PLANNING DATE 5/1/75
 APPROVED FOR PUBLIC WATER, PUBLIC SEWERAGE AND STORM DRAINAGE SYSTEMS, ROADS HOWARD COUNTY DEPARTMENT OF PUBLIC WORKS
 DIRECTOR
[Signature] 4/1/75
 DATE
 CHIEF BUREAU OF HIGHWAYS
[Signature] 4/1/75
 DATE

Reviewed For HOWARD S.C.S. and Meets Technical Requirements
 NAME
Eric V. Herman 4/15/75
 SIGNATURE DATE
 U.S. SOIL CONSERVATION SERVICE
 This Development Plan is Approved for Soil Erosion and Sediment Control by the Howard Soil Conservation District.
 Approved *Robert Zichan* 4/15/75
 HOWARD SCD DATE
CERTIFICATION BY THE DEVELOPER
 I certify that all development and or construction will be done according to this plan of development and plan for Erosion & Sediment Control, and I also authorize periodic on-site inspection by the Howard Soil Conservation District or their authorized agents, as are deemed necessary. Deviation from this plan will not be made unless authorized by the Howard Soil Conservation District.
[Signature] NCHP 1-30-73
 SIGNATURE OF DEVELOPER DATE
CERTIFICATION BY THE PROFESSIONAL ENGINEER
 I certify that this plan for Erosion and Sediment Control represents a practical and workable plan based on my personal knowledge of the site conditions and that it was prepared in accordance with the Requirements of the Howard Soil Conservation District.
[Signature] 1-30-73
 SIGNATURE OF ENGINEER DATE

REVISION TO APPROVED SDP 73-85

SEDIMENT CONTROL PLAN

VILLAGE OF LONGREACH - 6th ELECTION DISTRICT
 PARCEL D SECTION I AREA 1 PLAT BOOK 13 POLIO 10
 FINAL DEVELOPMENT PLAN PHASE 77 PR 10 POLIO 22 COLUMBIA MD

BEYBOLT, GORE, NETZQUIST & BERLINSKY
 CIVIL ENGINEERS & LAND SURVEYORS
 1111 BOHANNAN STREET
 SILVER SPRING, MARYLAND
 582-1111

COLLINS & KRONSTADT 688 3011
LEAHY HOGAN COLLINS 587 8642
 architects · planners · engineers
 1111 spring street · silver spring, maryland

SD-3
 SDP-75-52
 SHEETS OF 4

GENERAL NOTES

- All construction shall be in accordance with the "Standards & Specifications for Soil Erosion & Sediment Control in Urbanizing Areas."
- Sediment Control measures shall be installed & stabilized according to this plan prior to any other grading, clearing, or disturbance of the existing surface of the site.
- Control measures are to remain in place until permission for their removal has been obtained from the Howard Soil Conservation District (425-3180; 425-5000-328)
- Notify the Howard Soil Conservation District at the above numbers 24 hours in advance of starting work.
- Storm Drainage may be constructed, however all inlets are to be capped & remain inoperative until upgrade areas have been stabilized unless otherwise shown.
- Diversion dikes shown thus 
- The amount of excavation & fill as shown on these plans has been computed to be 7000 cubic yards of excavation & 4800 cubic yards of fill.
- Approval of this plan is conditional upon the approval of a Sediment Control Plan for the off-site waste or borrow areas prior to the import of any borrow or export of any waste to or from this site.
- Lawn & Embankment areas shall be stabilized in accordance with Sections 3.100 - 3.104 of the above Specifications & as follows:

- Seedbed Preparation
- Apply 2000#/Ac. of ground agricultural lime
 - Apply 1000#/Ac. of 10-10-10 fertilizer
- Seeding
- | | |
|-----------------------------|-----------|
| 70% Kentucky 31 Tall Fescue | } 60%/ac. |
| 20% Bluegrass | |
| 10% Annual Rye Grass | |

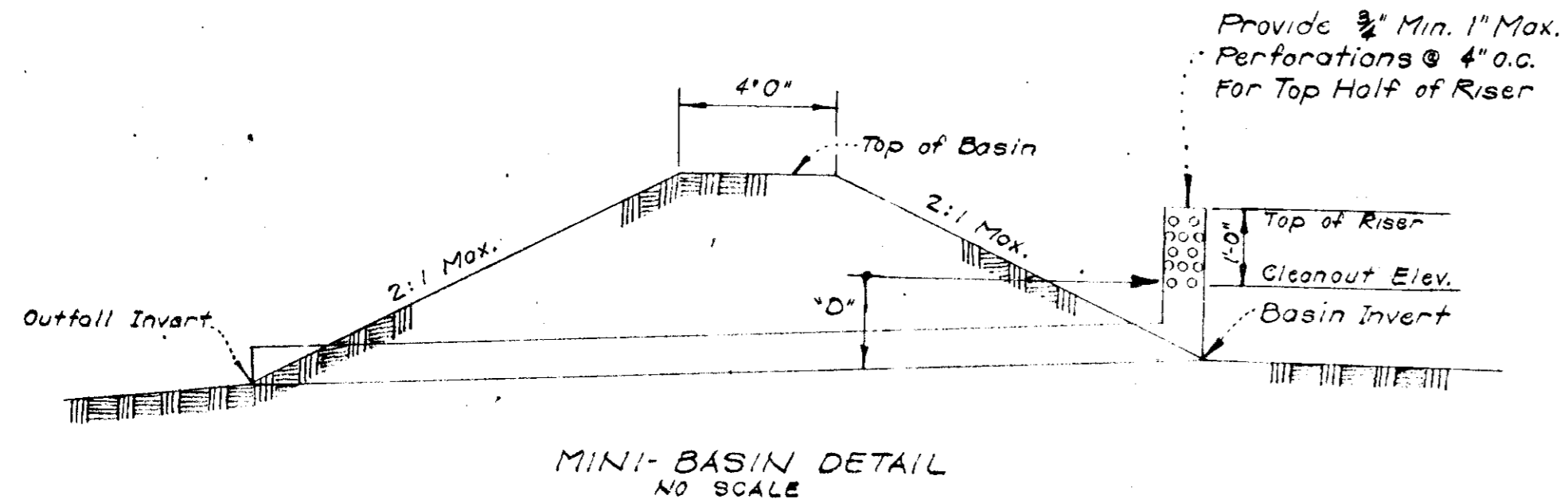

MINI-BASIN TABULATION

Basin #	Top Basin	Top Riser	Basin Inv.	Out Inv.	Drainage Area	"O"	Volume Ret.	Volume Ero.
1	372.0	370.5	367.5	366.5	3,326	10"	270cy	230cy
2								
3								
4								

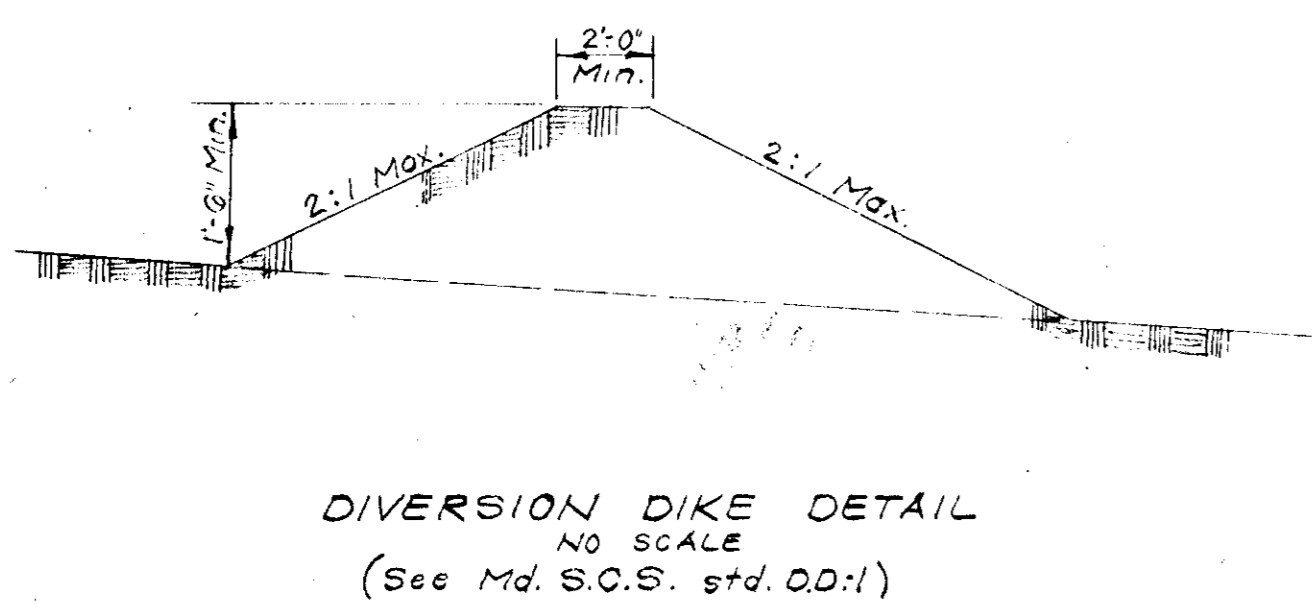

APPROVED FOR PUBLIC WATER & PUBLIC SEWERAGE SYSTEMS, HOWARD COUNTY HEALTH DEPARTMENT. DATE: 4/30/75

APPROVED HOWARD COUNTY OFFICE OF PLANNING AND ZONING. DATE: 5-2-75

APPROVED FOR PUBLIC WATER, PUBLIC GATEWAY AND STORM DRAINAGE SYSTEMS, LOCAL HOWARD COUNTY DEPARTMENT OF PUBLIC WORKS. DATE: 4/24/75

APPROVED FOR PUBLIC WATER, PUBLIC GATEWAY AND STORM DRAINAGE SYSTEMS, LOCAL HOWARD COUNTY DEPARTMENT OF PUBLIC WORKS. DATE: 4/18/75

Reviewed for HOWARD COUNTY S.C.D. and Meets Technical Requirements. DATE: 4/15/75

U.S. SOIL CONSERVATION SERVICE. This Development Plan is Approved for Soil Erosion and Sediment Control by The Howard Soil Conservation District. APPROVED: Robert W. Zichm. DATE: 4/15/75

CERTIFICATION BY THE DEVELOPER. "I certify that all development and or construction will be done according to this plan of development and plan for Erosion & Sediment Control, and I also authorize periodic on-site inspection by the Howard Soil Conservation District or their authorized agents, as are deemed necessary. Deviation from this will not be made unless authorized by the Howard Soil Conservation District." SIGNATURE OF DEVELOPER: William H. Hoffman NCHP. DATE: 1-30-73

CERTIFICATION BY THE PROFESSIONAL ENGINEER. "I certify that this plan for Erosion and Sediment Control represents a practical and workable plan based on my personal knowledge of the site conditions and that it was prepared in accordance with the Requirements of the Howard Soil Conservation District." SIGNATURE OF ENGINEER: Robert Paulin. DATE: 1-30-73

APPROVED
DIVISION OF LAND DEVELOPMENT
AND TRANSPORTATION PLANNING
HOWARD COUNTY, MARYLAND
DATE: APR 1 1975



SEYBOLT GORE, NEWQUIST & BERLINSKY
CIVIL ENGINEERS & LAND SURVEYORS
1111 BONIFANT STREET
SILVER SPRING, MARYLAND
589-1111

REVISED
DATE: FEB 25 1975

COLLINS & KRONSTADT code 301
LEAHY · HOGAN · COLLINS 587-8642
architects · planners · engineers
1111 spring street · silver spring, maryland

REVISION TO APPROVED SDP 73-85

SEDIMENT CONTROL PLAN
VILLAGE OF LONGREACH - C&H ELECTION DISTRICT
PARCEL "D" SECTION 1 AREA 1 PLAT BOOK 13 FOLIO 60
FINAL DEVELOPMENT PLAN - ADAMS-77 PL 10 FOLIOS 50-72 (L&M)

SD-4

SHEET 4 of 4

SDP-15-52.c