

- LEGEND**
- Contour Interval 2 Ft.
 - Existing Contours 318
 - Proposed Contours 318
 - Spot Elevations +18
 - Direction Of Drainage
 - Existing Trees To Be Retained
 - Proposed Inlets
 - Proposed Storm Drain Pipe
 - All streets and parking bays to be privately owned and maintained.
 - Plat Reference: Plat Book Folio
 - All Building setback restrictions to be complied with those set forth in Final Development Plan Phase 77-A2 recorded in Plat Book 20 Folios 95 thru 117.
 - Public Water & Sewer to be Utilized.
 - The Area included in this submission is located on Tax Map 36, Parcel "J".
 - Installation of all Traffic Control Devices shall be in accordance with the 1971 Edition of the Manual of Uniform Traffic Control Devices.
 - 100-year Flood Elevation 306.0*
 - Walk Out Basement WOB
 - Optional Deck

- BUFFER PLANT LIST**
- 13-8'-10' Ht. Pinus Stobus
 - 9-6'-8' Ht. Malus Hopa
 - 7-6'-8' Ht. Malus Sargentii
 - 16-6'-8' Ht. Prunus Kwanzan
 - 8-2"-2 1/2" Cal. Acer Saacharum
 - 11-2"-2 1/2" Cal. Quercus Palustris
 - 8-2"-2 1/2" Cal. Platanus Occ.
 - 11-2"-2 1/2" Cal. Acer Rubrum

- SITE ANALYSIS**
- Zone: New Town (Attached Land Use).
 - Area: Residential Lots (50) = 2.082 Acres
Community Owned (1) = 4.151 Acres
Total = 6.233 Acres
 - Max. No. of Units Permitted: 60
 - Number of Units shown: 50
 - Number of Parking Spaces Required: 100
 - Number of Parking Spaces Provided: 104
 - See sheets 5 thru 7 for Sediment and Erosion Control Plans.
 - Type "A" Unit consists of 3 Bedrooms, 2 1/2 Baths with Sunken Living Room.
Type "B" Unit consists of 3 Bedrooms, 2 1/2 Baths with Family Room.
 - Typical building dimensions:

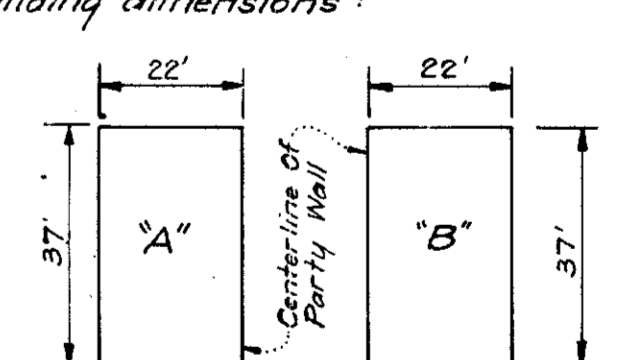

507
OPEN SPACE

POND
El. 395.2
April 15, 1974

VILLAGE OF LONGREACH
SEC. 1
P.B. 21

APPROVED
DIVISION OF LAND DEVELOPMENT
AND TRANSPORTATION PLANNING
HOWARD COUNTY, MARYLAND
DATE FEB 2 1975
JNEC



APPROVED: FOR PUBLIC WATER AND PUBLIC SEWERAGE SYSTEMS, HOWARD COUNTY HEALTH DEPARTMENT
DATE 6/25

APPROVED: HOWARD COUNTY OFFICE OF PLANNING & ZONING
DATE 6/25

APPROVED: FOR PUBLIC WATER AND PUBLIC SEWERAGE STORM DRAINAGE SYSTEMS AND PUBLIC ROADS, HOWARD COUNTY DEPARTMENT OF PUBLIC WORKS
DATE 6/25

CLARK • FINEFROCK & SACKETT
ENGINEERS • PLANNERS • SURVEYORS
11315 LOCKWOOD DRIVE SILVER SPRING, MARYLAND 20904 (301) 593-3403

DESIGNED: W.R.M.E. DATE 6/25
DRAWN: SUZAN DATE 6/25
CHECKED: W.R.M.E. DATE 6/25
DATE: Oct, 1974

SITE DEVELOPMENT PLAN
LOTS J-1 THRU J-51
A RESUBDIVISION OF PARCEL J
COLUMBIA
VILLAGE OF LONGREACH
SECTION 1 AREA 1
6TH ELECTION DISTRICT
HOWARD COUNTY, MARYLAND

FOR: PORETSKY & STARR, Inc.
8401 Connecticut Avenue
Chevy Chase, Maryland 20015

SCALE: 1"=30'
DRAWING: 1 OF 7
JOB NO.: 1128-X
FILE NO.:

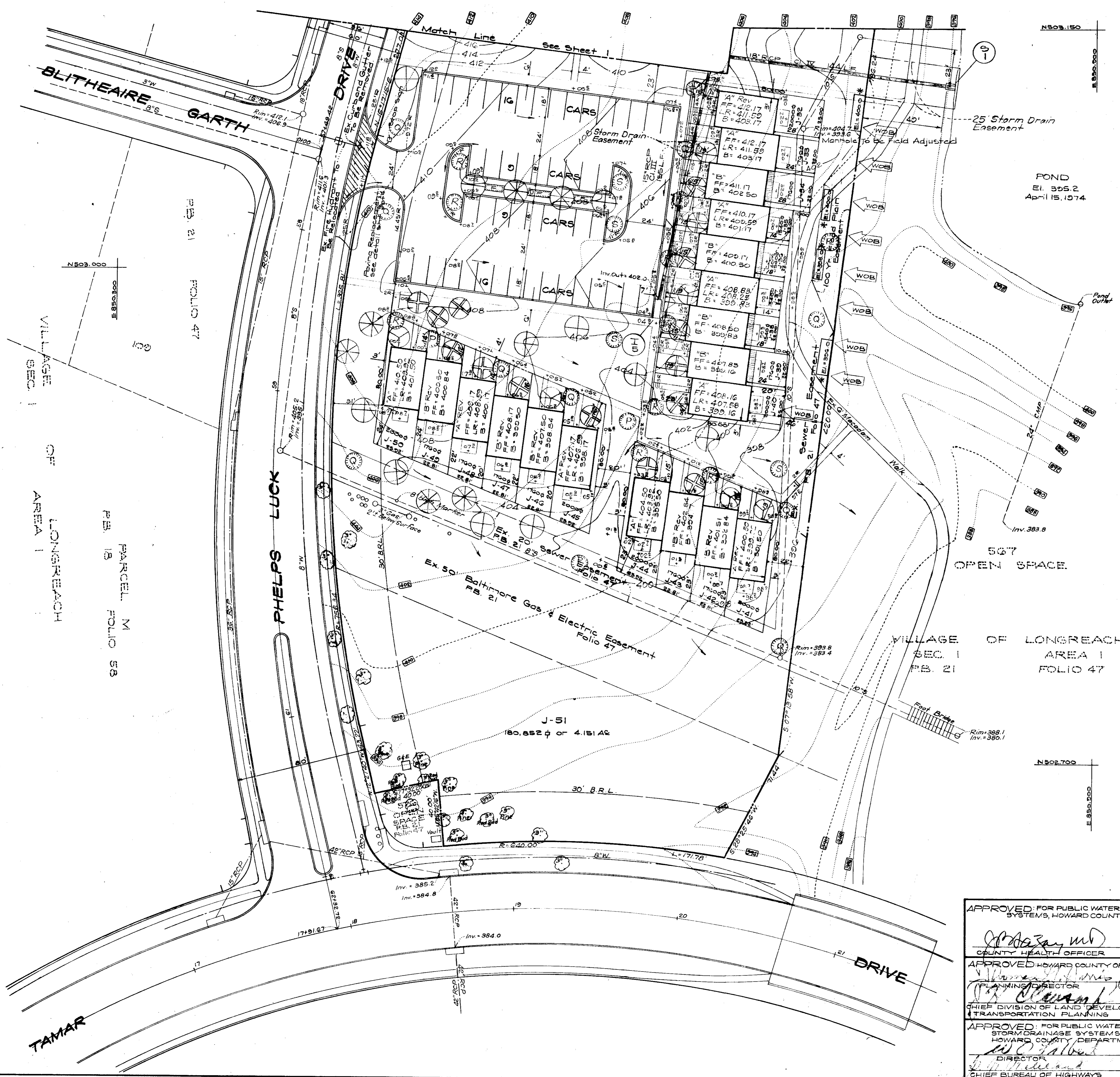

BUFFER PLANT LIST

- ⊕ 11-8'-10' Ht. *Pinus Strobus*
- ⊗ 6-8'-10' Ht. *Thuja Canadensis*
- ⊙ 5-6'-8' Ht. *Malus Hops*
- ⊖ 5-6'-8' Ht. *Malus Sargentii*
- ⊗ 12-6'-8' Ht. *Prunus Kwanzan*
- ⊙ 4'-2"-2 1/2" Cal. *Acer Saccharum*
- ⊙ 9'-2"-2 1/2" Cal. *Quercus Palustris*
- ⊙ 5'-2"-2 1/2" Cal. *Platanus Occ.*
- ⊙ 9'-2"-2 1/2" Cal. *Acer Rubrum*
- ⊖ 42-3'-4' Ht. *Forsythia Linwood Gold*

APPROVED
 DIVISION OF LAND DEVELOPMENT
 TRANSPORTATION PLANNING
 HOWARD COUNTY, MARYLAND
 DATE FEB 2 1975

J. Key



H. N. Lem Clark
 April 9, 1974

APPROVED FOR PUBLIC WATER AND PUBLIC SEWERAGE SYSTEMS, HOWARD COUNTY HEALTH DEPARTMENT

[Signature] 6/15/75
 COUNTY HEALTH OFFICER DATE

APPROVED HOWARD COUNTY OFFICE OF PLANNING & ZONING

[Signature] 6/15/75
 PLANNING DIRECTOR DATE

[Signature] 6/15/75
 CHIEF DIVISION OF LAND DEVELOPMENT & TRANSPORTATION PLANNING DATE

APPROVED FOR PUBLIC WATER AND PUBLIC SEWERAGE STORM DRAINAGE SYSTEMS AND PUBLIC ROADS HOWARD COUNTY DEPARTMENT OF PUBLIC WORKS

[Signature] 6/15/75
 DIRECTOR DATE

[Signature] 5/17/75
 CHIEF BUREAU OF HIGHWAYS DATE

CLARK • FINEFROCK & SACKETT ENGINEERS • PLANNERS • SURVEYORS 1105 LOCKWOOD DRIVE SILVER SPRING, MARYLAND 20903 (301) 593-3400		SCALE 1"=30' DRAWING 20F7 JOB NO.
DESIGNED WR.MS. DRAWN SUZON CHECKED WR.MS. DATE Oct. 1974	SITE DEVELOPMENT PLAN LOTS J-1 THRU J-51 A RESUBDIVISION OF PARCEL J COLUMBIA VILLAGE OF LONGREACH SECTION 1 AREA 1 6TH ELECTION DISTRICT HOWARD COUNTY, MARYLAND FOR: PORETSKY & STARR, INC. 8401 Connecticut Avenue Chevy Chase, Maryland 20015	FILE NO. 1123-X

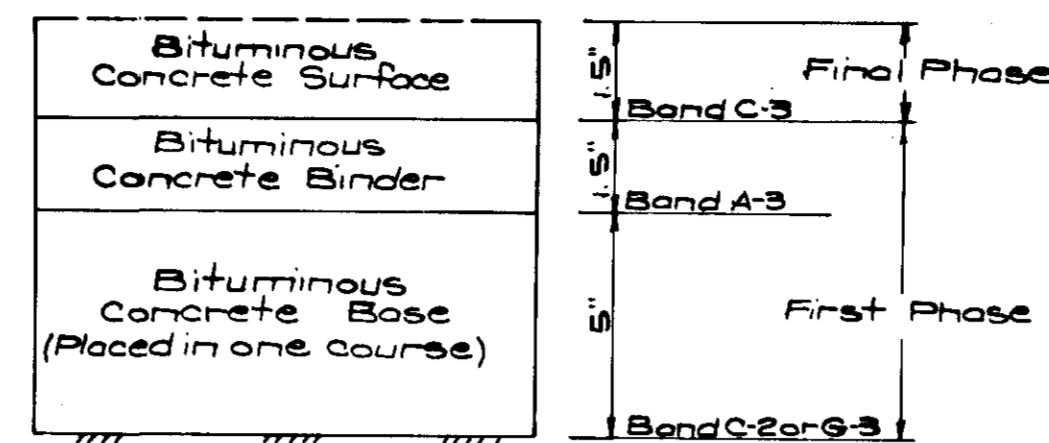
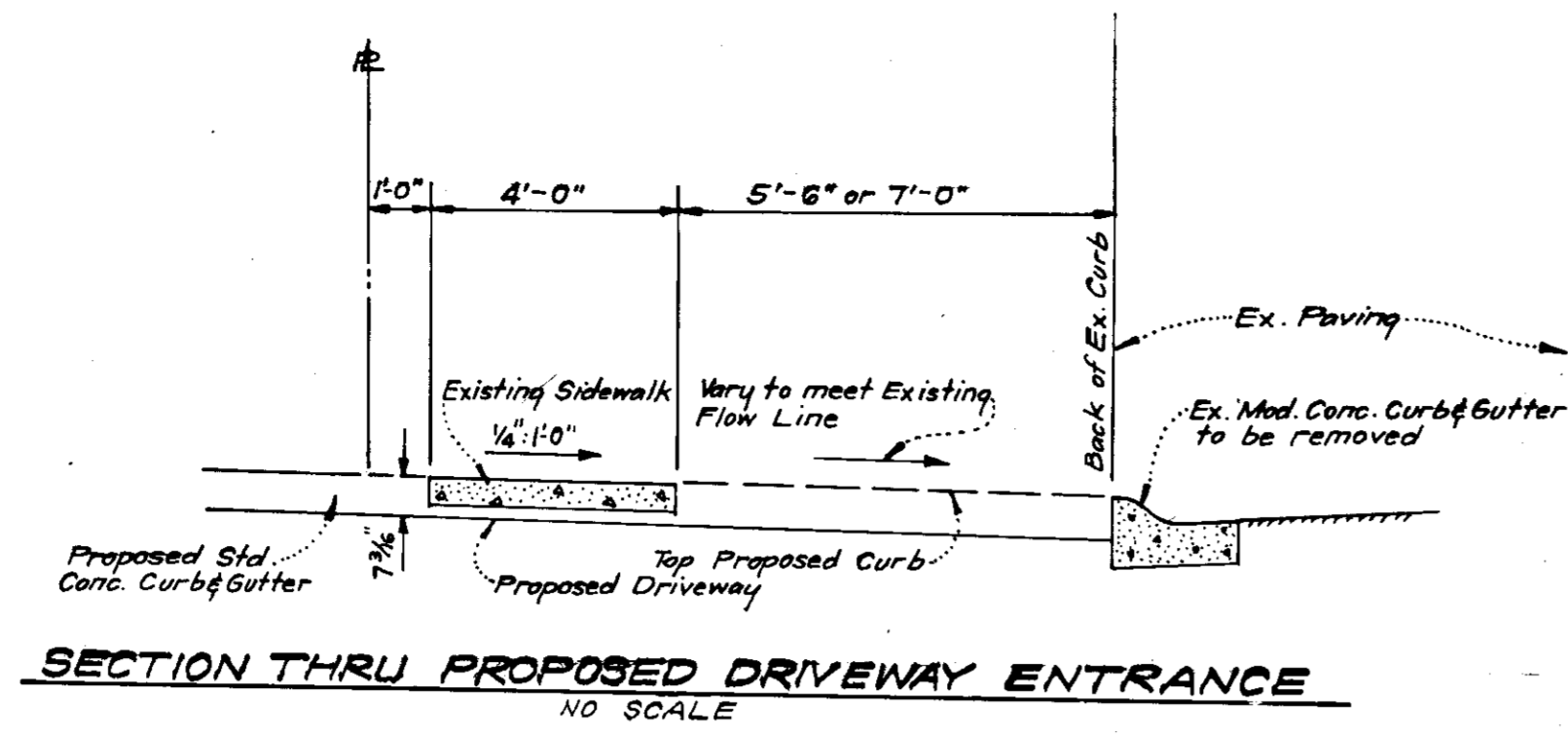

Clearing and Grading Article C-1
 Subgrade Article C-2
 Base Course Article C-31 or C-33
 Binder Course Article C-31
 Surface Course Article C-31

To be constructed in accordance with the Howard County Road Construction Code and Specifications.

PAVEMENT REPLACEMENT FOR ENTRANCES

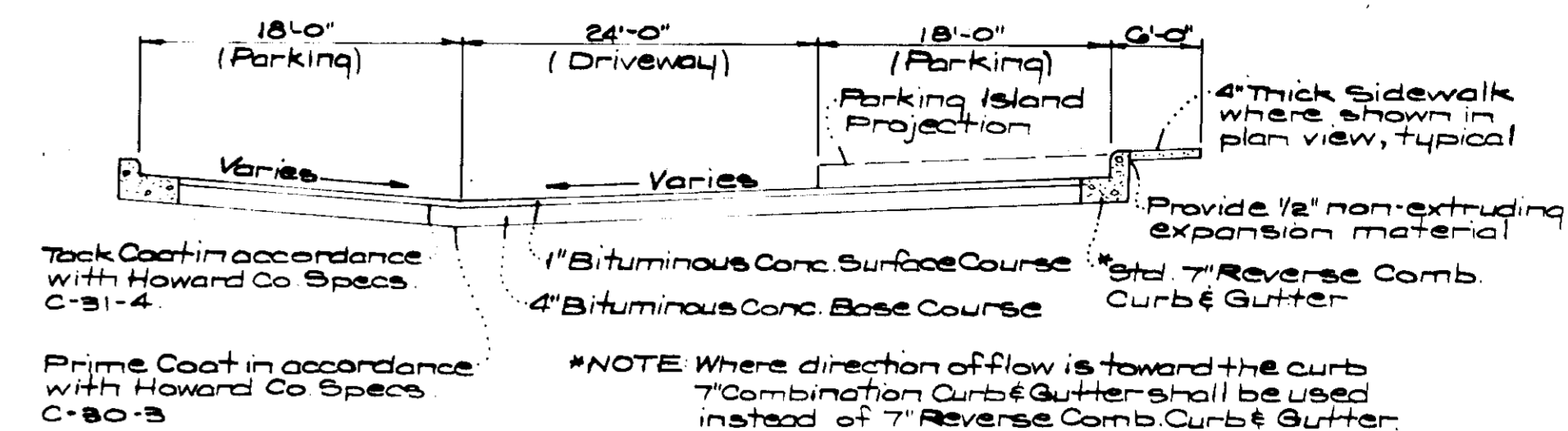

**TYPICAL PAVING SECTION
PRIVATE DRIVES & PARKING**
No Scale

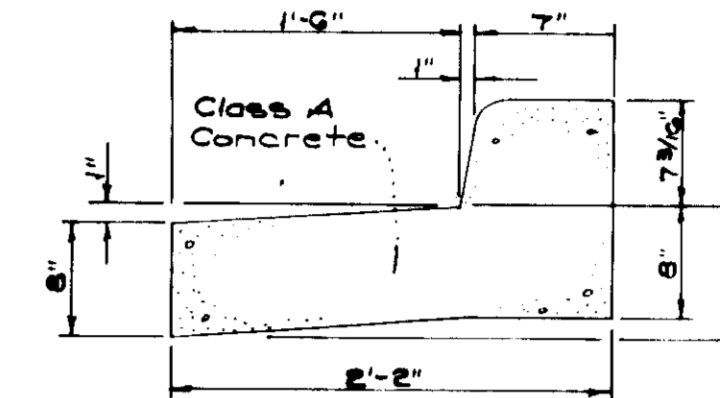

**STD. 7" REVERSE COMBINATION
CURB & GUTTER**
No Scale

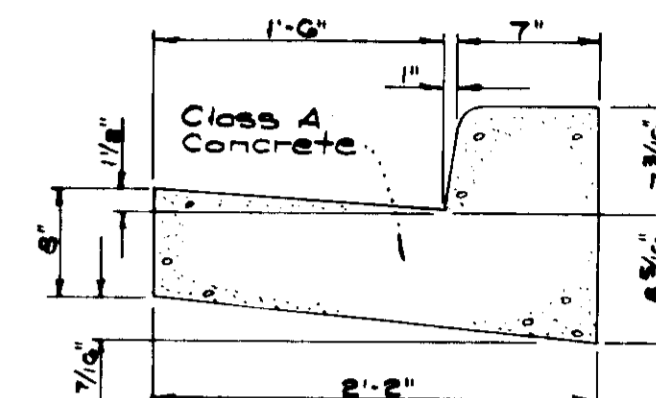

**STD. 7" COMBINATION
CURB & GUTTER**
No Scale

STRUCTURE SCHEDULE						
NO.	TYPE	TOP ELEV.		REMARKS	INV.	
		UPPER	LOWER		IN.	OUT.
* S-1	G-Endwall			Howard Co. Std. RIG D-01 Dia. 18"	395.20	395.80
M-2	Std. Manhole	409.00		" R. 158 D-025	409.00	522.78
I-3	A Inlet Tio	407.80	407.80	" R. 118A D-04A W=3'-0"	404.25	405.70
I-4	A Inlet Tio	410.80	410.80	" " R. 118A D-04A W=2'-0"		407.10
I-5	A Inlet Tio	408.80	408.80	" " R. 118A D-04A W=2'-0"		402.00

* Modify H=2'-0" and W=3'-8"

PIPE SCHEDULE		
SIZE	TYPE	LENGTH
15"	RCP CL III	125'
15"	RCP CL IV	80'
18"	RCP CL IV	144'

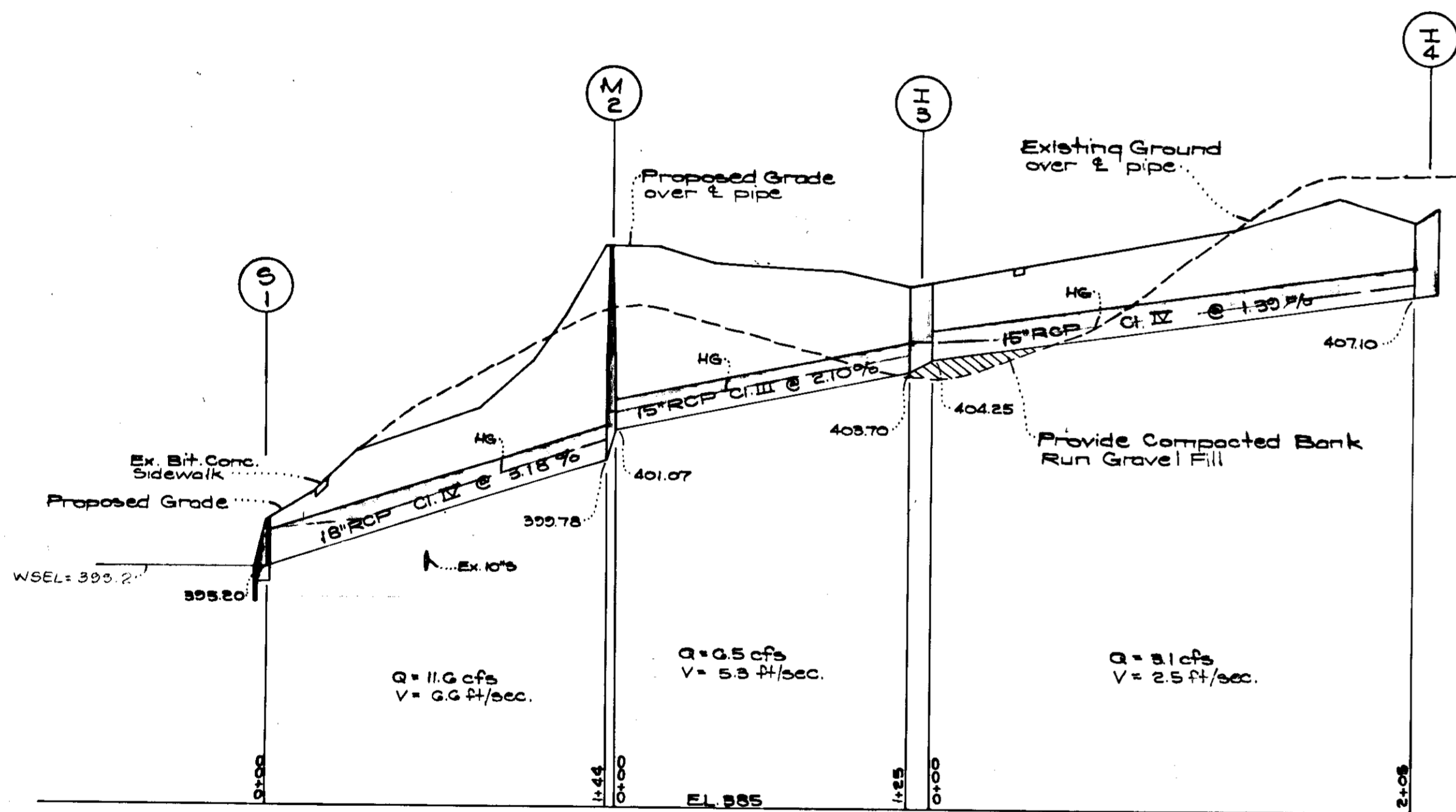

PROFILES

Scale: Horiz. 1"=50'
Vert. 1"=5'

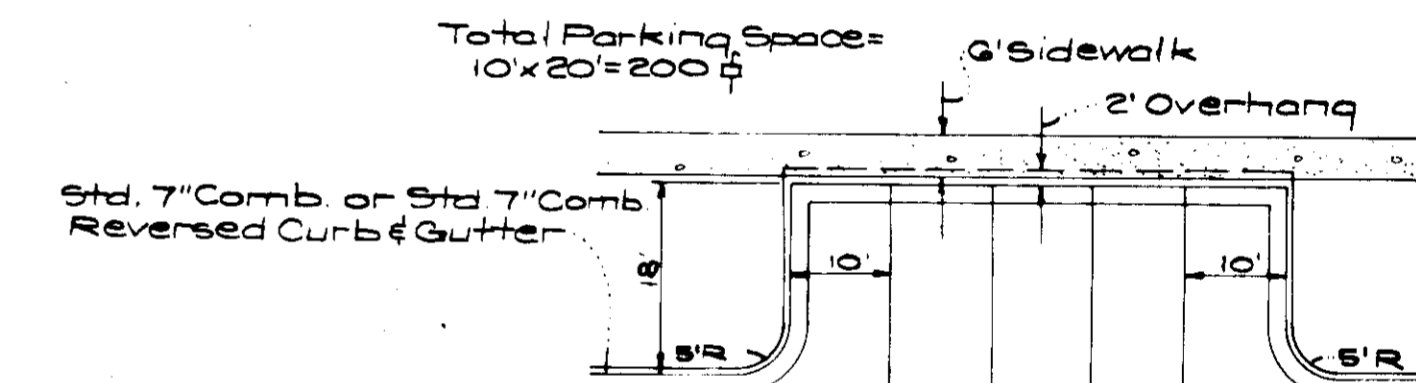
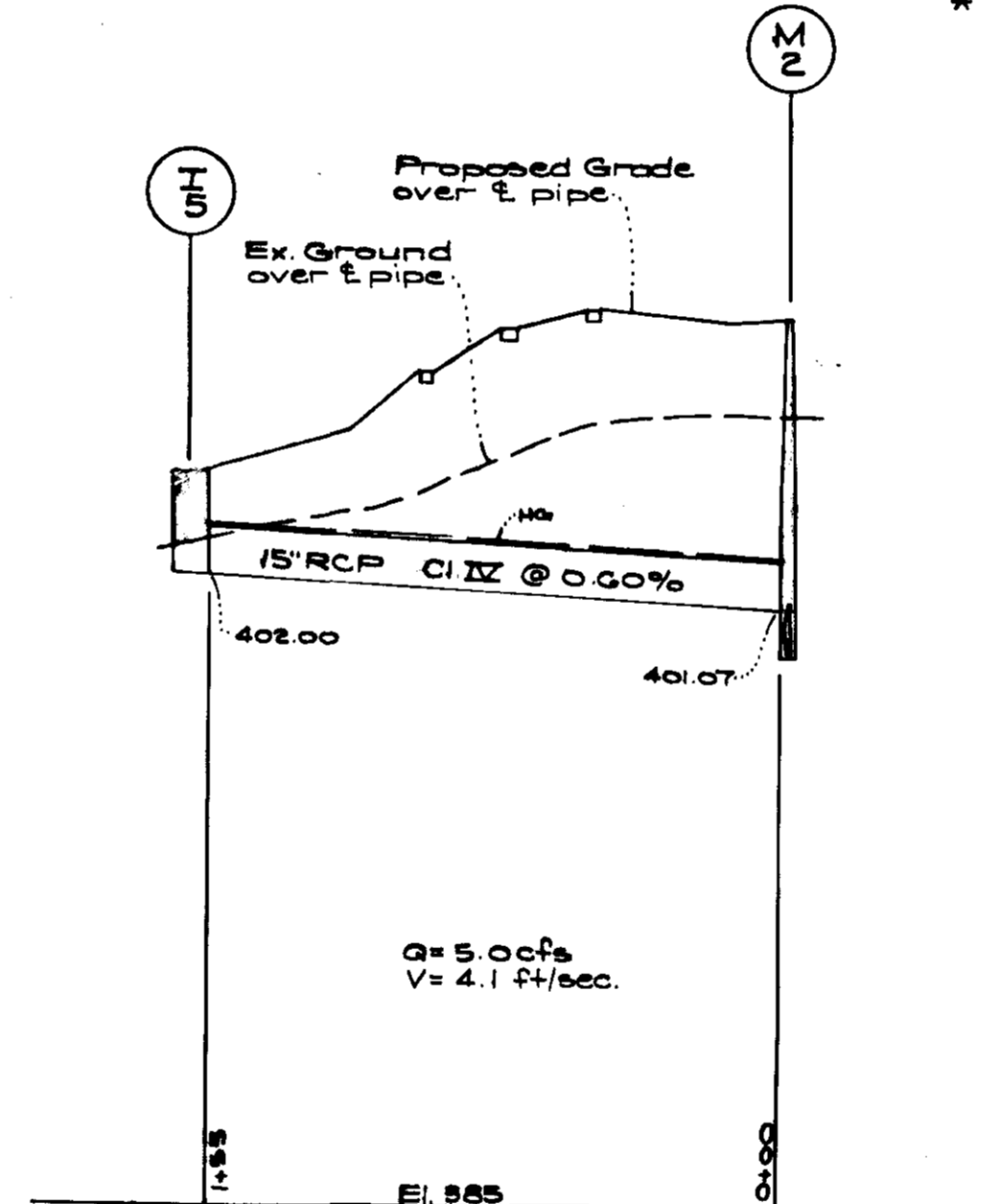

TYPICAL 90° PARKING
No Scale

STORM DRAINAGE GENERAL NOTES

All storm drainage and paving shall be constructed in accordance with the latest details and specifications of Howard County.

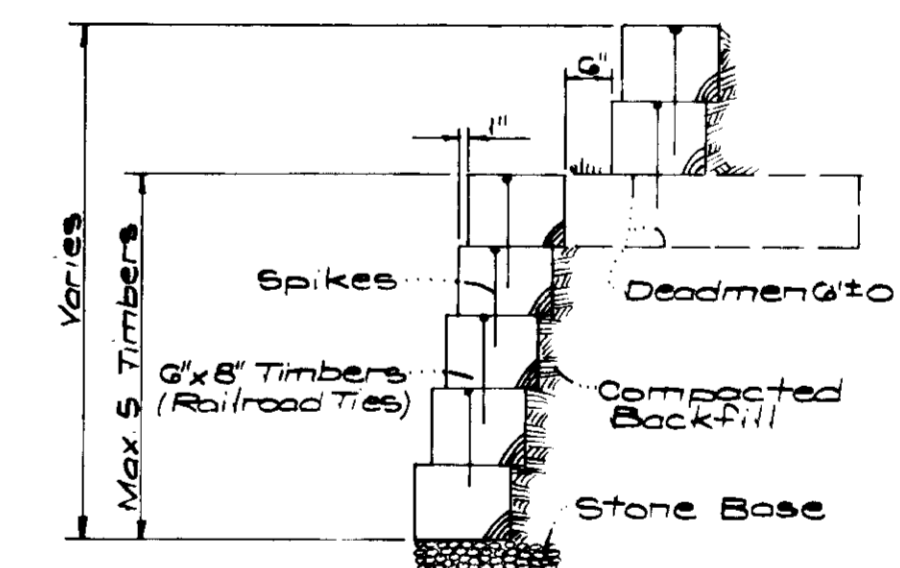

TIMBER RETAINING WALL
No Scale



APPROVED
DIVISION OF LAND DEVELOPMENT
AND TRANSPORTATION PLANNING
HOWARD COUNTY, MARYLAND
DATE FEB 2 1975

J. N. Ann Clark
10-28-74

APPROVED FOR PUBLIC WATER AND PUBLIC SEWERAGE SYSTEMS, HOWARD COUNTY HEALTH DEPARTMENT
 COUNTY HEALTH OFFICER
 APPROVED FOR HOWARD COUNTY OFFICE OF PLANNING AND ZONING
 APPROVED FOR PUBLIC WATER AND PUBLIC SEWERAGE, STORM DRAINAGE SYSTEMS AND PUBLIC ROADS, HOWARD COUNTY DEPARTMENT OF PUBLIC WORKS
 CHIEF BUREAU OF HIGHWAYS



CLARK • FINEFROCK & SACKETT
ENGINEERS • PLANNERS • SURVEYORS

DESIGNED: D.A.B.
 DRAWN: Suzoni
 CHECKED: G.N.C.
 DATE: Oct. 1974

SITE DEVELOPMENT PLAN
 LOTS J-1 THRU J-51
 A RESUBDIVISION OF PARCEL J
COLUMBIA
 VILLAGE OF LONGREACH
 SECTION I AREA I
 6TH ELECTION DISTRICT
 HOWARD COUNTY, MARYLAND

SCALE: As Shown
 DRAWING: 30F7
 JOB NO.:
 FILE NO.: 1125-X

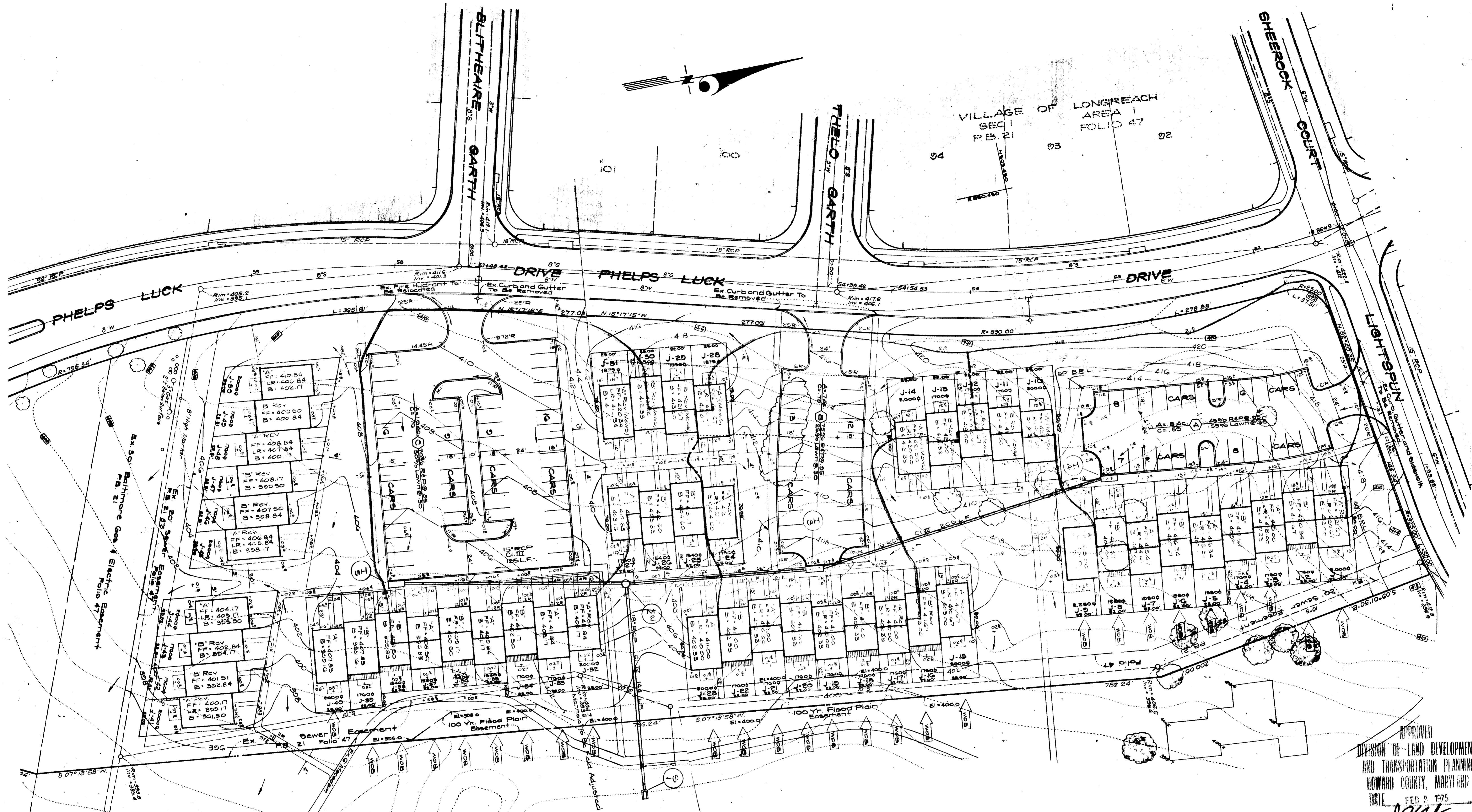

VILLAGE OF LONGREACH
 AREA I
 SEC 1
 P.B. 21 93 92

APPROVED
 DIVISION OF LAND DEVELOPMENT
 AND TRANSPORTATION PLANNING
 HOWARD COUNTY, MARYLAND
 DATE FEB 2, 1975
J. N. Clark



APPROVED FOR PUBLIC WATER AND PUBLIC SEWERAGE SYSTEMS, HOWARD COUNTY HEALTH DEPARTMENT
[Signature] 6/5/75
 COUNTY HEALTH OFFICER DATE
 APPROVED HOWARD COUNTY OFFICE OF PLANNING AND ZONING
[Signature] 6-6-75
 PLANNING DIRECTOR DATE
 APPROVED FOR PUBLIC WATER AND PUBLIC SEWERAGE STORM DRAINAGE SYSTEMS AND PUBLIC ROADS HOWARD COUNTY DEPARTMENT OF PUBLIC WORKS
[Signature] 6-3-75
 DIRECTOR DATE
 APPROVED FOR PUBLIC WATER AND PUBLIC SEWERAGE SYSTEMS, HOWARD COUNTY HEALTH DEPARTMENT
[Signature] 5/27/75
 CHIEF BUREAU OF HIGHWAYS DATE

CLARK • FINEPROCK & SACKETT ENGINEERS • PLANNERS • SURVEYORS 11415 LUCKWOOD DRIVE SILVER SPRING, MARYLAND 20904 (301) 593-3300		
DESIGNED	DRAINAGE AREA MAP	SCALE
DRAWN	LOTS J-1 THRU J-51	1"=30'
CHECKED	A RESUBDIVISION OF PARCEL J	DRAWING
DATE	COLUMBIA	40F7
	VILLAGE OF LONGREACH	JOB NO.
	SECTION 1 AREA I	
	6TH ELECTION DISTRICT	FILE NO.
	HOWARD COUNTY, MARYLAND	1123-X
FOR:	FORITSKY & STARR, Inc.	
	8401 Connecticut Avenue	
	Chevy Chase, Maryland 20015	

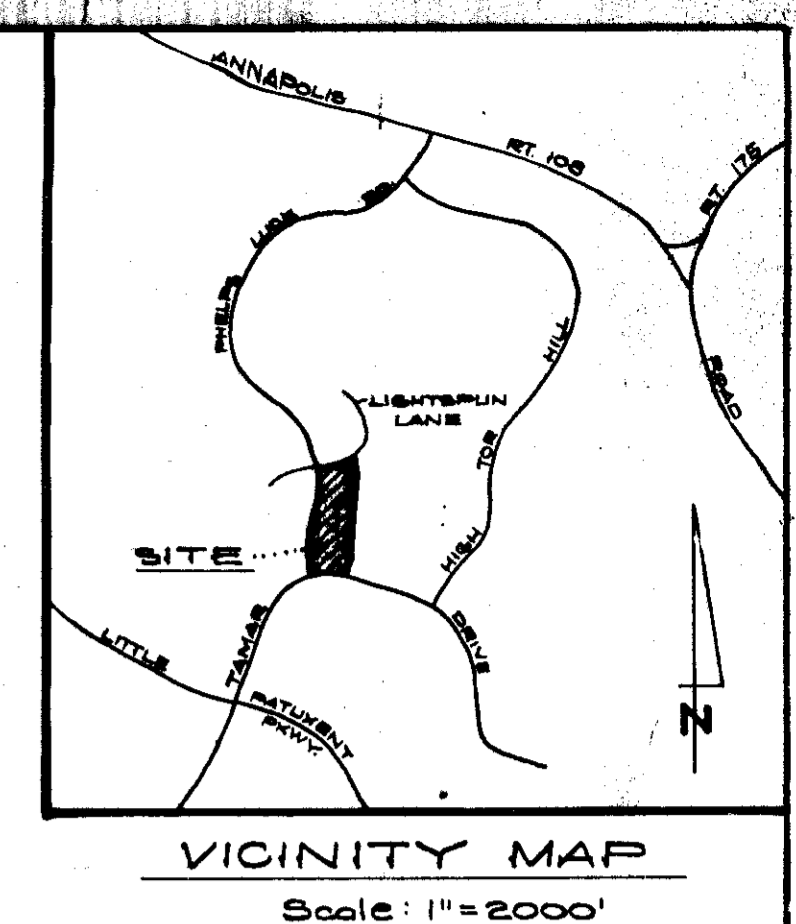
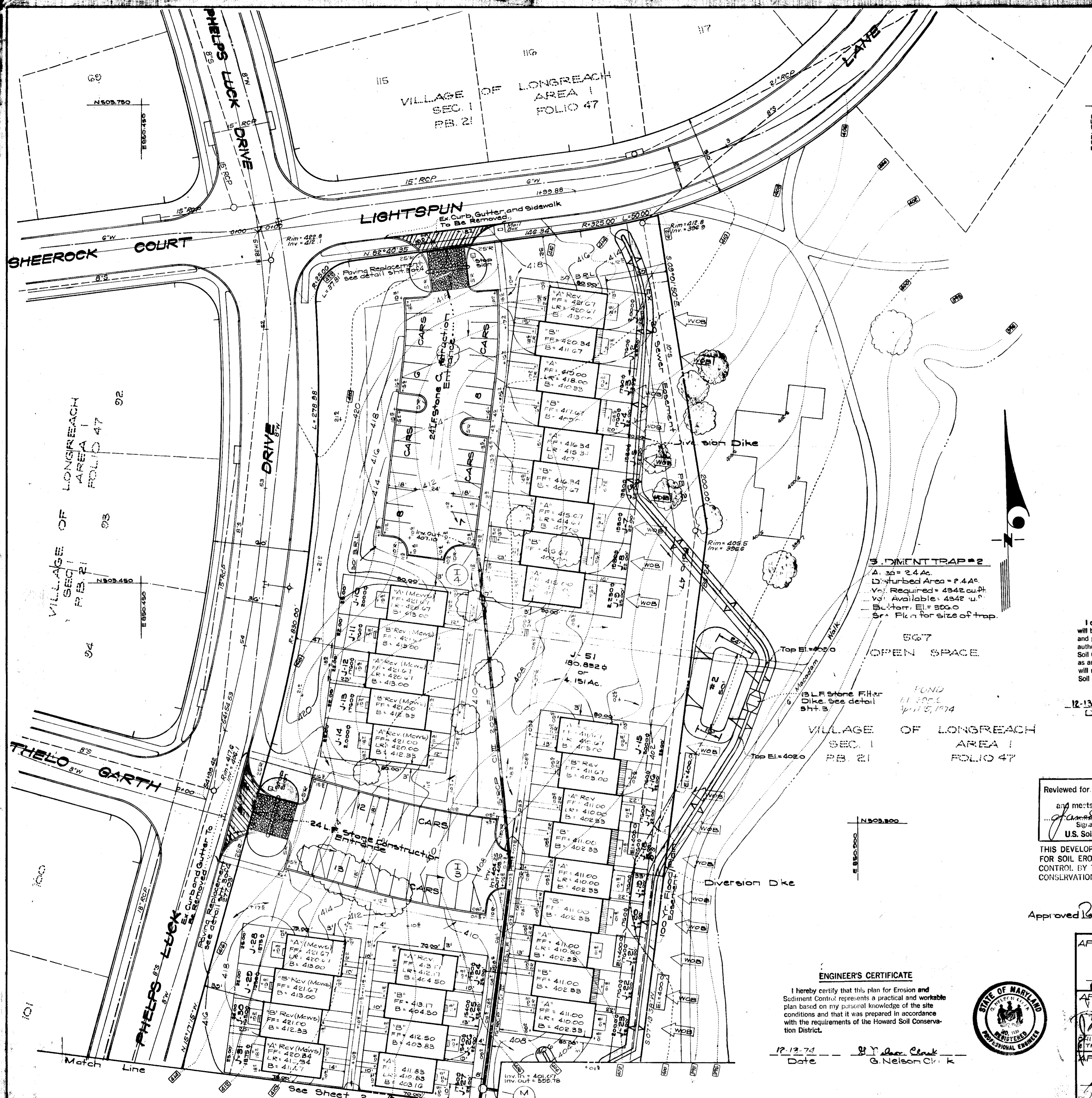

GENERAL NOTES

- All Sediment and Erosion Control Measures will be installed and stabilized according to this plan prior to any other grading, clearing, or disturbance of the existing surface of the site. See note #5 for stabilization, except that the seed mixture shall be Kentucky 31 applied at the rate of 1.4 lbs./1000 sq. ft.
- Notify the Howard Soil Conservation District and the Bureau of Inspections and Permits at least 24 hours before starting any work.
- All Sediment Control Practices to conform to the standards and specifications for Soil Erosion and Sediment Control in Urbanizing Areas and shall be adjusted to meet actual field conditions.
- Stabilization of disturbed ground to be done as soon after construction as possible.
- All graded areas shall be treated in accordance with the following specifications:
 - Seed - certified 85% germination applied at the rate of 3 lbs./1000 sq. ft. mixture - 40% Kentucky Blue, 20% Cheiving Fescue, 20% Kentucky 31, and 20% Annual Rye.
 - Fertilizer - 5-10-10 applied at the rate of 23 lbs./1000 sq. ft. and ground agricultural lime or dolomitic lime applied at the rate of 40 lbs./1000 sq. ft.
 - Mulch - Weed free grain straw applied at the rate of 70 lbs./1000 sq. ft. Mulch shall be secured to the ground by any approved method, i.e. asphalt tacks, chemical binder, wood chips, etc.
- All structural sediment control measures are to remain in place until permission for their removal has been obtained from the Howard Soil Conservation District, phone 465-3180 or 465-5000, ext. 328.
- On-site inspection and maintenance of all sediment control measures including cleaning of sediment traps and dikes and proper establishment of all planted vegetative measures will be the responsibility of the Developer or his representative on the site, on a continuing day to day basis.
- Protection of stabilized area from sediment runoff shall be provided by the use of an approved sediment control device, i.e. diversion dikes, straw bales, etc.
- Storm drainage inlets on the site shall be completely blocked with plywood so that no storm runoff can enter. They will continue to be blocked until all areas draining to them have been stabilized.
- Site Analysis:
 - Total Area: 6.23 Ac.
 - Area To Be Roofed: .85 Ac.
 - Area To Be Paved: 1.2 Ac.
 - Area To Be Seeded: 2.08 Ac.
 - Area Undisturbed: 1.20 Ac.
- See Sht. 3 for Construction Sequence.
- Storm drainage pipes shall be protected at end of each working day in accordance with Pipe Blocking Detail, see sht. 3.

APPROVED
DIVISION OF LAND DEVELOPMENT
AND TRANSPORTATION PLANNING
HOWARD COUNTY, MARYLAND
DATE FEB 2 1975
J. Mey

DEVELOPER'S CERTIFICATE

I certify that all development and/or construction will be done according to this plan of development and plan for Erosion and Sediment Control, and I also authorize periodic on-site inspection by the Howard Soil Conservation District or their authorized agents as are deemed necessary. Deviation from this plan will not be made unless authorized by the Howard Soil Conservation District.

12-13-74
Date *E. J. ...*
Signature

Reviewed for *Howard* Name
and meets Technical requirements
James H. ... Date 5-22-75
Signature
U.S. Soil Conservation Service

THIS DEVELOPMENT PLAN IS APPROVED FOR SOIL EROSION AND SEDIMENT CONTROL BY THE HOWARD SOIL CONSERVATION DISTRICT.

Approved *Robert J. Zelens* Date 5-22-75

ENGINEER'S CERTIFICATE

I hereby certify that this plan for Erosion and Sediment Control represents a practical and workable plan based on my personal knowledge of the site conditions and that it was prepared in accordance with the requirements of the Howard Soil Conservation District.

12-13-74 Date *G. Nelson Clark*
G. Nelson Clark



APPROVED FOR PUBLIC WATER AND PUBLIC SEWERAGE SYSTEMS, HOWARD COUNTY HEALTH DEPARTMENT

James H. ... 6-5-75
COUNTY HEALTH OFFICER DATE

APPROVED HOWARD COUNTY OFFICE OF PLANNING AND ZONING
James H. ... 6-6-75
PLANNING DIRECTOR DATE

CHIEF DIVISION OF LAND DEVELOPMENT AND TRANSPORTATION PLANNING
James H. ... 6-8-75
DATE

APPROVED FOR PUBLIC WATER AND PUBLIC SEWERAGE STORM DRAINAGE SYSTEMS AND PUBLIC ROADS HOWARD COUNTY DEPARTMENT OF PUBLIC WORKS
James H. ... 6-8-75
DATE

DIRECTOR
James H. ... 5-22-75
CHIEF BUREAU OF HIGHWAYS DATE

CLARK • FINEFROCK & SACKETT
ENGINEERS • PLANNERS • SURVEYORS
11315 LOCKWOOD DRIVE SILVER SPRING, MARYLAND 20904 (301) 593-3100

DESIGNED	SEDIMENT & EROSION CONTROL PLAN	SCALE
D.A.B.	LOTS J-1 THRU J-51	1" = 30'
DRAWN	A RESUBDIVISION OF PARCEL J	DRAWING
SUZAN	COLUMBIA	5 OF 7
CHECKED	VILLAGE OF LONGREACH	JOB NO.
G.N.C.	SECTION I, AREA 1	FILE NO.
DATE	4TH ELECTION DISTRICT	110-95
JUN 15 1974	HOWARD COUNTY, MARYLAND	

FOR: POPRETSKY & STARR, INC.
8401 Connecticut Avenue
Chevy Chase, Maryland 20015

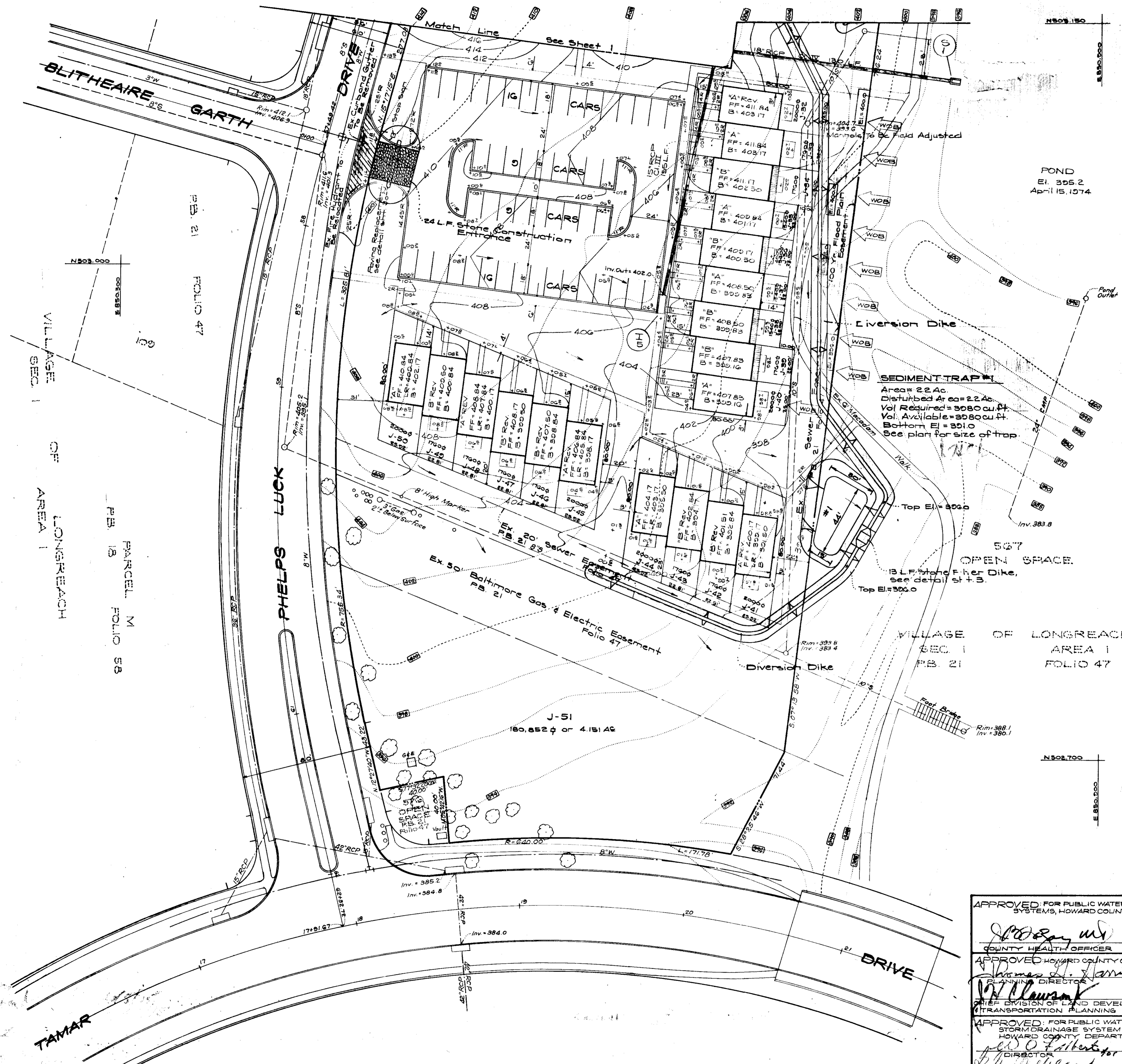

APPROVED
DIVISION OF LAND DEVELOPMENT
AND TRANSPORTATION PLANNING
HOWARD COUNTY, MARYLAND
DATE FEB 2 1975
J. New

Reviewed for Howard S.C.D.
Name
and meets Technical Requirements
James M. Nelson 5-22-75
Signature Date
U.S. Soil Conservation Service

THIS DEVELOPMENT PLAN IS APPROVED
FOR SOIL EROSION AND SEDIMENT
CONTROL BY THE HOWARD SOIL
CONSERVATION DISTRICT.

Approved *Robert J. Film* Date 5-22-75

DEVELOPER'S CERTIFICATE
I certify that all development and/or construction
will be done according to this plan of development
and plan for Erosion and Sediment Control, and I also
authorize periodic on-site inspection by the Howard
Soil Conservation District or their authorized agents
as are deemed necessary. Deviation from this plan
will not be made unless authorized by the Howard
Soil Conservation District.

12-13-74
Signature *E.P. [unclear]*

ENGINEER'S CERTIFICATE
I hereby certify that this plan for Erosion and
Sediment Control represents a practical and workable
plan based on my personal knowledge of the site
conditions and that it was prepared in accordance
with the requirements of the Howard Soil Conserva-
tion District.



12-13-74
Date
G. Nelson Clark
G. Nelson Clark

APPROVED FOR PUBLIC WATER AND PUBLIC SEWERAGE
SYSTEMS, HOWARD COUNTY HEALTH DEPARTMENT
[Signature] 6-5-75
COUNTY HEALTH OFFICER DATE
APPROVED HOWARD COUNTY OFFICE OF PLANNING AND ZONING
Thomas H. James 6-6-75
PLANNING DIRECTOR DATE
[Signature] 6-7-75
CHIEF DIVISION OF LAND DEVELOPMENT
& TRANSPORTATION PLANNING DATE
APPROVED FOR PUBLIC WATER AND PUBLIC SEWERAGE
STORM DRAINAGE SYSTEMS AND PUBLIC ROADS
HOWARD COUNTY DEPARTMENT OF PUBLIC WORKS
[Signature] 6-7-75
DIRECTOR DATE
[Signature] 5-27-75
CHIEF BUREAU OF HIGHWAYS DATE

CLARK • FINEROCK & SACKETT ENGINEERS • PLANNERS • SURVEYORS 11315 LOCKWOOD DRIVE SILVER SPRING, MARYLAND 20904 (301) 593-3400	
DESIGNED D.A.E.	SEDIMENT & EROSION CONTROL PLAN LOTS J-1 THRU J-51
DRAWN Suizan	A RESUBDIVISION OF PARCEL J COLUMBIA VILLAGE OF LONGREACH
CHECKED G.N.C.	SECTION 1 AREA I CITY SELECTION DISTRICT HOWARD COUNTY, MARYLAND
DATE D. [unclear]	FOR: PORITSKY & STARR, Inc. 8401 Connecticut Avenue Chevy Chase, Maryland 20015
SCALE 1"=30'	JOB NO. 1140-513
DRAWING # OF 7	FILE NO. 1140-513

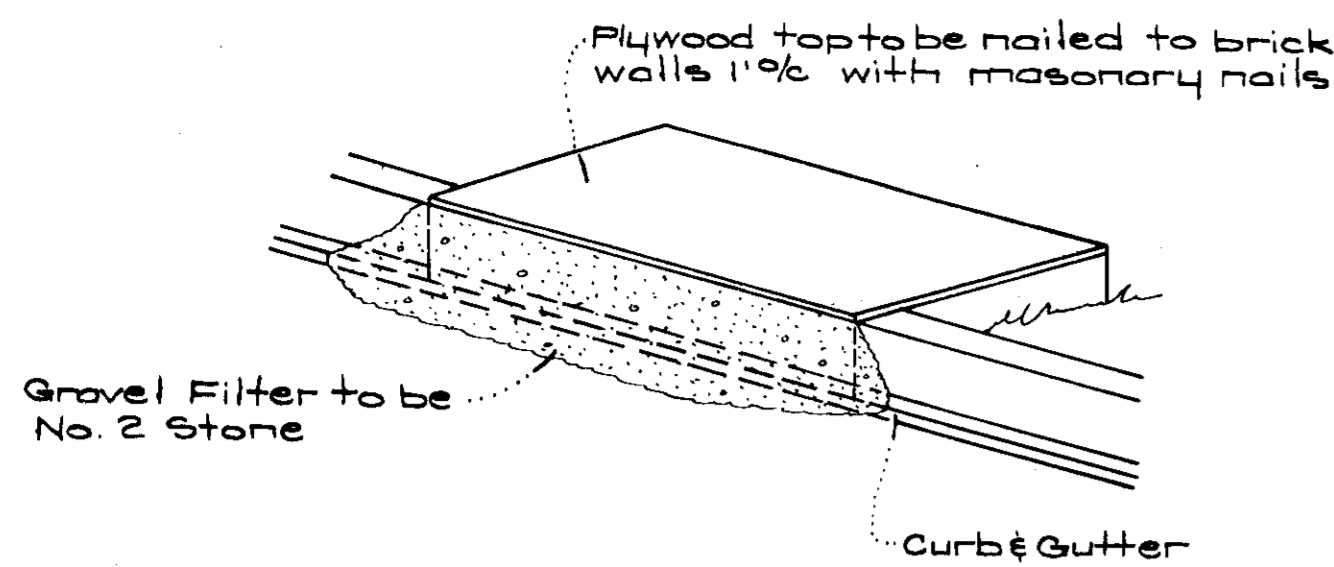

ISOMETRIC VIEW

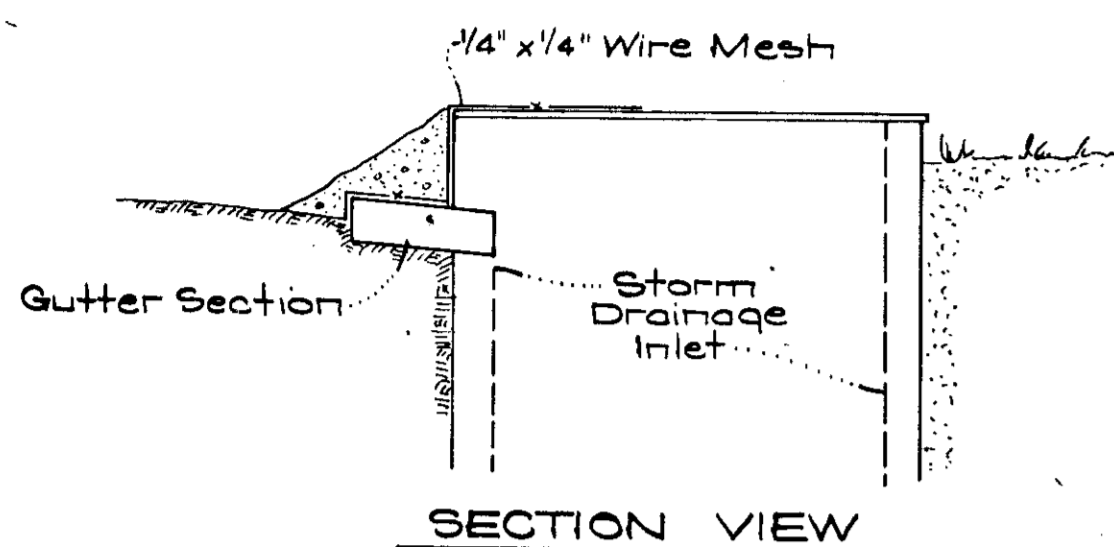

SECTION VIEW

STONE FILTER INLET PROTECTION DETAIL
No Scale

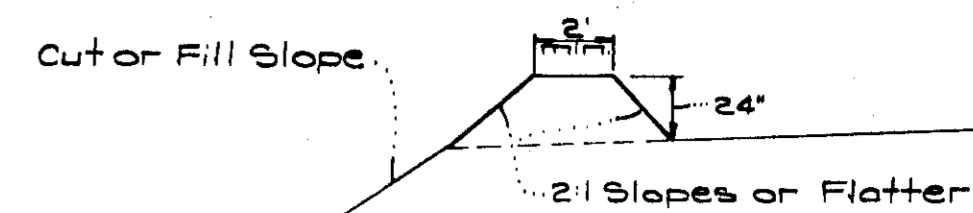

CROSS SECTION

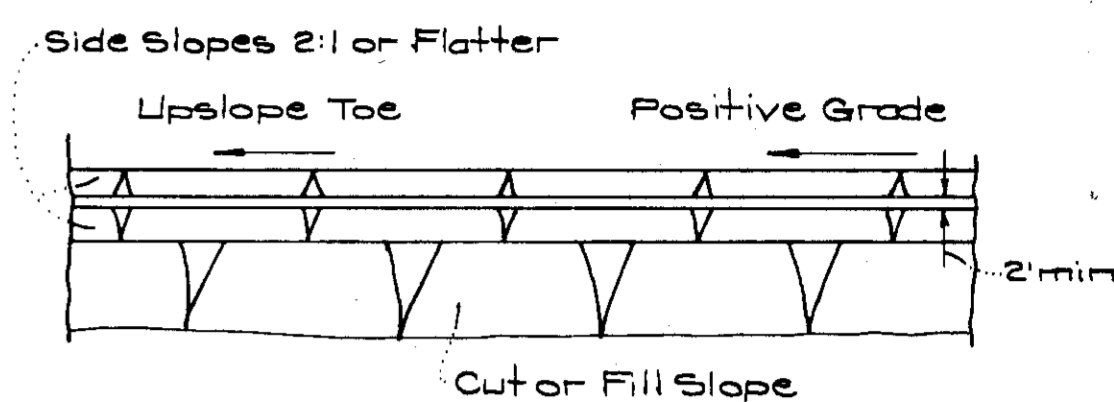

PLAN VIEW

DIVERSION DIKE
No Scale

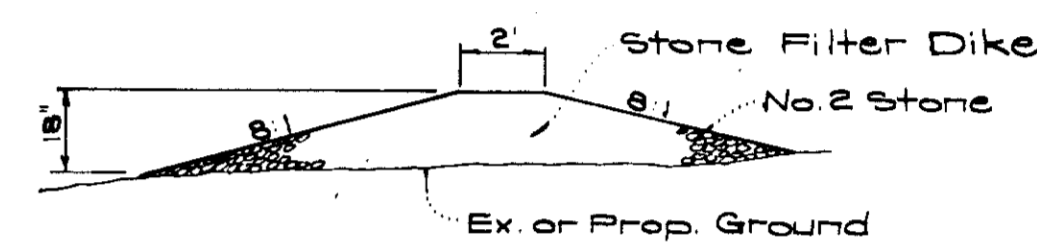

SECTION VIEW

STONE CONSTRUCTION ENTRANCE DETAIL
No Scale

APPROVED
DIVISION OF LAND DEVELOPMENT
AND TRANSPORTATION PLANNING
HOWARD COUNTY, MARYLAND
DATE FEB 2, 1975
J. J. [Signature]

CONSTRUCTION SEQUENCE

PHASE I (Bldgs J-1 Thru J-31)

1. Construct Stone Construction Entrance at Phelps Luck Dr. and Thelo Garth, and Entrance onto Lightspur Lane.
2. Construct Sediment Trap #2 and Diversion Dike along East property line and stabilize.
3. Construct storm drainage structures S-1, M-2, I-3, and I-4, and block shut. Restore sediment control devices and stabilize.
4. Excavate bldg. footings and rough grade.
5. Install utilities.
6. Construct Bldgs. J-1 Thru J-31.
7. Construct curb and gutter and paving.
8. Final grade and stabilize. Remove sediment control devices & stabilize.

PHASE II (Bldgs J-32 Thru J-50)

1. Construct Stone Construction Entrance at Phelps Luck and Blitheaire Garth.
2. Construct Sediment Trap #1 and Diversion Dike along East property line and stabilize.
3. Construct storm drainage structure I-5 and connecting pipe.
4. Excavate for bldg. footings and rough grade.
5. Install utilities.
6. Construct Bldgs. J-32 Thru J-50.
7. Construct curb and gutter and paving.
8. Final grade and stabilize. Remove sediment control devices & stabilize.

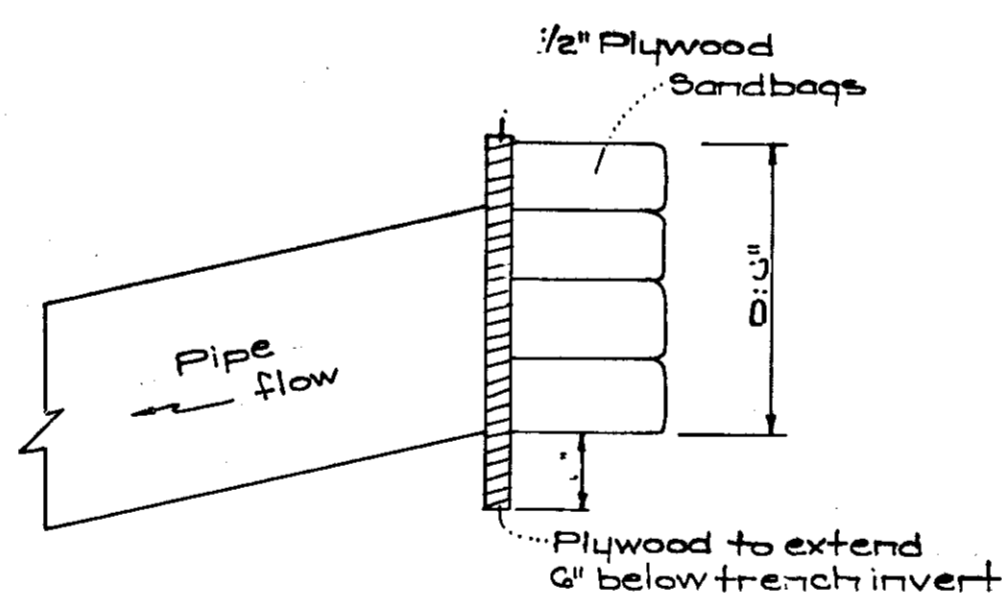

PIPE BLOCKING DETAIL
No Scale

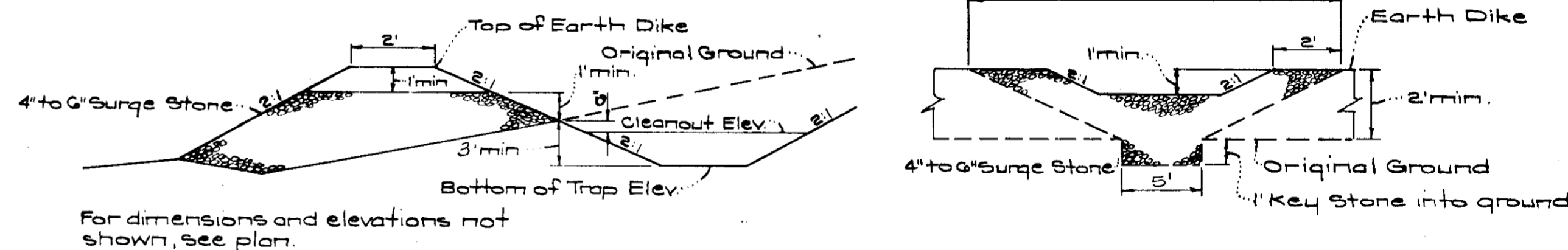

TYPICAL PROFILE

TYPICAL SPILLWAY CROSSSECTION

SEDIMENT TRAP DETAILS

SEDIMENT TRAP NOTES

1. All Sediment Traps to be cleaned out when sediment reaches a level 6" below the original ground line.
2. Bottoms of all Sediment Traps to be level and constructed to the dimensions shown in plan view.
3. Spillways to be constructed through Earth Dikes adjacent to excavated portion of sediment trap.

APPROVED FOR PUBLIC WATER AND PUBLIC SEWERAGE SYSTEMS, HOWARD COUNTY HEALTH DEPARTMENT
COUNTY HEALTH OFFICER
DATE 6-5-75

APPROVED HOWARD COUNTY OFFICE OF PLANNING & ZONING
PLANNING DIRECTOR
DATE 6-6-75

CHIEF DIVISION OF LAND DEVELOPMENT AND TRANSPORTATION PLANNING
DATE 6-5-75

APPROVED FOR PUBLIC WATER AND PUBLIC SEWERAGE, STORM DRAINAGE SYSTEMS AND PUBLIC ROADS, HOWARD COUNTY DEPARTMENT OF PUBLIC WORKS
DIRECTOR
DATE 6-3-75

CHIEF BUREAU OF HIGHWAYS
DATE 5/29/75

Reviewed for... Howard... S.C.D. Name
and meets Technical Requirements
Signature Date 5-22-75
U.S. Soil Conservation Service

THIS DEVELOPMENT PLAN IS APPROVED FOR SOIL EROSION AND SEDIMENT CONTROL BY THE HOWARD SOIL CONSERVATION DISTRICT.

Approved Robert W. Zielone Date 5-22-75

DEVELOPER'S CERTIFICATE

I certify that all development and/or construction will be done according to this plan of development and plan for Erosion and Sediment Control, and I also authorize periodic on-site inspection by the Howard Soil Conservation District or their authorized agents as are deemed necessary. Deviation from this plan will not be made unless authorized by the Howard Soil Conservation District.

12-13-74 Date
E. P. [Signature] Signature

ENGINEER'S CERTIFICATE

I hereby certify that this plan for Erosion and Sediment Control represents a practical and workable plan based on my personal knowledge of the site conditions and that it was prepared in accordance with the requirements of the Howard Soil Conservation District.

12-13-74 Date
S. Nelson Clark Signature



CLARK • FINEROCK & SACKETT ENGINEERS • PLANNERS • SURVEYORS 11315 LOCKWOOD DRIVE SILVER SPRING, MARYLAND 20904 (301) 593-3400		
DESIGNED	SEDIMENT & EROSION CONTROL PLAN LOTS J-1 THRU J-51 AN SUBDIVISION OF PARCEL J COLUMBIA VILLAGE OF LONGREACH SECTION I AREA I 3 RD ELECTION DISTRICT HOWARD COUNTY, MARYLAND	SCALE As Shown DRAWING 7 OF 7 JOB NO.
DRAWN		
CHECKED		
DATE	FOR FORETSKY & STARR, Inc. 8401 Connecticut Avenue Chevy Chase, Maryland 20015	FILE NO. 1140-5E
D.C. 1074		