

APPROVED
 DIVISION OF LAND DEVELOPMENT
 AND TRANSPORTATION PLANNING
 HOWARD COUNTY, MARYLAND
 DATE 1/13/75
 JTC

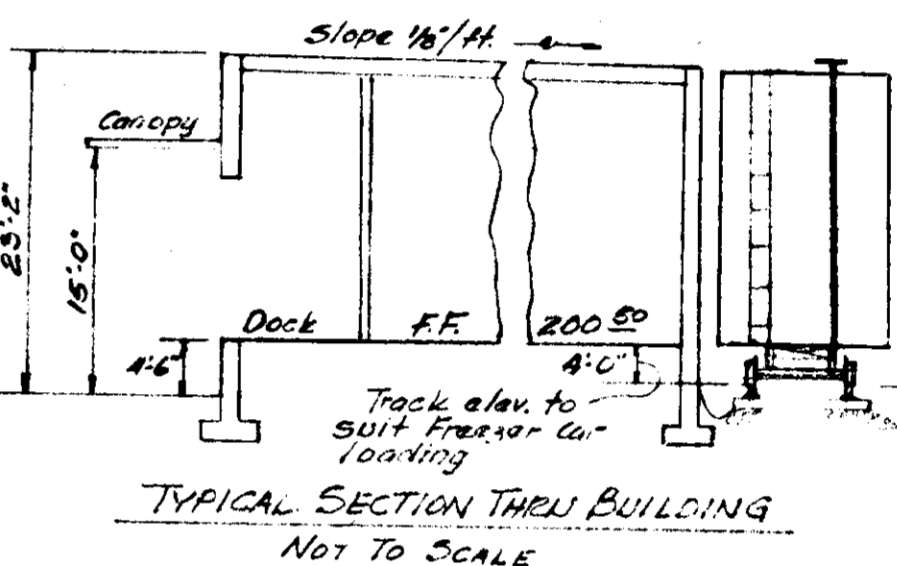
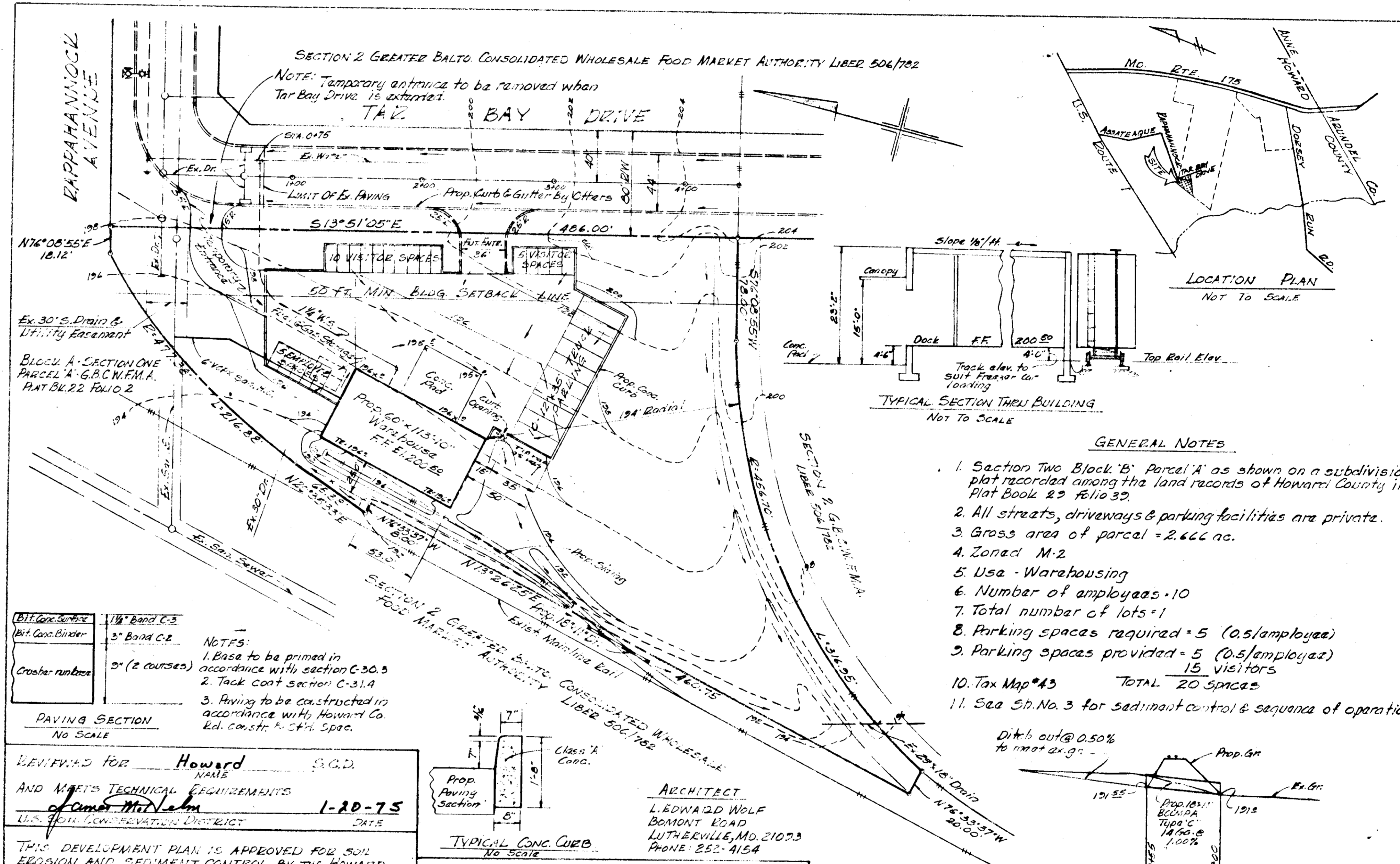

- GENERAL NOTES
1. Section Two Block 'B' Parcel 'A' as shown on a subdivision plat recorded among the land records of Howard County in Plat Book 23 Folio 39.
 2. All streets, driveways & parking facilities are private.
 3. Gross area of parcel - 2.666 ac.
 4. Zoned M-2
 5. Use - Warehousing
 6. Number of employees - 10
 7. Total number of lots = 1
 8. Parking spaces required = 5 (0.5/employee)
 9. Parking spaces provided = 5 (0.5/employee)
 10. Tax Map #43
 11. See Sp. No. 3 for sediment control & sequence of operation
- TOTAL 20 SPACES

| | |
|-------------------|-----------------|
| Bit. Coat Surface | 1 1/2" Bond C-3 |
| Bit. Coat Binder | 3" Bond C-2 |
| Crusher Course | 2" (2 courses) |

- NOTES:
1. Base to be primed in accordance with section C-30.3
 2. Tack coat section C-31.4
 3. Paving to be constructed in accordance with Howard Co. Ed. constr. & Sp. Spec.

PAVING SECTION
 NO SCALE

REVIEWED FOR HOWARD COUNTY
 NAME: Howard S.C.D.
 AND METS TECHNICAL REQUIREMENTS
 of Commissioner 1-20-75
 U.S. SOIL CONSERVATION DISTRICT DATE

THIS DEVELOPMENT PLAN IS APPROVED FOR SOIL EROSION AND SEDIMENT CONTROL BY THE HOWARD SOIL CONSERVATION DISTRICT
 APPROVED: Robert W. Zelman 1-20-75
 HOWARD SOIL CONSERVATION DISTRICT DATE

APPROVED FOR PUBLIC WATER AND PUBLIC SEWERAGE SYSTEMS
 HOWARD COUNTY HEALTH DEPARTMENT
 APPROVED: [Signature] 1/30/75
 HEALTH DEPARTMENT DATE

APPROVED FOR PLANNING AND ZONING
 HOWARD COUNTY OFFICE OF PLANNING & ZONING
 APPROVED: [Signature] 1-30-75
 PLANNING AND ZONING DATE

APPROVED FOR PUBLIC WATER, PUBLIC SEWERAGE AND STORM DRAIN SYSTEM AND ROADS
 HOWARD COUNTY DEPARTMENT OF PUBLIC WORKS
 APPROVED: [Signature] 1/11/75
 PUBLIC WORKS DATE

I certify that all development and/or construction will be done according to this plan of development and plan for erosion and sediment control, and I also authorize periodic onsite inspections by the Howard Soil Conservation District or their authorized agents as are deemed necessary.
 Deviation from this plan will not be made unless authorized by the Howard Soil Conservation District.

[Signature] Jan 10, 1975
 DATE

I certify that this plan for erosion and sediment control represents a practical and workable plan based on my personal knowledge of the site conditions and that it was prepared in accordance with the requirements of the Howard Soil Conservation District.

[Signature] Jan 10, 1975
 DATE

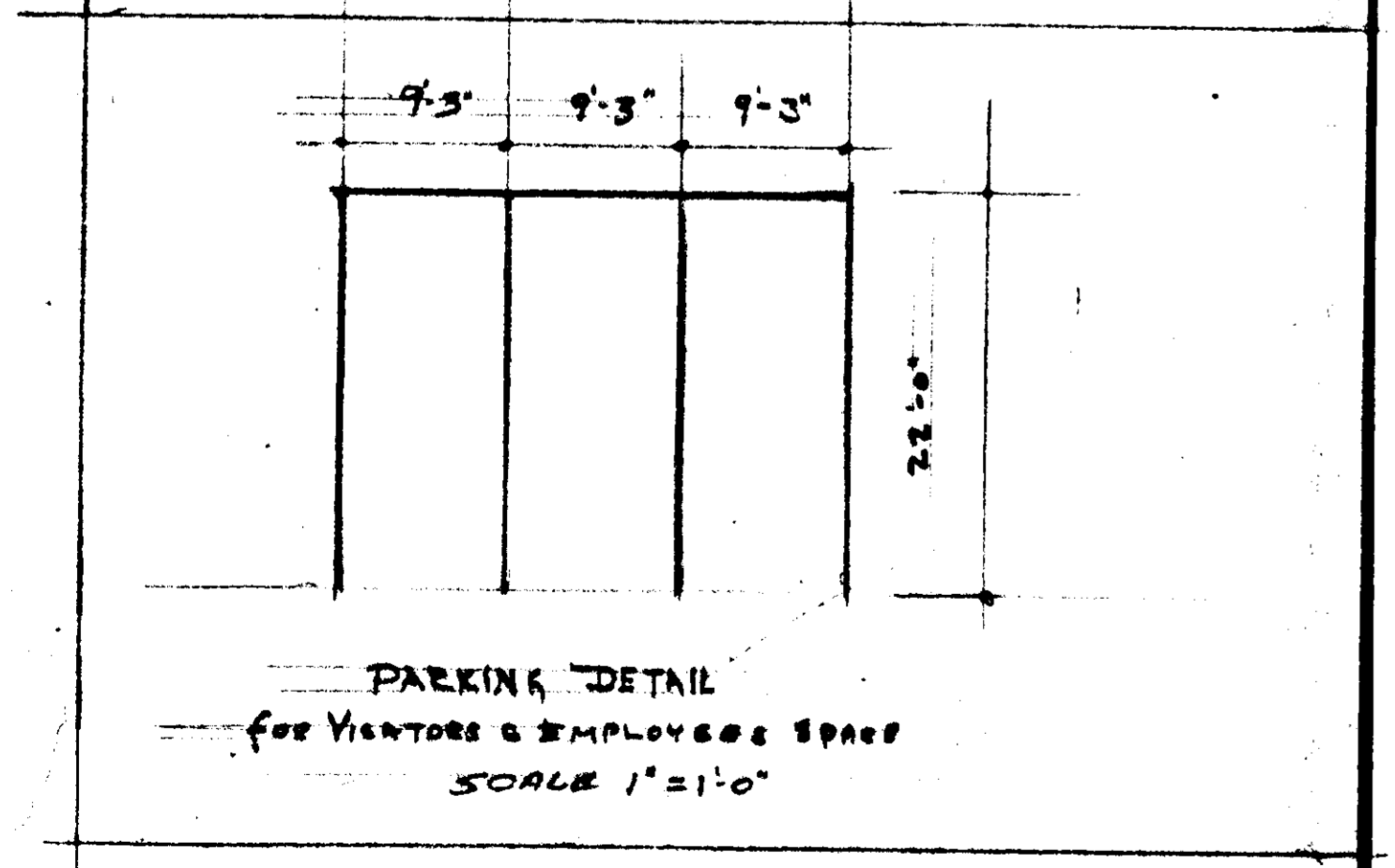

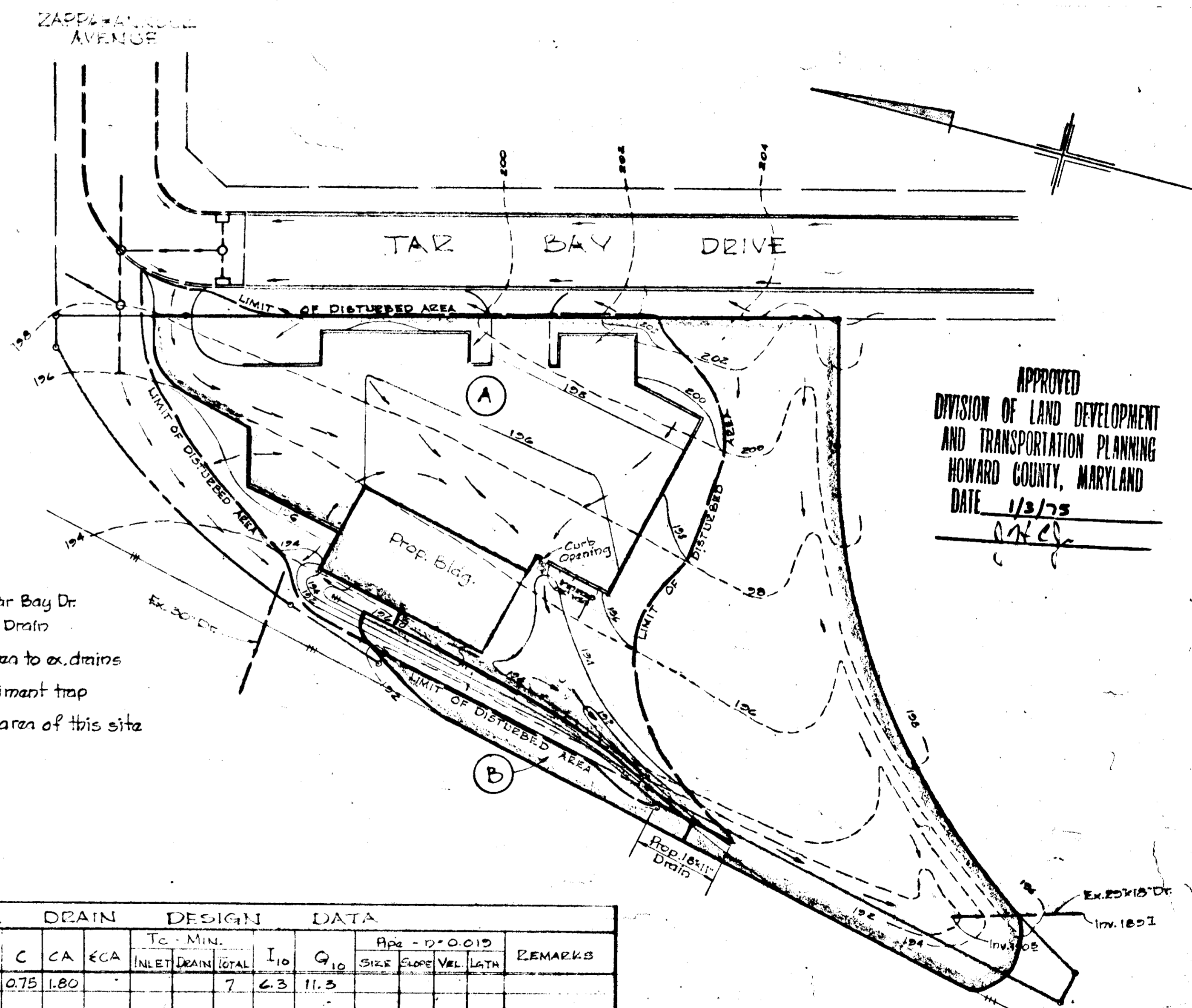

APPROVED
 DIVISION OF LAND DEVELOPMENT
 AND TRANSPORTATION PLANNING
 HOWARD COUNTY, MARYLAND
 DATE 1/3/75
 [Signature]

DISTURBED AREA
 0.05 ac. - disturbed area to inlets in Tar Bay Dr.
 0.11 ac. - disturbed area to exist. 30" Drain
 0.14 acres = Total disturbed area to ex. drains
 1.41 ac. - disturbed area to prop. sediment trap
 1.55 acres = Total disturbed area of this site

| LOCATION FROM TO | AREA | ACRES | | | INLET DRAIN | | | DATA | | | REMARKS |
|------------------|------|-------|-------|------|-------------|------|-----|-----------------|-----------------|---------------|---|
| | | AREA | TOTAL | C | CA | CA | ICA | I ₁₀ | Q ₁₀ | Area - 0.0015 | |
| A | 2.4 | | 0.75 | 1.80 | | | 7 | 2.3 | 11.3 | | |
| B | 0.2 | | 0.50 | 0.10 | | | 5 | 4.7 | 0.7 | 0.04 | 0.7 55' EXIST. 28" DIA. PIPE TO COVER OVER PIPE |
| A-B | 2.6 | | | | | 1.90 | 7 | 2.3 | 12.0 | 0.90 | 4.3 80' EXIST. 28" DIA. PIPE TO COVER OVER PIPE Slope 1.00% |

REVIEWED FOR Howard BCD
 NAME
 AND MEETS TECHNICAL REQUIREMENTS
 of Area M. T. V. S. 1-30-75
 SOIL CONSERVATION DISTRICT DATE
 THIS DEVELOPMENT PLAN IS APPROVED FOR SOIL
 EROSION AND SEDIMENT CONTROL BY THE HOWARD
 COUNTY HEALTH DEPARTMENT
 APPROVED Robert W. Zelman 1-30-75
 HOWARD COUNTY HEALTH DEPARTMENT DATE
 APPROVED
 FOR PUBLIC WATER AND PUBLIC SEWERAGE SYSTEMS
 HOWARD COUNTY HEALTH DEPARTMENT
Moorgan W. 1/30/75
 DATE
 APPROVED
 HOWARD COUNTY OFFICE OF PLANNING & ZONING
 STAFF PLANNING ENGINEER
Robert W. Zelman 1-30-75
 DATE
 APPROVED FOR PUBLIC WATER, PUBLIC SEWERAGE AND
 STORM DRAIN SYSTEMS & ROADS
 HOWARD COUNTY DEPARTMENT OF PUBLIC WORKS
William J. Allen 1/30/75
 DATE

B.D. LYNCH CO., INC.
 4207 HARTFORD ROAD
 BALTIMORE, MARYLAND 21214

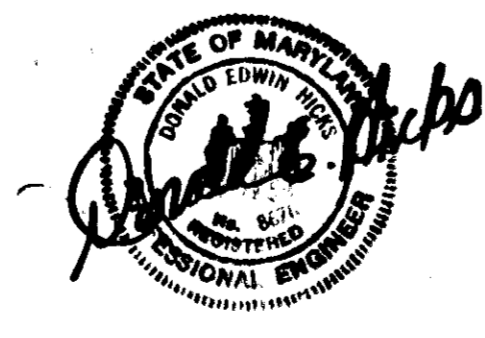

Drainage Area Map
 AMERICAN FOODSERVICE CORP.
 HOWARD COUNTY, MD
 Nov 10, 1974
 SCALE: 1" = 50'
 DRAWING 2

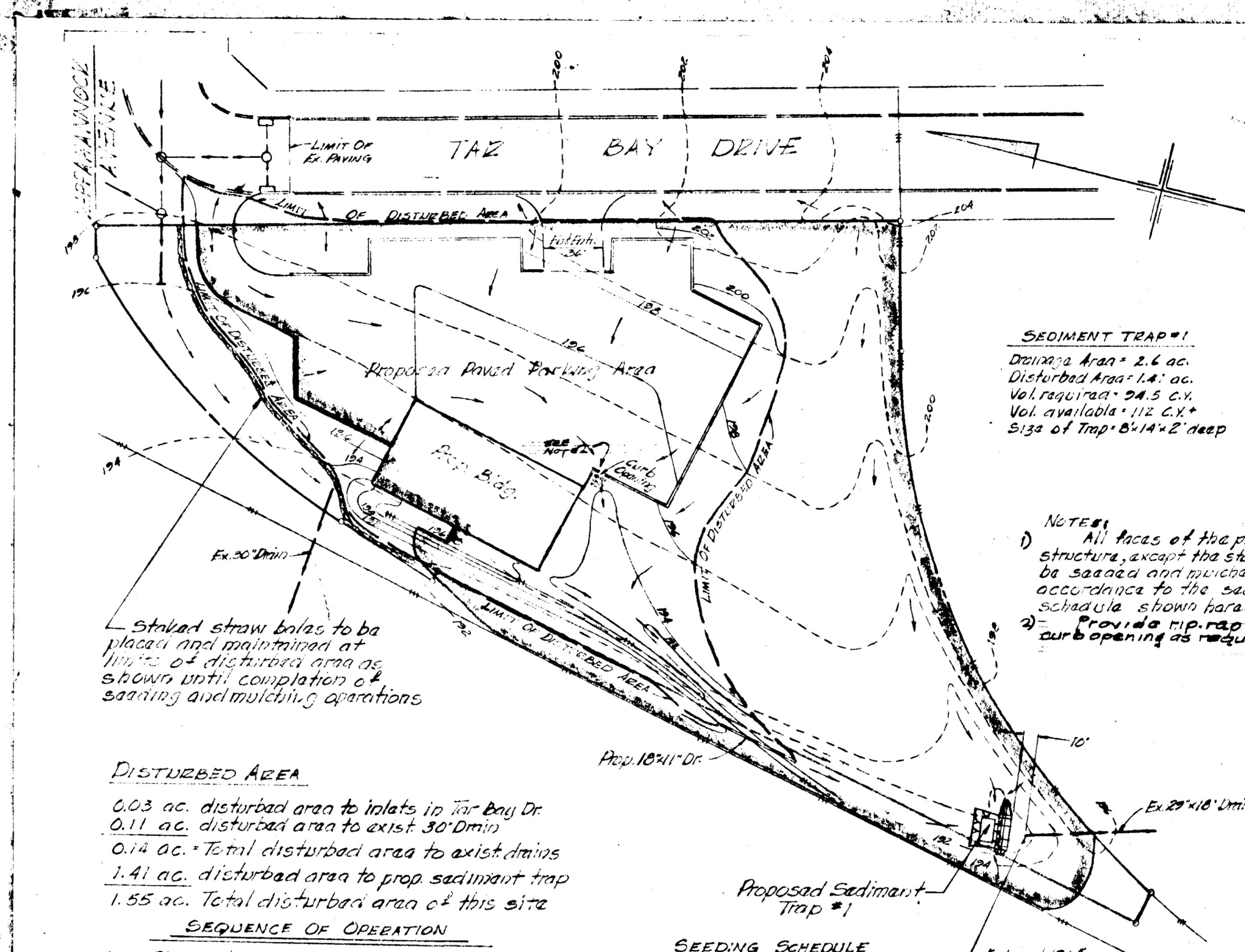

SEDIMENT TRAP #1
Disturbed Area = 2.6 ac.
Disturbed Area = 1.4 ac.
Vol. required = 24.5 cu yd.
Vol. available = 112 cu yd.
Size of Trap = 8' x 14' x 2' deep

NOTES:
1) All faces of the proposed structure, except the slope, shall be seeded and mulched in accordance to the seeding schedule shown hereon.
2) Provide rip-rap near curb opening as required.

Straw bales to be placed and maintained at limits of disturbed area as shown until completion of seeding and mulching operations.

DISTURBED AREA
0.03 ac. disturbed area to inlets in Tay Bay Dr.
0.11 ac. disturbed area to exist drains
0.14 ac. Total disturbed area to exist drains
1.41 ac. disturbed area to prop sediment trap
1.55 ac. Total disturbed area of this site

- SEQUENCE OF OPERATION**
1. Place straw bales and construct sediment basin.
 2. Building & site excavation - entrance and parking area to have crusher run - seed areas
 3. Construct Building.
 4. Install 18" x 11" drain and construct siding.
 5. Seed and mulch all remaining disturbed areas.
 6. Remove straw bales and dikes.

- SEEDING SCHEDULE**
1. Apply dolomite limestone @ 2,000 lb./ac.
 2. Apply 10-10-10 fertilizer @ 1,000 lb./ac.
 3. Disc lime & fertilizer into soil for 2 in. depth
 4. Sow ryegrass seed at 20 lb./ac.
 5. Mulch with unweathered small grain straw at 1/2 ton/ac.
 6. Anchor mulch
 7. Apply asphalt tie-down 20-70 or equal at 150 gal./ac.
- Note: Hydroseeding may be used in lieu of discing

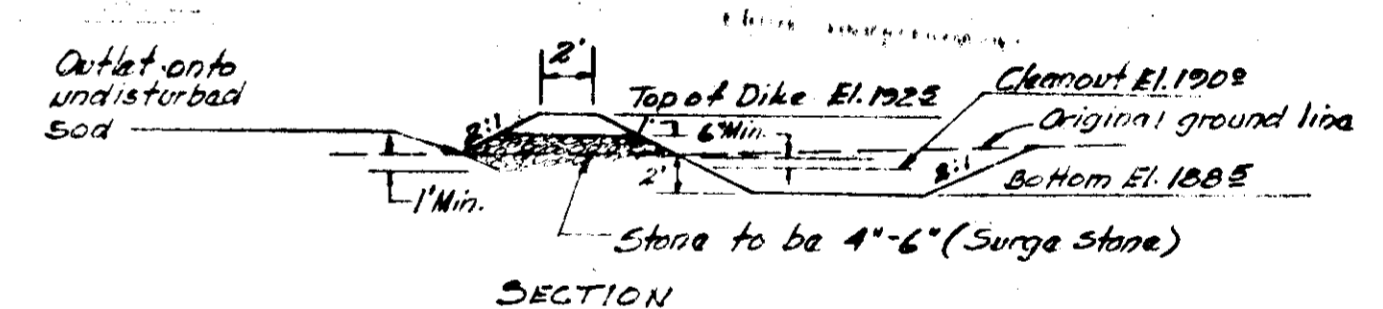
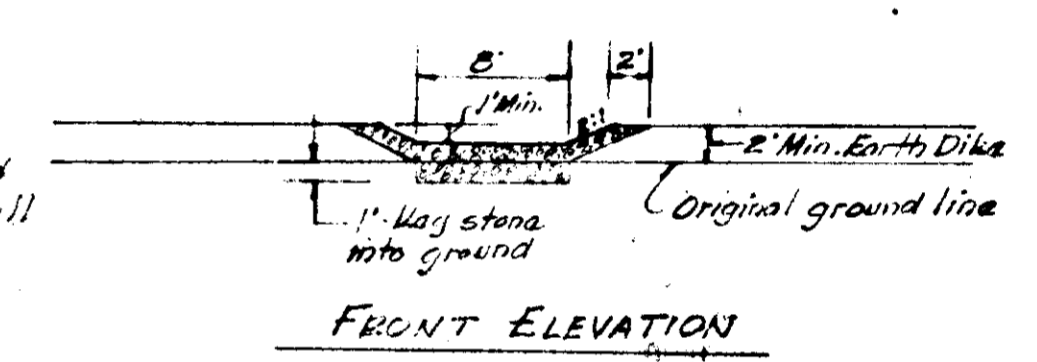
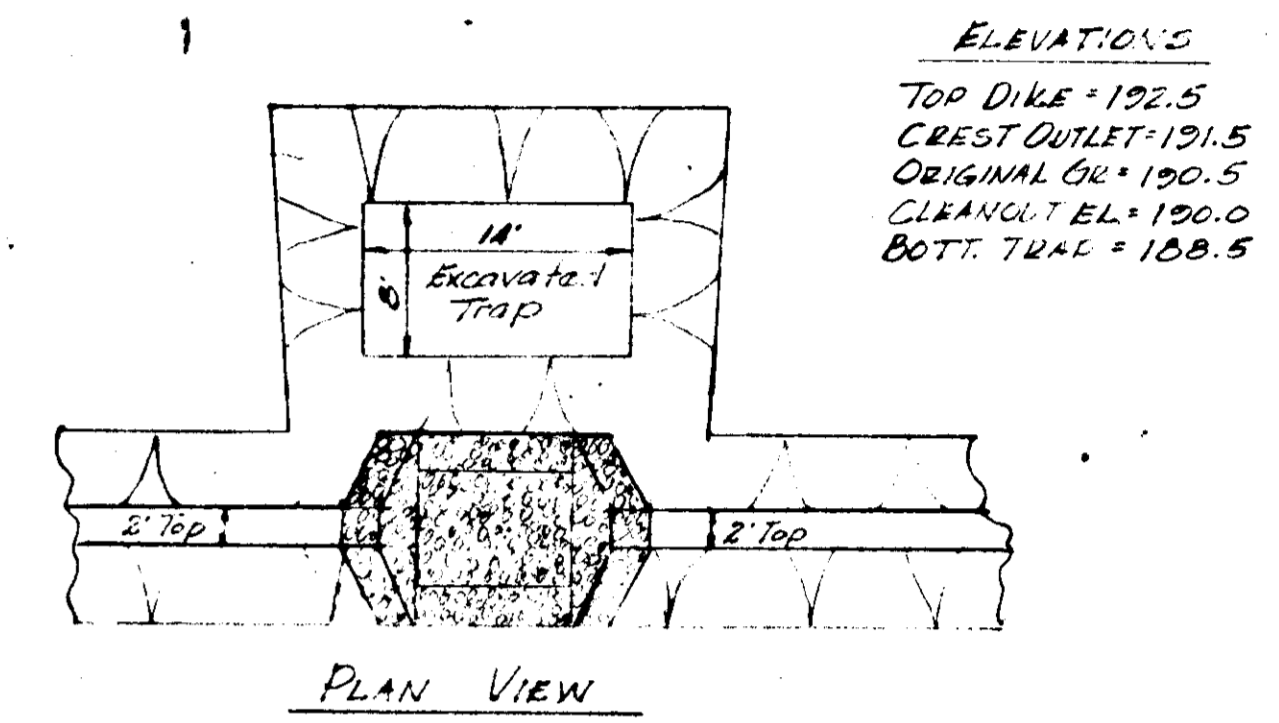

ELEVATIONS
TOP DIKE = 192.5
CREST OUTLET = 191.5
ORIGINAL GR = 190.5
CLEANOUT EL = 190.0
BOTT. TRAP = 188.5

PROPOSED SEDIMENT TRAP #1
NOT TO SCALE

SEDIMENT CONTROL NOTES

The Contractor shall notify the Howard Soil Conservation District at least 24 hours prior to beginning any construction shown on this drawing (Telephone 445-3180).
Protective sediment control measures must be installed prior to grading operations.
Construct cut and fill slopes and stabilize by seeding and mulching as soon as completed.
Sediment control measures shown on this plan are not to be removed except with permission of the Soil Conservation District.
All areas disturbed by grading or construction operations not being paved shall be topsoiled, seeded and mulched immediately following earthwork operations.



B.D. LYNCH CO. INC.
4907 HARBOR RD.
AITO, MD. 21214

SEDIMENT CONTROL PLAN

SECTION TWO BLOCK "B" PARCEL "A"
GREATER BALTO. CONSOLIDATED WHOLESALE FOOD MARKET
HOWARD COUNTY, MD. ELEC. DIST. 6 SCALE: 1" = 50'
PROPOSED REFRIGERATOR WAREHOUSE & DISTRIBUTION CENTER FOR
AMERICAN FOODSERVICE CORP.

| | | |
|---|--|---------|
| Reviewed by | Howard | 1-30-75 |
| Any MEETS DISTRICT REQUIREMENTS | James McNeil | 1-20-75 |
| SOIL CONSERVATION DISTRICT | | |
| APPROVED FOR EITC EROSION AND SEDIMENT CONTROL BY THE HOWARD SOIL CONSERVATION DISTRICT | James McNeil | 1-20-75 |
| HOWARD SOIL CONSERVATION DISTRICT | | |
| APPROVED FOR PUBLIC WATER AND PUBLIC SEWERAGE SYSTEMS | Howard County Health Department | 1/30/75 |
| HOWARD COUNTY HEALTH DEPARTMENT | | |
| APPROVED FOR PUBLIC WATER, PUBLIC SEWERAGE AND SEWERAGE SYSTEMS | Howard County Department of Public Works | 1/30/75 |
| HOWARD COUNTY DEPARTMENT OF PUBLIC WORKS | | |
| APPROVED FOR PUBLIC WATER, PUBLIC SEWERAGE AND SEWERAGE SYSTEMS | William G. McNeil | 1/30/75 |
| HOWARD COUNTY DEPARTMENT OF PUBLIC WORKS | | |

I certify that all development and/or construction will be done according to this plan of development and plan for erosion and sediment control, and I also authorize periodic or other inspections by the Howard Soil Conservation District or their authorized agents as are deemed necessary.
Deviation from this plan will not be made unless authorized by the Howard Soil Conservation District.

JOHN D. SIMONS
150 BELAIR ROAD BALTIMORE, MD. 661-3500
Date Jan 10, 1975

I certify that this plan for erosion and sediment control represents a practical and workable plan based on my personal knowledge of the site conditions and that it was prepared in accordance with the requirements of the Howard Soil Conservation District.

Donald G. Lynch
Signature of Engineer
Date Jan 10, 1975

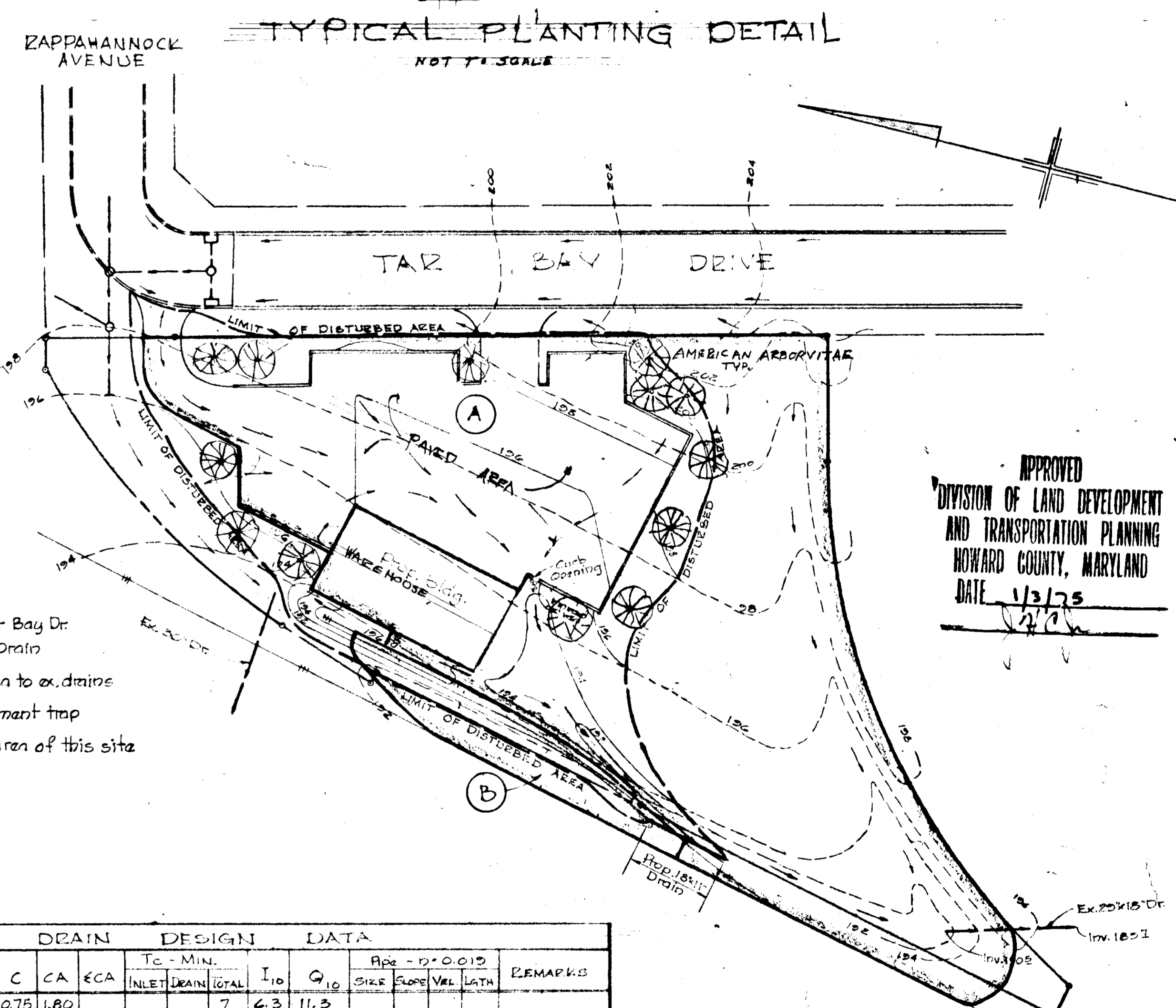
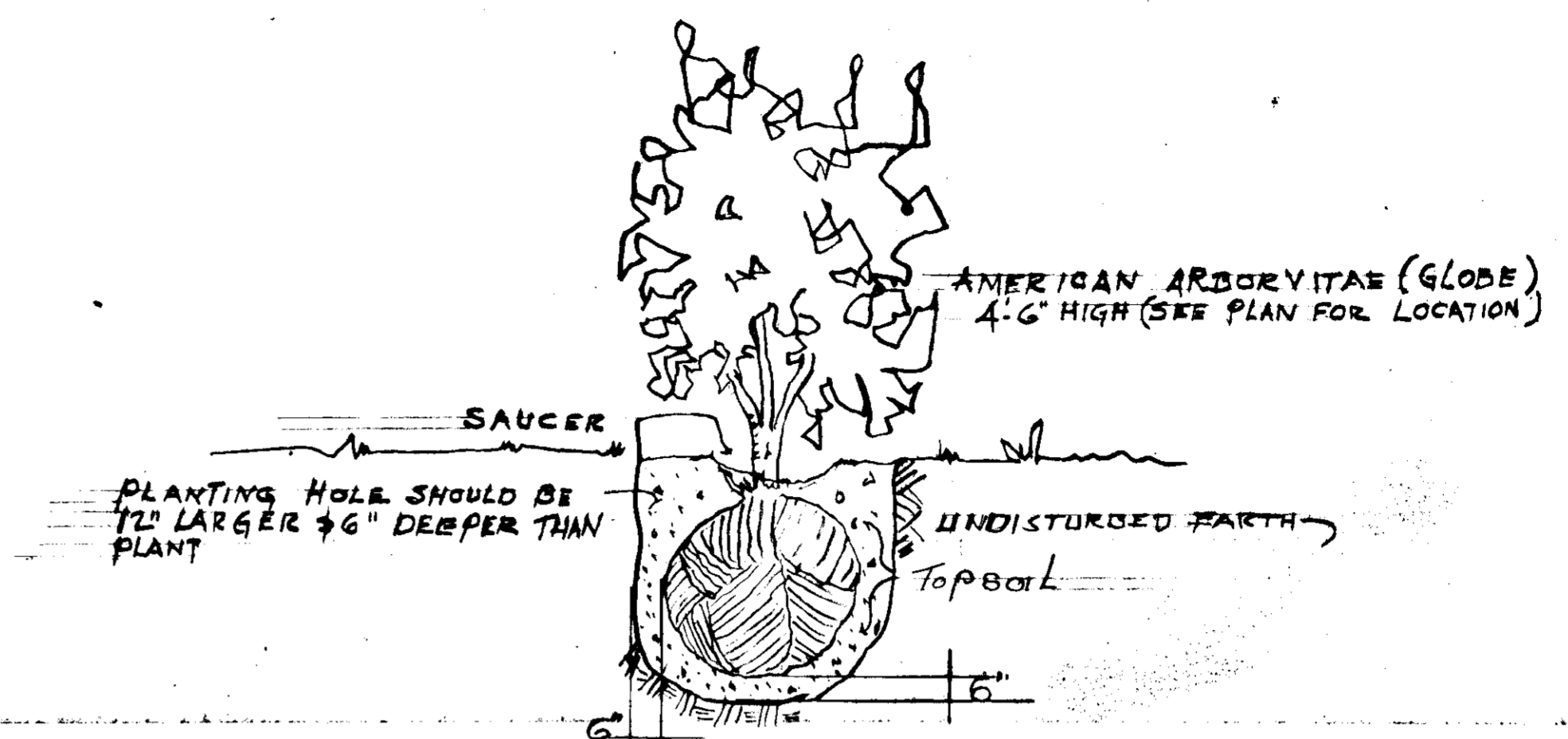

DISTURBED AREA
 0.03 ac. - disturbed area to inlets in Tar Bay Dr.
 0.11 ac. - disturbed area to exist 30" Drain
 0.14 acres = Total disturbed area to ex. drains
 1.41 ac. - disturbed area to prop sediment trap
 1.55 acres = Total disturbed area of this site

APPROVED
 DIVISION OF LAND DEVELOPMENT
 AND TRANSPORTATION PLANNING
 HOWARD COUNTY, MARYLAND
 DATE 1/31/75
 [Signature]

| | | |
|----------------------------------|-------------|-----|
| REVIEWED FOR | Howard | BCD |
| AND MEETS TECHNICAL REQUIREMENTS | | |
| DATE | 1-20-75 | |
| APPROVED | [Signature] | |
| DATE | 1-20-75 | |
| APPROVED | | |
| DATE | 1/30/75 | |
| APPROVED | | |
| DATE | 1/30/75 | |
| APPROVED | | |
| DATE | 1/30/75 | |

| LOCATION FROM TO | AREA ACRES | TC - MIN. | PIPE - D" 0.015 | REMARKS |
|------------------|------------|-----------|---|------------------------------|
| | SUB TOTAL | C CA ECA | INLET DRAIN TOTAL I ₁₀ Q ₁₀ | |
| A | 2.4 | 0.75 1.80 | 7 6.3 11.5 | |
| B | 0.2 | 0.50 0.10 | 5 4.7 0.7 | 12" x 18" x 11' 0.04 0.7 5.5 |
| A-B | 2.6 | 1.90 | 7 6.3 12.0 | 12" x 18" x 11' 0.04 0.7 5.5 |

B. D. LYNCH CO., INC.
 1907 HARTFORD ROAD
 BALTIMORE, MARYLAND 21214

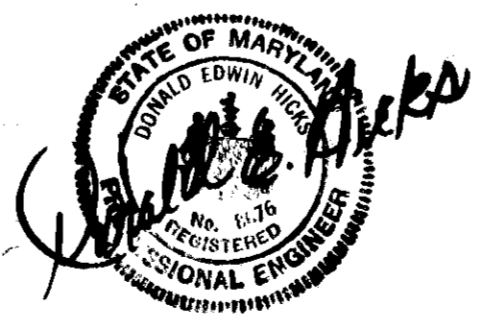

LANDSCAPE PLAN
 AMERICAN FOODSERVICE CORP
 HOWARD COUNTY, MD
 Nov 10, 1974
 SCALE: 1" = 50'
 DRAWING # 4