

STRUCTURE SCHEDULE		NO.	TYPE	INV. IN	INV. OUT	TOP EL.	REMARKS
I-1	HO. CO. STD. CLASS S INLET			330.72	332.30		SEE HO. CO. STD. DETAILS DRWG. D-23 PG. 153
S-1	HO. CO. STD. TYPE C ARCH ENDWALL			330.30	332.30		SEE HO. CO. STD. DETAILS DRWG. D-23 PG. 108
I-2	HO. CO. STD. CL. S INLET			330.82	332.30		SEE HO. CO. STD. DETAILS DRWG. D-23 PG. 153
S-2	HO. CO. STD. TYPE C ARCH ENDW.			330.40	332.30		SEE HO. CO. STD. DETAILS DRWG. D-23 PG. 108

REVISIONS			
NO.	DATE	DESCRIPTION	BY

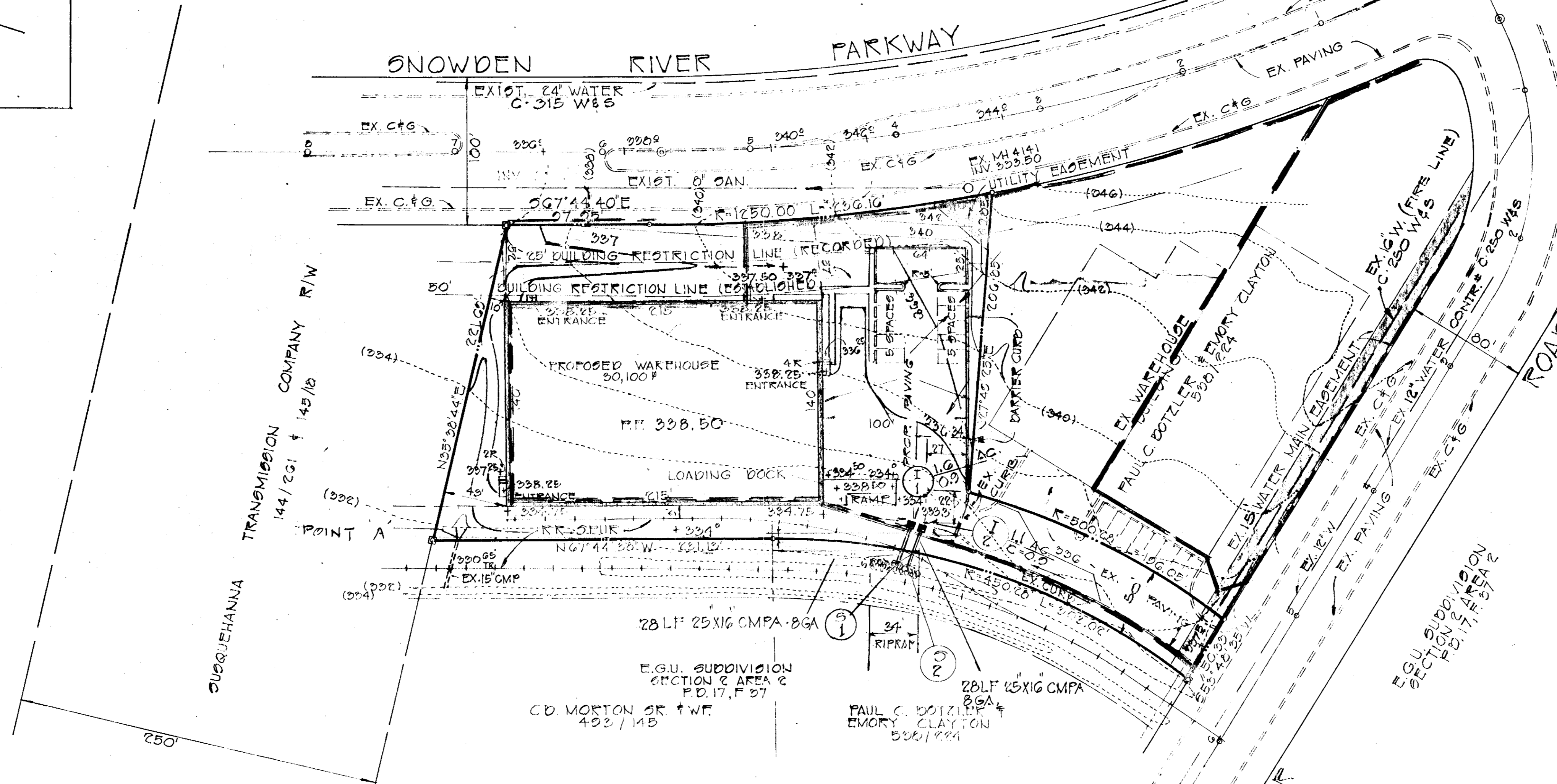
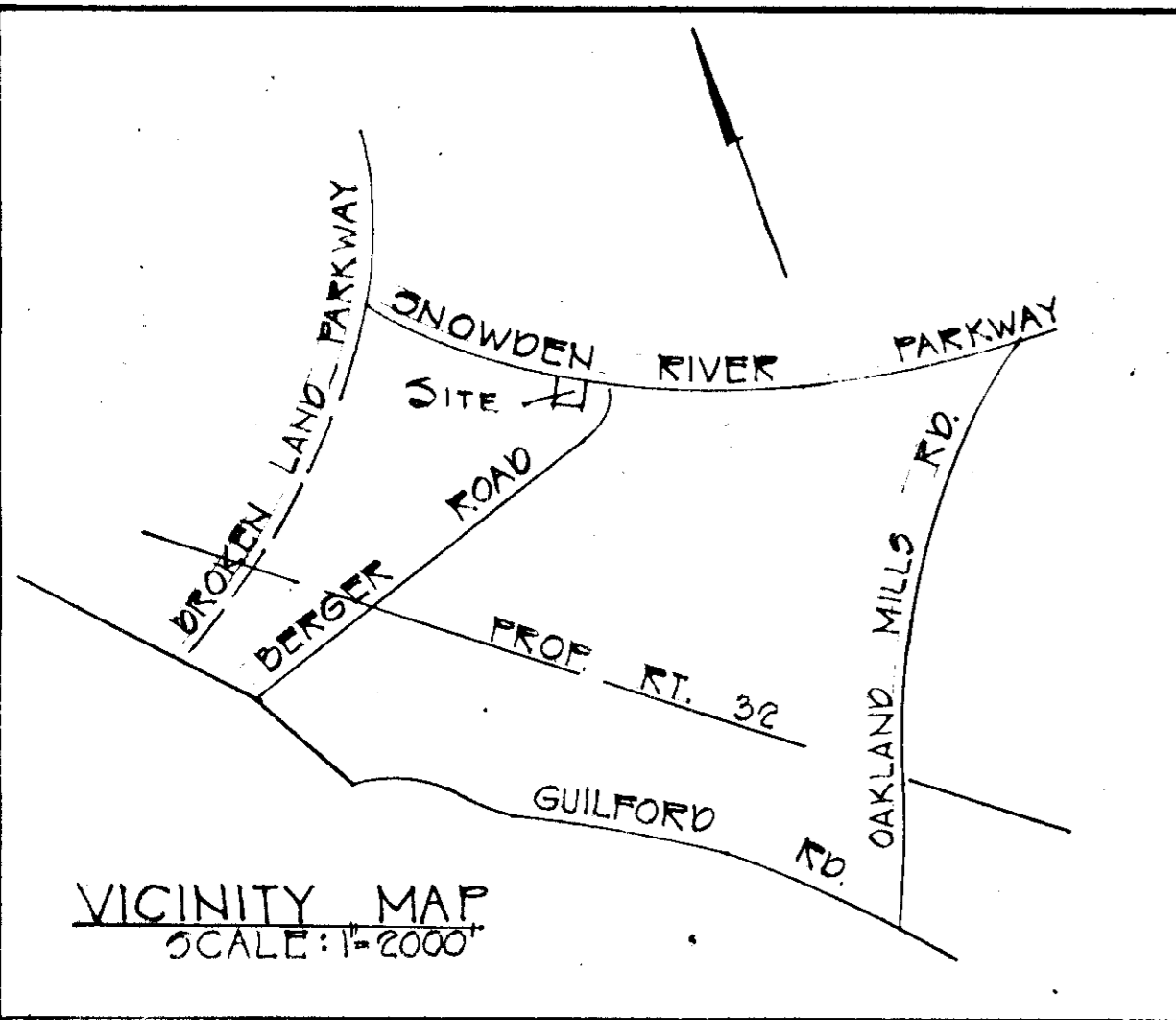

GENERAL NOTES

- AREA OF TRACT: 1.021 ACRES
- ZONING: NEW TOWN EMPLOYMENT
- SITE USE: WAREHOUSE
- PLAT BOOK REF: PD 22, F 88
- PARKING REQUIRED: 10
- PARKING PROVIDED: 10
- TAX MAP: 42
- PUBLIC WATER & SEWER
- OWNERSHIP: FOUR M PROPERTIES, INC.
BOX 32245
SAN ANTONIO, TEXAS 78210
- DEVELOPER: CHARLES A. KNOTT, INC.
FRANCIS J. McGUINNESS
1726 WHITEHEAD ROAD
BALTIMORE, MD. 21207
PHONE: 468-8800
- ENGINEERS: BOENDER ASSOCIATES, INC.
2726 TOWN & COUNTRY BLVD.
ELLCOTT CITY, MD. 21040
PHONE: 468-7777
- NO. OF EMPLOYING: 20 TO PROP. WAREHOUSE.

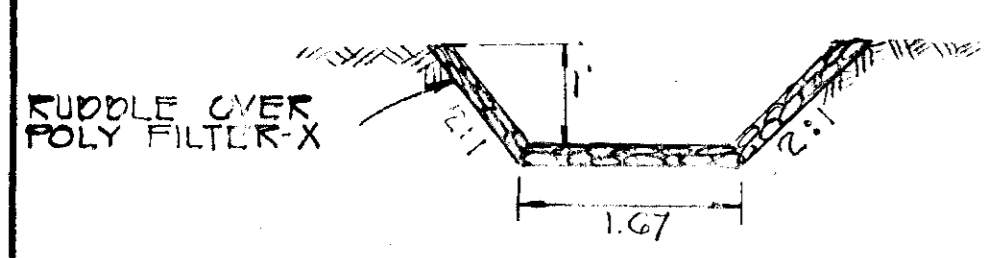

A = 0.67
VP = 6.47
HM = .57
SL = 10%
V = 2.23
Q = 10.75 cfs
QRTX = 10.8 cfs

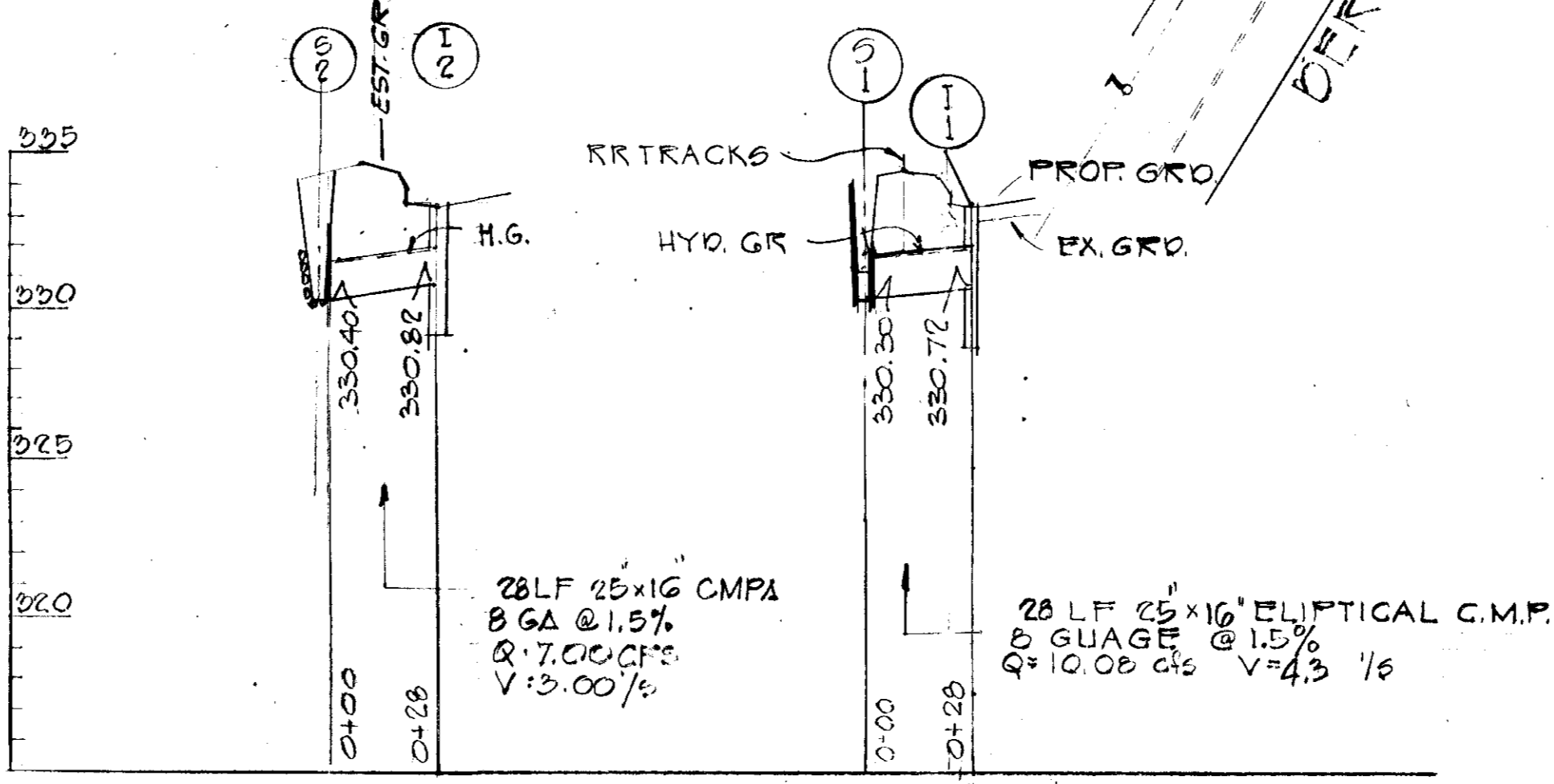

APPROVED FOR PUBLIC WATER AND PUBLIC SEWERAGE SYSTEMS,
HOWARD COUNTY HEALTH DEPARTMENT.

[Signature] 8/22/74
COUNTY HEALTH OFFICER DATE

APPROVED: HOWARD COUNTY OFFICE OF PLANNING AND ZONING.

[Signature] 8-23-74
PLANNING DIRECTOR DATE

[Signature] 8/22/74
CHIEF, DIVISION OF LAND DEVELOPMENT AND TRANSPORTATION PLANNING DATE

APPROVED FOR PUBLIC WATER, PUBLIC SEWERAGE AND STORM DRAINAGE SYSTEMS AND ROADS.

[Signature] 8-22-74
DIRECTOR DATE

[Signature]
CHIEF, BUREAU OF HIGHWAYS

LEGEND
 (360) --- EX. CONTOURS
 260 --- PROP. CONTOURS
 2604 --- SPOT CONTOURS

TITLE DRAINAGE AREA MAP		 ENGINEERING PLANNING SURVEYING BY BOENDER ASSOCIATES INC. BALTIMORE, MD. 466-7777 SALISBURY, MD. 749-1286 WESTMINSTER, MD. 848-5588		
PROJECT E.G.U. SUBDIVISION SECTION 2, AREA 2 LOT 18 COLUMBIA, MD.				
LOCATION GTHELECTION DISTRICT HOWARD CO., MD.	DATE: 5/21/74	DES. BY: TKO	DRAWN BY: TD	CHKD. BY: TKO
SCALE: 1" = 50'	JOB NO. 74-23-01	DRWG. NO. 2 OF 4		DATE: 8/22/74

REVISED 23 JULY 74

REVISIONS			
ISSUE	BY & DATE	DESCRIPTION	APPROVED & DATE

VICINITY MAP
SCALE: 1"=2000'

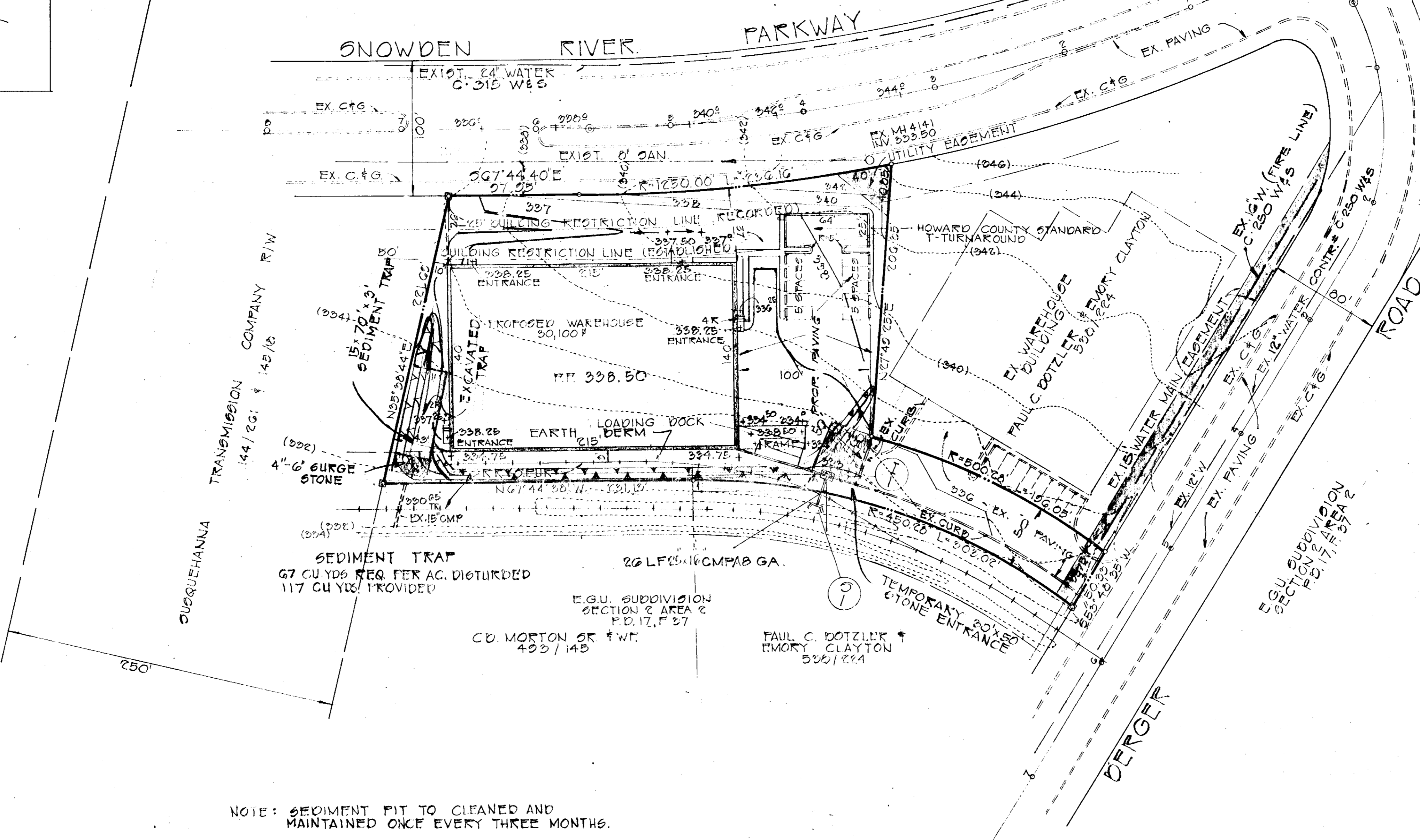
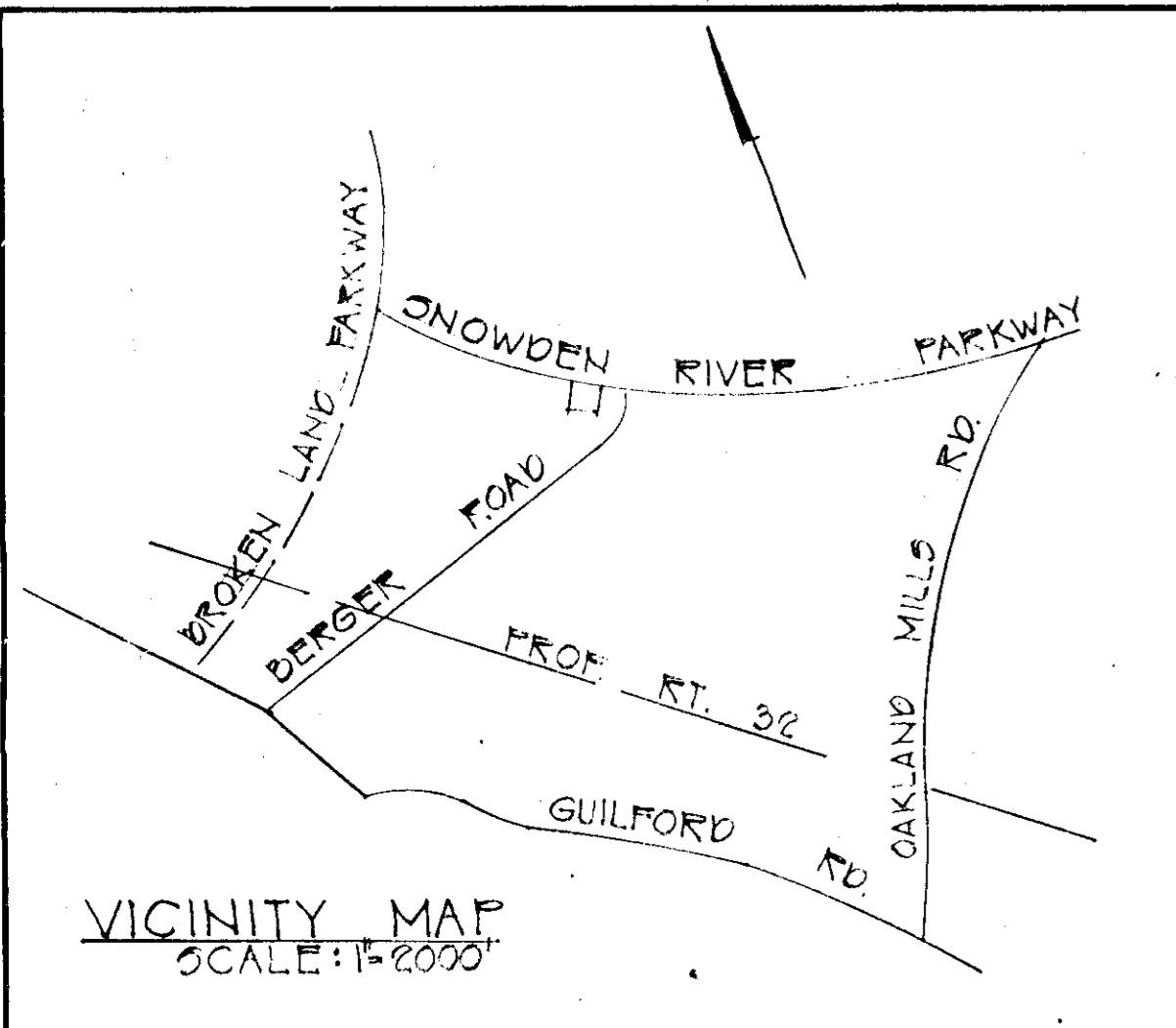

GENERAL NOTES

1. AREA OF TRACT: 1.021 ACRES
2. ZONING: NEW TOWN EMPLOYMENT
3. SITE USE: WAREHOUSE
4. PLAT BOOK REF: PD 22, F 88
5. PARKING REQUIRED: 10
6. PARKING PROVIDED: 10
7. TAX MAP: 42
8. PUBLIC WATER & SEWER
9. OWNERSHIP: TOUR M PROPERTIES, INC.
20X 3724 S
SAN ANTONIO, TEXAS 78210
10. DEVELOPER: CHARLES A. KNOTT, INC.
25 FRANCIS J. McGUINNESS
1726 WHITEHEAD ROAD
BALTIMORE, MD 21207
PHONE: 468-8800
11. ENGINEER: BOENDER ASSOCIATES, INC.
2726 TOWN & COUNTRY BLVD.
ELLICOTT CITY, MD 21042
PHONE: 468-7777
12. NO. OF EMPLOYEES: 20

NOTE: SEDIMENT PIT TO CLEANED AND MAINTAINED ONCE EVERY THREE MONTHS.

REVIEWED FOR HOWARD S.C.D. AND METS TECHNICAL REQUIREMENTS.
James M. Helms 8-16-74 DATE
U.S. SOIL CONSERVATION SERVICE

THIS DEVELOPMENT PLAN IS APPROVED FOR SOIL EROSION AND SEDIMENT CONTROL BY THE HOWARD COUNTY SOIL CONSERVATION DISTRICT.
Robert J. Zisk 8-16-74 DATE
HOWARD COUNTY SOIL CONSERVATION DISTRICT

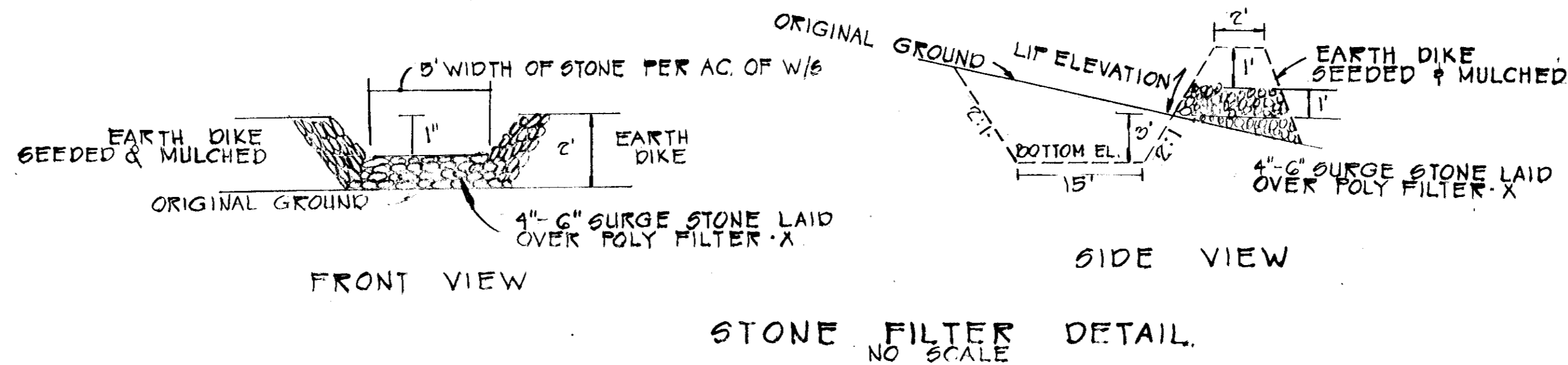

LEGEND

- (200) EX. CONTOURS
- 200 PROP. CONTOURS
- 2009 SPOT CONTOURS

APPROVED FOR PUBLIC WATER AND PUBLIC SEWERAGE SYSTEMS.
HOWARD COUNTY HEALTH DEPARTMENT.

John A. Harris, Jr. 8/21/74 DATE
COUNTY HEALTH OFFICER

APPROVED: HOWARD COUNTY OFFICE OF PLANNING AND ZONING.
John A. Harris, Jr. 8-23-74 DATE
PLANNING DIRECTOR

J. H. Kauson 8/22/74 DATE
CHIEF, DIVISION OF LAND DEVELOPMENT AND TRANSPORTATION PLANNING.

APPROVED FOR PUBLIC WATER, PUBLIC SEWERAGE AND STORM DRAINAGE SYSTEMS AND ROADS.
W. O. Falbert 8-22-74 DATE
DIRECTOR

TITLE: SEDIMENT CONTROL PLAN			
PROJECT: E.G.U. SUBDIVISION SECTION 2, AREA 2 LOT 18 COLUMBIA, MD.			
LOCATION: GTHELECTION DISTRICT HOWARD CO., MD.			
DATE: 8/21/74	DES. BY: JKS	DRAWN BY: TD	CHKD. BY: JKS
SCALE: 1"=50'	JOB NO.: 7488-01	DRWG. NO.: 201-4	DATE: 8/22/74

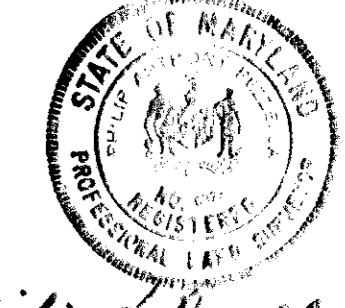

ENGINEERING PLANNING SURVEYING BY
BOENDER ASSOCIATES INC.
BALTIMORE, MD. 466-7777
SALISBURY, MD. 749-1286
WESTMINSTER, MD. 840-5588

SEDIMENT CONTROL NOTES

- 1) THE H. S. C. D. AND BUREAU OF LICENSE, INSPECTION, AND PERMITS WILL BE GIVEN 24 HOURS NOTICE PRIOR TO ANY GRADING.
- 2) ALL SEDIMENT CONTROL STRUCTURES SHOWN ON THIS PLAN, UNLESS OTHERWISE SPECIFIED, WILL BE INSTALLED AND STABILIZED IN ACCORDANCE WITH NOTE #9 PRIOR TO ANY OTHER GRADING OR EARTH DISTURBANCE ON THIS SITE.
- 3) AS SOON AS ROUGH GRADING IS COMPLETED, AREA TO BE PAVED WILL BE STABILIZED WITH BASE MATERIAL.
- 4) ALL CUT AND FILL SLOPES WILL BE A MAXIMUM OF 3:1.
- 5) FOLLOWING THE STABILIZATION OF ALL AREAS, UPGRADE THE AREA OF THE SEDIMENT CONTROL. MEASURES MAY BE REMOVED AND GRADED TO THE FINAL GRADES PLANNED AND STABILIZED IMMEDIATELY.
- 6) ELEVATIONS MARKED THUS (X) ARE FINISHED GRADES.
- 7) IN THE EVENT OF EXCESS OF MATERIAL, THE WASTE WILL BE STOCKPILED WITH A MAXIMUM 2:1 SLOPE ON AN AREA WHICH HAS BEEN CLEARED ON THE SITE. STOCKPILED MATERIAL WILL BE STABILIZED IN ACCORDANCE WITH NOTE #9.
- 8) SEDIMENT CONTROL MEASURES WILL NOT BE REMOVED UNTIL APPROVAL IS OBTAINED FROM THE H. S. C. D..
- 9) TEMPORARY STABILIZATION:
APPLY 2000 LBS. / ACRE OR 46 LBS. / SQ. FT. OF PULVERIZED DOLOMITIC LIMESTONE.
500 LBS. / ACRE OR 11.5 LBS. / 1000 SQ. FT. OF 5-5-5 FERTILIZER, PLANT TO RYEGRASS @ 40 LBS. / ACRE. FERTILIZE WITH 5-10-10, AND MULCH WITH STRAW @ 1 1/2 TONS / ACRE.
- 10) PERMANENT STABILIZATION:
APPLY 2000 LBS. / ACRE OF PULVERIZED DOLOMITIC LIMESTONE.
700 LBS. / ACRE OF 0-20-0 SOLUBLE PHOSPHATE.
1000 LBS. / ACRE OF 5-10-10 FERTILIZER.
SEED: 45 LBS. / ACRE OF KENTUCKY 31 TALL FESCUE.
40 LBS. / ACRE OF KENTUCKY BLUE GRASS.
25 LBS. / ACRE OF ANNUAL RYE GRASS.
NOTE: SEEDING MAY BE DONE BETWEEN MARCH 1 - MAY 1, OR AUGUST 1 - OCTOBER 1 ONLY.
MULCH: 2 TONS / ACRE OF UNWEATHERED WHEATSTRAW, TIE MULCH DOWN WITH 400 GAL. / ACRE OF LIQUID ASPHALT.

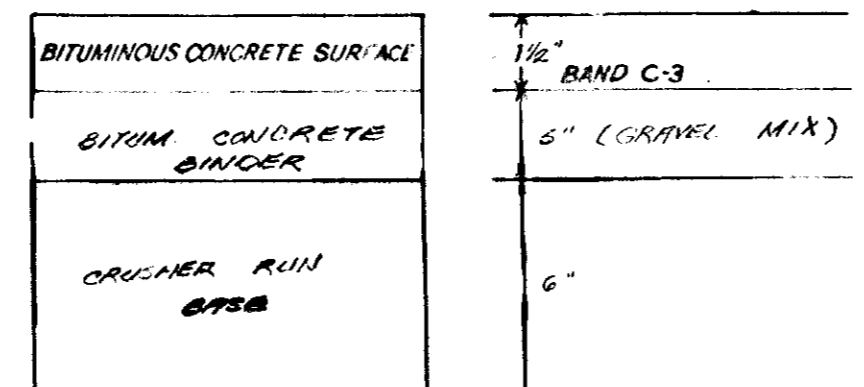
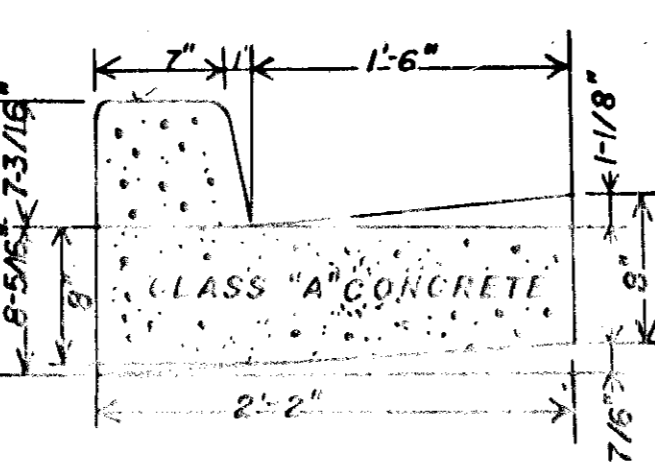
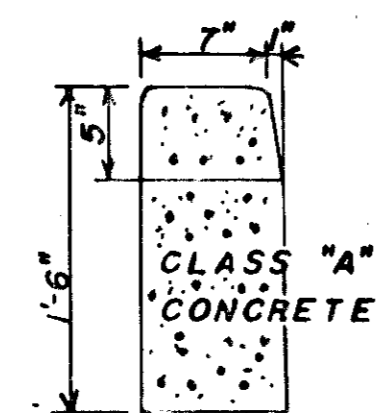
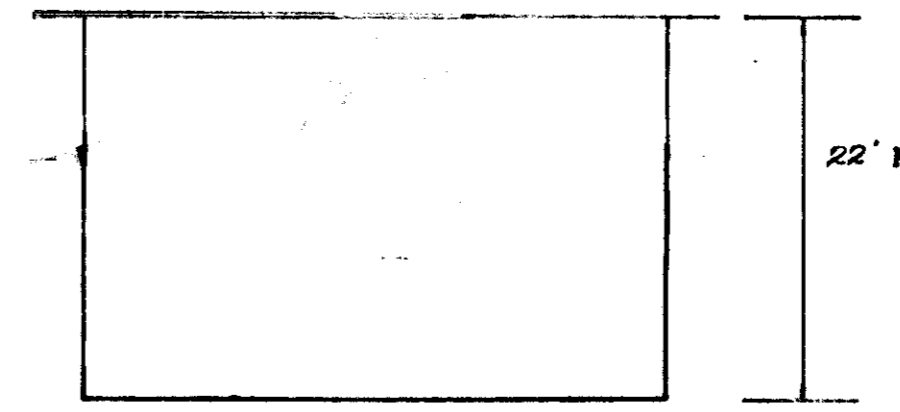
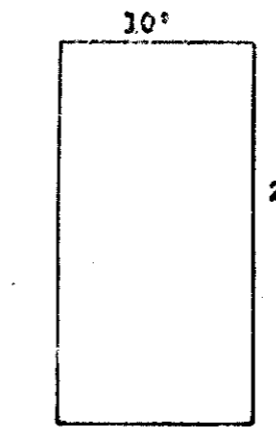
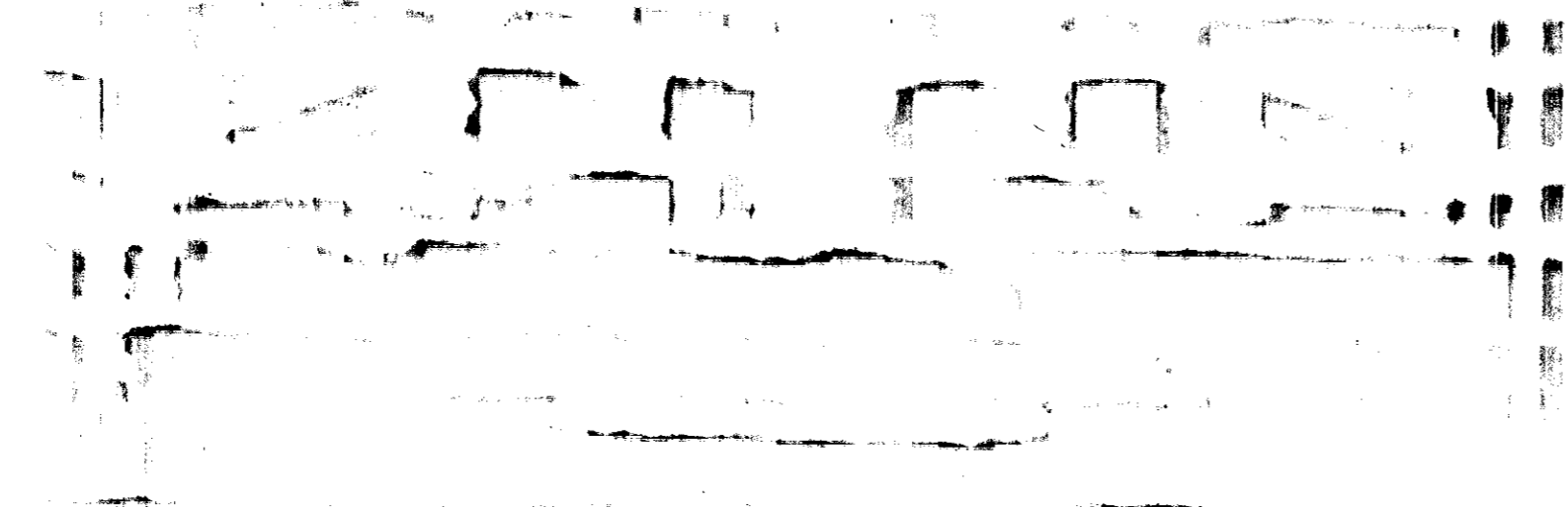

CLEARING & GRADING SUBGRADE SANDWICH COURSE SURFACE

ARTICLE C-1
ARTICLE C-2
ARTICLE C-21 OR C-22
ARTICLE C-21

TO BE CONSTRUCTED IN ACCORDANCE WITH THE HOWARD COUNTY ROAD CONSTRUCTION CODE AND SPECIFICATIONS

DRWG. D-8 PAGE 48

- PAVING SPECIFICATION
- 1) BASE WILL BE PRIMED IN ACCORDANCE WITH SECTION C-32-3 AS PROVIDED IN THE HOWARD COUNTY ROAD CONSTRUCTION CODE AND STANDARD SPECIFICATIONS.
 - 2) TACK COAT IS REQUIRED IN ACCORDANCE WITH SECTION C-31-4 OF THE HOWARD COUNTY ROAD CONSTRUCTION CODE AND STANDARD SPECIFICATIONS.

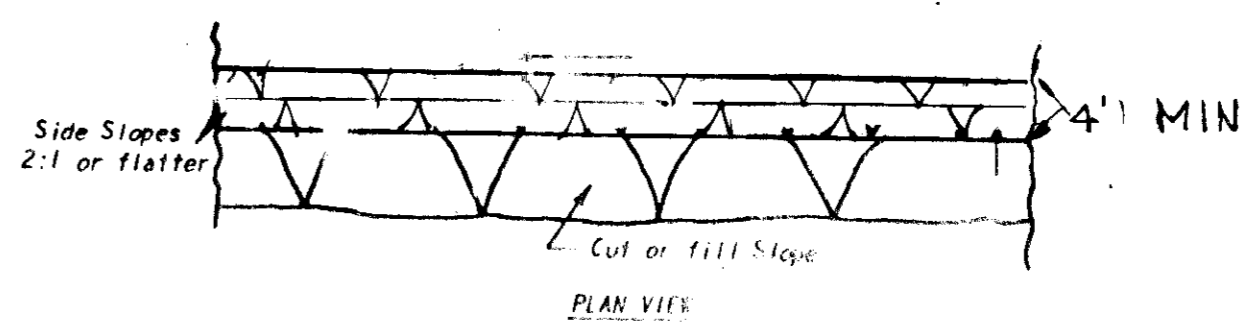
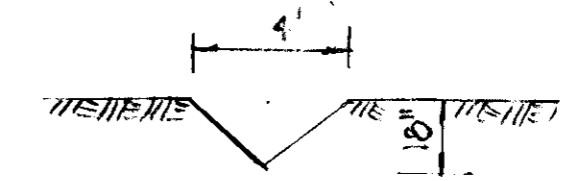

- General Notes
1. All drawings Not to Scale.
 2. All dikes must be machine compacted.
 3. All diversion dikes must have positive grade draining to a stabilized outlet.
 4. Diverted runoff will outlet onto a stabilized undisturbed area, a prepared level spreader, or into a grade stabilization structure.
 5. Periodic inspection and required maintenance must be provided.

REVIEWED FOR Howard S. C. D. AND PERMITS TECHNICAL REQUIREMENTS.
James M. Mordella 8-16-74
U. S. SOIL CONSERVATION SERVICE DATE

THIS DEVELOPMENT PLAN IS APPROVED FOR SOIL EROSION AND SEDIMENT CONTROL BY THE HOWARD SOIL CONSERVATION DISTRICT
Robert J. Zichow 8-16-74
HOWARD SOIL CONSERVATION DIST. DATE

ENGINEER'S STATEMENT

I CERTIFY THAT THIS PLAN FOR EROSION AND SEDIMENT CONTROL REPRESENTS A PRACTICAL AND WORKABLE PLAN BASED ON MY PERSONAL KNOWLEDGE OF THE SITE CONDITIONS AND THAT IT WAS PREPARED IN ACCORDANCE WITH THE REQUIREMENTS OF THE HOWARD SOIL CONSERVATION DISTRICT.
Thomas A. Pappalardo 6/12/74
DATE



DEVELOPER'S STATEMENT

I CERTIFY THAT ALL THE DEVELOPMENT AND / OR CONSTRUCTION WILL BE DONE ACCORDING TO THIS PLAN OF DEVELOPMENT AND PLAN FOR EROSION AND SEDIMENT CONTROL, AND I ALSO APPROVE PERIODIC ON-SITE INSPECTION BY THE HOWARD SOIL CONSERVATION DISTRICT OR THEIR AUTHORIZED AGENTS, AS SHE DEEMED NECESSARY. DEVIATION FROM THIS PLAN WILL NOT BE MADE UNLESS AUTHORIZED BY THE HOWARD SOIL CONSERVATION DISTRICT.
Henry A. Knoff II 7/1/74
DATE

APPROVED FOR PUBLIC WATER AND PUBLIC SEWERAGE SYSTEMS.
HOWARD COUNTY HEALTH DEPARTMENT
John J. ... 8/22/74
COUNTY HEALTH OFFICER

APPROVED HOWARD COUNTY OFFICE OF PLANNING & ZONING.
William L. ... 8/22/74
PLANNING DIRECTOR

APPROVED FOR PUBLIC WATER AND PUBLIC SEWERAGE AND STORM DRAINAGE SYSTEMS AND ROADS.
William L. ... 8/22/74
DIRECTOR

W.O. ... 8-22-74
CHIEF, BUREAU OF HIGHWAYS

TITLE: DETAIL SHEET				ENGINEERING: BOENDER ASSOCIATES INC.
PROJECT: P.G.U. SUBDIVISION SECTION 2 AREA 2 LOT 10 COLUMBIA, MD.				PLANNING: BOENDER ASSOCIATES INC.
LOCATION: HOWARD CO., MD.		DATE: 6/10/74		DESIGNER: T.G.
SCALE: AS SHOWN		JOB NO.: 7455		DRWG. NO.: 4014

Revision Record			
No.	Date	Per	Description

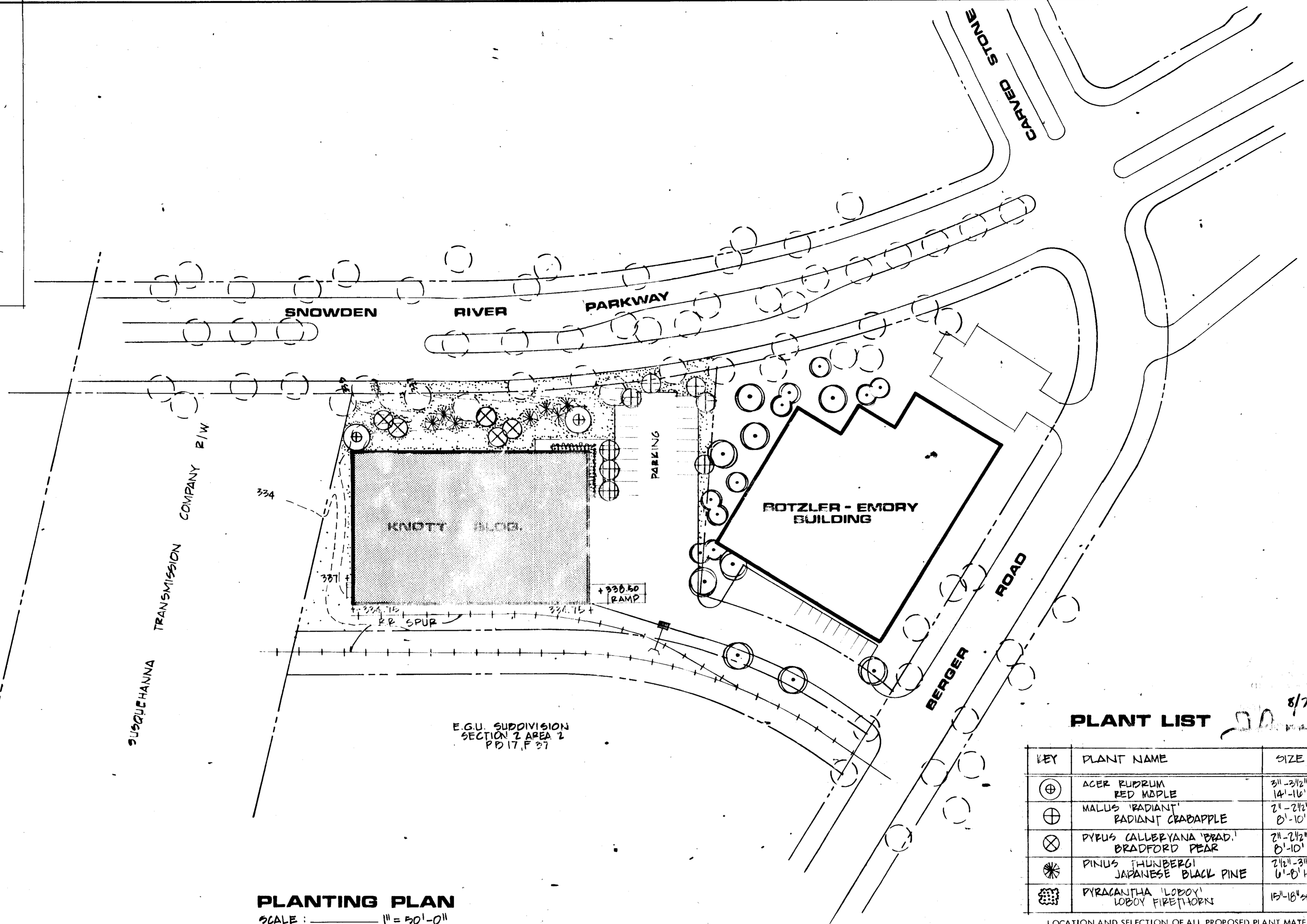
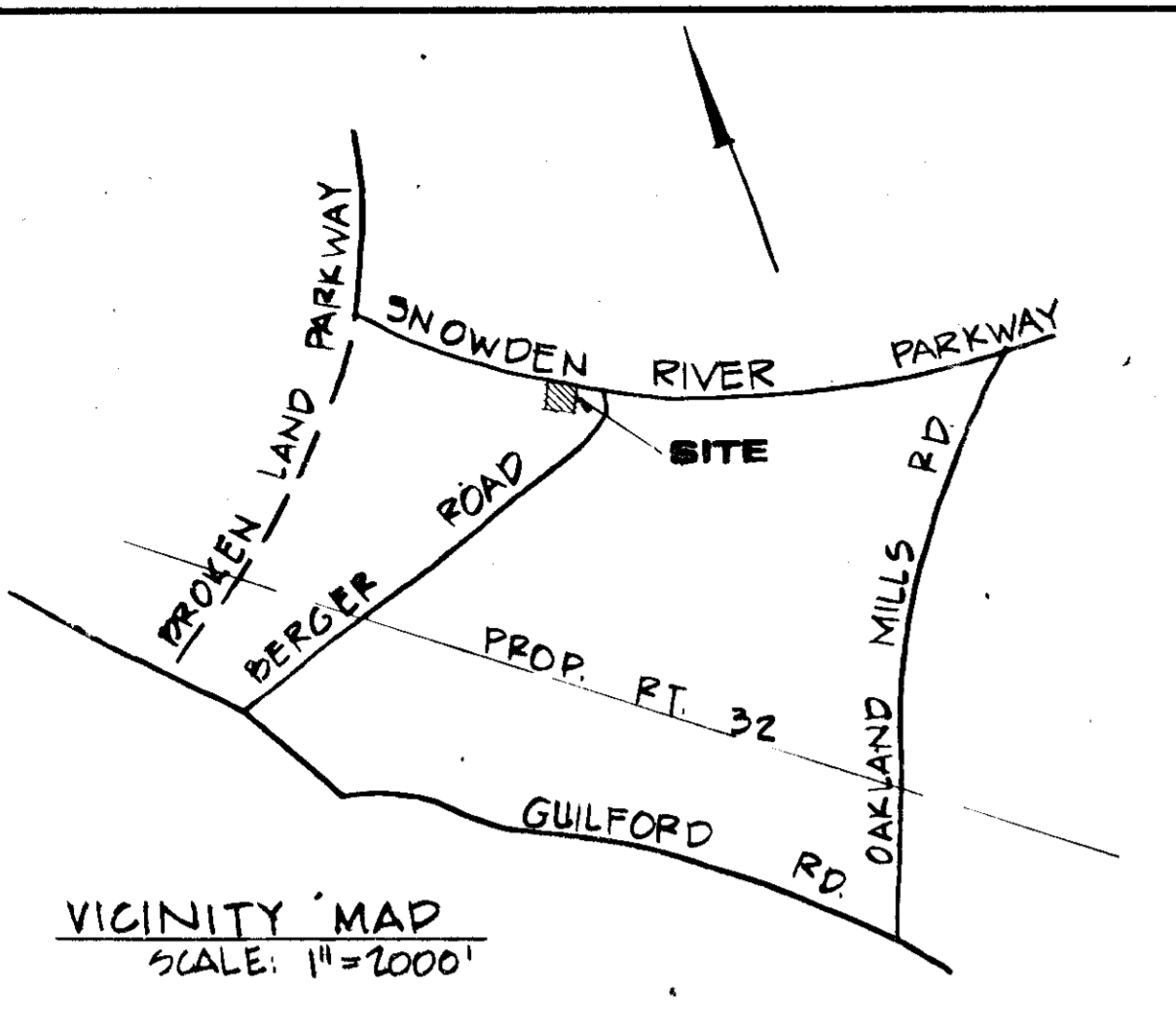

PLANT LIST 8/7/74

KEY	PLANT NAME	SIZE	QUANT.	REMARKS
⊕	ACER RUBRUM RED MAPLE	3 1/2" - 2 1/2" CAL. 14' - 16' HT.	2	B&B FULL HEADS
⊕	MALUS 'RADIANT' RADIANT CRABAPPLE	2 1/2" - 2 1/2" CAL. 8' - 10' HT.	0	B&B HEAVY SPEC.
⊗	PYRUS CALLERYANA 'BRAD.' BRADFORD PEAR	2 1/2" - 2 1/2" CAL. 8' - 10' HT.	5	B&B HEAVY SPEC.
⊗	PINUS THUNBERGII JAPANESE BLACK PINE	2 1/2" - 3" CAL. 6' - 8' HT.	7	B&B HEAVY HEADS
⊗	PYRACANTHA 'LOBOY' LOBOY FIRETHORN	1 1/2" - 1 1/2" SP. / HT.	50	B&B FULL HEADS

LOCATION AND SELECTION OF ALL PROPOSED PLANT MATERIAL IS TO BE APPROVED IN THE FIELD BY THE LANDSCAPE ARCHITECT.
 ALL PLANT MATERIAL IS TO BE GUARANTEED BY THE LANDSCAPE CONTRACTOR FOR ONE FULL GROWING SEASON AFTER THE LAST PLANT HAS BEEN INSTALLED AND APPROVED BY THE LANDSCAPE ARCHITECT.
 ALL PLANT MATERIAL AND ALL PLANTING METHODS ARE TO BE IN CONFORMANCE WITH 'THE ROUSE COMPANY COLUMBIA PLANTING SPECIFICATIONS', LATEST EDITION.
 ALL PLANT MATERIAL IS TO BE NURSERY GROWN IN ACCORDANCE WITH 'THE U.S.A. STANDARD FOR NURSERY STOCK', LATEST EDITION.
 CONTRACTOR IS TO VERIFY CORRECT LOCATION OF ALL UNDERGROUND UTILITIES IN THE FIELD BEFORE PROCEEDING WITH THE INSTALLATION OF ANY PROPOSED PLANT MATERIAL.

- ⊕ PROPOSED STREET TREE BY H.R.D.
- ⊗ EXISTING TREE

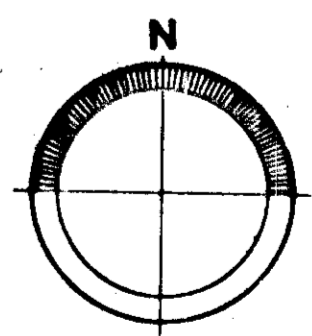
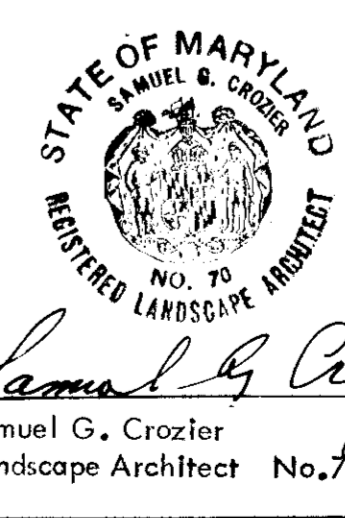

Ten Oaks Nursery and Gardens, Inc.
 Design Division
 5585 Sterrett Place
 Columbia, Maryland 21044

Project: E.G.U., SECTION 2, AREA 2, LOT 10
 THE KNOTT BUILDING

Subject: PLANTING PLAN

DWG. No. **TO-N-431-1**

of 1

Date: 7-2-74 Dwn. By: P.G. SUTT
 Scale: 1" = 50'-0" Ck. By: P.G. SUTT
 Des. By: P.G. SUTT App. By: P.G. SUTT
 CCF. No. 7155

APPROVED: FOR PUBLIC WATER AND PUBLIC SEWERAGE SYSTEMS,
 HOWARD COUNTY HEALTH DEPARTMENT

J. W. ...
 COUNTY HEALTH OFFICER
 DATE: 8/22/74

APPROVED: HOWARD COUNTY OFFICE OF PLANNING AND ZONING.

...
 PLANNING DIRECTOR
 DATE: 8-23-74

CHIEF, DIVISION OF LAND DEVELOPMENT AND
 TRANSPORTATION PLANNING.

...
 DATE: 8/22/74

APPROVED: FOR PUBLIC WATER, PUBLIC SEWERAGE AND STORM DRAINAGE
 SYSTEMS AND ROADS.

...
 DIRECTOR
 DATE: 8-22-74

W.O. ...
 CHIEF, BUREAU OF HIGHWAYS

BRUNING 44-132 3119D