

7-9-20 REV. #3
K&E ENGINEERING, INC.
610 GLENDALES CT. #311
TOWSON, MD. 21286

REVISIONS				
ISSUE	BY & DATE	DESCRIPTION	CHECK	APPROVED & DATE
	8/6/74	REVISED		

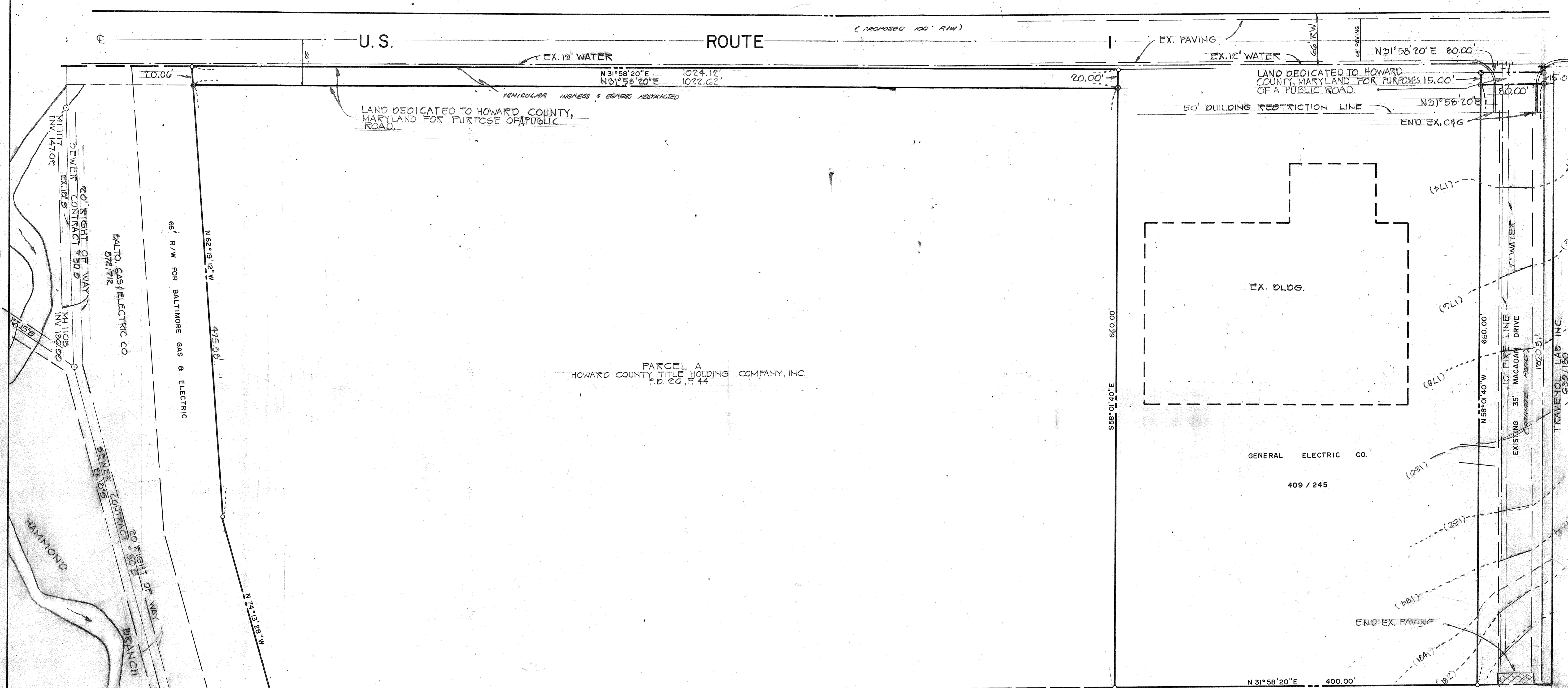

U.S. ROUTE

LAND DEDICATED TO HOWARD COUNTY, MARYLAND FOR PURPOSE OF PUBLIC ROAD.

PARCEL A
HOWARD COUNTY TITLE HOLDING COMPANY, INC.
P.D. 26, F. 44

LAND DEDICATED TO HOWARD COUNTY, MARYLAND FOR PURPOSES 15.00' OF A PUBLIC ROAD.

GENERAL ELECTRIC CO.

409 / 245

GENERAL NOTES

- TOTAL AREA OF SITE: 30.024 AC.
- BUILDING USE: WAREHOUSE
- NO. OF EMPLOYEES: 200
- PARKING SPACES PROVIDED: 182
- PARKING SPACES REQUIRED: 100
- TAX MAP: 47
- PARCEL: B
- ZONING: M-2
- PLAT REFERENCE: P.D. 26, F. 43
- OWNER & DEVELOPER: LEROY MERRITT
- ENGINEER: BOENDER ASSOCIATES
- 3720 TOWN & COUNTRY BLVD. ELLICOTT CITY, MD. 21043
- 458-7777
- COVERPAGE: 1 of 2

APPROVED
DIVISION OF LAND DEVELOPMENT
AND TRANSPORTATION PLANNING
HOWARD COUNTY, MARYLAND
DATE 10/15/74

NOTE:
THE LOTS OR PARCELS SHOWN ON THIS PLAT ARE SUBJECT TO THE SUPPLEMENTAL SEWER IN AID OF CONSTRUCTION CHARGE CREATED BY SECTION 20-311A OF THE HOWARD COUNTY CODE AND TO THE EXECUTIVE ORDER NO. 72-5

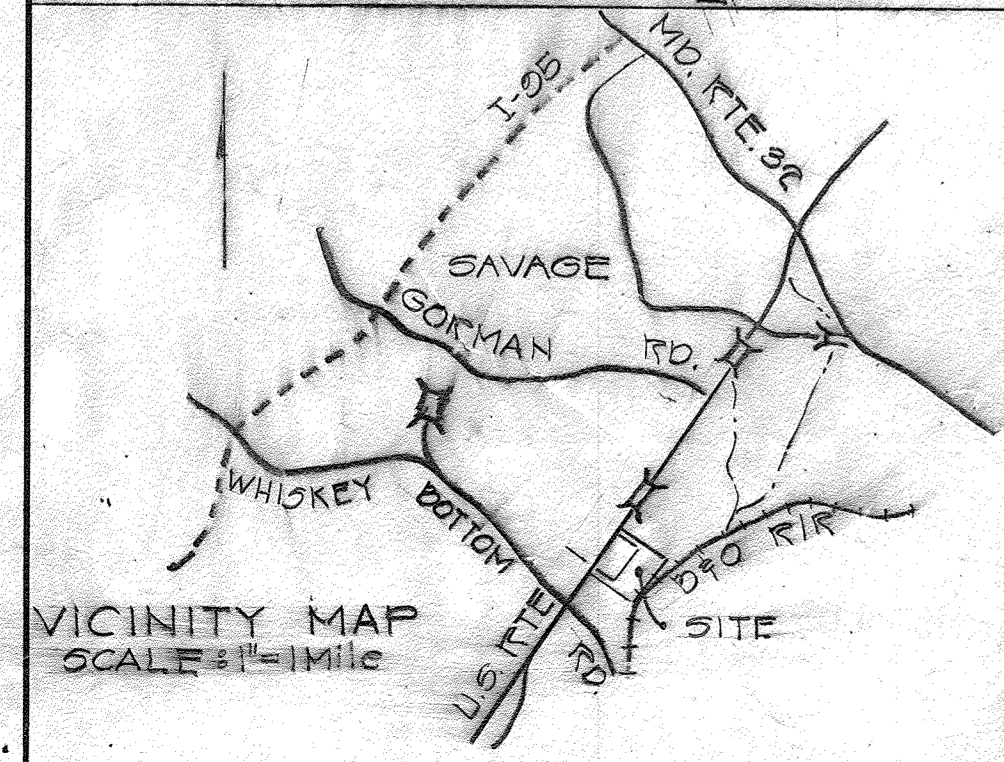

APPROVED FOR PUBLIC WATER AND PUBLIC SEWERAGE SYSTEMS, HOWARD COUNTY HEALTH DEPARTMENT.
[Signature]
HOWARD COUNTY HEALTH OFFICER
DATE 10/28/74

APPROVED FOR HOWARD COUNTY OFFICE OF PLANNING AND ZONING.
[Signature]
PLANNING DIRECTOR
DATE 10/28/74

APPROVED FOR PUBLIC WATER AND PUBLIC SEWERAGE AND STORM DRAINAGE SYSTEMS AND ROADS.
[Signature]
DIRECTOR
DATE 10/23/74

TITLE: SITE PLAN
PROJECT: HOWARD COUNTY TITLE HOLDING COMPANY, INC.
LOCATION: 6TH ELECTION DISTRICT HOWARD CO., MD.
DATE: 4/16/74 DES. BY: I.K.O. DRAWN BY: DR. CHKD. BY: J.D.
SCALE: 1"=50' JOB NO. 7427 BRWG. NO. 10711



ENGINEERING PLANNING SURVEYING BY
BOENDER ASSOCIATES INC.
BALTIMORE, MD. 488-7777
GALIBURDY, MD. 740-1286
WESTMINSTER, MD. 848-6688

ISSUE	BY & DATE	DESCRIPTION	CHECK	APPROVED & DATE
010/74		REVISED		
7/25/04		PROPOSED BRIDGE		
3	11/13/99	HC RAMPS & RAMPS, PARKING @ CONC RAMPS & HC RAMP		
4	11/4/00	CONC RAMPS & HC RAMP		
5	11/19/09	ADDED ADA RAMP, HC PARKING, FENCED AREA & DETAIL, CONC. RAMP, -FSH		
6	11/28/13	Remove existing 3th wood retaining wall. Replace w/ new 3th concrete segmental block retaining wall. See detail sheet 11 of 11.		
7	5-4-17	ADDED ADA RAMP, HC PARKING, FENCED AREA & DETAIL, CONC. RAMP, -FSH		
8	7-9-20	ADDED WHEELCHAIR LIFT, STEPS AND HC SPACE -NJB		

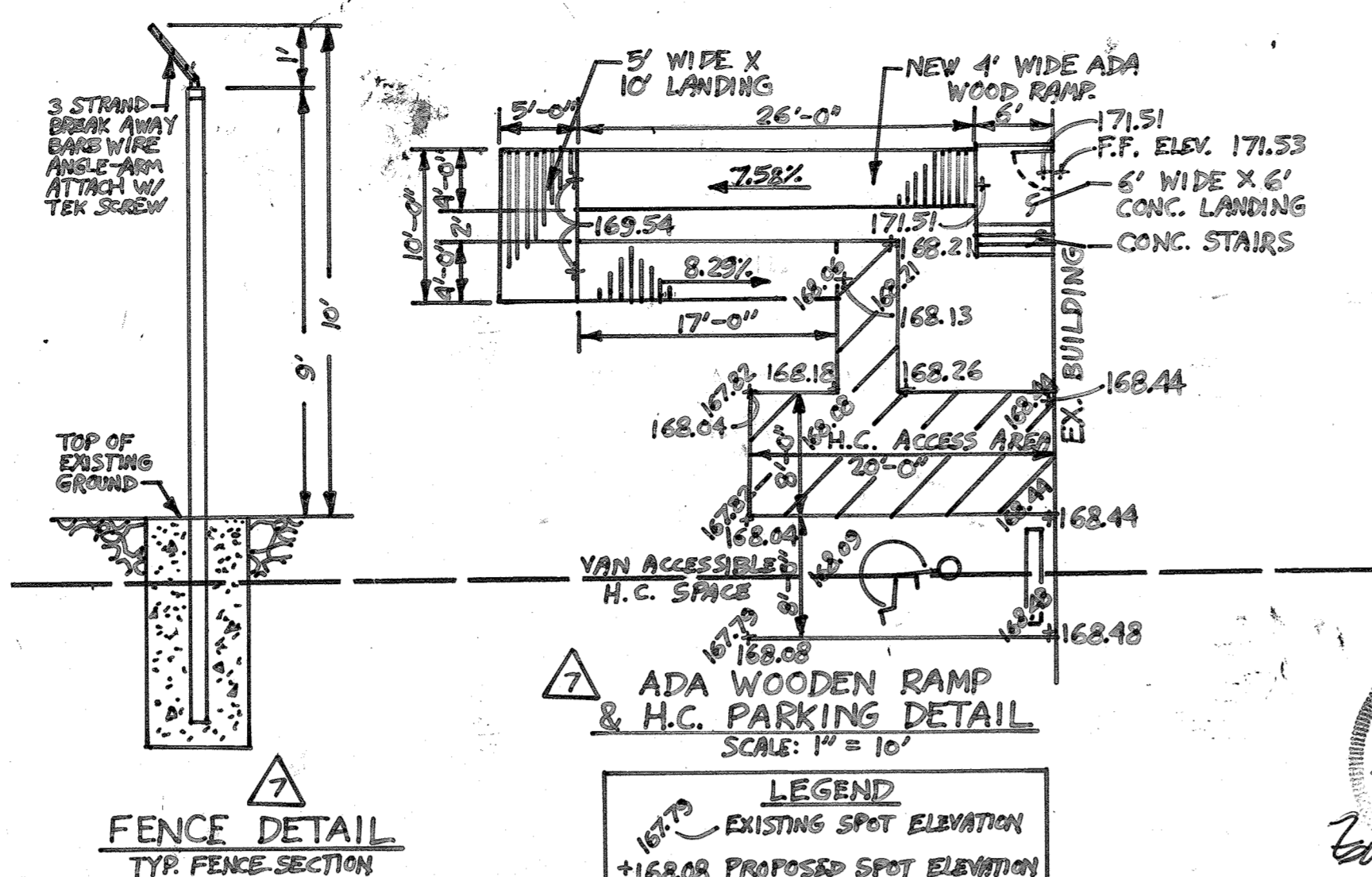
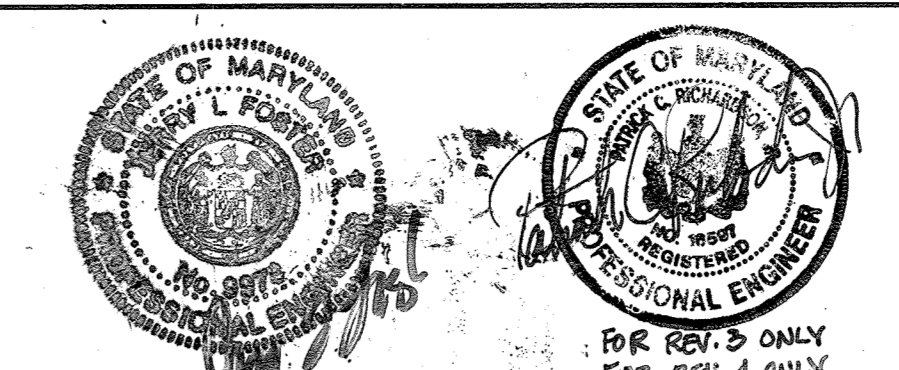

ADA WOODEN RAMP & H.C. PARKING DETAIL
SCALE: 1" = 10'

LEGEND
 167.75 EXISTING SPOT ELEVATION
 168.08 PROPOSED SPOT ELEVATION

10/15/74
12/6/17
12/2/24
For Rev. # 7 only.

PROFESSIONAL ENGINEER
NO. 18555
NICHOLAS JOSEPH BRANDO
STATE OF MARYLAND
7-9-20 REV #8
NJB ENGINEERING, INC.
810 GLENHAGES CT-SUITE 311
TOWSON, MD 21286

PARCEL "A"
HOWARD CO. TITLE HOLDING CO., INC.
PB. 276, F. 44

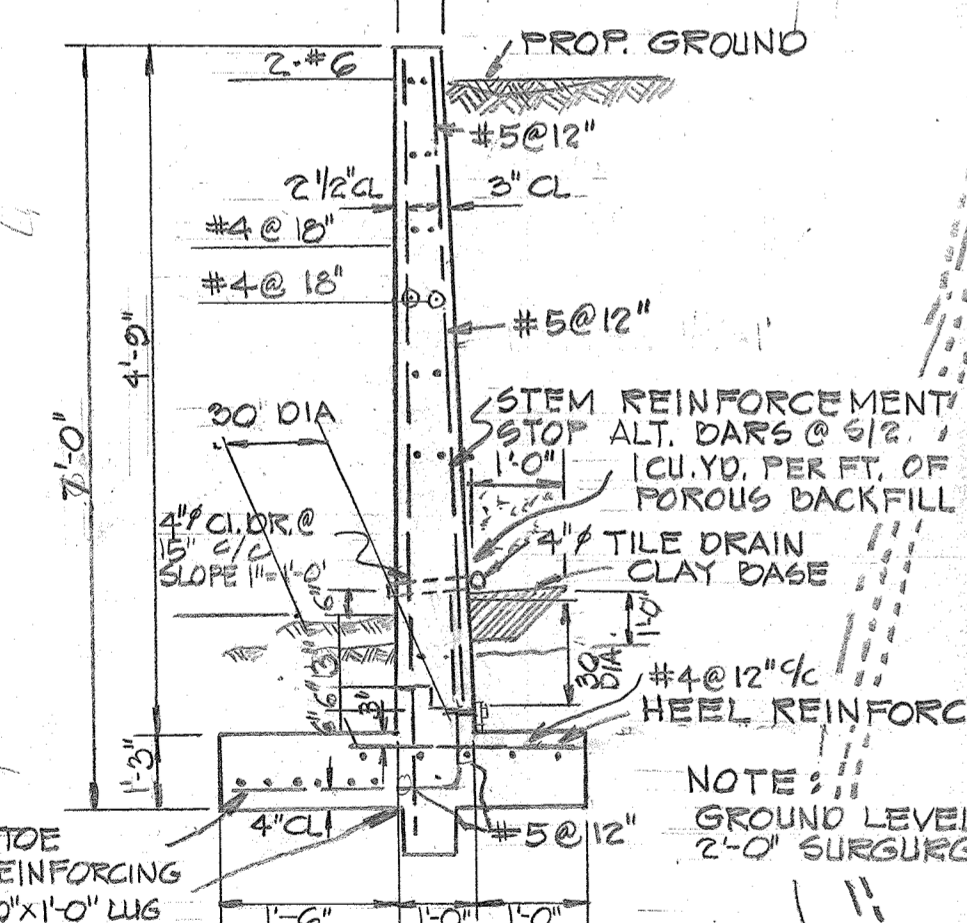
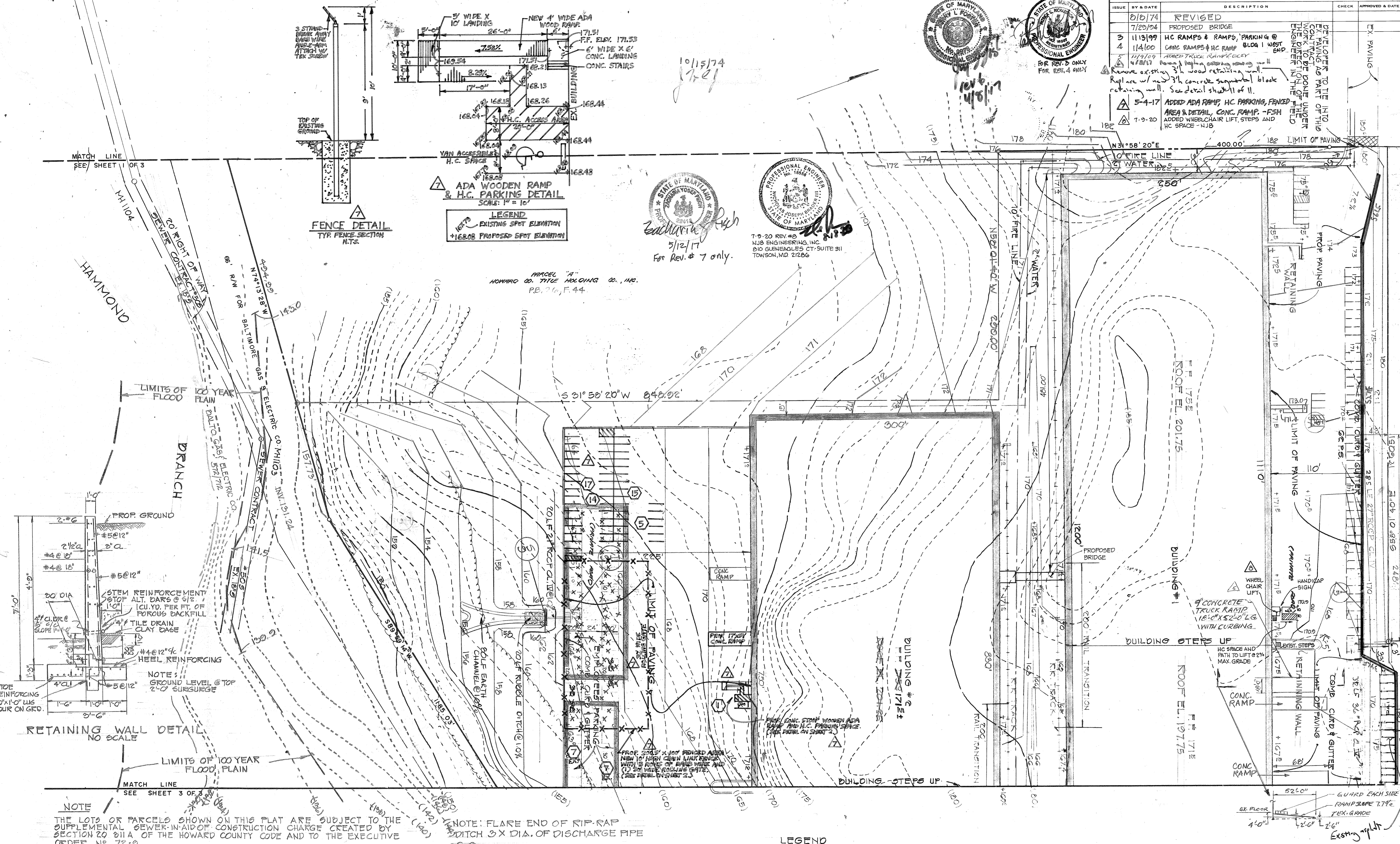

RETAINING WALL DETAIL
NO SCALE

NOTE: THE LOTS OR PARCELS SHOWN ON THIS PLAT ARE SUBJECT TO THE SUPPLEMENTAL SEWER-IN-AID OF CONSTRUCTION CHARGE CREATED BY SECTION 20.011A OF THE HOWARD COUNTY CODE AND TO THE EXECUTIVE ORDER NO. 72-0.

NOTE: FLARE END OF RIP-RAP DITCH 3X DIA. OF DISCHARGE PIPE 5'-0."

LEGEND
 --- EX. CONTOURS
 --- PROP. CONTOURS
 366B SPOT ELEV.

APPROVED: FOR PUBLIC WATER AND PUBLIC SEWERAGE SYSTEMS, HOWARD COUNTY HEALTH DEPARTMENT.
 HOWARD COUNTY HEALTH OFFICER DATE

APPROVED: HOWARD COUNTY OFFICE OF PLANNING AND ZONING.
 PLANNING DIRECTOR DATE
 CHIEF, DIVISION OF LAND DEVELOPMENT AND TRANSPORTATION PLANNING. DATE

APPROVED: FOR PUBLIC WATER AND PUBLIC SEWERAGE AND STORM DRAINAGE SYSTEMS AND ROADS.
 DIRECTOR DATE
 CHIEF, BUREAU OF HIGHWAYS DATE

TITLE	
SITE PLAN	
PROJECT	HOWARD COUNTY TITLE HOLDING CO., INC
LOCATION	GTH ELECTION DISTRICT HOWARD CO., MD.
DATE:	4/16/74
DES. BY:	T.K.E.
DRAWN BY:	D.R.
CHKD. BY:	J.D.
SCALE:	1" = 30'
JOB NO.	7427
DRWG. NO.	2 OF 11

ENGINEERING PLANNING SURVEYING BY
BOENDER ASSOCIATES INC.
 BALTIMORE, MD 465-7777
 SALISBURY, MD 749-1286
 WESTMINSTER, MD 548-5685

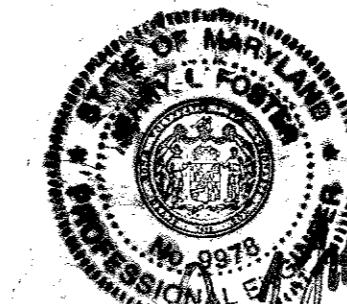

ISSUE	BY & DATE	DESCRIPTION	CHECK	APPROVED & DATE
3	11/13/74	REVISED		
4	4/12/77	CONC. RAMPS & HC RAMPS		
		Remove & replace existing retaining wall.		

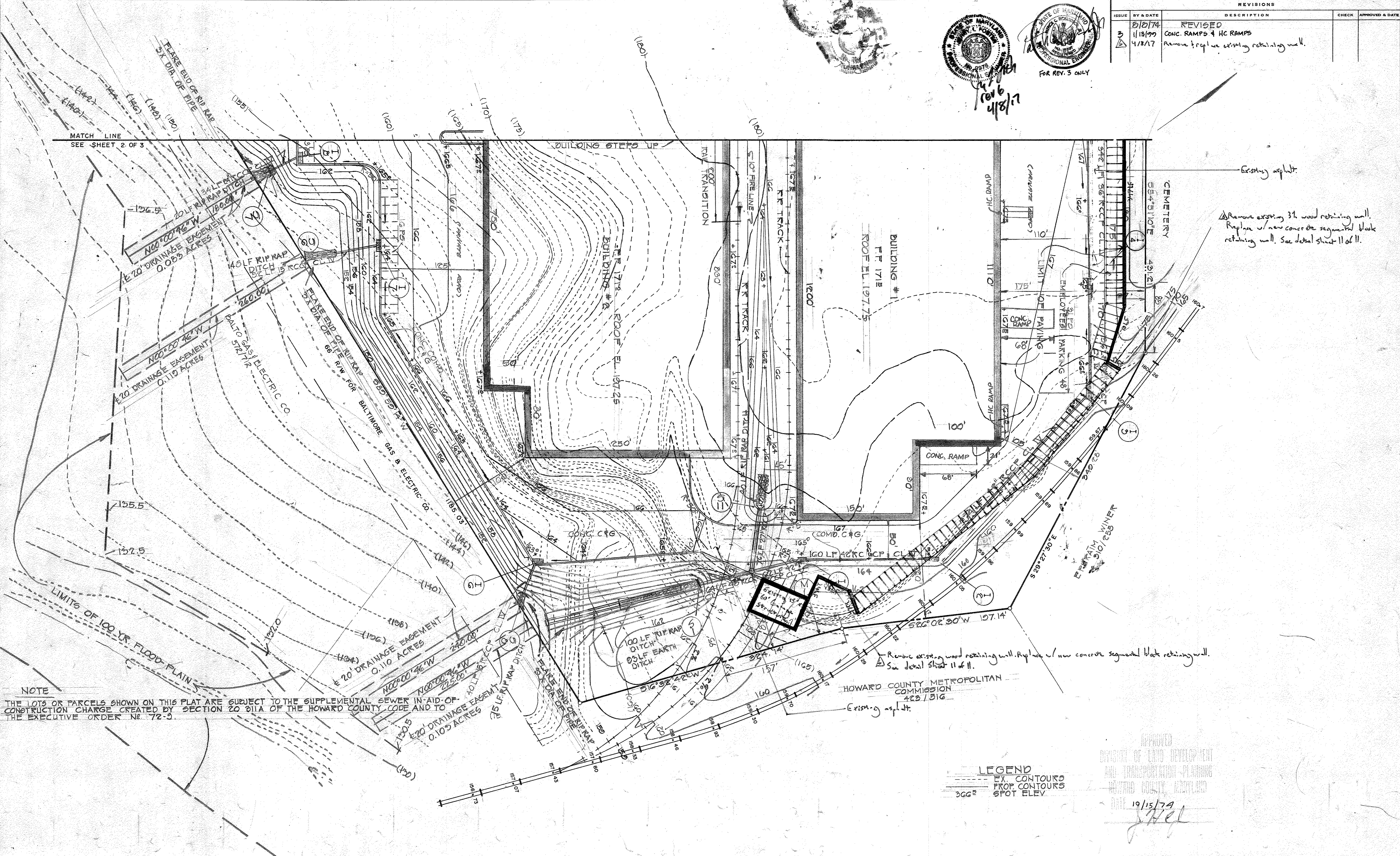

NOTE
 THE LOTS OR PARCELS SHOWN ON THIS PLAT ARE SUBJECT TO THE SUPPLEMENTAL SEWER IN-AID-OF-CONSTRUCTION CHARGE CREATED BY SECTION 20.011A OF THE HOWARD COUNTY CODE AND TO THE EXECUTIVE ORDER NO. 72-3.

LEGEND
 --- EX. CONTOURS
 --- PROP. CONTOURS
 --- 300' SPOT ELEV.

APPROVED
 DIVISION OF LAND DEVELOPMENT
 AND TRANSPORTATION PLANNING
 HOWARD COUNTY, MARYLAND
 DATE 10/15/74
J.W.E.

APPROVED: FOR PUBLIC WATER AND PUBLIC SEWERAGE SYSTEMS, HOWARD COUNTY HEALTH DEPARTMENT.
[Signature]
 HOWARD COUNTY HEALTH OFFICER
 DATE 10/28/74

APPROVED: HOWARD COUNTY OFFICE OF PLANNING AND ZONING.
[Signature]
 PLANNING DIRECTOR
 DATE 10/20/74
[Signature]
 CHIEF, DIVISION OF LAND DEVELOPMENT AND TRANSPORTATION PLANNING
 DATE 10/28/74

APPROVED: FOR PUBLIC WATER AND PUBLIC SEWERAGE AND STORM DRAINAGE SYSTEMS AND ROADS.
[Signature]
 DIRECTOR
 DATE 10/23/74
[Signature]
 CHIEF, BUREAU OF HIGHWAYS
 DATE 10/21/74

TITLE: SITE PLAN
 PROJECT: HOWARD COUNTY TITLE HOLDING CO., INC.
 LOCATION: GTH ELECTION DISTRICT HOWARD CO., MD
 DATE: 4/16/74 DES. BY: T.K.S. DRAWN BY: D.R. CHKD. BY: J.D.
 SCALE: 1" = 50' JOB NO. 7427 DRWG. NO. 3 OF 11

STATE OF MARYLAND
 PROFESSIONAL ENGINEER
 BOENDER ASSOCIATES INC.
 BALTIMORE, MD. 466-7777
 SALISBURY, MD. 749-1286
 WESTMINSTER, MD. 848-6688

DEVELOPER'S STATEMENT

I CERTIFY THAT ALL THE DEVELOPMENT AND / OR CONSTRUCTION WILL BE DONE ACCORDING TO THIS PLAN OF DEVELOPMENT AND PLAN FOR EROSION AND SEDIMENT CONTROL, AND I ALSO AUTHORIZE PERIODIC ON-SITE INSPECTION BY THE HOWARD SOIL CONSERVATION DISTRICT OR THEIR AUTHORIZED AGENTS, AS ARE DEEMED NECESSARY. DEVIATION FROM THIS PLAN WILL NOT BE MADE UNLESS AUTHORIZED BY THE HOWARD SOIL CONSERVATION DISTRICT.

Henry B. Pappan 10/15/74
DATE

ENGINEER'S STATEMENT

I CERTIFY THAT THIS PLAN FOR EROSION AND SEDIMENT CONTROL REPRESENTS A PRACTICAL AND WORKABLE PLAN BASED ON MY PERSONAL KNOWLEDGE OF THE SITE CONDITIONS AND THAT IT WAS PREPARED IN ACCORDANCE WITH THE REQUIREMENTS OF THE HOWARD SOIL CONSERVATION DISTRICT.

Philip A. Pappan 10/15/74
DATE



REVISIONS			
ISSUE	BY & DATE	DESCRIPTION	CHECK APPROVED & DATE

U.S. ROUTE

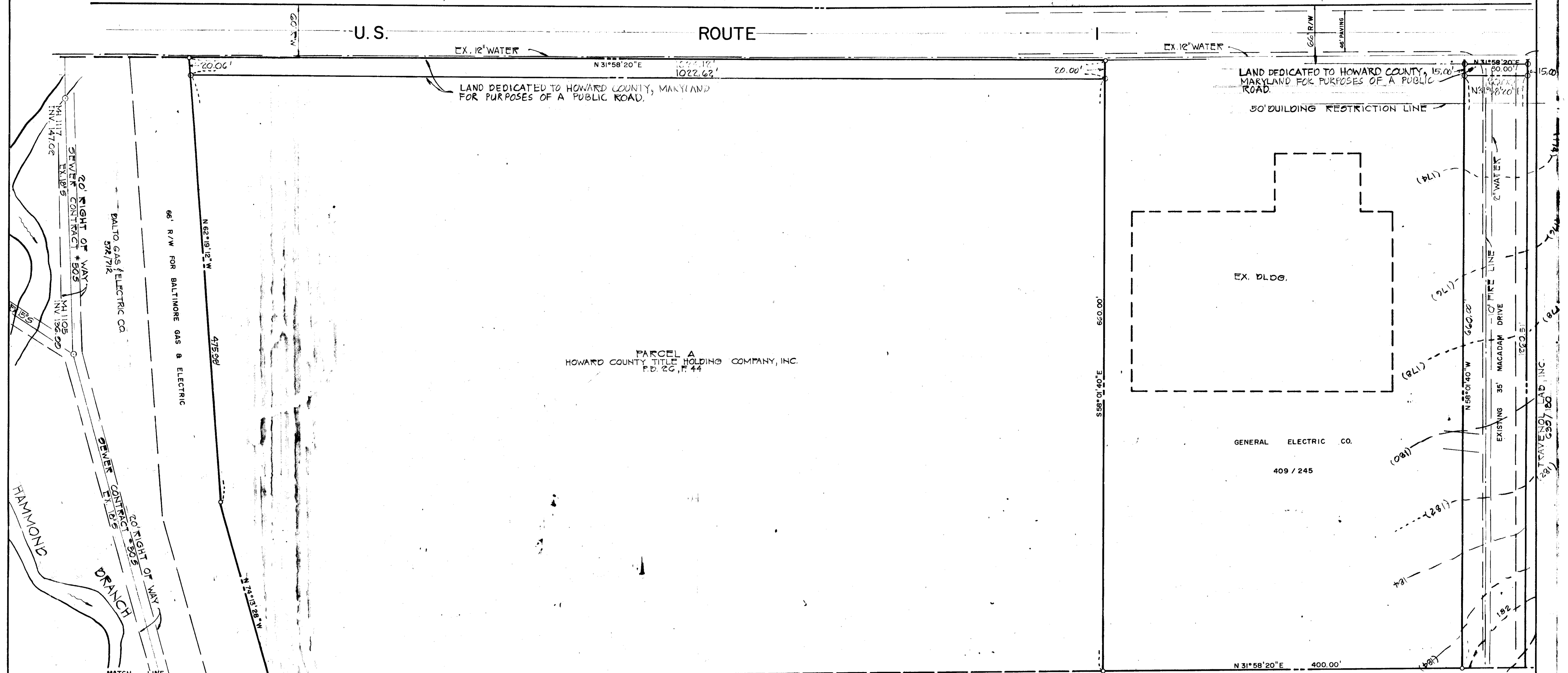

PARCEL A
HOWARD COUNTY TITLE HOLDING COMPANY, INC.
P.D. 26, F. 44

GENERAL NOTES

- 1. TOTAL AREA OF SITE: 30,004 AC.
- 2. BUILDING USE: WAREHOUSE
- 3. NO. OF EMPLOYEES: 200
- 4. PARKING SPACES PROVIDED: 181
- 5. PARKING SPACES REQUIRED: 100
- 6. TAX MAP: 47
- 7. PARCEL: D
- 8. ZONING: M-2
- 9. PLAT REFERENCE: P.D. 26, F. 43
- 10. OWNER & DEVELOPER:
LEROY MERRITT
BOENDER ASSOCIATES
2726 TOWN & COUNTRY BLVD. or 1940 RUXTON RD.
ELLICOTT CITY, MD. 21043 or BALTIMORE, MD. 21204
425-7777 or 358-6767

REVIEWED FOR Howard SCD AND MEETS TECHNICAL REQUIREMENTS.

James M. Nelson 10-17-74
DATE
U.S. SOIL CONSERVATION SERVICE
THIS DEVELOPMENT PLAN IS APPROVED FOR SOIL EROSION AND SEDIMENT CONTROL BY THE HOWARD SOIL CONSERVATION DISTRICT.

APPROVED: *Robert W. Zuehlke* 10-17-74
DATE
HOWARD SOIL CONSERVATION DISTRICT

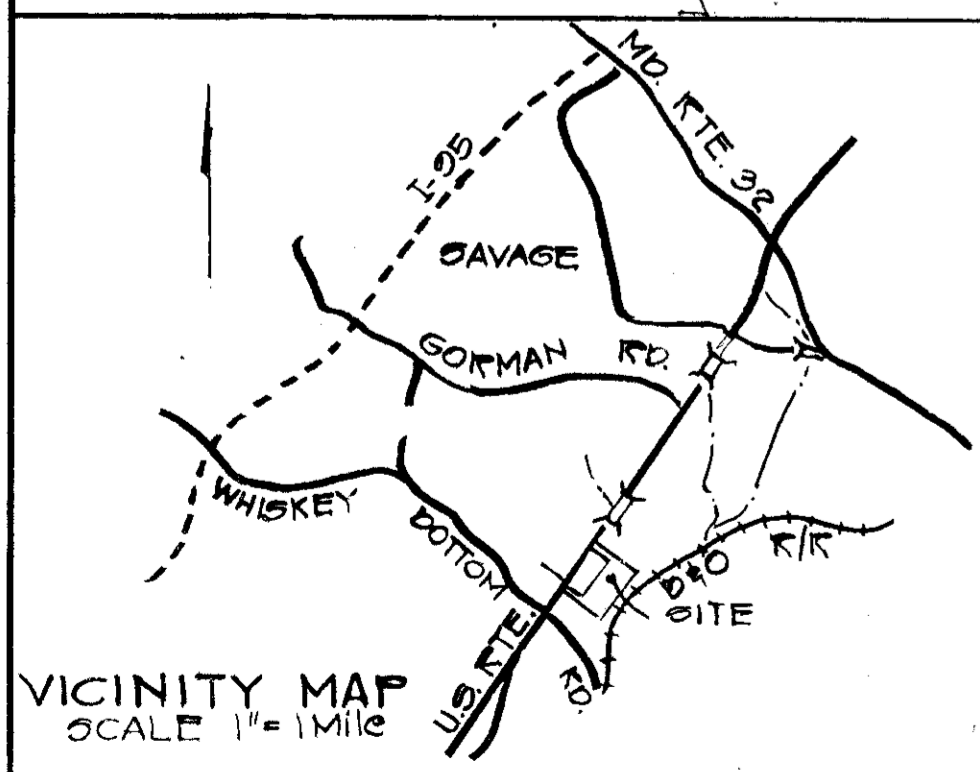

APPROVED: FOR PUBLIC WATER AND PUBLIC SEWERAGE SYSTEMS, HOWARD COUNTY HEALTH DEPARTMENT.
Howard County Health Officer 10/20/74
DATE

APPROVED: HOWARD COUNTY OFFICE OF PLANNING AND ZONING.
Thomas A. Harris 10/20/74
DATE
W. H. Lawson 10/20/74
DATE
CHIEF, DIVISION OF LAND DEVELOPMENT AND LAND TRANSPORTATION PLANNING.

APPROVED: FOR PUBLIC WATER AND PUBLIC SEWERAGE AND STORM DRAINAGE SYSTEMS AND ROADS.
William J. Altman 10/23/74
DATE
B. H. Johnson 10/21/74
DATE
CHIEF, BUREAU OF HIGHWAYS

TITLE SEDIMENT CONTROL			
PROJECT HOWARD COUNTY TITLE HOLDING CO., INC.			
LOCATION COLLECTION DISTRICT HOWARD CO., MD.			
DATE: 4/11/74	DES. BY: T.K.S.	DRAWN BY: D.R.	CHKD. BY: J.D.
SCALE: 1" = 50'	JOB NO. 1487	DRWG. NO.: 4 OF 11	DATE: 10/15/74

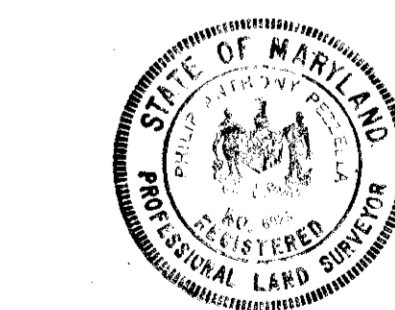

ENGINEERING PLANNING SURVEYING BY
BOENDER ASSOCIATES INC.
BALTIMORE, MD. 465-7777
SALISBURY, MD. 749-7286
WESTMINSTER, MD. 848-5588

BOTTOM DIMENSIONS	
PHASE 1	PHASE 2
TRAP N#1 68'	TRAP N#1 88'
TRAP N#2 38'	TRAP N#2 68'
TRAP N#3 18'	TRAP N#3 48'
TRAP N#4 18'	TRAP N#4 48'

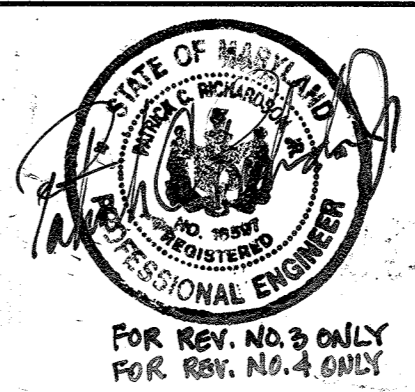
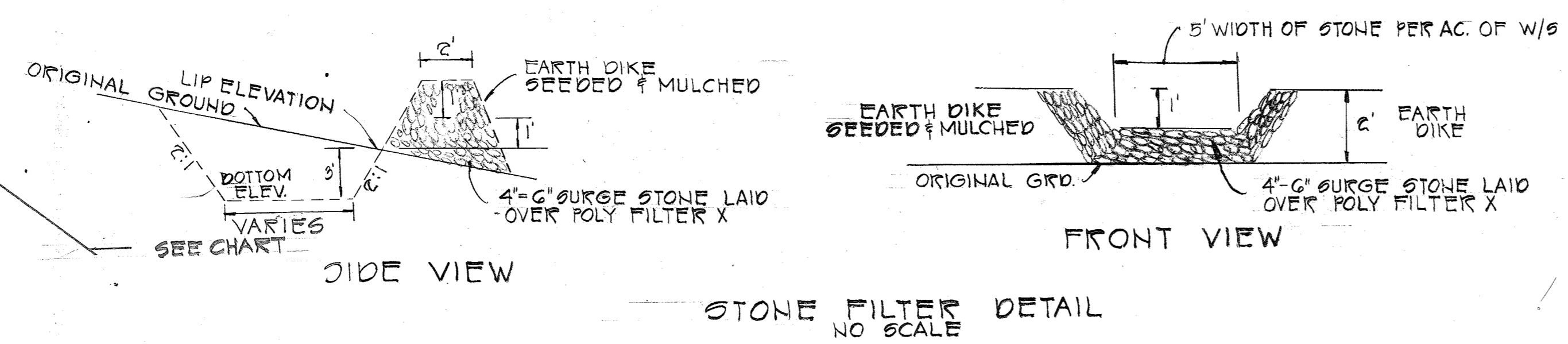

REVISIONS		CHECK	APPROVED & DATE
3	1/13/99		
4	1/14/00		
5	1/18/17		
6	5-4-17	FSH	
7	7-9-20		

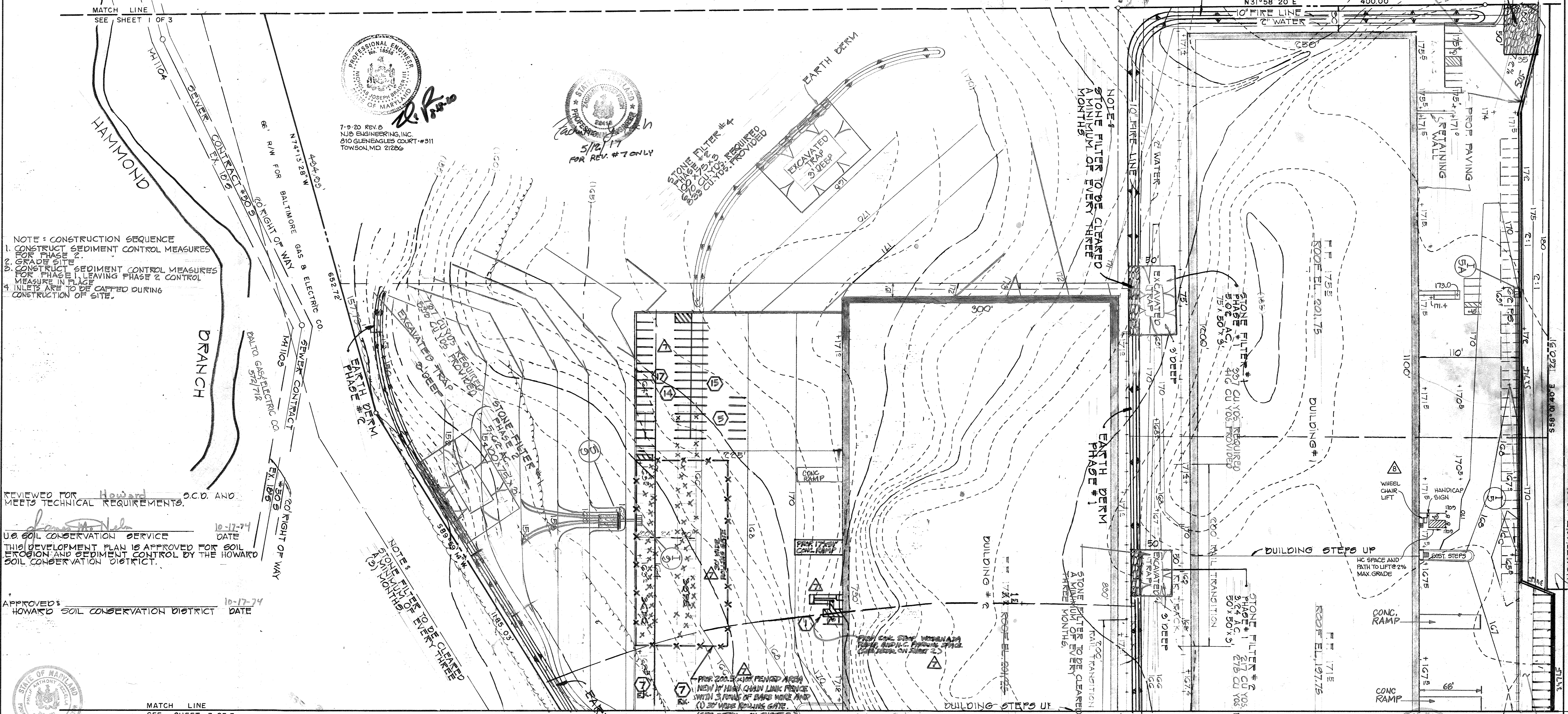

- NOTE: CONSTRUCTION SEQUENCE
1. CONSTRUCT SEDIMENT CONTROL MEASURES FOR PHASE 2.
 2. GRADE SITE.
 3. CONSTRUCT SEDIMENT CONTROL MEASURES FOR PHASE 1, LEAVING PHASE 2 CONTROL MEASURE IN PLACE.
 4. INLETS ARE TO BE CAPPED DURING CONSTRUCTION OF SITE.

REVIEWED FOR Howard O.C.D. AND MEETS TECHNICAL REQUIREMENTS.

US SOIL CONSERVATION SERVICE DATE 10-17-74
 THIS DEVELOPMENT PLAN IS APPROVED FOR SOIL EROSION AND SEDIMENT CONTROL BY THE HOWARD SOIL CONSERVATION DISTRICT.

APPROVED: HOWARD SOIL CONSERVATION DISTRICT DATE 10-17-74

ENGINEER'S STATEMENT
 I CERTIFY THAT THIS PLAN FOR EROSION AND SEDIMENT CONTROL REPRESENTS A PRACTICAL AND WORKABLE PLAN BASED ON MY PERSONAL KNOWLEDGE OF THE SITE CONDITIONS AND THAT IT WAS PREPARED IN ACCORDANCE WITH THE REQUIREMENTS OF THE HOWARD SOIL CONSERVATION DISTRICT.

DEVELOPER'S STATEMENT
 I CERTIFY THAT ALL THE DEVELOPMENT AND/OR CONSTRUCTION WILL BE DONE IN ACCORDANCE TO THIS PLAN OF DEVELOPMENT AND PLAN FOR EROSION AND SEDIMENT CONTROL, AND I ALSO AUTHORIZE PERIODIC ON-SITE INSPECTION BY THE HOWARD SOIL CONSERVATION DISTRICT OR THEIR AUTHORIZED AGENTS AS ARE DEEMED NECESSARY. DEVIATION FROM THIS PLAN WILL NOT BE MADE UNLESS AUTHORIZED BY THE HOWARD SOIL CONSERVATION DISTRICT.

APPROVED: FOR PUBLIC WATER AND PUBLIC SEWERAGE SYSTEMS, HOWARD COUNTY HEALTH DEPARTMENT.
 DATE 10/28/74

APPROVED: HOWARD COUNTY OFFICE OF PLANNING AND ZONING.
 DATE 10/28/74

APPROVED: FOR PUBLIC WATER AND PUBLIC SEWERAGE AND STORM DRAINAGE SYSTEMS AND ROADS.
 DATE 10/28/74

LEGEND
 --- EX CONTOURS
 --- PROP CONTOURS
 --- 3665 SPOT ELEV.

TITLE SEDIMENT CONTROL	
PROJECT HOWARD COUNTY TITLE HOLDING CO., INC.	
LOCATION 6TH ELECTION DISTRICT HOWARD CO., MD.	
DATE 4/10/74	DES. BY T.A.E.
SCALE 1"=50'	DRAWN BY O.R.
JOB NO. 7427	CHKD. BY J.D.
DRWG. NO. 5 OF 11	

Philip A. Cappella 10/15/74

ENGINEERING PLANNING SURVEYING BY
BOENDER ASSOCIATES INC.
 BALTIMORE, MD. 466-7777
 WESTMINSTER, MD. 848-5688

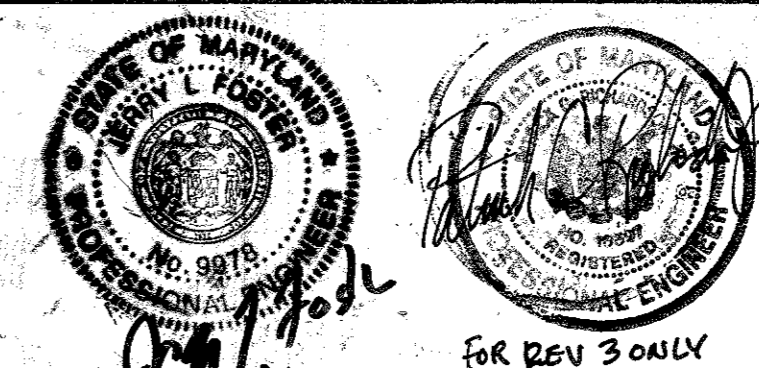

ISSUE	BY & DATE	DESCRIPTION	CHECK	APPROVED & DATE
3	11/3/79	CONC. RAMPS & HC RAMP		
4	4/18/77	Remove & replace existing retaining walls.		

10/15/74
K&E

FOR REV 3 ONLY

Remove existing 3' wood retaining wall. Replace with new concrete segmented block wall 3'h. See detail sheet 11 of 11.

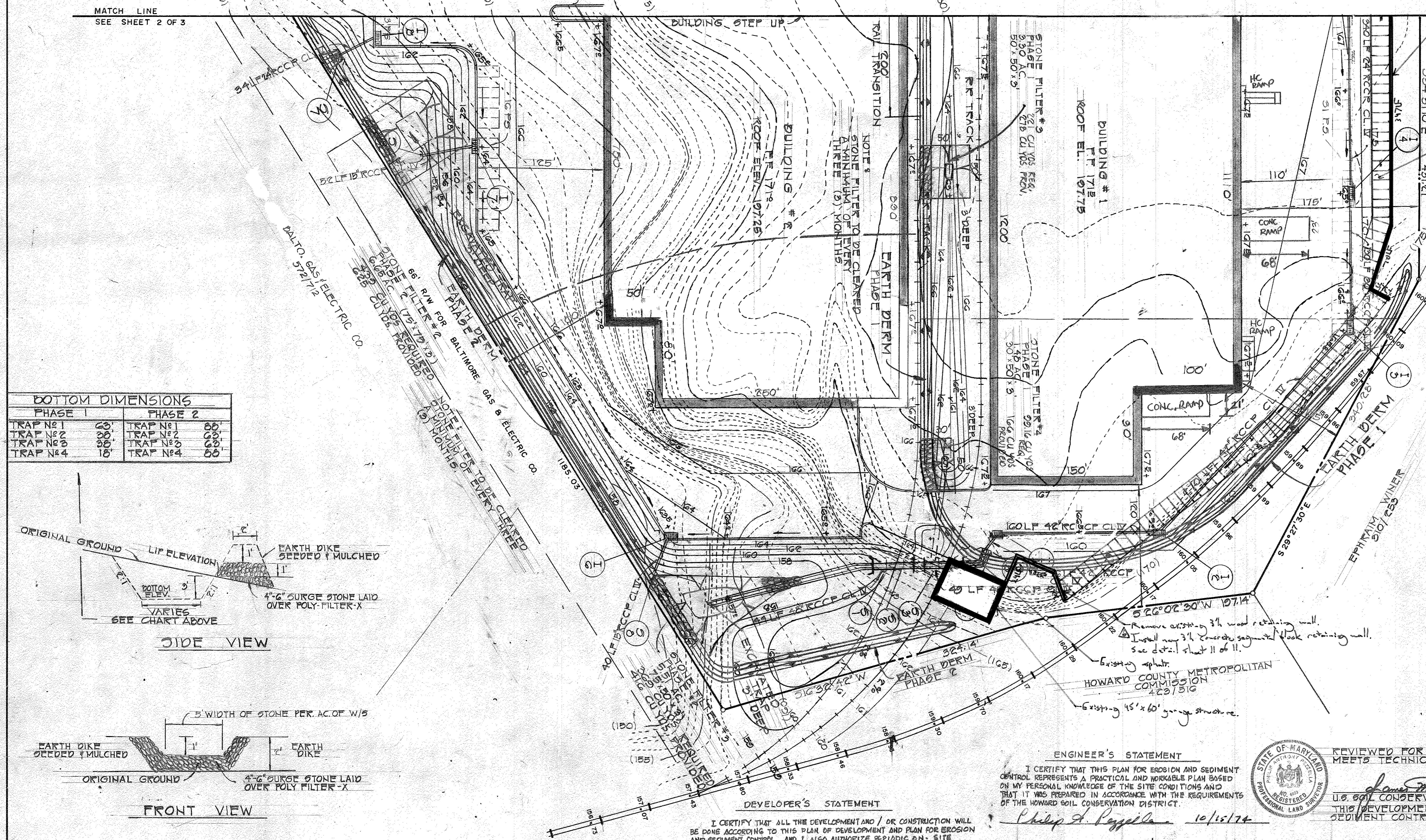

BOTTOM DIMENSIONS	
PHASE 1	PHASE 2
TRAP No 1 63'	TRAP No 1 60'
TRAP No 2 38'	TRAP No 2 63'
TRAP No 3 38'	TRAP No 3 63'
TRAP No 4 18'	TRAP No 4 60'

- CONSTRUCTION SEQUENCE:
1. INSTALL & STABILIZE SEDIMENT CONTROL MEASURES FOR PHASE I.
 2. CLEAR & GRADE SITE.
 3. STABILIZE ACCORDING TO NOTE #3 THAT AREA DISTURBED BY GRADING THAT IS OTHER THAN PHASE I. LEAVE PHASE II BASINS & DIKES IN PLACE.
 4. INSTALL AND STABILIZE PHASE I SEDIMENT TRAP & DIVERSION DIKES.
 5. CONSTRUCT STORM DRAINAGE IN PHASE I AREA.
 6. CONSTRUCT BUILDING NO. 1
 7. COMPLETE ALL CONSTRUCTION OF BLDG. #1 AND STABILIZE ALL DISTURBED AREAS ADJOINING THIS BLDG.
 8. MAINTAIN SEDIMENT STORAGE VOLG. IN PHASE II BASINS IN ACCORDANCE WITH DESIGN AS SHOWN ON THE PLAN.
 9. INSTALL STORM DRAINAGE FOR PHASE II.
 10. CONSTRUCT BLDG #2. CONSTRUCT PARKING LOTS FOR PHASE II.
 11. STABILIZE ALL DISTURBED AREAS FOR PHASE II AFTER REMOVING SEDIMENT MEASURES.

NOTE: PHASE II IS TO BE FOR THE TOTAL SITE IF ENTIRE SITE IS TO BE GRADED AT ONE TIME.

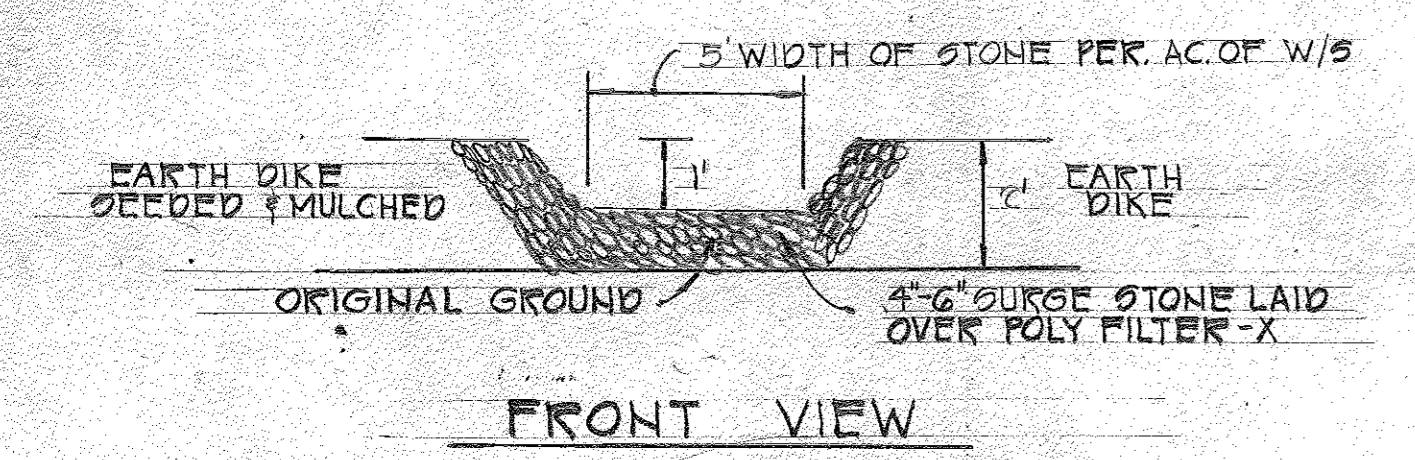
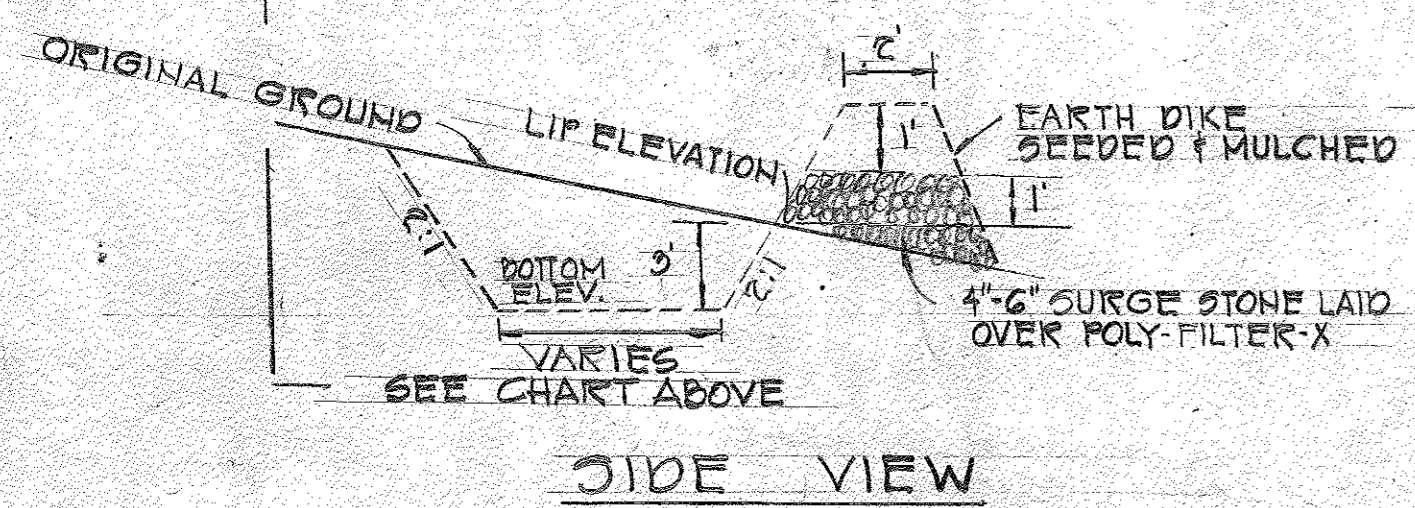

STONE FILTER DETAIL NO. SCALE

DEVELOPER'S STATEMENT

I CERTIFY THAT ALL THE DEVELOPMENT AND/OR CONSTRUCTION WILL BE DONE ACCORDING TO THIS PLAN OF DEVELOPMENT AND PLAN FOR EROSION AND SEDIMENT CONTROL, AND I ALSO AUTHORIZE PERIODIC 3-M. SITE INSPECTION BY THE HOWARD SOIL CONSERVATION DISTRICT OR THEIR AUTHORIZED AGENTS, AS ARE DEEMED NECESSARY. DEVIATION FROM THIS PLAN WILL NOT BE MADE UNLESS AUTHORIZED BY THE HOWARD SOIL CONSERVATION DISTRICT.

Henry B. Norman 10/11/74

ENGINEER'S STATEMENT

I CERTIFY THAT THIS PLAN FOR EROSION AND SEDIMENT CONTROL REPRESENTS A PRACTICAL AND WORKABLE PLAN BASED ON MY PERSONAL KNOWLEDGE OF THE SITE CONDITIONS AND THAT IT WAS PREPARED IN ACCORDANCE WITH THE REQUIREMENTS OF THE HOWARD SOIL CONSERVATION DISTRICT.

Philip A. Pappalardo 10/15/74

REVIEWED FOR Howard S.C.D. AND MEETS TECHNICAL REQUIREMENTS.

James M. Helm 10-17-74 DATE
U.S. SOIL CONSERVATION SERVICE
THIS DEVELOPMENT PLAN IS APPROVED FOR SOIL EROSION AND SEDIMENT CONTROL BY THE HOWARD SOIL CONSERVATION DISTRICT.

APPROVED: *Robert W. Zuelow Jr.* 10-17-74 DATE
HOWARD SOIL CONSERVATION DISTRICT

Philip A. Pappalardo 10/15/74

APPROVED: FOR PUBLIC WATER AND PUBLIC SEWERAGE SYSTEMS HOWARD COUNTY HEALTH DEPARTMENT.

Robert W. Zuelow Jr. 10/20/74 DATE
HOWARD COUNTY HEALTH OFFICER

APPROVED: HOWARD COUNTY OFFICE OF PLANNING AND ZONING.

Sharon H. Harris 10/20/74 DATE
PLANNING DIRECTOR

V.H. Clawson 10/20/74 DATE
CHIEF, DIVISION OF LAND DEVELOPMENT AND TRANSPORTATION PLANNING

APPROVED: FOR PUBLIC WATER AND PUBLIC SEWERAGE AND STORM DRAINAGE SYSTEMS AND ROADS.

William A. Oates 10/23/74 DATE
DIRECTOR

J.P. McCreary 10/21/74 DATE
CHIEF, BUREAU OF HIGHWAYS

TITLE SEDIMENT CONTROL	
PROJECT HOWARD COUNTY TITLE HOLDING CO., INC.	
LOCATION GTHELECTION DISTRICT HOWARD CO., MD	
DATE 4/16/74	DES. BY T.K.O.
SCALE 1" = 50'	JOB NO. 7427
DRWN. BY O.R.	CHKD. BY J.D.
DATE 5/1/74	DRWG. NO. 6 OF 11

STATE OF MARYLAND PROFESSIONAL LAND SURVEYOR

Philip A. Pappalardo 5/1/74 DATE

STATE OF MARYLAND PROFESSIONAL ENGINEER

Philip A. Pappalardo 5/1/74 DATE

ENGINEERING PLANNING SURVEYING

BOENDER ASSOCIATES INC.

BALTIMORE, MD. 466-7777
SALISBURY, MD. 749-1286
WESTMINSTER, MD. 848-5588

SDP-79-111

REVISIONS			
ISSUE	BY & DATE	DESCRIPTION	APPROVED & DATE

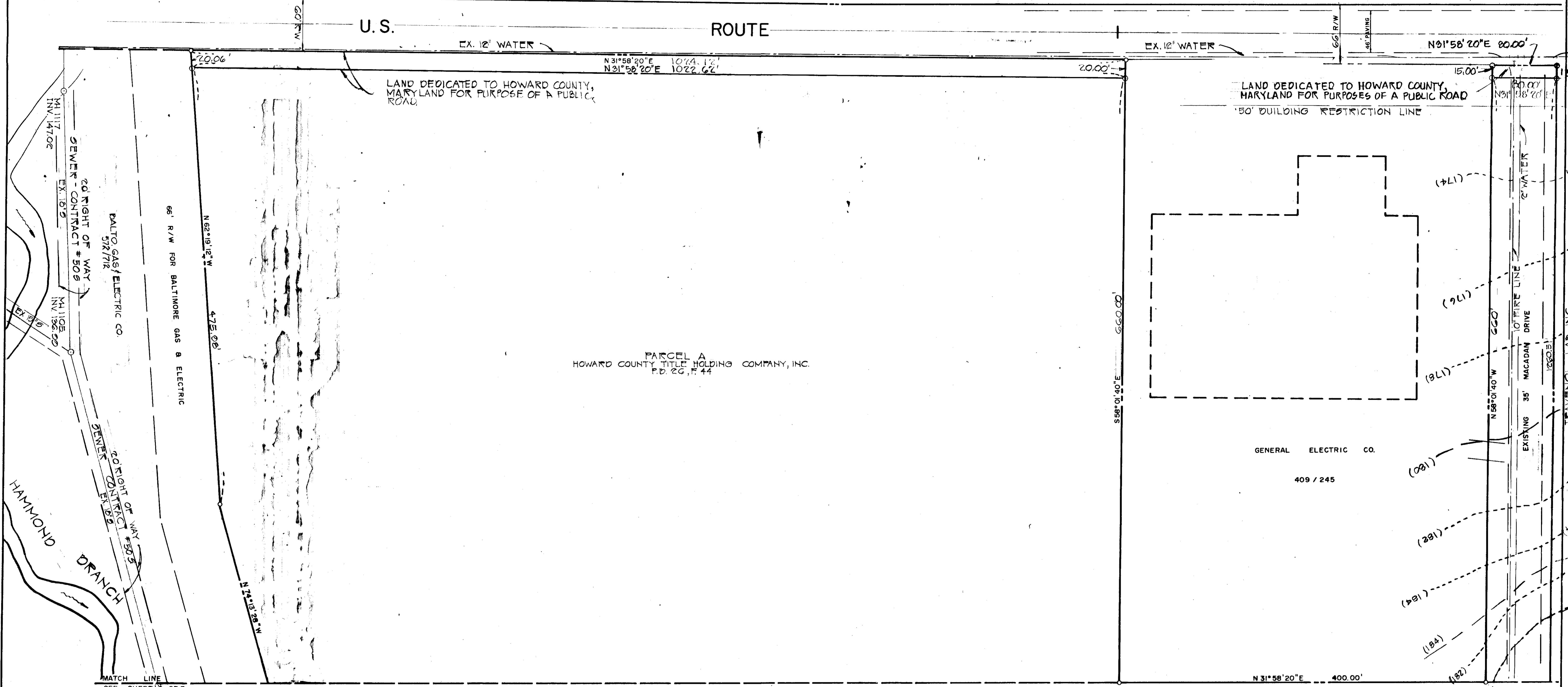

GENERAL NOTES

1. TOTAL AREA OF SITE: 80,004 AC.
 BUILDING USE: WAREHOUSE
 NR. OF EMPLOYEES: 200
 PARKING SPACES PROVIDED: 181
 PARKING SPACES REQUIRED: 100
 TAX MAP: 147
 PARCEL: 15
 ZONING: M-2
 PLAT REFERENCE: P.D. 22, P. 43
 OWNER + DEVELOPER:
 TROY MERRITT
 BOENDER ASSOCIATES
 8726 TOWN & COUNTRY BLVD or 1940 RUXTON RD.
 ELLICOTT CITY, MD. 21043 BALTIMORE, MD. 21204
 465-7777 828-1277

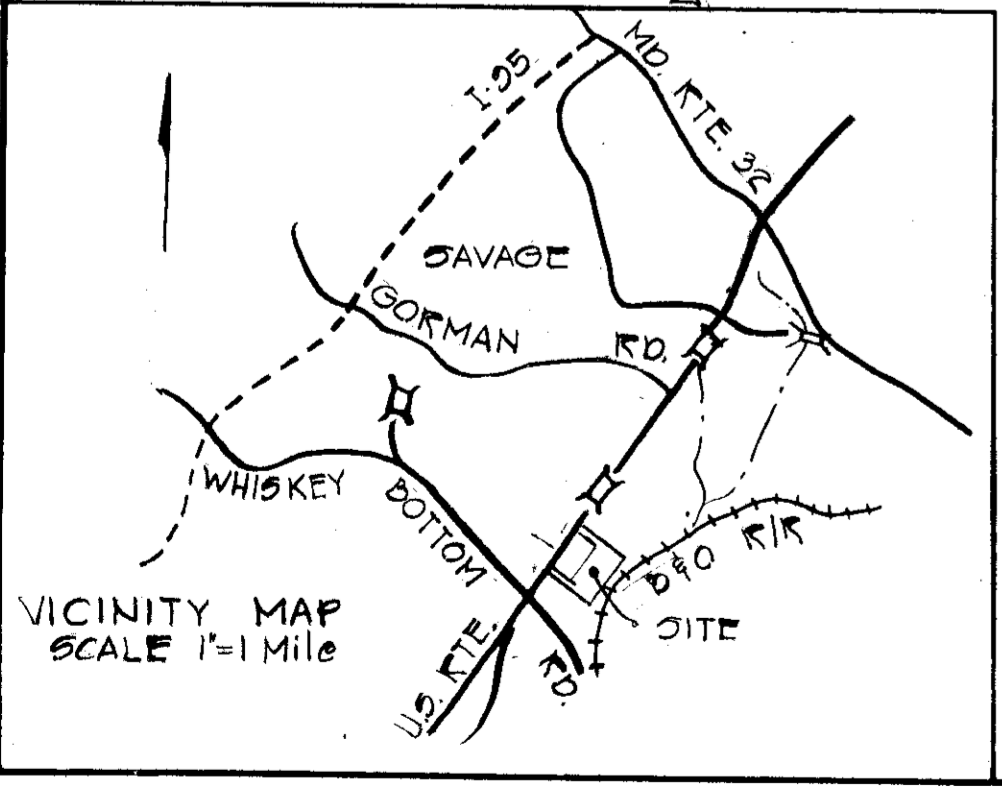

APPROVED FOR PUBLIC WATER AND PUBLIC SEWERAGE SYSTEMS, HOWARD COUNTY HEALTH DEPARTMENT.
Thomas M. Harris
 PLANNING DIRECTOR
 DATE: 10/20/74

APPROVED HOWARD COUNTY OFFICE OF PLANNING AND ZONING.
Thomas M. Harris
 PLANNING DIRECTOR
 DATE: 10/20/74

APPROVED FOR PUBLIC WATER AND PUBLIC SEWERAGE AND STORM DRAINAGE SYSTEMS AND ROADS.
William A. Acton
 DIRECTOR
 DATE: 10/21/74

TITLE: DRAINAGE AREA MAP
 PROJECT: HOWARD COUNTY TITLE HOLDING CO., INC.
 LOCATION: COLLECTION DISTRICT HOWARD CO., MD.
 DATE: 4/16/74 DES. BY: T.K.S. DRAWN BY: D.K. CHKD. BY: J.D.
 SCALE: 1"=50' JOB NO. 7401 DRWG. NO.: 7 OF 11



ENGINEERING PLANNING SURVEYING
BOENDER ASSOCIATES INC.
 BALTIMORE, MD. 465-7777
 WESTMINSTER, MD. 848-5588

ISSUE	BY & DATE	DESCRIPTION	CHECK	APPROVED & DATE
3	11/3/99	PARKING SPACES @ WEST END BLDG 1		
A	11/4/00	CONC RAMPS & HC RAMP		
A	4/18/17	REMOVE 2' RAMPING, RETAINING WALLS		
A	5-4-17	ADDED ADA RAMP, H.C. PARKING, FENCED AREA AND DETAIL, CONC. RAMP.	FSH	
A	7-9-20	ADDED WHEELCHAIR LIFT, STEPS & HC SPACE - NJJB		

PROFESSIONAL ENGINEER
STATE OF MARYLAND
No. 18552

PROFESSIONAL ENGINEER
STATE OF MARYLAND
No. 9978

PROFESSIONAL ENGINEER
STATE OF MARYLAND
No. 18552

PROFESSIONAL ENGINEER
STATE OF MARYLAND
No. 18552

7-9-20 REV. B
NJJB ENGINEERING, INC.
810 GLENDALES CT. #311
TOWSON, MD 21286

FOR REV. # 3 ONLY
FOR REV. # 4 ONLY

FOR REV. # 7 ONLY

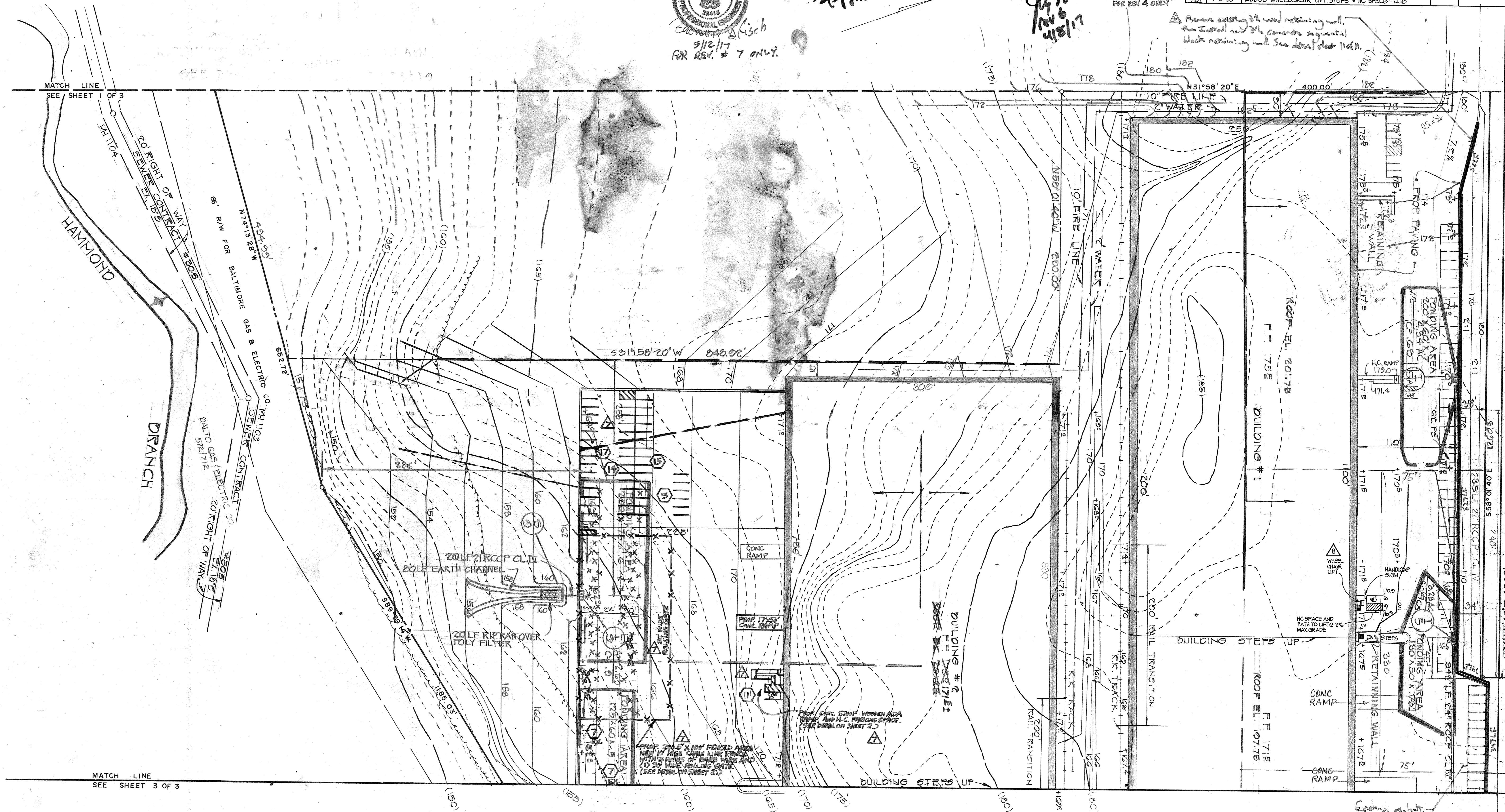

APPROVED FOR PUBLIC WATER AND PUBLIC SEWERAGE SYSTEMS, HOWARD COUNTY HEALTH DEPARTMENT.

APPROVED HOWARD COUNTY OFFICE OF PLANNING AND ZONING.

APPROVED FOR PUBLIC WATER AND PUBLIC SEWERAGE AND STORM DRAINAGE SYSTEMS AND ROADS.

John D. ... PLANNING DIRECTOR 10/20/74 DATE

William G. ... DIRECTOR 10/23/74 DATE

J. B. ... CHIEF, BUREAU OF HIGHWAY 10/21/74 DATE

HOWARD COUNTY HEALTH OFFICER DATE 10/28/74

CHIEF, DIVISION OF LAND DEVELOPMENT AND TRANSPORTATION PLANNING.

TITLE DRAINAGE AREA MAP	
PROJECT HOWARD COUNTY TITLE HOLDING CO., INC.	
LOCATION 6TH ELECTION DISTRICT HOWARD CO., MD.	
DATE 4/16/74	DES. BY: T.K.E.
SCALE: 1"=50'	JOB NO. 7427
DRAWN BY: D.F.	CHKD. BY: J.D.
DRWG. NO. 8 OF 11	

STATE OF MARYLAND
PROFESSIONAL LAND SURVEYOR
No. 18552

ENGINEERING PLANNING SURVEYING
BOENDER ASSOCIATES INC.
BALTIMORE, MD. 466-7777
SALISBURY, MD. 748-1288
WESTMINSTER, MD. 848-5588

REVIEWED FOR HOWARD S.C.D. AND MEETS TECHNICAL REQUIREMENTS.

U.S. SOIL CONSERVATION SERVICE DATE 10-17-74

THIS DEVELOPMENT PLAN IS APPROVED FOR SOIL EROSION AND SEDIMENT CONTROL BY THE HOWARD SOIL CONSERVATION DISTRICT.

APPROVED: Robert W. ... DATE 10-17-74 HOWARD SOIL CONSERVATION DISTRICT

ENGINEER'S STATEMENT I CERTIFY THAT THIS PLAN FOR EROSION AND SEDIMENT CONTROL REPRESENTS A PRACTICAL AND WORKABLE PLAN BASED ON MY PERSONAL KNOWLEDGE OF THE SITE CONDITIONS AND THAT IT WAS PREPARED IN ACCORDANCE WITH THE REQUIREMENTS OF THE HOWARD SOIL CONSERVATION DISTRICT. Philip J. ... 10/15/74

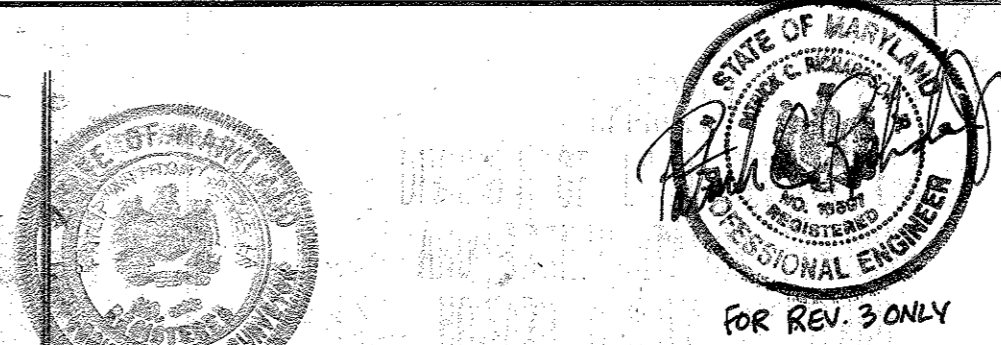

REVISIONS table with columns: ISSUE, BY & DATE, DESCRIPTION, CHECK, APPROVED & DATE. Includes revisions for CONC. RAMPS & HC RAMPS and Remove/Replace existing retaining walls.

DEVELOPER'S STATEMENT I CERTIFY THAT ALL THE DEVELOPMENT AND / OR CONSTRUCTION WILL BE DONE ACCORDING TO THIS PLAN OF DEVELOPMENT AND PLAN FOR EROSION AND SEDIMENT CONTROL AND I ALSO AUTHORIZE PERIODIC ON-SITE INSPECTION BY THE HOWARD SOIL CONSERVATION DISTRICT OR THEIR AUTHORIZED AGENTS, AS ARE DEEMED NECESSARY. DEVIATION FROM THIS PLAN WILL NOT BE MADE UNLESS AUTHORIZED BY THE HOWARD SOIL CONSERVATION DISTRICT. Henry R. ... 10/16/74

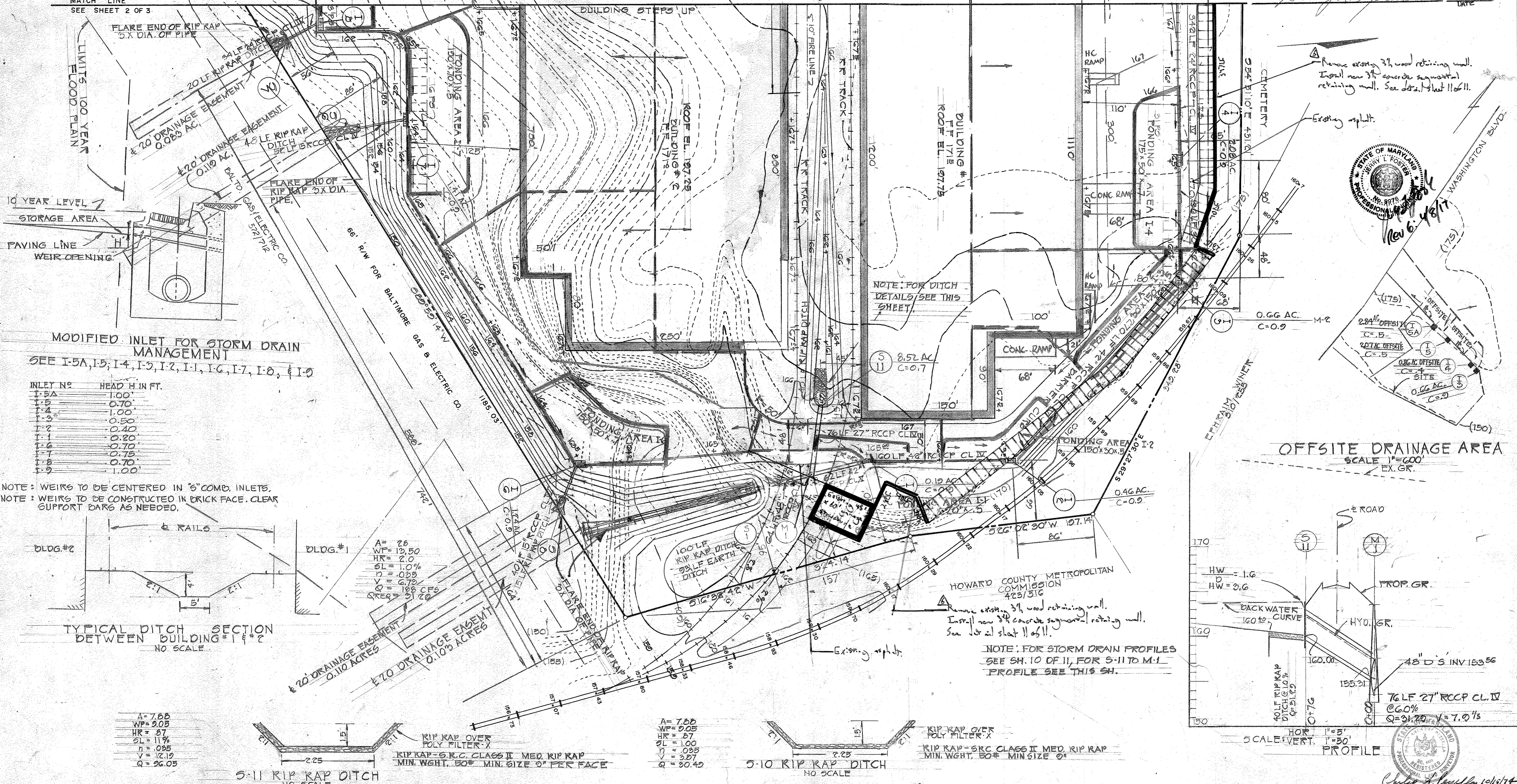

MODIFIED INLET FOR STORM DRAIN MANAGEMENT SEE I-5A, I-5, I-4, I-3, I-2, I-1, I-6, I-7, I-8, & I-9

Table with columns: INLET NO., HEAD H. IN FT. Rows: I-5A (1.00), I-5 (0.70), I-4 (1.00), I-3 (0.50), I-2 (0.40), I-1 (0.20), I-6 (0.70), I-7 (0.75), I-8 (0.70), I-9 (1.00)

NOTE: WEIRS TO BE CENTERED IN "S" COMB. INLETS. NOTE: WEIRS TO BE CONSTRUCTED IN BRICK FACE. CLEAR SUPPORT DARS AS NEEDED.

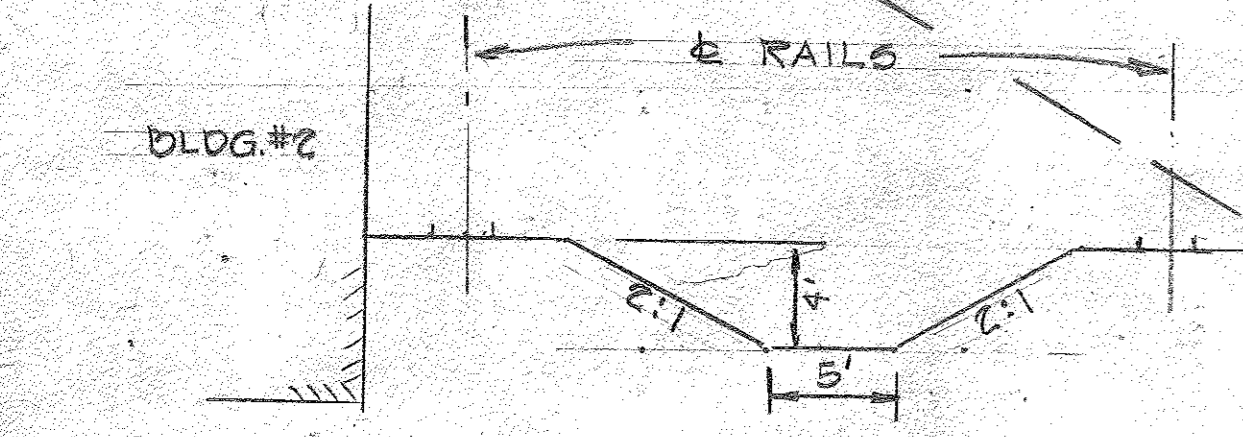

TYPICAL DITCH SECTION BETWEEN BUILDING #1 & #2 NO SCALE

Table with columns: A, WP, HR, SL, n, V, Q. Row 1: A=7.65, WP=0.05, HR=0.7, SL=11%, n=0.035, V=12.19, Q=26.05. Row 2: A=7.65, WP=0.05, HR=0.67, SL=1.00, n=0.035, V=3.07, Q=30.45

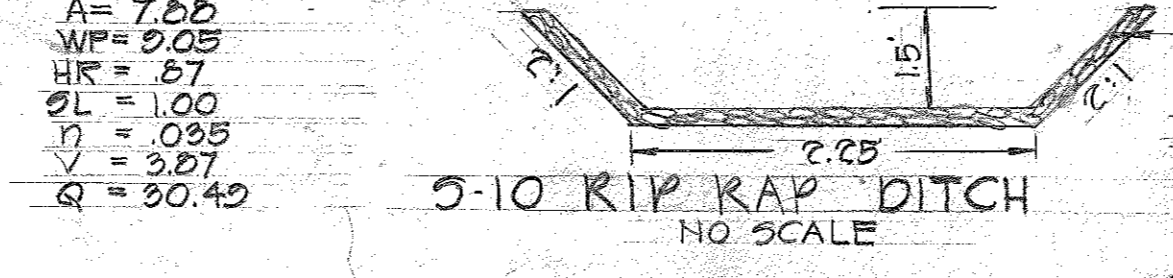
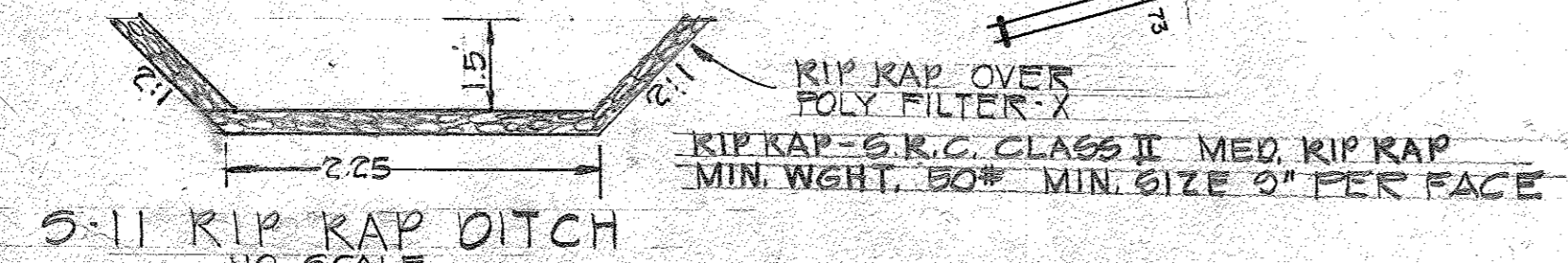

OFFSITE DRAINAGE AREA SCALE 1"=600' EX. GR.

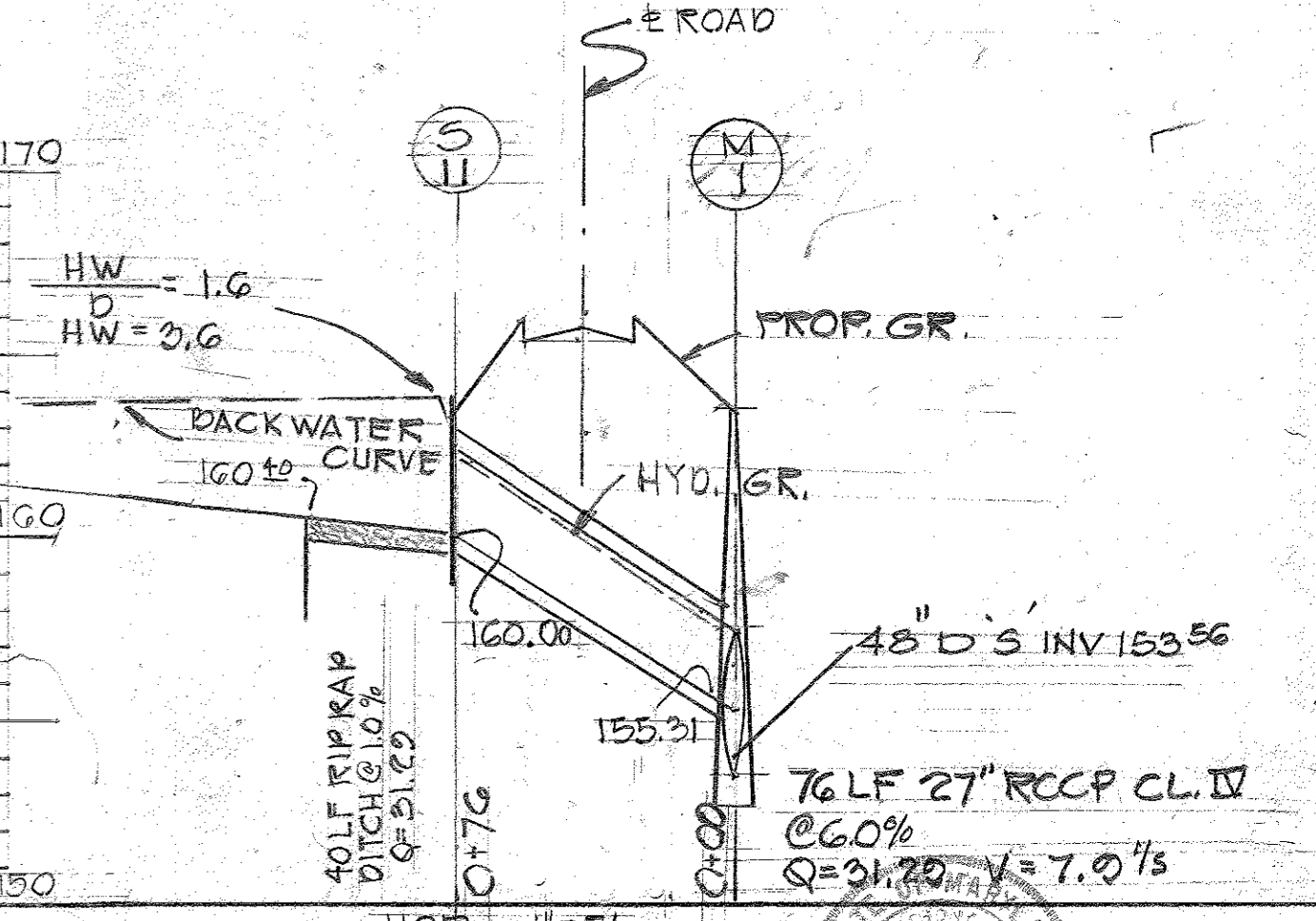

PROFILE SCALE: HOR. 1"=50' VERT. 1"=50'

APPROVED: FOR PUBLIC WATER AND PUBLIC SEWERAGE SYSTEMS, HOWARD COUNTY HEALTH DEPARTMENT. Howard County Health Officer, DATE 10/28/74

APPROVED: HOWARD COUNTY OFFICE OF PLANNING AND ZONING. Planning Director, DATE 11/28/74

APPROVED: FOR PUBLIC WATER AND PUBLIC SEWERAGE AND STORM DRAINAGE SYSTEMS AND ROADS. Director, DATE 10/23/74

TITLE DRAINAGE AREA MAP PROJECT HOWARD COUNTY TITLE HOLDING CO., INC. LOCATION 6TH ELECTION DISTRICT HOWARD CO., MD DATE: 4/16/74 DES. BY: T.K.S. DRAWN BY: D.R. CHKD. BY: J.D. SCALE: 1"=50' JOB NO. 7427 DRWG. NO. 2011

Professional Engineer Seal for Philip J. ... and Boender Associates Inc. logo and address: BALTIMORE, MD. 486-7771

APPROVED FOR PUBLIC WATER AND PUBLIC SEWERAGE SYSTEMS, HOWARD COUNTY HEALTH DEPARTMENT
 APPROVED FOR PUBLIC WATER AND PUBLIC SEWERAGE AND STORM DRAINAGE SYSTEMS AND ROADS.
 APPROVED FOR PUBLIC WATER AND PUBLIC SEWERAGE AND STORM DRAINAGE SYSTEMS AND ROADS.

APPROVED FOR PUBLIC WATER AND PUBLIC SEWERAGE AND STORM DRAINAGE SYSTEMS AND ROADS.
 HOWARD COUNTY HEALTH OFFICER
 DATE: 10/20/74
 PLANNING DIRECTOR
 DATE: 10/20/74
 CHIEF DIVISION OF LAND DEVELOPMENT AND TRANSPORTATION PLANNING
 DATE: 10/20/74
 CHIEF, BUREAU OF HIGHWAYS
 DATE: 10/21/74

APPROVED FOR PUBLIC WATER AND PUBLIC SEWERAGE AND STORM DRAINAGE SYSTEMS AND ROADS.
 HOWARD COUNTY HEALTH OFFICER
 DATE: 10/20/74
 PLANNING DIRECTOR
 DATE: 10/20/74
 CHIEF DIVISION OF LAND DEVELOPMENT AND TRANSPORTATION PLANNING
 DATE: 10/20/74
 CHIEF, BUREAU OF HIGHWAYS
 DATE: 10/21/74

REVIEWED FOR REQUIREMENTS. C.C.D. AND MEETS TECHNICAL
 U.S. SOIL CONSERVATION SERVICE DATE: 10/23/74
 THIS DEVELOPMENT PLAN IS APPROVED FOR SOIL EROSION AND SEDIMENT CONTROL BY THE HOWARD COUNTY SOIL CONSERVATION DISTRICT.
 HOWARD SOIL CONSERVATION DISTRICT DATE: 10/21/74

REVISIONS			
ISSUE	BY & DATE	DESCRIPTION	CHECK APPROVED & DATE

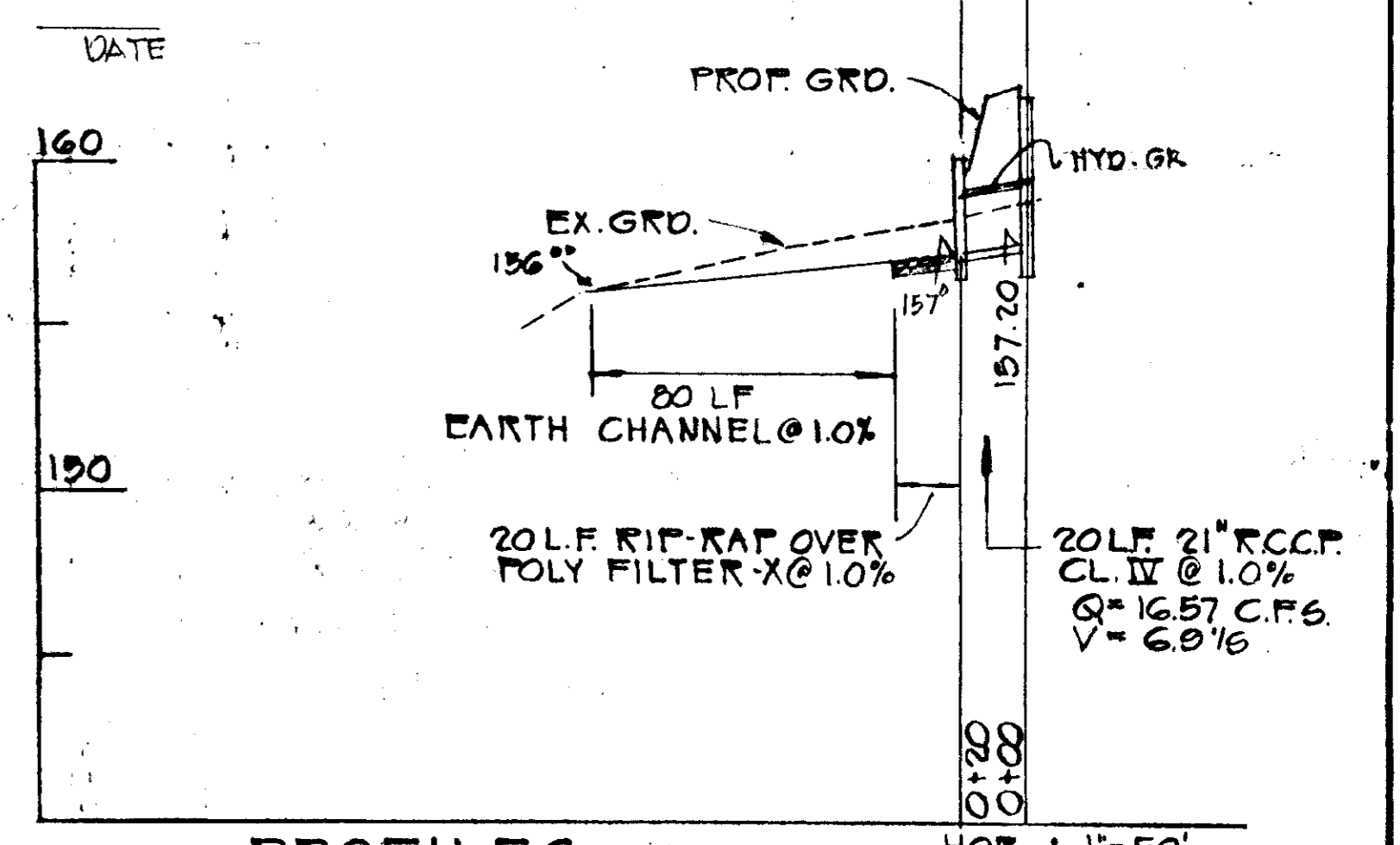
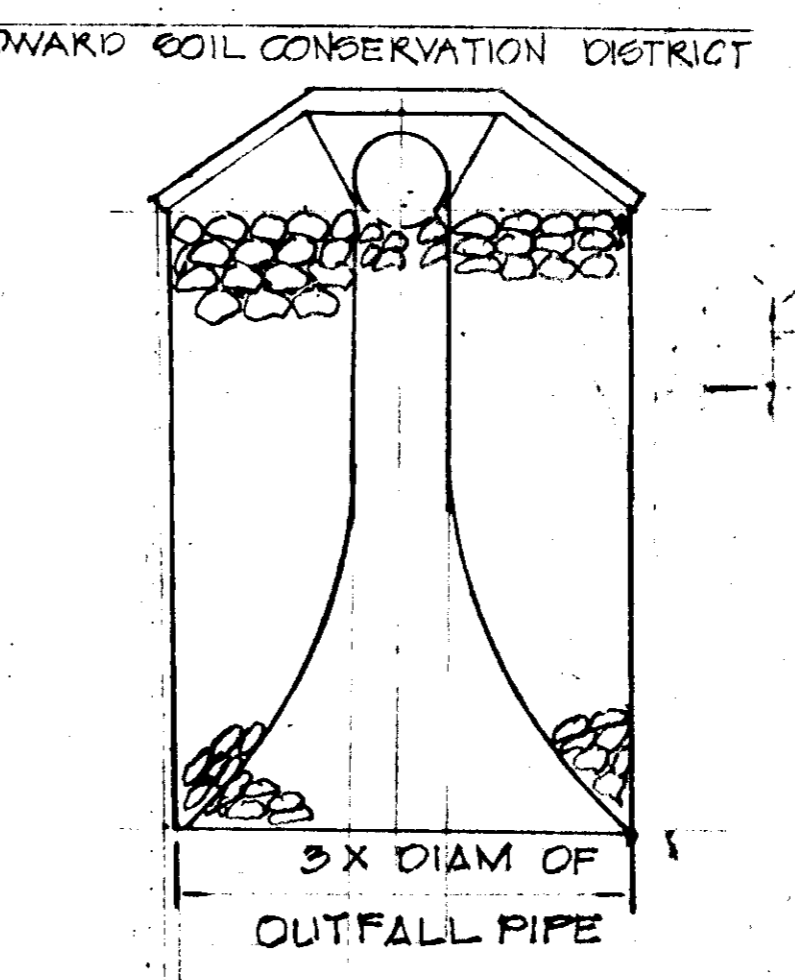
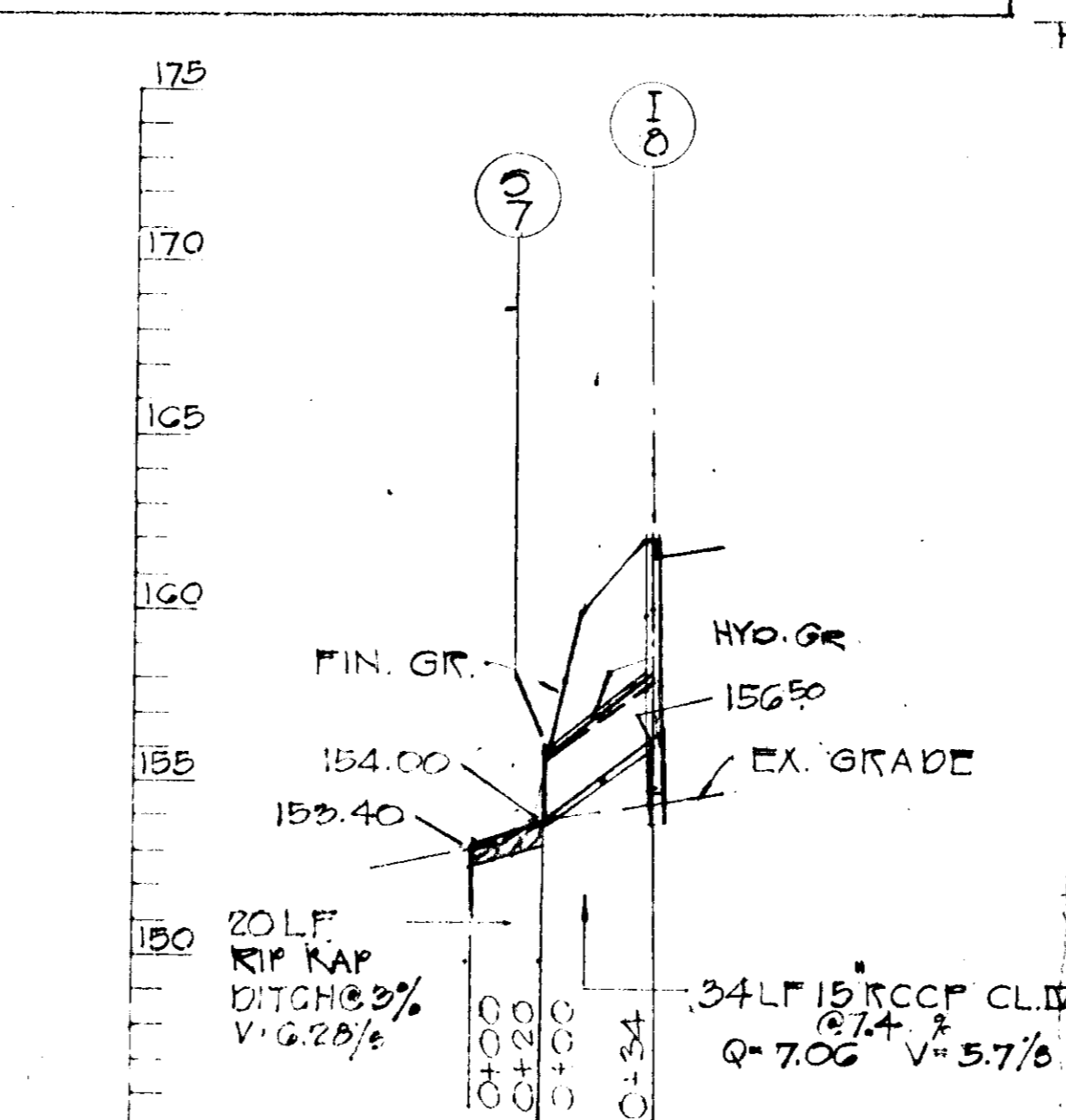
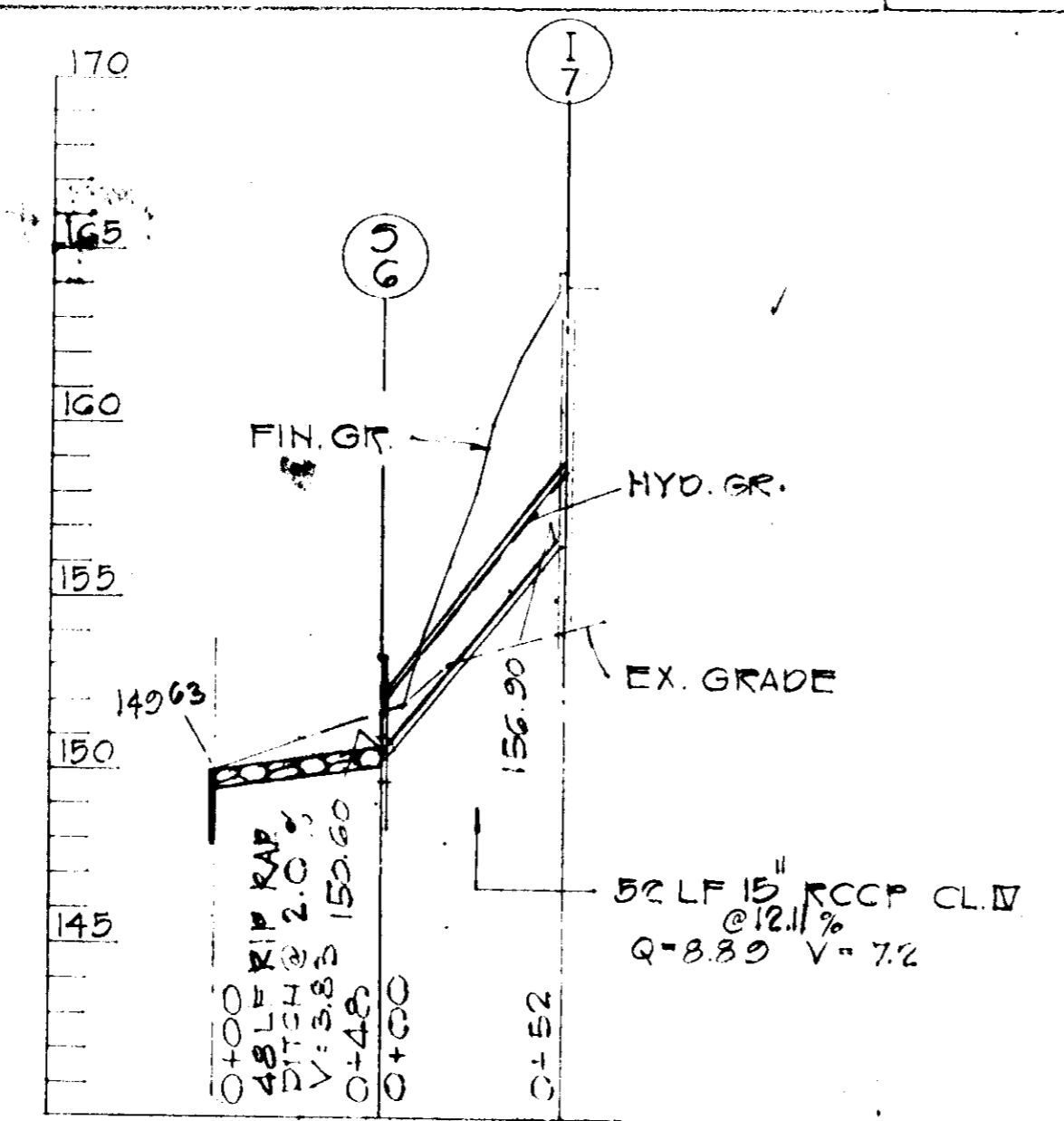
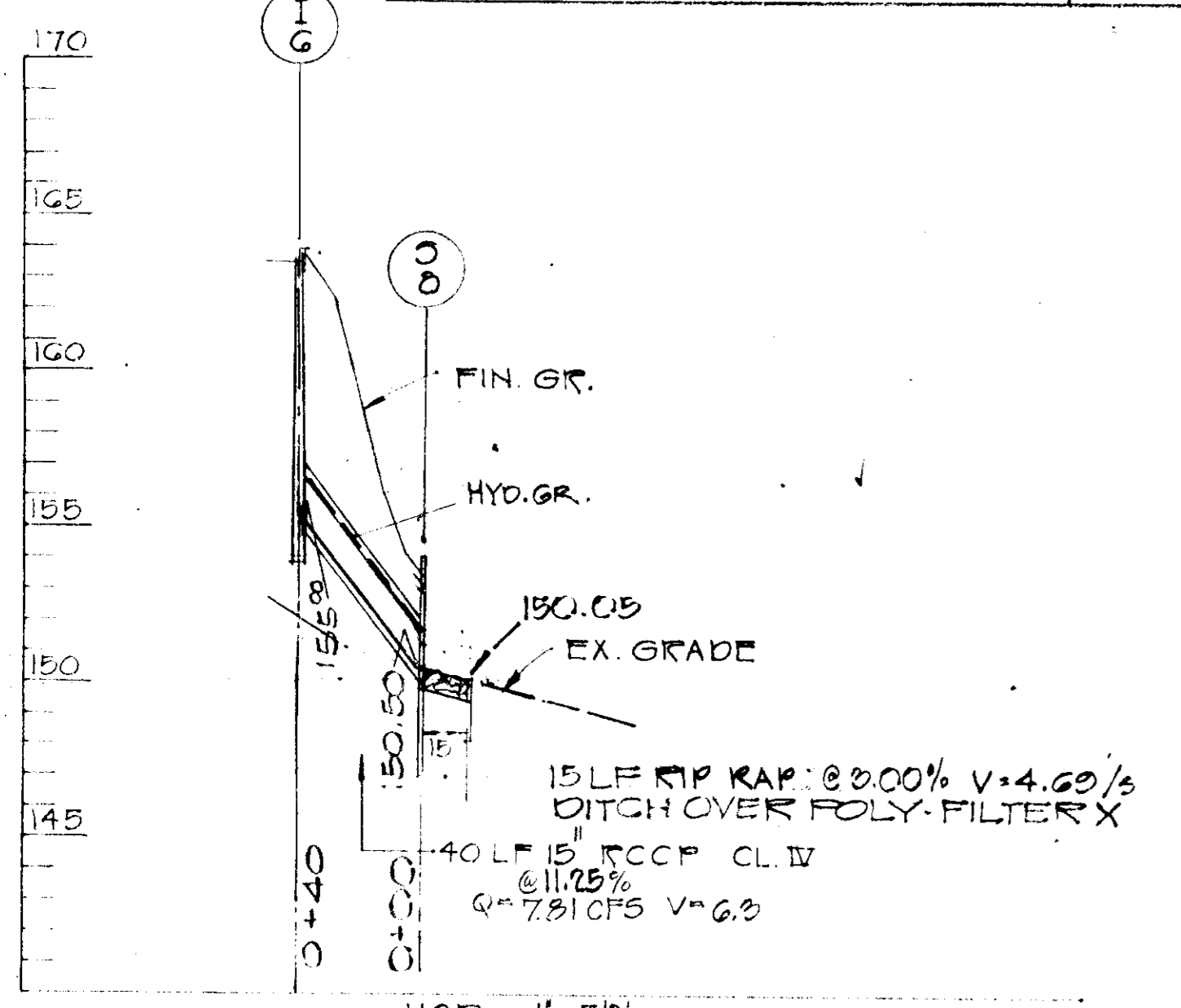

STRUCTURE SCHEDULE					
NO.	TYPE	INV. IN	INV. OUT	TOP EL.	REMARKS
I-1	HO. CO. STD. 5' COMB.	155.28	155.08	165.50	HO. CO. STD. DETAIL DRWG. D-29 PG. 154
I-2	5' COMB.	156.00	155.80	165.50	
I-3	5' COMB.	157.20	157.00	165.50	
I-4	STD. DIB. 5' COMB.	158.24	157.74	165.50	
I-5	HO. CO. STD. DIB. 5' COMB.	160.26	159.61	165.50	
I-6	HO. CO. STD. DIB. 5' COMB.	-	155.00	164.00	
I-7	HO. CO. STD. DIB. 5' COMB.	-	152.00	164.00	
I-8	HO. CO. STD. 5' COMB.	-	156.50	162.00	
I-9A	HO. CO. STD. DIB. 5' COMB.	-	161.50	167.50	HO. CO. STD. DETAIL DRWG. D-29 PG. 154
I-10	HO. CO. STD. C. ENDWALL	153.30	-	-	HO. CO. STD. DETAIL DRWG. D-52 PG. 107
I-11	2 HO. CO. STD. DIB. 5' COMB.	-	157.20	162.00	HO. CO. STD. DETAIL DRWG. D-29 PG. 154
I-12	HO. CO. STD. C. ENDWALL	-	150.60	SET	HO. CO. STD. DETAIL DRWG. D-52 PG. 107
I-13	HO. CO. STD. C. ENDWALL	-	154.00	TOP	HO. CO. STD. DETAIL DRWG. D-52 PG. 107
I-14	HO. CO. STD. C. ENDWALL	-	150.50	-	HO. CO. STD. DETAIL DRWG. D-52 PG. 107
I-15	HO. CO. STD. C. ENDWALL	-	157.00	IN	
I-16	HO. CO. STD. C. ENDWALL	-	161.50	FIELD	HO. CO. STD. DETAIL DRWG. D-52 PG. 107

OUTFALL S-7 & S-8
 A = 2.57
 WP = 4.65
 HR = 0.51
 SL = 3.00%
 V = 4.69
 Q = 11.12 CFS

OUTFALL S-6
 A = 2.57
 WP = 4.65
 HR = 0.51
 SL = 2.00%
 V = 3.83
 Q = 3.08 CFS

OUTFALL S-9
 A = 4.72
 WP = 6.99
 HR = 0.74
 SL = 1.00%
 V = 5.36
 Q = 16.99 CFS

ENGINEER'S STATEMENT
 I CERTIFY THAT THIS PLAN FOR EROSION AND SEDIMENT CONTROL REPRESENTS A PRACTICAL AND WORKABLE PLAN BASED ON MY PERSONAL KNOWLEDGE OF THE SITE CONDITIONS AND THAT IT WAS PREPARED IN ACCORDANCE WITH THE REQUIREMENTS OF THE HOWARD SOIL CONSERVATION DISTRICT.
 Philip J. Kappeler 10/15/74



DEVELOPER'S STATEMENT
 I CERTIFY THAT ALL THE DEVELOPMENT AND/OR CONSTRUCTION WILL BE DONE ACCORDING TO THIS PLAN OF DEVELOPMENT AND PLAN FOR EROSION AND SEDIMENT CONTROL. AND ALSO I AUTHORIZE PERIODIC ON-SITE INSPECTION BY THE HOWARD SOIL CONSERVATION DISTRICT OR THEIR AUTHORIZED AGENTS, AS ARE DEEMED NECESSARY, DEVIATION FROM THIS PLAN WILL NOT BE MADE UNLESS AUTHORIZED BY THE HOWARD SOIL CONSERVATION DISTRICT.
 Philip J. Kappeler 10/15/74

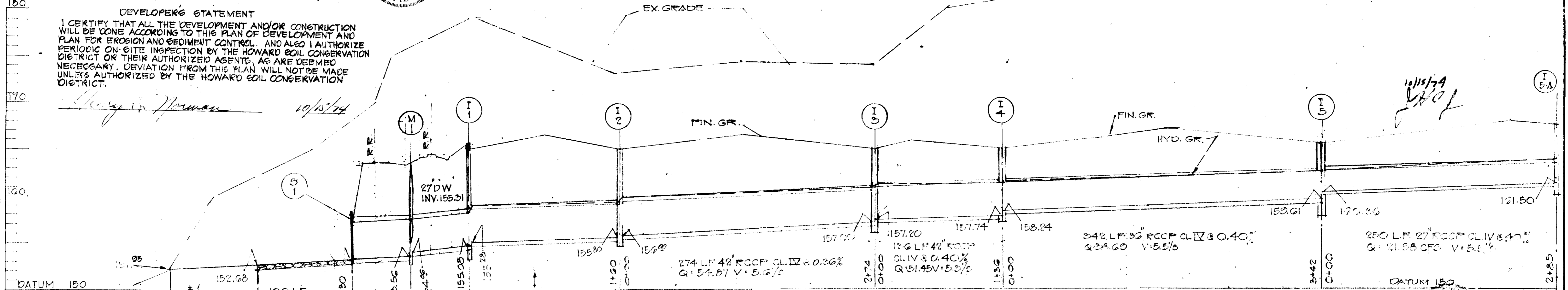

TYPICAL EARTH DITCH #1
 NO SCALE. Shows a cross-section of an earth ditch with 2:1 slopes and a 4.0' bottom width.

TYPICAL RIP-RAP DITCH S-1
 NO SCALE. Shows a cross-section of a rip-rap ditch with 2:1 slopes and a 4.0' bottom width.

TYPICAL RIP-RAP DITCH S-1
 NO SCALE. Shows a cross-section of a rip-rap ditch with 2:1 slopes and a 4.0' bottom width.

NOTE: ALL RIP-RAP SHOWN SHALL BE S.R.C. CLASS II MED. MIN. WT. 50* MIN. SIZE 9" PER FACE.
 REVISED AUG. 22, 1974.
 TITLE: STORM DRAIN PROFILES
 PROJECT: HOWARD COUNTY TITLE HOLDING CO., INC.
 LOCATION: THE ELECTION DISTRICT HOWARD CO., MD.
 DATE: 8/9/74 DES. BY: TKS DRAWN BY: TD CHKD. BY: TKS
 SCALE: AS SHOWN JOB NO. 7427 DRWG. NO. 10011
 BOENDER ASSOCIATES INC.
 BALTIMORE, MD. 465-7777
 SALISBURY, MD. 740-1236
 WESTMINSTER, MD. 848-6888

SEDIMENT CONTROL NOTES

- 1) THE H. S. C. D. AND BUREAU OF LICENSE, INSPECTION, AND PERMITS WILL BE GIVEN 24 HOURS NOTICE PRIOR TO ANY GRADING.
- 2) ALL SEDIMENT CONTROL STRUCTURES SHOWN ON THIS PLAN, UNLESS OTHERWISE SPECIFIED, WILL BE INSTALLED AND STABILIZED IN ACCORDANCE WITH NOTE #9 PRIOR TO ANY OTHER GRADING OR EARTH DISTURBANCE ON THIS SITE.
- 3) AS SOON AS ROUGH GRADING IS COMPLETED, AREA TO BE PAVED WILL BE STABILIZED WITH BASE MATERIAL.
- 4) ALL CUT AND FILL SLOPES WILL BE A MAXIMUM OF 3 : 1.
- 5) FOLLOWING THE STABILIZATION OF ALL AREAS, UPGRADE THIS AREA OF THE SEDIMENT CONTROL. MEASURES MAY BE REMOVED AND GRADED TO THE FINAL GRADES PLANNED AND STABILIZED IMMEDIATELY.
- 6) ELEVATIONS MARKED THUS (X) ARE FINISHED GRADES.
- 7) IN THE EVENT OF EXCESS OF MATERIAL, THE WASTE WILL BE STOCKPILED WITH A MAXIMUM 2:1 SLOPE ON AN AREA WHICH HAS BEEN CLEARED ON THE SITE, STOCKPILED MATERIAL WILL BE STABILIZED IN ACCORDANCE WITH NOTE #9.
- 8) SEDIMENT CONTROL MEASURES WILL NOT BE REMOVED UNTIL APPROVAL IS OBTAINED FROM THE H. S. C. D..
- 9) TEMPORARY STABILIZATION:
APPLY: 2000 LBS. / ACRE OR 46 LBS. / SQ. FT. OF PULVERIZED DOLOMITIC LIMESTONE.
500 LBS. / ACRE OR 11.5 LBS. / 1000 SQ. FT. OF 5-5-5 FERTILIZER. PLANT TO RYEGRASS @ 40 LBS. / ACRE.
FERTILIZE WITH 5-10-10, AND MULCH WITH STRAW @ 1 1/2 TONS / ACRE.
- 10) PERMANENT STABILIZATION: SLOPES FLATTER THAN 3:1
APPLY: 2000 LBS. / ACRE OF PULVERIZED DOLOMITIC LIMESTONE.
700 LBS. / ACRE OF 0-20-0 SUPER PHOSPHATE.
1000 LBS. / ACRE OF 5-10-10 FERTILIZER.
SEED: 85 LBS. / ACRE OF KENTUCKY 31 TALL FESCUE.
40 LBS. / ACRE OF KENTUCKY BLUE GRASS.
25 LBS. / ACRE OF ANNUAL RYE GRASS.
NOTE: SEEDING MAY BE DONE BETWEEN MARCH 1 - MAY 1, OR AUGUST 1 - OCTOBER 1 ONLY. IF JOB IS COMPLETED AT A TIME OTHER THAN THOSE ABOVE, THE AREA WILL BE STABILIZED MULCH: 2 TONS / ACRE OF UNWEATHERED WHEATSTRAW, TIE MULCH TEMPORARILY BY MULCHING ONLY AS STATED BELOW.

11) PERMANENT STABILIZATION: SLOPES STEEPER THAN 3:1
TREATMENT WILL BE THE SAME AS NOTE 9, EXCEPT THAT INSTEAD OF 40# OF BLUEGRASS, 40 LB. OF CROWN VETCH (INNOCULATED) IS TO BE USED.
REVIEWED FOR HOWARD COUNTY S. C. D. AND MEETS TECHNICAL REQUIREMENTS.
William A. Altman 10-17-74
U. S. SOIL CONSERVATION SERVICE DATE

THIS DEVELOPMENT PLAN IS APPROVED FOR SOIL EROSION AND SEDIMENT CONTROL BY THE HOWARD SOIL CONSERVATION DISTRICT
APPROVED: HOWARD SOIL CONSERVATION DIST. 10-17-74 DATE

ENGINEER'S STATEMENT

I CERTIFY THAT THIS PLAN FOR EROSION AND SEDIMENT CONTROL REPRESENTS A PRACTICAL AND WORKABLE PLAN BASED ON MY PERSONAL KNOWLEDGE OF THE SITE CONDITIONS AND THAT IT WAS PREPARED IN ACCORDANCE WITH THE REQUIREMENTS OF THE HOWARD SOIL CONSERVATION DISTRICT.

Philip A. Pappalardo 3/16/74
DATE



DEVELOPER'S STATEMENT

I CERTIFY THAT ALL THE DEVELOPMENT AND / OR CONSTRUCTION WILL BE DONE ACCORDING TO THIS PLAN OF DEVELOPMENT AND PLAN FOR EROSION AND SEDIMENT CONTROL, AND I ALSO AUTHORIZE PERIODIC ON - SITE INSPECTION BY THE HOWARD SOIL CONSERVATION DISTRICT OR THEIR AUTHORIZED AGENTS, AS ARE DEEMED NECESSARY. DEVIATION FROM THIS PLAN WILL NOT BE MADE UNLESS AUTHORIZED BY THE HOWARD SOIL CONSERVATION DISTRICT.

Henry B. Norman 10/11/74
DATE

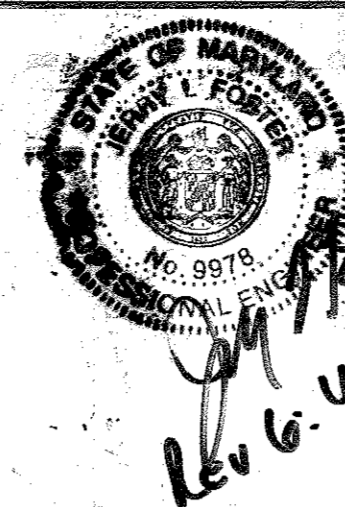

Rev.	By	Date	Description	Check	Approval
1	J.P.	4/8/77	Remove & replace existing retaining walls.		

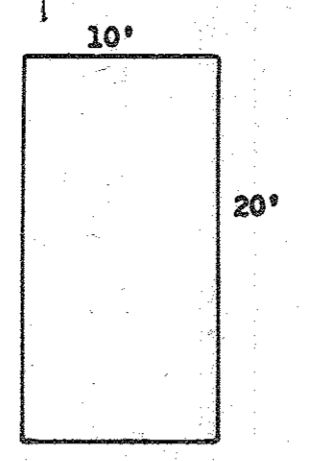

PARKING SPACE DETAIL

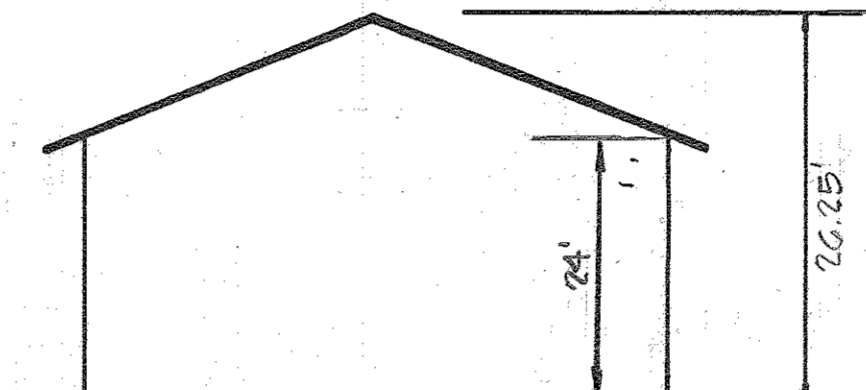

SIDE ELEVATION NO SCALE

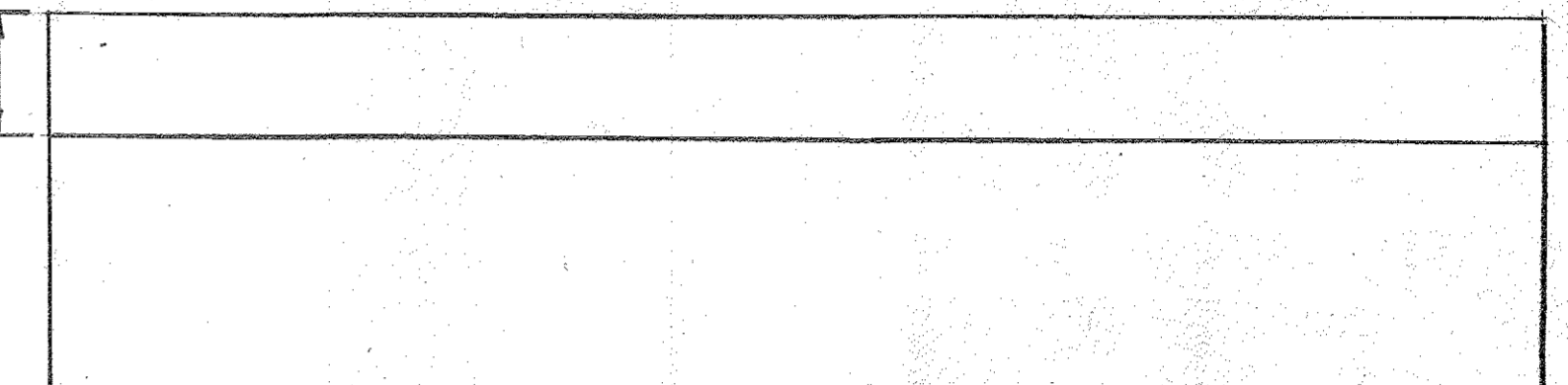

FRONT ELEVATION NO SCALE

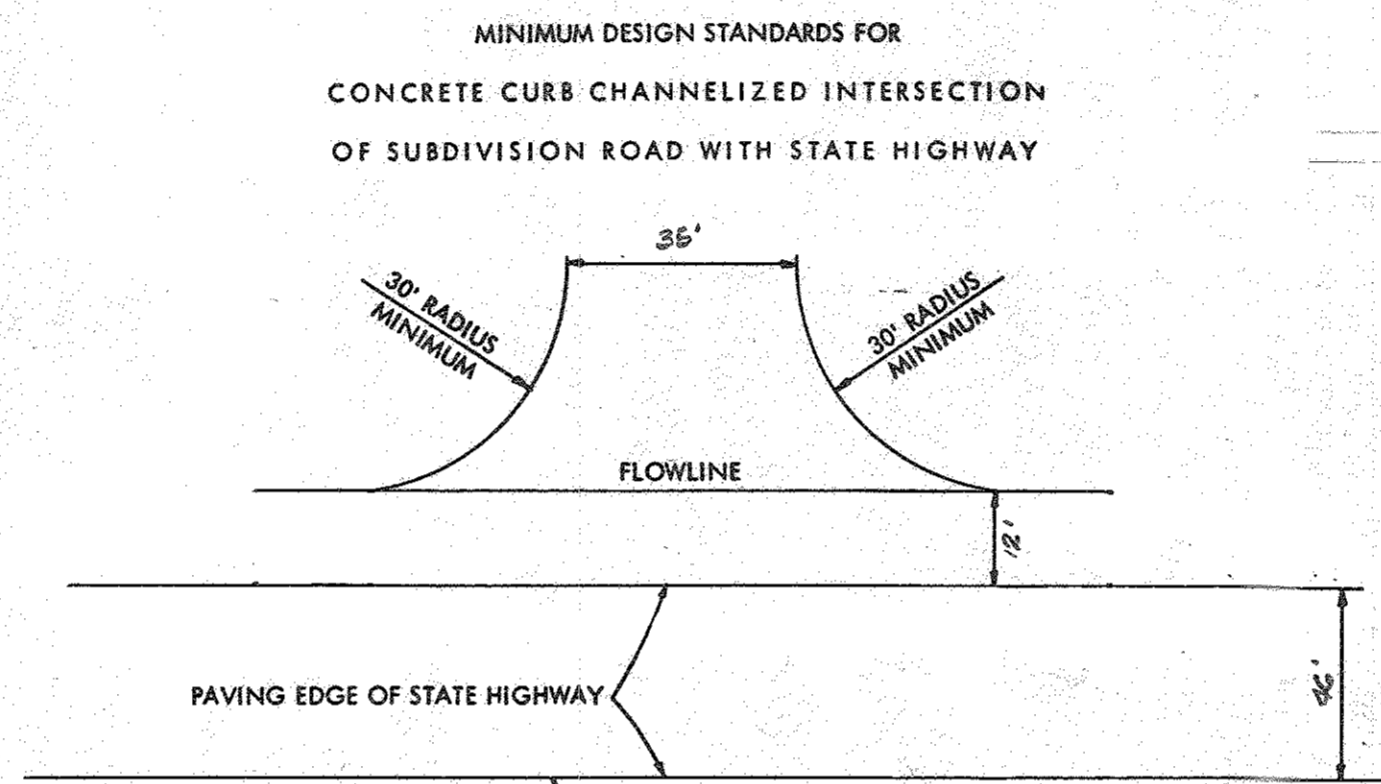

ENTRANCE DETAIL

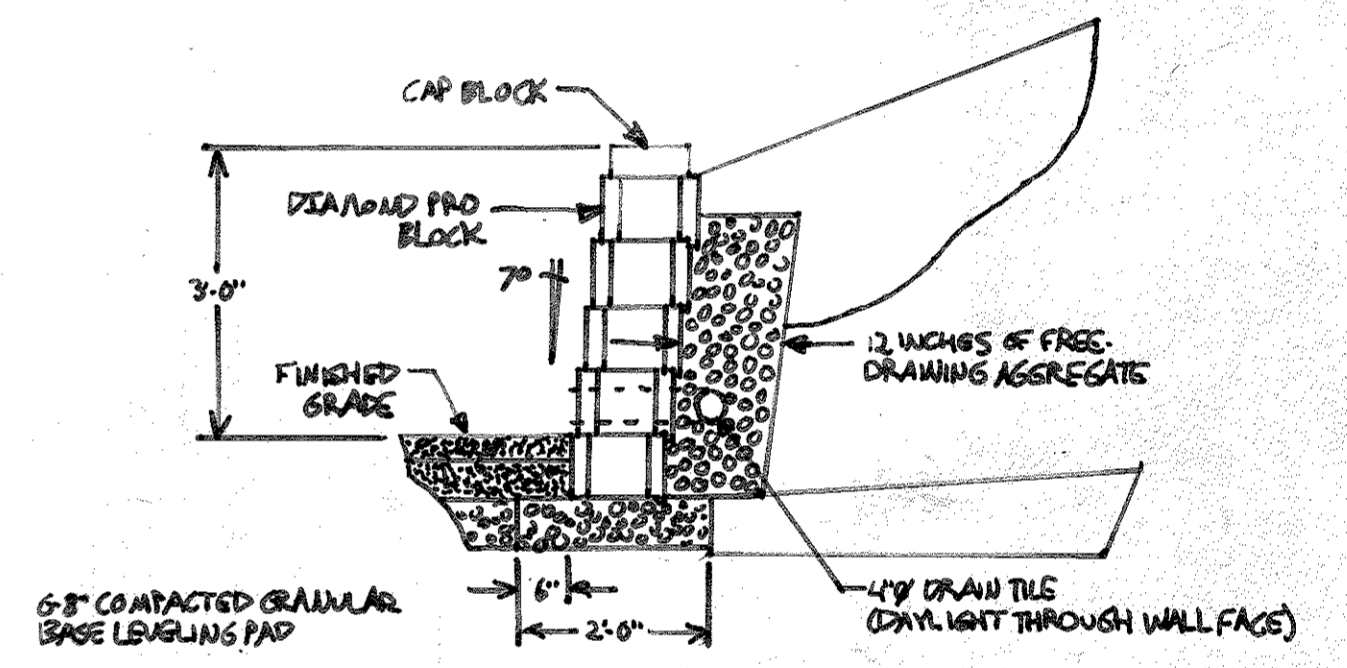

Proposed Wall Section Scale: 1/2" = 1'-0"

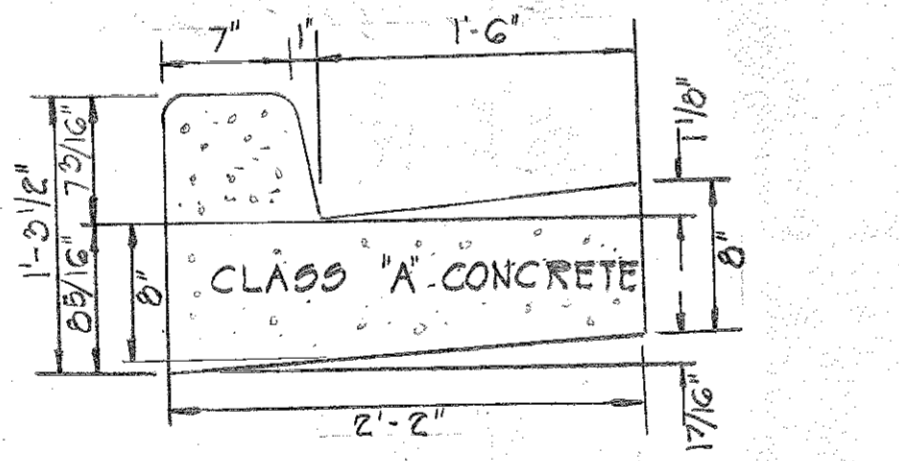

COMBINATION CURB & GUTTER NO SCALE

DITUMINOUS CONC. SURFACE	1 1/2"	BAND C-3
DITUMINOUS CONC. BINDER	5"	(GRAVEL MIX)
CRUSHER RUN BASE	6"	

CLEARING & GRADING	ARTICLE C-1
SUBGRADE	ARTICLE C-2
BASE COURSE	ARTICLE C-25
BINDER COURSE	ARTICLE C-21 OR C-23
SURFACE COURSE	ARTICLE C-31

TO BE CONSTRUCTED IN ACCORDANCE WITH THE HOWARD COUNTY ROAD CONSTRUCTION CODE AND SPECIFICATIONS
SEE HO. CO. STD. DETAILS DRAWING D-8 PAGE 63

PAVING SPECIFICATION

- 1) BASE WILL BE PRIMED IN ACCORDANCE WITH SECTION C-31-3 AS PROVIDED IN THE HOWARD COUNTY ROAD CONSTRUCTION CODE AND STANDARD SPECIFICATIONS.
- 2) TACK COAT IS REQUIRED IN ACCORDANCE WITH SECTION C-31-4 OF THE HOWARD COUNTY ROAD CONSTRUCTION CODE AND STANDARD SPECIFICATIONS.

DIVERSION DIKE

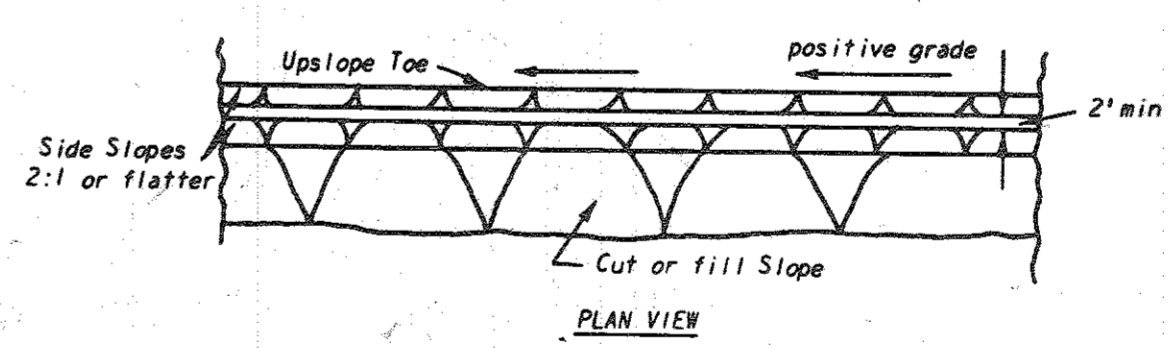
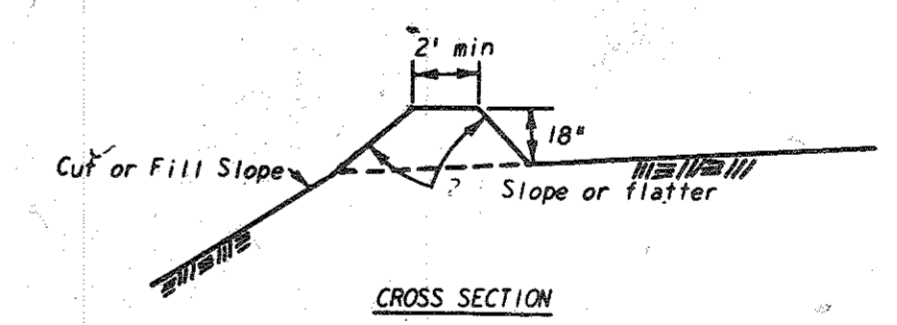

General Notes:

1. All drawings Not to Scale.
2. All dikes must be machine compacted.
3. All diversion dikes must have positive grade draining to a stabilized outlet.
4. Diverted runoff will outlet onto a stabilized undisturbed area, a prepared level spreader, or into a grade stabilization structure.
5. Periodic inspection and required maintenance must be provided.

APPROVED
DIVISION OF LAND DEVELOPMENT AND TRANSPORTATION PLANNING
HOWARD COUNTY, MARYLAND
DATE 10/15/74
J.P.



Philip A. Pappalardo 10/15/74

TITLE	DETAIL SHEET			ENGINEERING PLANNING SURVEYING
PROJECT	HOWARD COUNTY TITLE HOLDING CO., INC.			BY BOENDER ASSOCIATES INC.
LOCATION	ELECTION DISTRICT HOWARD CO., MD			ELLICOTT CITY, MD. 21043
DATE	4/16/74	DES. BY: T.B.	DRAWN BY: T.D.	CHKD BY: J.S.
SCALE:	AS SHOWN	JOB NO.:	7427	DRWG. NO. 11 OF 11