

APPROVED: FOR PUBLIC WATER AND PUBLIC/ COUNTY SEWERAGE SYSTEMS, HOWARD COUNTY HEALTH DEPARTMENT.
J. Meza (initials) 3/14/74
 COUNTY HEALTH OFFICER DATE

APPROVED: HOWARD COUNTY OFFICE OF PLANNING AND ZONING.
Thomas A. Harris 3-14-74
 PLANNING DIRECTOR DATE

H. Clawson 3/14/74
 CHIEF, DIVISION OF LAND DEVELOPMENT AND TRANSPORTATION PLANNING. DATE

APPROVED: FOR PUBLIC WATER, PUBLIC SEWERAGE AND STORM DRAINAGE SYSTEMS AND WORKS, HOWARD COUNTY DEPARTMENT OF PUBLIC WORKS.
William A. Altman 3/14/74
 DIRECTOR DATE

D. H. Nelson 3/11/74
 CHIEF, BUREAU OF HIGHWAYS DATE

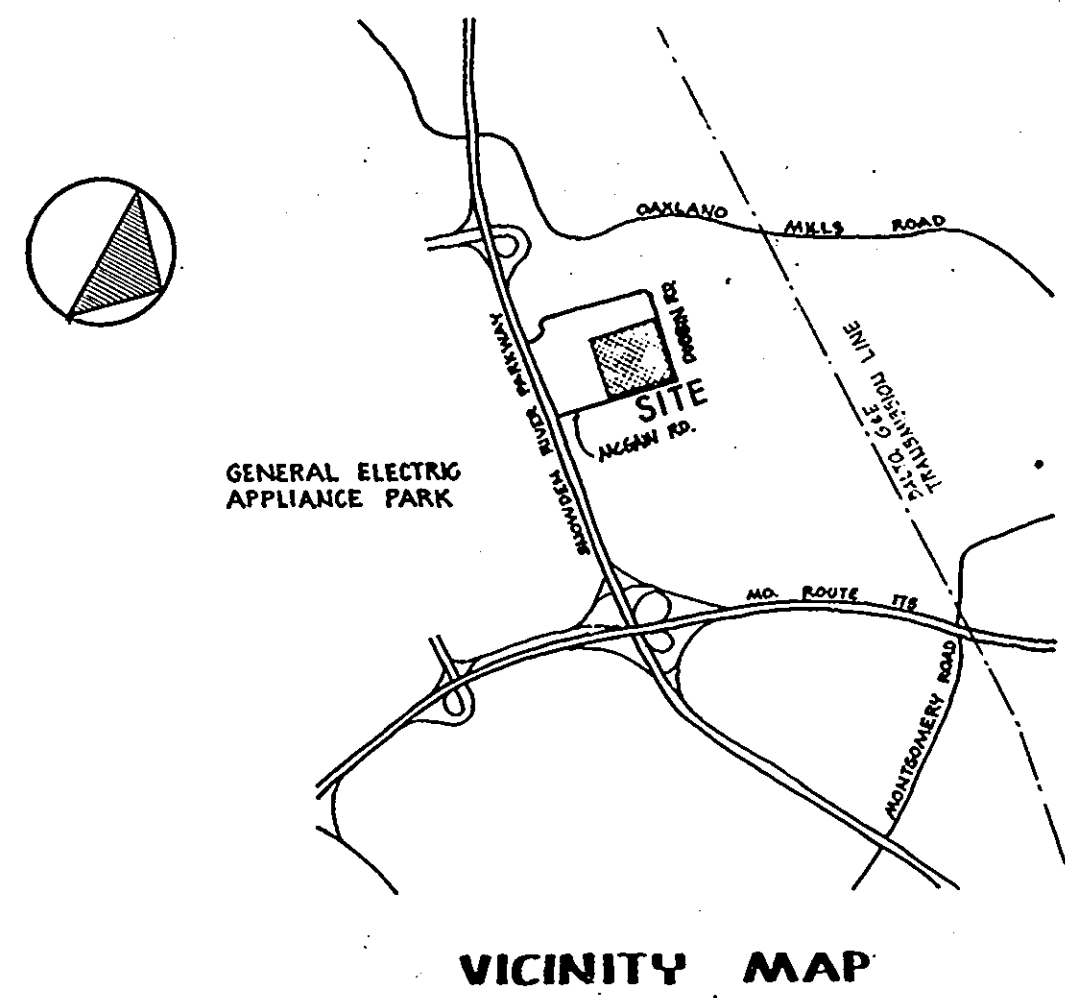

WAREHOUSE COMPLEX

SEILING INDUSTRIAL CENTER (PARCELS B-1 & C-1)
 HOWARD COUNTY, COLUMBIA, MD. 6TH ELECTION DISTRICT
 LIBER 24. FOLIO 66 RECORDED 3/16/73. TAX MAP #36

OWNER: **LG ASSOCIATES**
 10722 HANNA ST.
 BELTSVILLE, MD. 20705

ARCHITECT: **WILLIAM M. O'NEIL AIA**
 14600 HOMECREST ROAD
 SILVER SPRING, MD. 20906 570-6656

THIS STRUCTURE IS DESIGNED IN ACCORDANCE WITH THE BUILDING CODE OF HOWARD COUNTY
 WILLIAM MARTIN O'NEIL, A.I.A.



LOT AREA FOR BUILDING A (6.25 AC)			
LOT AREA (TOTAL)	544,496	SQ. FT.	42.5 AC
BUILDING AREA	204,276	SQ. FT.	37.5 %
PAVED AREA	176,112	SQ. FT.	36.0 %
PLANTED AREA	144,106	SQ. FT.	26.5 %

TOTAL FLOOR AREA OF BUILDINGS 299,470
 PARKING SPACES PROVIDED 284
 ZONED: NEW TOWN, EMPLOYMENT INDUSTRIAL.
 NO. OF EMPLOYEES = 30 (BUILDING A)
 TYR PARKING SPACE - 10' x 20'

INDEX

SHEET NO.	SHEET CONTENT
COVER SHEET	SITE PLAN, VICINITY MAP
SC2	OMITTED
SC1	SEDIMENT CONTROL AND GRADING PLAN
A1	FLOOR PLAN
A2	ELEVATIONS AND SECTIONS
A3	WALL SECTIONS, DETAILS
A4	FOUNDATION PLAN
A5	FOUNDATION DETAILS
E1	ELECTRICAL PLAN
SC3	STORM DRAINAGE PLAN
SC4	STORM DRAIN PROFILES

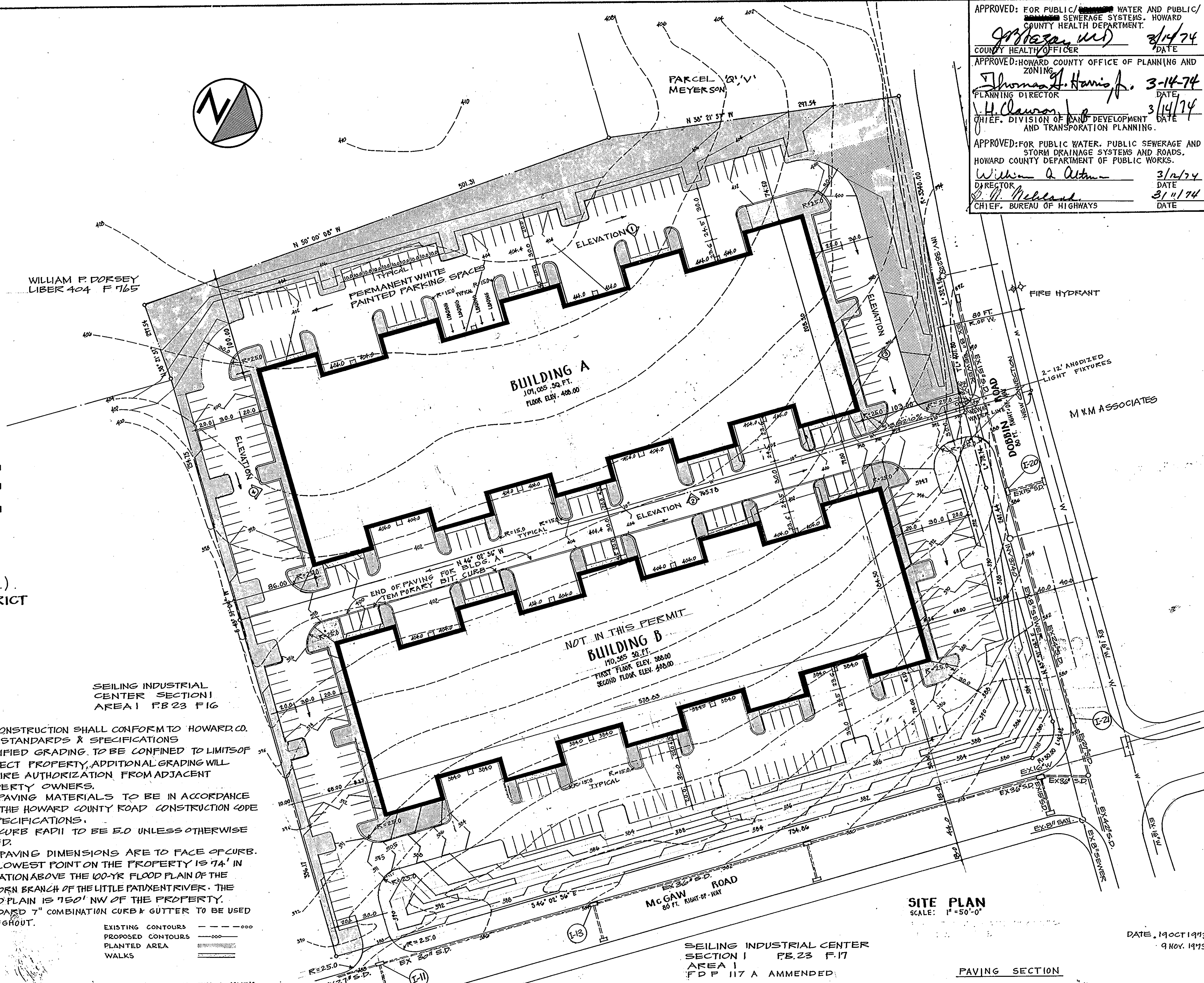

1. ALL CONSTRUCTION SHALL CONFORM TO HOWARD CO. MD. STANDARDS & SPECIFICATIONS
2. SPECIFIED GRADING TO BE CONFINED TO LIMITS OF SUBJECT PROPERTY. ADDITIONAL GRADING WILL REQUIRE AUTHORIZATION FROM ADJACENT PROPERTY OWNERS.
3. ALL PAVING MATERIALS TO BE IN ACCORDANCE WITH THE HOWARD COUNTY ROAD CONSTRUCTION CODE & SPECIFICATIONS.
4. ALL CURB RADII TO BE 50 UNLESS OTHERWISE NOTED.
5. ALL PAVING DIMENSIONS ARE TO FACE OF CURB.
6. THE LOWEST POINT ON THE PROPERTY IS 74' IN ELEVATION ABOVE THE 100-YR FLOOD PLAIN OF THE ELKHORN BRANCH OF THE LITTLE PATUXENT RIVER. THE FLOOD PLAIN IS 750' NW OF THE PROPERTY.
7. STANDARD 7" COMBINATION CURB & GUTTER TO BE USED THROUGHOUT.

EXISTING CONTOURS - - - - -
 PROPOSED CONTOURS - - - - -
 PLANTED AREA - - - - -
 WALKS - - - - -

TOPOGRAPHIC INFORMATION FROM A DRAWING MADE BY:
 CLARK + FINEPROCK AND SACKETT ENGINEERS - PLANNERS - SURVEYORS
 1161 NEW HAMPSHIRE AVE.
 SILVER SPRING, MARYLAND 20904
 (301) 515-3400 DWG. NO. HC-174

- WATER & SEWER NOTES**
1. 10" W. TO BE C.I. CLASS 22, CEMENT LINED.
 2. 2" W. TO BE COPPER, TYPE 'K'.
 3. ALL W. TO HAVE MIN 3.5' COVER.
 4. 4'S TO BE CAST IRON, HEAVY DUTY.

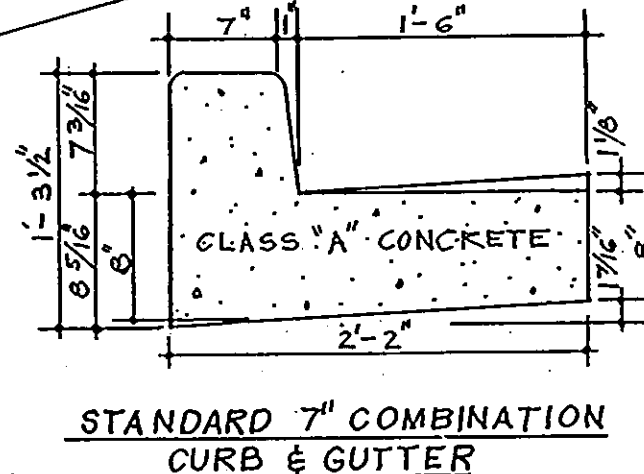

PAVING SECTION

BITUMINOUS CONCRETE SURFACE	3"	BAND C-3
BITUMINOUS CONCRETE BINDER	2"	(GRAVEL MIX)
CRUSHER RUN BASE	6"	

APPROVED
 PLANNING BOARD
 OF HOWARD COUNTY
 DATE: 11/9/74
Thomas A. Harris

CLEARING AND GRADING	ARTICLE C-1
SUBGRADE	ARTICLE C-2
BASE COURSE	ARTICLE C-25
BINDER COURSE	ARTICLE C-31 OR C-33
SURFACE COURSE	ARTICLE C-31

TO BE CONSTRUCTED IN ACCORDANCE WITH THE HOWARD COUNTY ROAD CONSTRUCTION CODE AND SPECIFICATIONS.

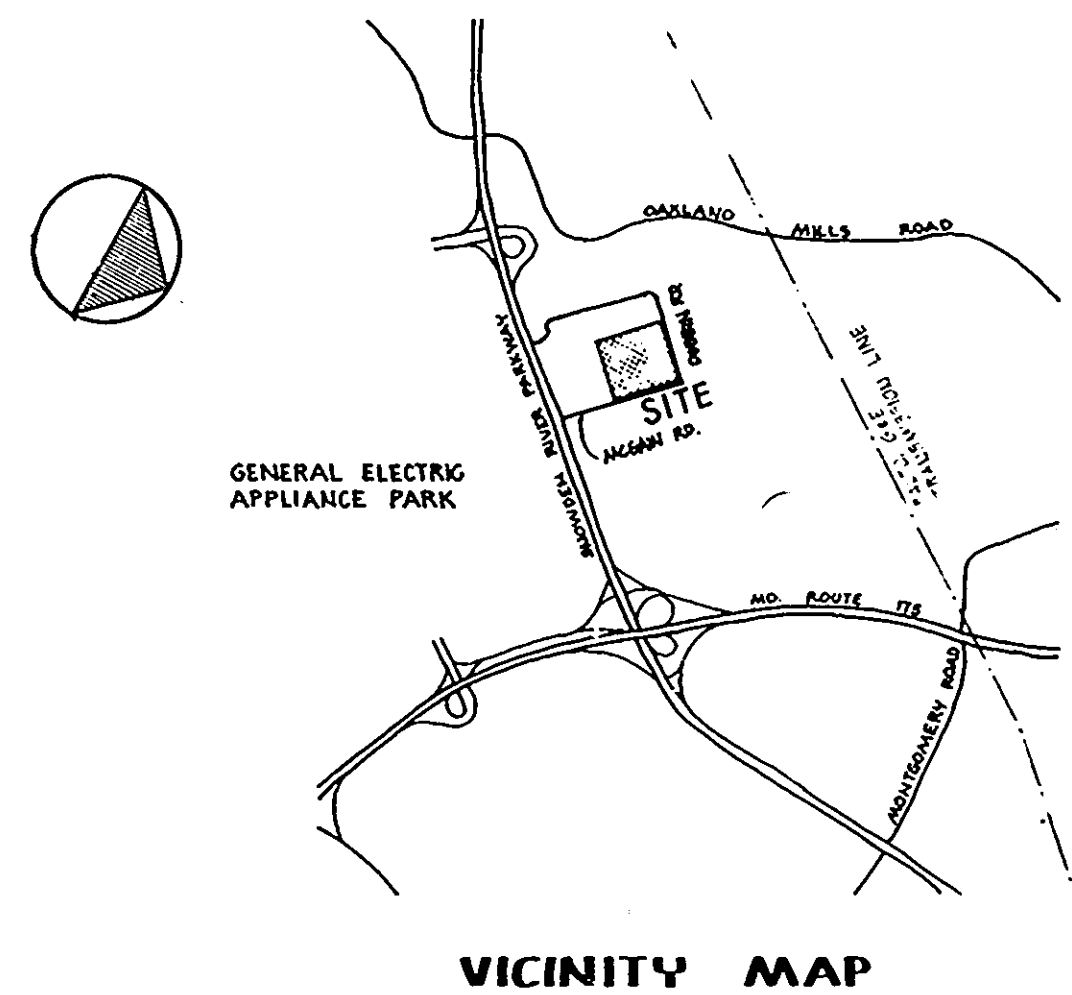

WAREHOUSE COMPLEX

SEILING INDUSTRIAL CENTER (PARCELS B-1 & C-1)
 HOWARD COUNTY, COLUMBIA, MD. 6TH ELECTION DISTRICT
 LIBER 24 FDUO 66 RECORDED 3/16/73 TAX MAP #36

OWNER: LG ASSOCIATES
 10722 HANNA ST.
 BELTSVILLE, MD. 20705

ARCHITECT: WILLIAM M. O'NEIL AIA
 14600 HOMECREST ROAD
 SILVER SPRING, MD. 20906 570-6656



LOT AREA FOR BUILDING A (6.25 AC)	
LOT AREA (TOTAL)	544,496 SQ. FT. (12.5 AC)
BUILDING AREA	204,276 SQ. FT. 37.5 %
PAVED AREA	176,112 SQ. FT. 36.0 %
PLANTED AREA	144,106 SQ. FT. 26.5 %

TOTAL FLOOR AREA OF BUILDINGS 291,470
 PARKING SPACES PROVIDED 284
 ZONED: NEW TOWN, EMPLOYMENT INDUSTRIAL.
 NO. OF EMPLOYEES - 30 (BUILDING A)
 TYP. PARKING SPACE - 10' x 20'

INDEX

SHEET NO.	SHEET CONTENT
COVER	SITE PLAN, VICINITY MAP
SC2	OMITTED
SC1	SEDIMENT CONTROL AND GRADING PLAN
A1	FLOOR PLAN
A2	ELEVATIONS AND SECTIONS
A3	WALL SECTIONS, DETAILS
A4	FOUNDATION PLAN
A5	FOUNDATION DETAILS
E1	ELECTRICAL PLAN
SC3	STORM DRAINAGE PLAN
SC4	STORM DRAIN PROFILES

DATA FOR EXISTING UTILITIES HAVE BEEN TAKEN FROM THE FOLLOWING DWGS. WATER & SEWER - CONTRACT NO 483-D STORM DRAIN - ROAD CONSTRUCTION PLANS FOR SEILING INDUSTRIAL CENTER, SECTION I AREA-1. P.B. 23 F.16.

- ALL CONSTRUCTION SHALL CONFORM TO HOWARD CO. MD. STANDARDS & SPECIFICATIONS
- SPECIFIED GRADING TO BE CONFINED TO LIMITS OF SUBJECT PROPERTY, ADDITIONAL GRADING WILL REQUIRE AUTHORIZATION FROM ADJACENT PROPERTY OWNERS.
- ALL PAVING MATERIALS TO BE IN ACCORDANCE WITH THE HOWARD COUNTY ROAD CONSTRUCTION CODE & SPECIFICATIONS.
- ALL CURB RADIUS TO BE 5.0 UNLESS OTHERWISE NOTED.
- ALL PAVING DIMENSIONS ARE TO FACE OF CURB.
- THE LOWEST POINT ON THE PROPERTY IS 74' IN ELEVATION ABOVE THE 100-YR FLOOD PLAIN OF THE ELKHORN BRANCH OF THE LITTLE PATUXENT RIVER. THE FLOOD PLAIN IS 750' NW OF THE PROPERTY.
- STANDARD 7" COMBINATION CURB & GUTTER TO BE USED THROUGHOUT.

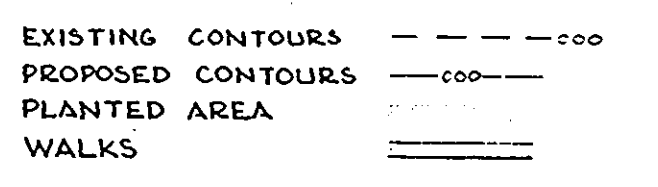

TOPOGRAPHIC INFORMATION FROM A DRAWING MADE BY: CLARK - FINEPROCK AND SACKETT ENGINEERS - PLANNERS - SURVEYORS 11161 NEW HAMPSHIRE AVE. SILVER SPRING, MARYLAND 20904 (301) 575-5400 DWG. NO. HC-179

- WATER & SEWER NOTES**
- 10" W TO BE C.I. CLASS 22, CEMENT LINED.
 - 2" W TO BE COPPER, TYPE 'K'.
 - ALL W TO HAVE MIN 3.5' COVER.
 - 4" S TO BE CAST IRON, HEAVY DUTY.

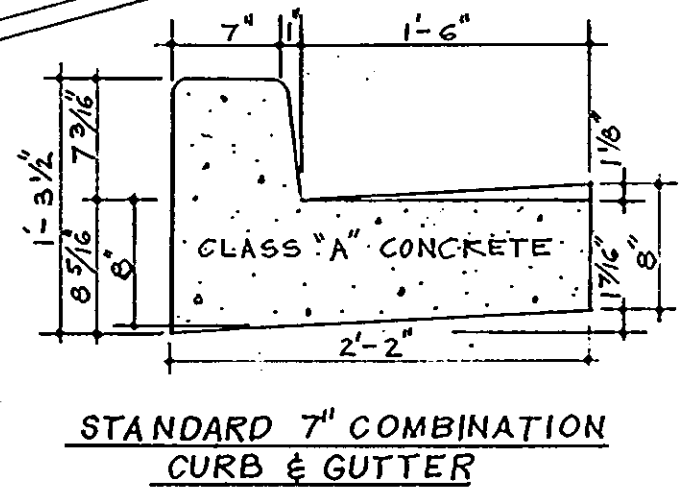
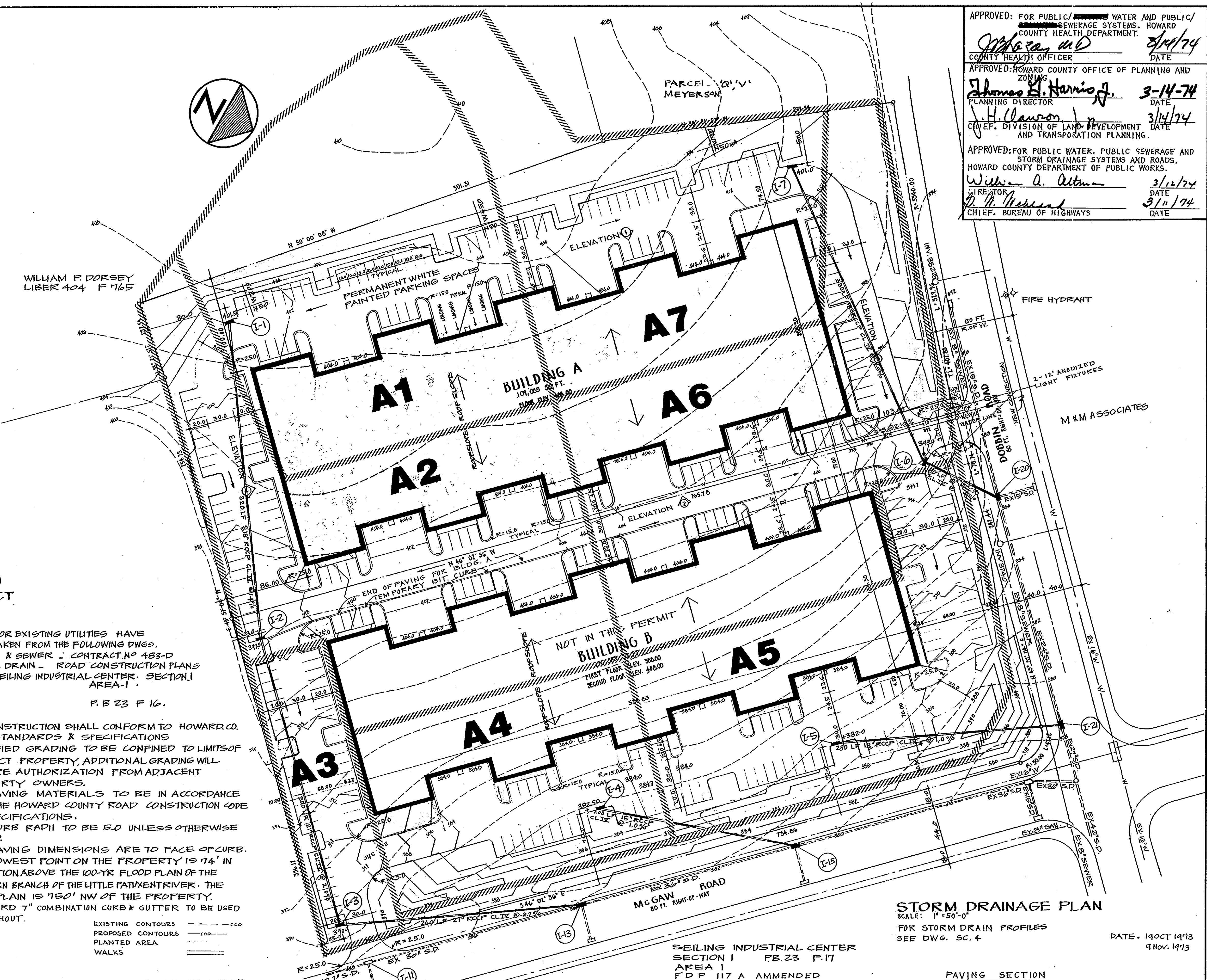

APPROVED: FOR PUBLIC WATER AND PUBLIC SEWERAGE SYSTEMS, HOWARD COUNTY HEALTH DEPARTMENT.
John P. ... 3/14/74
 COUNTY HEALTH OFFICER DATE

APPROVED: HOWARD COUNTY OFFICE OF PLANNING AND ZONING
James B. Harris Jr. 3-14-74
 PLANNING DIRECTOR DATE

J. H. Claxton Jr. 3/14/74
 CHIEF, DIVISION OF LAND DEVELOPMENT AND TRANSPORTATION PLANNING DATE

APPROVED: FOR PUBLIC WATER, PUBLIC SEWERAGE AND STORM DRAINAGE SYSTEMS AND ROADS, HOWARD COUNTY DEPARTMENT OF PUBLIC WORKS.
William A. Altman 3/14/74
 DIRECTOR DATE

W. H. ... 3/11/74
 CHIEF, BUREAU OF HIGHWAYS DATE

STORM DRAINAGE PLAN
 SCALE: 1" = 50'-0"
 FOR STORM DRAIN PROFILES SEE DWG. SC. 4
 DATE: 19 OCT 1973
 9 NOV 1973

PAVING SECTION

BITUMINOUS CONCRETE SURFACE	BAND C-3
BITUMINOUS CONCRETE BINDER	(GRAVEL MIX)
CRUSHER RUN BASE	

SC3

CLEARING AND GRADING	ARTICLE C-1
SUBGRADE	ARTICLE C-2
BASE COURSE	ARTICLE C-25
BINDER COURSE	ARTICLE C-31 OR C-33
SURFACE COURSE	ARTICLE C-31

TO BE CONSTRUCTED IN ACCORDANCE WITH THE HOWARD COUNTY ROAD CONSTRUCTION CODE AND SPECIFICATIONS.

APPROVED
 PLANNING BOARD
 OF HOWARD COUNTY
 DATE 1/9/74
James B. Harris Jr.

sh. 2 of 5
 SDP 74-26C

APPROVED: FOR PUBLIC WATER AND PUBLIC SEWERAGE SYSTEMS, HOWARD COUNTY HEALTH DEPARTMENT.
Thomas M. Harris 3/14/74
 COUNTY HEALTH OFFICER DATE

APPROVED: HOWARD COUNTY OFFICE OF PLANNING AND ZONING
Thomas M. Harris 3-14-74
 PLANNING DIRECTOR DATE

APPROVED: FOR PUBLIC WATER, PUBLIC SEWERAGE AND STORM DRAINAGE SYSTEMS AND ROADS, HOWARD COUNTY DEPARTMENT OF PUBLIC WORKS.
J. H. Claxton _____
 CHIEF DIVISION OF LAND DEVELOPMENT AND TRANSPORTATION PLANNING DATE

APPROVED: FOR PUBLIC WATER, PUBLIC SEWERAGE AND STORM DRAINAGE SYSTEMS AND ROADS, HOWARD COUNTY DEPARTMENT OF PUBLIC WORKS.
William A. Astum 3/12/74
 DIRECTOR DATE

D. P. McKeand 3/11/74
 CHIEF BUREAU OF HIGHWAYS DATE

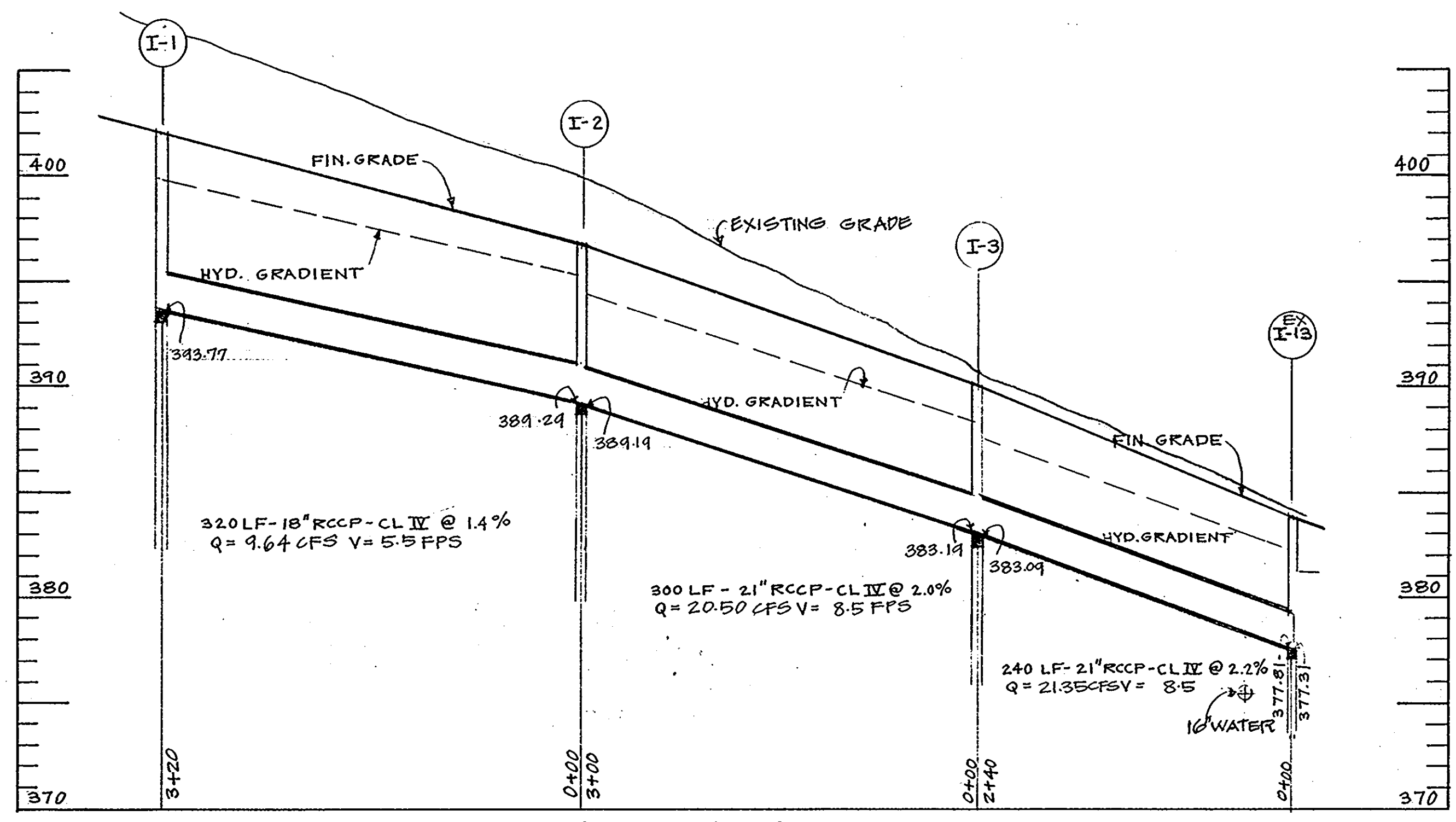

FOR PLAN SEE SHEET SC 3
 SCALE: 1" = 5'-0" VERT.
 1" = 80' HORZ.

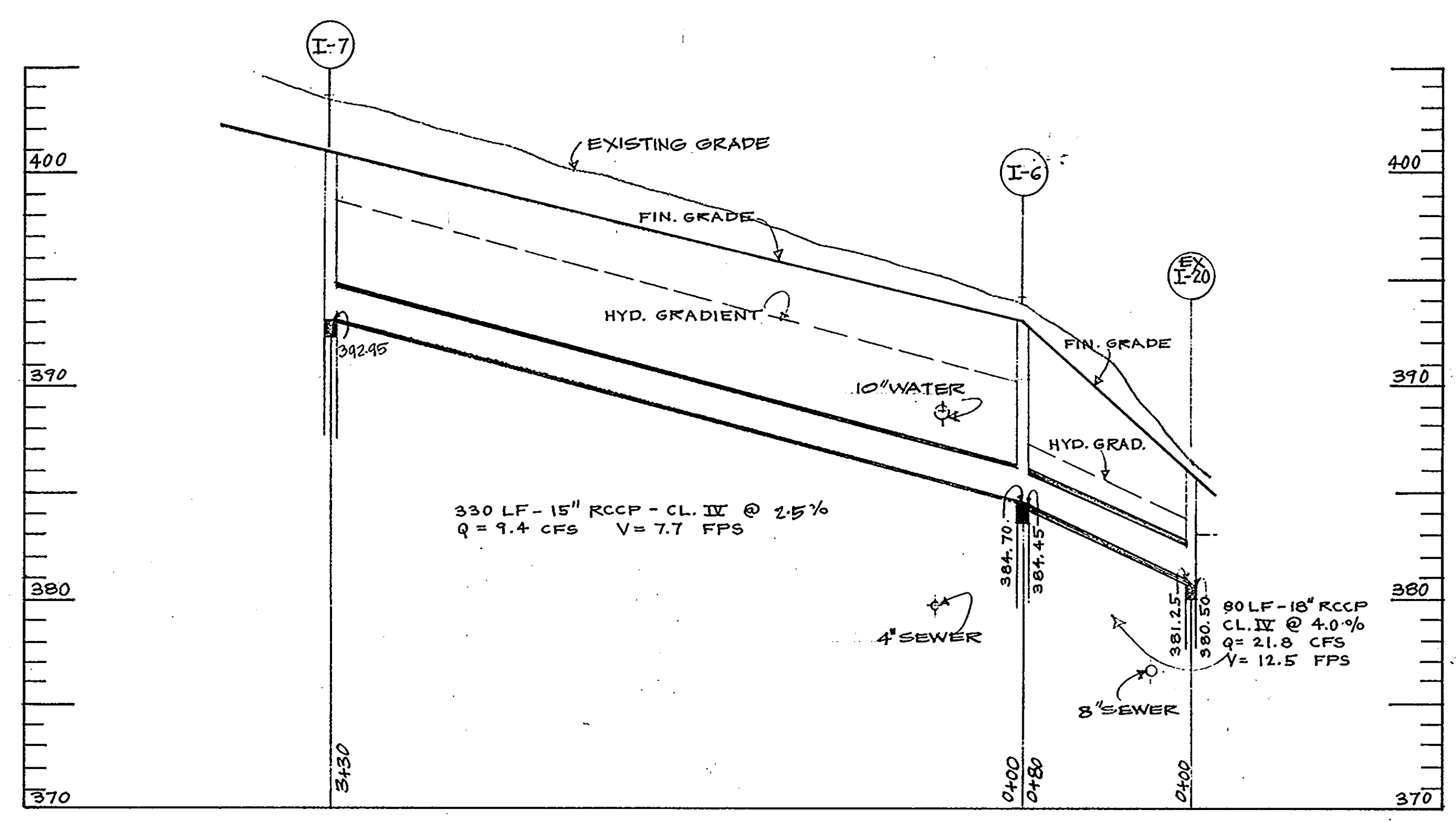

FOR PLAN SEE SHEET SC 3
 SCALE: 1" = 5'-0" VERT.
 1" = 50' HORZ.

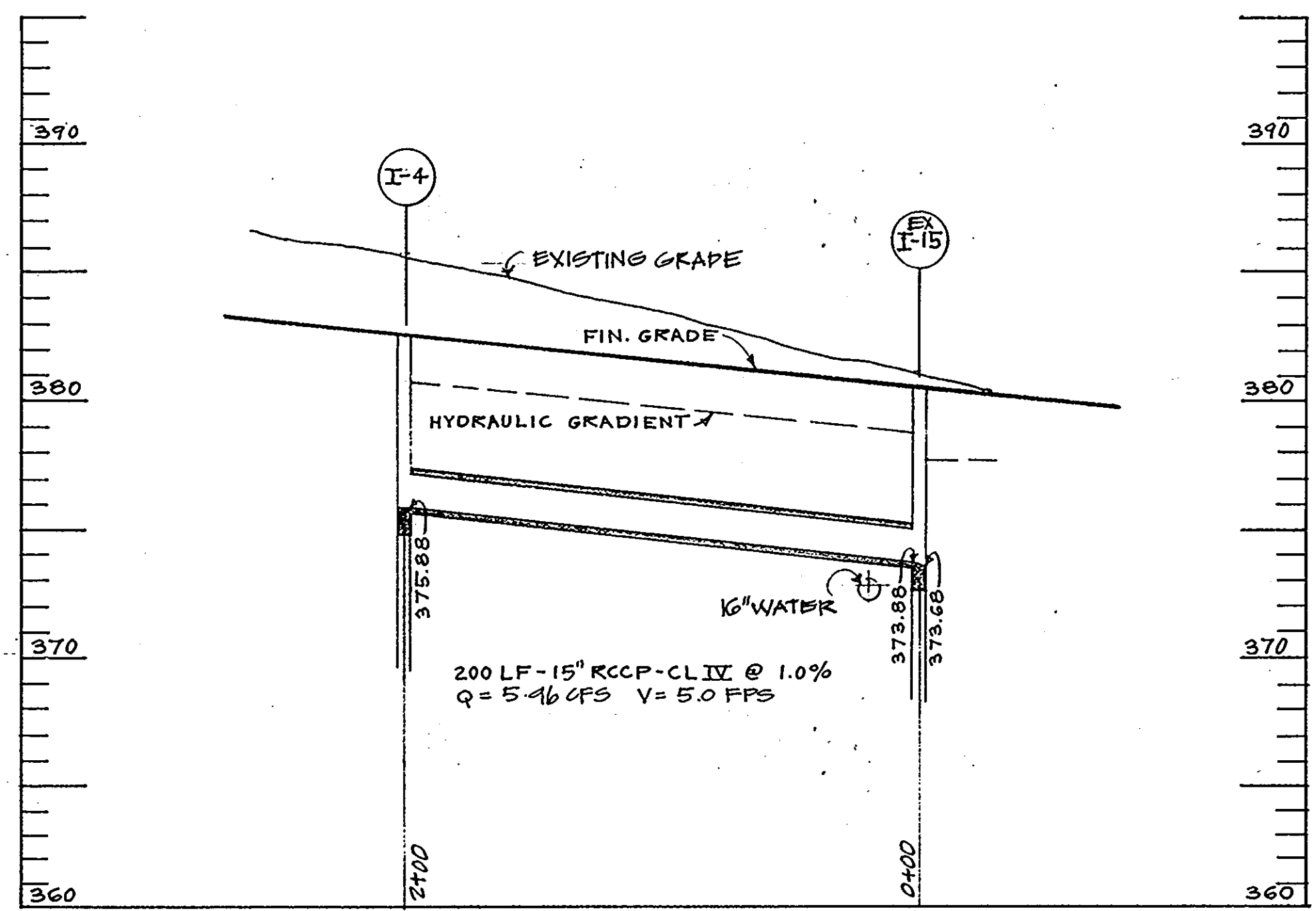

FOR PLAN SEE SHEET SC 3
 SCALE: 1" = 5'-0" VERT.
 1" = 50' HORZ.

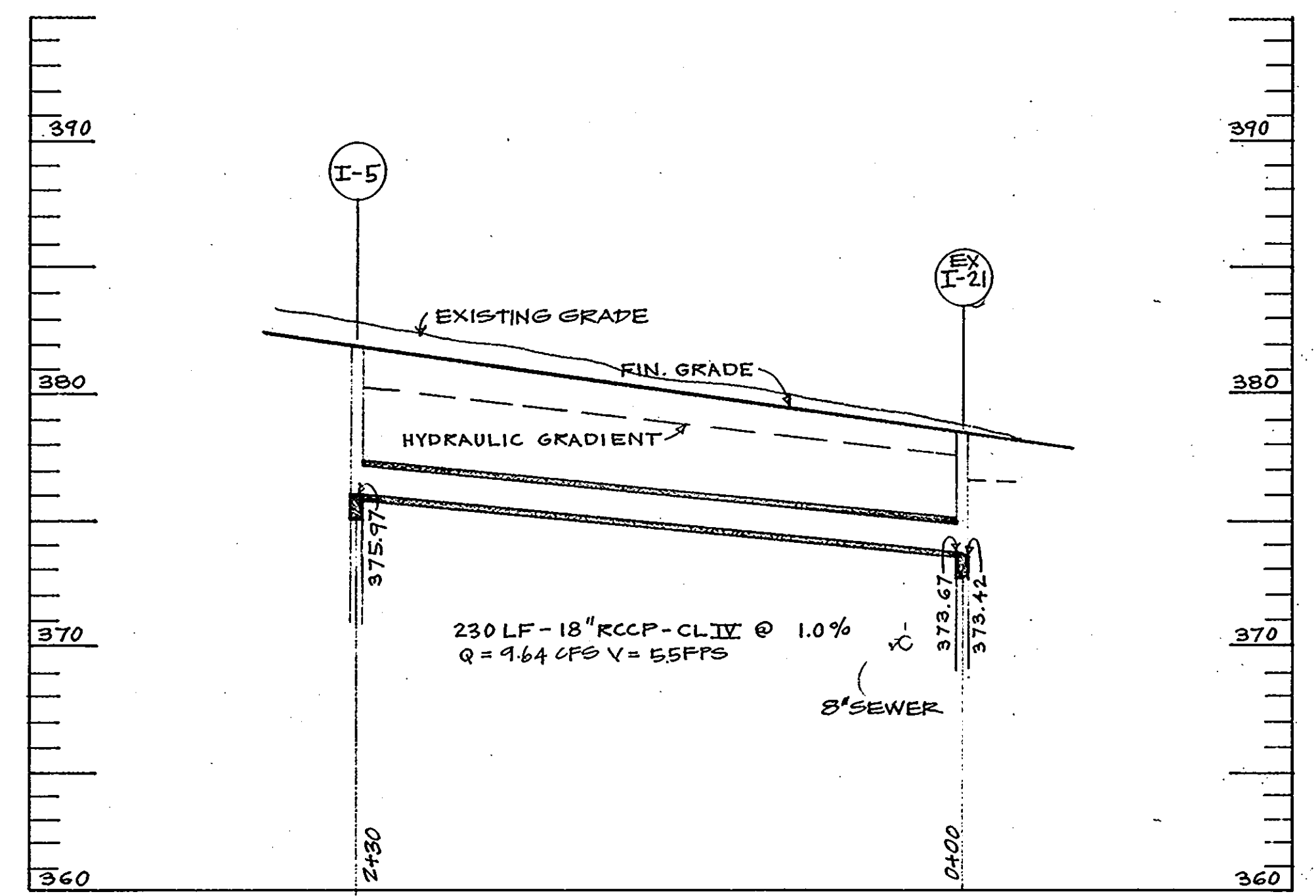

FOR PLAN SEE SHEET SC 3
 SCALE: 1" = 5'-0" VERT.
 1" = 50' HORZ.

STRUCTURE SCHEDULE				
NO.	TYPE	INV.- IN	INV.- OUT	TCP ELEV.
I-1	DOUBLE 'S' COMBINATION, DEPRESSED & PARALLEL TO CURB		393.77	401.50
I-2	DOUBLE 'S' COMBINATION	389.24	389.14	397.00
I-3	DOUBLE 'S' COMBINATION	382.14	383.04	390.00
I-4	DOUBLE 'S' COMBINATION		375.88	382.50
I-5	DOUBLE 'S' COMBINATION		375.47	382.00
I-6	DOUBLE 'S' COMB. DEPRESSED & PARALLEL TO CURB	384.70	384.45	393.00
I-7	DOUBLE 'S' COMB., DEPRESSED & PARALLEL TO CURB		392.95	401.00

DATA OF EXISTING UTILITIES HAS BEEN TAKEN FROM THE FOLLOWING DWGS.
 WATER & SEWER - CONTRACT NO. 483-D
 STORM DRAIN - ROAD CONSTRUCTION PLANS OF SEILING INDUSTRIAL CENTER, SECTION I, AREA 1.

STORM DRAIN PROFILES
 SCALE AS NOTED
 FOR STORM DRAINAGE PLAN
 SEE DWG. SC 3
 DATE: 19 OCT. 1973
 9 NOV. 1973
 14 JAN. 1974

WAREHOUSE COMPLEX
 SEILING INDUSTRIAL CENTER
 COLUMBIA, MARYLAND

LG ASSOCIATES
 10722 HANNA ST.
 BELTSVILLE, MARYLAND 20705

APPROVED
 PLANNING BOARD
 OF HOWARD COUNTY
 DATE: 11/9/74
Thomas M. Harris

SC 4

William A. Astum

SEDIMENT CONTROL NOTES

1. ALL ON-SITE STORAGE OF FILL ORT SHALL BE PLACED IN LOGS WITH PROTECTIVE MATS ALONG CONTOURS NEAR THE CENTRAL PORTION OF THE PROPERTY.
2. DIVERSION DITCHES WILL BE CONSTRUCTED AS SHOWN AND RESULT AS NECESSARY DURING GRADING OPERATIONS.
3. IMPROVEMENTS, CUT OR FILL, SHALL BE 1.0' WITH TEMPORARY STABILIZATION IMMEDIATELY AND PERMANENT VEGETATION ESTABLISHED AS SOON AS POSSIBLE PER NOTE 8 ON 9 AND NOTE 10. SLOPES STEEPER THAN 3:1 WILL BE STABILIZED PER NOTE 8.
4. FLATTER AREAS WHICH ARE NOT COVERED BY PAVING OR RUTLINGS WILL BE CONTOUR PLOTTED AT APPROXIMATELY 25 FEET HORIZONTAL SPACING.
5. THE SILT TRAP SHALL BE BUILT AS SHOWN. WHEN THE SILT REACHES ONE-HALF THE VOLUME OF THE TRAP, THE BASIN SHALL BE CLEANED OUT TO THE ORIGINAL STORAGE CAPACITY.
6. THE SLOPE OF THE BASIN SHALL BE CLEANED OUT TO THE ORIGINAL STORAGE CAPACITY.
7. THE SLOPE CONTROL STRUCTURES WILL BE BUILT AS SHOWN. WHEN THE SILT REACHES AN ELEVATION OF 32.5' FROM THE ELEVATION OF THE ORIGINAL STORAGE CAPACITY, THE ORIGINAL STORAGE CAPACITY SHALL BE MAINTAINED.
8. ALL SEDIMENT CONTROL DEVICES SHOWN HEREON SHALL BE CONSTRUCTED AND STABILIZED IN ACCORDANCE WITH NOTES 8 AND 10 AND IN OPERATION BEFORE ANY EARTH MOVING BEGINS.
9. ALL AREAS ARE TO BE GRADED TO PROVIDE POSITIVE DRAINAGE TO SEDIMENT CONTROL STRUCTURES.
10. AT THE END OF EACH WORKING DAY ALL SEDIMENT CONTROL DEVICES WILL BE INSPECTED FOR THEIR INTENDED PURPOSE AND LEFT IN OPERATIONAL CONDITION.
11. ALL SEDIMENT BASINS WILL BE CLEARED OUT WHEN SEDIMENT REACHES ONE HALF THE VOLUME OF THE TRAP, OR AS SHOWN IN THE DESIGN ON THE SEDIMENT CONTROL PLAN.
12. ALL SEDIMENT CONTROL DEVICES SHOWN ON THIS PLAN HAVE BEEN DESIGNED AND ARE IN STRICT ACCORD WITH THE "STANDARDS AND SPECIFICATIONS FOR SOIL EROSION AND SEDIMENT CONTROL IN URBANIZING AREAS" AS ADOPTED BY THE HOWARD SOIL CONSERVATION DISTRICT, 1973.

1. ALL COMPLETED STORM DRAINAGE INLETS AND PAVED STREETS WILL BE PROTECTED AND KEPT FREE OF ANY DEPOSITS OF SEDIMENT.
2. TEMPORARY FENCING WILL BE PROVIDED AROUND SEDIMENT TRAPS.
3. TEMPORARY STABILIZATION WILL BEGIN IMMEDIATELY AS GRADING PROGRESSES. ALL AREAS WHICH WILL REMAIN UNDISTURBED FOR LESS THAN SIX MONTHS SHALL BE SEEDING WITH GRASS PER ACRE. ALL AREAS WHICH WILL REMAIN UNDISTURBED FOR MORE THAN SIX MONTHS SHALL BE SEEDING WITH GRASS PER ACRE.
4. PERMANENT STABILIZATION SHALL BEGIN IMMEDIATELY UPON COMPLETION OF GRADING OF ANY AREA WHICH WILL NOT BE AGAIN DISTURBED DURING CONSTRUCTION. ALL AREAS WHICH WILL REMAIN UNDISTURBED FOR MORE THAN SIX MONTHS SHALL BE SEEDING WITH GRASS PER ACRE.
5. OPERATION FOR SOIL CONSERVATION DISTRICT.
6. APPLY GRASS APPLICATION LITERATURE AT ONE TON PER ACRE.
7. FERTILIZER SHALL BE APPLIED AT ONE TON PER ACRE.
8. MULCHING - UNDEVELOPED SMALL GRAIN STRAW WILL BE APPLIED AT THE RATE OF 150 TONS PER ACRE. FLATTER AREAS SHALL BE SEEDING AS IN NOTE 8 WITH FESCUE. MULCHING AND STRAWING ON OTHER AREAS SHALL BE APPROVED BY THE HOWARD SOIL CONSERVATION DISTRICT. (PHONE: 465-1100).
9. ALL SEDIMENT CONTROL STRUCTURES ARE TO REMAIN IN PLACE AND BE MAINTAINED IN EFFECTIVE OPERATING CONDITION UNTIL PERMISSSION FOR THEIR REMOVAL HAS BEEN OBTAINED FROM THE HOWARD SOIL CONSERVATION DISTRICT.
10. PRIOR TO STARTING ANY WORK WHICH RELATES TO SEDIMENT OR SEDIMENT CONTROL, PHONE: 465-2180 OR 465-3000 EXT. 3183.

SECTION THRU SEDIMENT BASIN DIKE AT EMERGENCY SPILLWAY
SEE DETAILS OF STONE FILTER & DIKE

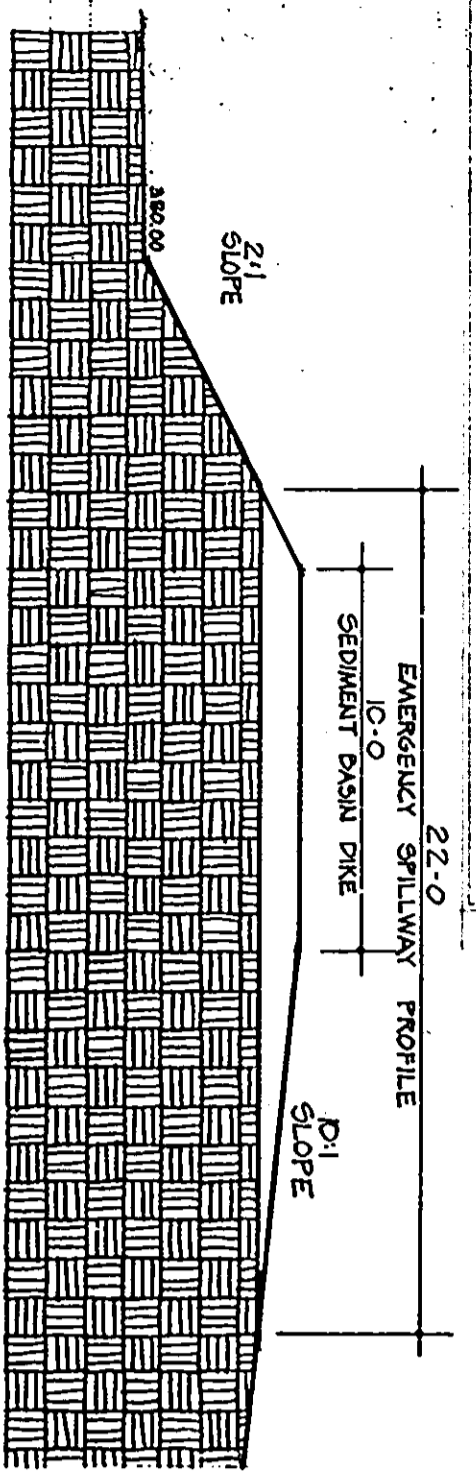

PLAN

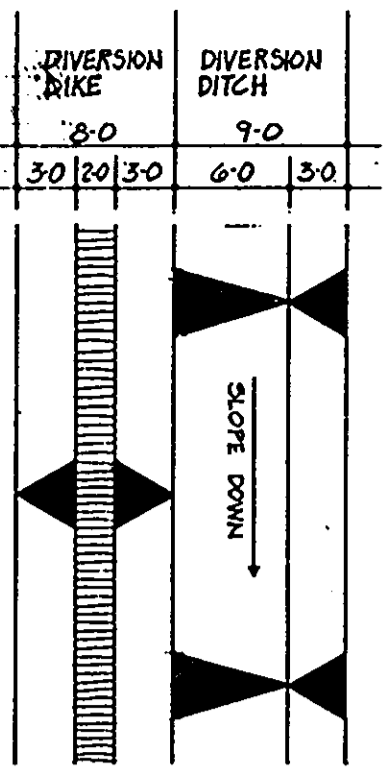

DETAILS OF DIVERSION DIKE & DRAINAGE DITCH

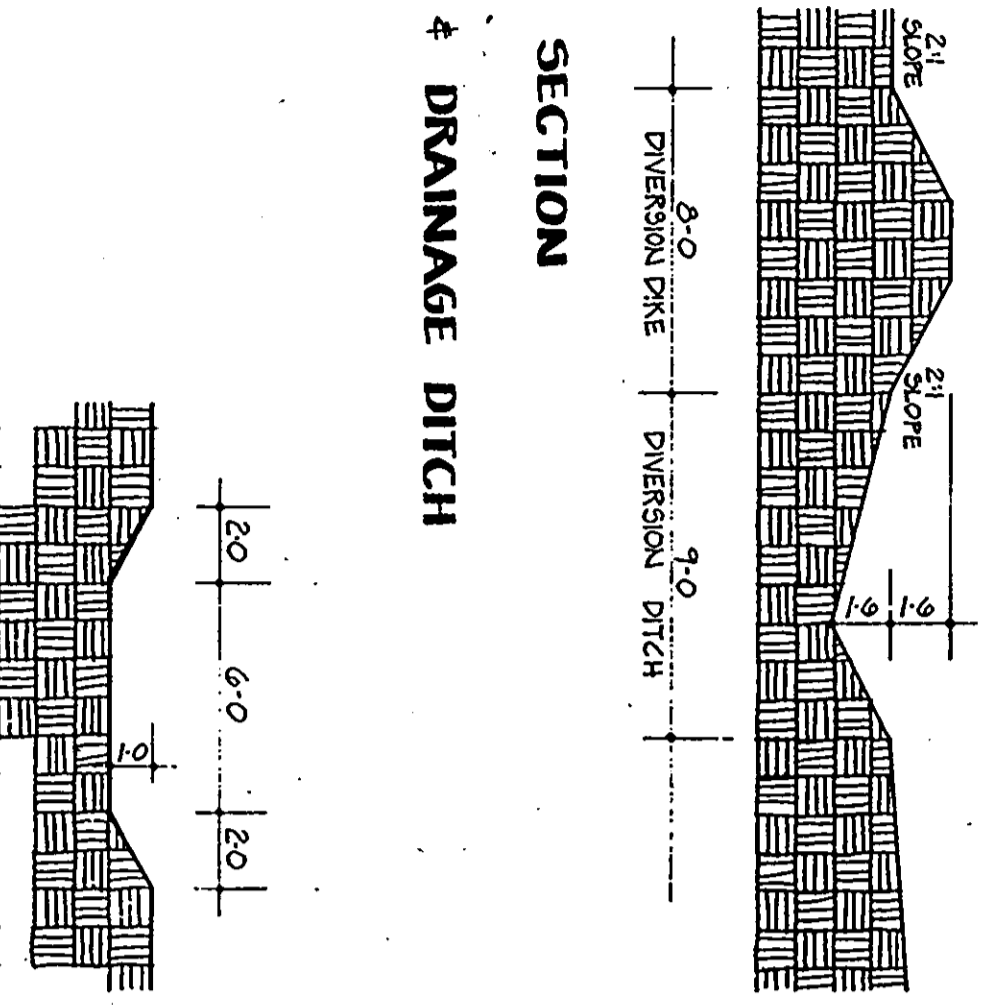

SECTION THRU EMERGENCY SPILLWAY
SEE DETAILS OF STONE FILTER & DIKE

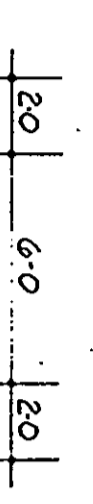

- CONTINGENT COST ESTIMATE**
CLASS "M" SEDIMENT BASIN
1. TOTAL DRAINAGE AREA 13.28 ACRES
 2. MINIMUM STORAGE REQUIRED 12.50 ACRES
 3. MINIMUM STORAGE REQUIRED 833 CU. YDS.
 4. CAPACITY OF SEDIMENT BASIN 833 CU. YDS.
 5. REQUIRED CLEAR-OUT ELEVATION 381.00 (903)
 6. REQUIRED CLEAR-OUT ELEVATION 381.00 (903)
 7. REQUIRED CLEAR-OUT ELEVATION 381.00 (903)
 8. REQUIRED CLEAR-OUT ELEVATION 381.00 (903)

EMERGENCY SPILLWAY PLAN

ITEM	QUANTITY	UNIT PRICE	TOTAL
EMERGENCY SPILLWAY STRUCTURE	1	\$10,000	\$10,000
EMERGENCY SPILLWAY FENCING	1	\$5,000	\$5,000
EMERGENCY SPILLWAY GRASSING	1	\$2,000	\$2,000
EMERGENCY SPILLWAY SIGNAGE	1	\$1,000	\$1,000
EMERGENCY SPILLWAY INSPECTION	1	\$500	\$500
EMERGENCY SPILLWAY TOTAL			\$18,500

I, *[Signature]* certify that all development and construction will be done according to this plan of development and plan for erosion and sediment control. I also authorize periodic on-site inspection by the HOWARD SOIL CONSERVATION DISTRICT or their authorized agents, as are deemed necessary. Deviation from this plan will not be made unless authorized by the HOWARD SOIL CONSERVATION DISTRICT.

DEVELOPER'S CERTIFICATE

DATE: 2/22/73

I, *[Signature]* certify that this plan for erosion and sediment control represents a practical and workable plan based on my personal knowledge of the site conditions and that I have designed the same in accordance with the requirements of the HOWARD SOIL CONSERVATION DISTRICT.

ARCHITECT'S CERTIFICATE

DATE: 2/22/73

BOARD OF EXAMINERS
STATE OF MARYLAND
DEPARTMENT OF ARCHITECTS

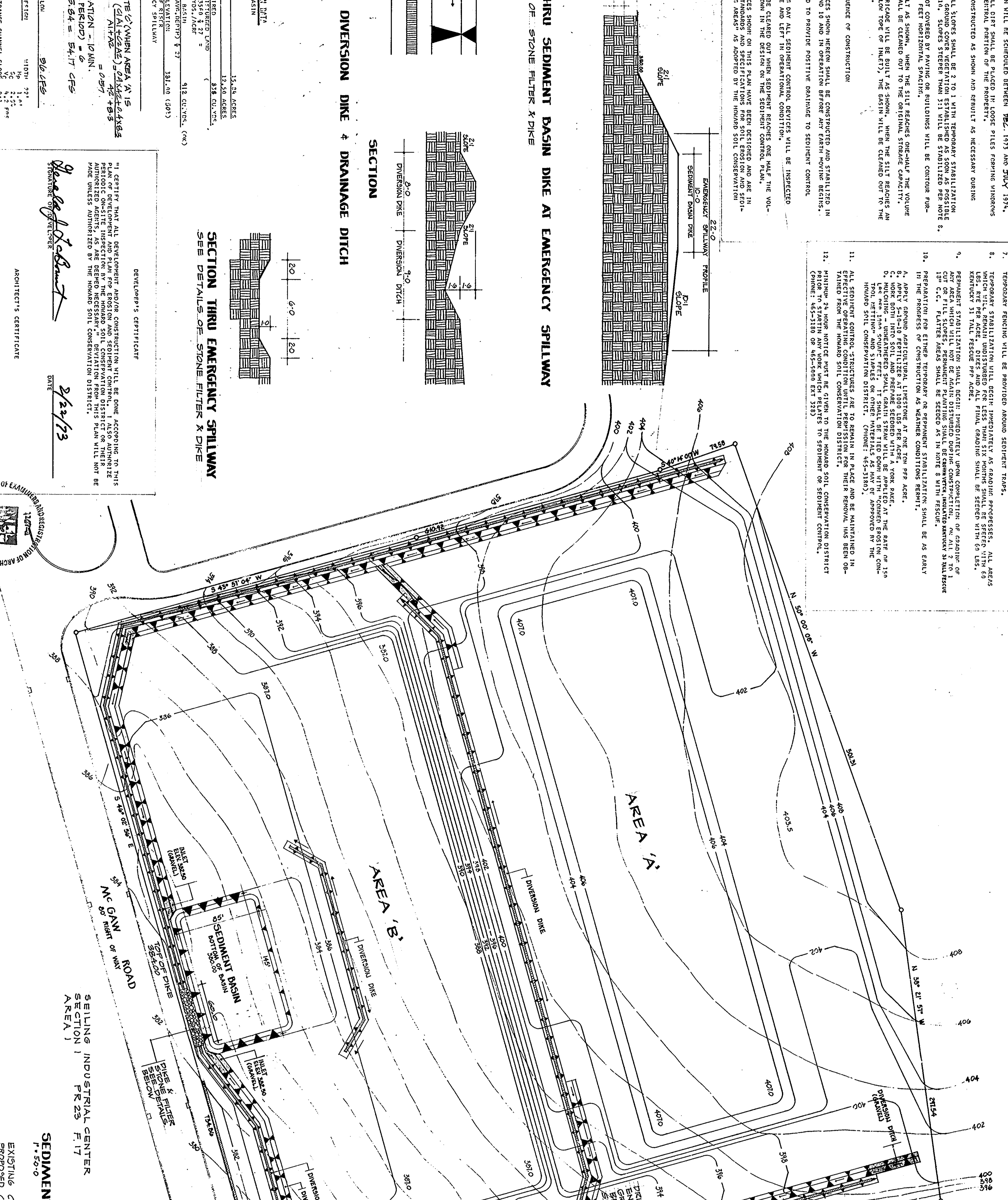
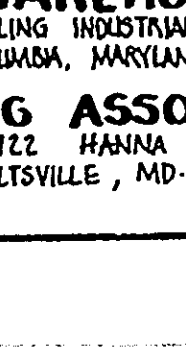
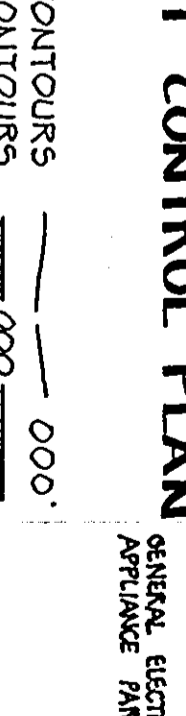
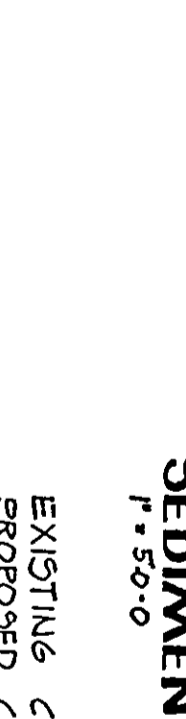

APPROVED FOR PUBLIC WATER AND PUBLIC/SEWERAGE SYSTEMS, HOWARD COUNTY HEALTH DEPARTMENT.	DATE
COUNTY HEALTH OFFICER	DATE
APPROVED: HOWARD COUNTY OFFICE OF PLANNING AND ZONING	DATE
PLANNING DIRECTOR	DATE
CHIEF, DIVISION OF LAND DEVELOPMENT AND TRANSPORTATION PLANNING	DATE
APPROVED: FOR PUBLIC WATER, PUBLIC SEWERAGE AND STORM DRAINAGE SYSTEMS AND ROADS, HOWARD COUNTY DEPARTMENT OF PUBLIC WORKS.	DATE
DIRECTOR	DATE
CHIEF, BUREAU OF HIGHWAYS	DATE
REVIEWED FOR TECHNICAL REQUIREMENTS AND MEETS SOIL CONSERVATION SERVICE	DATE: 3-6-74
APPROVED: <i>[Signature]</i> DATE: 3-6-74	DATE: 3-6-74
APPROVED: <i>[Signature]</i> DATE: 3-6-74	DATE: 3-6-74

SECTION THRU DRIVE ENTRANCE GRAVEL BERM
NO SCALE

APPROVED: PLANNING BOARD OF HOWARD COUNTY
DATE: 1/9/74

VICINITY MAP
SDP 74 26 C, A & D S

SEDIMENT CONTROL PLAN
SCALE: 1" = 50'-0"

SC1 SHEET

WAREHOUSE COMPLEX
SEDIMENT CONTROL AND GRADING PLAN

LG ASSOCIATES
10722 HANNA ST.
BELTSVILLE, MD - 20705

WILLIAM M. O'NEIL A.I.A.
ARCHITECT - PLANNER
14600 HOMECREST ROAD
SILVER SPRING, MARYLAND 20906
598 6656

DATE: FEB. 14, 1973
REVISIONS: 2802T-1A73
REV. 21 NOV. 1973

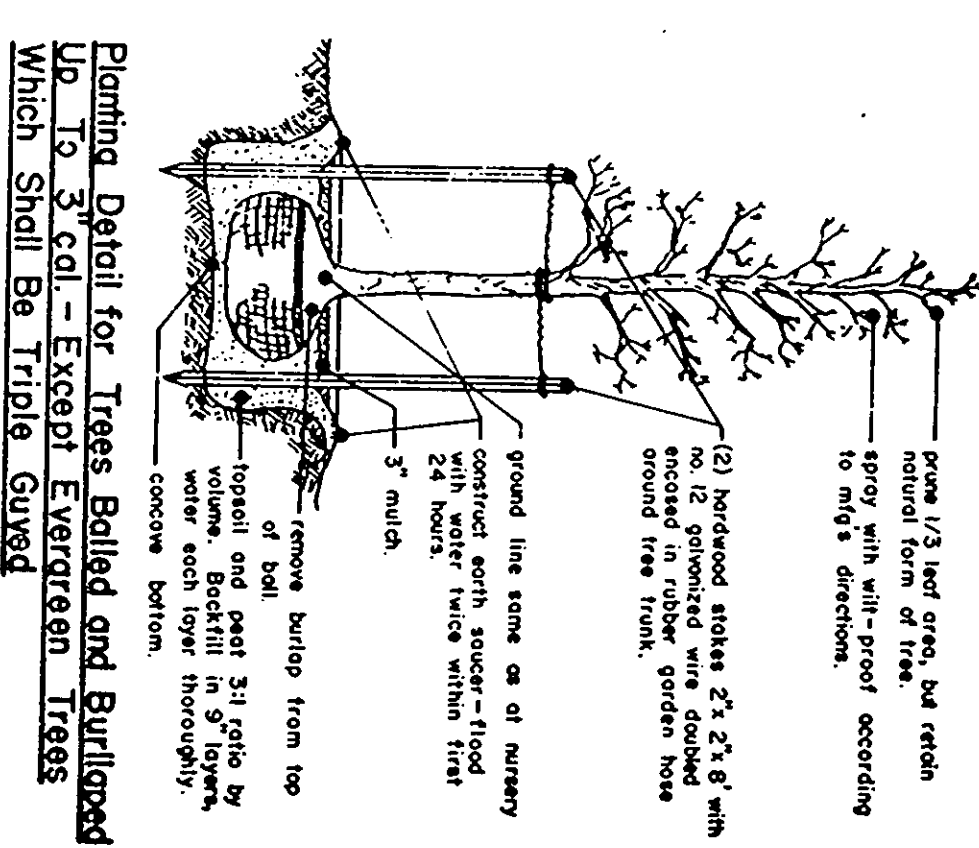
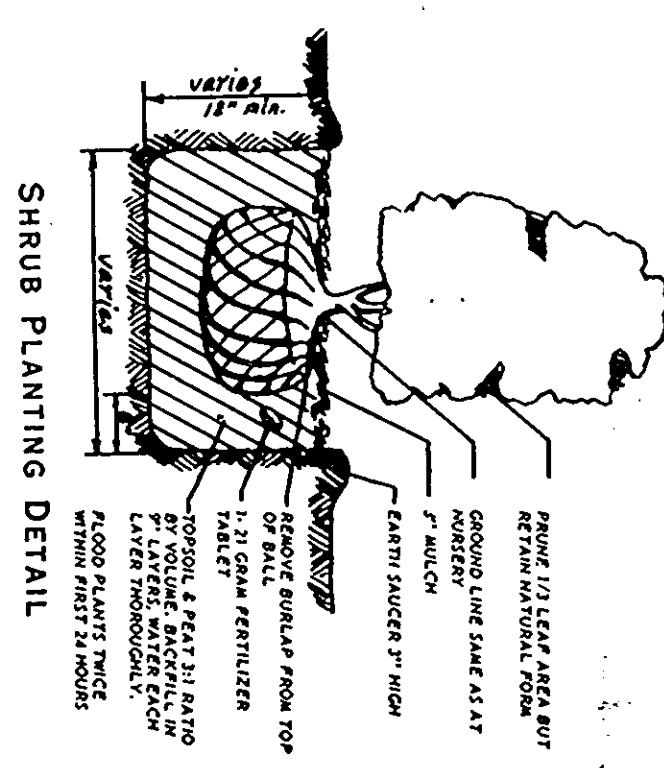
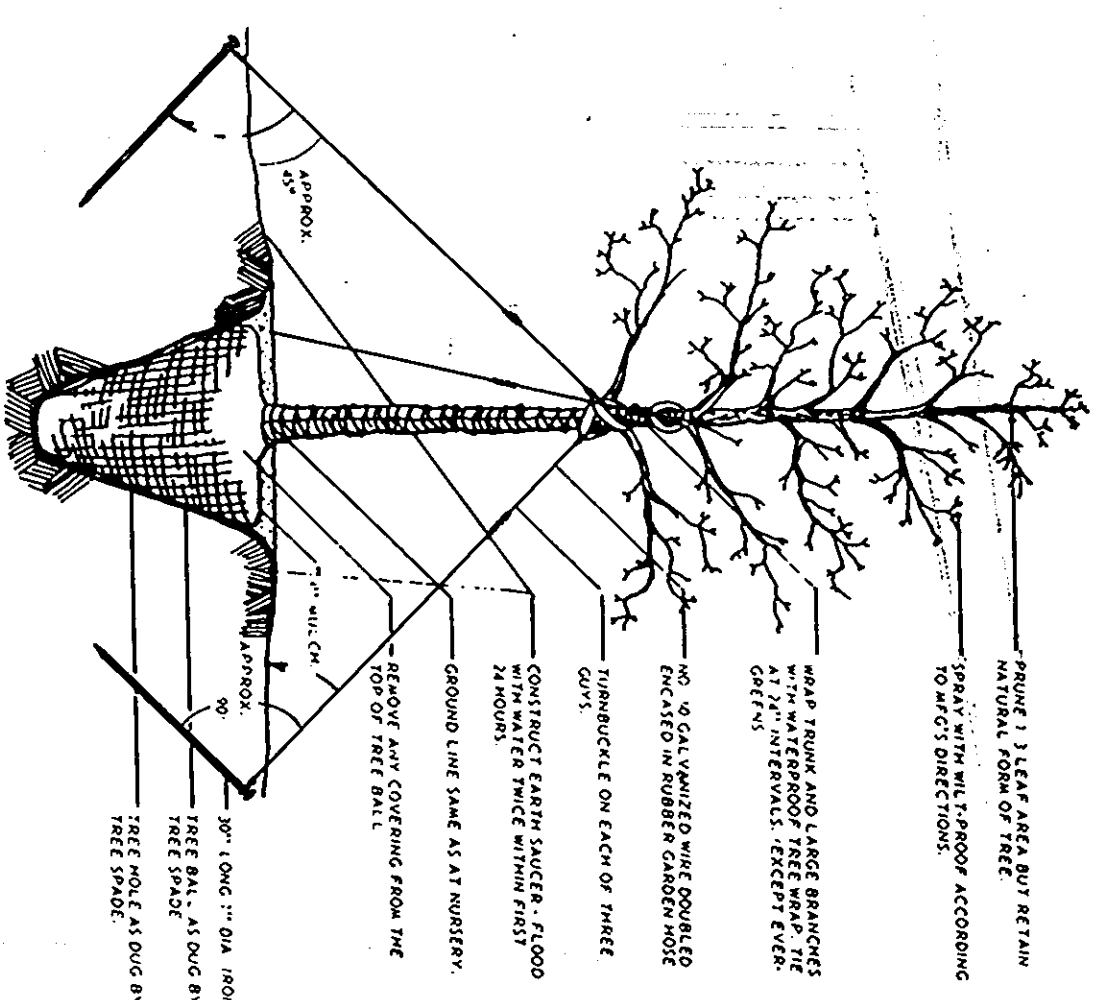

TYPE	QUAN.	SIZE	NAME
A	69	10'-12" 3-3/2" cal.	Pyrus calleryana Bradford Pear
B	11	10'-12" 2 1/2" 3" cal.	Cercis canadensis Redbud
C	28	12'-14" 3-3 1/2" cal.	Koeleria paniculata Golden Rain
D	37	12'-14" 3 1/2" 4" cal.	Pinus nigra Austrian Pine
E	9	14'-16" 3 1/2" 4" cal.	Cedrus deodora Deodora Cedar
F	30	18" 18" 4" 1/2" cal.	Quercus borealis Red Oak
G	13	12'-14" 3-3 1/2" cal.	Fraxinus pennsylvanica Green Ash All type GO trees to be planted by owner.
H	17	12'-14" 3-3 1/2" cal.	Fraxinus pennsylvanica Green Ash
I	12	4" pot 3 yr. plants	Pyramidalis quinquifida Virginia Creeper
J	182	18" 2" 2"	Eurostoma olea compacta Winged Eurostoma
K	208	18" 2" 2"	Quercus bicolor Oregon White Oak
L	214	2 1/4" pot	Vincetoxicum Vines
M	180 sq. yds.	No. 2 wash gravel	

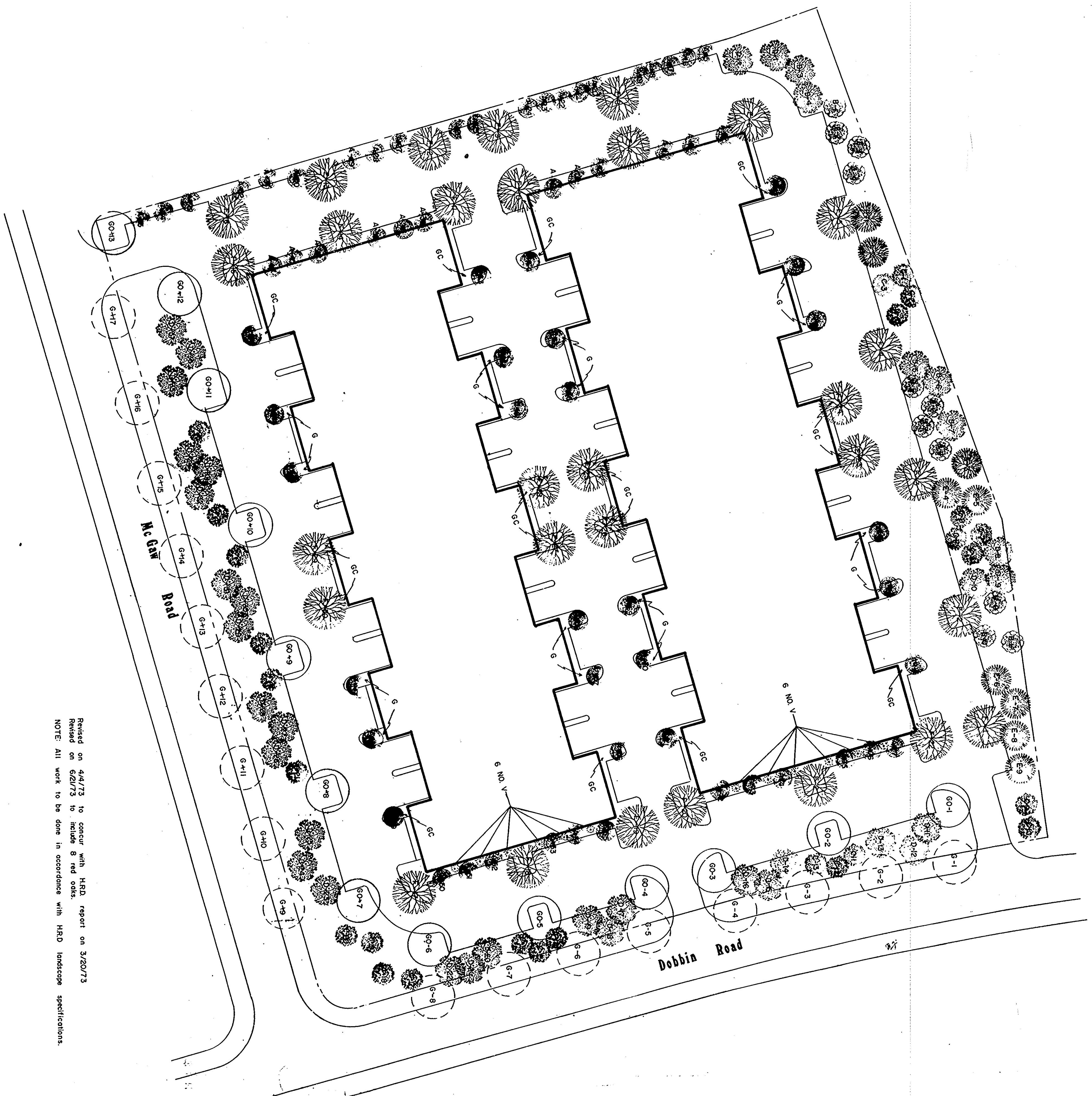

Revised on 4/4/73 to concur with HSD report on 3/20/73
 Revised on 6/21/73 to include 8 red oaks.
 NOTE: All work to be done in accordance with HSD landscape specifications.

STATE OF MARYLAND
 DEPARTMENT OF TRANSPORTATION
 DIVISION OF HIGHWAYS

WILLIAM M. O'NEIL AIA
 1460 HOMECREST ROAD
 SILVER SPRING, MD 20906

LANDSCAPE DEVELOPMENT PLAN
 WAREHOUSE COMPLEX
 SELLING INDUSTRIAL CENTER
 SCALE: 1" = 40'-0"
 DATE: FEB. 23, 1973