

VICINITY MAP  
SCALE 1"=1200'

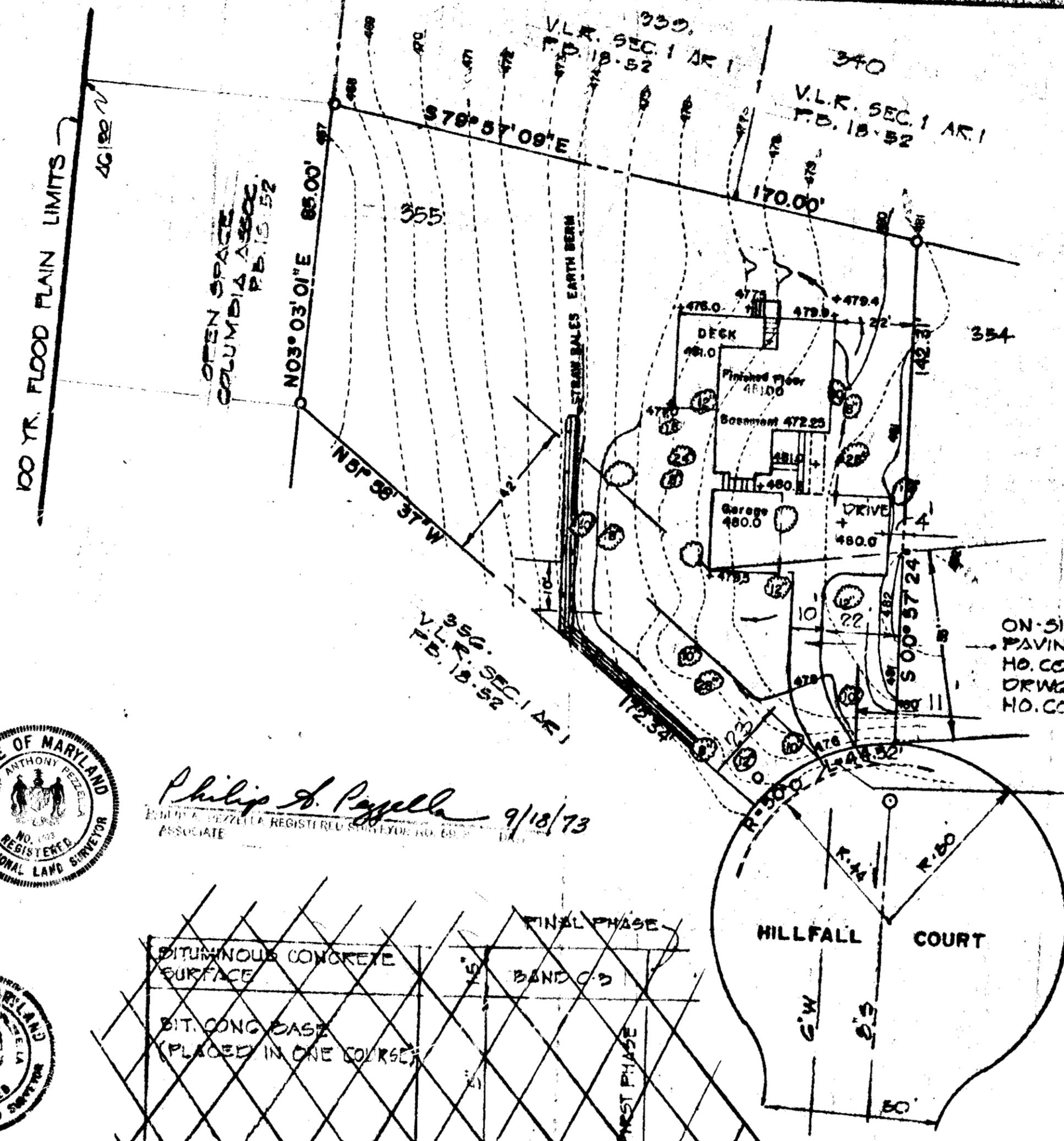

APPROVED: FOR PUBLIC WATER AND PUBLIC SEWERAGE SYSTEMS HOWARD COUNTY HEALTH DEPT.

COUNTY HEALTH OFFICER DATE  
 APPROVED: HOWARD COUNTY OFFICE OF PLANNING AND ZONING DATE  
*Thomas J. Howard* 9-27-73  
 PLANNING DIRECTOR  
*J. H. Clavon* 9/27/73  
 CHIEF, DIVISION OF LAND DEVELOPMENT AND TRANSPORTATION PLANNING  
 APPROVED: FOR PUBLIC WATER AND PUBLIC SEWERAGE AND STORM DRAINAGE SYSTEMS AND ROADS.  
*William A. O'Brien* 9/25/73  
 DIRECTOR  
*J. M. McRee* 9/24/73  
 CHIEF, BUREAU OF HIGHWAYS

REVIEWED FOR Howard S.C.D. AND MEETS TECHNICAL REQUIREMENTS.  
James M. Dehn 9/18/73  
 U.S. SOIL CONSERVATION SERVICE DATE  
 THIS DEVELOPMENT PLAN IS APPROVED FOR SOIL EROSION AND SEDIMENT CONTROL BY THE HOWARD SOIL CONSERVATION DISTRICT  
 APPROVED: Robert W. Johnson 9/18/73  
 HOWARD SOIL CONSERVATION DIST. DATE



*Philip J. Poggella* 9/18/73  
 ASSOCIATE

ENGINEERS CERTIFICATION  
 I CERTIFY THAT THIS PLAN FOR EROSION AND SEDIMENT CONTROL REPRESENTS A PRACTICAL AND WORKABLE PLAN BASED ON MY PERSONAL KNOWLEDGE OF THE SITE CONDITIONS AND THAT IT WAS PREPARED IN ACCORDANCE WITH THE REQUIREMENTS OF THE HOWARD SOIL CONSERVATION DISTRICT.  
*Philip J. Poggella* 9/18/73  
 DATE



DEVELOPERS CERTIFICATION  
 I CERTIFY THAT ALL THE DEVELOPMENT AND/OR CONSTRUCTION WILL BE DONE ACCORDING TO THIS PLAN OF DEVELOPMENT AND PLAN FOR EROSION AND SEDIMENT CONTROL, AND I ALSO AUTHORIZE PERIODIC ON-SITE INSPECTION BY THE HOWARD SOIL CONSERVATION DISTRICT OR THEIR AUTHORIZED AGENTS, AS ARE HELD NECESSARY. DEVIATION FROM THIS PLAN WILL NOT BE MADE UNLESS AUTHORIZED BY THE HOWARD SOIL CONSERVATION DISTRICT.  
Kenneth D. Shraeder 9/18/73  
 DATE

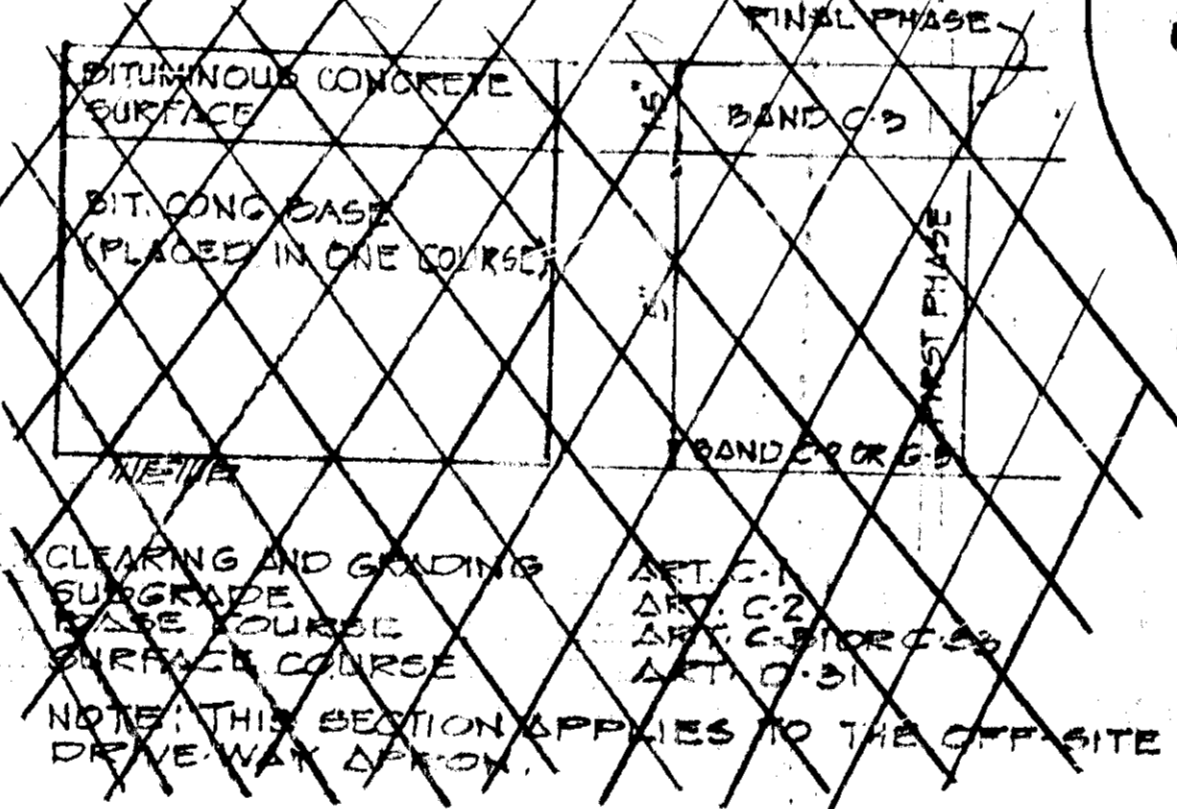

ON-SITE DRIVEWAY PAVING SHALL BE HO. CO. STD. SEE DRWG. D-15 PG. 68 HO. CO. STD. DETAILS  
 OFF-SITE DRIVEWAY APRON SHALL BE HO. CO. STD. SEE DRWG. D-34 PG. 89 HO. CO. STD. DETAILS  
 1/2" PREFORM. BIT. EXPAN. JOINT VARIES 4'-0" 1/2" 1/4" CONCRETE 6X6 #6 WIRE MESH SEC. OF CURB TO BE REMOVED SEC. DRIVEWAY IN EX. CURB  
 1) TAX MAP NUMBER - 30  
 2) LOT NUMBER - 365  
 3) TOTAL AREA OF SITE - 22,677 S.F. - 0.512 AC.  
 4) PRESENT ZONING - NEW TOWN  
 5) SUBDIVISION PLAT REFERENCE - P.D. 18-52

APPROVED  
 DIVISION OF LAND DEVELOPMENT AND TRANSPORTATION PLANNING  
 HOWARD COUNTY, MARYLAND  
 DATE: 9/18/73  
*J. H. Clavon*

OWNER:  
 KENNETH D. SHRAEDER  
 P.O. BOX 1544  
 ANNAPOLIS MD. 21404

FLOOD PLAIN STUDY INFORMATION  
 HOWARD COUNTY BUREAU OF PUBLIC WORKS  
 DEPARTMENT OF ENGINEERING  
 50 YR. FLOOD PLAIN 455E  
 100 YR. FLOOD PLAIN 4G1B2

BITUMINOUS CONC. SURFACE	BAND C-3
BITUMINOUS CONC. BASE	BAND C-2 OR G-3

NOTE: BASE WILL BE PRIMED IN ACCORDANCE WITH SECTION C-30-5 AS PROVIDED IN THE HO. CO. ROAD CONSTRUCTION CODE & STANDARD SPECIFICATIONS.  
 NOTE: TACK COAT IS REQUIRED IN ACCORDANCE WITH SECTION C-31-4 OF THE HO. CO. ROAD CONSTRUCTION CODE & STANDARD SPECIFICATIONS.

CLEARING & GRADING SURFACE ART. C-1  
 SUBGRADE ART. C-2  
 BASE COURSE ART. C-31 OR C-33  
 SURFACE ART. C-31  
 NOTE: ALL PAVING TO BE CONSTRUCTED IN ACCORDANCE WITH THE HOWARD CO. ROAD CONSTRUCTION CODE & SPECIFICATIONS  
 NOTE: THIS SECTION APPLIES TO THE ON-SITE DRIVEWAY

TITLE <b>SITE PLAN</b>		ENGINEERING PLANNING SURVEYING BY <b>BOENDER ASSOCIATES INC.</b>
PROJECT LOT 355		
LOCATION LONGREACH VILLAGE COLUMBIA, MD. SEC. 1 AREA 1	DATE JULY 16, 1973	811 HICOTT CITY, MD. 21043 SALISBURY, MD. 21801 301-468-7777
DESIGNER DRAWN BY CHKD BY	JOB NO.: 7815E-2	
SCALE: 1"=30'	DRWG. NO.:	

SDP 74-06C

SDP 74-06C