

# MAIER PLACE

BURSA ROAD

MAIER ROAD

**NOTES**

- 1- ALL ELEVATIONS SHALL BE TO 1982 TO FINISH CURB & GUTTER
- 2- ALL MATERIALS & CONSTRUCTION METHODS SHALL BE IN ACCORDANCE WITH HOWARD COUNTY ROAD & STANDARD SPECIFICATIONS UNDER THE PAVING SECTION DRAWING D-6 (May 1968) Page 61 of "Standard Road and Street Details"

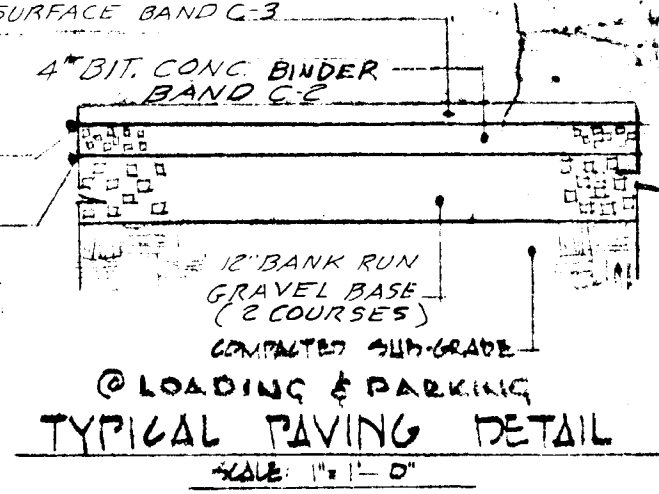
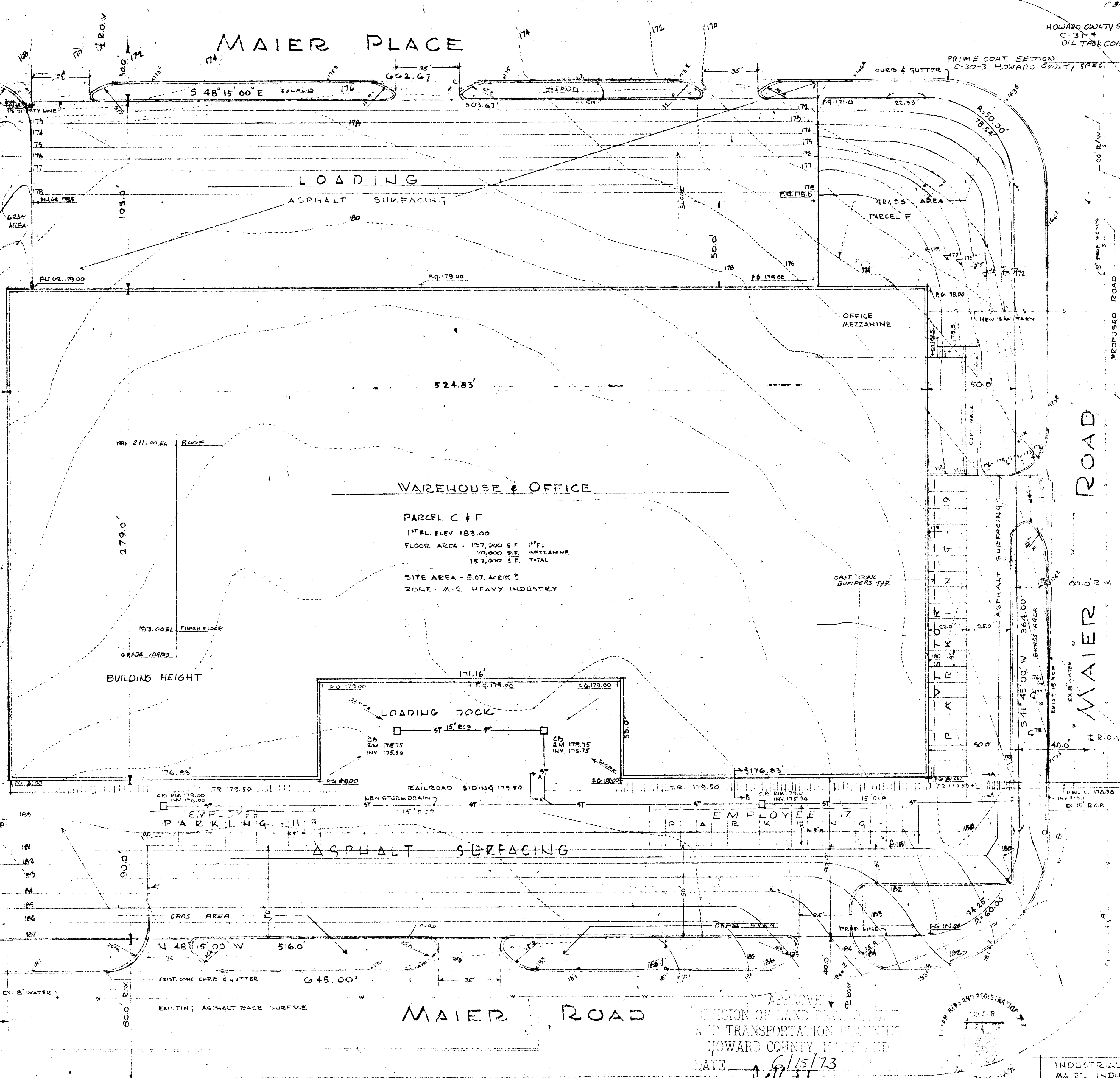

APPROVED FOR PUBLIC WATER AND PUBLIC SEWERAGE SYSTEMS, HOWARD COUNTY HEALTH DEPARTMENT.	DATE
COUNTY HEALTH OFFICER	DATE
APPROVED HOWARD COUNTY OFFICE OF PLANNING AND ZONING	DATE
PLANNING DIRECTOR	DATE
COM. DIVISION OF LAND DEVELOPMENT AND TRANSPORTATION PLANNING	DATE
APPROVED FOR PUBLIC WATER, PUBLIC SEWERAGE AND STORM DRAINAGE SYSTEMS AND ROADS	DATE
HOWARD COUNTY DEPARTMENT OF PUBLIC WORKS	DATE
DIRECTOR	DATE
CHIEF BUREAU OF HIGHWAYS	DATE

REVIEWED FOR HOWARD COUNTY DEPARTMENT OF PUBLIC WORKS  
NAME: HOWARD COUNTY DEPARTMENT OF PUBLIC WORKS  
DATE: 7/16/72  
SIGNATURE: [Signature]  
U.S. SOIL CONSERVATION SERVICE

THIS DEVELOPMENT PLAN IS APPROVED FOR SOIL EROSION AND SEDIMENT CONTROL BY THE HOWARD COUNTY SOIL CONSERVATION DISTRICT.  
APPROVED: [Signature] DATE: 7/16/72  
HOWARD COUNTY

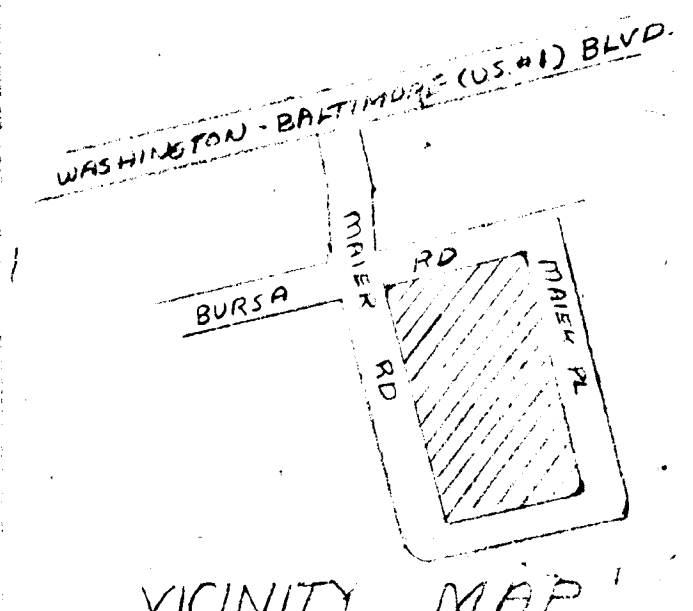

- KEY**
- - - EXISTING GRADE CONTOUR
  - - - NEW FINISH GRADE CONTOUR
  - + ELEV. NEW SPOT FIN. GRADE ELEVATION
  - - - EXIST. SPOT GRADE ELEVATION
  - - - SANITARY SEWER
  - - - STORM SEWER
  - - - WATER MAIN

BASED ON SURVEY BY ROBERT J. BANKS & ASSOC., CIVIL ENGR. COLLEGE PARK, MD. DATE: JULY 1972, REV. 10-13-72

APPROVED  
DIVISION OF LAND DEVELOPMENT AND TRANSPORTATION PLANNING  
HOWARD COUNTY, MARYLAND  
DATE: 6/15/73

**SITE PLAN**  
SCALE - 1" = 30'-0"  
TOTAL PARKING SPACES - 47  
REQUIRED PARKING - 17% SPACES, 35 FOR EMPLOYEES

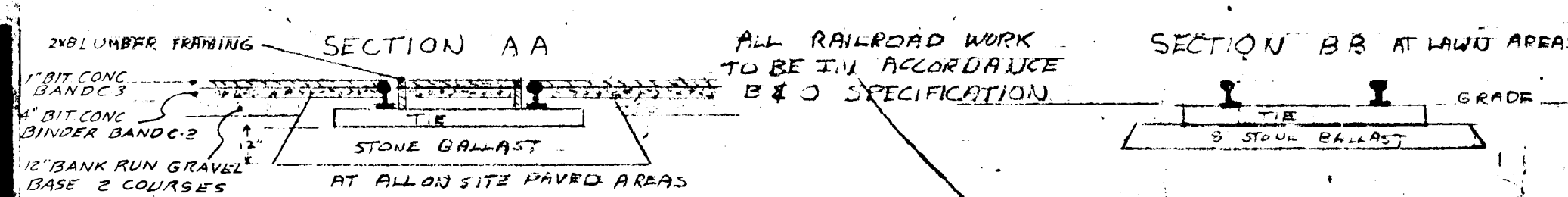

**BUILDERS DEVELOPER**  
**M. ALFIERI CO., INC.**

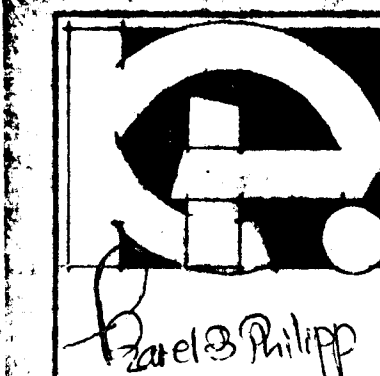

INDUSTRIAL BUILDING FOR SAVAGE PROPERTIES MATS INDUSTRIAL PARK - SIXTH ELECTION DISTRICT SAVAGE, HOWARD COUNTY, MARYLAND	
JOB NO. <b>7234</b>	DATE 6/15/73
DRAWN BY: DA, HE	DRWG. NO. 1
CHECKED BY:	SCALE
DATE: 11/06/72	

SDP 73-74

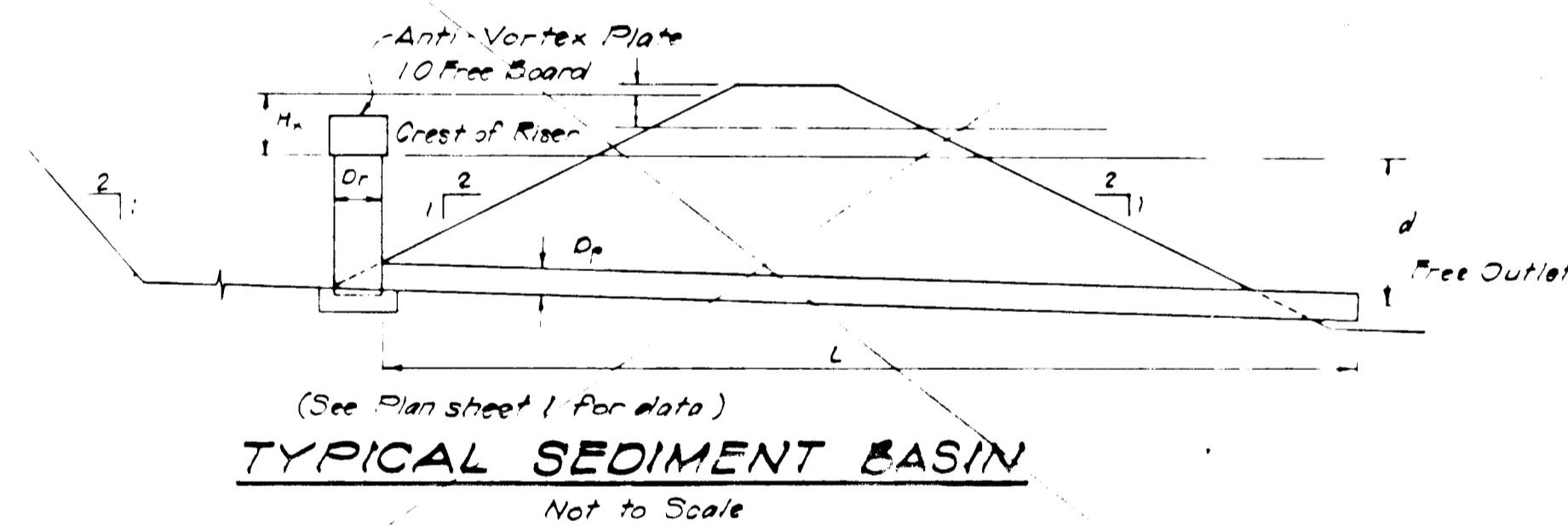
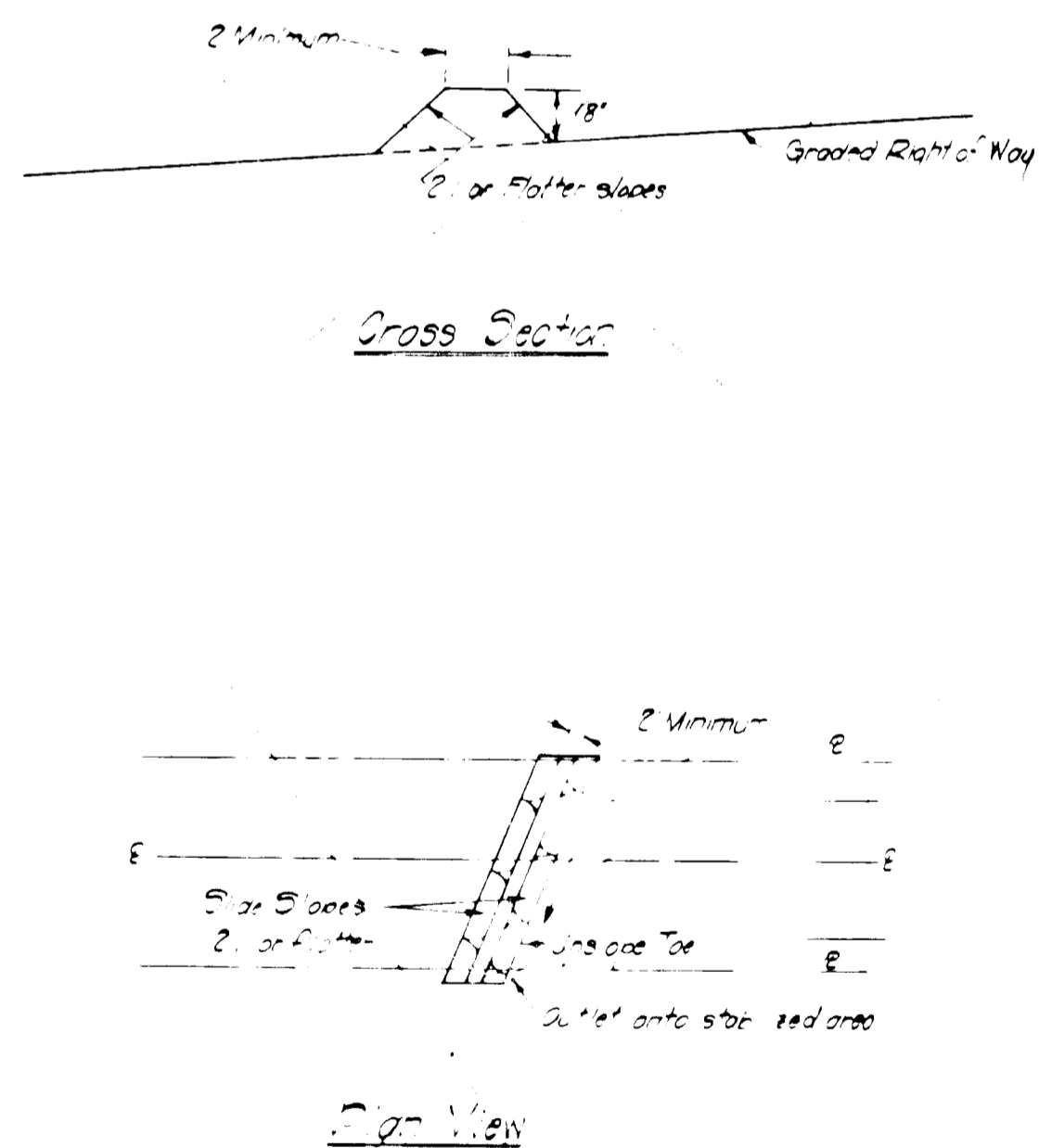
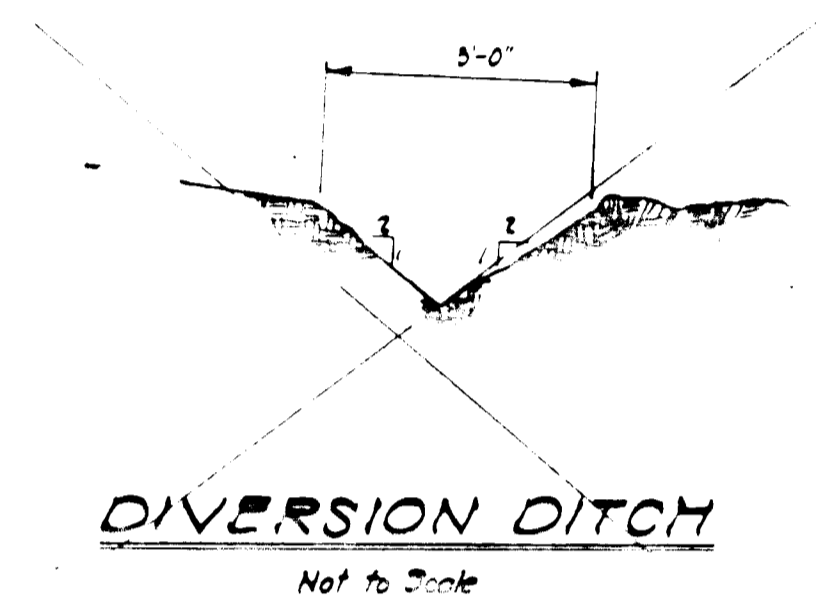
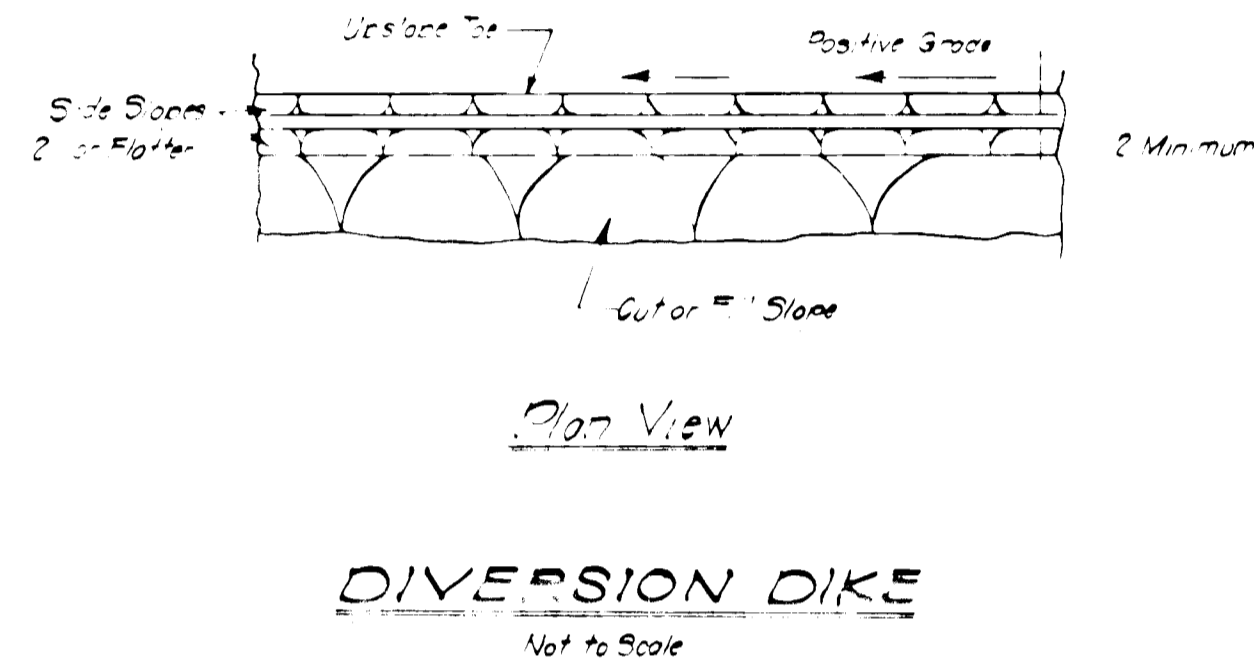
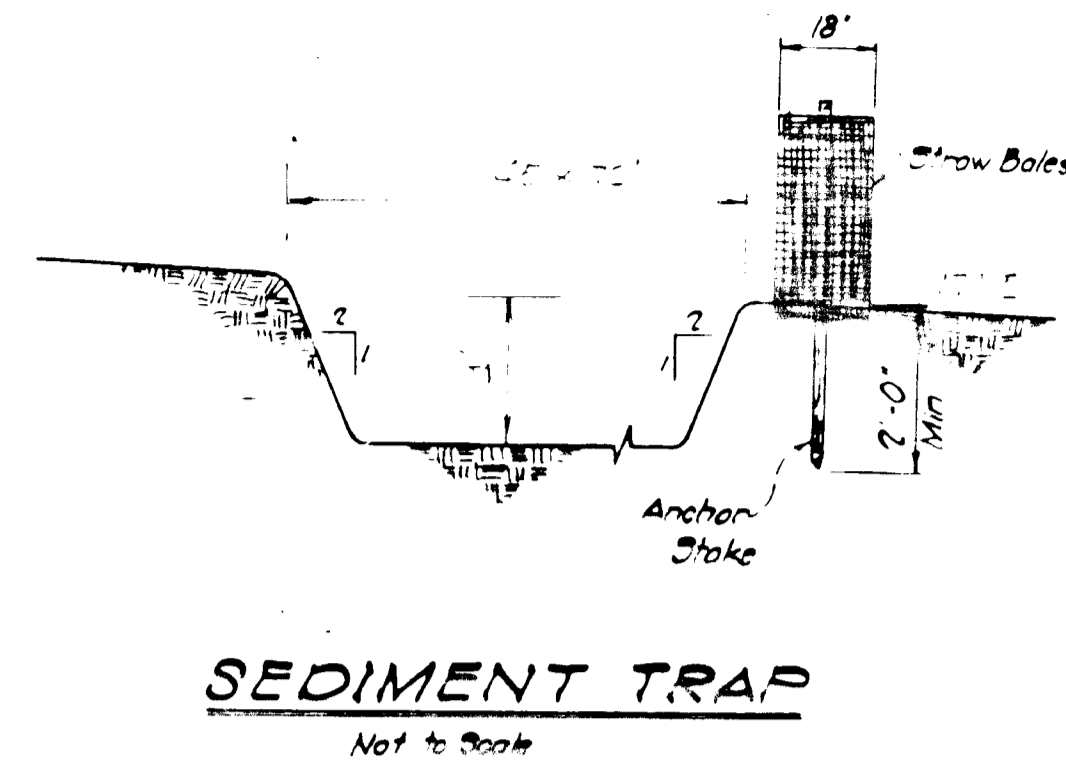
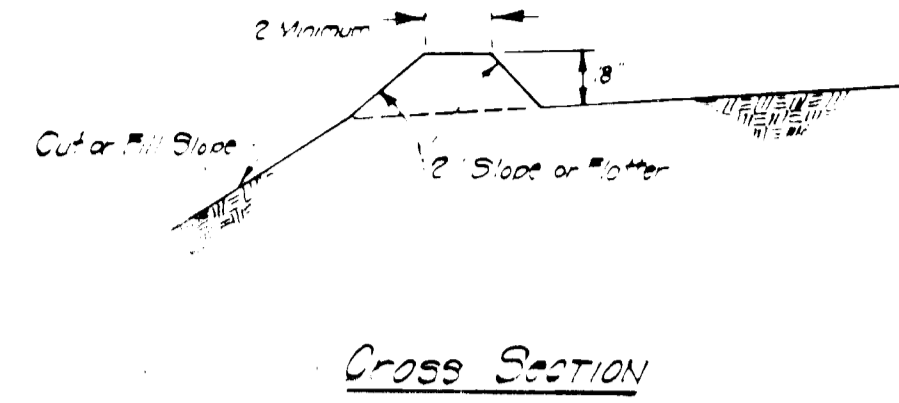

APPROVED FOR PUBLIC WATER AND PUBLIC SEWERAGE SYSTEMS, HOWARD COUNTY HEALTH DEPARTMENT	
COUNTY HEALTH OFFICER	DATE
APPROVED HOWARD COUNTY OFFICE OF PLANNING AND ZONING	
PLANNING DIRECTOR	DATE
CHIEF, DIVISION OF LAND DEVELOPMENT AND TRANSPORTATION PLANNING	DATE
APPROVED FOR PUBLIC WATER, PUBLIC SEWERAGE AND STORM DRAINAGE SYSTEMS AND ROADS	
HOWARD COUNTY DEPARTMENT OF PUBLIC WORKS	DATE
DIRECTOR	DATE
CHIEF BUREAU OF HIGHWAYS	DATE

Reviewed for \_\_\_\_\_ SOD  
and meets Technical Requirements  
Signature \_\_\_\_\_ Date \_\_\_\_\_  
U.S. Soil Conservation Service

**GENERAL NOTES**

- The Sediment Trap will be built prior to all other grading in this site. It will be built and maintained in accordance with the "Standards and Specifications for Soil Erosion and Sediment Control in Urbanizing Areas" Page 3, 200. The Sediment Trap will not be removed until disturbed areas are stable.
- Temporary erosion control devices (dikes, flumes, etc.) shall be placed prior to grading. Diversion dikes shall be placed so as to prevent water flow over the graded fill slopes.
- During the layout of the sediment control devices shown on this plan, field adjustments can and will be made to insure that proper placement has been made to arrest and control any sediment that could leave the construction site.
- Permanent stabilization of all basins will be accomplished within 30 days completion by seeding in accordance with the above ref. "Standards and Spec, s"; Page 3, 400.
- Permanent stabilization of all areas not to be graded or paved to be accomplished by seeding and mulching in accordance with the above ref. "Standards and Spec's" page 3, 100. See Note 21, below.
- All sediment basins and traps will be cleaned out when sediment reaches the clean out level as shown in the design on the sediment control plan.
- Storm drains structure to be blocked until permanent stabilization is completed.
- All completed storm drainage inlets and paved streets will be protected and kept free of any deposits of sediment.
- Any streams of water involved in this project will be constantly protected by berms, dikes or other approved sediment control methods.
- All disturbed areas not planned for or requiring a permanent seeding and to be exposed in excess of 15 days will immediately receive a temporary cover to control surface runoff.
- The developer shall provide safety fencing and post safety signs for all sediment basins and traps within the construction project.
- Written permission will be obtained from adjacent property owners for offsite drainage easements, grading, discharging of storm runoff, and other structures, necessary for the implementation of the sediment control plan.
- All outfalls are to be protected from erosive velocities.
- Public roads and other right of ways will be kept free of sediment deposits left from heavy truck traffic leaving the construction site.
- Immediately after final grades are obtained, all areas to be paved, will be paved within 30 working days.
- The builder will be liable for any sediment damage caused from sediment leaving the site.
- Retaining walls to be constructed prior to grading.
- All sediment control devices will remain in operation until the construction project is fully stabilized and free from sediment runoff.
- Periodic inspection and maintenance of all sediment control structure must be provided to insure intended purpose is accomplished.
- All surface runoff from the construction site will be diverted through planned sediment control devices before it is allowed to leave the site.
- Seeding: Preparation of soil with 23 lbs. per 1000 sq. ft. of 5-10-2 fertilizer or its equivalent and 40 lbs. per 1000 sq. ft. of lime. Harrow or disc fertilizer and lime into the soil to a depth of 2 to 3 inches. Apply seed, 1.37 lbs. per 1000 sq. ft. Kentucky 31, tall fescue. Mulching to be placed immediately after seeding, uniformly with unweathered small grain straw at a rate of 29 to 32 lbs. per 1000 sq. ft.
- The top is to remain on C. B. to allow overflow from sediment trap.
- Contractor installing the above shall obtain and follow the standards and specifications for soil erosion in urbanizing areas as distributed by Howard County's Soil Conservation District, 3051 Balt National Pike, Ellicott City, Md 21043

**DEVELOPER'S CERTIFICATE**  
I, \_\_\_\_\_ certify that all development and/or construction will be done according to this plan of development and plan for erosion and sediment control and I also authorize periodic on-site inspection by the Howard Soil Conservation District or their authorized agents, as are deemed necessary.  
Date 10-30-72  
Signature *Thomas Alfieri*

**SURVEYOR'S CERTIFICATE**  
I, \_\_\_\_\_ certify that this plan for erosion and sediment control represents a practical and workable plan based on my personal knowledge of the site conditions and that it was prepared in accordance with the requirements of the Howard Soil Conservation District.  
Date \_\_\_\_\_  
Signature *William W. Ludlow, Jr.*  
Registered Land Surveyor, Maryland #5691

22. If there's any excess earth mat'l it will be placed in Parcel C-2 & stabilized according to note N#21 within 15 days of placement.

CIVIL ENGINEERS LAND PLANNERS  
**Robert J. Banks & Associates**  
7100 BALTIMORE AVENUE • COLLEGE PARK MARYLAND 20740 • PHONE 776-1160

SOIL CONSERVATION PLAN  
PARCEL C-1  
**MAIER INDUSTRIAL PARK**  
SIXTH ELECTION DISTRICT  
HOWARD COUNTY, MARYLAND

6/15/73

PARCEL C-1  
MAIER INDUSTRIAL PARK  
6TH ELECTION DISTRICT  
HOWARD COUNTY, MD.

**SUPERVISOR'S CERTIFICATE**  
I certify that the plan of development and the plan of control of silt and erosion meets the requirements, standards and specifications of the Howard County Soil Conservation District.

*William W. Luttinger, Jr.*  
William W. Luttinger, Jr. MD 2836

**DEVELOPER'S CERTIFICATE**  
I certify that all development and construction will be done according to this plan of development and plan of silt and erosion control.

CIVIL ENGINEERS - ARCHITECTS - SURVEYORS - PLANNERS

**Robert J. Banks & Associates**

7100 BALTIMORE AVENUE • COLLEGE PARK, MARYLAND 20740 • PHONE 474-1100

DEPT. OF PUBLIC WORKS

*William W. Luttinger, Jr.* 11/16/73  
CHIEF, BUREAU OF HIGHWAYS

OFFICE OF PLANNING & ZONING

*William W. Luttinger, Jr.* 7/19/73  
CHIEF, DIVISION OF LAND DEVELOPMENT AND TRANSPORTATION PLANNING

Owners & Developer  
Howard County Joint Venture  
4700 Annapolis Road, Gaithersburg, Maryland

**PROFILE**

Scale: Hor. 1"=50'  
Vert. 1"=5'

Note: All construction on this project to be in accordance with the Howard County Construction Code & Standard Specifications.

CONCRETE HIGH CRADLE DETAIL  
Not to Scale

STRUCTURE SCHEDULE				
N°	TYPE	TOP ELEV.	UPPER CORNER	REMARKS
106	15" Inlet	178.75	178.75	11" S.R.C. Std. (Single Grate) pg. 750, N.C. 273
107	" "	178.75	178.75	" "
108	" "	170.00	170.00	" "
109	15" Manhole	170.30	170.30	11" S.R.C. Std. pg. 101, Sing. 103
110	15" Inlet	170.00	170.00	11" S.R.C. Std. (Single Grate) pg. 750, N.C. 273

PIPE SCHEDULE		
SIZE	TYPE	LENGTH
15"	Class II	157'
15"	Class I	105'

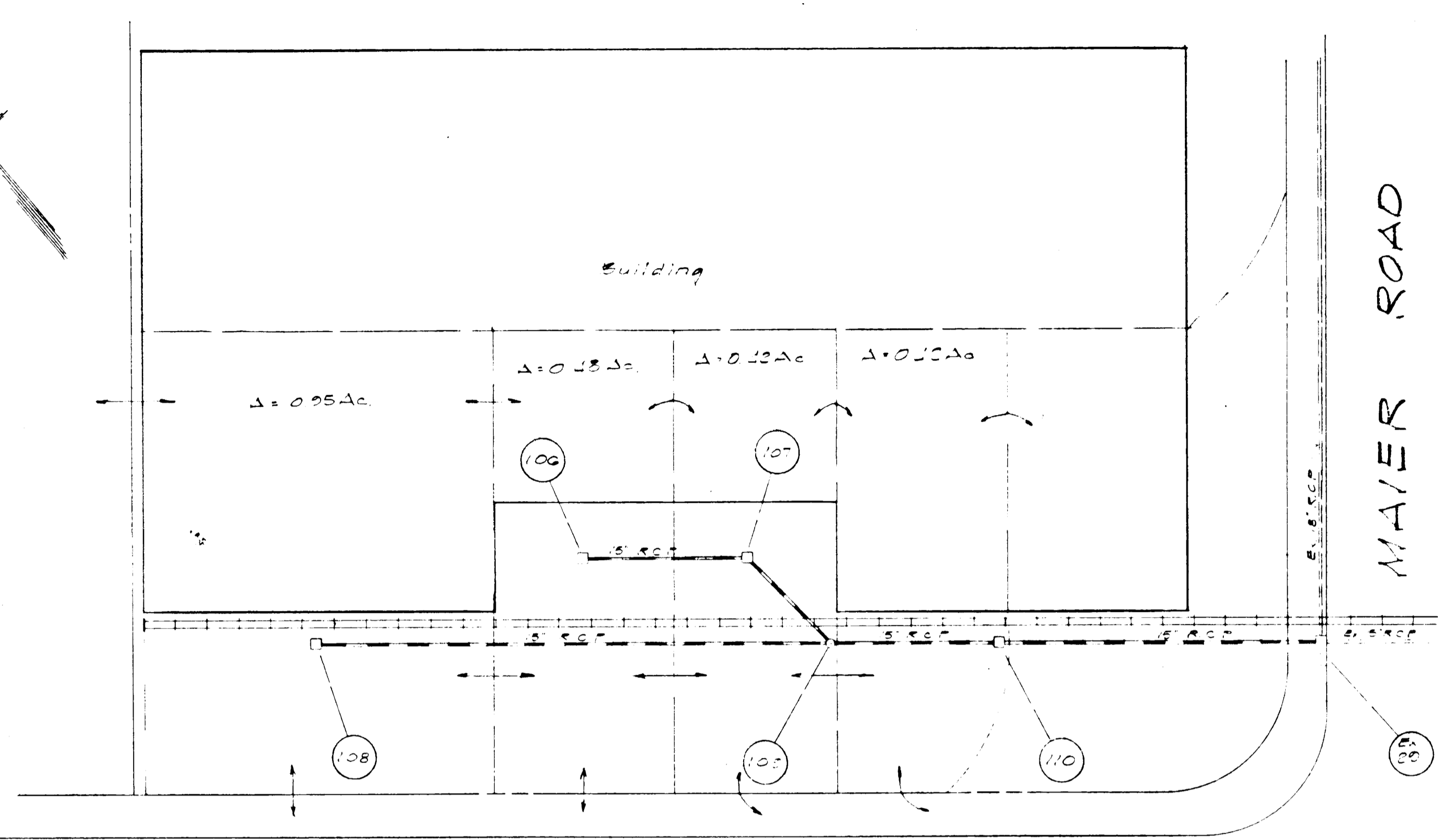

PLAN  
Scale 1"=50'

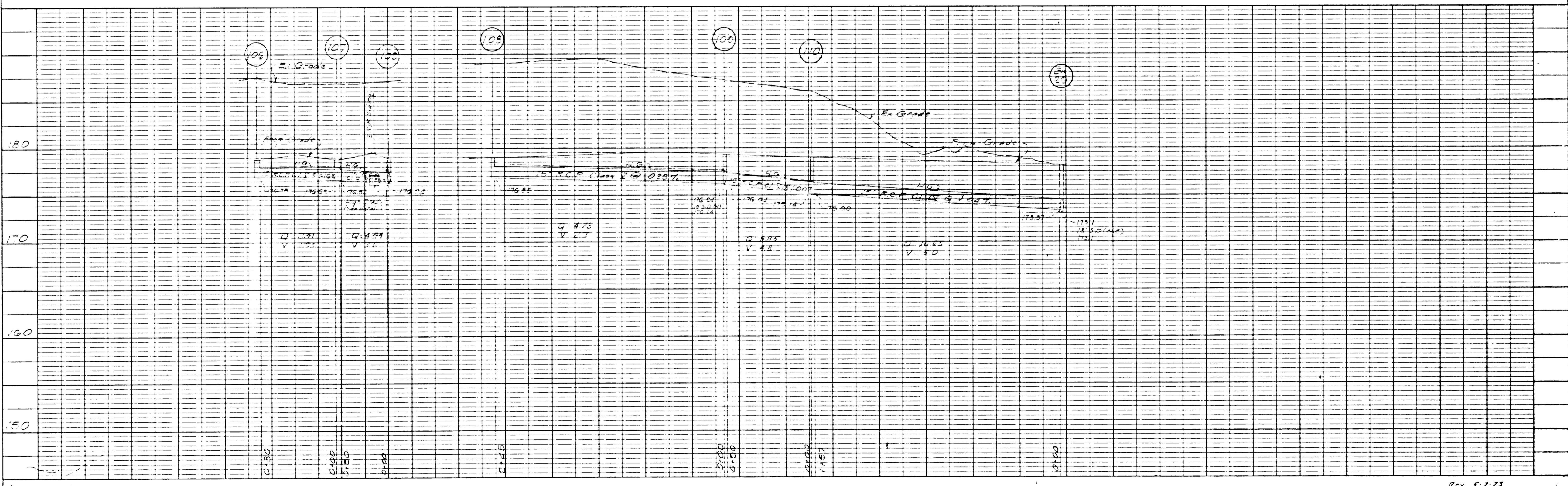

APPROVED FOR PUBLIC WATER AND PUBLIC SEWERAGE SYSTEMS, HOWARD COUNTY HEALTH DEPARTMENT

COUNTY HEALTH OFFICER \_\_\_\_\_ DATE \_\_\_\_\_

APPROVED HOWARD COUNTY OFFICE OF PLANNING AND ZONING

PLANNING DIRECTOR \_\_\_\_\_ DATE \_\_\_\_\_

DIVISION OF LAND DEVELOPMENT AND TRANSPORTATION PLANNING

APPROVED FOR PUBLIC WATER, PUBLIC SEWERAGE AND STORM DRAINAGE SYSTEMS AND ROADS

HOWARD COUNTY DEPARTMENT OF PUBLIC WORKS

DIRECTOR \_\_\_\_\_ DATE \_\_\_\_\_

CHIEF BUREAU OF HIGHWAYS \_\_\_\_\_ DATE \_\_\_\_\_

**PARCEL E**

THIS DEVELOPMENT PLAN IS APPROVED FOR SOIL EROSION AND SEDIMENT CONTROL BY THE HOWARD SOIL CONSERVATION DISTRICT.

Approved [Signature] Date 2/9/73  
Howard S.C.D.

Sediment Trap  
Area Disturbed = 6.5 Ac.  
67 cu/AC = 448 CU required  
Avg size trap = 4' x 45' x 18" @ 60 cu  
Top = 166.8'  
Cleanout 165.7'

Reviewed for Howard S.C.D. and State Technical Requirements

Signature \_\_\_\_\_ Date \_\_\_\_\_

U.S. Soil Conservation Service

**NOTE**

1. Datum: W.S.S.C.
2. Contour Interval: 2'
3. Existing Elev shown Mus 11001
4. Prop Elev shown this: 502
5. The existing & proposed utilities Whitman, Regardie & Assoc. 1304 St. Paul Street Baltimore Maryland Contract No 582-W-5. Howard County Dept of Public Works
6. CB designated Catch Basin

Owner: ECH's Master, Inc.  
5700 Annapolis Rd.  
Baltimore, Md.  
No 7-3506

FURTHER VERIFICATION

I hereby certify that this plan for erosion and sediment control represents a practical and workable plan based on my personal knowledge of the site conditions and that I have prepared it in accordance with the requirements of the Howard Soil Conservation District.

10/20/72 [Signature]

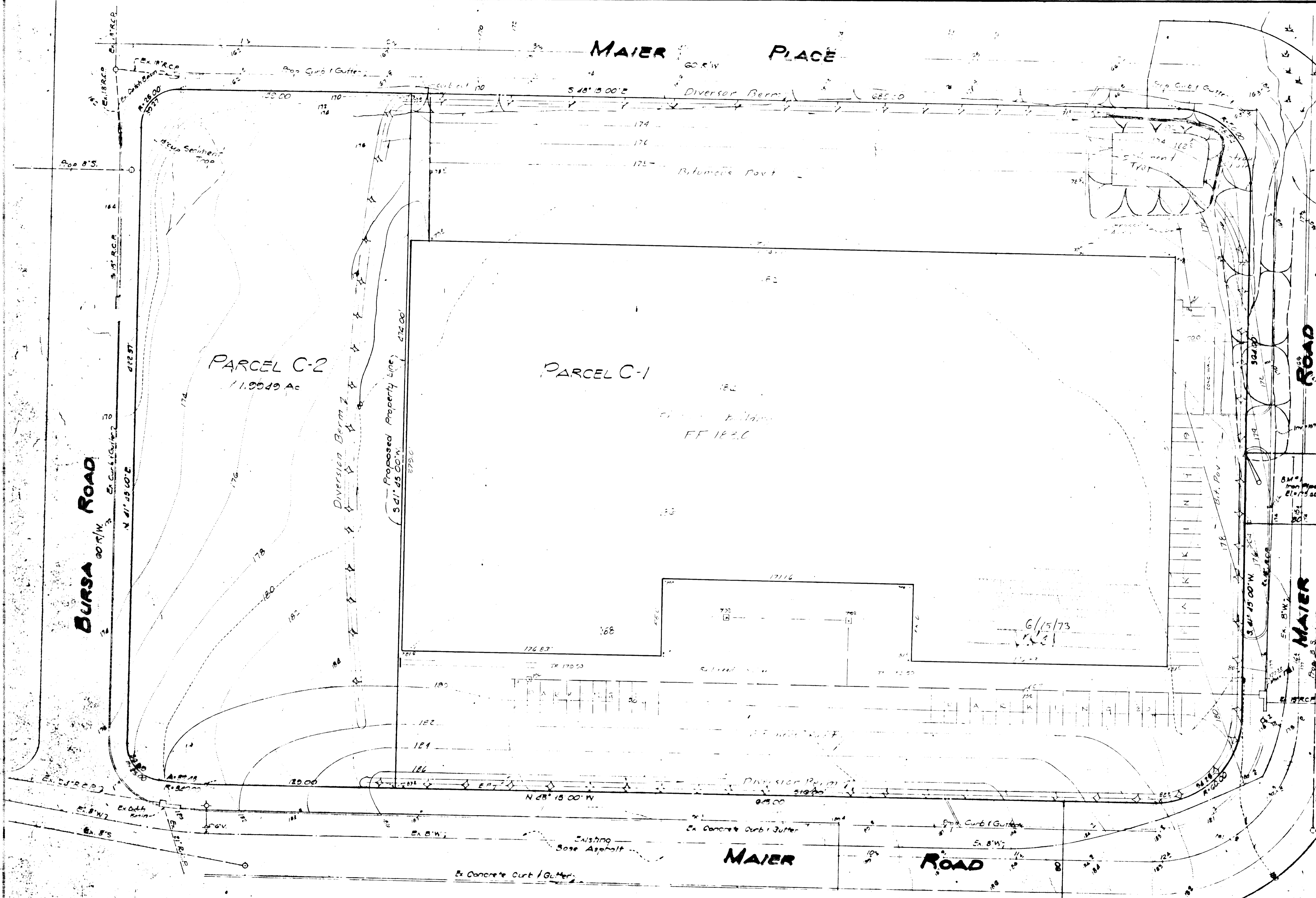

10-30-72 [Signature]

NOTE: Total Area = 8.2326 Ac.

PLAN  
SCALE 1/4" = 1'-00"

Site Plan done by Karel B. Philippe AIA, J. Philip, N.C.  
Revision 2/12/73 Revised FF Elevation and Spot Elevation of Building.

CIVIL ENGINEERS • LAND PLANNERS

**Robert J. Banks & Associates**

7100 BALTIMORE AVENUE • COLLEGE PARK, MARYLAND 20740 • PHONE 778-1180

[Signature]

SOIL CONSERVATION PLAN  
PARCEL C  
**MAIER INDUSTRIAL PARK**  
SIXTH ELECTION DISTRICT  
HOWARD COUNTY, MARYLAND