

REVIEWED FOR 1000 S.C.D.
 AND MEETS TECHNICAL REQUIREMENTS
C. J. N. O. J. 9/20/73
 SIGNATURE DATE
 U.S. SOIL CONSERVATION SERVICE

THIS DEVELOPMENT PLAN IS APPROVED FOR
 SOIL EROSION AND SEDIMENT CONTROL BY THE
 HOWARD SOIL CONSERVATION DISTRICT
 APPROVED: Robert W. Zuehlke 7/26/73
 HOWARD S.C.D. DATE

APPROVED
 DIVISION OF LAND DEVELOPMENT
 AND TRANSPORTATION PLANNING
 HOWARD COUNTY, MARYLAND
 DATE 7/26/73

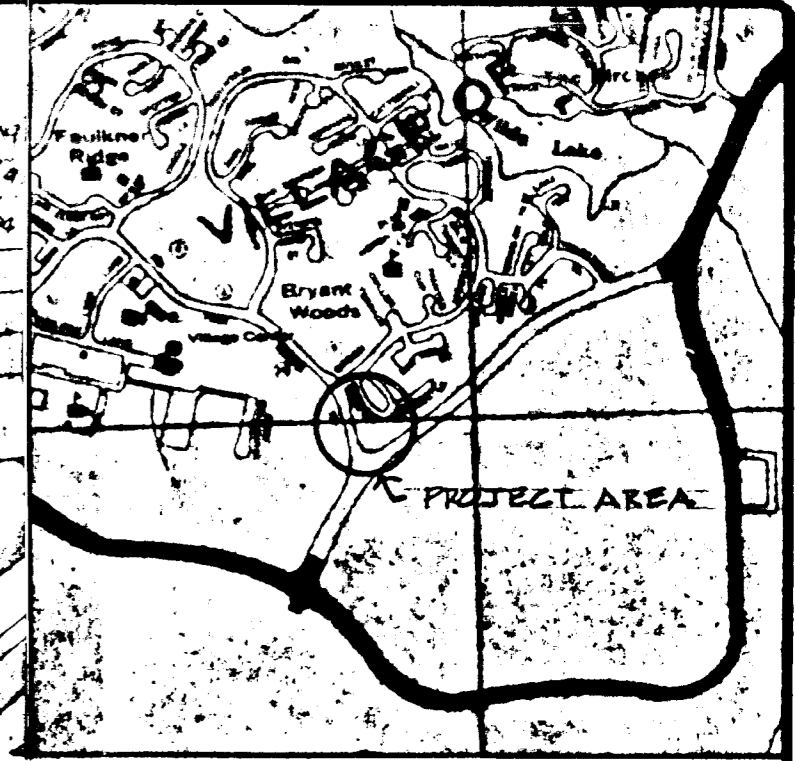
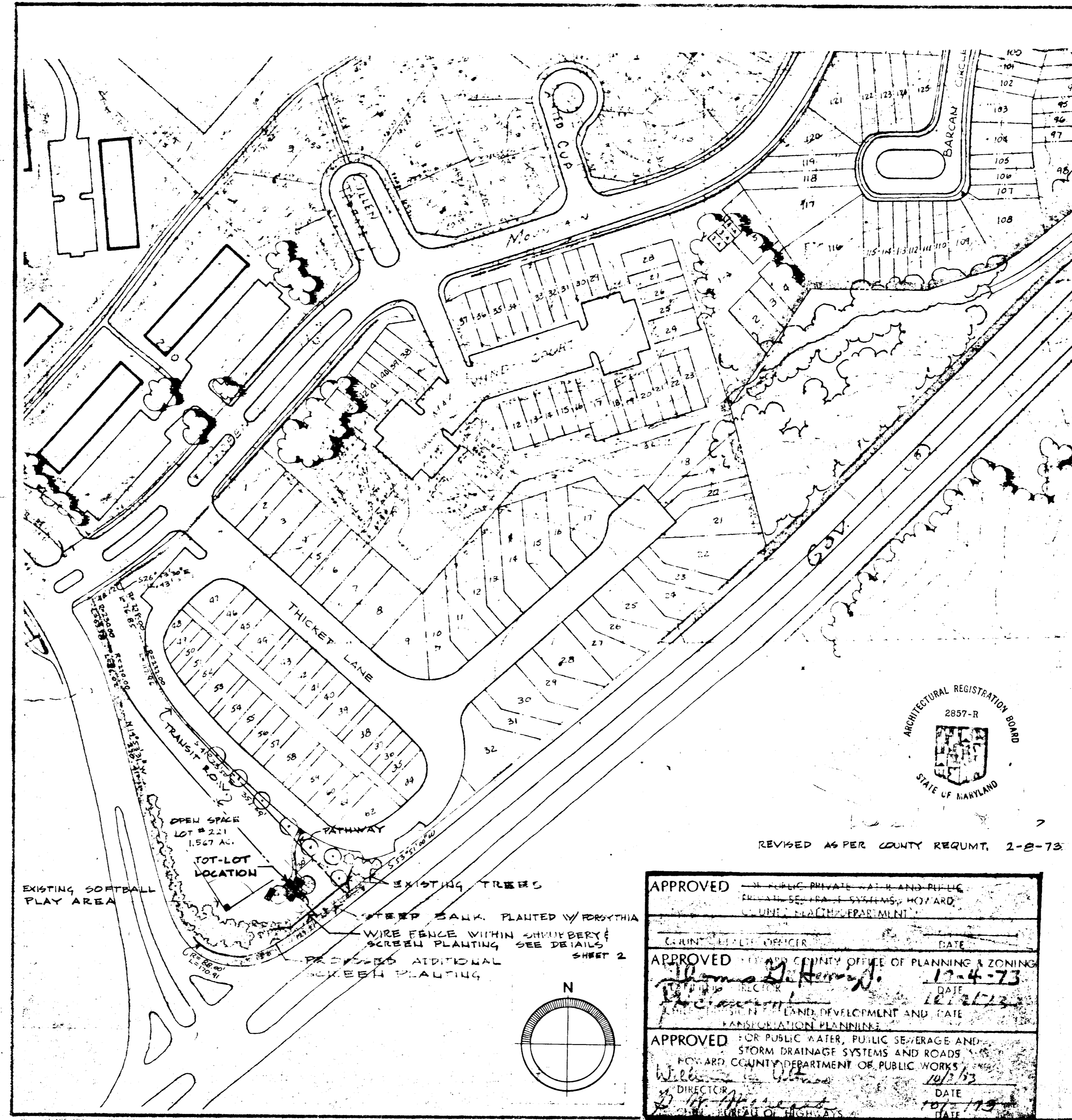

VICINITY MAP
 1" = 1600' APPROX.

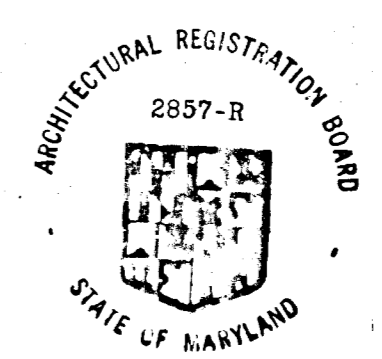

REVISED AS PER COUNTY REQUMT. 2-8-73

APPROVED FOR PUBLIC PRIVATE WATER AND PUBLIC STORM DRAINAGE SYSTEMS, HIGHWAYS, AND PUBLIC UTILITIES DEPARTMENT

APPROVED FOR THE COUNTY OFFICE OF PLANNING & ZONING
Thomas D. Henoff DIRECTOR 12-4-73
 DATE 12/2/73

APPROVED FOR PUBLIC WATER, PUBLIC SEWERAGE AND STORM DRAINAGE SYSTEMS AND ROADS
 HOWARD COUNTY DEPARTMENT OF PUBLIC WORKS
William J. ... DIRECTOR 7/2/73
 DATE 7/2/73

COLUMBIA MARYLAND
THE ROUSE COMPANY
 COLUMBIA, MARYLAND 21042

PROJECT TITLE
 WILDE LAKE VILLAGE - HOLLOW OAKS TOT LOT

SUBJECT:
 SITE DEVELOPMENT PLAN

SCALE	1" = 120'	DWG. NO.	
DATE	11-2-72		
DES. BY	W.T.		1
DWN. BY	W.T.		
CK. BY			OF 2
APP. BY			CF NO.

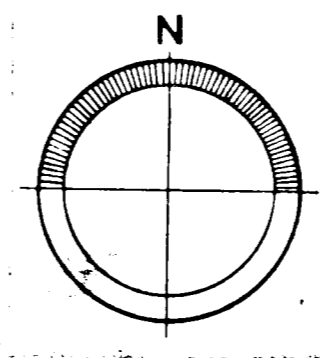

APPROVED
 DIVISION OF LAND DEVELOPMENT
 AND TRANSPORTATION PLANNING
 HOWARD COUNTY, MARYLAND
 DATE 11-2-72

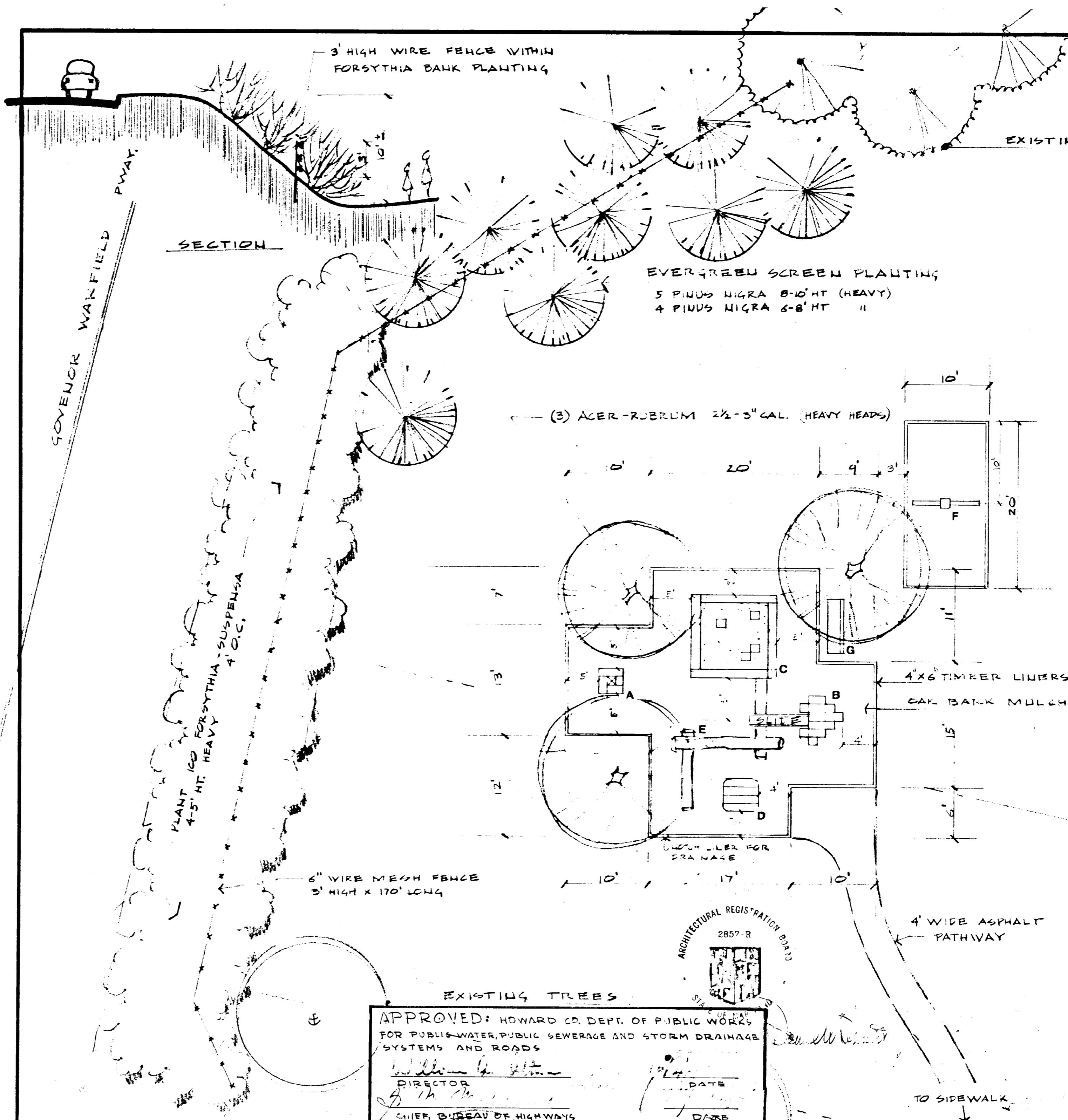

REVISION AND DISTRIBUTION RECORD			
NO.	DATE	PR.	DISTRIBUTION
1	2-8-73		AS PER COUNTY REQUIREMENT ADD FENCE & PATH EXISTING EVERGREENS

- EQUIPMENT**
 (SEE TOP LOT STANDARDS DETAILS)
- A CLIMBING SCULPTURE #TF 510
 - B STEPPING COLUMNS #TF 411
 - C SAND BOX #117
 - D SPRING PAD #TF 900
 - E BALANCE LOGS
 - F T TYPE SWING #116
W/ BUCKET SEATS #259-122
 - G PARK BENCH

- Notes:
1. Top Lot layout is to be approved in the field by the Landscape Architect prior to construction.
 2. Grading - contractor is to provide positive drainage away from all existing and proposed structures. 4"x6" liners are to be back filled with top soil to meet grade.
 3. Notch liners as shown to allow for drainage.
 4. All disturbed areas are to be re-seeded in accordance with the "T.R.C. Columbia Planting Specifications," Latest Edition.
 5. All planting to be in accordance with the "T.R.C. Columbia Planting Specifications," Latest Edition.
- Location of all plant material to be approved by the Landscape Architect prior to installation.

COLUMBIA
 MARYLAND

THE ROUSE COMPANY
 THE VILLAGE OF CROSS KEYS, BALTIMORE, MD. 21218

PROJECT TITLE:
 WILDE LAKE VILLAGE - HOLLOW CARS TOP-LOT

SUBJECT:
 LAYOUT & DETAILS

SCALE	1/8" = 1'	DWG. NO.	2
DATE	11-2-72		
DES. BY	WT		
DWN. BY	WT		
CK. BY		OF 2	
APP. BY		CCF NO.	

APPROVED: HOWARD CO. DEPT. OF PUBLIC WORKS
 FOR PUBLIC WATER, PUBLIC SEWERAGE AND STORM DRAINAGE
 SYSTEMS AND ROADS

[Signature]
 DIRECTOR

[Signature]
 CHIEF, BUREAU OF HIGHWAYS

DATE _____

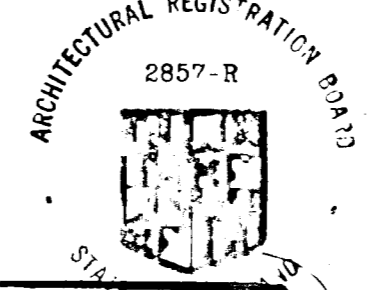

SAP 93-58C