

GENERAL NOTES

- Total Area: 24.85 Acres ±
- Zoned: M-1
- Use: Truck Terminal
- Total Number of Employees: 120
- Number of parking spaces required @ 1 space/2 employees: 60
- Number of parking spaces provided: 100 (All spaces 10' x 20')
- Except where otherwise noted all construction materials and details shall be in accordance with the latest revisions of the Howard County Road Construction Code and Standard Specifications.
- Public water and sanitary sewer facilities are to be provided.
- Proposed grades contours represent finished grades, contractor shall make allowances to subgrade for topsoil, paving and other surface finishes as required.
- Locate on existing utilities is approximate only and is obtained from recorded drawings. Contractor shall notify all utility companies involved and locate all existing utilities to his own satisfaction before any connections are made.
- See architectural drawings for building dimensions.
- Contours & elevations are controls only. All grading is to be smooth and continuous.
- Report discrepancies to the engineer immediately.
- See drawing 2 for details and storm drain profiles.
- All existing buildings, sheds, & fences on site shall be removed.
- Minimum building set back restrictions from property lines and the R/W line of any public road or street to be in accordance with Howard County Zoning Regulations.
- All on site roads and parking facilities shall be privately owned.
- Limits of work for excavation, grading, seeding and mulching shall be represented by undisturbed contours.
- Water and sewer layout shown on this plan is schematic only.
- Widening Paving:
 - Asphalt paving shall consist of 7" Crusher Run Base Course, 5" Bituminous Concrete Binder Course and 1 1/2" Bituminous Concrete Surface Course Band C-3.
 - 9" Crusher Run Base Course in two courses, 3" Bituminous Concrete Binder Course Band C-2 and 1 1/2" Bituminous Concrete Surface Course Band C-3.

- Base will be primed in accordance with C-30-3 as provided in the Howard County Road Construction Code and Standard Specifications.
- Tack Coat is required in accordance with Section C-31-4 of the Howard County Road Construction Code and Standard Specifications.
- Grade at inlets 1-1 thru 1-9 and 1-12, 1-13, 1-14 to provide positive flow to the inlets.

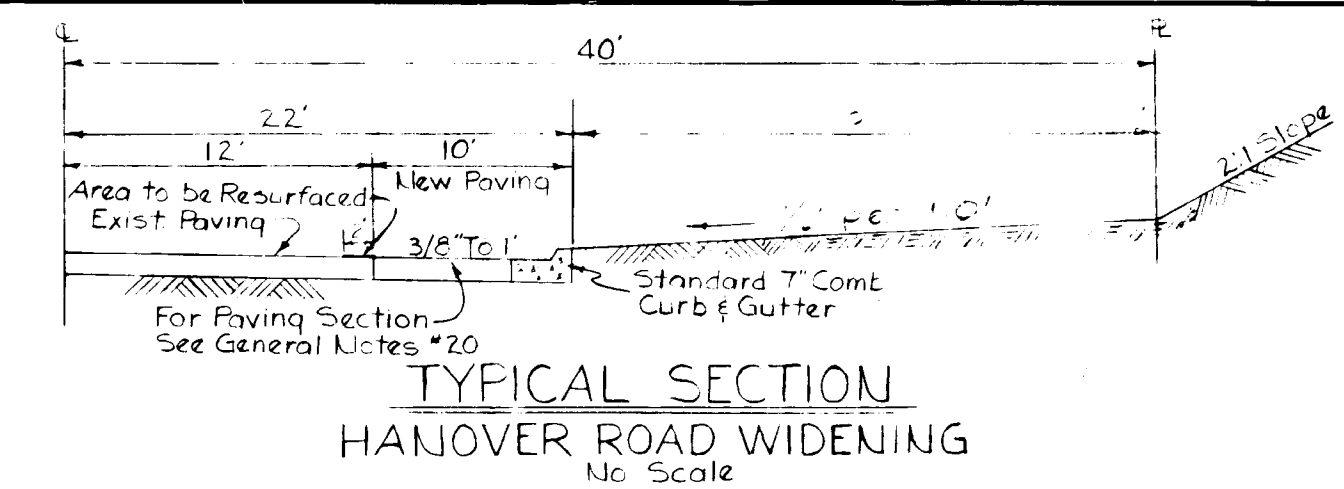
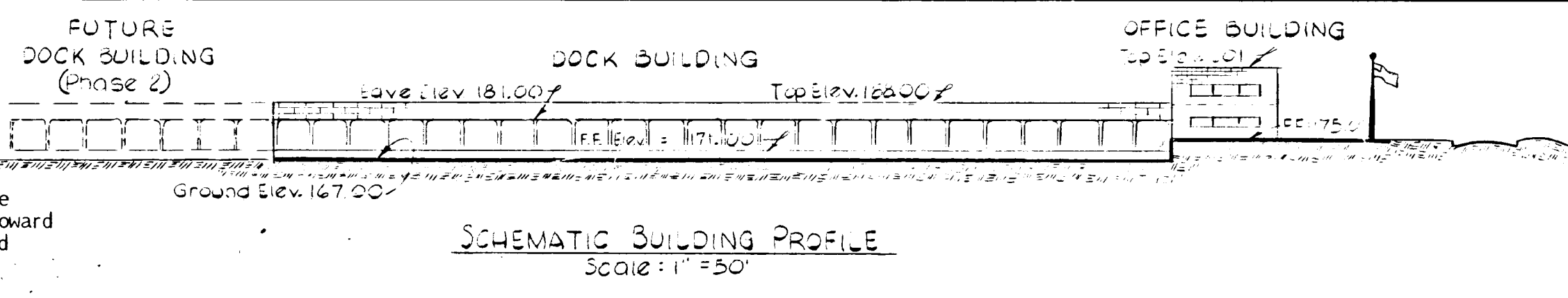

- SEDIMENT CONTROL NOTES
- All areas disturbed by grading or contractor's operations not being paved shall be topsoiled, seeded and mulched immediately following earthwork operations in accordance with the following:
 - Place 3" (inch) compacted layer of topsoil to finished grade.
 - Spread pulverized dolomitic limestone at the rate of 10 lbs./acre.
 - Spread commercial grade fertilizer at the rate of 10 lbs./acre and immediately disc into topsoil to a depth of 3 inches.
 - Seed prepared areas at the rate of 180 lbs./acre using Kentucky 31 Fescue and 20 lbs./acre Annual Ryegrass.
 - Mulch all areas immediately after seeding with unweathered small grain straw or hay at the rate of 1.5 tons/acre; spray mulch with emulsified asphalt at the rate of 0.24 gals./sq. yd.
 - No slopes steeper than 2:1 shall be created.
 - All slopes steeper than 3:1 shall be stabilized as follows:
 - Place 3" (inch) compacted layer of topsoil to finished grade.
 - Spread pulverized dolomitic limestone at the rate of 10 lbs./acre.
 - Spread 5-10-10 commercial grade fertilizer at the rate of 30 to 50 lbs./1000 sq. ft. and immediately disc into topsoil to a depth of 3 inches.
 - Apply straw mulch at the rate of 150 lbs./1000 sq. ft. together with plastic netting and staples.
 - Plant through the mulch with Halls Japanese Honey Suckle spaced 12 inches on centers.
 - Water as needed if it does not rain during establishment period.

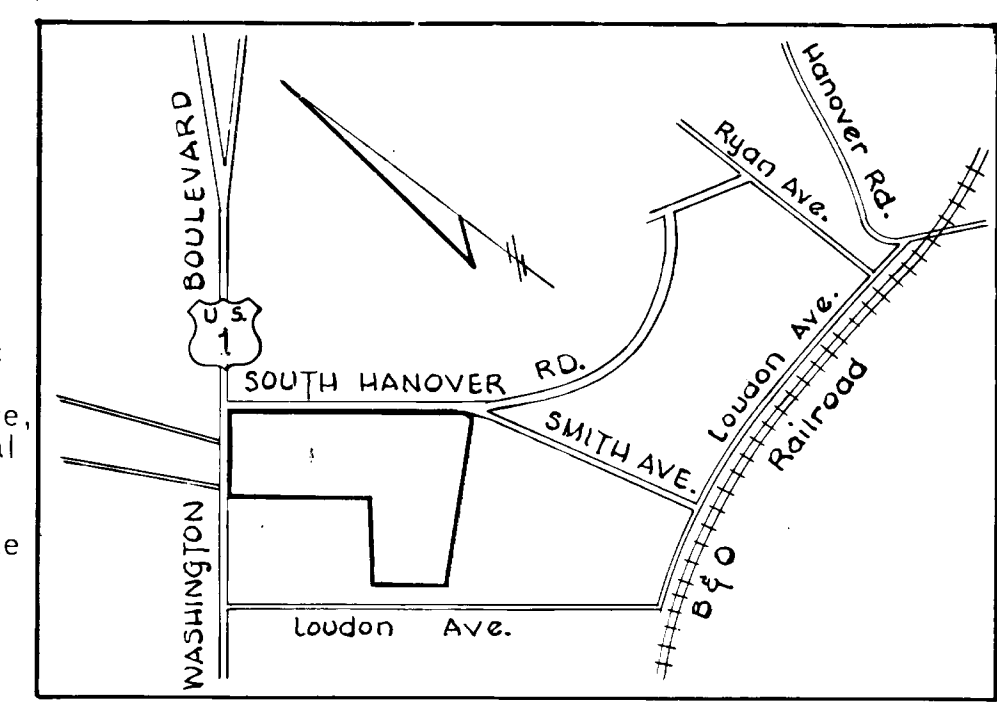

HARWOOD PARK J.H.O. 40/115



UNDERGROUND STORAGE TANKS

No.	CONTENTS	CAPACITY	SIZE
1	Antifreeze	250 gal.	8' x 3'
2	Diesel Fuel	12' x 35'	
3	Bulk Oil	8,000 gal.	7' x 30'
4	Fuel Oil	3,000 gal.	5' x 25'
5	Waste Oil	6,000 gal.	6' x 30'
6	Gas	8,000 gal.	7' x 30'

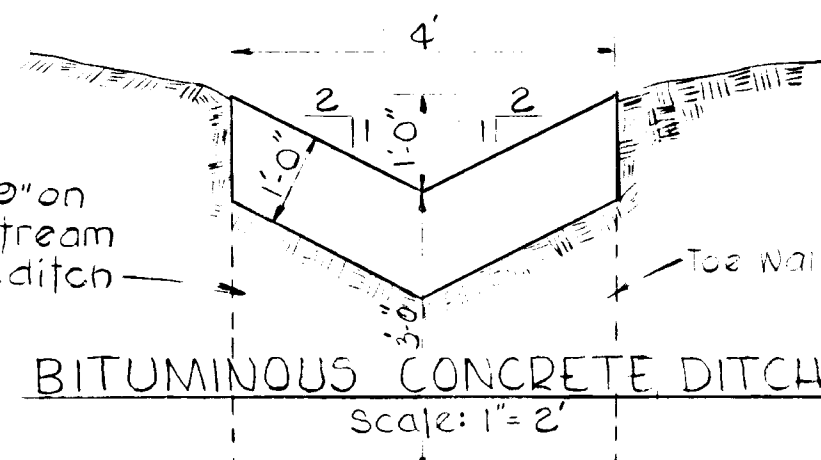

Approved: for public water and public sewerage systems
Howard County Health Department.
W. A. Act 10-5-72 Date
County Health Officer
Approved: Howard County Office of Planning and Zoning
Thomas A. Hunsicker 10-10-72 Date
Planning Director
W. P. ... 10/1/72 Date
Chief, Division of Land Development
Approved: for public water, public sewerage, storm drainage systems and public roads.
Howard County Department of Public Works.
William A. Act 10/2/72 Date
Director
W. P. ... 10/2/72 Date
Chief, Bureau of Highways

SITE DEVELOPMENT PLAN
OVERNITE TRANSPORTATION COMPANY
BALTIMORE TERMINAL
ELECTION DISTRICT - ELKRIDGE NO.1
HOWARD COUNTY - MARYLAND
SCALE: AS SHOWN - JUNE 1, 1972

- LEGEND
- Contours:
 - Existing --- 15' (2' interval)
 - Proposed --- (1" & 2" interval as required)
 - Existing Sanitary
 - Existing water
 - Proposed Storm Drains
 - Fence (All to be 6' High Chain Link with barbed wire guard except as noted)
 - Light Pole (#D denotes Double Light)
 - Concrete Paving
 - Bituminous Concrete Paving Section
 - On Site Paving:
 - Asphalt paving shall consist of 7" Crusher Run Base Course, 5" Bituminous Concrete Binder Course, Band C-2, and 1 1/2" Bituminous Concrete Surface Course, Band C-3.
 - Concrete paving shall consist of 9" 3000 lbs. concrete reinforced with 6-6" x 6" W4 welded wire fabric on center line.

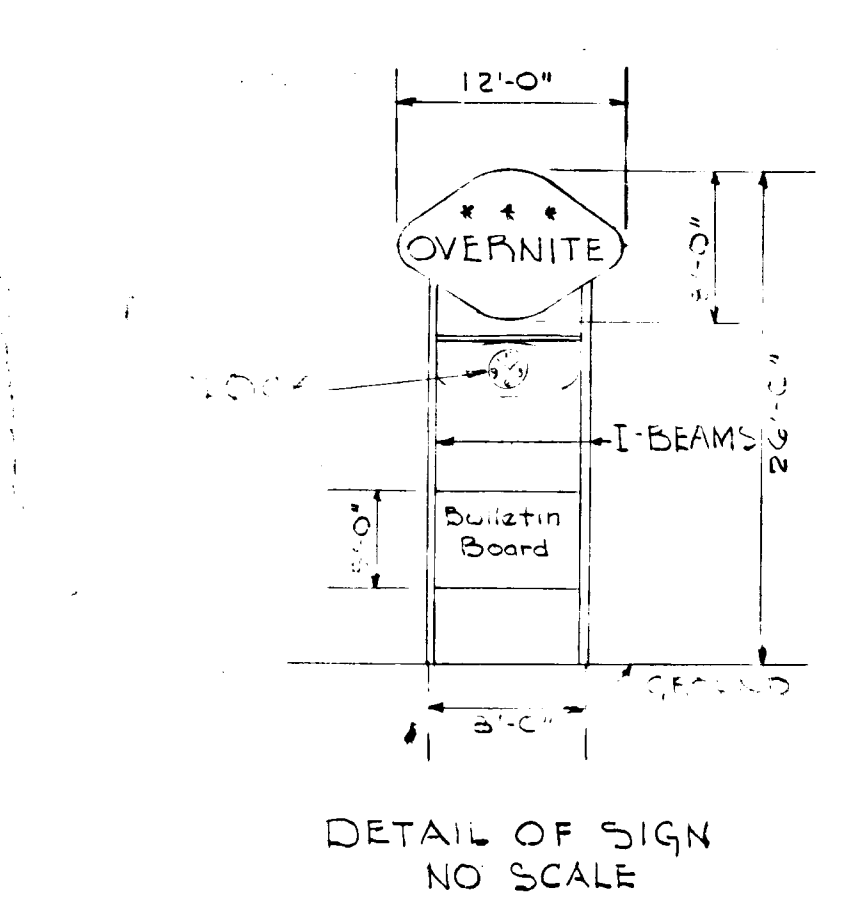

OWNER & DEVELOPER
OVERNITE TRANSPORTATION CO.
P.O. Box 1216
Richmond, Virginia 23209

PREPARED BY
PURDUM & JESCHKE
CONSULTING ENGINEERS
AND LAND SURVEYORS
1023 N. CALVERT STREET
BALTIMORE, MARYLAND

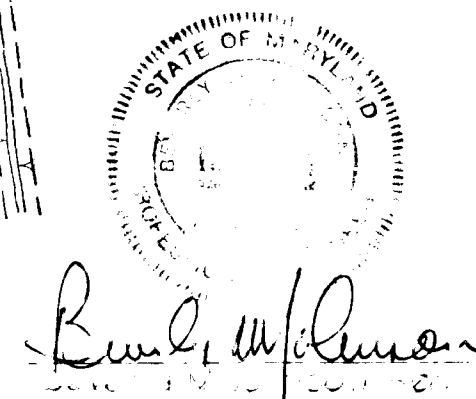

PLAN
SCALE: 1" = 50'

APPROVED
DIVISION OF LAND DEVELOPMENT
AND TRANSPORTATION PLANNING
HOWARD COUNTY, MARYLAND
DATE SEP 28 1972

WASHINGTON BOULEVARD

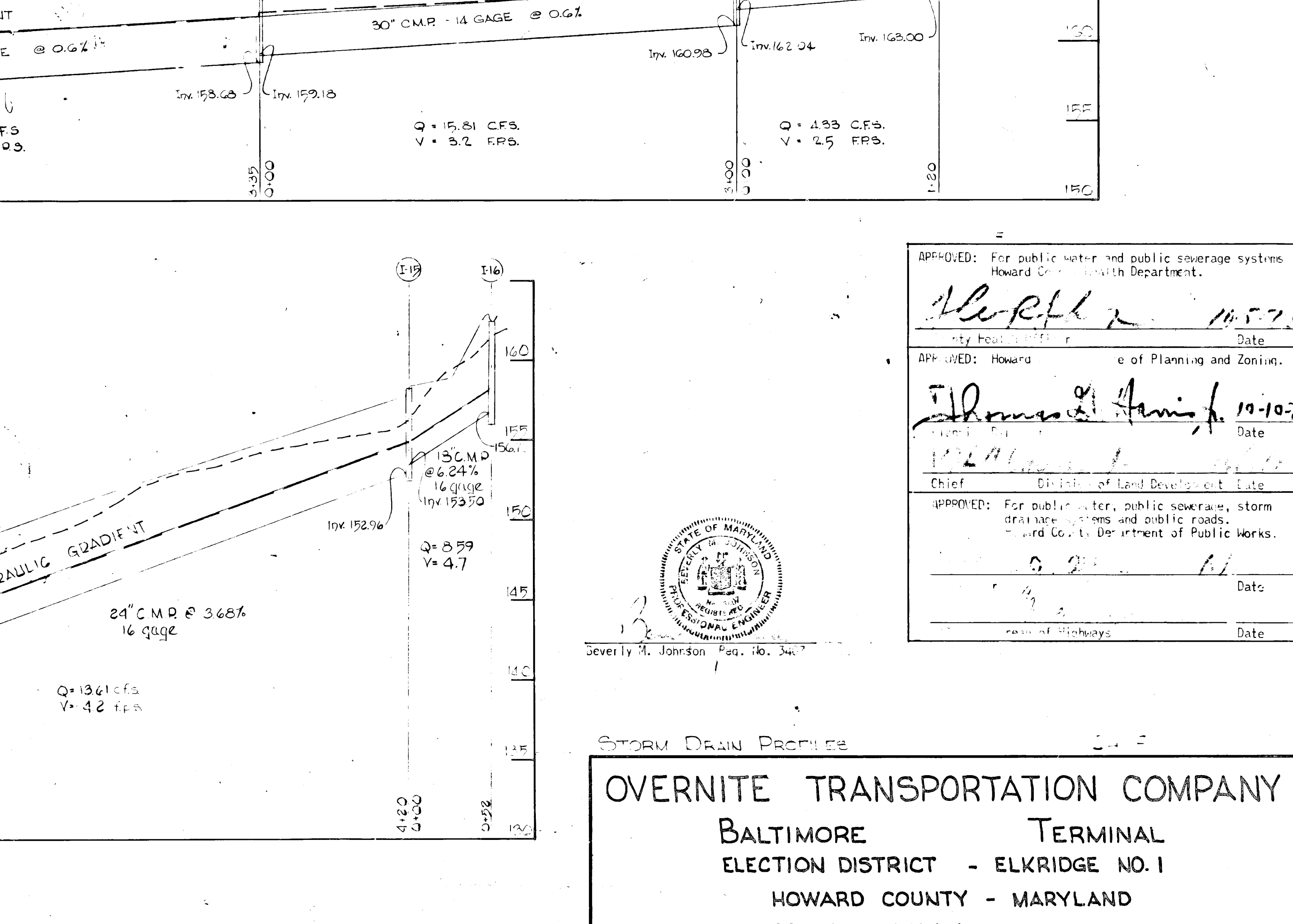
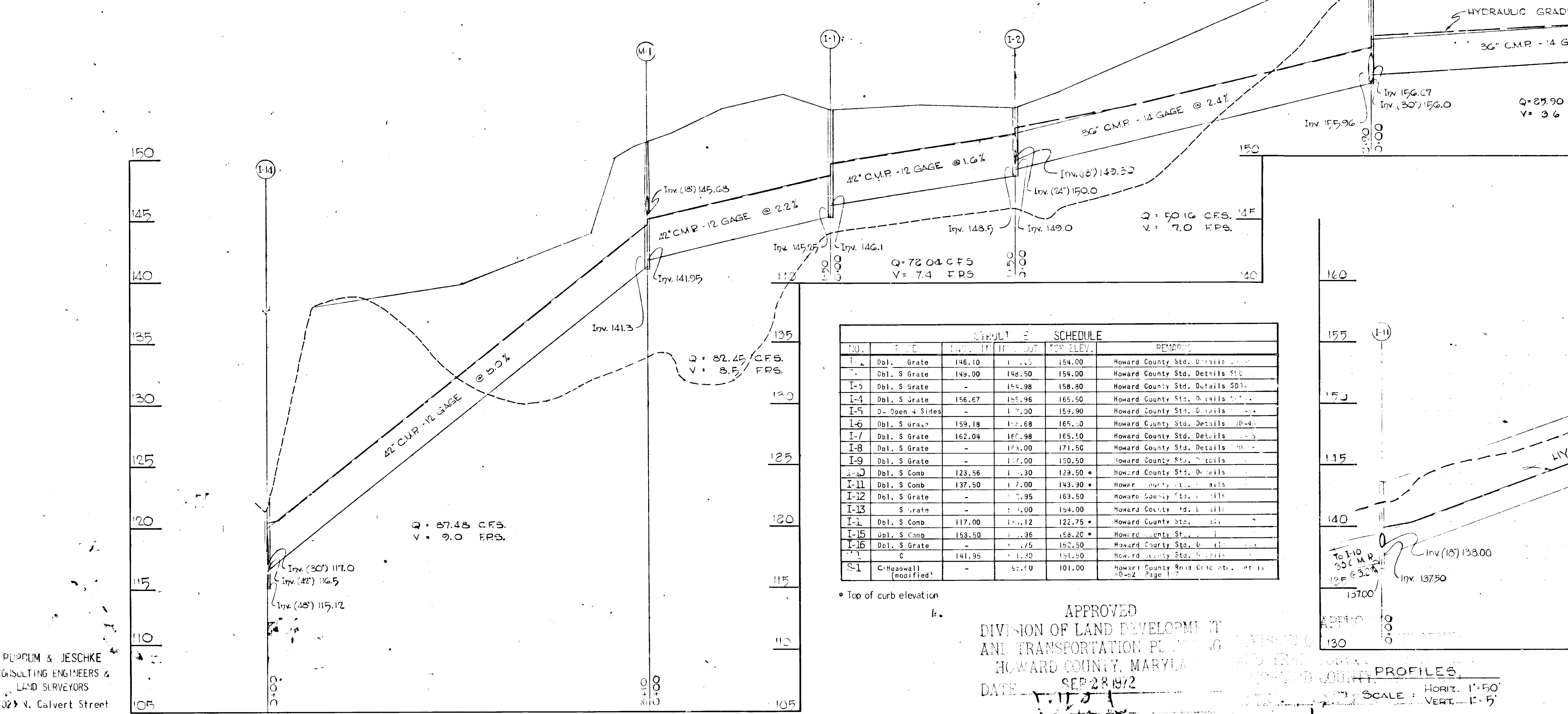
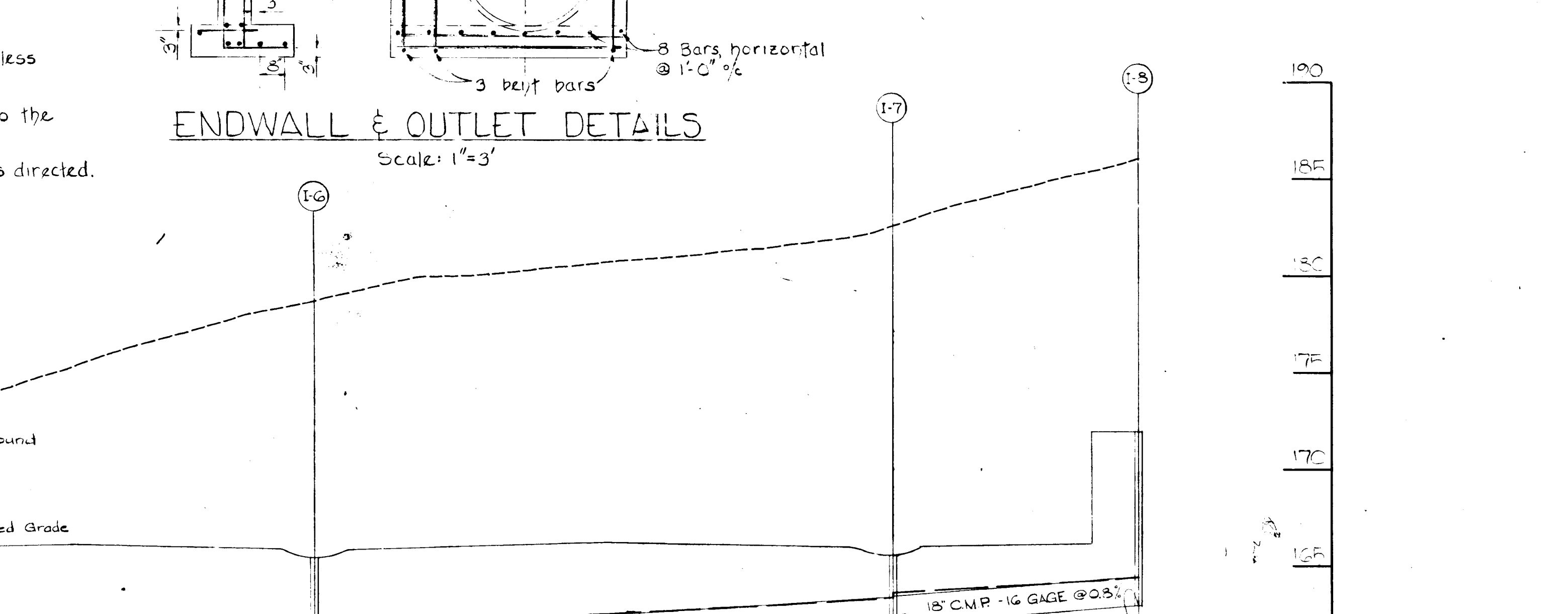
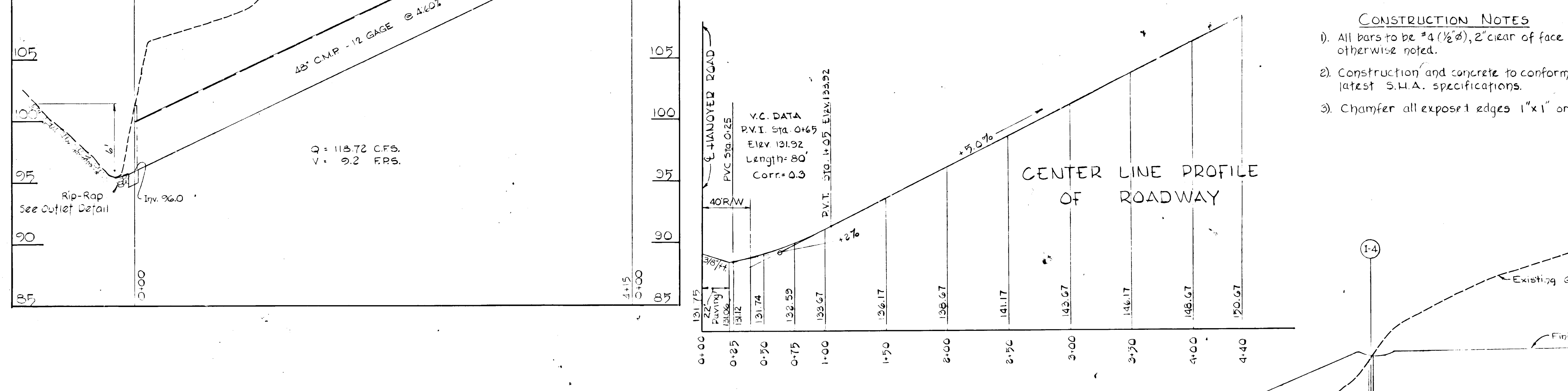
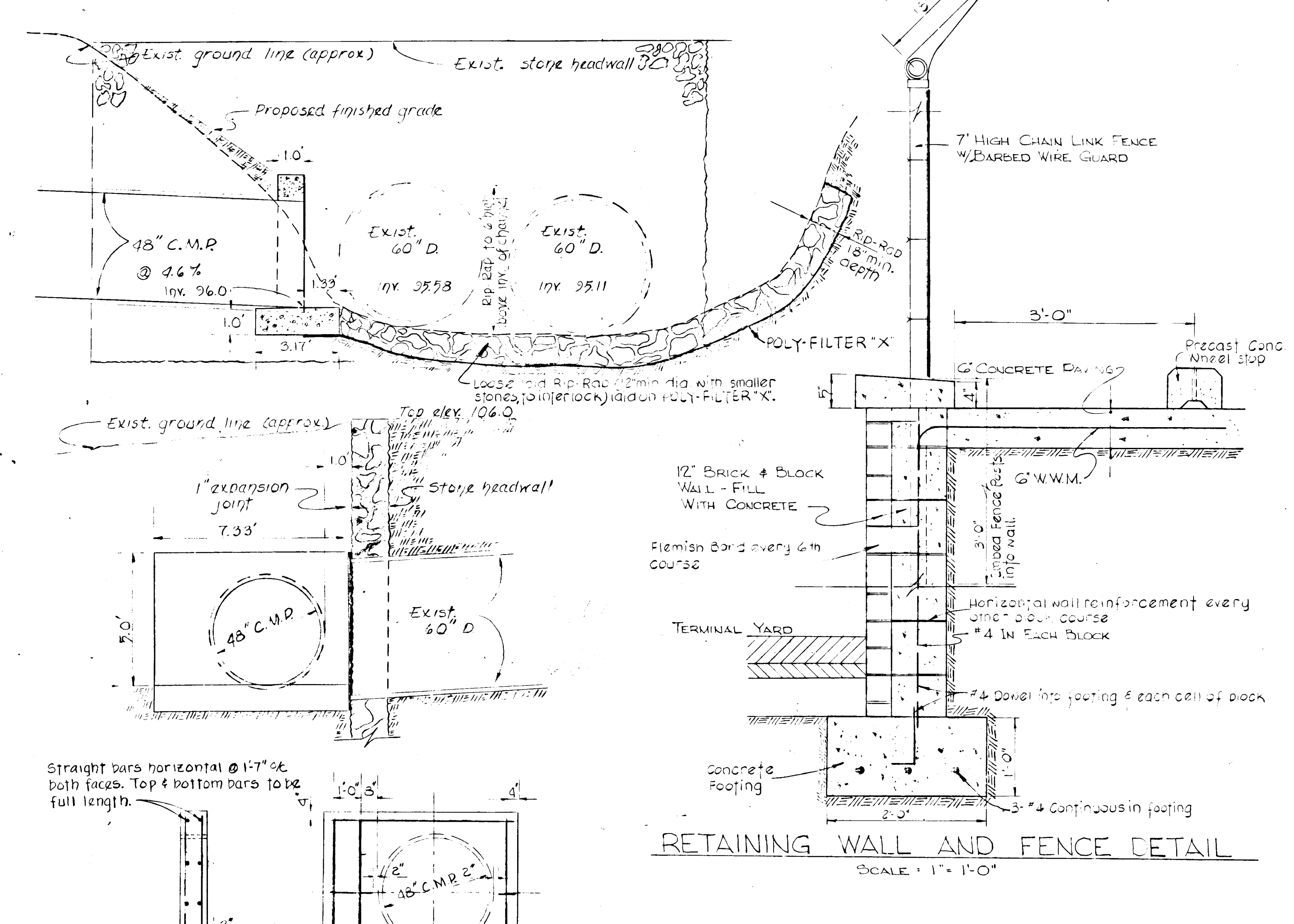
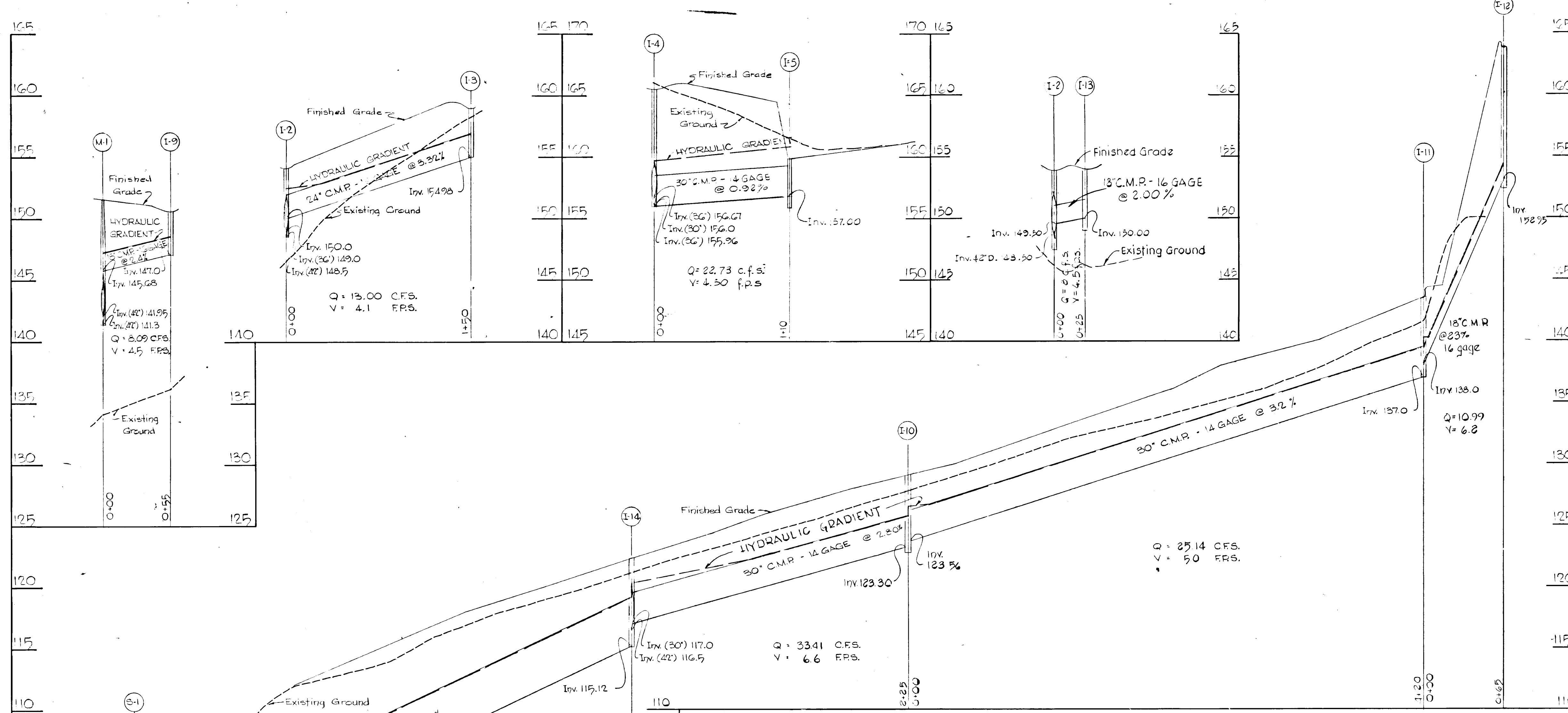

NO.	TYPE	INVERT	OUTLET	TOP ELEV.	REMARKS
1-4	Dbl. S. Grate	146.10	146.50	154.00	Howard County Std. Details 515
1-5	Dbl. S. Grate	146.90	148.50	154.00	Howard County Std. Details 515
1-6	Dbl. S. Grate	144.98	148.80	158.80	Howard County Std. Details 515
1-7	Dbl. S. Grate	146.67	148.98	155.50	Howard County Std. Details 515
1-8	Dbl. S. Grate	147.00	149.00	153.00	Howard County Std. Details 515
1-9	Dbl. S. Grate	148.18	149.69	165.00	Howard County Std. Details 515
1-10	Dbl. S. Grate	142.04	147.98	165.50	Howard County Std. Details 515
1-11	Dbl. S. Grate	148.00	149.50	171.50	Howard County Std. Details 515
1-12	Dbl. S. Grate	147.00	149.00	170.50	Howard County Std. Details 515
1-13	Dbl. S. Grate	147.00	149.00	171.50	Howard County Std. Details 515
1-14	Dbl. S. Grate	147.00	149.00	171.50	Howard County Std. Details 515
1-15	Dbl. S. Grate	147.00	149.00	171.50	Howard County Std. Details 515
1-16	Dbl. S. Grate	147.00	149.00	171.50	Howard County Std. Details 515
1-17	Dbl. S. Grate	147.00	149.00	171.50	Howard County Std. Details 515
1-18	Dbl. S. Grate	147.00	149.00	171.50	Howard County Std. Details 515
1-19	Dbl. S. Grate	147.00	149.00	171.50	Howard County Std. Details 515
1-20	Dbl. S. Grate	147.00	149.00	171.50	Howard County Std. Details 515
1-21	Dbl. S. Grate	147.00	149.00	171.50	Howard County Std. Details 515
1-22	Dbl. S. Grate	147.00	149.00	171.50	Howard County Std. Details 515
1-23	Dbl. S. Grate	147.00	149.00	171.50	Howard County Std. Details 515
1-24	Dbl. S. Grate	147.00	149.00	171.50	Howard County Std. Details 515
1-25	Dbl. S. Grate	147.00	149.00	171.50	Howard County Std. Details 515
1-26	Dbl. S. Grate	147.00	149.00	171.50	Howard County Std. Details 515
1-27	Dbl. S. Grate	147.00	149.00	171.50	Howard County Std. Details 515
1-28	Dbl. S. Grate	147.00	149.00	171.50	Howard County Std. Details 515
1-29	Dbl. S. Grate	147.00	149.00	171.50	Howard County Std. Details 515
1-30	Dbl. S. Grate	147.00	149.00	171.50	Howard County Std. Details 515
1-31	Dbl. S. Grate	147.00	149.00	171.50	Howard County Std. Details 515
1-32	Dbl. S. Grate	147.00	149.00	171.50	Howard County Std. Details 515
1-33	Dbl. S. Grate	147.00	149.00	171.50	Howard County Std. Details 515
1-34	Dbl. S. Grate	147.00	149.00	171.50	Howard County Std. Details 515
1-35	Dbl. S. Grate	147.00	149.00	171.50	Howard County Std. Details 515
1-36	Dbl. S. Grate	147.00	149.00	171.50	Howard County Std. Details 515
1-37	Dbl. S. Grate	147.00	149.00	171.50	Howard County Std. Details 515
1-38	Dbl. S. Grate	147.00	149.00	171.50	Howard County Std. Details 515
1-39	Dbl. S. Grate	147.00	149.00	171.50	Howard County Std. Details 515
1-40	Dbl. S. Grate	147.00	149.00	171.50	Howard County Std. Details 515
1-41	Dbl. S. Grate	147.00	149.00	171.50	Howard County Std. Details 515
1-42	Dbl. S. Grate	147.00	149.00	171.50	Howard County Std. Details 515
1-43	Dbl. S. Grate	147.00	149.00	171.50	Howard County Std. Details 515
1-44	Dbl. S. Grate	147.00	149.00	171.50	Howard County Std. Details 515
1-45	Dbl. S. Grate	147.00	149.00	171.50	Howard County Std. Details 515
1-46	Dbl. S. Grate	147.00	149.00	171.50	Howard County Std. Details 515
1-47	Dbl. S. Grate	147.00	149.00	171.50	Howard County Std. Details 515
1-48	Dbl. S. Grate	147.00	149.00	171.50	Howard County Std. Details 515
1-49	Dbl. S. Grate	147.00	149.00	171.50	Howard County Std. Details 515
1-50	Dbl. S. Grate	147.00	149.00	171.50	Howard County Std. Details 515
1-51	Dbl. S. Grate	147.00	149.00	171.50	Howard County Std. Details 515
1-52	Dbl. S. Grate	147.00	149.00	171.50	Howard County Std. Details 515
1-53	Dbl. S. Grate	147.00	149.00	171.50	Howard County Std. Details 515
1-54	Dbl. S. Grate	147.00	149.00	171.50	Howard County Std. Details 515
1-55	Dbl. S. Grate	147.00	149.00	171.50	Howard County Std. Details 515
1-56	Dbl. S. Grate	147.00	149.00	171.50	Howard County Std. Details 515
1-57	Dbl. S. Grate	147.00	149.00	171.50	Howard County Std. Details 515
1-58	Dbl. S. Grate	147.00	149.00	171.50	Howard County Std. Details 515
1-59	Dbl. S. Grate	147.00	149.00	171.50	Howard County Std. Details 515
1-60	Dbl. S. Grate	147.00	149.00	171.50	Howard County Std. Details 515
1-61	Dbl. S. Grate	147.00	149.00	171.50	Howard County Std. Details 515
1-62	Dbl. S. Grate	147.00	149.00	171.50	Howard County Std. Details 515
1-63	Dbl. S. Grate	147.00	149.00	171.50	Howard County Std. Details 515
1-64	Dbl. S. Grate	147.00	149.00	171.50	Howard County Std. Details 515
1-65	Dbl. S. Grate	147.00	149.00	171.50	Howard County Std. Details 515
1-66	Dbl. S. Grate	147.00	149.00	171.50	Howard County Std. Details 515
1-67	Dbl. S. Grate	147.00	149.00	171.50	Howard County Std. Details 515
1-68	Dbl. S. Grate	147.00	149.00	171.50	Howard County Std. Details 515
1-69	Dbl. S. Grate	147.00	149.00	171.50	Howard County Std. Details 515
1-70	Dbl. S. Grate	147.00	149.00	171.50	Howard County Std. Details 515
1-71	Dbl. S. Grate	147.00	149.00	171.50	Howard County Std. Details 515
1-72	Dbl. S. Grate	147.00	149.00	171.50	Howard County Std. Details 515
1-73	Dbl. S. Grate	147.00	149.00	171.50	Howard County Std. Details 515
1-74	Dbl. S. Grate	147.00	149.00	171.50	Howard County Std. Details 515
1-75	Dbl. S. Grate	147.00	149.00	171.50	Howard County Std. Details 515
1-76	Dbl. S. Grate	147.00	149.00	171.50	Howard County Std. Details 515
1-77	Dbl. S. Grate	147.00	149.00	171.50	Howard County Std. Details 515
1-78	Dbl. S. Grate	147.00	149.00	171.50	Howard County Std. Details 515
1-79	Dbl. S. Grate	147.00	149.00	171.50	Howard County Std. Details 515
1-80	Dbl. S. Grate	147.00	149.00	171.50	Howard County Std. Details 515
1-81	Dbl. S. Grate	147.00	149.00	171.50	Howard County Std. Details 515
1-82	Dbl. S. Grate	147.00	149.00	171.50	Howard County Std. Details 515
1-83	Dbl. S. Grate	147.00	149.00	171.50	Howard County Std. Details 515
1-84	Dbl. S. Grate	147.00	149.00	171.50	Howard County Std. Details 515
1-85	Dbl. S. Grate	147.00	149.00	171.50	Howard County Std. Details 515
1-86	Dbl. S. Grate	147.00	149.00	171.50	Howard County Std. Details 515
1-87	Dbl. S. Grate	147.00	149.00	171.50	Howard County Std. Details 515
1-88	Dbl. S. Grate	147.00	149.00	171.50	Howard County Std. Details 515
1-89	Dbl. S. Grate	147.00	149.00	171.50	Howard County Std. Details 515
1-90	Dbl. S. Grate	147.00	149.00	171.50	Howard County Std. Details 515
1-91	Dbl. S. Grate	147.00	149.00	171.50	Howard County Std. Details 515
1-92	Dbl. S. Grate	147.00	149.00	171.50	Howard County Std. Details 515
1-93	Dbl. S. Grate	147.00	149.00	171.50	Howard County Std. Details 515
1-94	Dbl. S. Grate	147.00	149.00	171.50	Howard County Std. Details 515
1-95	Dbl. S. Grate	147.00	149.00	171.50	Howard County Std. Details 515
1-96	Dbl. S. Grate	147.00	149.00	171.50	Howard County Std. Details 515
1-97	Dbl. S. Grate	147.00	149.00	171.50	Howard County Std. Details 515
1-98	Dbl. S. Grate	147.00	149.00	171.50	Howard County Std. Details 515
1-99	Dbl. S. Grate	147.00	149.00	171.50	Howard County Std. Details 515
1-100	Dbl. S. Grate	147.00	149.00	171.50	Howard County Std. Details 515

APPROVED: For public water and public coverage systems
Howard County Health Department.

[Signature] Date: 11-5-71

APPROVED: Howard County Department of Planning and Zoning.

[Signature] Date: 11-10-71

APPROVED: For public water, public sewerage, storm drainage systems and public roads.
Howard County Department of Public Works.

[Signature] Date: 11-10-71

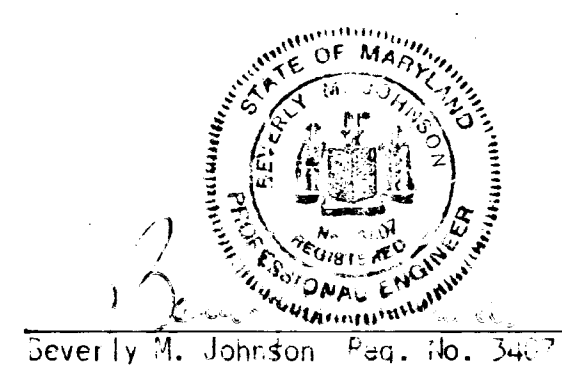

STORM DRAIN PROFILE

OVERNITE TRANSPORTATION COMPANY

BALTIMORE TERMINAL
ELECTION DISTRICT - ELKRIDGE NO. 1
HOWARD COUNTY - MARYLAND
SCALE: AS SHOWN