

I CERTIFY THAT ALL DEVELOPMENT AND/OR CONSTRUCTION WILL BE DONE ACCORDING TO THIS PLAN OF DEVELOPMENT AND PLAN OF SILT AND SEDIMENT CONTROL.

John T. Swann 8-1-72
DATE

I CERTIFY THAT THE PLAN OF DEVELOPMENT AND THE PLAN FOR CONTROL OF SILT AND EROSION MEETS THE REQUIREMENTS, STANDARDS AND SPECIFICATIONS OF THE HOWARD SOIL CONSERVATION DISTRICT.

William G. Rasch II 6/29/72
DATE

THIS DEVELOPMENT PLAN IS APPROVED FOR SOIL EROSION AND SEDIMENT CONTROL BY THE HOWARD SOIL CONSERVATION DISTRICT.

REVIEWED *James M. Nelson* 8/4/72
DISTRICT CONSERVATIONIST DATE

APPROVED *Robert W. Jick* 8/4/72
HOWARD SOIL CONSERVATION DISTRICT DATE

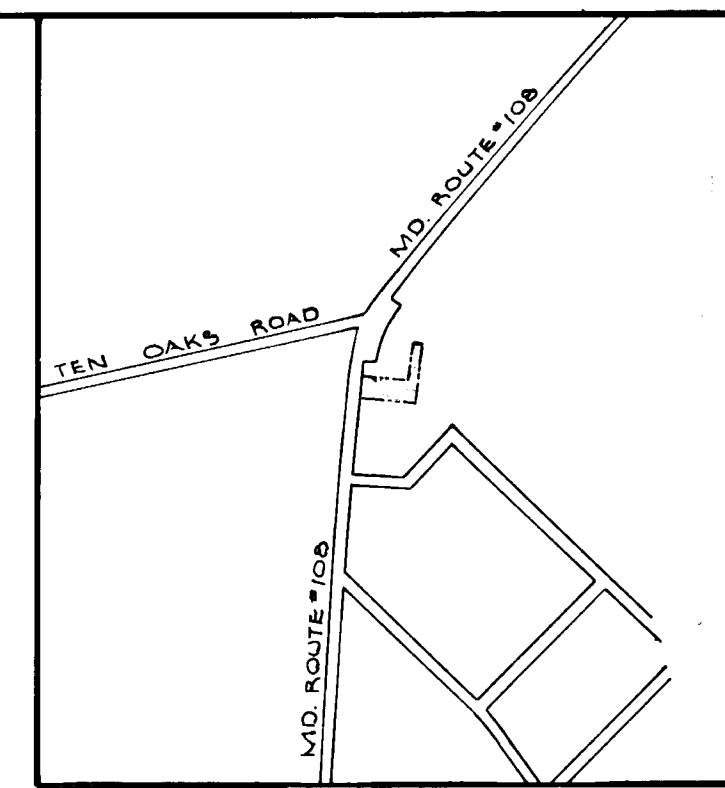
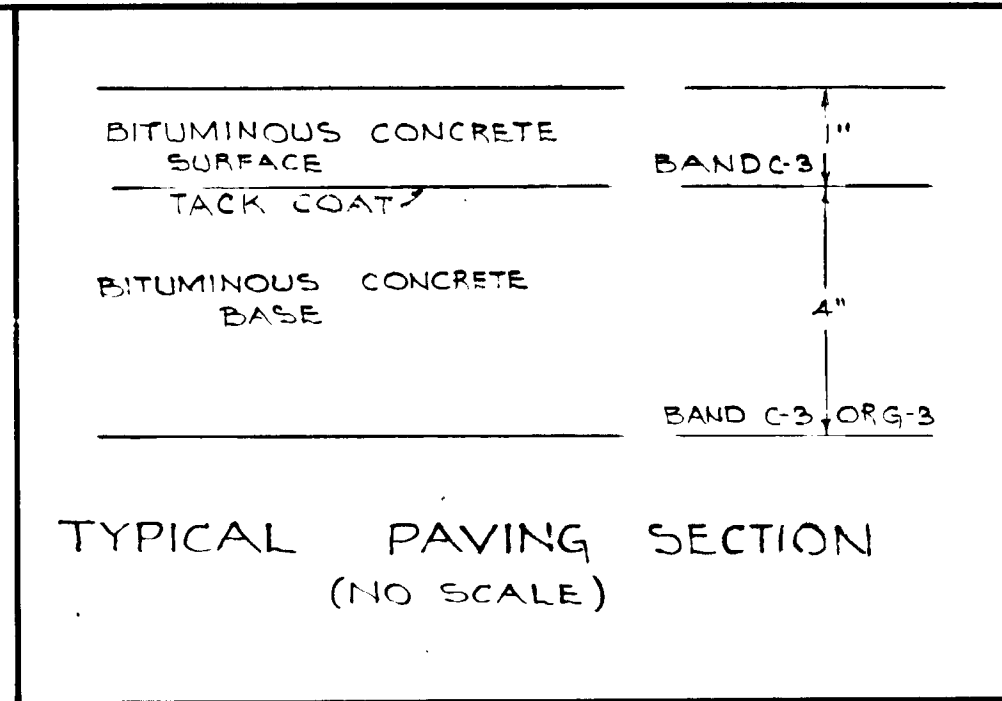

VICINITY MAP
SCALE: 1" = 600'

EROSION CONTROL CONSTRUCTION SEQUENCE

- Grade site to required Subgrade elevations.
- Install Bituminous Concrete Base.
- Seed all disturbed areas not being paved, except a 5' strip adjacent to the building to be constructed.
 - Sow the following seed mixture at the rate of 200 pounds per acre with a mechanical spreader:
 - 20% Annual Ryegrass
 - 80% Kentucky 31 Fescue
 - The seeded area shall then be raked with a York Rake (minimum of two passes), covered and compacted with Cultipicker or other approved method.
- Mulch
 - Seeded area shall be uniformly mulched after seeding with Unweathered Small Grain Straw - 1 1/2 ton per Acre.
 - Tied down with Liquid Asphalt at the rate of 1/10 gallon per Sq. Yd. or Mulch Netting.
- Construct building.
- Complete the stabilization of the disturbed areas not previously treated.

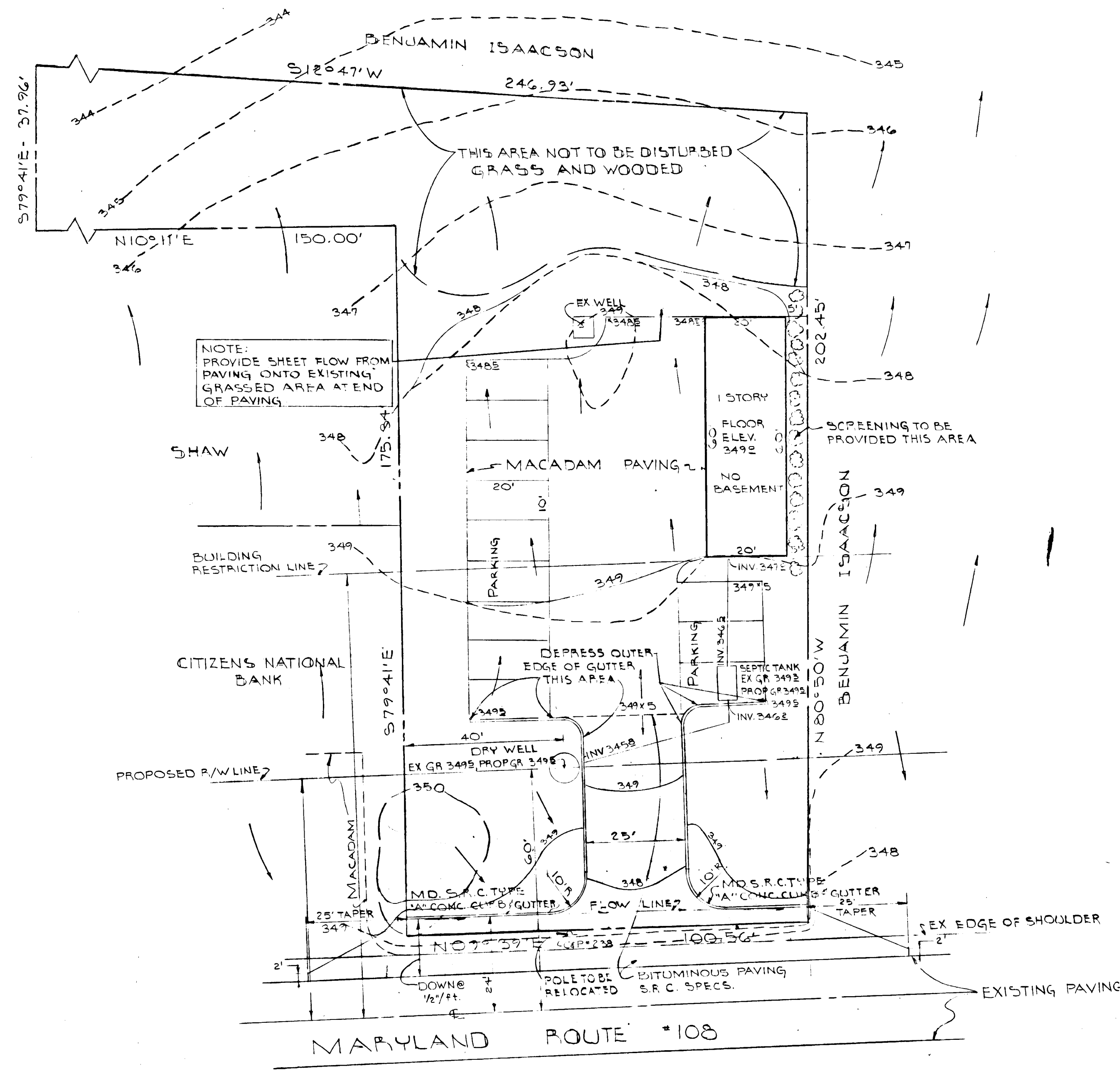

- GENERAL NOTES:**
- Area of building: 1200^{sq}
 - Parking required:
 - each 100^{sq} retail area: 12 spaces.
 - Parking provided: 12 spaces.
 - No. of employees: 5
 - Property Zoned: B-2
 - Site paving to be in accordance with Howard County Specs. See Detail.
 - Area of Parcel: 27,300^{sq}
 - Proposed Use: Lock and Key Service Shop.

APPROVED FOR PRIVATE WATER AND PRIVATE SEWERAGE SYSTEMS, HOWARD COUNTY HEALTH DEPARTMENT.
Robert W. Jick 8-16-72
COUNTY HEALTH OFFICER, DATE

APPROVED HOWARD COUNTY OFFICE OF PLANNING AND ZONING.
James M. Nelson 8-15-72
PLANNING DIRECTOR, DATE

William G. Rasch II 8-15-72
CHIEF DIVISION OF LAND DEVELOPMENT AND TRANSPORTATION PLANNING, DATE

APPROVED FOR STORM DRAINAGE SYSTEMS, AND PUBLIC ROADS, HOWARD COUNTY DEPARTMENT OF PUBLIC WORKS.
William G. Rasch II 8/19/72
DIRECTOR, DATE

William G. Rasch II 8/19/72
CHIEF, BUREAU OF HIGHWAYS, DATE

PURDUM WESCHKE
ENGINEERS AND LAND SURVEYORS
3697 PARK AVE
ELLICOTT CITY, MD.

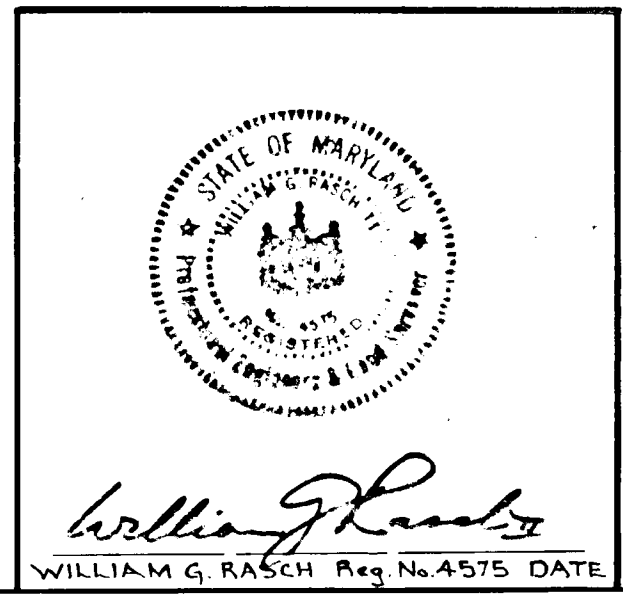

OWNER & DEVELOPER
John T Swann
Route 108 - Box 13015
Highland, Maryland 20777

SITE PLAN
PROPERTY OF
JOHN SWANN
5TH ELECTION DISTRICT
JUNE 28, 1972
HOWARD COUNTY, MD.
SCALE: 1" = 20'