

5

3. TOTAL PARKING REQUIRED = 109 SPACES (PER SHARED PARKING ADJUSTMENT)

- EXISTING INDUSTRIAL TENANTS (1 SPACE FOR EACH EMPLOYEE PER FDP 85)
- a. TAYO SEAFOOD @ 12,680 sf (15 EMPLOYEES) = 15 SPACES
 - b. IT'S MY AMPHITHEATRE @ 8,945 sf (2 EMPLOYEES) = 2 SPACES
 - c. HMC @ 31,381 sf (16 EMPLOYEES) = 16 SPACES
 - d. VACANT SPACE @ 10,050 sf (ALLOCATE 13 EMPLOYEES) = 13 SPACES
 - e. VACANT SPACE @ 12,039 sf (ALLOCATE 13 EMPLOYEES) = 13 SPACES
 - f. YONG FA INTERNATIONAL @ 9,023 sf (6 EMPLOYEES) = 6 SPACES
 - g. UCL @ 5,460 sf (6 EMPLOYEES) = 6 SPACES
 - h. CONTINENTAL LIGHTING @ 4,200 sf (4 EMPLOYEES) = 4 SPACES
 - i. ENI DISTRIBUTORS @ 15,263 sf (15 EMPLOYEES) = 15 SPACES
 - j. HI-TEL ENTERPRISES @ 6,490 sf (6 EMPLOYEES) = 6 SPACES

Proposed Commercial Tenant (5 spaces per 1000 sf commercial use per FDP 85)

k. Proposed Gymnasium @ 6,021 sf = 31 SPACES

REVISIONS			
NO	DESCRIPTION	DRN	REV DATE
5	REVISION TO ADD NEW TENANT (GYMNASIUM)	ALS	DDC 03/30/77

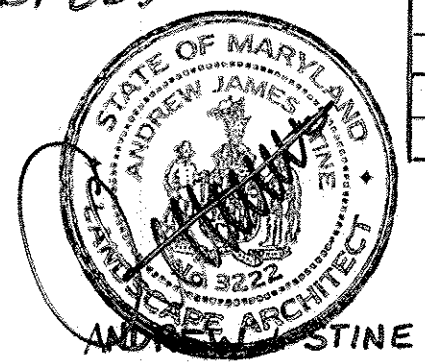

LANDSCAPE ARCHITECT NO. 3222

SHARED PARKING ADJUSTMENT

CATEGORY OFFICE OR INDUSTRIAL COMMERCIAL RECREATION	WEEKDAY			EVENING 5PM - MIDNIGHT	DAYLIGHT 6AM - 6PM	WEEKEND	
	MORNING 6AM - 8AM	MID DAY 8AM - 3PM	AFTERNOON 3PM - 5PM			EVENING 6PM - MIDNIGHT	NIGHT MID - 6AM
	77	96	96	10	20	5	5
	13	13	13	31	25	31	4
	90	109	109	41	35	36	9

4. TOTAL PARKING PROVIDED = 109 SPACES (PER THIS REVISION)

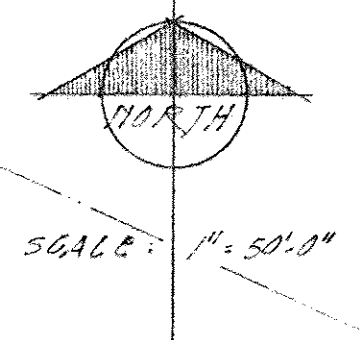
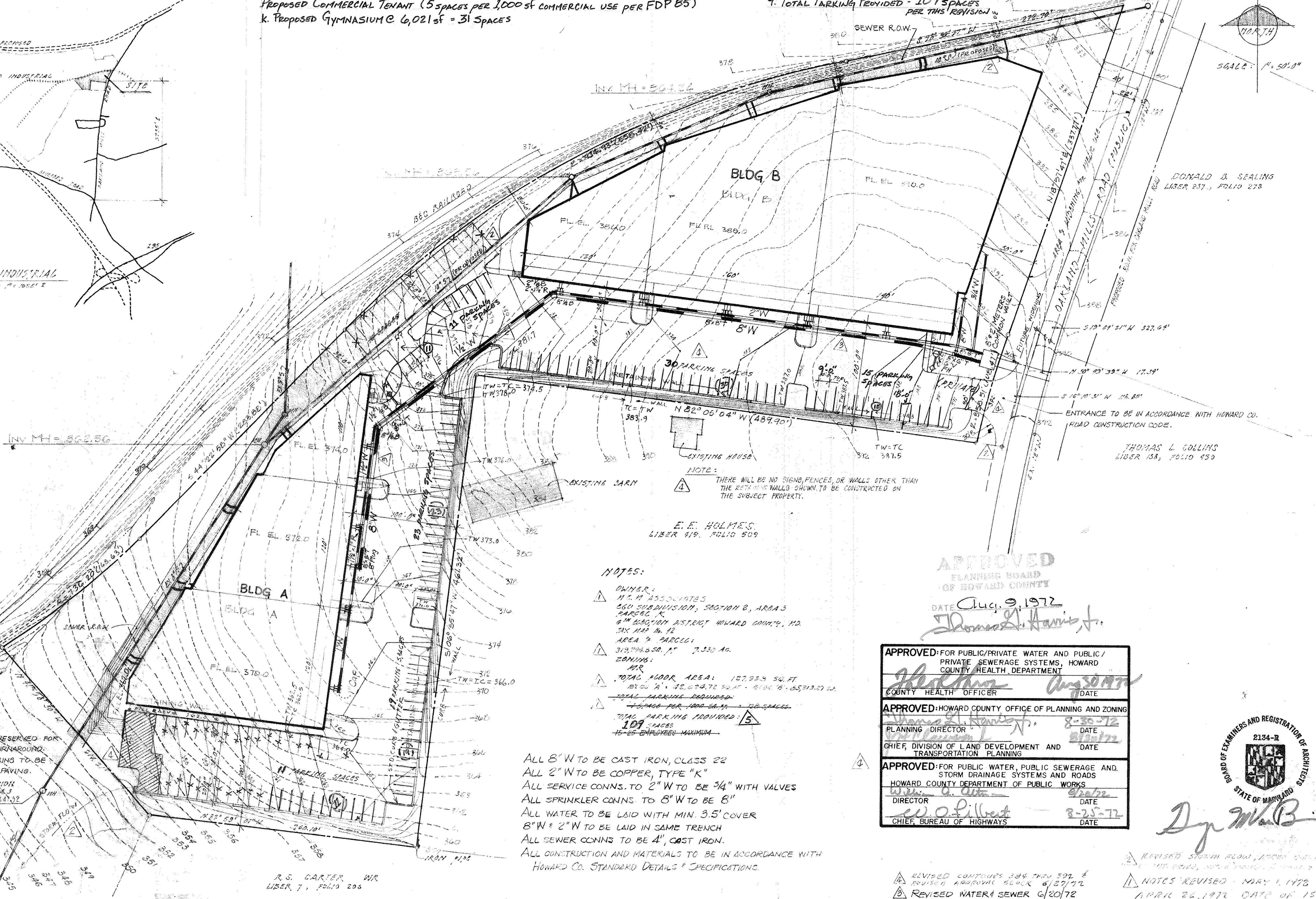
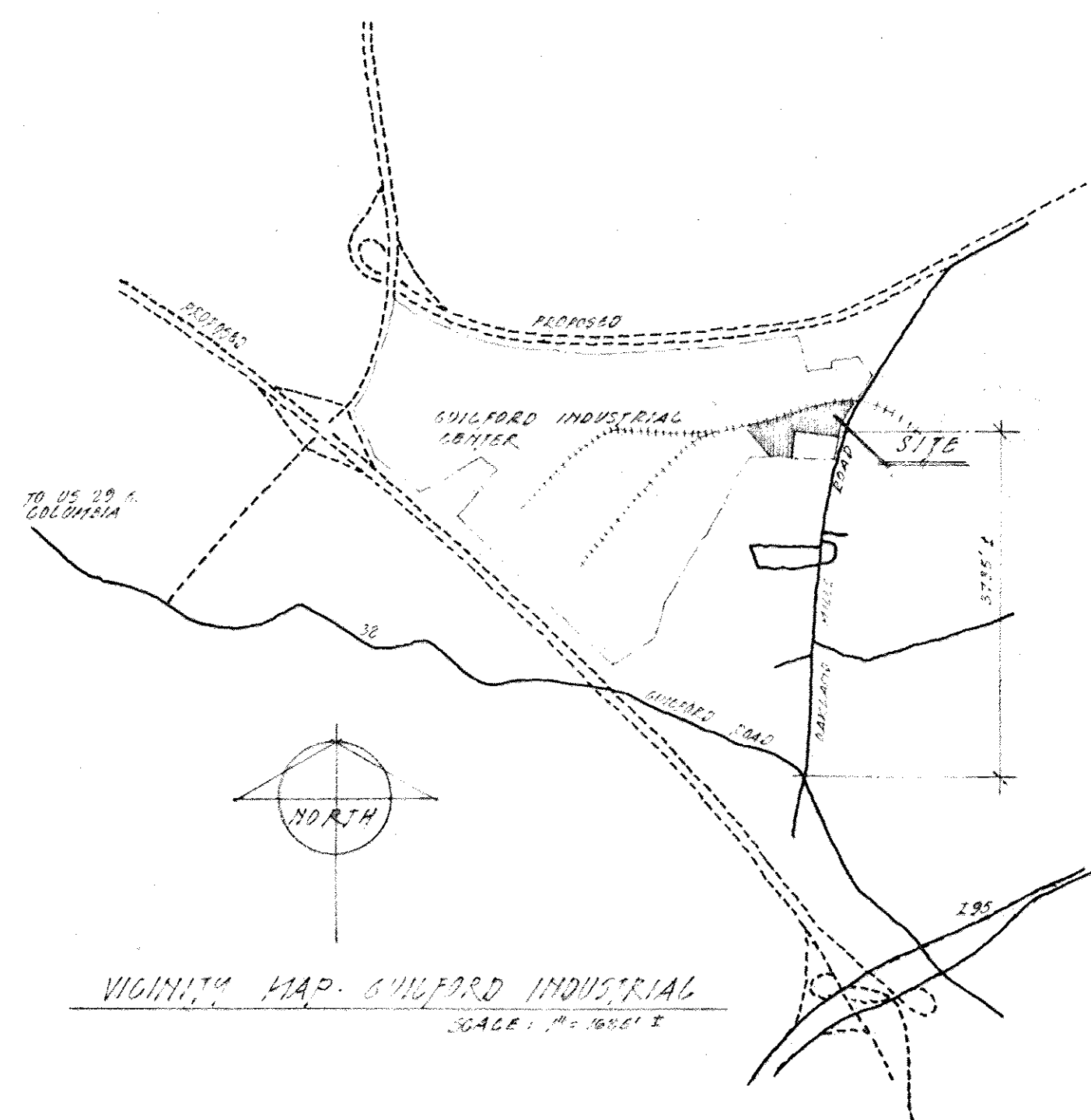

NOTE:
THERE WILL BE NO SIGNS, FENCES, OR WALLS OTHER THAN THE RETAINING WALLS SHOWN TO BE CONSTRUCTED ON THE SUBJECT PROPERTY.

NOTES:

- OWNER: M.C.M. ASSOCIATES, 650 SUBDIVISION, SECTION 8, AREA 3 PARCELS 14, 15, 16, 17, 18, 19, 20, 21, 22, 23, 24, 25, 26, 27, 28, 29, 30, 31, 32, 33, 34, 35, 36, 37, 38, 39, 40, 41, 42, 43, 44, 45, 46, 47, 48, 49, 50, 51, 52, 53, 54, 55, 56, 57, 58, 59, 60, 61, 62, 63, 64, 65, 66, 67, 68, 69, 70, 71, 72, 73, 74, 75, 76, 77, 78, 79, 80, 81, 82, 83, 84, 85, 86, 87, 88, 89, 90, 91, 92, 93, 94, 95, 96, 97, 98, 99, 100, 101, 102, 103, 104, 105, 106, 107, 108, 109, 110, 111, 112, 113, 114, 115, 116, 117, 118, 119, 120, 121, 122, 123, 124, 125, 126, 127, 128, 129, 130, 131, 132, 133, 134, 135, 136, 137, 138, 139, 140, 141, 142, 143, 144, 145, 146, 147, 148, 149, 150, 151, 152, 153, 154, 155, 156, 157, 158, 159, 160, 161, 162, 163, 164, 165, 166, 167, 168, 169, 170, 171, 172, 173, 174, 175, 176, 177, 178, 179, 180, 181, 182, 183, 184, 185, 186, 187, 188, 189, 190, 191, 192, 193, 194, 195, 196, 197, 198, 199, 200, 201, 202, 203, 204, 205, 206, 207, 208, 209, 210, 211, 212, 213, 214, 215, 216, 217, 218, 219, 220, 221, 222, 223, 224, 225, 226, 227, 228, 229, 230, 231, 232, 233, 234, 235, 236, 237, 238, 239, 240, 241, 242, 243, 244, 245, 246, 247, 248, 249, 250, 251, 252, 253, 254, 255, 256, 257, 258, 259, 260, 261, 262, 263, 264, 265, 266, 267, 268, 269, 270, 271, 272, 273, 274, 275, 276, 277, 278, 279, 280, 281, 282, 283, 284, 285, 286, 287, 288, 289, 290, 291, 292, 293, 294, 295, 296, 297, 298, 299, 300, 301, 302, 303, 304, 305, 306, 307, 308, 309, 310, 311, 312, 313, 314, 315, 316, 317, 318, 319, 320, 321, 322, 323, 324, 325, 326, 327, 328, 329, 330, 331, 332, 333, 334, 335, 336, 337, 338, 339, 340, 341, 342, 343, 344, 345, 346, 347, 348, 349, 350, 351, 352, 353, 354, 355, 356, 357, 358, 359, 360, 361, 362, 363, 364, 365, 366, 367, 368, 369, 370, 371, 372, 373, 374, 375, 376, 377, 378, 379, 380, 381, 382, 383, 384, 385, 386, 387, 388, 389, 390, 391, 392, 393, 394, 395, 396, 397, 398, 399, 400, 401, 402, 403, 404, 405, 406, 407, 408, 409, 410, 411, 412, 413, 414, 415, 416, 417, 418, 419, 420, 421, 422, 423, 424, 425, 426, 427, 428, 429, 430, 431, 432, 433, 434, 435, 436, 437, 438, 439, 440, 441, 442, 443, 444, 445, 446, 447, 448, 449, 450, 451, 452, 453, 454, 455, 456, 457, 458, 459, 460, 461, 462, 463, 464, 465, 466, 467, 468, 469, 470, 471, 472, 473, 474, 475, 476, 477, 478, 479, 480, 481, 482, 483, 484, 485, 486, 487, 488, 489, 490, 491, 492, 493, 494, 495, 496, 497, 498, 499, 500, 501, 502, 503, 504, 505, 506, 507, 508, 509, 510, 511, 512, 513, 514, 515, 516, 517, 518, 519, 520, 521, 522, 523, 524, 525, 526, 527, 528, 529, 530, 531, 532, 533, 534, 535, 536, 537, 538, 539, 540, 541, 542, 543, 544, 545, 546, 547, 548, 549, 550, 551, 552, 553, 554, 555, 556, 557, 558, 559, 560, 561, 562, 563, 564, 565, 566, 567, 568, 569, 570, 571, 572, 573, 574, 575, 576, 577, 578, 579, 580, 581, 582, 583, 584, 585, 586, 587, 588, 589, 590, 591, 592, 593, 594, 595, 596, 597, 598, 599, 600, 601, 602, 603, 604, 605, 606, 607, 608, 609, 610, 611, 612, 613, 614, 615, 616, 617, 618, 619, 620, 621, 622, 623, 624, 625, 626, 627, 628, 629, 630, 631, 632, 633, 634, 635, 636, 637, 638, 639, 640, 641, 642, 643, 644, 645, 646, 647, 648, 649, 650, 651, 652, 653, 654, 655, 656, 657, 658, 659, 660, 661, 662, 663, 664, 665, 666, 667, 668, 669, 670, 671, 672, 673, 674, 675, 676, 677, 678, 679, 680, 681, 682, 683, 684, 685, 686, 687, 688, 689, 690, 691, 692, 693, 694, 695, 696, 697, 698, 699, 700, 701, 702, 703, 704, 705, 706, 707, 708, 709, 710, 711, 712, 713, 714, 715, 716, 717, 718, 719, 720, 721, 722, 723, 724, 725, 726, 727, 728, 729, 730, 731, 732, 733, 734, 735, 736, 737, 738, 739, 740, 741, 742, 743, 744, 745, 746, 747, 748, 749, 750, 751, 752, 753, 754, 755, 756, 757, 758, 759, 760, 761, 762, 763, 764, 765, 766, 767, 768, 769, 770, 771, 772, 773, 774, 775, 776, 777, 778, 779, 780, 781, 782, 783, 784, 785, 786, 787, 788, 789, 790, 791, 792, 793, 794, 795, 796, 797, 798, 799, 800, 801, 802, 803, 804, 805, 806, 807, 808, 809, 810, 811, 812, 813, 814, 815, 816, 817, 818, 819, 820, 821, 822, 823, 824, 825, 826, 827, 828, 829, 830, 831, 832, 833, 834, 835, 836, 837, 838, 839, 840, 841, 842, 843, 844, 845, 846, 847, 848, 849, 850, 851, 852, 853, 854, 855, 856, 857, 858, 859, 860, 861, 862, 863, 864, 865, 866, 867, 868, 869, 870, 871, 872, 873, 874, 875, 876, 877, 878, 879, 880, 881, 882, 883, 884, 885, 886, 887, 888, 889, 890, 891, 892, 893, 894, 895, 896, 897, 898, 899, 900, 901, 902, 903, 904, 905, 906, 907, 908, 909, 910, 911, 912, 913, 914, 915, 916, 917, 918, 919, 920, 921, 922, 923, 924, 925, 926, 927, 928, 929, 930, 931, 932, 933, 934, 935, 936, 937, 938, 939, 940, 941, 942, 943, 944, 945, 946, 947, 948, 949, 950, 951, 952, 953, 954, 955, 956, 957, 958, 959, 960, 961, 962, 963, 964, 965, 966, 967, 968, 969, 970, 971, 972, 973, 974, 975, 976, 977, 978, 979, 980, 981, 982, 983, 984, 985, 986, 987, 988, 989, 990, 991, 992, 993, 994, 995, 996, 997, 998, 999, 1000

ALL 8" W TO BE CAST IRON, CLASS 22
 ALL 2" W TO BE COPPER, TYPE "K"
 ALL SERVICE CONNS. TO 2" W TO BE 3/4" WITH VALVES
 ALL SPRINKLER CONNS. TO 8" W TO BE 8"
 ALL WATER TO BE LAID WITH MIN. 3.5' COVER
 8" W * 2" W TO BE LAID IN SAME TRENCH
 ALL SEWER CONNS TO BE 4", CAST IRON.
 ALL CONSTRUCTION AND MATERIALS TO BE IN ACCORDANCE WITH HOWARD CO. STANDARD DETAILS & SPECIFICATIONS.

APPROVED PLANNING BOARD OF HOWARD COUNTY

DATE Aug. 9, 1972

Thomas L. Harris, Jr.

APPROVED FOR PUBLIC/PRIVATE WATER AND PUBLIC/PRIVATE SEWERAGE SYSTEMS, HOWARD COUNTY HEALTH DEPARTMENT
 COUNTY HEALTH OFFICER [Signature] DATE [Signature]

APPROVED HOWARD COUNTY OFFICE OF PLANNING AND ZONING
 PLANNING DIRECTOR [Signature] DATE 8-29-72
 CHIEF, DIVISION OF LAND DEVELOPMENT AND TRANSPORTATION PLANNING [Signature] DATE 8/29/72

APPROVED FOR PUBLIC WATER, PUBLIC SEWERAGE AND STORM DRAINAGE SYSTEMS AND ROADS
 HOWARD COUNTY DEPARTMENT OF PUBLIC WORKS
 DIRECTOR [Signature] DATE 8/29/72
 CHIEF, BUREAU OF HIGHWAYS [Signature] DATE 8-25-72

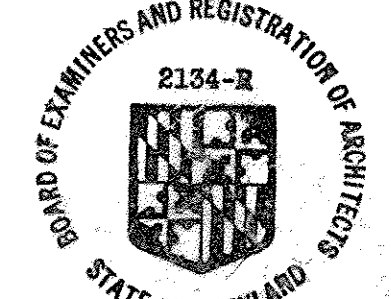

[Signature]

REVISOR CONTIGUES 294 THRU 302 & REVISOR APPROVALS BLOCK 6/29/72
 REVISOR WATER & SEWER 6/20/72

REVISOR STORM FLOW, APPROV. DRAINAGE CONNS. TO SEWER, WITH A MINIMUM COVER OF 3.5' TO 4' 72
 NOTES REVISOR - MAY 1, 1978
 APRIL 26, 1972 DATE OF ISSUE

1000 CONNECTION AVE. KENSINGTON, MD. TEL. 593-8900
GUILFORD INDUSTRIAL COLUMBIA, MARYLAND

Mayne, Oseroff, Van Besien, Inc.
 Architecture Planning Interior Design
 1901 N. Fort Myer Dr. 5620 St. Barnabas Rd.
 Arlington, Va. 22209 Oxon Hill, Md. 20021
 703/528-8686 301/630-3232

SITE & GRADING PLAN
 SENIOR C. DWYER
 SDF-72-109
 COMM. NO: C72-94
 CHECKED BY
 DRAWN BY

DATE: 8-25-72
 OF
 DRAWING NO.