

APPROVED FOR PUBLIC WATER AND PUBLIC SEWERAGE SYSTEMS, HOWARD COUNTY HEALTH DEPARTMENT
 COUNTY HEALTH OFFICER DATE 6-1-73
 APPROVED HOWARD COUNTY OFFICE OF PLANNING & ZONING PLANNING DIRECTOR DATE 6-5-73
 APPROVED FOR PUBLIC WATER AND PUBLIC SEWERAGE, STORM DRAINAGE SYSTEMS AND PUBLIC ROADS, HOWARD COUNTY DEPARTMENT OF PUBLIC WORKS DATE 6-14-73
 CHIEF BUREAU OF HIGHWAYS DATE 6-20-73

NOTE: For approved Silt and Erosion Control Plans, see Plans 1048-D sheets (and 2)

SITE ANALYSIS - PARCEL 'A' SECT. 1 AREA 5

AREA	9,537 A.C. OR 415,445 sq.
BUILDING COVERAGE ALLOWED @ 35%	145,401 sq.
BUILDING COVERAGE PROVIDED	98,420 sq.
PARKING & DRIVES COVERAGE	91,680 sq.
GREEN AREA PROVIDED	265,131 sq.
Nº OF UNITS ALLOWED	173
Nº OF UNITS PROVIDED	173
PARKING REQUIRED @ 15/UNIT	260
PARKING PROVIDED	267

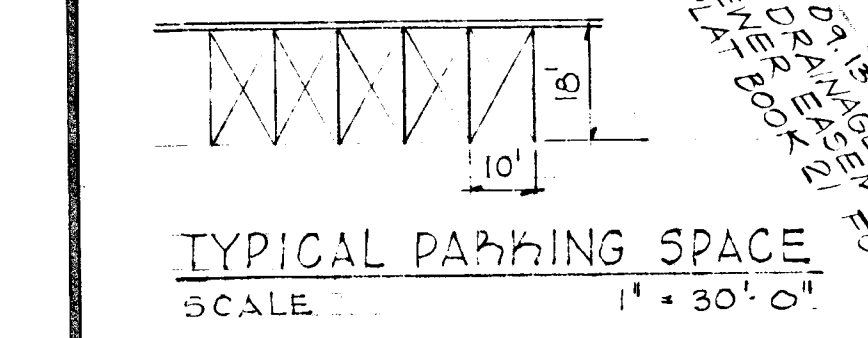
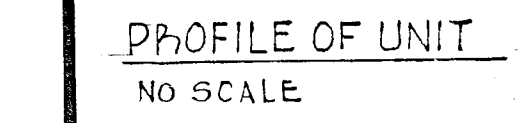
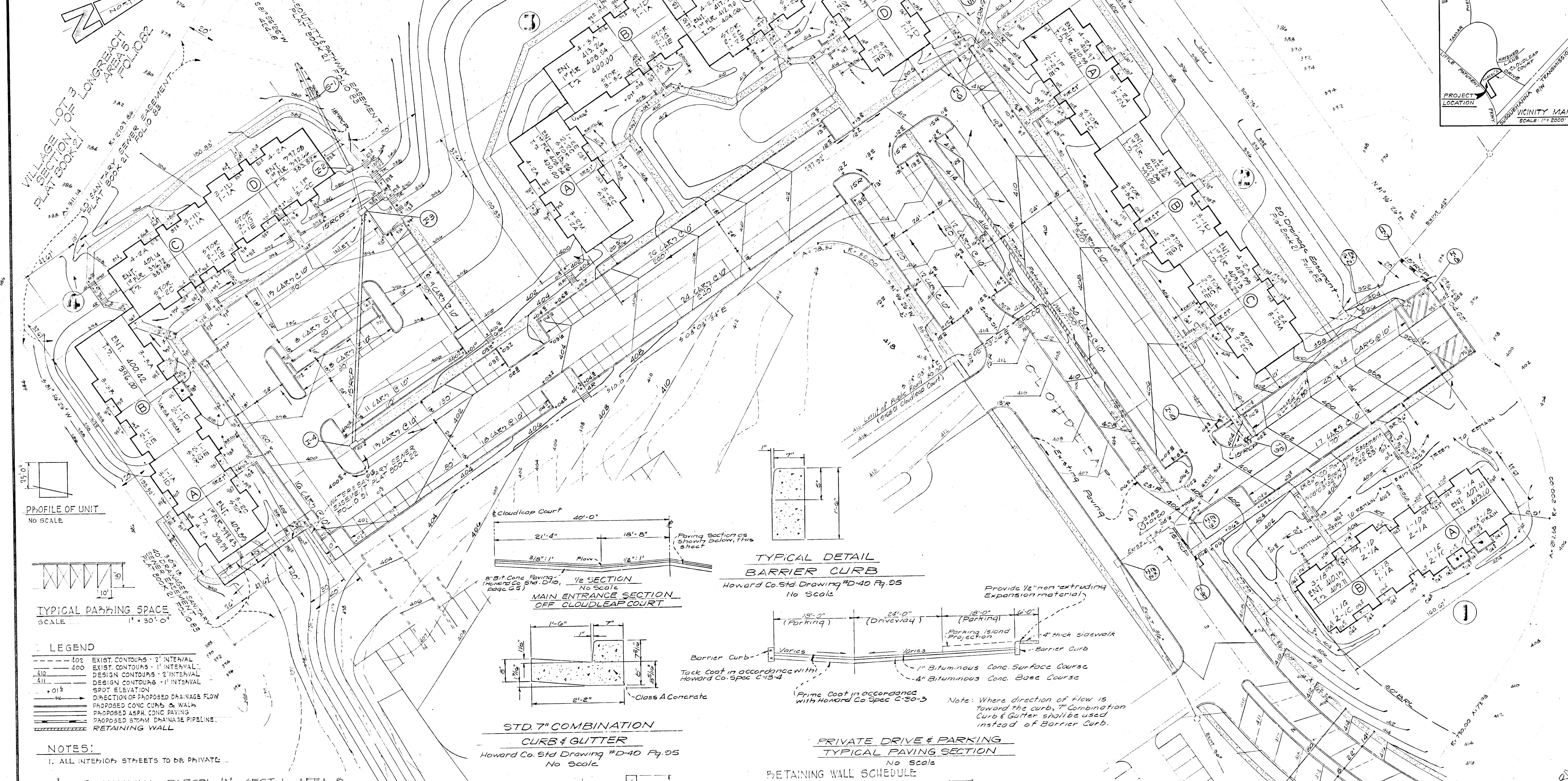

- LEGEND
- 102 EXIST. CONTOURS - 2' INTERVAL
 - 400 EXIST. CONTOURS - 1' INTERVAL
 - 410 DESIGN CONTOURS - 2' INTERVAL
 - 411 DESIGN CONTOURS - 1' INTERVAL
 - +0.12 SPOT ELEVATION
 - DIRECTION OF PROPOSED DRAINAGE FLOW
 - PROPOSED CONC. CURB & WALK
 - PROPOSED ASPH. CONC. PAVING
 - PROPOSED STORM DRAINAGE PIPELINE
 - RETAINING WALL

NOTES:
1. ALL INTERIOR STREETS TO BE PRIVATE

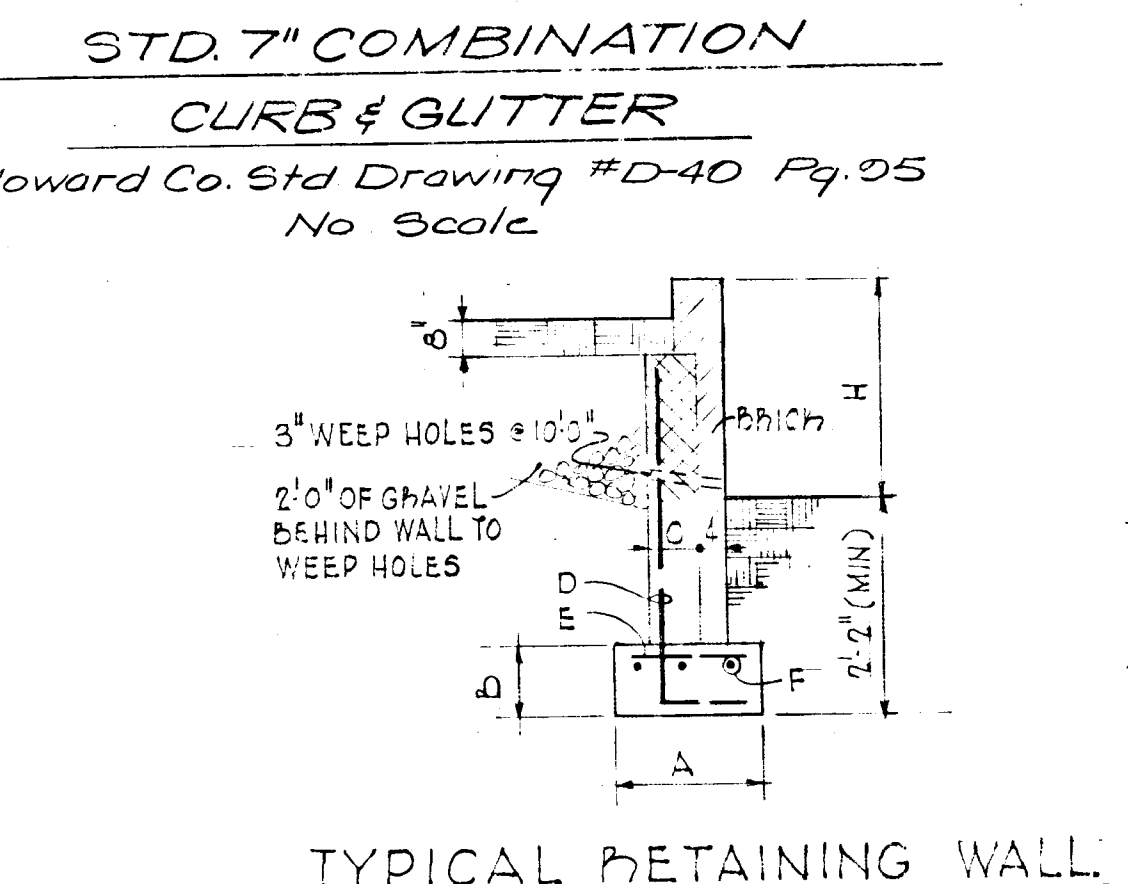
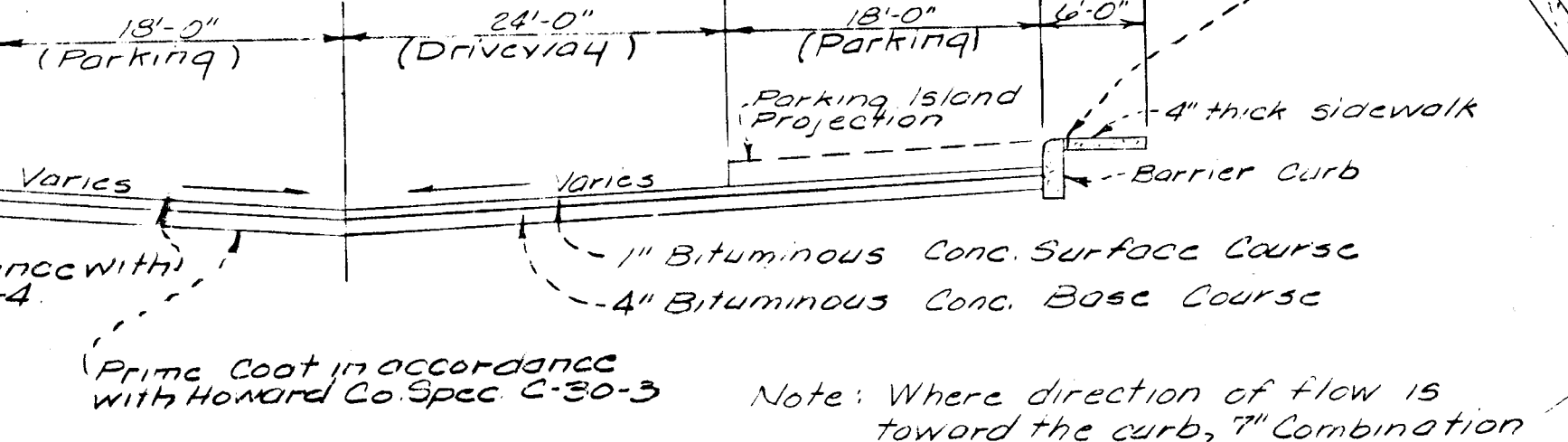
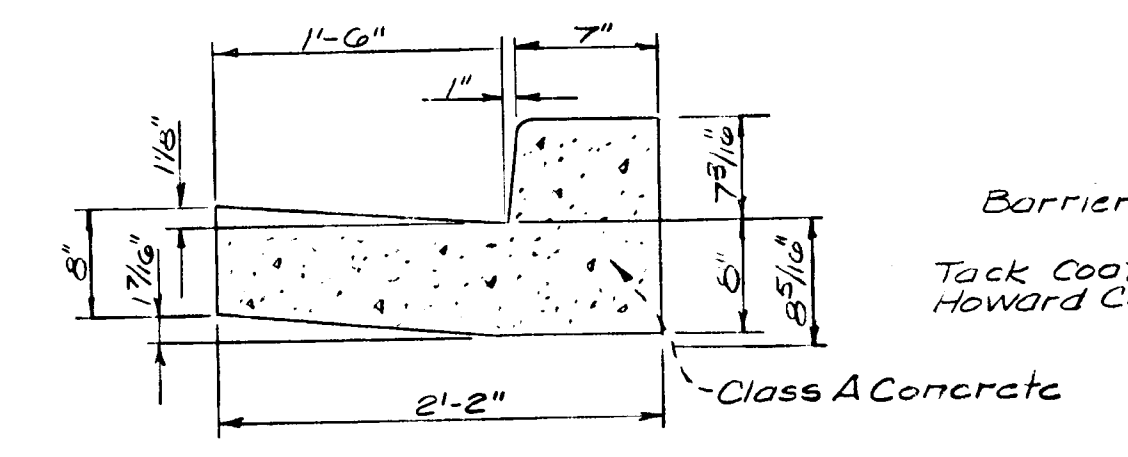
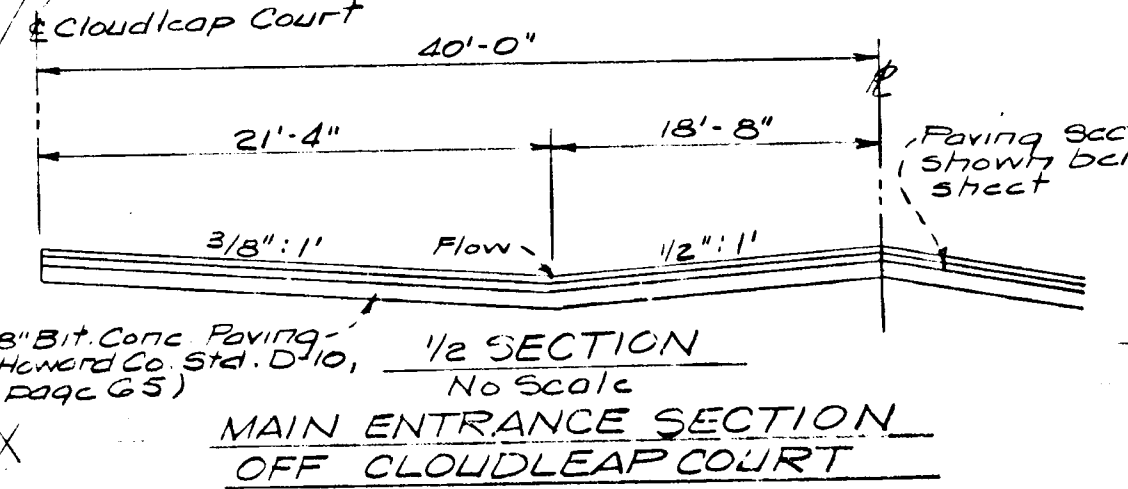

RETAINING WALL SCHEDULE

NO.	H	A	B	C	D	E	F	REMARKS
I	2'-0"	2'-0"	1'-0"	8"	8"	8"	8"	SOLID CMU
II	4'-0"	2'-0"	1'-0"	8"	8"	8"	8"	HOLLOW CMU
III	5'-0"	2'-0"	1'-0"	8"	8"	8"	8"	HOLLOW CMU
IV	7'-0"	4'-0"	1'-0"	8"	8"	8"	8"	HOLLOW CMU
V	8'-0"	4'-0"	1'-0"	8"	8"	8"	8"	HOLLOW CMU
VI	9'-0"	4'-0"	1'-0"	8"	8"	8"	8"	HOLLOW CMU
VII	10'-0"	4'-0"	1'-0"	8"	8"	8"	8"	HOLLOW CMU

UNIT	1 BR	2 BR	2 BR, 2 B	3 BR
TOTAL	18	6	2	13
SQUARE FEET	15,910.00	4,230.00	4,430.00	15,030.00
	5,230.00	2,170.00	2,260.00	7,570.00
	10,680.00	2,060.00	2,170.00	7,460.00

UNIT ANALYSIS - PARCEL 'A' SECT. 1 AREA 5

BLDG. Nº	1 BEDROOM					2 BEDROOM		2 BR, 2B			3 BR			TOTAL
	A	B	C	D	E	F	G	H	I	J	K	L		
1	10	6	4	2	1								24	
2						10	2						43	
3						6	2	4					56	
4						5	2	10	4	1	6		55	
TOTALS	18	6	6	2	8	2	13	32	4	14	11	36	173	
%	41.6%					20.2%		27.0%			11.2%			

APPROVED
 3-7-73
 Howard Co. Health Department

Revisions

Revisions	Date

VILLAGE OF LONGREACH
 COLUMBIA, MARYLAND
 ARTS & CRAFTS ORGANIZATION, INC. DEVELOPMENT PLAN

PARCEL 'A' SECT. 1 - AREA 5
 VILLAGE OF LONGREACH
 HOWARD COUNTY DISTRICT
 PLAT BOOK 21 FOLIO 83

OWNER: ARTS & CRAFTS ORGANIZATION, INC.
 5530 WISCONSIN AVE
 CHEVY CHASE, MD 20012
 TELE. 682-9599
 ARCHITECTS: COHEN HAFT & ASSOCIATES
 3900 GEORGIA AVE
 SILVER SPRING, MD. 20900

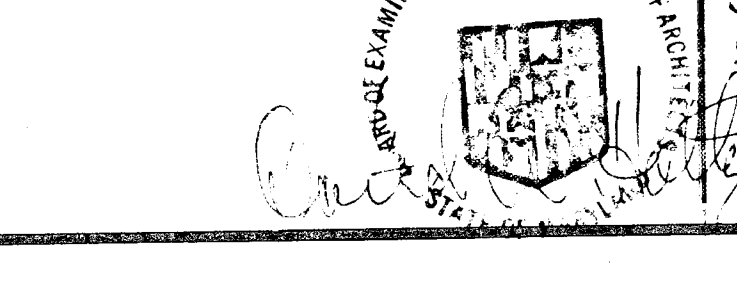

SITE PLAN
 SCALE 1" = 30'-0"

Job No. 157A-71
 Date

See Revised Site Plan sheet 2 of 8
 1 of 8
 SDP 15 12

Cohen Haft and Associates Architects and Planners
 David A. Holtz Associate
 Silver Spring, Maryland

APPROVED FOR PUBLIC WATER AND PUBLIC SEWERAGE SYSTEMS, HOWARD COUNTY HEALTH DEPARTMENT
 COUNTY HEALTH OFFICER DATE
 APPROVED HOWARD COUNTY OFFICE OF PLANNING & ZONING
 PLANNING DIRECTOR DATE
 APPROVED FOR PUBLIC WATER AND PUBLIC SEWERAGE, STORM DRAINAGE SYSTEMS AND PUBLIC ROADS, HOWARD COUNTY DEPARTMENT OF PUBLIC WORKS
 DIRECTOR DATE
 CHIEF BUREAU OF HIGHWAYS DATE

NOTES:
 For approved Silt and Erosion Control Plans, see P.E. No. 1048-D sheets 1 and 2

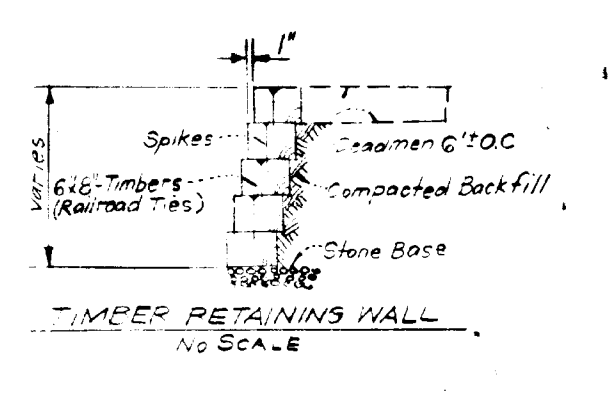

SITE ANALYSIS - PARCEL 'A' SECT. 1 AREA 5

AREA	9,537 A. or 415,445 sq. ft.
BUILDING COVERAGE ALLOWED @ 35%	148,458 sq. ft.
BUILDING COVERAGE PROVIDED	69,125 sq. ft.
PARKING & DRIVEWAY COVERAGE	91,400 sq. ft.
GREEN AREA PROVIDED	264,230 sq. ft.
NO. OF UNITS ALLOWED	173
NO. OF UNITS PROVIDED	173
PLANNING PROVIDED	167

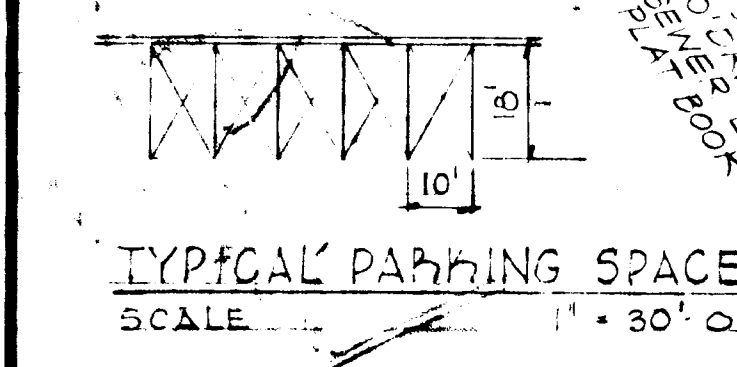
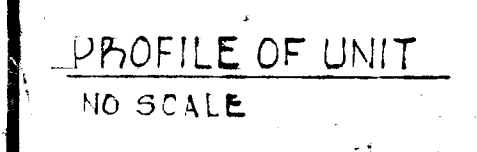
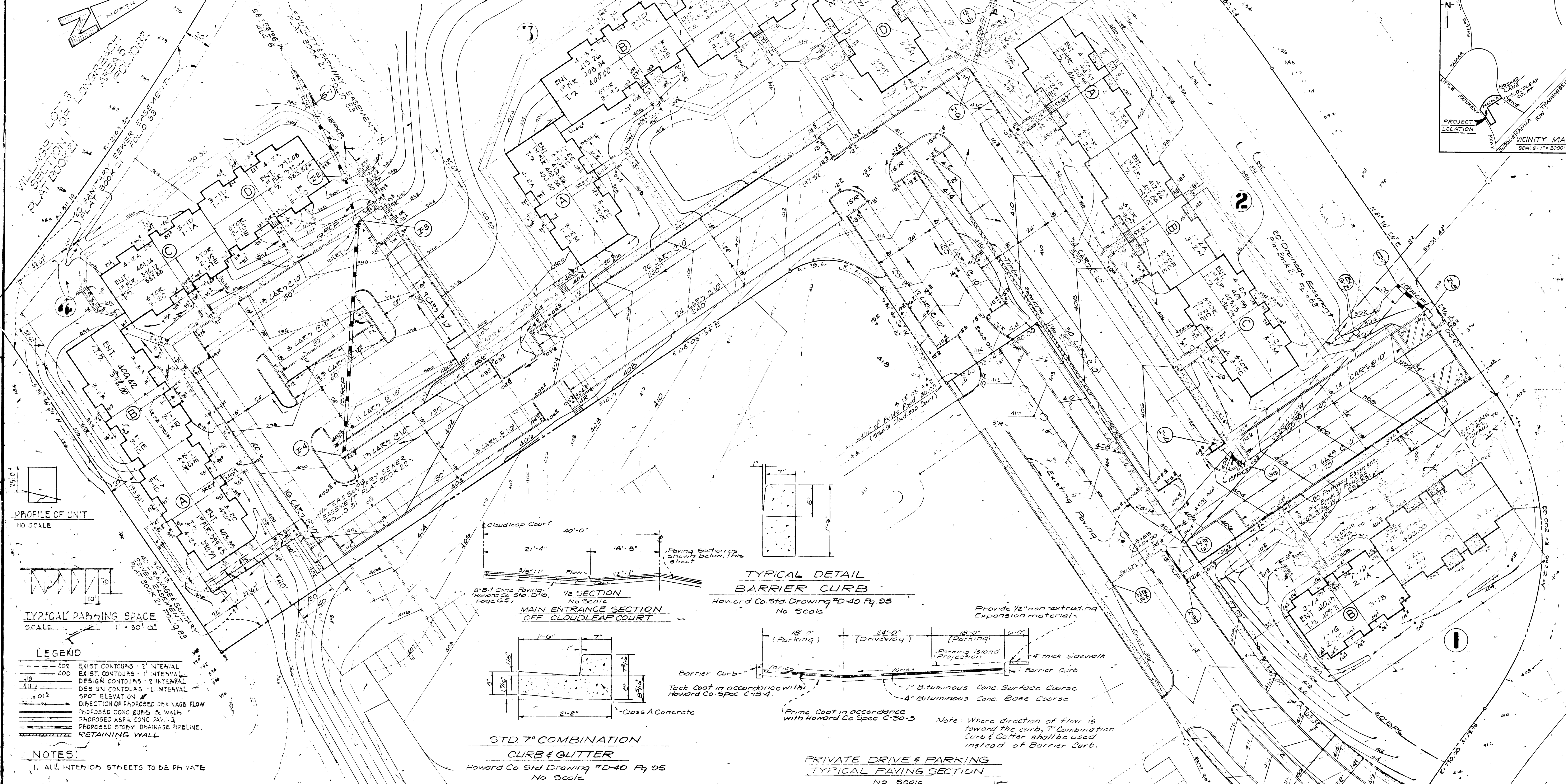

- LEGEND
- 402 EXIST. CONTOURS - 2' INTERVAL
 - 400 EXIST. CONTOURS - 1' INTERVAL
 - DESIGN CONTOURS - 2' INTERVAL
 - DESIGN CONTOURS - 1' INTERVAL
 - SPOT ELEVATION
 - DIRECTION OF PROPOSED DRAINAGE FLOW
 - PROPOSED CONC CURB & WALK
 - PROPOSED ASPHALT CONC PAVING
 - PROPOSED STORM DRAINAGE PIPELINE
 - RETAINING WALL

NOTES:
 1. ALL INTERIOR STREETS TO BE PRIVATE

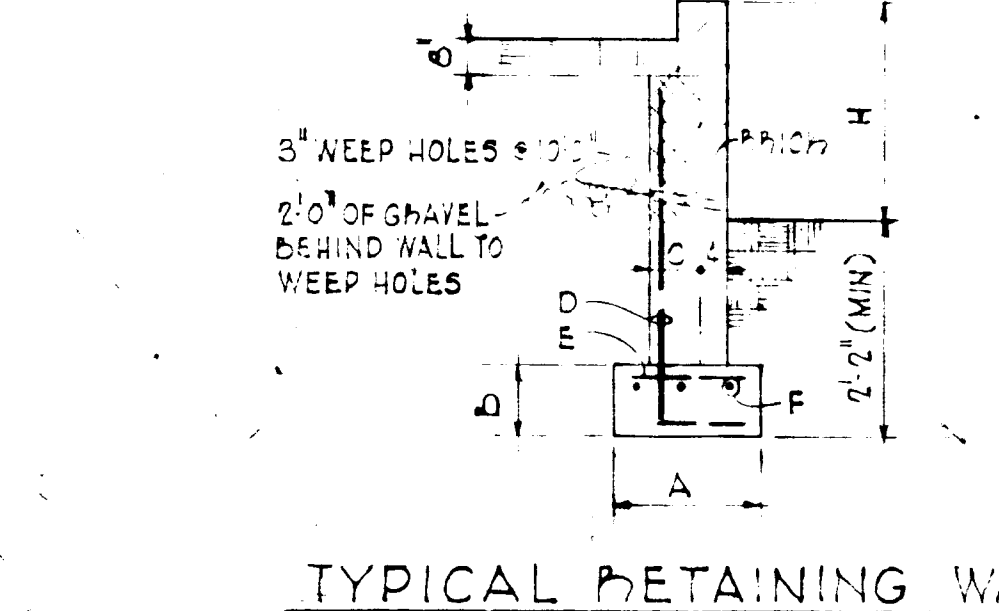
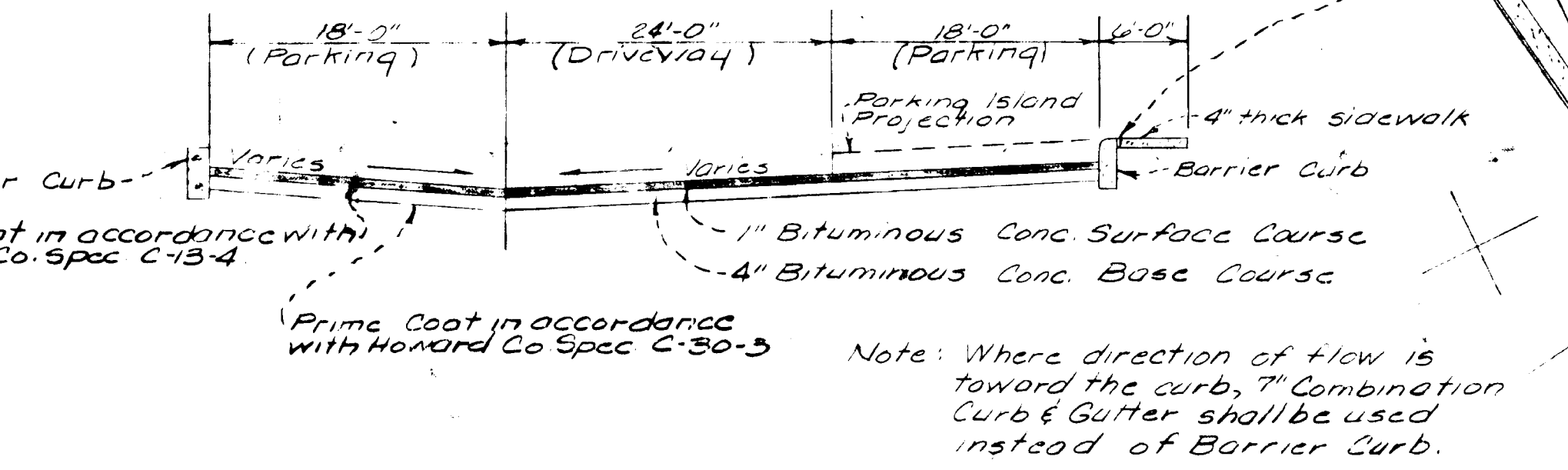
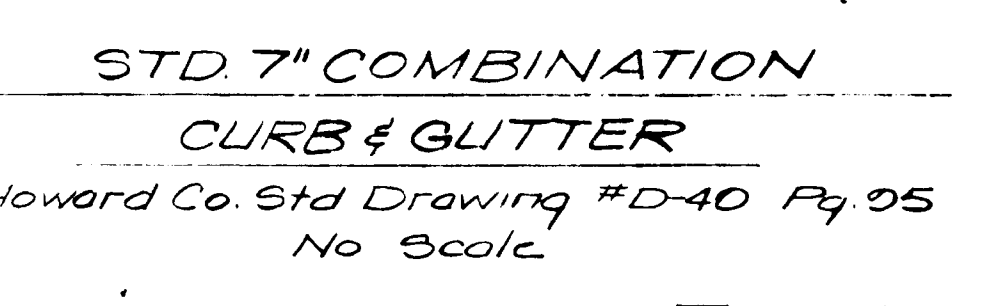
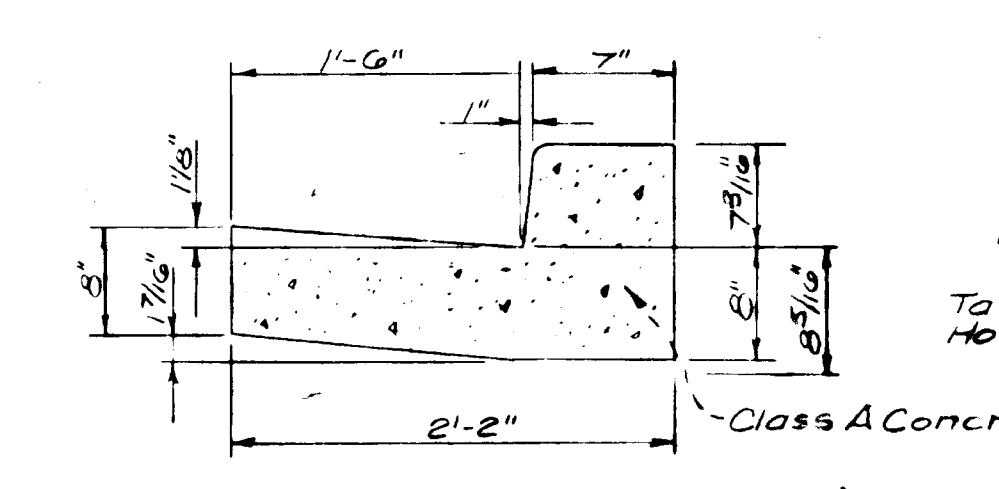
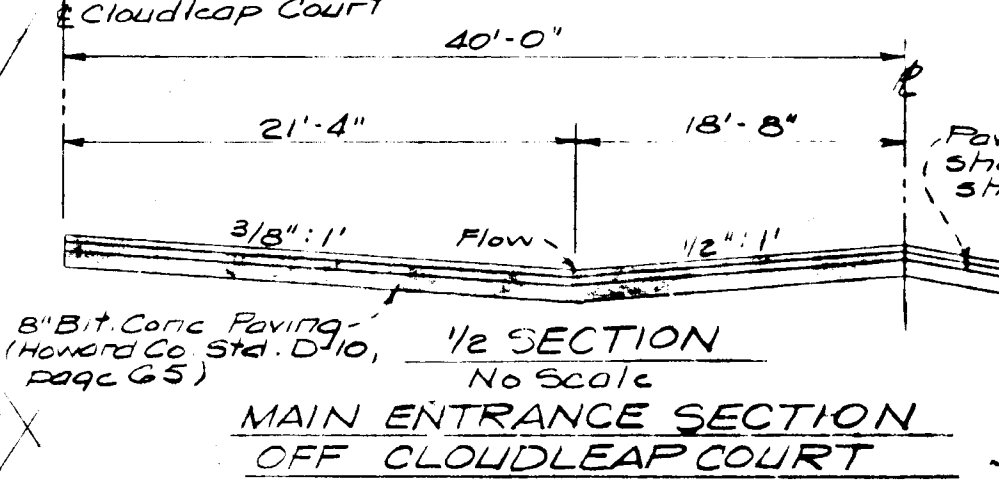

UNIT ANALYSIS - PARCEL 'A' SECT. 1 AREA 5

BDR.	1 BEDROOM		2 BR		2 BR 2B		3 BR		TOTAL
	A	B	C	D	E	F	G	H	
1	3	3	2	1	1	1	5	3	24
2	1	1	1	1	1	1	1	1	43
3	1	3	1	2	1	3	1	1	56
4	5	2	10	4	1	9	1	1	55
TOTAL	11	3	14	5	2	9	3	3	62
%	27.0%		27.0%		34.8%		11.2%		173

RETAINING WALL SCHEDULE

NO.	TYPE	HEIGHT	LENGTH	REMARKS
I	1	4'-0"	10'-0"	SOLID CMU
II	1	4'-0"	10'-0"	HOLLOW CMU
III	1	4'-0"	10'-0"	HOLLOW CMU
IV	1	4'-0"	10'-0"	HOLLOW CMU
V	1	4'-0"	10'-0"	HOLLOW CMU
VI	1	4'-0"	10'-0"	HOLLOW CMU
VII	1	4'-0"	10'-0"	HOLLOW CMU

Revisions

Revisions	Date
CHANGED MAINT. AREA	8/16/73

VILLAGE OF LONGREACH COLUMBIA, MARYLAND
 PARCEL 'A' SECTION 1, AREA 5 VILLAGE OF LONGREACH 6th ELECTION DISTRICT PLAT BOOK 21, FOLIO 83
 OWNERS: LONGREACH ASSOCIATES, 5530 WISCONSIN AVE, CHEVY CHASE, MD 20815, TEL: 952-9555
 ARCHITECTS: COHEN HAFT & ASSOCIATES, 3300 SEDGS AVE, SILVER SPRING, MD 20910, TEL: 952-3900
 SITE PLAN SCALE: 1" = 30' 0"
 Job No. 1576-71
 Date: 27 AUG 73
 A.K. 2 of 8

Cohen Haft and Associates Architects and Planners

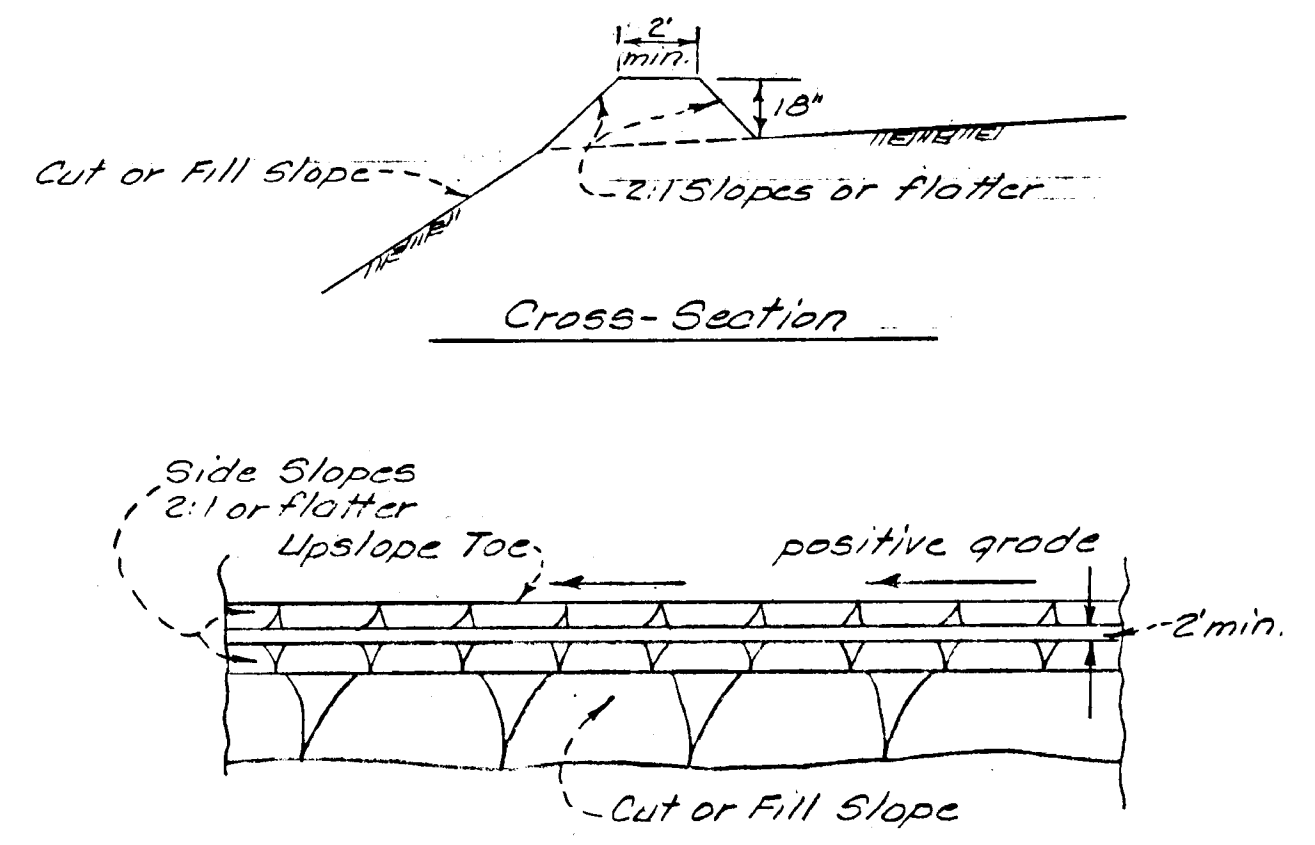

Plan View
DIVERSION BERM
 M.S.C.D. DB-1

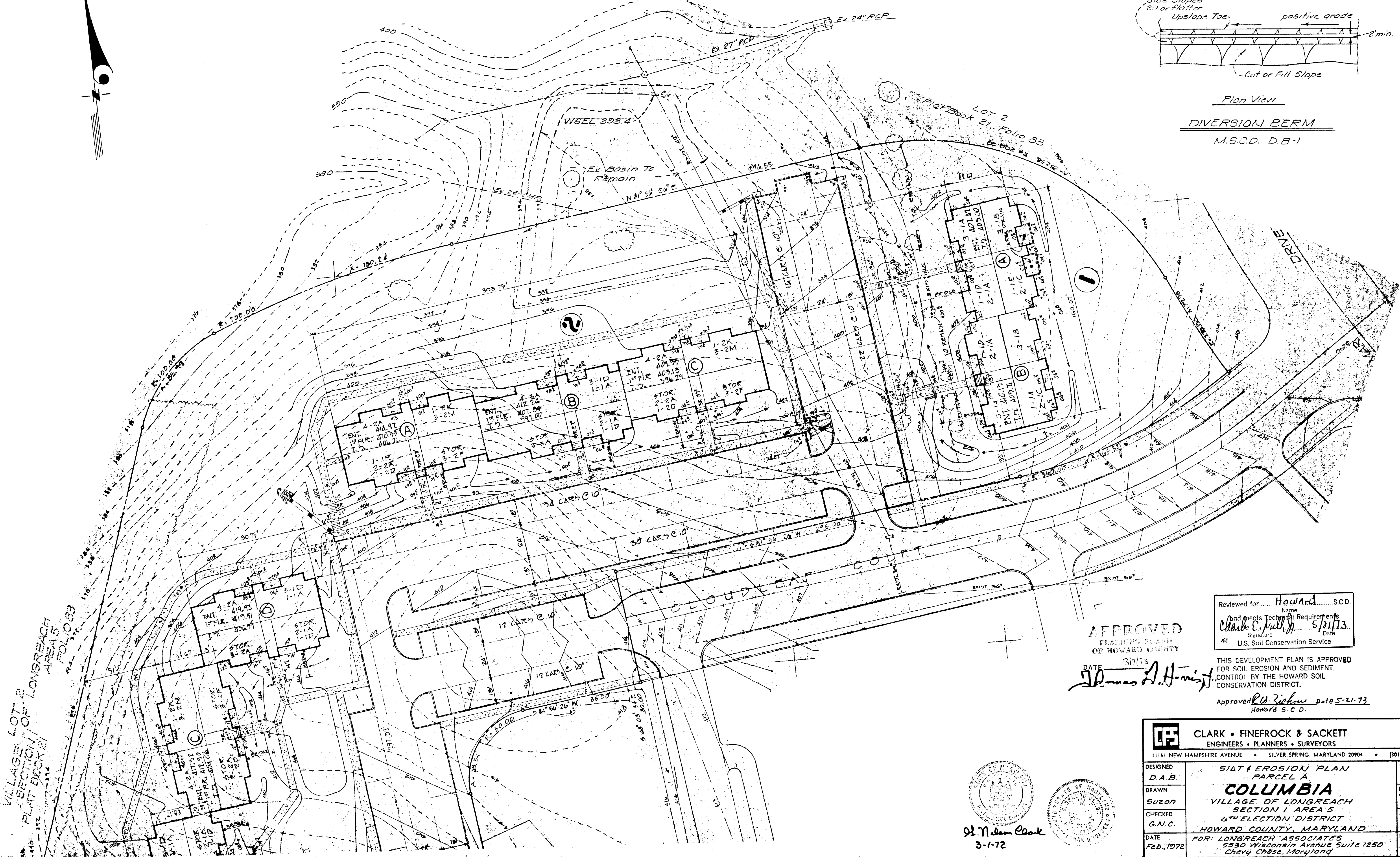
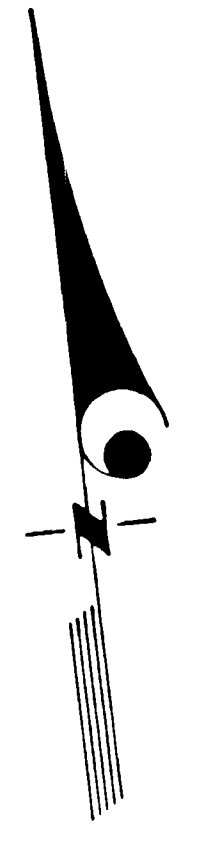

Reviewed for Howard S.C.D.
 Name
 and meets Technical Requirements
Charles E. Miller 5/31/73
 Signature Date
 U.S. Soil Conservation Service

APPROVED
 PLANNING BOARD
 OF HOWARD COUNTY
 DATE 3/1/73
James A. H. Wright

THIS DEVELOPMENT PLAN IS APPROVED
 FOR SOIL EROSION AND SEDIMENT
 CONTROL BY THE HOWARD SOIL
 CONSERVATION DISTRICT.

Approved R.W. Zickler Date 5-21-73
 Howard S.C.D.

CLARK • FINEROCK & SACKETT ENGINEERS • PLANNERS • SURVEYORS 11161 NEW HAMPSHIRE AVENUE • SILVER SPRING, MARYLAND 20904 • (301) 593-3400			
DESIGNED	SILT & EROSION PLAN PARCEL A	SCALE	1" = 30'
DRAWN	COLUMBIA	DRAWING	4-8-8
CHECKED	VILLAGE OF LONGREACH SECTION 1 AREA 5	JOB NO.	70-314
G.N.C.	6TH ELECTION DISTRICT HOWARD COUNTY, MARYLAND	FILE NO.	1048-D
DATE	FOR: LONGREACH ASSOCIATES 5530 Wisconsin Avenue Suite 1250 Chevy Chase, Maryland		

St. Nelson Clark
 3-1-72

Plan Scale: 1"=30'

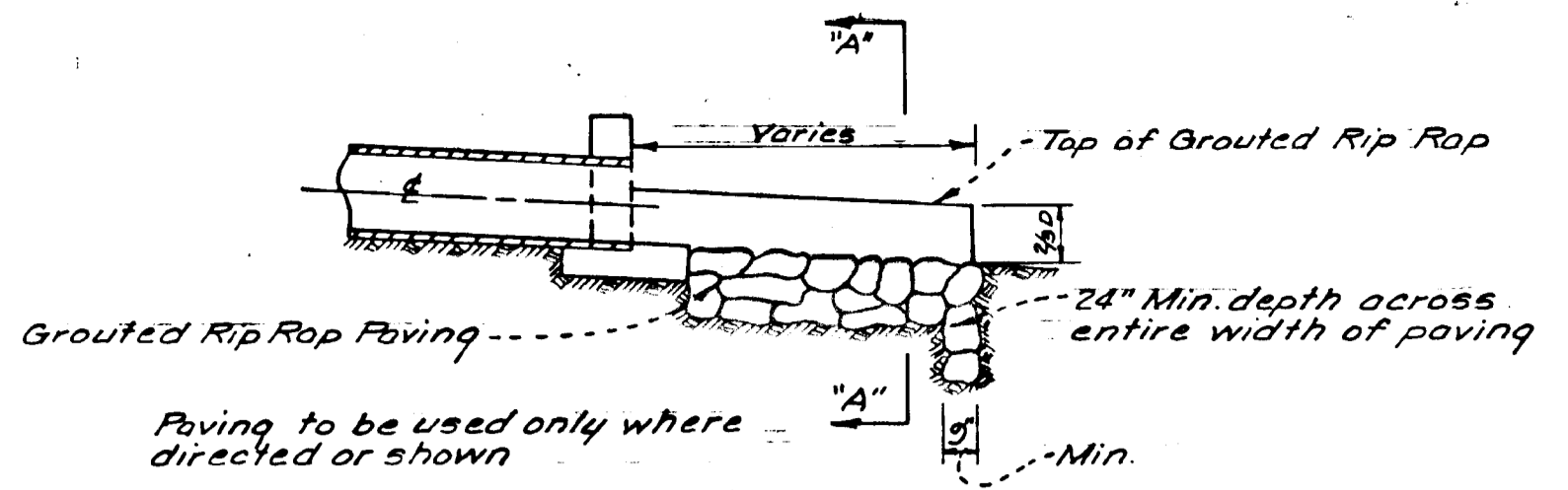
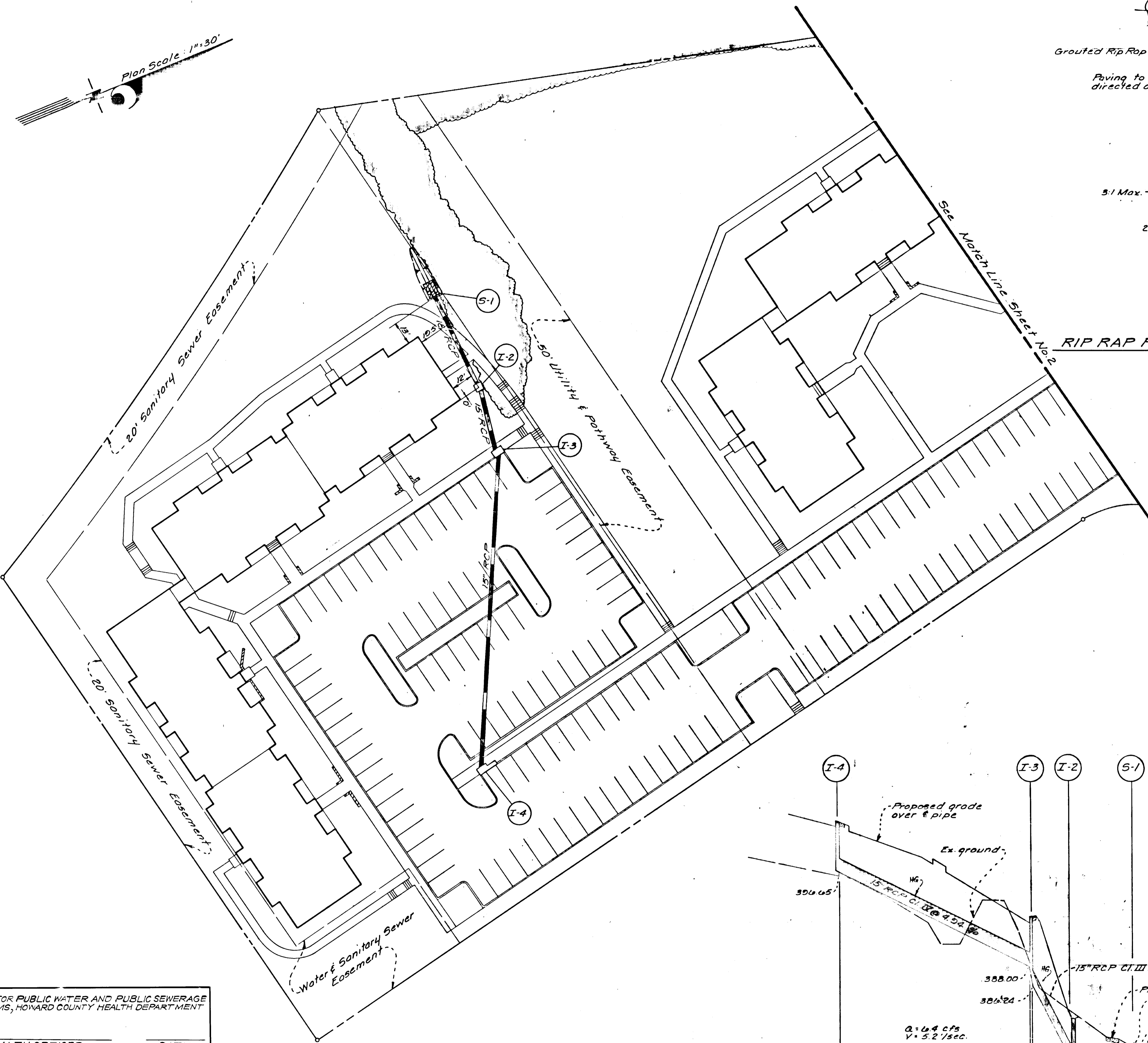

SECTION "B-B"

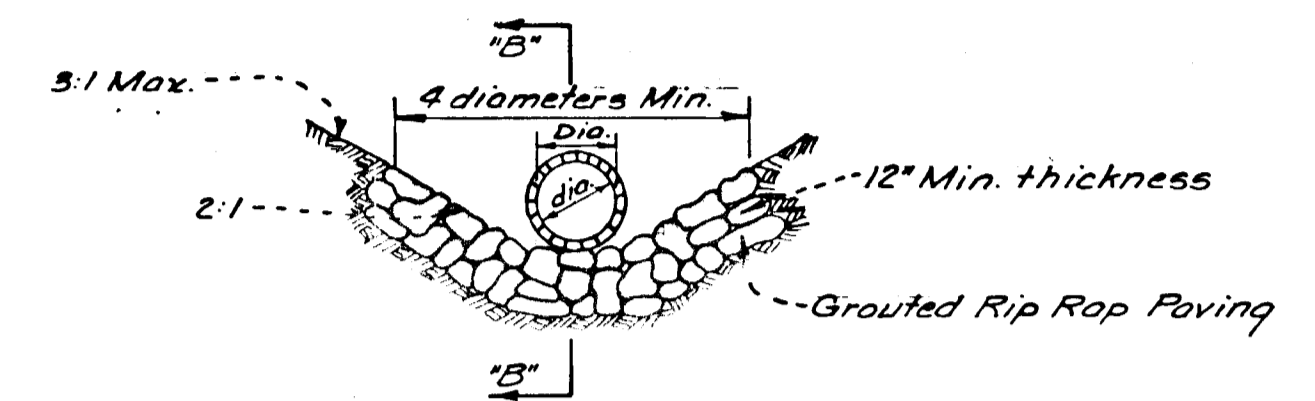

SECTION "A-A"

RIP RAP PAVING DETAIL FOR STRUCTURE Nos. S-1 & S-2
No Scale

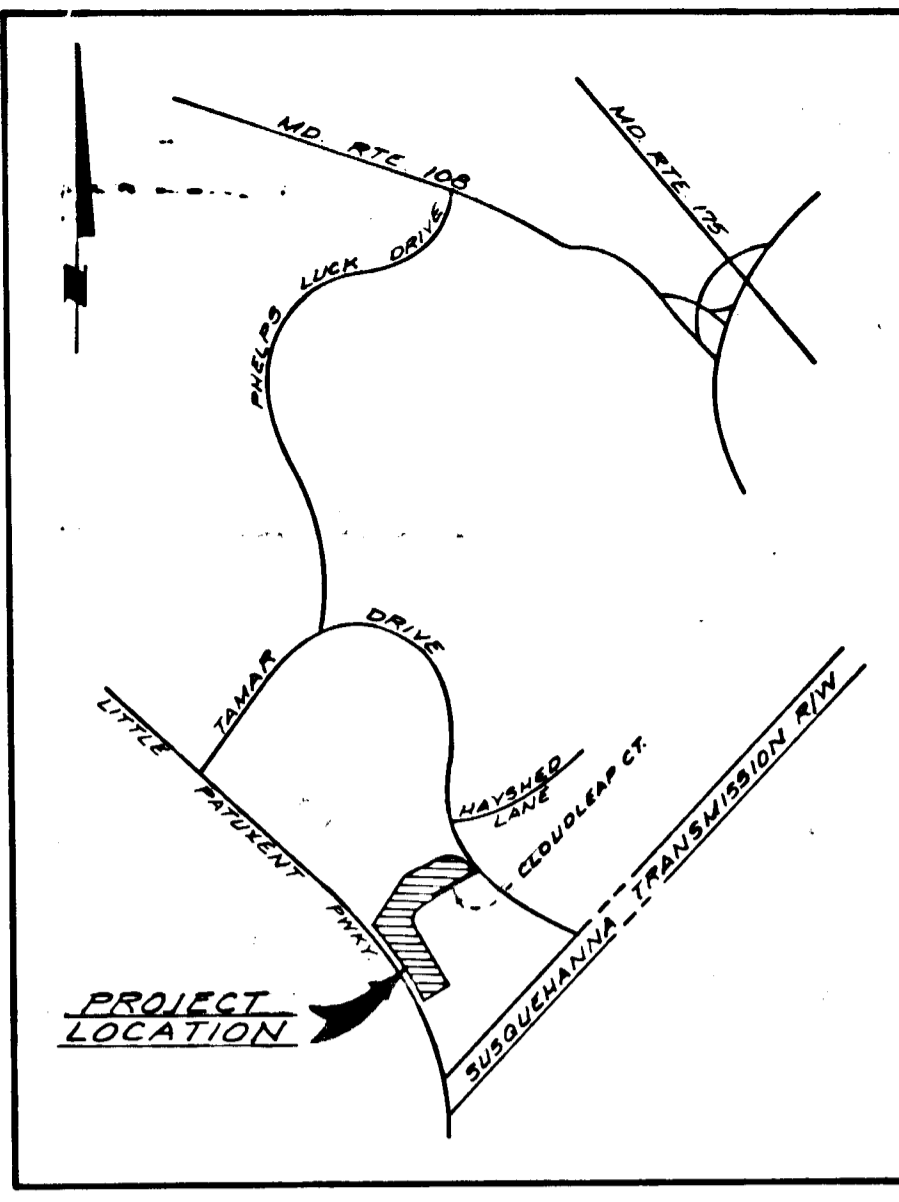

VICINITY MAP
Scale: 1"=2000'

STRUCTURE SCHEDULE				
NO.	TYPE	TOP ELEV.		REMARKS
		UPPER	LOWER	
S-1	C-Endwall			Howard Co Std. D=18"
I-2	E-Inlet	383.10		W.S.C. Std. 2'-4"x2'-6"
I-3	A-5 Inlet	392.50	392.50	Howard Co Std. W=2'-6"
I-4	B-10 Inlet	401.20	401.20	Howard Co Std. W=2'-6"
S-5	C-Endwall			Howard Co Std. D=15"
I-4	A-5 Inlet	409.50	409.50	Howard Co Std. W=2'-6"
CI-7	Cut-In			15" x 42"
I-8	A-5 Inlet	395.10	395.50	Howard Co Std. W=2'-6"
JB-9	Junction Box			Howard Co Std. 44"x44"
I-10	A-5 Inlet	404.50	404.50	Howard Co Std. W=2'-6"
I-30	A-5 Inlet	406.02	405.84	" " " "

PIPE SCHEDULE		
SIZE	TYPE	LENGTH
15"	RCP CI. V	31'
15"	RCP CI. III	108'
15"	RCP CI. IV	190'
18"	RCP CI. III	53'

GENERAL NOTES

- All storm drainage and paving shall be constructed in accordance with the latest details and specifications of Howard County.
- Types of Storm Drain Structures refer to the Standard Details of Howard County, unless otherwise indicated.
- Trench compaction for storm drains within road or street right of way limits shall be in accordance with the latest Howard County Road Code.

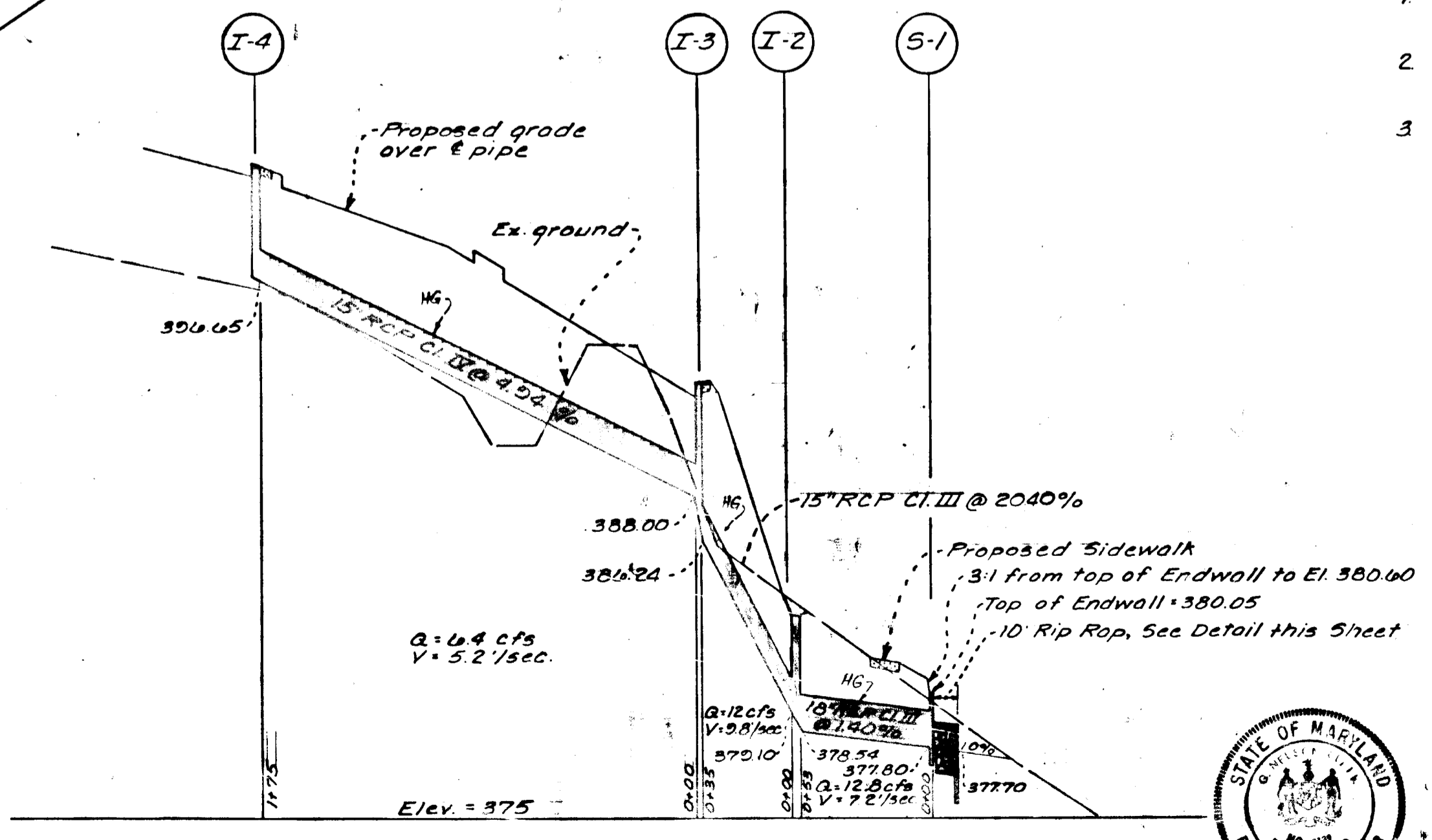

PROFILE
Scale: Horz. 1"=50'
Vert. 1"=5'

3/1/73
John J. Harris, Jr.

APPROVED: FOR PUBLIC WATER AND PUBLIC SEWERAGE SYSTEMS, HOWARD COUNTY HEALTH DEPARTMENT

COUNTY HEALTH OFFICER _____ DATE _____

APPROVED: HOWARD COUNTY OFFICE OF PLANNING / ZONING

PLANNING DIRECTOR _____ DATE _____

CHIEF DIVISION OF LAND DEVELOPMENT AND TRANSPORTATION PLANNING _____ DATE _____

APPROVED: FOR PUBLIC WATER AND PUBLIC SEWERAGE, STORM DRAINAGE SYSTEMS AND PUBLIC ROADS, HOWARD COUNTY DEPARTMENT OF PUBLIC WORKS

DIRECTOR _____ DATE _____

CHIEF BUREAU OF HIGHWAYS _____ DATE _____

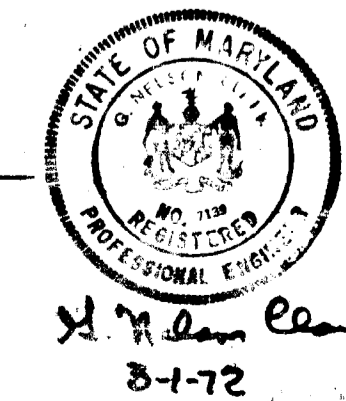

CLARK • FINEFROCK & SACKETT
ENGINEERS • PLANNERS • SURVEYORS
11161 NEW HAMPSHIRE AVENUE • SILVER SPRING, MARYLAND 20904 • (301) 593-3400

DESIGNED: D.A.B.
DRAWN: Suzon
CHECKED: G.N.C.
DATE: Feb, 1972

STORM DRAINAGE PLAN
PARCEL "A"
COLUMBIA
VILLAGE OF LONGREACH
SECTION 1 AREA 5
6TH ELECTION DISTRICT
HOWARD COUNTY, MARYLAND

SCALE: As Shown
DRAWING: 5-1-8
JOB NO.: 70-514
FILE NO.: 1046-D

FOR: LONGREACH ASSOCIATES
5530 Wisconsin Avenue, Suite 1250
Chevy Chase, Maryland 20812

Bench Mark #1 - El. 406.16
Cut nail in 24" Walnut

APPROVED FOR PUBLIC WATER AND PUBLIC SEWERAGE SYSTEMS, HOWARD COUNTY HEALTH DEPARTMENT
 COUNTY HEALTH OFFICER *Alphazam M.D.* DATE 6/4/72
 APPROVED: HOWARD COUNTY OFFICE OF PLANNING & ZONING
 PLANNING DIRECTOR *Thomas L. Harp* DATE 6-2-72
 CHIEF DIVISION OF LAND DEVELOPMENT AND TRANSPORTATION PLANNING
 DATE 6-12-72
 APPROVED FOR PUBLIC WATER AND PUBLIC SEWERAGE, STORM DRAINAGE SYSTEMS AND PUBLIC ROADS
 HOWARD COUNTY DEPARTMENT OF PUBLIC WORKS
 DIRECTOR *William U. Miller* DATE 6-12-72
 CHIEF BUREAU OF HIGHWAYS *W. J. Wood* DATE 6-7-72

Plan Scale: 1"=50'

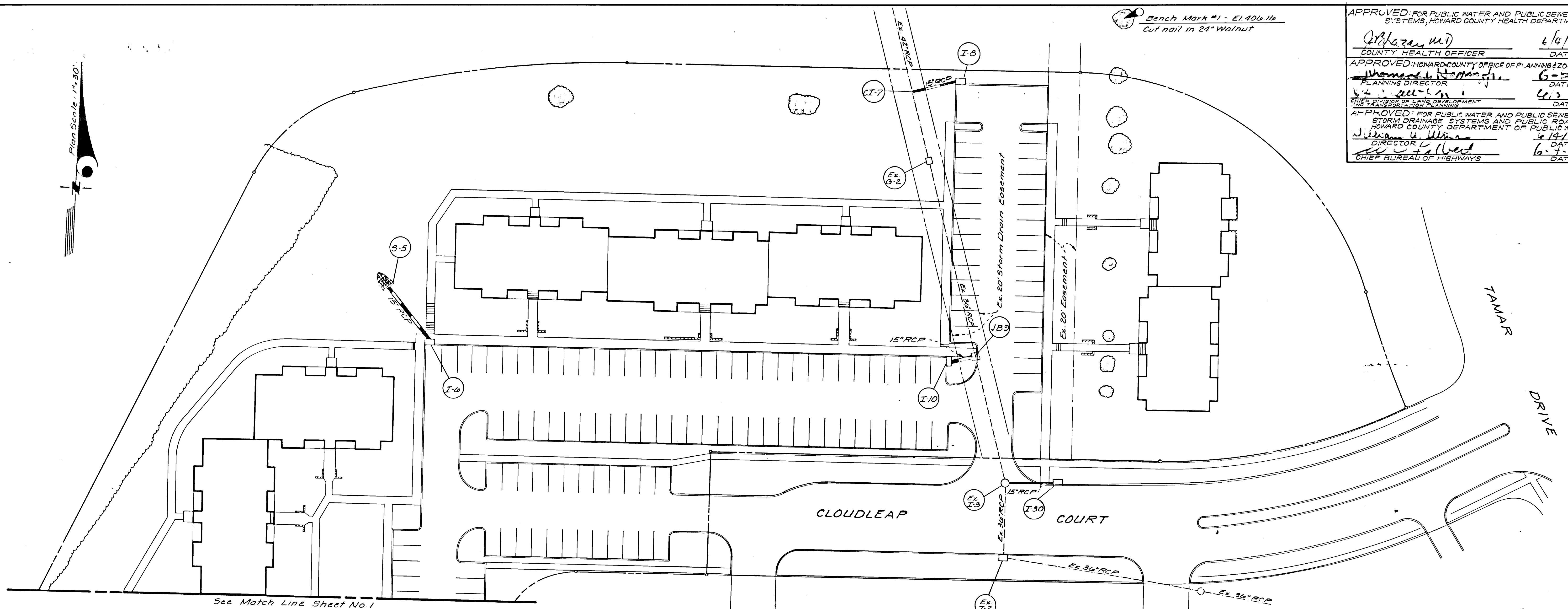

See Match Line Sheet No. 1

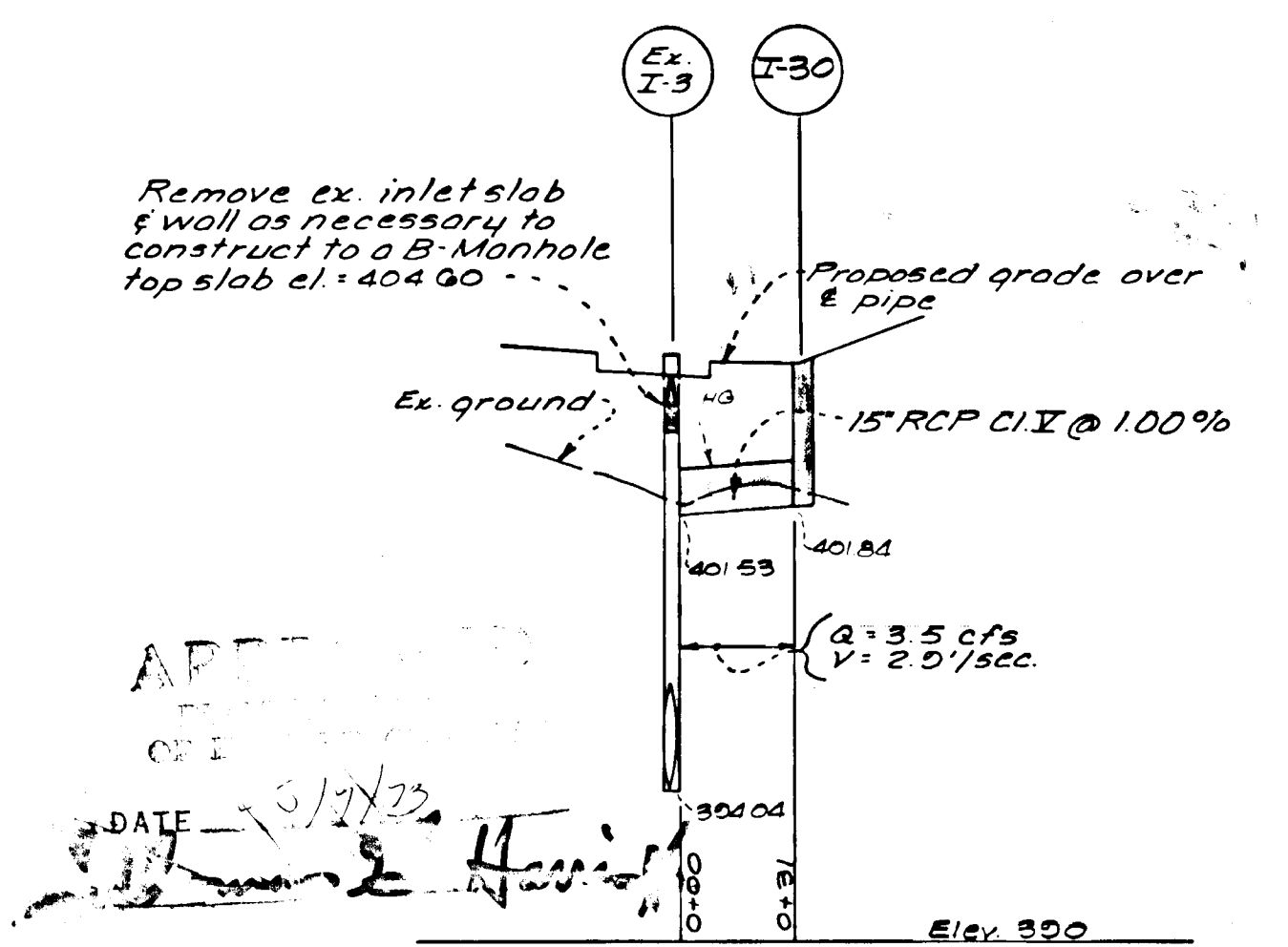
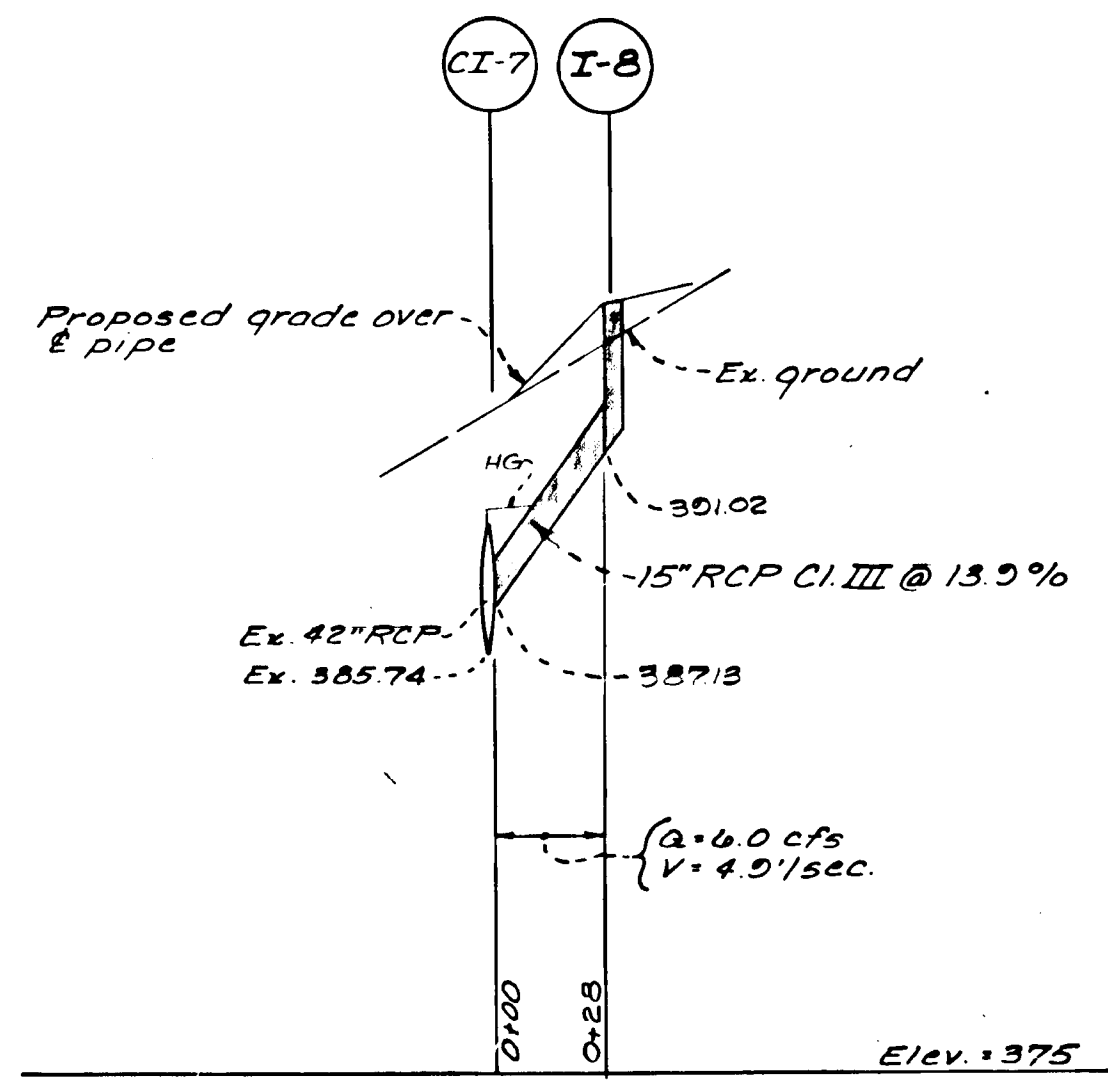
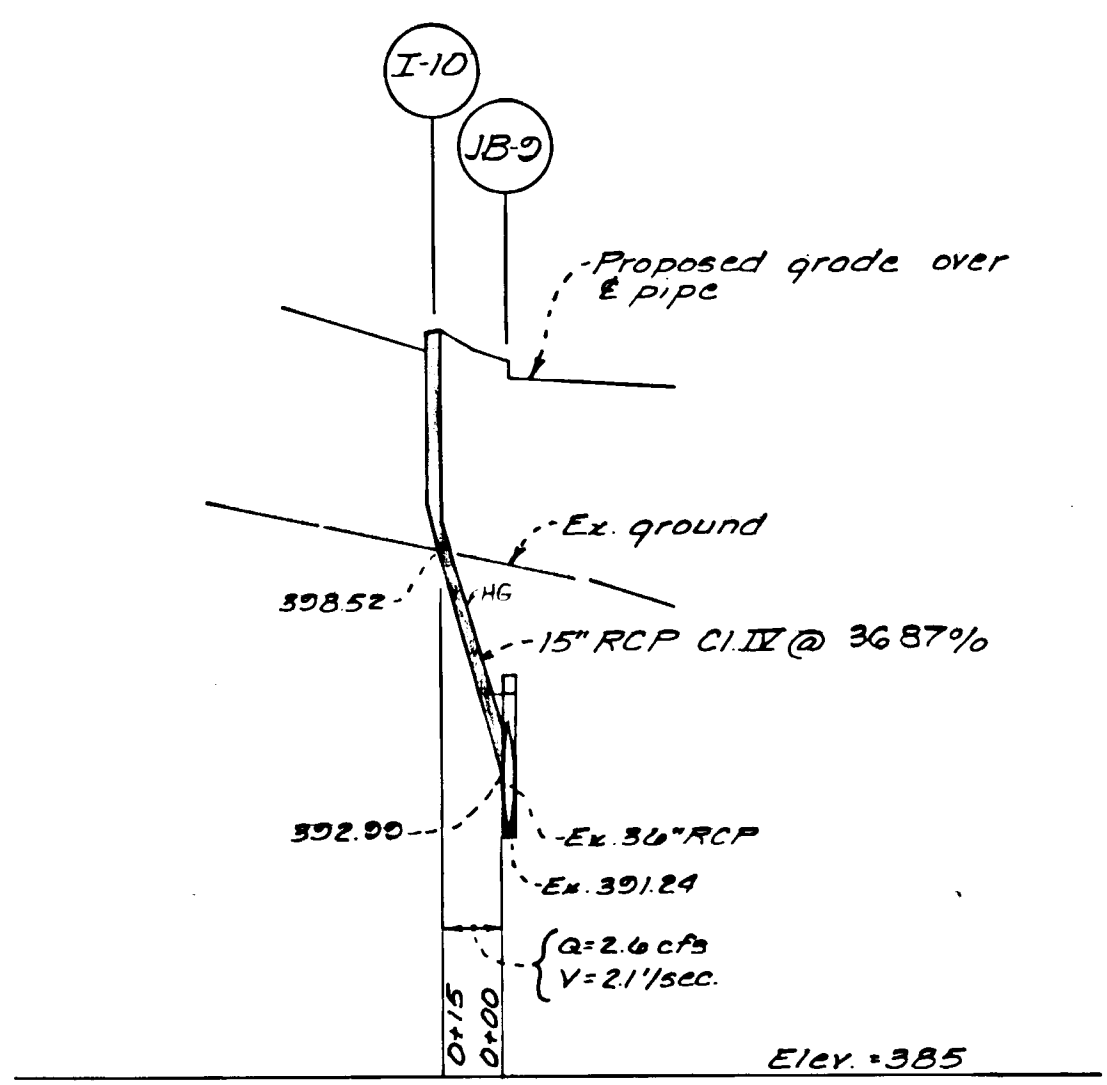
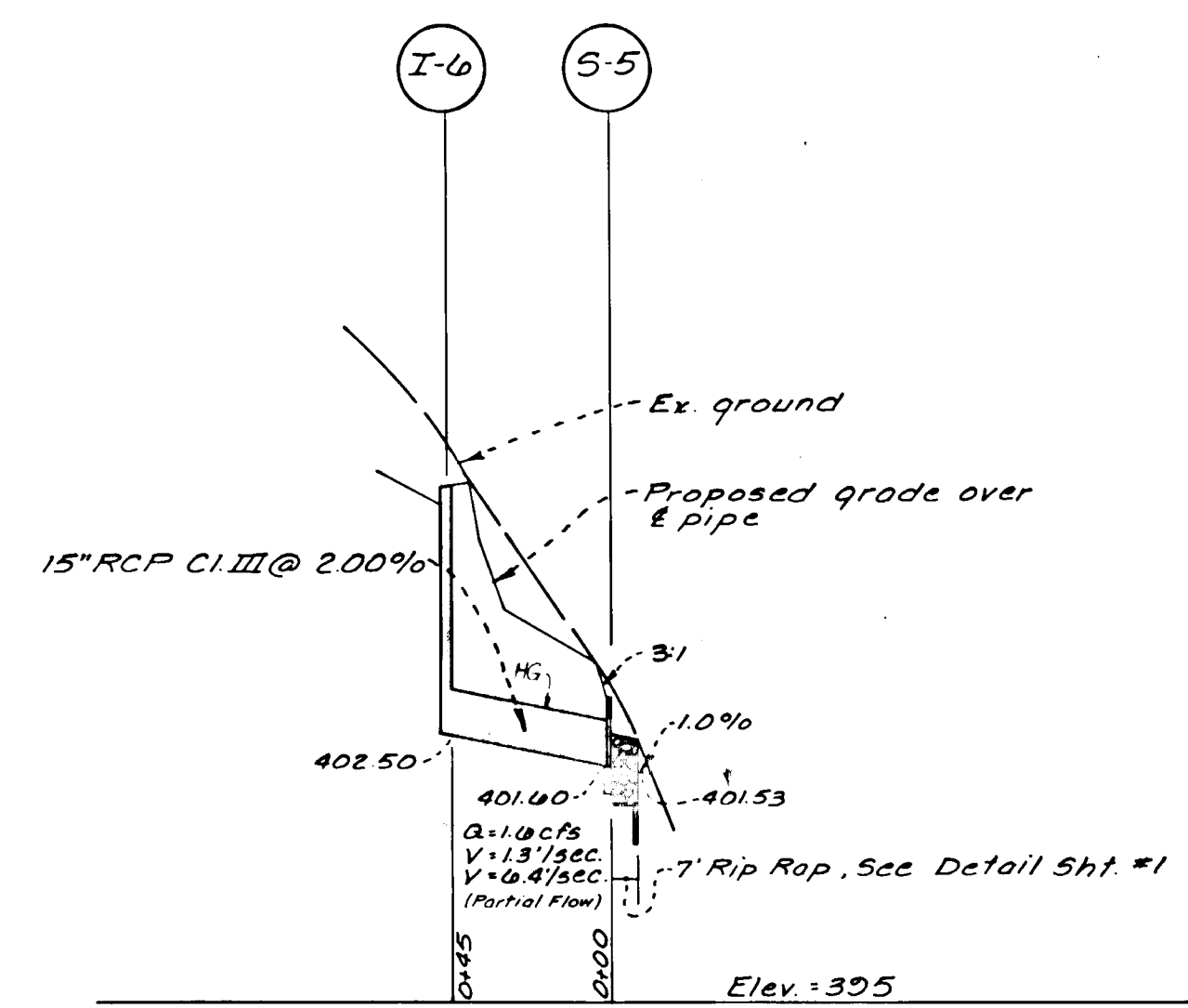

PROFILES
Scale: Horz. 1"=50'
Vert. 1"=5'

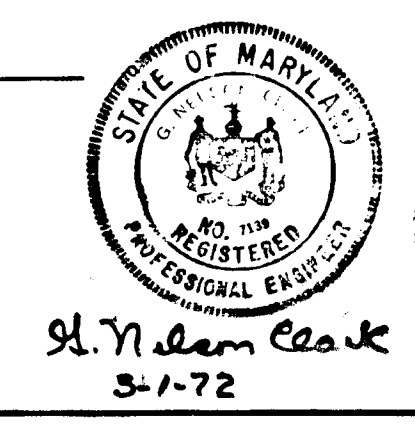

CLARK • FINEFROCK & SACKETT ENGINEERS • PLANNERS • SURVEYORS 11161 NEW HAMPSHIRE AVENUE • SILVER SPRING, MARYLAND 20904 • (301) 593-3400		
DESIGNED D.A.B.	STORM DRAINAGE PLAN PARCEL "A" COLUMBIA VILLAGE OF LONGREACH SECTION I AREA 5 6TH ELECTION DISTRICT HOWARD COUNTY, MARYLAND FOR: LONGREACH ASSOCIATES 3530 WISCONSIN AVENUE SUITE 1250 Chevy Chase, Maryland 20012	SCALE As shown
DRAWN Suzon		DRAWING P-1-8
CHECKED G.A.C.	FILE NO. 70-318	
DATE Feb., 1972	FILE NO. 1046-D	

APPROVED: FOR PUBLIC WATER AND PUBLIC SEWERAGE SYSTEMS, HOWARD COUNTY HEALTH DEPARTMENT

Christopher M. D... 6.4.73
COUNTY HEALTH OFFICER DATE

APPROVED: HOWARD COUNTY OFFICE OF PLANNING & ZONING

Thomas A. Harris, Jr. 6-5-73
PLANNING DIRECTOR DATE

... 6.5.73
CHIEF, DIVISION OF LAND DEVELOPMENT AND TRANSPORTATION PLANNING DATE

APPROVED: FOR PUBLIC WATER AND PUBLIC SEWERAGE STORM DRAINAGE SYSTEMS AND PUBLIC ROADS, HOWARD COUNTY DEPARTMENT OF PUBLIC WORKS

William A. Altman 6.4.73
DIRECTOR DATE

W. O. Albert 6.4.73
CHIEF, BUREAU OF HIGHWAYS DATE

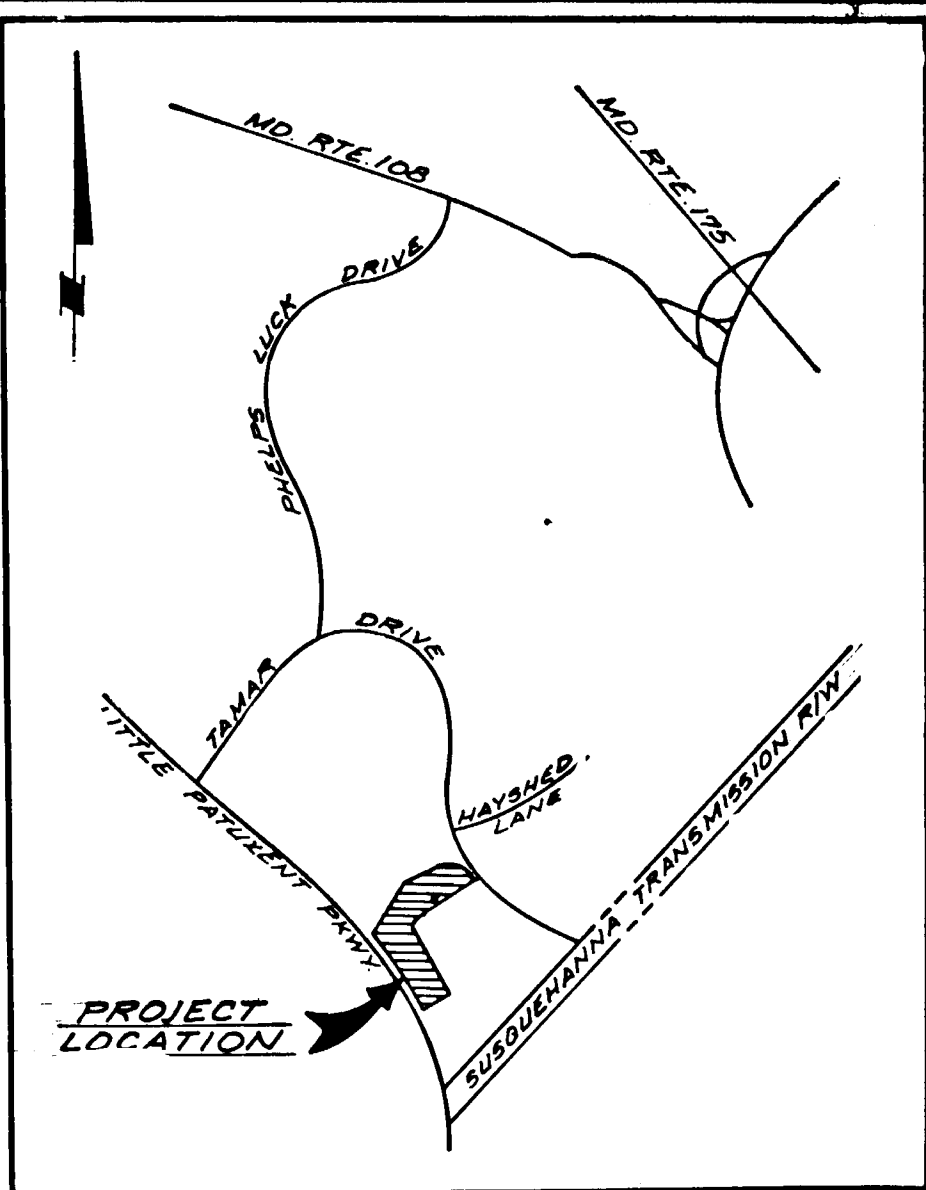

VICINITY MAP
Scale: 1"=2000'

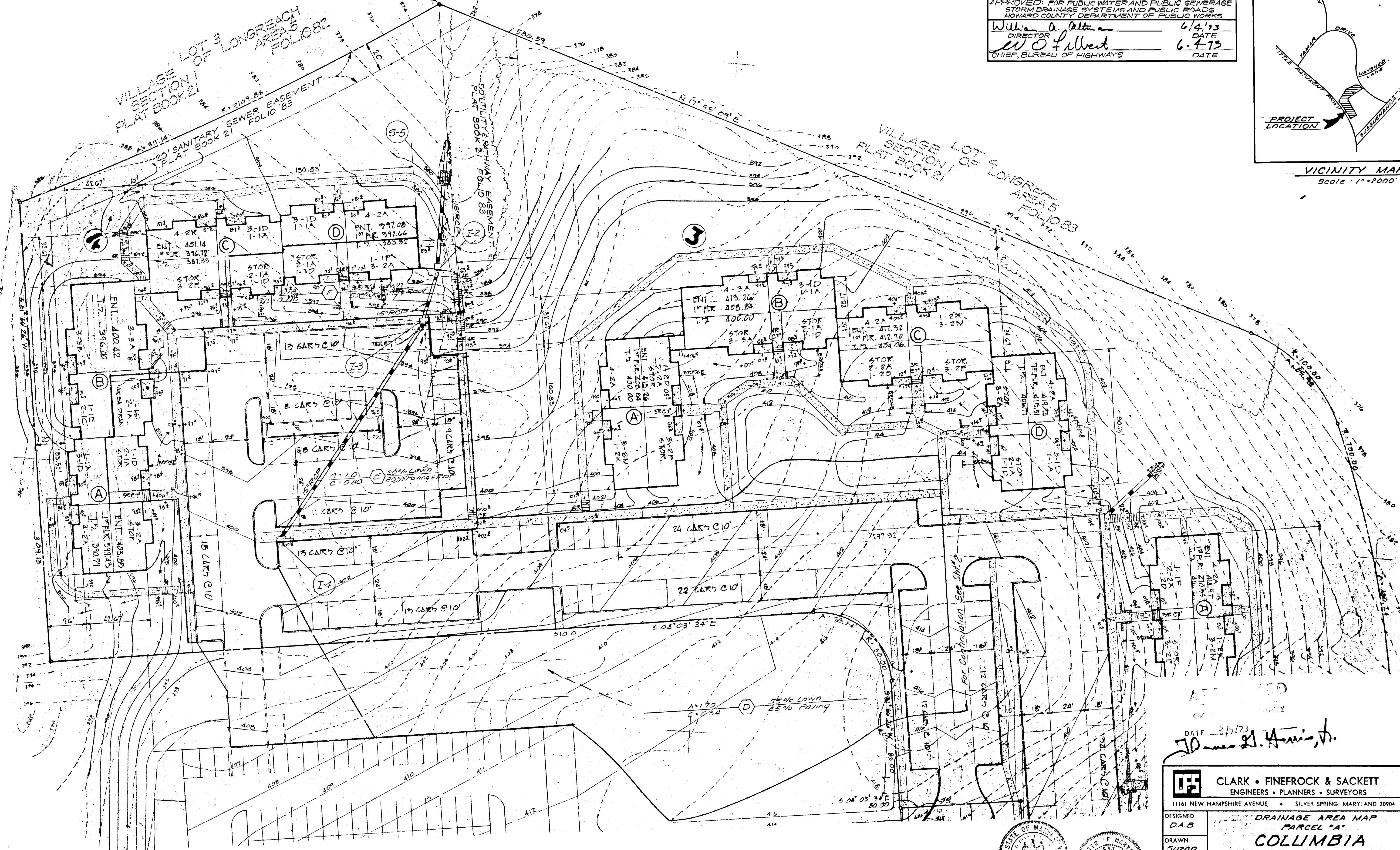
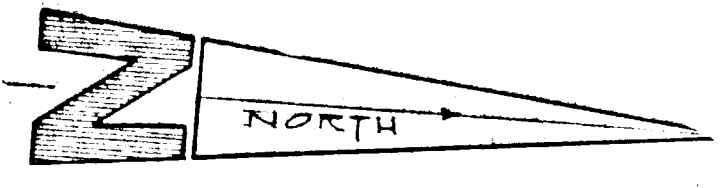

DATE 3/1/73
Thomas A. Harris, Jr.

CLARK • FINEROCK & SACKETT ENGINEERS • PLANNERS • SURVEYORS 11161 NEW HAMPSHIRE AVENUE • SILVER SPRING, MARYLAND 20904 • (301) 593-3400		
DESIGNED D.A.B.	DRAINAGE AREA MAP PARCEL "A"	SCALE 1"=30'
DRAWN Suzon	COLUMBIA VILLAGE OF LONGREACH SECTION 1 AREA 5 6TH ELECTION DISTRICT	DRAWING 18 of 2 7 of 8 JOB NO. 70-318
CHECKED G.N.C.	HOWARD COUNTY, MARYLAND	FILE NO. 1847-D
DATE Feb, 1972	FDR LONGREACH ASSOCIATES 5530 Wisconsin Avenue Suite 1250 Chevy Chase, Maryland	

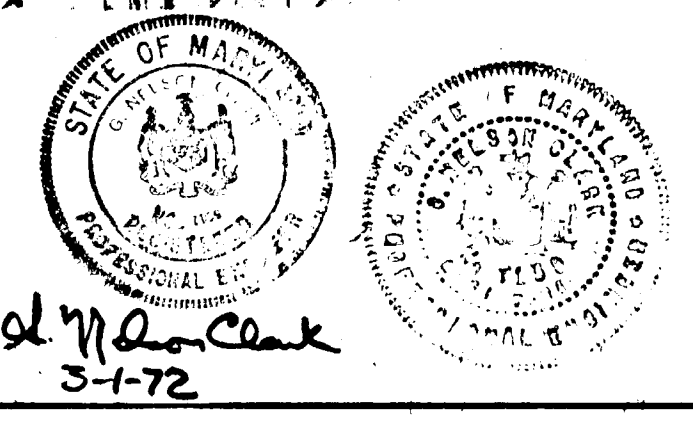

Wm. O. Albert
3-1-72

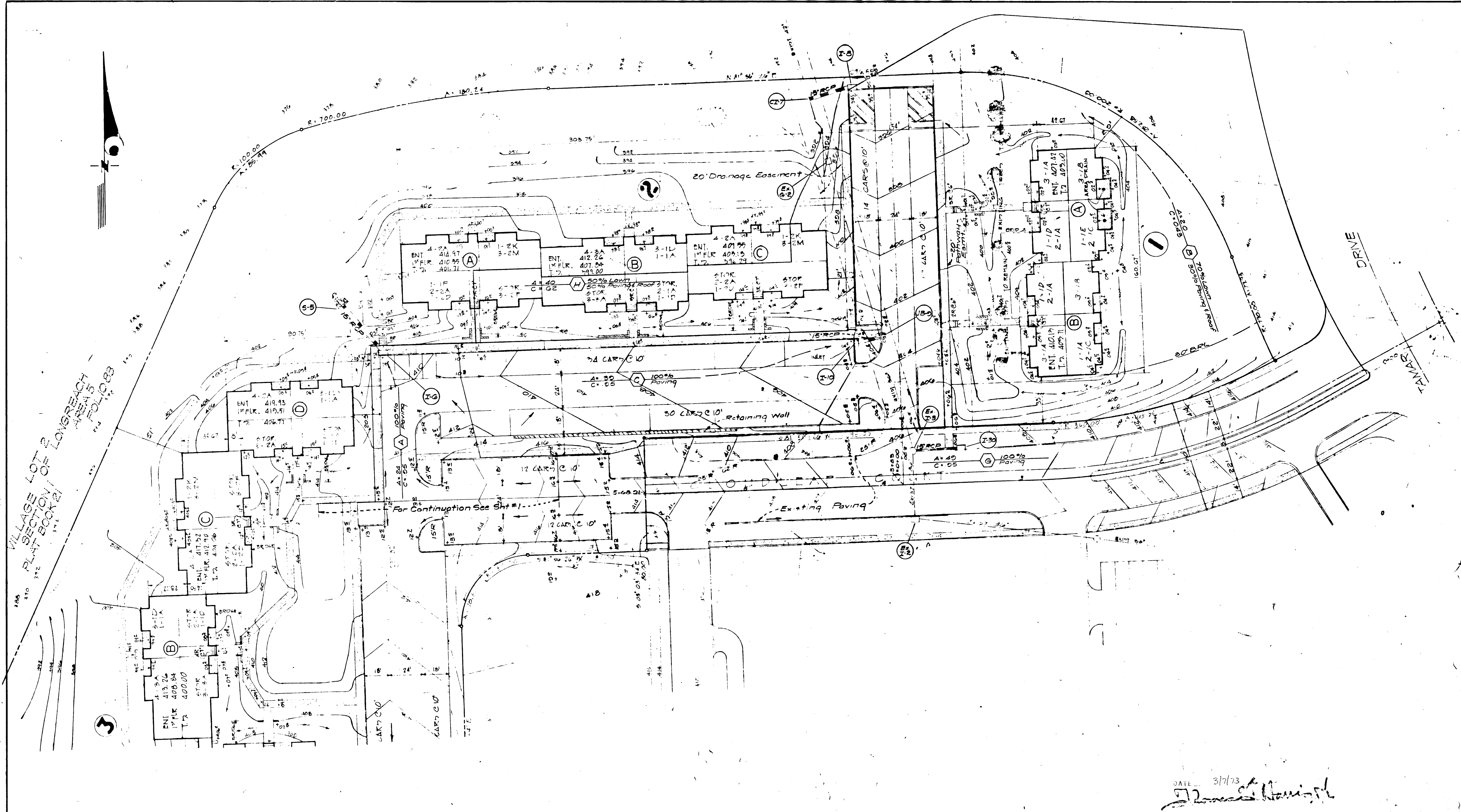

VILLAGE LOT 2
SECTION I AREA 5
PLAT BOOK 21
FOLIO 88

APPROVED FOR PUBLIC WATER AND PUBLIC SEWERAGE SYSTEMS, HOWARD COUNTY HEALTH DEPARTMENT

COUNTY HEALTH OFFICER _____ DATE _____

APPROVED HOWARD COUNTY OFFICE OF PLANNING & ZONING

PLANNING DIRECTOR _____ DATE _____

CHIEF DIVISION OF LAND DEVELOPMENT AND TRANSPORTATION PLANNING _____ DATE _____

APPROVED FOR PUBLIC WATER AND PUBLIC SEWERAGE, STORM DRAINAGE SYSTEMS AND PUBLIC ROADS, HOWARD COUNTY DEPARTMENT OF PUBLIC WORKS

DIRECTOR _____ DATE _____

CHIEF BUREAU OF HIGHWAYS _____ DATE _____

DATE 3/7/73
Thomas Hamilton



St. Adam Clark
12-6-72

Revised Dec. 1972

CLARK • FINEROCK & SACKETT ENGINEERS • PLANNERS • SURVEYORS 11161 NEW HAMPSHIRE AVENUE • SILVER SPRING, MARYLAND 20904 • (301) 593-1400		SCALE 1" = 50'
DESIGNED D.A.B.	DRAINAGE AREA MAP PARCEL "A" COLUMBIA VILLAGE OF LONGREACH SECTION I AREA 5 6TH ELECTION DISTRICT HOWARD COUNTY, MARYLAND	DRAWING 301-2
DRAWN SUZON		JOB NO. 70-314
CHECKED G.N.C.	FOR LONGREACH ASSOCIATES 5530 Wisconsin Avenue Chevy Chase, Maryland	FILE NO. 1047-D
DATE Feb. 1972		

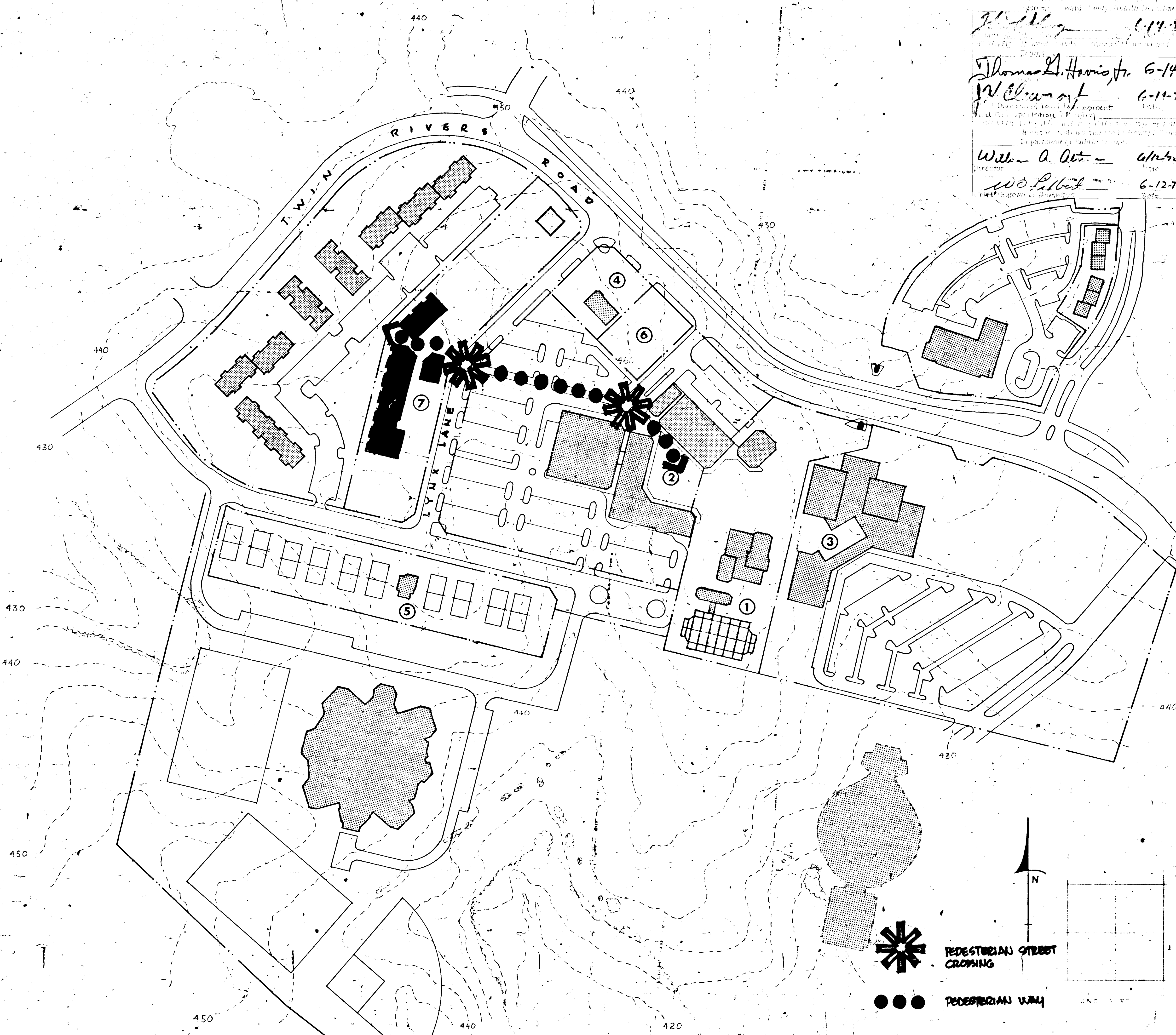

Thomas G. Harris, Jr. 6-14-72
 J. W. Clouse, Jr. 6-11-72
 William A. Ott 6/14/72
 W. O. Felber 6-12-72

DATA

NO	USE	ACRE	PARKING	BLDG. #
①	C.A.	2.93		
②	C.D.C.	6.33		
③	R.F.C.	10.07		
④	SER. SH.	5.71		
⑤	TENNIS	2.82		
⑥	C.D.C.	4.62		
⑦	C.D.C.	2.63		

C.A. ACTIVITIES

ASSEMBLY BLDG.	10,158	#
POOL & PARTY HOUSE	14,354	#
TENNIS	2.82	AC.
LEISURE	2,411	#

OFFICE

C.D.C. ACTIVITIES

SUPERMARKET	20,450	#
W. HOUSE	5,015	#
W. HOUSE	4,400	#
W. HOUSE	2,400	#
W. HOUSE	3,700	#
W. HOUSE	1,700	#
PATCHED HOUSE	800	#
W. HOUSE	1,500	#
W. HOUSE	1,100	#
CANDY STORE	3,400	#
W. HOUSE	6,700	#
W. HOUSE	1,700	#
W. HOUSE	1,450	#
W. HOUSE	1,510	#
W. HOUSE	1,100	#
W. HOUSE	1,020	#
W. HOUSE	800	#

APPROVED
 PLANNING BOARD
 OF HOWARD COUNTY
 DATE 5-3-72
 Thomas G. Harris, Jr.

Rev Date	Rev No	Revision Description

COLUMBIA
 MARYLAND
OWNER AND DEVELOPER
 HOWARD RESEARCH AND DEVELOPMENT CORP.
THE VILLAGE OF CROSS CREEK - BALTIMORE, MARYLAND 21210
 PROJECT AREA
WILDE LAKE VILLAGE CENTER
 PROJECT TITLE
C.D.C., C.A., R.F.C., SCH., APTS.

Des By	Scale 1" = 100'	Dwg No
Drn By L. B.	Date 5-19-69	C.C.F. No
Chk By	Approved	