

DETAIL OF RECTANGULAR MANHOLES

GENERAL NOTES FOR WATER & SEWER

1. Approximate location of existing mains are shown. The Contractor shall take all necessary precautions to protect existing mains and services and maintain uninterrupted supply. Any damage incurred shall be repaired immediately.
2. All elevations shown are invert elevations.
3. The Contractor shall locate existing utilities a minimum of 2 weeks in advance of construction operations in vicinity of utilities.
4. All water mains to have a minimum 3 1/4' cover.
5. All rims shall be set to finished grade.
6. All sewer mains shall have a minimum 5' cover.
7. All sewer pipe shall be C.S. EX, V.C. EX or A.C. P Class 2400.
8. The Contractor shall provide a joint in all sewer mains within 2'-0" of exterior manhole walls.

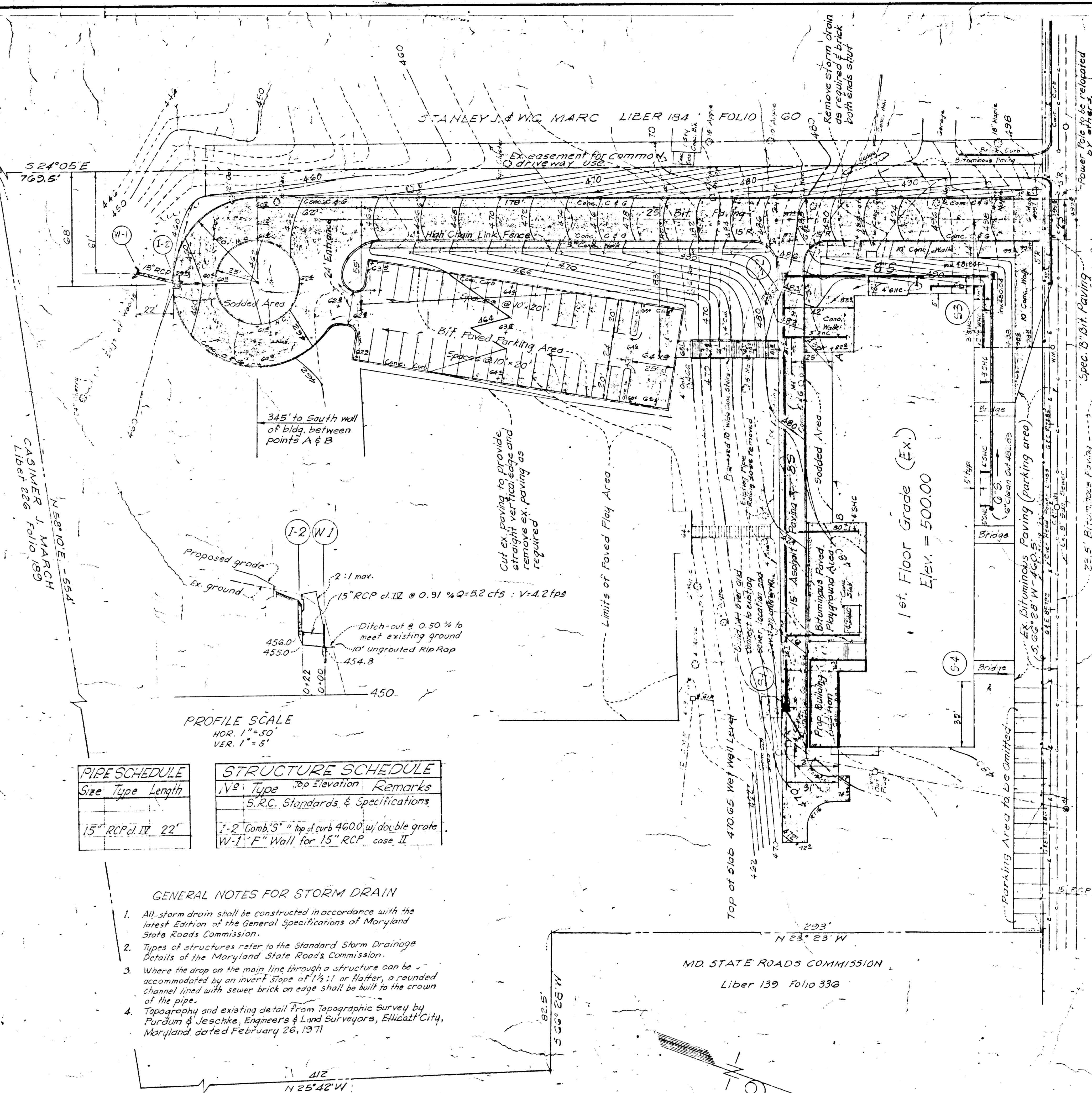
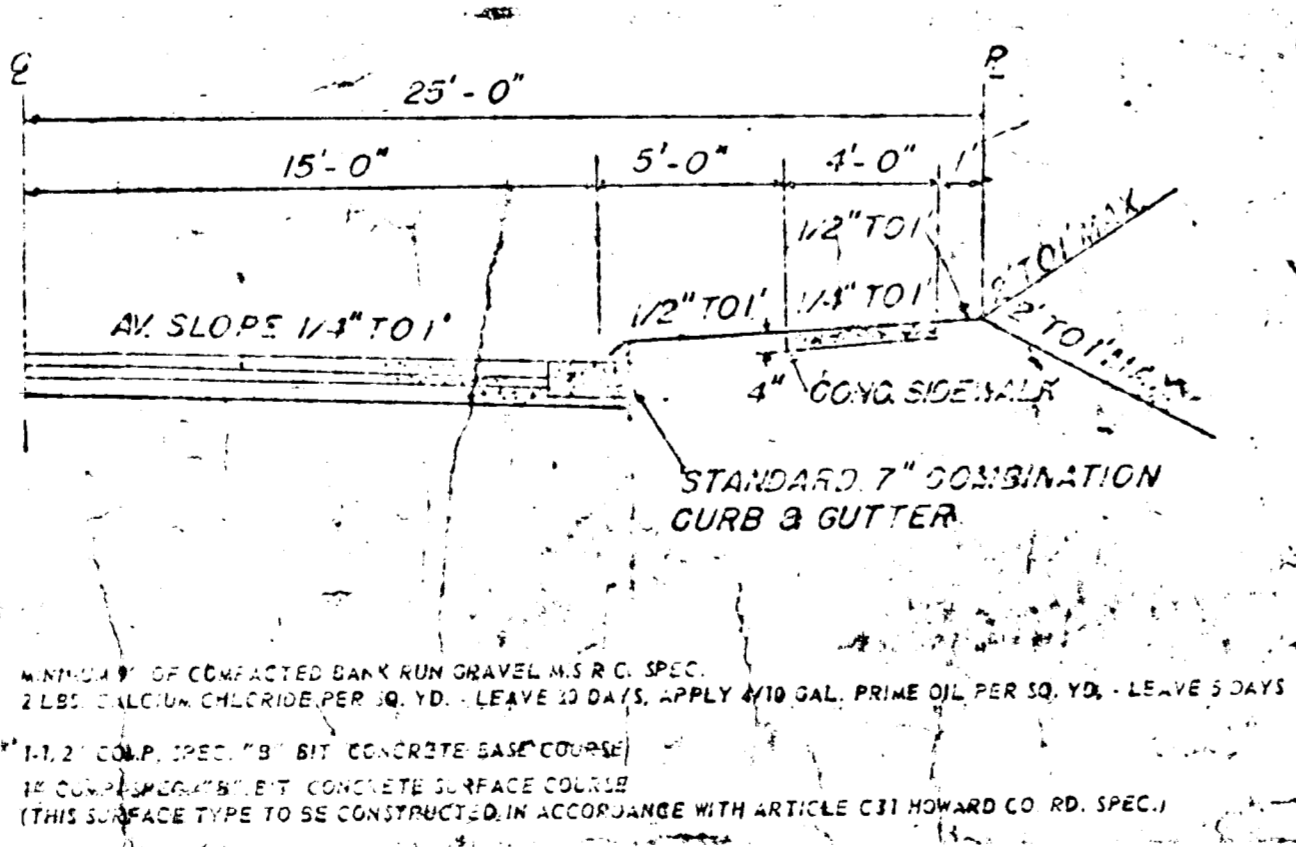
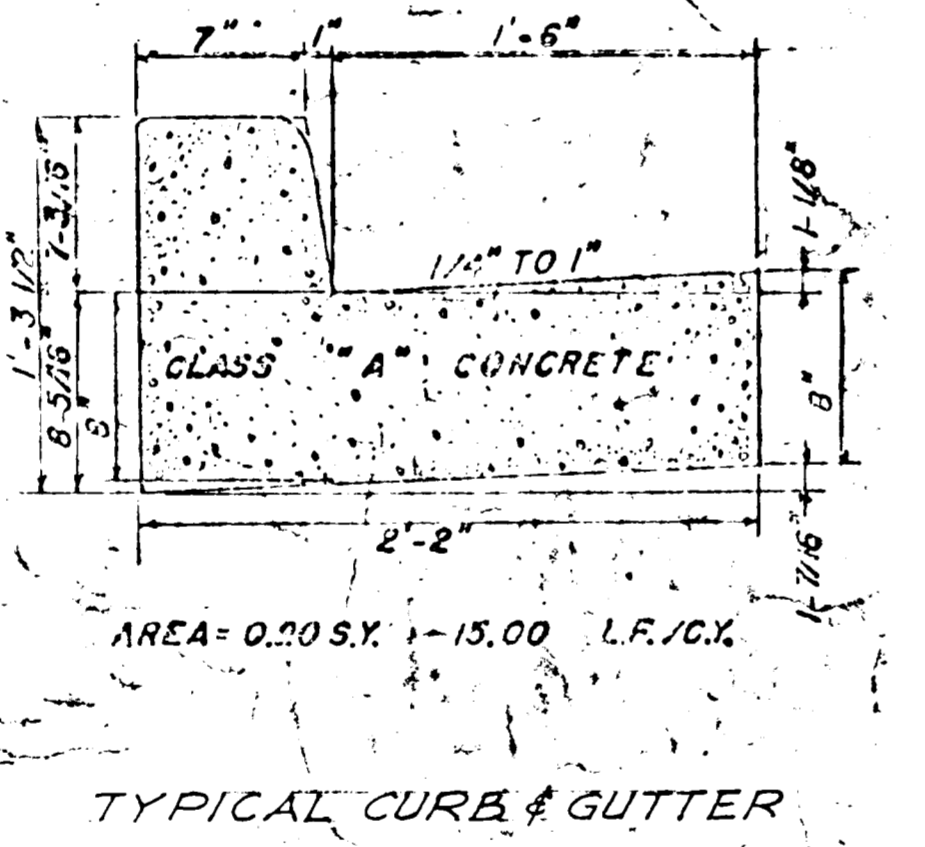

PIPE SCHEDULE			STRUCTURE SCHEDULE		
Size	Type	Length	No.	Type	Remarks
15"	RCP	22'	1-2	Comb. S	1-2 Comb. S 15" top curb 4600 w/ double grate. W-11' F" Wall for 15" RCP case II.

GENERAL NOTES FOR STORM DRAIN

1. All storm drain shall be constructed in accordance with the latest Edition of the General Specifications of Maryland State Roads Commission.
2. Types of structures refer to the Standard Storm Drainage Details of the Maryland State Roads Commission.
3. Where the drop on the main line through a structure can be accommodated by an invert slope of 1/8" or flatter, a rounded channel lined with sewer brick on edge shall be built to the crown of the pipe.
4. Topography and existing detail from Topographic Survey by Purdum & Leschke, Engineers & Land Surveyors, Ellicott City, Maryland, dated February 26, 1971.

NOTE:
All disturbed areas to be added, see landscape drawing.

APPROVED FOR SOIL EROSION & SEDIMENT CONTROL BY THE HOWARD SOIL CONSERVATION DISTRICT
 REVIEWED BY CONSERVATION DISTRICT
 APPROVED, H.S.C.D.

APPROVED: For Public Water & Public Sewerage Systems, Howard County Health Department
 COUNTY HEALTH OFFICER _____ DATE _____
 APPROVED: Howard County Office of Planning & Zoning
 PLANNING DIRECTOR _____ DATE 10-1-72
 APPROVED: For Public Water, Public Sewerage And Storm Drainage Systems And Roads
 HOWARD COUNTY DEPARTMENT OF PUBLIC WORKS
 CHIEF BUREAU OF HIGHWAYS _____ DATE 7-11-72

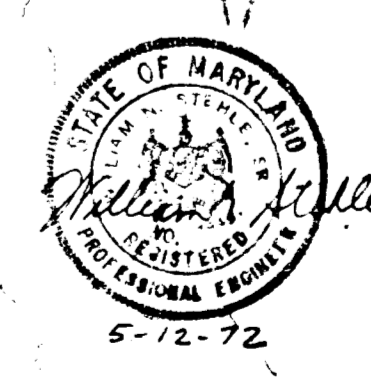

OLD WASHINGTON BOULEVARD - MD. RTE. 477