

GENERAL NOTES

- EXCEPT WHERE OTHERWISE NOTED ALL CONSTRUCTION MATERIALS AND DETAILS SHALL BE IN ACCORDANCE WITH THE LATEST REVISIONS OF THE HOWARD COUNTY ROAD CONSTRUCTION CODE AND STANDARD SPECIFICATIONS.
- PUBLIC WATER AND SANITARY SEWER FACILITIES ARE AVAILABLE AND ADEQUATE.
- PROPOSED GRADE CONTOURS REPRESENT FINISHED GRADE. CONTRACTOR SHALL MAKE REQUIRED ALLOWANCES TO SUBGRADE FOR TOPSOIL, PAVING AND OTHER SURFACE FINISHES AS REQUIRED.
- LOCATIONS OF EXISTING UTILITIES IS APPROXIMATE ONLY AND IS OBTAINED FROM RECORD DRAWINGS.
- ALL PARKING SPACES ARE TO BE 10' X 20'.
- CONTRACTOR IS TO NOTIFY THE FOLLOWING UTILITY COMPANIES PRIOR TO COMMENCING WORK:
 - BELL TELEPHONE SYSTEM 393-2649
 - LONG DISTANCE CABLE DIV. 393-2553
 - BALTO GAS & ELECTRIC CO. 539-8300 EXT. 691
- REFER TO ARCHITECTURAL DRAWINGS FOR BUILDING DIMENSIONS AND TIES TO PROPERTY LINES.
- REFER TO MECHANICAL PLANS FOR WATER, SEWER AND STORM DRAIN CONNECTIONS.
- REFER TO ENGINEERING DRAWINGS FOR TOWN CENTER SECTION 7 AREA 1 & 4 FOR EXISTING ADJACENT DEVELOPMENT WORK WHICH IS RELATIVE TO THE SUBJECT PROJECT.
- REFER TO PARKING COVENANTS RECORDED IN LIBER 552 FOLIO 516 IN THE LAND RECORDS OF HOWARD CO. MD. FOR THE PARKING EVALUATION AND BREAKDOWN FOR THE SUBJECT SITE.
- PRIOR TO DISTURBING THE EXISTING PARKING AREA, UPON WHICH THE THEATRE COMPLEX WILL BE BUILT AN EQUAL AMOUNT OF REPLACEMENT PARKING MUST BE PROVIDED.
- ALL SLOPES STEEPER THAN 3:1 SHALL BE COVERED WITH A PERMANENT, LOW MAINTENANCE GROUND COVERING. THE TYPE OF GROUND COVERING AND THE METHOD OF INSTALLATION SHALL BE OF TYPES APPROVED BY THE HOWARD SOIL CONSERVATION DISTRICT.
- ALL UNPAVED AREAS SHOWN ON THE SITE PLAN, EXCLUDING SLOPE AREAS, ARE TO BE GRADED.
- DETAILS SHOWN ON THIS PLAN FOR ROADWAYS, PARKING AREAS AND CURBS ARE FOR REFERENCE IN THE EVENT DURING CONSTRUCTION DUE TO DAMAGE OR REMOVAL ANY OF THE MENTIONED ITEMS WOULD REQUIRE REPLACEMENT.
- ALL CONC WALKWAYS ARE TO BE 4" DEPTH CONCRETE CONSTRUCTED AS SHOWN.

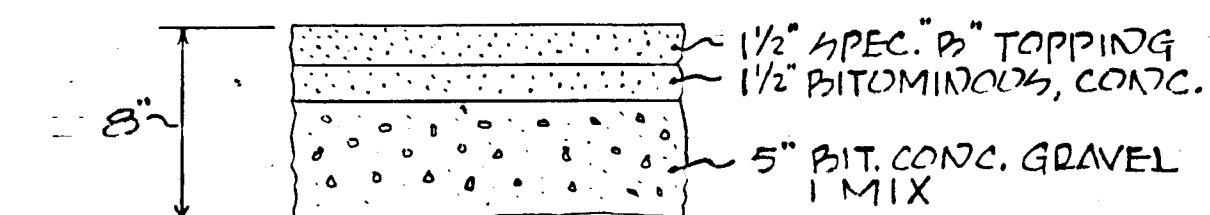

DETAIL PAVING FOR ROADWAYS
SCALE: 1/2" = 1'-0"

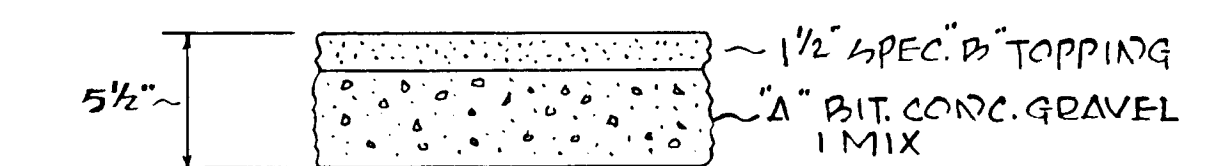

DETAIL PAVING FOR PARKING LOT
SCALE: 1/2" = 1'-0"

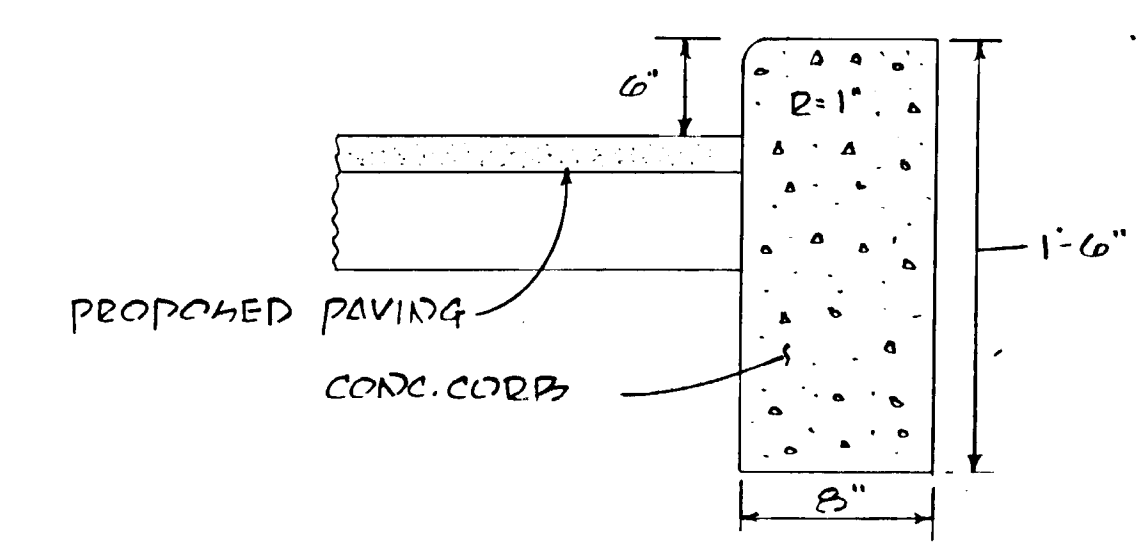

CURB DETAIL
SCALE: 1/2" = 1'-0"

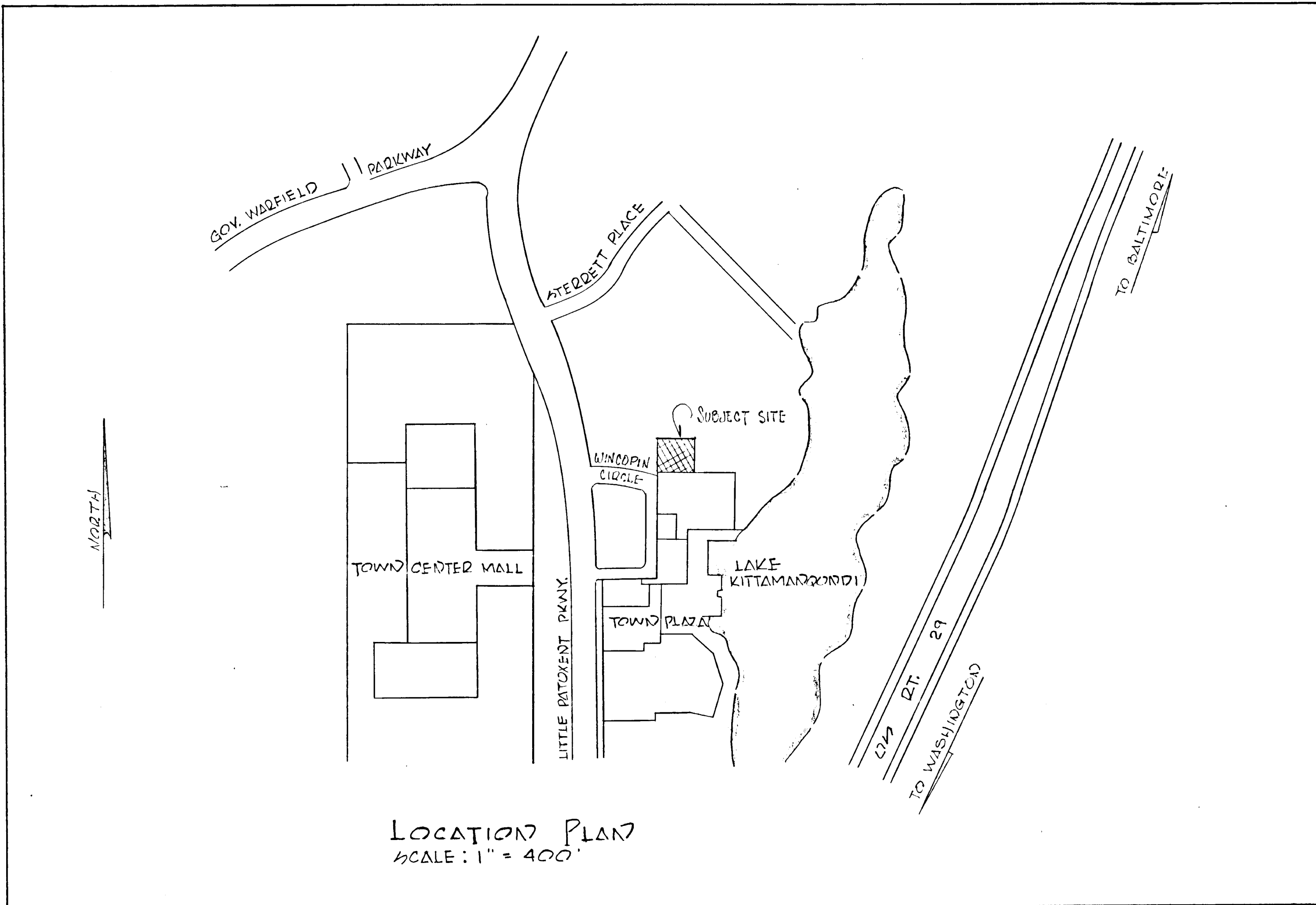

LOCATION PLAN
SCALE: 1" = 400'

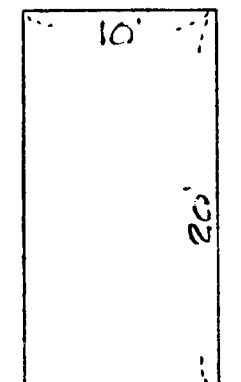

TYPICAL PARKING SPACE
(NO CURB)
SCALE: 1" = 10'

PARKING TABULATION

TOTAL SEATING CAPACITY (BOTH CINEMAS): 799
TOTAL NUMBER OF PARKING SPACES REQUIRED: 249
(1 space per 4 seats)

NOTE:

SEE SHEET # 2 OF 2 - OUTLINED PARKING AREA INDICATES PARKING PROVIDED FOR CINEMA I + CINEMA II (254 SPACES)

OWNER & DEVELOPER
THE HOWARD RESEARCH AND DEVELOPMENT CORP.
COLUMBIA, MARYLAND

ENGINEER
JOSEPH D. THOMPSON
ENGINEERS AND SURVEYORS
101 SHELL BLDG. 200 E. DOPPA RD.
TOWSON, MARYLAND 21284

PROPERTY DESCRIPTION
SECTION 7 AREA 6 - PARCEL "E"
5TH ELECTION DISTRICT OF HOWARD CO. MD.
RECORDED IN PLAT BOOK 21 FOLIO 56
ZONING - COMMERCIAL
AREA - 0.755 AC. ±

APPROVED
PLANNING BOARD
OF HOWARD COUNTY
DATE 2/1/72
Thomas St. Hanig

APPROVED: FOR PUBLIC WATER AND PUBLIC SEWERAGE SYSTEMS HOWARD CO. HEALTH DEPARTMENT
Robert W. Ziehm 1/27/72
COUNTY HEALTH OFFICER DATE

APPROVED: HOWARD CO. OFFICE OF PLANNING AND ZONING
Thomas St. Hanig 3-7-72
PLANNING DIRECTOR DATE

John C. ... 3-7-72
CHIEF ENGINEER DIV. LAND DEVELOPMENT DATE

APPROVED: FOR PUBLIC WATER, PUBLIC SEWERAGE AND STORM DRAINAGE SYSTEMS AND ROADS, HOWARD COUNTY DEPARTMENT OF PUBLIC WORKS
William A. Altner 3/6/72
DIRECTOR DATE

B. H. ... 3/2/72
CHIEF BUREAU OF HIGHWAYS DATE

CINEMA 1 & 2
SITE PLAN
LOCATION PLAN, GENERAL NOTES, ETC.
TOWN CENTER SECTION 7 AREA 6
COLUMBIA
HOWARD CO. MARYLAND
5TH ELEC. DIST.
SCALE: AS SHOWN DATE: NOV. 5, 1971

DESIGNED	Larson	DRAWN	Eschenbach
CHECKED	Larson	DATE	"
	JOP		
	?		
	DEA		
	1		
	RE		
	109		

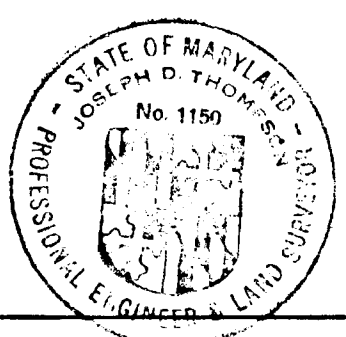

PROFESSIONAL ENGINEER
I CERTIFY THAT THE PLAN OF DEVELOPMENT AND PLAN FOR CONTROL OF SILT AND EROSION MEETS THE REQUIREMENTS, STANDARDS AND SPECIFICATIONS OF THE HOWARD SOIL CONSERVATION DISTRICT.
Joseph D. Thompson 2/22/72
SIGNATURE DATE

DEVELOPER
I CERTIFY THAT ALL DEVELOPMENT AND/OR CONSTRUCTION WILL BE DONE ACCORDING TO THE PLAN OF DEVELOPMENT AND PLAN OF SILT AND SEDIMENT CONTROL.
J. Spadone Jr 2/22/72
SIGNATURE DATE
Columbia Development Corp.

HOWARD SOIL CONSERVATION DISTRICT
THIS DEVELOPMENT PLAN IS APPROVED FOR SOIL EROSION AND SEDIMENT CONTROL BY THE HOWARD SOIL CONSERVATION DISTRICT.
REVIEWED *James M. ...* 3-1-72
DISTRICT CONSERVATIONIST DATE
APPROVED *Robert W. Ziehm* 3-1-72
HOWARD SOIL CONSERVATION DIST. DATE

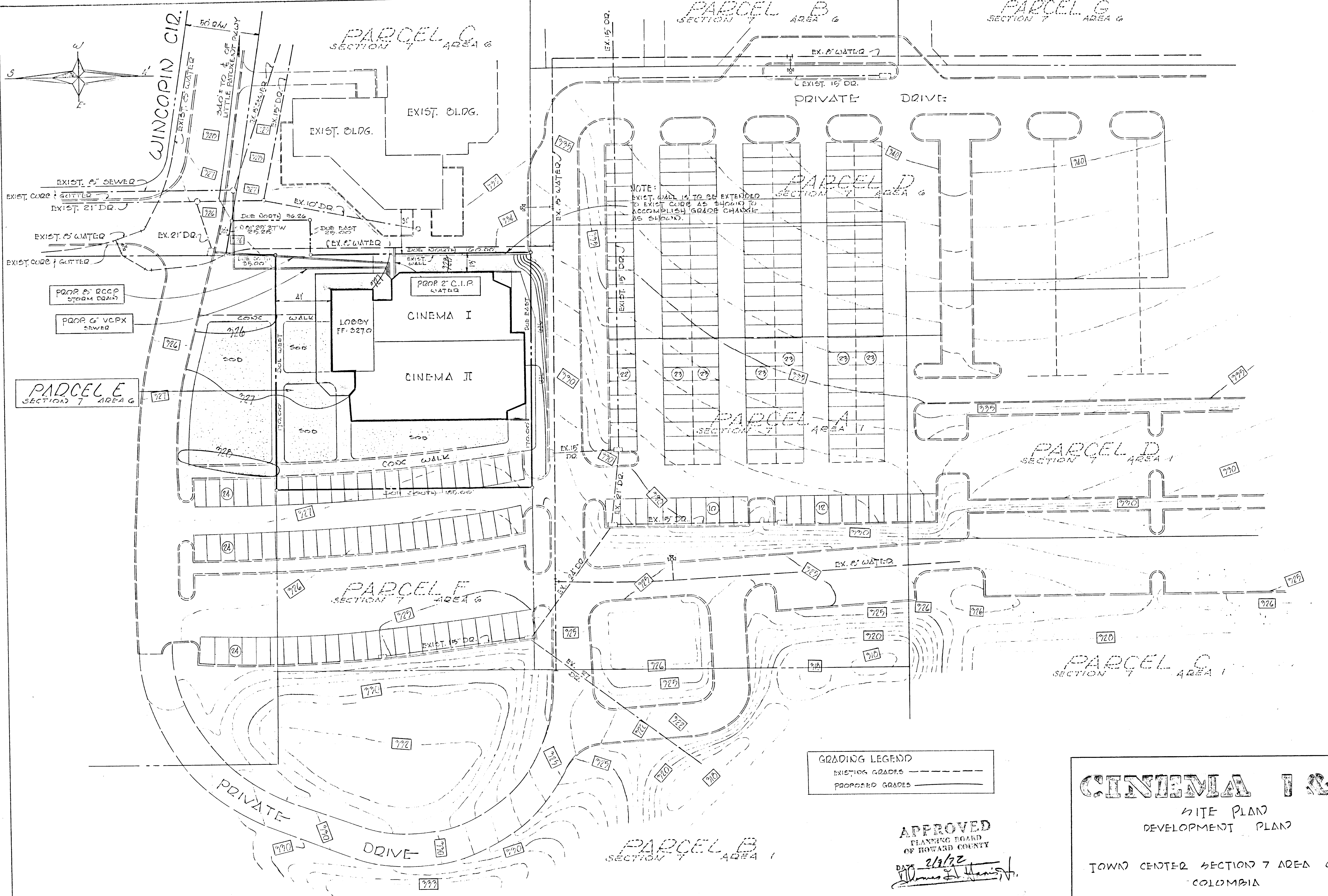
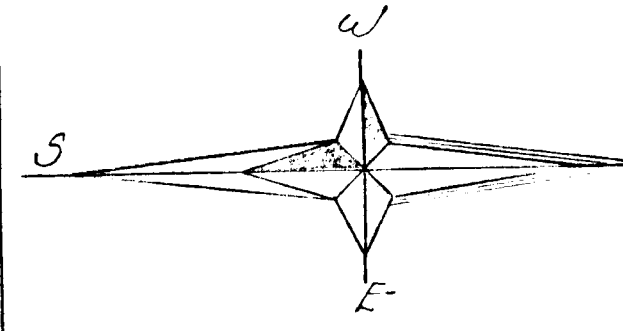

PARCEL E
SECTION 7 AREA 6

PARCEL F
SECTION 7 AREA 6

PARCEL B
SECTION 7 AREA 6

PARCEL B
SECTION 7 AREA 6

PARCEL G
SECTION 7 AREA 6

PARCEL D
SECTION 7 AREA 6

PARCEL D
SECTION 7 AREA 1

PARCEL C
SECTION 7 AREA 1

GRADING LEGEND
EXISTING GRADES
PROPOSED GRADES

APPROVED
PLANNING BOARD
OF HOWARD COUNTY
DATE 2/13/72
James H. Haney

CINEMA I & II

SITE PLAN
DEVELOPMENT PLAN

TOWN CENTER SECTION 7 AREA 6
COLUMBIA

HOWARD CO. ELECT. DIST. MARYLAND
DODGING DR. 2 OF 2

SCALE: 1" = 30' DATE: NOV. 5, 1971

REVISED 04/13/1972
REVISED 01/20/1971

JOSEPH D. THOMPSON
ENGINEERS AND SURVEYORS
101 SHELL BLDG. 200E JOPPA RD
TOWSON, MARYLAND 21204

500 72-520