

ADDITION - ORIENTATION
MAIN & OUTLYING BLDGS

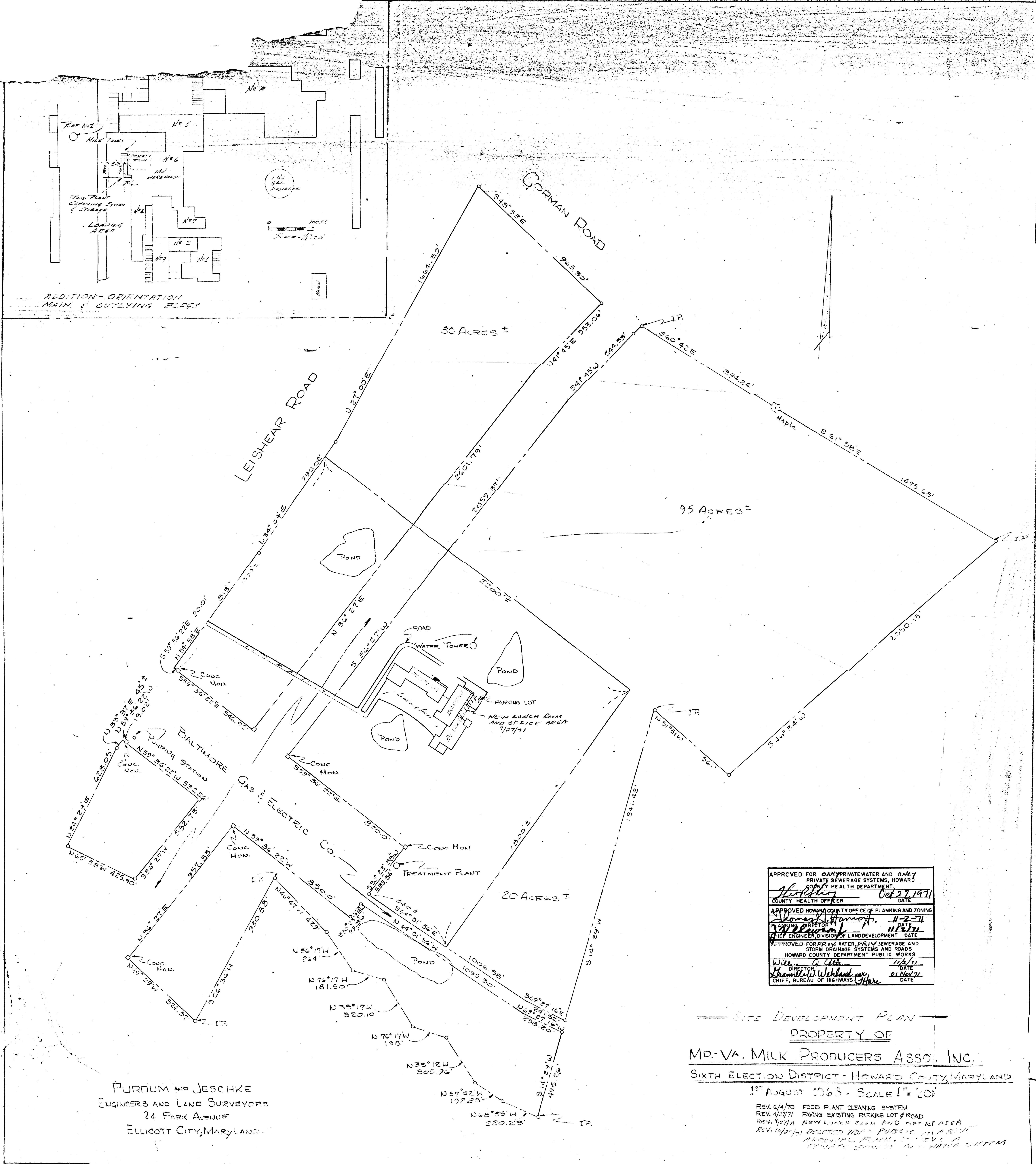

APPROVED FOR ONLY PRIVATE WATER AND ONLY PRIVATE SEWERAGE SYSTEMS, HOWARD COUNTY HEALTH DEPARTMENT	
<i>William A. Galt</i> COUNTY HEALTH OFFICER	Oct 27, 1971 DATE
APPROVED HOWARD COUNTY OFFICE OF PLANNING AND ZONING	
<i>Thomas H. Starnes</i> PLANNING DIRECTOR	11-2-71 DATE
<i>W. A. Galt</i> CHIEF ENGINEER, DIVISION OF LAND DEVELOPMENT	11/2/71 DATE
APPROVED FOR PRIVATE WATER, PRIVATE SEWERAGE AND STORM DRAINAGE SYSTEMS AND ROADS HOWARD COUNTY DEPARTMENT PUBLIC WORKS	
<i>William A. Galt</i> DIRECTOR	11/2/71 DATE
<i>Charles W. Wehland</i> CHIEF, BUREAU OF HIGHWAYS	11/2/71 DATE

SITE DEVELOPMENT PLAN
PROPERTY OF
MD.-VA. MILK PRODUCERS ASSO. INC.
SIXTH ELECTION DISTRICT - HOWARD COUNTY, MARYLAND
1ST AUGUST 1963 - SCALE 1" = 10'

- REV. 6/4/70 FOOD PLANT CLEANING SYSTEM
- REV. 4/2/71 PAVING EXISTING PARKING LOT & ROAD
- REV. 9/27/71 NEW LUNCH ROOM AND OFFICE AREA
- REV. 10/27/71 DEDICATED WATER PUBLIC IN A R/W
- APPROVAL PLANNING DIVISION
- APPROVAL HEALTH DEPARTMENT
- APPROVAL BUREAU OF HIGHWAYS
- APPROVAL PUBLIC WORKS

PURDUM AND JESCHKE
ENGINEERS AND LAND SURVEYORS
24 PARK AVENUE
ELICOTT CITY, MARYLAND