

DENSITY NOTES

ZONED AREA OF PROPERTY	DA-1
Nº OF UNITS ALLOWED	3,224 AC.
Nº OF UNITS PROPOSED	61
AREA OF BUILDINGS	20,000 Sq. Ft. = 0.455 AC.
BUILDING COVERAGE	12% ±
MAXIMUM HEIGHT OF BLDG.	35
MIN. FLOOR AREA PER UNIT (1-BR)	800 Sq. Ft.
MIN. FLOOR AREA PER UNIT (2-BR)	953 Sq. Ft.
Nº OF PROPOSED PARKING SPACES	30 = 150%
MIN. SIZE OF EACH SPACE	10' x 20' = 200 Sq. Ft.

GENERAL NOTES

- Sidewalks to be provided in accordance with Howard County Regulations.
- Seeding and Planting to be in accordance with Interim Standards and Specifications US Soil Conservation Service, College Park Maryland.
- Stabilization: Within 10' of Buildings: Lod (Spec Page 3,400) Areas 2:1 and Flatter: Kentucky 31 Tall Fescue 1.37 #/1000 S.F. Area Steeper than 2:1: Common Periwinkle or Approved Substitute (Spec Page 3,500)
- Exposed Earth will be stabilized in the planting season immediately following construction. Temporary Seeding (Spec Page 3,000) will be used as necessary for short term cover.
- 24 Hour Notice will be given to the Howard Soil Conservation District before earthmoving operations begin (Phone 435-3210).
- Temporary Erosion Control Measures must be in place before other grading begins.
- No Sediment Control Measures must be removed without permission of the Howard Soil Conservation District.
- All Storm Drain Inlets will be capped until soil areas are stabilized, or discharge from storm drain will be directed into Basin #2.

SEDIMENTATION CONTROL PLAN

"VENUS GARDENS APARTMENTS"

2ND ELECTION DISTRICT HOWARD COUNTY MD.

FOR
ANGELO AMABILE
2332 FREDERICK AVE.
BALTIMORE MD, 21223

Revised 6-7-71 S.D. for Erosion Protection
REVISED: 5/2/1971 UTILITIES & BLDG © - J.M.



EVANS, HAGAN & HOLDEFER, INC.
SURVEYORS AND CIVIL ENGINEERS
4200 ELSDORF AVENUE / BALTIMORE, MD. 21214
(301) 426-2144

L. Evans
DATE: 5/11/1971 SCALE: 1" = 30'

"I Certify that the Plan of Development and the Plan for Control of Silt and Erosion Meets the Requirements, Standards and Specifications of Howard County Soil Conservation District."
George W. Holdefer #3087 6/8/71
SIGNATURE (engineer) Date

"I Certify that all Development and/or Construction will be done According to this Plan of Development and Plan of Silt and Sediment Control."
Angelo Amabile June 10 71
SIGNATURE (developer) Date

"This Development Plan is Approved for Soil Erosion and Sediment Control by the Howard County Soil Conservation District. Reviewed"
James W. Helms 9-2-71
District Conservationist Date
Approved: *Robert B. Campbell* 9-7-71
Howard Soil Conservation District Date

THIS DEVELOPMENT PLAN IS APPROVED FOR SOIL EROSION & SEDIMENT CONTROL BY THE HOWARD SOIL CONSERVATION DISTRICT

REVIEWED: *Jane Mitchell* 7-23-71
DISTRICT CONSERVATIONIST - DATE

APPROVED: *R. B. Gault* 9-29-71
HOWARD SOIL CONSERVATION DISTRICT

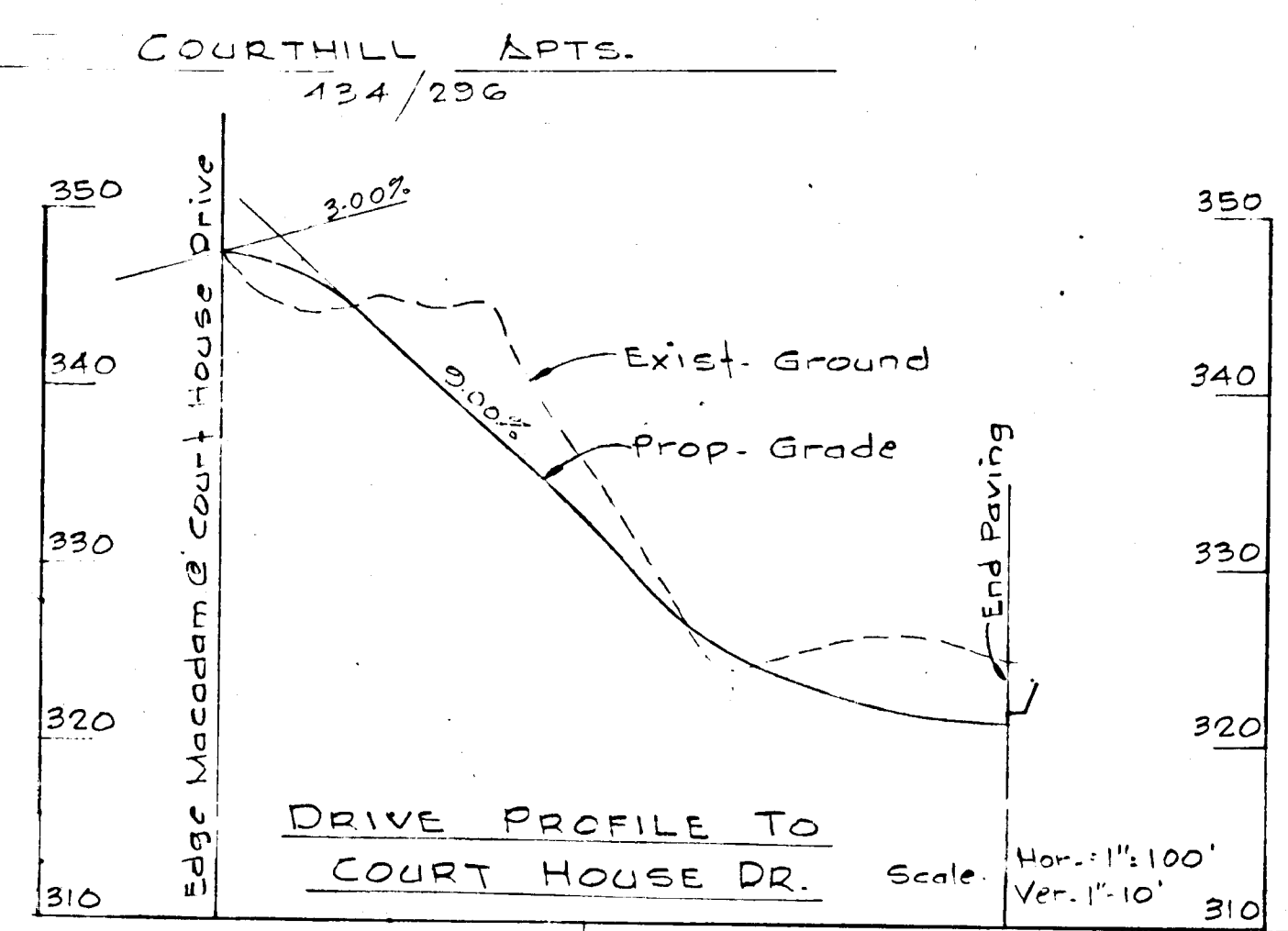
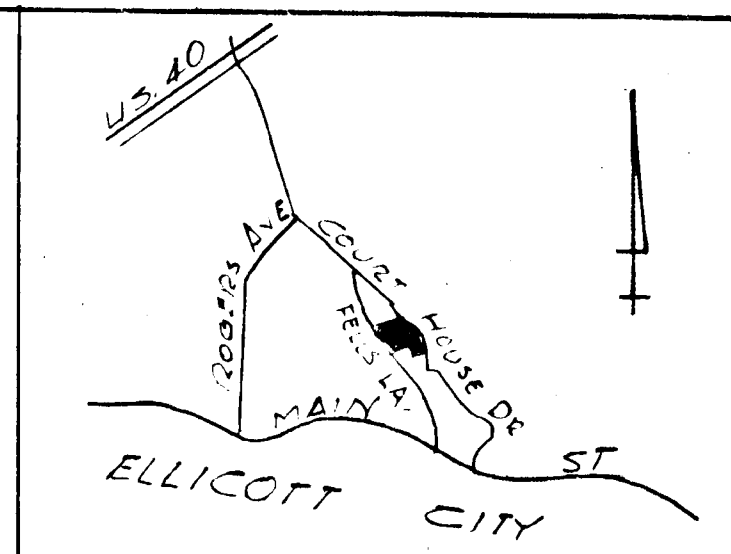

APPROVED FOR PUBLIC WATER & PUBLIC SEWERAGE SYSTEMS
HOWARD CO. HEALTH DEPT.
DATE: 10/17/71

APPROVED FOR OFFICE OF PLANNING & ZONING
DATE: 9/20/71

APPROVED FOR PUBLIC WATER PUBLIC SEWERAGE AND STORM DRAINAGE SYSTEMS AND ROAD
DATE: 8/11/71

S. H. McKeand 9/10/71

DENSITY REQUIREMENTS:

ZONED:	R-2-1
AREA OF PROPERTY	3,922.1 ^{sq} ft.
N ^o OF UNITS ALLOWED	61
N ^o OF UNITS PROPOSED	60
AREA OF BUILDINGS	20,600 sq. ft. (2,457 ^{sq} ft.)
BUILDING COVERAGE	12.1%
MAXIMUM HEIGHT OF BLDG.	55' - 245'
MIN. FLOOR AREA PER UNIT (1BR)	800 sq. ft.
MIN. FLOOR AREA PER UNIT (2BR)	953 sq. ft.
N ^o OF PROPOSED PARKING SPACES	90 = 150%
MIN. SIZE OF EACH SPACE	10 x 20 = 200 sq. ft.

GENERAL NOTES:
ALL SIDEWALKS TO BE PROVIDED IN ACCORDANCE WITH HOWARD COUNTY REGULATIONS.
ALL UNPAVED AREAS IF NOT LEFT IN NATURAL COVER TO BE SEED OR SODDED.

APPROVED
PLANNING BOARD
OF HOWARD COUNTY
DATE: 8/25/71
Thomas Harris

FINAL SITE PLAN OF
VENUS GARDEN APARTMENTS
2ND ELECTION DISTRICT FOR
ANGELO AMABILE
4330 FREDERICK AVE, BALTO, MD, 21223

REVISED: 7/29/71 - Revised To Final Site Plan
REVISED: 5/12/1971 - UTILITIES & BLDG @ - JH.

EVANS, HAGAN & HOLDEFER, INC.
SURVEYORS AND CIVIL ENGINEERS
4200 ELSDORE AVENUE / BALTIMORE MD 21214
(301) 428-2144

DATE: 5/11/1970 SCALE: 1"=30'

