

- NOTES:
- SEEDING-TEMPORARY SEEDING TO BE SPRING DATE 3 BU PER AC AFTER FERTILIZER (500 LBS PER AC 10-10-10) MULCH IMMEDIATELY W/ 1 TO 1 1/2 TONS SMALL GRAINED STRAW PER AC W/ MULCH NETTING
  - MIN 24HR NOTICE TO H.S.C.D (465-2182) PRIOR TO ANY CONSTRUCTION
  - SEDIMENT CONTROL MEASURES MUST BE INSTALLED PRIOR TO ANY CONST.
  - PERM STABILIZATION TO BE IN ACCORDANCE WITH SECT 3100 OF HO. CO. S.D.R. STD'S
  - ROUGH GRADING & BERMS TO BE FORMED SIMULTANEOUSLY WITH EXCAVATION.

VILLAGE OF LONGREACH  
SECTION I AREA I  
SHEET 17 OF 23

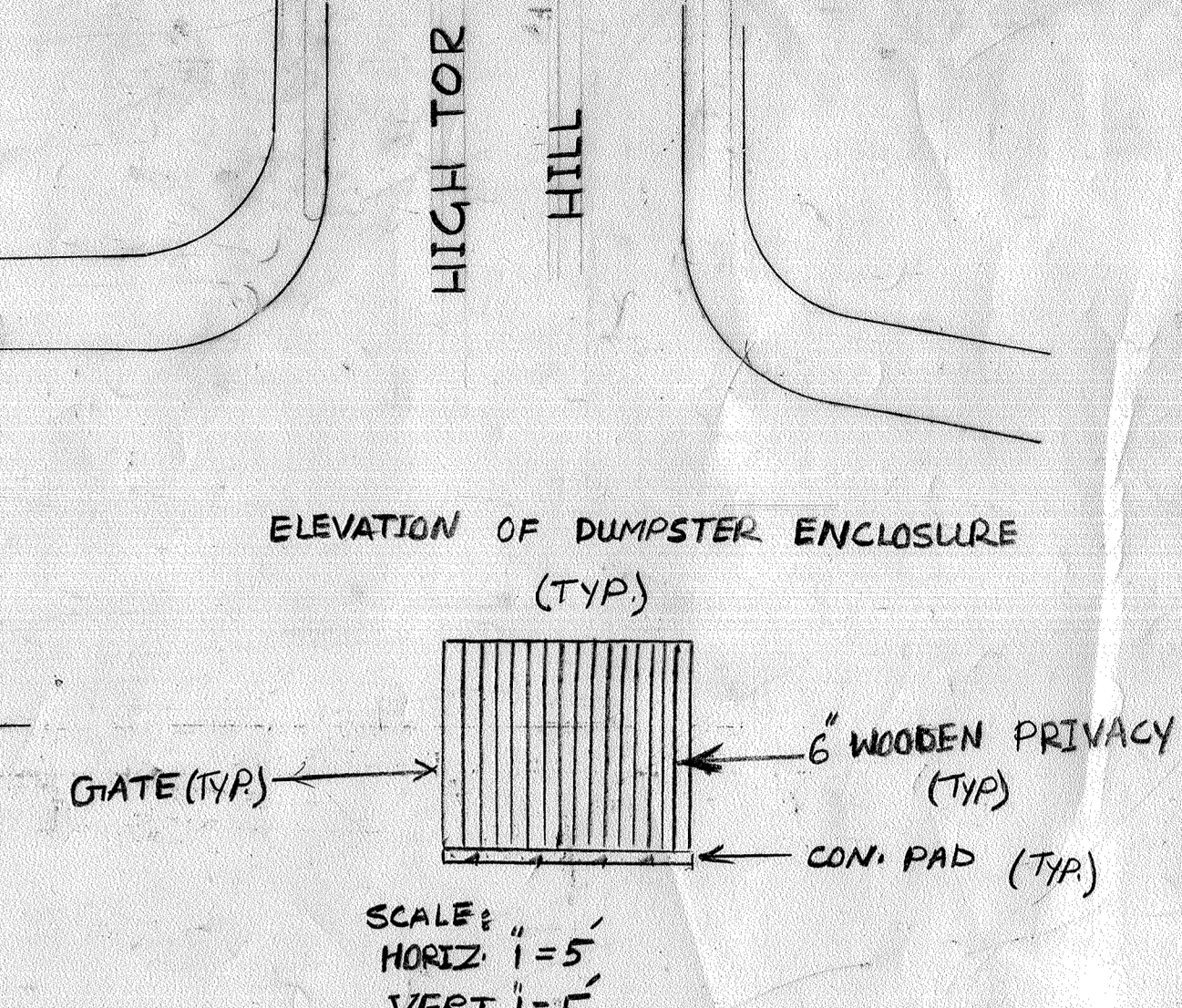

LOT 572  
OPEN SPACE



VISIONS  
REVISION #2  
SCOPE OF REVISION INCLUDES NEW CONCRETE PADS FOR NEW MECHANICAL EQUIPMENT. TOTAL LIMIT OF DISTURBANCE = 1,900 SF.

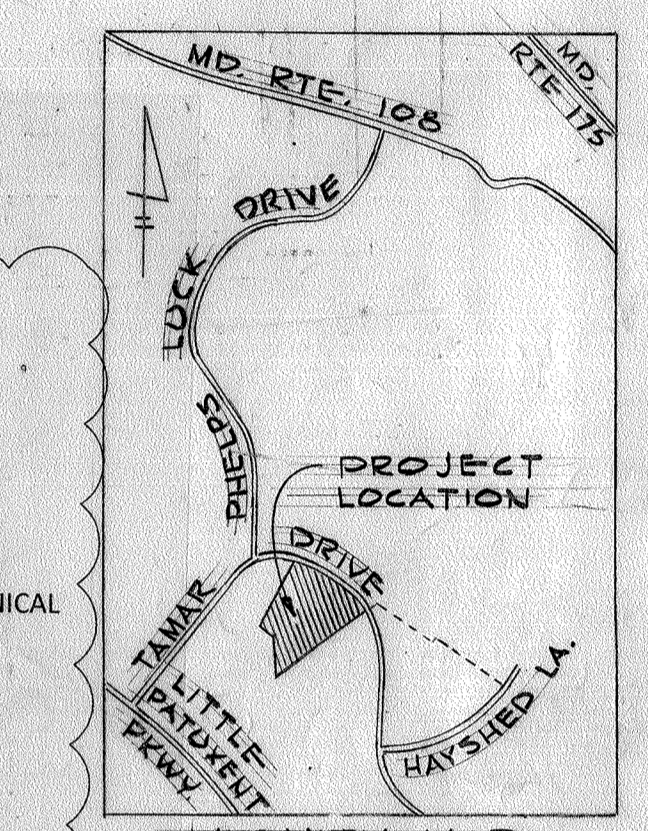
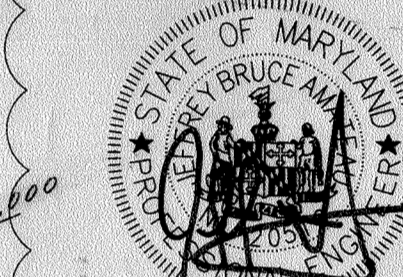

PROFILE GDN. UNIT (NO SCALE)  
MEASURED FROM AVGE. GRADE AT BLDG. TO MEAN HEIGHT BETWEEN RIDGE & EAVES.

APPROVED  
PLANNING BOARD  
OF HOWARD COUNTY  
DATE 7/18/71

NOTE 'A'  
FOR DRAINAGE UNDER WALK SEE LANDSCAPE PLAN

CERTIFICATION BY REGISTERED LAND SURVEYOR:  
I HEREBY CERTIFY THAT THE PLAN OF DEVELOPMENT, THE PLAN OF SILT & EROSION MEETS THE REQUIREMENTS, STANDARDS & SPECIFICATIONS OF THE HOWARD COUNTY SOIL CONSERVATION DISTRICT.

ROBERT J. AIKENS No. 5467 DATE  
CERTIFICATION BY THE DEVELOPER:  
I HEREBY CERTIFY THAT ALL DEVELOPMENT AND CONSTRUCTION WILL BE DONE ACCORDING TO THIS PLAN OF DEVELOPMENT & PLAN OF SILT & SEDIMENT CONTROL.

EDMOND J. BENNETT ASSOC. DATE  
HOWARD SOIL CONSERVATION DISTRICT:  
THIS DEVELOPMENT PLAN IS APPROVED FOR SOIL EROSION & SEDIMENT CONTROL BY THE HOWARD SOIL CONSERVATION DISTRICT.

REVIEWED DISTRICT CONSERVATIONIST DATE  
APPROVED HOWARD SOIL CONSERVATION DIST. DATE

APPROVED FOR PUBLIC WATER AND PUBLIC SEWERAGE SYSTEMS, HOWARD COUNTY HEALTH DEPARTMENT DATE 04/19/71  
APPROVED HOWARD COUNTY OFFICE OF PLANNING AND ZONING DATE 10-4-71  
FREE ENGINEER, DIVISION OF LAND DEVELOPMENT DATE 10-29-71  
APPROVED FOR PUBLIC WATER, PUBLIC SEWERAGE AND STORM DRAINAGE SYSTEMS AND ROADS HOWARD COUNTY DEPARTMENT OF PUBLIC WORKS DATE 9/23/71

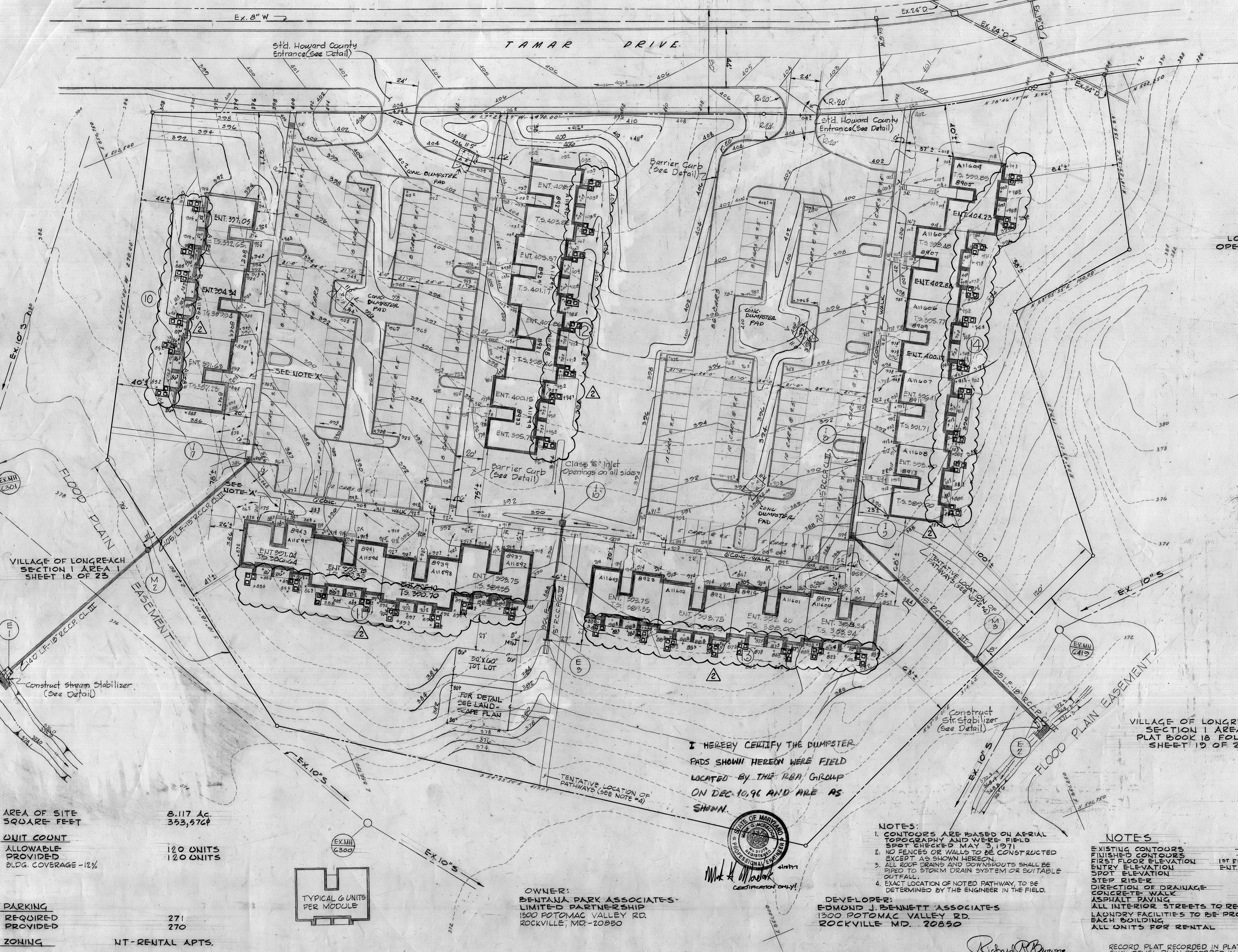

AREA OF SITE	8,117 AC.
SQUARE FEET	333,9764
UNIT COUNT	
ALLOWABLE	120 UNITS
PROVIDED	120 UNITS
BLDG. COVERAGE - 12%	
PARKING	
REQUIRED	271
PROVIDED	270
ZONING	NT-RENTAL APTS.

I HEREBY CERTIFY THE DUMPSTER PADS SHOWN HEREON WERE FIELD LOCATED BY THE RBA GROUP ON DEC. 10, 96 AND ARE AS SHOWN.

- NOTES:
- CONTOURS ARE BASED ON AERIAL TOPOGRAPHY AND WERE FIELD SPOT CHECKED MAY 3, 1971
  - NO FENCES OR WALLS TO BE CONSTRUCTED EXCEPT AS SHOWN HEREON
  - ALL ROOF DRAINS AND DOWNSPOUTS SHALL BE PIPED TO STORM DRAIN SYSTEM OR SUITABLE OUTFALL.
  - EXACT LOCATION OF NOTED PATHWAY TO BE DETERMINED BY THE ENGINEER IN THE FIELD.

NOTES

EXISTING CONTOURS	400
FINISHED CONTOURS	400
FIRST FLOOR ELEVATION	1ST FL. = 441.70
ENTRY ELEVATION	ENT. = 446.10
SPOT ELEVATION	592
STEP RISE	4.2
DIRECTION OF DRAINAGE	
CONCRETE WALK	
ASPHALT PAVING	
ALL INTERIOR STREETS TO REMAIN PRIVATE	
LAUNDRY FACILITIES TO BE PROVIDED IN EACH BUILDING	
ALL UNITS FOR RENTAL	

OWNER:  
BENTANA PARK ASSOCIATES - LIMITED PARTNERSHIP  
1300 POTOMAC VALLEY RD.  
ROCKVILLE, MD. 20850

DEVELOPER:  
EDMOND J. BENNETT ASSOCIATES  
1300 POTOMAC VALLEY RD.  
ROCKVILLE, MD. 20850

BENTANA WEST  
IN THE VILLAGE OF LONGREACH  
COLUMBIA, MD.  
STORM DRAIN AND SITE DEVELOPMENT PLAN  
GTH ELECTION DISTRICT  
SCALE 1"=30'

RICHARD P. BROWNE ASSOCIATES  
Columbia, Maryland  
J.C. 33/4

ENGINEERS PLANNERS ARCHITECTS  
Wayne, New Jersey

VILLAGE OF LONGREACH  
SECTION ONE - AREA ONE  
PARCEL 'B'  
TAX MAP NO. 86

S-2  
S.D.P. 71-104-C

David A. Holtz Associate Silver Spring, Maryland  
Cohen Haft and Associates Architects and Planners

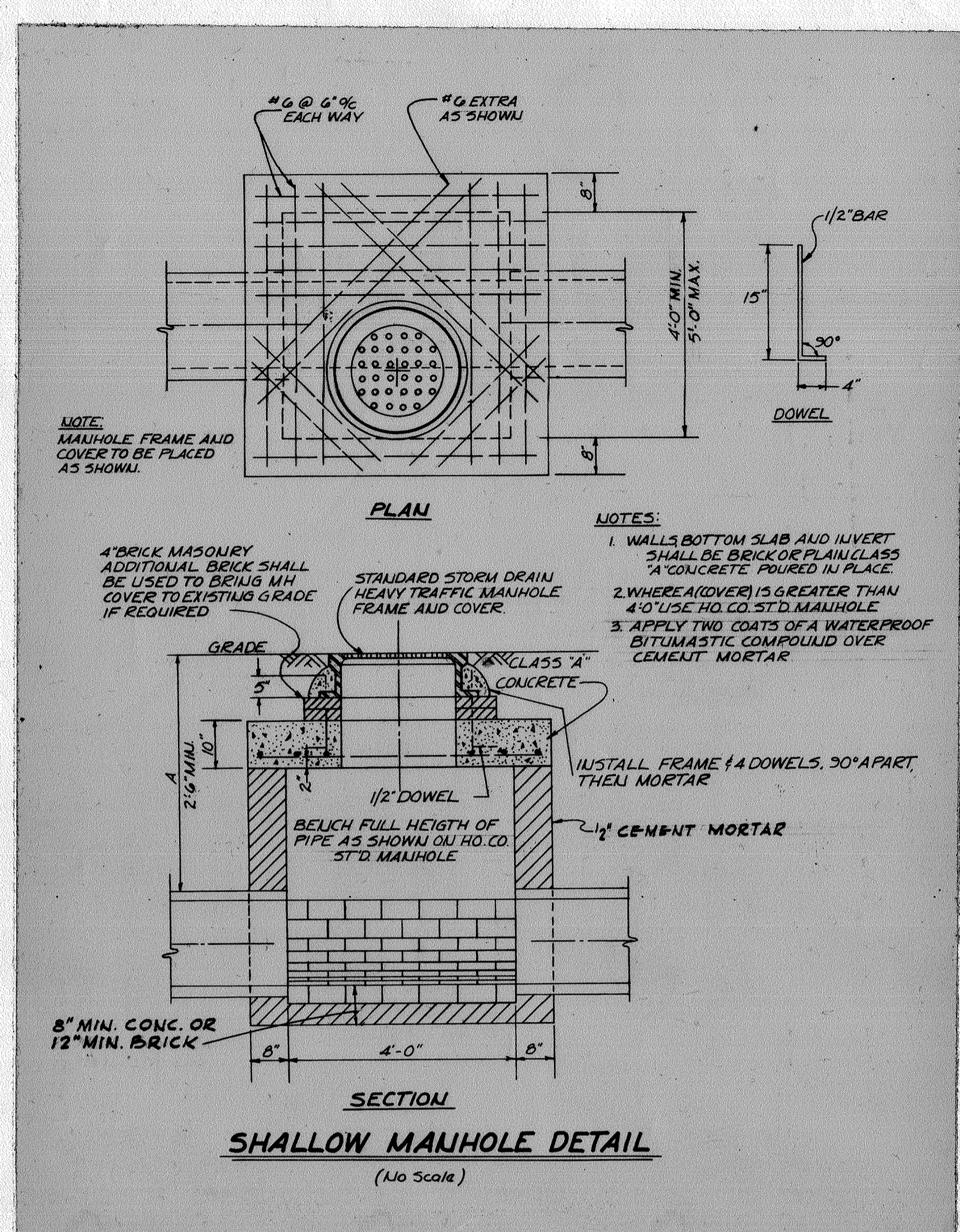
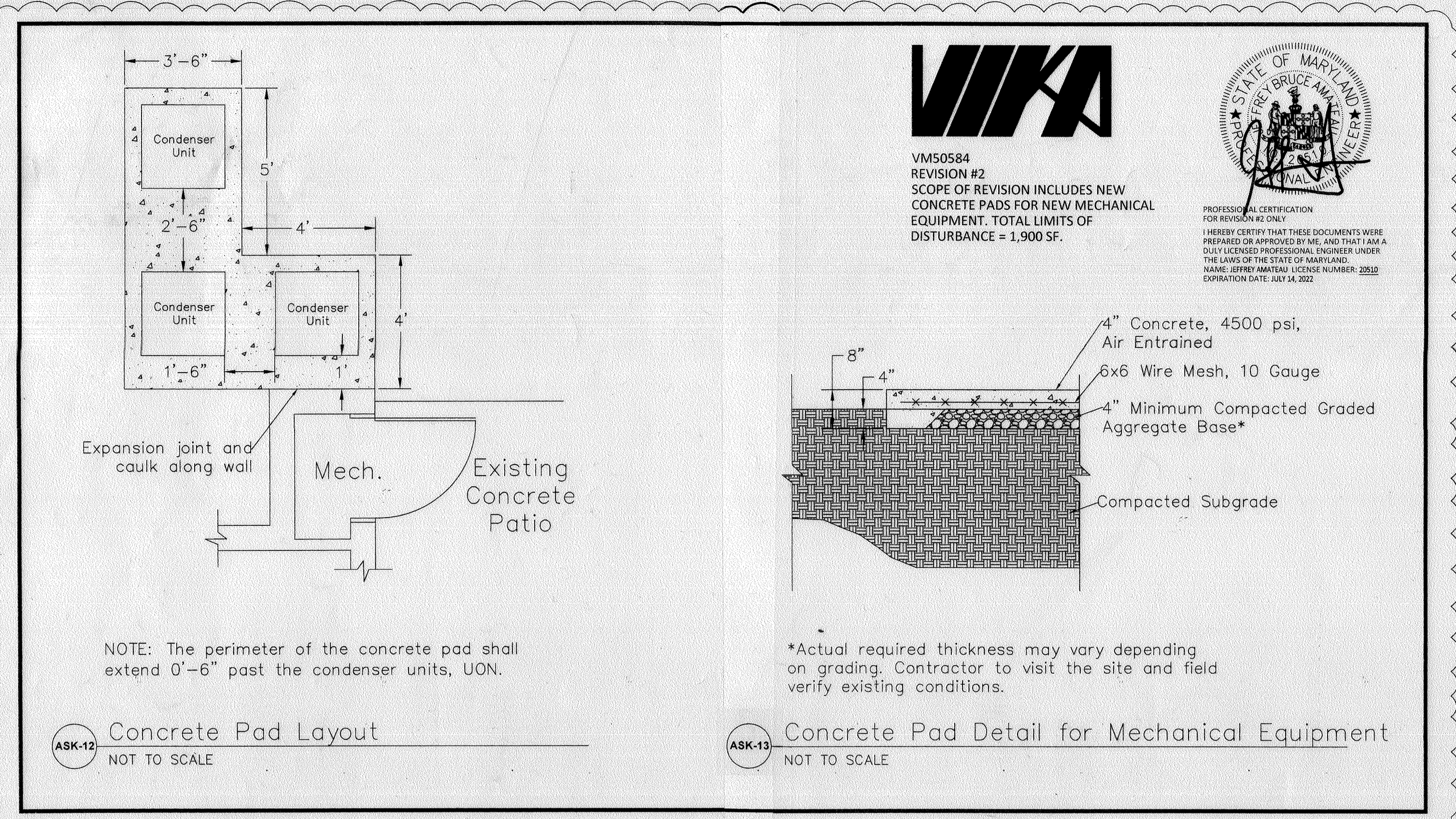

STORM DRAINAGE STRUCTURE SCHEDULE						
NO.	TYPE	LOCATION	INV. IN	INV. OUT	T.C. ELEV.	REMARKS
M12	Shallow MH	See Plan	374.94	374.74	374.0	See Detail
M13	Shallow MH	See Plan	370.75	370.55	374.50	See Detail
I-7	A-10 Inlet	See Plan	---	321.22	325.90	Ho. Co. STD. Draw. C-24-A Page 119-A
I-8	A-5 Inlet	See Plan	---	327.40	321.50	"
I-9	A-5 Inlet	See Plan	324.12	323.92	327.50	"
I-10	Class "C" Inlet	See Plan	---	324.50	323.50	Ho. Co. STD. Draw. C-24-C Page 119-C

\* Elev. Given at Throat

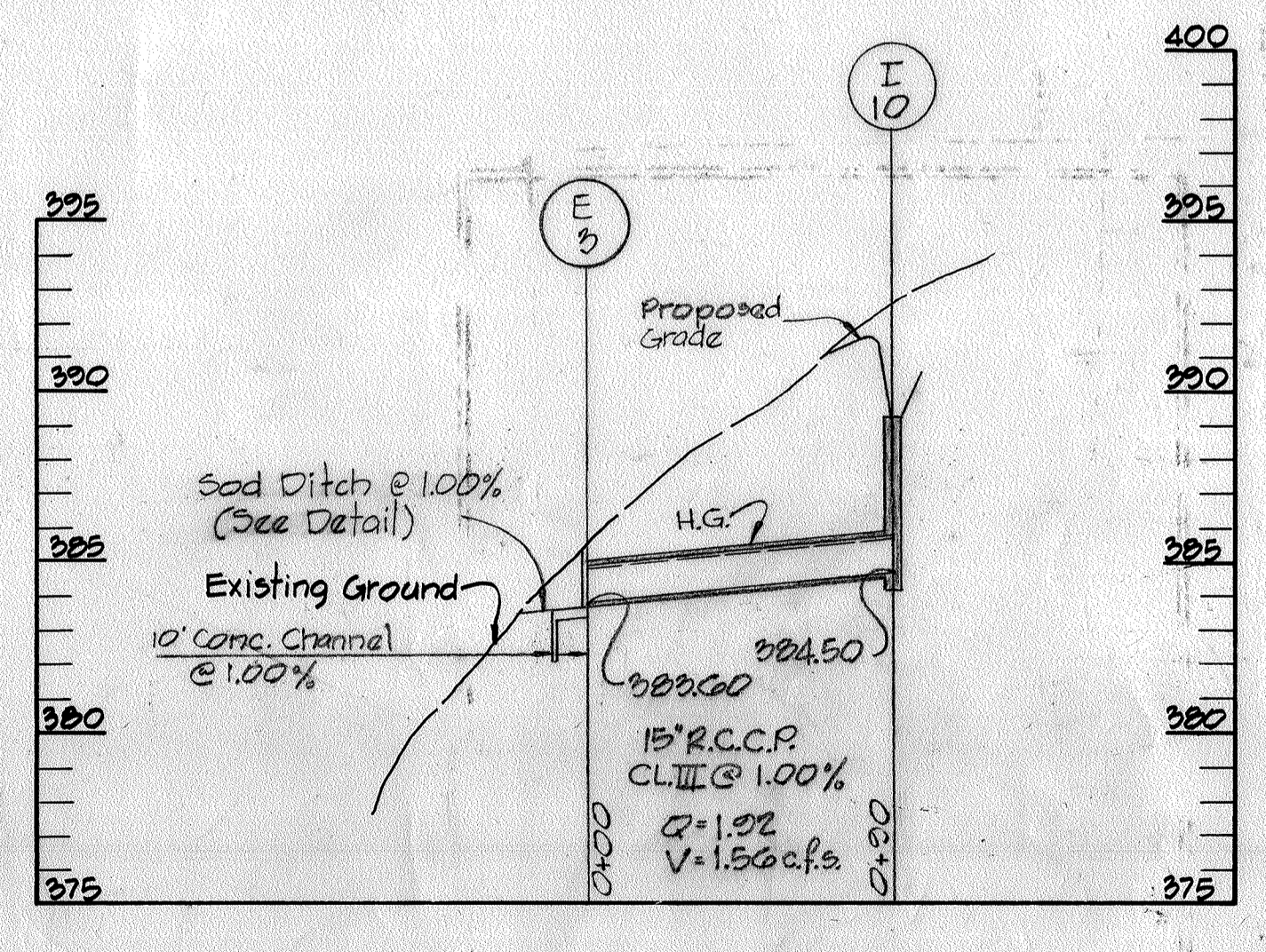
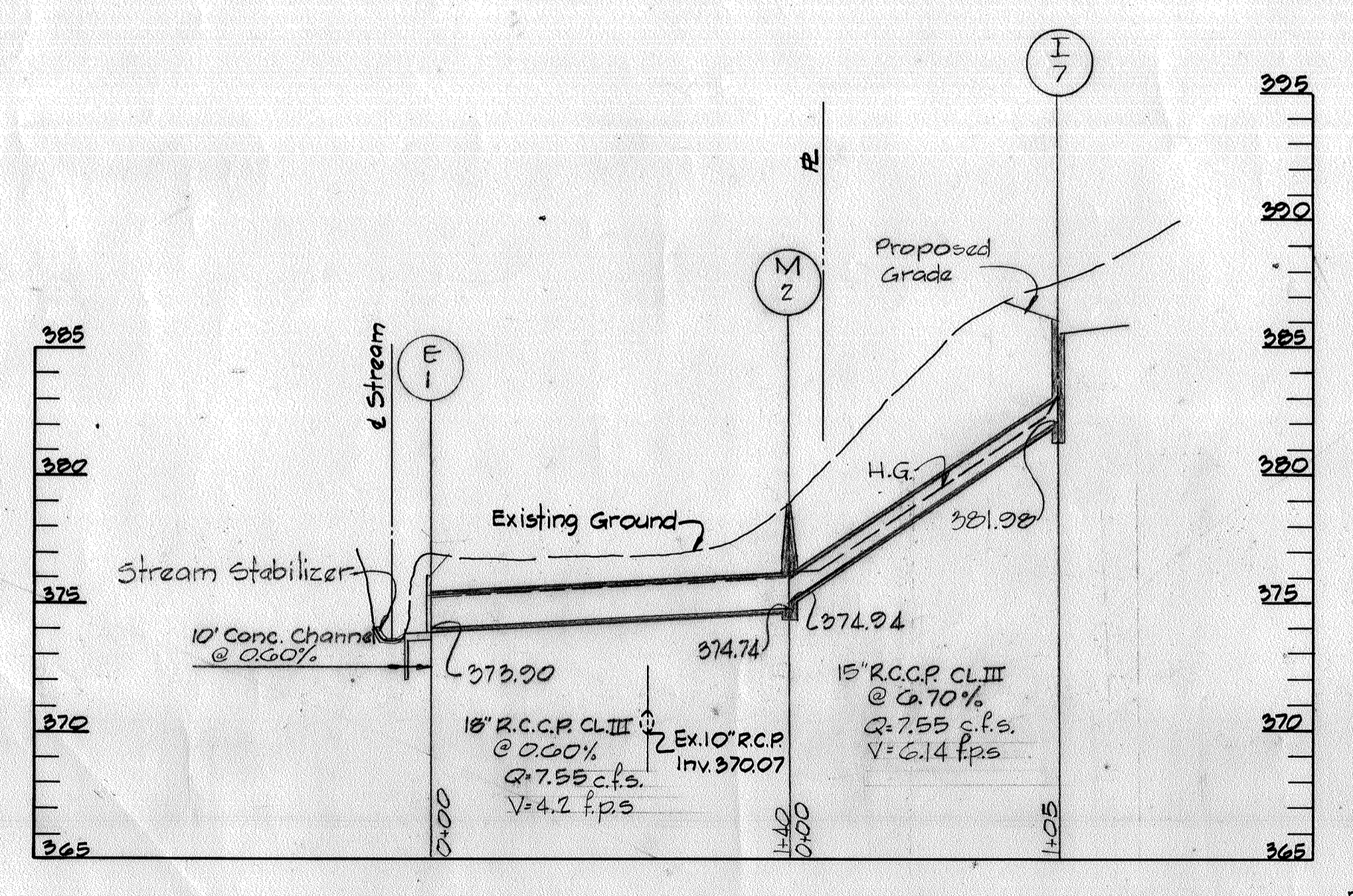
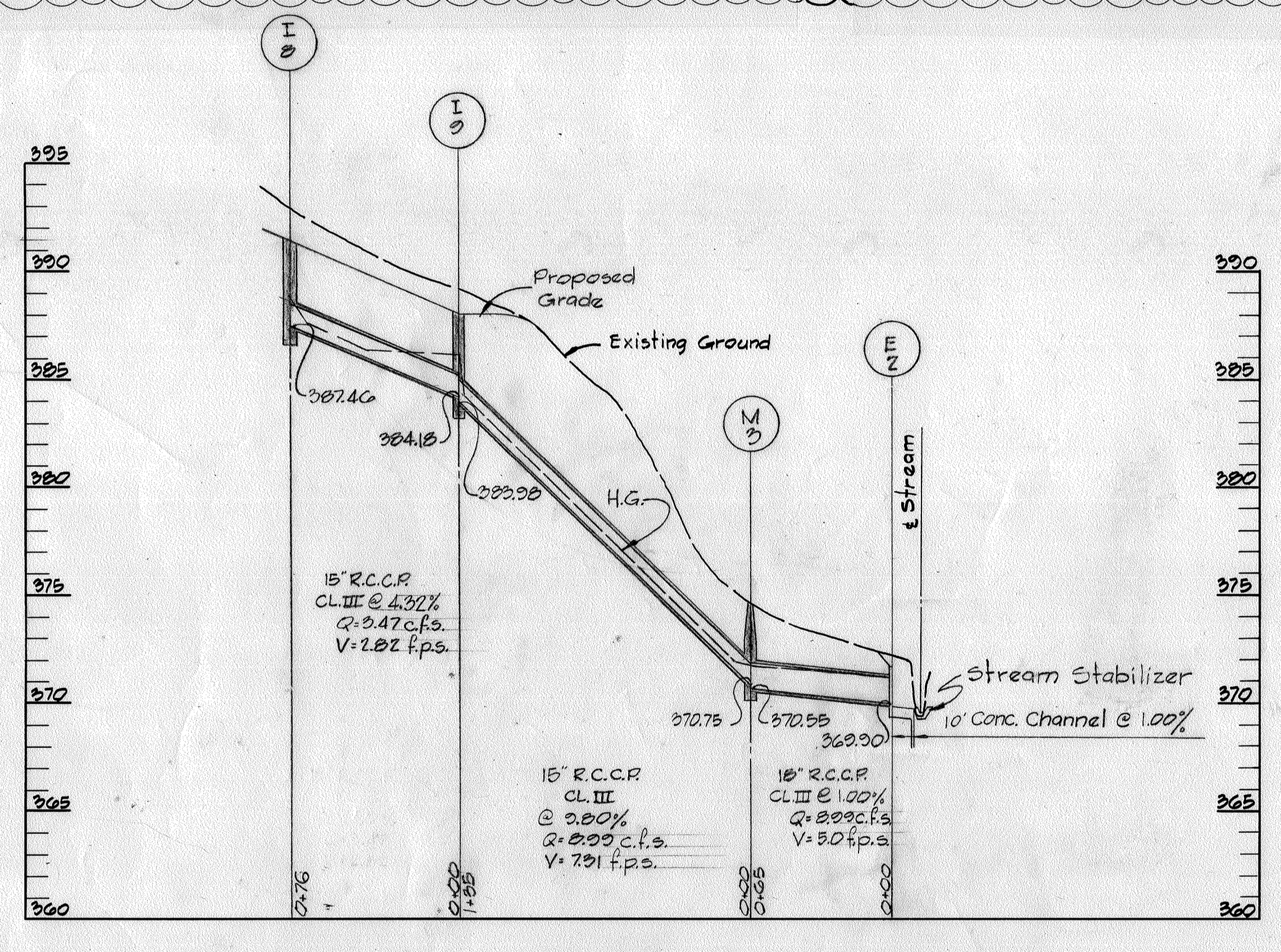
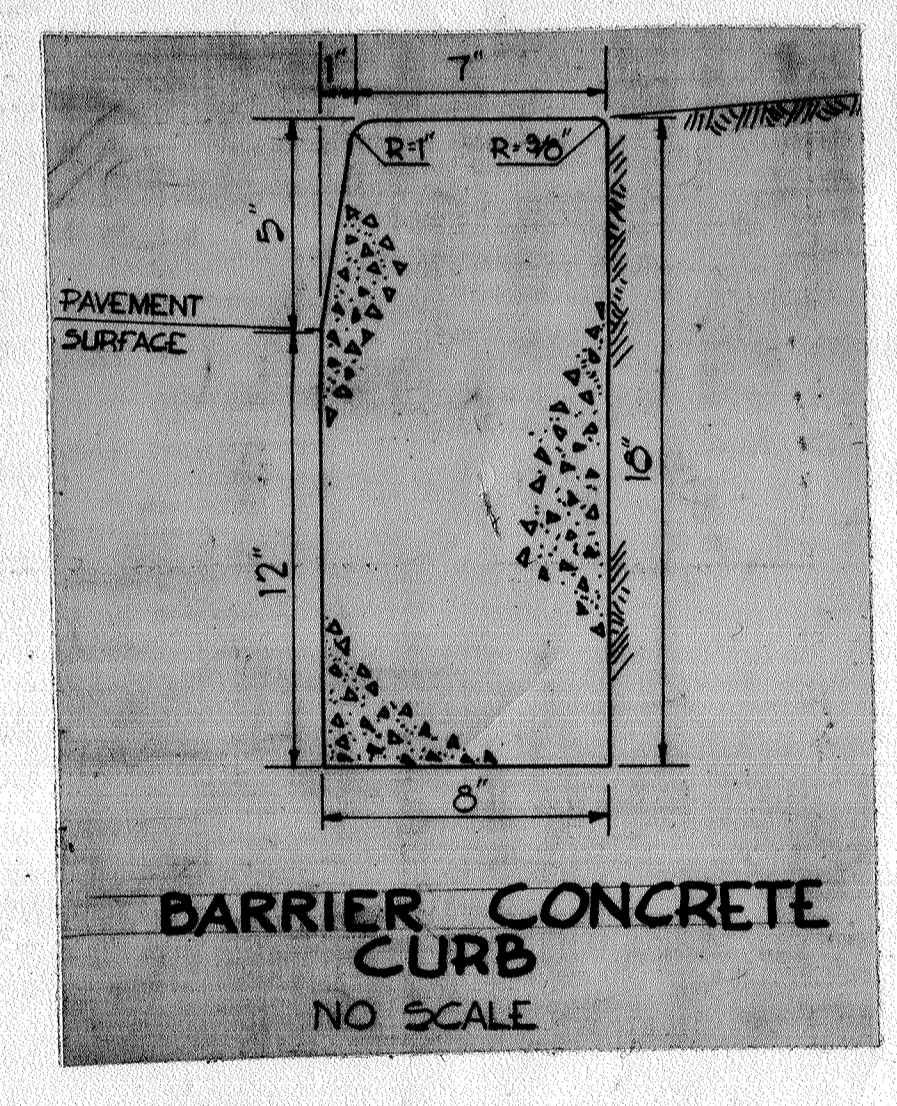
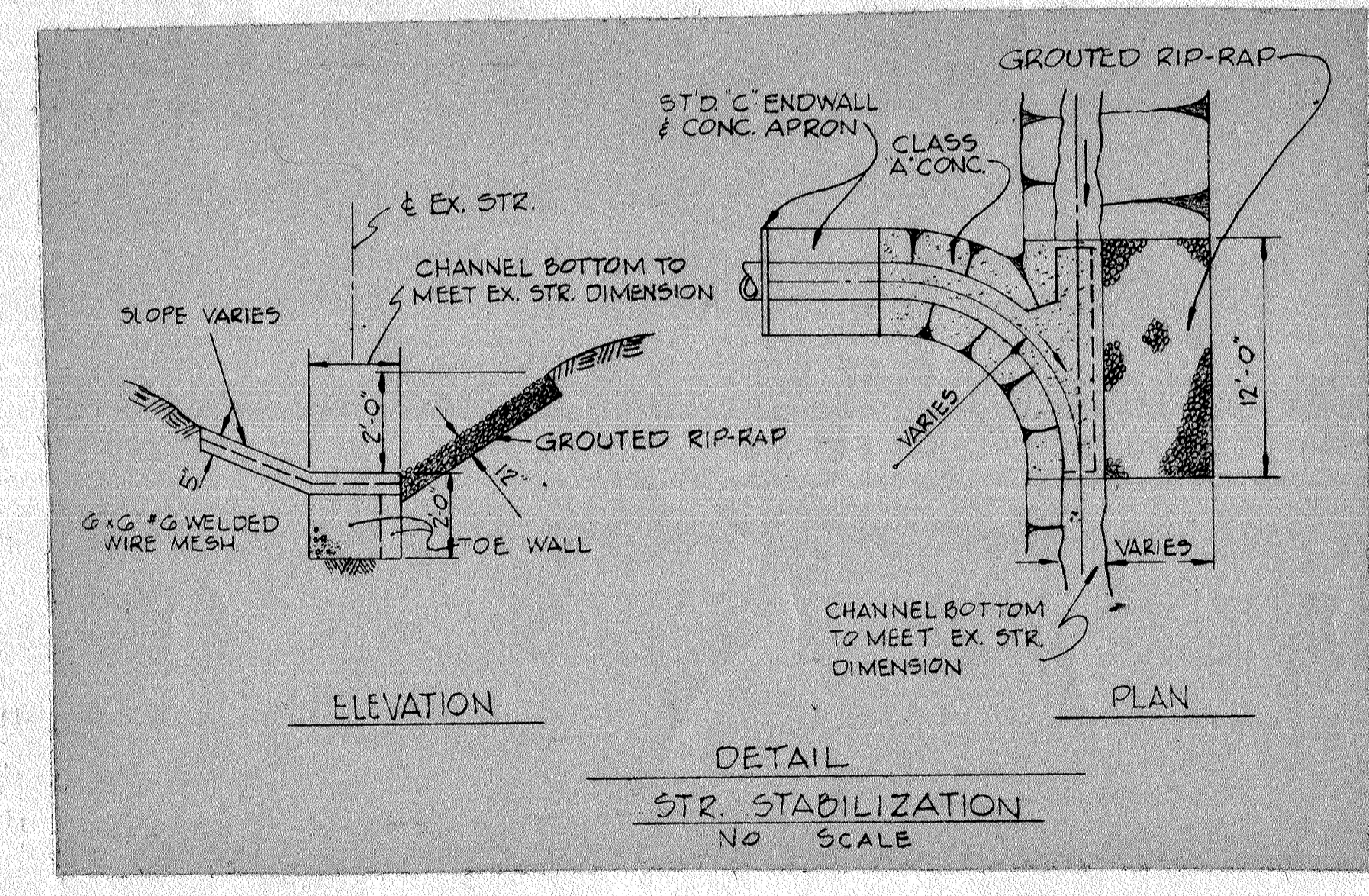
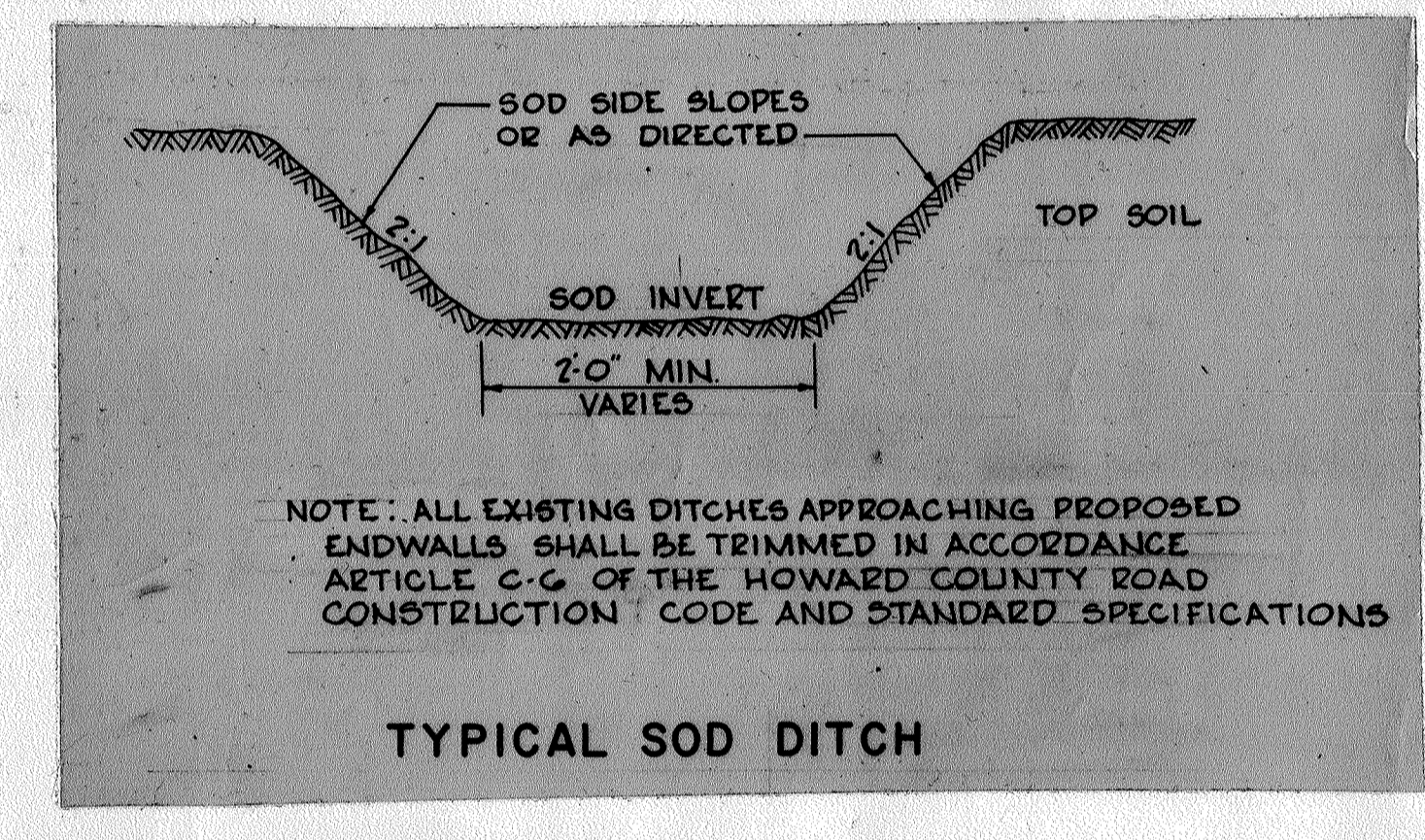
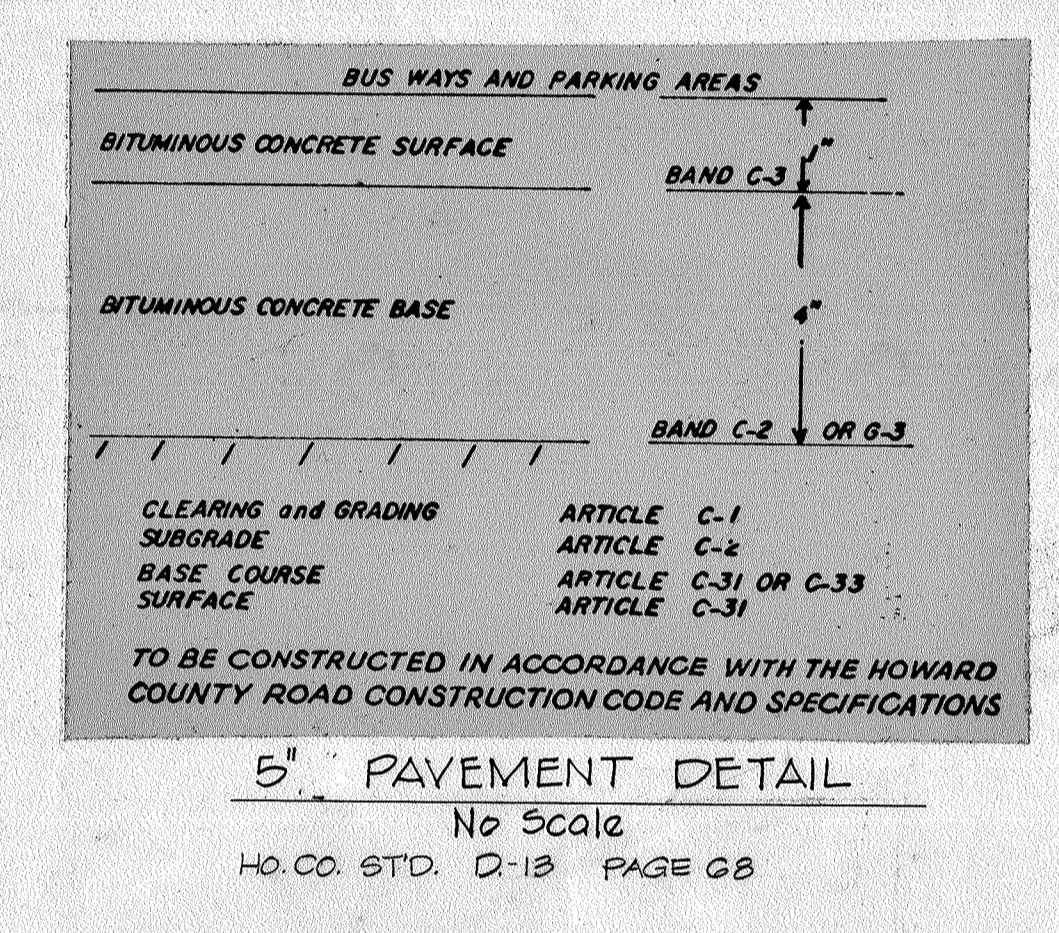
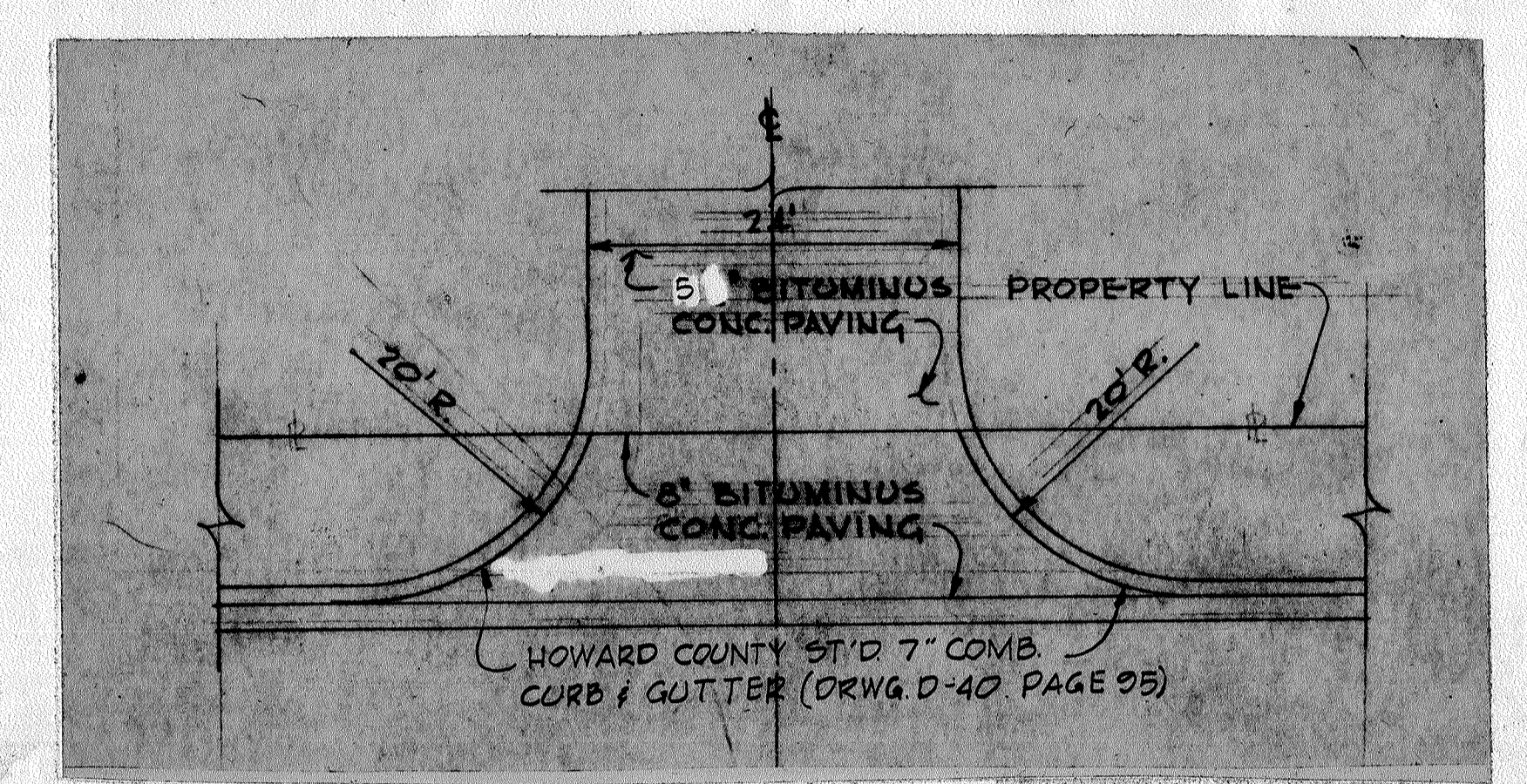

APPROVED  
PLANNING BOARD  
OF HOWARD COUNTY  
DATE 7/14/71  
Shirley Hammit

APPROVED FOR PUBLIC WATER AND PUBLIC SEWERAGE SYSTEMS, HOWARD COUNTY HEALTH DEPARTMENT  
DATE 7/14/71  
APPROVED HOWARD COUNTY OFFICE OF PLANNING AND ZONING  
DATE 10-4-71  
APPROVED FOR PUBLIC WATER, PUBLIC SEWERAGE AND STORM DRAINAGE SYSTEMS AND ROADS  
HOWARD COUNTY DEPARTMENT OF PUBLIC WORKS  
DATE 7/14/71

OWNER:  
BENNET ASSOCIATES  
1800 POTOMAC VALLEY RD.  
ROCKVILLE, MD. 20850

BENTANA WEST  
IN THE VILLAGE OF LONGREACH  
COLUMBIA, MD.  
STORM DRAINAGE PROFILES AND DETAILS  
SCALE 1"=30'

RICHARD P. BROWNE ASSOCIATES  
Columbia, Maryland  
42-3316

ENGINEERS PLANNERS ARCHITECTS  
Wayne, New Jersey

VILLAGE OF LONGREACH  
SECTION ONE - AREA ONE  
PARCEL B  
JOB NO. 100-70  
DATE 6-14-71

SD-P 71-104-C