

NO.	RADIUS	DELTA	ARC	TANG.	CHORD
1	118.00'	54.41°	118.87'	63.55'	100.52'
2	50.00'	57.00°	112.44'	70.25'	96.94'
3	246.50'	57.00°	428.03'	284.78'	428.03'
4	61.00'	74.00°	61.50'	47.91'	76.41'
5	266.92'	48.50°	117.56'	95.20'	102.58'
6	57.25'	57.50°	62.77'	53.40'	44.78'

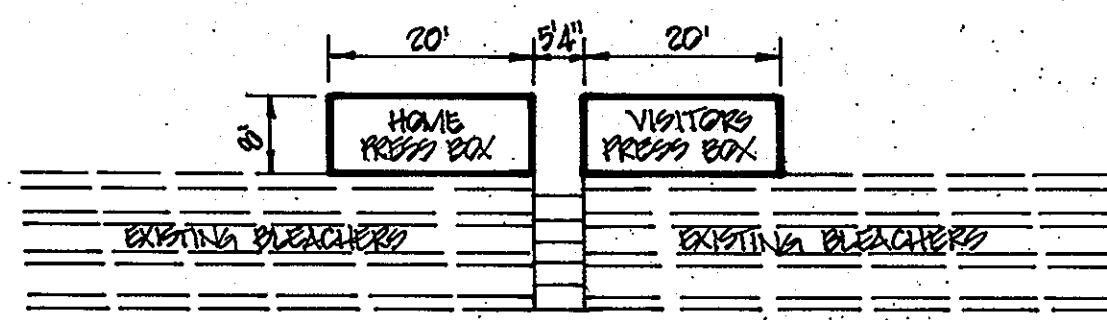

DETAIL
NO SCALE

APPROVED: [Signature]
DATE: 3/17/71
APPROVED: HOWARD COUNTY OFFICE OF PLANNING AND ZONING
DATE: 3/17/71
APPROVED: [Signature]
DATE: 3/17/71
APPROVED: [Signature]
DATE: 3/17/71

- COMPLETE SET OF SITE PLANS CONSISTS OF THE FOLLOWING PAGES:
- 1) LAYOUT PLAN FOR PRELIMINARY SITE WORK - G-1
 - 2) GRADING PLAN FOR PRELIMINARY SITE WORK - G-2
 - 3) STORM DRAINAGE PROFILE & CROSS-SECTION PRELIMINARY SITE WORK - G-3
 - 4) SEDIMENT CONTROL PLAN - G-4
 - 5) SEDIMENT CONTROL PLAN REVISIONS - G-4-R
 - 6) DRAINAGE DIVISION (D-D-1)
 - 7) STORM DRAINAGE COMPUTATIONS - 23 PAGES

SDP-71-022, VILLAGE OF OAKLAND MILLS
SECTION 2, AREA 5, LOT 1

- LEGEND
- STORM DRAIN LINE AND STRUCTURE BY THIS CONTRACT
 - EXTENT OF CONTRACT FOR FUTURE MIDDLE SCHOOL
 - EXISTING STORM DRAIN LINE STRUCTURES
 - PROPOSED STORM DRAIN BY OTHERS
 - CURVE NUMBER - REFER TO CURVE TABLE THIS DRAWING
 - STORM DRAIN STRUCTURE NUMBER - REFER TO STRUCTURE TABLE THIS DRAWING

NOTE: CONTRACTOR SHALL SUBMIT SEPARATE PRICE FOR PIPES AND STRUCTURES FROM 44-45, 46-47, 48-49, 50-51, 52-53, 54-55, 56-57, 58-59, 60-61, 62-63, 64-65, 66-67, 68-69, 70-71, 72-73, 74-75, 76-77, 78-79, 80-81, 82-83, 84-85, 86-87, 88-89, 90-91, 92-93, 94-95, 96-97, 98-99, 100-101, 102-103, 104-105, 106-107, 108-109, 110-111, 112-113, 114-115, 116-117, 118-119, 120-121, 122-123, 124-125, 126-127, 128-129, 130-131, 132-133, 134-135, 136-137, 138-139, 140-141, 142-143, 144-145, 146-147, 148-149, 150-151, 152-153, 154-155, 156-157, 158-159, 160-161, 162-163, 164-165, 166-167, 168-169, 170-171, 172-173, 174-175, 176-177, 178-179, 180-181, 182-183, 184-185, 186-187, 188-189, 190-191, 192-193, 194-195, 196-197, 198-199, 200-201, 202-203, 204-205, 206-207, 208-209, 210-211, 212-213, 214-215, 216-217, 218-219, 220-221, 222-223, 224-225, 226-227, 228-229, 230-231, 232-233, 234-235, 236-237, 238-239, 240-241, 242-243, 244-245, 246-247, 248-249, 250-251, 252-253, 254-255, 256-257, 258-259, 260-261, 262-263, 264-265, 266-267, 268-269, 270-271, 272-273, 274-275, 276-277, 278-279, 280-281, 282-283, 284-285, 286-287, 288-289, 290-291, 292-293, 294-295, 296-297, 298-299, 300-301, 302-303, 304-305, 306-307, 308-309, 310-311, 312-313, 314-315, 316-317, 318-319, 320-321, 322-323, 324-325, 326-327, 328-329, 330-331, 332-333, 334-335, 336-337, 338-339, 340-341, 342-343, 344-345, 346-347, 348-349, 350-351, 352-353, 354-355, 356-357, 358-359, 360-361, 362-363, 364-365, 366-367, 368-369, 370-371, 372-373, 374-375, 376-377, 378-379, 380-381, 382-383, 384-385, 386-387, 388-389, 390-391, 392-393, 394-395, 396-397, 398-399, 400-401, 402-403, 404-405, 406-407, 408-409, 410-411, 412-413, 414-415, 416-417, 418-419, 420-421, 422-423, 424-425, 426-427, 428-429, 430-431, 432-433, 434-435, 436-437, 438-439, 440-441, 442-443, 444-445, 446-447, 448-449, 450-451, 452-453, 454-455, 456-457, 458-459, 460-461, 462-463, 464-465, 466-467, 468-469, 470-471, 472-473, 474-475, 476-477, 478-479, 480-481, 482-483, 484-485, 486-487, 488-489, 490-491, 492-493, 494-495, 496-497, 498-499, 500-501, 502-503, 504-505, 506-507, 508-509, 510-511, 512-513, 514-515, 516-517, 518-519, 520-521, 522-523, 524-525, 526-527, 528-529, 530-531, 532-533, 534-535, 536-537, 538-539, 540-541, 542-543, 544-545, 546-547, 548-549, 550-551, 552-553, 554-555, 556-557, 558-559, 560-561, 562-563, 564-565, 566-567, 568-569, 570-571, 572-573, 574-575, 576-577, 578-579, 580-581, 582-583, 584-585, 586-587, 588-589, 590-591, 592-593, 594-595, 596-597, 598-599, 600-601, 602-603, 604-605, 606-607, 608-609, 610-611, 612-613, 614-615, 616-617, 618-619, 620-621, 622-623, 624-625, 626-627, 628-629, 630-631, 632-633, 634-635, 636-637, 638-639, 640-641, 642-643, 644-645, 646-647, 648-649, 650-651, 652-653, 654-655, 656-657, 658-659, 660-661, 662-663, 664-665, 666-667, 668-669, 670-671, 672-673, 674-675, 676-677, 678-679, 680-681, 682-683, 684-685, 686-687, 688-689, 690-691, 692-693, 694-695, 696-697, 698-699, 700-701, 702-703, 704-705, 706-707, 708-709, 710-711, 712-713, 714-715, 716-717, 718-719, 720-721, 722-723, 724-725, 726-727, 728-729, 730-731, 732-733, 734-735, 736-737, 738-739, 740-741, 742-743, 744-745, 746-747, 748-749, 750-751, 752-753, 754-755, 756-757, 758-759, 760-761, 762-763, 764-765, 766-767, 768-769, 770-771, 772-773, 774-775, 776-777, 778-779, 780-781, 782-783, 784-785, 786-787, 788-789, 790-791, 792-793, 794-795, 796-797, 798-799, 800-801, 802-803, 804-805, 806-807, 808-809, 810-811, 812-813, 814-815, 816-817, 818-819, 820-821, 822-823, 824-825, 826-827, 828-829, 830-831, 832-833, 834-835, 836-837, 838-839, 840-841, 842-843, 844-845, 846-847, 848-849, 850-851, 852-853, 854-855, 856-857, 858-859, 860-861, 862-863, 864-865, 866-867, 868-869, 870-871, 872-873, 874-875, 876-877, 878-879, 880-881, 882-883, 884-885, 886-887, 888-889, 890-891, 892-893, 894-895, 896-897, 898-899, 900-901, 902-903, 904-905, 906-907, 908-909, 910-911, 912-913, 914-915, 916-917, 918-919, 920-921, 922-923, 924-925, 926-927, 928-929, 930-931, 932-933, 934-935, 936-937, 938-939, 940-941, 942-943, 944-945, 946-947, 948-949, 950-951, 952-953, 954-955, 956-957, 958-959, 960-961, 962-963, 964-965, 966-967, 968-969, 970-971, 972-973, 974-975, 976-977, 978-979, 980-981, 982-983, 984-985, 986-987, 988-989, 990-991, 992-993, 994-995, 996-997, 998-999, 1000-1001, 1002-1003, 1004-1005, 1006-1007, 1008-1009, 1010-1011, 1012-1013, 1014-1015, 1016-1017, 1018-1019, 1020-1021, 1022-1023, 1024-1025, 1026-1027, 1028-1029, 1030-1031, 1032-1033, 1034-1035, 1036-1037, 1038-1039, 1040-1041, 1042-1043, 1044-1045, 1046-1047, 1048-1049, 1050-1051, 1052-1053, 1054-1055, 1056-1057, 1058-1059, 1060-1061, 1062-1063, 1064-1065, 1066-1067, 1068-1069, 1070-1071, 1072-1073, 1074-1075, 1076-1077, 1078-1079, 1080-1081, 1082-1083, 1084-1085, 1086-1087, 1088-1089, 1090-1091, 1092-1093, 1094-1095, 1096-1097, 1098-1099, 1100-1101, 1102-1103, 1104-1105, 1106-1107, 1108-1109, 1110-1111, 1112-1113, 1114-1115, 1116-1117, 1118-1119, 1120-1121, 1122-1123, 1124-1125, 1126-1127, 1128-1129, 1130-1131, 1132-1133, 1134-1135, 1136-1137, 1138-1139, 1140-1141, 1142-1143, 1144-1145, 1146-1147, 1148-1149, 1150-1151, 1152-1153, 1154-1155, 1156-1157, 1158-1159, 1160-1161, 1162-1163, 1164-1165, 1166-1167, 1168-1169, 1170-1171, 1172-1173, 1174-1175, 1176-1177, 1178-1179, 1180-1181, 1182-1183, 1184-1185, 1186-1187, 1188-1189, 1190-1191, 1192-1193, 1194-1195, 1196-1197, 1198-1199, 1200-1201, 1202-1203, 1204-1205, 1206-1207, 1208-1209, 1210-1211, 1212-1213, 1214-1215, 1216-1217, 1218-1219, 1220-1221, 1222-1223, 1224-1225, 1226-1227, 1228-1229, 1230-1231, 1232-1233, 1234-1235, 1236-1237, 1238-1239, 1240-1241, 1242-1243, 1244-1245, 1246-1247, 1248-1249, 1250-1251, 1252-1253, 1254-1255, 1256-1257, 1258-1259, 1260-1261, 1262-1263, 1264-1265, 1266-1267, 1268-1269, 1270-1271, 1272-1273, 1274-1275, 1276-1277, 1278-1279, 1280-1281, 1282-1283, 1284-1285, 1286-1287, 1288-1289, 1290-1291, 1292-1293, 1294-1295, 1296-1297, 1298-1299, 1300-1301, 1302-1303, 1304-1305, 1306-1307, 1308-1309, 1310-1311, 1312-1313, 1314-1315, 1316-1317, 1318-1319, 1320-1321, 1322-1323, 1324-1325, 1326-1327, 1328-1329, 1330-1331, 1332-1333, 1334-1335, 1336-1337, 1338-1339, 1340-1341, 1342-1343, 1344-1345, 1346-1347, 1348-1349, 1350-1351, 1352-1353, 1354-1355, 1356-1357, 1358-1359, 1360-1361, 1362-1363, 1364-1365, 1366-1367, 1368-1369, 1370-1371, 1372-1373, 1374-1375, 1376-1377, 1378-1379, 1380-1381, 1382-1383, 1384-1385, 1386-1387, 1388-1389, 1390-1391, 1392-1393, 1394-1395, 1396-1397, 1398-1399, 1400-1401, 1402-1403, 1404-1405, 1406-1407, 1408-1409, 1410-1411, 1412-1413, 1414-1415, 1416-1417, 1418-1419, 1420-1421, 1422-1423, 1424-1425, 1426-1427, 1428-1429, 1430-1431, 1432-1433, 1434-1435, 1436-1437, 1438-1439, 1440-1441, 1442-1443, 1444-1445, 1446-1447, 1448-1449, 1450-1451, 1452-1453, 1454-1455, 1456-1457, 1458-1459, 1460-1461, 1462-1463, 1464-1465, 1466-1467, 1468-1469, 1470-1471, 1472-1473, 1474-1475, 1476-1477, 1478-1479, 1480-1481, 1482-1483, 1484-1485, 1486-1487, 1488-1489, 1490-1491, 1492-1493, 1494-1495, 1496-1497, 1498-1499, 1500-1501, 1502-1503, 1504-1505, 1506-1507, 1508-1509, 1510-1511, 1512-1513, 1514-1515, 1516-1517, 1518-1519, 1520-1521, 1522-1523, 1524-1525, 1526-1527, 1528-1529, 1530-1531, 1532-1533, 1534-1535, 1536-1537, 1538-1539, 1540-1541, 1542-1543, 1544-1545, 1546-1547, 1548-1549, 1550-1551, 1552-1553, 1554-1555, 1556-1557, 1558-1559, 1560-1561, 1562-1563, 1564-1565, 1566-1567, 1568-1569, 1570-1571, 1572-1573, 1574-1575, 1576-1577, 1578-1579, 1580-1581, 1582-1583, 1584-1585, 1586-1587, 1588-1589, 1590-1591, 1592-1593, 1594-1595, 1596-1597, 1598-1599, 1600-1601, 1602-1603, 1604-1605, 1606-1607, 1608-1609, 1610-1611, 1612-1613, 1614-1615, 1616-1617, 1618-1619, 1620-1621, 1622-1623, 1624-1625, 1626-1627, 1628-1629, 1630-1631, 1632-1633, 1634-1635, 1636-1637, 1638-1639, 1640-1641, 1642-1643, 1644-1645, 1646-1647, 1648-1649, 1650-1651, 1652-1653, 1654-1655, 1656-1657, 1658-1659, 1660-1661, 1662-1663, 1664-1665, 1666-1667, 1668-1669, 1670-1671, 1672-1673, 1674-1675, 1676-1677, 1678-1679, 1680-1681, 1682-1683, 1684-1685, 1686-1687, 1688-1689, 1690-1691, 1692-1693, 1694-1695, 1696-1697, 1698-1699, 1700-1701, 1702-1703, 1704-1705, 1706-1707, 1708-1709, 1710-1711, 1712-1713, 1714-1715, 1716-1717, 1718-1719, 1720-1721, 1722-1723, 1724-1725, 1726-1727, 1728-1729, 1730-1731, 1732-1733, 1734-1735, 1736-1737, 1738-1739, 1740-1741, 1742-1743, 1744-1745, 1746-1747, 1748-1749, 1750-1751, 1752-1753, 1754-1755, 1756-1757, 1758-1759, 1760-1761, 1762-1763, 1764-1765, 1766-1767, 1768-1769, 1770-1771, 1772-1773, 1774-1775, 1776-1777, 1778-1779, 1780-1781, 1782-1783, 1784-1785, 1786-1787, 1788-1789, 1790-1791, 1792-1793, 1794-1795, 1796-1797, 1798-1799, 1800-1801, 1802-1803, 1804-1805, 1806-1807, 1808-1809, 1810-1811, 1812-1813, 1814-1815, 1816-1817, 1818-1819, 1820-1821, 1822-1823, 1824-1825, 1826-1827, 1828-1829, 1830-1831, 1832-1833, 1834-1835, 1836-1837, 1838-1839, 1840-1841, 1842-1843, 1844-1845, 1846-1847, 1848-1849, 1850-1851, 1852-1853, 1854-1855, 1856-1857, 1858-1859, 1860-1861, 1862-1863, 1864-1865, 1866-1867, 1868-1869, 1870-1871, 1872-1873, 1874-1875, 1876-1877, 1878-1879, 1880-1881, 1882-1883, 1884-1885, 1886-1887, 1888-1889, 1890-1891, 1892-1893, 1894-1895, 1896-1897, 1898-1899, 1900-1901, 1902-1903, 1904-1905, 1906-1907, 1908-1909, 1910-1911, 1912-1913, 1914-1915, 1916-1917, 1918-1919, 1920-1921, 1922-1923, 1924-1925, 1926-1927, 1928-1929, 1930-1931, 1932-1933, 1934-1935, 1936-1937, 1938-1939, 1940-1941, 1942-1943, 1944-1945, 1946-1947, 1948-1949, 1950-1951, 1952-1953, 1954-1955, 1956-1957, 1958-1959, 1960-1961, 1962-1963, 1964-1965, 1966-1967, 1968-1969, 1970-1971, 1972-1973, 1974-1975, 1976-1977, 1978-1979, 1980-1981, 1982-1983, 1984-1985, 1986-1987, 1988-1989, 1990-1991, 1992-1993, 1994-1995, 1996-1997, 1998-1999, 2000-2001, 2002-2003, 2004-2005, 2006-2007, 2008-2009, 2010-2011, 2012-2013, 2014-2015, 2016-2017, 2018-2019, 2020-2021, 2022-2023, 2024-2025, 2026-2027, 2028-2029, 2030-2031, 2032-2033, 2034-2035, 2036-2037, 2038-2039, 2040-2041, 2042-2043, 2044-2045, 2046-2047, 2048-2049, 2050-2051, 2052-2053, 2054-2055, 2056-2057, 2058-2059, 2060-2061, 2062-2063, 2064-2065, 2066-2067, 2068-2069, 2070-2071, 2072-2073, 2074-2075, 2076-2077, 2078-2079, 2080-2081, 2082-2083, 2084-2085, 2086-2087, 2088-2089, 2090-2091, 2092-2093, 2094-2095, 2096-2097, 2098-2099, 2100-2101, 2102-2103, 2104-2105, 2106-2107, 2108-2109, 2110-2111, 2112-2113, 2114-2115, 2116-2117, 2118-2119, 2120-2121, 2122-2123, 2124-2125, 2126-2127, 2128-2129, 2130-2131, 2132-2133, 2134-2135, 2136-2137, 2138-2139, 2140-2141, 2142-2143, 2144-2145, 2146-2147, 2148-2149, 2150-2151, 2152-2153, 2154-2155, 2156-2157, 2158-2159, 2160-2161, 2162-2163, 2164-2165, 2166-2167, 2168-2169, 2170-2171, 2172-2173, 2174-2175, 2176-2177, 2178-2179, 2180-2181, 2182-2183, 2184-2185, 2186-2187, 2188-2189, 2190-2191, 2192-2193, 2194-2195, 2196-2197, 2198-2199, 2200-2201, 2202-2203, 2204-2205, 2206-2207, 2208-2209, 2210-2211, 2212-2213, 2214-2215, 2216-2217, 2218-2219, 2220-2221, 2222-2223, 2224-2225, 2226-2227, 2228-2229, 2230-2231, 2232-2233, 2234-2235, 2236-2237, 2238-2239, 2240-2241, 2242-2243, 2244

CERTIFICATION

"I CERTIFY THAT THE PLAN OF DEVELOPMENT AND THE PLAN FOR CONTROL OF SILT AND SEDIMENT MEETS THE REQUIREMENTS, STANDARDS, AND SPECIFICATIONS OF HOWARD COUNTY SOIL CONSERVATION DISTRICT."

DESIGNED BY: *[Signature]* DATE: _____

"I CERTIFY THAT ALL DEVELOPMENT AND/OR CONSTRUCTION WILL BE DONE ACCORDING TO THIS PLAN OF DEVELOPMENT AND PLAN OF SILT AND SEDIMENT CONTROL."

APPROVED: _____ DATE: _____

"THIS DEVELOPMENT PLAN IS APPROVED FOR SOIL EROSION AND SEDIMENT CONTROL BY THE HOWARD COUNTY SOIL CONSERVATION DISTRICT."

APPROVED: *[Signature]* DATE: 8-11-71

APPROVED: *[Signature]* DATE: 8-11-71

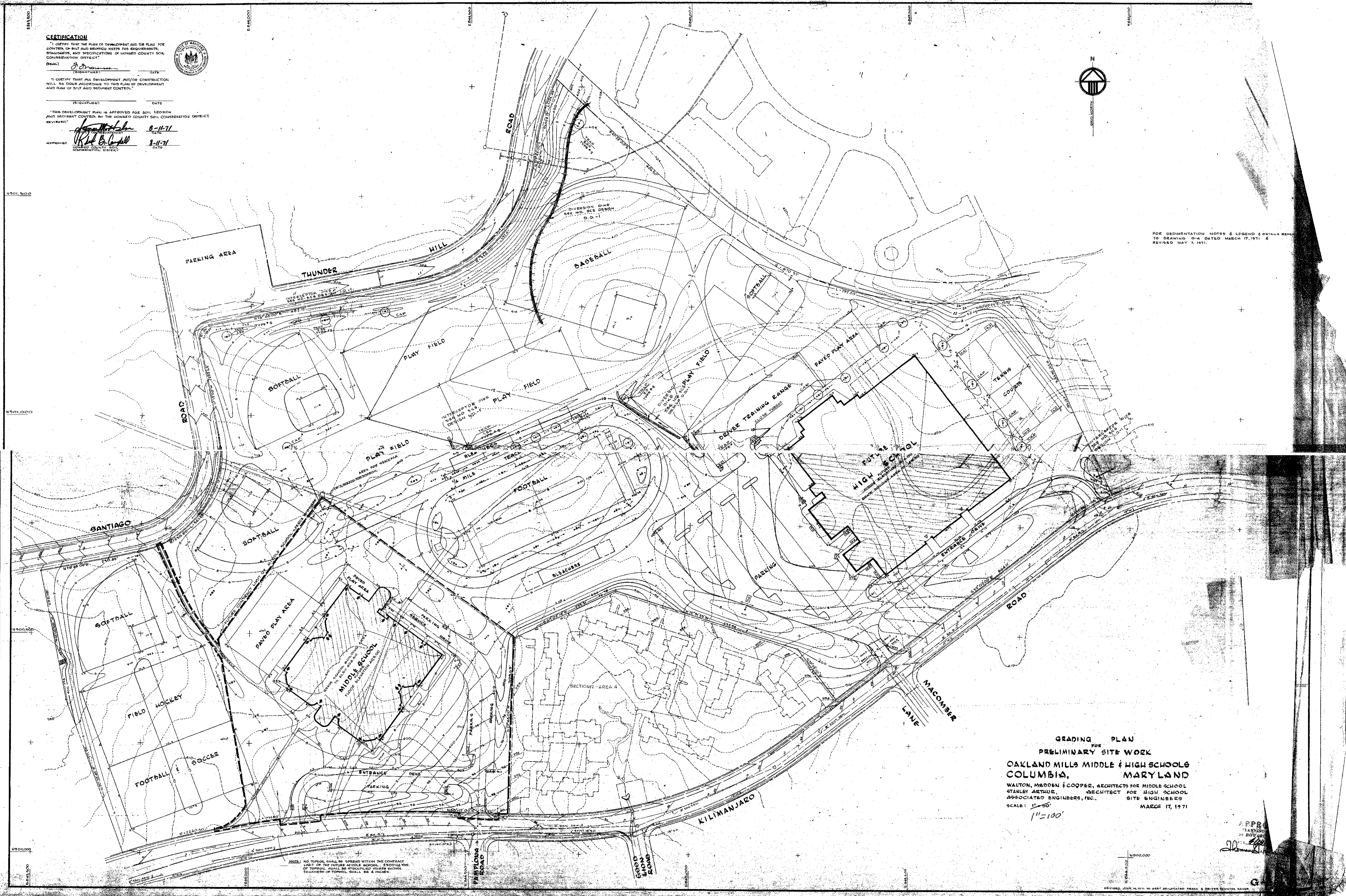
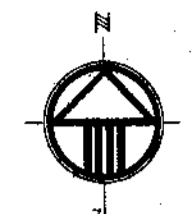

FOR SEDIMENTATION NOTES & LEGEND & DETAILS REFER TO DRAWING G-4 DATED MARCH 17, 1971 & REVISED MAY 7, 1971.

GRADING PLAN
FOR
PRELIMINARY SITE WORK
OAKLAND MILLS MIDDLE & HIGH SCHOOLS
COLUMBIA, MARYLAND
WALTON, MADDEN & COOPER, ARCHITECTS FOR MIDDLE SCHOOL
STANLEY ARTHUR, ARCHITECT FOR HIGH SCHOOL
ASSOCIATED ENGINEERS, INC., SITE ENGINEERS
SCALE: 1"=50'
MARCH 17, 1971

NOTE: NO TOPSOIL SHALL BE SPREAD WITHIN THE CONTRACT LIMITS OF THE FUTURE MIDDLE SCHOOL, 2,500 SQ. YD. OF TOPSOIL SHALL BE STOCKPILED WHERE SHOWN. THICKNESS OF TOPSOIL SHALL BE 4 INCHES.

APPROVED: *[Signature]*

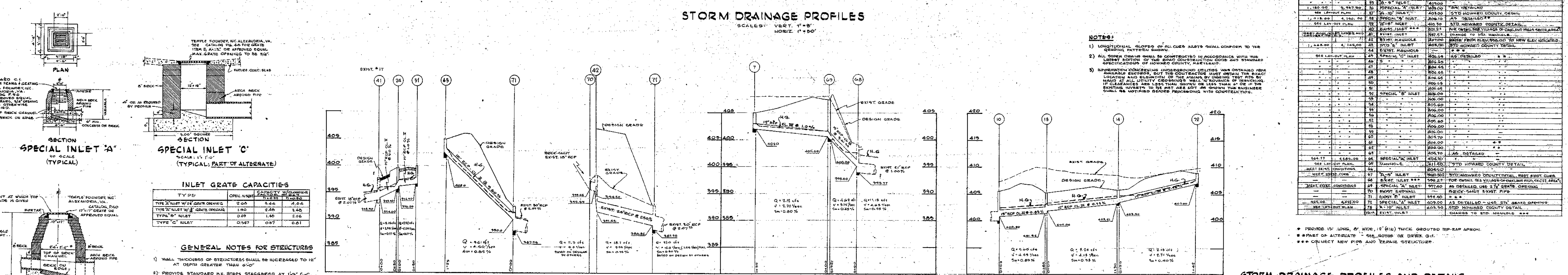
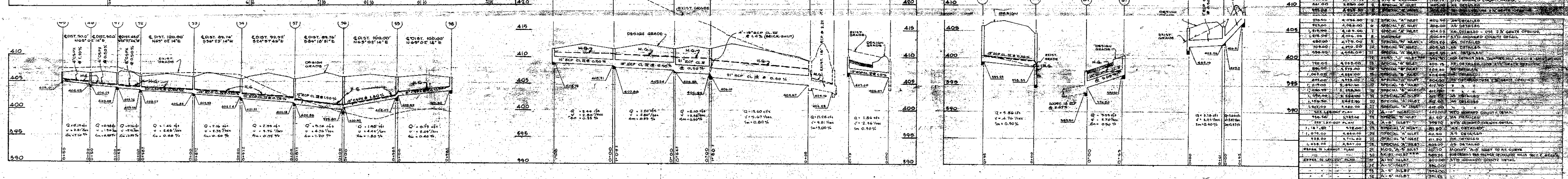
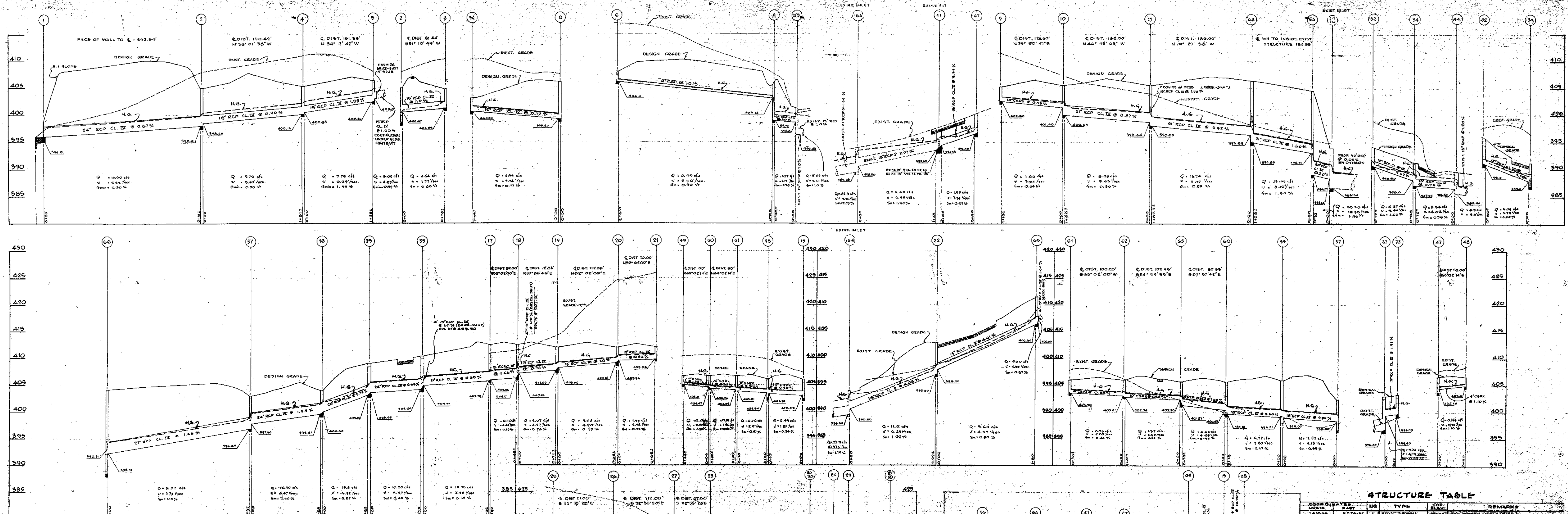

STRUCTURE TABLE

STATION	NO.	TYPE	REMARKS
1	1	18" x 18" INLET	AS SHOWN ON PLAN
2	2	18" x 18" INLET	AS SHOWN ON PLAN
3	3	18" x 18" INLET	AS SHOWN ON PLAN
4	4	18" x 18" INLET	AS SHOWN ON PLAN
5	5	18" x 18" INLET	AS SHOWN ON PLAN
6	6	18" x 18" INLET	AS SHOWN ON PLAN
7	7	18" x 18" INLET	AS SHOWN ON PLAN
8	8	18" x 18" INLET	AS SHOWN ON PLAN
9	9	18" x 18" INLET	AS SHOWN ON PLAN
10	10	18" x 18" INLET	AS SHOWN ON PLAN
11	11	18" x 18" INLET	AS SHOWN ON PLAN
12	12	18" x 18" INLET	AS SHOWN ON PLAN
13	13	18" x 18" INLET	AS SHOWN ON PLAN
14	14	18" x 18" INLET	AS SHOWN ON PLAN
15	15	18" x 18" INLET	AS SHOWN ON PLAN
16	16	18" x 18" INLET	AS SHOWN ON PLAN
17	17	18" x 18" INLET	AS SHOWN ON PLAN
18	18	18" x 18" INLET	AS SHOWN ON PLAN
19	19	18" x 18" INLET	AS SHOWN ON PLAN
20	20	18" x 18" INLET	AS SHOWN ON PLAN
21	21	18" x 18" INLET	AS SHOWN ON PLAN
22	22	18" x 18" INLET	AS SHOWN ON PLAN
23	23	18" x 18" INLET	AS SHOWN ON PLAN
24	24	18" x 18" INLET	AS SHOWN ON PLAN
25	25	18" x 18" INLET	AS SHOWN ON PLAN
26	26	18" x 18" INLET	AS SHOWN ON PLAN
27	27	18" x 18" INLET	AS SHOWN ON PLAN
28	28	18" x 18" INLET	AS SHOWN ON PLAN
29	29	18" x 18" INLET	AS SHOWN ON PLAN
30	30	18" x 18" INLET	AS SHOWN ON PLAN
31	31	18" x 18" INLET	AS SHOWN ON PLAN
32	32	18" x 18" INLET	AS SHOWN ON PLAN
33	33	18" x 18" INLET	AS SHOWN ON PLAN
34	34	18" x 18" INLET	AS SHOWN ON PLAN
35	35	18" x 18" INLET	AS SHOWN ON PLAN
36	36	18" x 18" INLET	AS SHOWN ON PLAN
37	37	18" x 18" INLET	AS SHOWN ON PLAN
38	38	18" x 18" INLET	AS SHOWN ON PLAN
39	39	18" x 18" INLET	AS SHOWN ON PLAN
40	40	18" x 18" INLET	AS SHOWN ON PLAN
41	41	18" x 18" INLET	AS SHOWN ON PLAN
42	42	18" x 18" INLET	AS SHOWN ON PLAN
43	43	18" x 18" INLET	AS SHOWN ON PLAN
44	44	18" x 18" INLET	AS SHOWN ON PLAN
45	45	18" x 18" INLET	AS SHOWN ON PLAN
46	46	18" x 18" INLET	AS SHOWN ON PLAN
47	47	18" x 18" INLET	AS SHOWN ON PLAN
48	48	18" x 18" INLET	AS SHOWN ON PLAN
49	49	18" x 18" INLET	AS SHOWN ON PLAN
50	50	18" x 18" INLET	AS SHOWN ON PLAN
51	51	18" x 18" INLET	AS SHOWN ON PLAN
52	52	18" x 18" INLET	AS SHOWN ON PLAN
53	53	18" x 18" INLET	AS SHOWN ON PLAN
54	54	18" x 18" INLET	AS SHOWN ON PLAN
55	55	18" x 18" INLET	AS SHOWN ON PLAN
56	56	18" x 18" INLET	AS SHOWN ON PLAN
57	57	18" x 18" INLET	AS SHOWN ON PLAN
58	58	18" x 18" INLET	AS SHOWN ON PLAN
59	59	18" x 18" INLET	AS SHOWN ON PLAN
60	60	18" x 18" INLET	AS SHOWN ON PLAN
61	61	18" x 18" INLET	AS SHOWN ON PLAN
62	62	18" x 18" INLET	AS SHOWN ON PLAN
63	63	18" x 18" INLET	AS SHOWN ON PLAN
64	64	18" x 18" INLET	AS SHOWN ON PLAN

STORM DRAINAGE PROFILES

SCALE: VERT. 1"=10'
HORIZ. 1"=50'

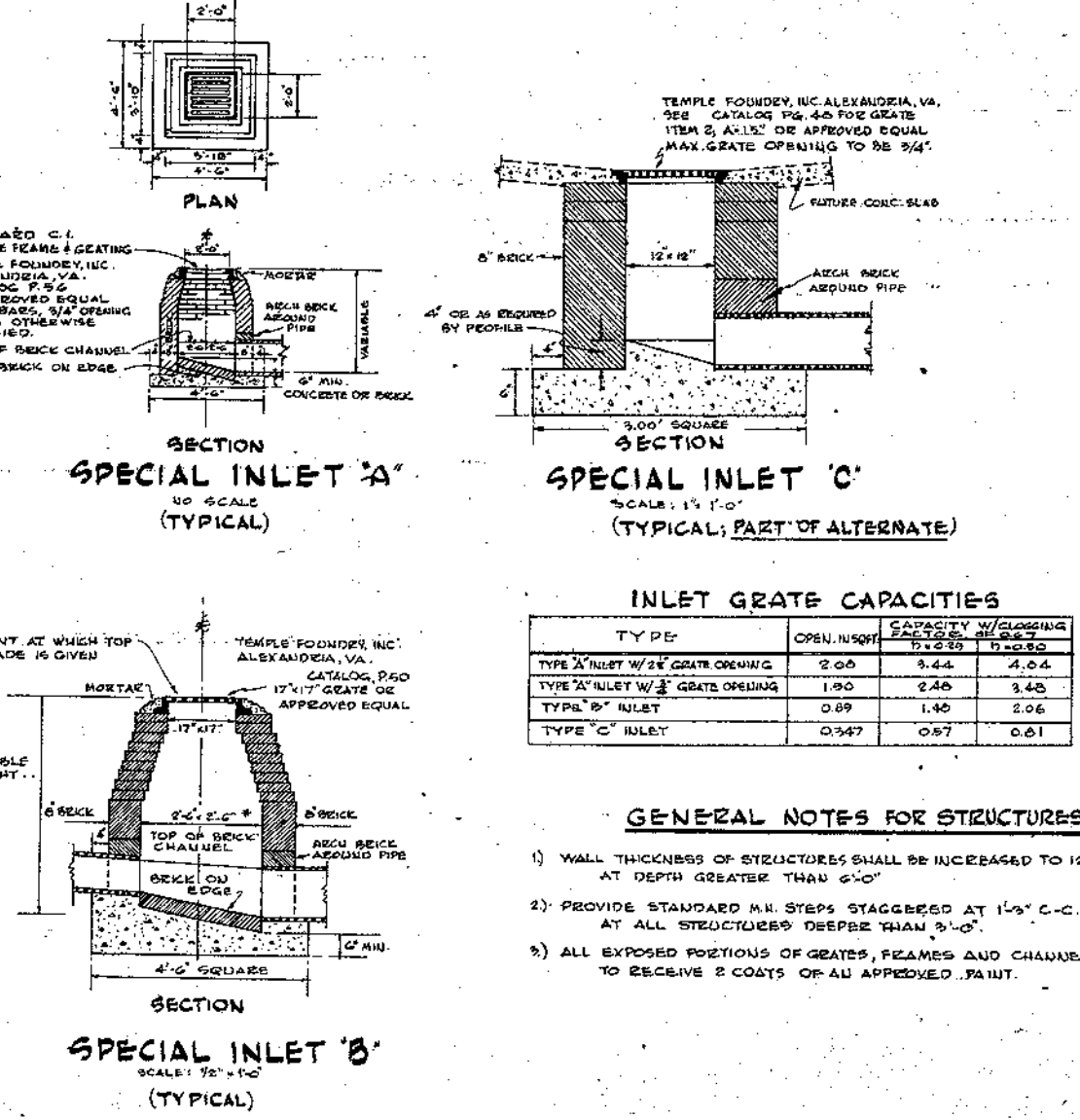

INLET GRATE CAPACITIES

TYPE	DEPTH	WIDTH	AREA	Q (CFS)
TYPE 'A' INLET	1.00	2.00	2.00	3.50
TYPE 'B' INLET	0.67	1.00	0.67	1.00
TYPE 'C' INLET	0.67	0.67	0.45	0.67

GENERAL NOTES FOR STRUCTURES

- 1) WALL THICKNESS OF STRUCTURES SHALL BE INCREASED TO 12" AT DEPTH GREATER THAN 6'0".
- 2) PROVIDE STANDARD REBAR STAGGERED AT 12" C.C. AT ALL STRUCTURES DEEPER THAN 6'0".
- 3) ALL EXPOSED PORTIONS OF GRATES, FRAMES AND CHANNELS TO RECEIVE 2 COATS OF AN APPROVED PAINT.

NOTES

- 1) LONGITUDINAL SLOPES OF ALL CURBS SHALL CONFORM TO THE GRADING PATTERN SHOWN.
- 2) ALL WORK SHALL BE COMPLETED IN ACCORDANCE WITH THE LATEST EDITION OF THE STANDARD SPECIFICATIONS FOR HIGHWAY CONSTRUCTION OF HOWARD COUNTY, MARYLAND.
- 3) REVISIONS TO THIS DRAWING SHALL BE INDICATED BY CIRCLED NUMBERS AND LETTERS. ANY CHANGES TO THE ORIGINAL DESIGN SHALL BE NOTIFIED BEFORE PROCEEDING WITH CONSTRUCTION.

STORM DRAINAGE PROFILES AND DETAILS
FOR
PRELIMINARY SITE WORK
OAKLAND MILLS MIDDLE & HIGH SCHOOLS
COLUMBIA, MARYLAND
WALTON, MADDEN & COOPER, ARCHITECTS FOR MIDDLE SCHOOL
STANLEY, ARTHUR, ARCHITECT FOR HIGH SCHOOL
ASSOCIATED ENGINEERS, INC., SITE ENGINEERS
SCALE AS SHOWN
MARCH 29, 1971

APPROVED
PLANNING BOARD
OF HOWARD COUNTY
DATE: 3/29/71
BY: [Signature]

CERTIFICATION
 I, Ed B. Campbell, certify that the plan of development and the plan for control of silt and erosion areas, the requirements, standards, and specifications of HOWARD COUNTY SOIL CONSERVATION DISTRICT.



I, Ed B. Campbell, certify that all development and/or construction will be done according to this plan of development and silt and erosion control.
 DATE: 2-11-71
 I, Ed B. Campbell, certify that this development plan is approved for soil erosion and sediment control by the HOWARD COUNTY SOIL CONSERVATION DISTRICT.
 DATE: 2-11-71
 APPROVED: Ed B. Campbell
 HOWARD COUNTY SOIL CONSERVATION DISTRICT

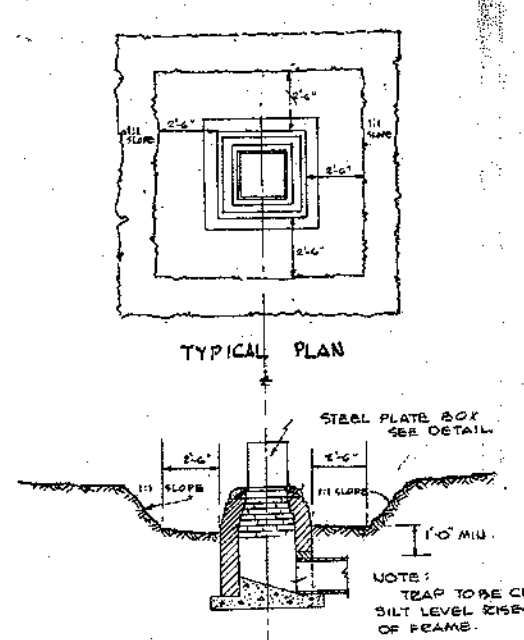
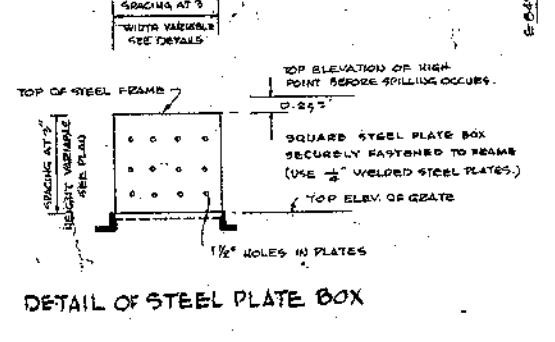
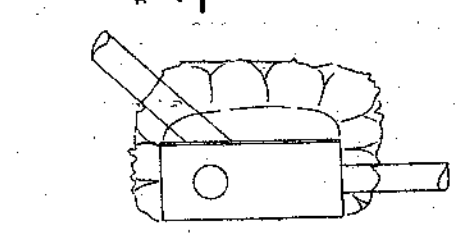
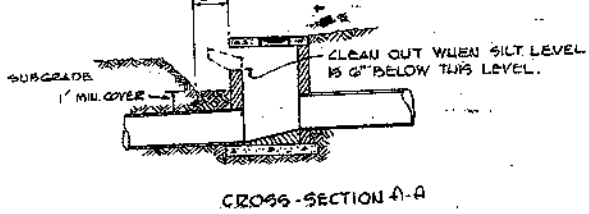

- LEGEND**
- EXISTING CONTOURS
 - - - FINISHED DESIGN CONTOUR THIS CONTRACT
 - - - EXISTING CONTOURS BY OTHERS
 - FINISHED SLOPE GRADES
 - - - FINISHED SPOT GRADES
 - SPOT GRADES FOR UNIMPROVED AREAS
 - DRAINAGE STRUCTURES
 - LIMIT OF CONTRACT FOR FUTURE MIDDLE SCHOOL - SEE GENERAL NOTE #1
 - TEMPORARY INTERCEPTOR INTERCEPTOR DICES
 - SILT TRAP
 - INTERCEPTOR
 - SILT TRAP WITH FLOW THROUGH INTERCEPTOR
 - CURB INLET TRAPPED
 - CURB INLET TRAPPED
 - CURB INLET TRAPPED

- SEDIMENTATION NOTES**
- 1) NO TEMPORARY SEDIMENTATION MEASURES ARE TO BE PERMITTED WITHOUT PERMISSION BY THE SOIL CONSERVATION DISTRICT.
 - 2) ALL GRADING, SPREADING, SEDIMENT AND MULCHING TO MEET ALL APPLICABLE REQUIREMENTS OF THE SOIL CONSERVATION DISTRICT AND THE "STANDARDS AND SPECIFICATIONS FOR SOIL SEDIMENT AND SEDIMENT CONTROL UNIMPROVED AREAS".
 - 3) SEDIMENT IS TO BE REMOVED IMMEDIATELY AFTER FINAL GRADING.
 - 4) TYPICAL DEPTH SHALL BE 4" COMPACTED.
 - 5) HOWARD COUNTY SOIL CONSERVATION DISTRICT SHALL BE NOTIFIED AT LEAST 72 HOURS PRIOR TO THE RESUMPTION OF GRADING OPERATIONS.
 - 6) MULCH SHALL BE SPREAD AT THE RATE OF ONE TON PER ACRE IN LIEU OF THE REQUIREMENTS GIVEN ON THESE PLANS OR PRECEDENT STANDARDS AND SPECIFICATIONS FOR SOIL SEDIMENT.
 - 7) MULCH SHALL BE SPREAD AT THE RATE OF ONE TON PER ACRE IN LIEU OF THE REQUIREMENTS GIVEN ON THESE PLANS OR PRECEDENT STANDARDS AND SPECIFICATIONS FOR SOIL SEDIMENT.
 - 8) MULCH FOR PERMANENT TREES SHALL BE 40 TONS PER ACRE OF MULCH. MULCH FOR PERMANENT TREES SHALL BE ALL CHIPPED, UNWEED AREA.
 - 9) ALL FUTURE PAVED OR UNPAVED AREAS SHALL BE PROTECTED THROUGH MULCHING WITH MULCHES AT THE RATE OF ONE TON PER 100 SQ. FT. (AREA WITHIN LIMITS OF FUTURE MIDDLE SCHOOL SHALL RECEIVE 12 TONS PER ACRE).
 - 10) IMMEDIATELY AFTER SEDIMENT, THESE AREAS SHALL BE UNWEED AND MULCHES TO MAINTAIN A MULCH OF APPROXIMATELY 1/2" ABOVE MULCHED SURFACE. (REFER TO PAGE 7 OF THESE PLANS FOR MULCHING SPECIFICATIONS.)
 - 11) AT ALL FULL SLOPE CONSTRUCTION HEIGHT SHALL BE MAINTAINED THROUGHOUT, ESPECIALLY AT THE END OF THE DAY.
 - 12) PERIODIC INSPECTION AND MAINTENANCE OF SILT TRAPS MUST BE PROVIDED TO MAINTAIN PROPER FUNCTIONING.
 - 13) PROVIDED THAT THE MIDDLE SCHOOL BUILDING IS UNDER CONTRACT FOR CONSTRUCTION AT THE TIME THIS TEMPORARY SEDIMENTATION MEASURES ARE IN PLACE AND THAT THE MIDDLE SCHOOL BUILDING IS NOT UNDER CONTRACT AT THIS TIME TEMPORARY SEDIMENTATION MEASURES SHALL BE APPLIED.
 - 14) ALL SLOPES (5% AND STEEPER) SHALL BE STREPPED WITH A MIXTURE OF STRAW OR MULCHES AT THE RATE OF ONE TON PER 100 SQ. FT. OF SURFACE AT THE END OF EACH DAY AND AT THE END OF EACH YEAR.

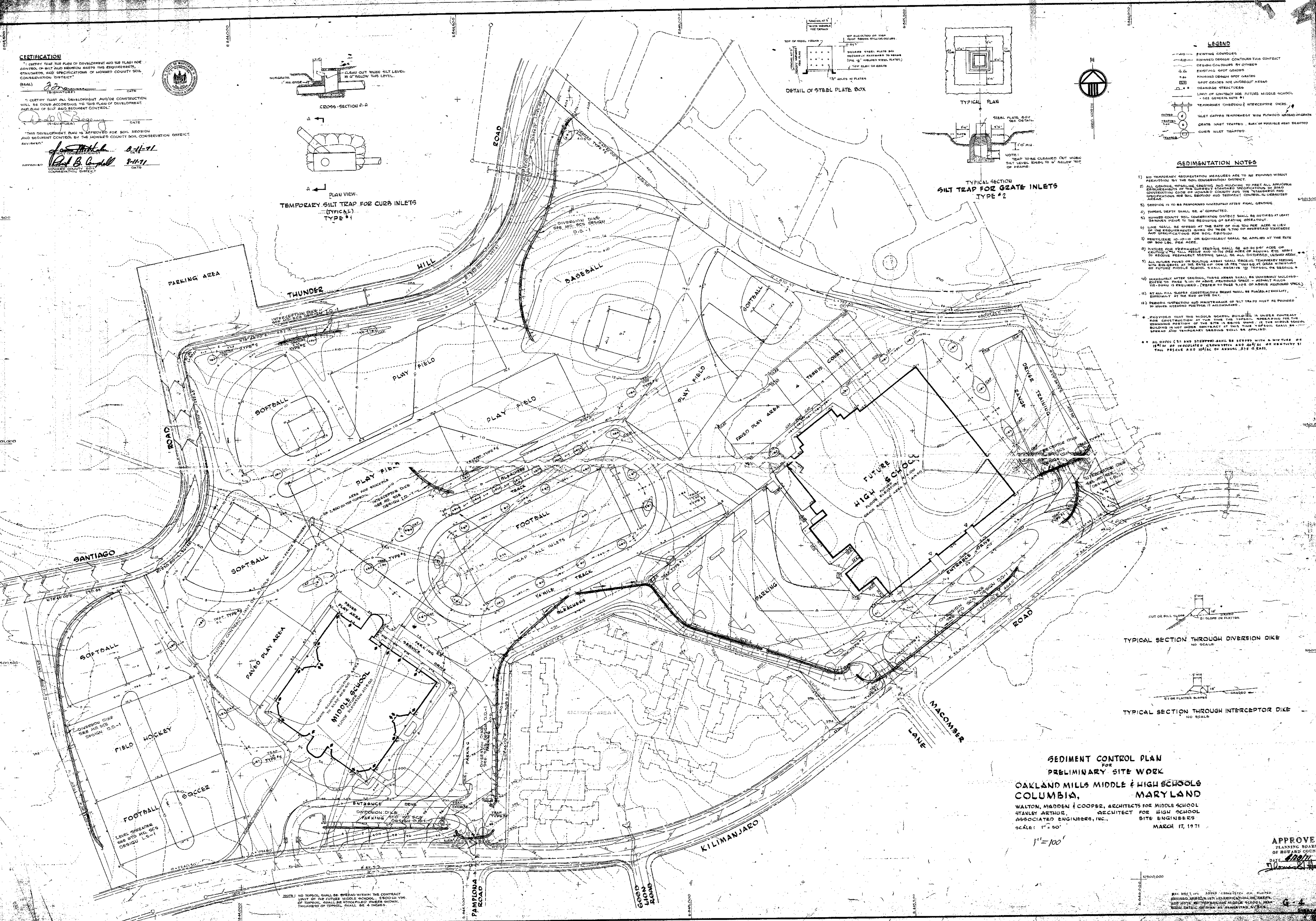

TYPICAL SECTION THROUGH DIVERSION DIKE
 NO SCALE

TYPICAL SECTION THROUGH INTERCEPTOR DIKE
 NO SCALE

SEDIMENT CONTROL PLAN
PRELIMINARY SITE WORK
OAKLAND MILLS MIDDLE & HIGH SCHOOLS
COLUMBIA, MARYLAND
 WALTON, MADDEN & COOPER, ARCHITECTS FOR THE MIDDLE SCHOOL
 ASSOCIATED ENGINEERS, INC., ARCHITECT FOR HIGH SCHOOL
 SITE ENGINEERS
 SCALE: 1" = 50'
 MARCH 17, 1971

1" = 100'

APPROVED
 PLANNING BOARD
 OF HOWARD COUNTY
 DATE: 3/10/71
 BY: [Signature]

NOTE: NO TOPSOIL SHALL BE SPREAD WITHIN THE CONTRACT LIMIT OF THE FUTURE MIDDLE SCHOOL. TOPSOIL TO BE SPREAD SHALL BE STOCKPILED UNDER COVER. THICKNESS OF TOPSOIL SHALL BE 4" MINIMUM.

CERTIFICATION
 I CERTIFY THAT THE PLAN OF DEVELOPMENT AND THE PLAN FOR CONTROL OF SILT AND SEDIMENT MEETS THE REQUIREMENTS, STANDARDS, AND SPECIFICATIONS OF HOWARD COUNTY SOIL CONSERVATION DISTRICT.
 (SIGNATURE) _____ DATE _____
 I CERTIFY THAT ALL DEVELOPMENT AND/OR CONSTRUCTION WILL BE DONE ACCORDING TO THIS PLAN OF DEVELOPMENT AND PLAN OF SILT AND SEDIMENT CONTROL.
 (SIGNATURE) _____ DATE _____
 THIS DEVELOPMENT PLAN IS APPROVED FOR SOIL EROSION AND SEDIMENT CONTROL BY THE HOWARD COUNTY SOIL CONSERVATION DISTRICT REVIEWER.
 DISTRICT SUPERVISOR _____ DATE _____
 APPROVED _____ DATE _____
 HOWARD COUNTY SOIL CONSERVATION DISTRICT



LEGEND
 --- EXISTING CONTOURS
 --- FINISHED DESIGN CONTOURS THIS CONTRACT
 --- DESIGN CONTOURS BY OTHERS
 --- EXISTING SPOT GRADES
 --- 2.0' FINISHED DESIGN SPOT GRADES
 --- 4.0' SPOT GRADES FOR UNDERCUT AREAS
 --- DRAINAGE STRUCTURES
 --- LIMIT OF CONTRACT FOR FUTURE MIDDLE SCHOOL
 --- SEE GENERAL NOTE #1

GENERAL NOTES:
 1. PROPOSED BUILDING AREAS SHALL BE UNDERCUT TO ELEVATIONS SHOWN. AREAS FOR FUTURE DRIVEWAYS, PARKING AREAS & DRIVE TRAINING RANGES SHALL BE UNDERCUT BY 6" INCREAS. AREAS FOR FUTURE TENNIS COURTS & PAVED PLAY AREAS SHALL BE UNDERCUT BY 4" INCREAS.
 2. ALL DISTURBED AREAS (EXCEPT FOR LIMITS SHOWN FOR FUTURE MIDDLE SCHOOL CONTRACT AND PAVED AND PLAY AREAS FOR HIGH SCHOOLS) SHALL BE TOPSOILED. THICKNESS OF TOPSOIL TO BE 4" INCREAS.
 3. ALL DISTURBED AREAS (EXCEPT FOR LIMITS SHOWN FOR FUTURE MIDDLE SCHOOL CONTRACT) SHALL BE SEEDED AND MULCHED.
 4. TOPOGRAPHY BASED ON INFORMATION FURNISHED BY THE EARTH CO.
 5. PERCENT OF 3.4 OF 40 MAY HAVE TO BE ADDED TO ALL EXISTING SPOT GRADES AND ALL DESIGN CONTOURS AND SPOT GRADES.

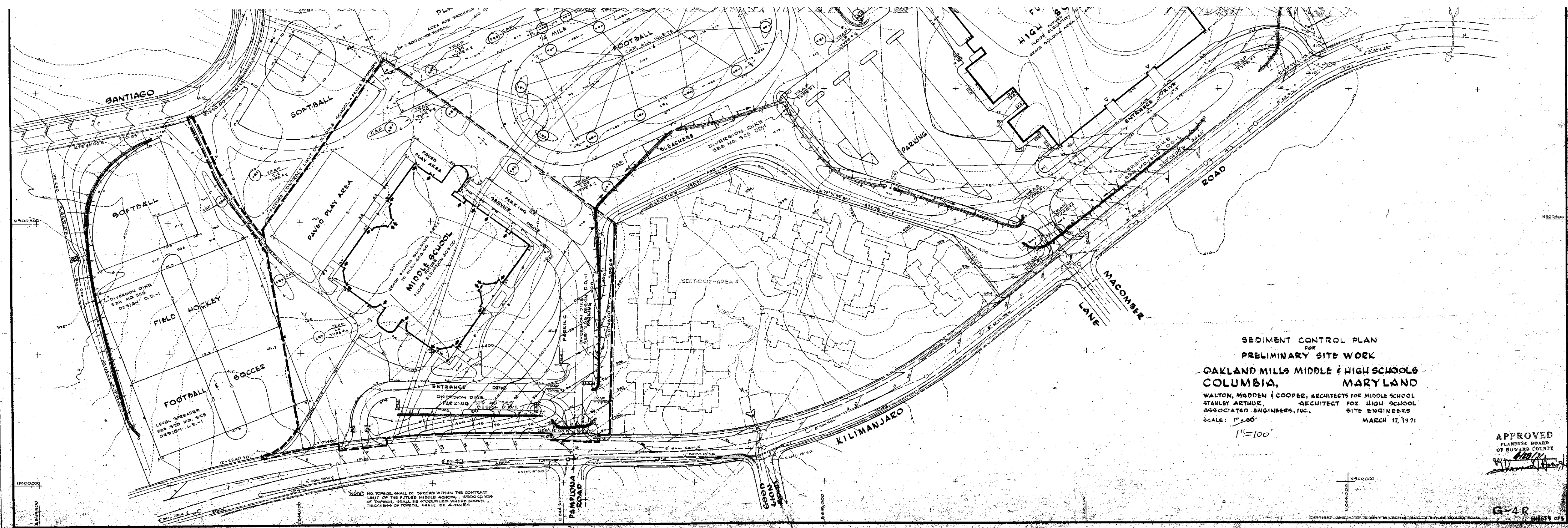

SEDIMENT CONTROL PLAN
 FOR
PRELIMINARY SITE WORK
OAKLAND MILLS MIDDLE & HIGH SCHOOLS
COLUMBIA, MARYLAND
 WALTON, MADDEN & COOPER, ARCHITECTS FOR MIDDLE SCHOOL
 STANLEY ARTHUR, ARCHITECT FOR HIGH SCHOOL
 ASSOCIATED ENGINEERS, INC., SITE ENGINEERS
 SCALE: 1" = 100'
 MARCH 17, 1971

APPROVED
 PLANNING BOARD
 OF HOWARD COUNTY
 DATE 3/22/71
 [Signature]

G-4R
 SHEET 078