

NOTE: ALL OFFSITE AREAS DISTURBED DURING CONSTRUCTION SHALL BE GRADED & LANDSCAPED IN ACCORDANCE WITH COLUMBIA ASSOCIATION SPECIFICATIONS.

PLAN SCALE: 1"=10'

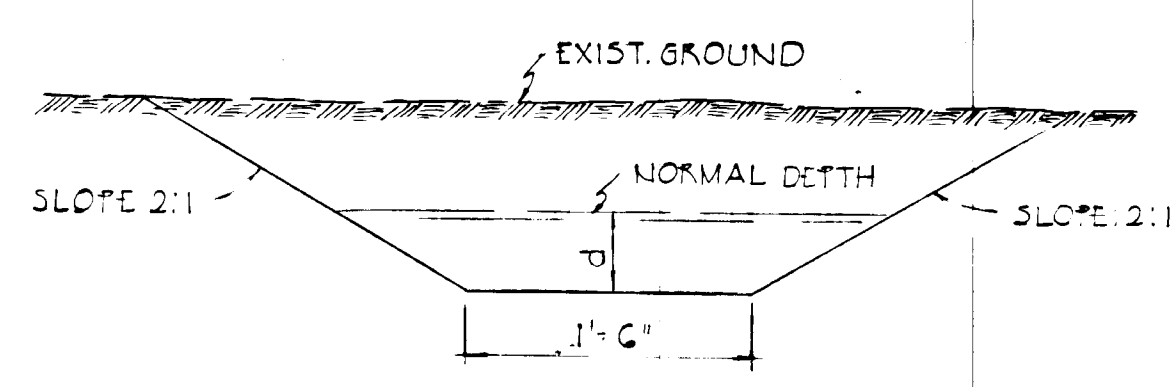

SOD CHANNEL DETAIL NOT TO SCALE

A = 0.27 ft
 F = 1.83'
 R = 0.14
 R² = 0.242
 n = 0.030

S = 0.075'/ft
 S² = 0.2755
 Q₂ = 1.425
 d = 0.15

V = 1.9/0.27 = 3.7/sec

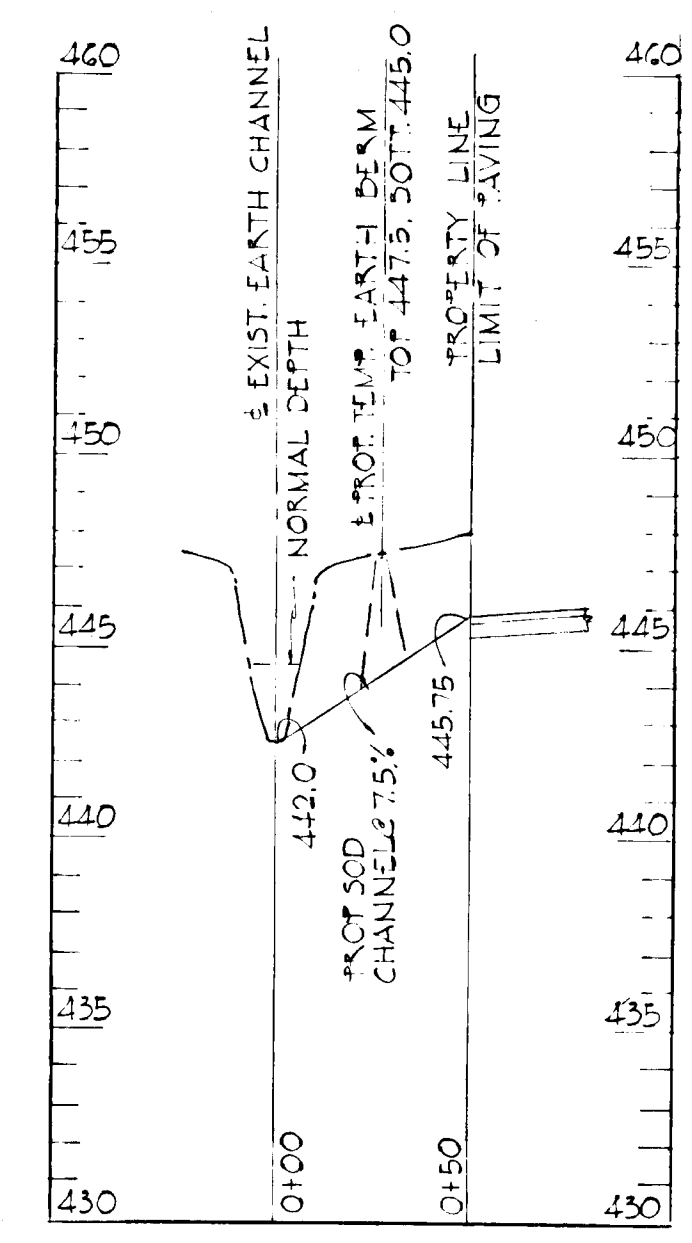

PROFILE SCALE: HORIZ. 1"=50' VERT. 1"=5'

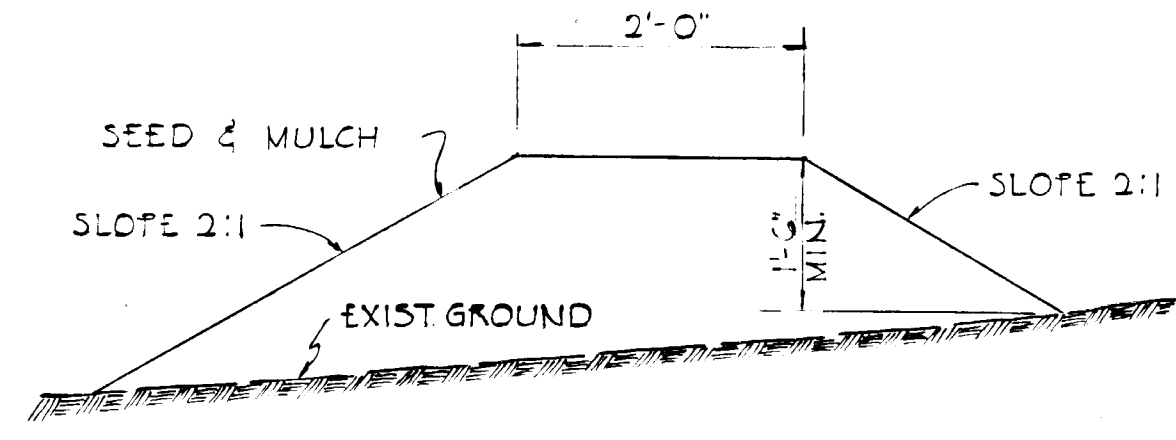

TEMPORARY EARTH BERM NOT TO SCALE

NOTE:

- SEDIMENT CONTROL IS REQUIRED DURING CONSTRUCTION BY MEANS OF EARTH BERMS AND/OR DITCHES TO PROVIDE SURFACE RETENTION, SEEDING, SODDING, PLANTING OR OTHER APPROVED SURFACE TREATMENT MUST BE COMPLETED AS SOON AS POSSIBLE DURING THE CONSTRUCTION CYCLE.
- SEEDING
 - SEEDING PREPARATION - AREAS TO BE SEEDDED SHALL BE GRADED TO A DEPTH OF 2" BELOW FINISHED GRADE AND BROUGHT TO GRADE WITH 2" TOPSOIL.
 - LOESSITIC LIMESTONE SHALL THEN BE SPREAD AT THE RATE OF 0.4 LBS./SQ. AND DISCED OR HARKOWED INTO TOPSOIL.
 - FERTILIZER - A COMMERCIAL 10-10-10 FERTILIZER SHALL BE SPREAD AT THE RATE OF 0.10 LBS./SQ. AND DISCED OR HARKOWED INTO TOPSOIL.
 - THE FOLLOWING SEEDING MIXTURE SHALL BE SPREAD AT THE RATE OF 4 LBS./2500 SQ. FT.
 - 50% KENTUCKY BLUEGRASS
 - 40% CREEPING RED FESCUE
 - 10% CHEWINGS FESCUE
- ALL SEEDING AREAS SHALL BE MULCHED WITH UNWEATHERED SMALL GRAINED STRAW OR HAY AT THE RATE OF 1.5 TONS/ACRE AND TIED DOWN WITH AN EMULSIFIED ASPHALT (RS1 OR 2) AT THE RATE OF 0.24 GALLONS/SY.

DRAINAGE DESIGN DATA
 Q = CIA = 0.85 A = 0.1 GACKES
 t = 5.0 MIN. 1" = 6.8
 Q = 0.85 * 0.8 * 0.16 = 1.0 CFS

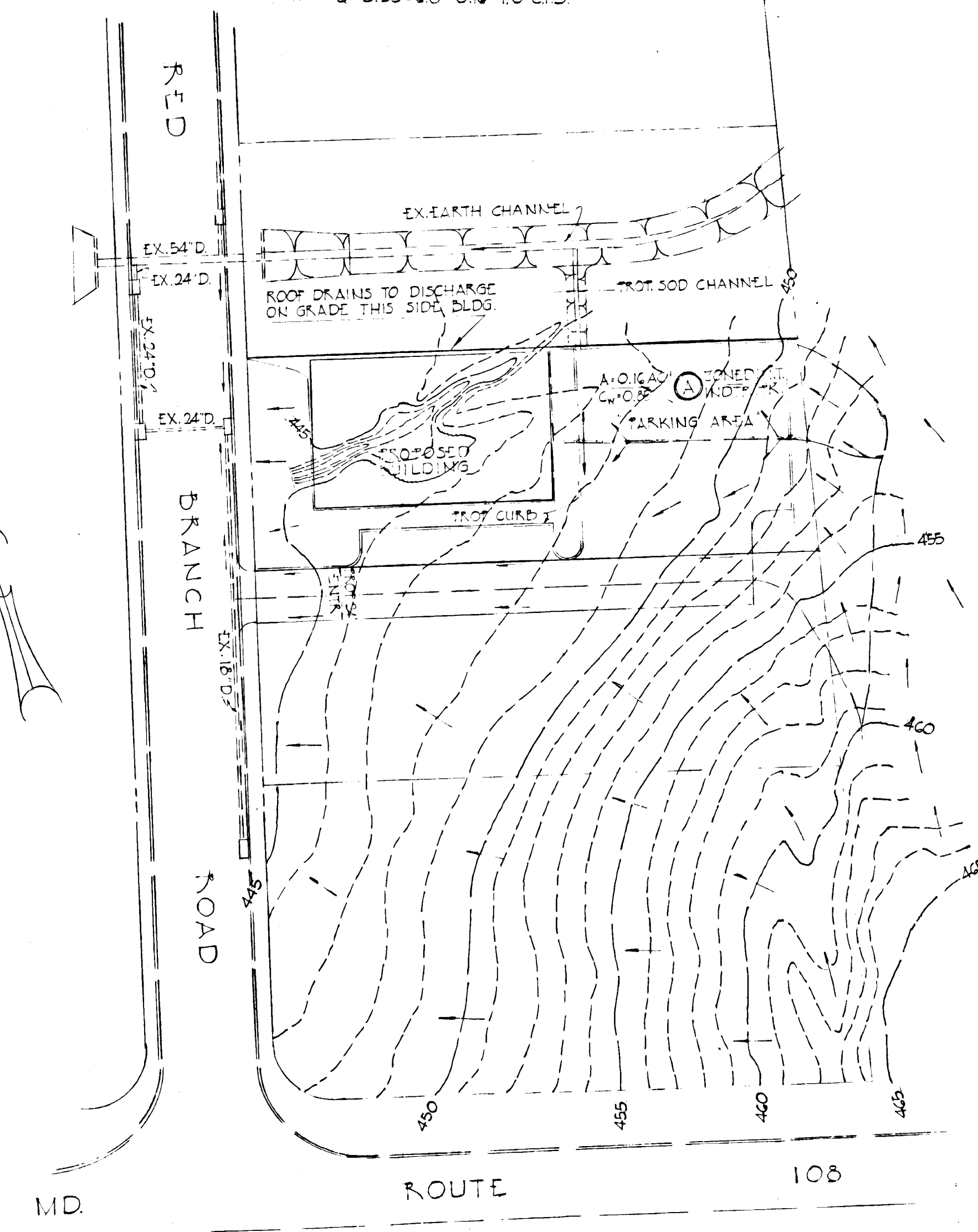

DRAINAGE AREA MAP SCALE: 1"=50'

APPROVED
 PLANNING BOARD
 OF HOWARD COUNTY
 DATE: 1/27/71

SEDIMENT CONTROL AND DRAINAGE DETAILS FOR MARCOIN, INC. LOT 44 - SECTION 2 OAKLAND RIDGE INDUSTRIAL PARK COLUMBIA 2ND ELECTION DIST. - HOWARD CO., MD. SCALE: AS SHOWN NOVEMBER 10, 1970 SHEET 2 OF 2 REVISED 12/10/70

PURDUM & JESCHKE ENGINEERS LAND SURVEYORS 3627 PARK AVENUE ELLICOTT CITY, MARYLAND

I CERTIFY THAT ALL DEVELOPMENT AND/OR CONSTRUCTION WILL BE DONE ACCORDING TO THIS PLAN OF SILT AND SEDIMENT CONTROL. <i>William G Rasch II</i> DATE: 5-27-71	I CERTIFY THAT THE PLAN OF DEVELOPMENT AND THE PLAN FOR CONTROL OF SILT AND EROSION MEETS THE REQUIREMENTS OF THE HOWARD COUNTY SOIL CONSERVATION DISTRICT. <i>William G Rasch II</i> WILLIAM G RASCH II REG NO 4575 DATE: 5-27-71	THIS DEVELOPMENT IS APPROVED FOR SOIL EROSION AND SEDIMENT CONTROL BY THE HOWARD COUNTY SOIL CONSERVATION DISTRICT. <i>James M. Hahn</i> JAMES M. HAHN HOWARD COUNTY SOIL CONSERVATION DIST. DATE: 5-18-71
APPROVED: FOR PUBLIC WATER AND PUBLIC SEWERAGE SYSTEMS COUNTY HEALTH DEPARTMENT. <i>Palmer F. Wine</i> PALMER F. WINE COUNTY HEALTH OFFICER DATE: 5-25-71	APPROVED: HOWARD COUNTY OFFICE OF PLANNING AND ZONING <i>William G Rasch II</i> WILLIAM G RASCH II DIRECTOR DATE: 5-26-71	APPROVED: FOR PUBLIC WATER AND PUBLIC SEWERAGE; STORM DRAINAGE SYSTEMS AND PUBLIC ROADS <i>James M. Hahn</i> JAMES M. HAHN HOWARD COUNTY DEPARTMENT OF PUBLIC WORKS DATE: 5/24/71

