

OWNER - MR. NORMAN UDOME
 ENTERPRISE USED CARS INC.
 ELKRIESE, MD. 21827
 1ST ELECTION DISTRICT
 TAX MAP NO. PARCELS 1000
 NEW ELEV. HEIGHT GROUND TO RIDGE - 15'-0"
 AREA OF PROPERTY 0.723 ACRES
 ZONING - ZONING WASHINGTON BLVD. M-1
 EMPLOYEES - NONE
 FLOOR AREA - 1,360 SQ. FT.

NOTES

ALL WORK WILL BE DONE IN ACCORDANCE WITH HOWARD COUNTY ORDINANCES.
 THERE WILL BE NO EXISTING BRACINGS SHOWN ON SURVEY BUT BY THE TIME OF CONSTRUCTION THE HIGH POINT OF EXISTING GRADE IS AT THE CORNER OF THE PROPERTY & FINISHED GROUND IN A LINE WITH THE EXISTING GRADE. ALL EXCAVATION & FINISHED GROUND TO BE AT HIGH POINT OF EXISTING GRADE AT ALL POINTS TO ACHIEVE A NEAR LEVEL SITE. ALL EXCAVATION & FINISHED GROUND TO BE AT HIGH POINT OF EXISTING GRADE AT ALL POINTS TO ACHIEVE A NEAR LEVEL SITE. ALL EXCAVATION & FINISHED GROUND TO BE AT HIGH POINT OF EXISTING GRADE AT ALL POINTS TO ACHIEVE A NEAR LEVEL SITE.
 ALL MATERIALS & WORK SHOWN ON DRAWINGS SUBJECT TO OWNER'S & CONTRACTOR'S AGREEMENT & APPROVAL BEFORE WORK BEGINS.
 ELECTRICAL - MECHANICAL - HEATING - ETC. WORK NOT SHOWN ON THESE DRAWINGS ARE TO BE PROVIDED & INSTALLED BY OTHERS AS DIRECTED BY OWNER.
 PAINTING OR ANY CHANGES OR ADDITIONAL WORK NOT SHOWN ON THESE DRAWINGS WILL BE DONE ONLY AS DIRECTED BY OWNER.

SITE PLAN DATE - DEC. 11 - 1970

SITE PLAN PREPARED FROM SURVEY MEASUREMENTS BY HOWARD COUNTY SURVEYOR'S OFFICE, DATE 10/21/70.

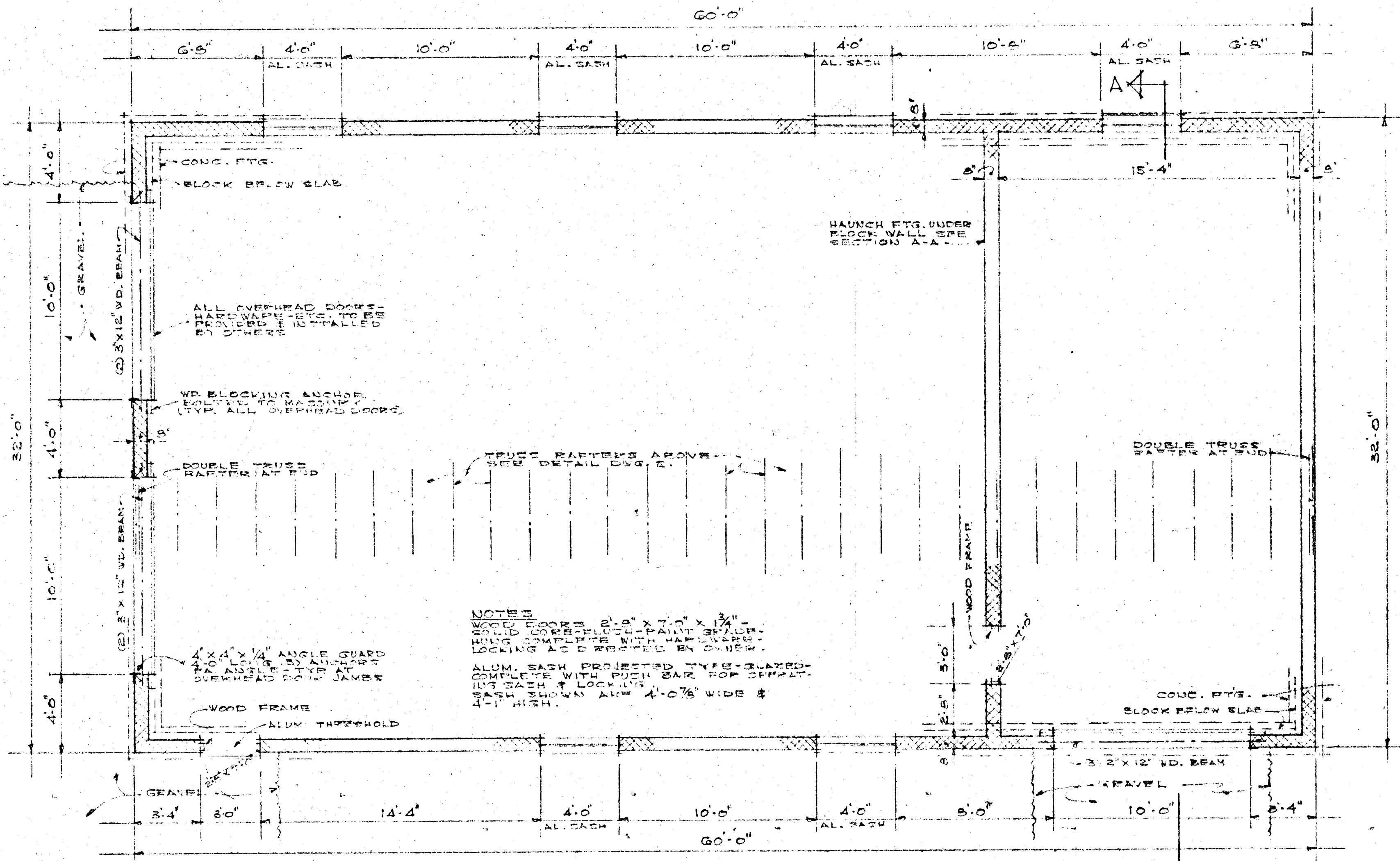

NOTES
 WOOD FLOOR - 2" x 6" x 7'-0" x 1 3/4"
 HOLD COMBES WITH HARDWARE - LOCKING & D. B. PROVIDED BY OWNER.
 ALUM. SASH PROJECTED TYPE - BLANK - COMPLETE WITH PUSH BAR FOR DEFLECT. INS. SASH & LOCKING. SASH SHOWS ARE 4'-0" x 7/8" WIDE & 4 1/2" HIGH.

FLOOR PLAN
 1/4" = 1'-0"

APPROVED
 LAND DEVELOPMENT
 PLANNING AND ZONING
 OF HOWARD COUNTY
 DATE: DEC 18 1970

STORAGE BUILDING FOR -
 ENTERPRISE USED CARS INC.
 5517 WASHINGTON BLVD.
 ELKRIESE, MARYLAND
 ROBERT W. LANGE ARCHITECT
 800 MAIN STREET - FALLS CHURCH, VIRGINIA