

NO.	TYPE	DEPTH	REMARKS
1	Open Endwall	3'-0"	Std. Dwg. D-52
2	Class "H" Manhole	3'-0"	Std. Dwg. D-76
3	Manhole	3'-0"	Std. Dwg. D-103
4	"S" Comb.	3'-0"	Std. Dwg. D-49
5	Class "H" Manhole	3'-0"	Std. Dwg. D-76
6	"S" Comb.	3'-0"	Std. Dwg. D-49
7	Manhole	3'-0"	Std. Dwg. D-103
8	Type "C" Endwall	3'-0"	Std. Dwg. D-52
9	Manhole	3'-0"	Std. Dwg. D-103

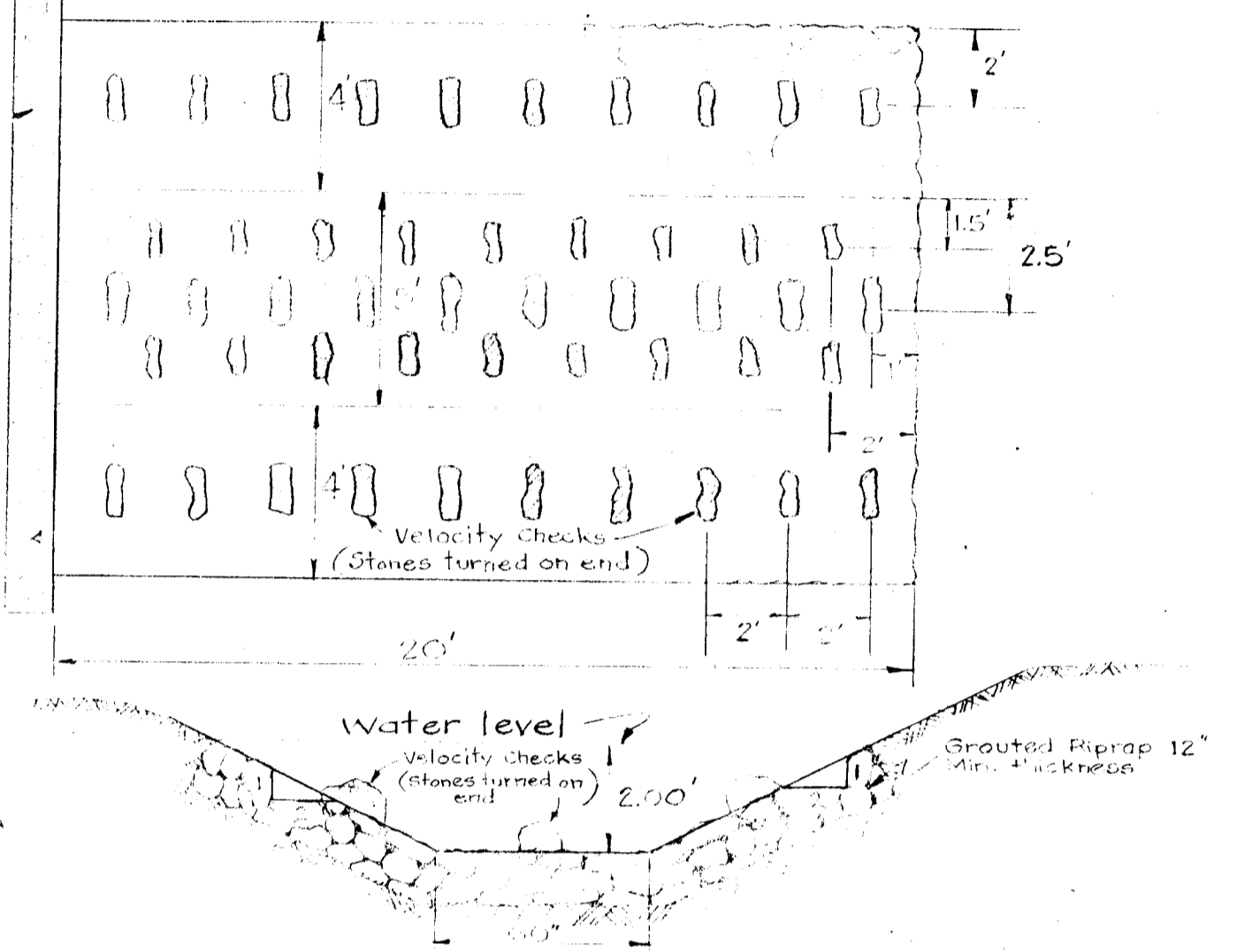

DETAIL OF OUTFALL CHANNEL FLOW

$$Q = AV = A \times \left[ \frac{1.49}{n} R^{2/3} S^{1/2} \right]$$

$$19 \times [55.4 \times 1 \times 1.64]$$

$$Q = 172.5 \text{ C.F.S.}$$

NOTE:  
ALL DISTURBED EARTH  
SHALL BE COVERED WITH  
TURF OR WALKS  
SHALL BE RESEED OR  
SODDED.

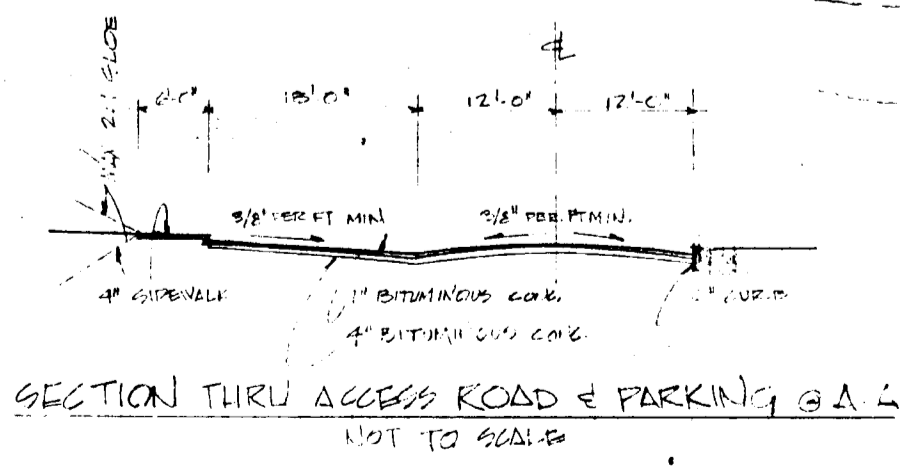

SECTION THRU ACCESS ROAD & PARKING G.A. 2  
NOT TO SCALE

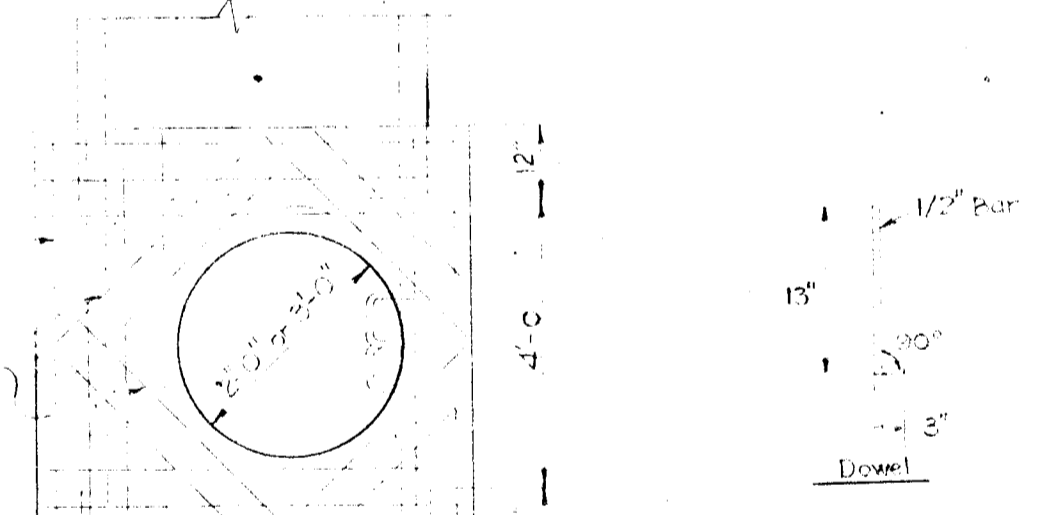

DETAIL MANHOLE NO. 7

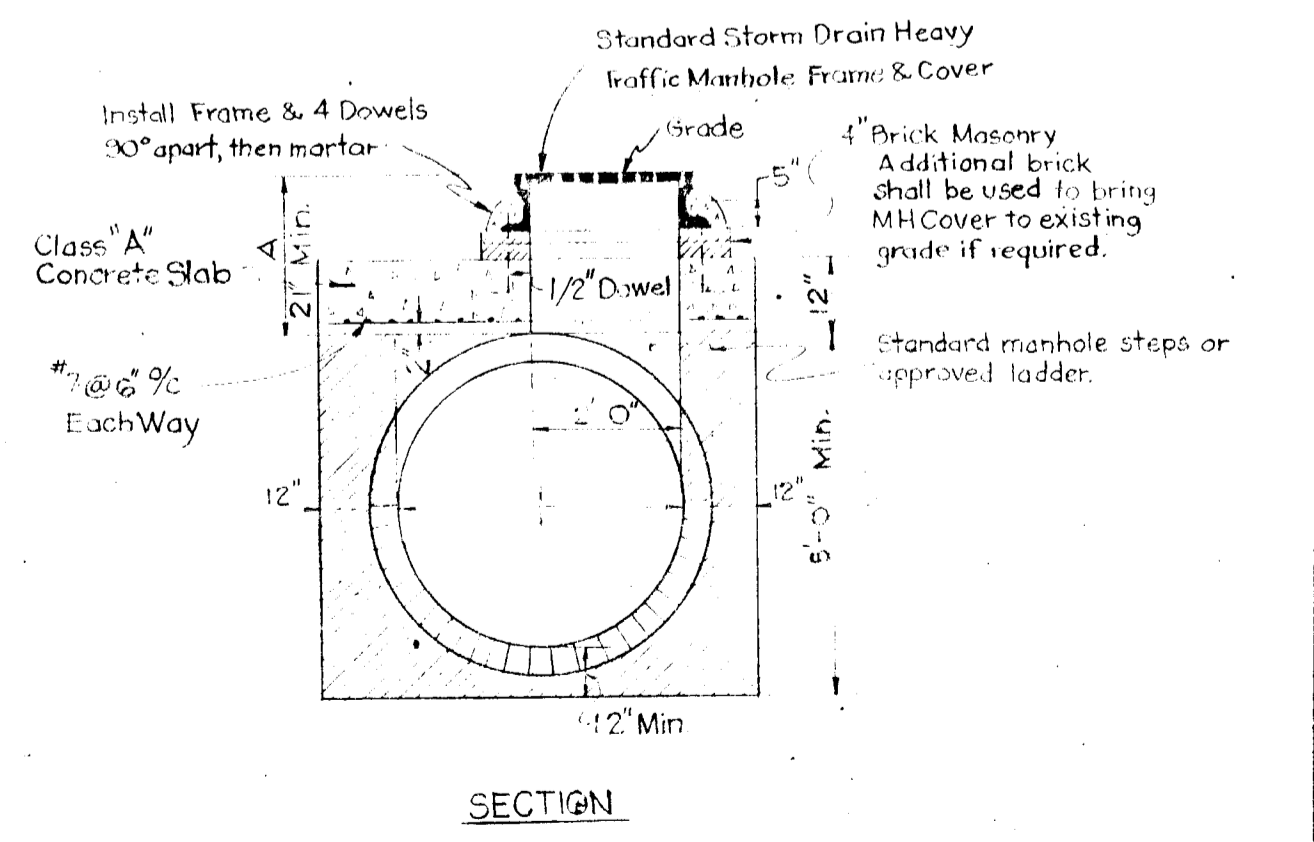

SECTION

NOTES:  
Walls, bottom slab and invert shall be brick  
or plain class "A" concrete poured in place.

APPROVED  
PLANNING BOARD  
OF HOWARD COUNTY  
DATE: 8/27/70  
*Thomas J. Smith*

HOWARD SOIL CONSERVATION DISTRICT  
This development plan is approved for soil erosion and  
sediment control by the Howard Soil Conservation District.  
Reviewed: *Elmer J. Sauer* 8/27/70  
Approved: *Paul B. Langford* 11/11/70  
Howard Soil Conservation Dist.



MCA  
MATZ, CHILDS & ASSOCIATES, INC.  
CONSULTING  
ENGINEERS  
1020 Cromwell Bridge Rd. Baltimore, Md.

APPROVED FOR STORM DRAINAGE SYSTEMS AND  
PUBLIC ROAD  
HOWARD COUNTY DEPARTMENT OF PUBLIC WORKS  
*Edman S. DeHull* 11/5/70  
DIRECTOR

DEPARTMENT OF PUBLIC WORKS  
*Bruce W. McLeod* 11/5/70  
CHIEF BUREAU OF HIGHWAYS  
OFFICE OF PLANNING AND ZONING  
*J.W. Clawson* 11-10-70  
CHIEF ENGINEER, DIVISION OF LAND DEVELOPMENT

VILLAGE OF OAKLAND MILLS  
SECT. 2 STEVEN'S FOREST AREA A & B  
OAKLAND MILLS  
APARTMENTS  
D.W.R. 11/5/70  
J.W.R. July 15, 1970  
P.S.S. D-1

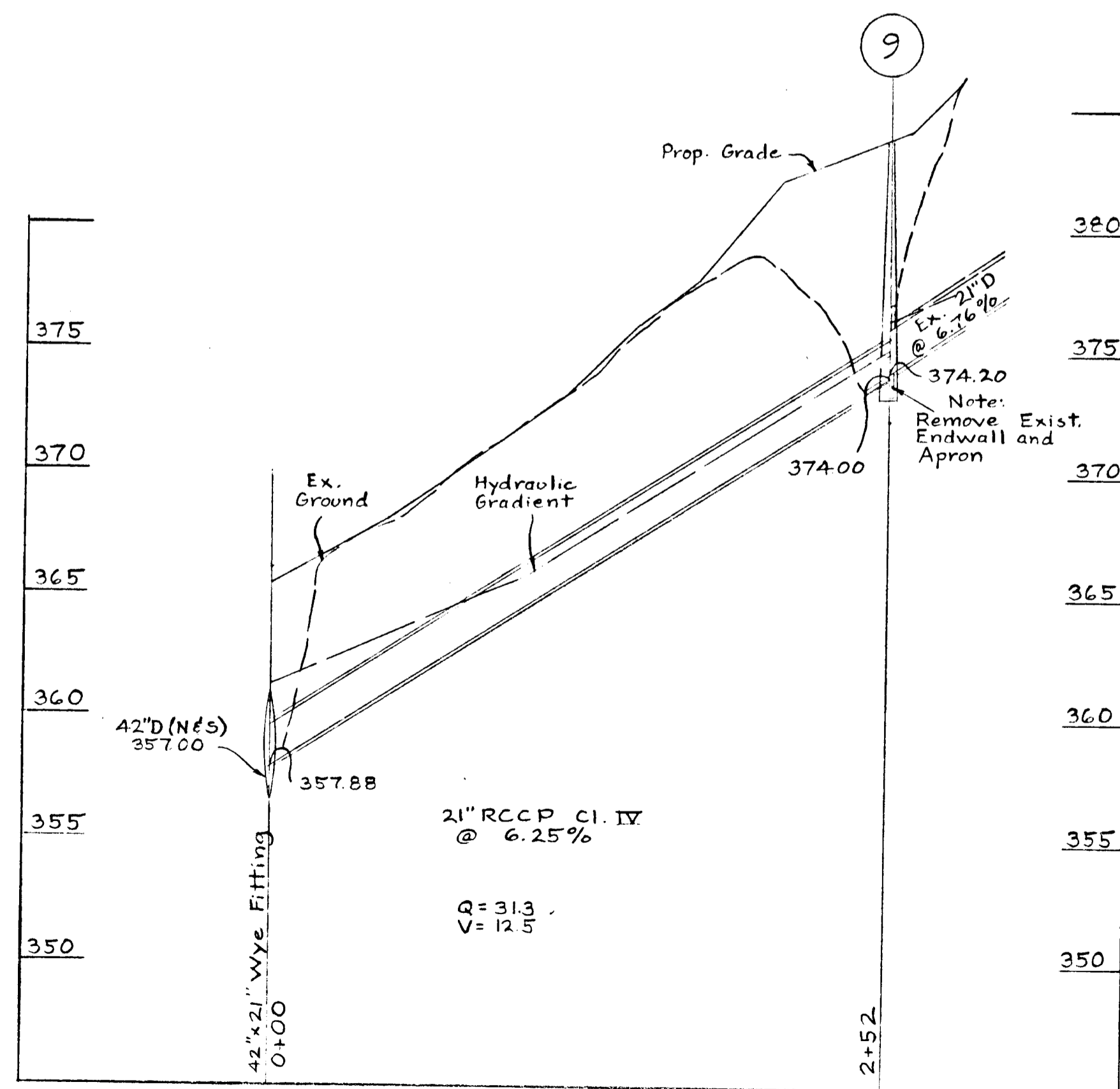
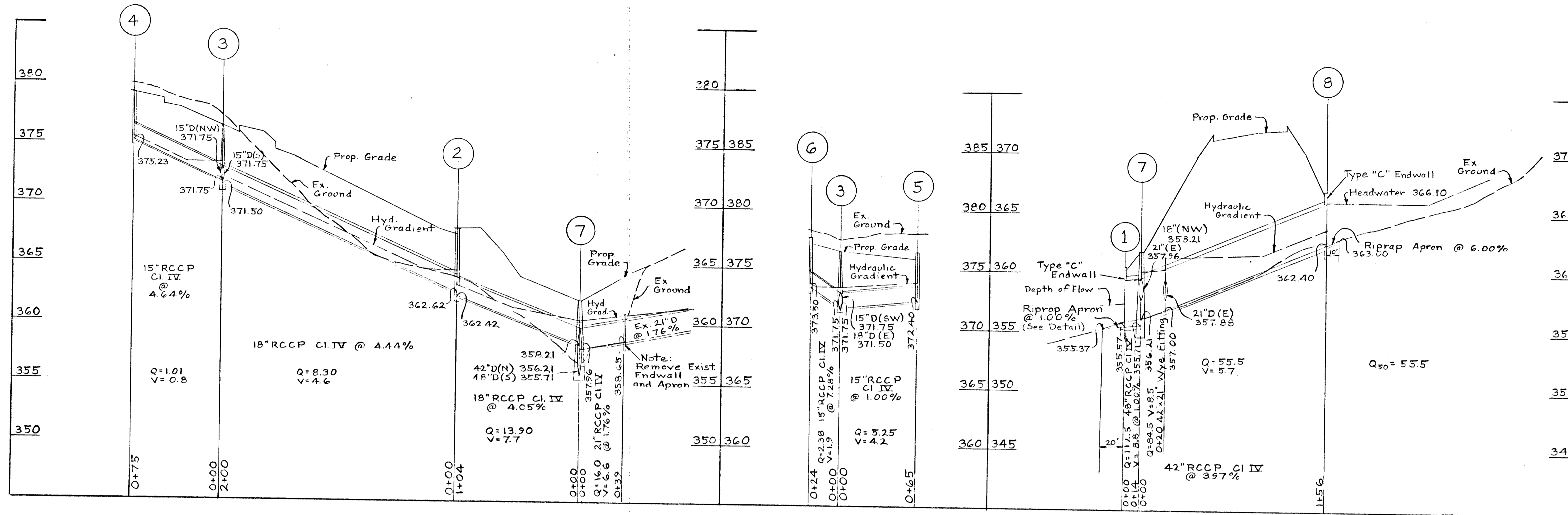

STORM DRAIN PROFILES

Rev. Date	Rev. No.	Revision Description

**COLUMBIA**  
M A R Y L A N D  
HOWARD RESEARCH AND DEVELOPMENT CORP.

PARCEL D  
VILLAGE OF OAKLAND MILLS  
SECT. 2 STEVENS FOREST AREA 3  
PROJECT TITLE: OAKLAND MILLS APARTMENTS

By: J.W.R. Date: 11/15/70  
By: J.W.R. Date: July 15, 1970  
By: P.O.S. Date: 11/15/70

APPROVED

DATE: OCT 7 1970  
*Thomas H. Harris*

HOWARD SOIL CONSERVATION DISTRICT  
This development plan is approved for soil erosion and sediment control by the Howard Soil Conservation District

Reviewed: *Edna L. Law* 8/21/70  
District Conservationist  
Approved: *P. J. B. Campbell* 11/15/70  
Howard Soil Conservation District



**MCA**   
MATZ, CHILDS & ASSOCIATES, INC.  
CONSULTING ENGINEERS  
1020 Cramwell Bridge Rd. Baltimore, Md.

APPROVED FOR STORM DRAINAGE SYSTEMS AND PUBLIC ROAD  
HOWARD COUNTY DEPARTMENT OF PUBLIC WORKS  
*Herbert E. Mell* 11/15/70  
DIRECTOR

DEPARTMENT OF PUBLIC WORKS  
CHIEF, BUREAU OF HIGHWAYS  
*Franklin M. McLeod* 11/15/70  
DATE

OFFICE OF PLANNING AND ZONING  
*J. H. Lawson* 11-10-70  
CHIEF ENGINEER, DIVISION OF LAND DEVELOPMENT DATE

# VILLAGE OF OAKLAND MILLS

NHA section **236 GARDEN APARTMENTS**

FOR

## ROUSE-WATES COLUMBIA, MARYLAND

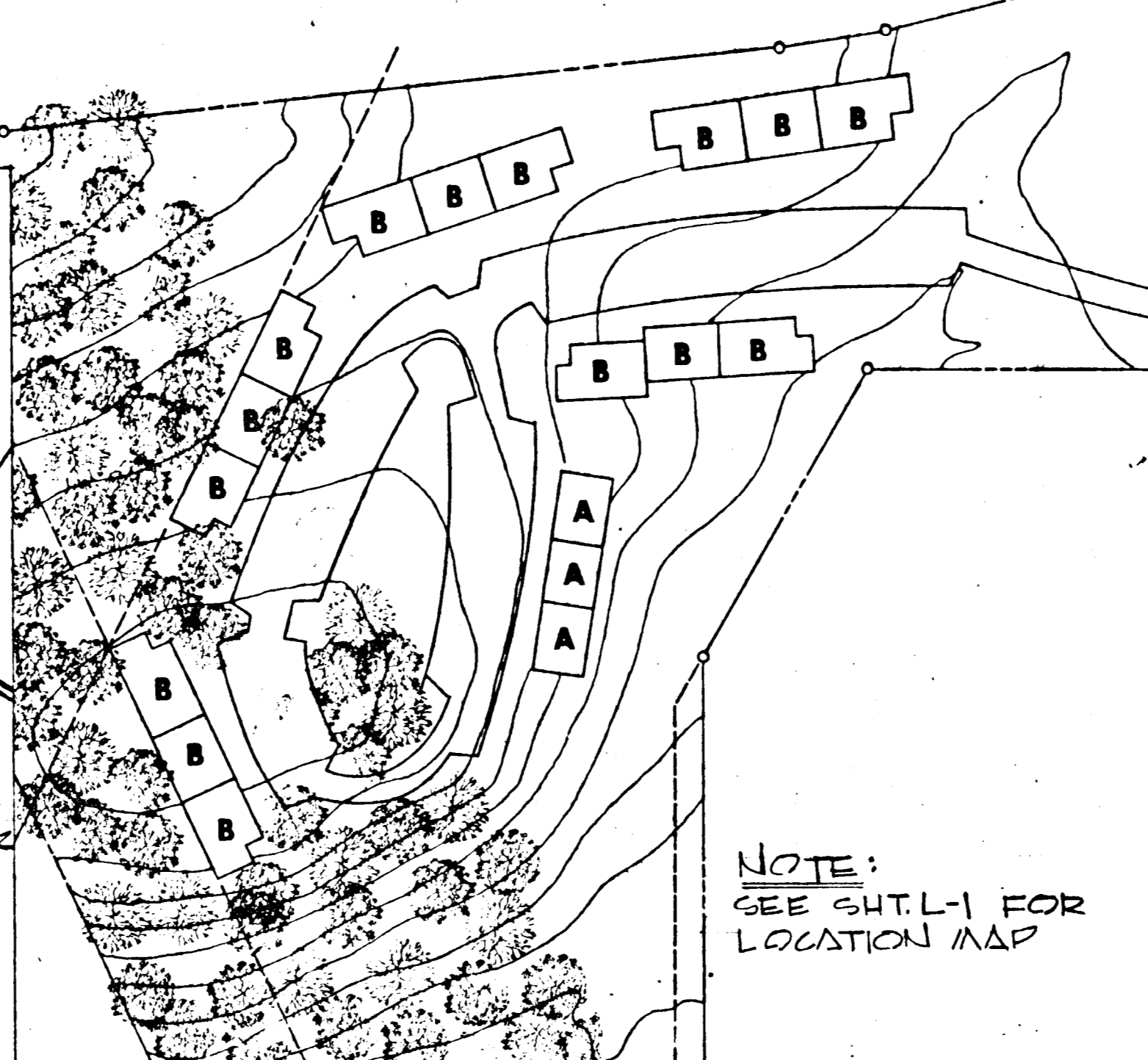
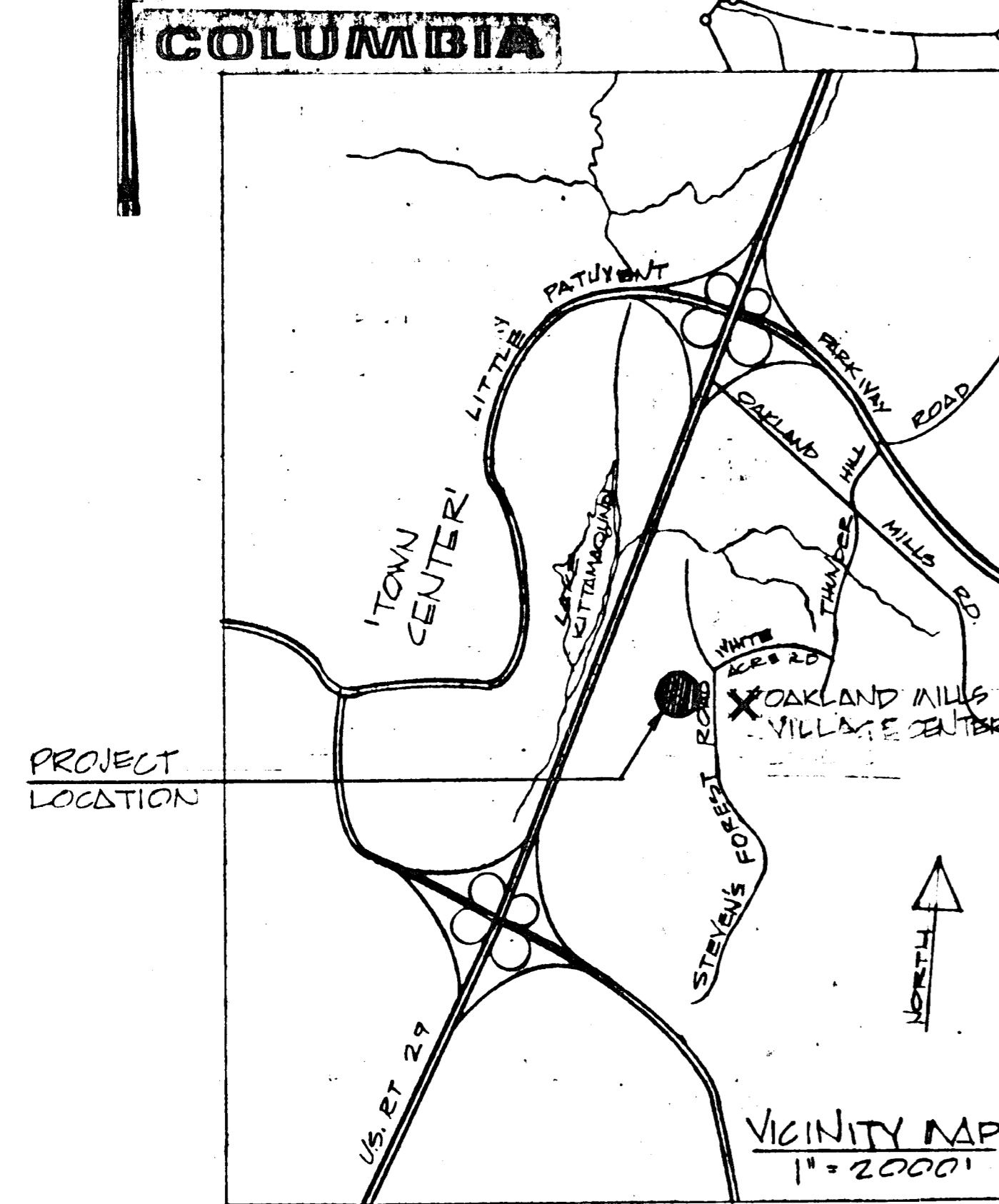
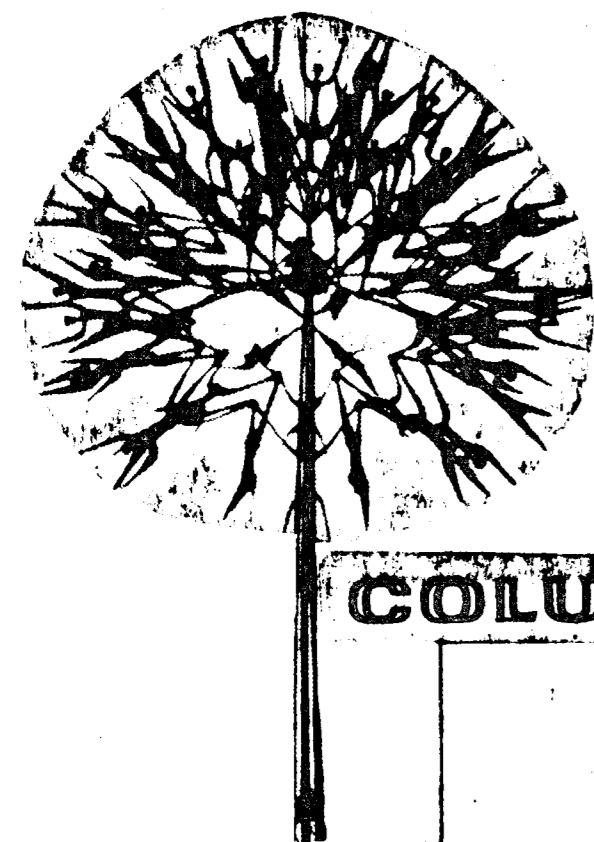

NOTE:  
SEE SHT. L-1 FOR  
LOCATION MAP

description	DESIGN	BLDG	STAIR UNIT	mix			
				TYPE	1 BR #180	2 BR #120	3 BR #120
ONE BR BLDG	A	1	3	N° BLDG	1	5	5
2+3 BR BLDG	B	5	15	UNITS BLDG	18	12	6
				TOTAL	18	60	30

TOTAL UNITS 108

DRAWING INDEX	
TITLE SHEET	TITLE
L-1	GRADING PLAN SITE
ARCHITECTURAL	
A-1	BUILDING NO. 1 SCALE PLAN + ELEVATION
A-2	BUILDING NO. 2 SCALE PLAN + ELEVATION
A-3	BUILDING NO. 3 SCALE PLAN + ELEVATION
A-4	BUILDING NO. 4 SCALE PLAN + ELEVATION
A-5	BUILDING NO. 5 SCALE PLAN + ELEVATION
A-6	BUILDING NO. 6 SCALE PLAN + ELEVATION
A-7	ONE BEDROOM UNIT FLOOR PLAN
A-8	2+3 BEDROOM UNIT FLOOR PLAN
A-9	TYPICAL ELEVATION ONE BEDROOM BLDG.
A-10	TYPICAL ELEVATION 2+3 BEDROOM BLDG.
A-11	ELEVATION DETAILS
A-12	BUILDING CROSS SECTION + WALL SECTION
A-13	STAIR SECTION PLANS + DETAILS
A-14	TYPICAL SECTION THRU BLDG. ENTRANCE
A-15	KITCHEN + BATHROOM PLANS + ELEVATIONS
A-16	SCHEDULES + WALL SECTIONS
STRUCTURAL	
S-1	ONE BEDROOM FLOOR FRAMING PLAN
S-2	2+3 BEDROOM FLOOR FRAMING PLAN
S-3	ONE BEDROOM ROOF FRAMING PLAN
S-4	2+3 BEDROOM ROOF FRAMING PLAN
S-5	FOUNDATION PLANS BLDG. 1+2
S-6	FOUNDATION PLANS BLDG. 3+4
S-7	FOUNDATION PLANS BLDG. 5+6
MECHANICAL	
M-1	ONE BEDROOM UNIT MECHANICAL
M-2	2+3 BEDROOM UNIT MECHANICAL
M-3	PLUMBING - BLDGS. 1 THRU 4
M-4	PLUMBING - BLDGS. 5+6
ELECTRICAL	
E-1	SITE PLAN ELECTRICAL
E-2	ONE BEDROOM UNIT ELECTRICAL
E-3	2+3 BEDROOM UNIT ELECTRICAL
E-4	ENTRANCE, LAUNDRY + AE. ROOM PLAN

REVISION AND DISTRIBUTION RECORD			
NO.	DATE	PR.	DISTRIBUTION

APPROVED  
[Signature]

APPROVED FOR PUBLIC/PRIVATE  
WATER AND PUBLIC/  
PRIVATE SEWERAGE  
SYSTEMS HOWARD  
COUNTY HEALTH  
DEPARTMENT  
COUNTY HEALTH OFFICER DATE

APPROVED HOWARD COUNTY OFFICE  
OF PLANNING & ZONING  
PLANNING DIRECTOR DATE

CHIEF ENGINEER, DIVISION  
OF LAND DEVELOPMENT DATE

APPROVED FOR PUBLIC WATER,  
PUBLIC SEWERAGE  
AND STORM DRAINAGE  
SYSTEMS & ROADS  
HOWARD CO. DEPARTMENT OF  
PUBLIC WORKS  
DIRECTOR DATE

CHIEF, BUREAU OF HIGHWAYS DATE

**COLUMBIA**  
MARYLAND

**THE ROUSE COMPANY**  
THE VILLAGE OF CROSS KEYS, BALTIMORE, MD. 21210

PROJECT TITLE:  
**OAKLAND MILLS APTS.**  
5TH ELECTION DISTRICT, HOWARD CO.

SUBJECT: SECT. 2, STEVENS FOREST, AREA 3  
PARCEL 5

**TITLE SHEET**

SCALE	DWG. NO.
DATE 29 JULY 1970	
DES. BY	
DWN. BY	
CK. BY	
APP. BY	CF NO.

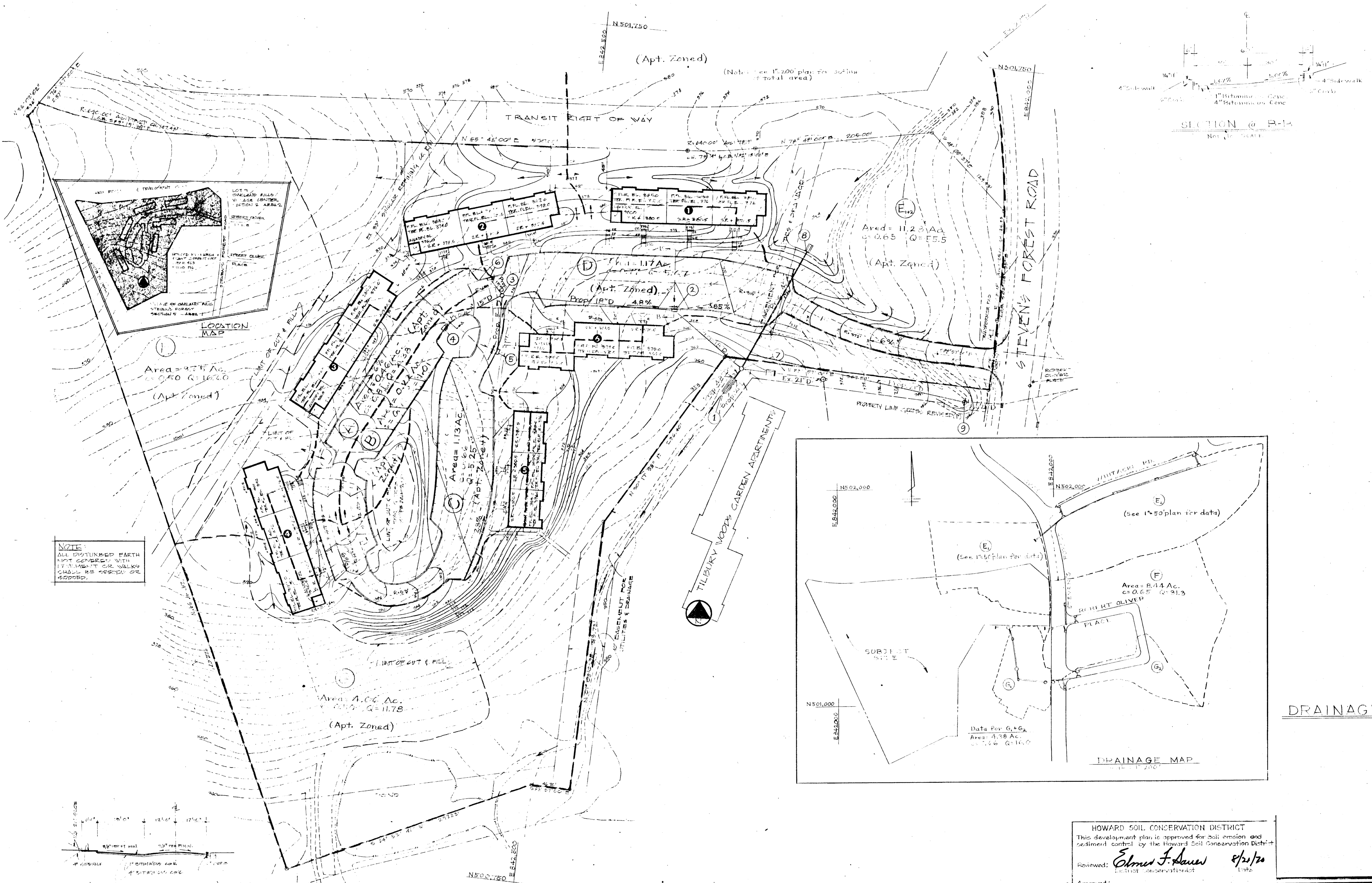

**NOTE:**  
ALL DISTURBED EARTH NOT COVERED WITH 12" MINIMUM GRADE SHALL BE SEEDED OR SOPPED.

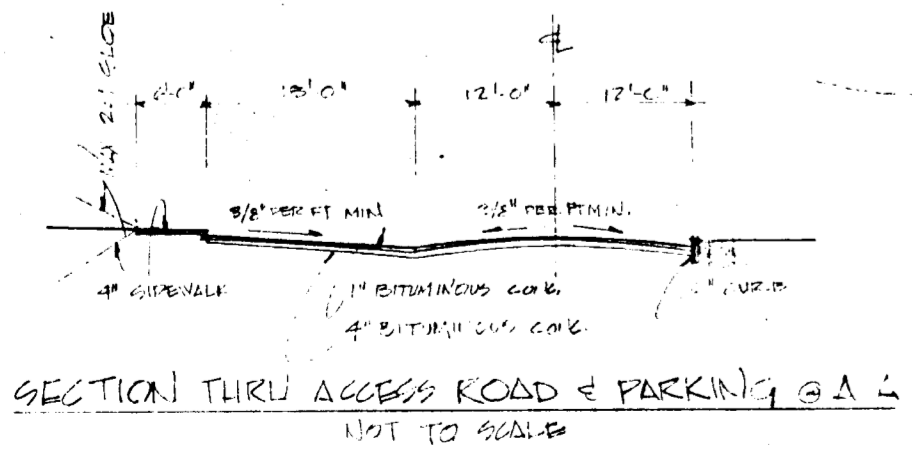

HOWARD SOIL CONSERVATION DISTRICT  
This development plan is approved for soil erosion and sediment control by the Howard Soil Conservation District.  
Reviewed: *Edmund J. Sauer* 8/21/70  
District Conservationist Date  
Approved: \_\_\_\_\_ Date

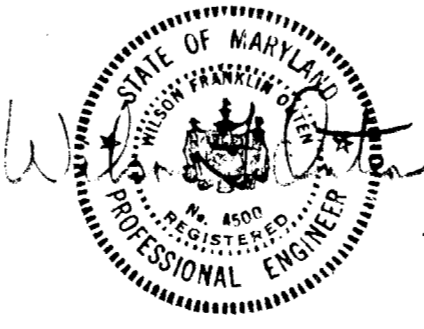

**MCA**   
MATZ, CHILDS & ASSOCIATES, INC.  
CONSULTING ENGINEERS  
1020 Cromwell Bridge Rd. Baltimore, Md.

APPROVED FOR STORM DRAINAGE SYSTEMS & PUBLIC ROAD  
HOWARD COUNTY DEPARTMENT OF PUBLIC WORKS  
DIRECTOR DATE

DEPARTMENT OF PUBLIC WORKS  
CHIEF, BUREAU OF HIGHWAYS DATE  
OFFICE OF PLANNING AND ZONING  
CHIEF ENGINEER, DIVISION OF LAND DEVELOPMENT DATE

VILLAGE OF OAKLAND  
OF THE 2 STEVENS MAP  
OAKLAND MI  
APARTMENT  
T.W.R. DATE  
J.W.R. July 15, 1970  
P.C.S.