

SOILS LEGEND		
SOIL	NAME	CLASS
**Ba	BAILE SILT LOAM	D
Bc2	BRANDYWINE LOAM, 0 TO 15 PERCENT SLOPES, MODERATELY ERODED	C
Bd2	BRANDYWINE LOAM, 15 TO 25 PERCENT SLOPES, MODERATELY ERODED	C
Bd3	BRANDYWINE LOAM, 15 TO 25 PERCENT SLOPES, SEVERELY ERODED	C
*Cb	COMUS SILT LOAM, LOCAL ALLUVIUM, 3 TO 8 PERCENT SLOPES	B
Gb2	GLENELG LOAM, 3 TO 8 PERCENT SLOPES, MODERATELY ERODED	B
Gc2	GLENELG LOAM, 8 TO 15 PERCENT SLOPES, MODERATELY ERODED	C
*Gnb2	GLENVILLE SILT LOAM, 3 TO 8 PERCENT SLOPES, MODERATELY ERODED	C
Mc3	MANOR LOAM, 0 TO 15 PERCENT SLOPES, SEVERELY ERODED	B
Md2	MANOR LOAM, 15 TO 25 PERCENT SLOPES, MODERATELY ERODED	B
Md3	MANOR LOAM, 15 TO 25 PERCENT SLOPES, SEVERELY ERODED	B

NOTES:
 * HYDRIC SOILS AND/OR CONTAINS HYDRIC INCLUSIONS
 ** MAY CONTAIN HYDRIC INCLUSIONS
 † GENERALLY ONLY WITHIN 100-YEAR FLOODPLAIN AREAS



PROFESSIONAL CERTIFICATION
 I HEREBY CERTIFY THAT THESE DOCUMENTS WERE PREPARED OR APPROVED BY ME AND THAT I AM A DULY LICENSED PROFESSIONAL ENGINEER UNDER THE LAWS OF THE STATE OF MARYLAND, LICENSE NO. 9753, EXPIRATION DATE: 2/28/10.
 Signature: Earl D. Collins
 DATE: 3-17-09

FISHER, COLLINS & CARTER, INC.
 CIVIL ENGINEERING CONSULTANTS & LAND SURVEYORS
 CENTRAL SQUARE OFFICE PARK - 10772 BALTIMORE NATIONAL PIKE
 ELKJETT CITY, MARYLAND 22042
 410-461-2995

NO.	REVISION	DATE
3	Rev. Use of Lot 1 from Gen. Box to H-H 1	1/8/2013
2	Rev. Lot 2G to show as built conditions	11-5-10
1	Rev. Lot 2G to show Fairmont model	3-19-10



ENGINEER'S CERTIFICATE
 I certify that this plan for erosion and sediment control represents a practical and workable plan based on my personal knowledge of the site conditions and that it was prepared in accordance with the requirements of the Howard Soil Conservation District.
 Signature of Engineer: Earl D. Collins
 DATE: 3-17-09

DEVELOPER'S CERTIFICATE
 I/We certify that all development and construction will be done according to this plan, for sediment and erosion control and that any responsible personnel involved in the construction project will have a Certificate of Attendance at a Department of the Environment Approved Training Program for the Control of Sediment and Erosion before beginning the project. I also authorize periodic on-site inspection by the Howard Soil Conservation District.
 Signature of Developer: B. James Greenfield
 DATE: 3/12/09

This development plan is approved for soil erosion and sediment control by the HOWARD SOIL CONSERVATION DISTRICT.
 Signature: John R. Patterson
 DATE: 3/26/09

OWNER/DEVELOPER
 MID-ATLANTIC LAND DEVELOPMENT COMPANY
 C/O B. JAMES GREENFIELD
 6420 AUTUMN SKY WAY
 COLUMBIA, MARYLAND 21044
 410-330-3939

APPROVED: HOWARD COUNTY DEPARTMENT OF PLANNING AND ZONING

Chief, Division of Land Development	DATE: 5/1/09
Chief, Development Engineering Division	DATE: 5/15/09
Director - Department of Planning and Zoning	DATE: 5/17/09

PROJECT	SECTION	LOTS NO.
HOLLIFIELD HILLS	N/A	1,26 & 27 THRU 43
PLAT	BLOCK NO.	ZONE
19804 THRU 19808	6 & 12	R-20
TAX/ZONE	ELEC. DIST.	CENSUS TR.
17	SECOND	
WATER CODE	SEWER CODE	
F-04	1450000	

SITE DEVELOPMENT/SEDIMENT EROSION CONTROL PLAN

SINGLE FAMILY DETACHED
HOLLIFIELD HILLS
PLAT NO'S 19804 THRU 19808
LOTS 1,26 & 27 THRU 43
 ZONED: R-20

TAX MAP NO.: 17 PARCEL NO'S: 42 & 43 GRID NO'S: 6 & 12
 SECOND ELECTION DISTRICT, HOWARD COUNTY, MARYLAND
 SCALE: 1" = 30' DATE: FEBRUARY, 2009

SHEET 2 OF 6

SDP 09-038

I:\2004\04137 Home-Long Property\dwg\04137_Sdp_Lots 1 & 26.dwg, 3/16/2009 2:59:08 PM, bampy, 1/30

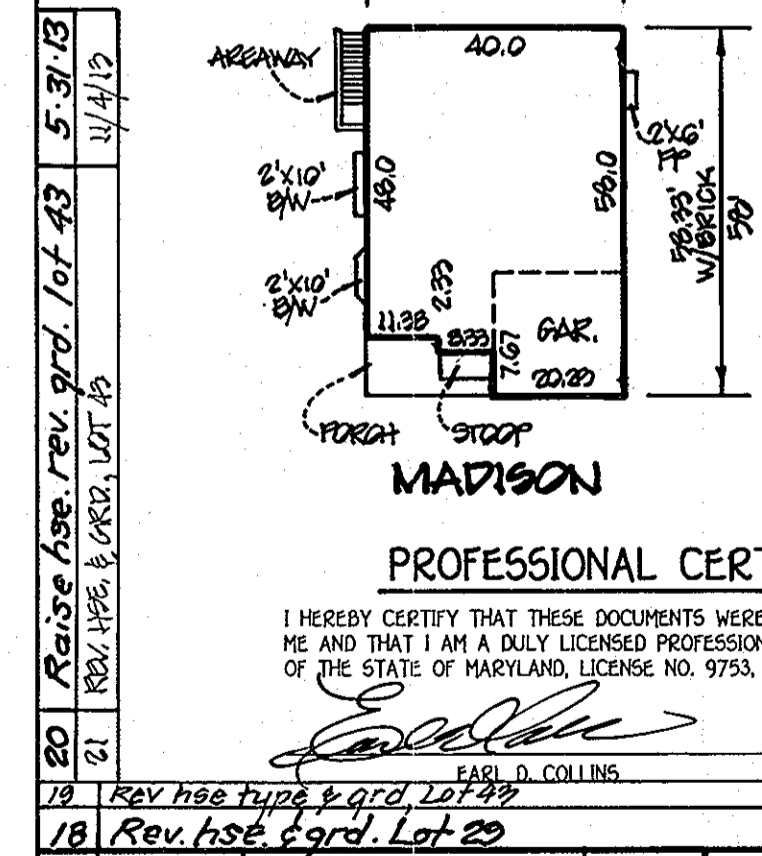
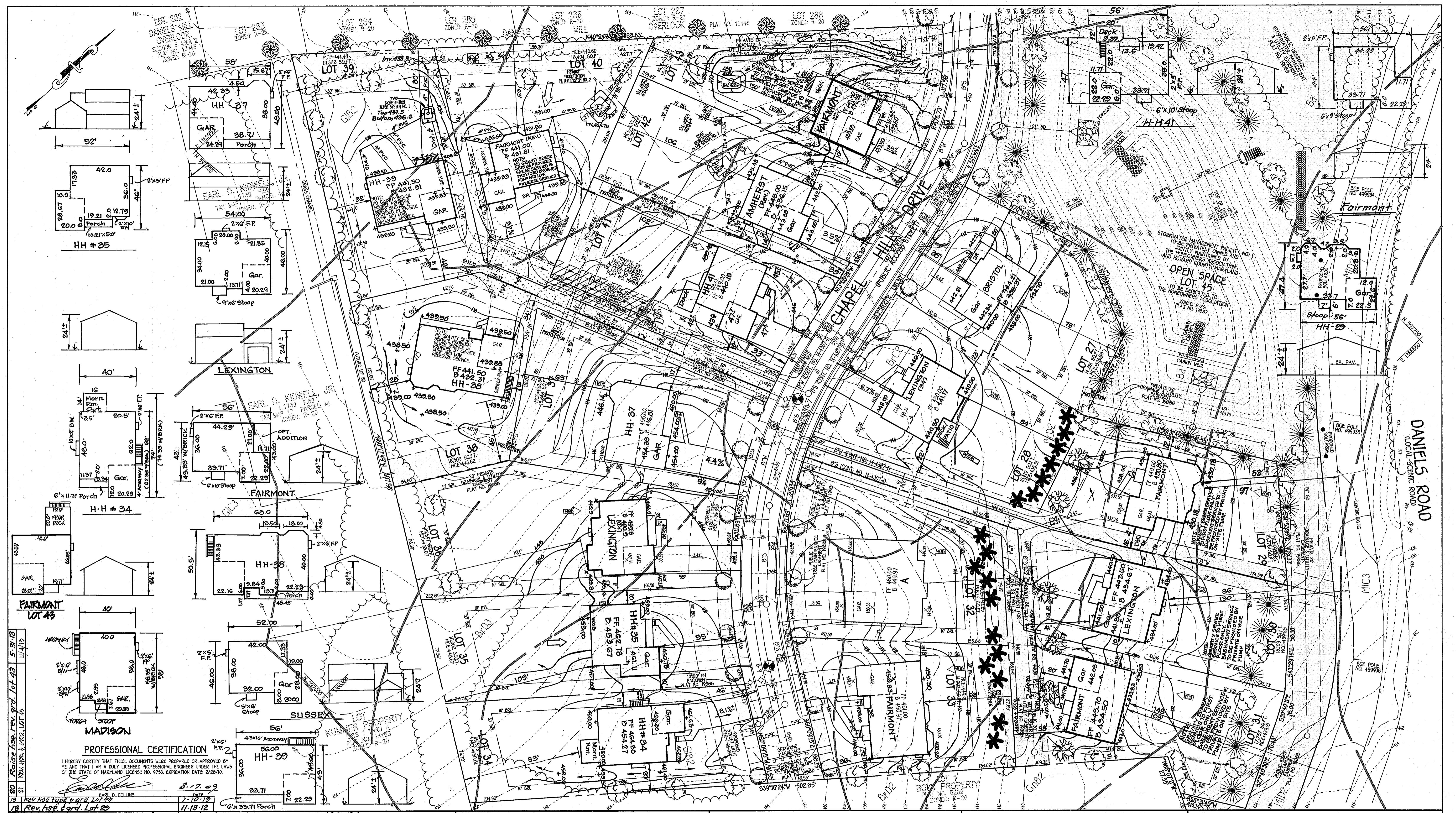

NO.	REVISION	DATE
1	REV. HSE. & GRD. LOT 27 FROM 'A' BOX TO FAIRMONT	3/17/09
2	REV. HSE. & GRD. LOT 27 FROM 'A' BOX TO BRISTOL	3/17/09
3	REV. HSE. & GRD. LOT 27 FROM 'A' BOX TO BRISTOL	3/17/09
4	REV. HSE. & GRD. LOT 27 FROM 'A' BOX TO BRISTOL	3/17/09
5	REV. HSE. & GRD. LOT 27 FROM 'A' BOX TO BRISTOL	3/17/09
6	REV. HSE. & GRD. LOT 27 FROM 'A' BOX TO BRISTOL	3/17/09
7	REV. HSE. & GRD. LOT 27 FROM 'A' BOX TO BRISTOL	3/17/09
8	REV. HSE. & GRD. LOT 27 FROM 'A' BOX TO BRISTOL	3/17/09
9	REV. HSE. & GRD. LOT 27 FROM 'A' BOX TO BRISTOL	3/17/09
10	REV. HSE. & GRD. LOT 27 FROM 'A' BOX TO BRISTOL	3/17/09
11	REV. HSE. & GRD. LOT 27 FROM 'A' BOX TO BRISTOL	3/17/09
12	REV. HSE. & GRD. LOT 27 FROM 'A' BOX TO BRISTOL	3/17/09
13	REV. HSE. & GRD. LOT 27 FROM 'A' BOX TO BRISTOL	3/17/09
14	REV. HSE. & GRD. LOT 27 FROM 'A' BOX TO BRISTOL	3/17/09
15	REV. HSE. & GRD. LOT 27 FROM 'A' BOX TO BRISTOL	3/17/09
16	REV. HSE. & GRD. LOT 27 FROM 'A' BOX TO BRISTOL	3/17/09
17	REV. HSE. & GRD. LOT 27 FROM 'A' BOX TO BRISTOL	3/17/09
18	REV. HSE. & GRD. LOT 27 FROM 'A' BOX TO BRISTOL	3/17/09
19	REV. HSE. & GRD. LOT 27 FROM 'A' BOX TO BRISTOL	3/17/09
20	REV. HSE. & GRD. LOT 27 FROM 'A' BOX TO BRISTOL	3/17/09
21	REV. HSE. & GRD. LOT 27 FROM 'A' BOX TO BRISTOL	3/17/09
22	REV. HSE. & GRD. LOT 27 FROM 'A' BOX TO BRISTOL	3/17/09
23	REV. HSE. & GRD. LOT 27 FROM 'A' BOX TO BRISTOL	3/17/09
24	REV. HSE. & GRD. LOT 27 FROM 'A' BOX TO BRISTOL	3/17/09
25	REV. HSE. & GRD. LOT 27 FROM 'A' BOX TO BRISTOL	3/17/09
26	REV. HSE. & GRD. LOT 27 FROM 'A' BOX TO BRISTOL	3/17/09
27	REV. HSE. & GRD. LOT 27 FROM 'A' BOX TO BRISTOL	3/17/09
28	REV. HSE. & GRD. LOT 27 FROM 'A' BOX TO BRISTOL	3/17/09
29	REV. HSE. & GRD. LOT 27 FROM 'A' BOX TO BRISTOL	3/17/09
30	REV. HSE. & GRD. LOT 27 FROM 'A' BOX TO BRISTOL	3/17/09
31	REV. HSE. & GRD. LOT 27 FROM 'A' BOX TO BRISTOL	3/17/09
32	REV. HSE. & GRD. LOT 27 FROM 'A' BOX TO BRISTOL	3/17/09
33	REV. HSE. & GRD. LOT 27 FROM 'A' BOX TO BRISTOL	3/17/09
34	REV. HSE. & GRD. LOT 27 FROM 'A' BOX TO BRISTOL	3/17/09
35	REV. HSE. & GRD. LOT 27 FROM 'A' BOX TO BRISTOL	3/17/09
36	REV. HSE. & GRD. LOT 27 FROM 'A' BOX TO BRISTOL	3/17/09
37	REV. HSE. & GRD. LOT 27 FROM 'A' BOX TO BRISTOL	3/17/09
38	REV. HSE. & GRD. LOT 27 FROM 'A' BOX TO BRISTOL	3/17/09
39	REV. HSE. & GRD. LOT 27 FROM 'A' BOX TO BRISTOL	3/17/09
40	REV. HSE. & GRD. LOT 27 FROM 'A' BOX TO BRISTOL	3/17/09
41	REV. HSE. & GRD. LOT 27 FROM 'A' BOX TO BRISTOL	3/17/09
42	REV. HSE. & GRD. LOT 27 FROM 'A' BOX TO BRISTOL	3/17/09
43	REV. HSE. & GRD. LOT 27 FROM 'A' BOX TO BRISTOL	3/17/09

PROFESSIONAL CERTIFICATION
 I HEREBY CERTIFY THAT THESE DOCUMENTS WERE PREPARED OR APPROVED BY ME AND THAT I AM A DAILY LICENSED PROFESSIONAL ENGINEER UNDER THE LAWS OF THE STATE OF MARYLAND, LICENSE NO. 9753, EXPIRATION DATE: 2/28/10.
 EARL D. COLLINS
 3-17-09

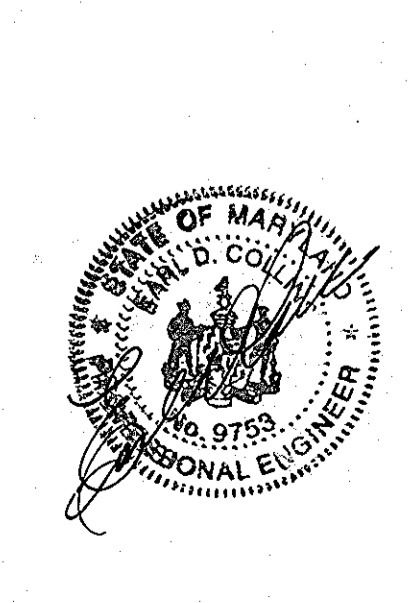

ENGINEER'S CERTIFICATE
 I certify that this plan for erosion and sediment control represents a practical and workable plan based on my personal knowledge of the site conditions and that it was prepared in accordance with the requirements of the Howard Soil Conservation District.
 Signature of Engineer: Earl D. Collins
 Date: 3-17-09

DEVELOPER'S CERTIFICATE
 I/We certify that all development and construction will be done according to this plan, for sediment and erosion control and that any responsible personnel involved in the construction project will have a Certificate of Attendance at a Department of the Environment Approved Training Program for the Control of Sediment and Erosion before beginning the project. I also authorize periodic on-site inspection by the Howard Soil Conservation District.
 Signature of Developer: B. James Greenfield
 Date: 3/17/09

APPROVED: HOWARD COUNTY DEPARTMENT OF PLANNING AND ZONING
 Chief, Division of Land Development
 Chief, Development Engineering Division
 Director - Department of Planning and Zoning

DATE: 3/24/09

OWNER/DEVELOPER
 MID-ATLANTIC LAND DEVELOPMENT COMPANY
 C/O B. JAMES GREENFIELD
 6420 AUTUMN SKY WAY
 COLUMBIA, MARYLAND 21044
 410-730-3939

PROJECT	SECTION	LOTS NO.
HOLLIFIELD HILLS	N/A	1,26 & 27 THRU 43
PLAT 19804 THRU 19808	6 & 12	R-20
WATER CODE	SEWER CODE	
F-04	1450000	

SITE DEVELOPMENT PLAN
 SINGLE FAMILY DETACHED
 HOLLIFIELD HILLS
 PLAT NO'S 19804 THRU 19808
 LOTS 1,26 & 27 THRU 43
 ZONED: R-20
 TAX MAP NO.: 17 PARCEL NO'S: 42 & 43 GRID NO'S: 6 & 12
 SECOND ELECTION DISTRICT, HOWARD COUNTY, MARYLAND
 SCALE: 1" = 30' DATE: FEBRUARY, 2009
 SHEET 3 OF 6

SDP 09-038

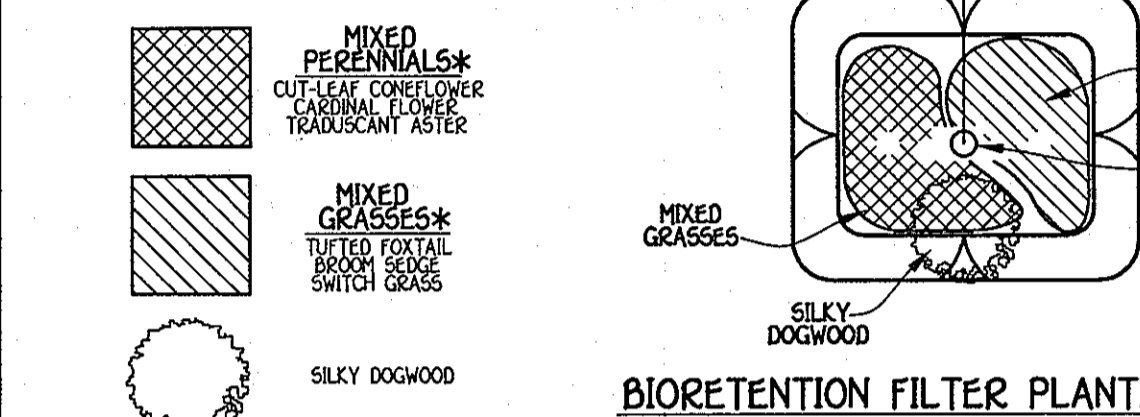
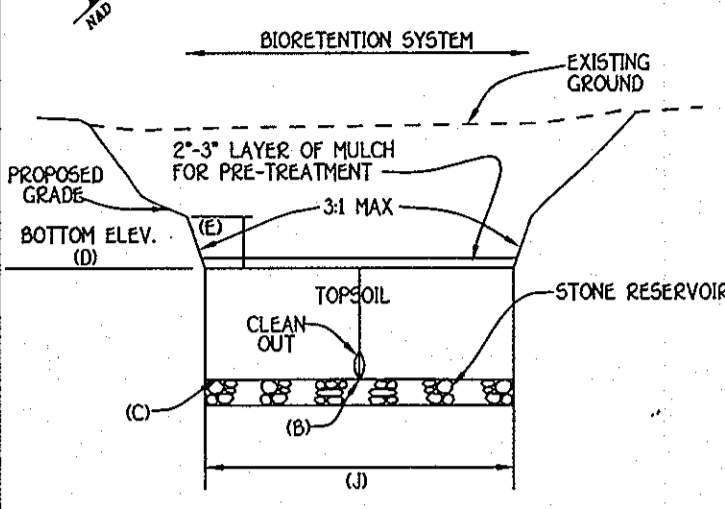

PRIVATE BIORETENTION FILTER OPERATION & MAINTENANCE SCHEDULE

- ANNUAL MAINTENANCE OF PLANT MATERIAL, MULCH LAYER AND SOIL LAYER IS REQUIRED. MAINTENANCE OF MULCH AND SOIL IS LIMITED TO CORRECTING AREAS OF EROSION OR WASH OUT. ANY MULCH REPLACEMENT SHALL BE DONE IN THE SPRING. PLANT MATERIAL SHALL BE CHECKED FOR DISEASE AND INSECT INFESTATION AND MAINTENANCE WILL ADDRESS DEAD MATERIAL AND PRUNING.
- SCHEDULE OF PLANT INSPECTION WILL BE TWICE A YEAR IN SPRING AND FALL. THIS INSPECTION WILL INCLUDE REMOVAL OF DEAD AND DISEASED VEGETATION BEYOND TREATMENT. TREATMENT OF ALL DISEASED TREES AND SHRUBS AND REPLANTING OF ALL DEFICIENT TREES AND SHRUBS.
- MULCH SHALL BE INSPECTED EACH SPRING. REMOVE PREVIOUS MULCH LAYER BEFORE APPLYING NEW LAYER ONCE EVERY 2 TO 3 YEARS.
- SOIL EROSION TO BE ADDRESSED ON AN AS NEEDED BASIS, WITH A MINIMUM OF ONCE PER MONTH AND AFTER HEAVY STORM EVENTS.

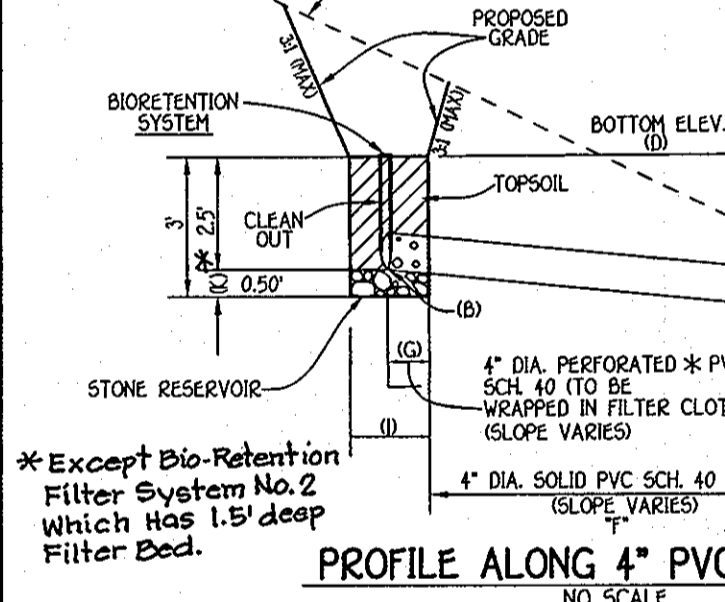

BIORETENTION FILTER PLANT MATERIAL	QUANTITY	NAME	MAXIMUM SPACING (FT.)
	45	MIXED PERENNIALS	1 FT.
	45	MIXED GRASSES	1 FT.
	1	SILKY DOGWOOD	PLANT AWAY FROM INFLOW LOCATION

BIORETENTION FILTER DATA	A	B	C	D	E	F	G	H	I	J	K
1	433.20	433.50	435.00	435.50	24'	5.0'	7'	10'	0.50'		
2	427.70	428.75	430.50	431.00	50'	5.0'	12'	12'	0.50'		
3	428.00	430.00	432.50	433.00	35'	7.0'	10'	14'	0.50'		
4	428.50	427.00	428.50	429.00	40'	7.0'	10'	14'	0.50'		

ONLY 1 CLEANOUT
* C & H NOT REQUIRED

PROFESSIONAL CERTIFICATION

I HEREBY CERTIFY THAT THESE DOCUMENTS WERE PREPARED OR APPROVED BY ME AND THAT I AM A DULY LICENSED PROFESSIONAL ENGINEER UNDER THE LAWS OF THE STATE OF MARYLAND, LICENSE NO. 9753, EXPIRATION DATE: 2/28/10.

Earl D. Collins 2/7/09
EARL D. COLLINS DATE

ENGINEER'S CERTIFICATE

"I certify that this plan for erosion and sediment control represents a practical and workable plan based on my personal knowledge of the site conditions and that it was prepared in accordance with the requirements of the Howard Soil Conservation District."

Earl D. Collins 2/7/09
Signature of Engineer EARL D. COLLINS Date

DEVELOPER'S CERTIFICATE

"I/we certify that all development and construction will be done according to this plan for sediment and erosion control and that any responsible personnel involved in the construction project will have a Certificate of Attendance at a Department of the Environment Approved Training Program for the Control of Sediment and Erosion before beginning the project. I also authorize persons on site inspection by the Howard Soil Conservation District."

B. James Greenfield 3/19/09
Signature of Developer B. JAMES GREENFIELD Date

This development plan is approved for erosion and sediment control by the Howard Soil Conservation District.

John K. Robertson 3/26/09
John K. Robertson Date

OWNER/DEVELOPER
MID-ATLANTIC LAND DEVELOPMENT COMPANY
C/O B. JAMES GREENFIELD
6420 AUTUMN SKY WAY
COLUMBIA, MARYLAND 21044
410-730-3939

APPROVED: HOWARD COUNTY DEPARTMENT OF PLANNING AND ZONING

John Starnes 5/1/09
Chief, Division of Land Development Date

Chris Damann 5/5/09
Chief, Development Engineering Division Date

Doreen E. Suttler 5/7/09
Director - Department of Planning and Zoning Date

PROJECT	SECTION	LOTS NO.			
HOLLIFIELD HILLS	N/A	1,26 & 27 THRU 43			
PLAT	BLOCK NO.	ZONE	TAX/ZONE	ELEC. DIST.	CENSUS TR.
19084 THRU 19088	6 & 12	R-20	17	SECOND	
WATER CODE	SEWER CODE				
F-04	1450000				

SEDIMENT/EROSION CONTROL PLAN

SINGLE FAMILY DETACHED
HOLLIFIELD HILLS
PLAT NO. 5 19084 THRU 19088
LOTS 1,26 & 27 THRU 43
ZONED: R-20

TAX MAP NO.: 17 PARCEL NO.'S: 42 & 43 GRID NO.'S: 6 & 12
SECOND ELECTION DISTRICT, HOWARD COUNTY, MARYLAND
SCALE: 1" = 30' DATE: FEBRUARY, 2009

SHEET 4 OF 6

FISHER, COLLINS & CARTER, INC.
CIVIL ENGINEERING, CONSULTANTS & LAND SURVEYORS
CENTRAL SQUARE OFFICE PARK - 10275 BALTIMORE NATIONAL PIKE
ELLSWORTH CITY, MARYLAND 21041
(410) 461-2895

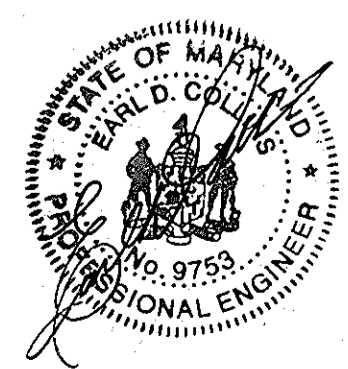

NO.	REVISION	DATE
1	Rev Bio-ret. data & detail for Lot 40	7-6-12

SDP 09-038

20.0 STANDARDS AND SPECIFICATIONS FOR VEGETATIVE STABILIZATION DEFINITION

Using vegetation as cover for barren soil to protect it from forces that cause erosion... PURPOSE... CONDITIONS WHERE PRACTICE APPLIES

VEGETATIVE STABILIZATION SPECIFICATIONS ARE USED TO PROMOTE the establishment of vegetation on exposed soil... EFFECTS ON WATER QUALITY AND QUANTITY

SECTION 1 - VEGETATIVE STABILIZATION METHODS AND MATERIALS

- A. Site Preparation... B. Soil Amendments... C. Seeded Preparation... D. Seed Specifications... E. Methods of Seeding... F. Mulch Specifications... G. Mutching Seeded Areas... H. Securing Straw Mulch...

- I. Incremental Stabilization - Cut Slopes... J. Incremental Stabilization of Embankments - Full Slopes... K. Construction Sequence... L. Seeded Preparation... M. Seed Specifications... N. Methods of Seeding... O. Mulch Specifications... P. Mutching Seeded Areas... Q. Securing Straw Mulch... R. Sequence of Construction

STANDARDS AND SPECIFICATIONS FOR TOPSOIL

Definition... Purpose... Conditions Where Practice Applies

- 1. This practice is limited to areas having 2:1 or flatter slopes where: a. The texture of the exposed subsoil/parent material is not adequate to produce vegetative growth... b. The soil material is so shallow that the rooting zone is not deep enough to support plants... c. The original soil to be vegetated contains material toxic to plant growth... d. The soil is so acidic that treatment with limestone is not feasible...

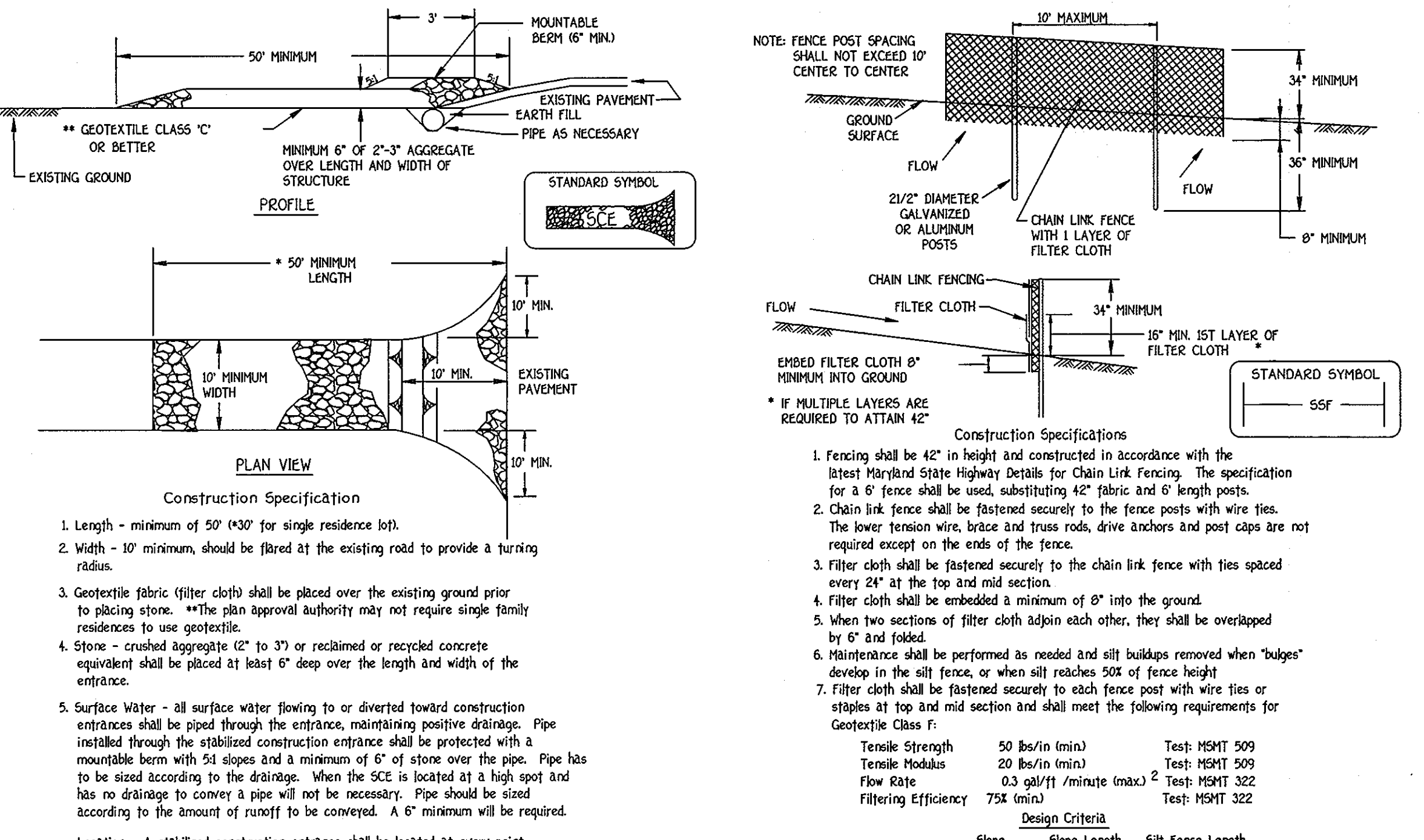

TEMPORARY SEEDING NOTES

- 1. A MINIMUM OF 48 HOURS NOTICE MUST BE GIVEN TO THE HOWARD COUNTY DEPARTMENT OF INSPECTIONS... 2. ALL VEGETATIVE AND STRUCTURAL PRACTICES ARE TO BE INSTALLED ACCORDING TO THE PROVISIONS OF THIS PLAN AND ARE TO BE IN CONFORMANCE WITH THE MOST CURRENT MARYLAND STANDARDS AND SPECIFICATIONS FOR SOIL EROSION AND SEDIMENT CONTROL... 3. FOLLOWING INITIAL SOIL DISTURBANCE OR RE-DISTURBANCE, PERMANENT OR TEMPORARY STABILIZATION SHALL BE COMPLETED WITHIN 30 CALENDAR DAYS...

PERMANENT SEEDING NOTES

- Apply to graded or cleared areas not subject to immediate further disturbance where a permanent long-lived vegetative cover is needed... SEEDING PREPARATION - Loosen upper three inches of soil by raking, discing or other acceptable means before seeding... SEEDING - Apply 2 tons per acre dolomitic limestone (92 lbs. per 1000 sq.ft.) before seeding...

SEQUENCE OF CONSTRUCTION

Table with 2 columns: Activity and Duration. Rows include: OBTAIN GRADING PERMIT (7 DAYS), INSTALL SEDIMENT AND EROSION CONTROL DEVICES AS SHOWN ON PLAN (7 DAYS), CLEAR AND GRUB TO LIMITS OF DISTURBANCE (4 DAYS), INSTALL TEMPORARY SEEDING (2 DAYS), CONSTRUCT BUILDINGS (60 DAYS), FINE GRADE SITE AND INSTALL PERMANENT SEEDING AND LANDSCAPE (14 DAYS), REMOVE SEDIMENT CONTROL DEVICES AS UPLAND AREAS ARE STABILIZED AND PERMISSION IS GRANTED BY E/S CONTROL INSPECTOR (7 DAYS).

AT GRADE INLET PROTECTION



EROSION CONTROL MATTING



ENGINEER'S CERTIFICATE, DEVELOPER'S CERTIFICATE, and various project details including site name, location, and dates.

OWNER/DEVELOPER information, including company name, address, and contact details.

SEDIMENT/EROSION CONTROL NOTES & DETAILS. SINGLE FAMILY DETACHED HOLLIFIELD HILLS. PLAT NO.'S 19804 THRU 19808. LOTS 1,26 & 27 THRU 43. ZONED: R-20. TAX MAP NO: 17 PARCEL NO'S: 42 & 43 GRID NO'S: 6 & 12 SECOND ELECTION DISTRICT, HOWARD COUNTY, MARYLAND. SCALE: AS SHOWN DATE: FEBRUARY, 2009. SHEET 5 OF 6.

SDP 09-038

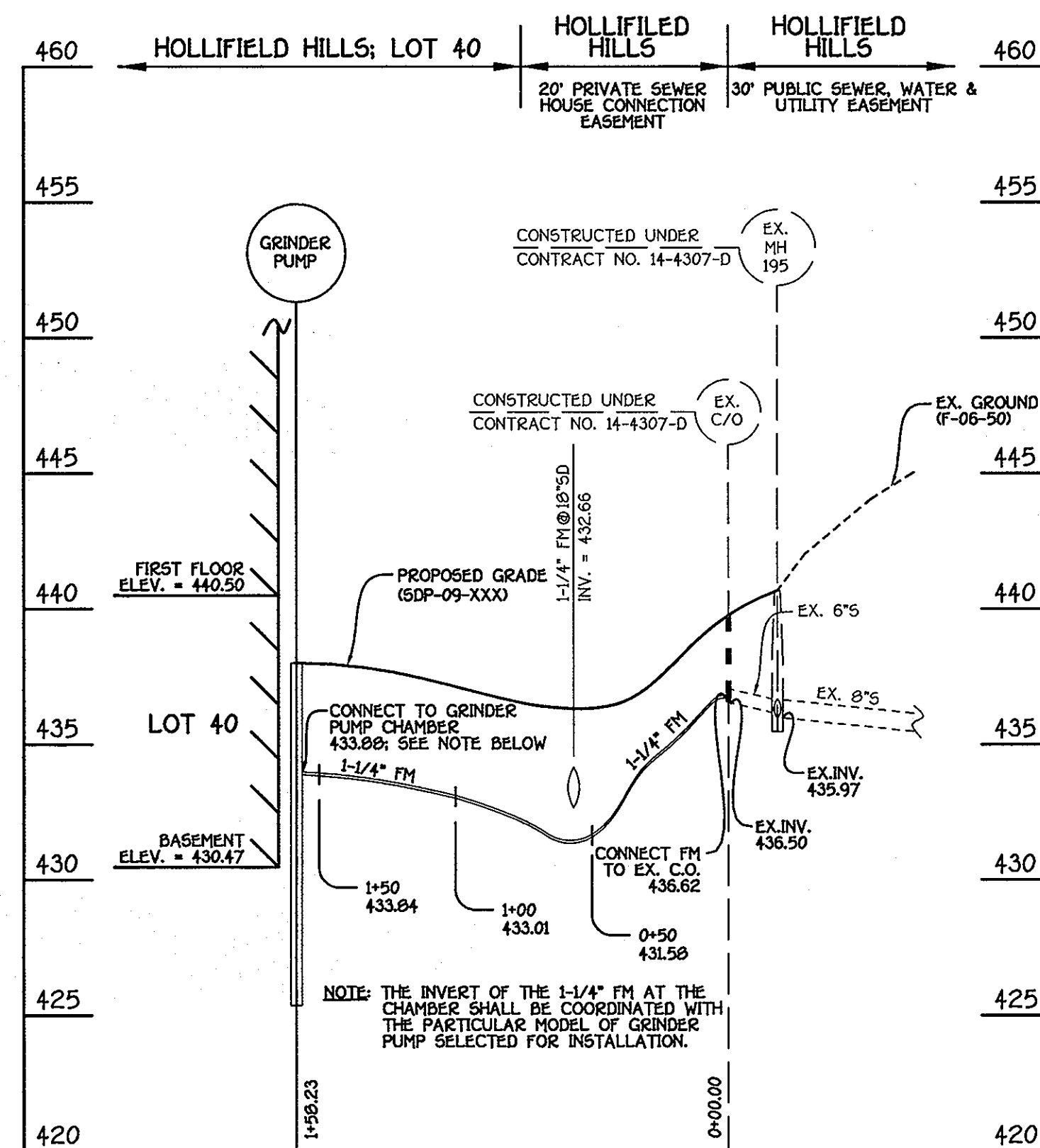

PRIVATE 1-1/4" FM TO LOT 40

SCALE: HORZ. : 1" = 50'
VERT. : 1" = 5'

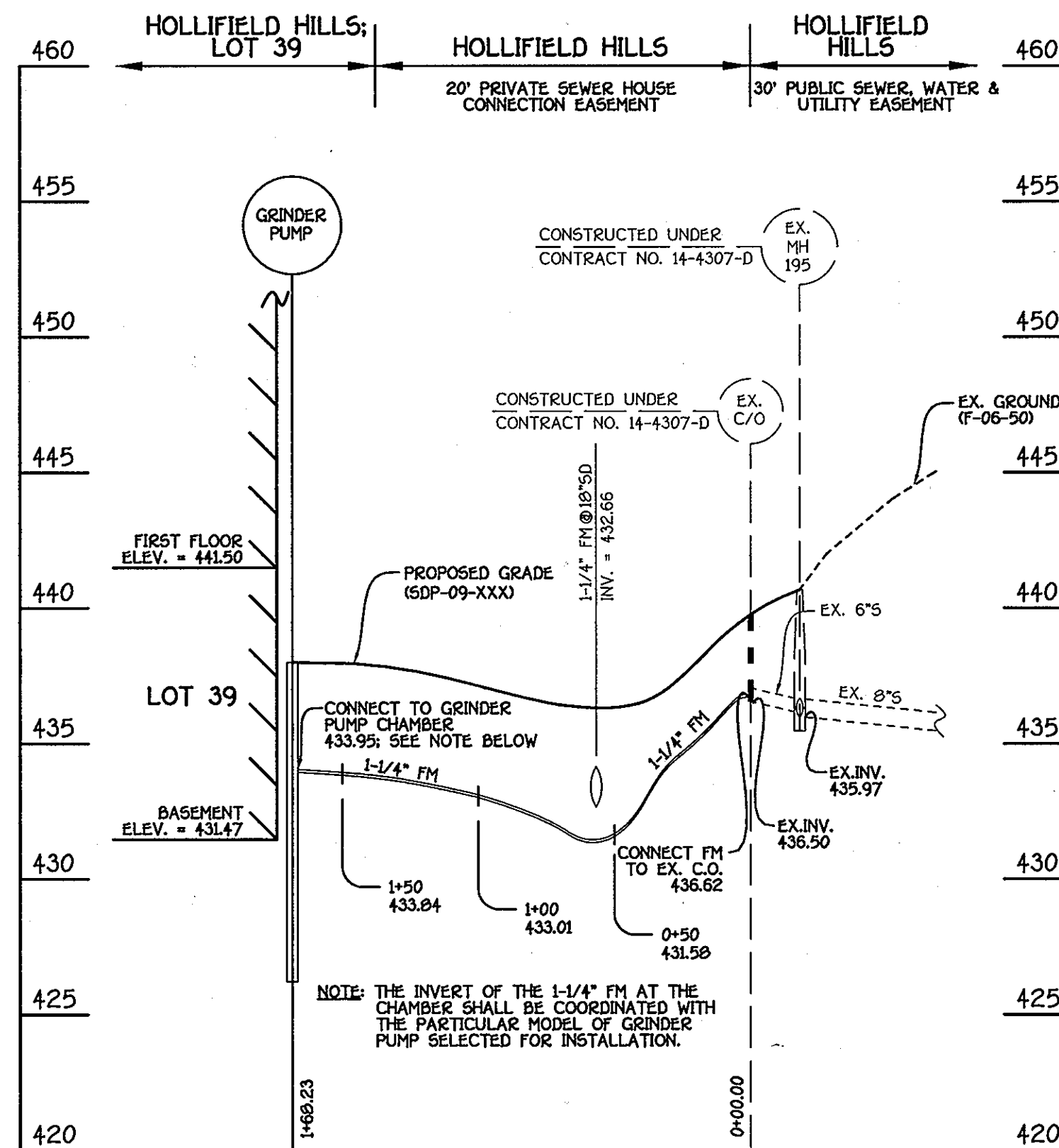

PRIVATE 1-1/4" FM TO LOT 39

SCALE: HORZ. : 1" = 50'
VERT. : 1" = 5'

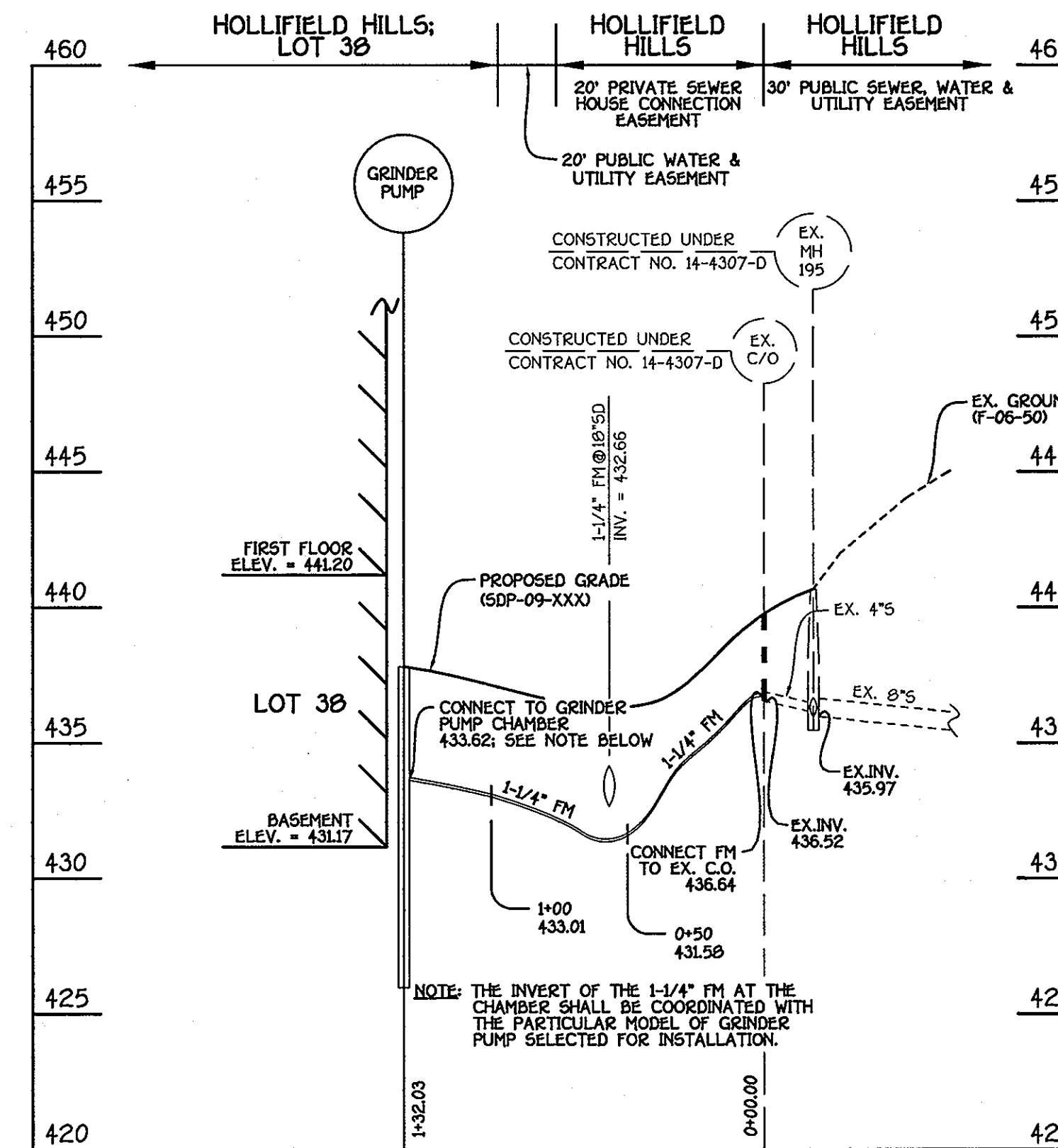

PRIVATE 1-1/4" FM TO LOT 38

SCALE: HORZ. : 1" = 50'
VERT. : 1" = 5'

FISHER, COLLINS & CARTER, INC.
CIVIL ENGINEERING CONSULTANTS & LAND SURVEYORS
CENTENNIAL SQUARE OFFICE PARK - 10072 BALTIMORE NATIONAL PIKE
ELKLOTT CITY, MARYLAND 21942
(410) 461-2999

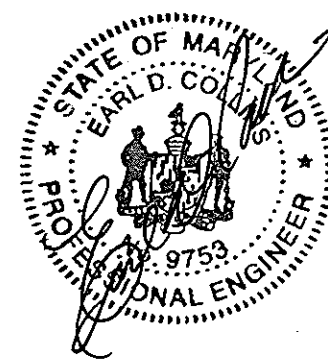

ENGINEER'S CERTIFICATE

"I certify that this plan for erosion and sediment control represents a practical and workable plan based on my personal knowledge of the site conditions and that it was prepared in accordance with the requirements of the Howard Soil Conservation District."

Signature of Engineer: *Earl D. Collins* Date: 3/17/09

DEVELOPER'S CERTIFICATE

"I/we certify that all development and construction will be done according to this plan, for sediment and erosion control and that any responsible personnel involved in the construction project will have a Certificate of Attendance at a Department of the Environment Approved Training Program for the Control of Sediment and Erosion before beginning the project. I also authorize periodic site inspection by the Howard Soil Conservation District."

Signature of Developer: *B. James Greenfield* Date: 3/17/09

OWNER/DEVELOPER

MID-ATLANTIC LAND DEVELOPMENT COMPANY
C/O B. JAMES GREENFIELD
6420 AUTUMN SKY WAY
COLUMBIA, MARYLAND 21044
410-730-3559

APPROVED: HOWARD COUNTY DEPARTMENT OF PLANNING AND ZONING

Chief, Division of Land Development: *Cindy Hunt* Date: 5/12/09
Chief, Development Engineering Division: *Bob Daum* Date: 5/16/09
Director - Department of Planning and Zoning: *Priscilla S. Suttle* Date: 5/17/09

PROJECT	HOLLIFIELD HILLS	SECTION	N/A	LOTS NO.	1,26 & 27 THRU 43
PLAT	1988A THRU 1988B	BLOCK NO.	6 & 12	ZONE	R-20
TAX/ZONE	17	ELEC. DIST.	SECOND	CENSUS TR.	
WATER CODE	F-04	SEWER CODE	1450000		

SEWER PROFILES

SINGLE FAMILY DETACHED
HOLLIFIELD HILLS
PLAT NO.'S 1988A THRU 1988B
LOTS 1,26 & 27 THRU 43
ZONED: R-20

TAX MAP NO.: 17 PARCEL NO.'S: 42 & 43 GRID NO.'S: 6 & 12
SECOND ELECTION DISTRICT, HOWARD COUNTY, MARYLAND
SCALE: AS SHOWN DATE: FEBRUARY, 2009

SHEET 6 OF 6

SDP 09-038