

PERMANENT SEEDING NOTES

APPLY TO GRADED OR CLEARED AREAS NOT SUBJECT TO UTILITY-LINE DISTURBANCE WHERE A PERMANENT LONG-LIVED VEGETATIVE COVER IS REQUIRED.

SEEDING PREPARATION: Loosen upper three inches of soil by raking, discing or other acceptable means before seeding if not previously done.

SOIL AMENDMENTS: In lieu of soil test recommendations, use one of the following schedules:

- 1) Preferred-Agry 2 tons per acre granular limestone (12 lbs/100 sq ft) and soil less than pH 6.0 fertilizer (4 lbs/100 sq ft) and 100-0-0 uniform fertilizer (4 lbs/1000 sq ft).
- 2) Preferred-Agry 2 tons per acre granular limestone (12 lbs/100 sq ft) and soil less than pH 6.0 fertilizer (4 lbs/100 sq ft) and 100-0-0 uniform fertilizer (4 lbs/1000 sq ft).

SEEDING: For the period March 1 thru April 30 and August 1 thru October 31, seed with 2 1/2 bushels of annual ryegrass (1.5 lbs/1000 sq ft) and 1/2 bushel of winter wheat (0.7 lbs/1000 sq ft). For the period November 1 thru February 28, seed with 2 tons of well-anchored straw mulch and seed as specified in the same section (2) use section (3) seed with 30 lbs/1000 sq ft of annual ryegrass.

MULCHING: Apply 1/2 to 2 tons per acre (70 to 140 lbs/1000 sq ft) of well-anchored straw mulch immediately after seeding. Another mulch immediately after application using mulch anchoring tool (18 inches x 18 inches x 1/2 inch) or equivalent, or established on flat areas. On slopes 6 feet or higher, use 3/8 gallon per acre of well-anchored straw mulch and seed as specified in the same section (2) use section (3) seed with 30 lbs/1000 sq ft of annual ryegrass.

TEMPORARY SEEDING NOTES

SEEDING PREPARATION: Loosen upper three inches of soil by raking, discing or other acceptable means before seeding if not previously done.

SOIL AMENDMENTS: Apply 600 lbs. per acre 10-10-10 fertilizer (14 lbs/1000 sq ft).

SEEDING: For the period March 1 thru April 30 and August 1 thru October 31, seed with 2 1/2 bushels of annual ryegrass (1.5 lbs/1000 sq ft) and 1/2 bushel of winter wheat (0.7 lbs/1000 sq ft). For the period November 1 thru February 28, seed with 2 tons of well-anchored straw mulch and seed as specified in the same section (2) use section (3) seed with 30 lbs/1000 sq ft of annual ryegrass.

MULCHING: Apply 1/2 to 2 tons per acre (70 to 140 lbs/1000 sq ft) of well-anchored straw mulch immediately after seeding. Another mulch immediately after application using mulch anchoring tool (18 inches x 18 inches x 1/2 inch) or equivalent, or established on flat areas. On slopes 6 feet or higher, use 3/8 gallon per acre of well-anchored straw mulch and seed as specified in the same section (2) use section (3) seed with 30 lbs/1000 sq ft of annual ryegrass.

210 STANDARDS AND SPECIFICATIONS FOR TOPSOIL

Definition: Placement of topsoil over a prepared subsoil prior to establishment of permanent vegetation.

Purpose: To provide a suitable soil medium for vegetative growth.

Conditions Where Practice Applies:

1. This practice is limited to areas having 211 or flatter slopes where the texture of the exposed subsoil/parent material is not adequate to produce vegetative growth.
2. The soil material is so shallow that the rooting zone is not deep enough to support plants or furnish continuing supplies of moisture and plant nutrients.
3. The original soil to be vegetated contains material less than 1/4 inch in size.
4. The soil is so acidic that treatment with limestone is not feasible.

Construction and Material Specifications:

1. Topsoil salvaged from the existing site may be used provided that it meets the standards set forth in these specifications. The depth of topsoil to be salvaged for a given soil type can be found in the "Soil Salvage" section of the Soil Salvage Manual published by USDA-NRCS in cooperation with Maryland Agricultural Experiment Station.
1. Topsoil specifications - soil to be used as topsoil must meet the following:
 - a. Topsoil shall be loam, sandy loam, clay loam, silt loam, sandy clay loam, loamy sand, or loam, as determined by a soil scientist and approved by the appropriate authority.
 - b. Topsoil shall not be a mixture of contrasting textures, subsols and soil carbon less than 5% by volume of coarse, silty, clay, coarse fragments, gravel, sticks, rocks, trash, or other materials larger than 1 and 1/2" in diameter.
 - c. Topsoil must be free of plants or plant parts such as Bermuda grass, quackgrass, johnsongrass, nutgrass, poison ivy, thistle, or others as specified.

SEDIMENT CONTROL NOTES

1. A minimum of 48 hours notice must be given to the Howard County Department of Inspection, License and Permits Sediment Control Division prior to the start of any construction (315-1880).
2. All vegetation and structural practices are to be installed according to the provisions of this plan and are to be in conformance with the 1994 MARYLAND STANDARDS AND SPECIFICATIONS FOR SOIL EROSION AND SEDIMENT CONTROL and respective Chapter.
3. Following initial soil disturbance or redistribution, permanent or temporary sediment control structures, dikes, perimeter slopes, and all slopes greater than 3:1, (3:1) 14 days as to all other disturbed or graded areas on the project site.
4. All sediment traps/basins shall be fenced and warning signs posted around their perimeter in accordance with Vol. 1, Chapter 7, HOWARD COUNTY DESIGN MANUAL, Storm Drainage.
5. All disturbed areas must be stabilized within the time period specified above in accordance with the 1994 MARYLAND STANDARDS AND SPECIFICATIONS FOR SOIL EROSION AND SEDIMENT CONTROL for permanent seeding, soil temporary seeding, and mulching (Sec. G). Temporary stabilization with mulch alone shall be done when recommended seeding species do not allow for proper germination and establishment of grasses.
6. All sediment control structures are to remain in place and are to be maintained in operative condition until permission for their removal has been obtained from the Howard County Sediment Control Inspector.
7. Site Analysis:

Total Area	0.42 Acres
Area Disturbed	0.24 Acres
Area to be seeded or paved	0.24 Acres
Area to be vegetatively stabilized	0.18 Acres
Total Fill	1200 C.Y.
Off-site water/borrow area location	??
8. Any sediment control practice which is disturbed by grading activity for placement of utilities must be repaired on the same day of disturbance.
9. Additional sediment controls must be provided, if deemed necessary by the Howard County Sediment Control Inspector.
10. On all sites with disturbed areas in excess of 2 acres, approval of the inspection agency shall be requested upon completion of installation of perimeter fence and sediment controls, but before proceeding with any other earth disturbance or grading. Other building or grading inspection approvals may not be authorized until this initial approval by the inspection agency is made.

Earthwork quantities are solely for the purpose of calculating fees. Contractor to verify all quantities prior to start of construction.

To be determined by contractor, with pre-approval of the Sediment Control Inspector with an approved and active grading permit.

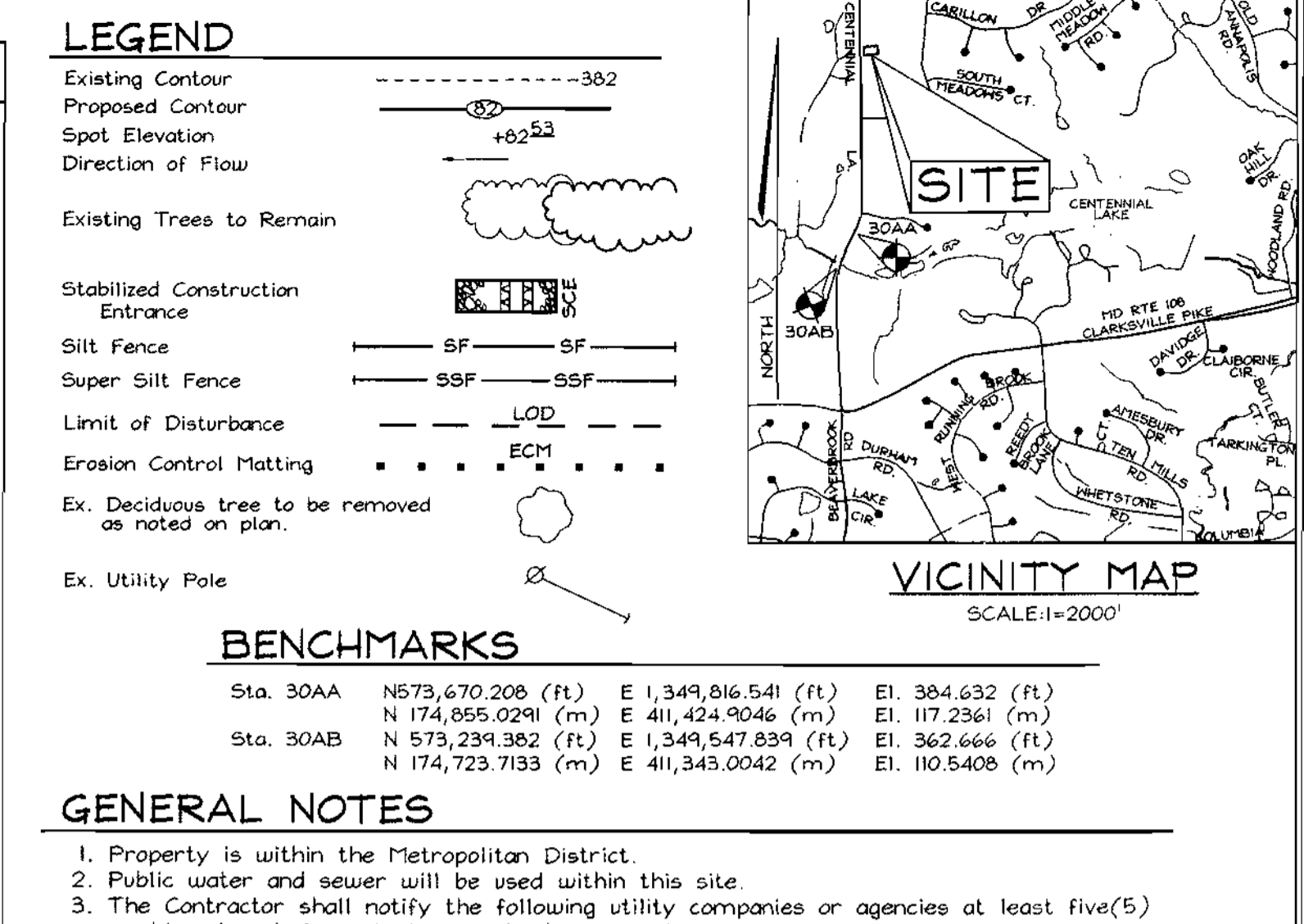
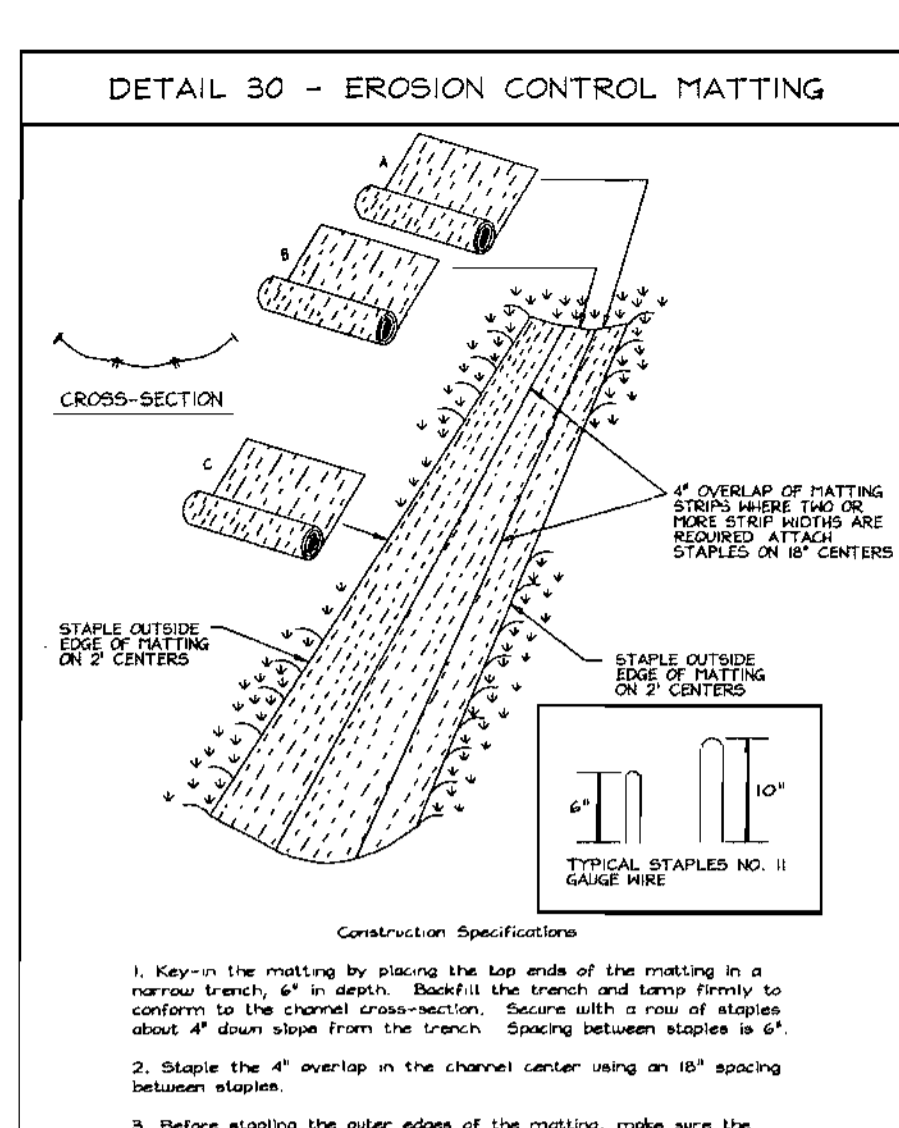
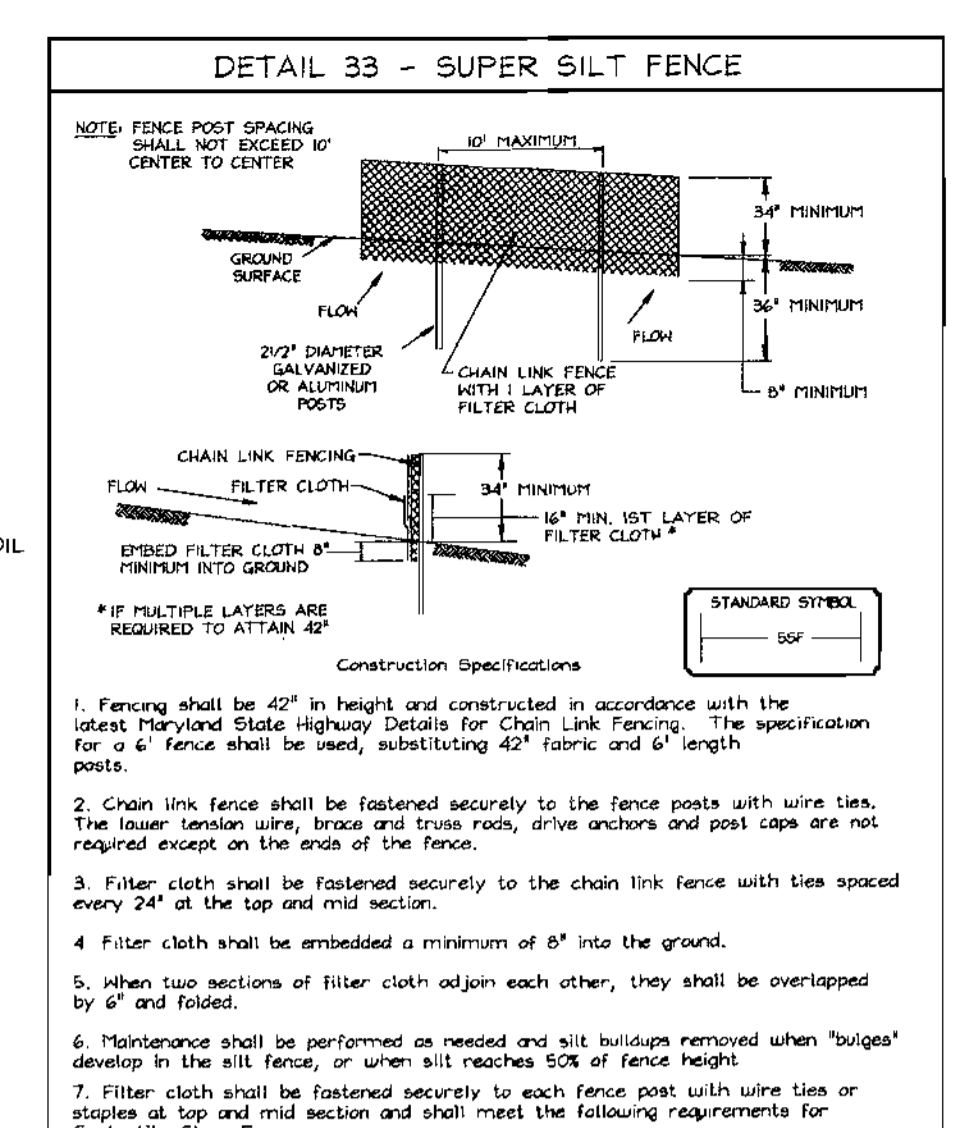

SCHEDULE A PERIMETER LANDSCAPE EDGE

CATEGORY	ADJACENT TO ROADWAYS	ADJACENT TO PERIMETER PROPERTIES
Perimeter/Frontage Designation Landscape Type	4*	1 2 3
Linear Feet of Roadway	105	175 105 178
Credit for Existing Vegetation (Yes, No, Linear Feet)	-	-
Remaining Perimeter Length (Yes, No, Linear Feet)	-	-
Remaining Perimeter Length (Describe Plant Substitution Credits Below if needed)	-	-
Shade Trees	160 3	160 2
Evergreen Trees	-	160 3
Number of Plants Provided	-	-
Shade Trees	-	3
Evergreen Trees	-	2
Other Trees (21 Substitution)	-	2
Shrubs (101 Substitution)	-	-
(Describe Plant Substitution Credits Below if needed)	-	-

* No landscaping required since House fronts road.

Credit taken for an Existing 24" Tree to remain.

