

**SITE ANALYSIS DATA**

1. Site Analysis:

Total Area of Site	= 1.828 Acres
Area Disturbed	= 0.71 Acres
Area to be roofed or paved	= 0.16 Acres
Area to be vegetatively stabilized	= 0.55 Acres
Total Cut	= 5,900 Cu. Yds.
Total Fill	= 7,400 Cu. Yds.

2. Zoning NTSFLD Per 10/18/93 Comprehensive Zoning Plan.

3. Proposed usage of site is residential (Single Family Home).

4. Total number of units proposed for site is one (1) unit.

5. Maximum lot coverage permitted is 15%.

**STANDARD SEDIMENT CONTROL NOTES**

1. A minimum of 48 hours notice must be given to the Howard County Department of Inspections, Licenses and Permits, Sediment Control Division prior to the start of any construction (313-1855).

2. All vegetative and structural practices are to be installed according to the provisions of this plan and are to be in conformance with the 1994 MARYLAND STANDARDS AND SPECIFICATIONS FOR SOIL EROSION AND SEDIMENT CONTROL and revisions thereto.

3. Following initial soil disturbance or re-disturbance, permanent or temporary stabilization shall be complete within:

- 7 calendar days for all perimeter sediment control structures, dikes, perimeter slopes and all slopes steeper than 3:1.
- 14 days as to all other disturbed or graded areas on the project site.

4. All sediment traps/basins shown must be fenced and warning signs posted around their perimeter in accordance with Vol 1, Chapter 7 of the HOWARD COUNTY DESIGN MANUAL, Storm Drainage.

5. All disturbed areas must be stabilized within the time period specified above in accordance with the 1994 MARYLAND STANDARDS AND SPECIFICATIONS FOR SOIL EROSION AND SEDIMENT CONTROL for permanent seeding, sod, temporary seeding, and mulching (Sec. G). Temporary stabilization with mulch alone shall only be done when recommended seeding dates do not allow for proper germination and establishment of grasses.

6. All sediment control structures are to remain in place and are to be maintained in operation until their removal has been obtained from the Howard County Sediment Control Inspector.

7. Any sediment control practice which is disturbed by grading activity for placement of utilities must be repaired on the same day of disturbance.

8. Additional sediment control must be provided, if deemed necessary by the Howard County Sediment Control Inspector.

9. On all sites with disturbed areas in excess of 2 acres, approval of the inspection agency shall be requested upon completion of installation of perimeter erosion and sediment controls, but before proceeding with any other earth disturbance or grading. Other building or grading inspection approvals may not be authorized until this initial approval by the inspection agency is made.

10. Trenches for the construction of utilities is limited to three pipe lengths or that which shall be back-filled and stabilized within one working day, whichever is shorter.

**USE-IN-COMMON LINE CHART**

LINE	BEARING	DISTANCE
L1	N 62°08'28" E	202.74'
L2	S 54°17'00" E	27.17'
L3	S 09°56'07" E	170.56'
L4	S 66°29'42" W	45.00'
L5	N 19°32'00" W	105.00'
L6	N 09°13'58" W	116.05'
L7	N 62°08'28" E	240.00'

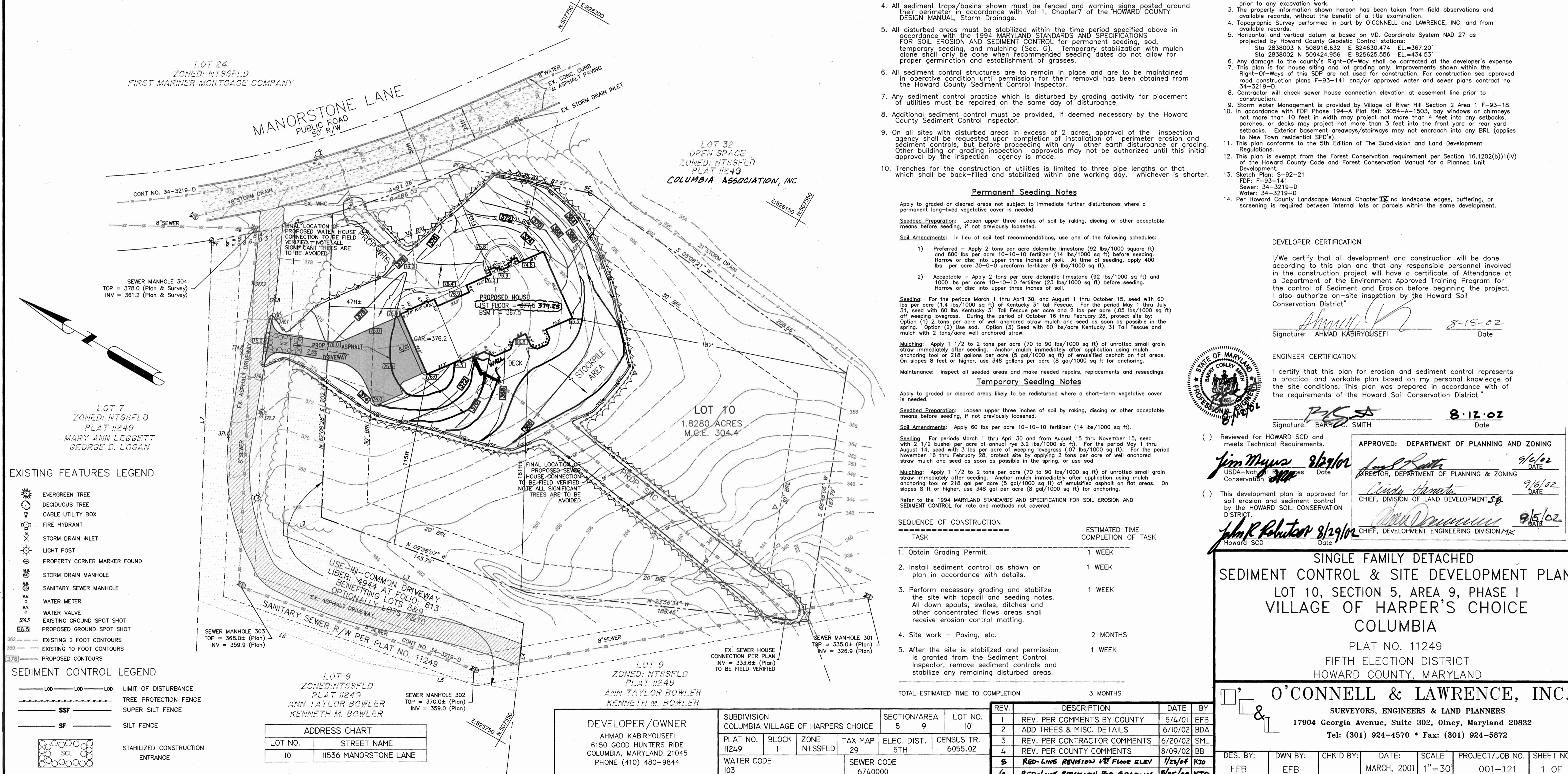
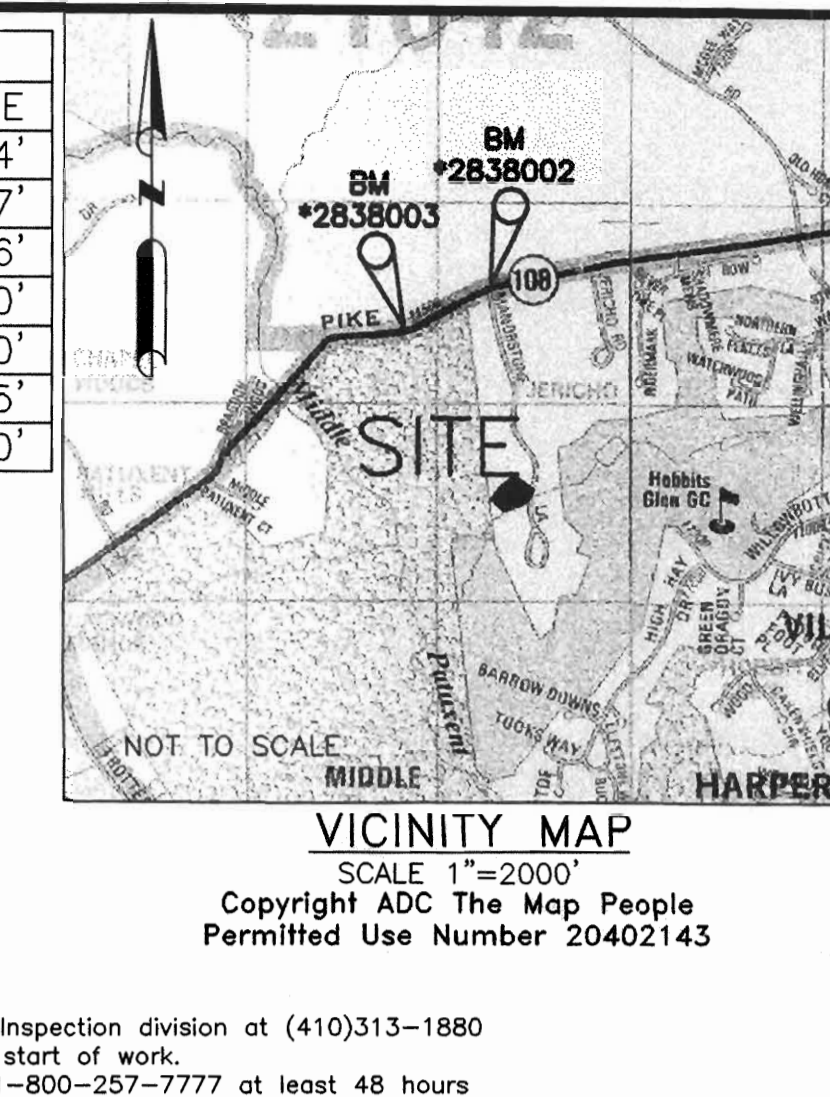

**Permanent Seeding Notes**

Apply to graded or cleared areas not subject to immediate further disturbances where a permanent long-lived vegetative cover is needed.

**Seedbed Preparation:** Loosen upper three inches of soil by raking, discing or other acceptable means before seeding, if not previously loosened.

**Soil Amendments:** In lieu of soil test recommendations, use one of the following schedules:

- Preferred - Apply 2 tons per acre dolomitic limestone (92 lbs/1000 square ft) and 600 lbs per acre 10-10-10 fertilizer (14 lbs/1000 sq ft) before seeding. Harrow or disc into upper three inches of soil. At time of seeding, apply 400 lbs per acre 30-0-0 ureaform fertilizer (9 lbs/1000 sq ft).
- Acceptable - Apply 2 tons per acre dolomitic limestone (92 lbs/1000 sq ft) and 1000 lbs per acre 10-10-10 fertilizer (23 lbs/1000 sq ft) before seeding. Harrow or disc into upper three inches of soil.

**Seeding:** For the periods March 1 thru April 30, and August 1 thru October 15, seed with 60 lbs per acre (1.4 lbs/1000 sq ft) of Kentucky 31 tall Fescue. For the period May 1 thru July 31, seed with 60 lbs Kentucky 31 Tall Fescue per acre and 2 lbs per acre (.05 lbs/1000 sq ft) of weeping lovegrass. During the period of October 16 thru February 28, protect site by: Option (1) 2 tons per acre of well anchored straw mulch and seed as soon as possible in the spring. Option (2) Use sod. Option (3) Seed with 60 lbs/acre Kentucky 31 Tall Fescue and mulch with 2 tons/acre well anchored straw.

**Mulching:** Apply 1 1/2 to 2 tons per acre (70 to 90 lbs/1000 sq ft) of unrotted small grain straw immediately after seeding. Anchor mulch immediately after application using mulch anchoring tool or 218 gallons per acre (5 gal/1000 sq ft) of emulsified asphalt on flat areas. On slopes 8 feet or higher, use 348 gallons per acre (8 gal/1000 sq ft) for anchoring.

**Maintenance:** Inspect all seeded areas and make needed repairs, replacements and reseedings.

**Temporary Seeding Notes**

Apply to graded or cleared areas likely to be redisturbed where a short-term vegetative cover is needed.

**Seedbed Preparation:** Loosen upper three inches of soil by raking, discing or other acceptable means before seeding, if not previously loosened.

**Soil Amendments:** Apply 80 lbs per acre 10-10-10 fertilizer (14 lbs/1000 sq ft).

**Seeding:** For periods March 1 thru April 30 and from August 15 thru November 15, seed with 2 1/2 bushel per acre of annual ryegrass (3.2 lbs/1000 sq ft). For the period May 1 thru August 14, seed with 3 lbs per acre of weeping lovegrass (.07 lbs/1000 sq ft). For the period November 16 thru February 28, protect site by applying 2 tons per acre of well anchored straw mulch and seed as soon as possible in the spring, or use sod.

**Mulching:** Apply 1 1/2 to 2 tons per acre (70 to 90 lbs/1000 sq ft) of unrotted small grain straw immediately after seeding. Anchor mulch immediately after application using mulch anchoring tool or 218 gal per acre (5 gal/1000 sq ft) of emulsified asphalt on flat areas. On slopes 8 ft or higher, use 348 gal per acre (8 gal/1000 sq ft) for anchoring.

Refer to the 1994 MARYLAND STANDARDS AND SPECIFICATION FOR SOIL EROSION AND SEDIMENT CONTROL for rate and methods not covered.

**SEQUENCE OF CONSTRUCTION**

TASK	ESTIMATED TIME COMPLETION OF TASK
1. Obtain Grading Permit.	1 WEEK
2. Install sediment control as shown on plan in accordance with details.	1 WEEK
3. Perform necessary grading and stabilize the site with topsoil and seeding notes. All down spouts, swales, ditches and other concentrated flows areas shall receive erosion control matting.	1 WEEK
4. Site work - Paving, etc.	2 MONTHS
5. After the site is stabilized and permission is granted from the Sediment Control Inspector, remove sediment controls and stabilize any remaining disturbed areas.	1 WEEK
<b>TOTAL ESTIMATED TIME TO COMPLETION</b>	<b>3 MONTHS</b>

REV.	DESCRIPTION	DATE	BY
1	REV. PER COMMENTS BY COUNTY	5/4/01	EFB
2	ADD TREES & MISC. DETAILS	6/10/02	BDA
3	REV. PER CONTRACTOR COMMENTS	6/20/02	SBL
4	REV. PER COUNTY COMMENTS	8/09/02	EFB
5	RED-LINE REVISION 1ST FLOOR ELEV	1/25/04	KTD
6	RED-LINE REVISION FOR GRADING	9/25/04	KTD

**DEVELOPER CERTIFICATION**

I/We certify that all development and construction will be done in accordance with the plan and that any responsible personnel involved in the construction project will have a certificate of Attendance at a Department of the Environment Approved Training Program for the control of Sediment and Erosion before beginning the project. I also authorize on-site inspection by the Howard Soil Conservation District.

Signature: AHMAD KABIRYOUSEFI Date: 8-15-02

**ENGINEER CERTIFICATION**

I certify that this plan for erosion and sediment control represents a practical and workable plan based on my personal knowledge of the site conditions. This plan was prepared in accordance with the requirements of the Howard Soil Conservation District.

Signature: BARRY C. SMITH Date: 8-12-02

APPROVED: DEPARTMENT OF PLANNING AND ZONING

9/6/02 DATE

9/6/02 DATE

9/5/02 DATE

**SINGLE FAMILY DETACHED SEDIMENT CONTROL & SITE DEVELOPMENT PLAN**

LOT 10, SECTION 5, AREA 9, PHASE I VILLAGE OF HARPER'S CHOICE COLUMBIA

PLAT NO. 11249 FIFTH ELECTION DISTRICT HOWARD COUNTY, MARYLAND

**O'CONNELL & LAWRENCE, INC.**

SURVEYORS, ENGINEERS & LAND PLANNERS

17904 Georgia Avenue, Suite 302, Olney, Maryland 20832

Tel: (301) 924-4570 • Fax: (301) 924-5872

DES. BY:	DWN BY:	CHK'D BY:	DATE:	SCALE:	PROJECT/JOB NO.:	SHEET NO.:
EFB	EFB		MARCH, 2001	1"=30'	001-121	1 OF 1

- EXISTING FEATURES LEGEND**
- EVERGREEN TREE
  - DECIDUOUS TREE
  - CABLE UTILITY BOX
  - FIRE HYDRANT
  - STORM DRAIN INLET
  - LIGHT POST
  - PROPERTY CORNER MARKER FOUND
  - STORM DRAIN MANHOLE
  - SANITARY SEWER MANHOLE
  - WATER METER
  - WATER VALVE
  - EXISTING GROUND SPOT SHOT
  - PROPOSED GROUND SPOT SHOT
  - EXISTING 2 FOOT CONTOURS
  - EXISTING 10 FOOT CONTOURS
  - PROPOSED CONTOURS
- SEDIMENT CONTROL LEGEND**
- LIMIT OF DISTURBANCE
  - TREE PROTECTION FENCE
  - SUPER SILT FENCE
  - SILT FENCE
  - STABILIZED CONSTRUCTION ENTRANCE

**ADDRESS CHART**

LOT NO.	STREET NAME
10	11536 MANORSTONE LANE

**DEVELOPER/OWNER**

AHMAD KABIRYOUSEFI  
6150 GOOD HUNTERS RIDE  
COLUMBIA, MARYLAND 21045  
PHONE (410) 480-9844

SUBDIVISION	COLUMBIA VILLAGE OF HARPER'S CHOICE
SECTION/AREA	5 9
LOT NO.	10
PLAT NO.	11249
BLOCK	I
ZONE	NTSSFLD
TAX MAP	29
ELEC. DIST.	5TH
CENSUS TR.	6055.02
WATER CODE	103
SEWER CODE	6740000